



# Ferrari F40 Competizione

Designed for Tamiya F40 Competizione 1993 Shell Kit No. 24284

SKU#2021

Scale Motorsport

SKU 2021

P.O. Box 823

Newtown, CT 06470 USA

customerservice@scalemotorsport.com

www.scalemotorsport.com

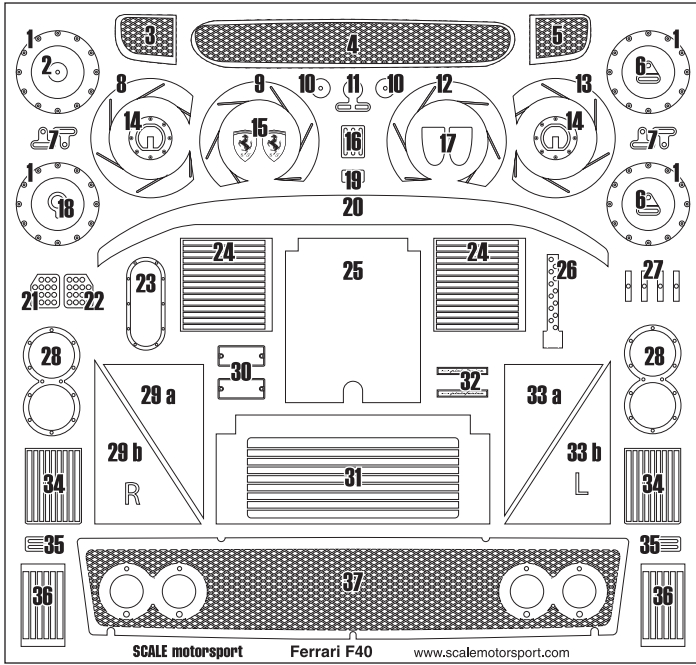

Photo-Etch Part numbers are followed by Tamiya part numbers if applicable and a brief description. Step numbers are coordinated with Tamiya instructions if applicable.

- |                       |                            |
|-----------------------|----------------------------|
| 1 F8 Hub Detail       | 21 B14 Brake Pedal         |
| 2 Seat Belt           | 22 B14 Clutch Pedal        |
| 3 R Intake Mesh       | 23 Exhaust Rim             |
| 4 Radiator Mesh       | 24 C24 Radiator F/B        |
| 5 L Intake Mesh       | 25 Exhaust Shield          |
| 6 Seat Belt           | 26 B12 Gas Pedal           |
| 7 Seat Belt           | 27 Body Latch              |
| 8 F8 Brake Disc       | 28 Tail Light Rim          |
| 9 F8 Brake Disc       | 29 Undertray               |
| 10 Seat Belt          | 30 Rear Lights Decal# (46) |
| 11 Seat Belt          | 31 B4 Radiator Face        |
| 12 F8 Brake Disc      | 32 Badges                  |
| 13 F8 Brake Disc      | 33 Undertray               |
| 14 Dry Break          | 34 D1 D5 Intercooler Face  |
| 15 Fender Emblem      | 35 Seat Belt               |
| 16 Shift Plate        | 36 C25 Radiator F/B        |
| 17 F2 F3 Mirror Faces | 37 Rear Body Mesh          |
| 18 Seat Belt          |                            |
| 19 Hood Badge         |                            |
| 20 Splitter           |                            |

## BUILD SOMETHING!



# Ferrari F40 Competizione

Designed for Tamiya F40 Competizione 1993 Shell Kit No. 24284

SKU#2021

Scale Motorsport

SKU 2021

P.O. Box 823

Newtown, CT 06470 USA

customerservice@scalemotorsport.com

www.scalemotorsport.com

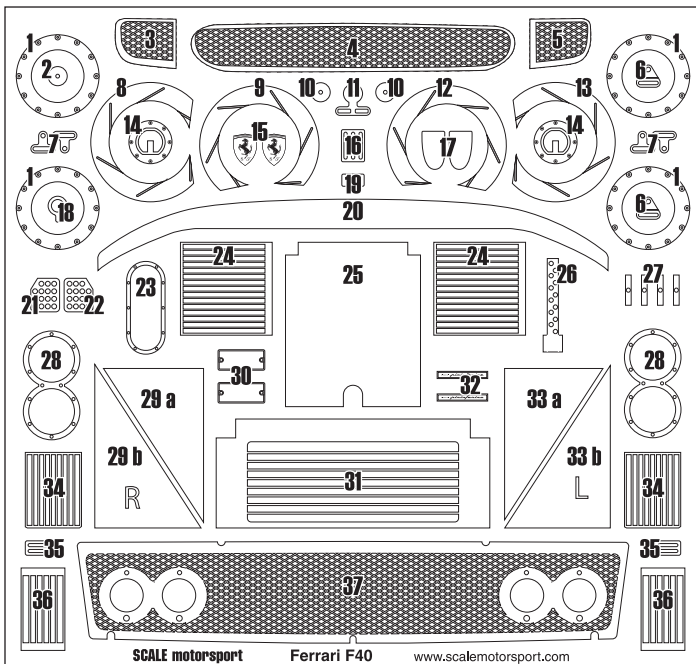
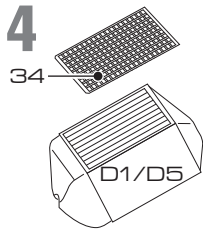
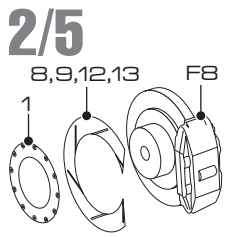

Photo-Etch Part numbers are followed by Tamiya part numbers if applicable and a brief description. Step numbers are coordinated with Tamiya instructions if applicable.

- |                       |                            |
|-----------------------|----------------------------|
| 1 F8 Hub Detail       | 21 B14 Brake Pedal         |
| 2 Seat Belt           | 22 B14 Clutch Pedal        |
| 3 R Intake Mesh       | 23 Exhaust Rim             |
| 4 Radiator Mesh       | 24 C24 Radiator F/B        |
| 5 L Intake Mesh       | 25 Exhaust Shield          |
| 6 Seat Belt           | 26 B12 Gas Pedal           |
| 7 Seat Belt           | 27 Body Latch              |
| 8 F8 Brake Disc       | 28 Tail Light Rim          |
| 9 F8 Brake Disc       | 29 Undertray               |
| 10 Seat Belt          | 30 Rear Lights Decal# (46) |
| 11 Seat Belt          | 31 B4 Radiator Face        |
| 12 F8 Brake Disc      | 32 Badges                  |
| 13 F8 Brake Disc      | 33 Undertray               |
| 14 Dry Break          | 34 D1 D5 Intercooler Face  |
| 15 Fender Emblem      | 35 Seat Belt               |
| 16 Shift Plate        | 36 C25 Radiator F/B        |
| 17 F2 F3 Mirror Faces | 37 Rear Body Mesh          |
| 18 Seat Belt          |                            |
| 19 Hood Badge         |                            |
| 20 Splitter           |                            |

## BUILD SOMETHING!



Seatbelt Hardware

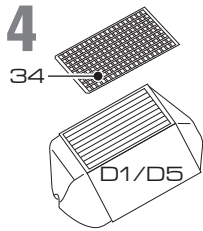
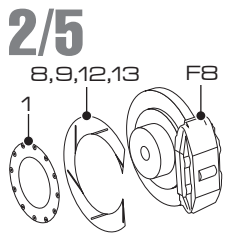
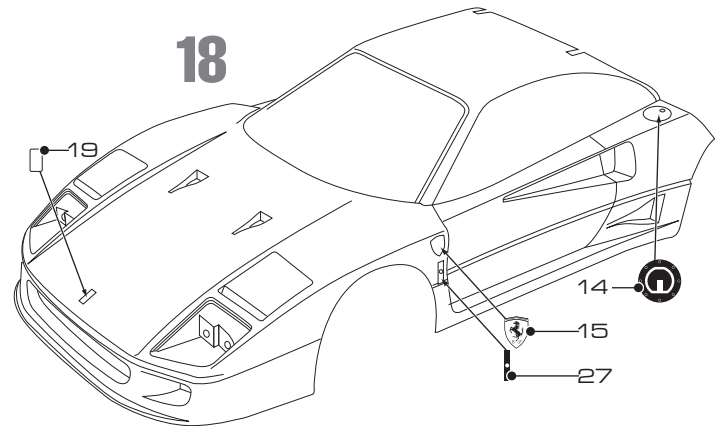
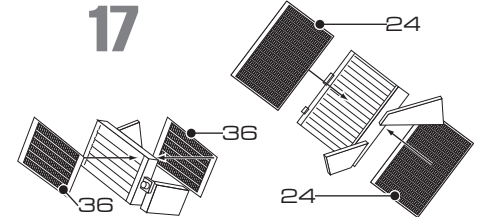
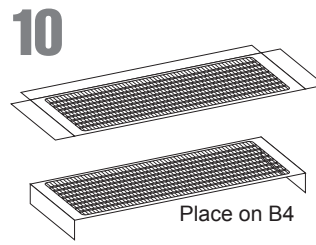
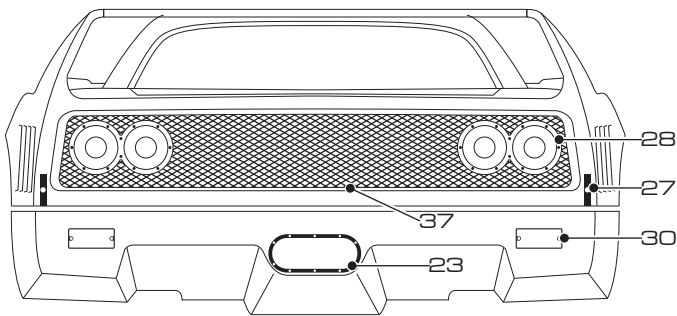
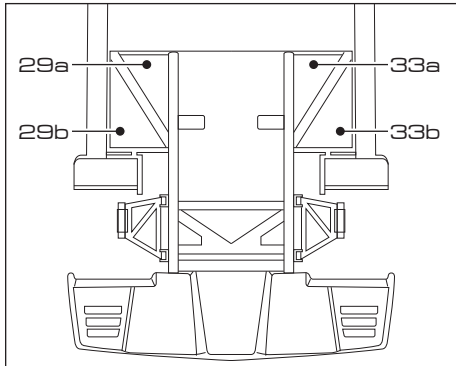
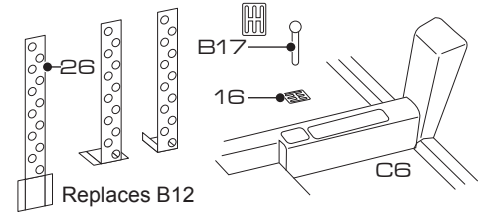
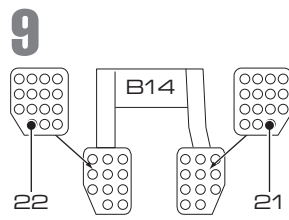
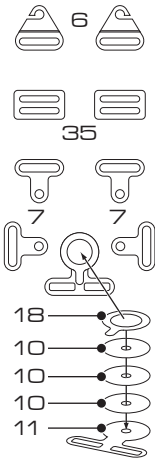

Seatbelt Hardware

