

1/35 Russian SPG ZiS30 Assembly Guide updated

Go through assembly guide before you start your work. Images in rows one by one show usually one small assembly step

Heat up PE parts with lighter before use, brass will soften and become easy to bend and work with
Tamiya Super Thin Glue or Gunze Mr. Cement are recommended for plastic parts, let the glue work for a few seconds, then push parts together, melted plastic will fill the gaps between parts. You can also melt sprue frame and use it as an amazing filler for small works, or use this glue to wash out tiny seam lines on little parts or make texture on some parts etc.

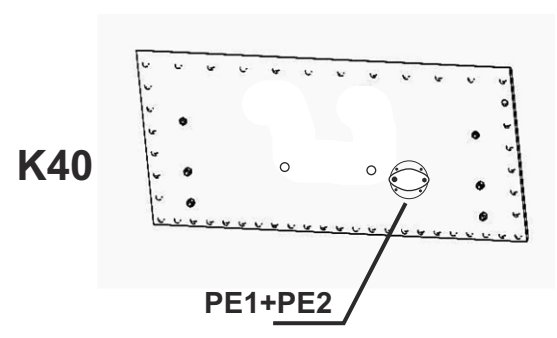

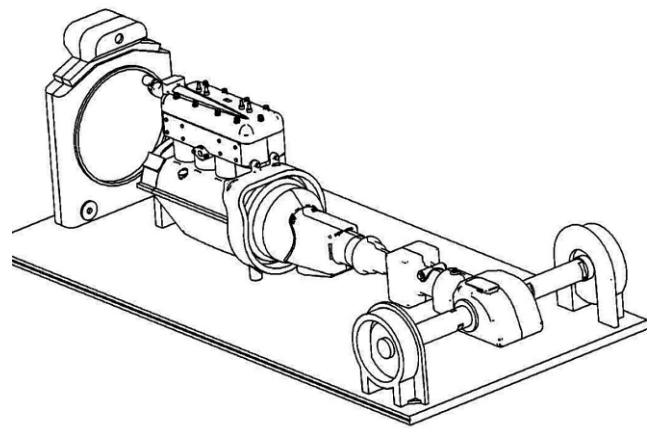
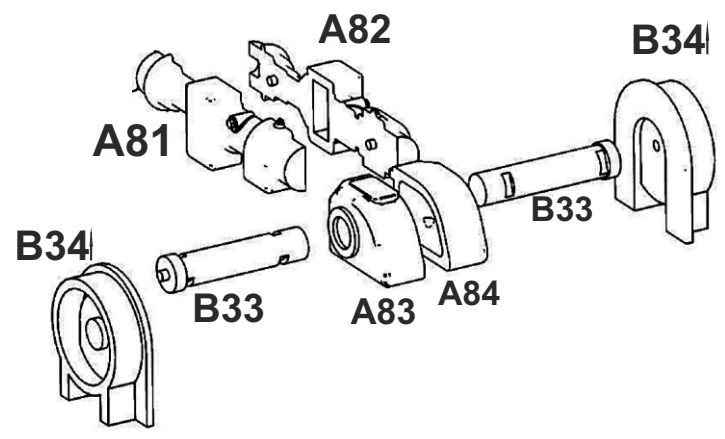
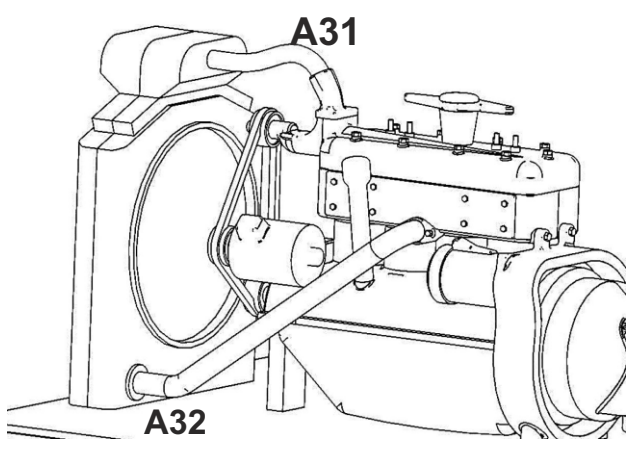
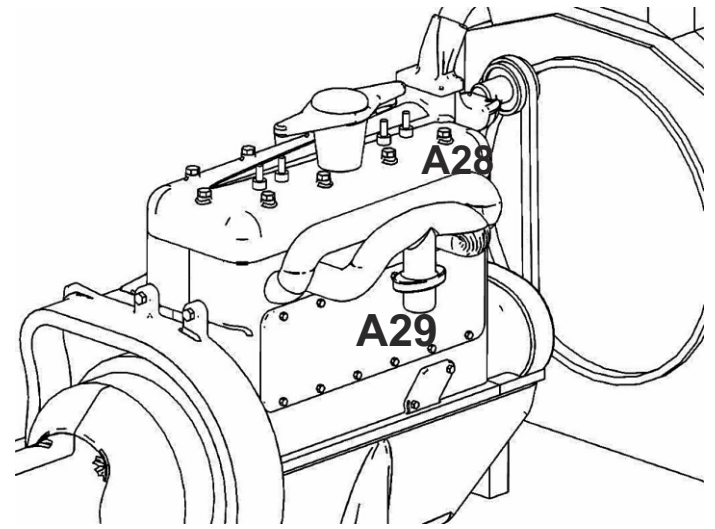
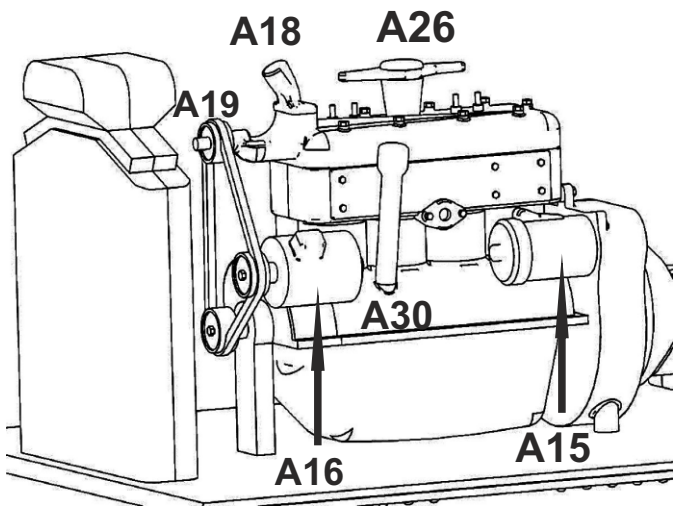
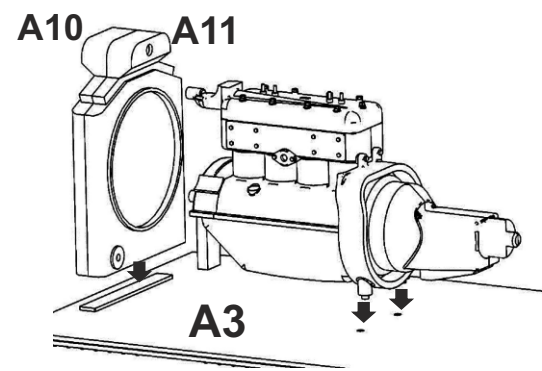
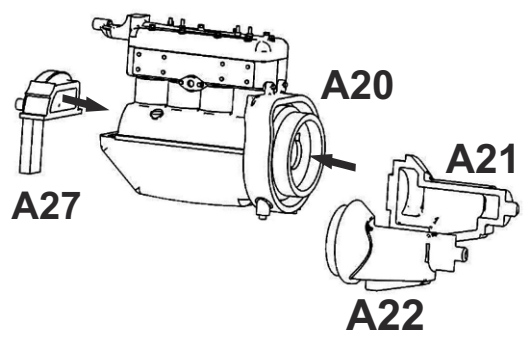
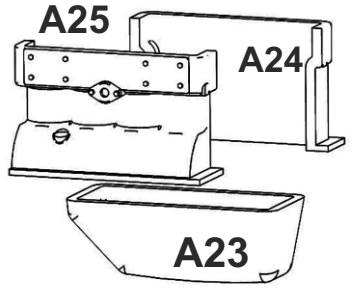
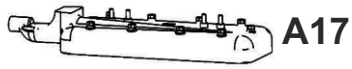
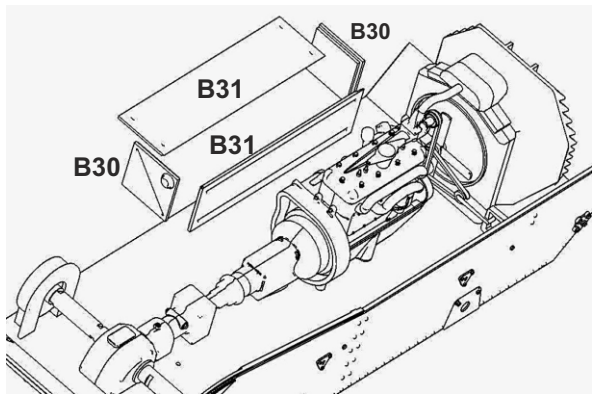
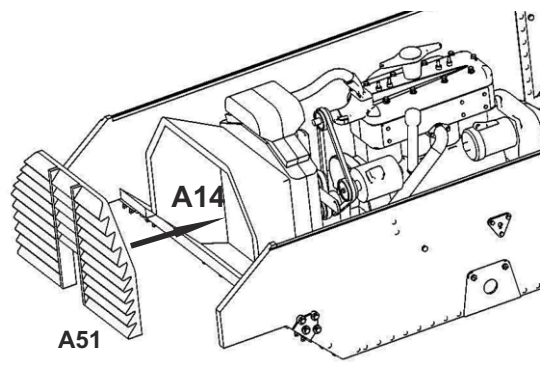
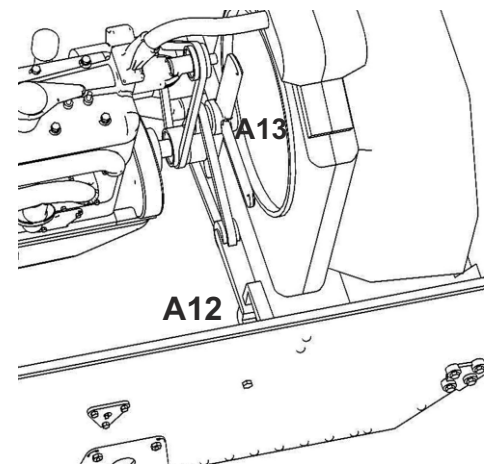
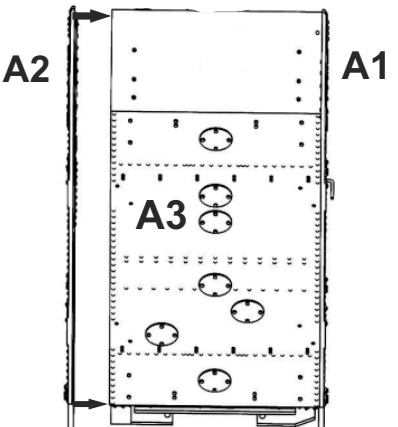
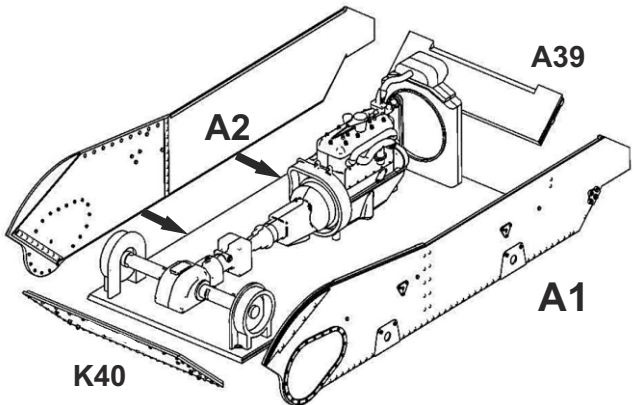

A67 - remove outside rivets on sides

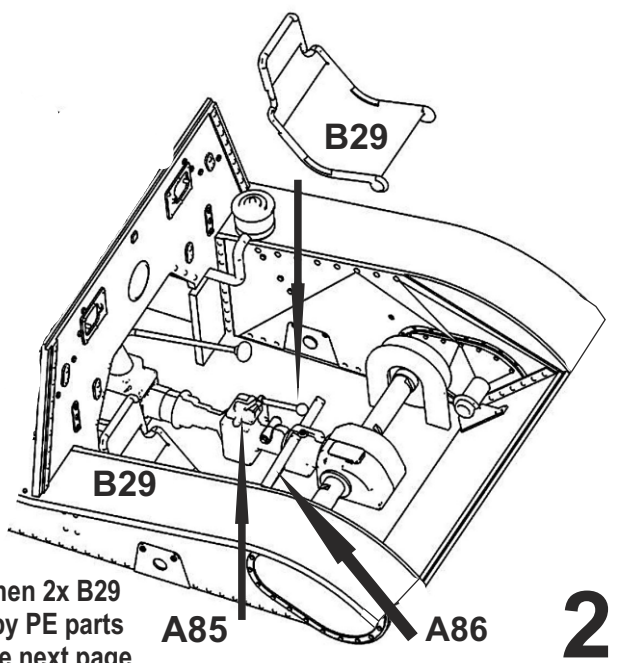
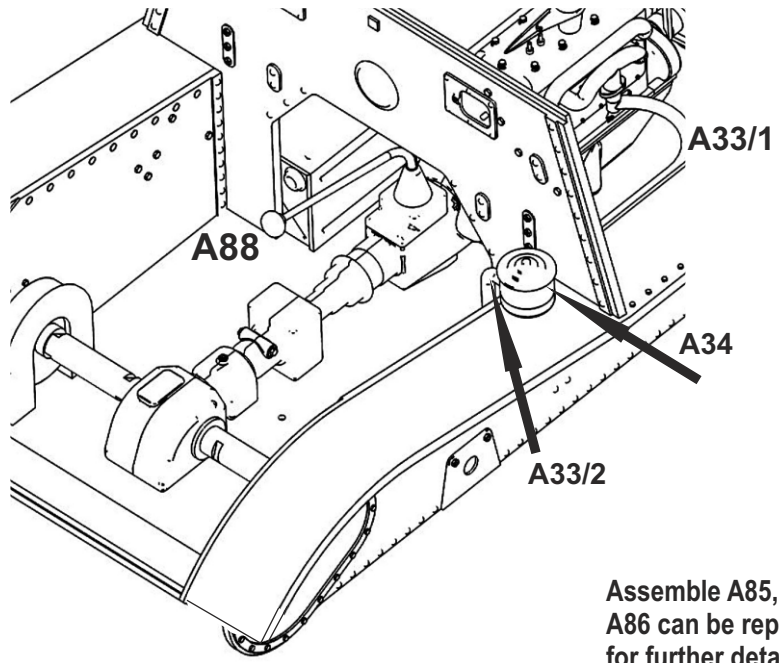
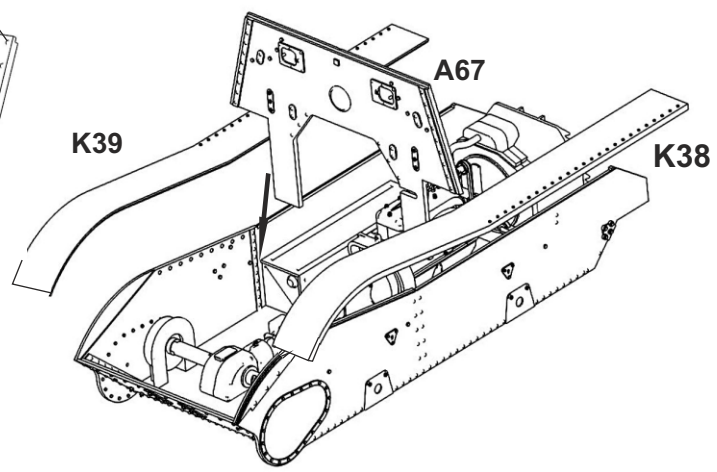
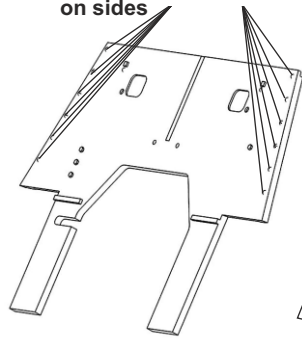
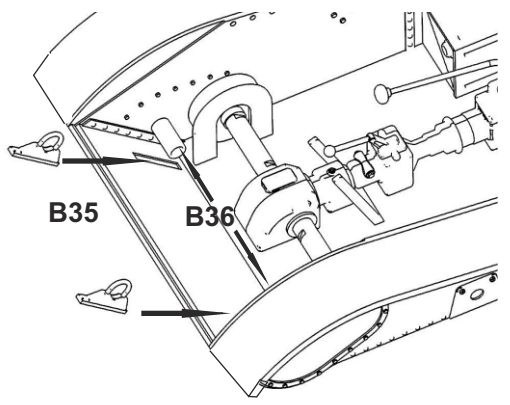

Assemble A85, A86, then 2x B29
 A86 can be replaced by PE parts for further details - see next page

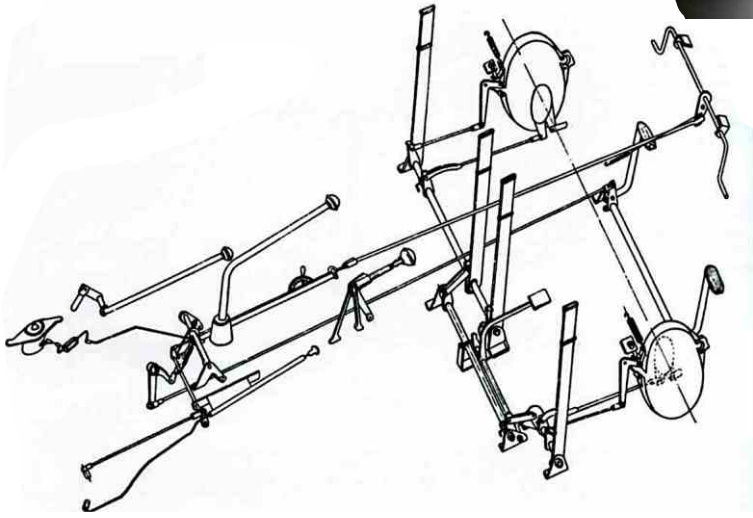
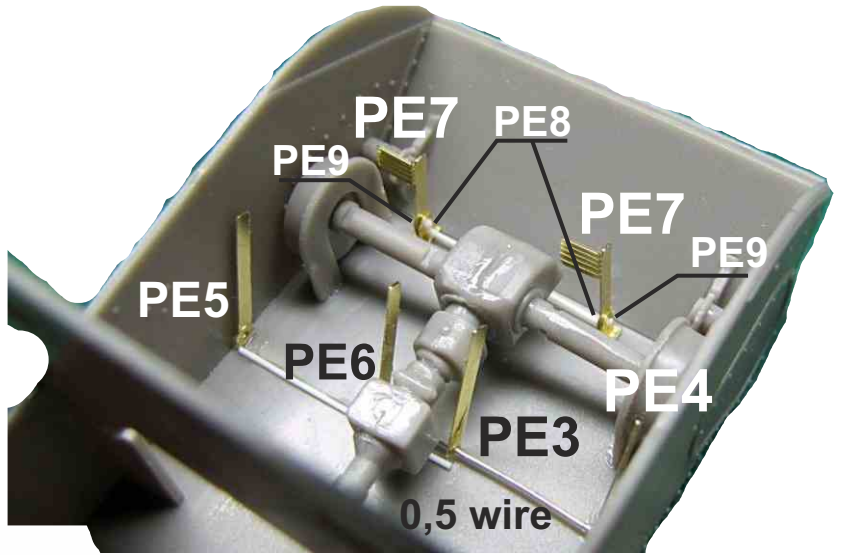
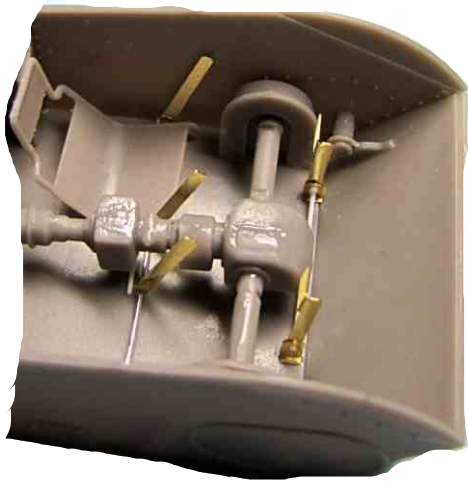

Interior diagram

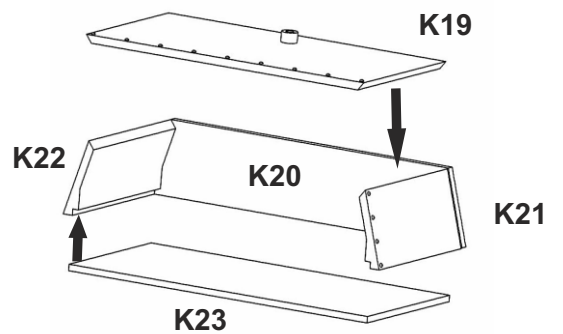
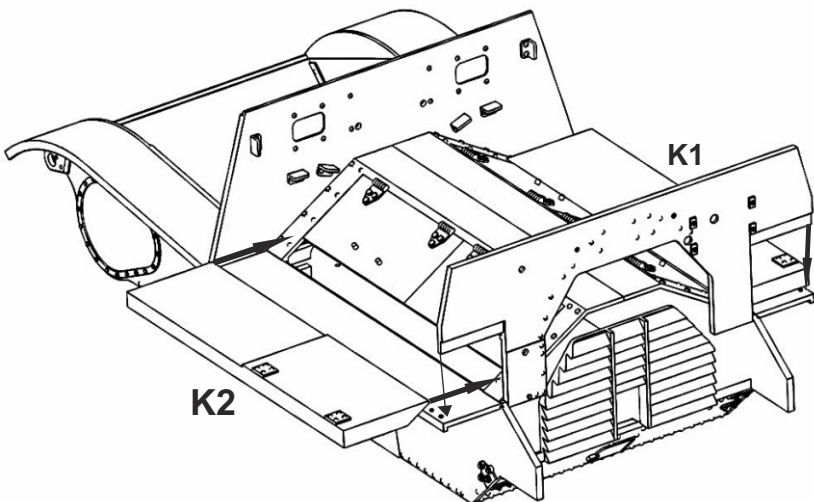
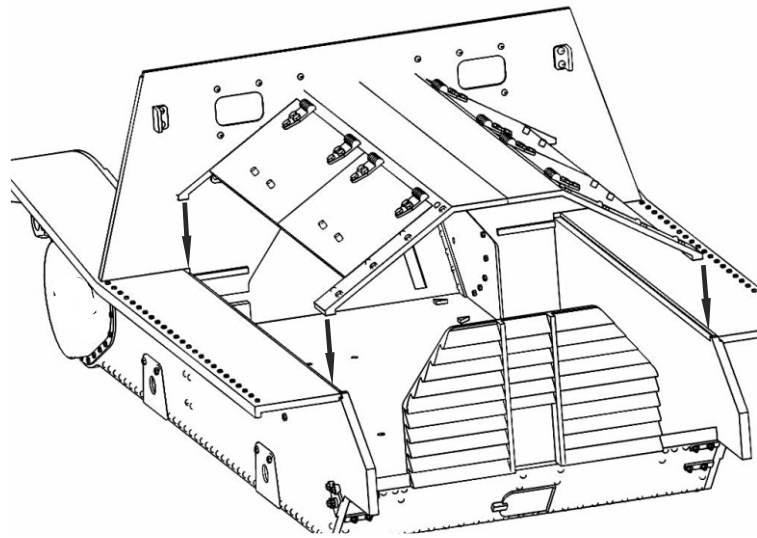
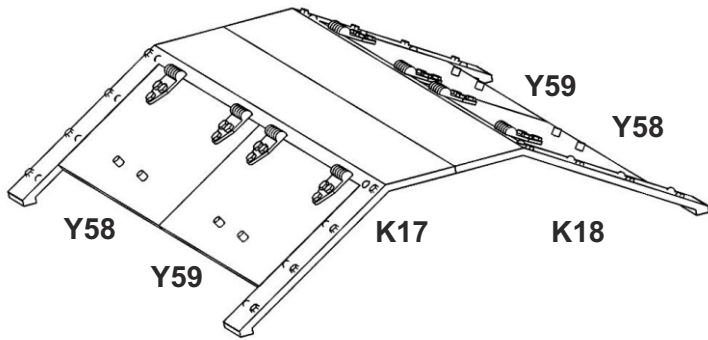

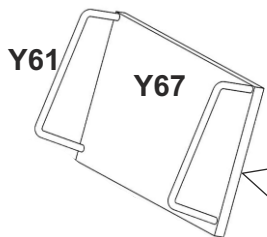
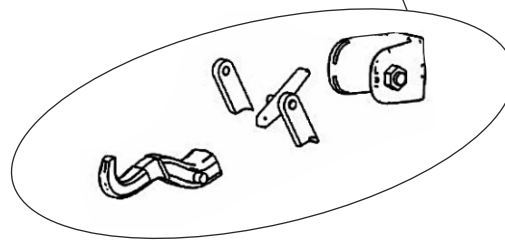
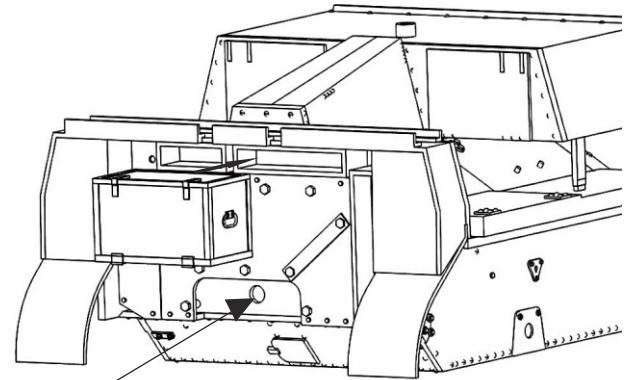
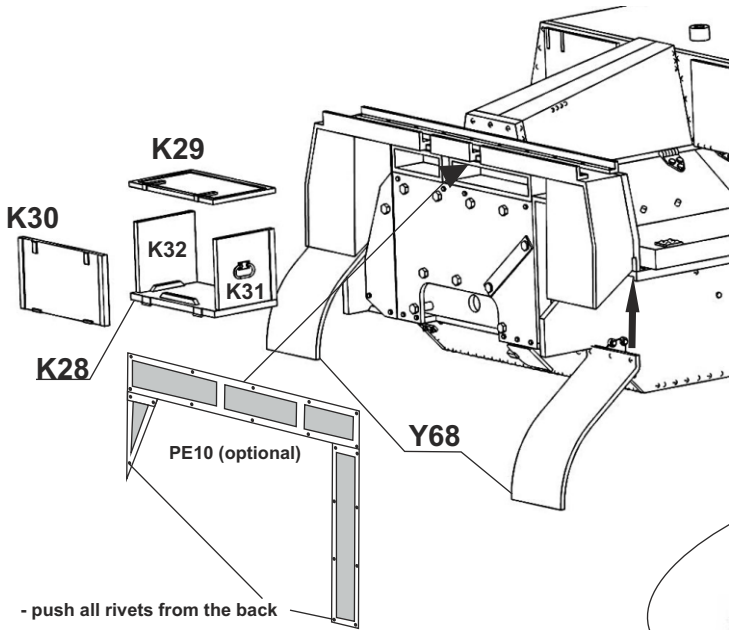
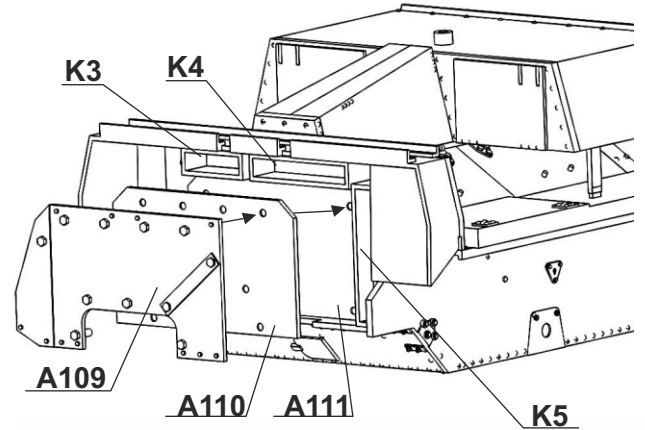
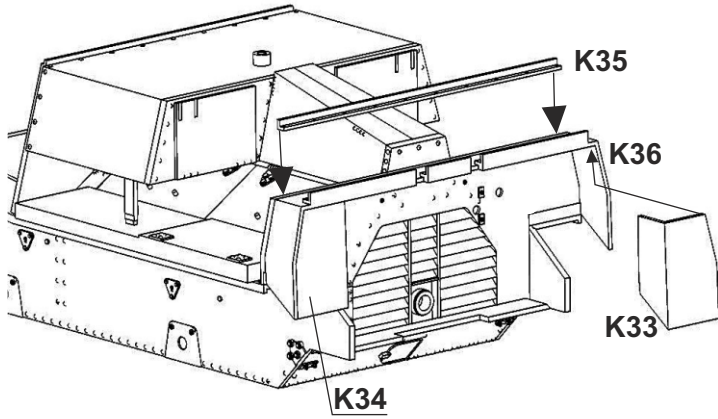
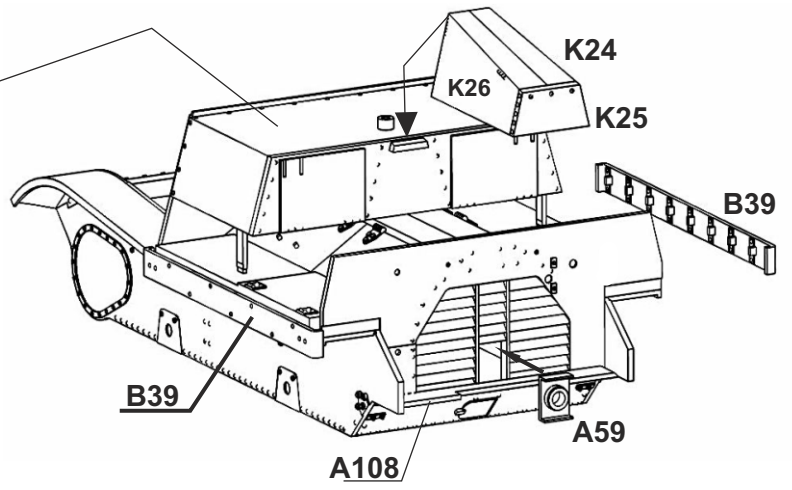
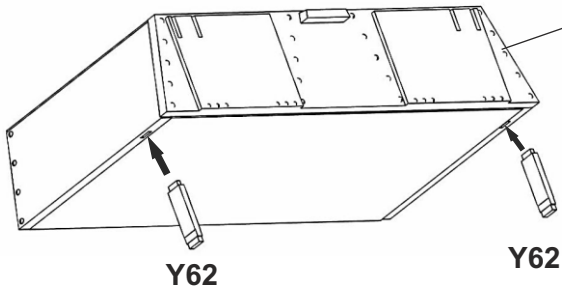

benches can be assembled open or closed

make two

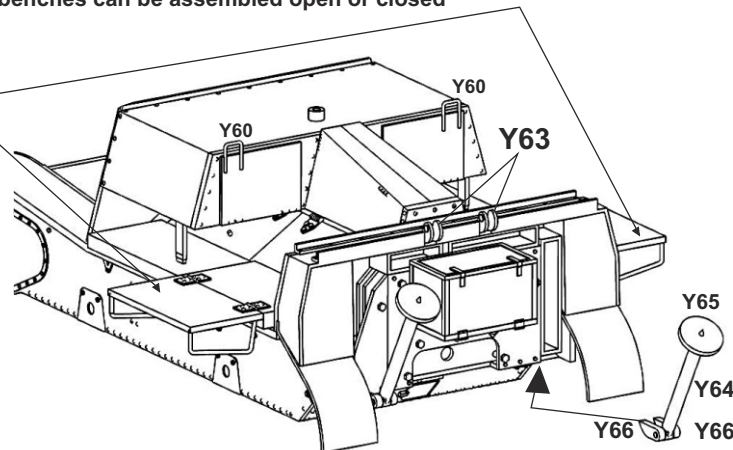

bottom view

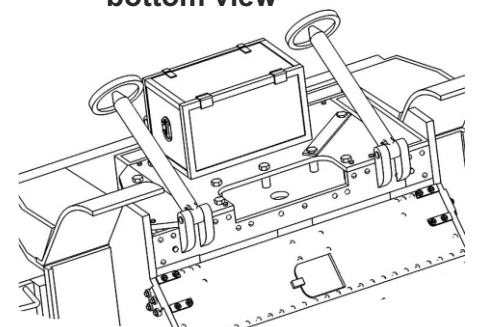

make two - supports can be assembled lifted or dropped

INNER SHUTTERS B28 CAN BE ASSEMBLED EITHER OPEN OR CLOSED

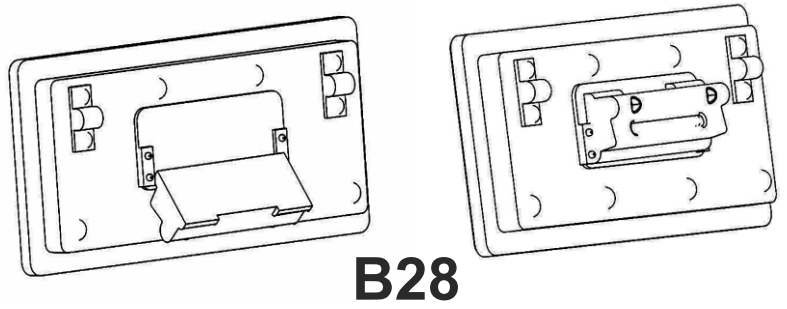
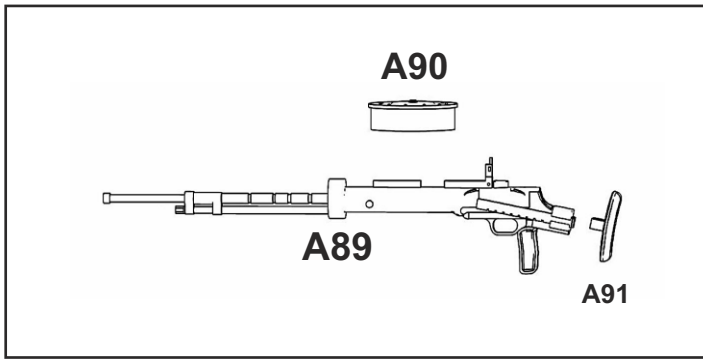

K10 A92 K9 A93 A95 K15

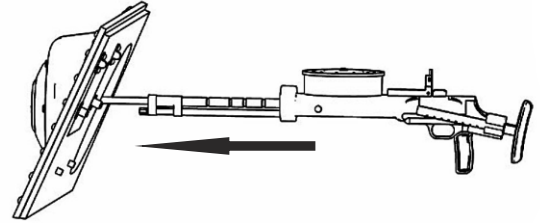
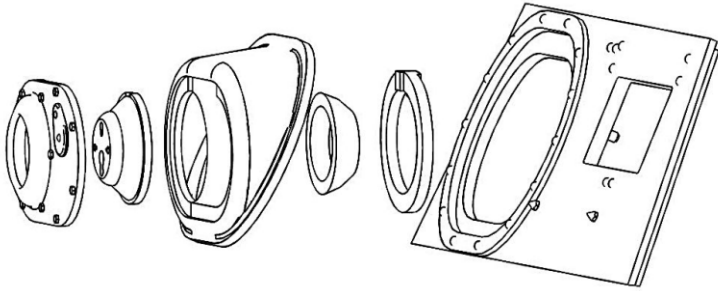

MAIN SHUTTERS CAN BE ALSO ASSEMBLED CLOSED OR IN ANY OPEN POSITION

in that case SET B32 ACCORDINGLY

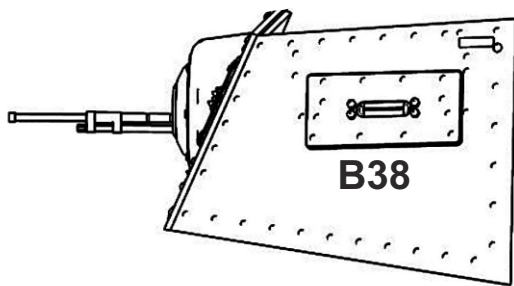
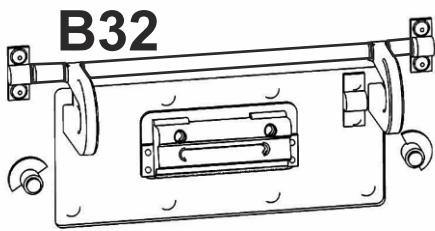

K13

“XX”

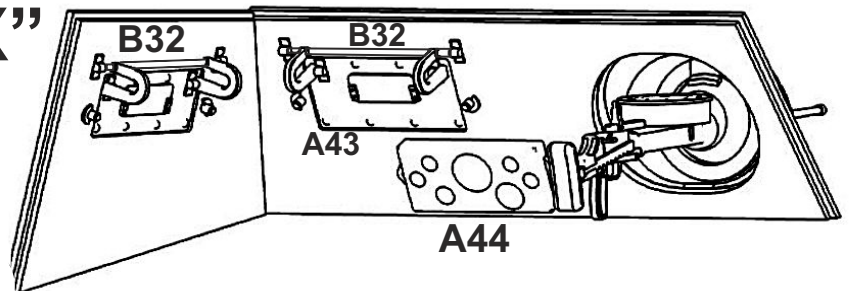

Assemble A42 before you place “XX”

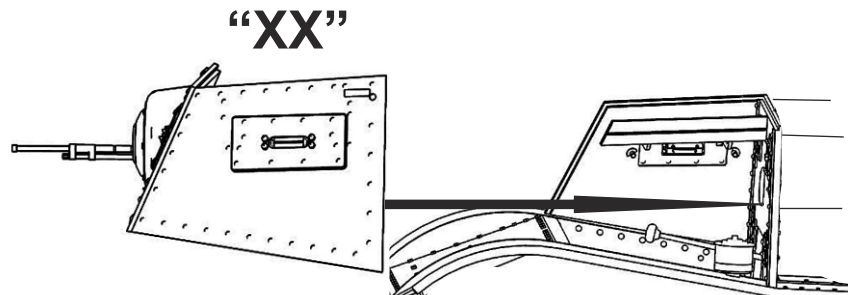
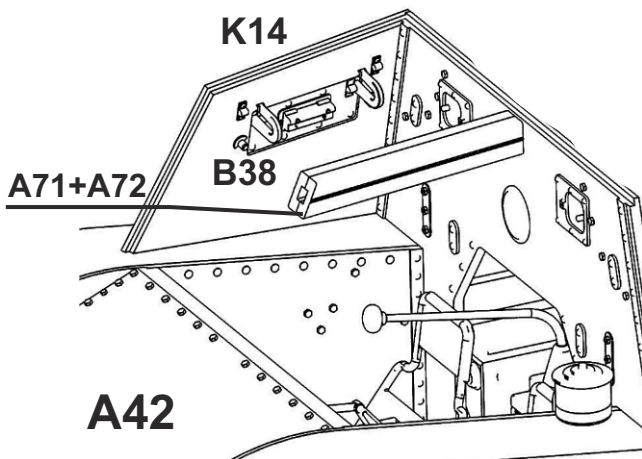

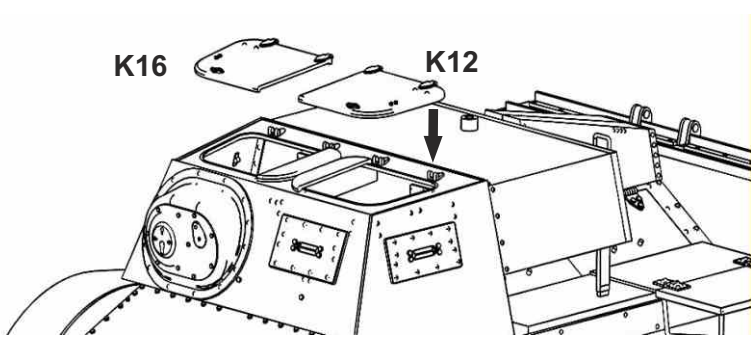

hatches can be assembled open or closed

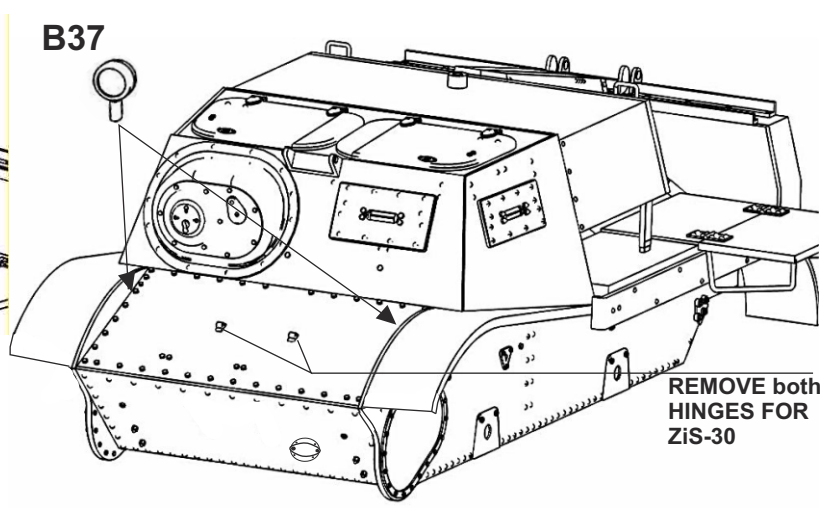

REMOVE both HINGES FOR ZIS-30

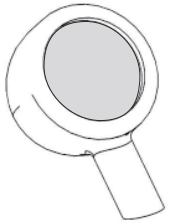

Paint lights inside in silver, then apply drop of thick clear varnish to make glass. Depending on varnish used, you might need to repeat it a couple times

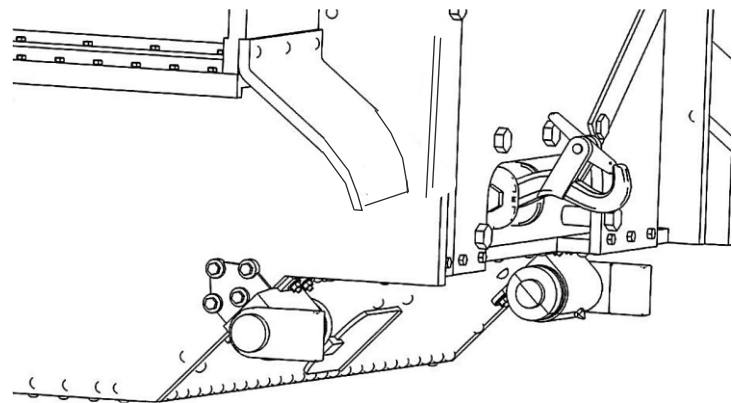
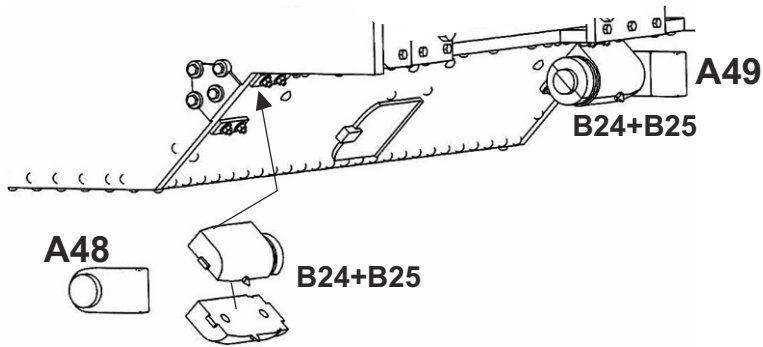

Idler wheels

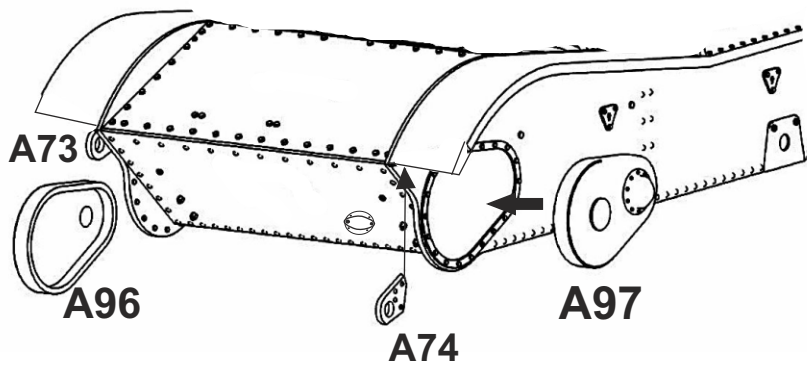
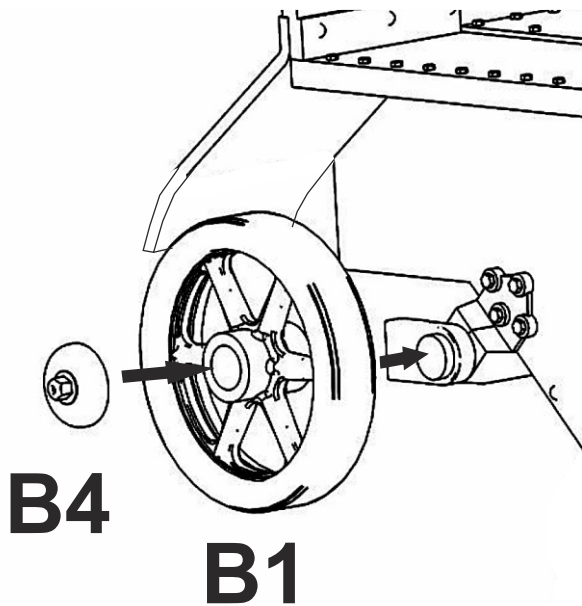

Make 4 bogies, 2+2 have very same parts

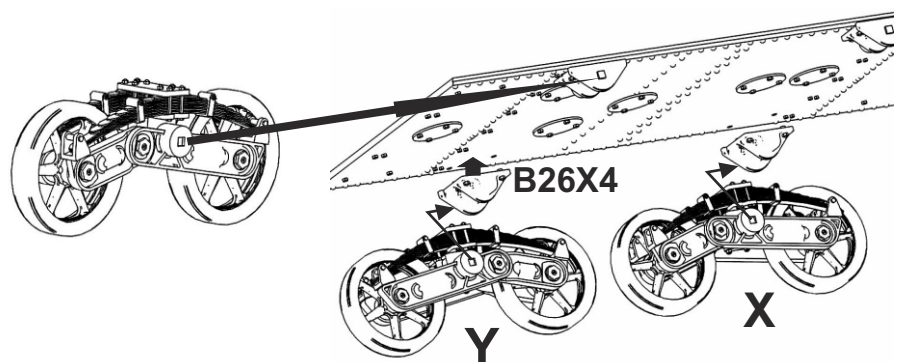
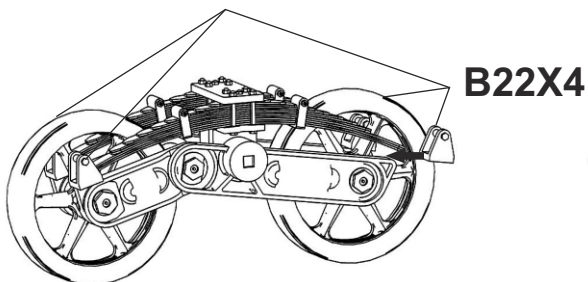
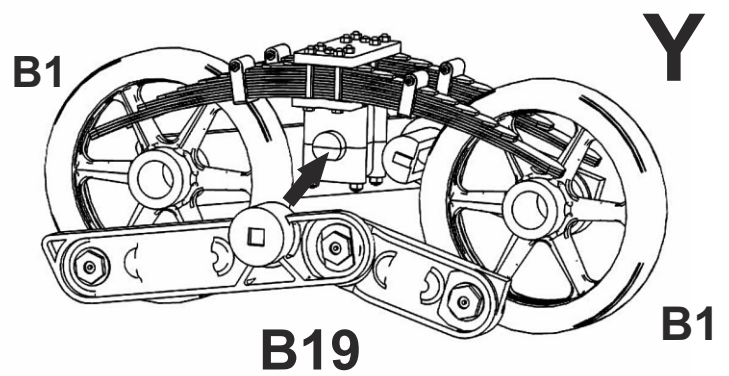
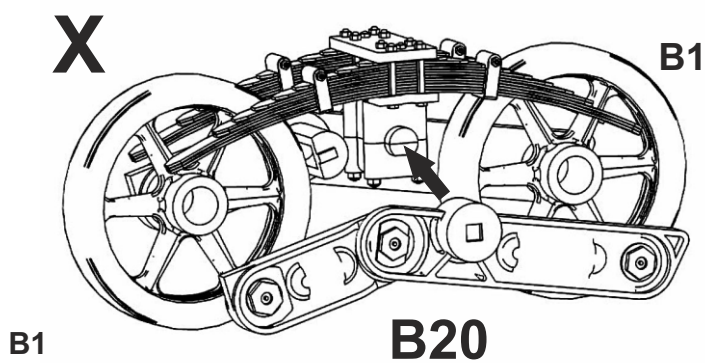
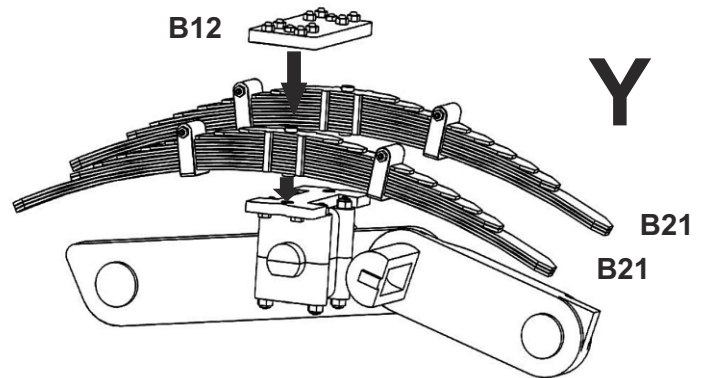
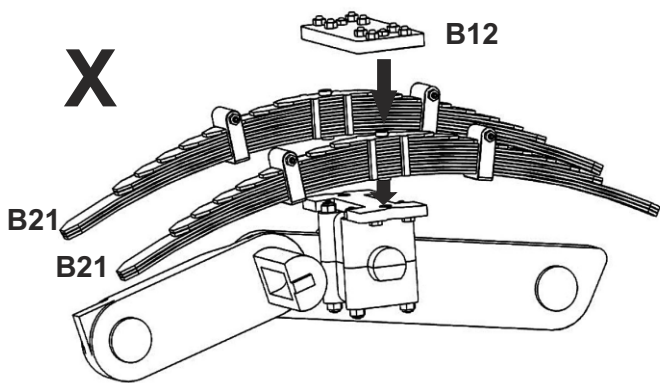
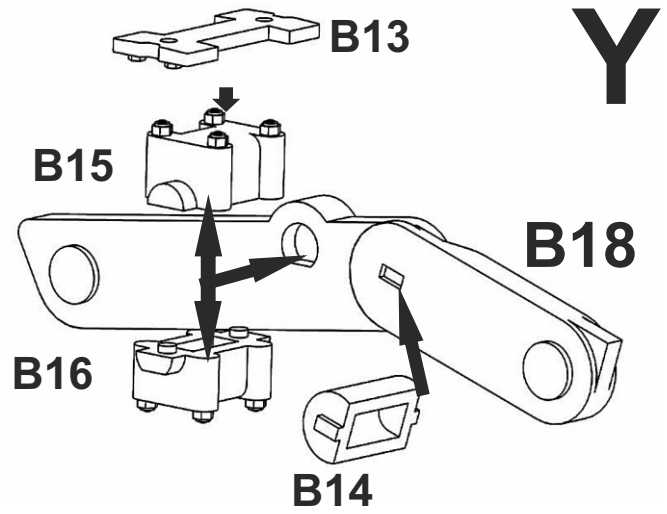
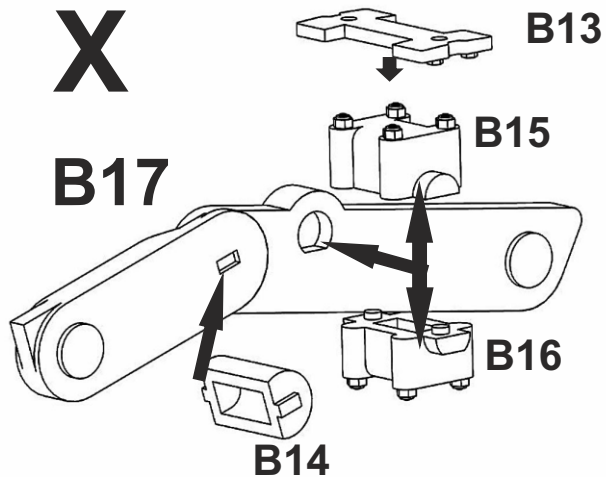

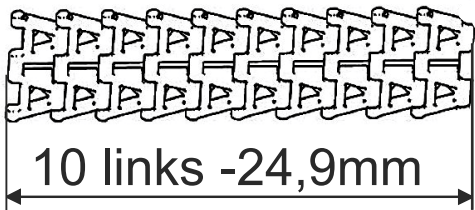
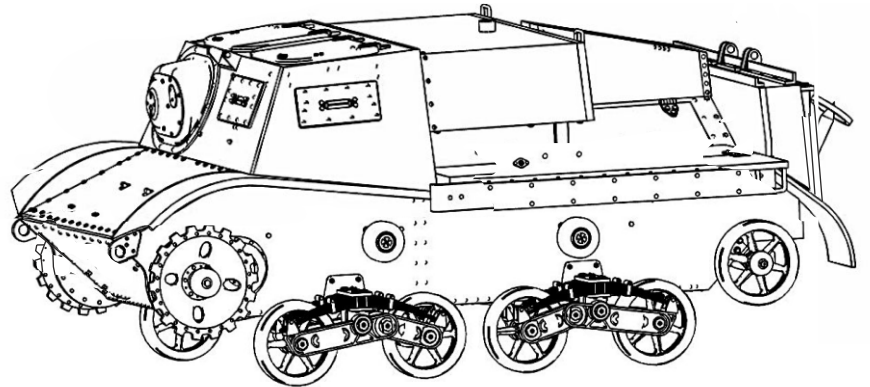
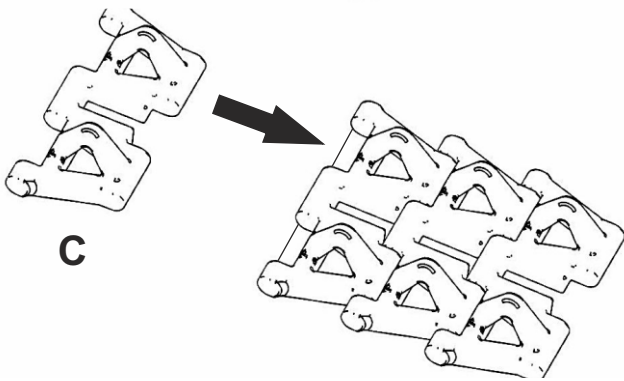
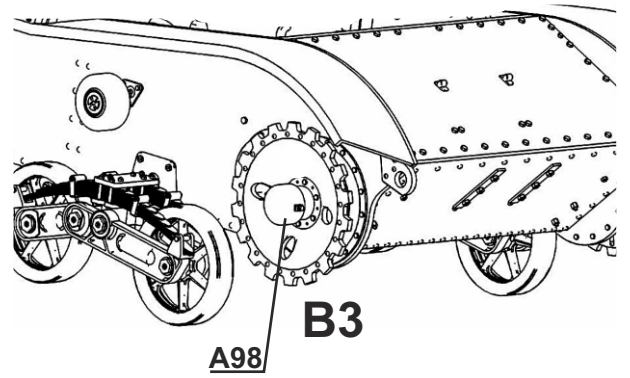
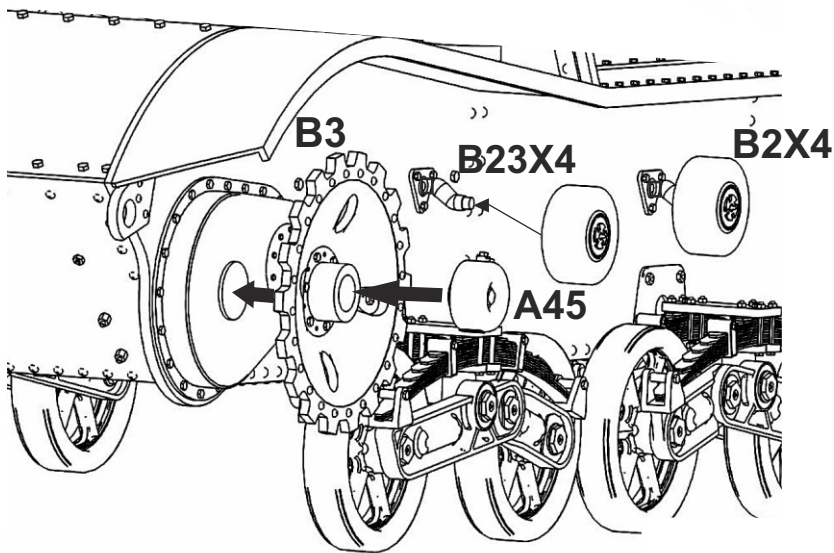

Keep checking length of the tracks during assembly, do not leave gaps between links

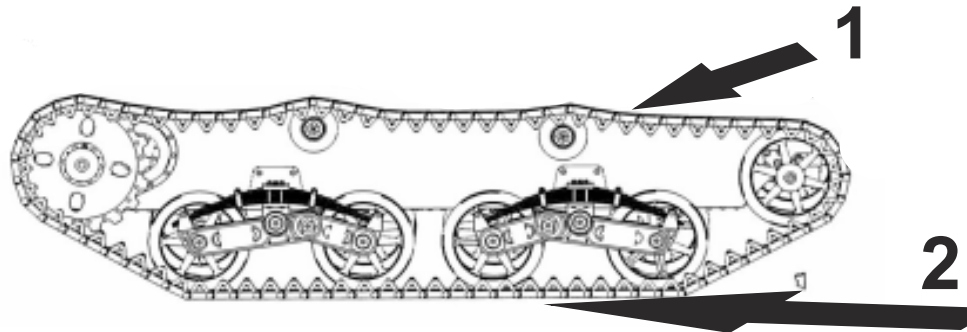

it is easier to assemble top first and then bottom

Track assembly, 78 links per track, tractors had trouble with falling tracks often, some references mentioned that a tracks were sometimes shortened to 77 links to improve this issue

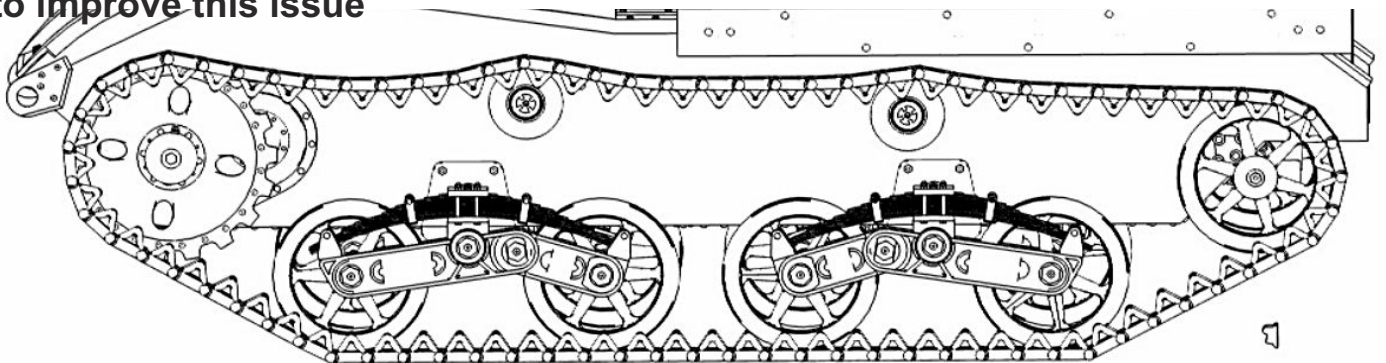

Besides Mod.1937 Late and Mod.1940 this kit contains also all the parts to build 2 early options, Mod.1937 and Mod.1938 Early (Russian and Finnish service). In case of interest in these you can download assembly guide for early variants here: http://mirror-models.websnadno.cz/35200/t20_early_assembly_guide_updated.pdf

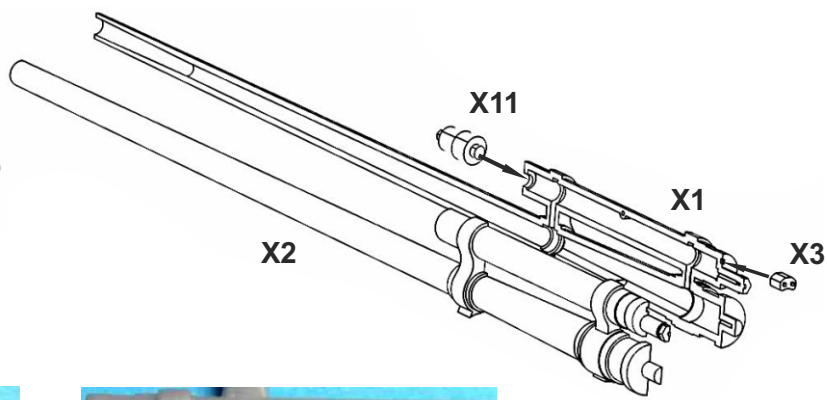
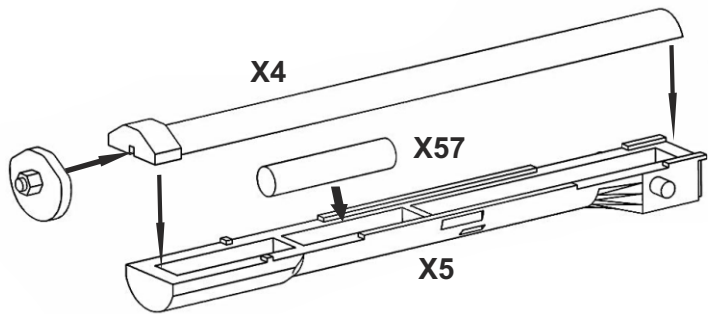

remove plastic edge



original parts

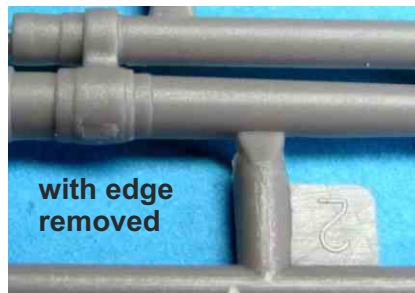

with edge removed

early produced kits parts X1 and X2
remove little plastic edge for assembly

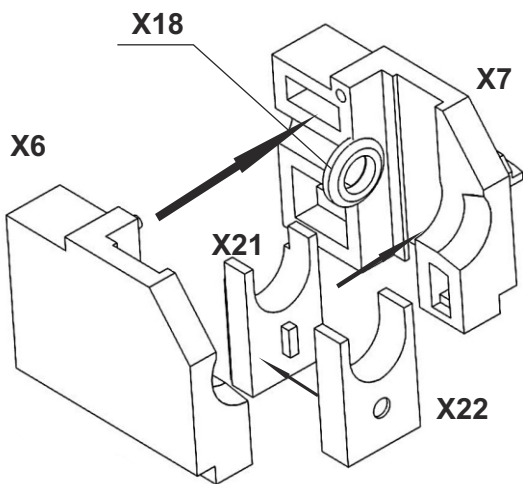
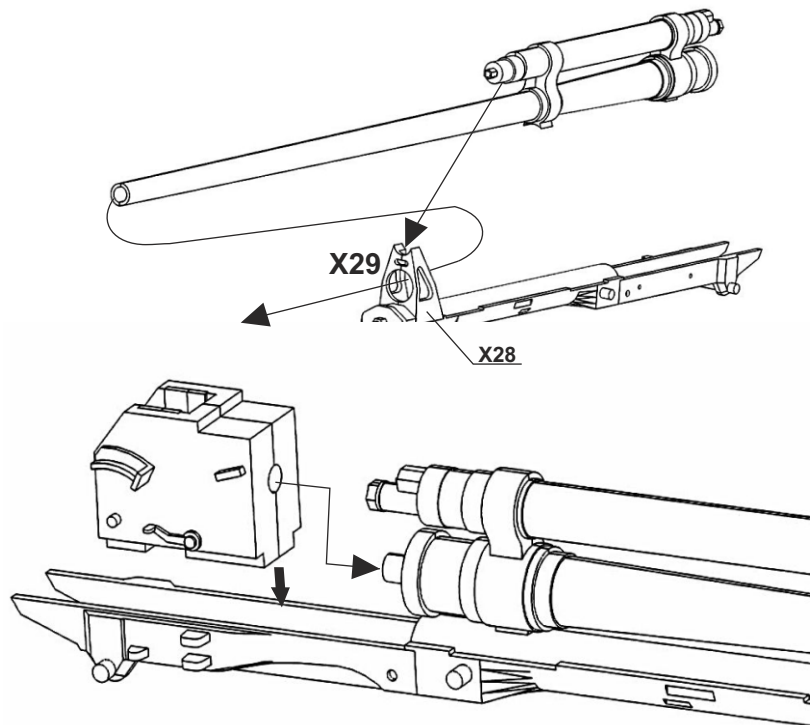
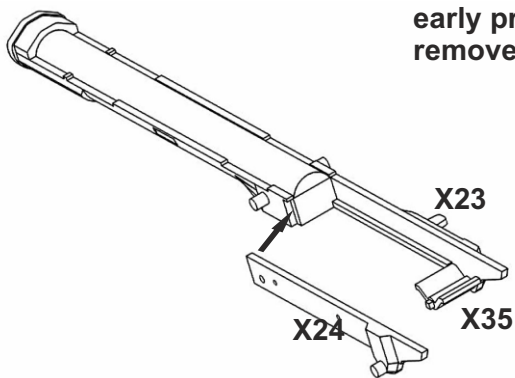

The gun is set in traveling position as a standard. If you want to set it elevated, do not glue X36 and X37 into assembled cylinders (X31+X35_2 and X32+X35) before you set your elevation angle wanted in your next steps.

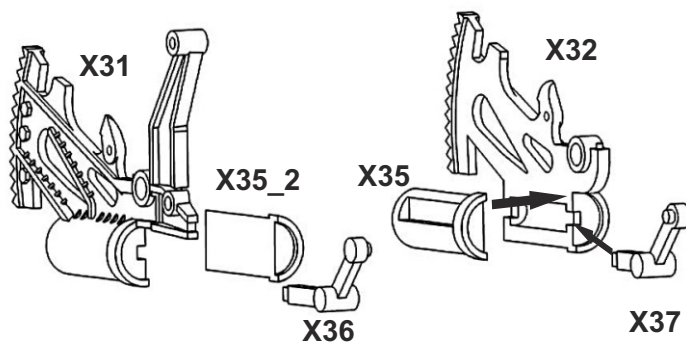
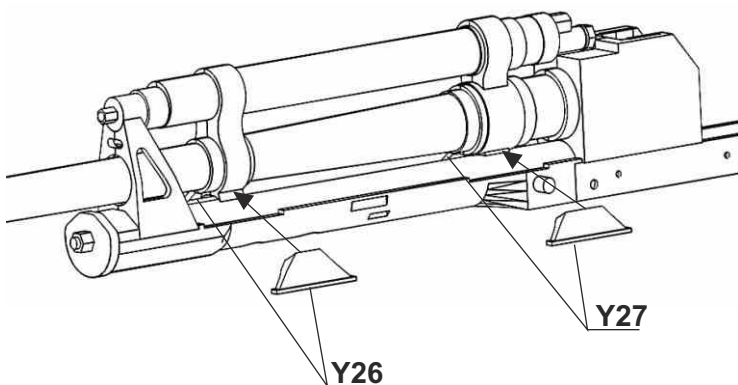

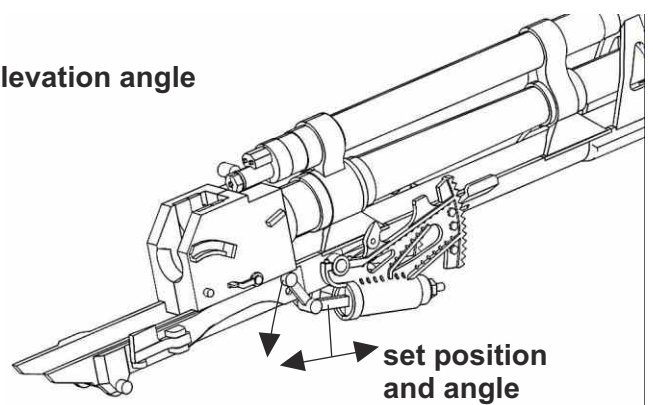
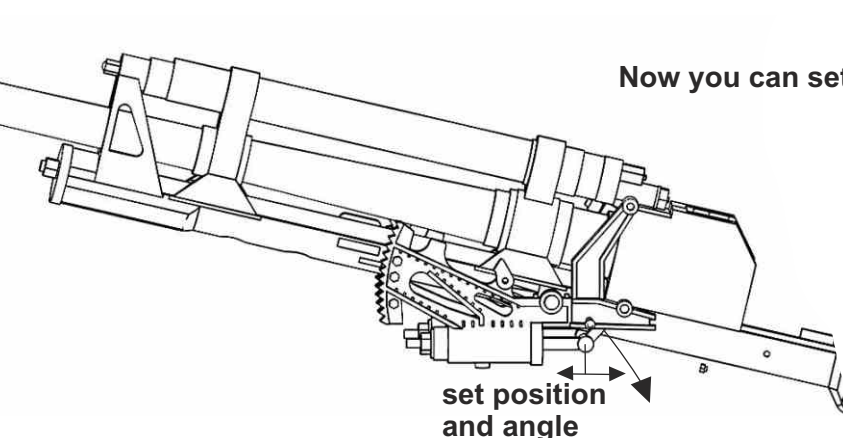
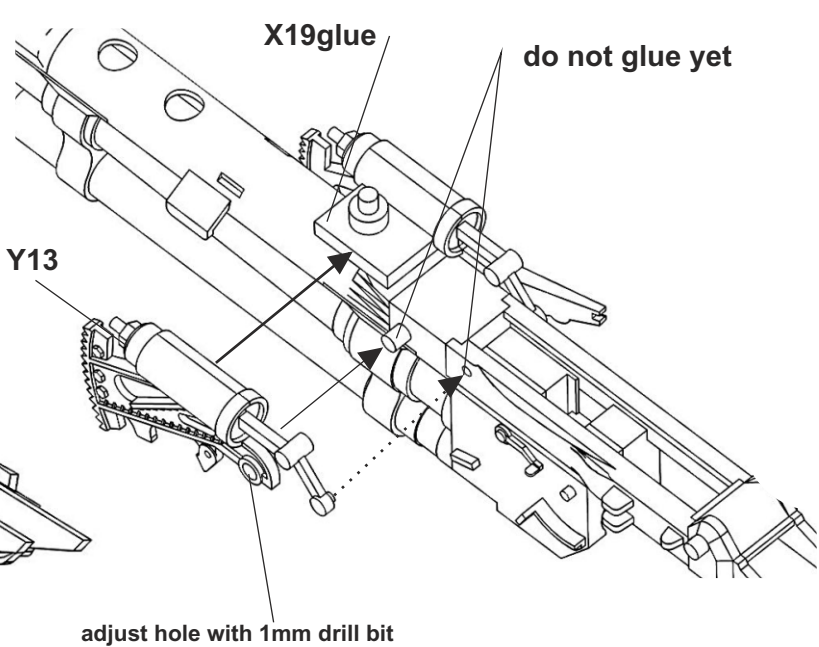
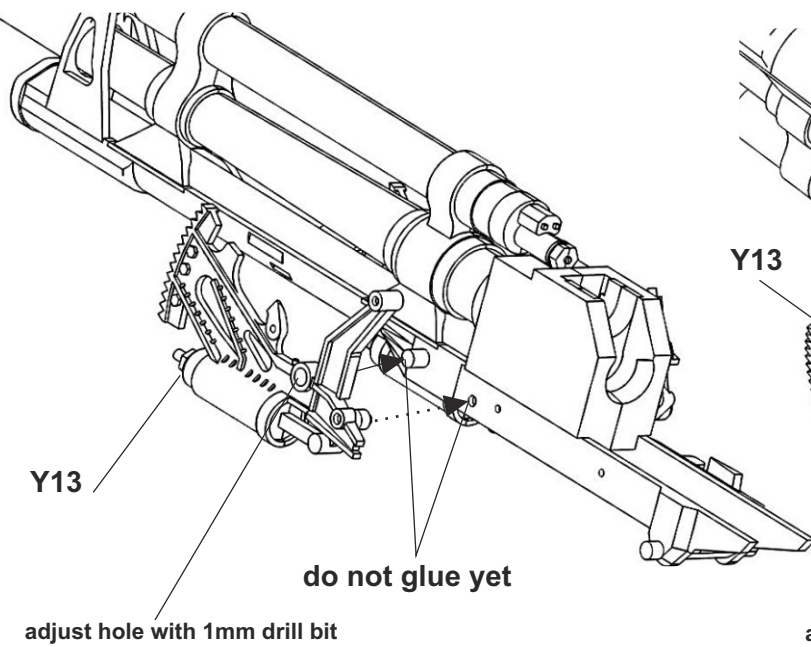

Depending on your elevation angle set position of X36 and X37 in cylinders, you might need to shorten their length and bend their ends slightly to fit into holes in X23 and X24. Then glue all joints before you continue assembly.

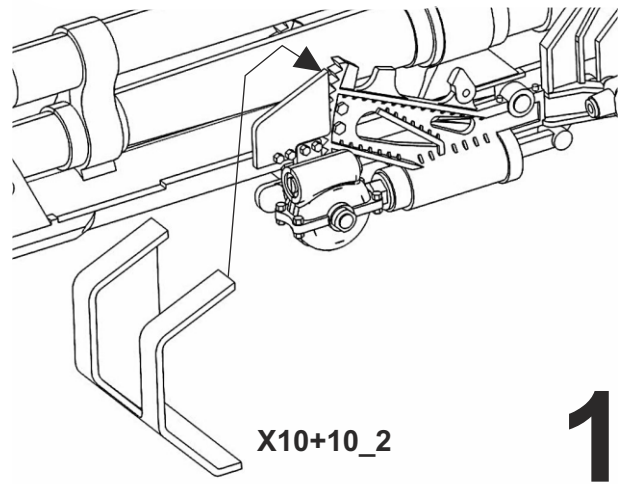
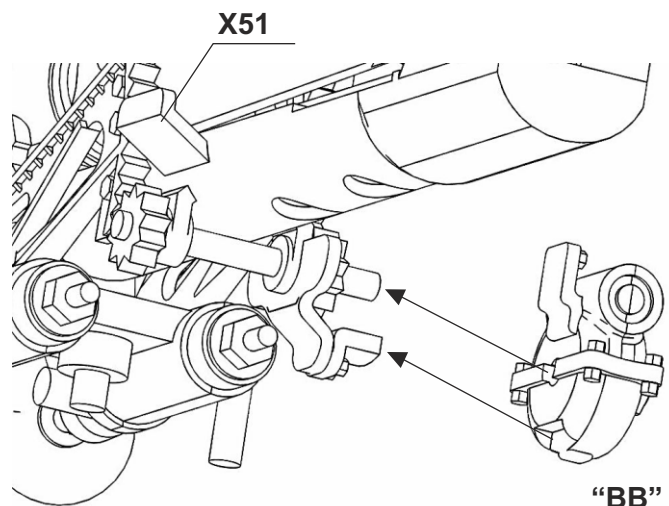
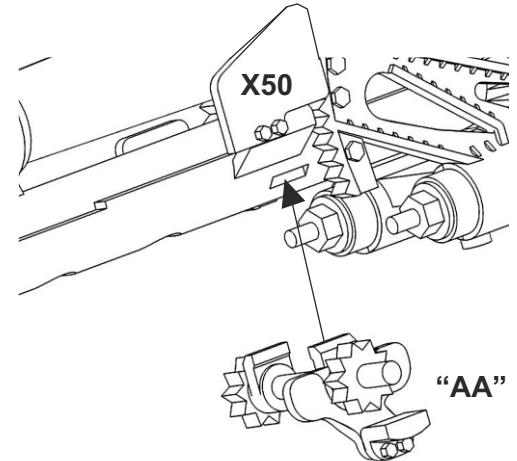
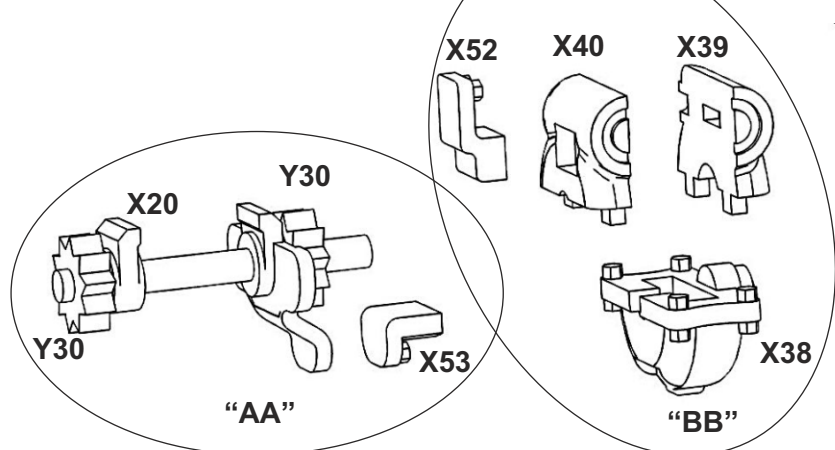

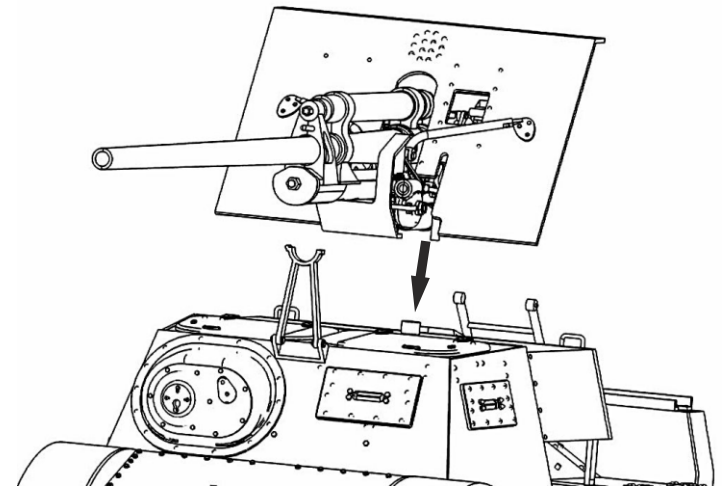
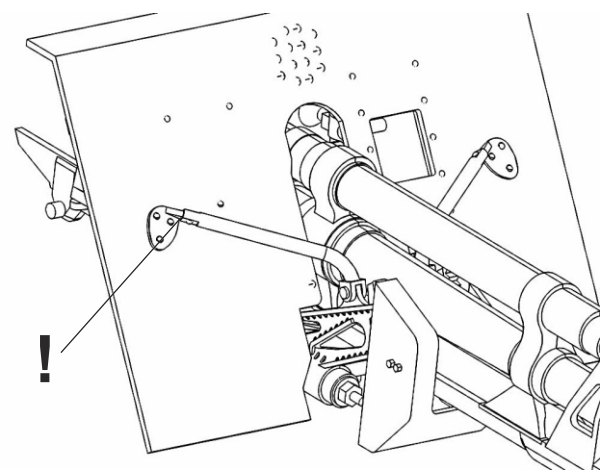
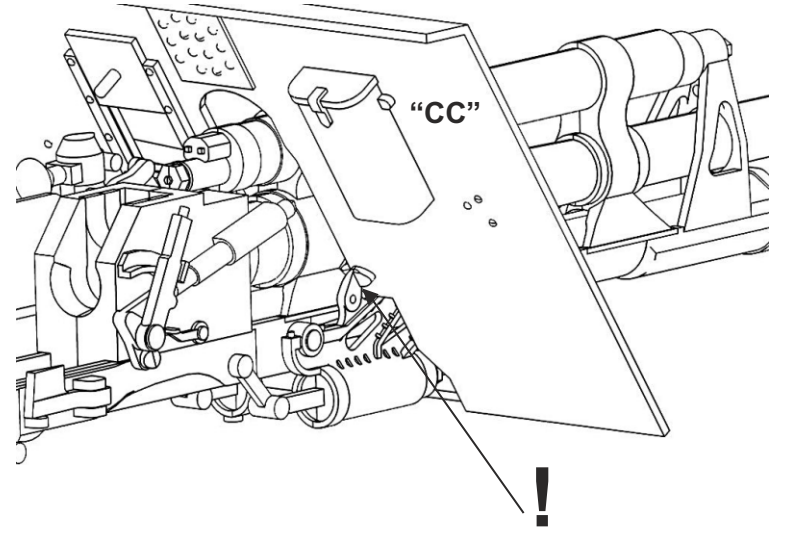
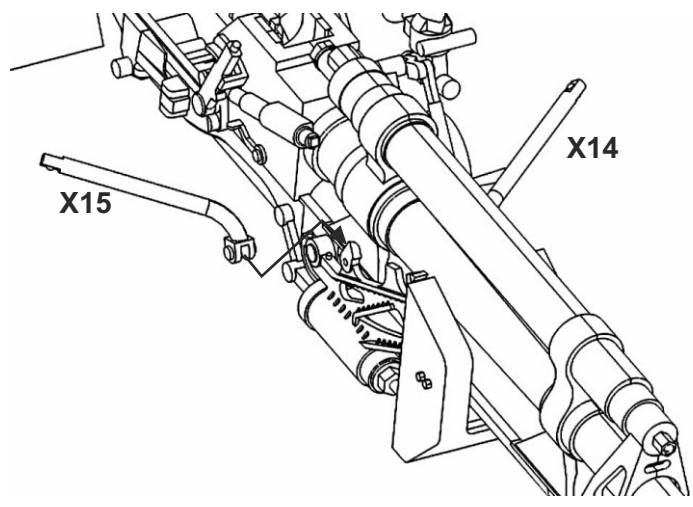
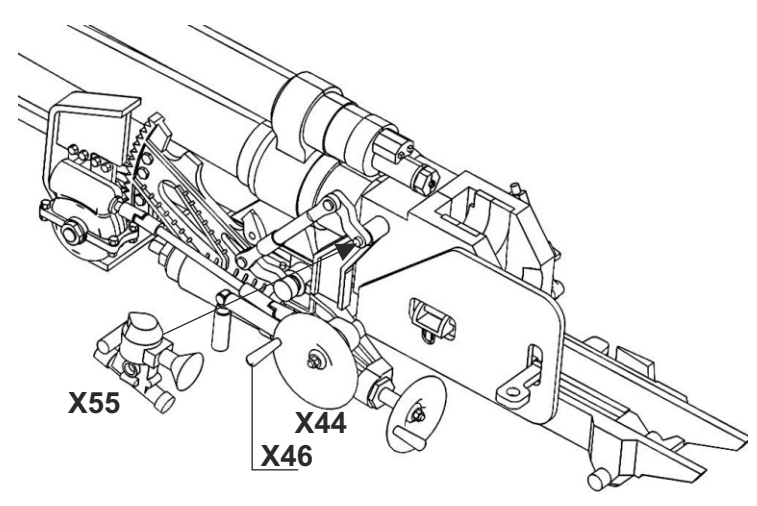
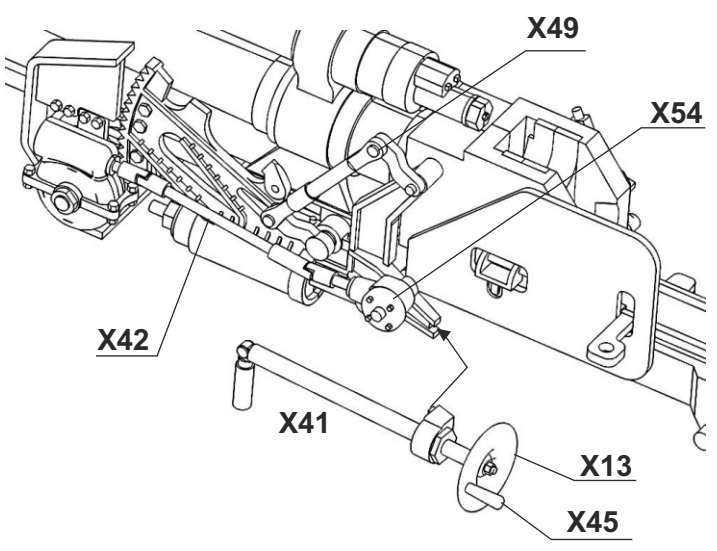
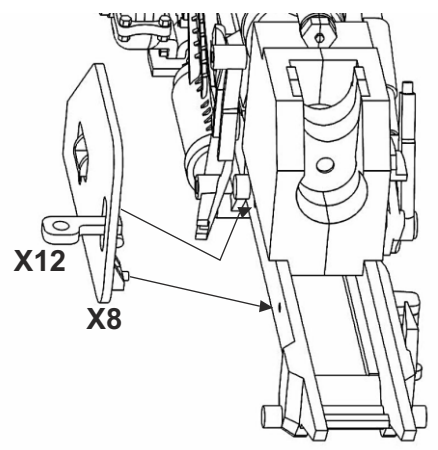
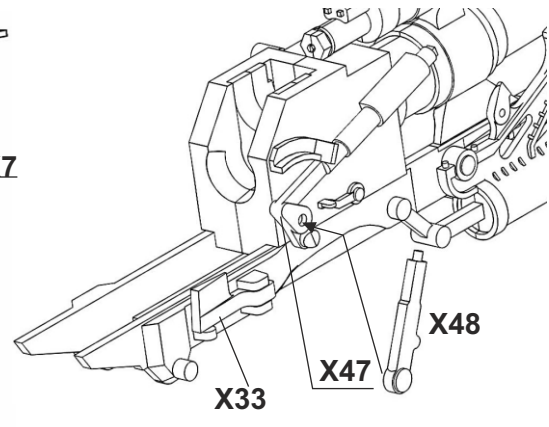
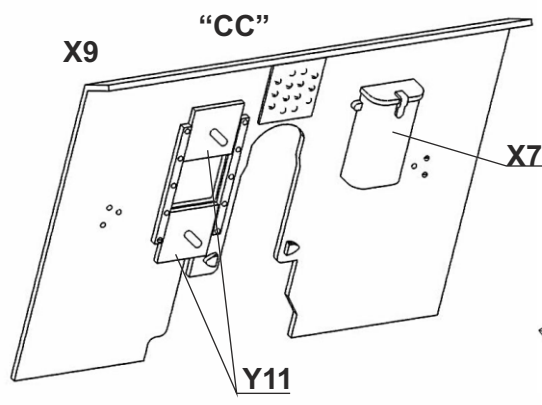

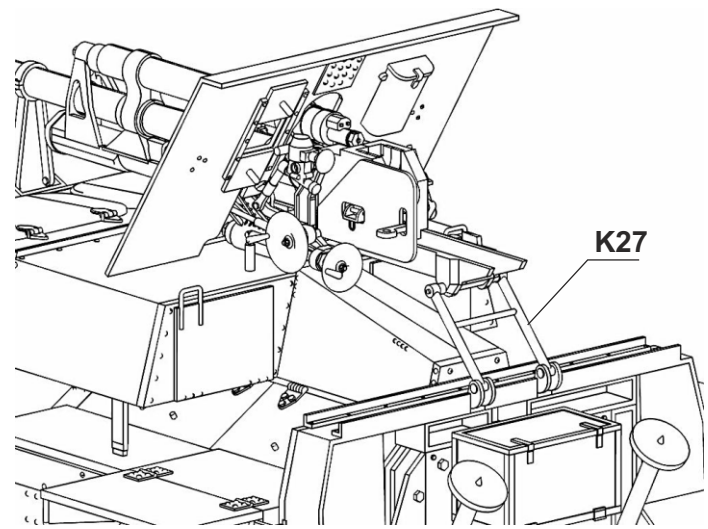
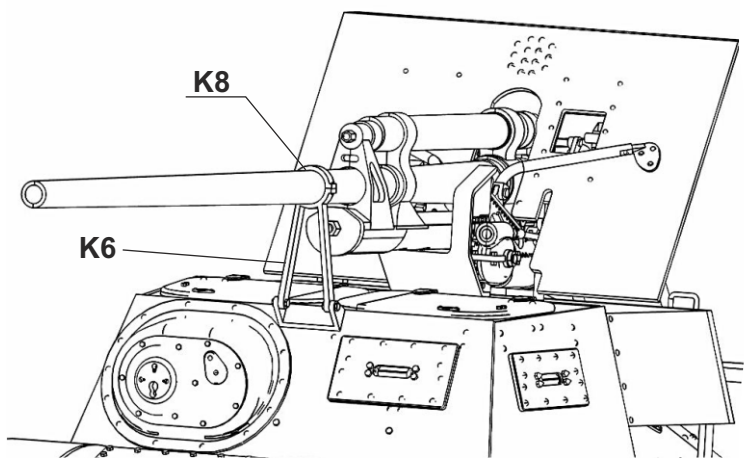

Option with the gun secured and locked in traveling position

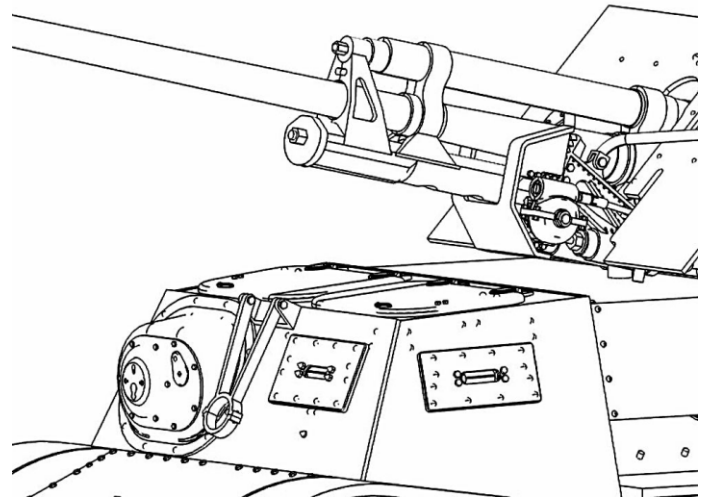
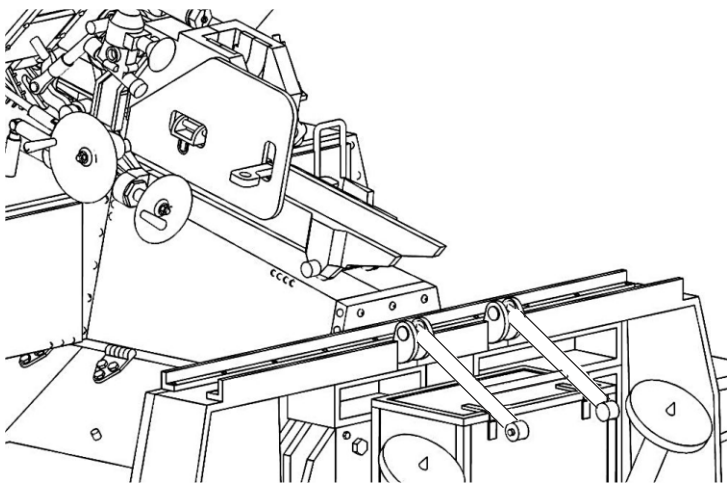

Option with the gun unlocked in firing position (elevated or not)