



Scale Motorsport
 PO Box 823
 Newtown, Connecticut 06470 USA
 Phone: 203-426-9686
 Fax: 203-426-7136
 www.scalemotorsport.com
 customerservice@scalemotorsport.com

This product is not a toy, it is designed for the advanced or intermediate builder interested in learning new techniques while expanding their modelling skills. Not safe for children under the age of 14 years old. To see all the other great Scale Motorsport products visit our web site: www.scalemotorsport.com

Scale Motorsport Sku#: 4240

Subject:

Kawasaki Ninja ZX-RR Motorcycle Photoetch Set
 Designed for the Tamiya Kawasaki Ninja ZX-RR kit#14109

Companion Products: Sku# 7240

Kawasaki Ninja ZX-RR Carbon Fiber Template Set
 Designed for the Tamiya Kawasaki Ninja ZX-RR kit#14109

- | | | |
|--|---|--|
| 1 Rear Chain Sprocket (outer) | 19 Display Panel | 37 Front Sprocket Detail |
| 2 Front Brake Disk (2) | 20 Display Panel Lights | 38 Front Sprocket (Inner) |
| 3 Engine Detail Right Side | 21 Valve Cover Detail | 39 Front Sprocket Detail |
| 4 Engine Detail Right Side | 22 Chain | 40 Handle Bar Detail (2) |
| 5 Radiator Face | 23 Radiator Support Washer (2) | 41 Large Sprocket Nuts (5) |
| 6 Cowl Fasteners | 24 Radiator Support Clip (2) | 42 Seat Bolt Cap (2) |
| 7 Clutch Detail | 25 Radiator Support (2) | 43 Rear Sprocket |
| 8 Clutch Detail | 26 Radiator Support Washer (2) | 44 Large Sprocket Washer (5) |
| 9 Engine Detail Near Clutch | 27 Radiator Support Nuts (2) | 45 Racing Stand Wheel Inserts (4) |
| 10 Engine Detail Bolts Left Side | 28 Radiator Support Washer (2) | 46 Clutch Detail |
| 11 Chain Adjuster Detail (Right Side) | 29 Handle Bar Nut | 47 Rear Brake Disk |
| 12 Rear Chain Sprocket (inner) | 30 Handle Bar Detail | 48 Front Brake Disk Support (2) |
| 13 Engine Detail Cover Left Side | 31 Chain Adjuster Nut (Left Side) | 49 Gas Cap Outer Ring |
| 14 Chain Adjuster (2) | 32 Chain Adjuster Washer (Left Side) | 50 Front Brake Disk Detail (12) |
| 15 Front Rotor Support (2) | 33 Radiator Cap | 51 Clutch Detail |
| 16 Hose Clamp (4) | 34 Front Sprocket Detail | 52 Clutch Detail Nut |
| 17 Front Rotor Detail | 35 Front Sprocket Detail | 53 Rear Brake Support |
| 18 Display Panel Knob | 36 Front Sprocket (Outer) | |

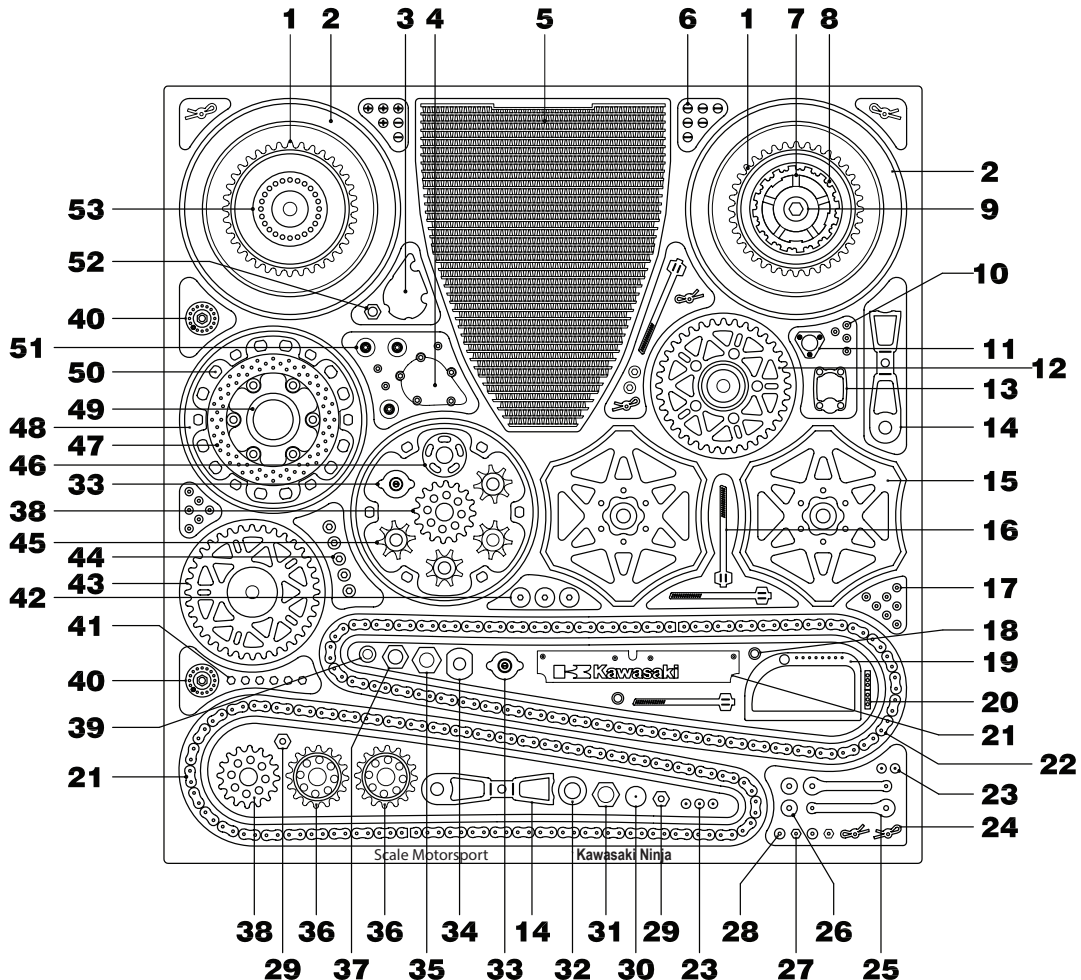

Copyright Scale Motorsport 2008

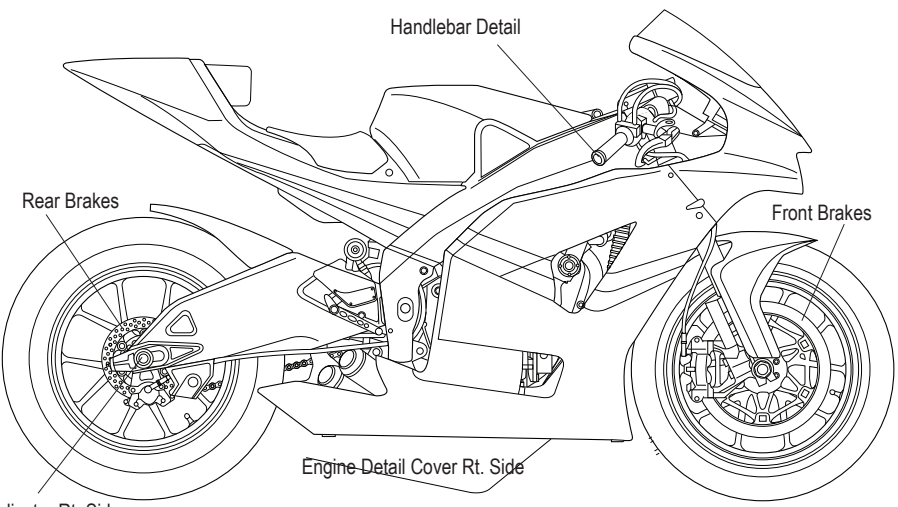
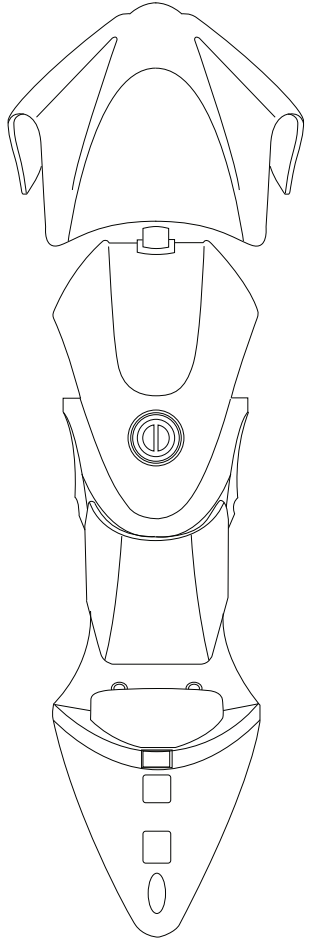
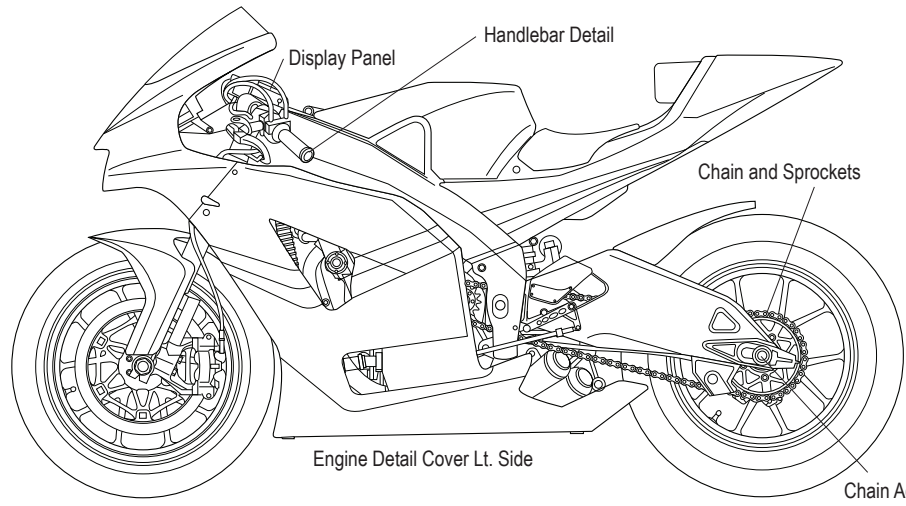

Chain Adjuster Rt. Side

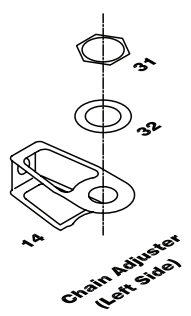

Chain Adjuster (Left Side)

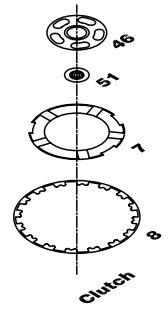

Clutch

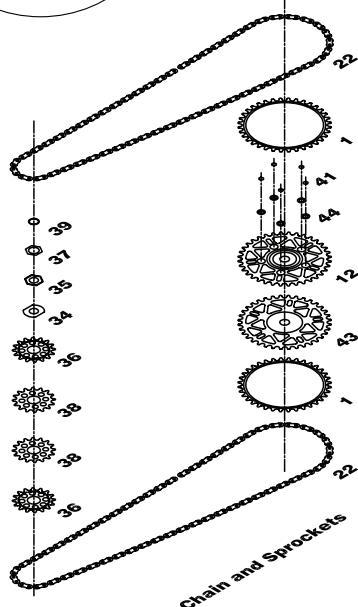

Chain and Sprockets

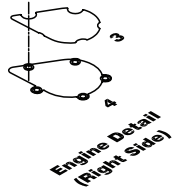

Engine Detail (Right Side)

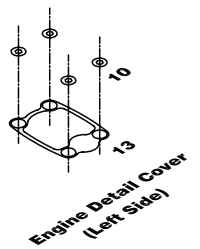

Engine Detail Cover (Left Side)

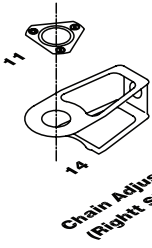

Chain Adjuster (Right Side)

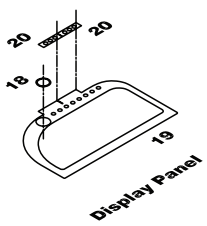

Display Panel

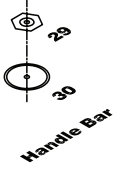

Handle Bar

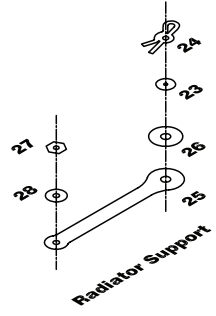

Radiator Support

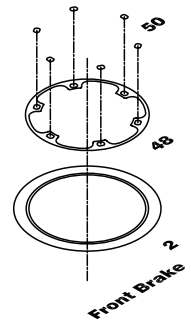

Front Brake

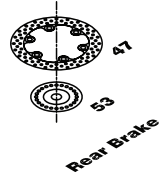

Rear Brake