



# PBY-5A undercarriage

eduard

48 825

1/48 scale detail set for REVELL model kit • sada detailů pro model 1/48 REVELL

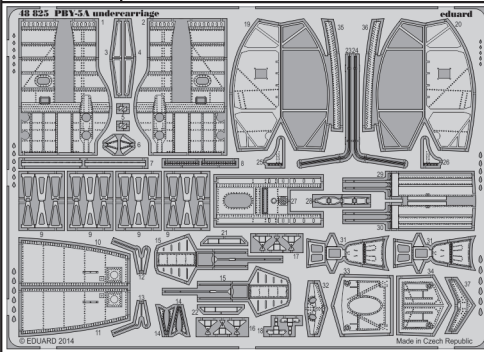

- APPLY EXPRESS MASK AND PAINT BEFORE GLUING  
POUŽIT EXPRESS MASK NABARVIT PŘED SLEPENÍM
- SYMMETRICAL ASSEMBLY  
SYMETRICKÁ MONTÁŽ
- REMOVE  
ODSTRANIT
- GRIND  
OBROUSIT
- DRILL HOLE  
VRTAT OTVOR
- BEND  
OHNOUT
- OPTION  
VOLBA
- REPLACE  
NAHRADIT
- REVERSE SIDE  
OTOČIT
- 1** COLORED ETCHED PARTS  
LEPTANÉ BAREVNÉ DÍLY
- 1** ETCHED PARTS  
LEPTANÉ NEBAREVNÉ DÍLY
- 1** ORIGINAL KIT PARTS  
PŮVODNÍ DÍLY STAVEBNICE

ORIGINAL KIT PARTS  
PŮVODNÍ DÍLY STAVEBNICE

PHOTO-ETCHED PARTS  
LEPTANÉ DÍLY

PARTS TO BE REMOVED  
DÍLY K ODSTRANĚNÍ

FILL  
TMELIT

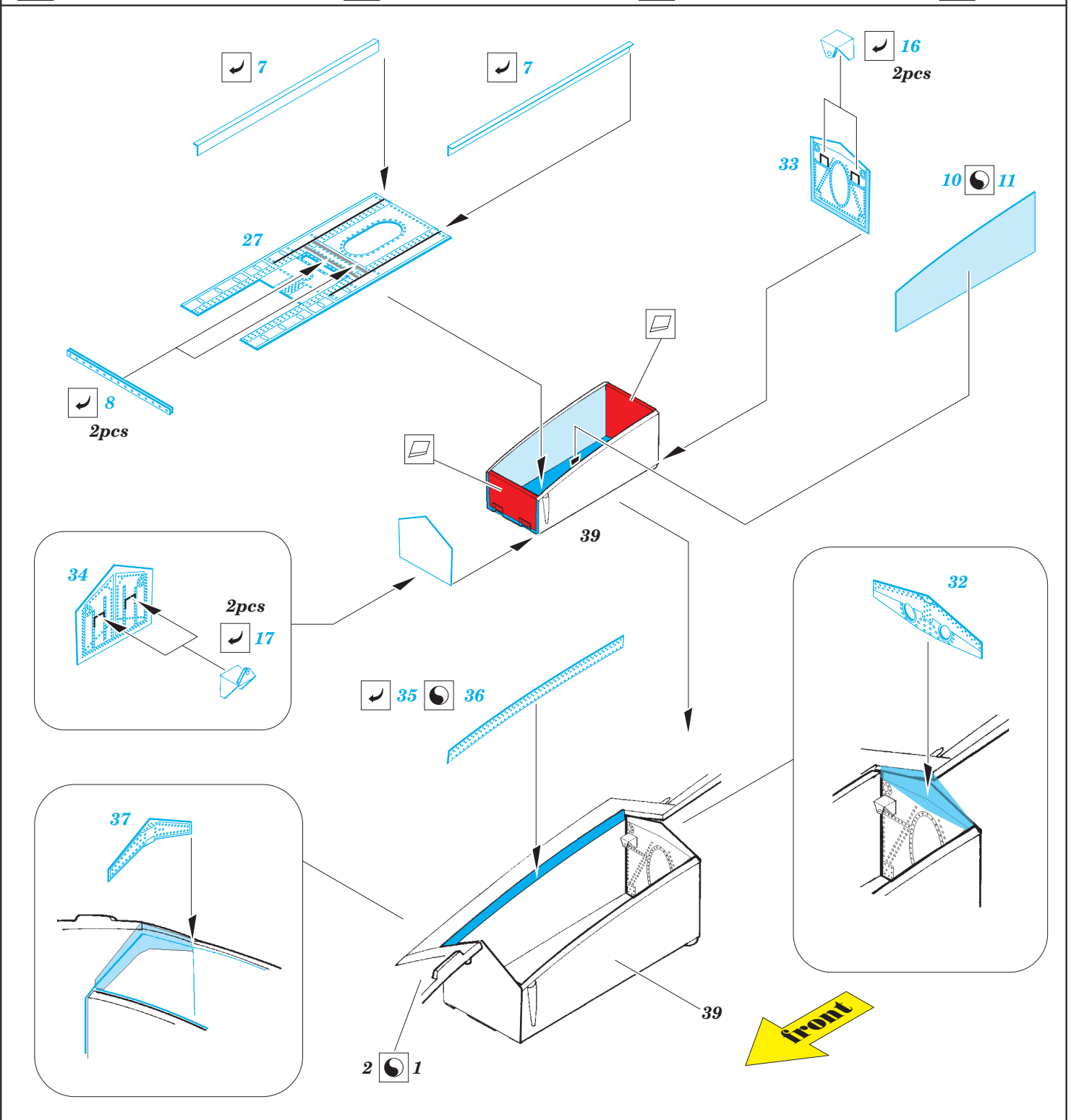

**step#1**

☑ 2 ☐ 1

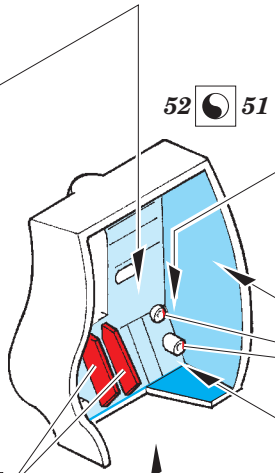
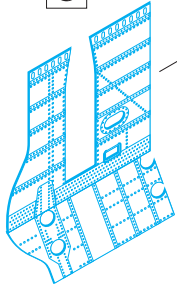

52 ☐ 51

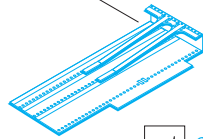

☑ 30 ☐ 29

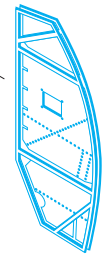
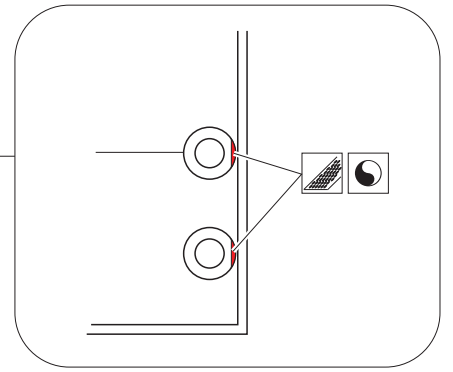

**step#2**

☑ 20 ☐ 19

**step#3**

☑ 3 ☐ 4

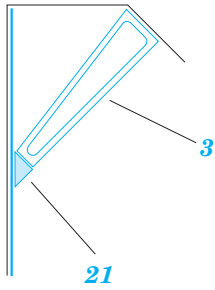

☑ 25 ☐ 26

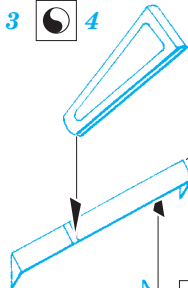

☑ 21 ☐ 22

☐ 5

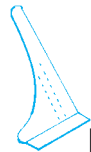

ball pen 15

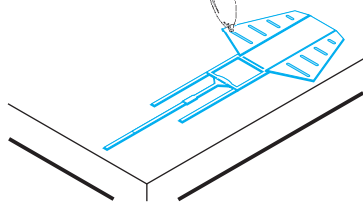

☑ 6 ☐

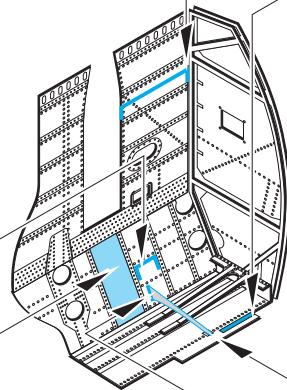
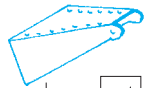

☑ 14 ☐

15

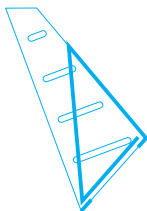

☑ 15 ☐

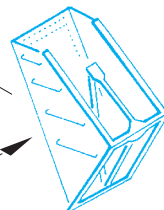

41, 47, 49, 52



42, 46, 48, 51

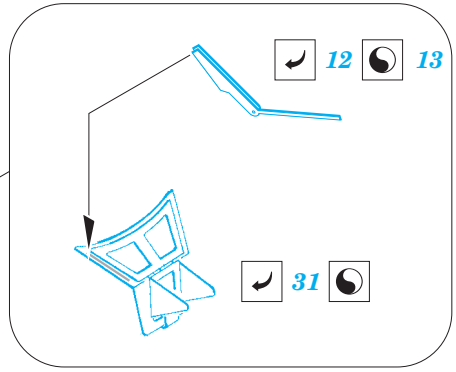
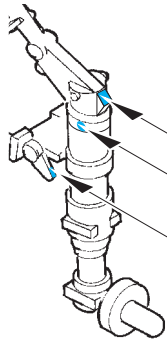

41, 47, 49, 52



42, 46, 48, 51

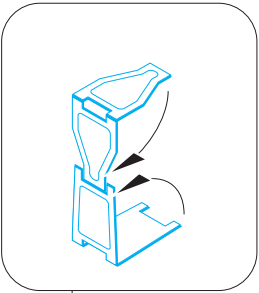
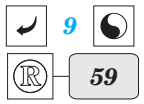
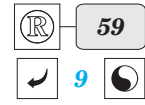
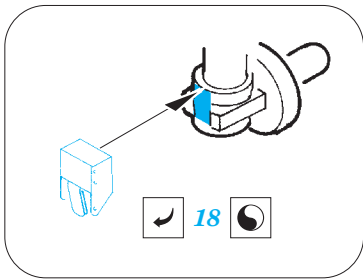
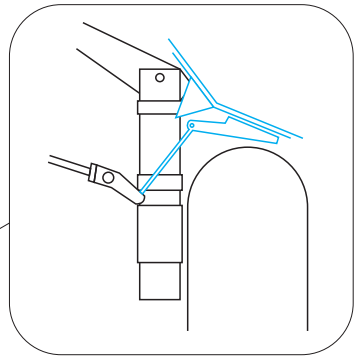
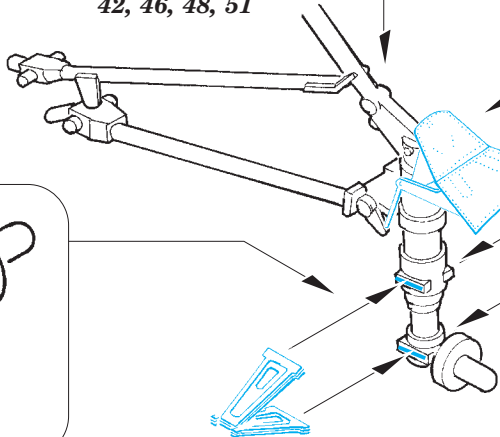

43, 44

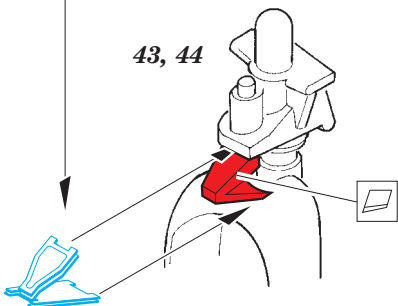

41, 47, 49, 52



42, 46, 48, 51

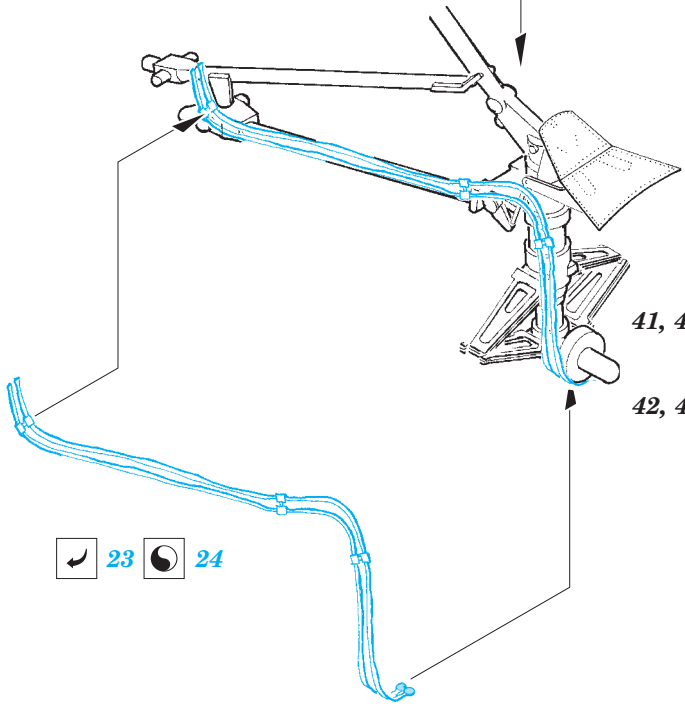

For further detail sets look for **eduard** FE 697 + 49 697 PBY-5A interior  
(not included in this set)

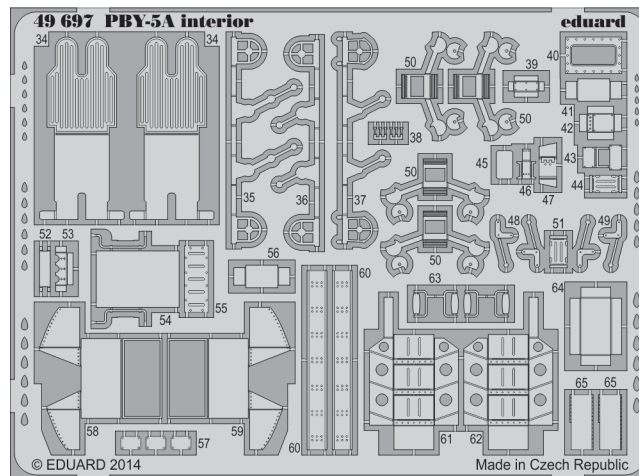
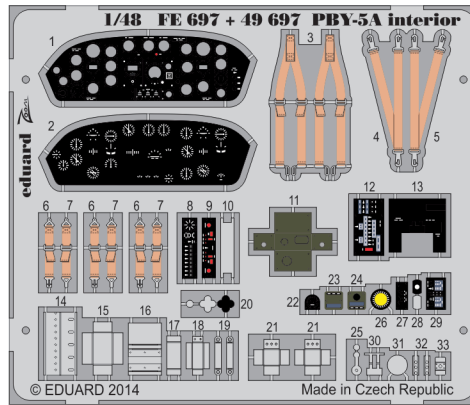

For further detail sets look for **eduard** 48 826 PBY-5A floats  
(not included in this set)

