

eduard

LIMITED EDITION



Avia S-99/C-10

1/48

11122 - NAV1

ATTENTION



UPOZORNĚNÍ



ACHTUNG



ATTENTION



注意



Carefully read instruction sheet before assembling. When you use glue or paint, do not use near open flame and use in well ventilated room. Keep out of reach of small children. Children must not be allowed to suck any part, or pull vinyl bag over the head.



Před započatím stavby si pečlivě prostudujte stavební návod. Při používání barev a lepidel pracujte v dobře větrané místnosti. Lepidla ani barvy nepoužívejte v blízkosti otevřeného ohně. Model není určen malým dětem, mohlo by dojít k požití drobných dílů.

INSTRUCTION SIGNS

* INSTR. SYMBOLS

* INSTRUKTION SINNBILDEN

* SYMBOLES

* 記号の説明

OPTIONAL
VOLBABEND
OHNOUOPEN HOLE
VYVRTAT OTVORSYMMETRICAL ASSEMBLY
SYMETRICKÁ MONTÁŽREMOVE
ODŘÍZNOUTREVERSE SIDE
OTOČITAPPLY EDUARD MASK
AND PAINT
POUŽIT EDUARD MASK
NABARVIT

PARTS



DÍLY



TEILE



PIÈCES



部品

PLASTIC PARTS

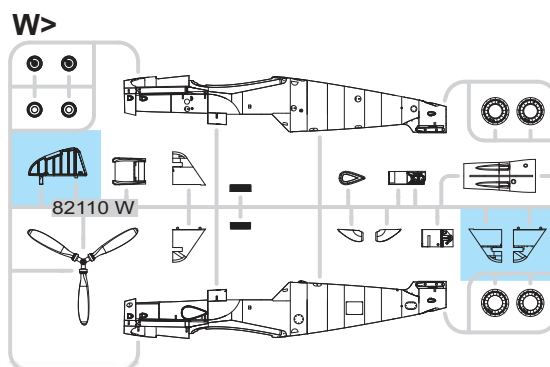
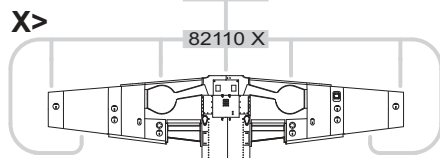
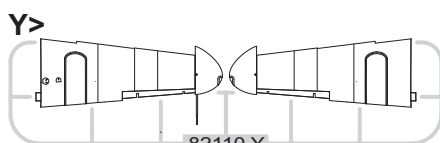
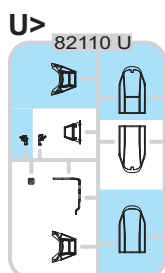
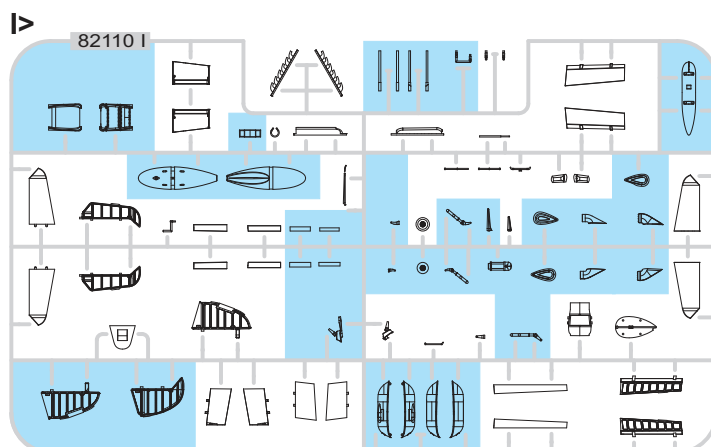
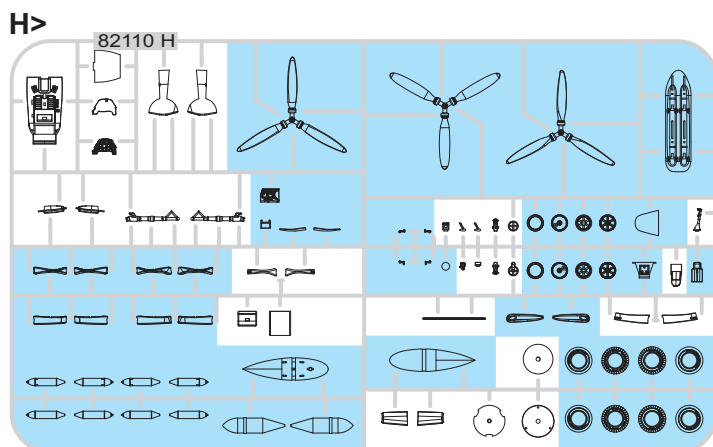

PE - PHOTO ETCHED DETAIL PARTS

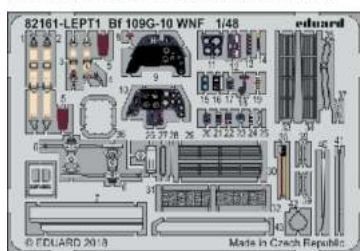

-Parts not for use. -Teile werden nicht verwendet. -Pièces à ne pas utiliser. -Tyto díly nepoužívejte při stavbě. - 使用しない部品

COLOURS



BARVY



FARBEN



PEINTURE



色

GSI Creos (GUNZE)		MISSION MODELS	
AQUEOUS	Mr.COLOR	PAINTS	
H2	C2	MMP-047	BLACK
H3	C3	MMP-003	RED
H5	C5	MMP-048	BLUE
H12	C33	MMP-047	FLAT BLACK
H43	C100		WINE RED
H47	C41	MMP-012	RED BROWN
H65	C18	MMP-088	RLM70 BLACK GREEN
H69	C37	MMP-050	RLM75 GRAY
H70	C60	MMP-056	RLM02 GRAY
H77	C137	MMP-040	TIRE BLACK
H90	C47		CLEAR RED

GSI Creos (GUNZE)		MISSION MODELS	
AQUEOUS	Mr.COLOR	PAINTS	
H94	C138		CLEAR GREEN
H324	C324	MMP-116	LIGHT GRAY
H413	C113	MMP-090	RLM04 YELLOW
H416	C116	MMP-089	RLM66 BLACK GRAY
H417	C117	MMP-051	RLM76 LIGHT BLUE
Mr.METAL COLOR		METALLICS	
MC213		MMM-006	STEEL
MC214		MMM-001	DARK IRON
Mr.COLOR SUPER METALLIC		METALLICS	
SM01		MMC-001	SUPER CHROME

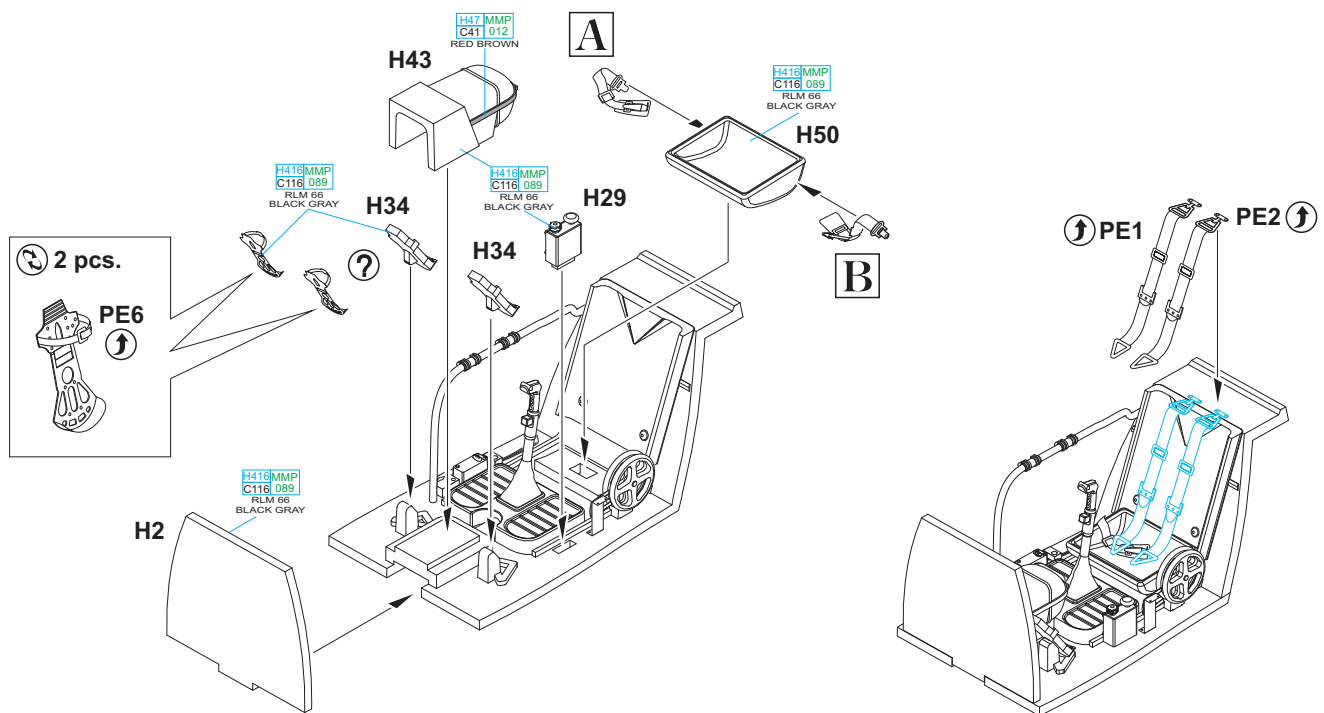
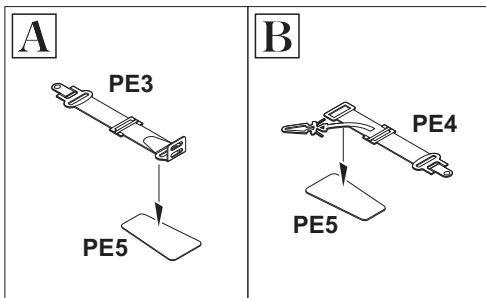
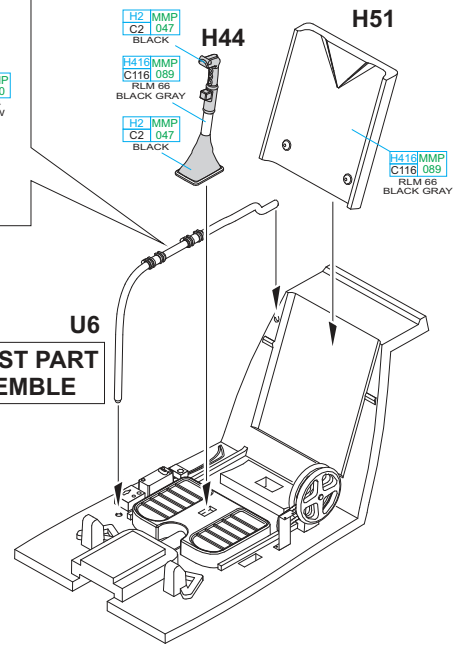
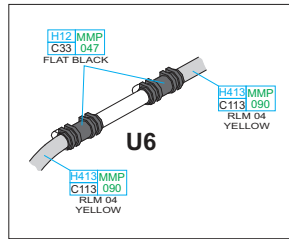
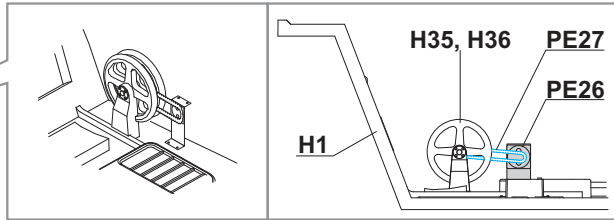
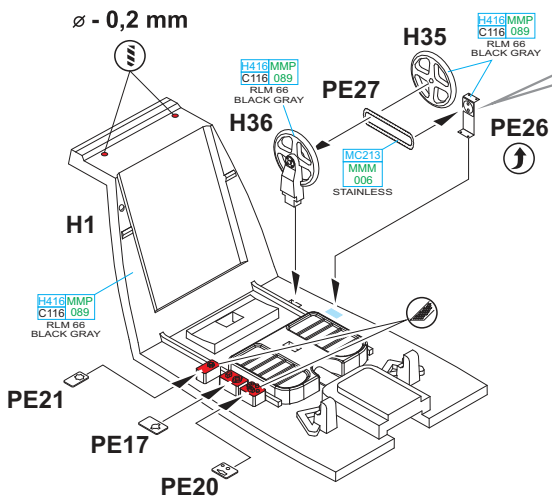

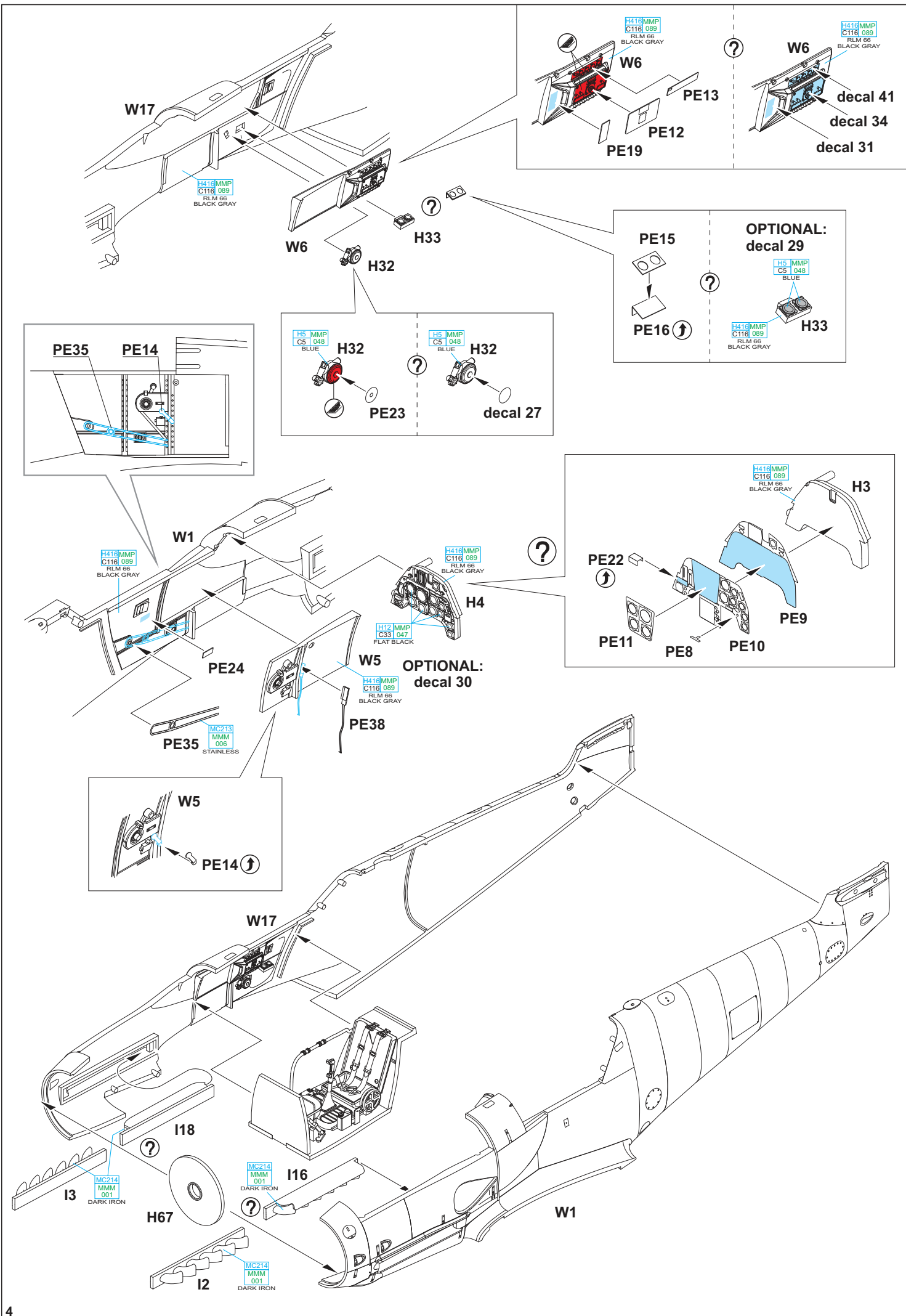

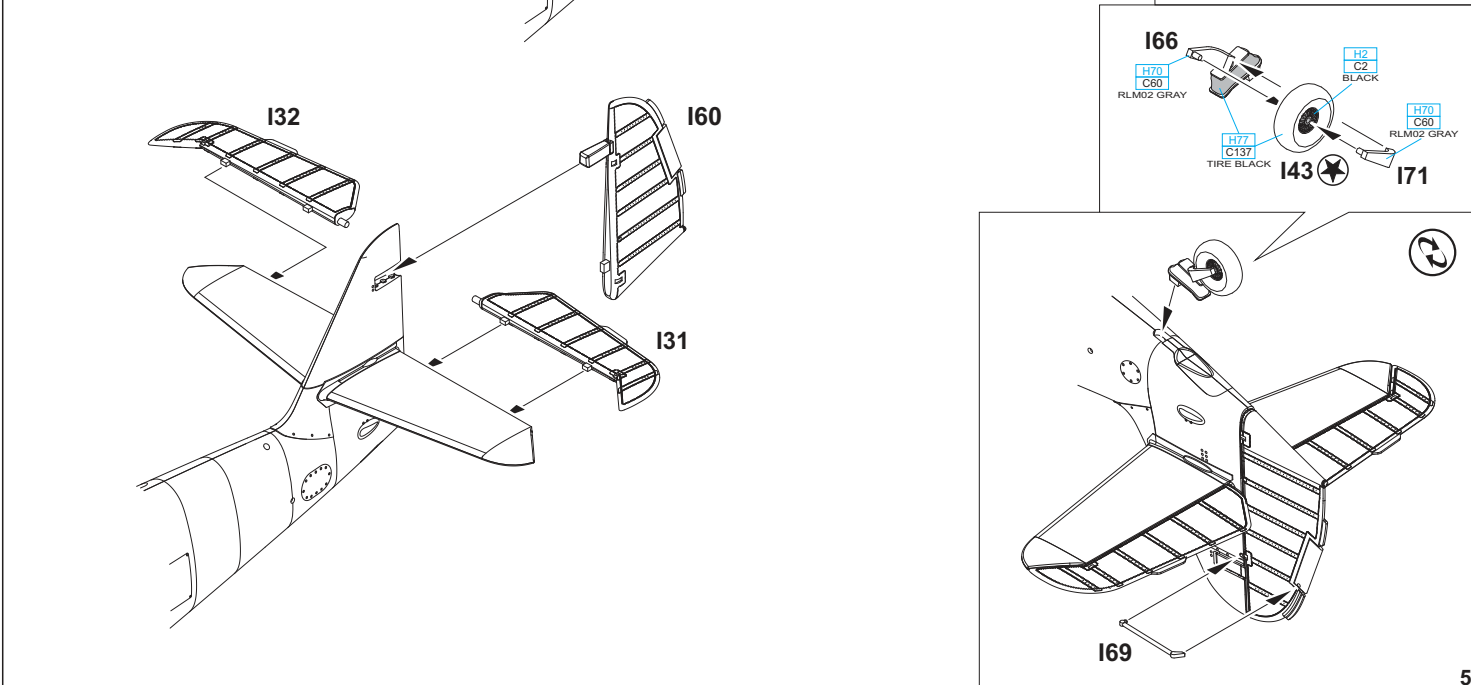
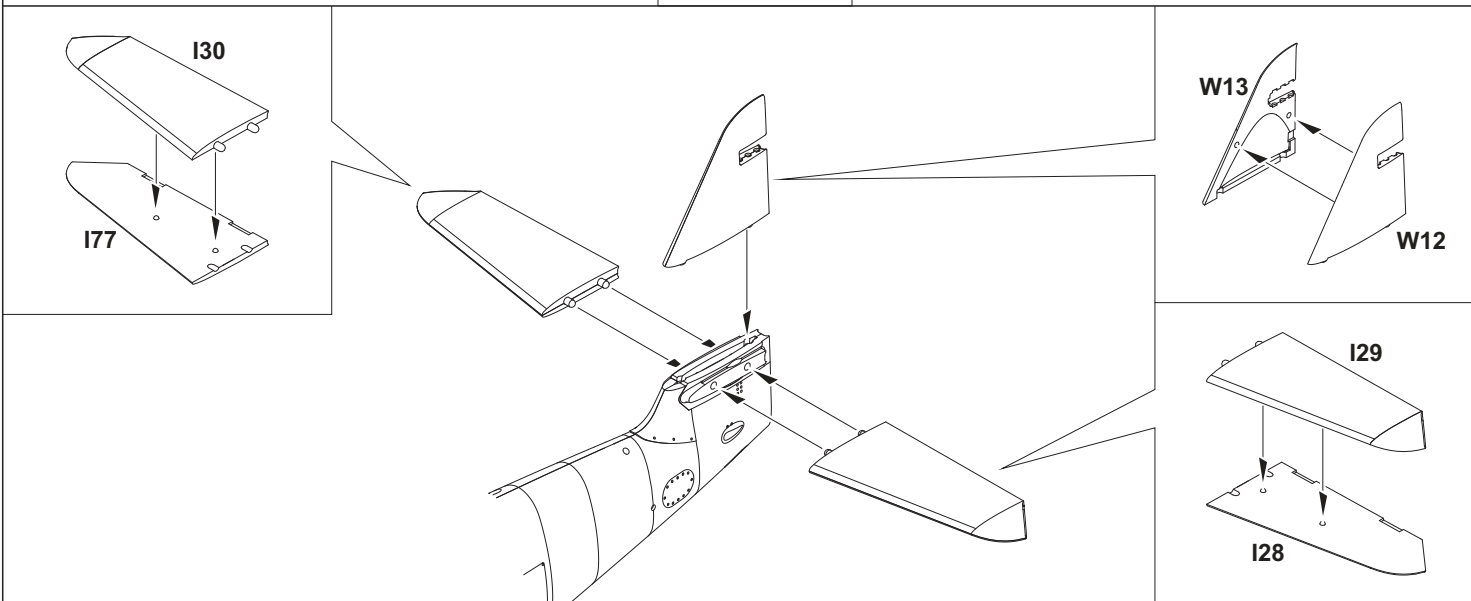
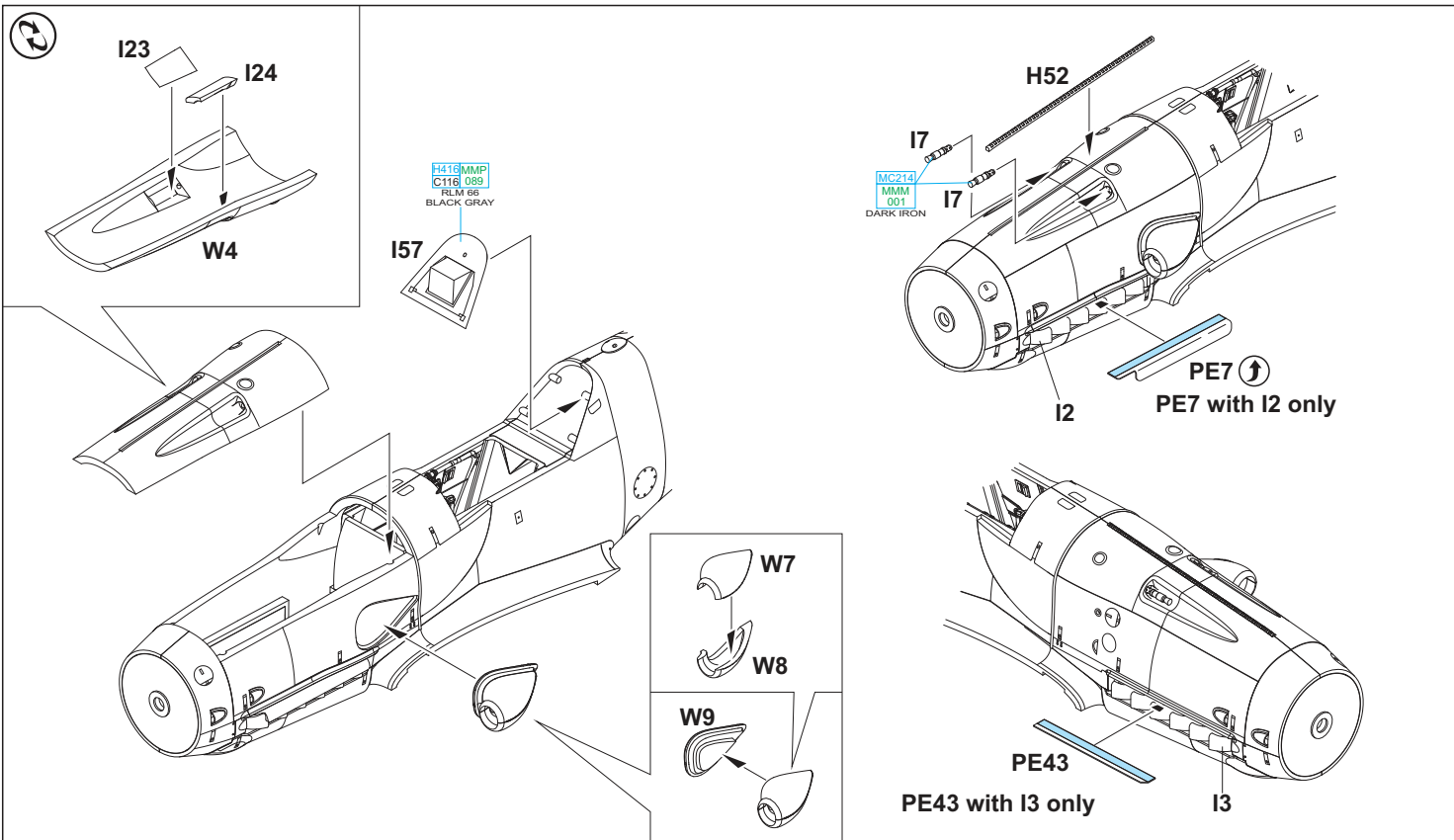

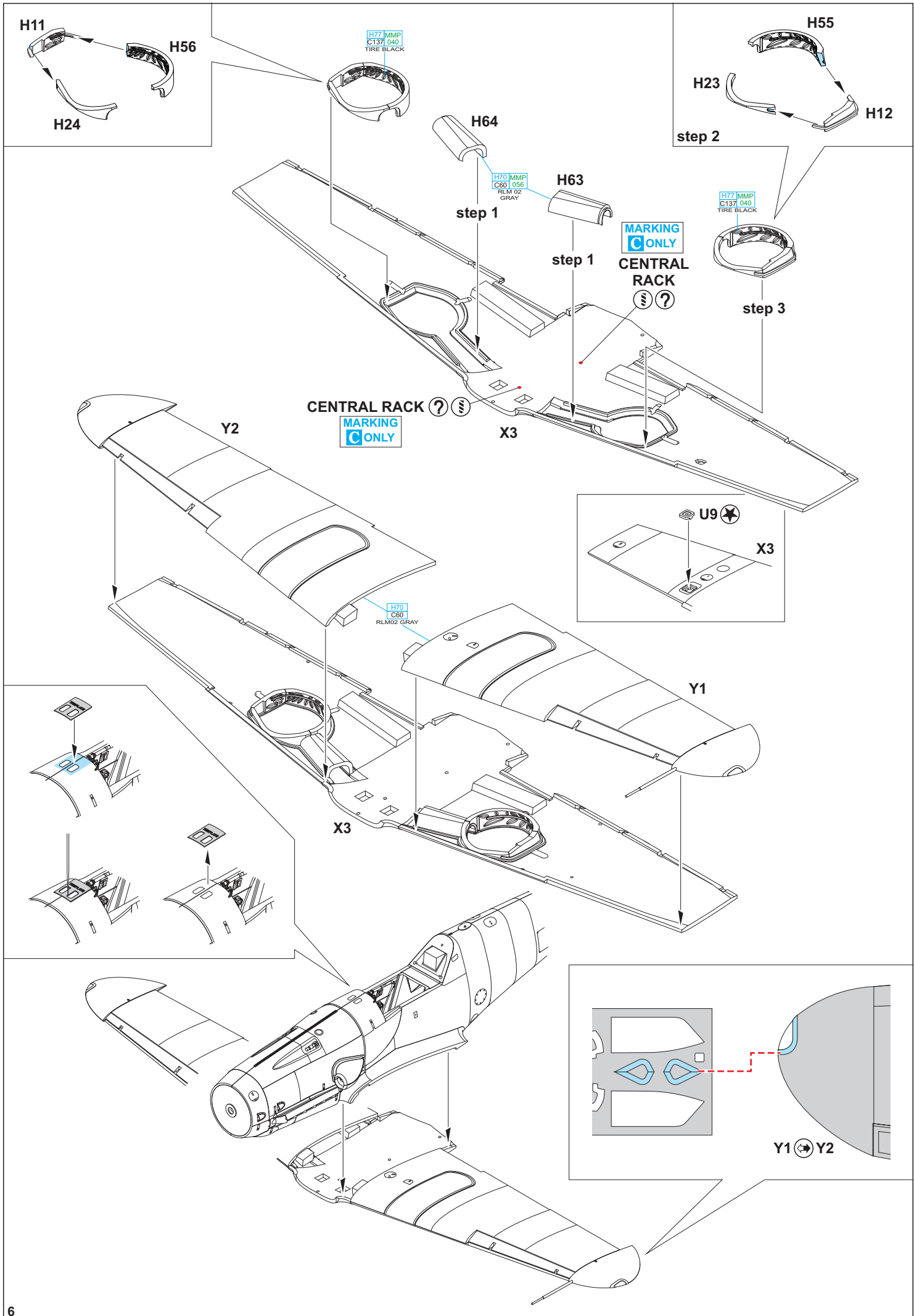

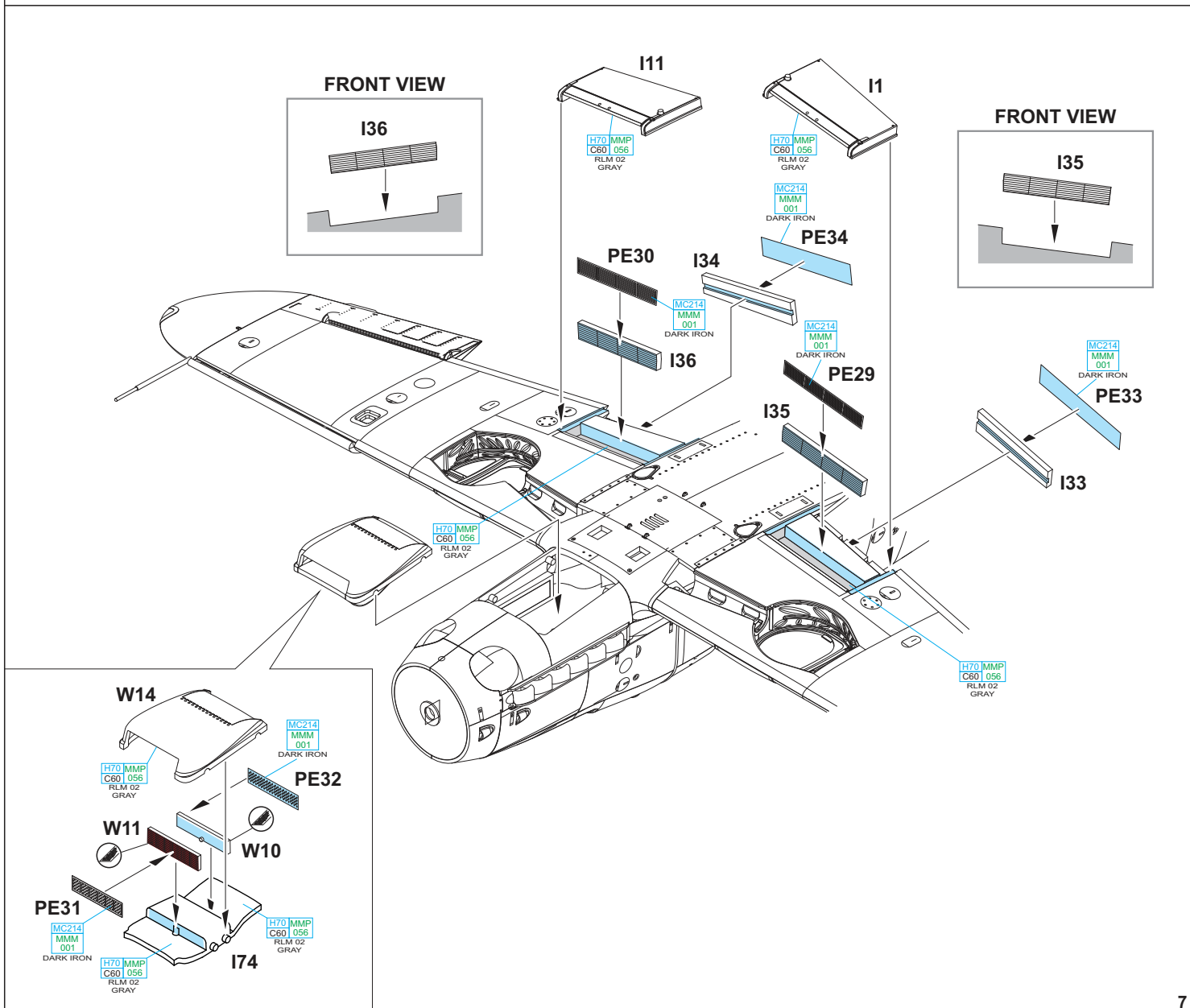
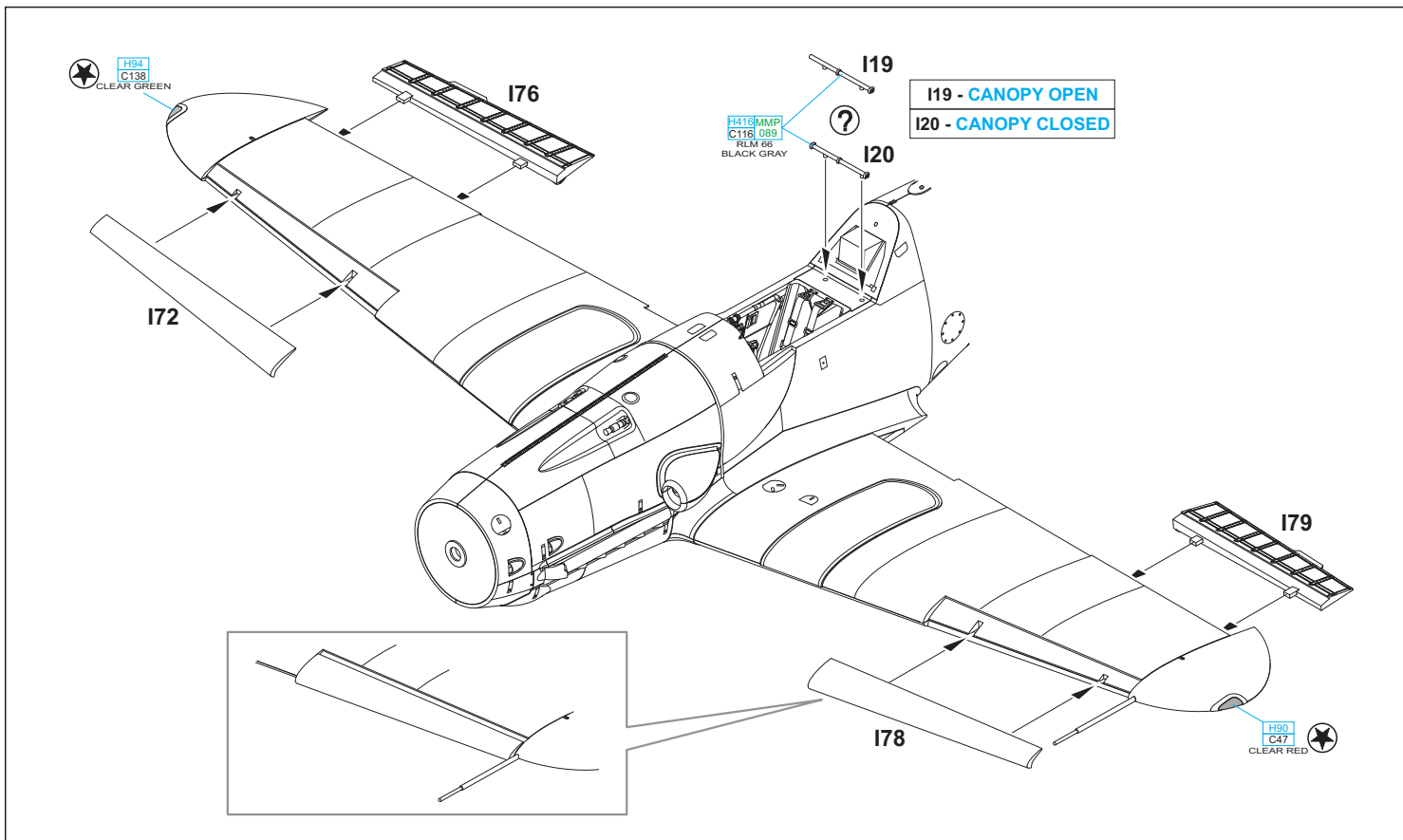

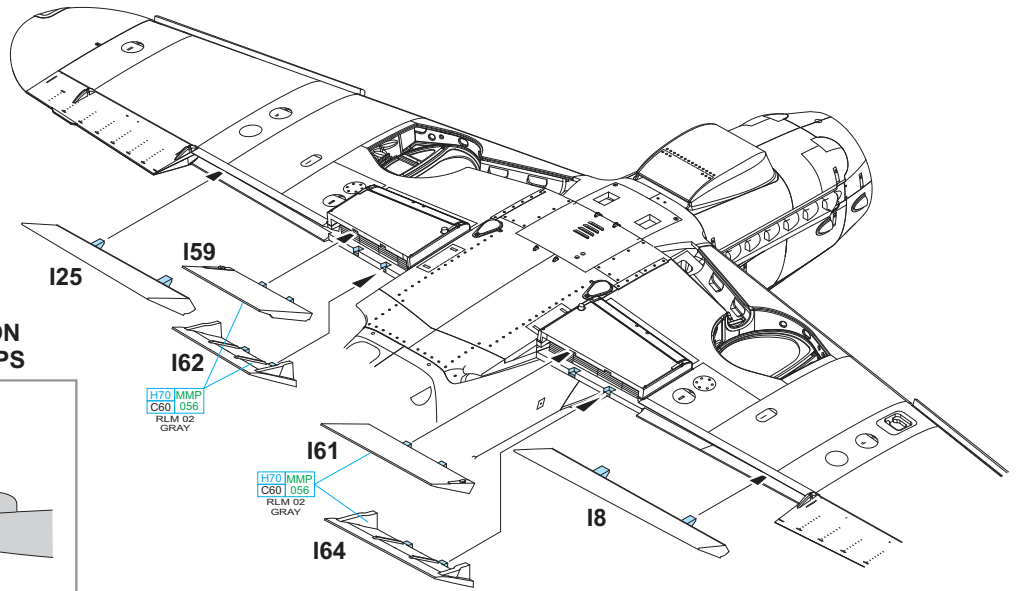

CORRECT POSITION OF RADIATOR FLAPS

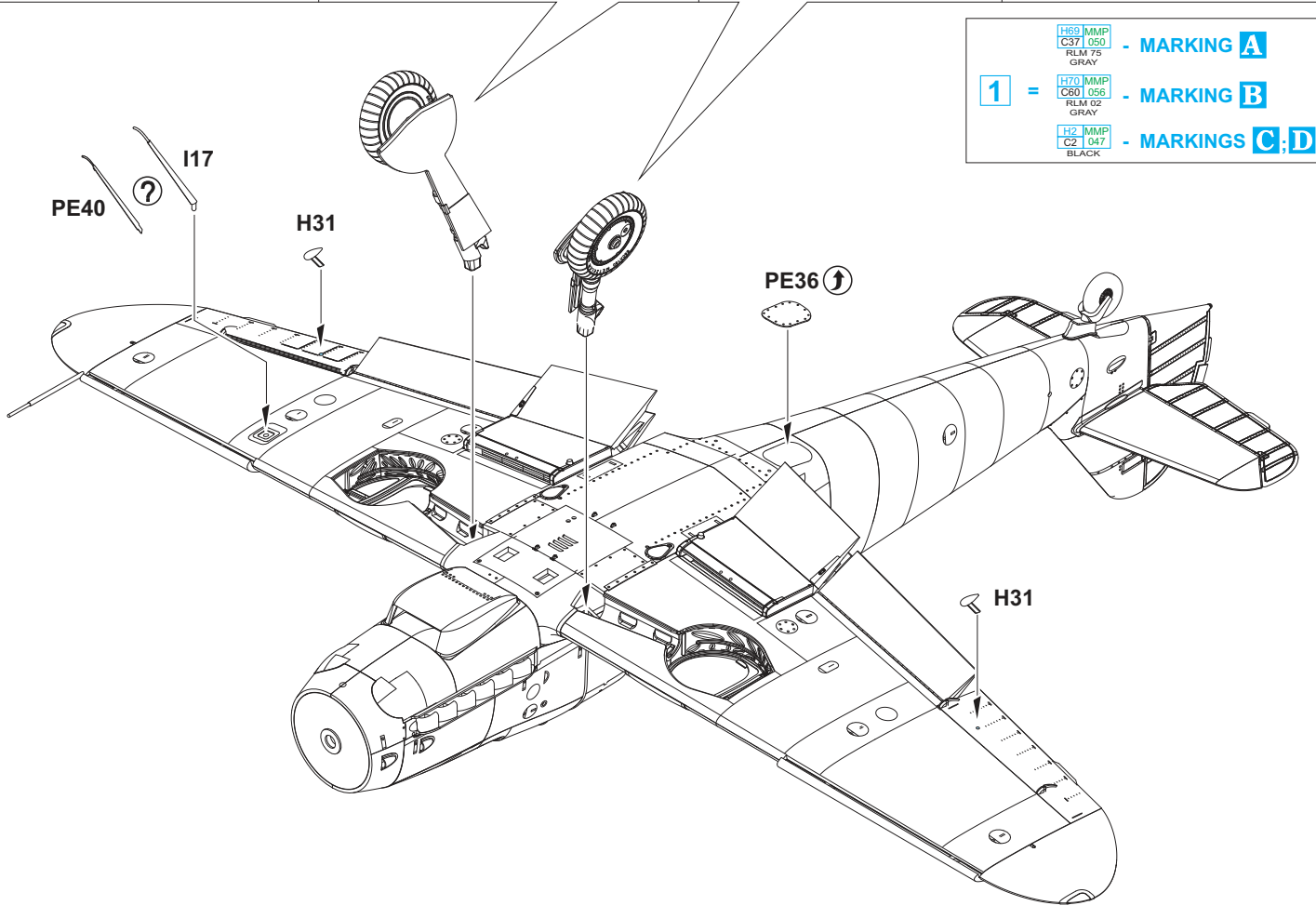
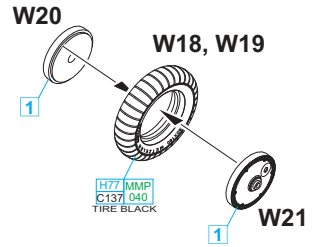
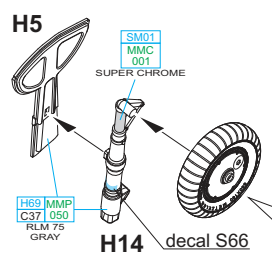
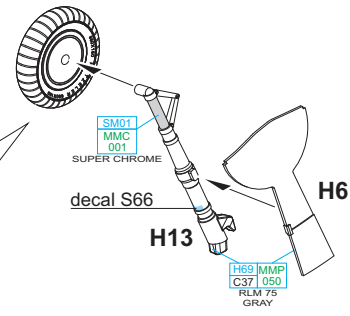
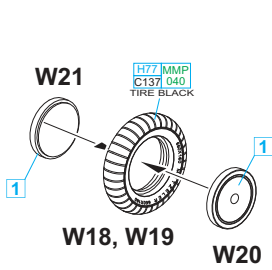
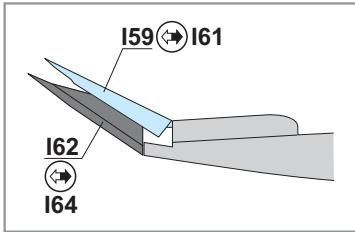

H69 MMP C37 050 RLM 75 GRAY	- MARKING A
1 = H70 MMP C60 056 RLM 02 GRAY	- MARKING B
H2 MMP C2 047 BLACK	- MARKINGS C;D

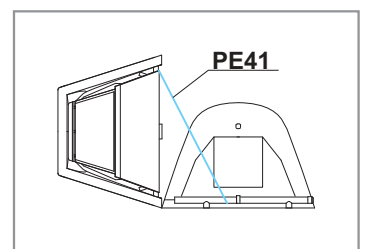
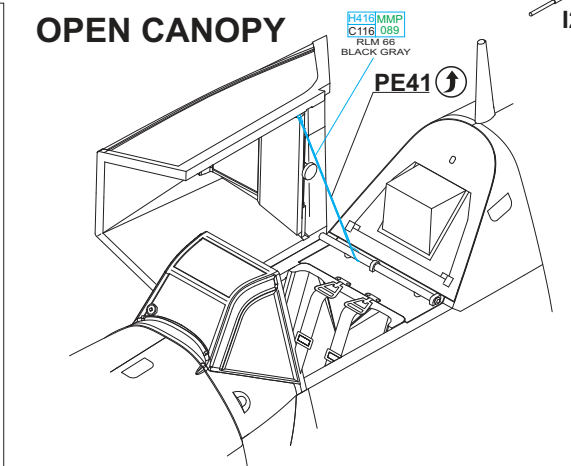
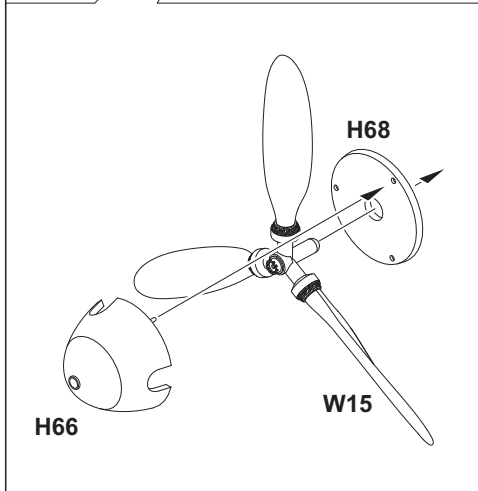
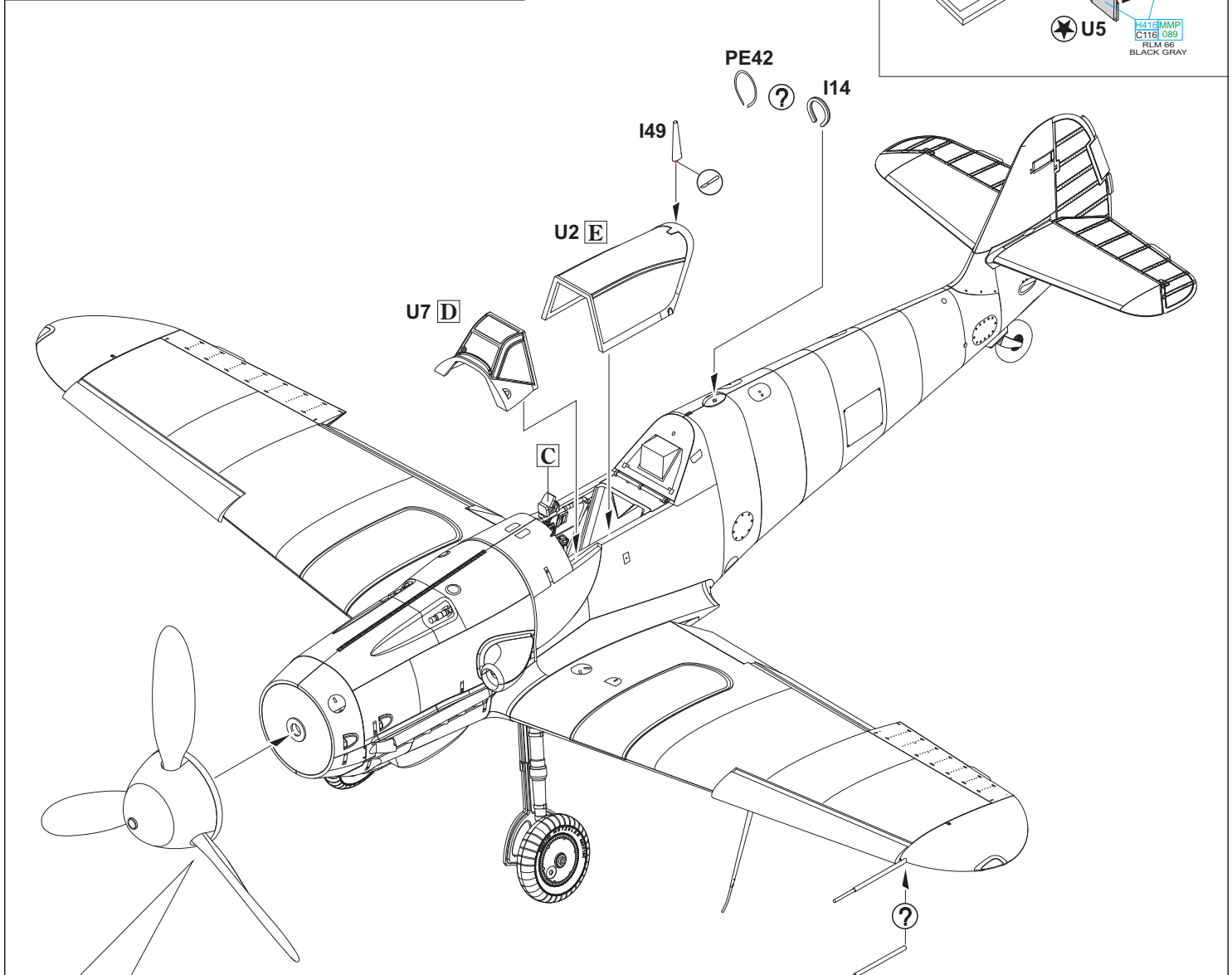
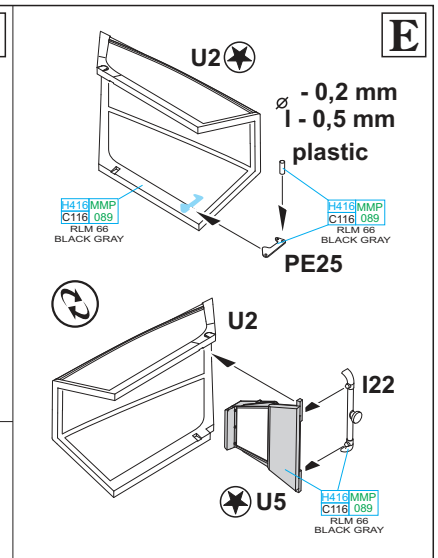
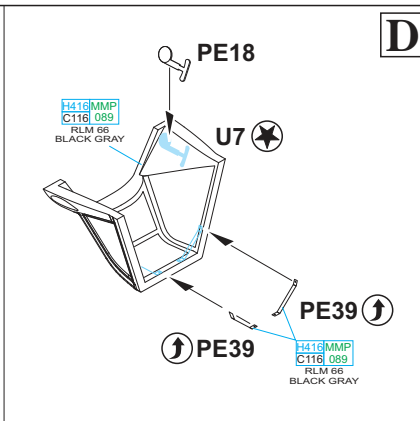
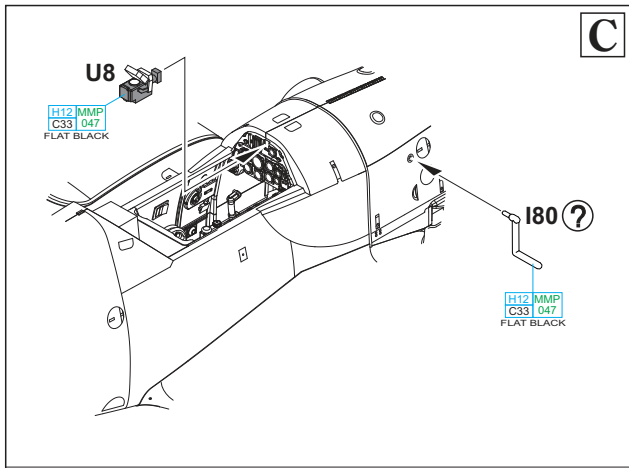

H69 MMP
C37 050
RLM 75
GRAY

I75 ?

I75 - MARKING C ONLY

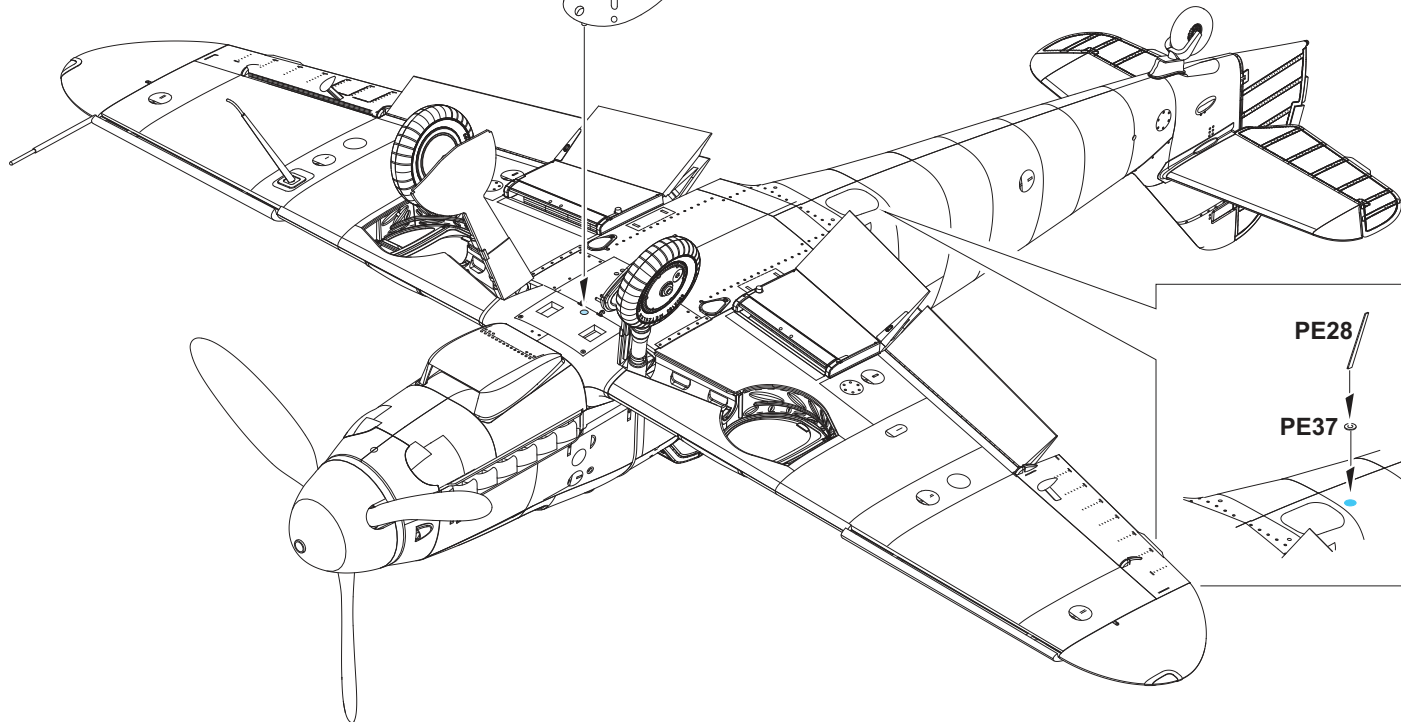

eduard
MASK

11122

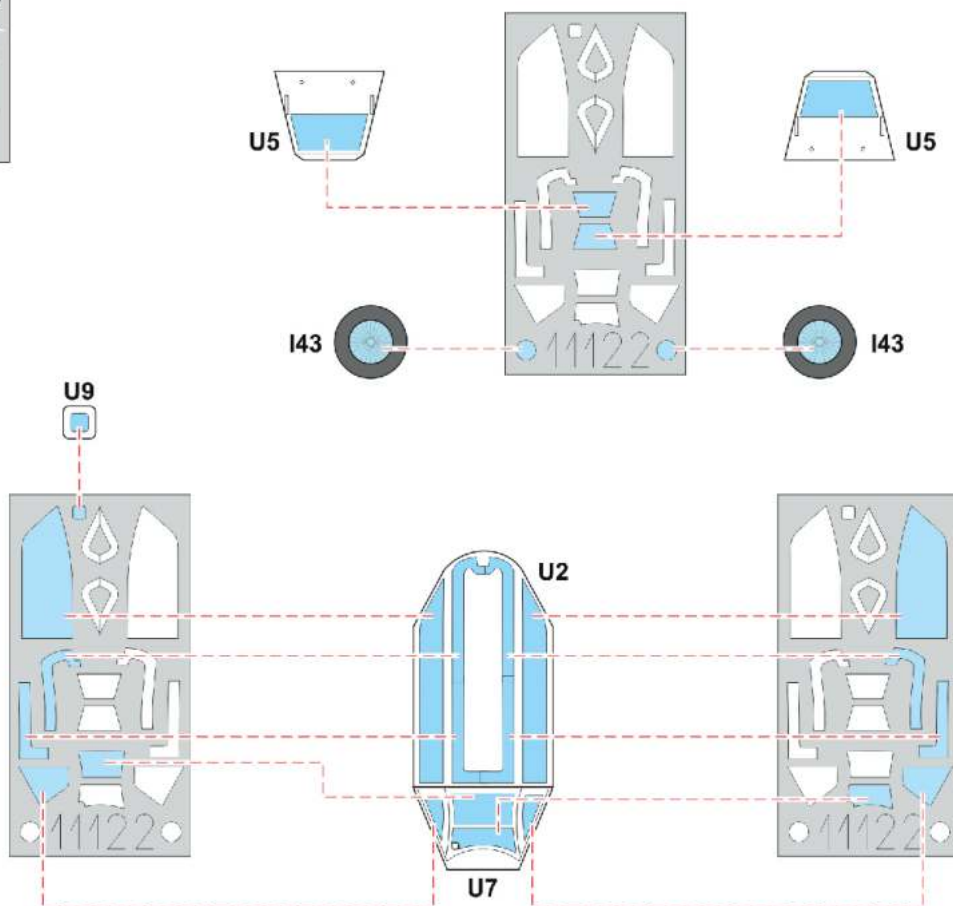

A Avia C-10.8 (S-99.8), OK-BYH, Police Air Patrol Unit, Czechoslovak Police Air Force, Brno – Slatina, 1947 - 1950

This aircraft, assigned to the Police Air Patrol Unit, first flew in November 1946 and was then transferred to the LVU (Aviation Research Centre). There, it would serve until April 1947, when it was finally delivered to the Police Air Patrol Unit. It was camouflaged on the upper and side surfaces in a metal grey colour while the lower surfaces were painted in a darker grey. Aircraft that served with the Police Air Patrol Unit had their engine cowls, leading edges of the wings, the elevators and stabilizers painted wine red. The codes on the fuselage sides and upper and lower wing surfaces were in the same colour, outlined in white. Also common to the Police Air Patrol Unit aircraft were the triangular roundels.

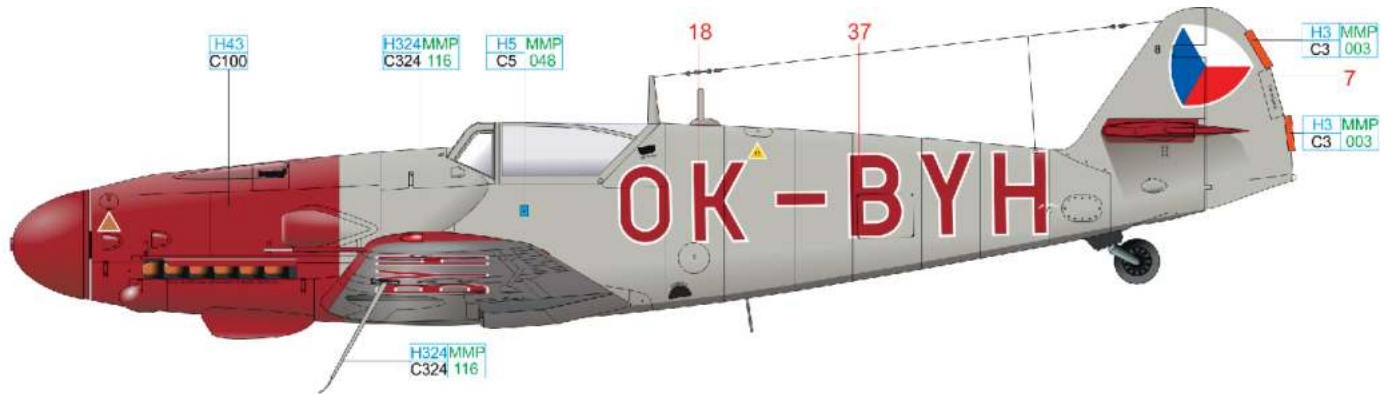

ČESKOU VERZI TEXTU NALEZNETE NA www.eduard.cz POD KATALOGOVÝM ČÍSLEM 11122

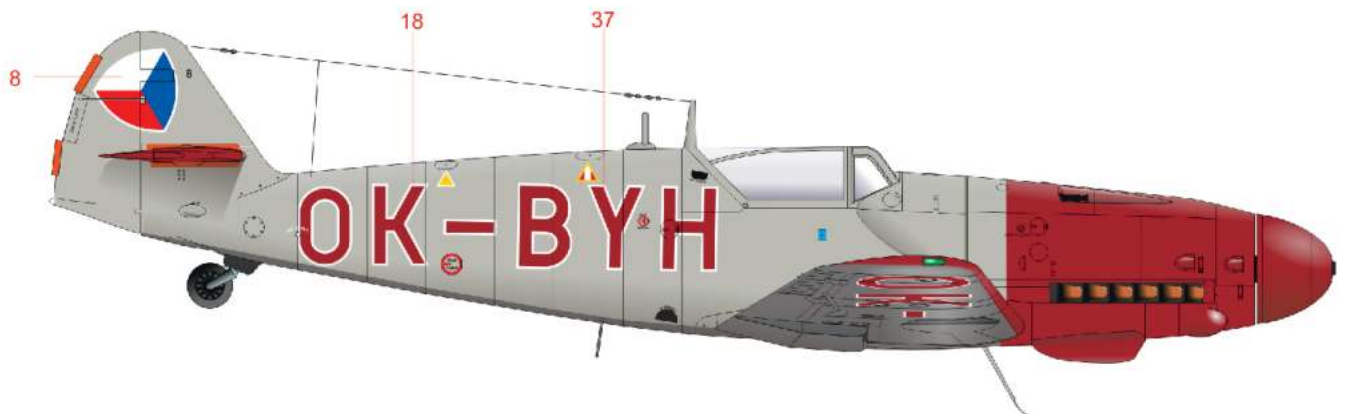
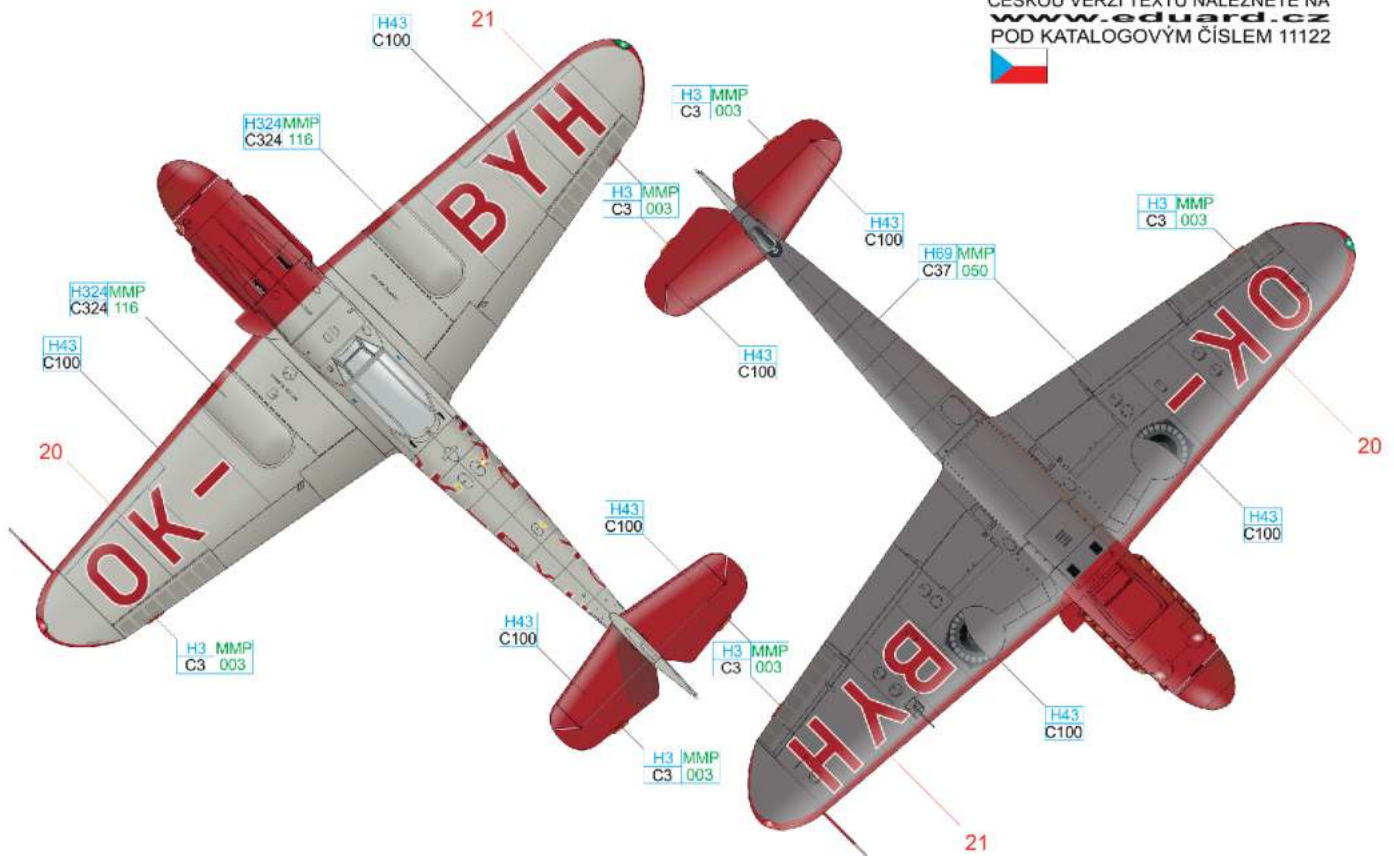

DARK GRAY	H69 MMP C37 050	RED	H43 C100	LIGHT GRAY	H324MMP C324 116	RED	H3 MMP C3 003	BLUE	H5 MMP C5 048
-----------	-----------------	-----	----------	------------	------------------	-----	---------------	------	---------------

B Avia C-10.6, EV-11, Command Flight, 2nd Air Division, Fighter Training Centre, Czechoslovak Air Force, Planá Air Base, České Budějovice, Spring 1947

This aircraft, borrowed from the Czechoslovak Police Air Force, flew with the black fuselage code EV-11 with the Air Force. The same code should also appear under the wings, according to Staff Command Order from January 1946. This, however, remains unconfirmed due to the low quality of photographic evidence. According to some sources, the entire aircraft was painted in a grey-green colour, most likely German RLM 02, with the white outlined Czechoslovak national roundels in six positions.

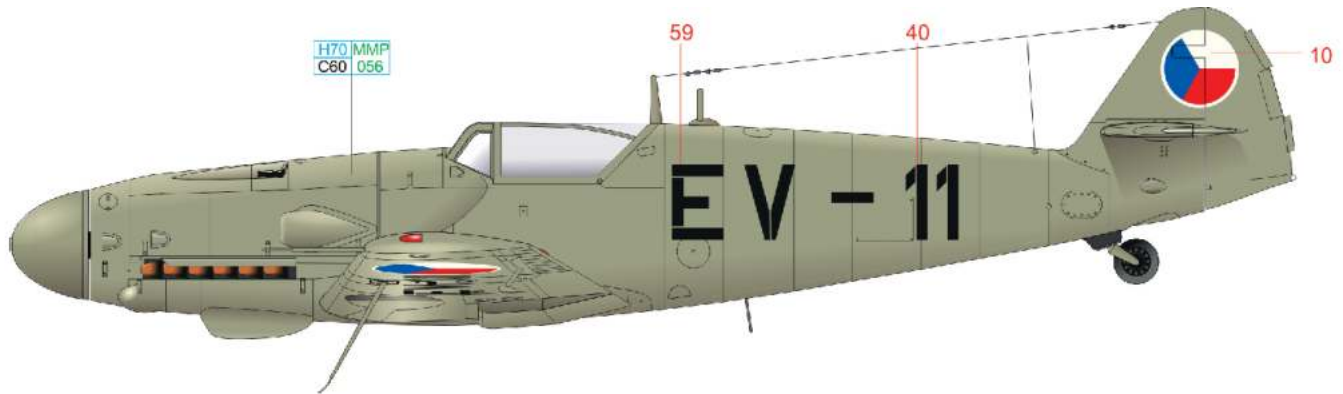

ČESKOU VERZI TEXTU NALEZNETE NA www.eduard.cz POD KATALOGOVÝM ČÍSLEM 11122

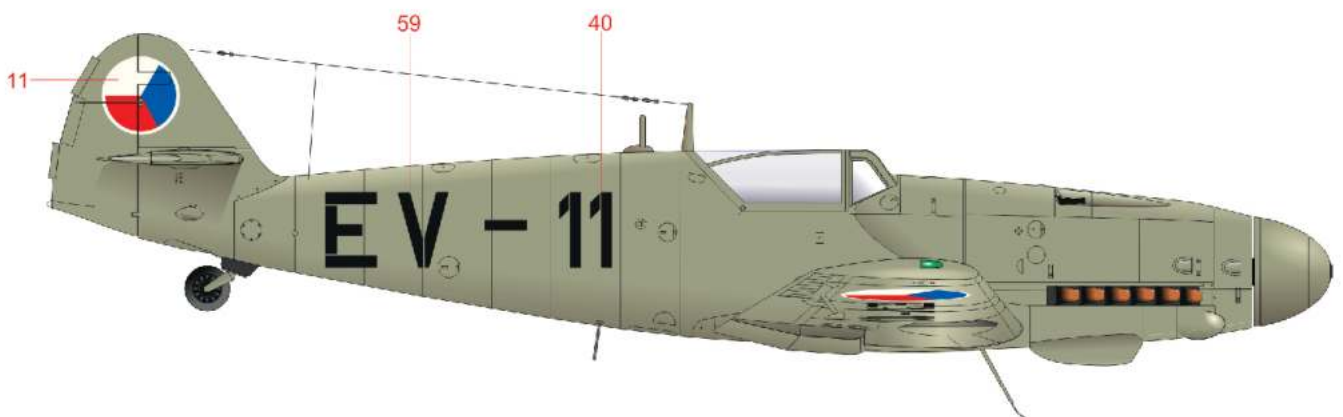
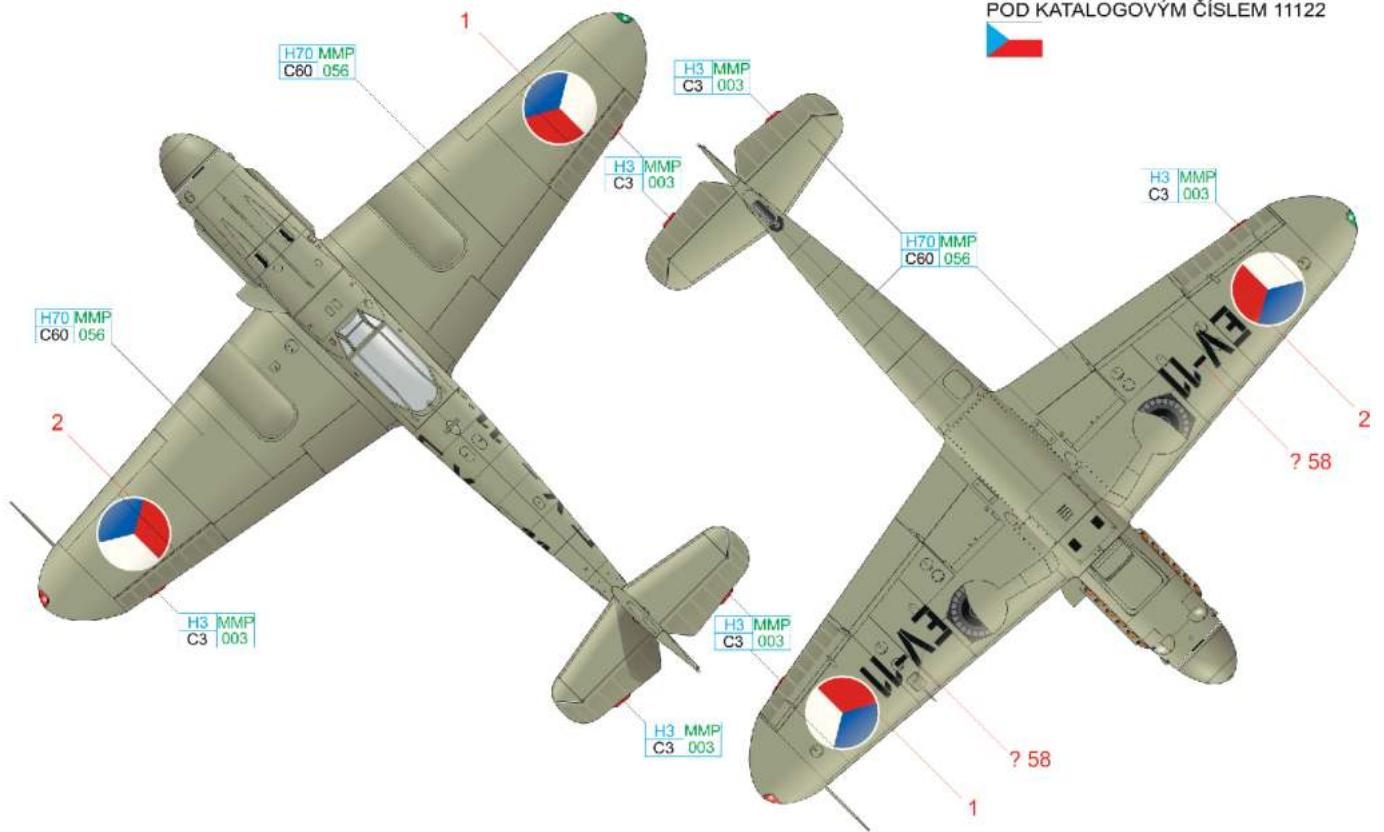

RLM 02 H70 MMP C60 056 RED H3 MMP C3 003

C Avia C-10.21, OK-BYU, Police Air Patrol Unit, Czechoslovak Police Air Force, Prague – Ruzyně, 1947

This aircraft was the last to be assembled in the spring of 1947 by Avia at Letňany, after verification flights, it was transferred to the Police Air Patrol Unit element of the Czechoslovak Police Air Force in mid-July 1947 at Ruzyně in Prague, where it served until at least 1949. This aircraft was marked the same way as OK-BYH, with the exception of lacking the white border to the markings on the vertical tail surfaces.



ČESKOU VERZI TEXTU NALEZNETE NA www.eduard.cz POD KATALOGOVÝM ČÍSLEM 11122

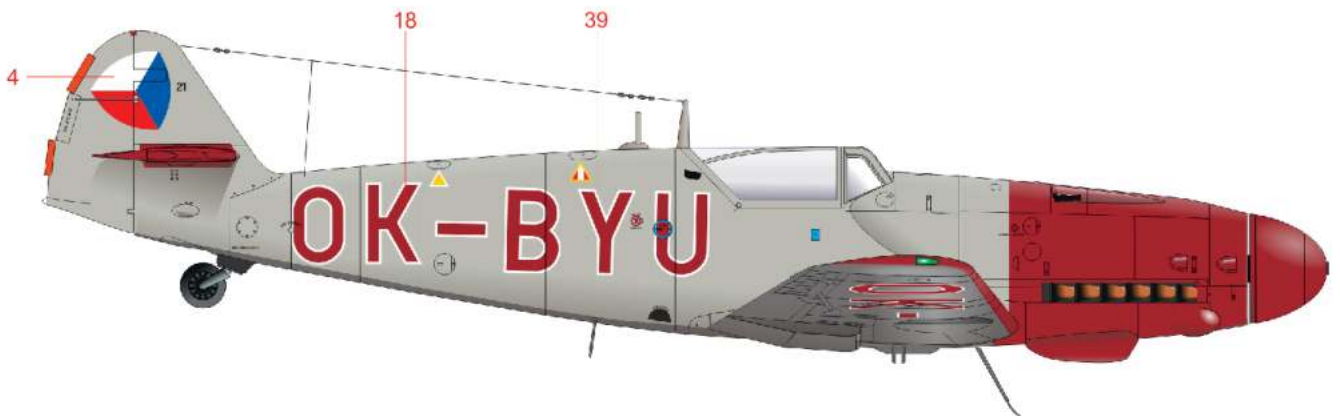
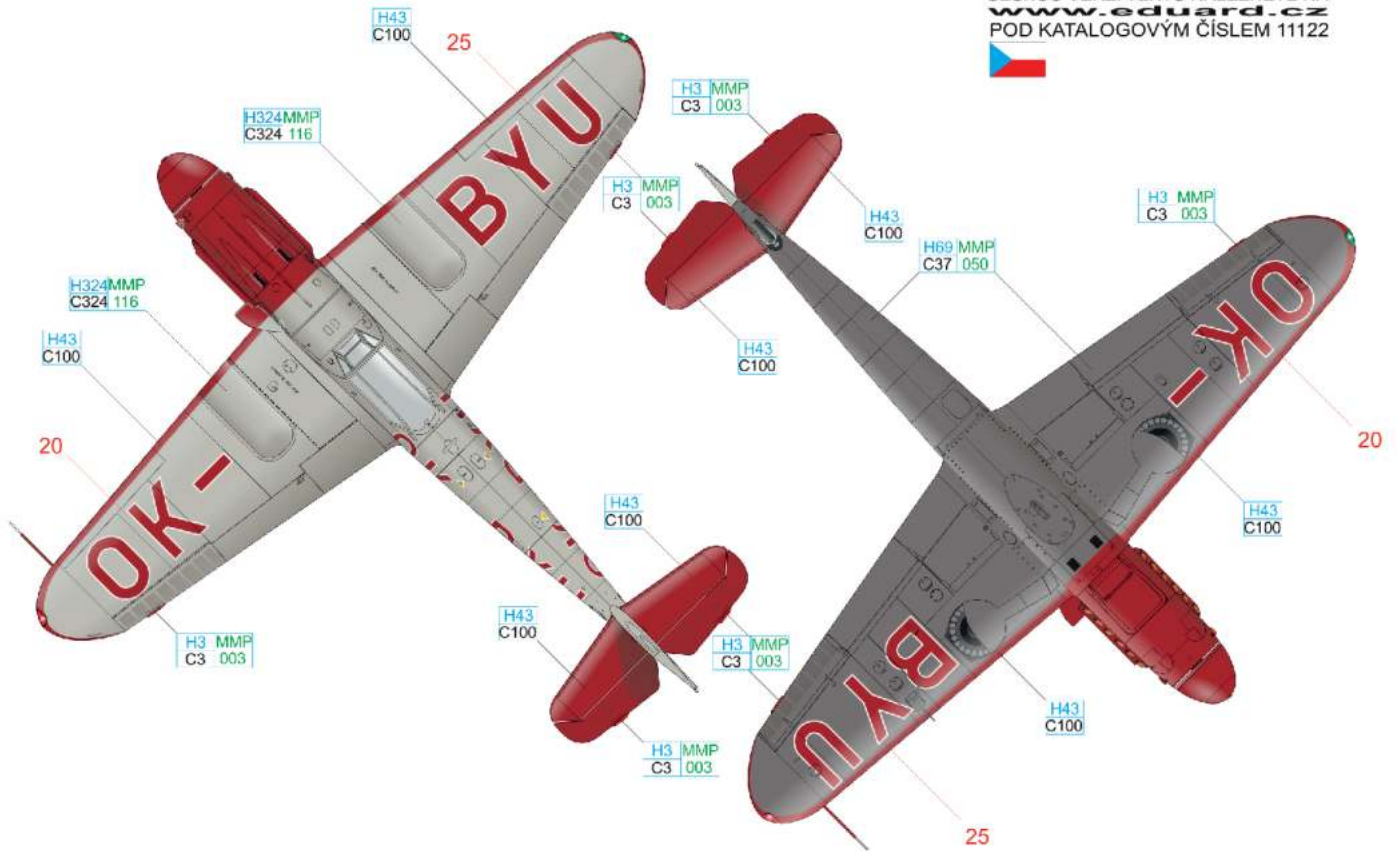

DARK GRAY	H69 MMP C37 050	RED	H43 C100	LIGHT GRAY	H324MMP C324 116	RED	H3 MMP C3 003	BLUE	H5 MMP C5 048
-----------	-----------------	-----	----------	------------	------------------	-----	---------------	------	---------------

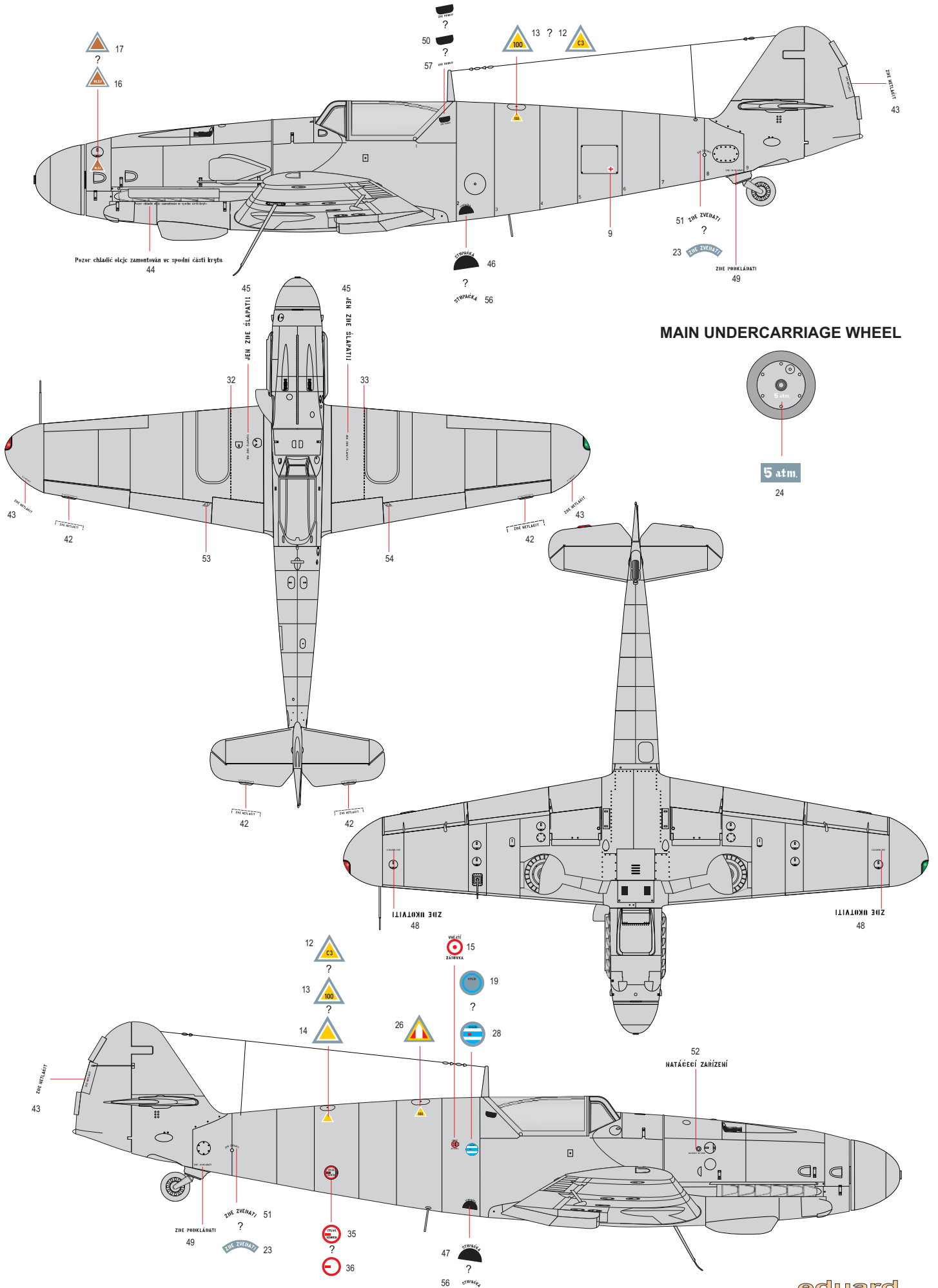

S-99/C-10

1/48

#11122
eduard
LIMITED EDITION

RELATED PRODUCTS for Avia S-99/C-10:

- 49093 Bf 109G seatbelts FABRIC 1/48 (PE-set)
- 49094 Bf 109G seatbelts SUPERFABRIC 1/48 (PE-set)
- 49095 Seatbelts Luftwaffe WWII fighters STEEL 1/48 (PE-Set)
- 644004 Bf 109G-10 Löök 1/48 (Brassin)
- 648158 Bf 109G-10 wheels 1/48 (Brassin)
- 648247 Bf 109G exhaust stacks Eduard 1/48 (Brassin)
- 648309 Bf 109G undercarriage legs BRONZE 1/48 (Brassin)
- 648422 Bf 109G-10 cockpit 1/48 (Brassin)
- EX608 Bf 109G-10 1/48 (Mask)
- EX609 Bf 109G-10 TFace 1/48 (Mask)

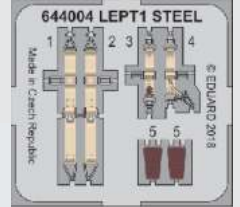

Cat. No. 644004



Cat. No. 648247

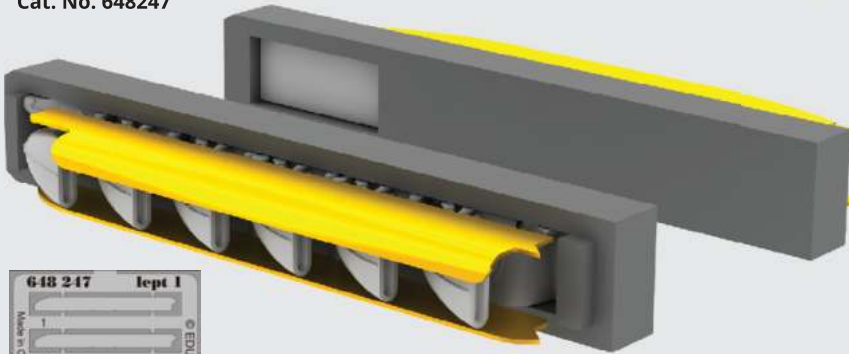

Cat. No. 648422

