

Revell

KIT 5624

85562400200

JUNKERS Ju 52 / 3m TRANSPORT

Originally developed and used as a peacetime commercial airliner, the Ju52 made its maiden flight in 1932. At the start of World War II, when Germany invaded Poland, the Luftwaffe's Transportverband had an inventory of 547 Ju52/3ms. The Ju52 was tailor-made to supply fast moving troops and advanced paratrooper deployment, the Ju52 was a real "workhorse".

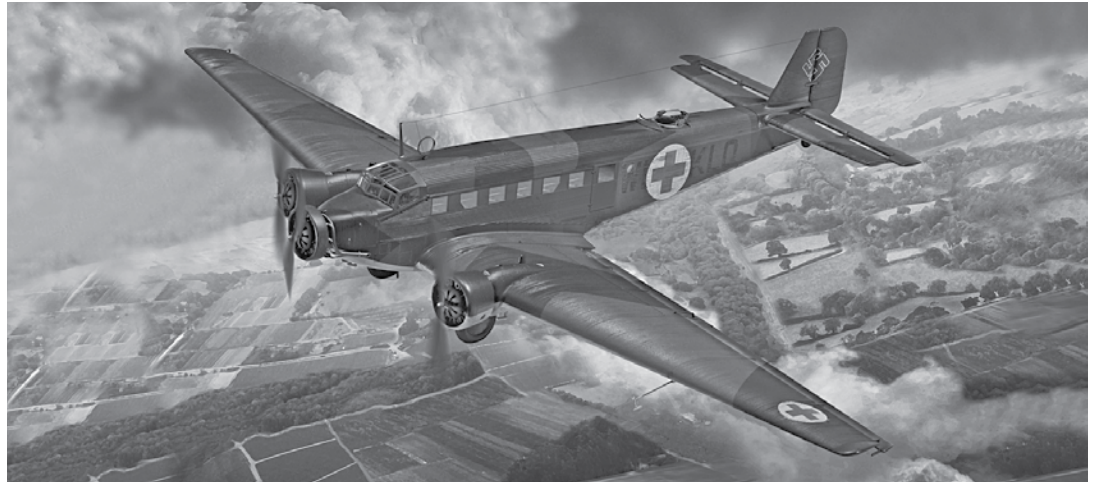

* REPEAT SEVERAL TIMES
* A REPETER PLUSIEURS FOIS



* OPTIONAL PARTS
* PIECES EN OPTION



* DECAL
* DECAL COMANIE



* ALTERNATIVE ASSEMBLY
* ENSEMBLAGE ALTERNATIVE



* CEMENT TOGETHER
* A COLLER



* REMOVE AND THROW AWAY
* A RETIRER ET JETER



* DO NOT CEMENT
* NE PAS COLLER

READ THIS BEFORE YOU BEGIN

- * Study the assembly drawings.
- * Each plastic part is identified by a number.
- * In the assembly drawings, some parts will be marked by a star (★) to indicate chrome plated plastic.
- * For better paint and decal adhesion, wash the plastic parts in a mild detergent solution. Rinse and let air dry.
- * Check the fit of each piece before cementing in place.
- * Use only cement for polystyrene plastic.
- * Scrape plating and paint from areas to be cemented.
- * Allow paint to dry thoroughly before handling parts.
- * Any unused parts may be discarded.

DECAL APPLICATION INSTRUCTIONS

1. Cut desired decal from sheet.
2. Dip decal in water for a few seconds.
3. Place wet decal on paper towel.
4. Wait until decal is movable on paper backing.
5. Place decal in position on model, face up and slide backing away.
6. Press out air bubbles with a soft damp cloth.
7. Milkiness that may appear is for better decal adhesion and will dry clear. Wipe away any excess adhesive.
8. Do not touch decal until fully dry.
9. Allow the decals 48 hours to dry before applying clear coat.

NOTE: Decals are compatible with setting solutions or solvents.

LIRE CE QUI SUIT AVANT DE COMMENCER

- * Etudier les schémas de montage.
- * Chaque pièce en plastique est identifiée par un numéro.
- * Sur les schémas de montage, certaines pièces sont marquées d'une étoile (★) pour indiquer qu'elles sont en plastique chromé.
- * Pour une meilleure prise de la peinture et des autocollants, laver les pièces en plastique avec une solution détergente peu concentrée. Les rincer et les laisser sécher à l'air.
- * Vérifier que chaque pièce s'ajuste bien avant de la coller en place.
- * N'utiliser que de la colle pour polystyrène.
- * Gratter les parties à colle pour enlever le chrome et la peinture.
- * Laisser la peinture bien sécher avant de manipuler les pièces.
- * Toute pièce inutilisée peut être jetée.

DIRECTIVES D'APPLICATION DES AUTOCOLLANTS

1. Découper l'autocollant désiré de la feuille.
2. Tremper l'autocollant dans de l'eau pendant quelques secondes.
3. Placer l'autocollant mouillé sur une serviette en papier.
4. Attendez que l'autocollant puisse être déplacé sur son support en papier.
5. Mettre l'autocollant en position sur le modèle face sur le dessus et faire glisser le support pour l'enlever.
6. Appuyer avec un chiffon doux humide pour éliminer les bulles d'air.
7. La substance laiteuse qui peut apparaître est destinée à améliorer l'adhésion de l'autocollant et devient incolore au séchage. Essuyer pour enlever tout excédent d'adhésif.
8. Ne pas toucher l'autocollant tant qu'il n'est pas bien sec.
9. Laisser l'autocollant sécher pendant 48 heures avant d'appliquer une couche transparente.

REMARQUE: Les autocollants sont compatibles avec les solutions de fixage ou les solvants.

This paint guide is provided to complete this kit as shown on the box.

Ce guide de peintures est fourni pour reproduire le modèle réduit qui apparaît sur la boîte.

Black Green	Vert noir
Dark Green	Vert foncé
Flat Black	Noir mat
Light Gray	Gris clair
Light Olive Green	Gris vert
Yellow	Jaune
Flat White	Blanc mat
Gray	Gris
Gunmetal	Bronze
Steel	Acier
Flesh	Chair
Tan	Havane
Light Blue	Bleu clair

If you have any questions or comments, call our hotline at: **(800) 833-3570**
or, please write to:

Revell Inc Consumer Service Department, 1850 Howard Street Unit A, Elk Grove Village, Illinois 60007

Be sure to include the plan number (85562400200), part number, description, your return address and phone number.

Visit our website: www.revell.com

1

FLOOR / COCKPIT ASSEMBLY

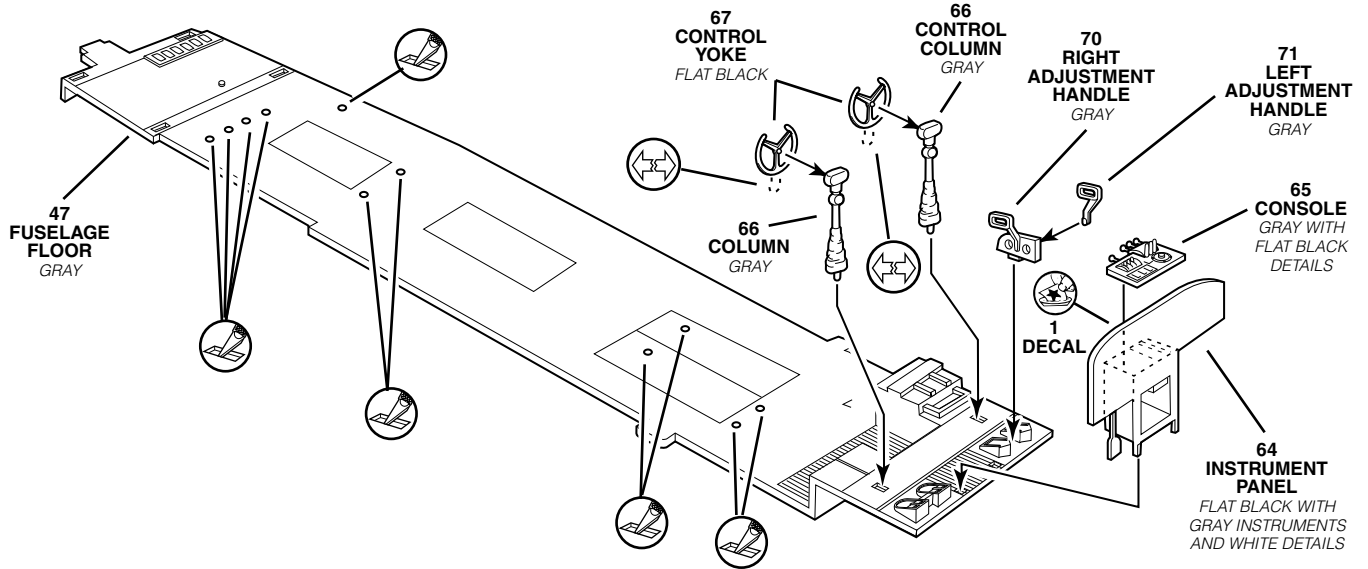

USE THE POINT OF A MODELING KNIFE TO OPEN UP ALL HOLES WHICH ARE INDICATED ON THE BOTTOM OF THE PART. THERE ARE A TOTAL OF ELEVEN HOLES TO BE OPENED.

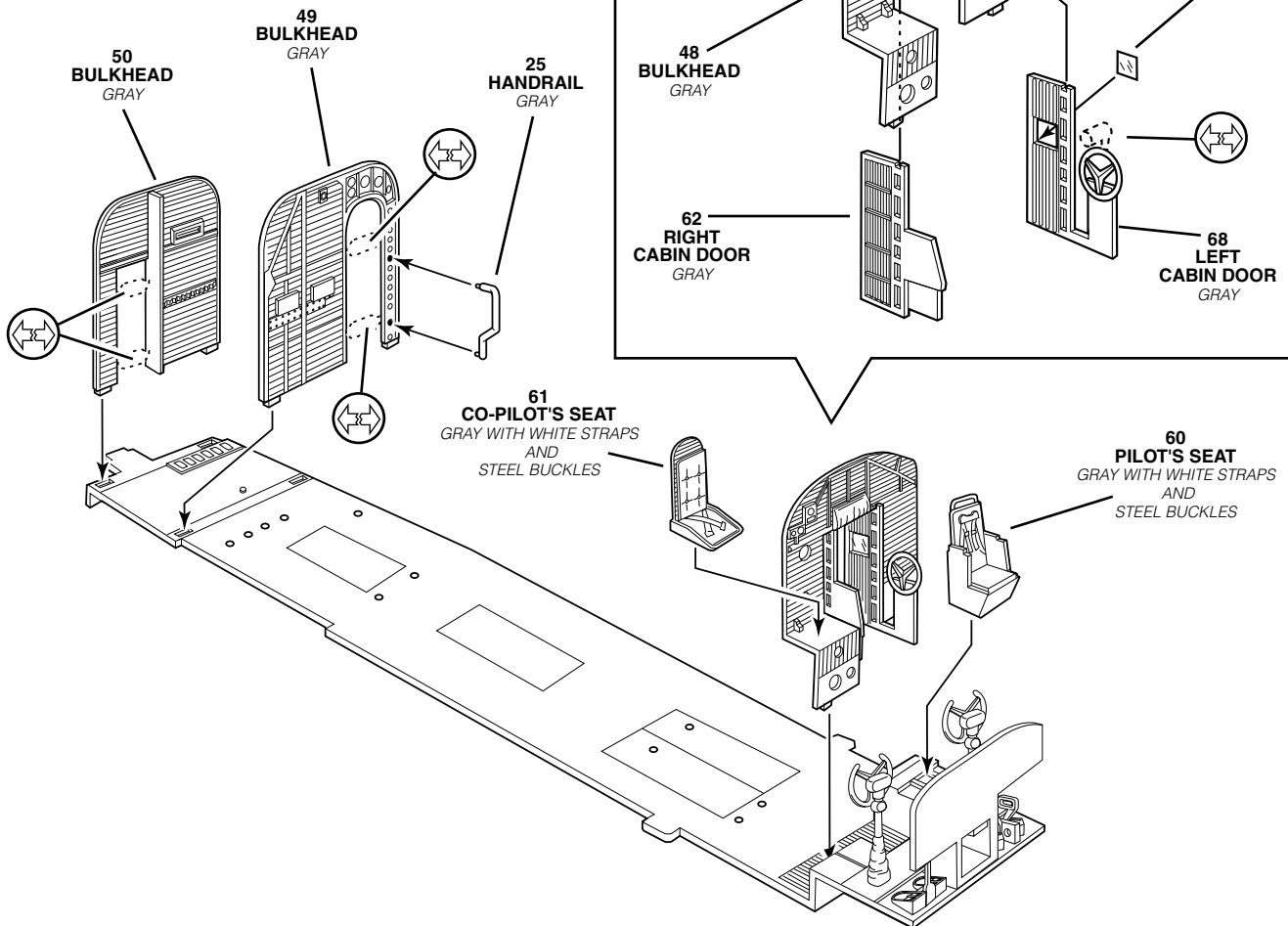
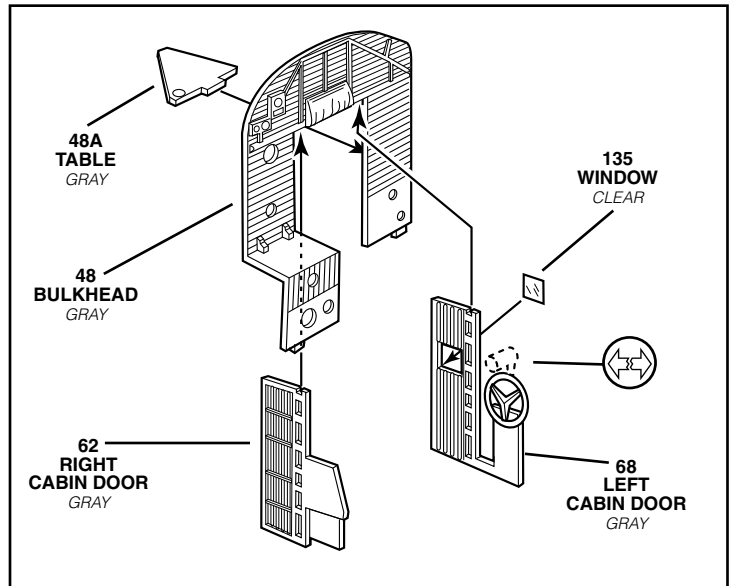

2

LEFT FUSELAGE ASSEMBLY

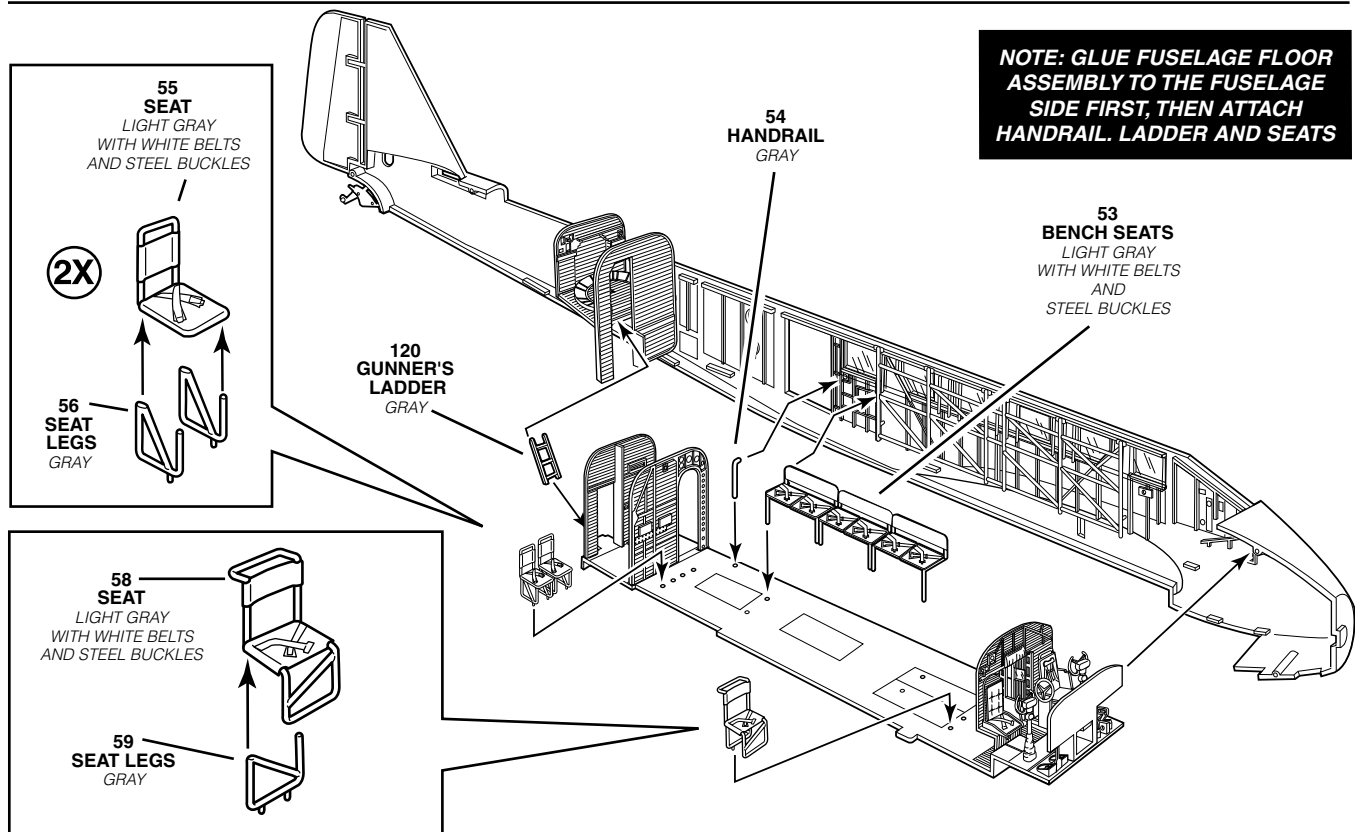
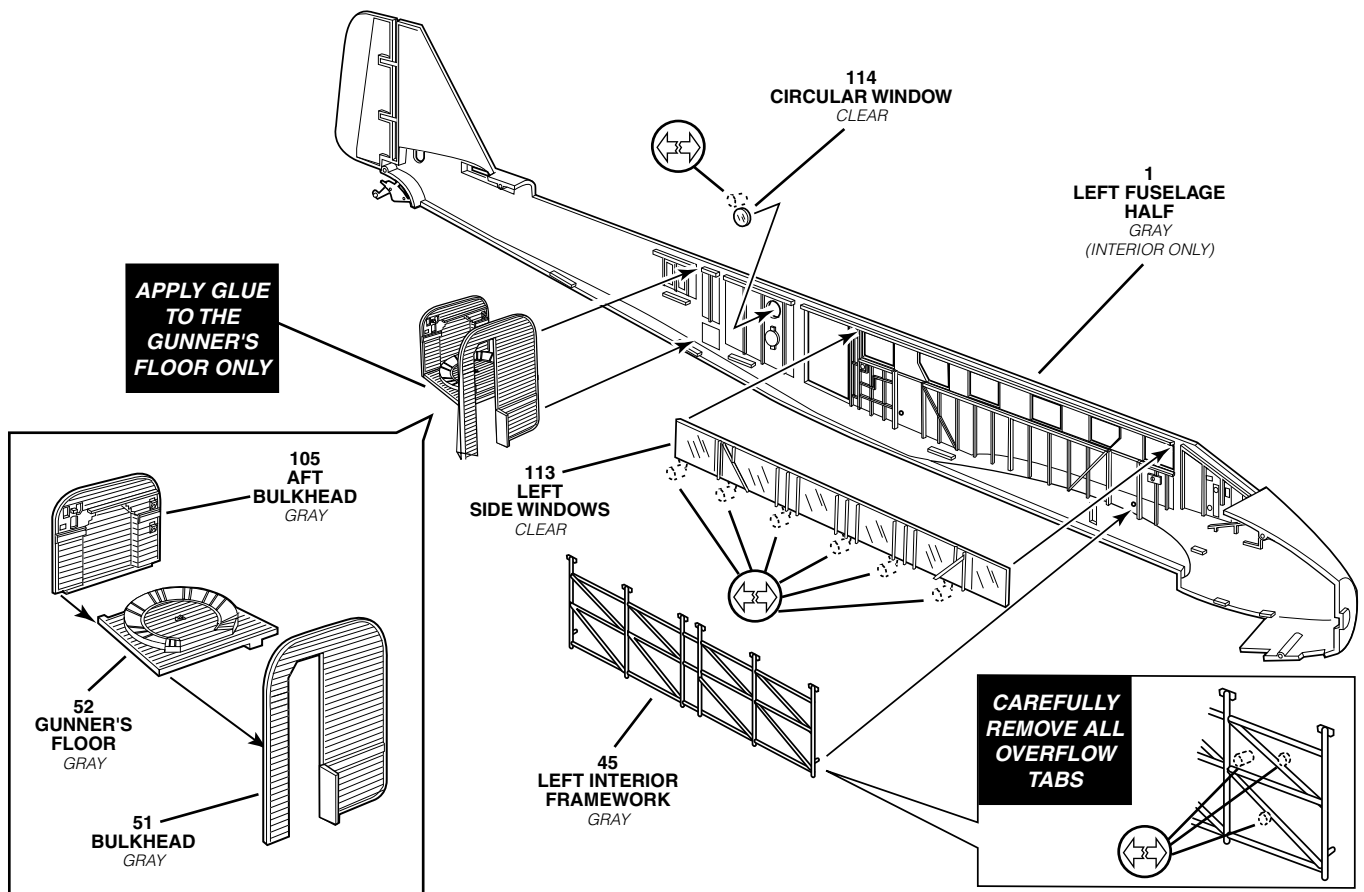

3

RIGHT FUSELAGE SIDE ASSEMBLY

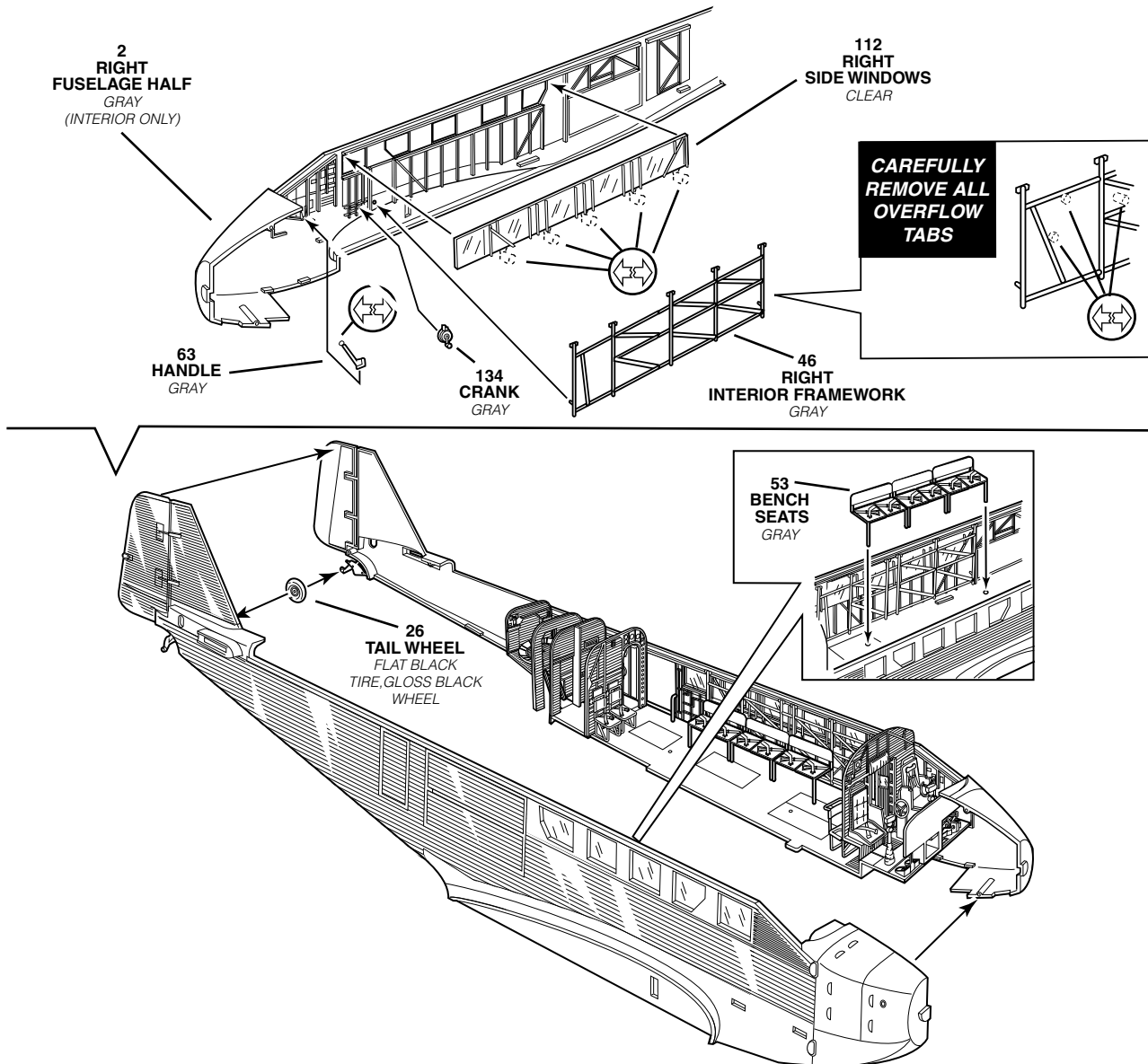

4

FUSELAGE BOTTOM

NOTE:
OPEN UP THE HOLES IN THE FUSELAGE BOTTOM FOR THE MILITARY AND AMBULANCE VERSIONS AS INDICATED IN THIS DRAWING. OPEN UP THE TWO PANELS AS INDICATED FOR THE MILITARY VERSION ONLY.

SEE STEPS #9 AND #10 FOR OPTIONAL LANDING GEAR ASSEMBLIES

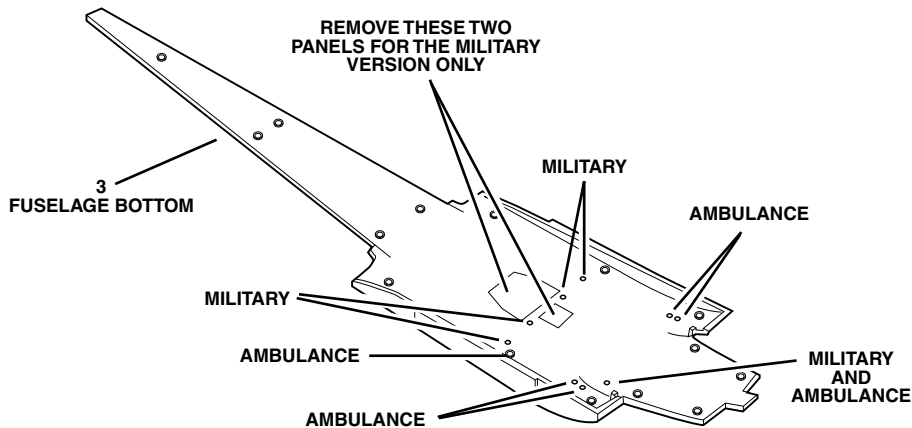

5

FUSELAGE BOTTOM ASSEMBLY

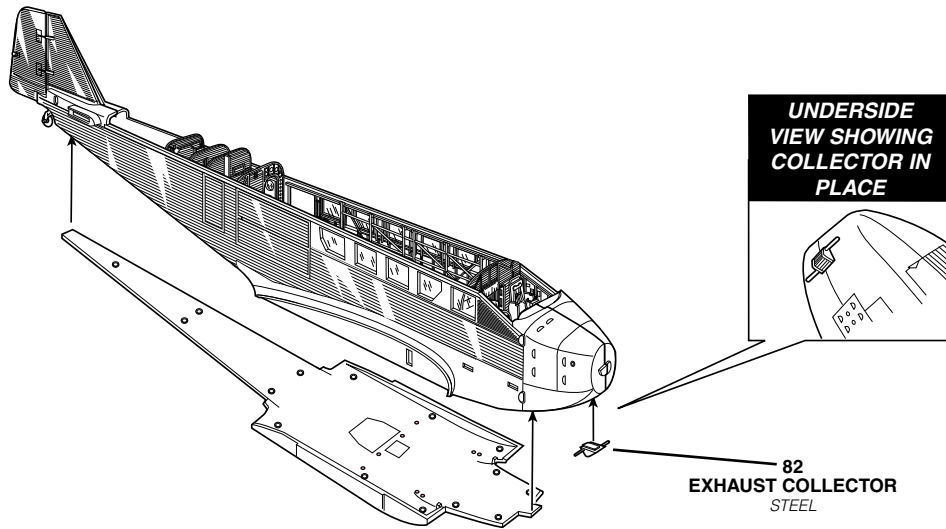

6

FUSELAGE TOP ASSEMBLY

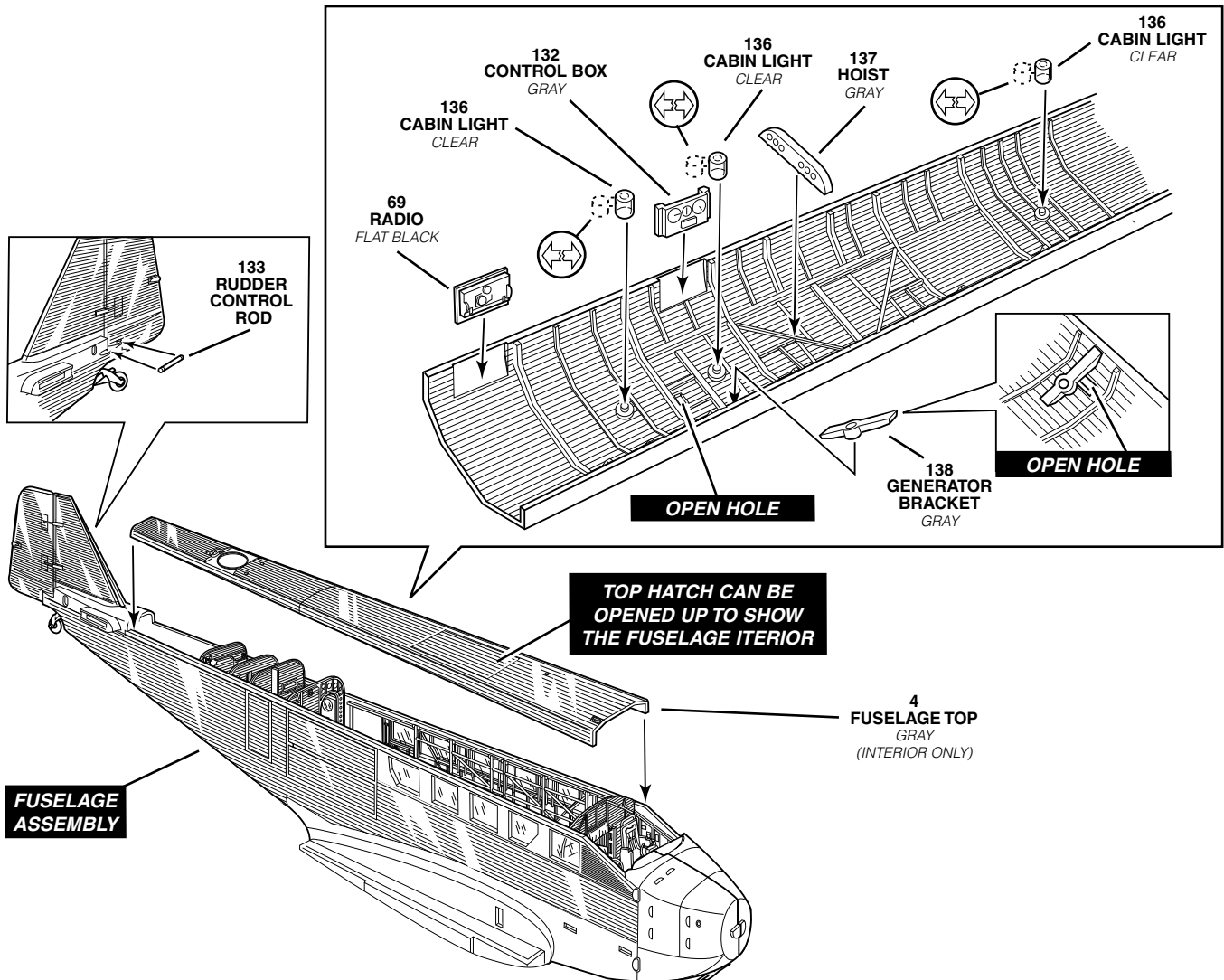

7

WING ASSEMBLY

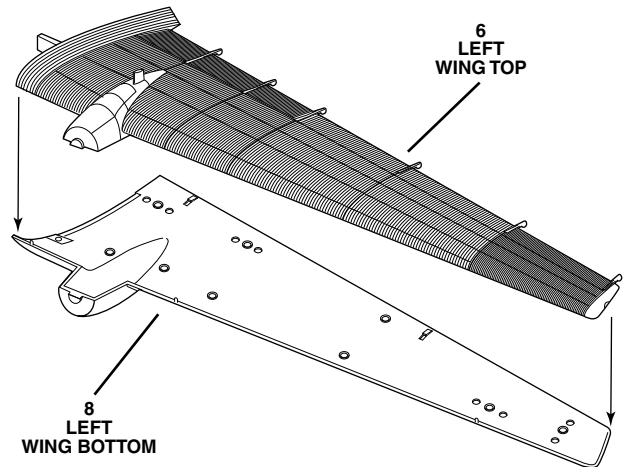
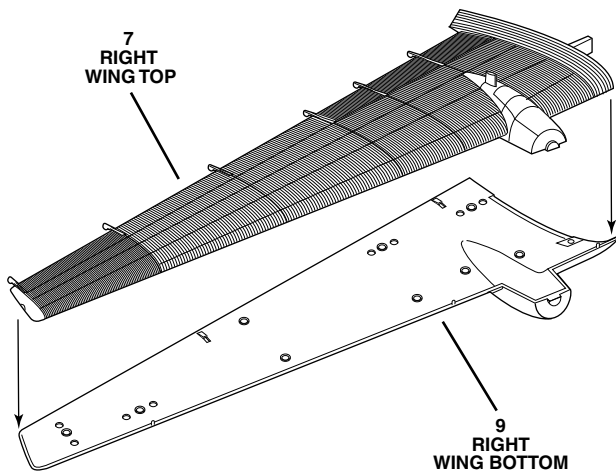

WINGS TO FUSELAGE

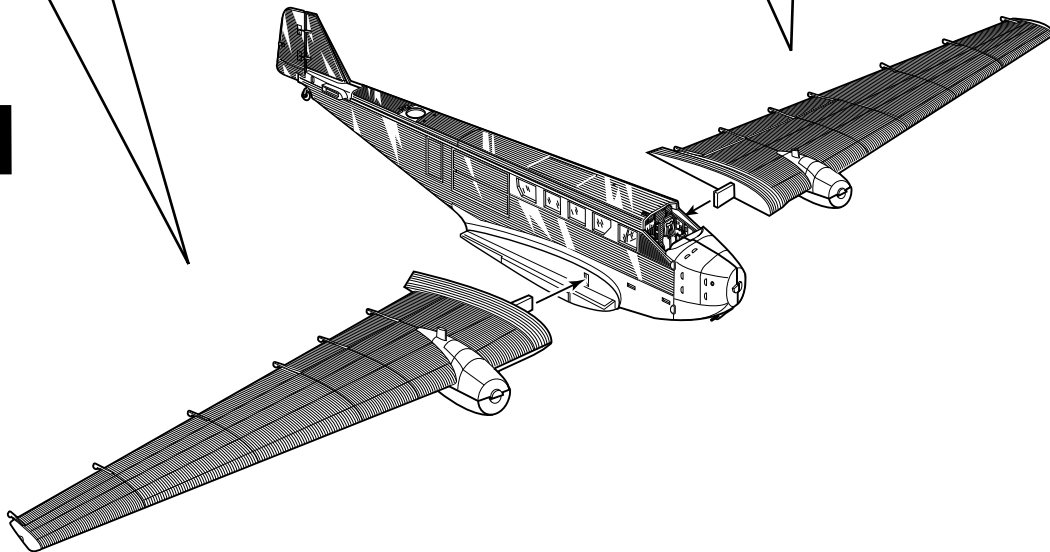

8

STABLIZER ASSEMBLY

LEFT

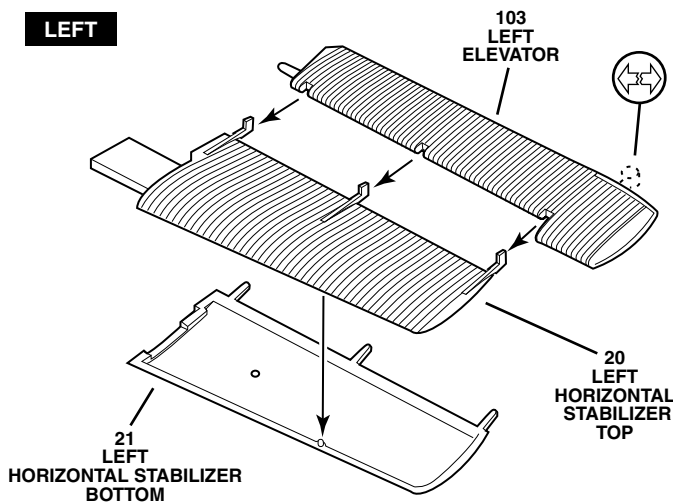

RIGHT

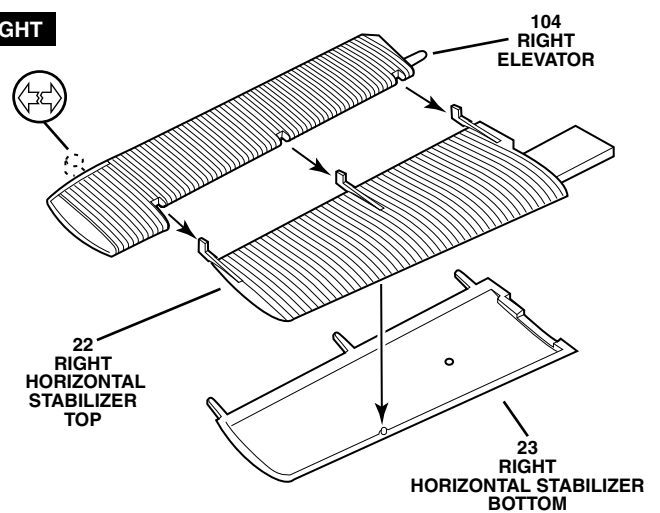

8

STABLIZER ASSEMBLY CONTINUED

LEFT

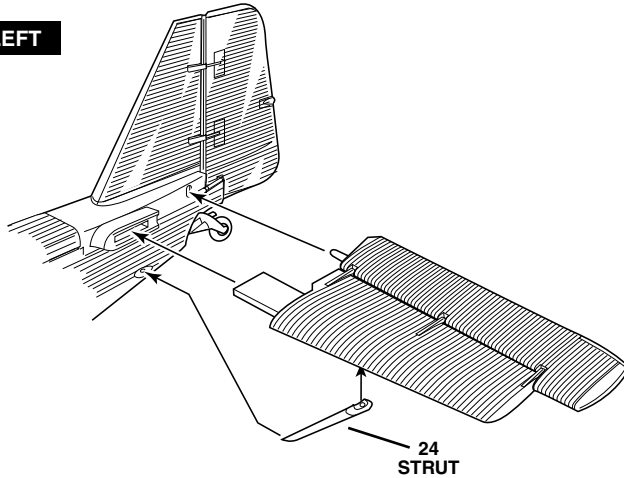

RIGHT

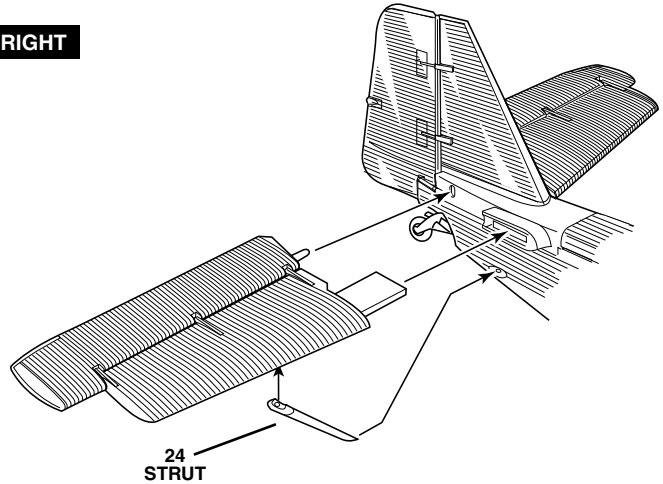

9

MILITARY LANDING GEAR ASSEMBLY

LEFT

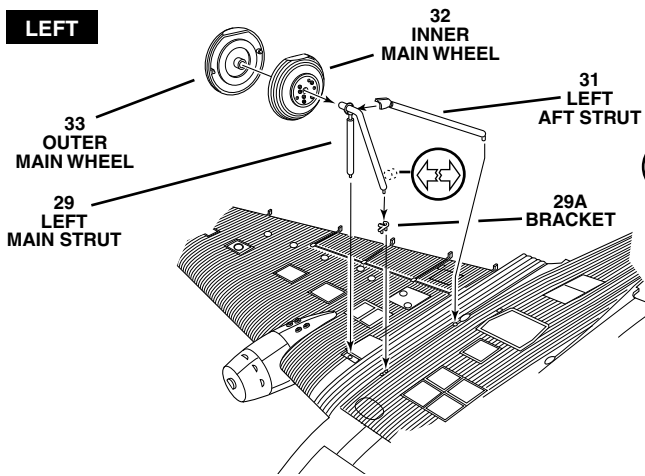

RIGHT

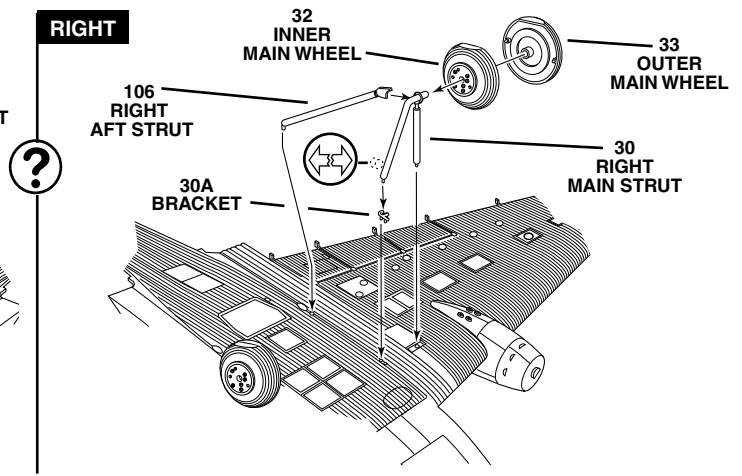

10

AMBULANCE LANDING GEAR ASSEMBLY

LEFT

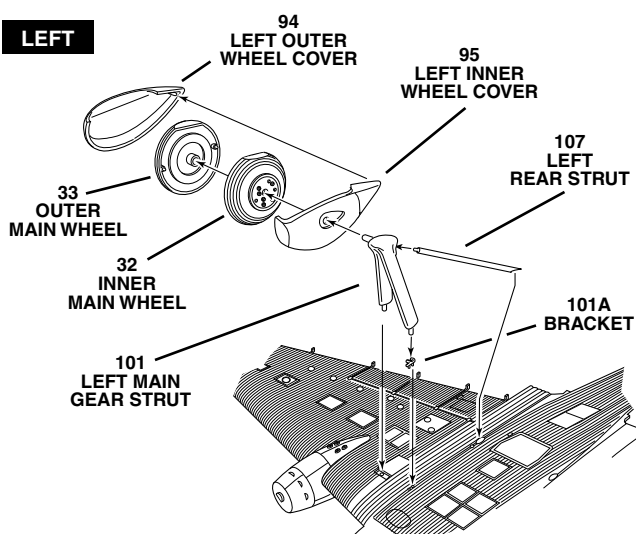

RIGHT

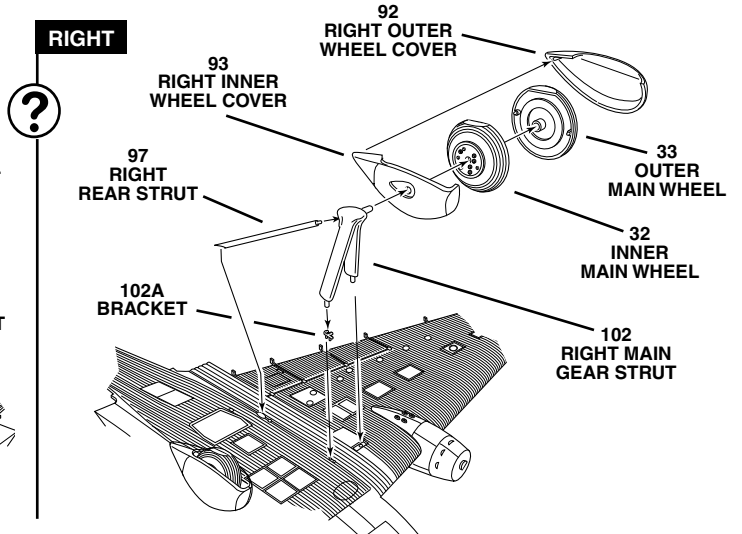

11 MILITARY VERSION DUST BIN ASSEMBLY

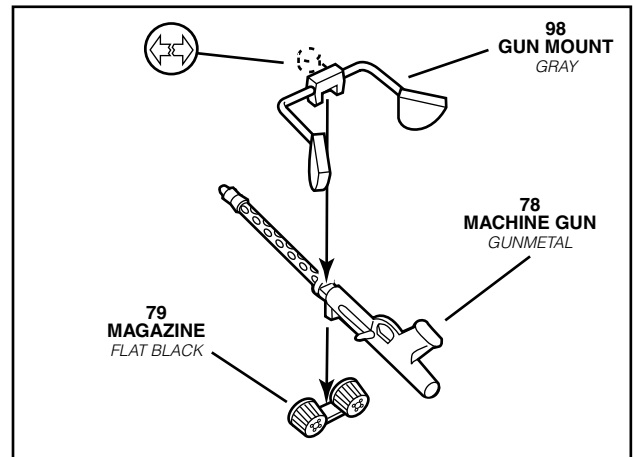
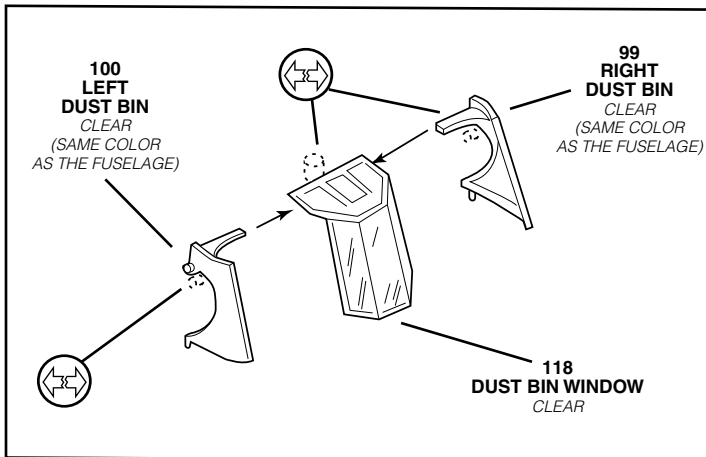

RETRACTED POSITION

EXTENDED POSITION

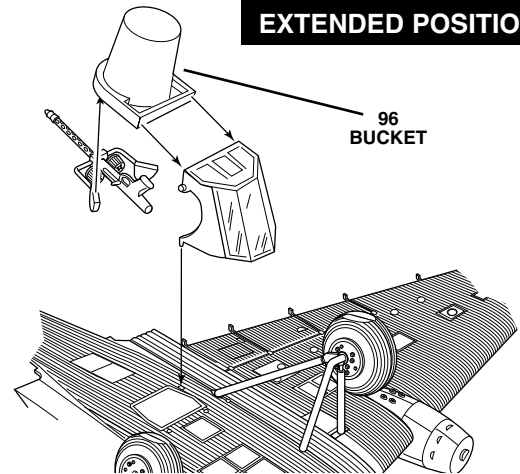
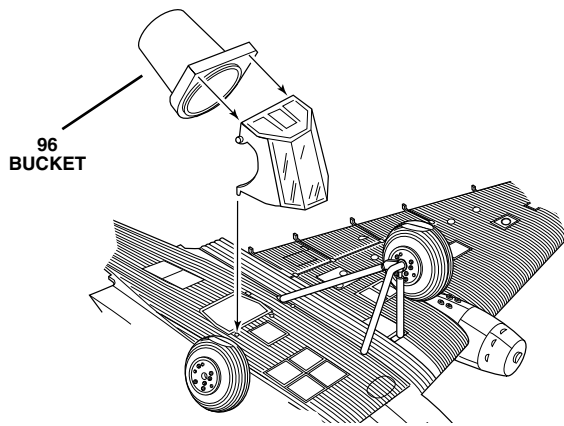

12 RIGHT ENGINE ASSEMBLY

MARK THESE LOCATIONS ON THE BACK SIDE OF THE CYLINDERS BEFORE ASSEMBLING THE ENGINE.

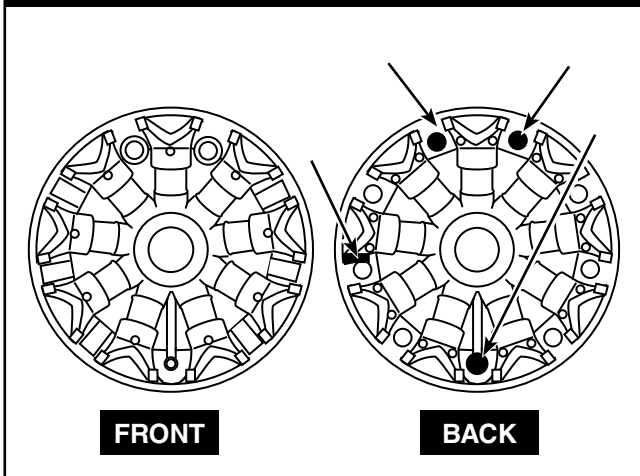

NOTE: THE OPEN SPACE ON THE COVER FITS TO THE BOTTOM OF THE CYLINDERS.

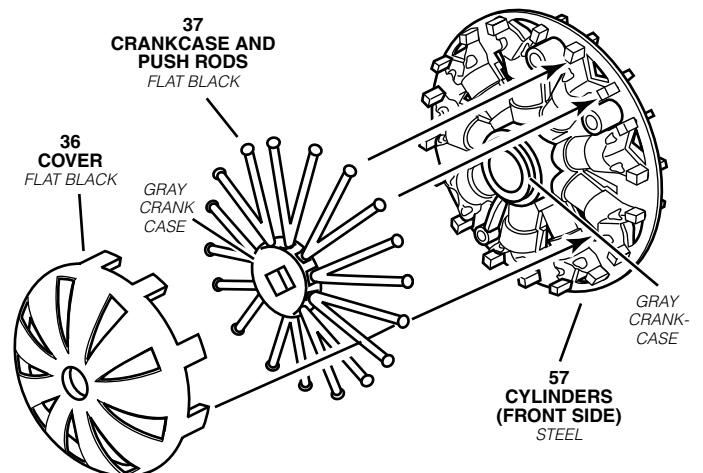

12

RIGHT ENGINE ASSEMBLY CONTINUED

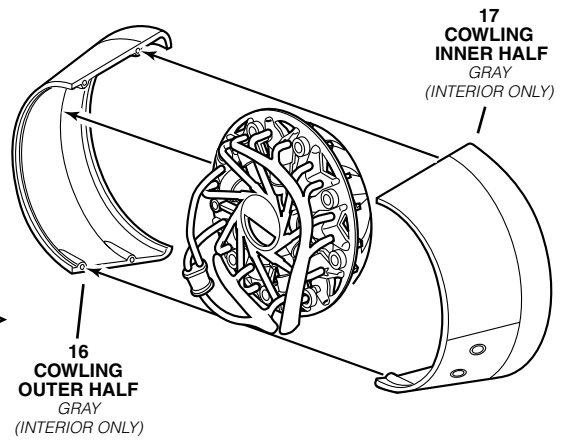
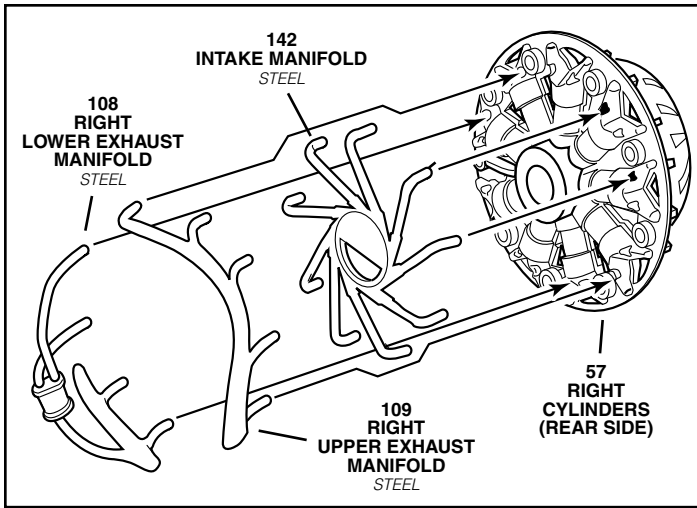

13

LEFT ENGINE ASSEMBLY

MARK THESE LOCATIONS ON THE BACK SIDE OF THE CYLINDERS BEFORE ASSEMBLING THE ENGINE.

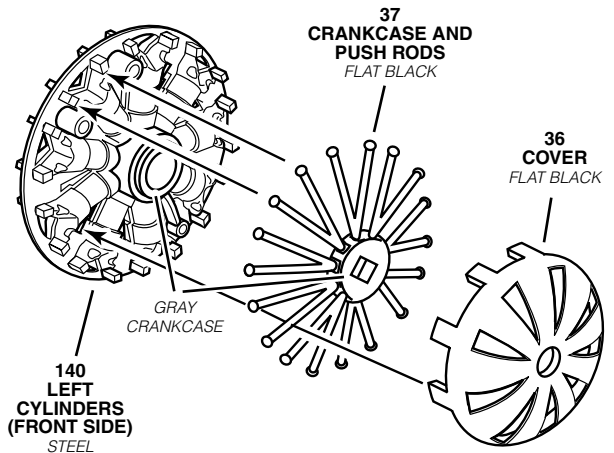
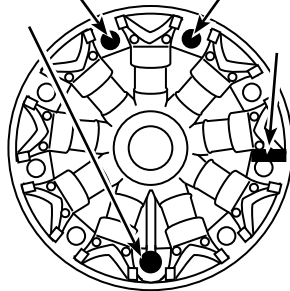
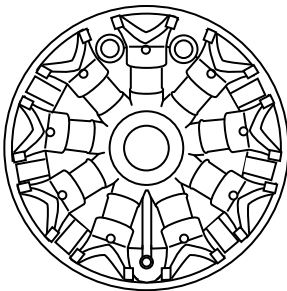

NOTE: THE OPEN SPACE ON THE COVER FITS TO THE BOTTOM OF THE CYLINDERS.

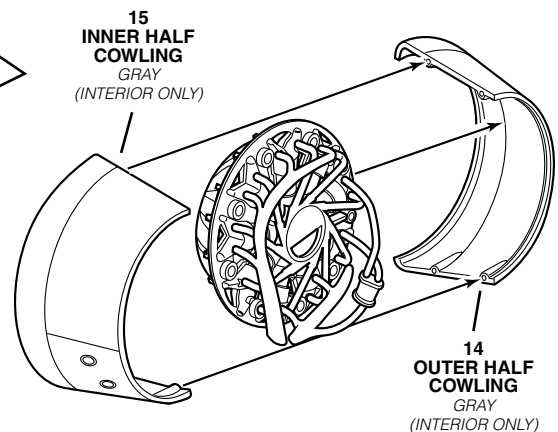
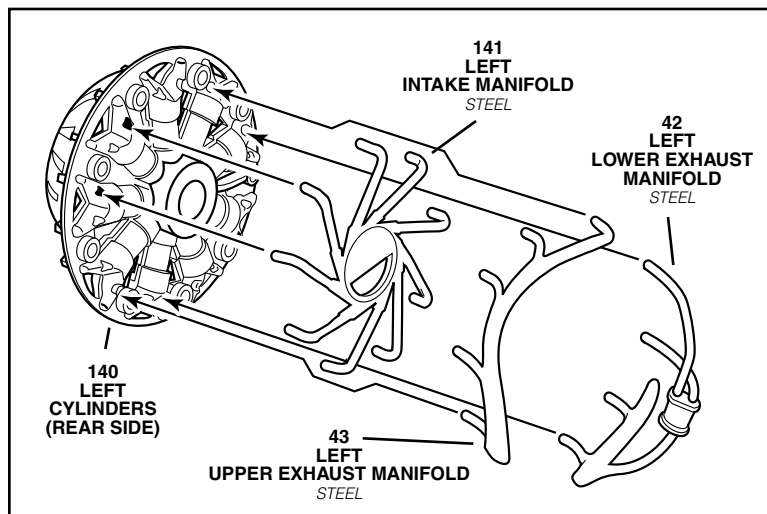

14

ENGINES TO WING ASSEMBLY

RIGHT

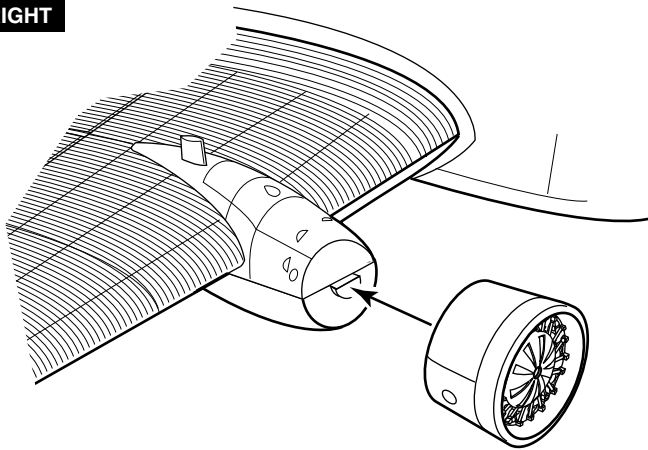

LEFT

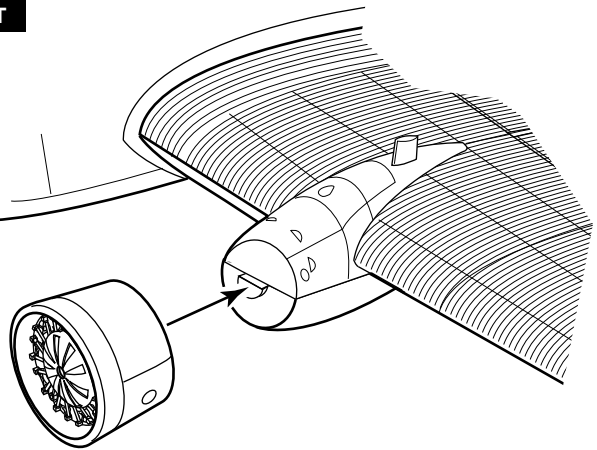

15

CENTER ENGINE ASSEMBLY

MARK THESE LOCATIONS ON THE BACK SIDE OF THE CYLINDERS BEFORE ASSEMBLING THE ENGINE.

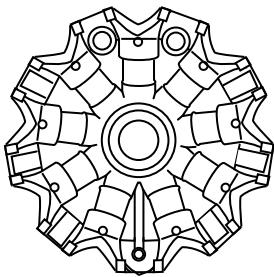

FRONT

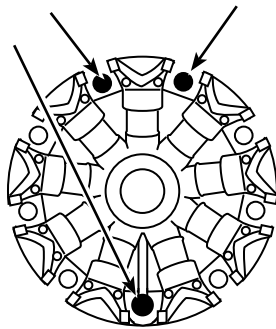

BACK

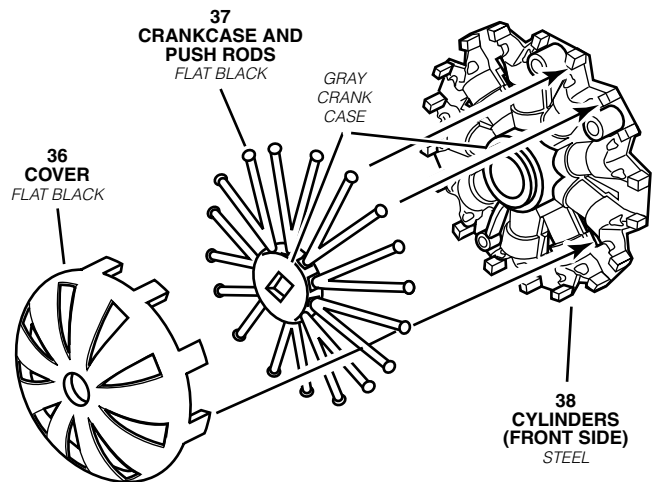

NOTE: THE OPEN SPACE ON THE COVER FITS TO THE BOTTOM OF THE CYLINDERS.

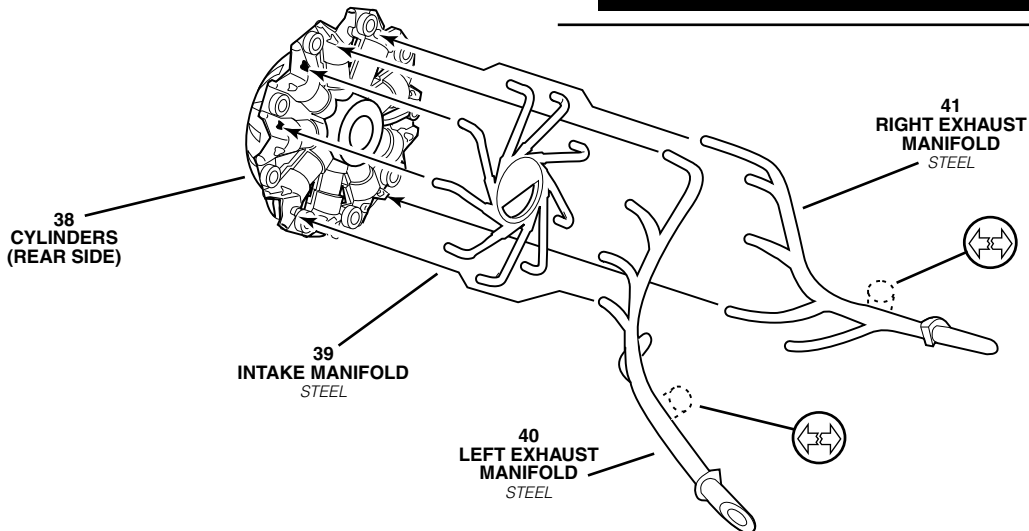

15 CENTER ENGINE ASSEMBLY CONTINUED

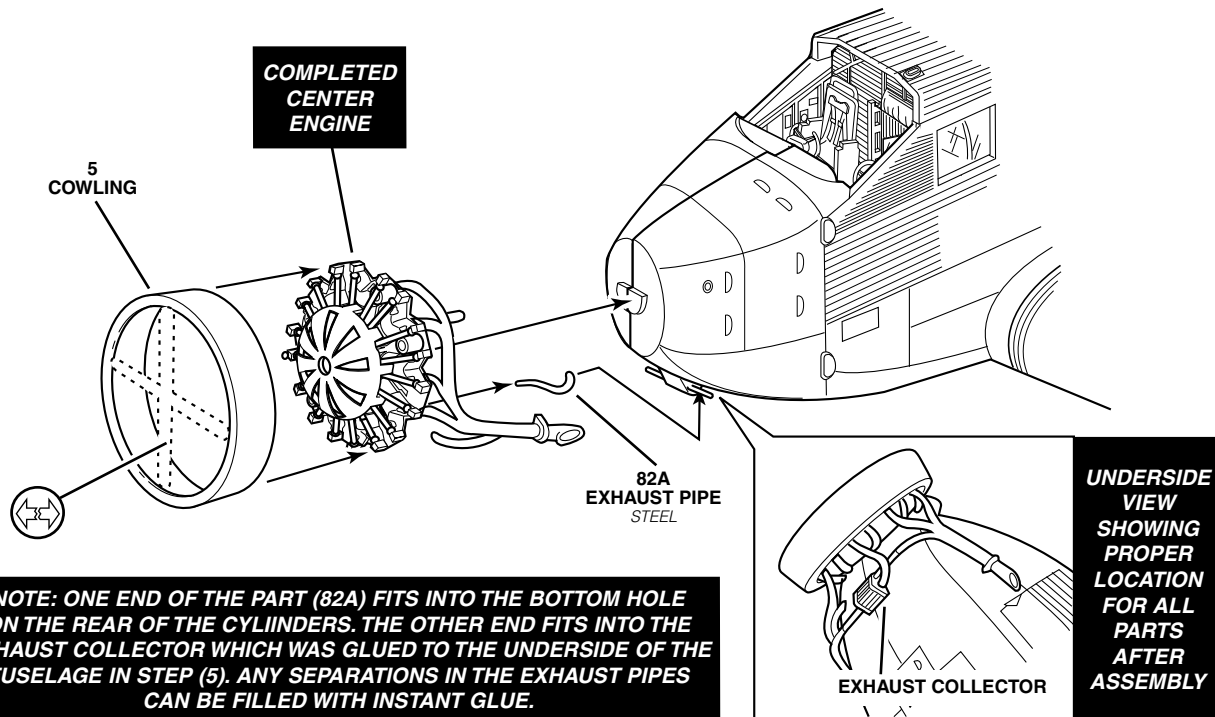

16 UNDERSIDE ASSEMBLY

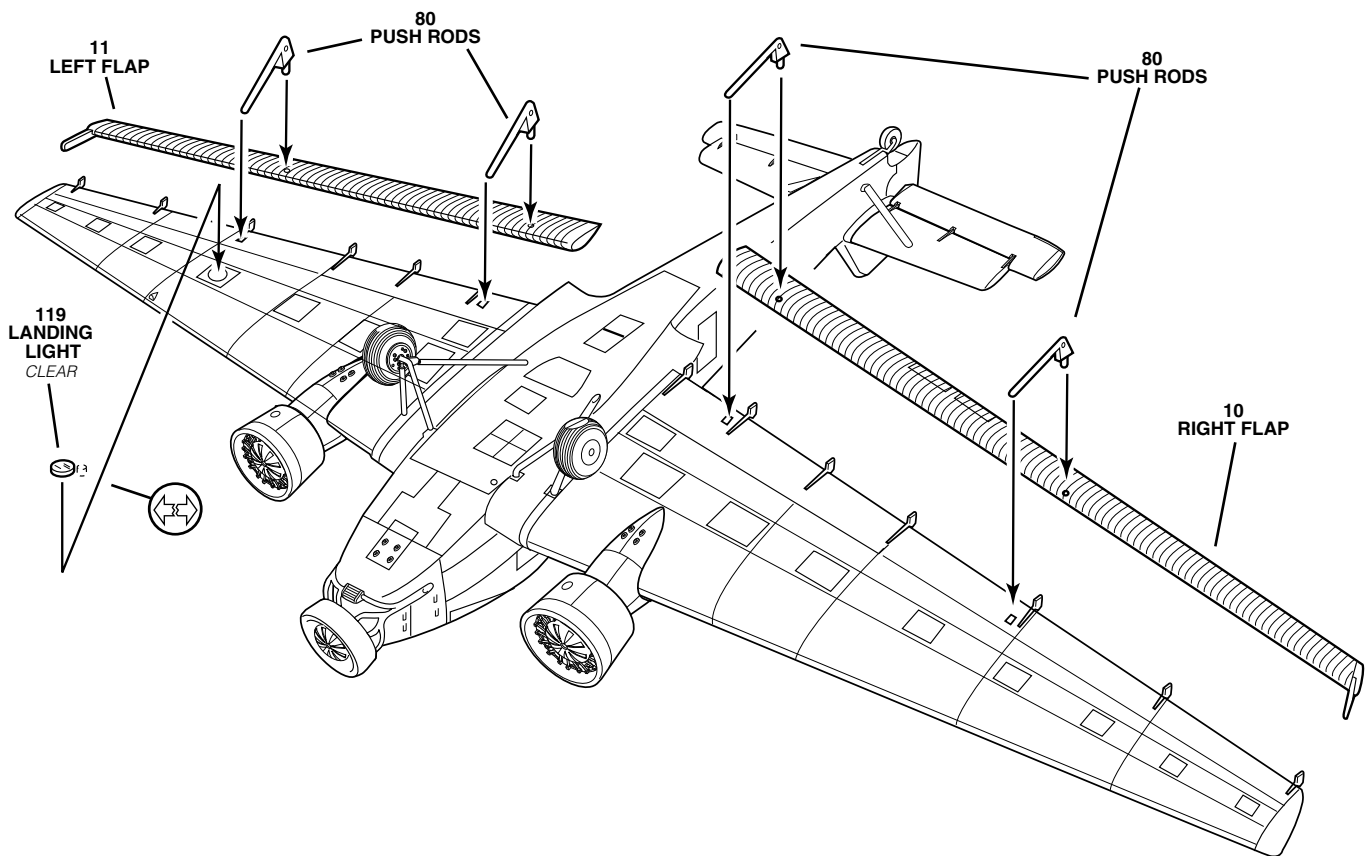

16

UNDERSIDE ASSEMBLY CONTINUED

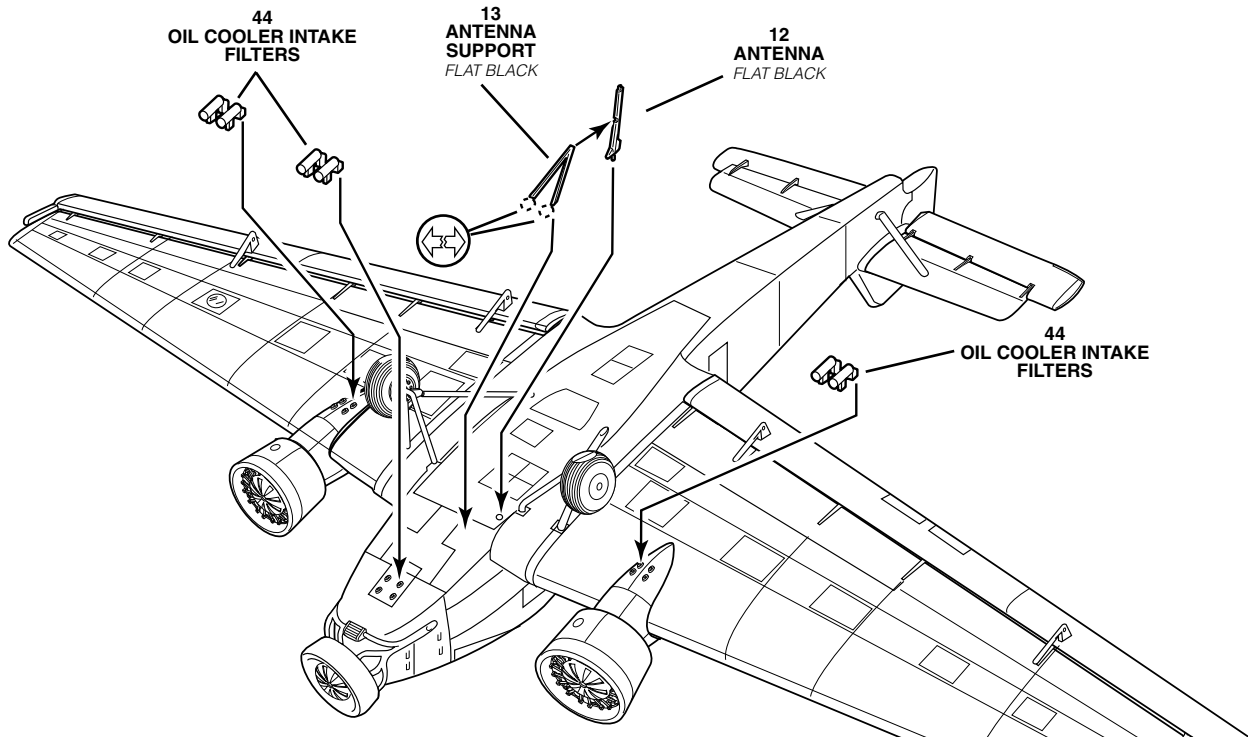

17

TOPSIDE ASSEMBLY

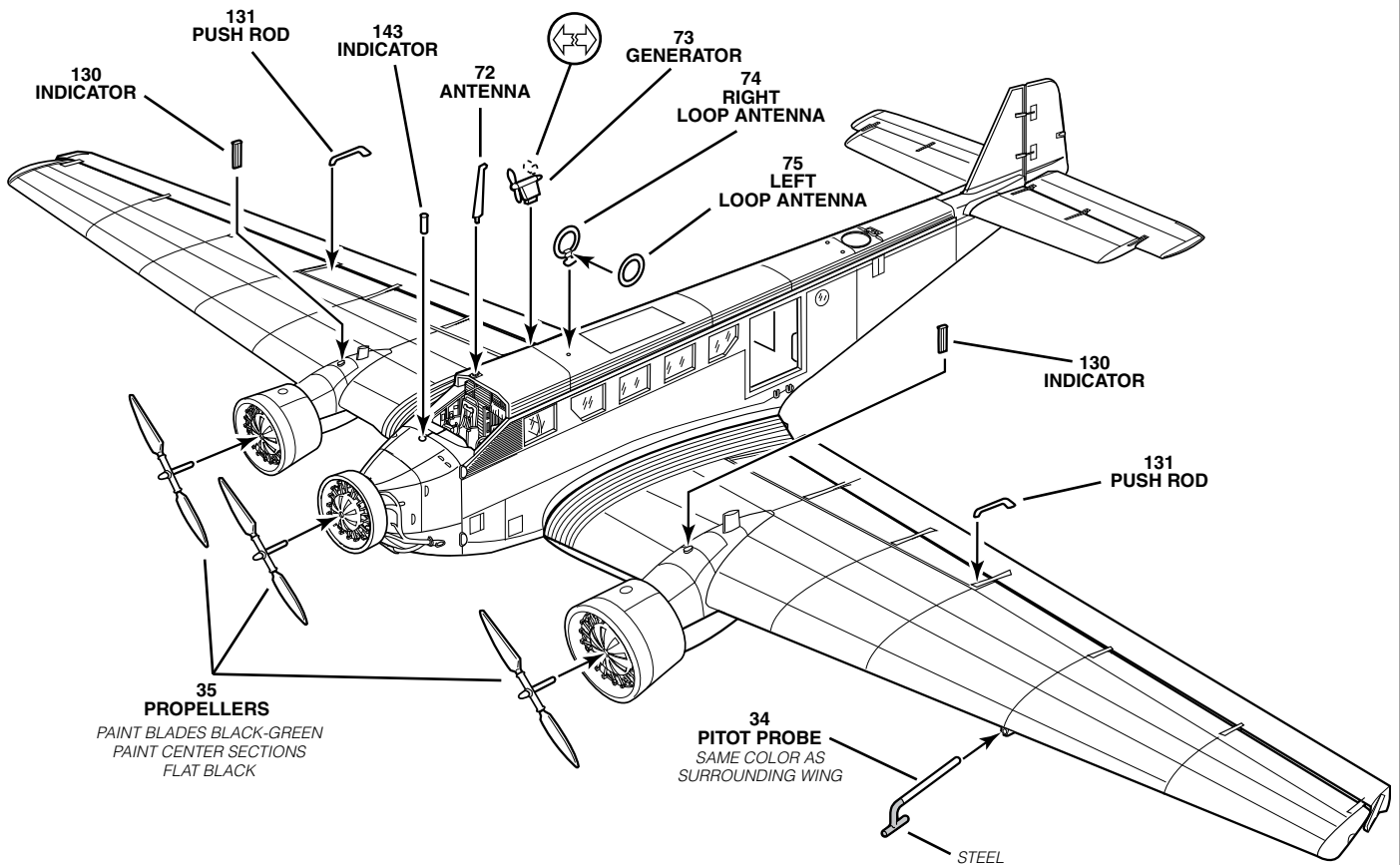

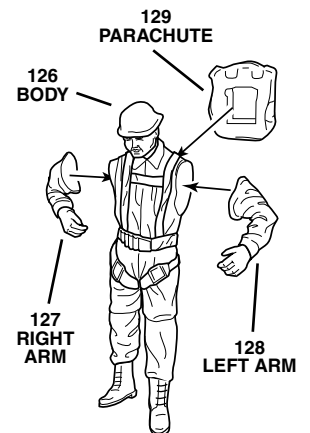
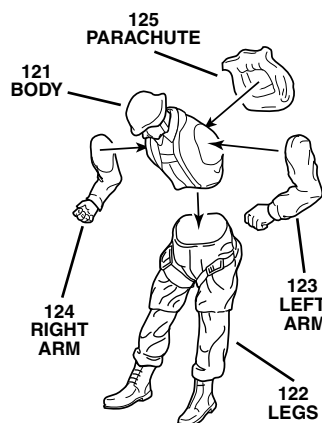
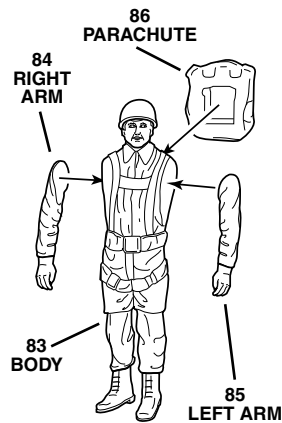
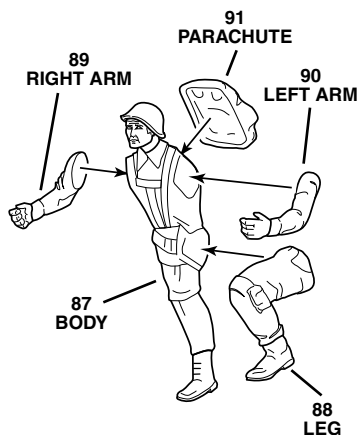
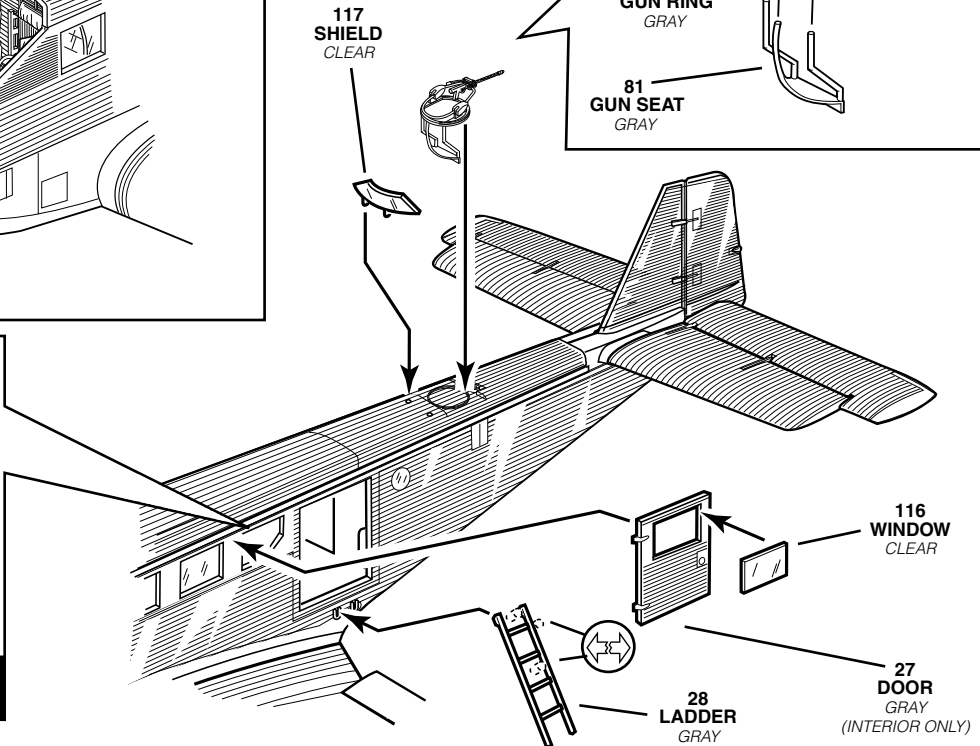
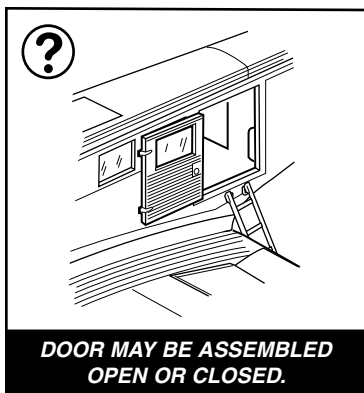
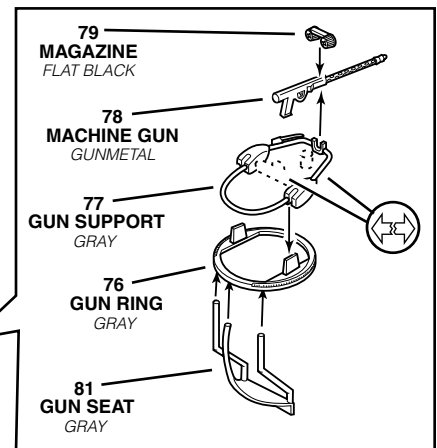
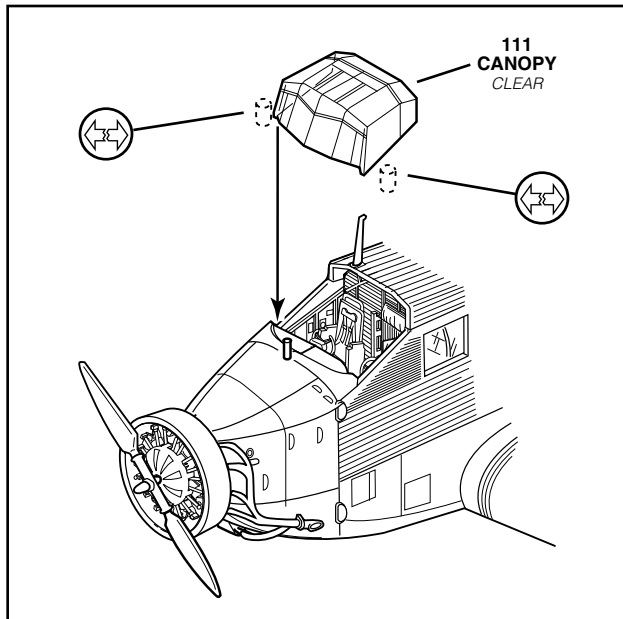

THE GERMAN PARATROOPER UNIFORM INCLUDED A TAN PULLOVER WITH MEDIUM GRAY PANTS AND BLACK BOOTS. THE HELMETS WERE A STEEL GRAY, AND THE PARACHUTE PACKS WERE USUALLY NEUTRAL OR LIGHT GRAY WITH FLAT WHITE STRAPS AND STEEL BUCKLES. THE FACES AND HANDS SHOULD BE PAINTED A FLESH COLOR.

DECAL PLACEMENT

JUNKERS Ju 52/3m AMBULANCE, POLAND, 1940

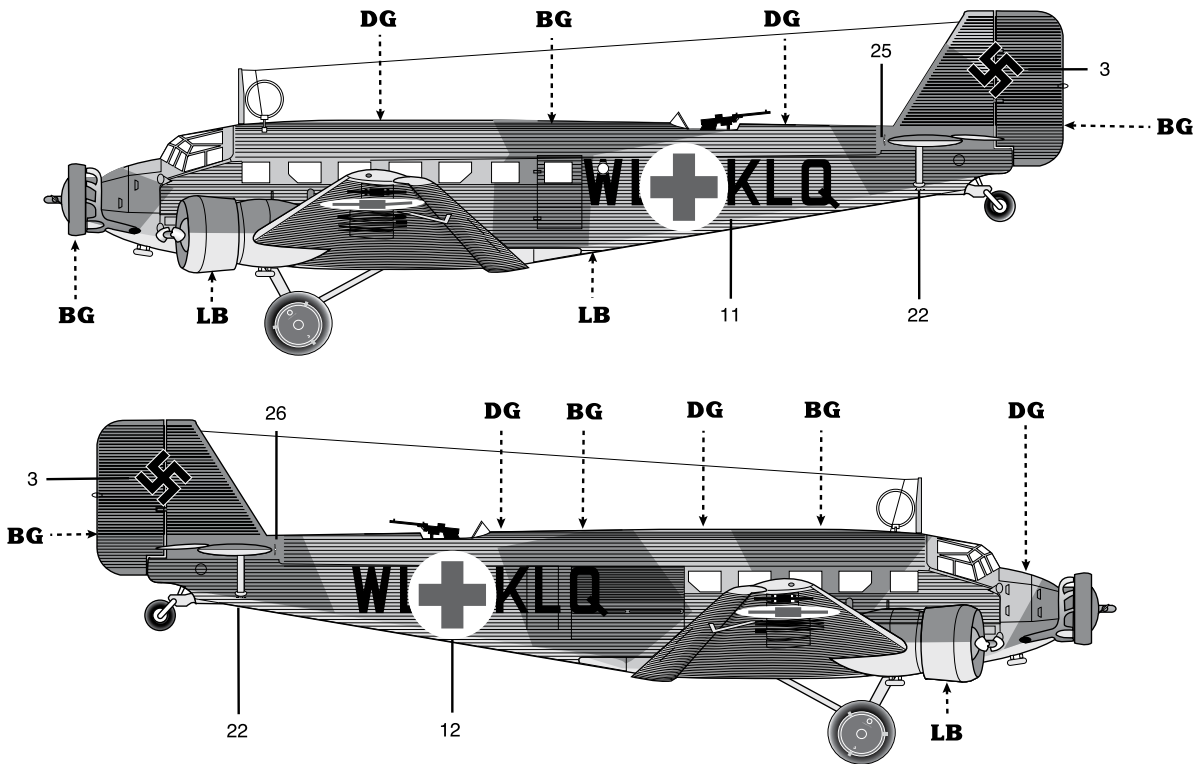

JUNKERS Ju 52/3m IV GRUPPE, KGzb VI, BALKANS, 1942

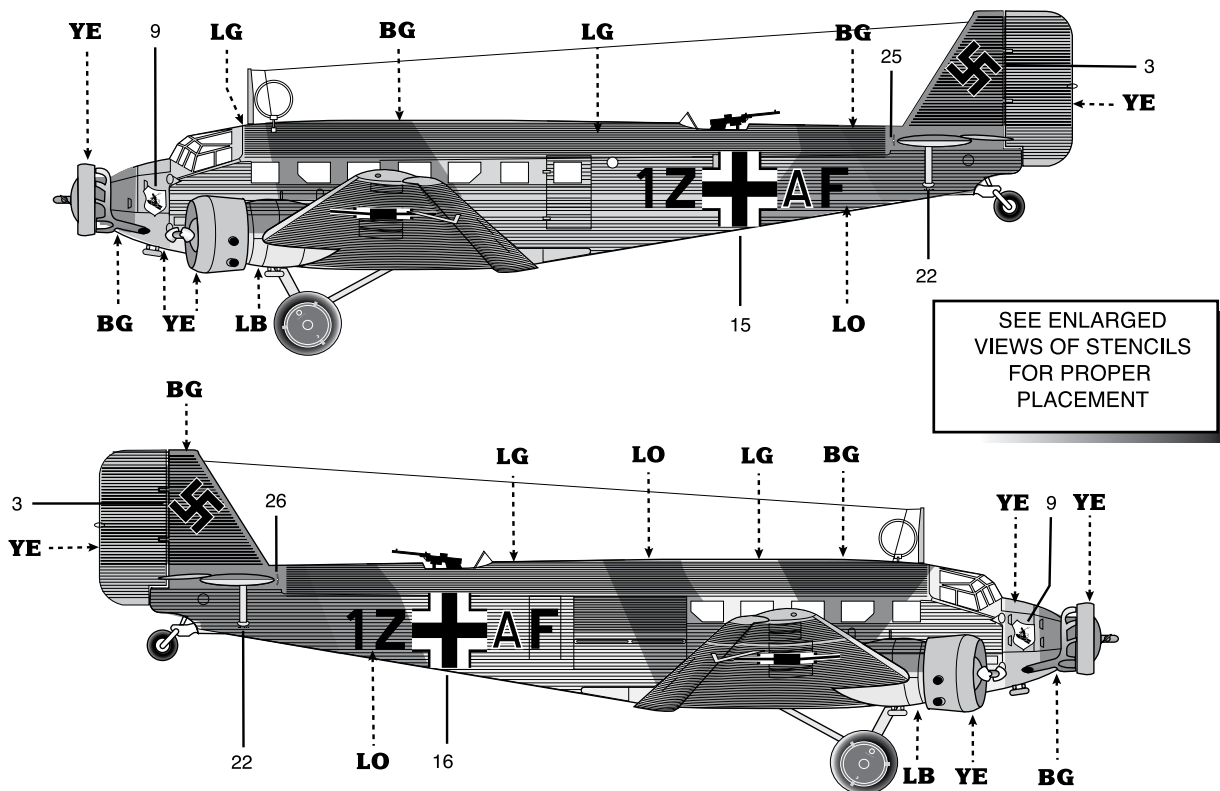







SEE ENLARGED VIEWS OF STENCILS FOR PROPER PLACEMENT

DECAL PLACEMENT

JUNKERS Ju 52/3m AMBULANCE, POLAND, 1940

PAINT COLORS

Color note: These camouflage colors have been altered to allow the patterns to be better defined. Actual camouflage paint colors are very similar to each other and difficult to define in many cases.

LB	 Lt. Blue Hellblau RLM 65	LG	 Lt. Gray RLM 77
BG	 Black. Green Schwarzgrun RLM 70	LO	 Lt. Olive Green Hellolivegrun 68
DG	 Dk. Green Dunklegrun RLM 71	YE	 Yellow Gelb RLM 27

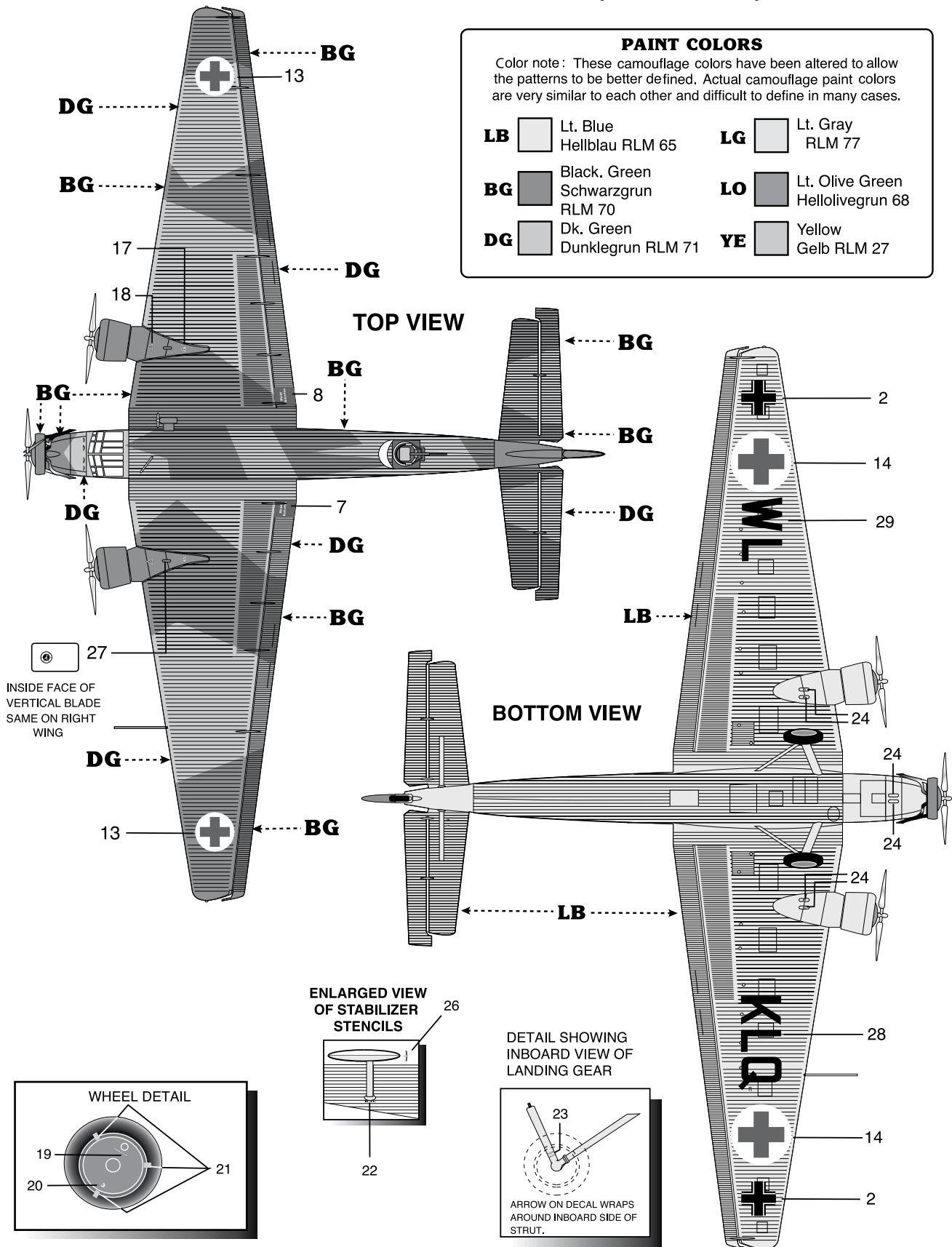

JUNKERS Ju 52/3m IV GRUPPE, KGzb VI, BALKANS, 1942

