

Pz.Kpfw.I Ausf.B

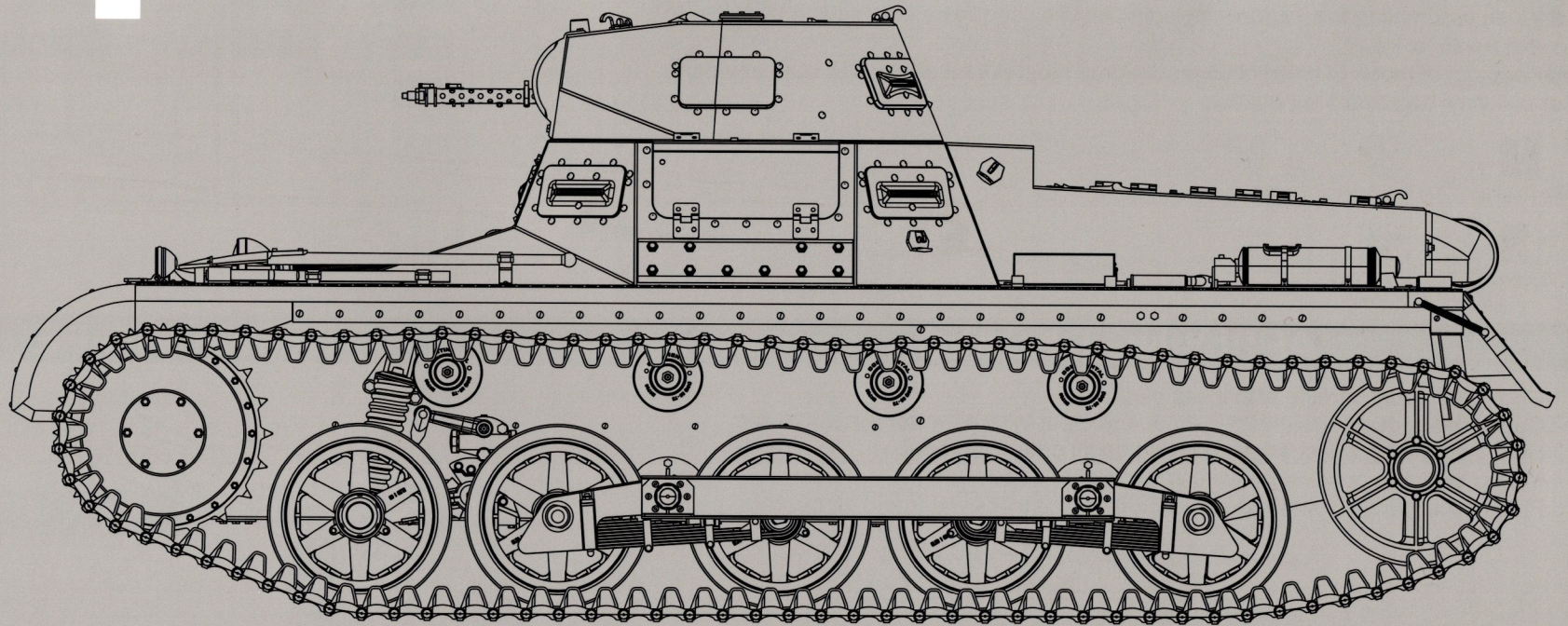

In 1930, Krupp was selected by Waffenpruefwesen 6 (the automotive and tank design office of the German army) to work on the design of a small light tracked tractor named Kleintraktor. It was to be equipped with a 20 mm (0.79 in) auto-cannon, powered by a 60 hp engine and weigh no more than 3000 kg. A year later, in 1931, Krupp sent a description of the Kleintraktor-Fahrgestell (chassis) to Wa.Prw.6. The Krupp Kleintraktor was described as a fast and maneuverable tracked vehicle that weighed about 3.5 tons and could achieve 45 km/h (28 mph). The hull of the tank was made of welded steel plates, it was armed with a 20 mm (0.79 in) auto-cannon and carried 500 rounds.

As development proceeded, several prototypes were made, with some flaws being removed from the tank. The turret was redesigned to fit 2 machine guns and armor protection was increased. In 1933, the Panzer I was considered ready and an order was placed for 150 training tanks, with another 1000 combat-ready tanks being ordered the following year. Neither of these orders were fully delivered.

The Panzerkampfwagen I Ausf.A went into production in late 1934 and continued until early 1936. Around 800 examples were built, having several limitations. The armour was insufficient, being only 13 mm (0.51 in) at its thickest. There were problems with the early suspension, making the tank pitch backwards at high speeds. There were also concerns about the propulsion, overheating, the commander being both gunner and loader of the two machine guns, and communication going through old-fashioned vocal tubes. With its two machine guns, light armor and speed, these machines were nothing more than training and scout tanks. Despite this, most of them fought in regular Panzer divisions alongside the improved Ausf.B until late 1941.

Many of the flaws of the Ausf. A were addressed with the introduction of the Ausf. B. This variant first appeared in 1936 and was built until 1938, with around 675 machines produced. The main difference was a longer chassis (by 40 cm), requiring the addition of one more bogie wheel and improved suspension in order to accommodate the much improved water-cooled, six-cylinder Maybach NL 38 TR delivering 90 bhp, along with a new & improved transmission. The weight rose to 5.8 tons, but neither the armament nor armor were modified.

READ BEFORE ASSEMBLY

CAUTION

- Read carefully and fully understand the instructions before commencing assembly. A supervising adult should also read the instructions if a child assembles the model.
- When assembling this kit, tools including knives used. Extra care should be taken to avoid personal injury.
- Keep out of reach of small children. Children must not be allowed to suck any part, or pull vinyl bag over their heads.



Be Careful



Do Not Cement



Remove



Optional



Instant Glue
for Metal

PAINTS REQUIRED

Color info and profiles by Mig Jimenez

A.MIG-0033 Rubber & Tires

A.MIG-0035 Dark Tracks

A.MIG-0045 Gun Metal

A.MIG-0041 Dark Rust

A.MIG-0195 Silver

A.MIG-0008 RAL 7021 Olivgrun opt.1

A.MIG-0007 RAL 7017 Dunkelbraun

A.MIG-0038 Old Wood

A.MIG-0093 Crystal Red

APPLYING DECALS

1. Clean the model surface with a wet cloth.
2. Cut out each decal design from sheet, and dip it in tepid water for 15~20 sec.
3. Hold the backing sheet edge and slide decal onto the model.
4. Move decal into position by wetting decal with finger.
5. Press decal gently down with a soft cloth until excess water and air bubbles are gone.

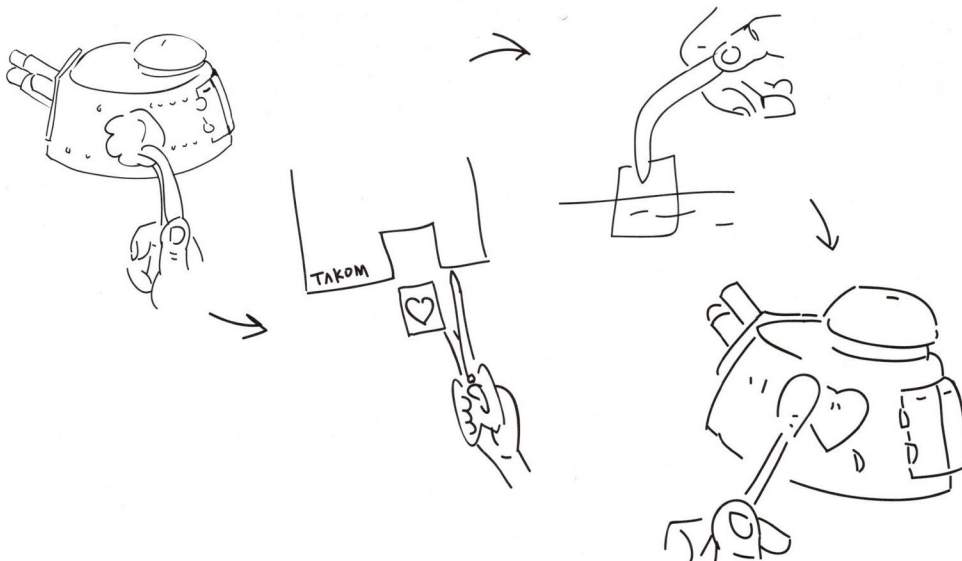

REMOVING PE

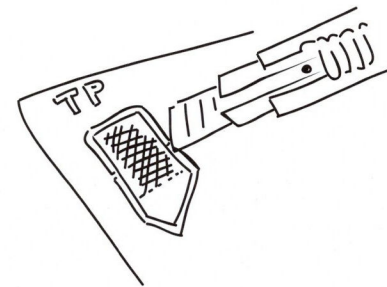

Be careful not to hurt when removing PE parts.

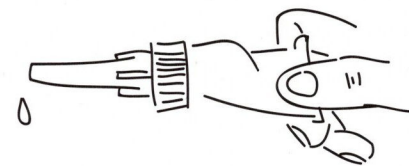

Secure using instant glue (not included).

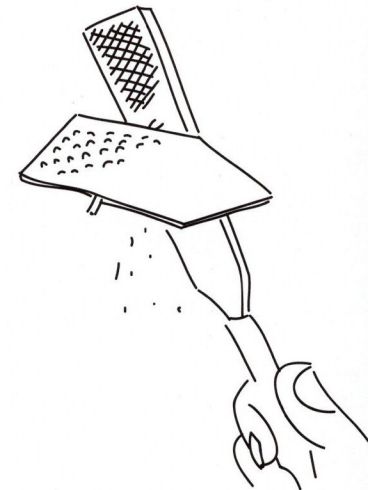

Finish using file.

PARTS

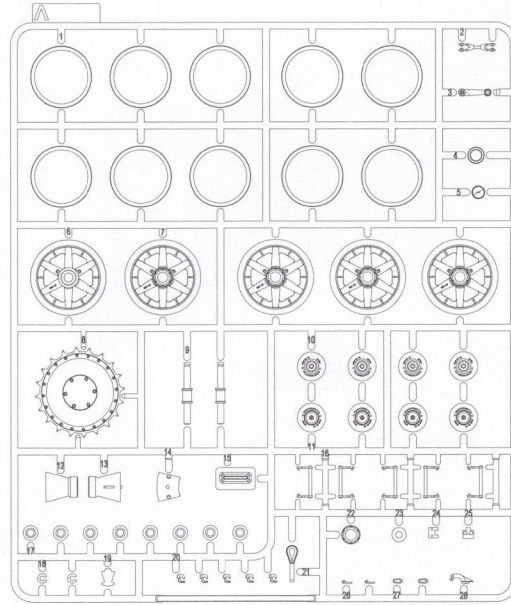
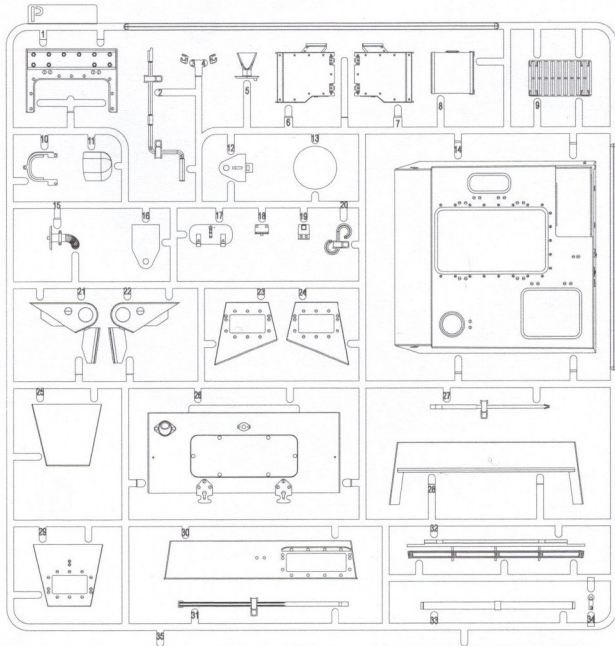

X2

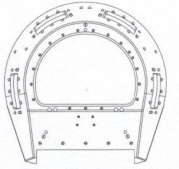
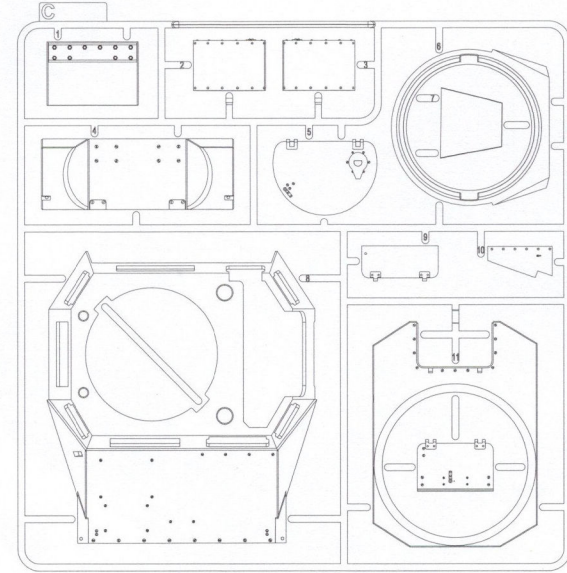

Turret



H X20

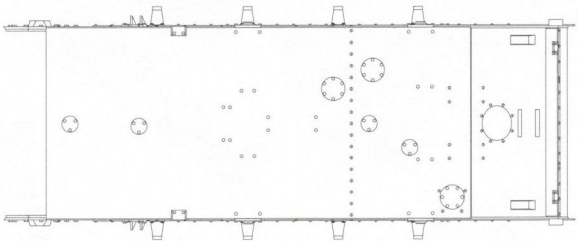
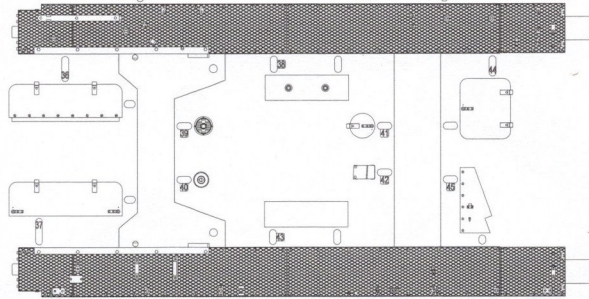

Lower Hull

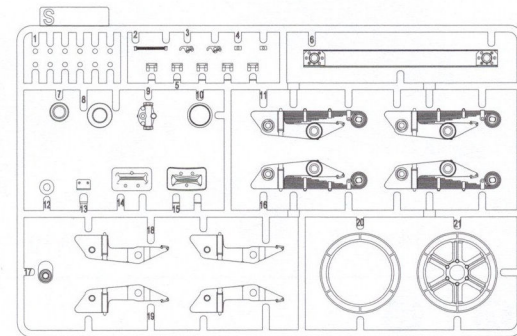
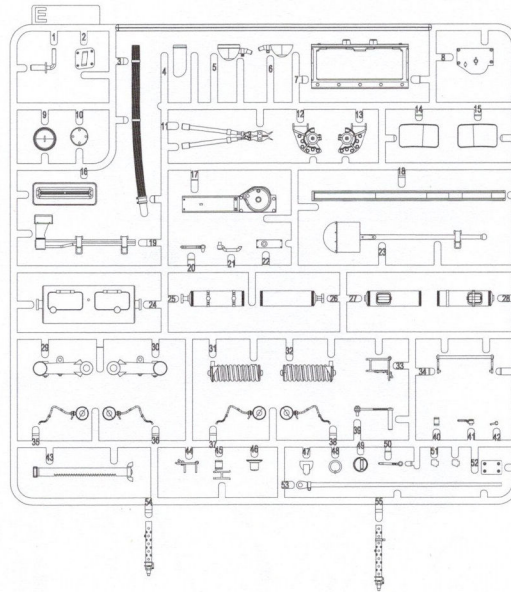

X2

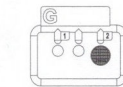

J X10

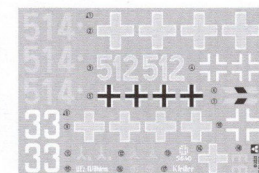
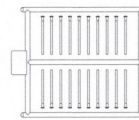

Decal



Cable



TP

1

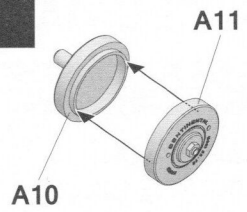

Make 4

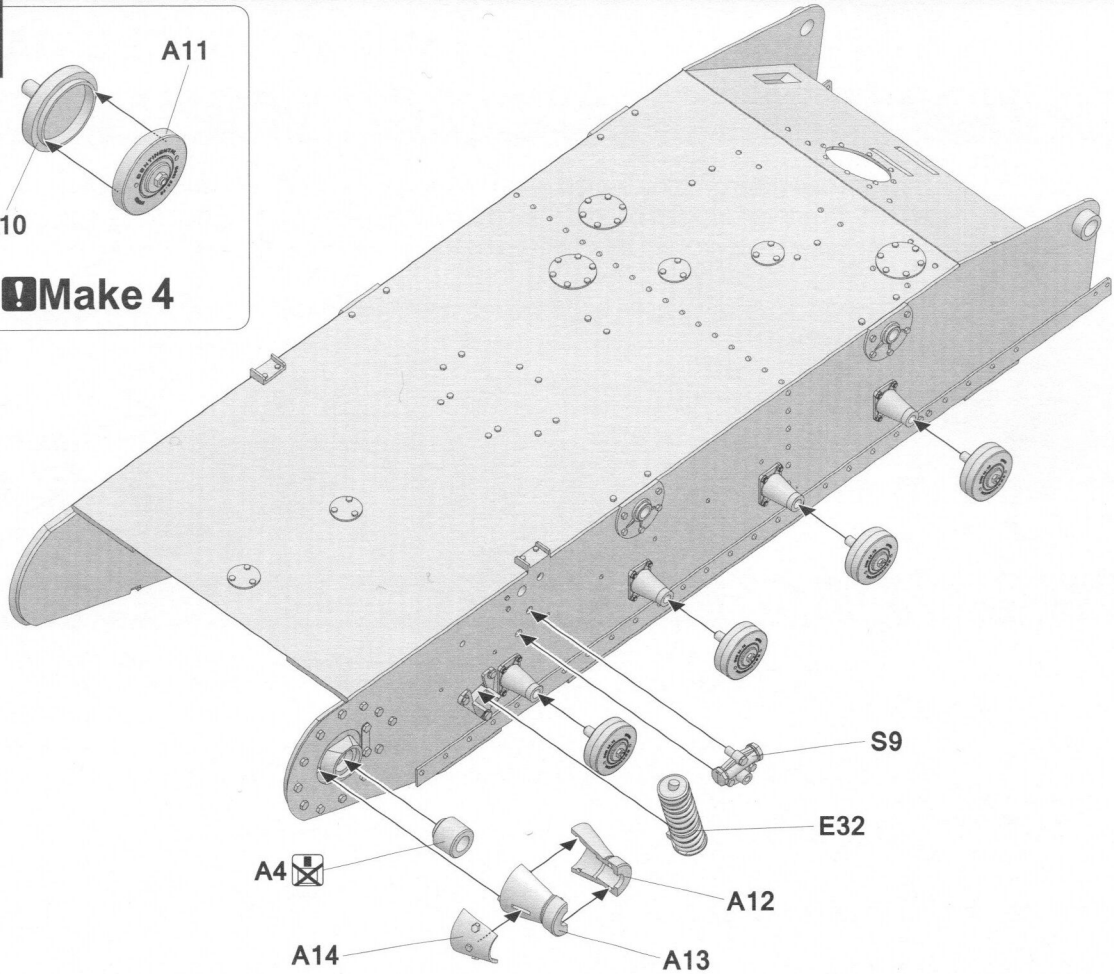

2

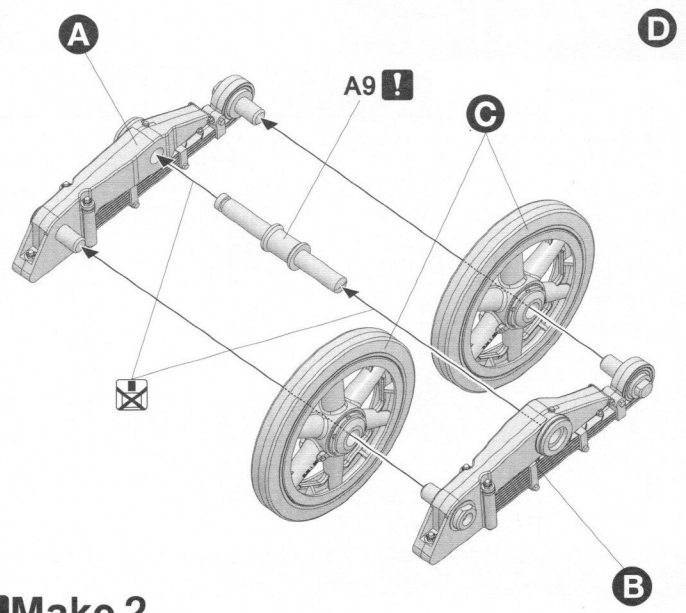

Make 2

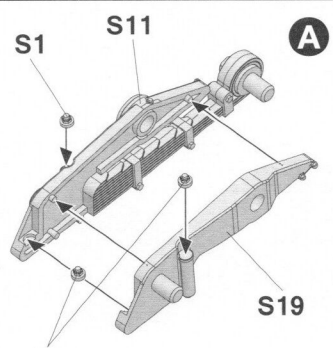

Make 4

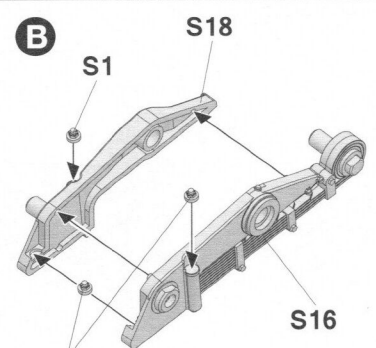

Make 4

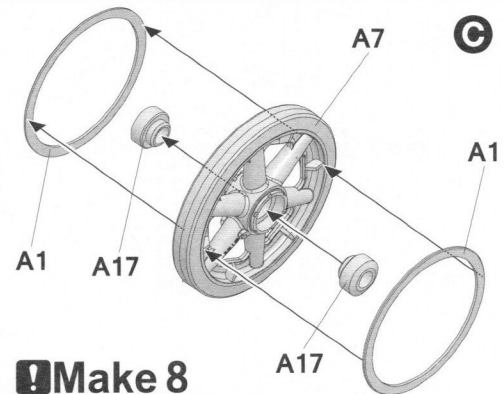

Make 8

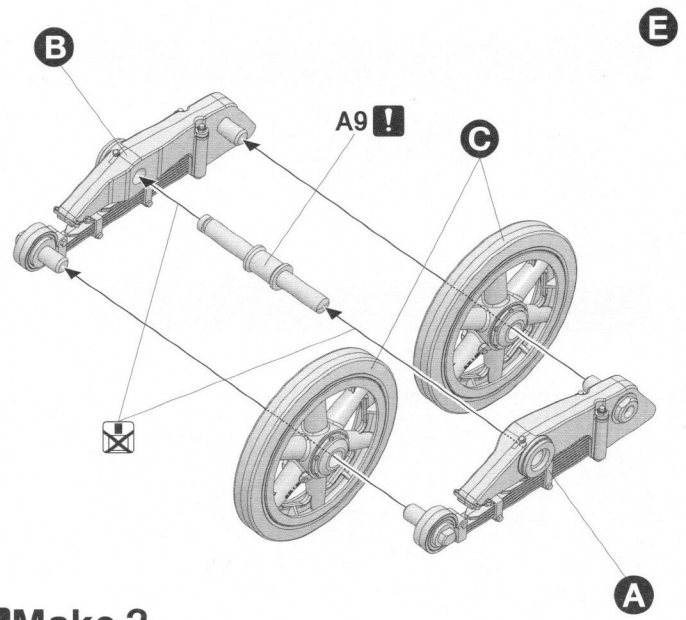

Make 2

3

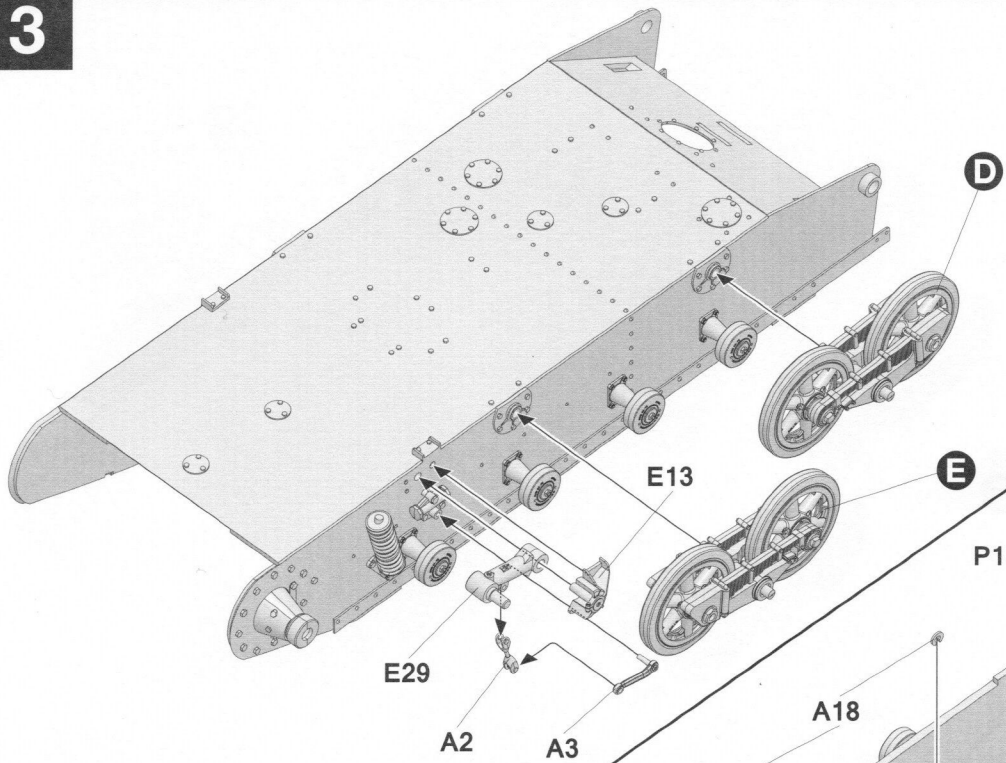

4

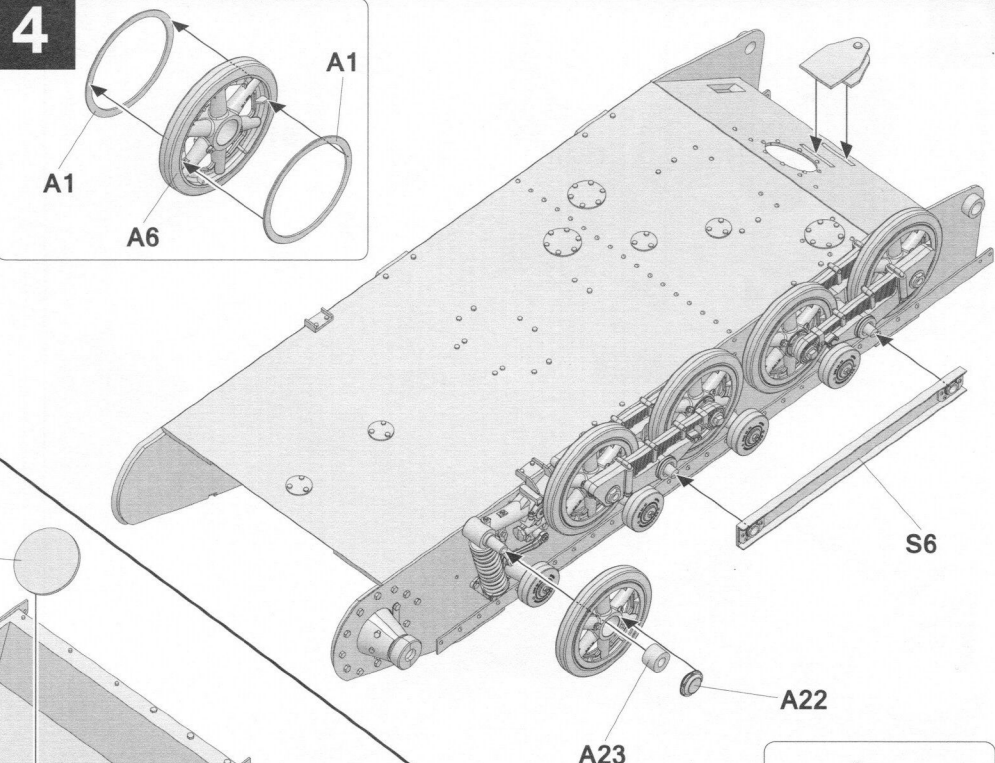

5

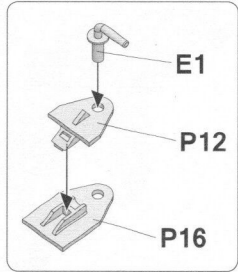
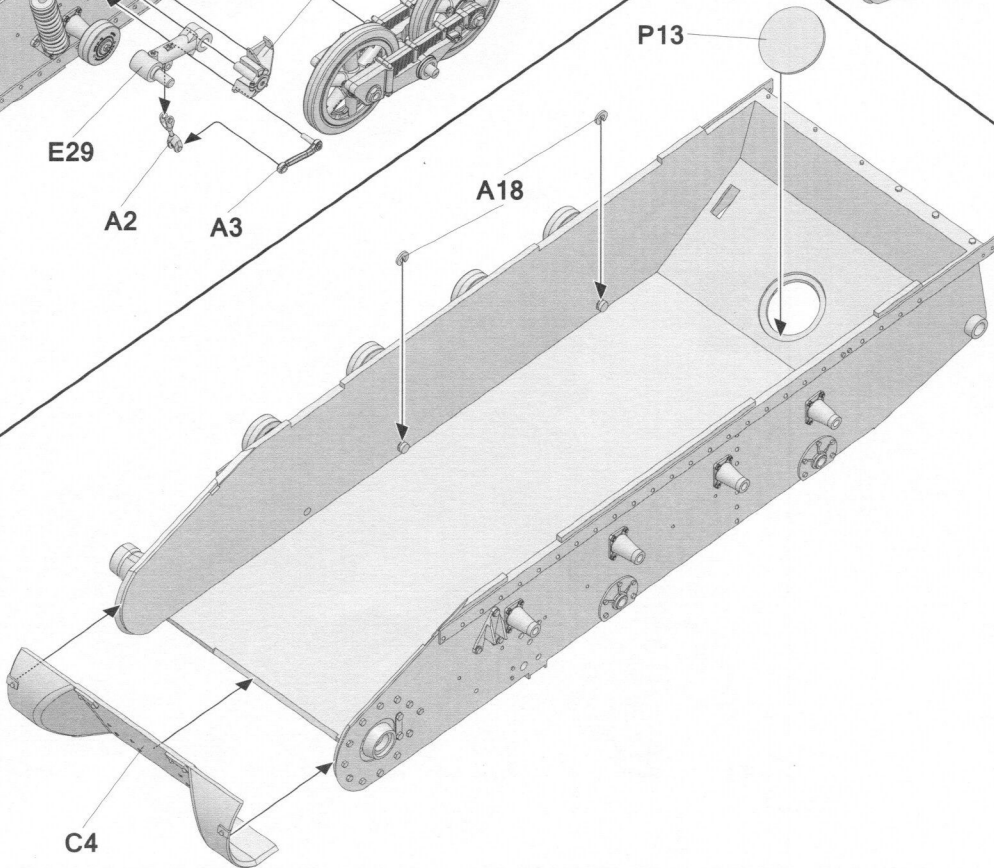

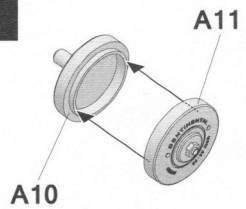
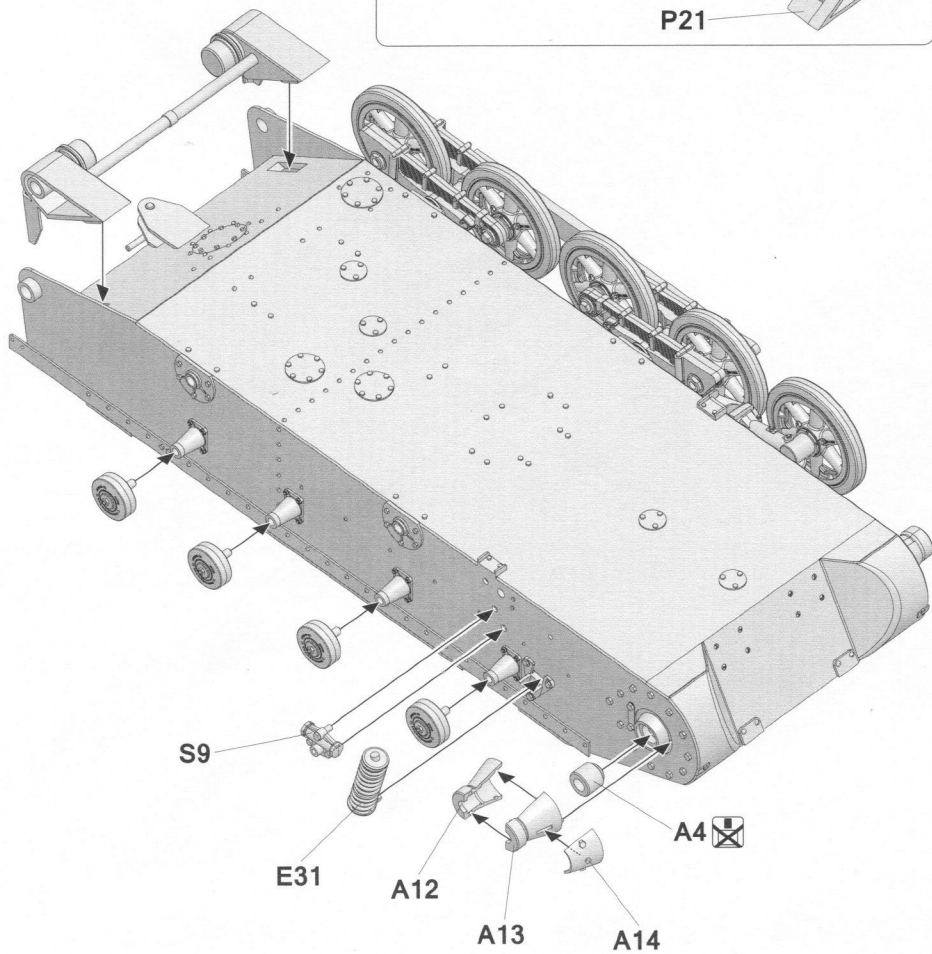
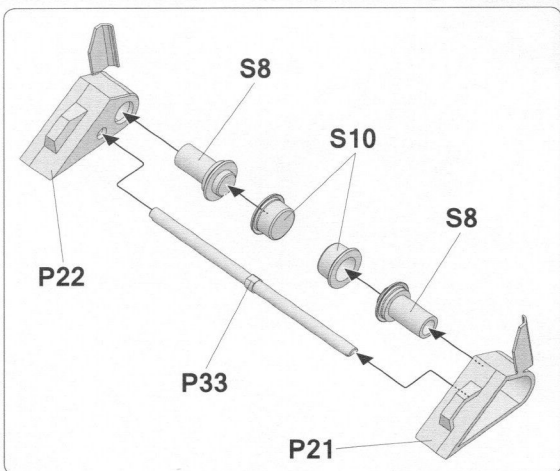
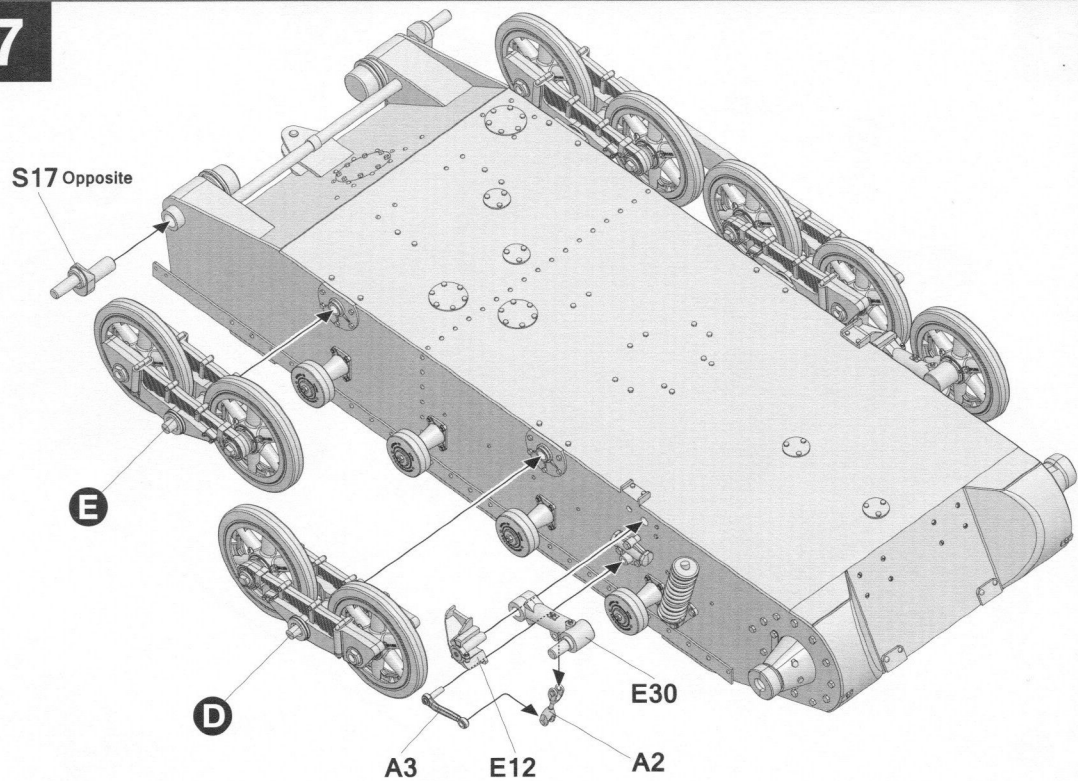
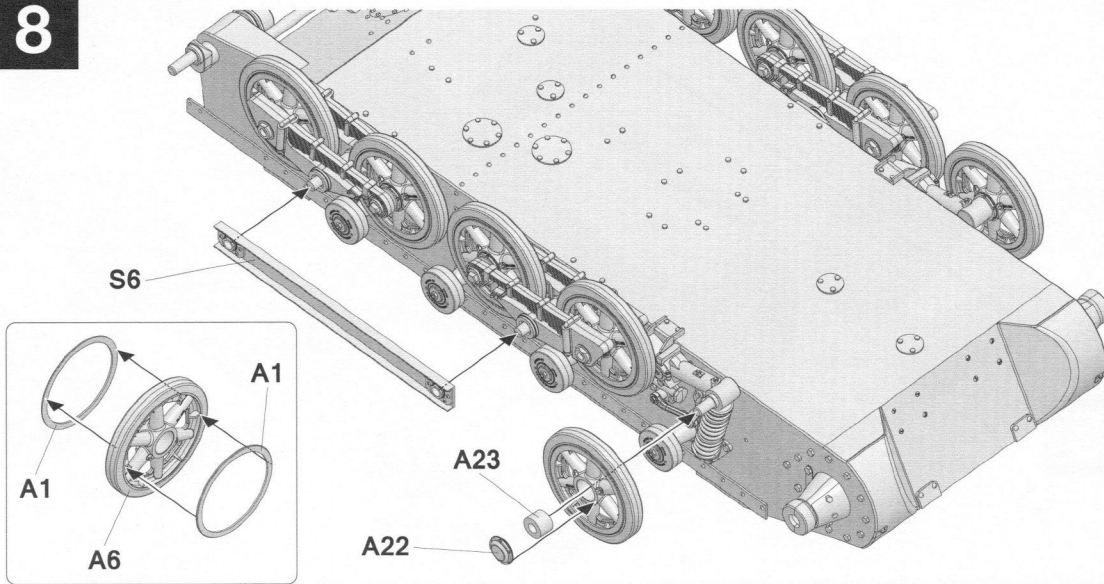
6**Make 4****7****8**

9

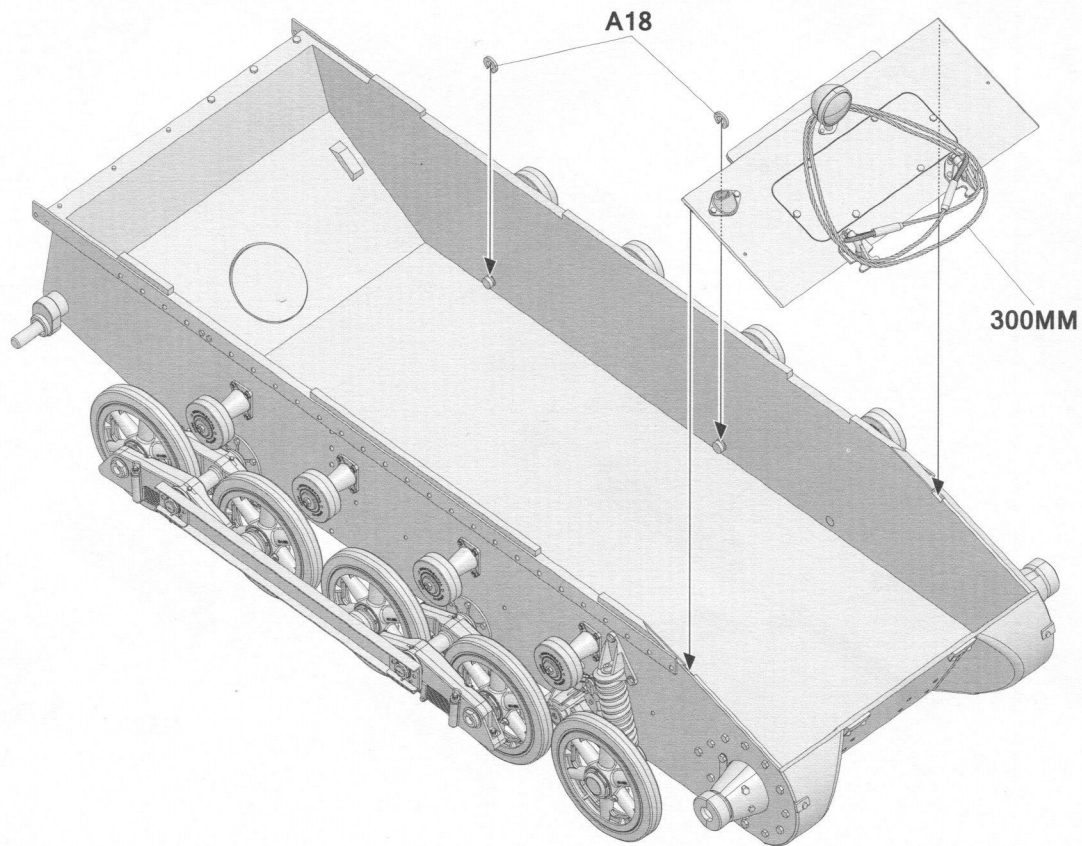
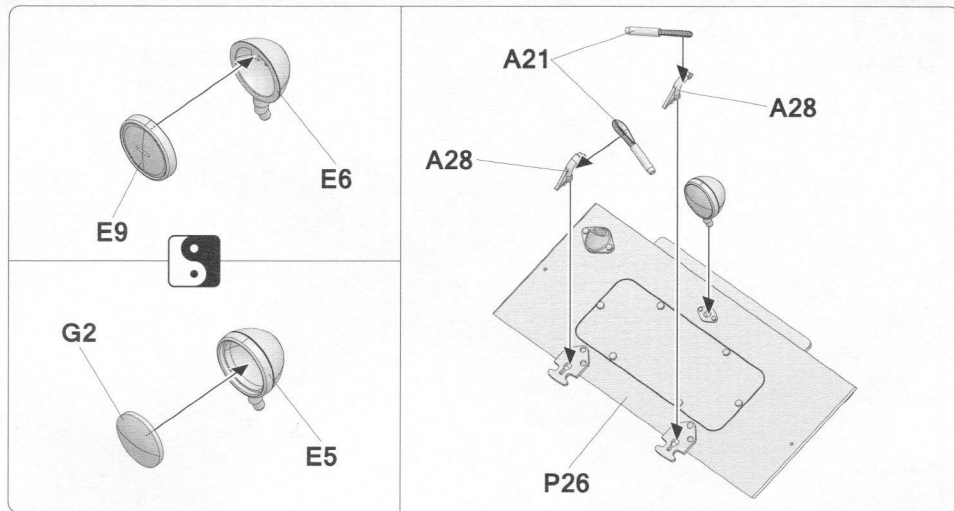

10

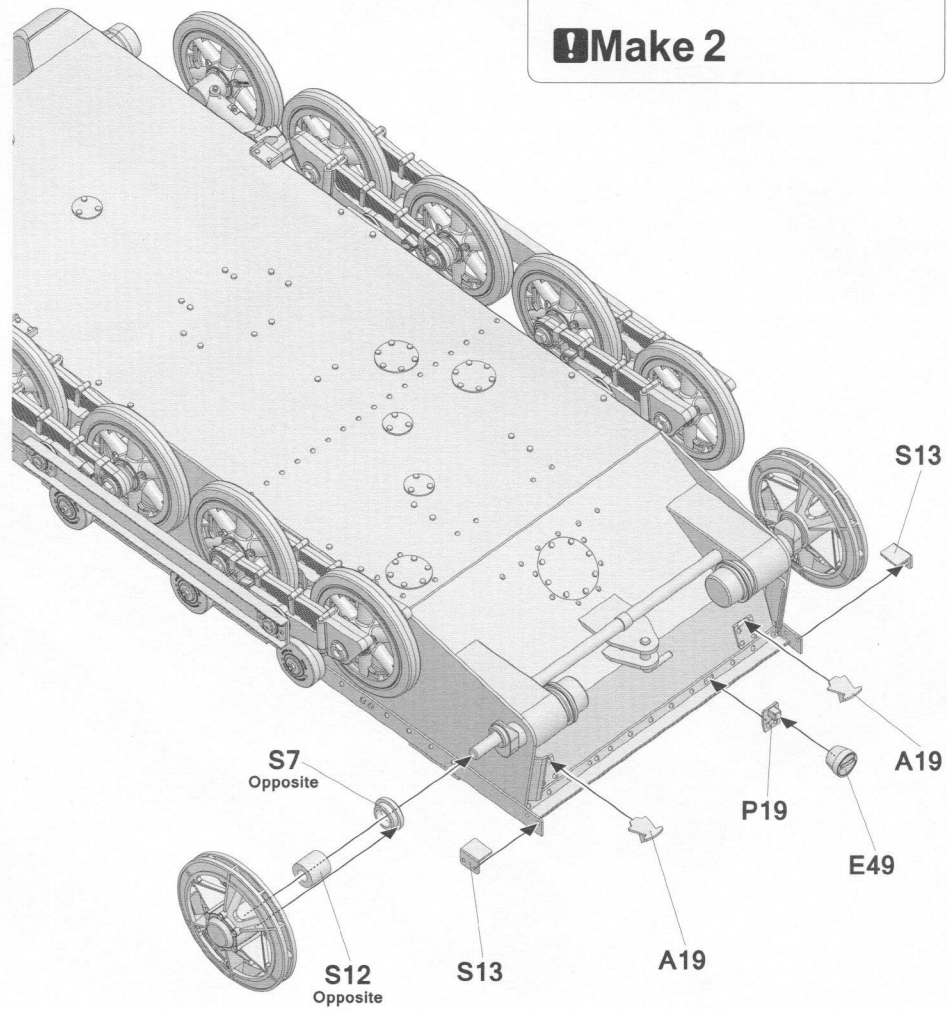

11

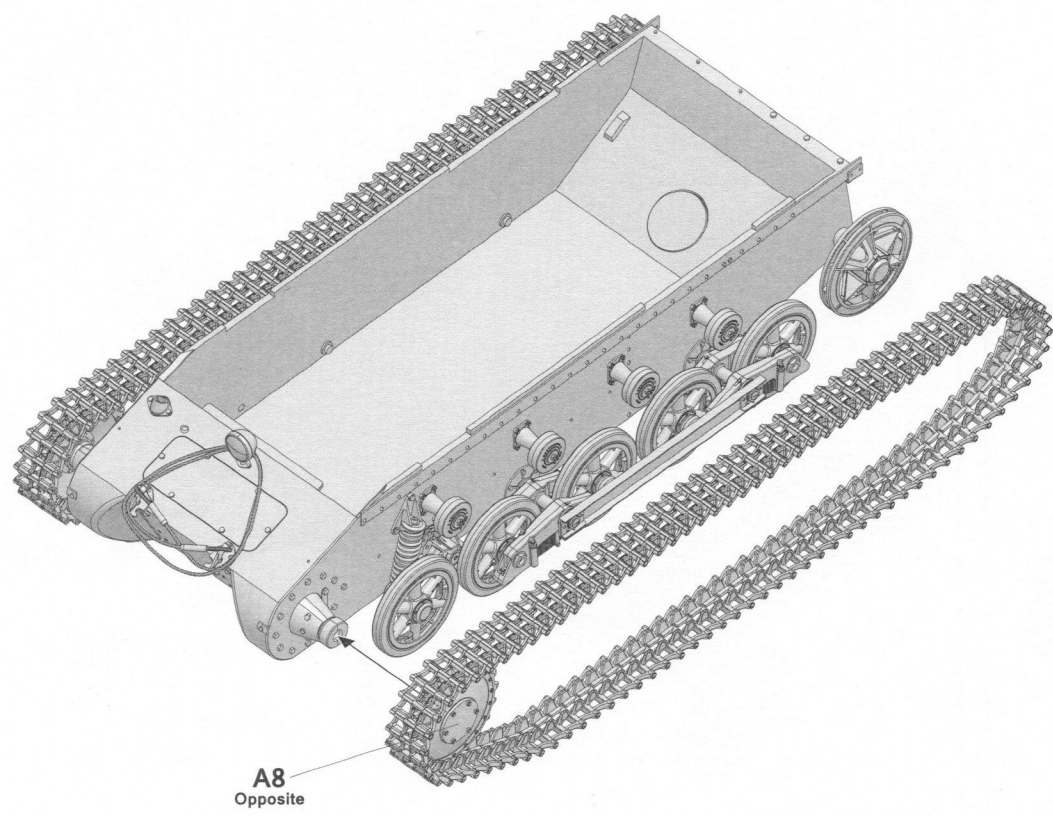
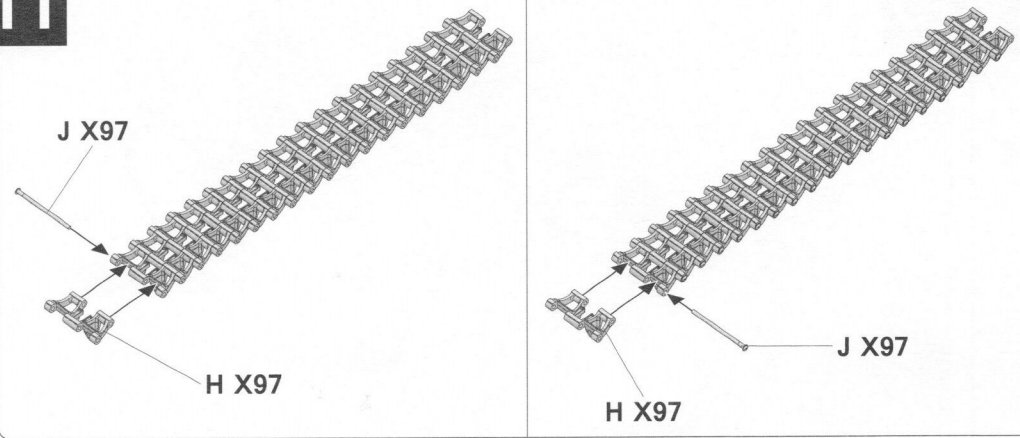

12

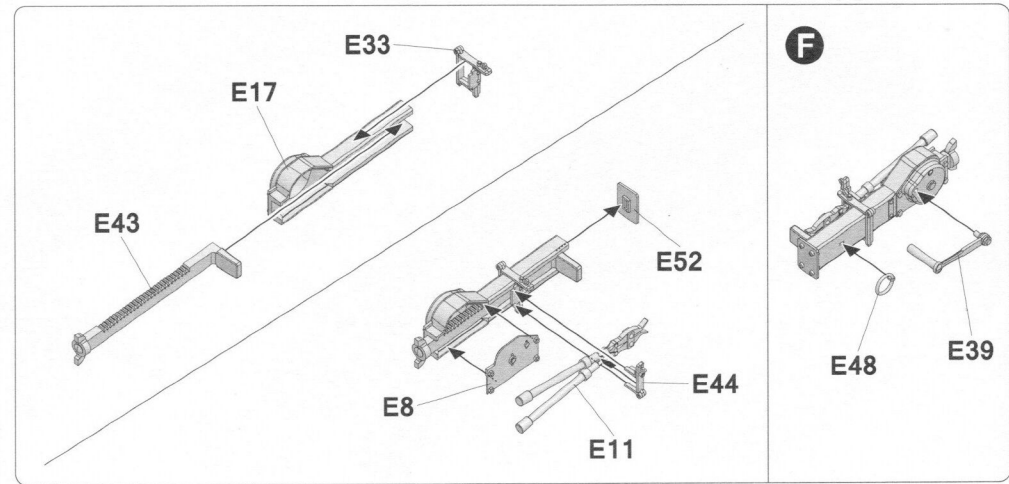
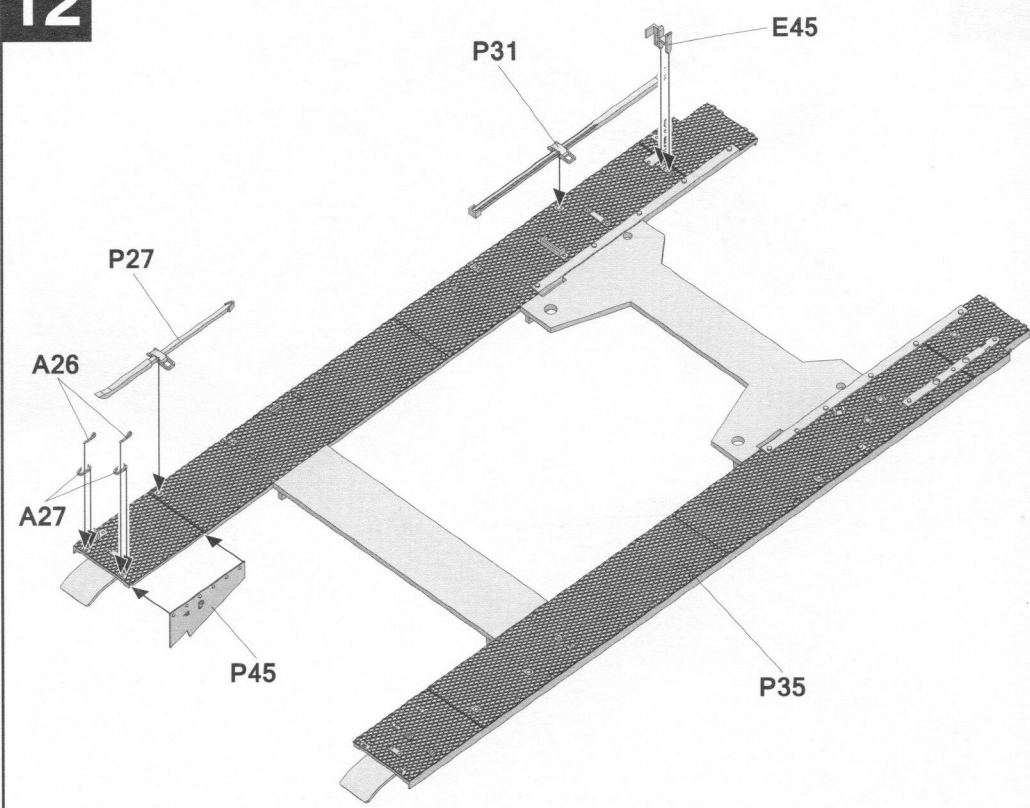

13

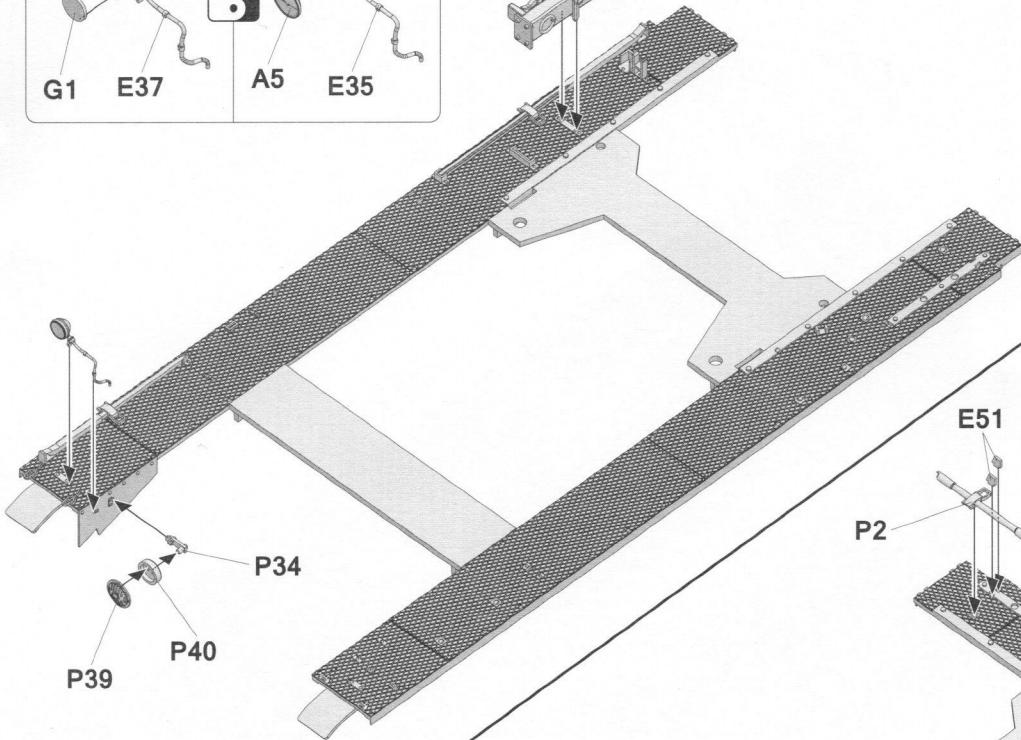
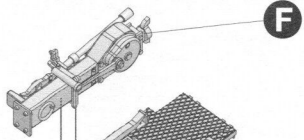
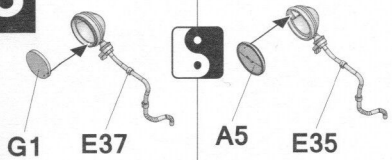

15

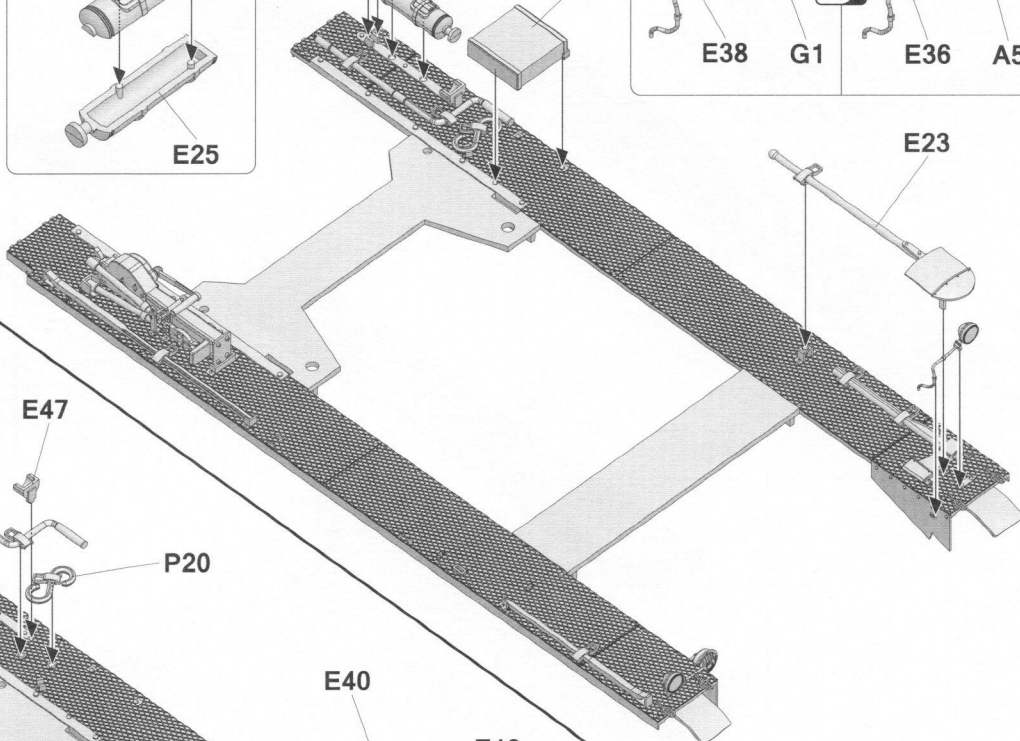
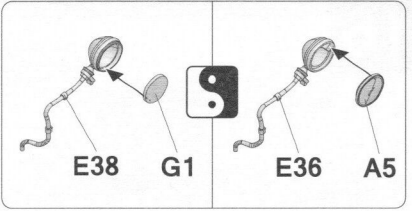
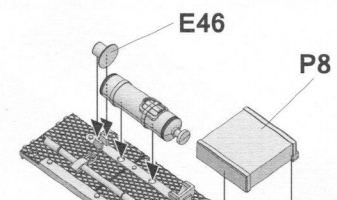
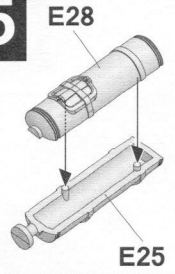

14

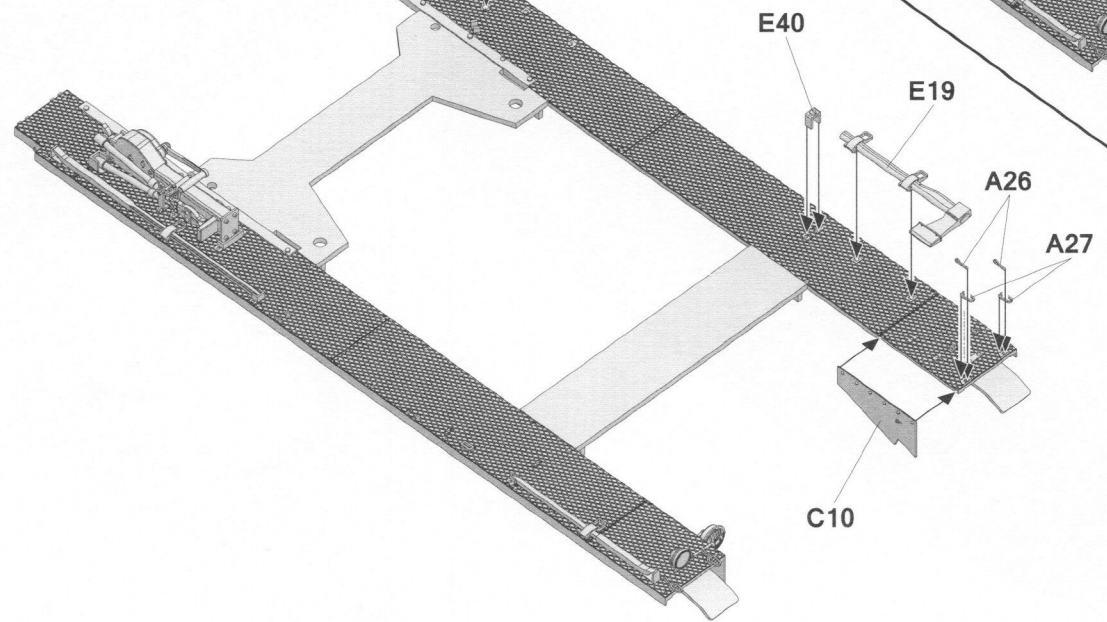

16

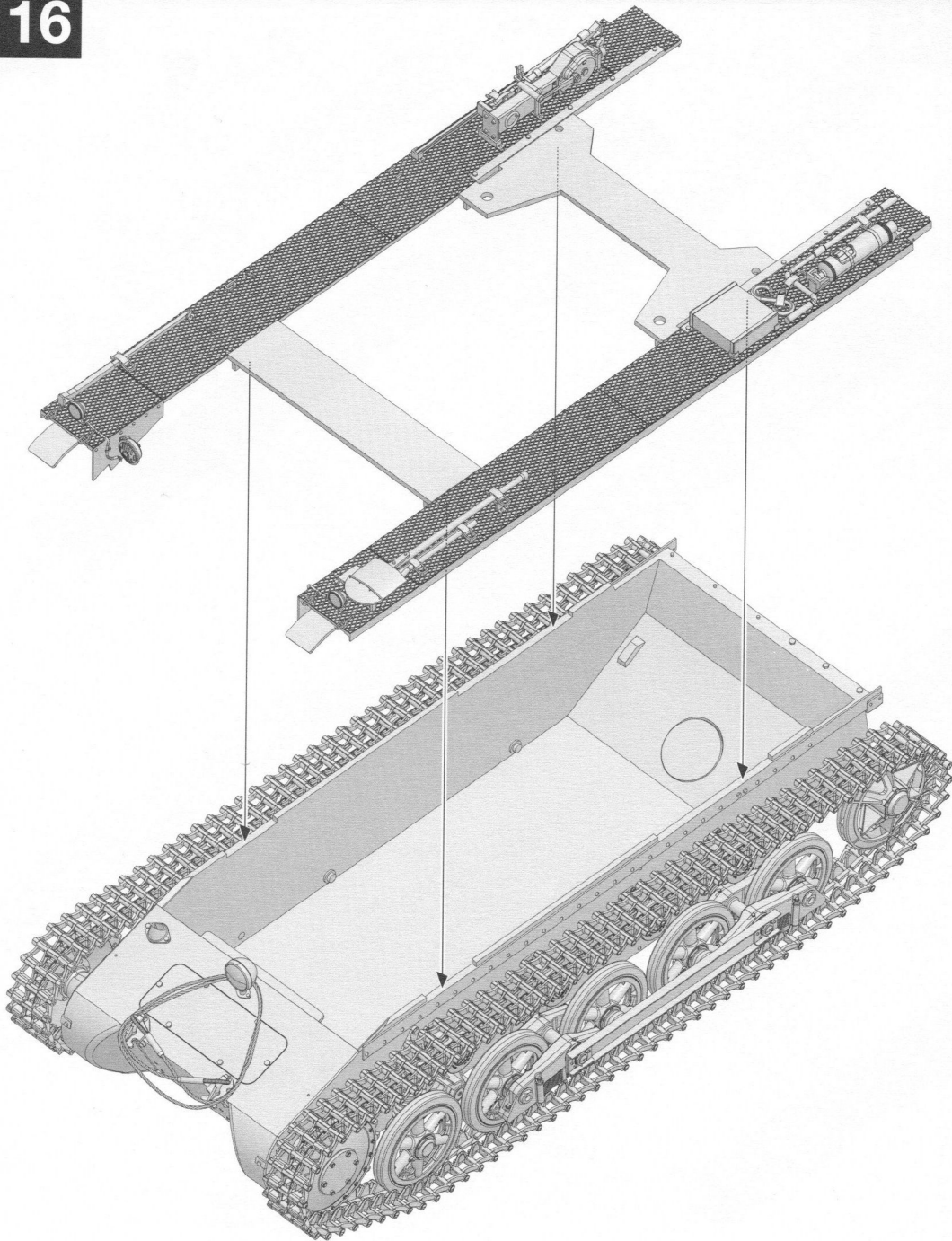

17

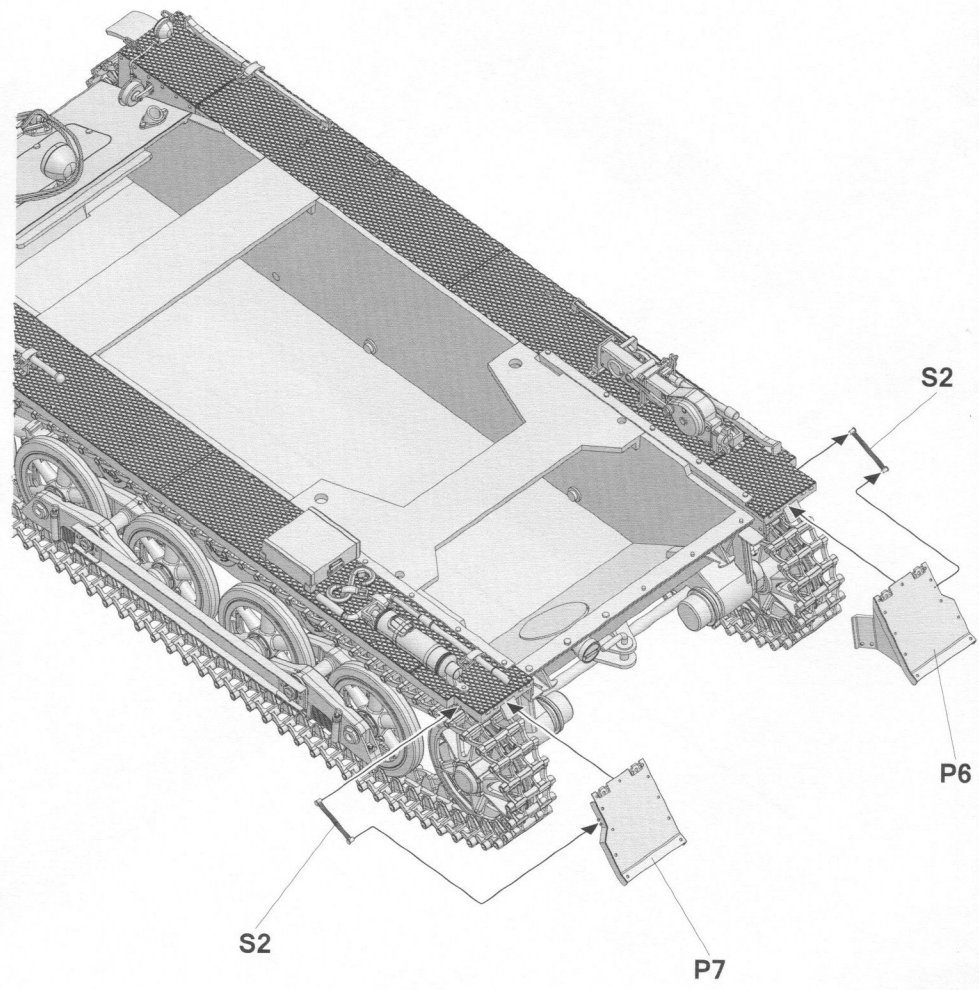

18

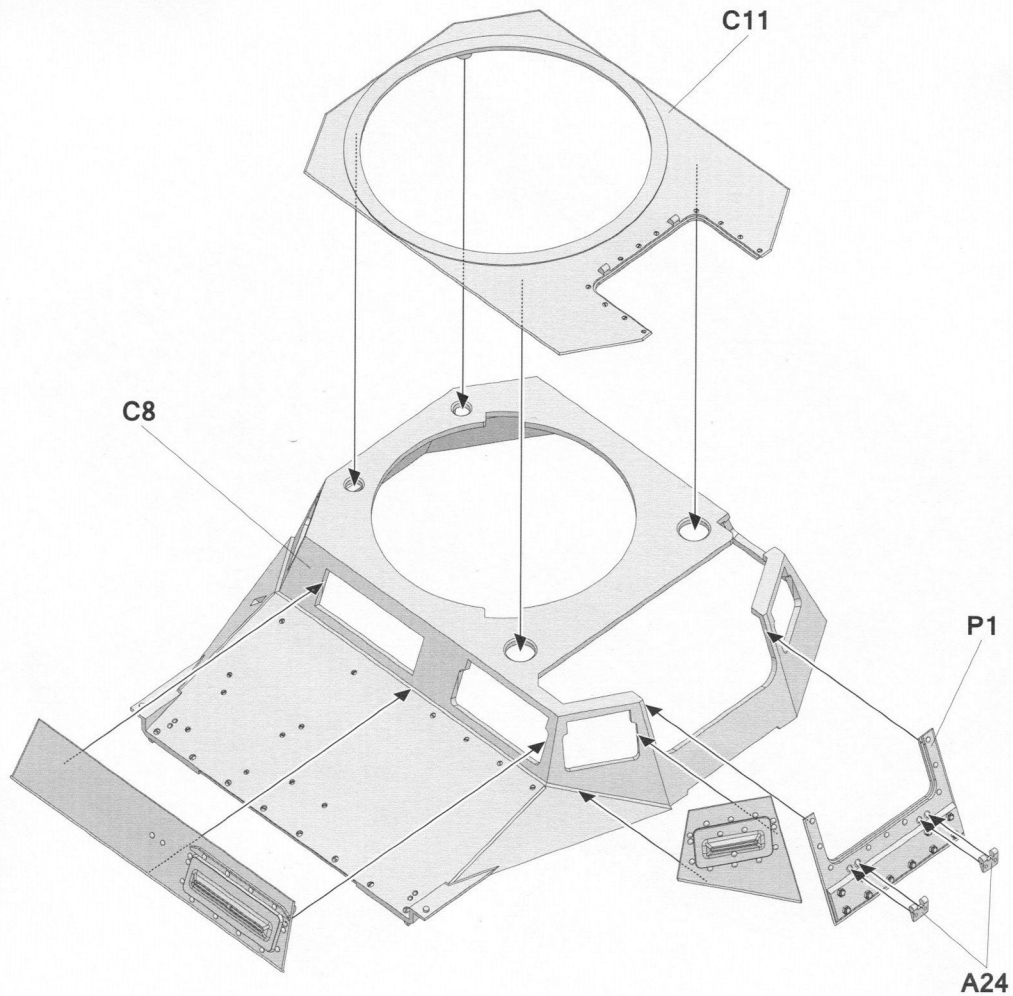
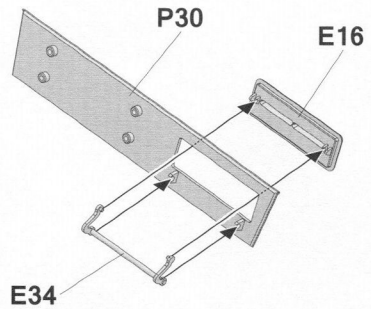
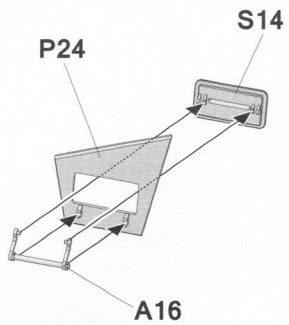

19

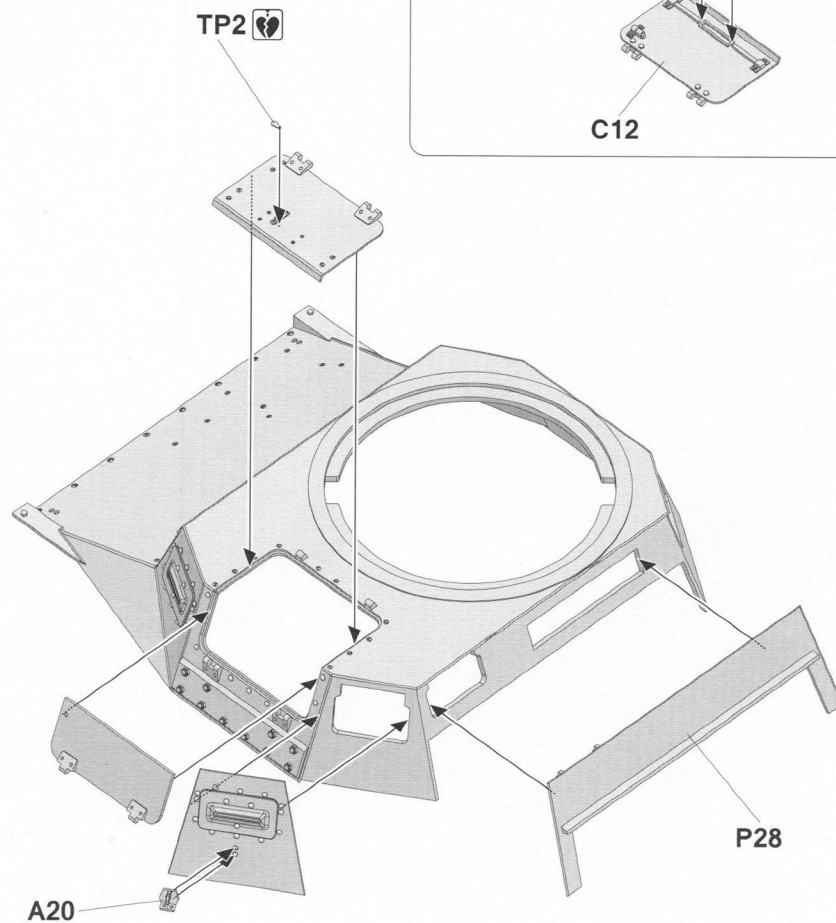
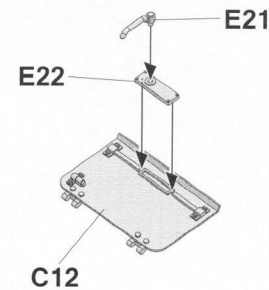
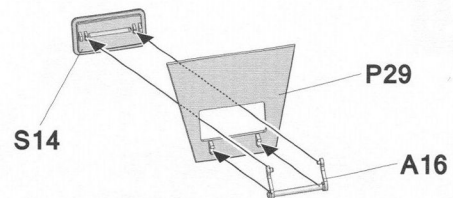
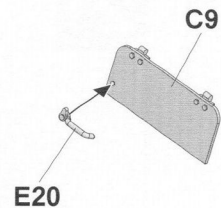

20

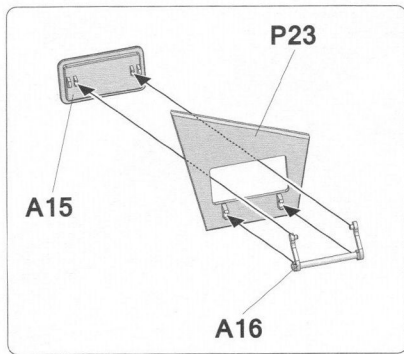

21

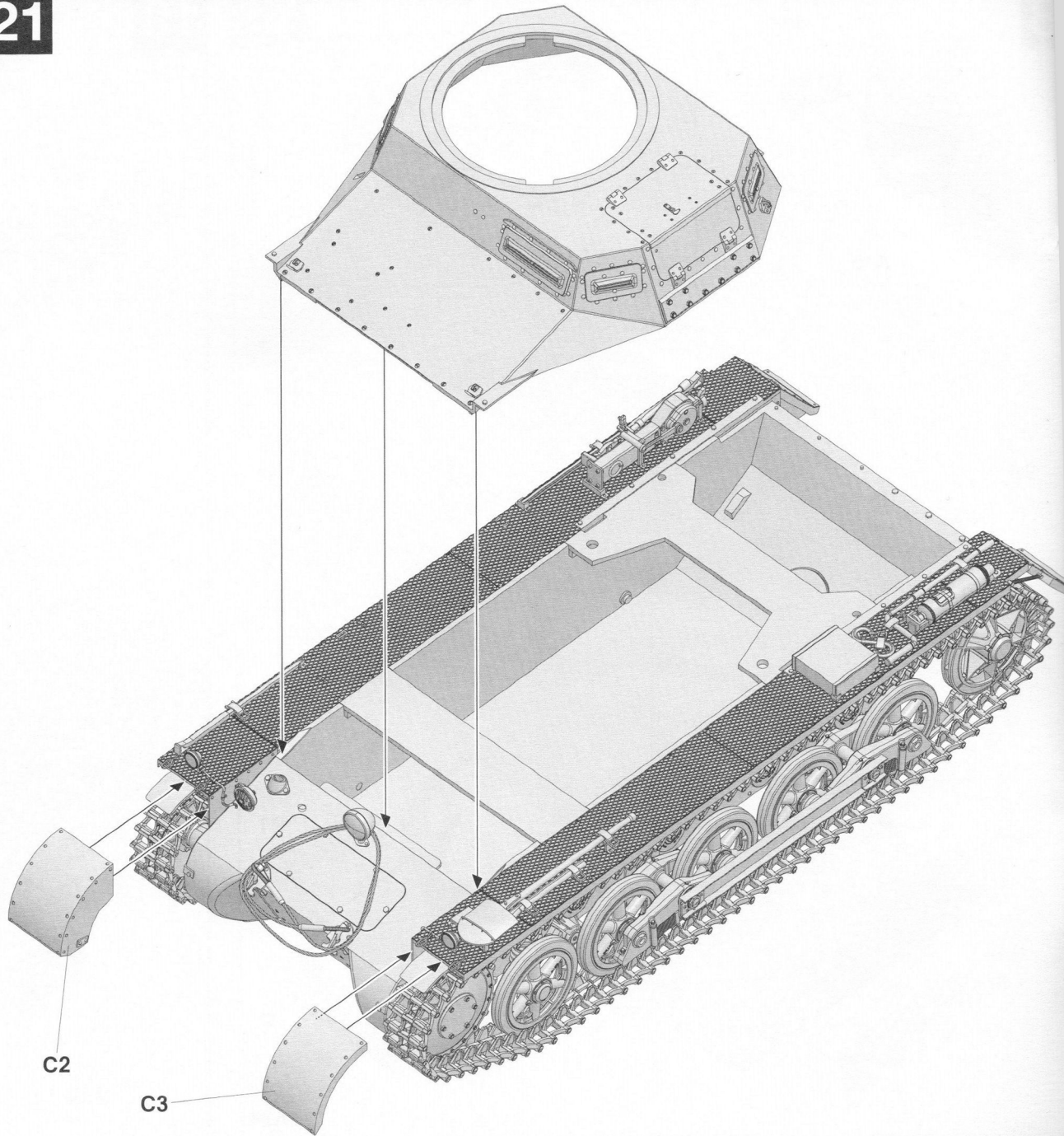
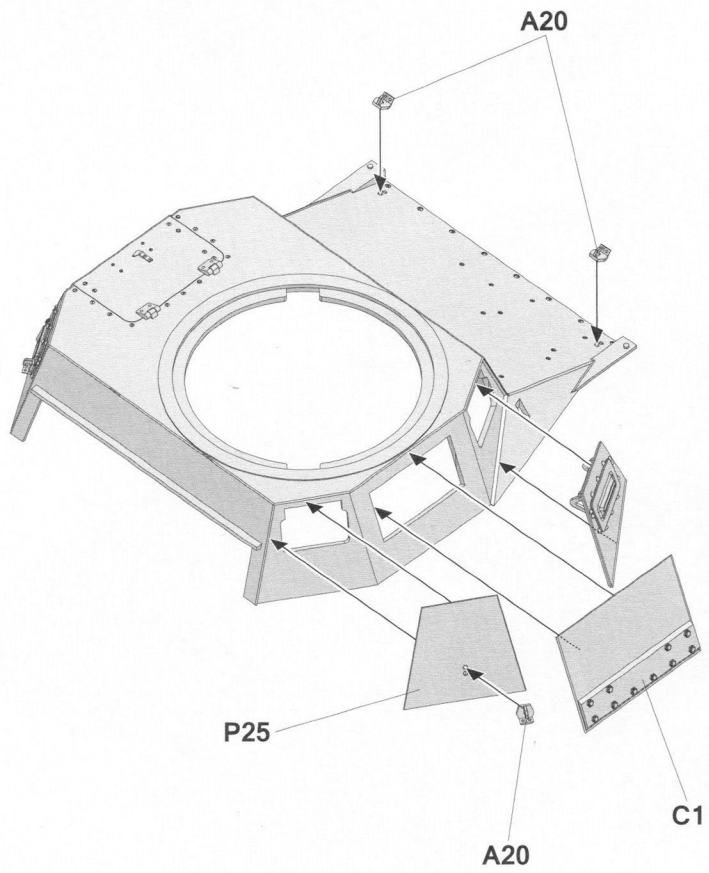

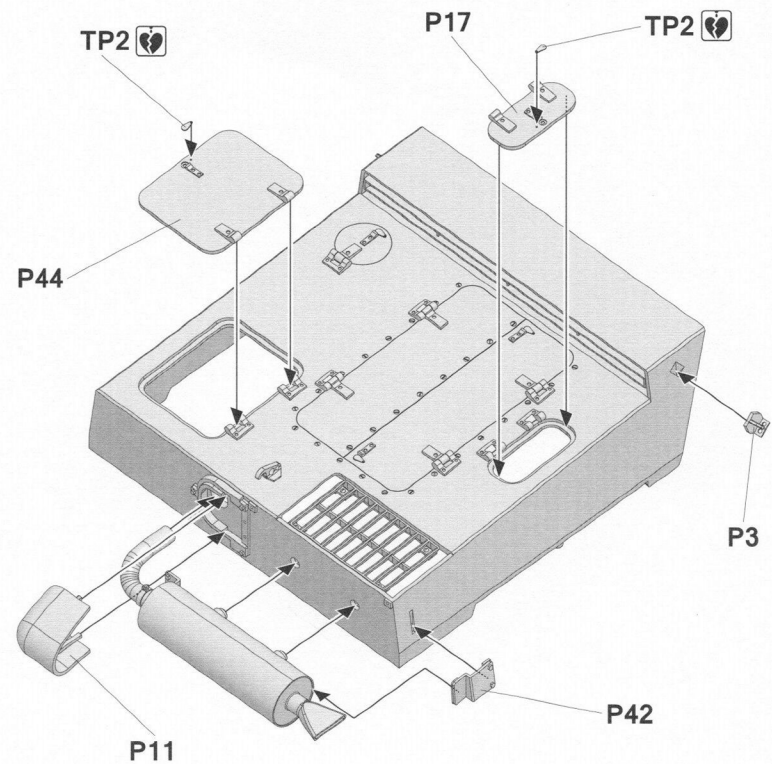
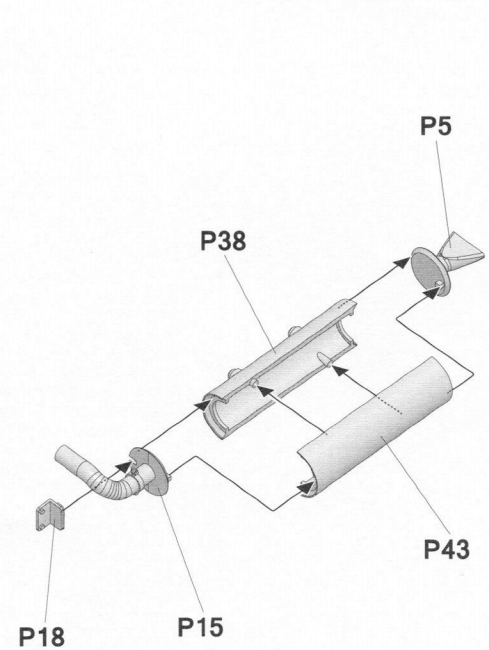
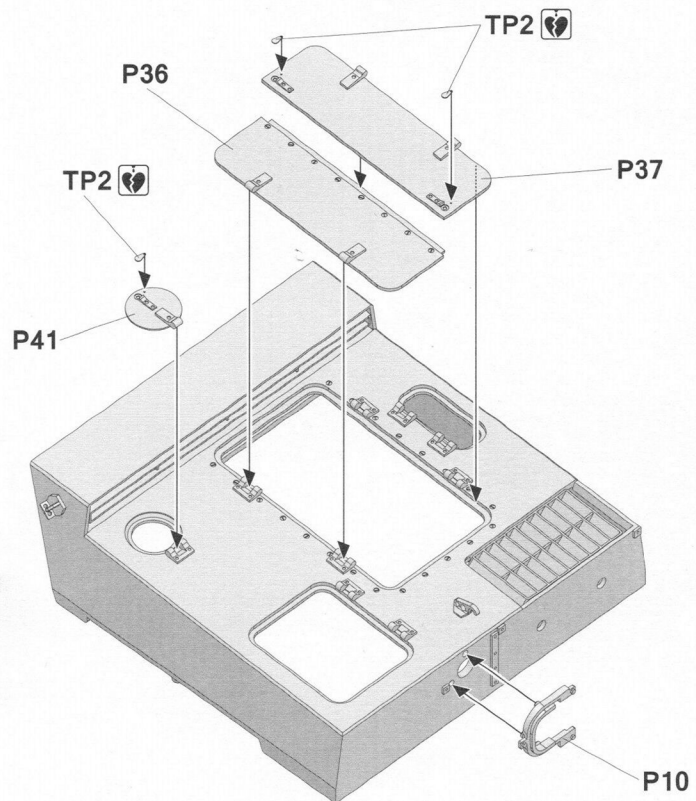
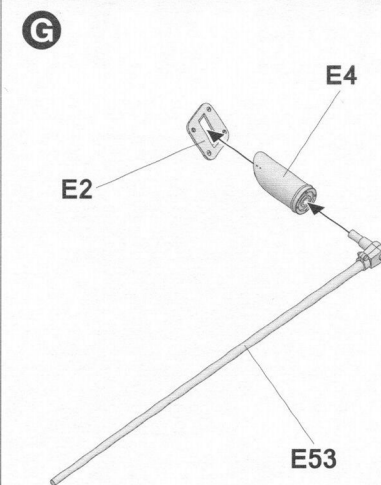
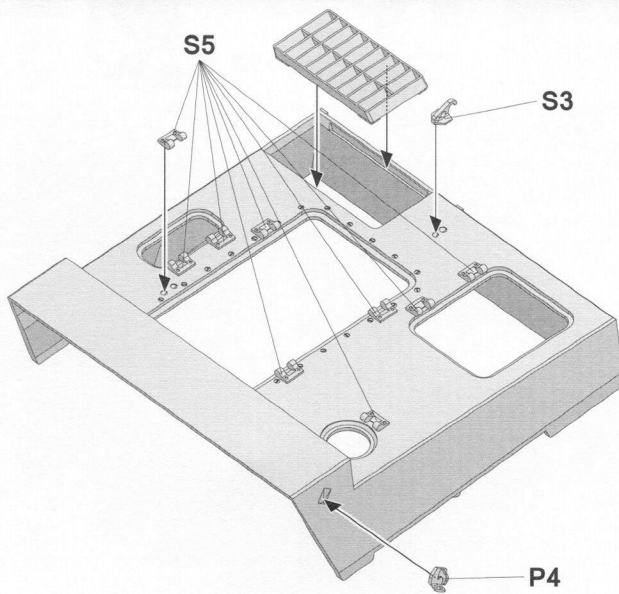
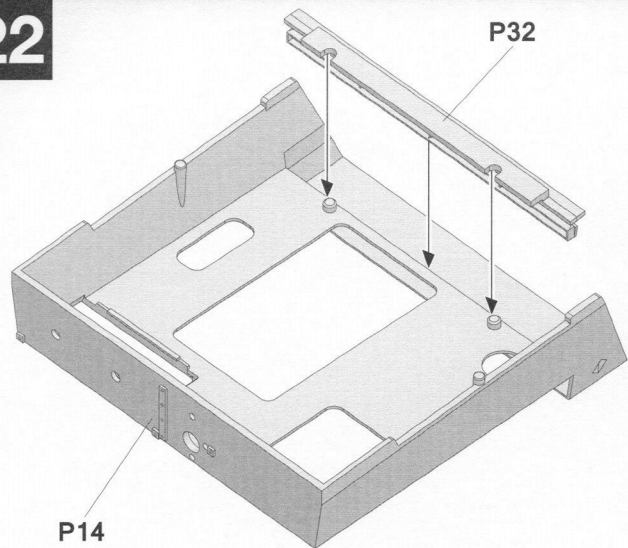

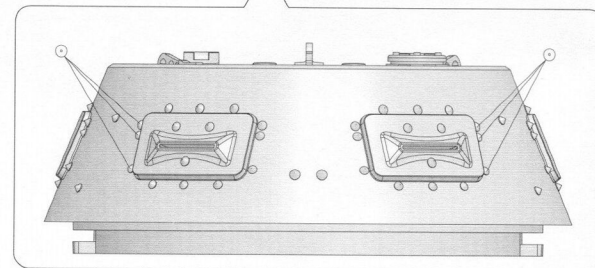
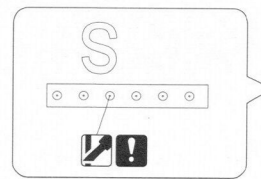
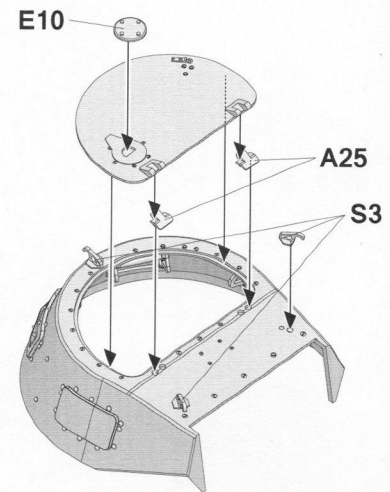
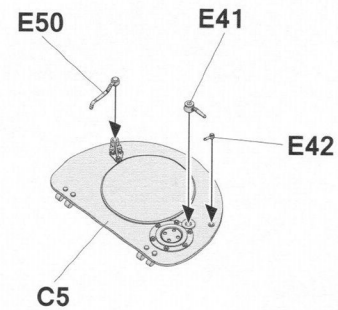
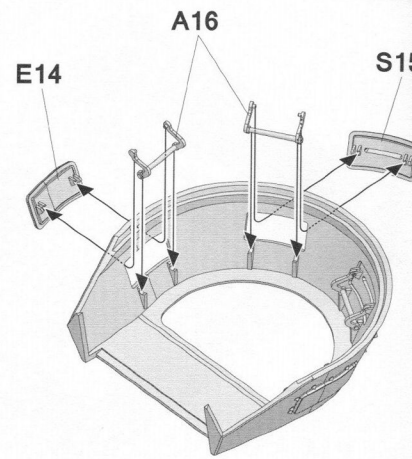
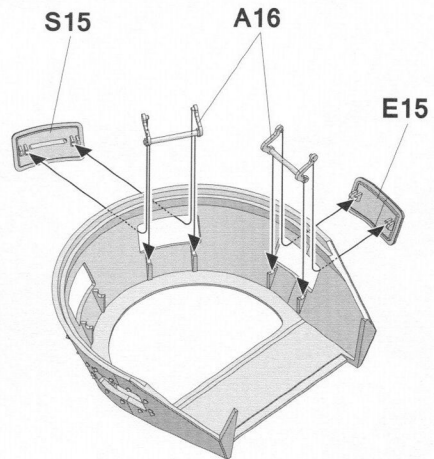
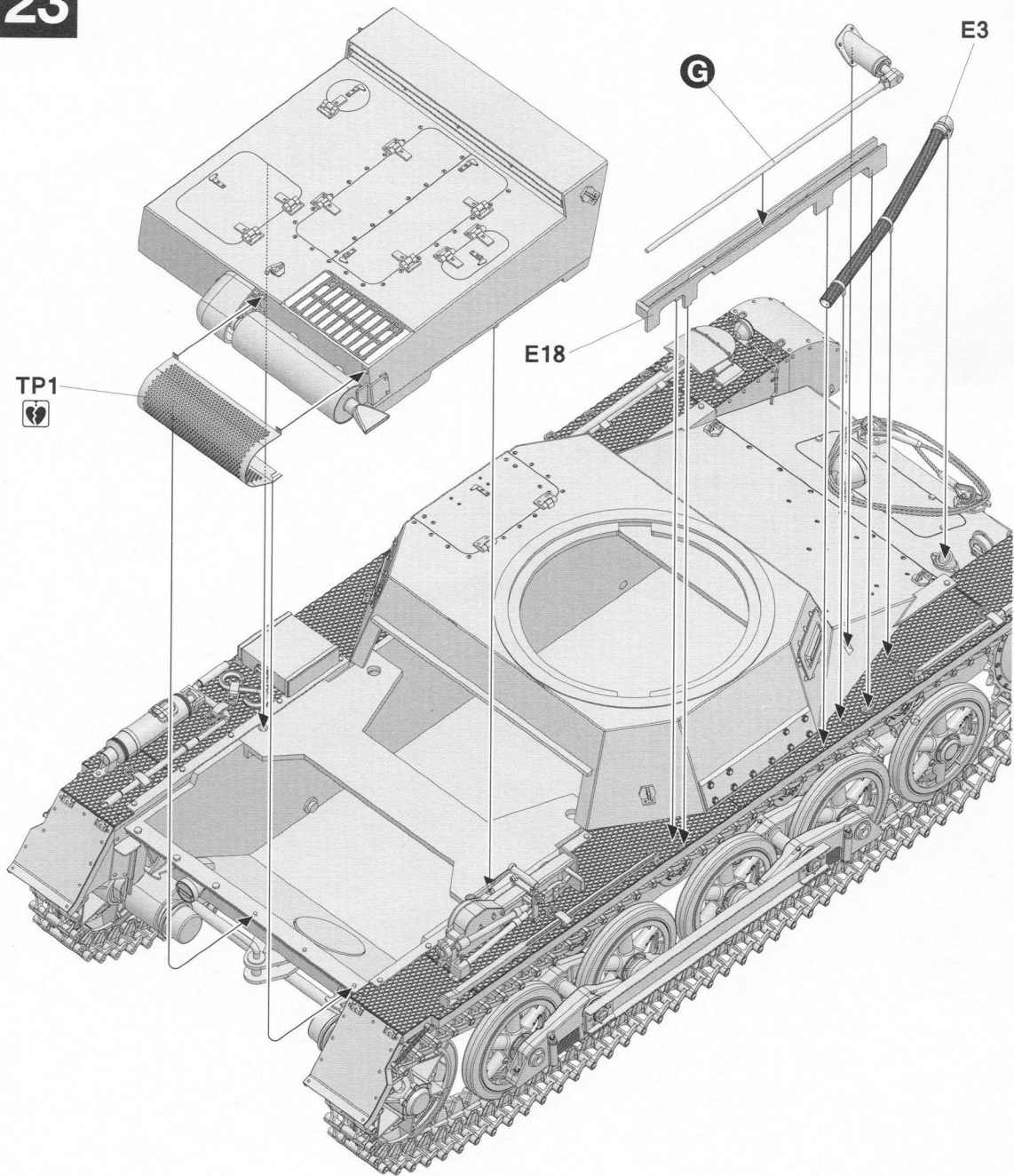

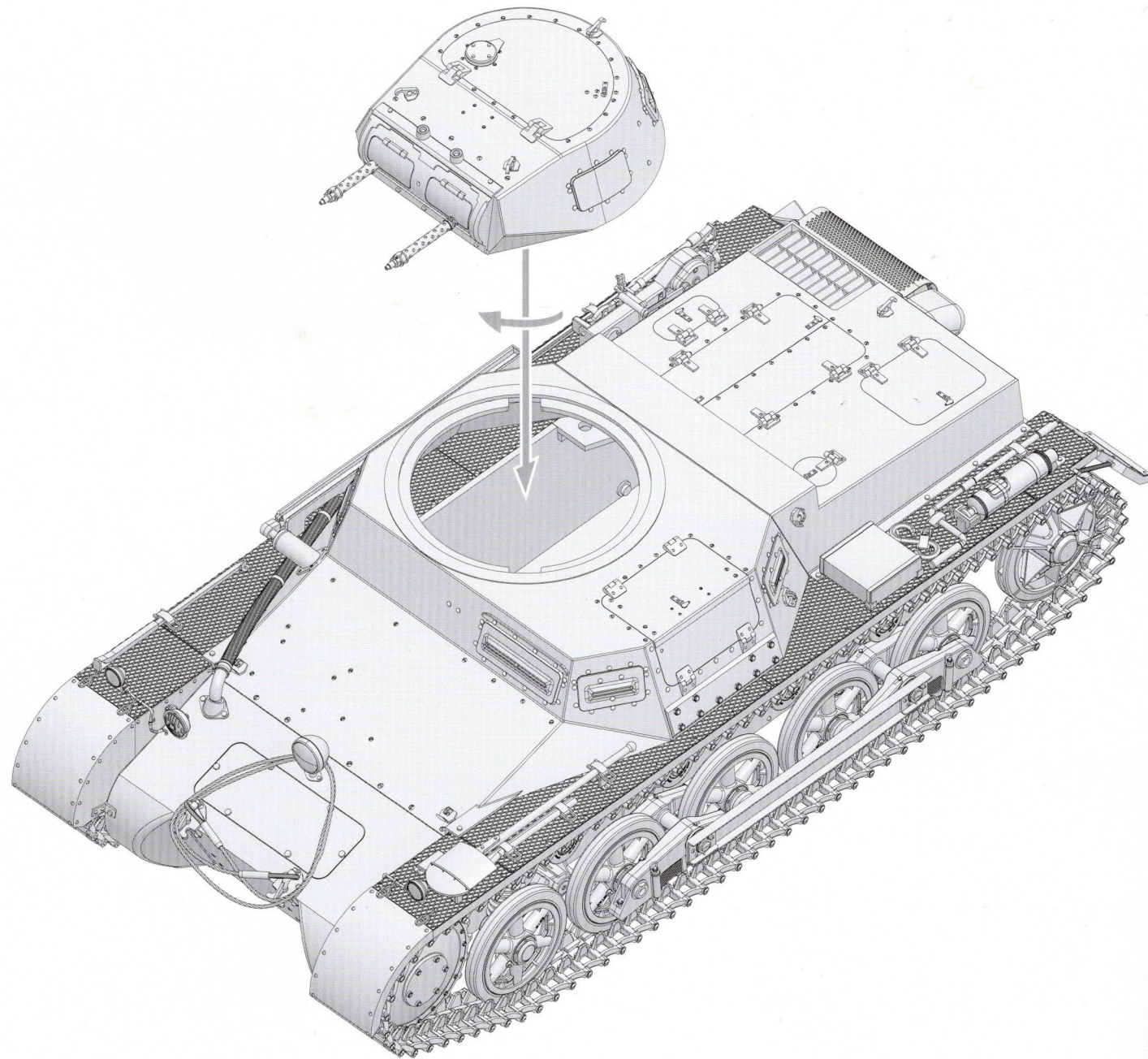
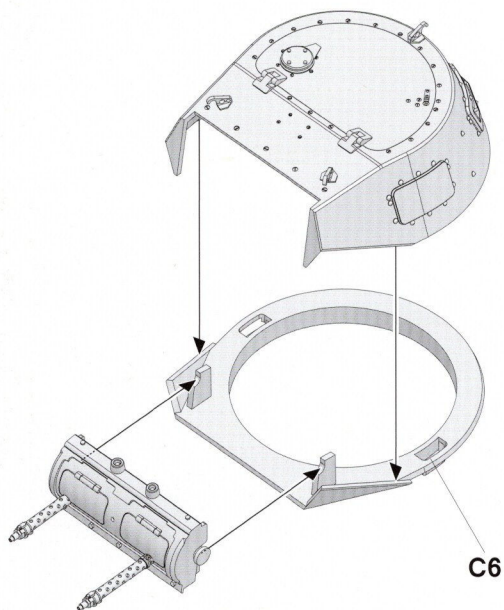
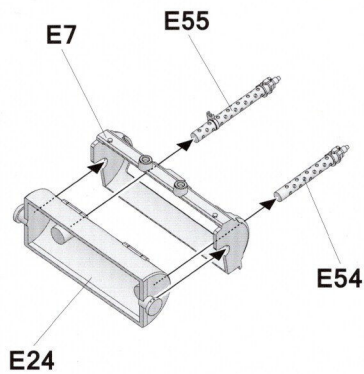

Painting and Marking Guide

TAKOM Ref: 1010

5. Kompanie, Panzer Regiment 35,
4th Panzer Division, Poland, September 1939

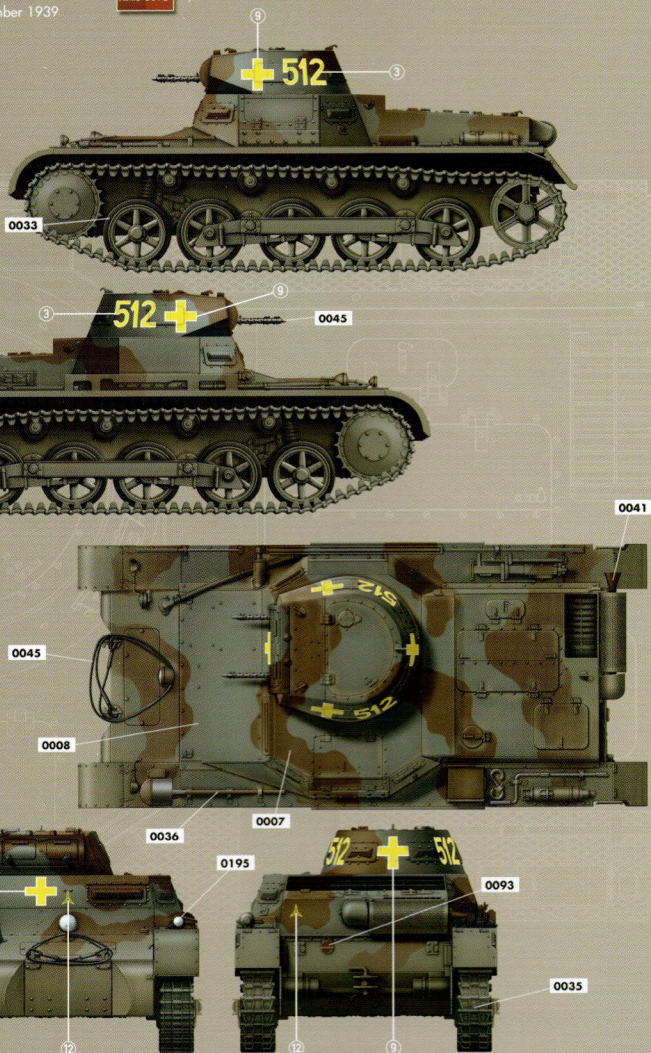

WEATHERING STEPS WITH AMMO PRODUCTS

- | | | | |
|---|---|---|--|
| 1 GENERAL WASH
A.MIG-1006 Blue Wash for Panzer Grey | 3 STREAKING
A.MIG-1206 Dark Streaking Grime | 5 RUST
A.MIG-1254 Streakingbrusher Rust | 7 MUD & SPLASHES
A.MIG-1751 Dry Steppe |
| 2 FILTER
A.MIG-1502 Dark Grey for White | 4 TRACKS WASH
A.MIG-1002 Tracks Wash | 6 DUST
A.MIG-3004 Europe Earth | 8 GREASE & OIL
A.MIG-1408 Fresh Engine Oil |

Painting and Marking Guide

TAKOM Ref: 1010

Panzer Regiment 31, 5th Panzer Division,
Pszczyna, Poland, September 1939

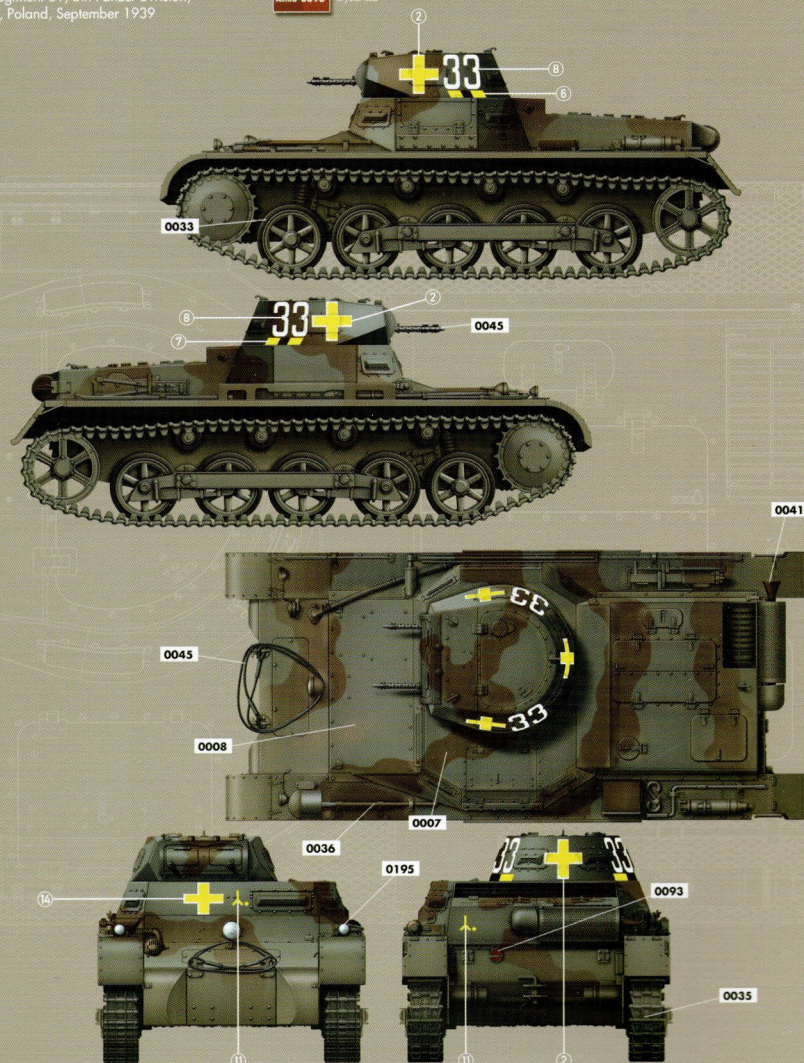

WEATHERING STEPS WITH AMMO PRODUCTS

- | | | | |
|---|---|---|--|
| 1 GENERAL WASH
A.MIG-1006 Blue Wash for Panzer Grey | 3 STREAKING
A.MIG-1206 Dark Streaking Grime | 5 RUST
A.MIG-1254 Streakingbrusher Rust | 7 MUD & SPLASHES
A.MIG-1751 Dry Steppe |
| 2 FILTER
A.MIG-1502 Dark Grey for White | 4 TRACKS WASH
A.MIG-1002 Tracks Wash | 6 DUST
A.MIG-3004 Europe Earth | 8 GREASE & OIL
A.MIG-1408 Fresh Engine Oil |

Painting and Marking Guide

TAKOM Ref: 1010

5. Kompanie, Panzer Regiment 36,
4th Panzer Division, France, June 1940

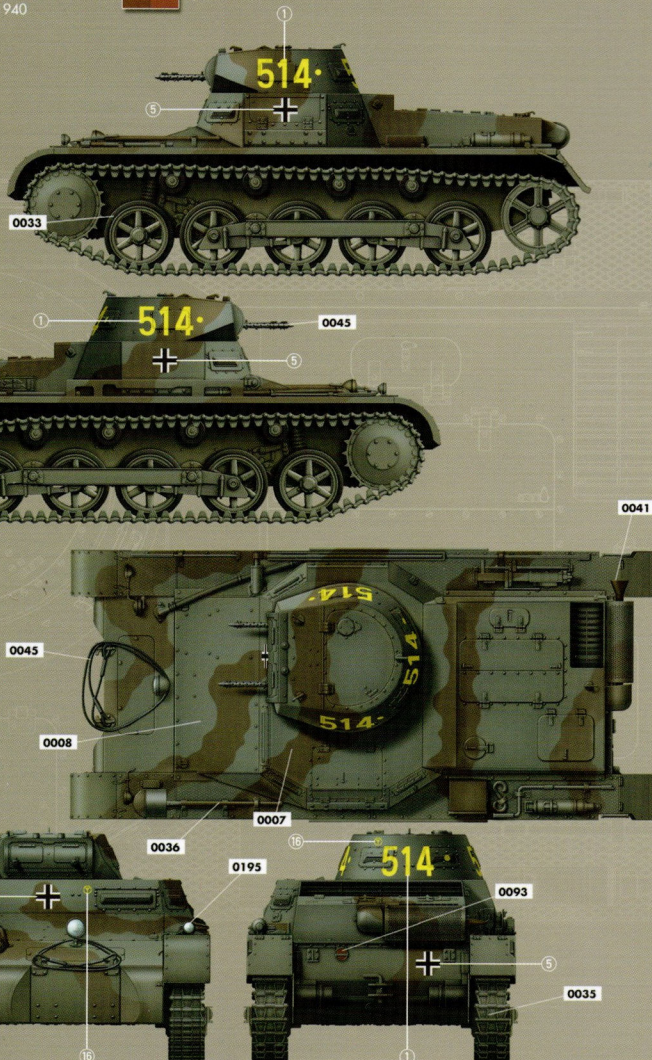

WEATHERING STEPS WITH AMMO PRODUCTS

- | | | | |
|---|---|---|--|
| 1 GENERAL WASH
A.MIG-1006 Blue Wash for Panzer Grey | 3 STREAKING
A.MIG-1206 Dark Streaking Grime | 5 RUST
A.MIG-1254 Streakingbrusher Rust | 7 MUD & SPLASHES
A.MIG-1751 Dry Steppe |
| 2 FILTER
A.MIG-1502 Dark Grey for White | 4 TRACKS WASH
A.MIG-1002 Tracks Wash | 6 DUST
A.MIG-3004 Europe Earth | 8 GREASE & OIL
A.MIG-1408 Fresh Engine Oil |

Painting and Marking Guide

TAKOM Ref: 1010

1. Kompanie, Panzer Regiment 6,
3rd Panzer Division, France, June 1940

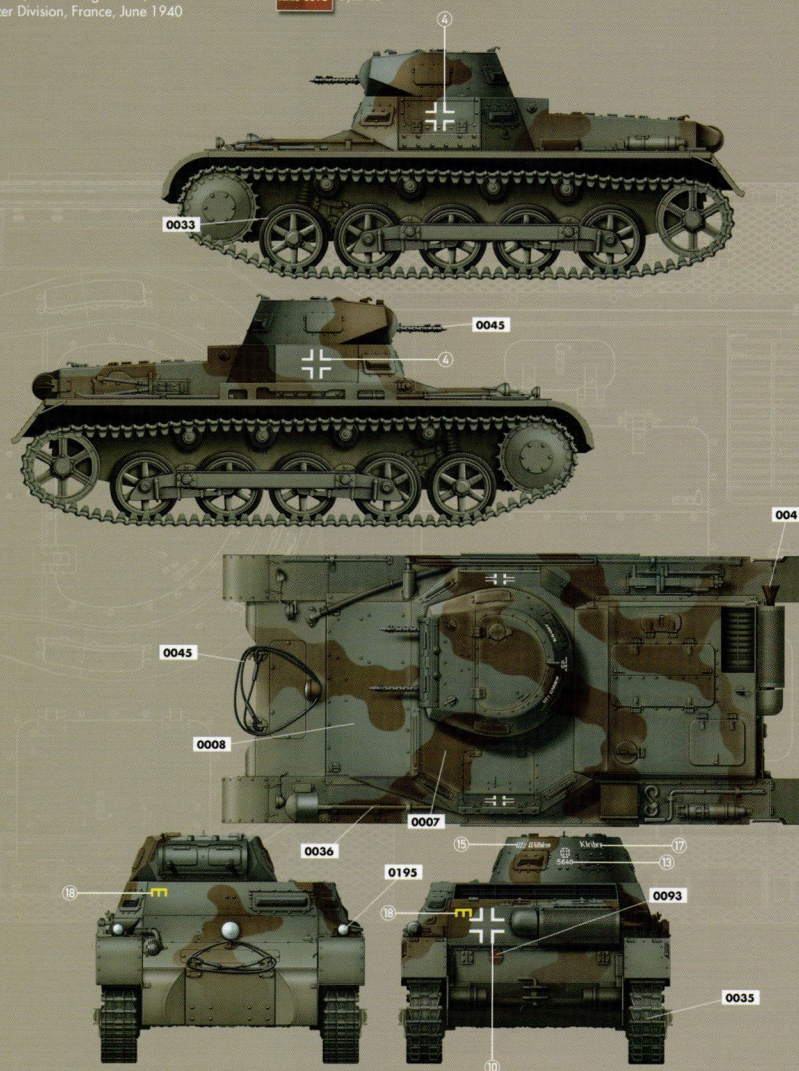

WEATHERING STEPS WITH AMMO PRODUCTS

- | | | | |
|---|---|---|--|
| 1 GENERAL WASH
A.MIG-1006 Blue Wash for Panzer Grey | 3 STREAKING
A.MIG-1206 Dark Streaking Grime | 5 RUST
A.MIG-1254 Streakingbrusher Rust | 7 MUD & SPLASHES
A.MIG-1751 Dry Steppe |
| 2 FILTER
A.MIG-1502 Dark Grey for White | 4 TRACKS WASH
A.MIG-1002 Tracks Wash | 6 DUST
A.MIG-3004 Europe Earth | 8 GREASE & OIL
A.MIG-1408 Fresh Engine Oil |

2020/1010

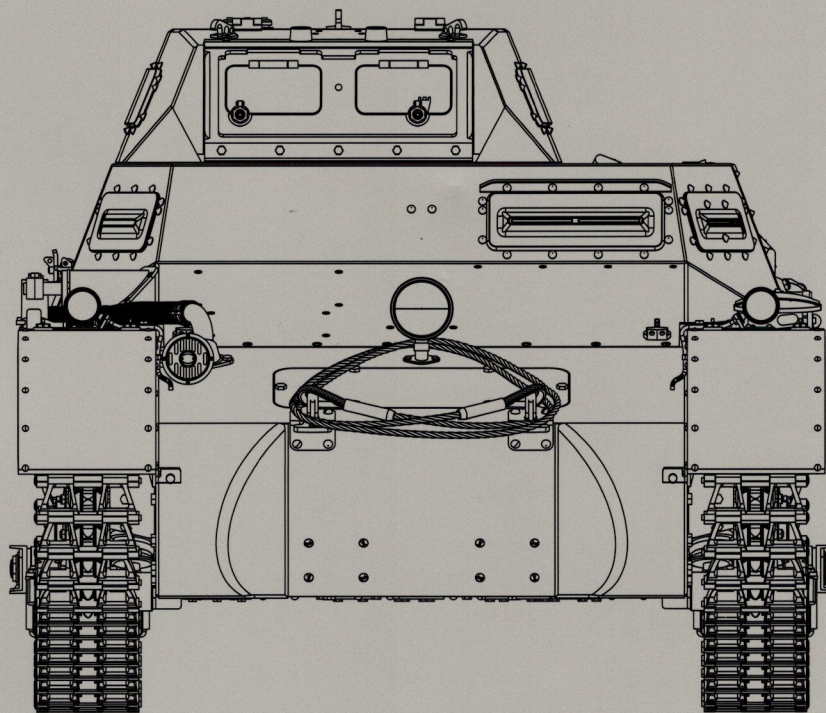

You can find TAKOM on Facebook.com

Panzer Regiment 31, 5th Panzer Division,
Pszczyna, Poland, September 1939



Color info and profiles by

1. Kompanie, Panzer Regiment 6,
3rd Panzer Division, France, June 1940



UNIT E, 15F, CH
HENNESSY RO
HONG KONG

© 2020 TAKO
WWW.TAKO

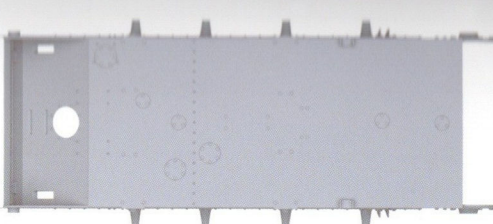
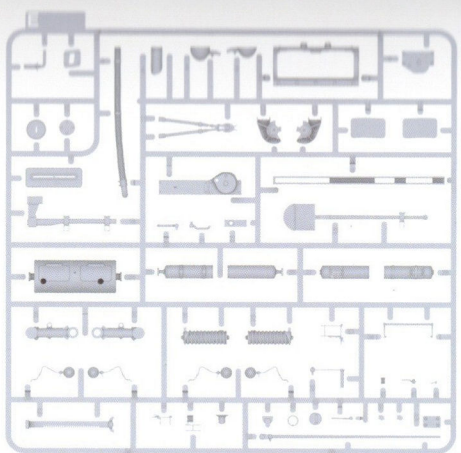
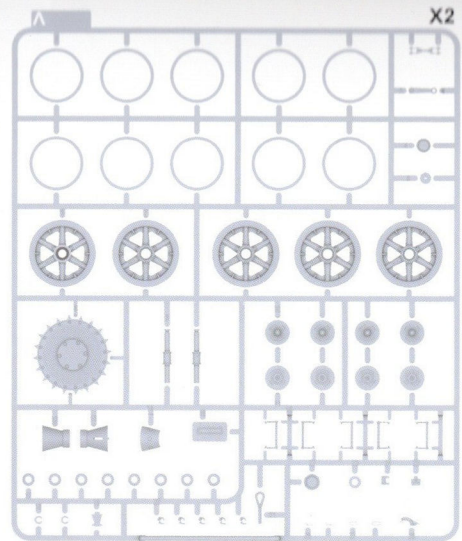
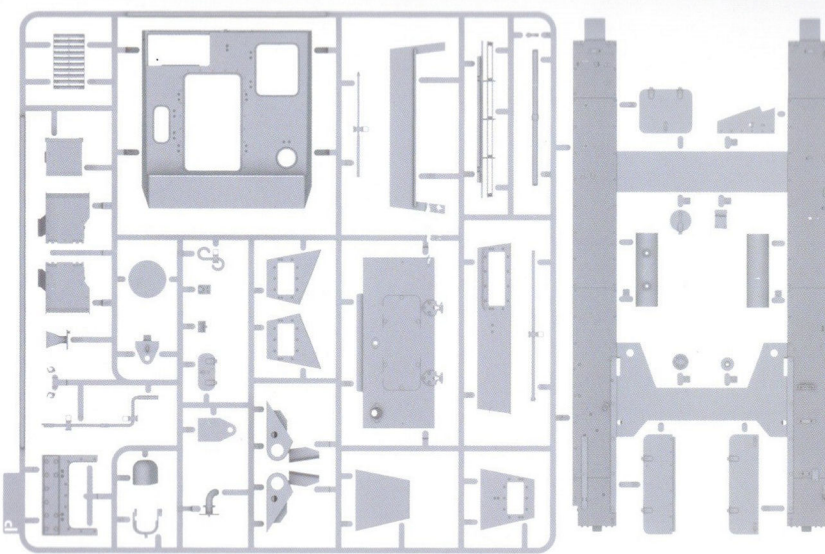
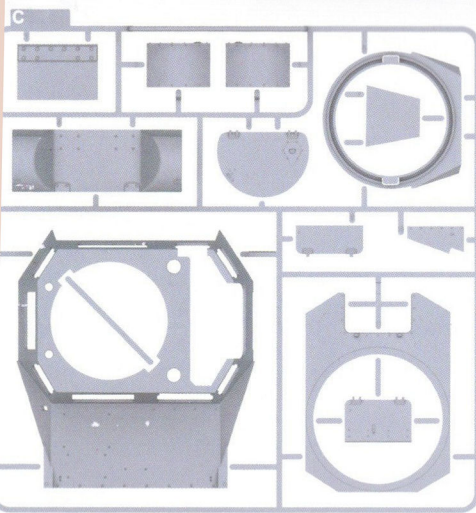

Lower Hull

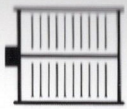

J X10



Turret

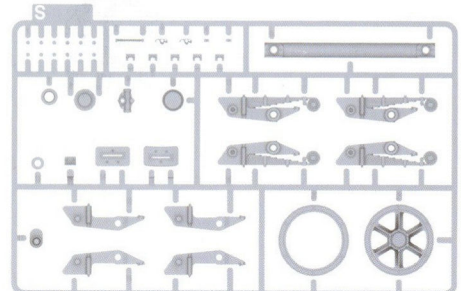

X2



Decal



H X20

Cable



TP

