



ZIS-5V

w WOJSKU POLSKIM

1:72

model # CP72053

ADVANCED



LENGTH: 84,1 mm



WIDTH: 30,1 mm



NUMBER OF PARTS: 125 pcs

scale model kit

- | | |
|----------------------------------|------------------------------|
| 1 stages of assembly | ? optional |
| A variants of assembly | glue by super glue |
| A1 part number | do not glue |
| fill with putty | make a hole |
| 1 apply decals | detach with knife |
| 1 apply the adhesive mask | paint |
| bend | repeat the operation N times |

This soviet truck was a simplified version of the AMO-3/ZIS-5 multipurpose vehicle, based on the components of the U.S.-made Autocar Dispatch SA truck. It had a load capacity of 3,000 kilograms. The Cyrillic letter "B" (pronounced as V) in the vehicle index stands for "voenny" ("military"). However, it refers to the war-time period of manufacture, when fewer and simpler parts were used for higher cost-effectiveness, rather than a specific set of military equipment.

In October 1941, the ZIS-5 production line was moved to the Ural region. Initially, the trucks were manufactured in Ulyanovsk, and later in Miass, both subject to severe austerity measures. The truck's design was significantly modified, for instance the shape of the fenders was altered to rule out press forging. Front brakes, engine pan protection, and metal cabin step covers were discarded. A single headlight was often installed, and there was no horn. The original cabin was replaced with a structure made from wooden planks, and the cargo platform was simplified, with only swing tailgate left.

By the summer of 1942, when the capture of Moscow did not seem such a dire threat anymore, the assembly and repair of ZIS-5 trucks was partially resumed at the Moscow plant. ZIS-5B trucks made by different factories during various production phases would often have major distinctions. The wheels of ZIS-5 were the same as those of American trucks, which is why the military variants were equipped with lend-lease Firestone tires with a "chevron" tread pattern.

The ZIS-5B was produced at the ZIS factory from 1942 to 1946 (126,215 units, of which 66,900 during the war years), at the Ulyanovsk ZIS factory from 1942 to 1944 (10,400 units), and at the Ural ZIS factory from 1944 to 1947 (8,500 during the war years). A total of 84,100 units were produced during the war.

REQUIRED PAINTS



A MR.COLOR C33
BLACK



B MR.COLOR C511
GREEN 4B0



C MR.COLOR C137
TIRE BLACK



D MR.COLOR C61
BURNT METALL



E MR.COLOR C8
SILVER



F MR.COLOR SM212
AlIal SILVER
ALUMINIUM



G MR.COLOR C47
RED CRYSTAL

THIS MODEL IS PRODUCED FOR EXPERIENCED MODELERS OVER 14 YEARS

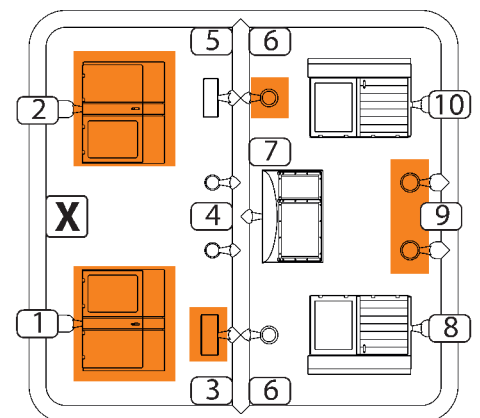
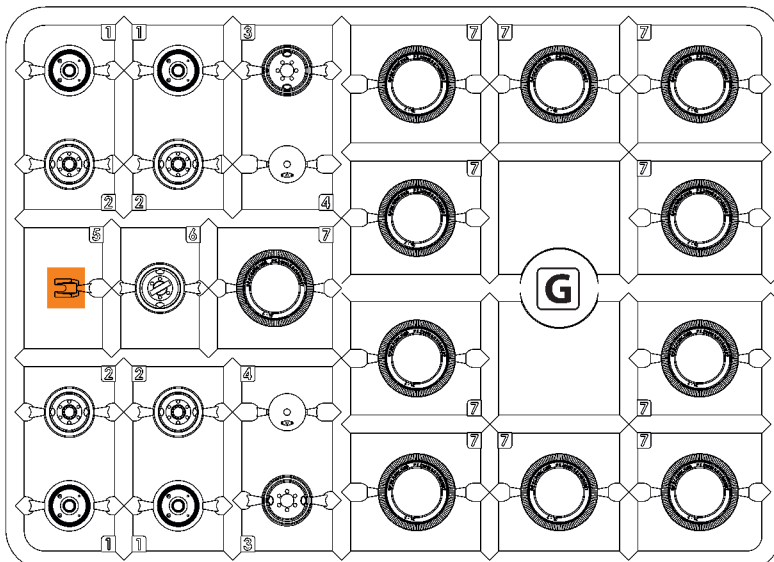
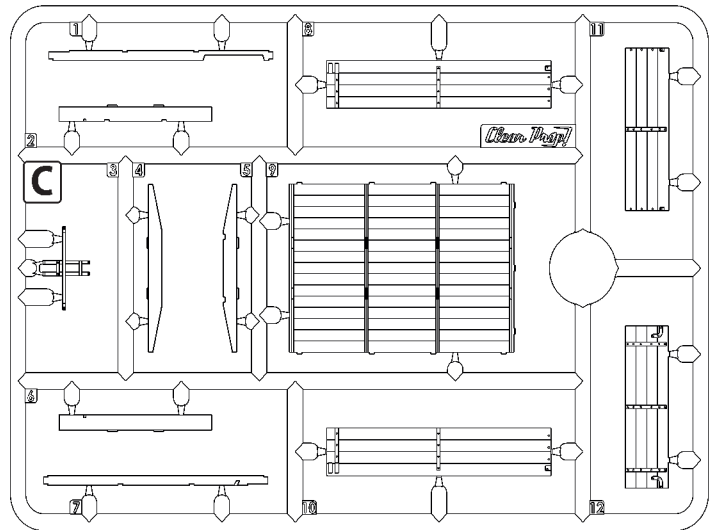
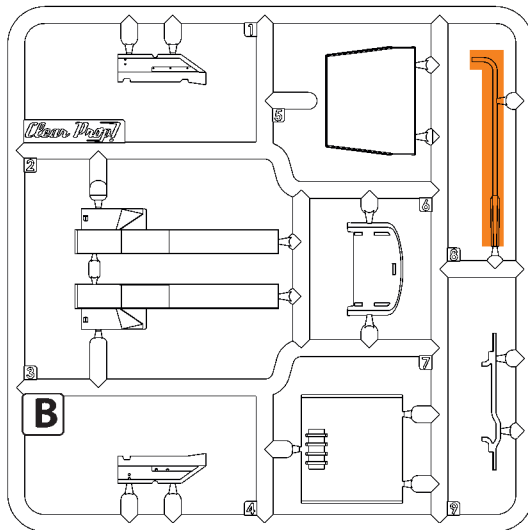
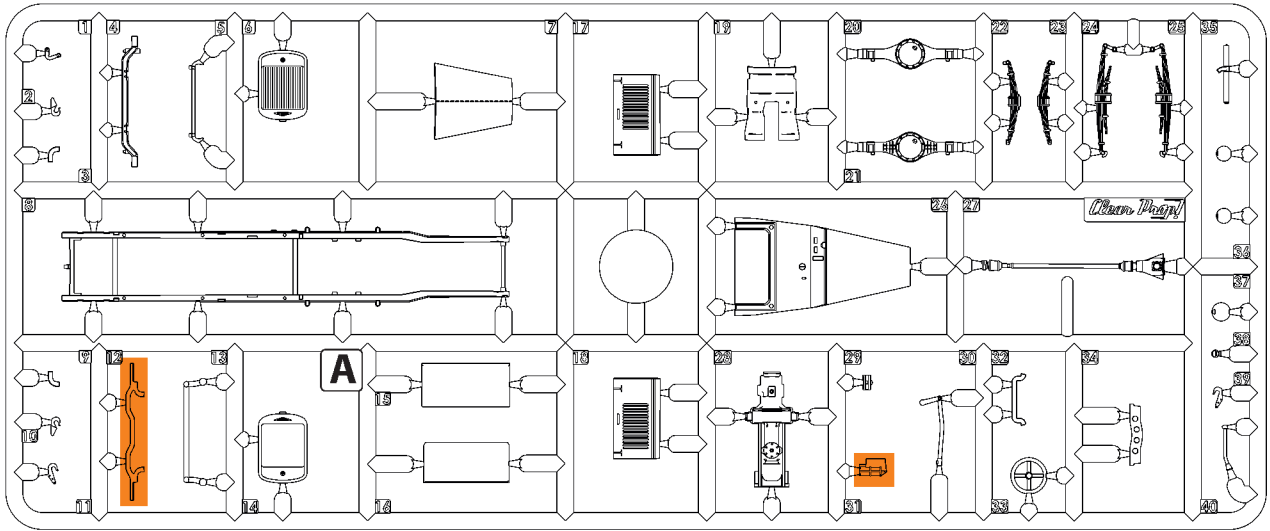

Parts not for use

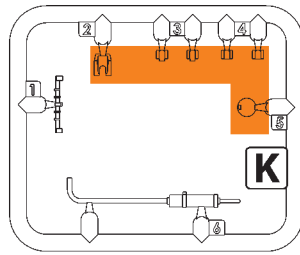

DECAL SHEET

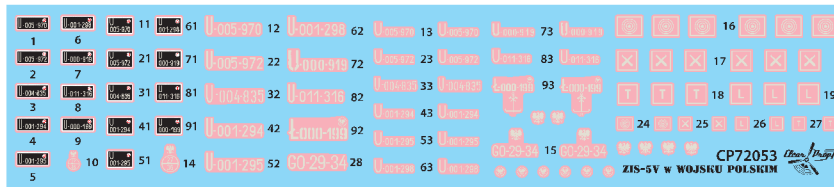

PHOTOETCHED PARTS

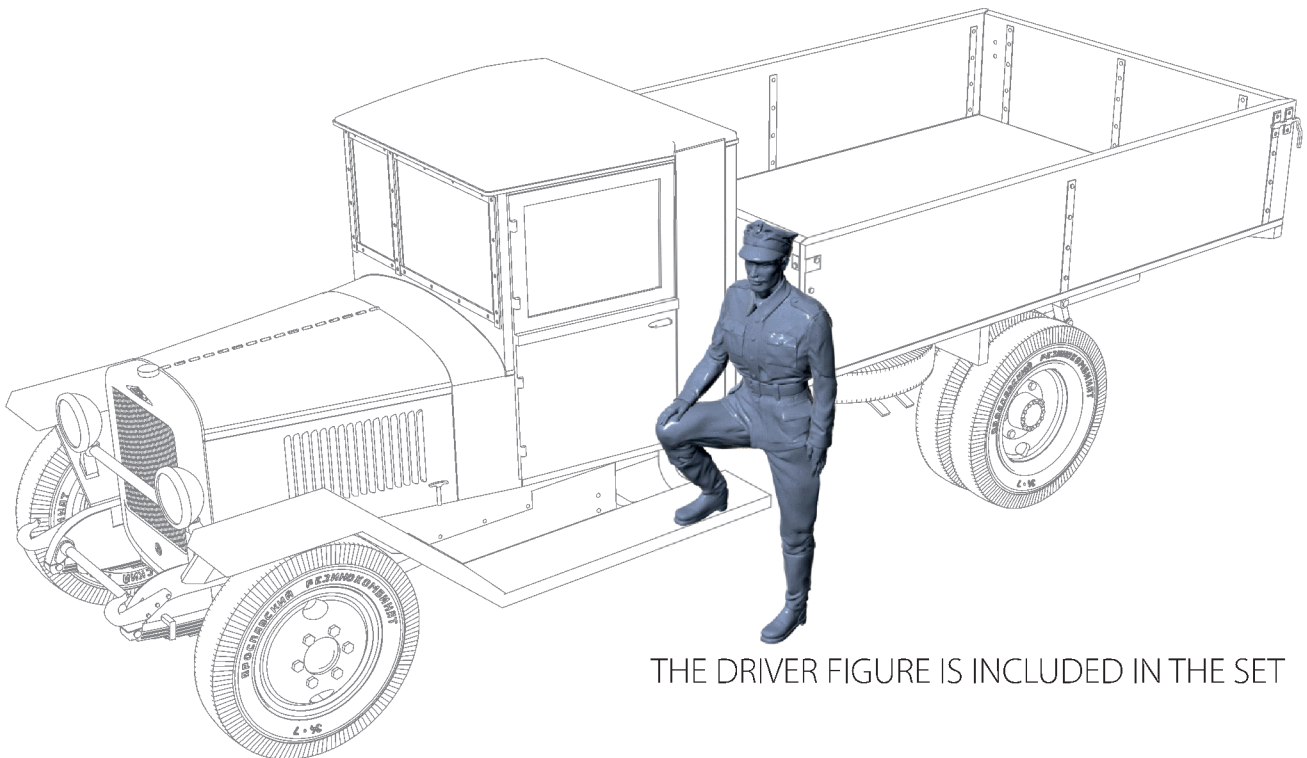
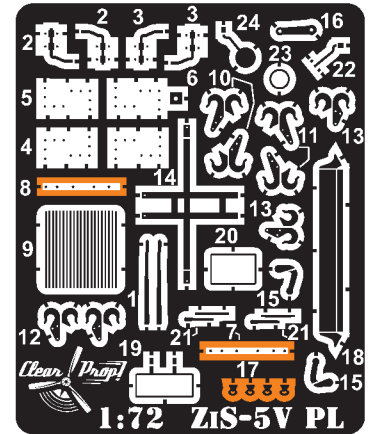

THE DRIVER FIGURE IS INCLUDED IN THE SET

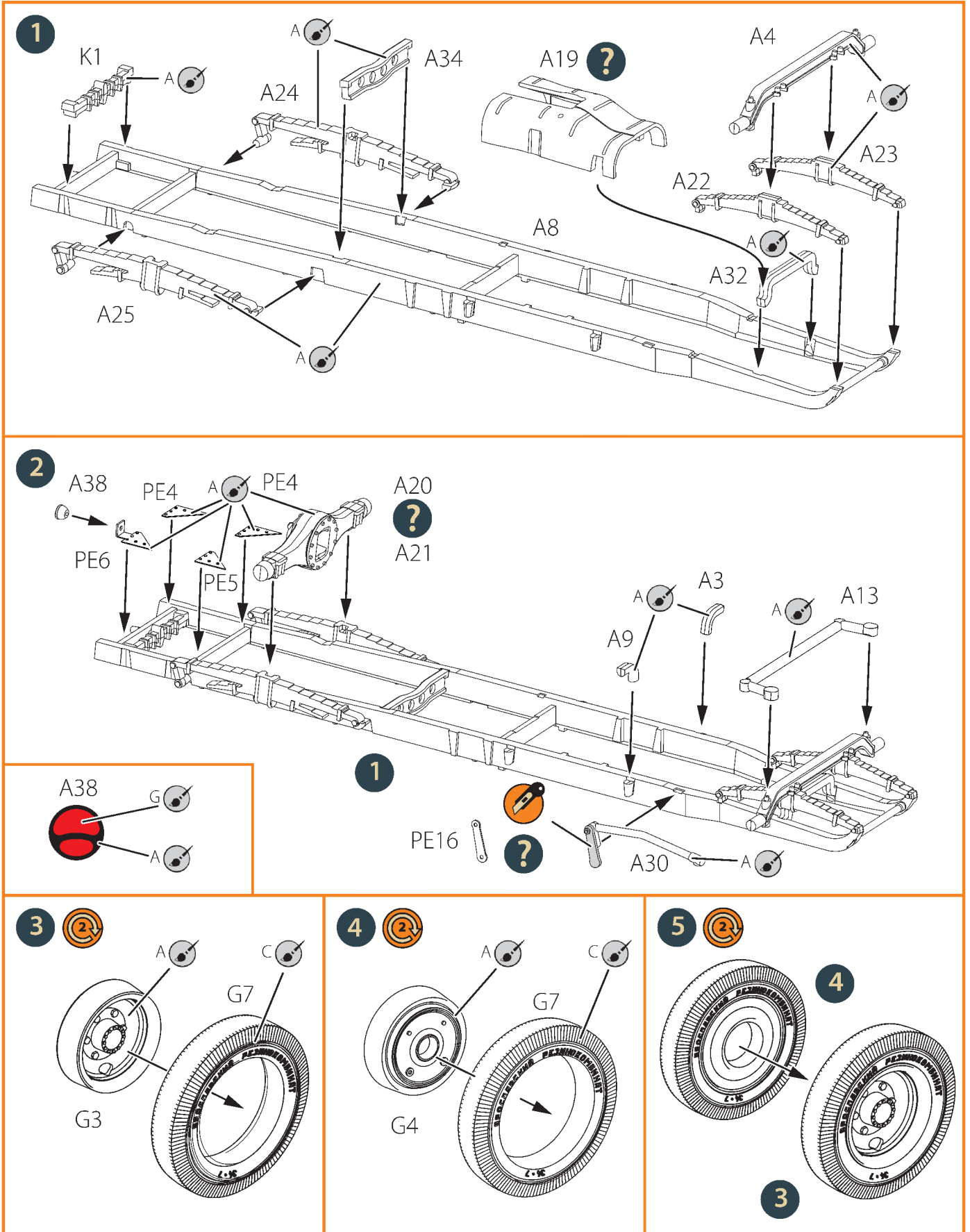

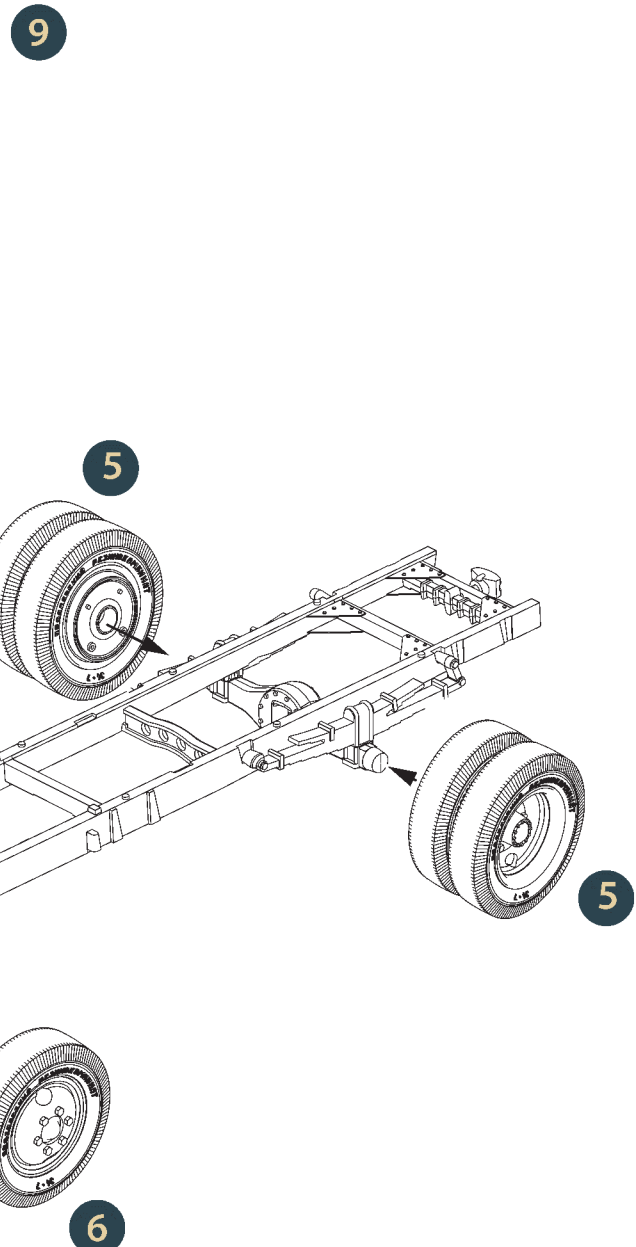

10

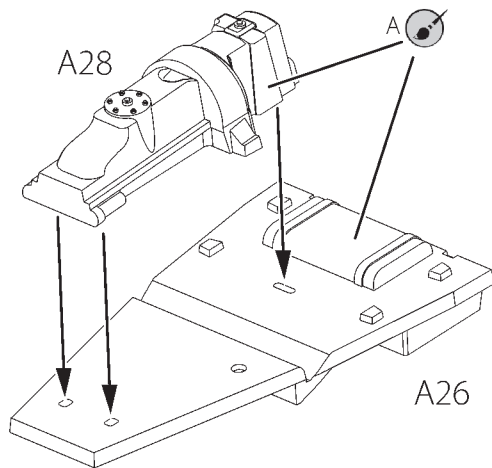

11

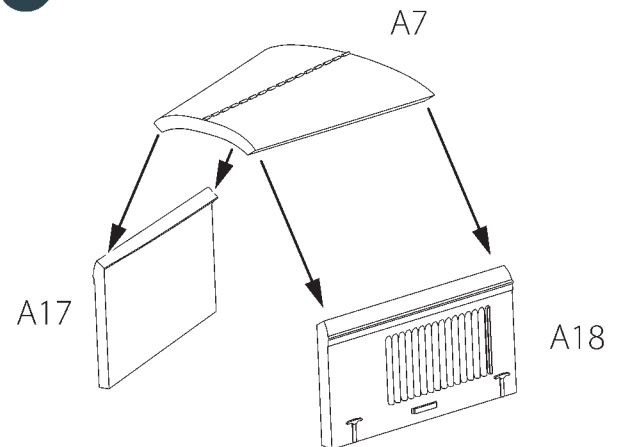

12

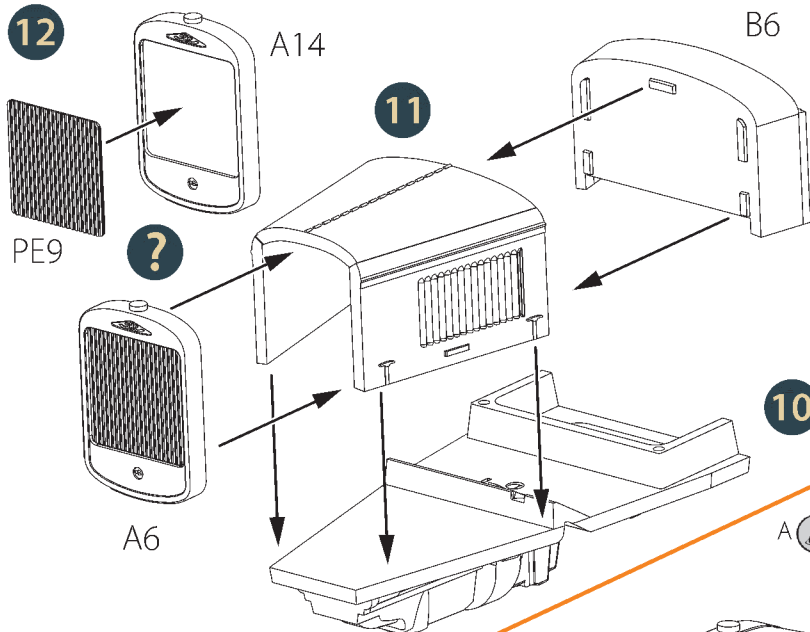

13

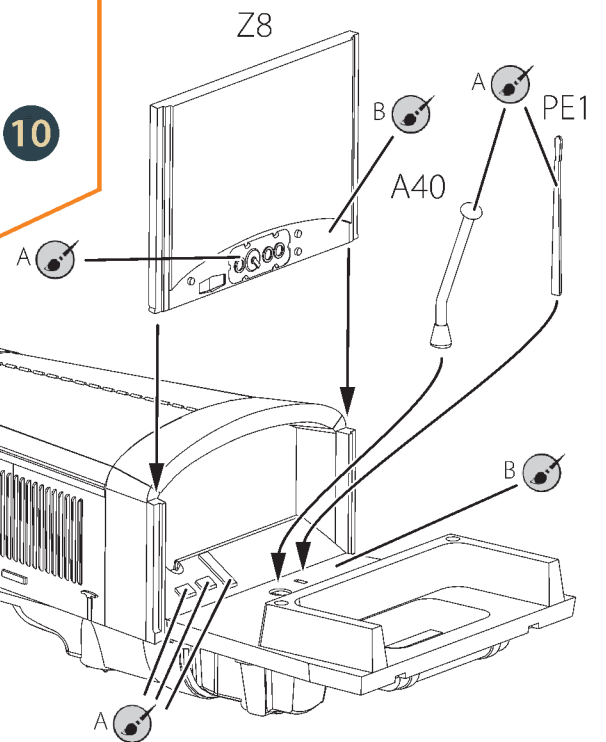

14

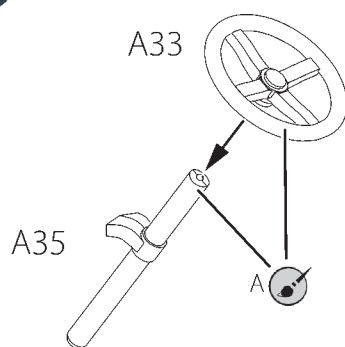

12

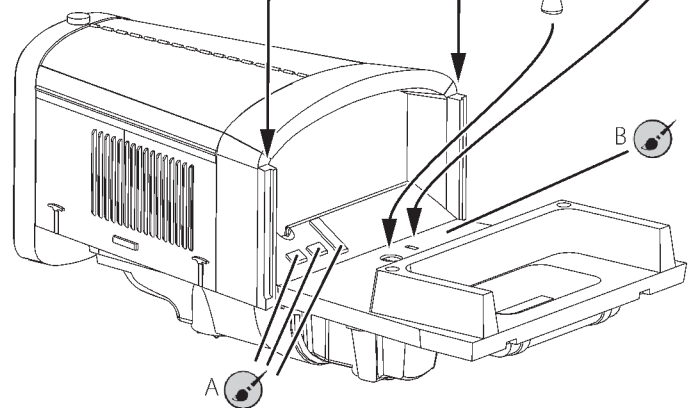

15

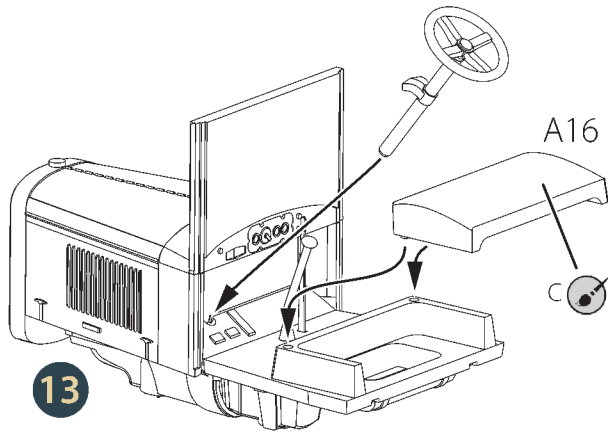

16

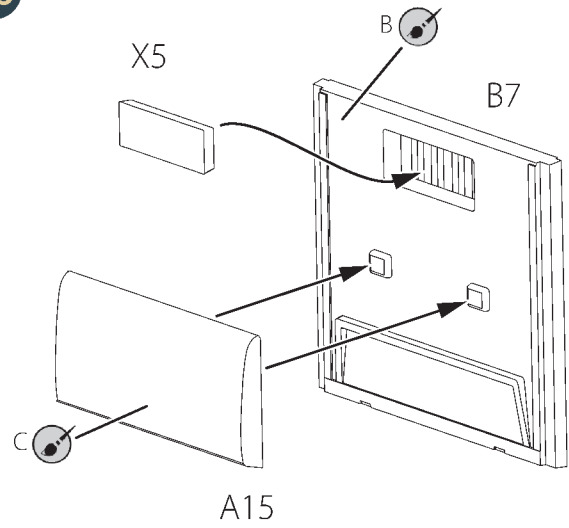

17

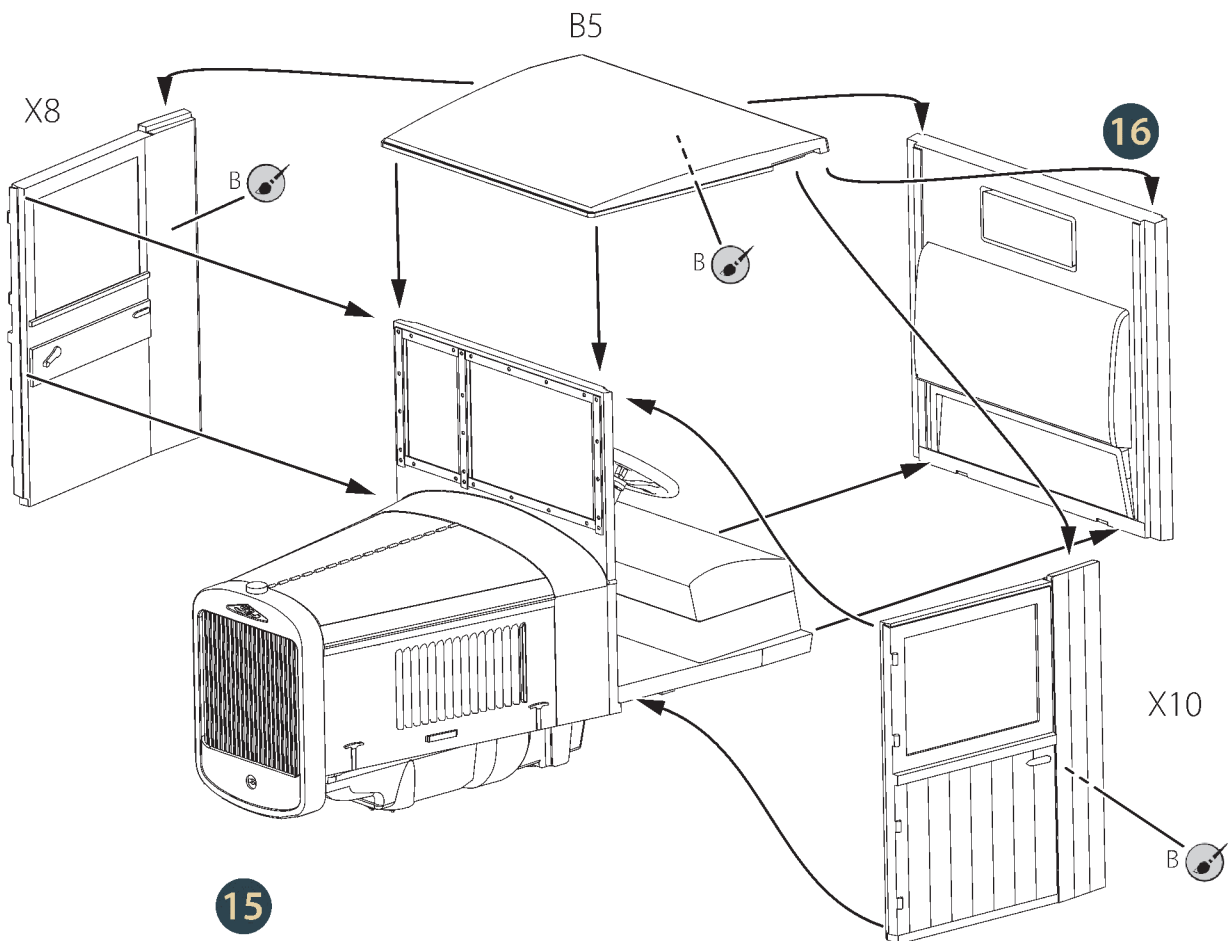

18

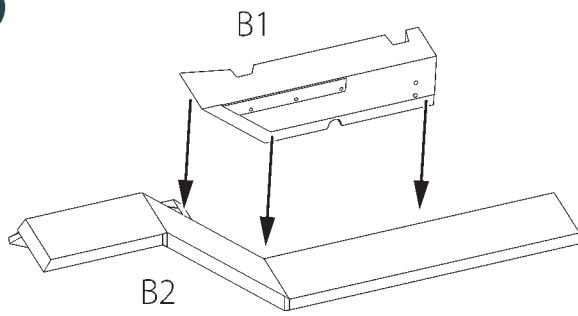

19

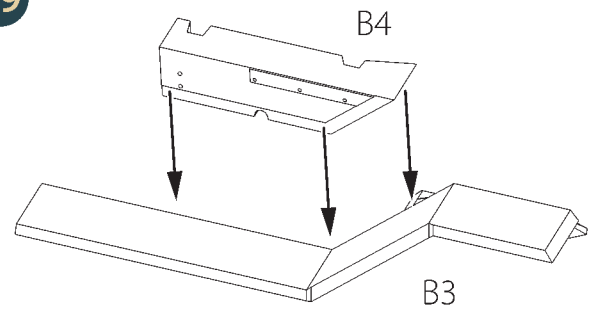

20

17

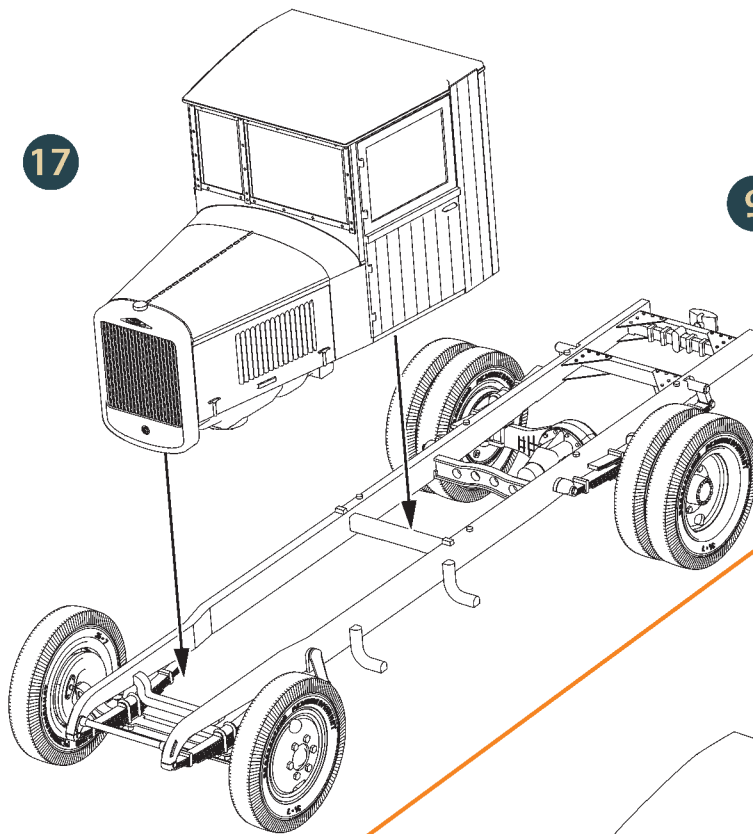

9

21

19

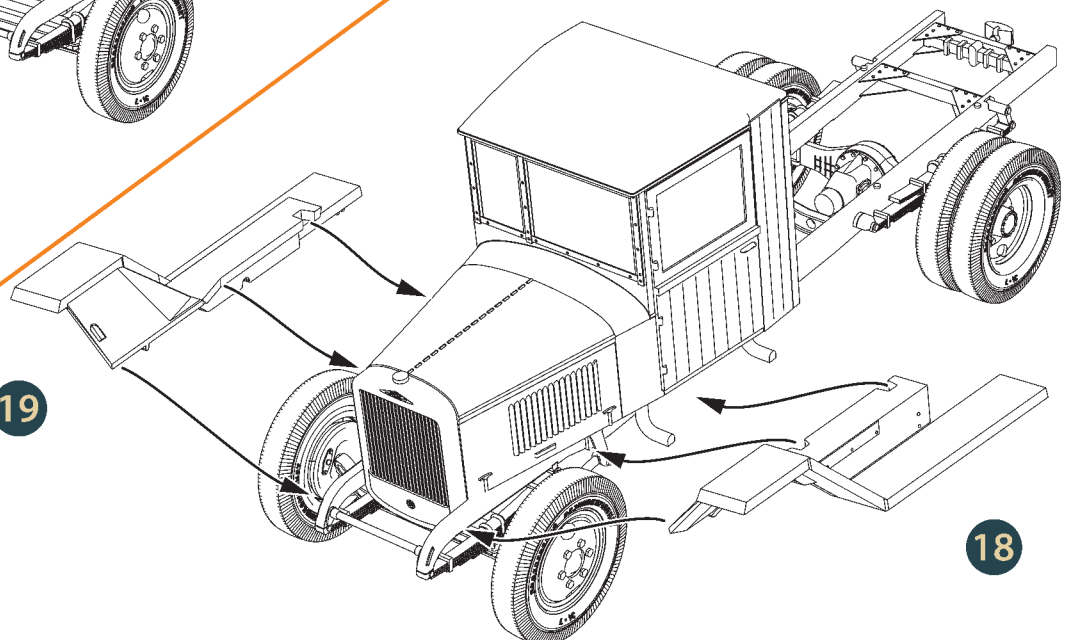

20

18

22

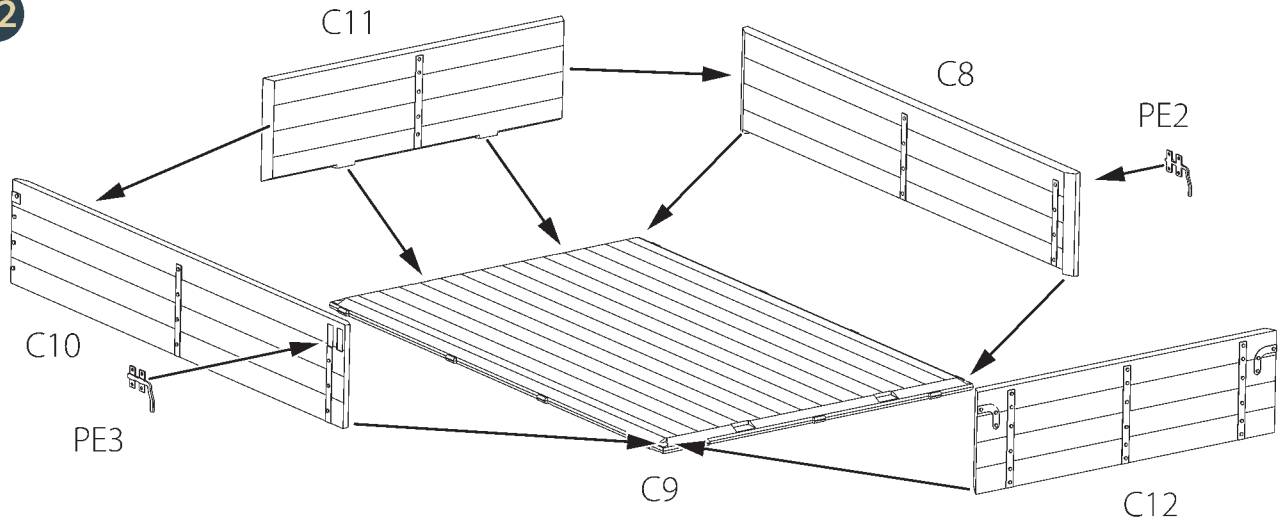

23

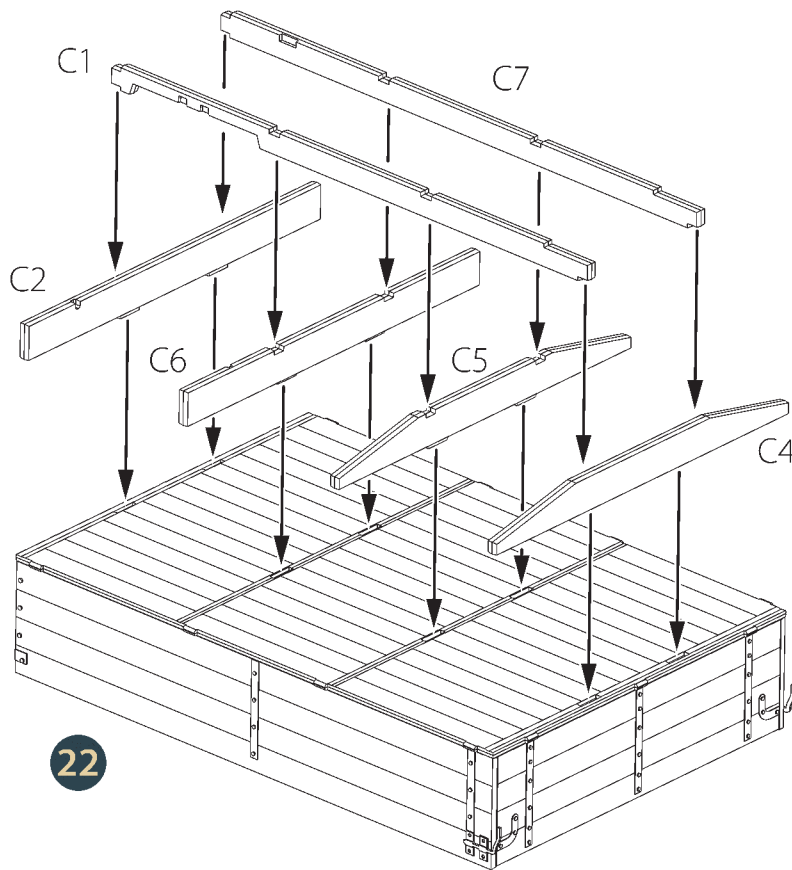

24

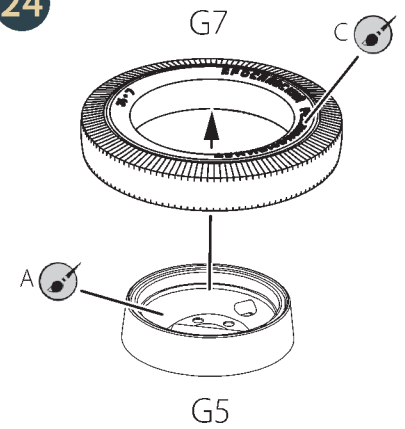

25

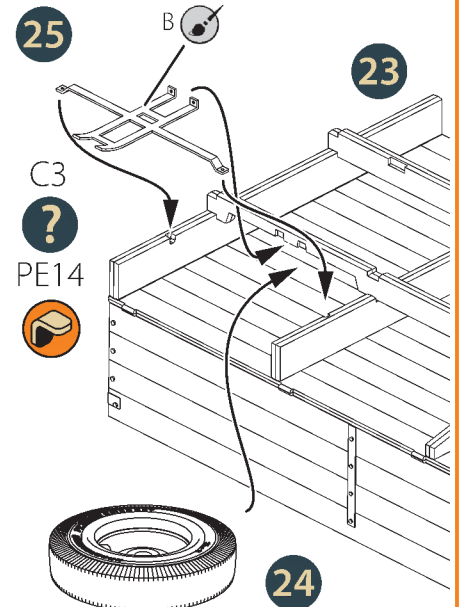

26

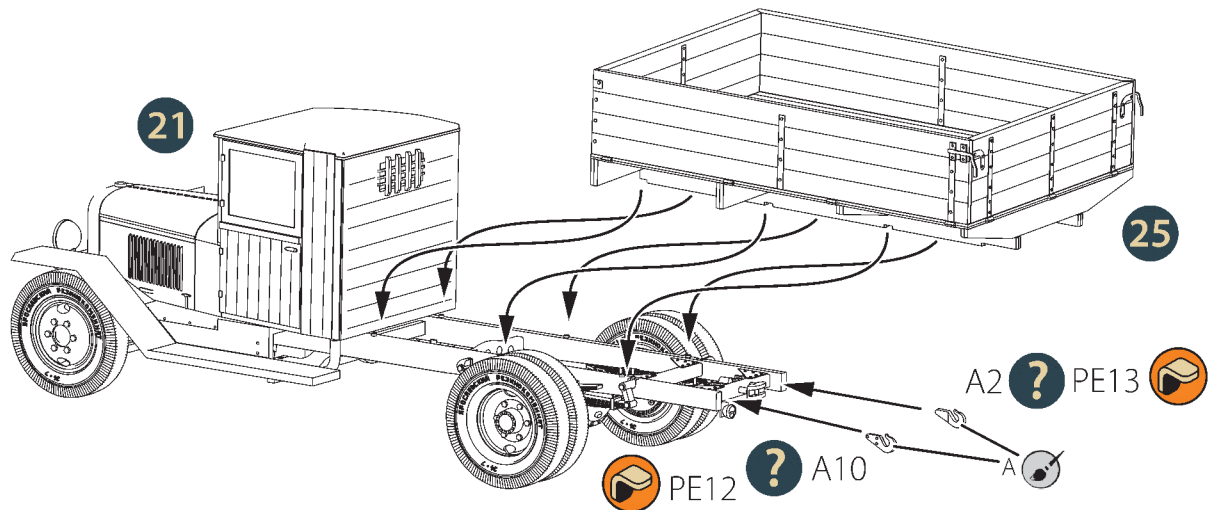

27

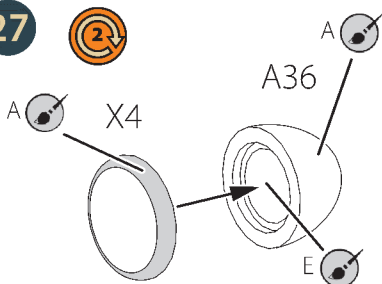

29

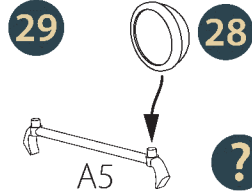

28



27



26

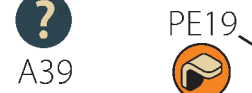

25



24



23



22



21



20



19



18



17



16



15



14



13



12



11

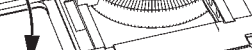

10



9



8



7



6



5



4



3

2

1

0

-1

-2

-3

-4

-5

-6

-7

-8

-9

-10

-11

-12

-13

-14

-15

-16

-17

-18

-19

-20

-21

-22

-23

-24

-25

-26

-27

-28

-29

-30

-31

-32

-33

-34

-35

-36

-37

-38

-39

-40

-41

-42

-43

-44

-45

-46

-47

-48

-49

-50

-51

-52

-53

-54

-55

-56

-57

-58

-59

-60

-61

-62

-63

-64

-65

-66

-67

-68

-69



clearpropmodels.com

MORE SCALE MODEL KITS



VISIT OUR SITE FOR MORE SCALE MODEL KITS

clearpropmodels.com



**ZIS-5V
WHEEL SET**
ACCESSORIES SET FOR
CLEAR PROP KIT
1:72
#CPA72182



3D PRINT

NUMBERS OF PARTS: 7 pcs



**ZIS-5/5V/6,
BZ-35/39
PAINTING MASK**
ACCESSORIES SET FOR
CLEARPROP
ZIS-5/5V/6, BZ-35/39 KITS
1:72
#CPA72103



**PAINTING MASK
DOUBLE-SIDED**

NUMBER OF PARTS: 19 pcs



**ZIS-5/5V/BZ39
RADIATOR**
FOR CLEAR PROP KITS
1:72
#CPA72118



RESIN

NUMBERS OF PARTS: 1 pcs



sales@clearpropmodels.com



www.fb.com/Clearpropmodels