





**CAUTION!**

**-주의-**

◀READ THIS BEFORE YOU BEGIN▶  
 ◀ALLGEMEINE HINWEISE▶  
 ◀LISEZ CE QUI SUIT AVANT DE COMMENCER LE MONTAGE▶  
 ◀組み立てる前に▶  
 ◀조립하기 전에 먼저 읽어주세요▶

**◀READ THIS BEFORE YOU BEGIN▶**

- Study the instructions before assembling. → Check the list of each place before cementing into place.
- Do not use too much cement to join parts. → Never use cement or paint near open flame.
- Open a window or make area well ventilated when cement or paint is in use.
- Tear up and throw away the empty plastic bags to avoid danger of suffocation for little children.

**◀ALLGEMEINE HINWEISE▶**

- Die Anordnung der Bauteile ist aus den Zeichnungen der Anleitung ersichtlich.
- Die Teile vor dem Verkleben ungelagert zusammenhalten, um ihnen feilscht zu prüfen.
- Klebstoff nicht zu dick auftragen. → Klebstoff und Farben niemals in der Nähe einer Flamme verwenden.
- Während der Bemalung mit Spritzpistole oder Pinsel für frische Luftzufuhr, z.B. Öffnen des Fensters, sorgen.
- Bauzeit von Kleinen Kindern fernhalten. Verhüten Sie, daß Kinder irgendwelche Bauteile in den Mund nehmen oder Plastikfolie über den Kopf ziehen.

**◀LISEZ CE QUI SUIT AVANT DE COMMENCER LE MONTAGE▶**

- Étudier les schémas d'emballage. → Contrôler que chaque pièce soit bien conforme avant de la coller à sa place.
- Ne laissez pas trop de colle pour joindre les pièces. → Ne laissez manipuler la colle ou peinture à proximité d'une flamme.
- Aller soigneusement la pièce où vous peignez (avant la lecture).
- Après avoir sorti les pièces du sac en plastique, déchirer le sac afin d'éviter que les enfants ne le mettent sur la tête et ne s'étouffent.

**◀組み立てる前に▶**

- 組み立てる前に仕様書をお読み下さい。→ 部品をランナーから取り出す時は慎重にニッパーとカッターを使用します。
- 接着剤を少なすぎた状態にすることがおそれられることがあります。→ 接着する前に部品を合わせて確かめます。
- 塗料や絵具を使用する時は必ず新鮮な空気が流れるようにして下さい。
- 組み立てる際の袋やプラスチック袋は小さなお子様の手の届かない場所に保管して下さい。

**◀조립하기 전에▶**

- 부품들 조립하기 전에 설명서를 잘 읽어본 후 조립한다.
- 접착하기 전에 부품들 맞추어 확인한 후 조립한다.
- 부품을 자를 때에는 반드시 니퍼나 칼로 잘라내야 한다.
- 접착제를 사용할 곳과 사용하지 않는 곳에 주의하고 너무 많이 바르지 않도록 한다.
- 예-바른 색연필이나 점성제를 사용할 때는 창문을 열어 환기를 시키고 화기를 끌라한다.
- 사용 후 남은 부품은 어린 아이들의 손이 닿지 않도록 잘 처리한다.



- Use tweezers for small parts.(not included)
- 작은 부품의 조립시 핀셋을 사용하면 편리합니다. ( 핀셋은 별매 입니다. )

※ Attach 1 first  
 1 번 부터 조립하십시오.

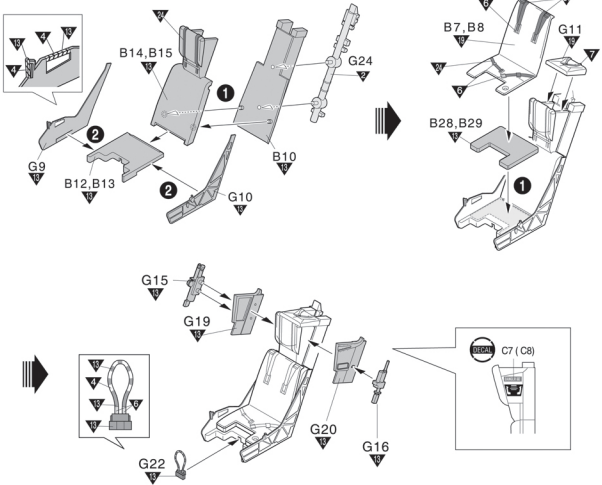

■ Front Instrument / 전방 계기판

■ Rear Instrument / 후방 계기판

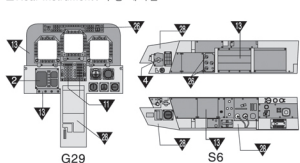
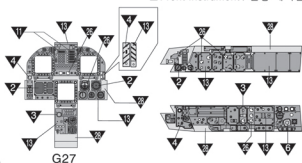

2

■ Front Instrument / 전방 계기판

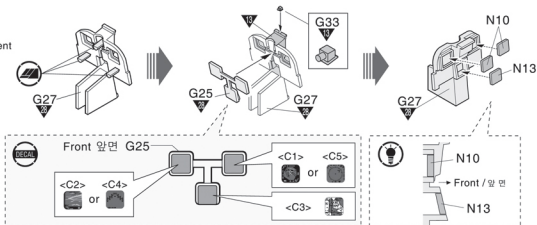

■ Rear Instrument / 후방 계기판

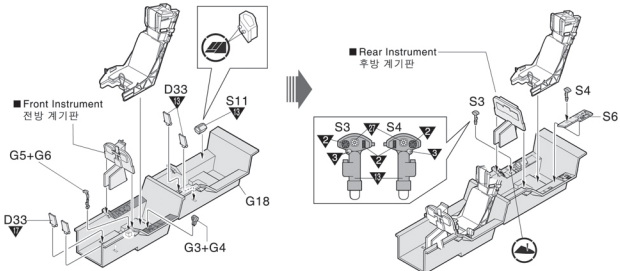
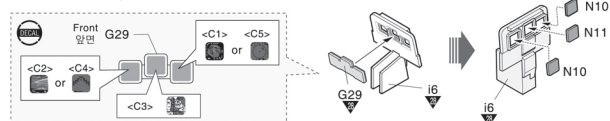

**3** 

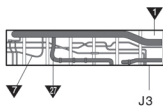
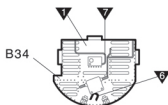
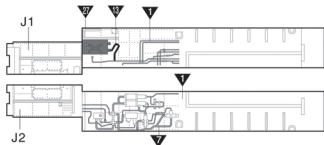
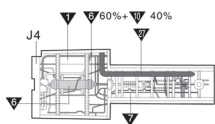
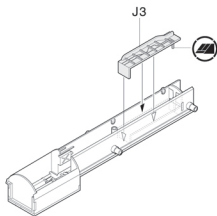
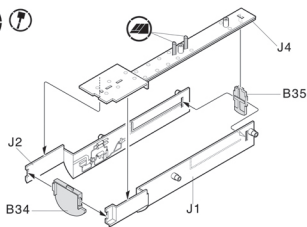

**4** 



Finish using file.(not included)  
이 표시 부분은 줄로 깨끗이 다듬어 주십시오.



Secure using instant glue(not included).  
이 표시부분은 순간접착제로 접착해 주십시오.

\* OPTIONAL.  
취향에 따라 선택하십시오.

RUBBER TIRE(SMALL)  
고무타이어 (소)



× 2

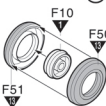

× 2

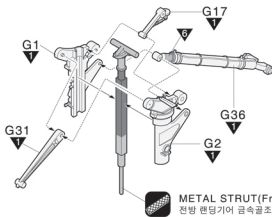

METAL STRUT(Front)  
전방 맨딩기어 금속골조

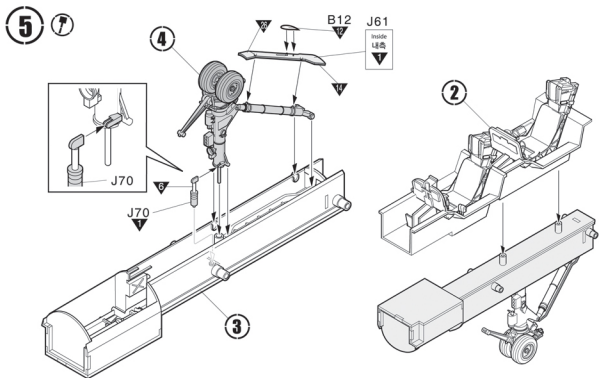
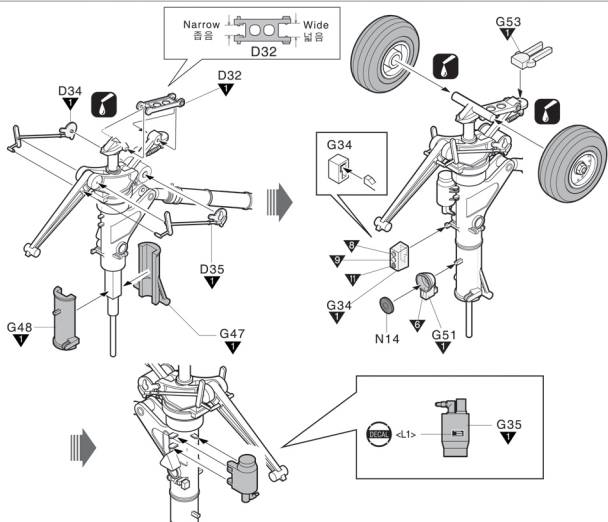

**6** 

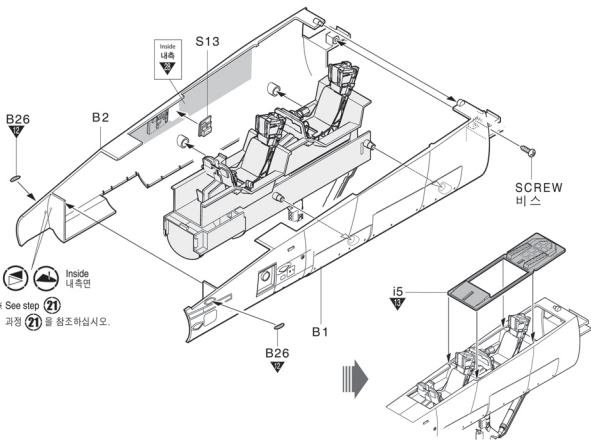
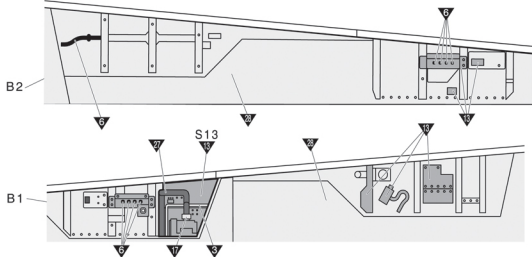
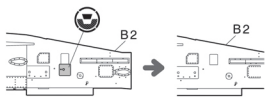
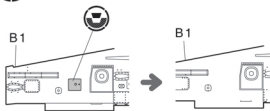

**7** 

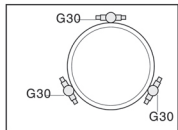
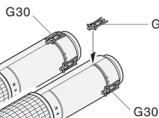
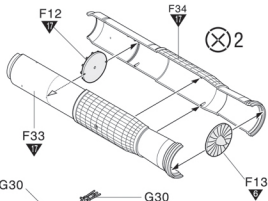
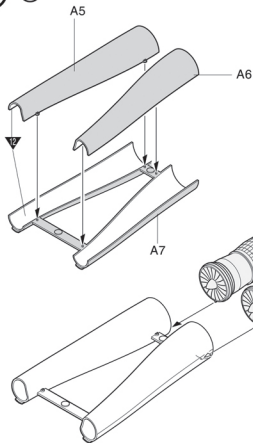

**8** 

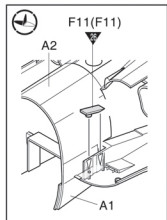
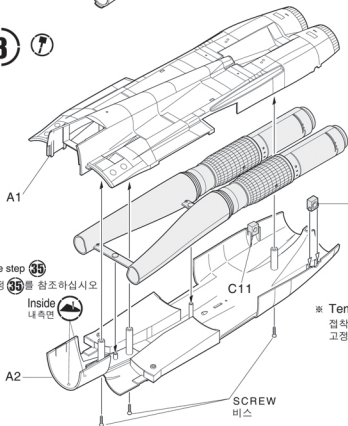

※ Note direction.  
방향에 주의하십시오.

※ See step 35  
과정 35를 참조하십시오

Inside  
내측면 

※ Temporarily hold with cellophane tape.  
접착제가 단단히 굳을 때까지 셀로판 테이프로 고정시켜 주십시오

SCREW  
비스

Extended / 편상태

→ See Step 9

과정 9를 참조하세요.

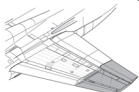

Folded/접은 상태

→ See Step 36-45

과정 36-45를 참조하세요.

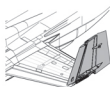

※ OPTIONAL.  
취향에 따라 선택하십시오.

9 7

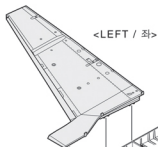
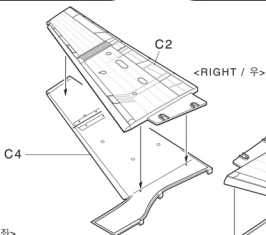

<LEFT / 좌>

C1

C3

Inside  
내측면

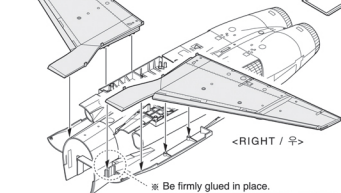

<RIGHT / 우>

※ Be firmly glued in place.  
이 부분은 확실하게 접착하여 주십시오.

※ Temporarily hold with cellophane tape.  
접착제가 단단히 굳을때까지 셀로판 테이프로 고정시켜 주십시오.

※ ( ) is opposite number.  
( )는 반대측 번호입니다.

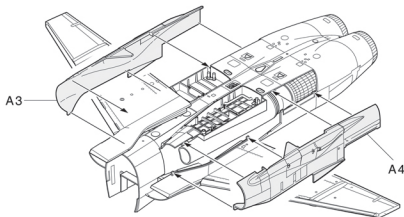

A3

A4

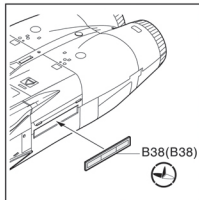

B38(B38)



※ Temporarily hold with cellophane tape.  
접착제가 단단히 굳을때까지 셀로판 테이프로 고정시켜 주십시오.



**10** 

※ Attach **1** first  
**1**번 부터 조립하십시오.

※ Temporarily hold with cellophane tape.  
 접착제가 단단히 굳을때까지 셀로판 테이프로 고정시켜 주십시오.

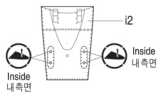

※ See step **32**.  
 과정 **32**를 참조하십시오.

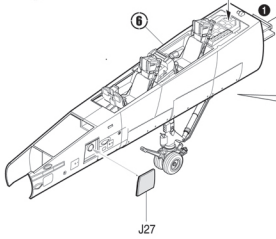

**11** 

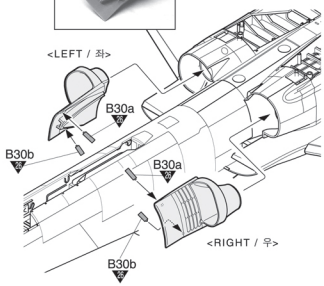
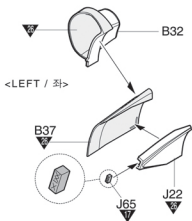
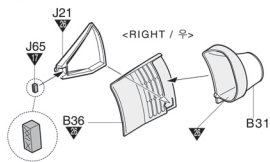

12

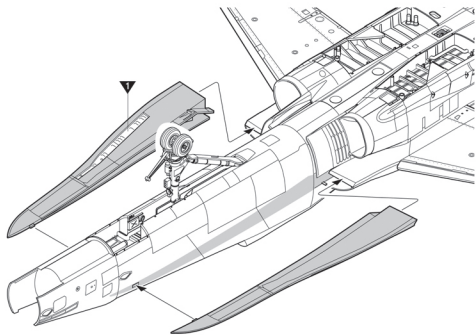
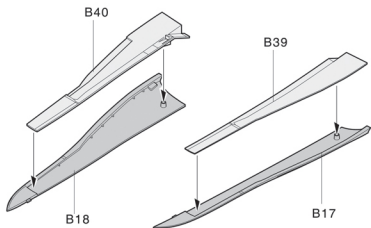

13



<RIGHT / 우>

<LEFT / 좌>

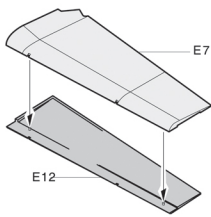
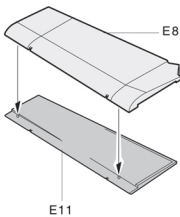



★ : Select either various angles of the flaps.  
 : 원하는 각도를 선택하십시오.

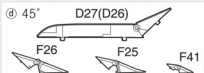
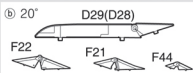

※ Ex) Angle a) (0°)

a) 각도 (0°) 조립시의 예입니다.

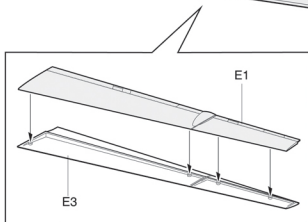
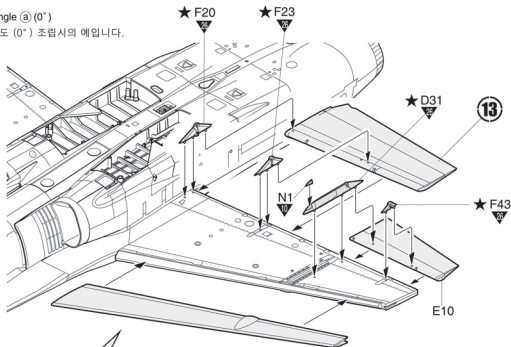

※ Do not use S14, S15, S16 & S17  
 when assemble Angle a) (0°).

각도 a) 상태로 조립시엔 S14, S15, S16, S17은  
 사용하지 않습니다.

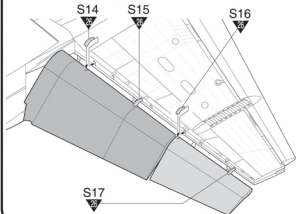

**15** 

※ Ex) Angle @ (0°)

@ 각도 (0°) 조립시의 예입니다.

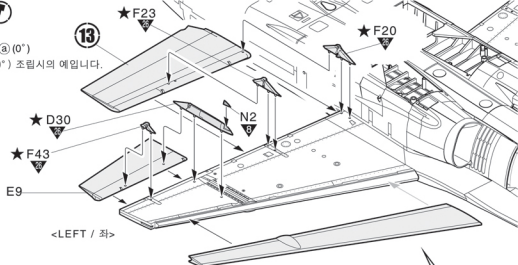



※ Do not use S14, S15, S16 & S17 when assemble Angle @ (0°).

※ 각도 @ 상태로 조립시엔 S14, S15, S16, S17은 사용하지 않습니다.

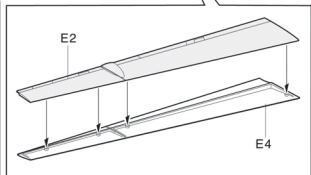
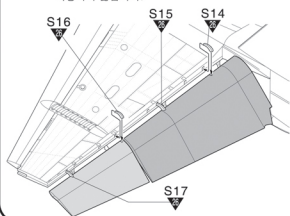

**16** 

※ Angle @ (0°)

각도 0° (@상태)로 조립될 경우

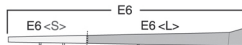
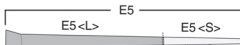

<LEFT / 좌>

 Inside  
내측면

 Inside  
내측면

<RIGHT / 우>

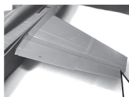
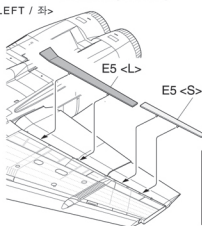

Angle @ (0°)  
각도 0° (@상태) E5 (E6)

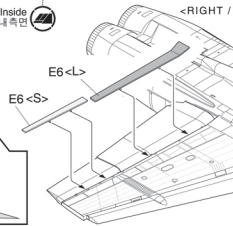

**17**

※ Angle (b), (c), (d) (20°~45°)  
 각도 20°~45°(b, c, d 상태)로 조립될 경우

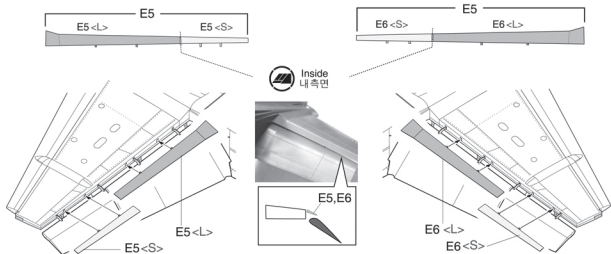
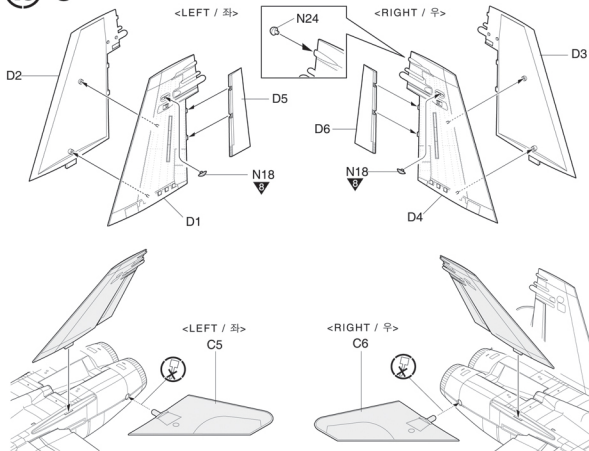
**18**

19



\* OPTIONAL.  
취향에 따라 선택하십시오.

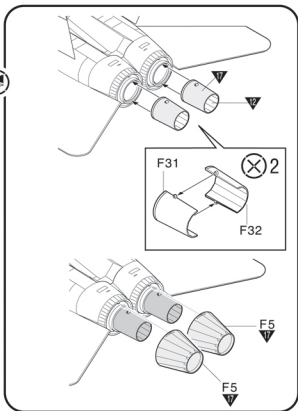
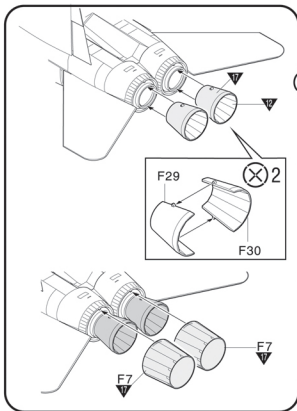

20

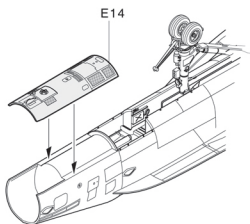
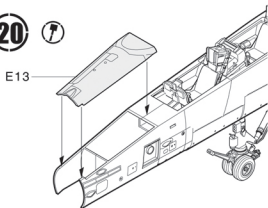

< IFF BLADE ANTENNA >  
■ IFF 블레이드 안테나

Inside

내측면



S12

S12 x 5

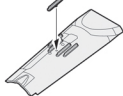

K

Inside  
내측면

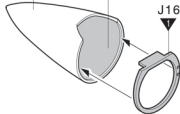

J16

※ OPTIONAL.  
취향에 따라 선택하십시오.

<CLOSED> 닫힌 상태

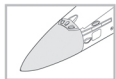

20

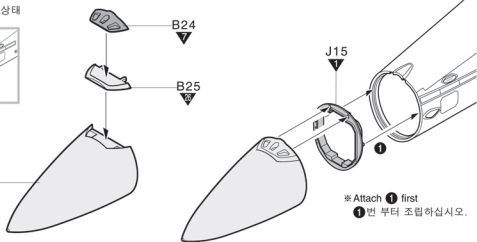

※ Attach ① first  
① 번 부터 조립하십시오.



<OPEN> 열린 상태

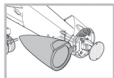

※ Attach ① first  
① 번 부터 조립하십시오.

 Movable. 가동됩니다.

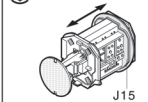
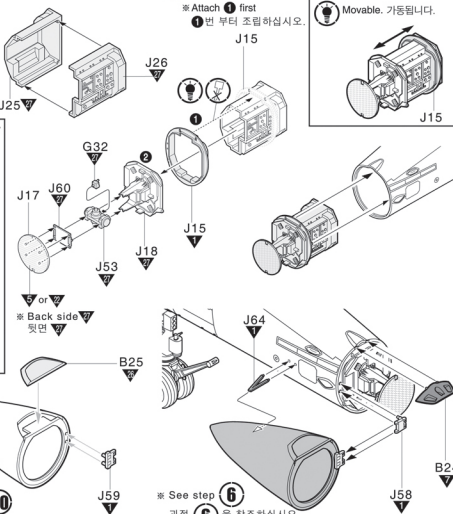
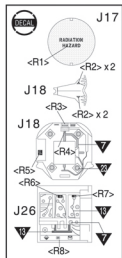

※ See step ⑥  
과정 ⑥ 을 참조하십시오.

22



<LEFT / 좌>



Finish using file.(not included)

이 표시 부분은 줄로 깨끗이 닦아주세요.

\* Attach 1 first

1번 부터 조립하십시오.



Strut of main landing gear(Left)

후방랜딩기어 금속부품 (좌측)

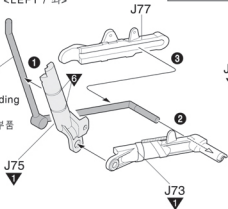

J71

3

D44

1

D43

2

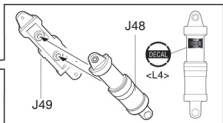

J49

J48

DECAL

<L4>

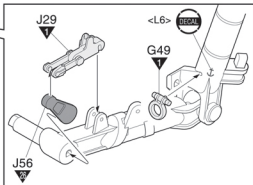
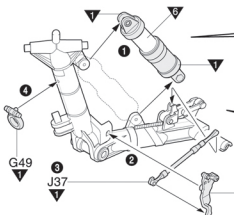

J29

DECAL

<L6>

J56

G49

\* OPTIONAL.

취향에 따라 선택하십시오.

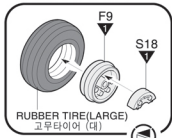
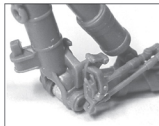

RUBBER TIRE(LARGE)

고무타이어 (대)

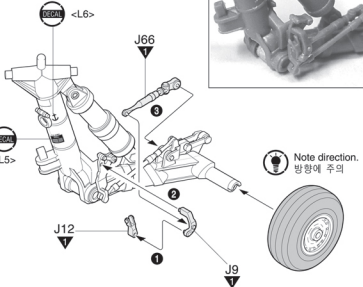
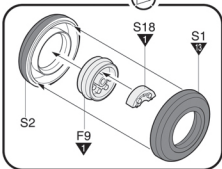

DECAL <L6>

J66

3

DECAL <L5>

J12

DECAL

Note direction.

방향에 주의

J9

1



**23** 

<RIGHT / 우>



Finish using file.(not included)

이 표시 부분은 줄로 깨끗이 닦아 주십시오.

※ Attach 1 first

1번 부터 조립하십시오.

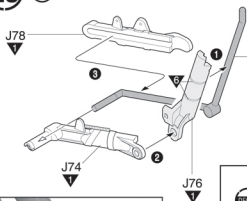

Strut of main landing gear(Right)  
후방랜딩기어 금속부품 (우측)

D42

3

D41

1

2

J72



<L4>

J50

J51

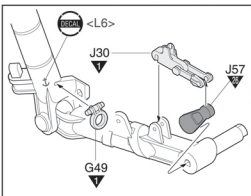

<L6>

J30

J57

G49

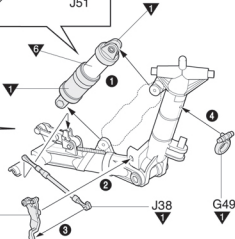

※ OPTIONAL.

취향에 따라 선택하십시오.

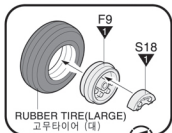
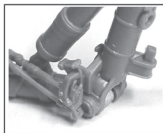

F9

S18

RUBBER TIRE(LARGE)  
고무타이어 (대)

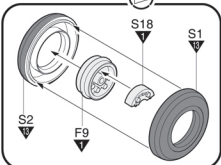

S2

F9

S18

S1



※ Note direction.  
방향에 주의



J66

3

2

1

<L6>

<L5>

J12

J10

\* ( ) is opposite number.  
 ( )는 반대쪽 번호입니다.

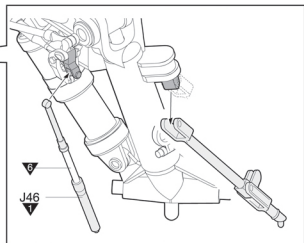
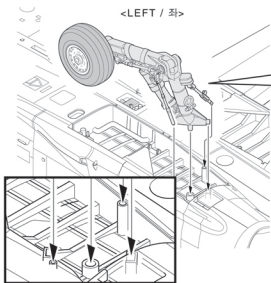
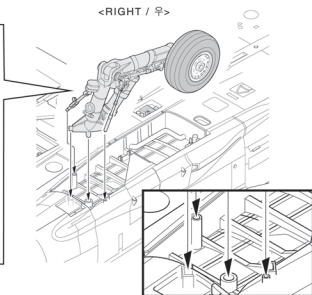
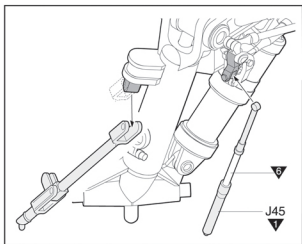
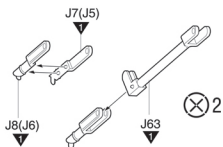
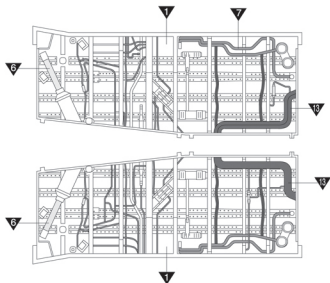



<RIGHT / 우>

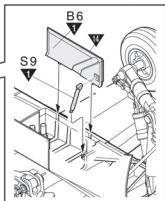
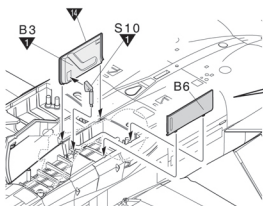
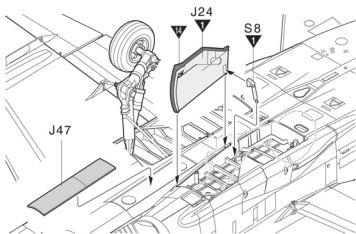

<LEFT / 좌>

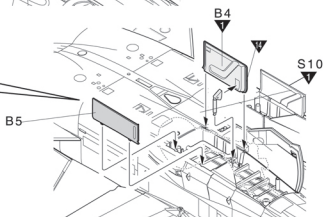
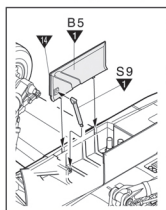
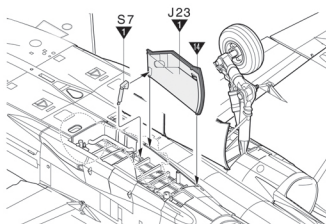

27

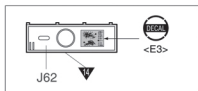
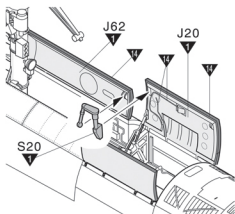
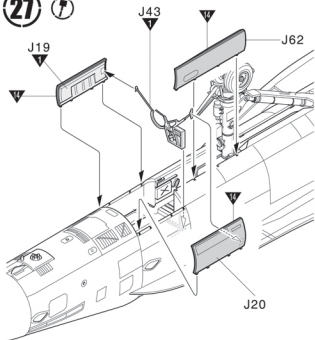

28

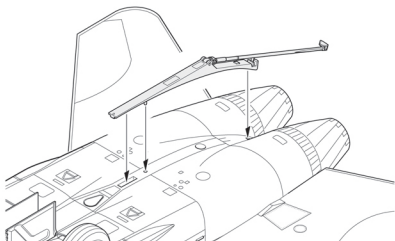
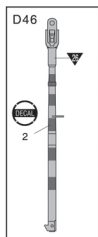
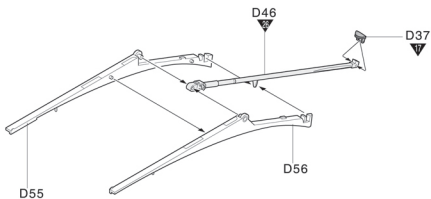

**29** 

※ OPTIONAL.  
취향에 따라 선택하십시오.

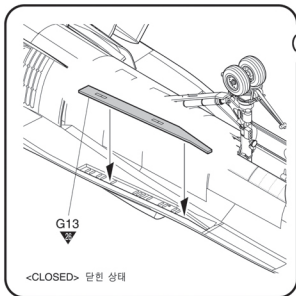

<OPEN> 열린 상태

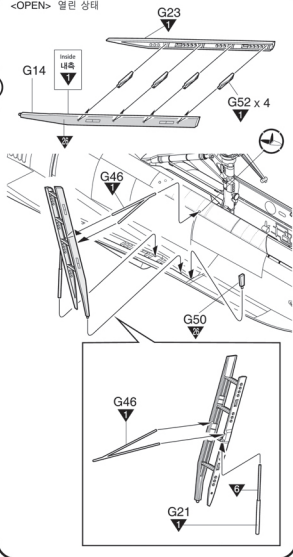

**30** 

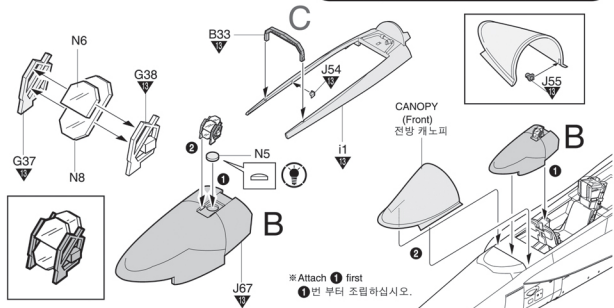
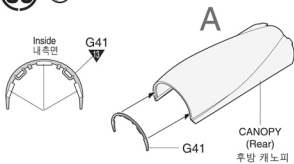

**31**

※ OPTIONAL.

취향에 따라 선택하십시오.

&lt;CLOSED&gt; 닫힌 상태

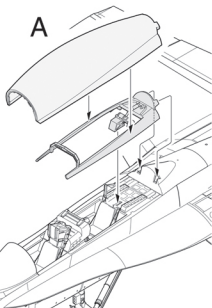
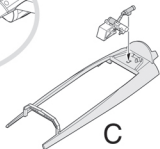
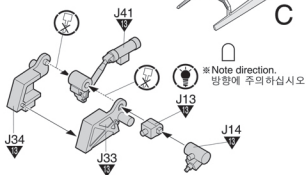
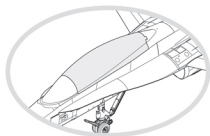

&lt;OPEN&gt; 열린 상태

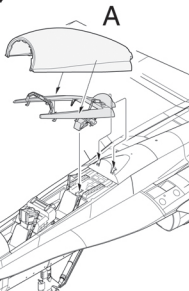
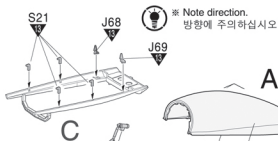
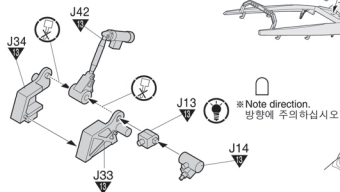
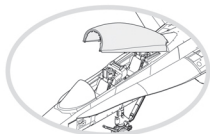

**32** 

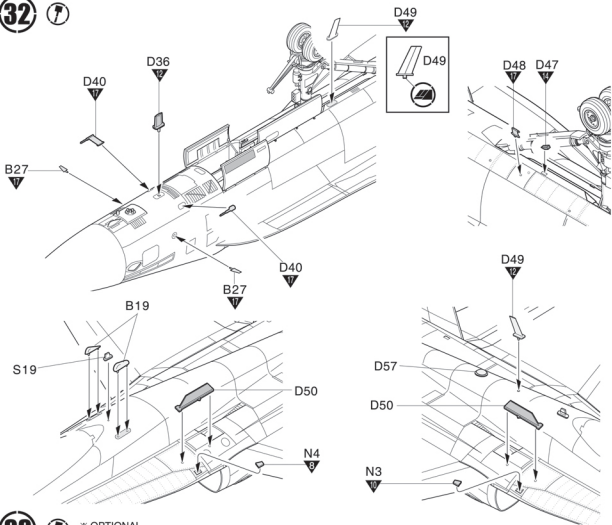

**33** 

※ OPTIONAL.  
취향에 따라 선택하십시오.

<OPEN> 열린 상태

<CLOSED> 닫힌 상태

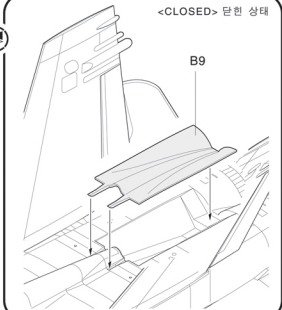
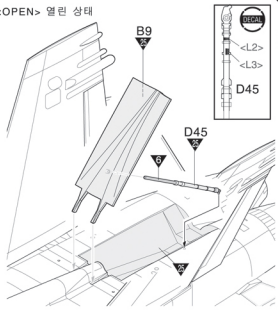

**34** 

■ SUU-63 Wing pylon  
SUU-63 주익 파일런

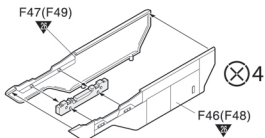
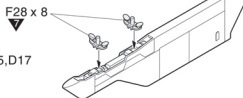
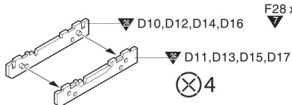

※ Adjust the pin length for some armaments.  
일부 무장의 경우 핀길이 조절이 필요합니다.



**35** 

■ SUU-62 Centerline pylon  
SUU-62 동체 중앙하부 파일런

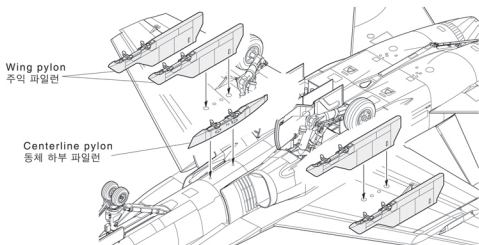
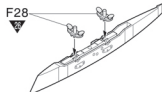
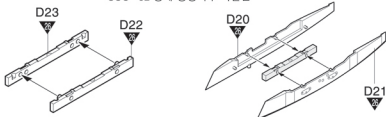



36

Folded / 접힌 상태



Finish using file.(not included)

이 표시 부분은 줄로 깨끗이 다듬어 주십시오.

Step 39 ~ 45 : Explanation for Wing Folding Type

과정 39 ~ 45는 날개가 접힌 형태에 관한 설명입니다.

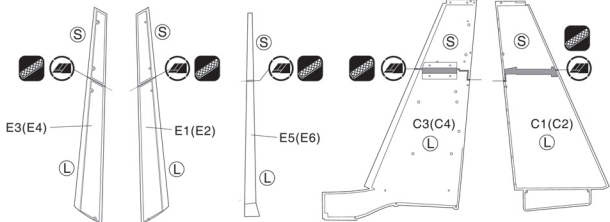

37



※ Attach 1 first

1번 부터 조립하십시오.

&lt;LEFT / 좌&gt;

&lt;RIGHT / 우&gt;

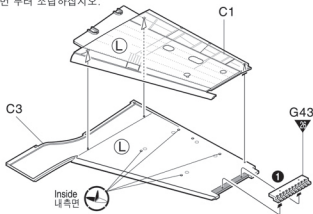
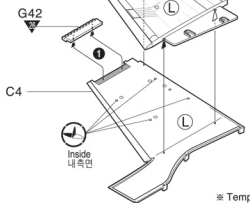

※ Temporarily hold with cellophane tape.

접착제가 단단히 굳을때까지 셀로판 테이프로 고정시켜 주십시오.

38



&lt;RIGHT / 우&gt;

※ ( ) is opposite number.

( )는 반대측 번호 입니다.

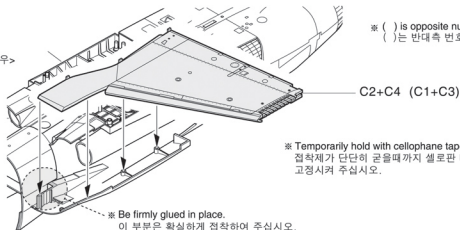

※ Temporarily hold with cellophane tape.

접착제가 단단히 굳을때까지 셀로판 테이프로 고정시켜 주십시오.

※ Be firmly glued in place.

이 부분은 확실하게 접착하여 주십시오.

39



<RIGHT / 우>

※ ( ) is opposite number.  
( )는 반대측 번호입니다.

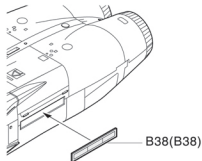
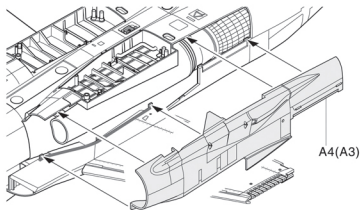

40



※ Temporarily hold with cellophane tape.  
접착제가 단단히 굳을때까지 셀로판 테이프로 고정시켜 주십시오.

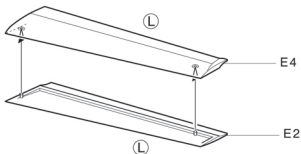
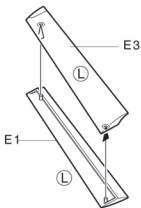

41



<RIGHT / 오른쪽>

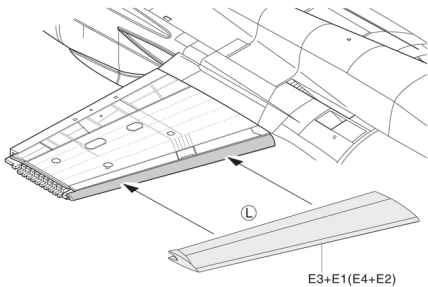

42 

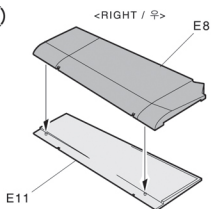

<LEFT / 좌>

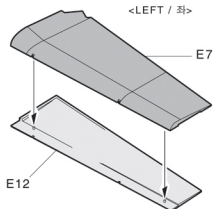

43 

<RIGHT / 우>

\* ( ) is opposite number.  
( )는 반대측 번호입니다.

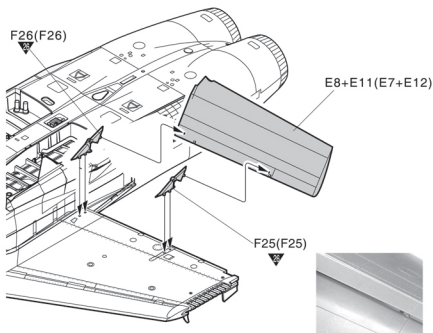

S14(S14)

S15(S15)

<RIGHT / 우>

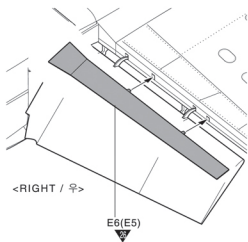

<RIGHT / 우>

44 

※ Attach ① first  
① 번 부터 조립하십시오.

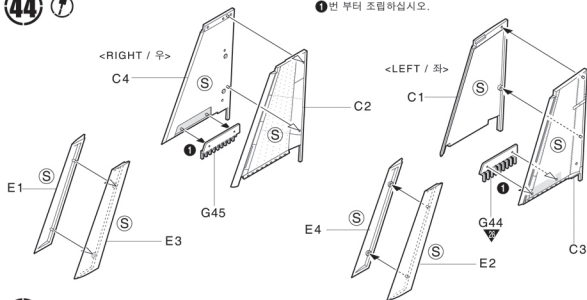

45 

※ ( ) is opposite number.  
( ) 는 반대쪽 번호입니다.

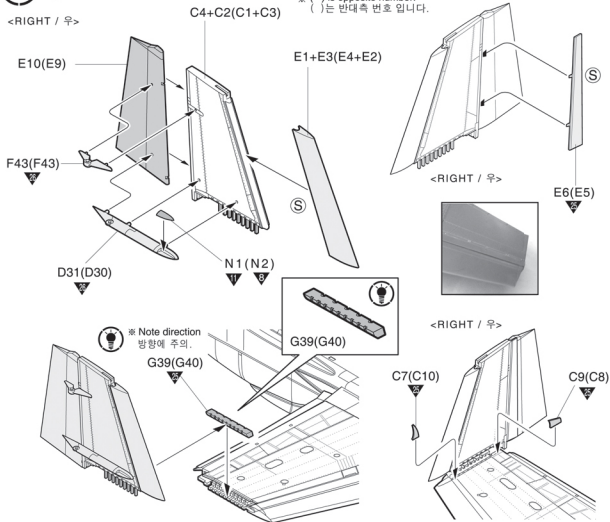

· Hang desired external stores referring to page 32.  
 · Refer to page 34 for painting & decal placement.  
 · 무장의 장착은 32페이지를 참조하십시오.  
 · 무장의 색칠 및 전사지 붙이기는 34페이지를 참조하십시오.

■ AIM-9L/M Sidewinder (for wingtip launcher)  
 AIM-9L/M 사이드 와인더 단거리용 공대공 미사일 (주익단 런처용)

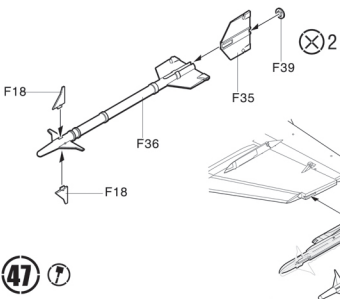

■ LAU-7/A-6 Wingtip launcher  
 LAU-7/A-6 주익단 런처

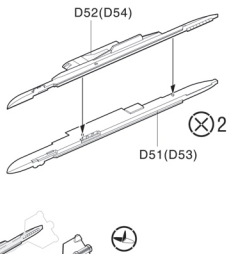

■ AIM-9L/M Sidewinder (for LAU-127 launcher)  
 AIM-9L/M 사이드와인더 단거리용 공대공 미사일 (LAU-127 런처용)

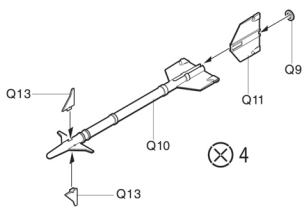

■ AIM-120 AMRAAM  
 AIM-120 암람 중거리용 공대공 미사일

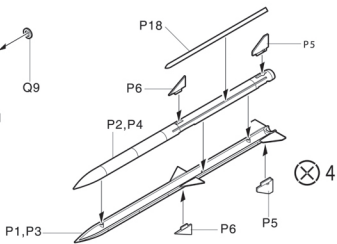

■ LAU-115C/A + LAU-127  
 LAU-115C/A + LAU-127 런처

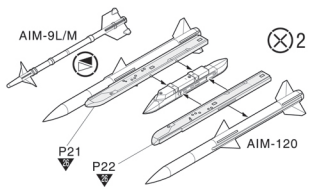
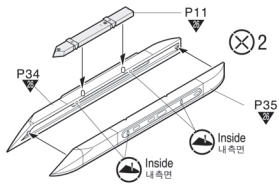

■ AIM-7F/M Sparrow

AIM-7F/M 스페로우 중거리용 공대공 미사일

※ Attach ① first

①번 부터 조립하십시오.

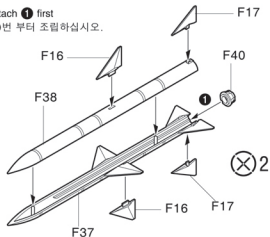

■ 330 U.S. gal. External Fuel Tank  
330 갤런 외부연료탱크

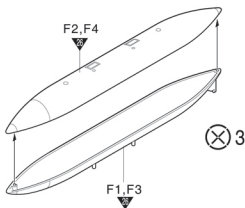

■ GBU-31 JDAM (Joint Direct Attack Munition)

GBU-31 제이엡 GPS 유도폭탄

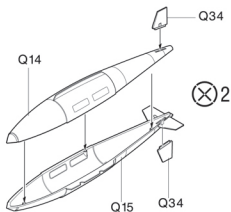

■ GBU-10 Paveway II

GBU-10 페이브웨이 II 레이저 유도폭탄

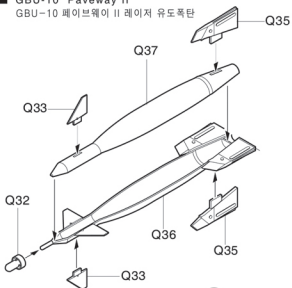

■ GBU-24 Paveway III

GBU-24 페이브웨이 III 레이저 유도폭탄

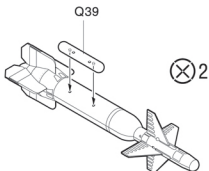
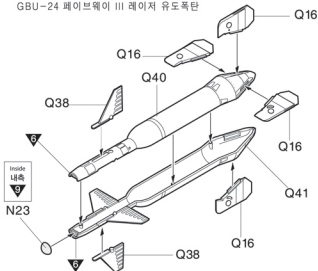

Inside  
내측  
↓

■AGM-84D Harpoon/AGM-84E SLAM

AGM-84D 하푼 공대함 미사일  
AGM-84E 슬램 공대지 미사일

\* OPTIONAL.  
취향에 따라 선택하십시오.

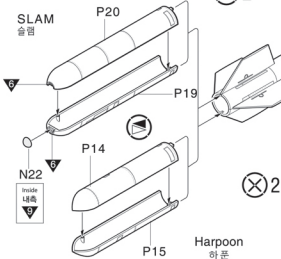
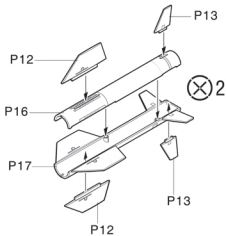

\* OPTIONAL.  
취향에 따라 선택하십시오.

■Mk.82 500lb Bomb  
MK.82 500 파운드 폭탄

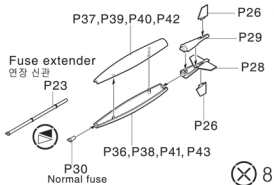

■Mk.82 Snakeye  
MK.82 스네이크아이 형 폭탄

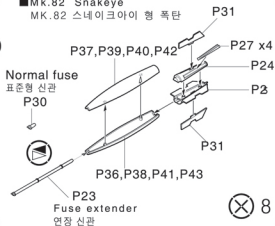

■BRU-33 VER (Vertical Ejector Rack)  
BRU-33 VER 2연장 폭탄 장착대

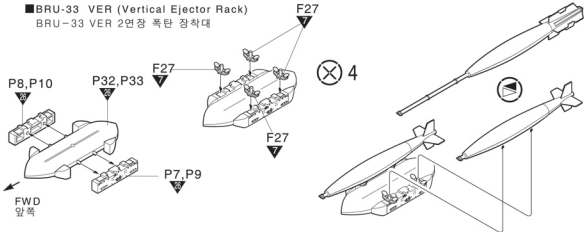

■ AGM-88 HARM  
AGM-88 함 대 레이더 미사일

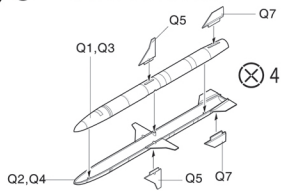

■ LAU-118 Launcher  
LAU-118 런처

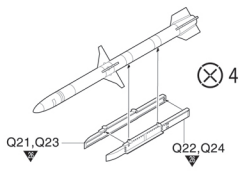

■ AGM-65E Maverick  
AGM-65E 매버릭 공대지 미사일

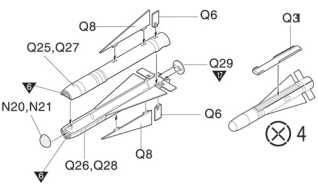

■ LAU-117 Launcher  
LAU-117 런처

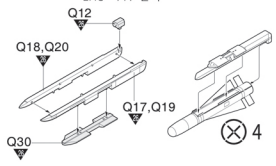

■ AN/ASQ-173 LDT/SCAM pod  
AN/ASQ-173 LDT/SCAM

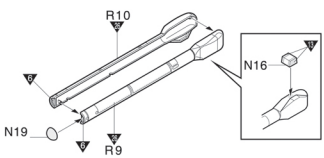

LDT/SCAM : Laser Detector Tracker/Strike Camera  
(레이저 탐지 추적 / 스트라이크 카메라 장치)

■ AN/AAR-50 TINS pod  
AN/AAR-50 TINS

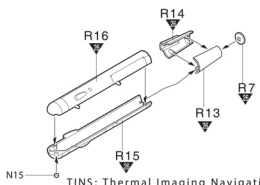

TINS: Thermal Imaging Navigation Set  
(열영상 항법장치)

■ AN/AAS-38 FLIR pod  
AN/AAS-38 FLIR 포드

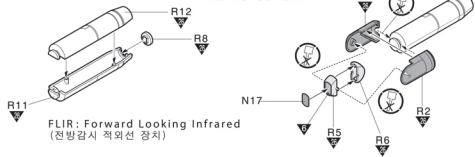

FLIR: Forward Looking Infrared  
(전방감시 적외선 장치)



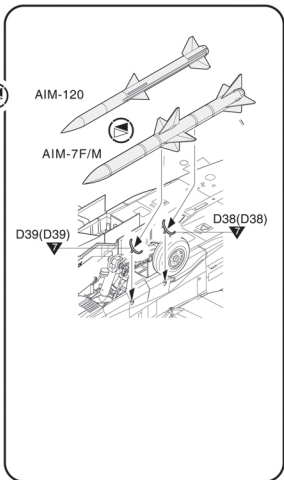
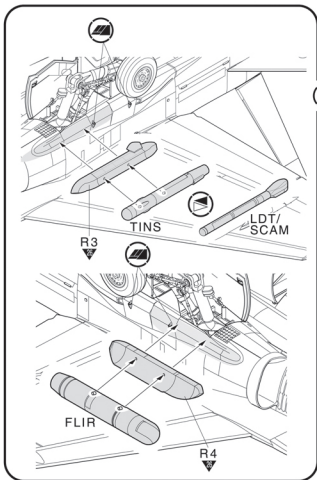

■ External Stores  
외부 무장 장착도



Weapons	Sta. No.	<9>	<8>	<7>	<6>	<5>	<4>	<3>	<2>	<1>
AIM-9L/M		●								●
AIM-7F/M					●		●			
AIM-120					●				●	
330 gal. Fuel tank				●		●		●		
GBU-31			●	●				●		
GBU-10			●	●				●		
GBU-24			●	●				●		
MK 82 / Snakeye(+VER)			●	●		●		●		
AGM-84D/-84E			●	●				●		
AGM-88			●	●				●		
AGM-65E			●					●		
AN/ASQ-173 LDT/SCAM					●					
AN/AAR-50 TINS					●					
AN/AAS-38 FLIR							●			

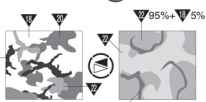
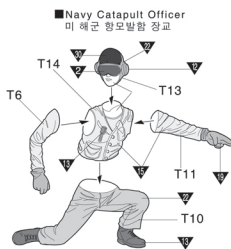
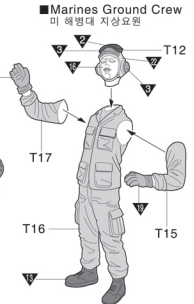
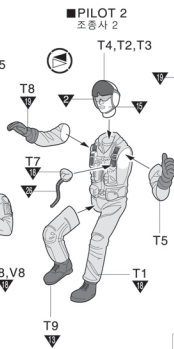
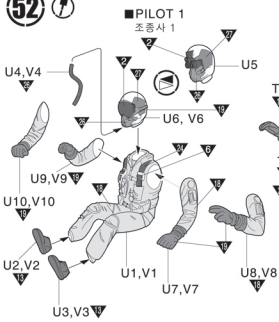

OPTIONAL <U1> ~ <U3>, <U5>, <U7>, <U8>, <U11> ~ <U20>, <U24>

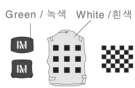

【 AIRCRAFT WEAPONS 】 무장류 

★ : Both side.  
: 양쪽 면에 붙입니다.

■ AIM-9L/M Sidewinder

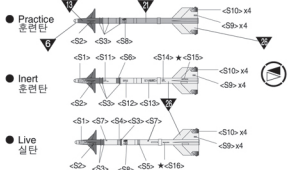

■ AIM-7F/M Sparrow

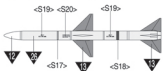

■ AIM-120 AMRAAM

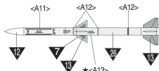

■ Mk.82 500lb Bomb / Mk.82 Snakeye



■ GBU-31 JDAM

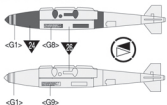

■ GBU-10 Paveway II

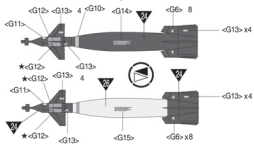

■ GBU-24 Paveway III

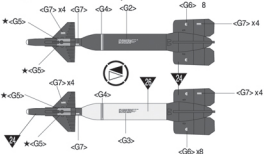

■ AGM-84D Harpoon/84E SLAM

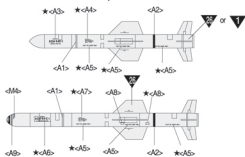

■ AGM-65E Maverick

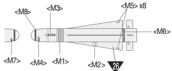

■ AGM-88 HARM



■ AN/AAS-38 FLIR

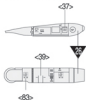

■ AN/AAR-50 TINS





**1** F/A-18D BuNo 165686, VMFA(AW)-242 "BATS" DT-01, USMC, MCAS Iwakuni, Japan, 2010~2012.  
미 해병 제242 전천후 전투공격비행대 "배츠" 소속 F/A-18D. 일본 이와쿠니 기지, 2010~2012년.

Upper Color (기체 상면색): 75 Lower Color (기체 하면색): 33

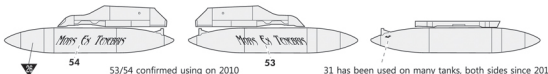
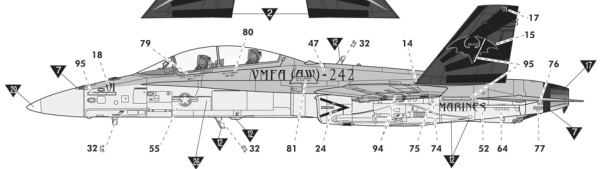
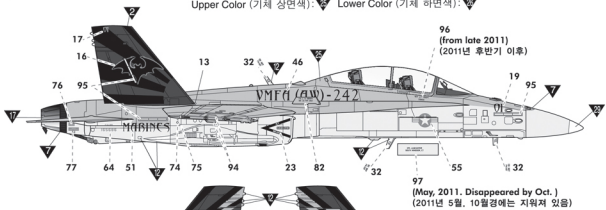

53/54 confirmed using on 2010  
53/54는 2010년에 사용이 확인됨

31 has been used on many tanks, both sides since 2010  
31은 2010년 이래 많은 연료탱크 양측면에 부착되고 있음



93 confirmed using on May, 2011 with marking 97, possibly on both sides  
93은 2011년 5월에 97번 마킹과 함께 사용이 확인됨

**2** F/A-18D BuNo 164955, VMFA(AW)-242 "BATS" DT-00, USMC, MCAS Iwakuni, Japan, 2012.  
미 해병 제242 전천후 전투공격비행대 "배츠" 소속 F/A-18D. 일본 이와쿠니 기지, 2012년.

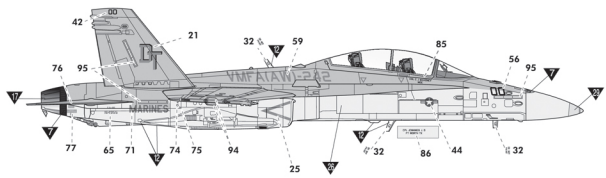

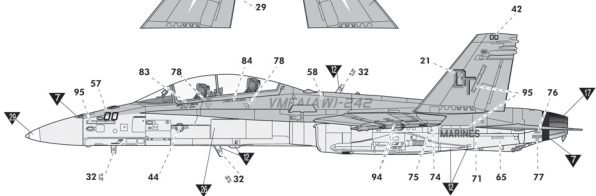
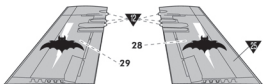

3

F/A-18D BuNo 165411, VMFA(AW)-225 "VIKINGS" DT-00, USMC, MCAS Miramar, California, 2012.  
미 해병 제225 전천후 전투공격비행대 "바이킹스" 소속 F/A-18D. 캘리포니아 미라마 기지, 2012년.

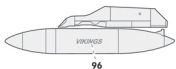
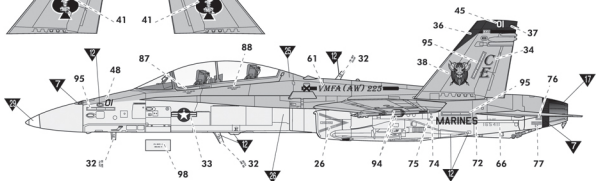
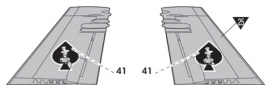
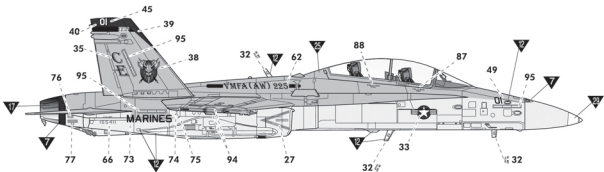

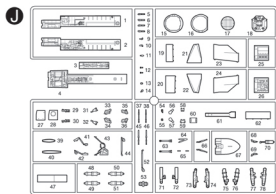
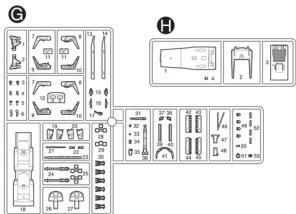
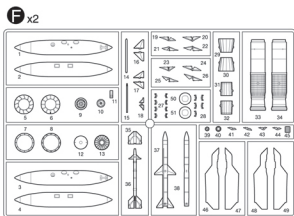
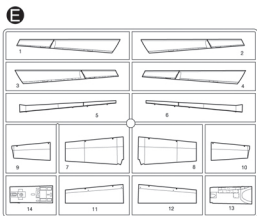
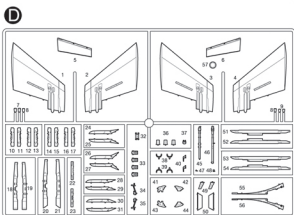
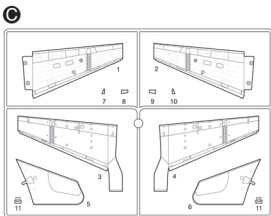
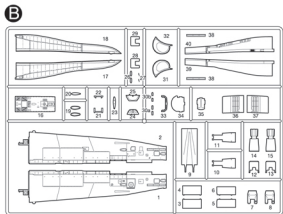
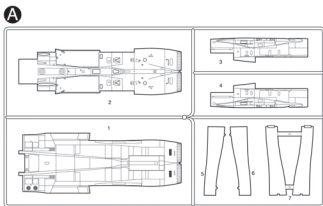

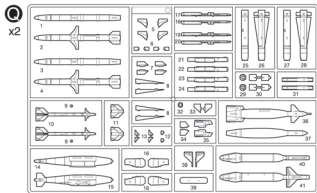
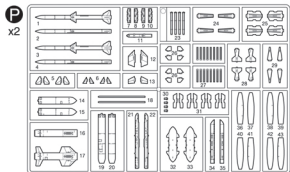

SCREW DRIVER  
드라이버



TIRES(Large)  
타이어 (대)



TIRES(Small)  
타이어 (소)



CANOPY(Front)  
캐노피 (전방)



SCREW(1pc. is extra.)  
비스 (1개 - 여분)



RADOME  
레이돔



CANOPY(Rear)  
캐노피 (후방)



METAL STRUTS  
철재 골조

●Unused parts / 불필요 부품

B8, B11, B13, B15, B19, B20, B22  
B21, B23, B26, B29, B33, D7,  
D8, D9, D20, D21, D33X2, E14,  
F6, F8, G3X1, G4X1, G5X1,  
G6X1, G7X2, G8X2, G9X1, G10X1,  
G11X1, G15X1, G16X1, G19X1,  
G20X1, G22X1, G24X1, G25X1, G27,  
G28, G29, J13, J14, J28, J33, J34, J39,  
J40, J41, J42, J54, N7, N9, N10X4, N11,  
N12, N13X1, S3, S4, S5, S6, S11

●Decal - 1

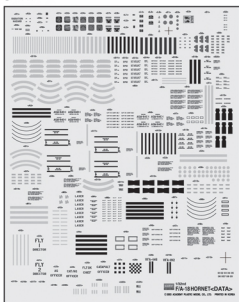

●Decal - 2

