

Revell

KIT 5253

85525300200

MESSERSCHMITT Bf 109G-10

The Bf 109 was first flown in 1935 and went on to become one of the most popular axis fighter planes in wartime aviation history. Towards the end of the 2nd world war Bf 109 production reached in excess of 33,000 units. The G-10 variant was developed late in the war and had a larger 1,475 HP supercharged engine and heavier protective armour-plating. Your Revell model has a movable propeller and long range fuel tank, a detailed cockpit, optional position landing gear and authentic G-10 decal markings for two wartime fighter versions.

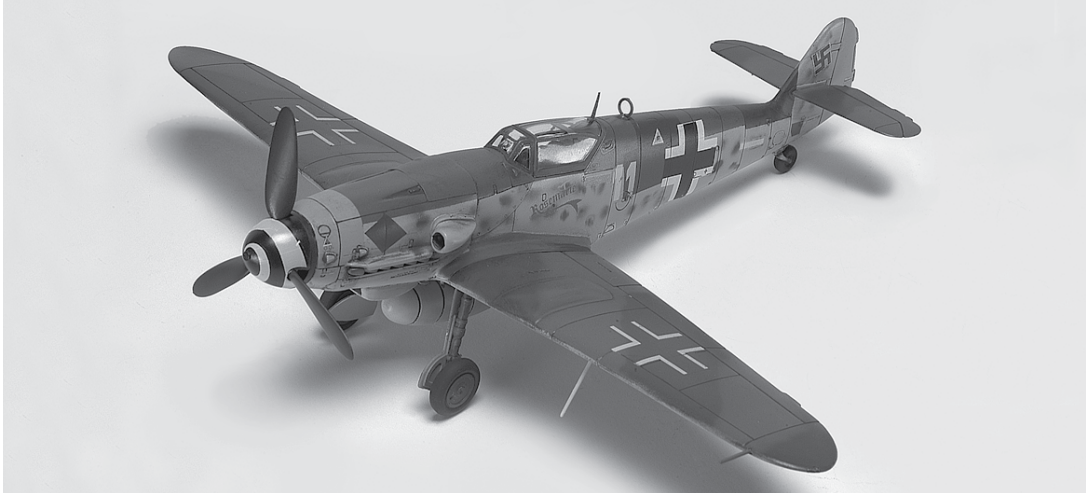

* REPEAT SEVERAL TIMES
* A REPETER PLUSIEURS FOIS



* OPTIONAL PARTS
* PIECES EN OPTION



* DECAL
* DECAL COMANIE



* ALTERNATIVE ASSEMBLY
* ENSEMBLAGE ALTERNATIVE



* CEMENT TOGETHER
* A COLLER



* REMOVE AND THROW AWAY
* A RETIRER ET JETER



* DO NOT CEMENT
* NE PAS COLLER

READ THIS BEFORE YOU BEGIN

- * Study the assembly drawings.
- * Each plastic part is identified by a number.
- * In the assembly drawings, some parts will be marked by a star (★) to indicate chrome plated plastic.
- * For better paint and decal adhesion, wash the plastic parts in a mild detergent solution. Rinse and let air dry.
- * Check the fit of each piece before cementing in place.
- * Use only cement for polystyrene plastic.
- * Scrape plating and paint from areas to be cemented.
- * Allow paint to dry thoroughly before handling parts.
- * Any unused parts may be discarded.

DECAL APPLICATION INSTRUCTIONS

1. Cut desired decal from sheet.
2. Dip decal in water for a few seconds.
3. Place wet decal on paper towel.
4. Wait until decal is movable on paper backing.
5. Place decal in position on model, face up and slide backing away.
6. Press out air bubbles with a soft damp cloth.
7. Milkyness that may appear is for better decal adhesion and will dry clear. Wipe away any excess adhesive.
8. Do not touch decal until fully dry.
9. Allow the decals 48 hours to dry before applying clear coat.

NOTE: Decals are compatible with setting solutions or solvents.

LIRE CE QUI SUIT AVANT DE COMMENCER

- * Etudier les schémas de montage.
- * Chaque pièce en plastique est identifiée par un numéro.
- * Sur les schémas de montage, certaines pièces sont marquées d'une étoile (★) pour indiquer qu'elles sont en plastique chromé.
- * Pour une meilleure prise de la peinture et des autocollants, laver les pièces en plastique avec une solution détergente peu concentrée. Les rincer et les laisser sécher à l'air.
- * Vérifier que chaque pièce s'ajuste bien avant de la coller en place.
- * N'utiliser que de la colle pour polystyrène.
- * Gratter les parties à coller pour enlever le chrome et la peinture.
- * Laisser la peinture bien sécher avant de manipuler les pièces.
- * Toute pièce inutilisée peut être jetée.

DIRECTIVES D'APPLICATION DES AUTOCOLLANTS

1. Découper l'autocollant désiré de la feuille.
2. Tremper l'autocollant dans de l'eau pendant quelques secondes.
3. Placer l'autocollant mouillé sur une serviette en papier.
4. Attendez que l'autocollant puisse être déplacé sur son support en papier.
5. Mettre l'autocollant en position sur le modèle face sur le dessus et faire glisser le support pour l'enlever.
6. Appuyer avec un chiffon doux humide pour éliminer les bulles d'air.
7. La substance laiteuse qui peut apparaître est destinée à améliorer l'adhésion de l'autocollant et devient incolore au séchage. Essuyer pour enlever tout excédent d'adhésif.
8. Ne pas toucher l'autocollant tant qu'il n'est pas bien sec.
9. Laisser l'autocollant sécher pendant 48 heures avant d'appliquer une couche transparente.

REMARQUE: Les autocollants sont compatibles avec les solutions de fixation ou les solvants.

This paint guide is provided to complete this kit as shown on the box.

Ce guide de peintures est fourni pour reproduire le modèle réduit qui apparaît sur la boîte.

Bronze Metallic	Métallique En bronze
Semi Gloss Black	Noir satiné
Flat Black	Noir mat
Gloss Red	Rouge brillant
Chrysler Engine Red	Rouge De Moteur De Chrysler
Chrysler Engine Blue	Bleu De Moteur De Chrysler
Flat White	Blanc mat
Aluminum	Aluminum
Silver	Argent
Steel	Acier
Wood	Bois
Tan	Tan

If you have any questions or comments, call our hotline at: **(800) 833-3570**
or, please write to:

Revell Inc Consumer Service Department, 1850 Howard Street Unit A, Elk Grove Village, Illinois 60007

Be sure to include the plan number (85525300200), part number, description, your return address and phone number.

Visit our website: www.revell.com

1

COCKPIT ASSEMBLY

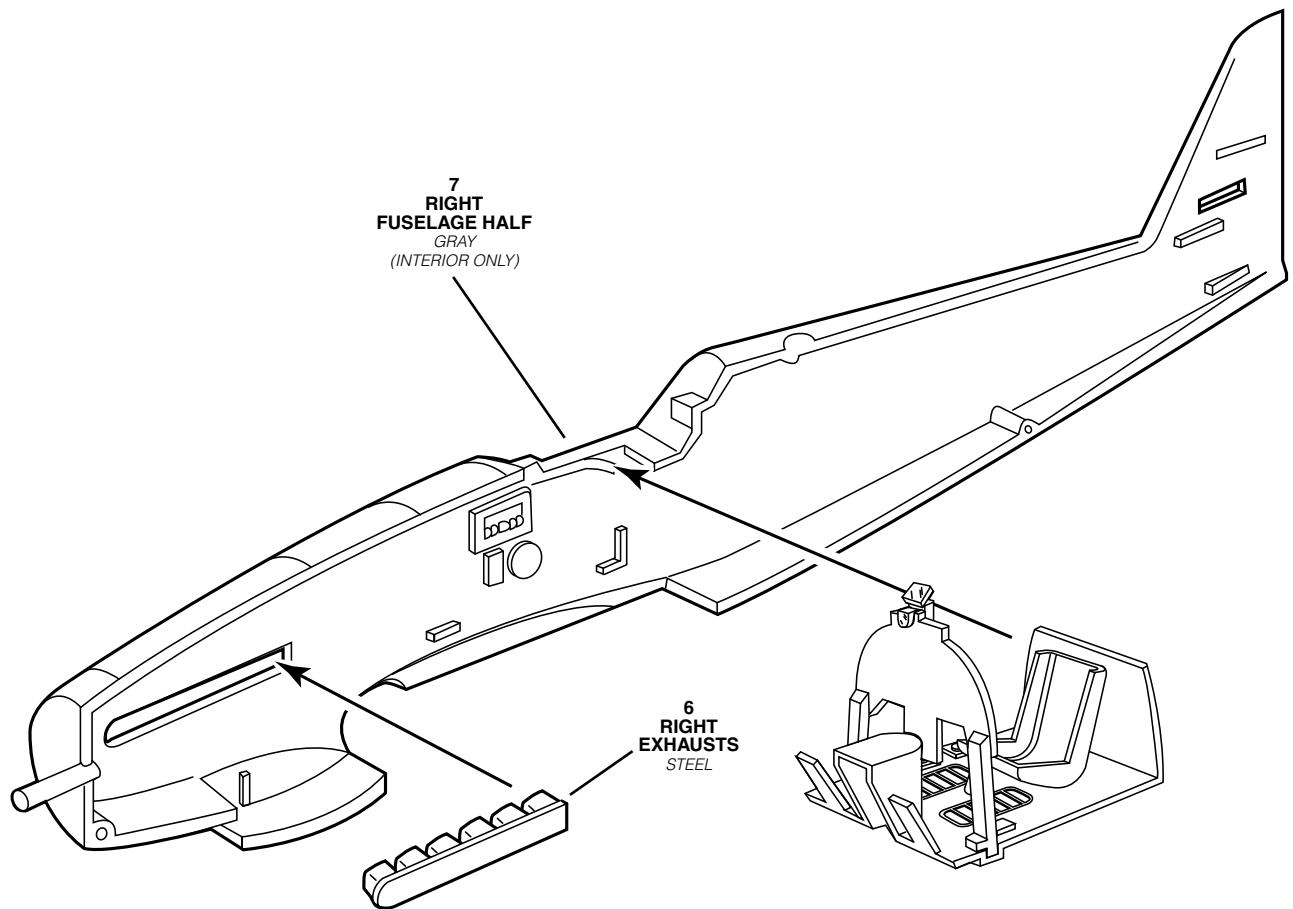
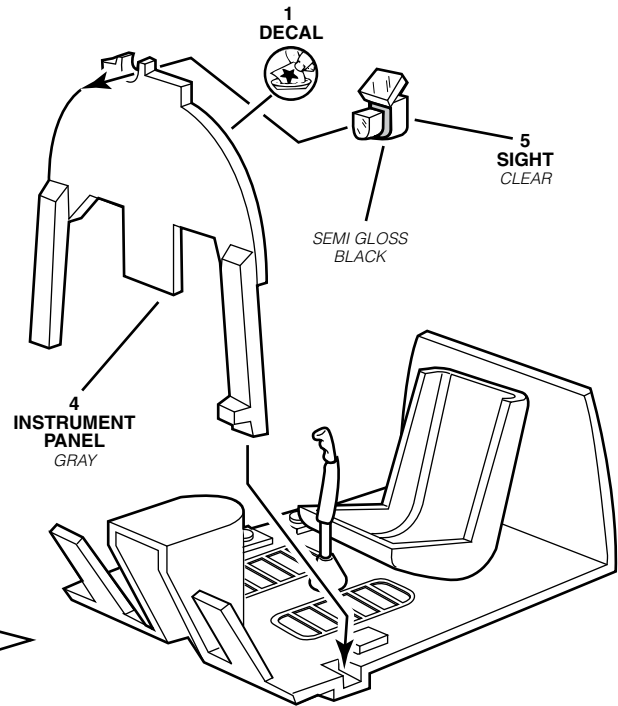
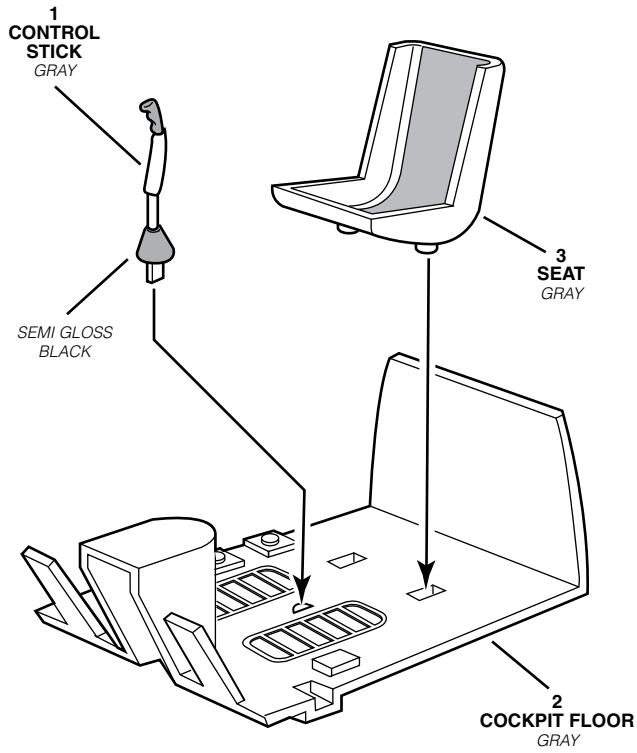

2

FUSELAGE ASSEMBLY

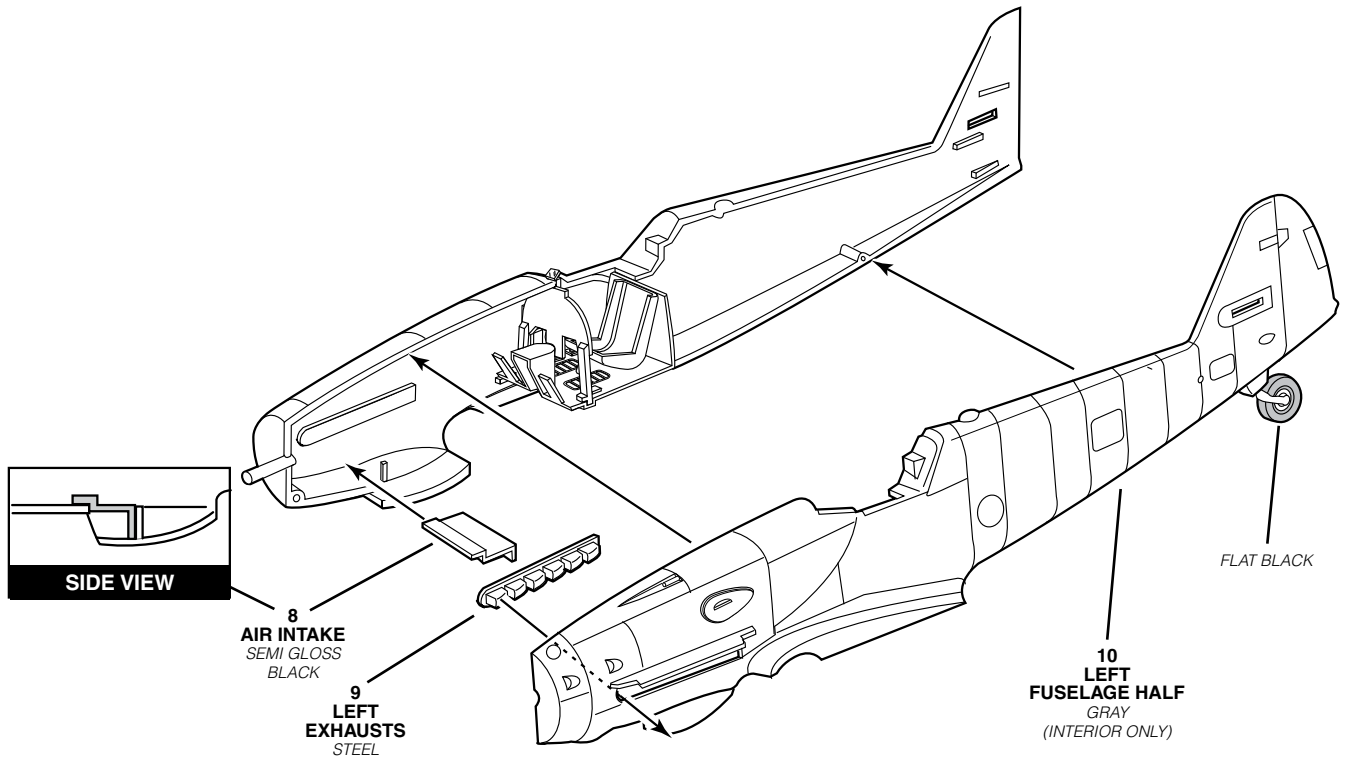

3

WING ASSEMBLY

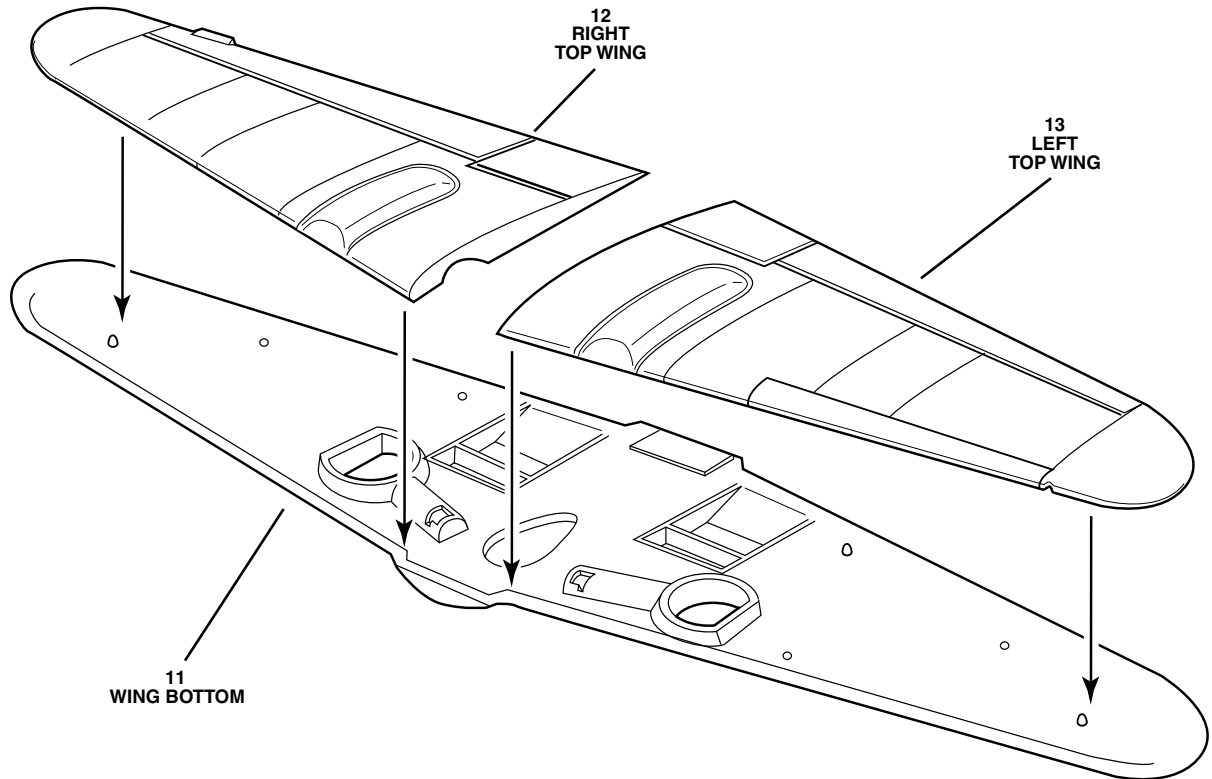

4

FUSELAGE / WING ASSEMBLY

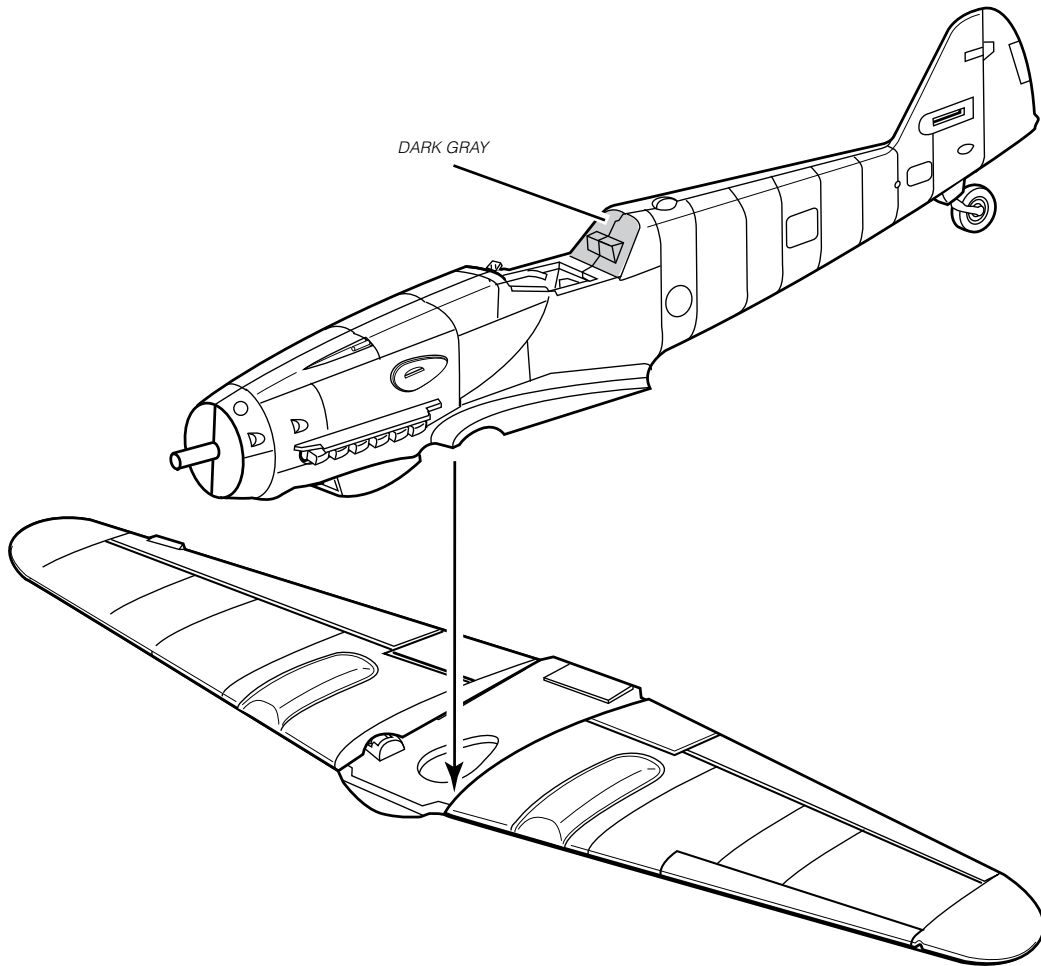

5

STABLIZER ASSEMBLY

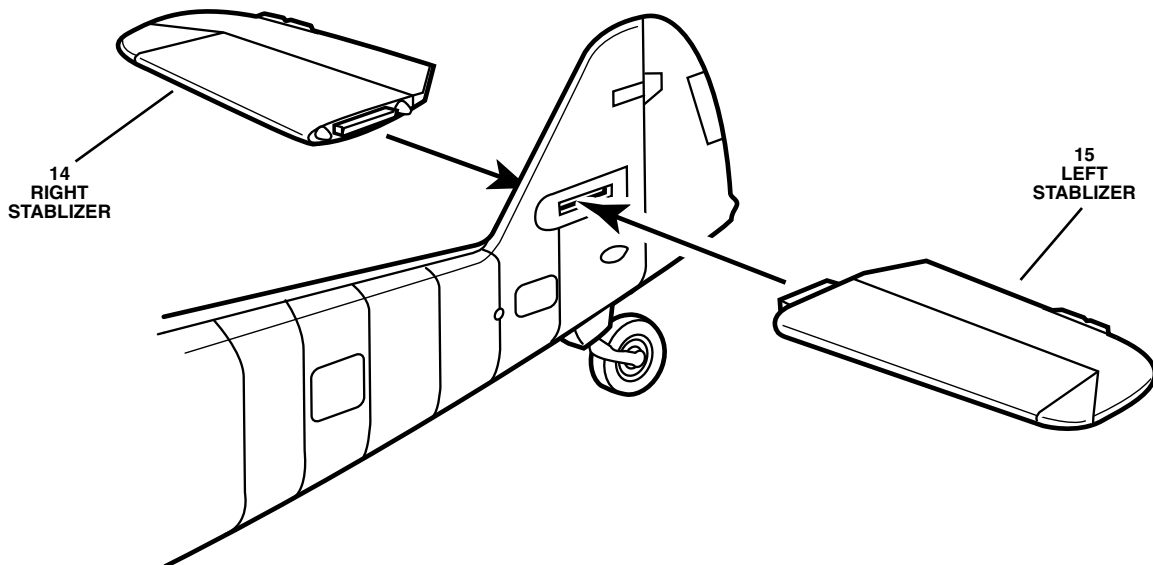

6

WHEEL / STRUT ASSEMBLY

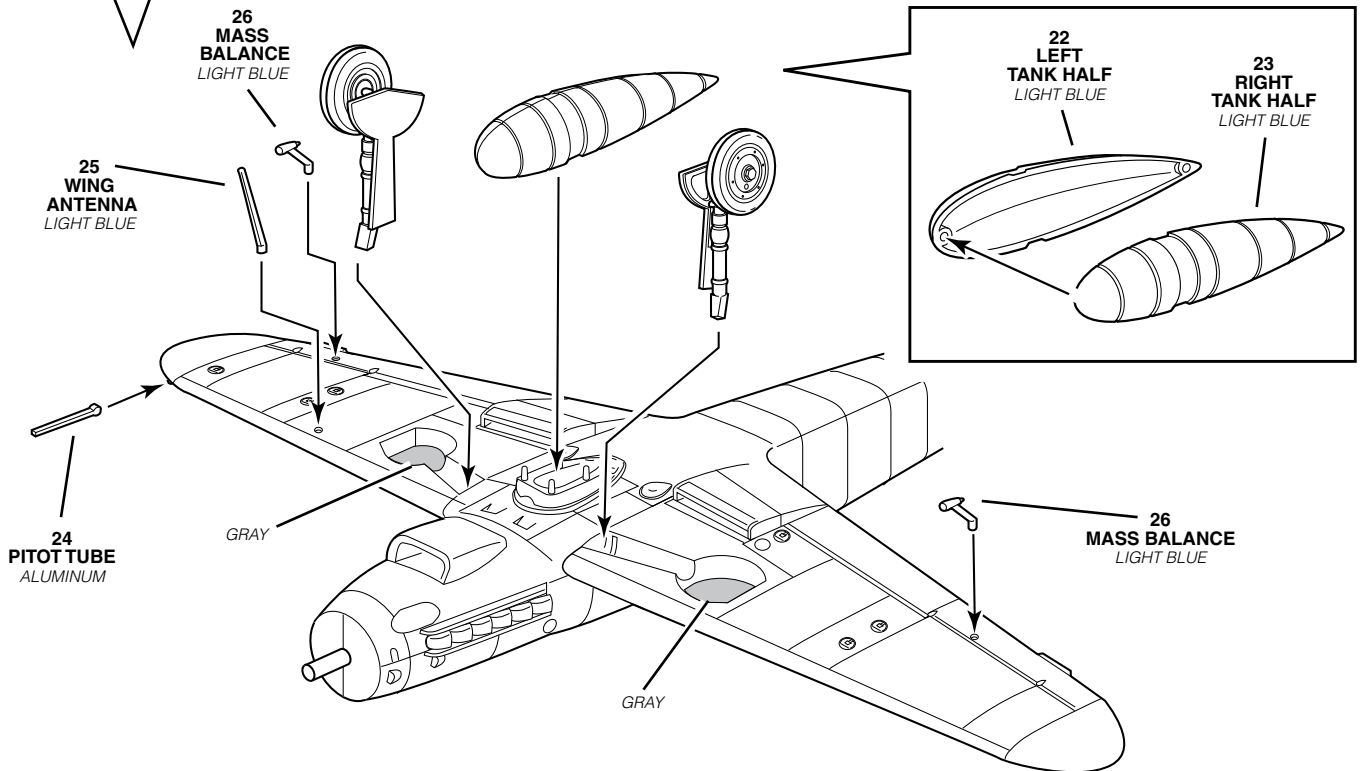
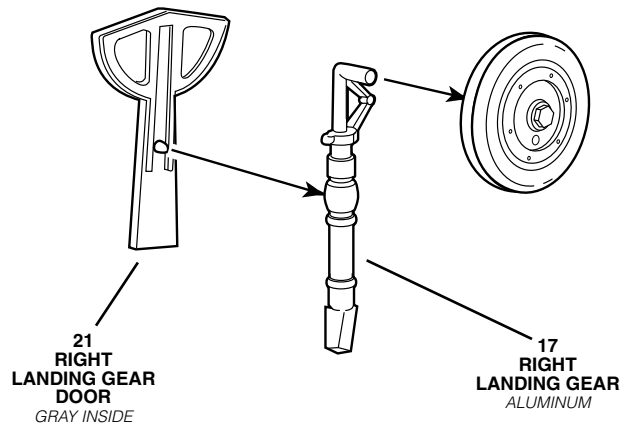
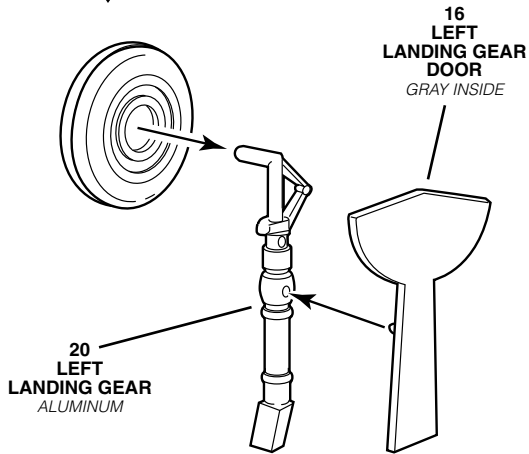
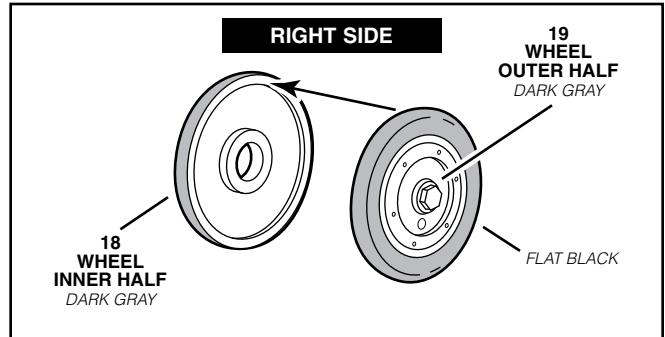
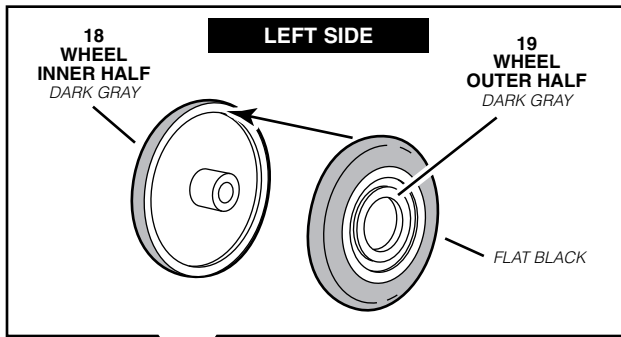

7

PROP ASSEMBLY

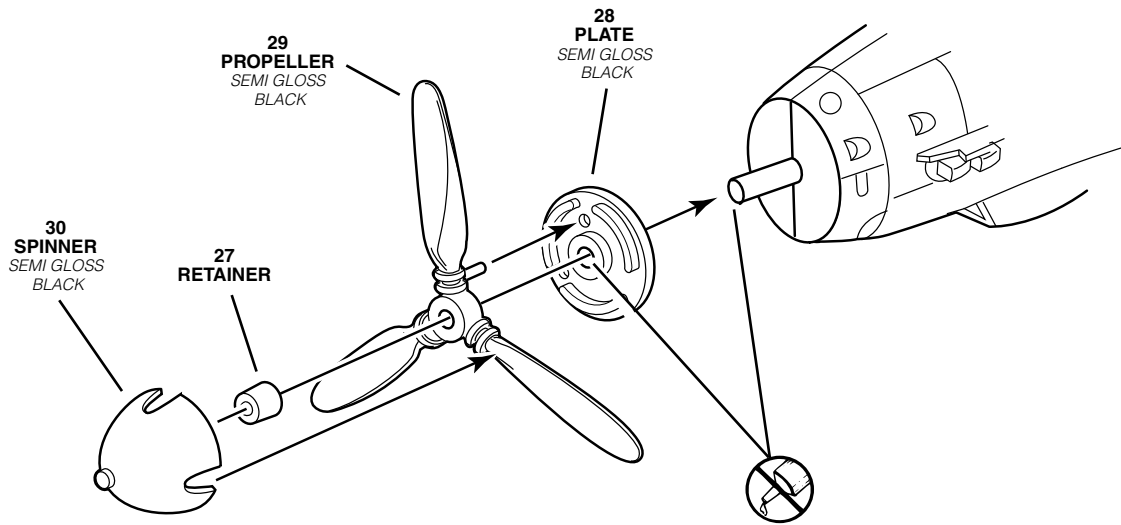

8

CANOPY / FINAL ASSEMBLY

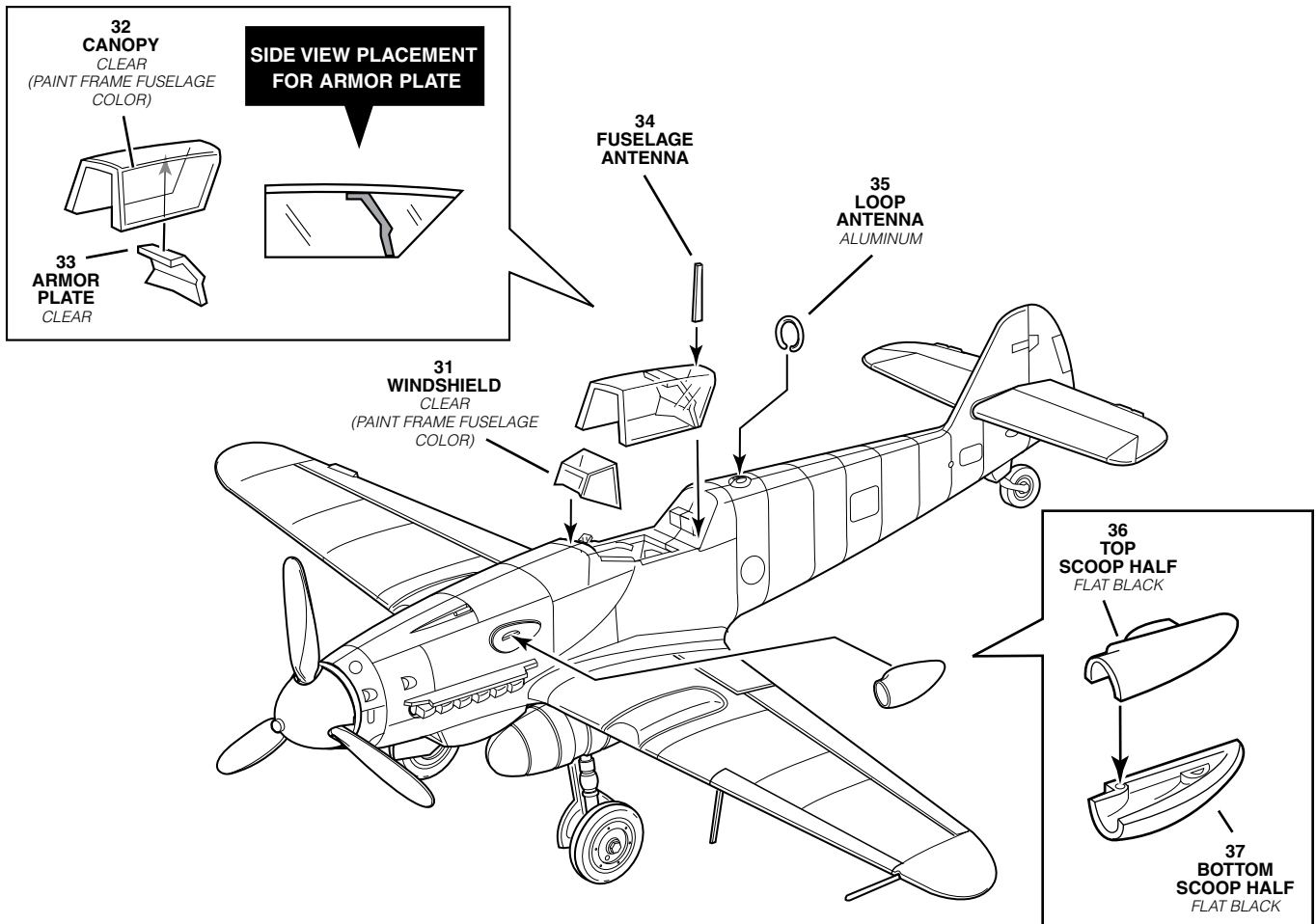

DECAL PLACEMENT

Messerschmitt Bf 109G-10, "White 11" II./JG 52

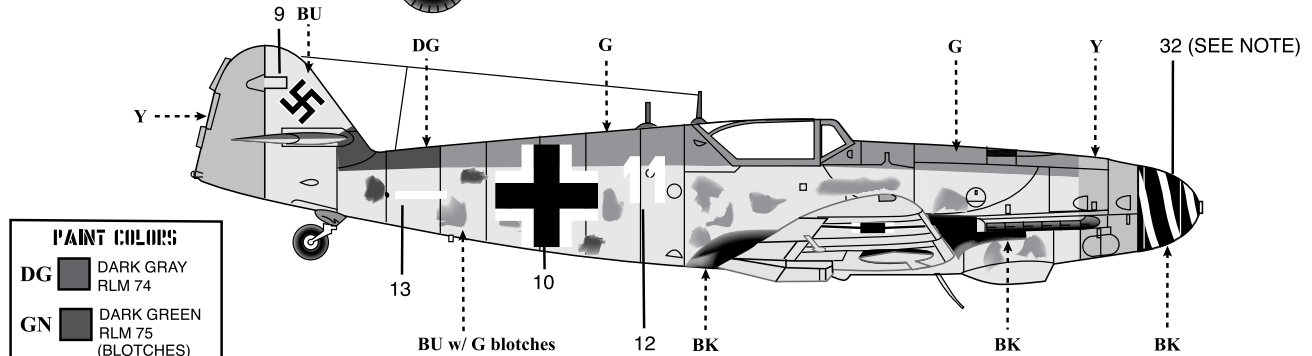
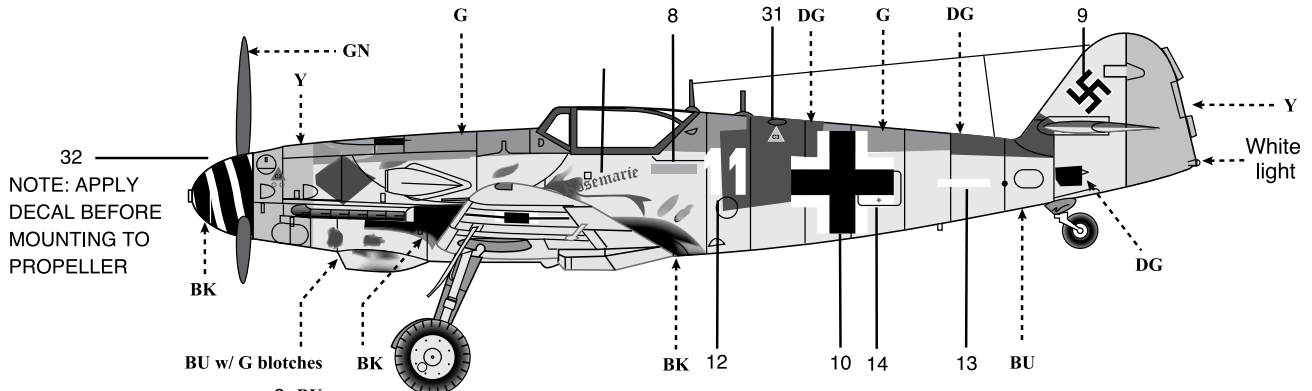

PAINT COLORS	
DG	DARK GRAY RLM 74
GN	DARK GREEN RLM 75 (BLOTCHES)
G	GRAY RLM 75 (BLOTCHES)
BU	LIGHT BLUE RLM 76
BK	BLACK
Y	YELLOW RLM 27

Messerschmitt Bf 109G-10, "Yellow 5" 10./JG 51, Bulltofta, Sweden, 1945.

Pilot Feldwebel Horst Petzschler

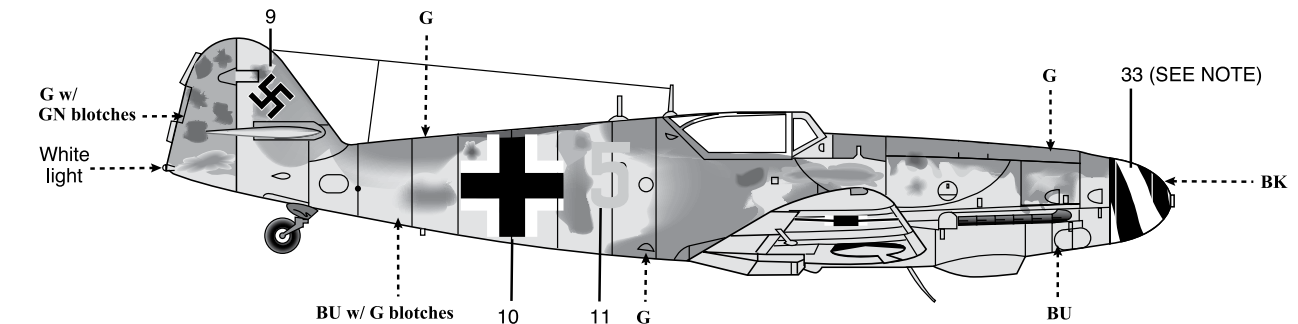
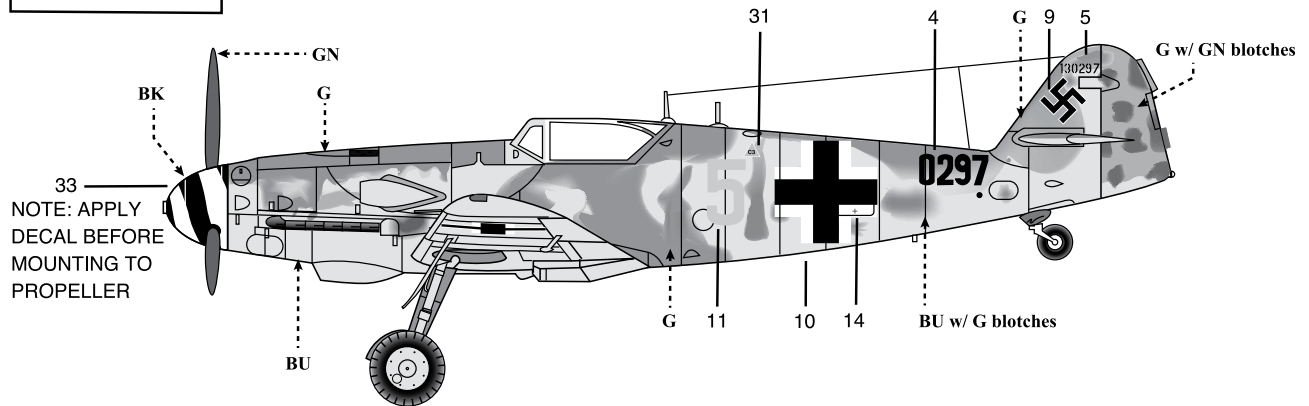

PAINING AND DECAL INSTRUCTIONS

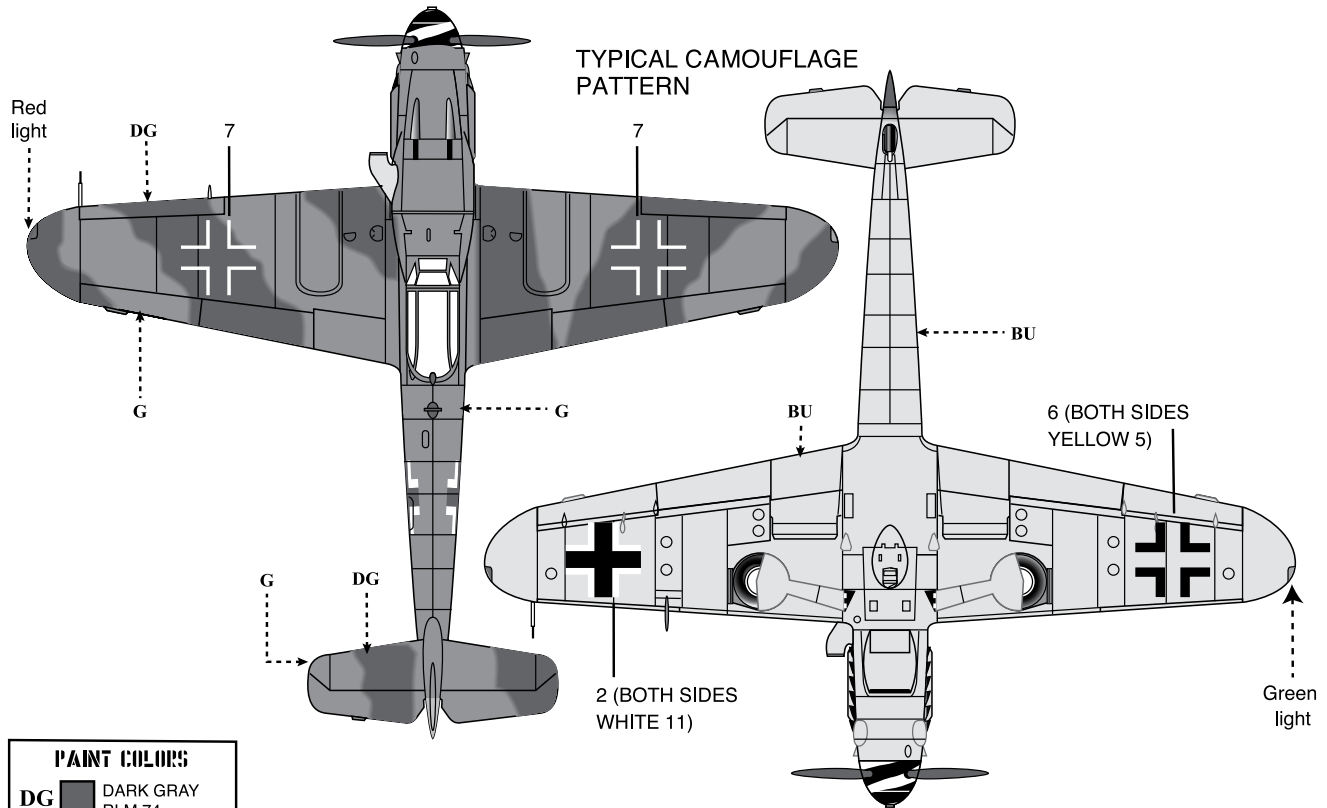

PAINT COLORS	
DG	DARK GRAY RLM 74
GN	DARK GREEN RLM 75 (BLOTCHES)
G	GRAY RLM 75 (BLOTCHES)
BU	LIGHT BLUE RLM 76
BK	BLACK
Y	YELLOW RLM 27

STENCILS COMMON TO BOTH VERSIONS

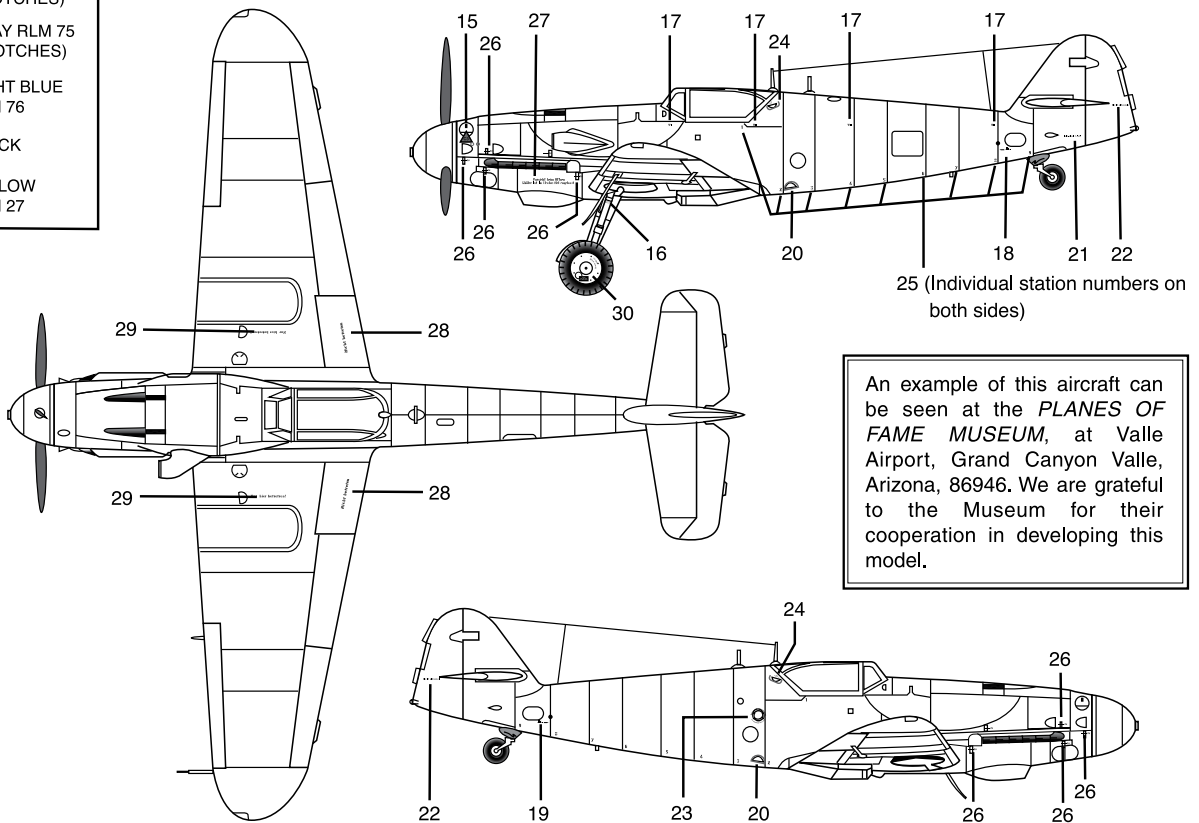

An example of this aircraft can be seen at the *PLANES OF FAME MUSEUM*, at Valle Airport, Grand Canyon Valle, Arizona, 86946. We are grateful to the Museum for their cooperation in developing this model.