



Soviet T-28 Medium Tank (Riveted)

ソビエト T-28 中戦車 (リベット接合型)

苏联T-28中型坦克(铆接型)

PLEASE READ BEFORE OPERATION!

- * Tools recommended as below: (Not included)
Adhesives; Paints; Side Cutters; Sharp Edged Pliers; Modeling Knife; Modeling File; Nippers; Drill; Scissors; Sand Paper; Soft Cloth; Cyanoacrylate Glue.
- * Make sure to read this instruction listed below before assembling.
- * The kit contains the small parts, they can be dangerous if swallowed by mistake, so keep them away from reach of children.
- * Cut the all parts off carefully and remove the waste parts into the garbage can.
- * More caution and care should be needed for cutting and handling the photo etched parts.
- * Make attention that some parts should be attached the decal when assembled.
- * During assembling, please tear up and throw away the plastic bags, or may cause the dangerous if wearing over head by children's mistake.
- * When using the adhesives and paints, please do not use them in the closed room or near the fire, also must be very careful to protect your eyes, face and clothes.
- * Adult supervised when assembled by children under 14 years old.

装配前请仔细阅读:

- * 推荐使用的模型工具(请自备):
专用模型胶水, 专用模型油漆, 水口剪刀, 长咀钳, 刀片, 锉刀, 镊子钳, 钻, 剪刀, 软布, 砂纸, 瞬间快干胶等。
- * 用水口剪刀或刀片小心切下所有塑胶零件和蚀刻片零件, 不要遗失小零件。
- * 切取蚀刻片时应特别注意防止利边划伤手指。
- * 用模型锉刀小心锉平所有零件表面的注射浇口。
- * 用适量的强力快干胶水粘合蚀刻片零件和金属轴, 切忌过量, 否则可能导致可动零件被粘住。
- * 注意某些零件表面需在装配时同步贴水上贴纸。
- * 制作时应远离幼儿并将包装袋及时收妥, 谨防小孩玩耍而引起意外。



cyanoacrylate glue
强力胶



weight
配重



make hole
钻孔



cut / remove
切除



option
选择



no cement
不涂胶水



decal
贴纸



bend
弯曲



repair
填补

The method to apply the decals

1. Cut off the decal from the decal paper and put it into the warm water 40°C for 10 seconds.
2. Take the decal from the water and put it on a piece of clean cloth.
3. Remove the decal slowly from the paper to the targeted location by a wet finger.
4. Use a piece of dry and soft cloth to press it gently on the decal until it getting dry and no bubble existing.

水贴纸的使用方法:

- 一. 把相关的印花从水贴上剪下, 放入40℃左右的温水中浸10秒。
- 二. 然后将印花放在干净的布上。
- 三. 拿上印花纸板, 手指蘸水将印花移到适当的位置。
- 四. 用软干布轻压印花直至水干, 气泡消失。

部品图 Parts

AX4

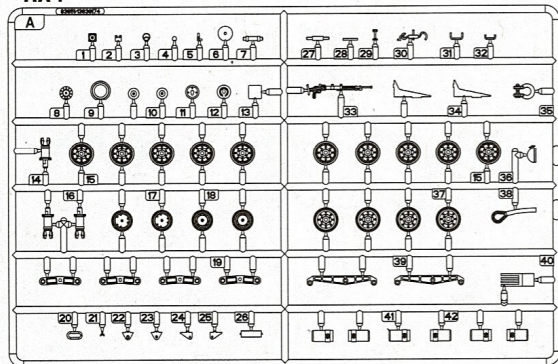

BX2

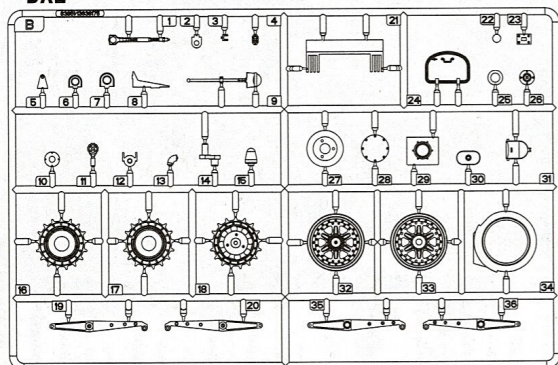

B37X2

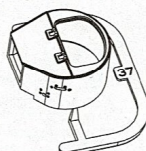

B38X2

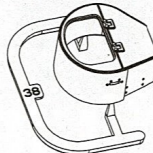

TRX5

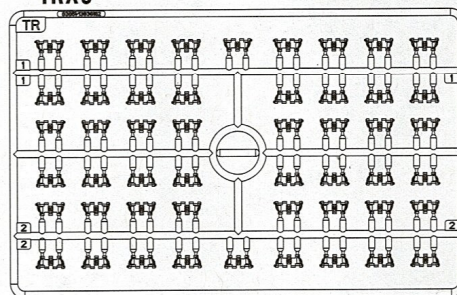

D

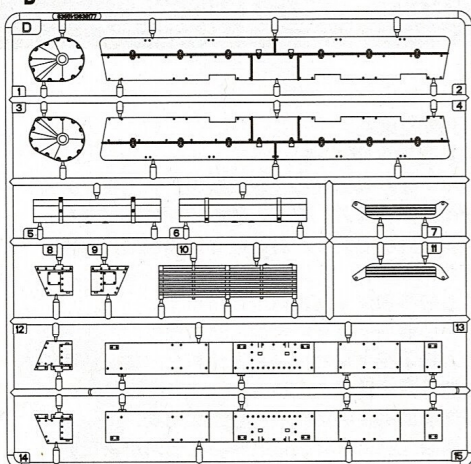

E

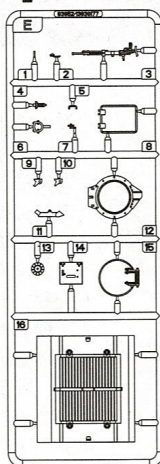

L

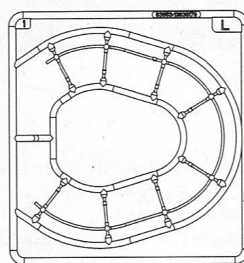

T

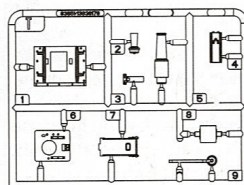

炮塔
Turret

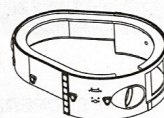

QX2



铜缆 100mm
Brass wire



车面
Upper hull

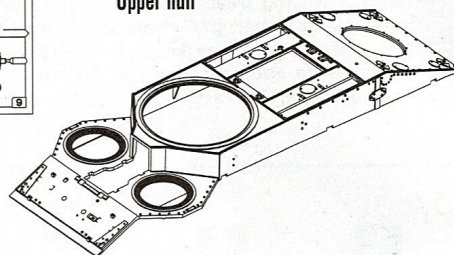

U

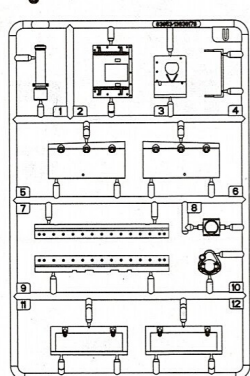

G

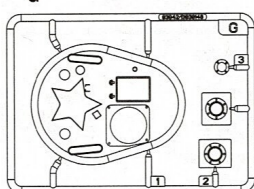

S2

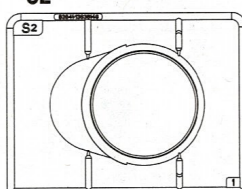

蚀刻片 B
PE-B

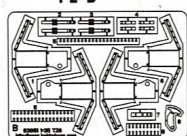

蚀刻片 A
PE-A

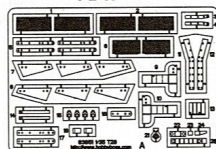

车底
Lower hull

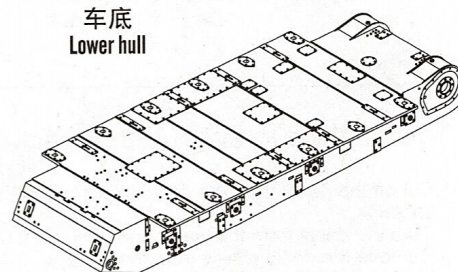

不用部品: B10、B15、B25、E4、G2、G3、T2、T3、U4、PE-B3、PE-B7;
No used parts

1
STEP

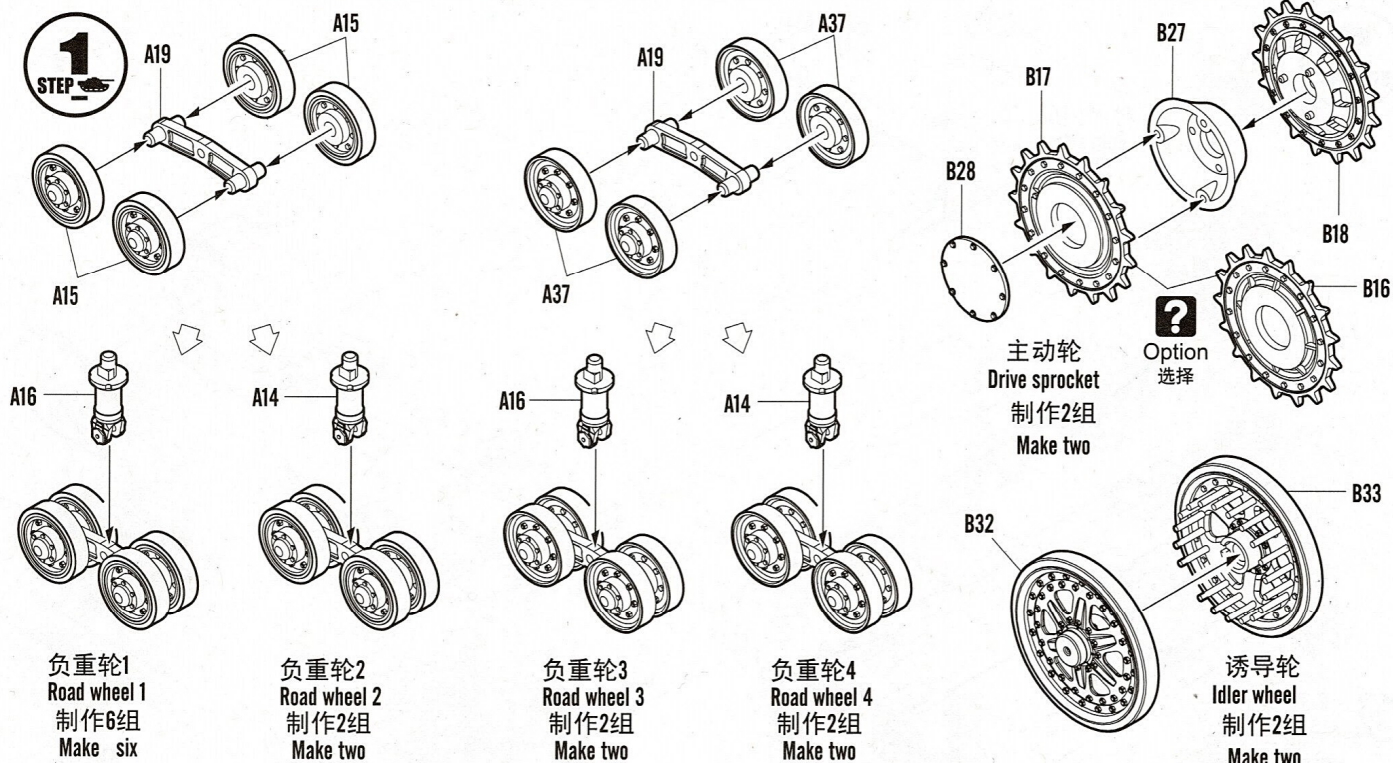

2
STEP

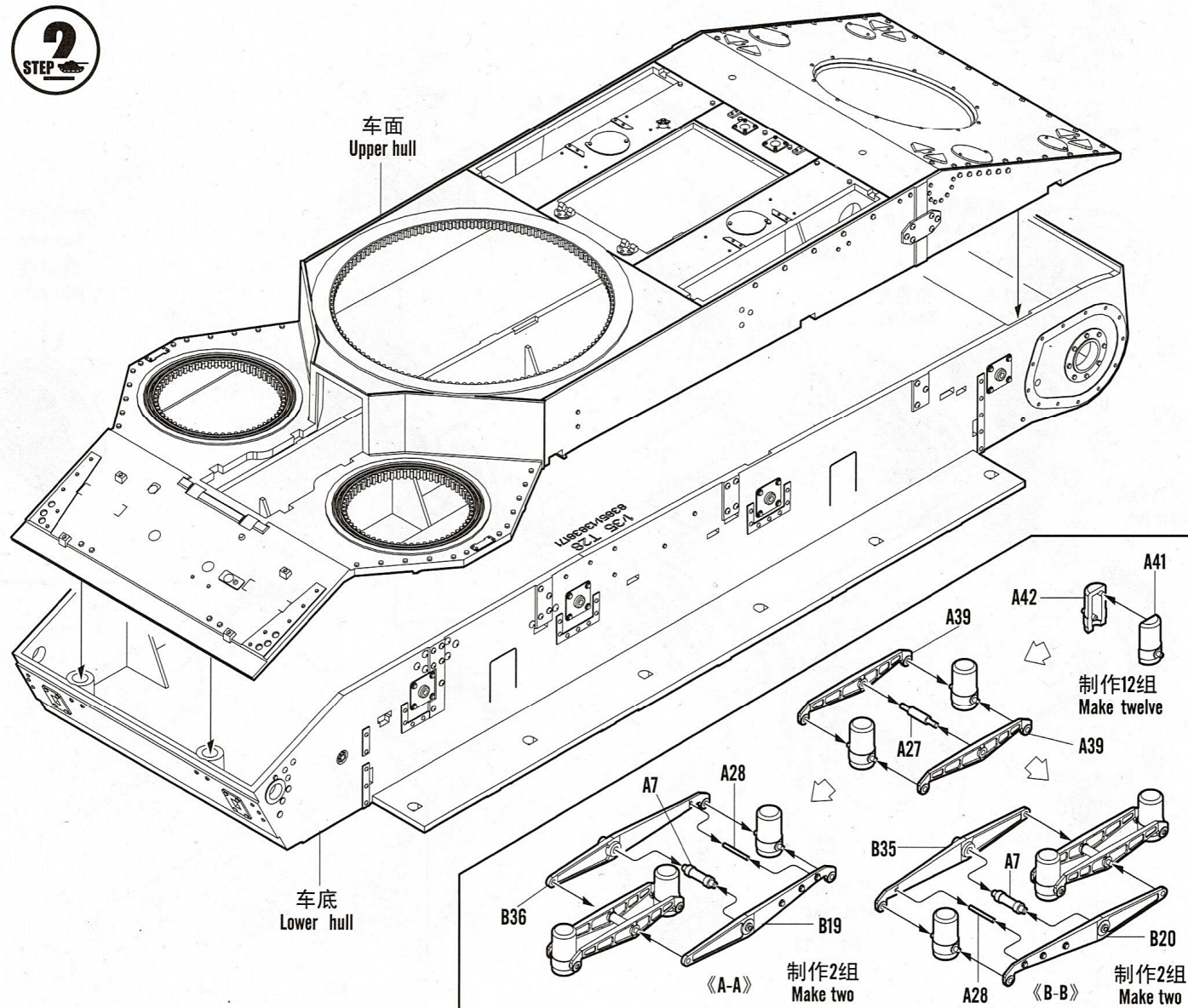

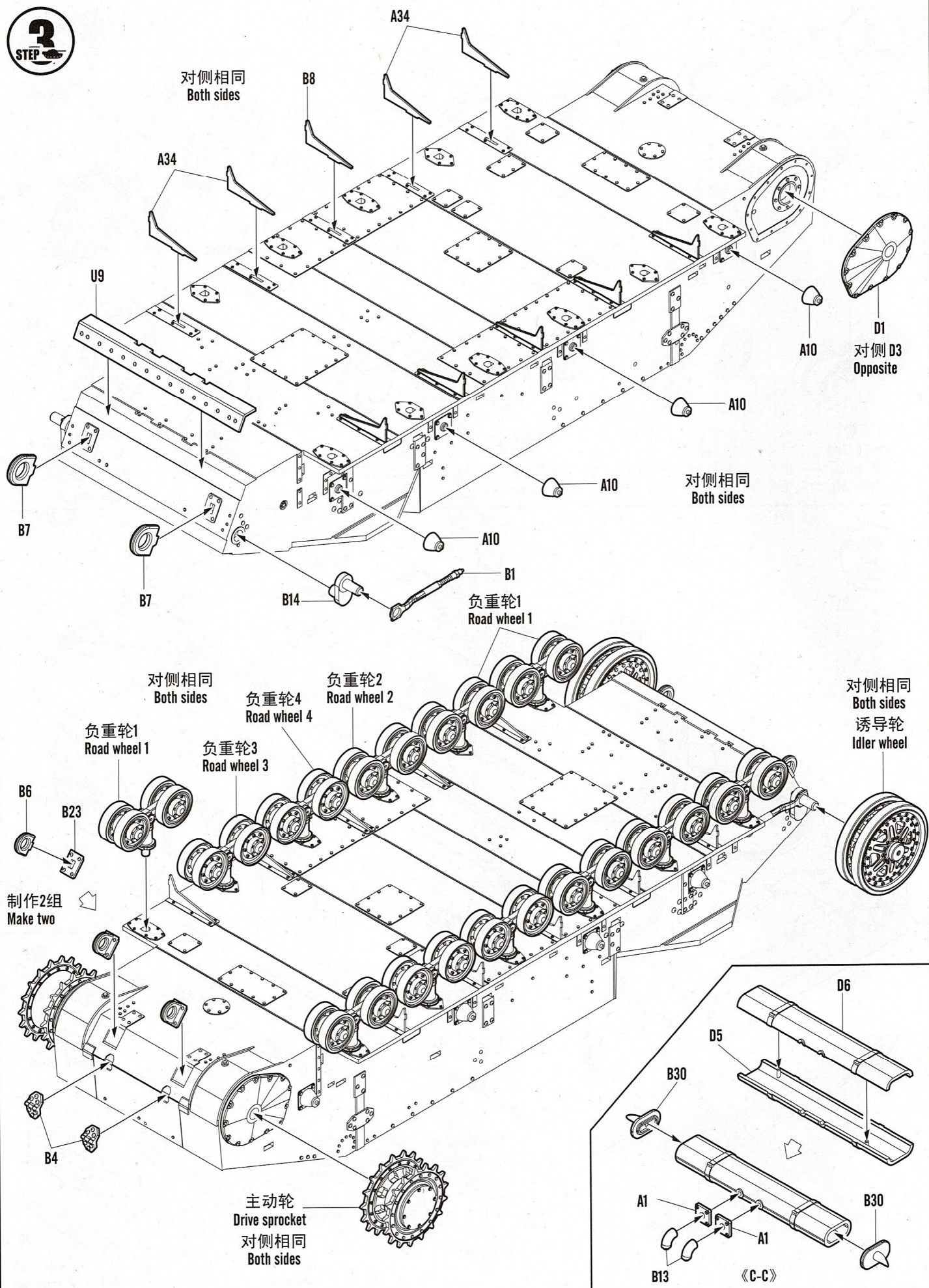

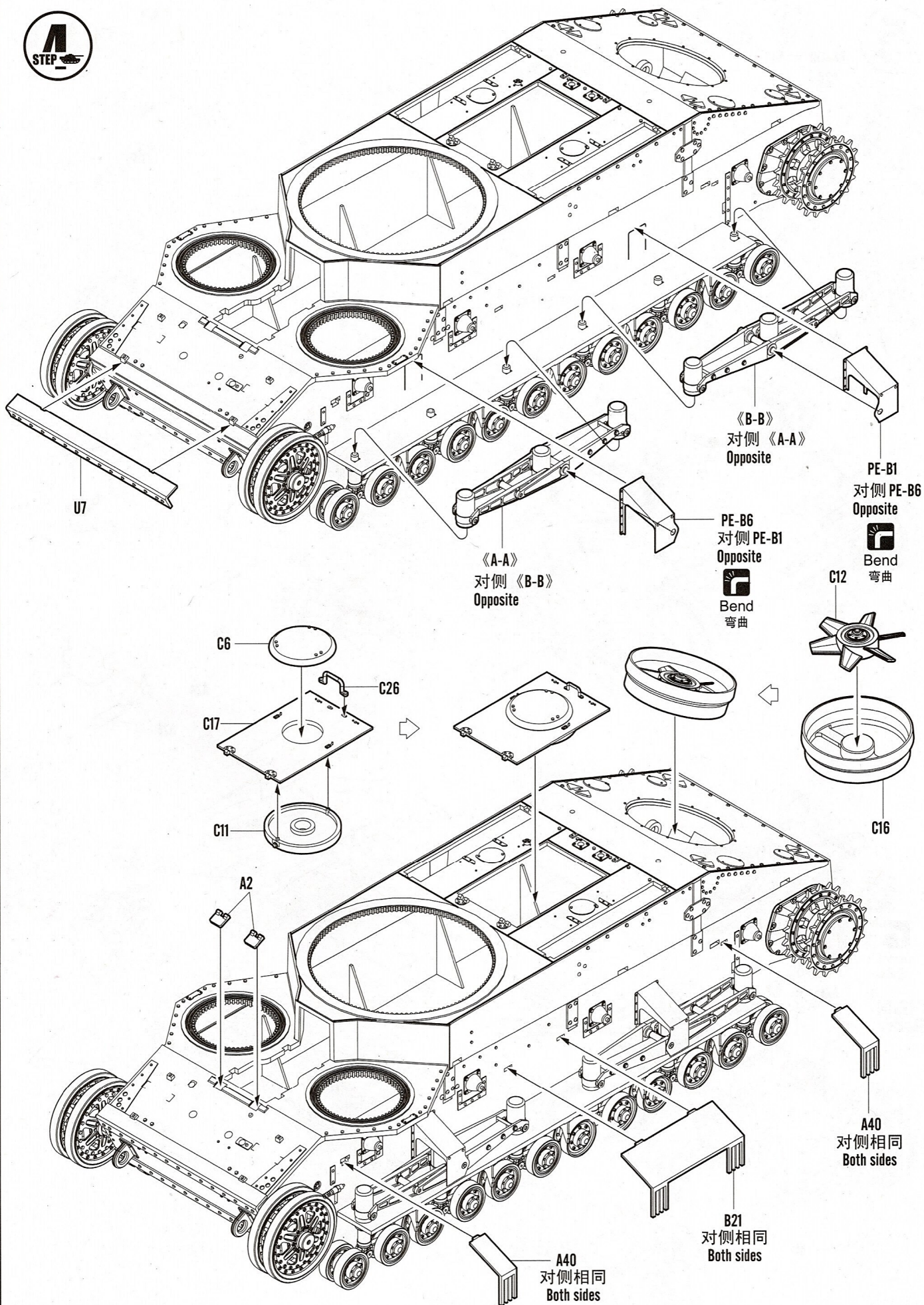

5
STEP

PE-A19
C20

PE-A20

C21

C8

C28

《C-C》

A24

D14

A26

A25

《D-D》

E14

C13

C22

《C-C》

对侧 《E-E》
Opposite

D8

A24

A26

A25

对侧 《D-D》
Opposite

Q1

A36

A24

A25

A26

B31

制作2组
Make two

C4

A24

A26

A25

《E-E》

PE-A15

PE-A15

Bend
弯曲

Bend
弯曲

A21

对侧相同
Both sides

D13
对侧 D15
Opposite

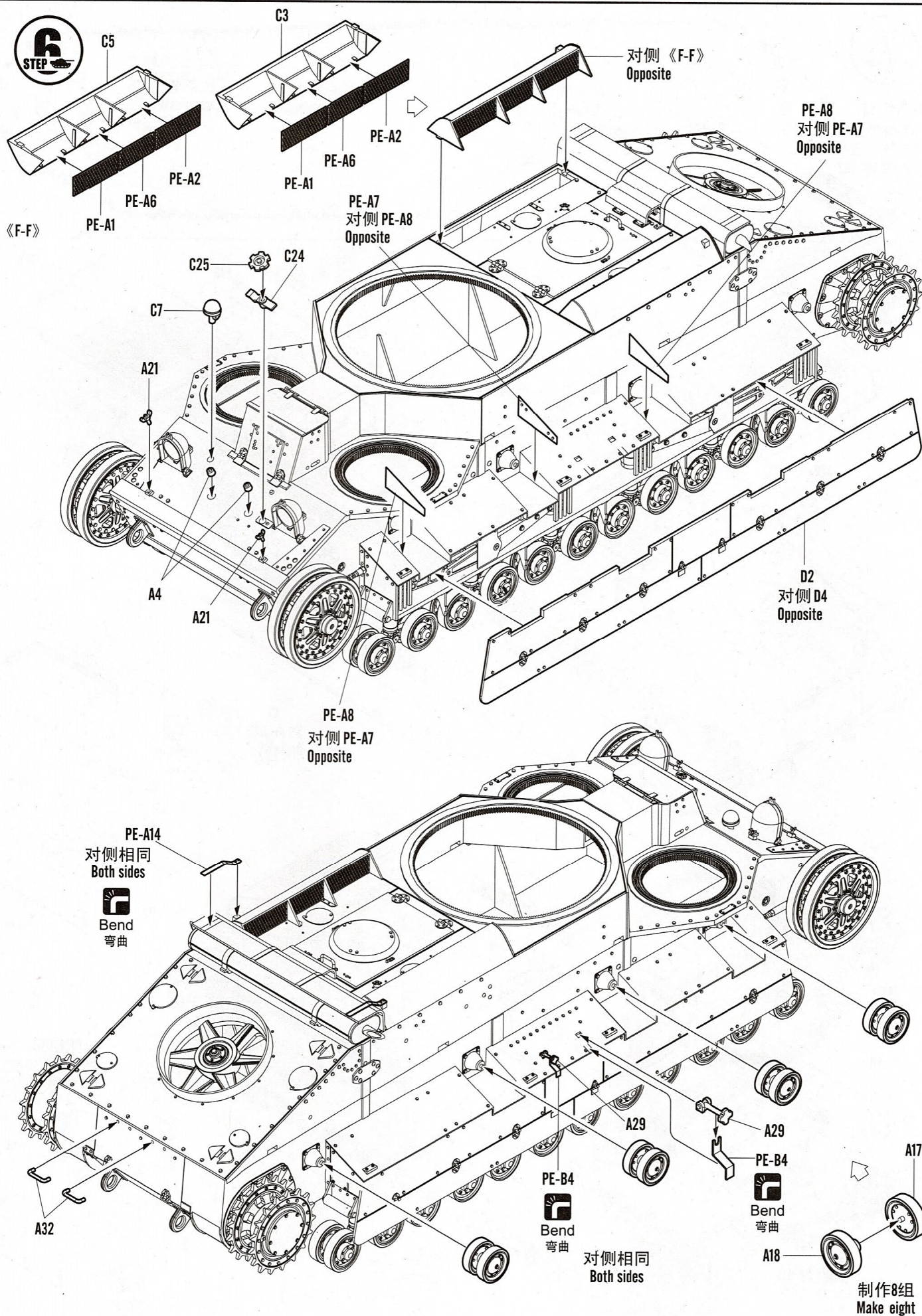

7
STEP

履带组装
Track assembly
右侧TR1, 左侧TR2
Right TR1, Lift TR2

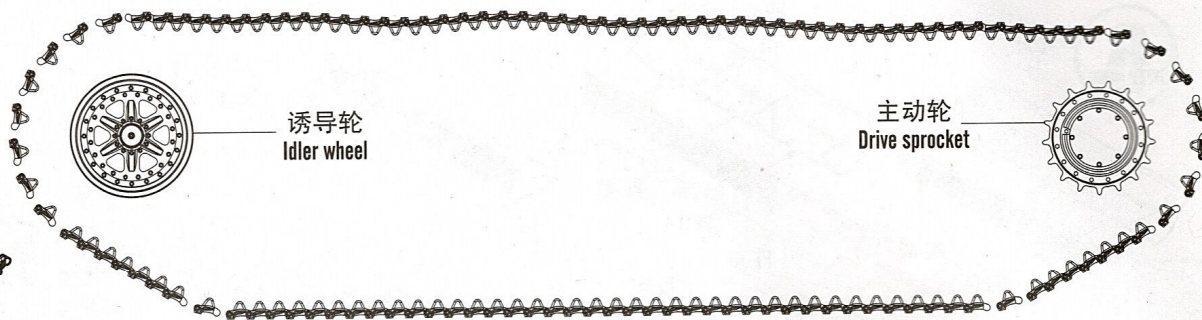
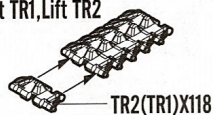

8
STEP

对侧相同
Both sides

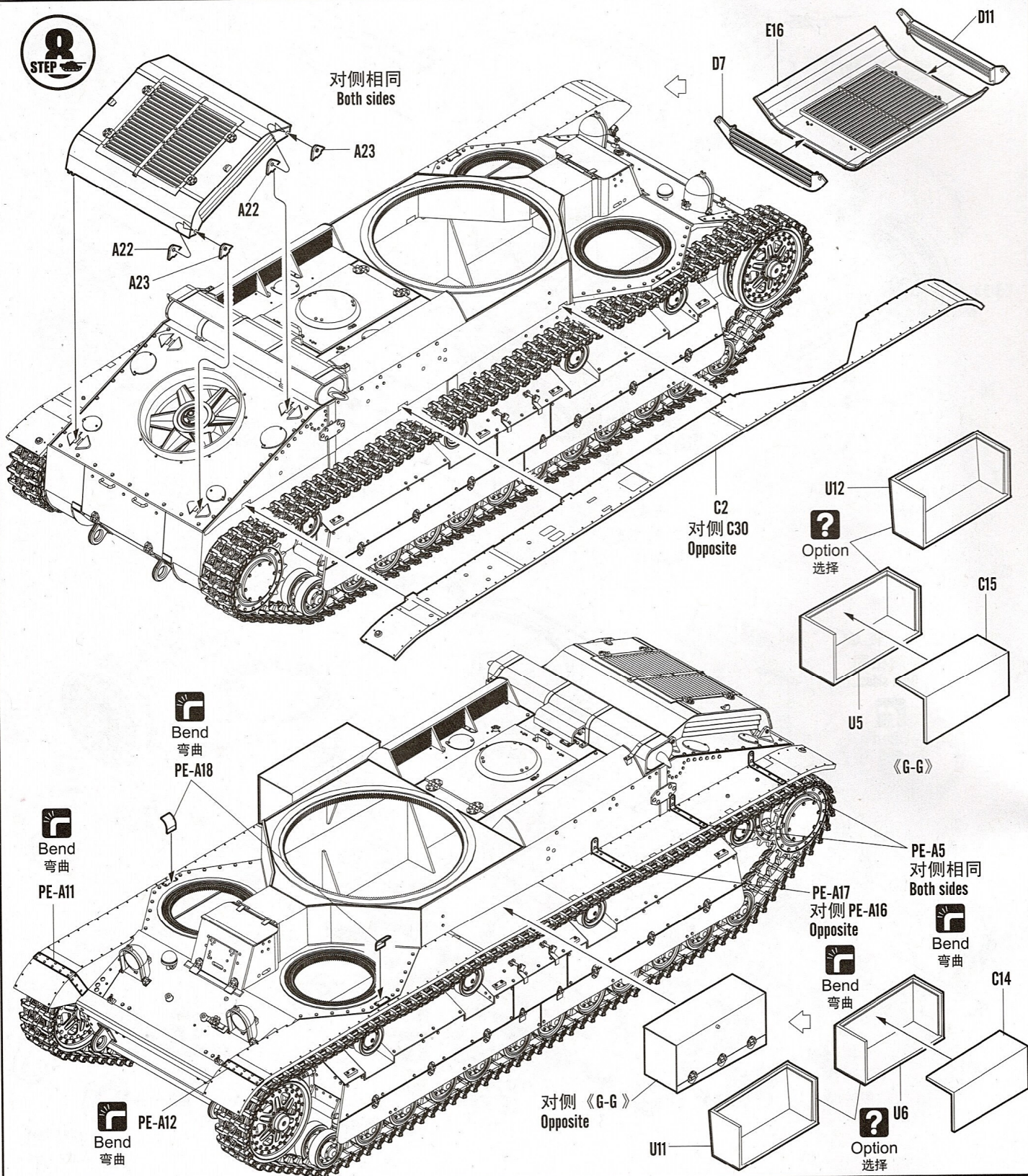



PE-A9



Bend
弯曲



对侧 A3+PE-A10
Opposite

C23

A3

制作2组
Make two

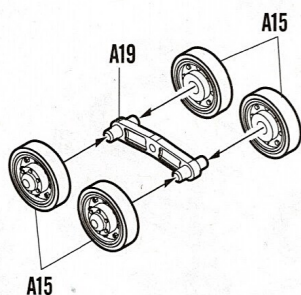
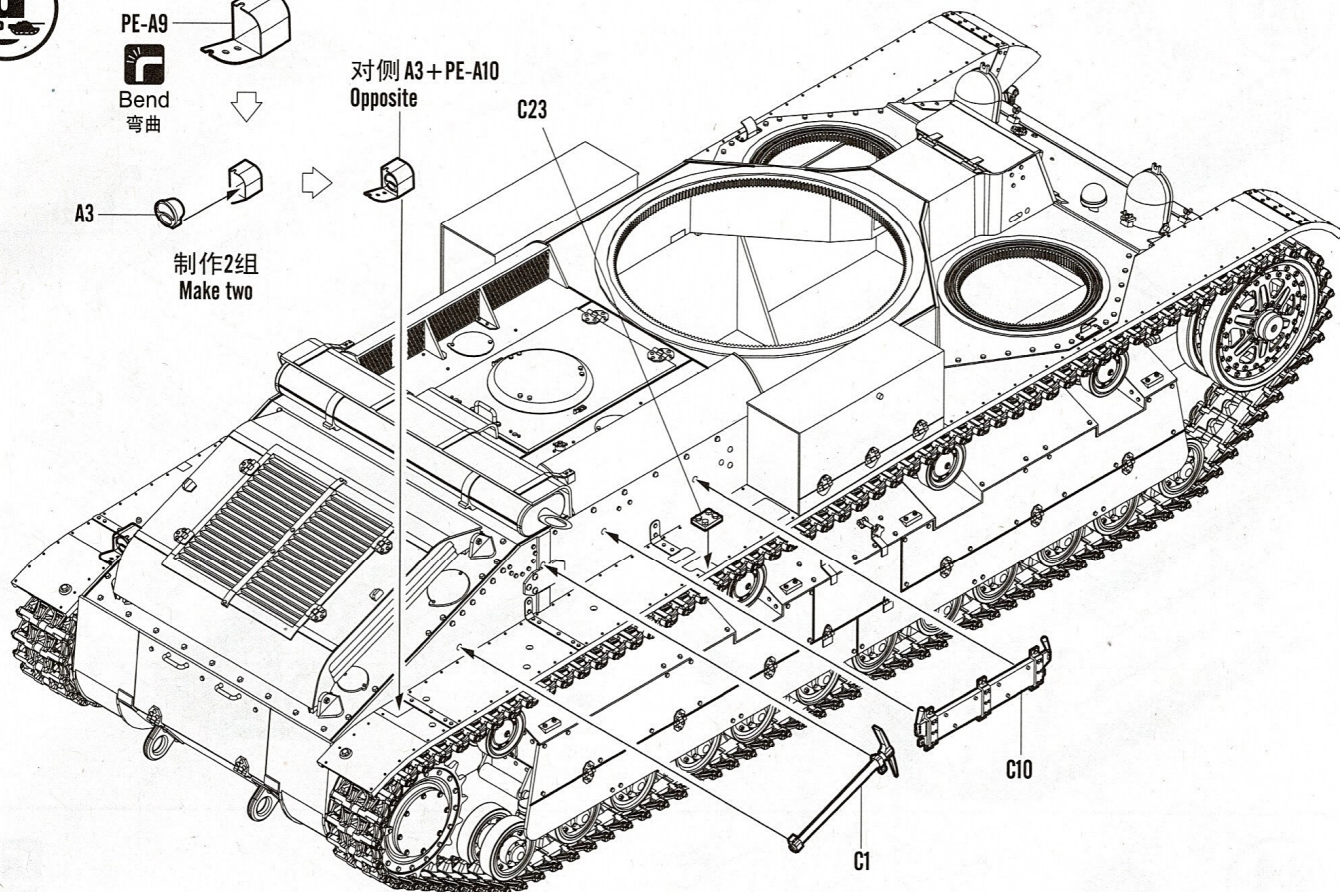

B5

B5

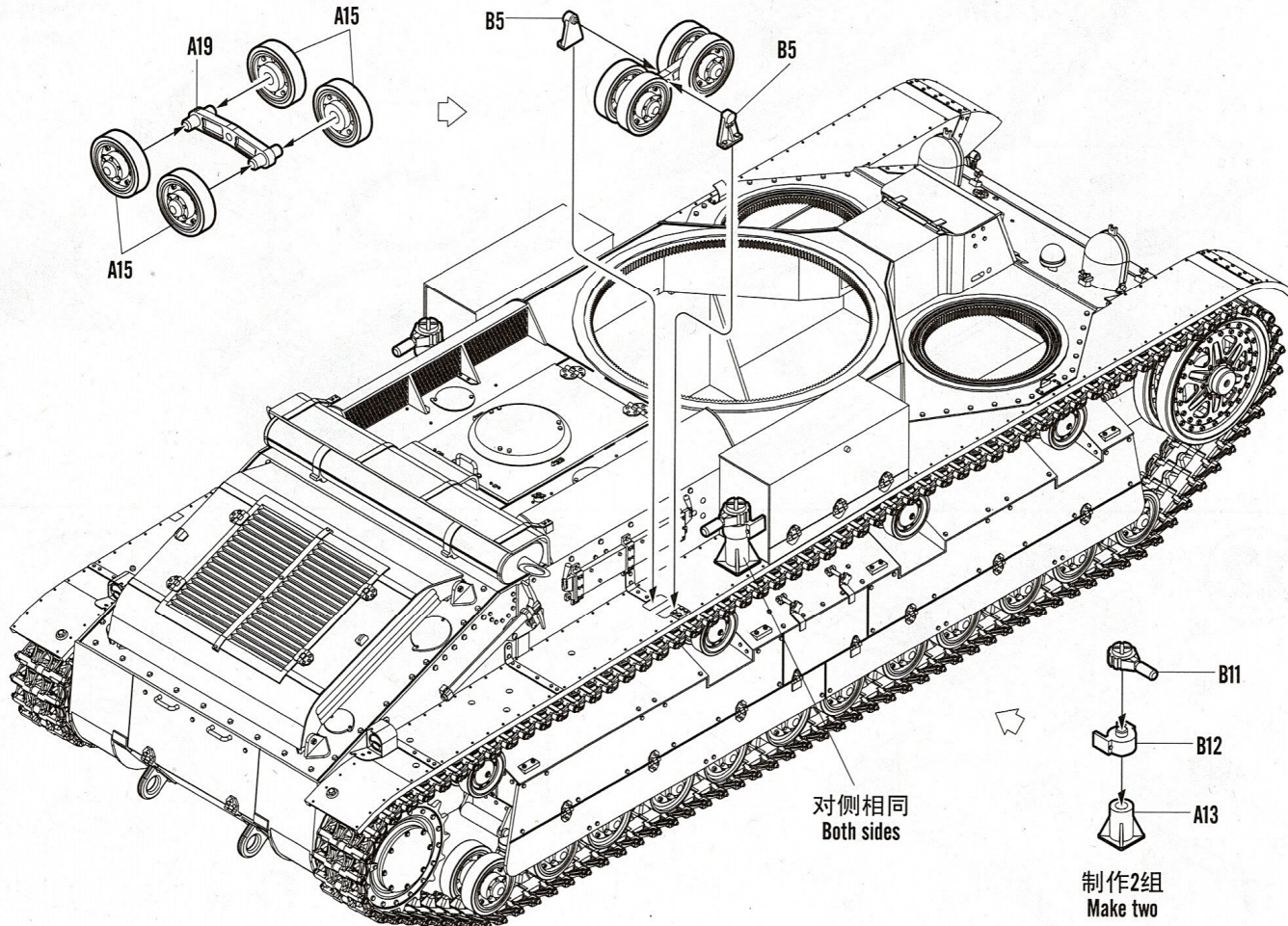

对侧相同
Both sides

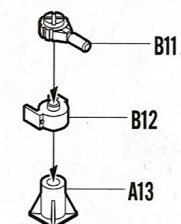

制作2组
Make two

10
STEP

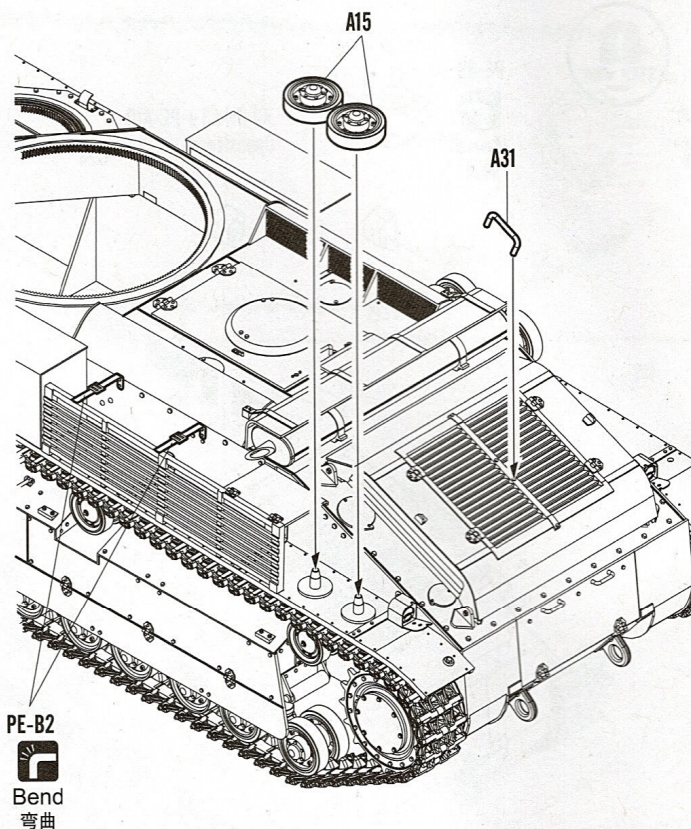
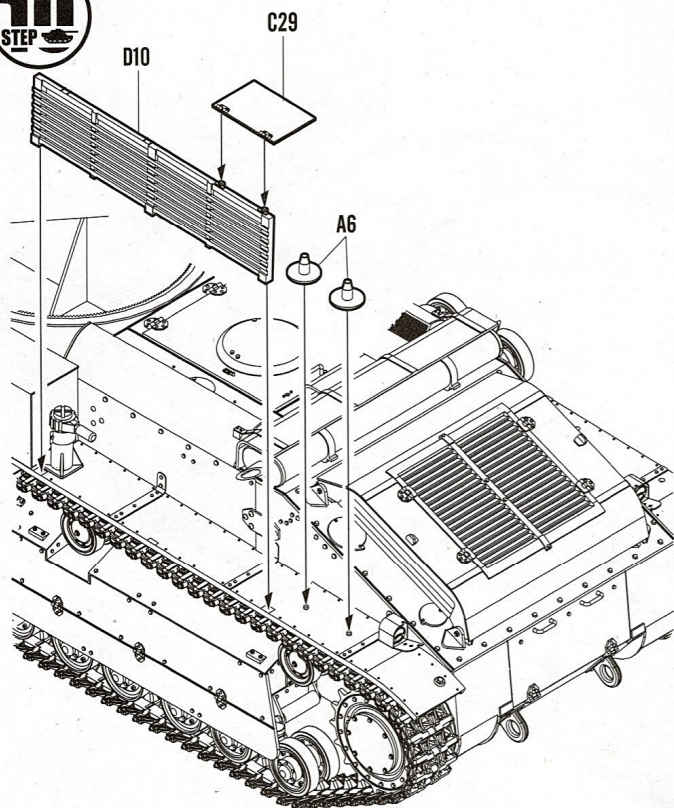

11
STEP

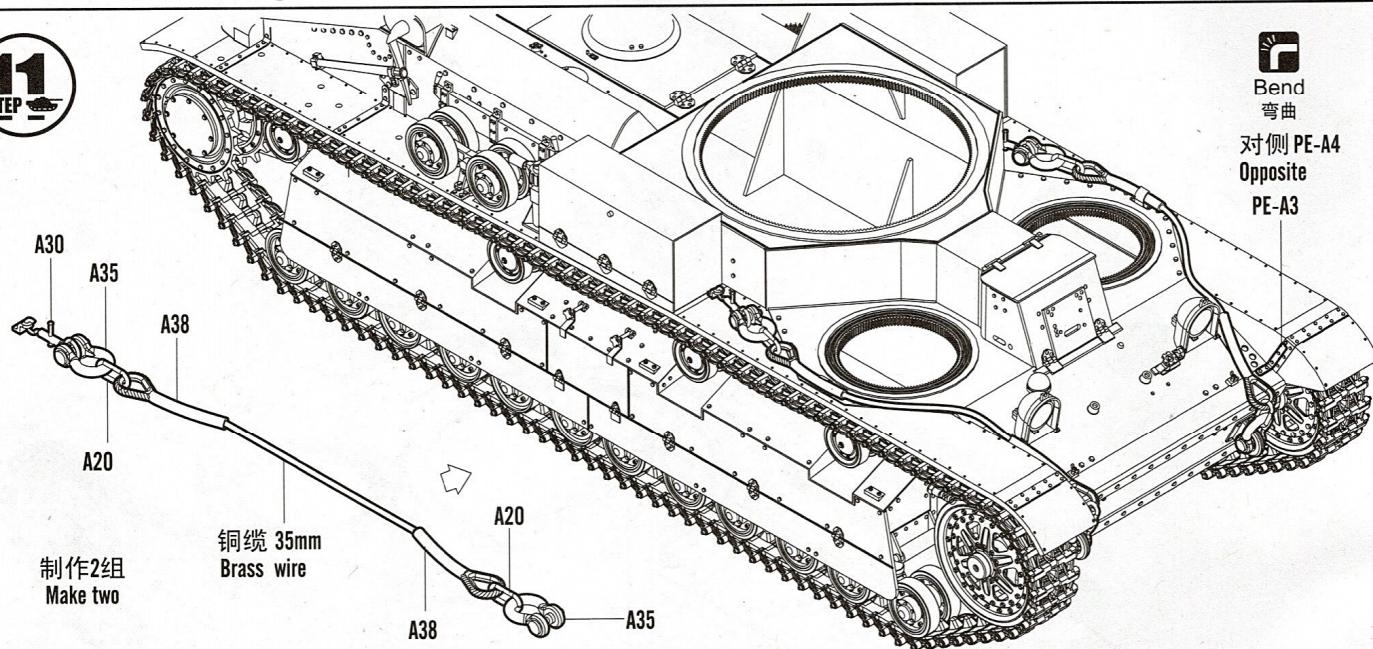

12
STEP

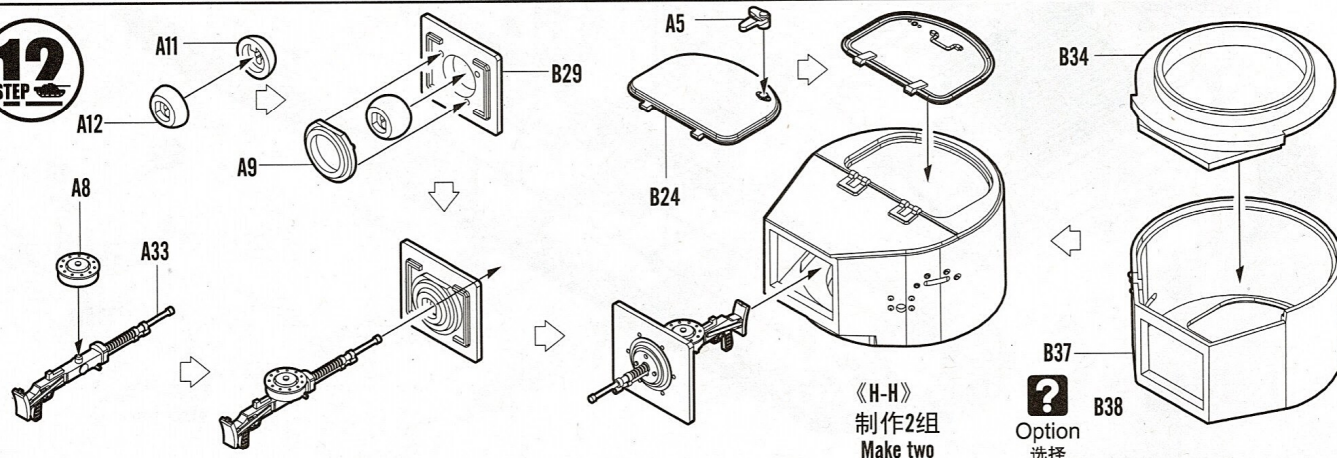

13
STEP

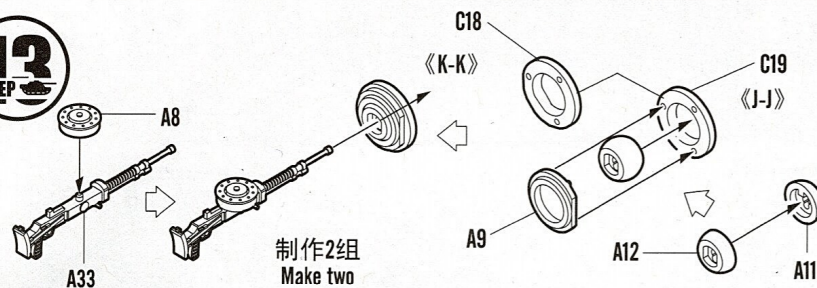

?
Option
选择

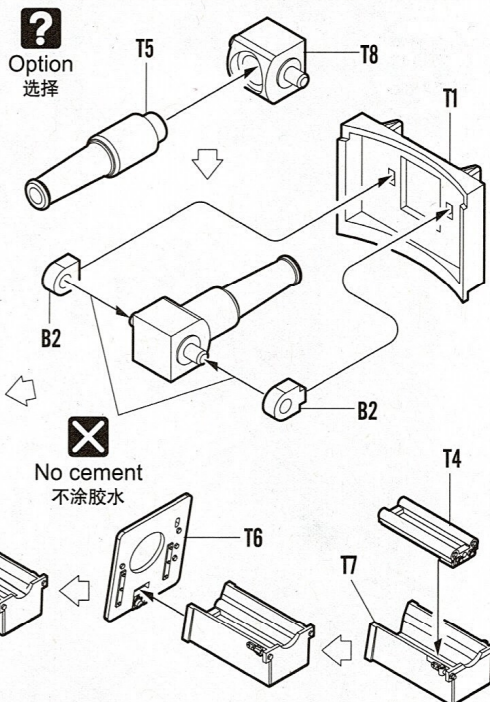

$\langle L-L \rangle$

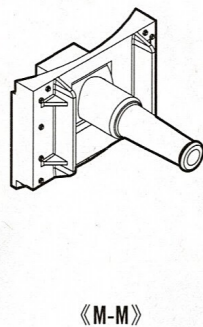
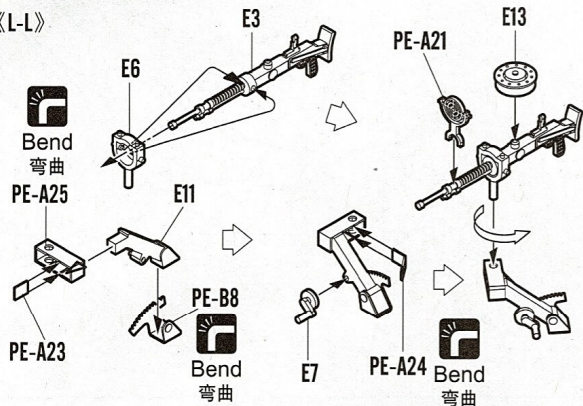

?
Option
选择

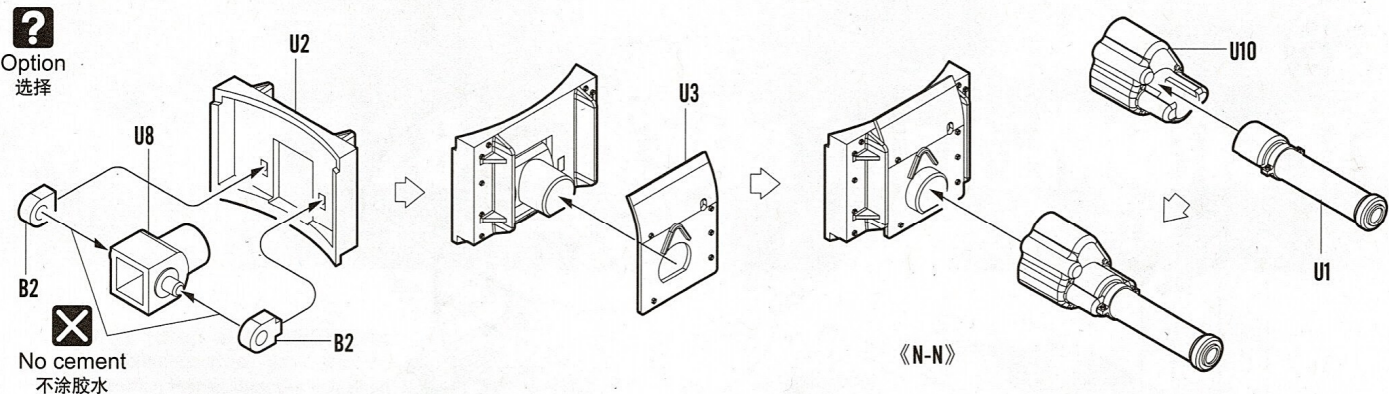

14
STEP

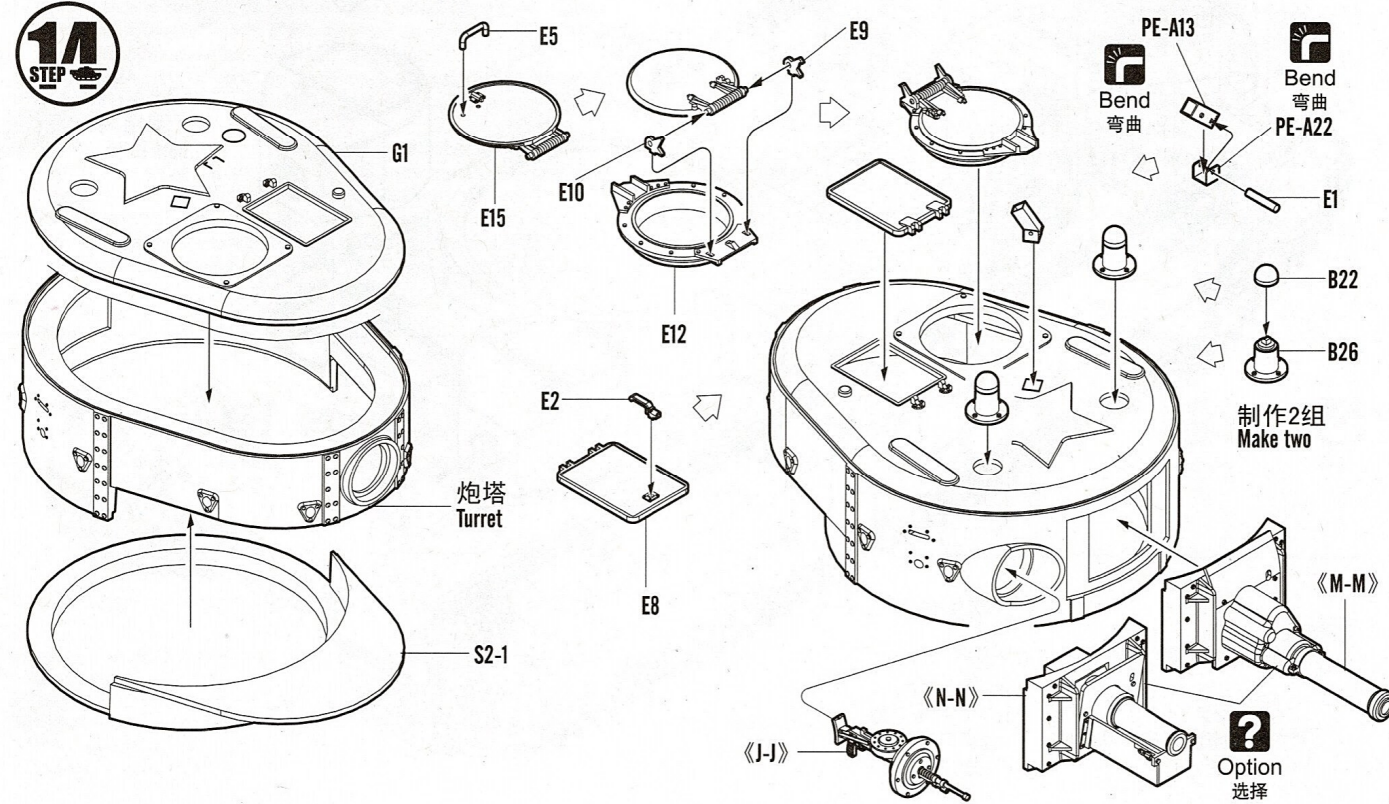

15
STEP

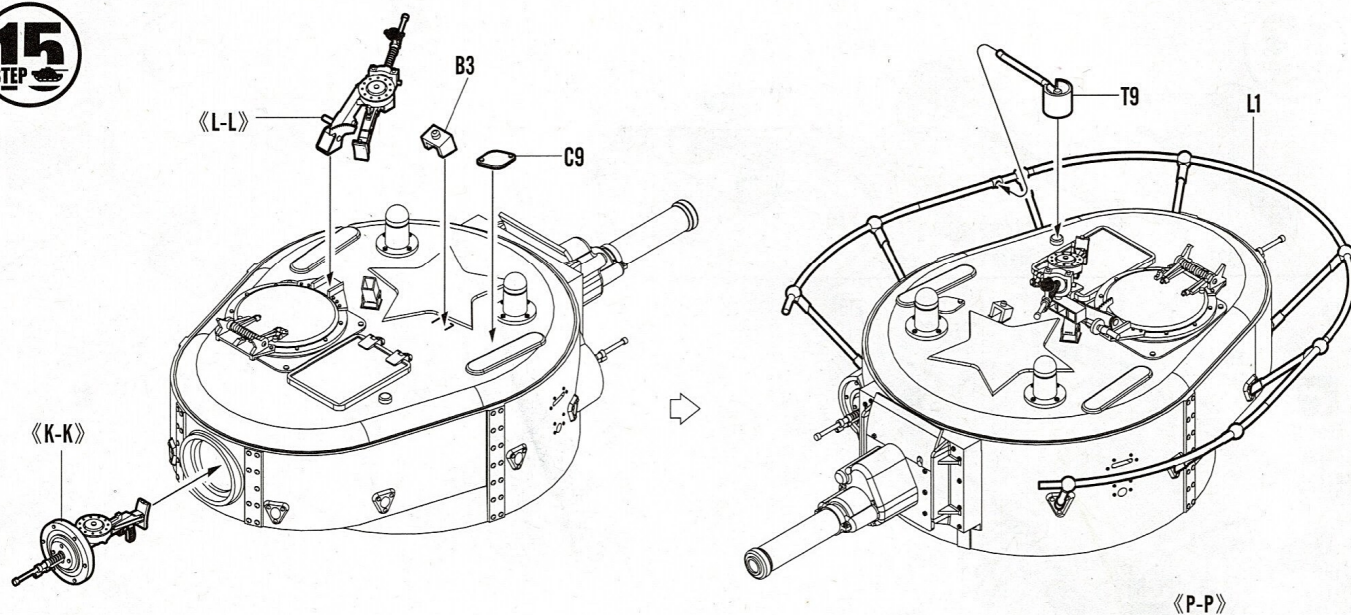

16
STEP

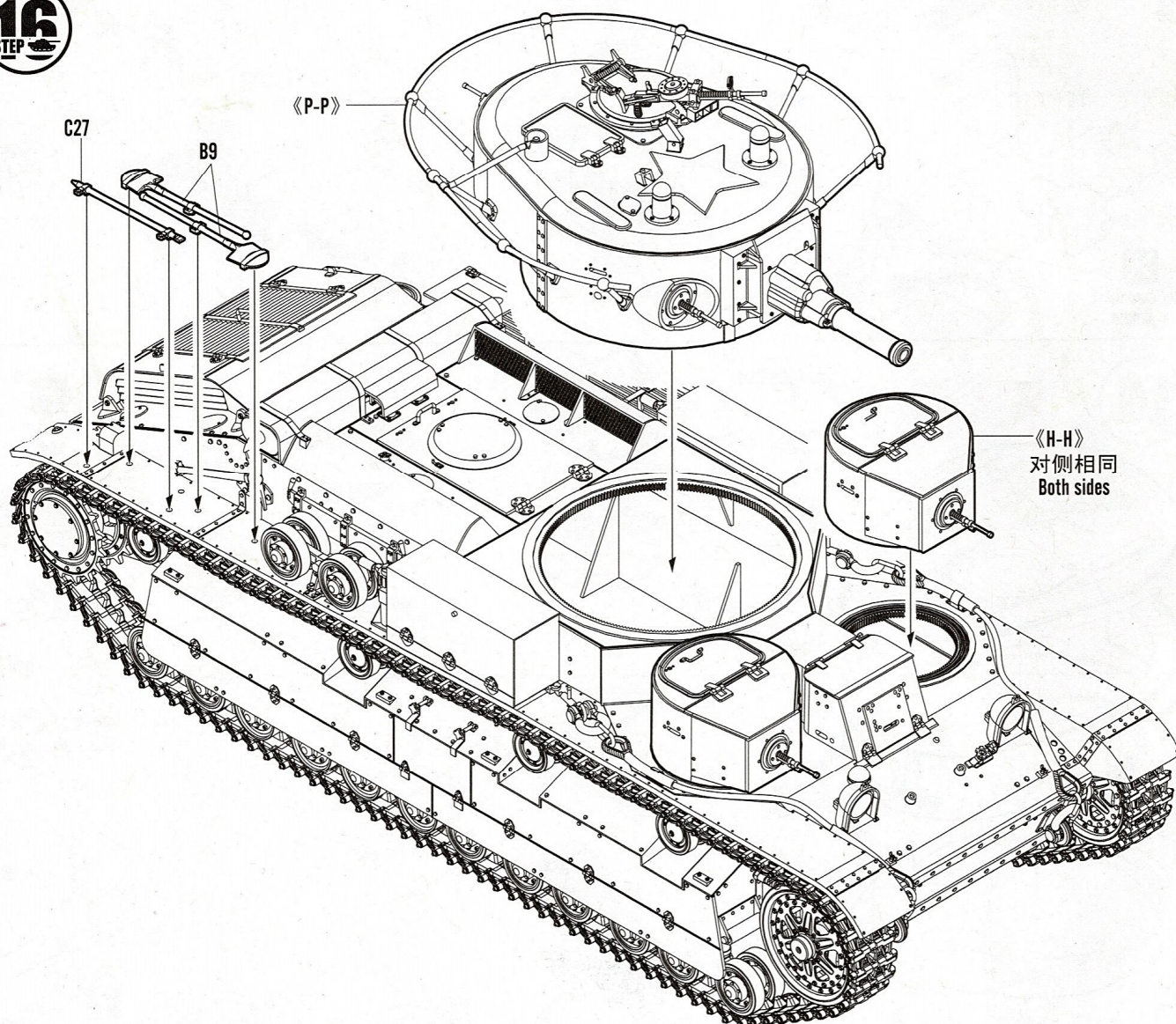

I

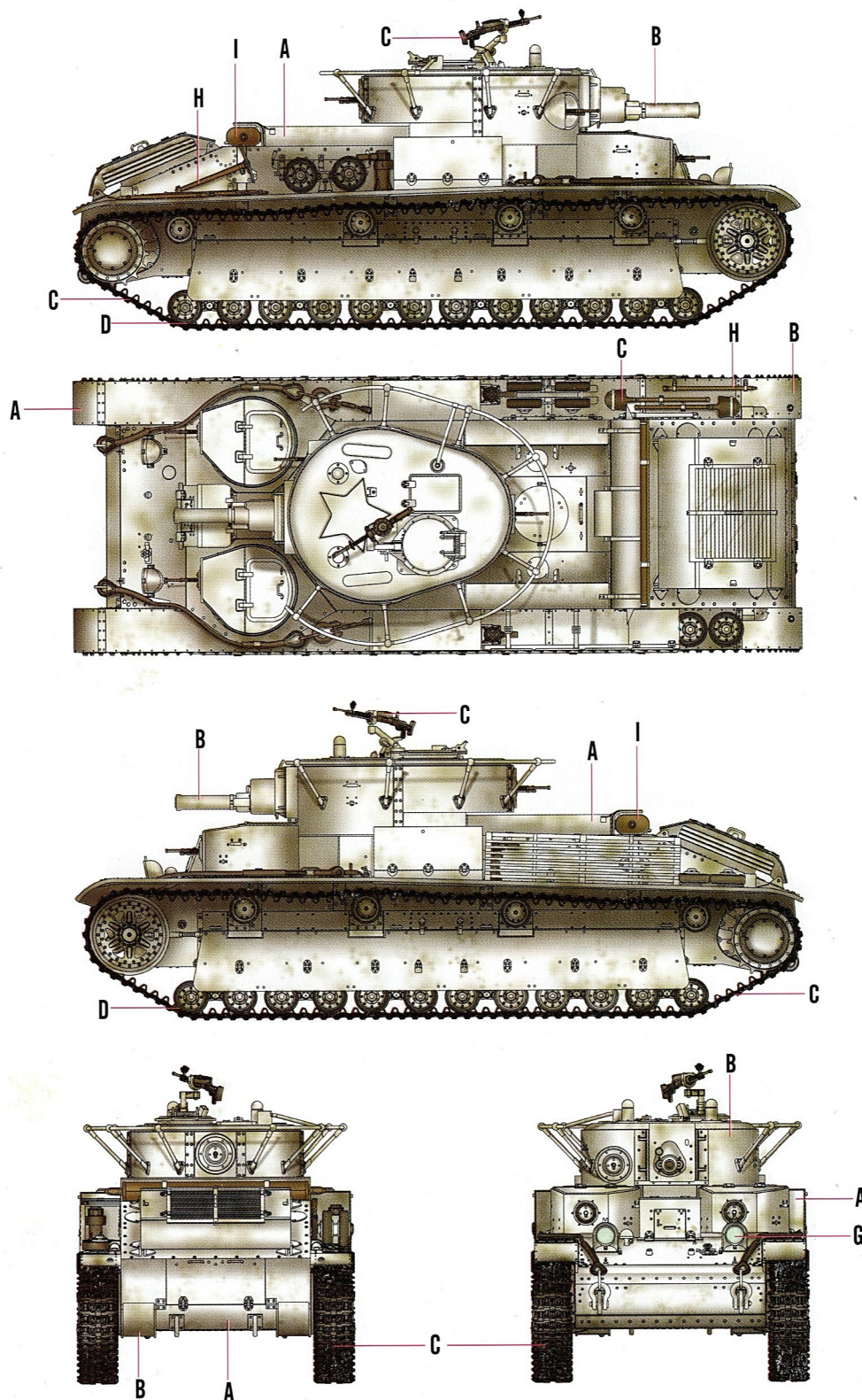

| | Color | Mr.Hobby | Vallejo | Model Master | Tamiya | Humbrol |
|---|----------------------|-----------|---------|--------------|--------|---------|
| A | 白色 White Insignia | H 316 316 | 991 | 1745 | X2 | 22 |
| B | 绿色 Forest Green | H 309 309 | 893 | 1710 | XF58 | 116 |
| C | 黑铁色 Steel | H 18 28 | 864 | 1402 | -- | -- |
| D | 胎黑色 Tire Black | H 77 137 | -- | -- | -- | -- |

II

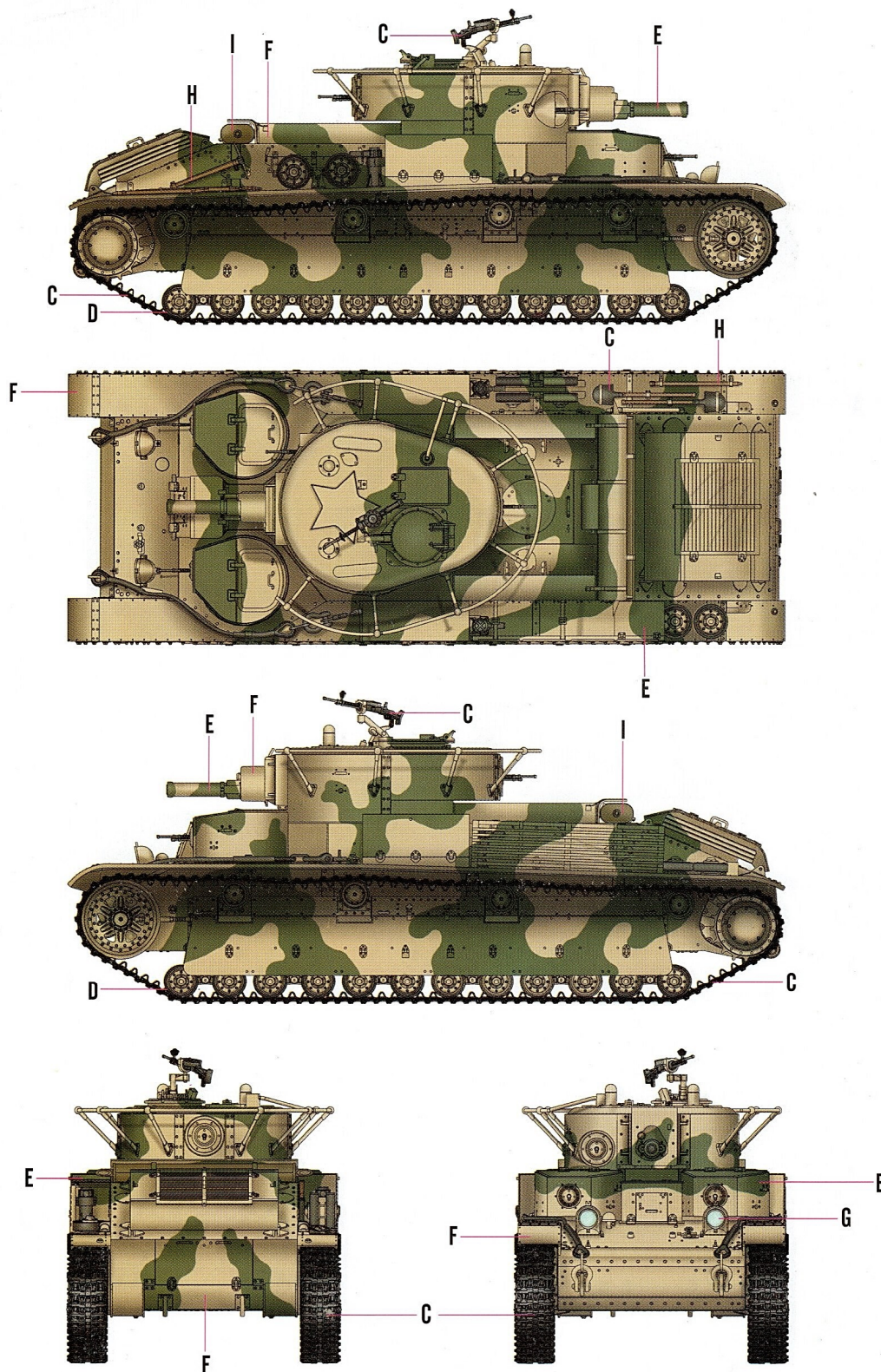

| | Color | Mr.Hobby | Vallejo | Model Master | Tamiya | Humbrol |
|---|--------------------|-----------|---------|--------------|--------|---------|
| E | 绿色 Green | H 303 303 | -- | 1713 | XF20 | 117 |
| F | 砂黄色 Sandy Brown | H 79 39 | 824 | -- | XF59 | 111 |
| G | 透明蓝 Clear Blue | H 93 50 | 938 | -- | X23 | -- |
| H | 木棕色 Wood Brown | H 37 43 | 983 | 1701 | -- | 186 |
| I | 烧铁色 Burnt Iron | H 76 61 | 863 | 1795 | X10 | 53 |