

eduard
Express Mask

F-18A/B/C

The die-cut mask for accurate canopy frame painting of the
Italeri 1/72 KIT

XS 220



LIQUID MASK
MASCOL



B32
2pcs.



B37
2pcs.



B38
2pcs.

1.)

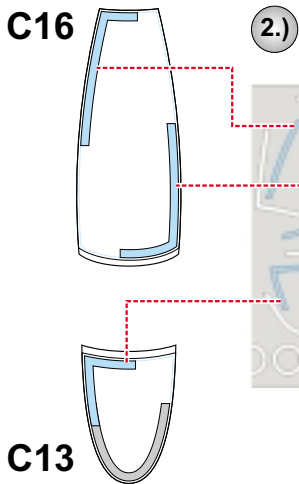
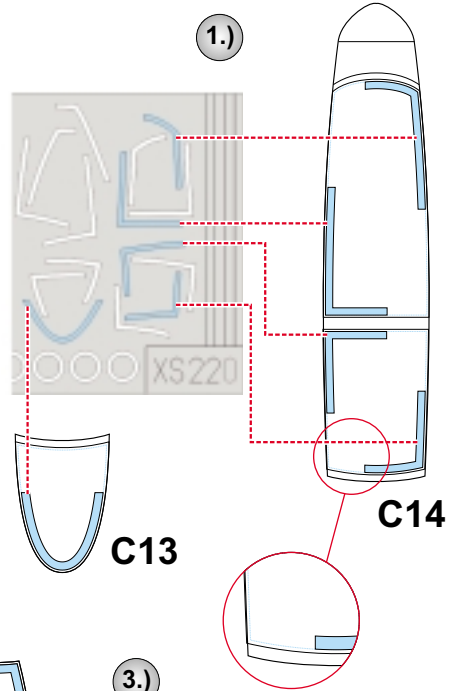

2.)

C14

C16

3.)

C13

LIQUID MASK
MASCOL

C14

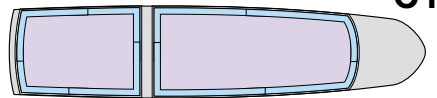

4.)

INTERIOR COLOR
BARVA INTERIÉRU

5.)

RUBBER COLOR
BARVA GUMY

C13

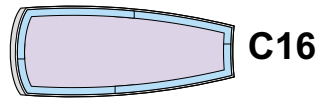

C14



6.)

REMOVE MASK
ODSTRANIT MASKU

C13



C16

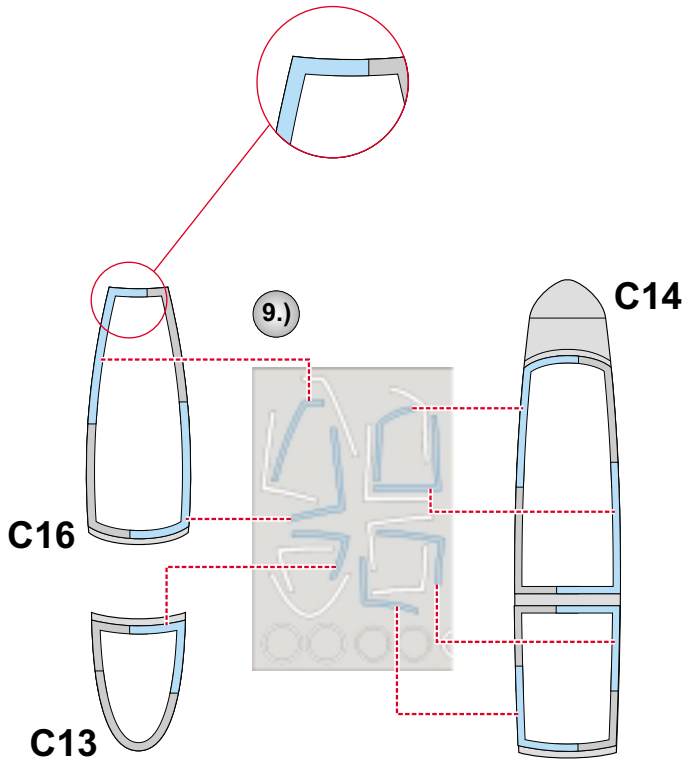
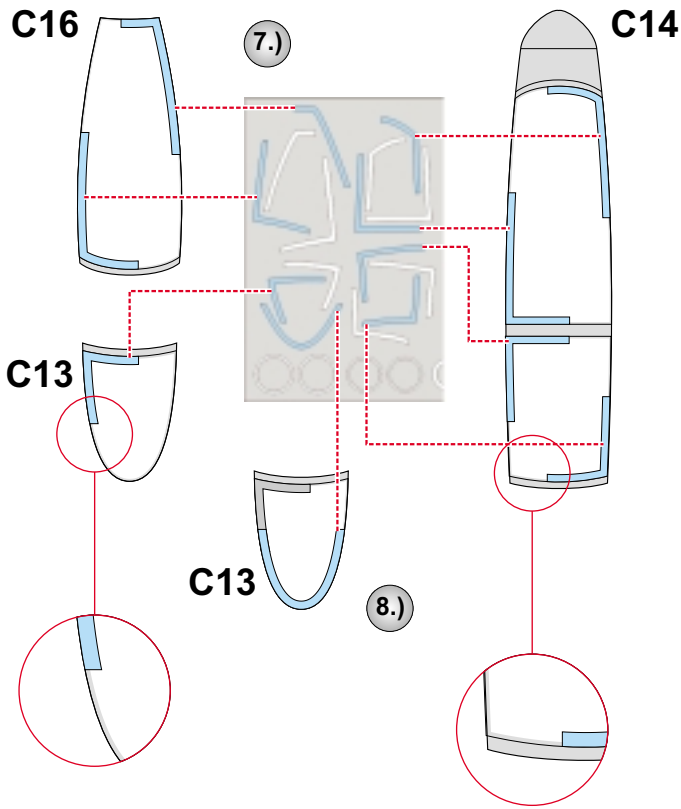

10.)



CAMOUFLAGE COLOR
BARVA KAMUFLÁŽE

11.)

REMOVE MASK
ODSTRANIT MASKU

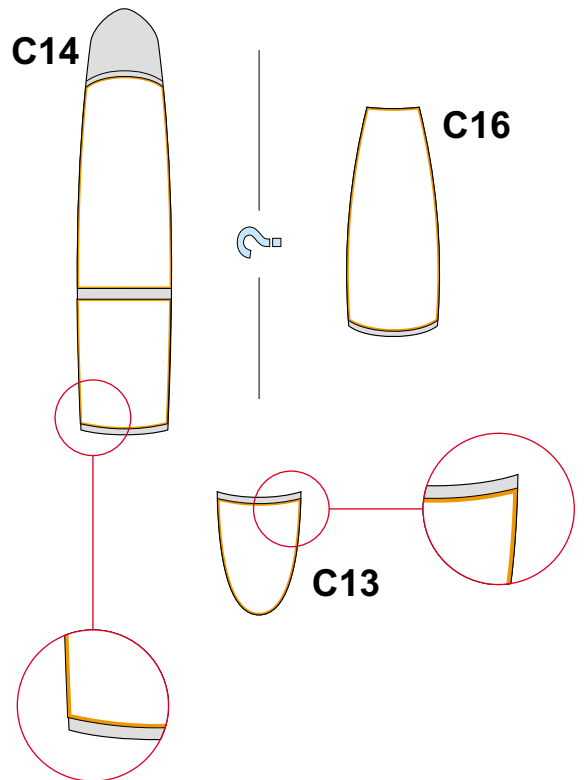
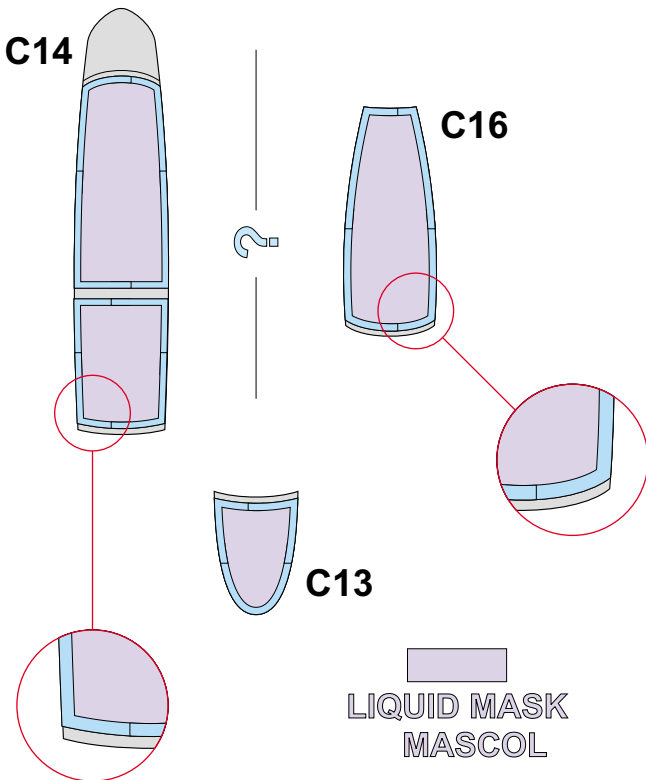

REFERENCES: REPLIC No. 48/1995
Letectví + Kosmonautika No.78 3/2002
Modeling No. 64 10/1996