

MIG-29 "FULCRUM"

1/48 SCALE **L4811** 9-12 LATE TYPE 米格-29“支点”战斗机 9-12 后期型

G.W.H™



• *Special thanks to Mr. Alexander Drannikov and Mr. Yufei Mao.*

The Mikoyan MiG-29 (Russian: Микоян и Гуревич МиГ-29; NATO reporting name: "Fulcrum") is a fourth-generation jet fighter aircraft designed in the Soviet Union for an air superiority role. Developed in the 1970s by the Mikoyan design bureau, it entered service with the Soviet Air Force in 1983, and remains in use by the Russian Air Force as well as in many other nations. The NATO name "Fulcrum" was sometimes unofficially used by Soviet pilots in service.

The MiG-29 was first publicly seen in the West when the Soviet Union displayed the aircraft in Finland in July 1986. Two MiG-29s were also displayed at the Farnborough Airshow in Britain in September 1988.

MiG-29 (Product 9.12) is the initial production version and entered service in 1983. NATO reporting code is "Fulcrum-A". The later 9-12 type was modified from the early 9-12 type, flare dispensers and some other equipment were added.

米格-29是前苏联米高扬-格列维奇飞机设计局设计的双发高性能制空战斗机。北约组织给予的绰号是“支点”(Fulcrum)。米格-29于1983年开始装备前苏联空军，并在1986年6月的访问芬兰过程中首次向西方亮相，随后于1988年参加英国范堡罗航展，以其高机动性飞行表演轰动一时。米格-29的海外用户包括了阿尔及利亚、孟加拉、保加利亚、古巴、捷克斯洛伐克、厄立特里亚、东德、匈牙利、印度、伊朗、伊拉克、马来西亚、缅甸、朝鲜、秘鲁、波兰、罗马尼亚、塞尔维亚、斯洛伐克、叙利亚与也门。另外，苏联解体时，白俄罗斯、哈萨克、摩达维亚、土库曼、乌克兰、乌兹别克等前加盟共和国亦自前苏联空军分得了大批数量。这些飞机状况不一，其中许多至今仍在其新用户的手中服役。

General characteristics

Length: 17.37 m (57 ft) Wingspan: 11.4 m (37 ft 3 in) Height: 4.73 m (15 ft 6 in) Wing area: 38 m² (409 ft²) Empty weight: 11,000 kg (24,250 lb) Loaded weight: 15,300 kg (33,730 lb) Max. takeoff weight: 20,000 kg (44,100 lb) Powerplant: 2xKlimov RD-33 afterburning turbofans, 8,300 kgf (81.4 kN, 18,300 lbf) each Performance : 2.25 (2,400 km/h, 1,490 mph) At low

altitude: Mach 1.25 (1,500 km/h, 930 mph): 1,430 km (772 nmi, 888 mi) with maximum internal fuel: 2,100 km (1,300 mi) with 1 drop tank: 18,013 m (59,100 ft); initial 330 m/s average 109 m/s 0-6000 m (65,000 ft/min): 442 kg/m² (82 lb/ft²): 1.08-1.1

Armament: 1x30 mm cannon with 150 rounds; 7 Hard points: 6x pylons under-wing, 1x under fuselage Up to 3,500 kg (7,720 lb) of weapons including six air-to-air missiles - a mix of (SARH) and, FAB 500-M62, FAB-1000, TN-100, ECM Pods, Avionics: N019,

米格-29 9-12后期型是9-12前期型的改进型，加装了干扰弹发射器等装备。也有很多9-12早期型升级到后期型。北约给其取的代号为“支点-A”。

机长(含空速管): 17.32m; 翼展: 11.36m; 全高: 4.73m。空重: 8.175t; 正常起飞重量(截击): 15吨; 最大起飞重量: 18t; 翼面积: 35.20m²。最大平飞速度(12000米): 2.3马赫; 海平面, 爬升率: 330米/秒; 实用升限: 17000米; 滑跑距离: 起飞: 240m; 着陆: 600m。引擎: RD-33涡轮扇叶引擎x2; 最大军用推力: 100 knt (50knt x 2); 最大后燃推力: 168.2 knt (84.1knt x 2)。对空装备: 30mm机炮x1 AA8、AA9、AA10、AAM、AA12等六发导弹。

△注意:

1. 勿於近火處使用膠水或油漆，並打開窗戶保持空氣流通。
2. 塗料的號碼請參考本欄以下的說明。本品本身不包括膠水和塗料。
3. 自膠架中取出部件時，應用模型專用剪，並用介刀或小挫除去多餘膠料。
4. 各圖形的含義可參考本欄以下的說明。

△CAUTION:

1. When you use glue or paint, do not use near a open flame, and use in a well-ventilated room.
2. See below for the color list. Glue and paint are not included in this kit.
3. When you take parts off the runner frame, use the modeling scissors and trim excess plastic with a cutter or a file.
4. See below for the meaning of symbols.

組み立ての注意:

1. 接着剤や塗料は火の近くで使わないで下さい、使用の際は換気をよくして下さい。
2. 塗料指定のは下記のとおりです、接着剤や塗料は入っていないので別に求めて下さい。
3. 部品のランナーから切り離す時は模型用ハサミ等を使い、余分な部分はカッターやヤスリ等で仕上げして下さい。
4. 組立図のサインマークは下の説明を御覧下さい。

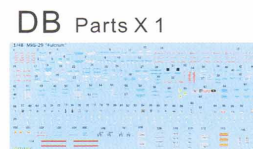
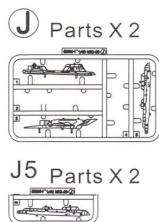
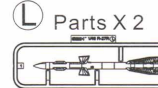
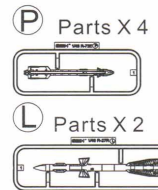
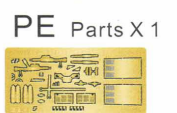
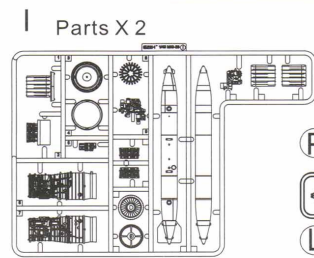
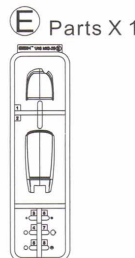
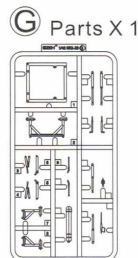
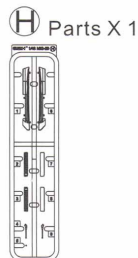
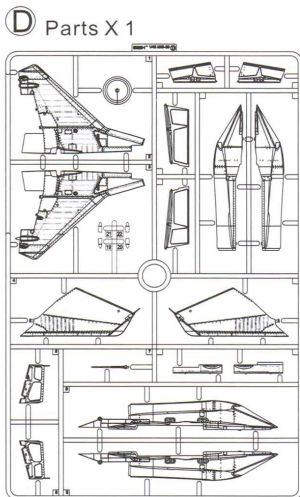
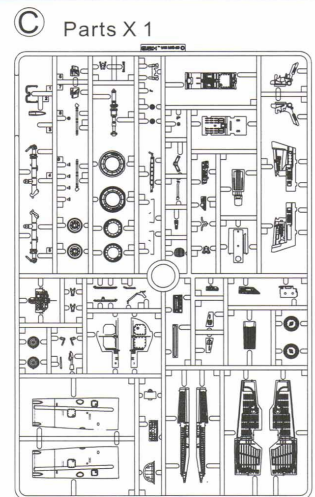
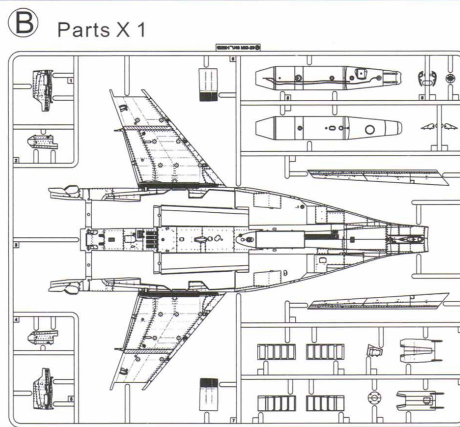
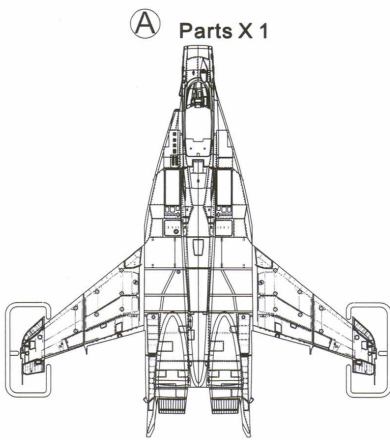

C 000 GSI CREOS Mr.COLOR

C 118	浅蓝灰色	71-101
C 308	浅灰色	71-050
C 319	松绿色	71-017
C 305	中灰色	71-053
C 33	消光黑色	71-057
80% C325+ 20% C320	浅灰绿色	71-048
C 306	灰色	71-049
GX 01	光泽白	71-001
C 62	消光白	71-001
C 42	棕色	
C 47	透明红	

LIGHT BLUE	
GRAY	
LIGHT GREEN	
GRAY	
FLAT BLACK	
LIGHT GREEN	
GRAY	
WHITE	
FLAT	
MAHOGANY	
CLEAR RED	

ACRYLICOS VALLEJO

SM 03	铝色	71-062	ALUMINUM
MC213	钢铁色		STEEL
50% C318+ 50% GX01	光泽浅奶黄色	71-074	
C 03	红色	71-084	ERD
C 73	光泽灰	71-012	AIRCRAFT GRAY
C 08	银色	71-063	SILVER
MC214	黑铁色		DARK IRON
SM 03	烧铁色	71-073	BURNT IRON
C 41	红褐色		RED BROWN
C138	透明绿		CLEAR GREEN

1 弾射座椅組装

Ejection Seat Assembly

射出シートの組み立て

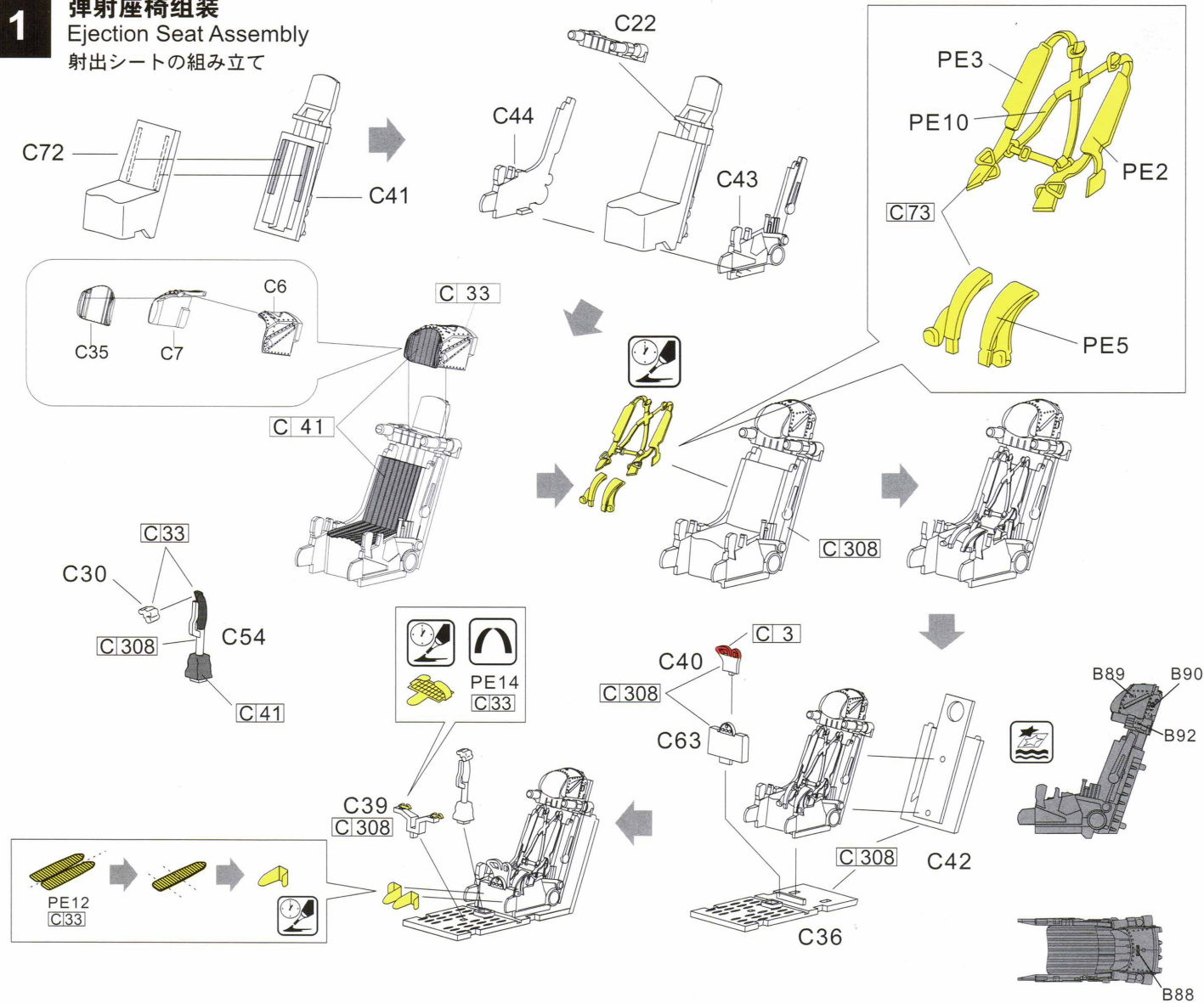

2 座舱組装

Cockpit Assembly

コックピットの組み立て

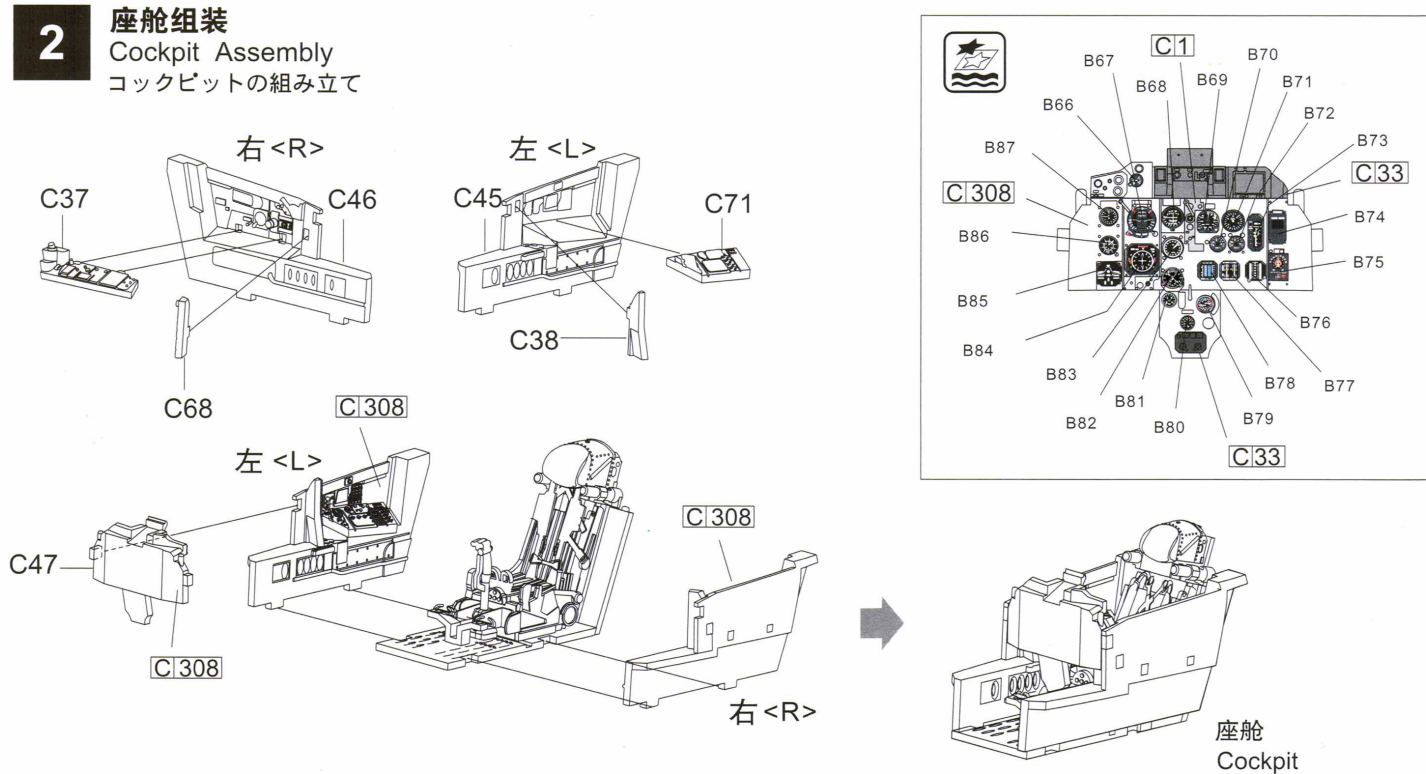

3

上机身组装 Upper Hull Assembly 機体上面の組み立て

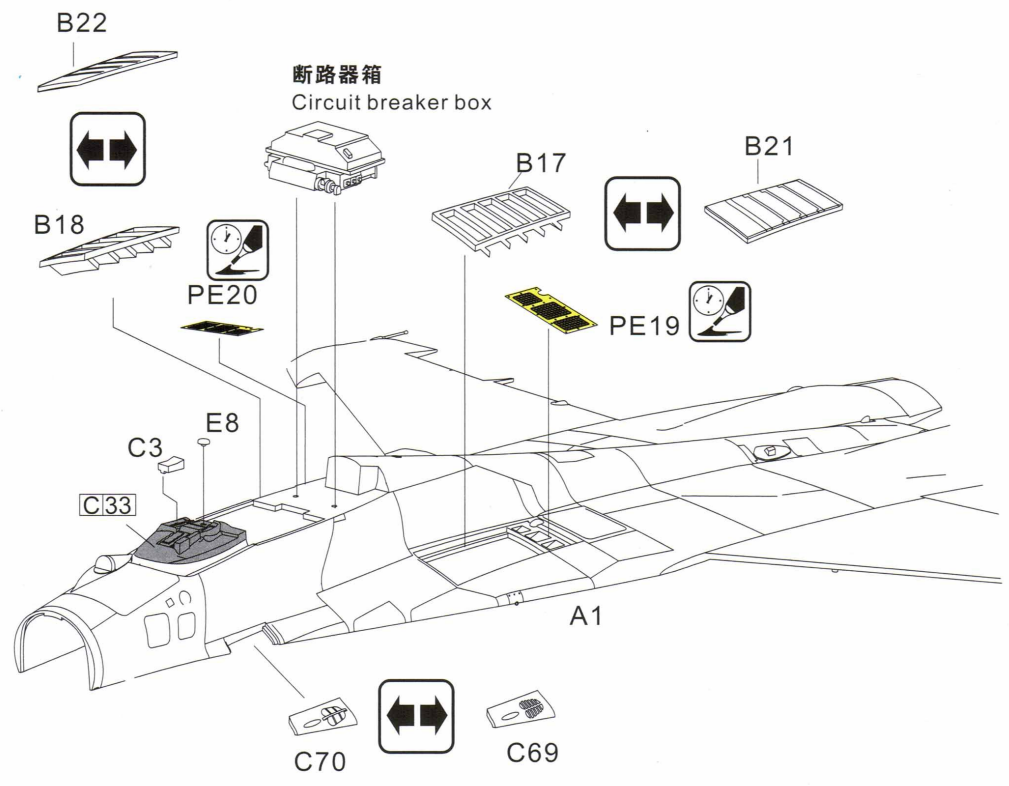
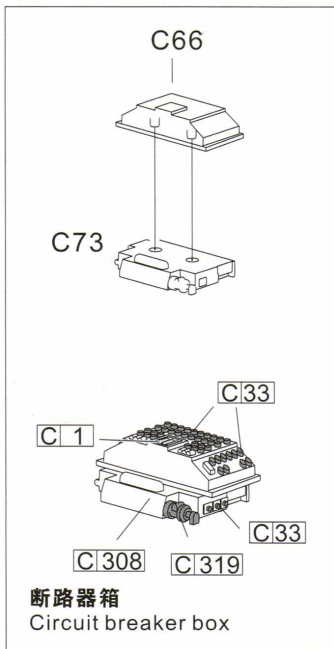

4

下机身组装 Lower Hull Assembly 機体下面の組み立て

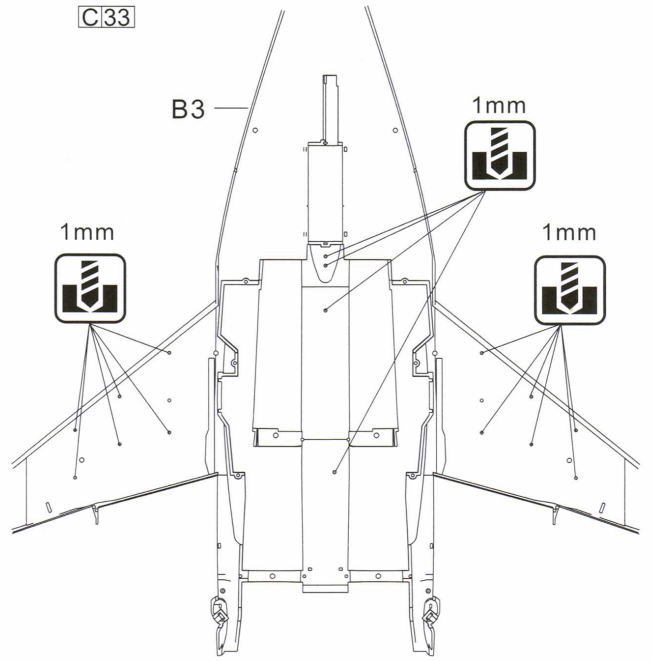
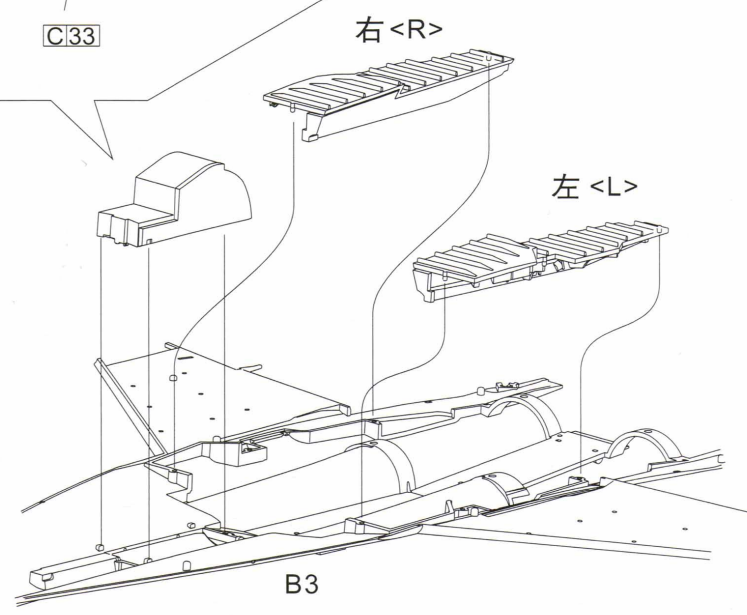
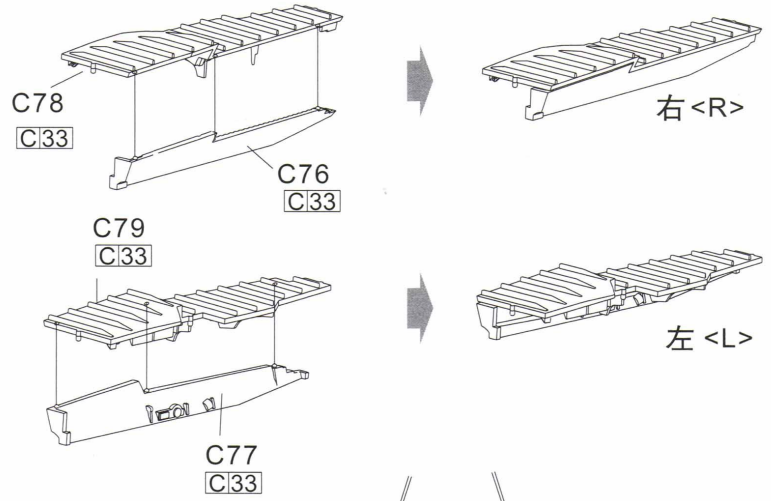
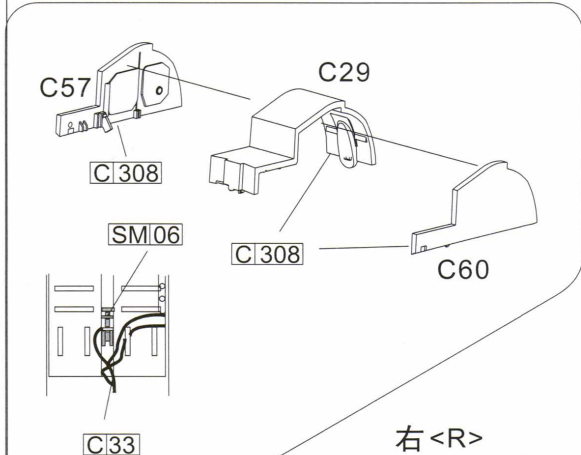

5

垂直尾翼组装 Vertical Tail Assembly 垂直尾翼の組み立て

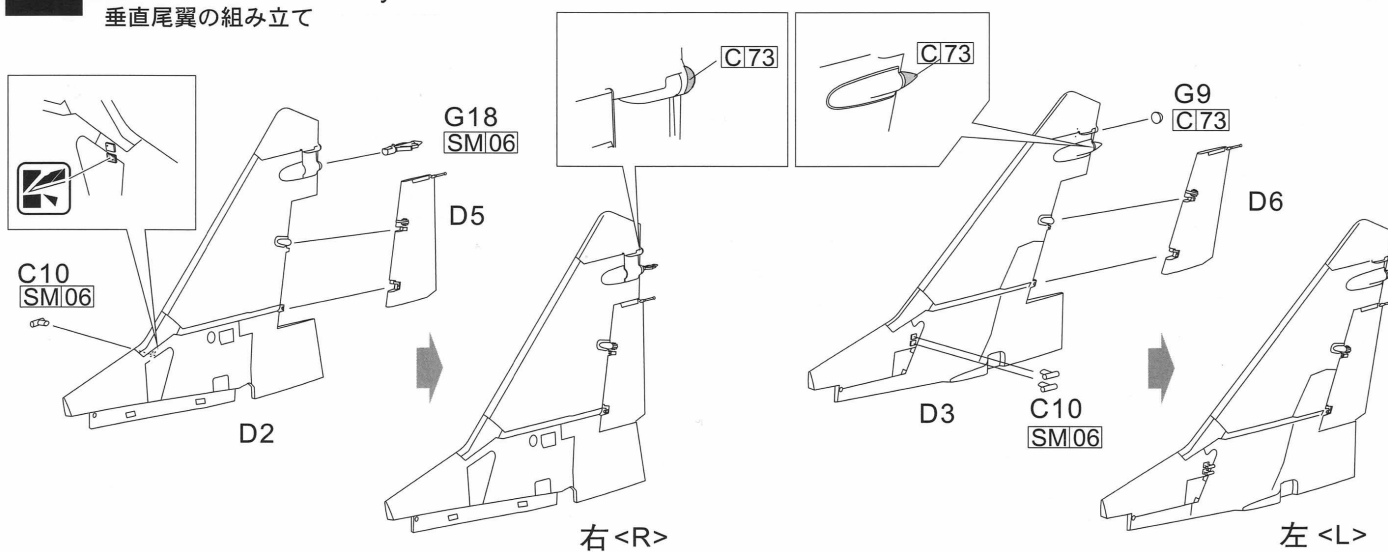

6

飞机机身组装 Fuselage Assembly 胴体の組み立て

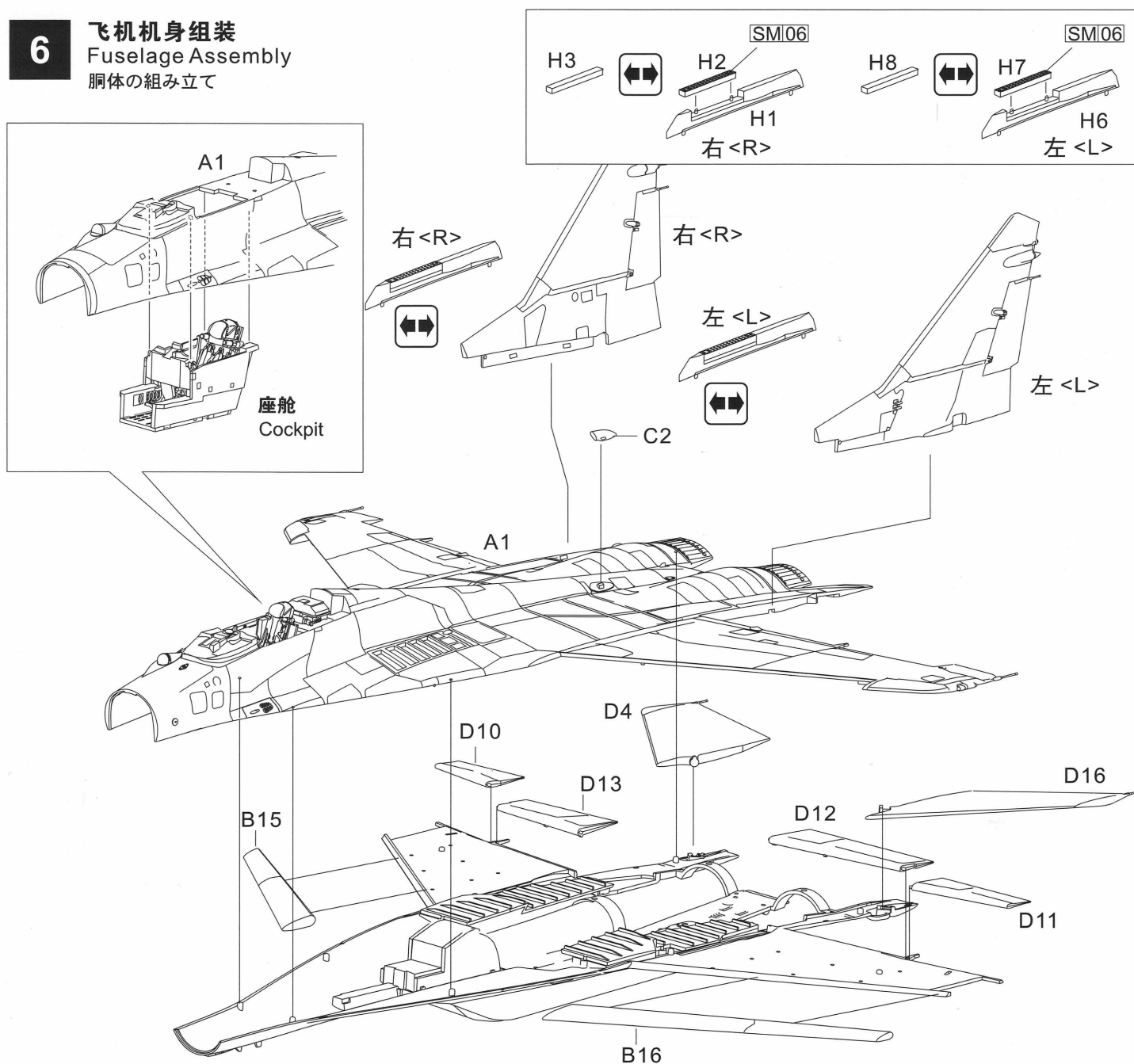

7 发动机组
Engines Assembly
エンジンの組み立て

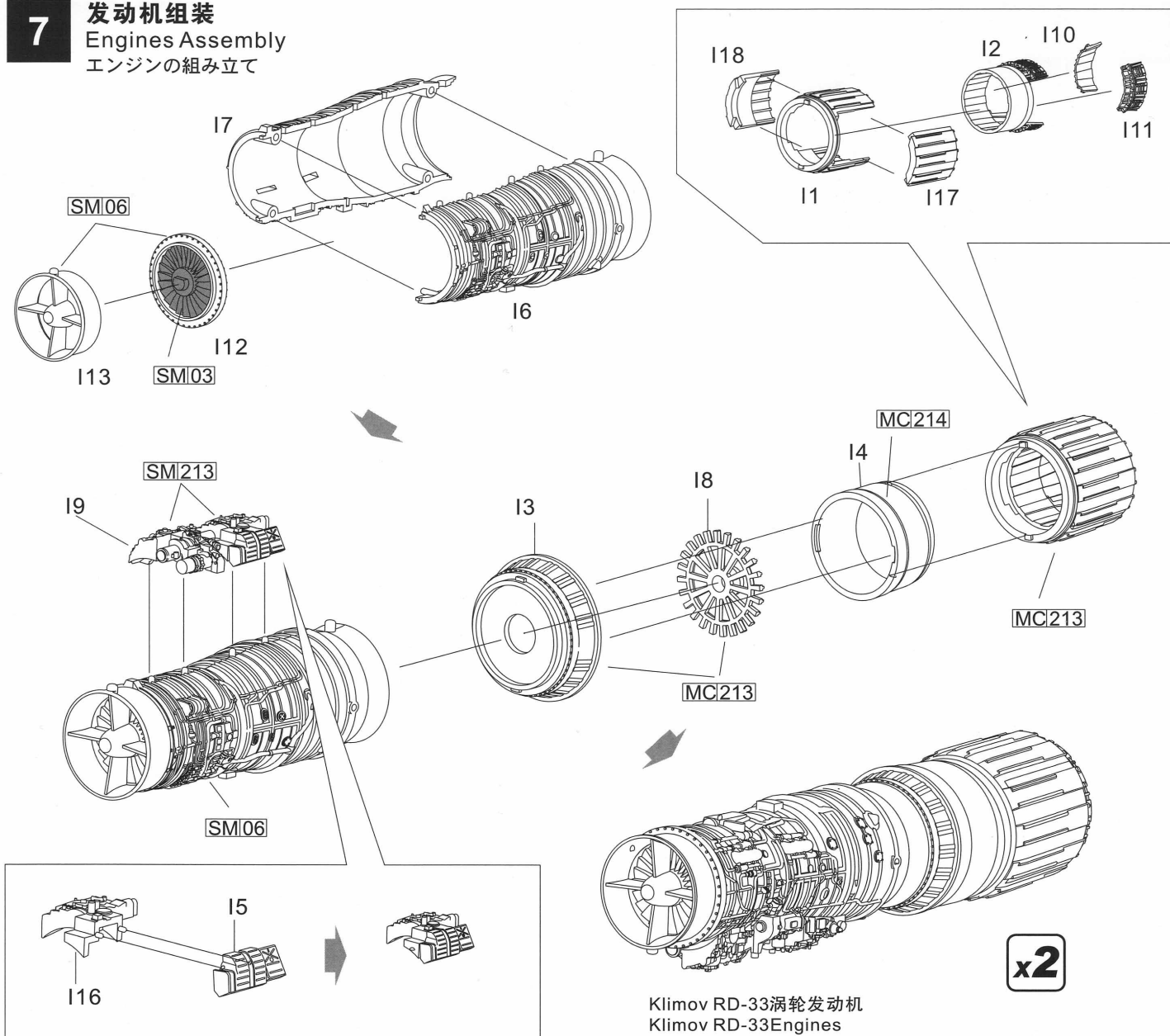

发动机展示状态
Engines appearance state

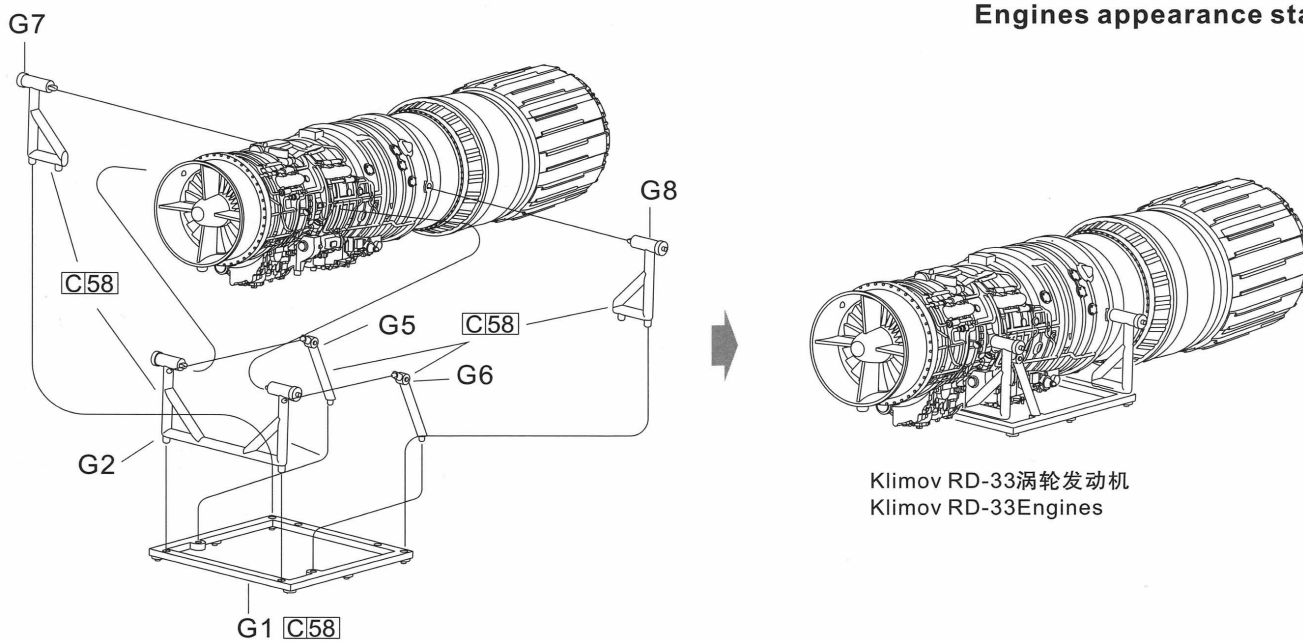

8

进气道组装

Engine Intakes Assembly

インテークの組み立て

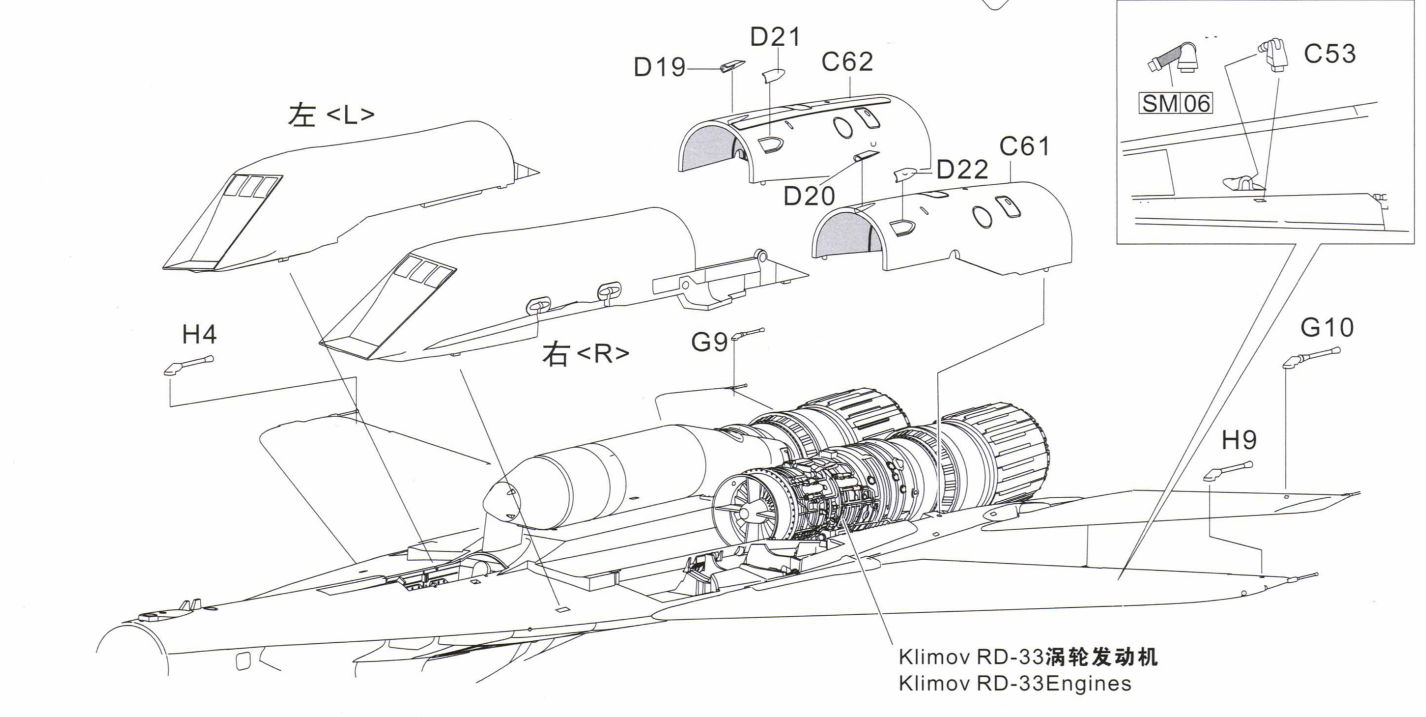
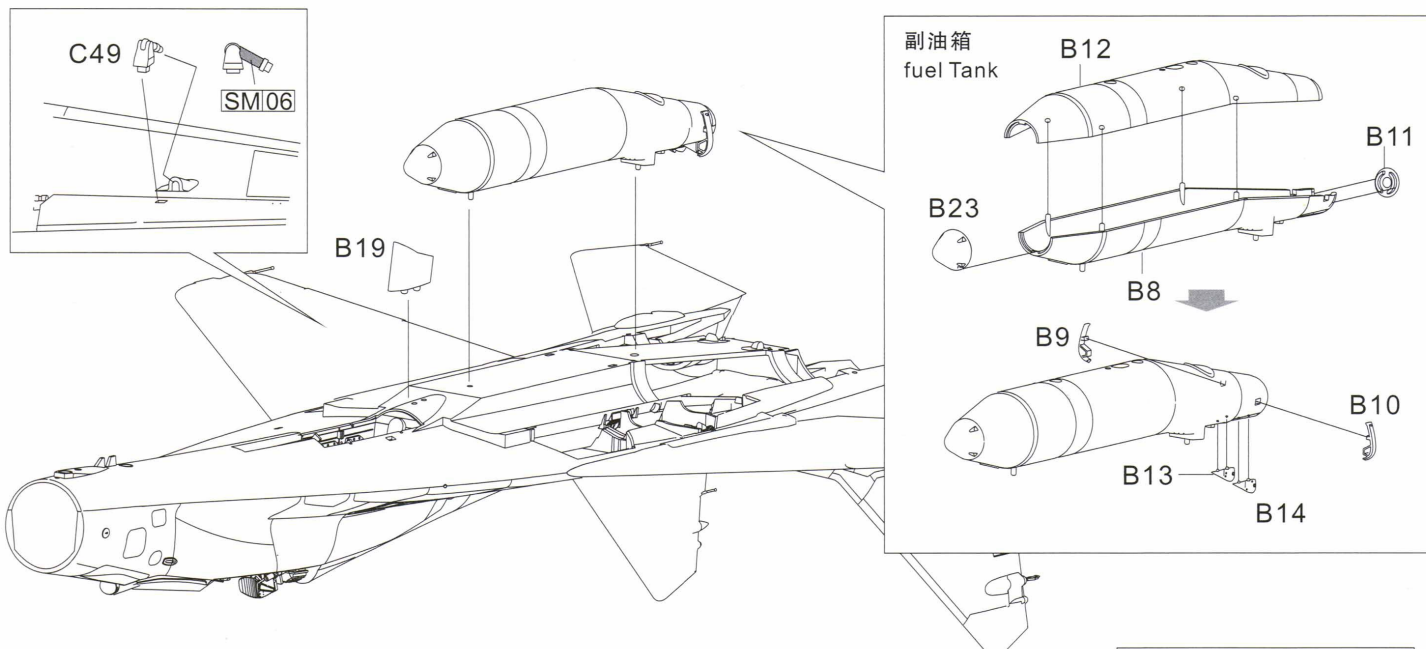
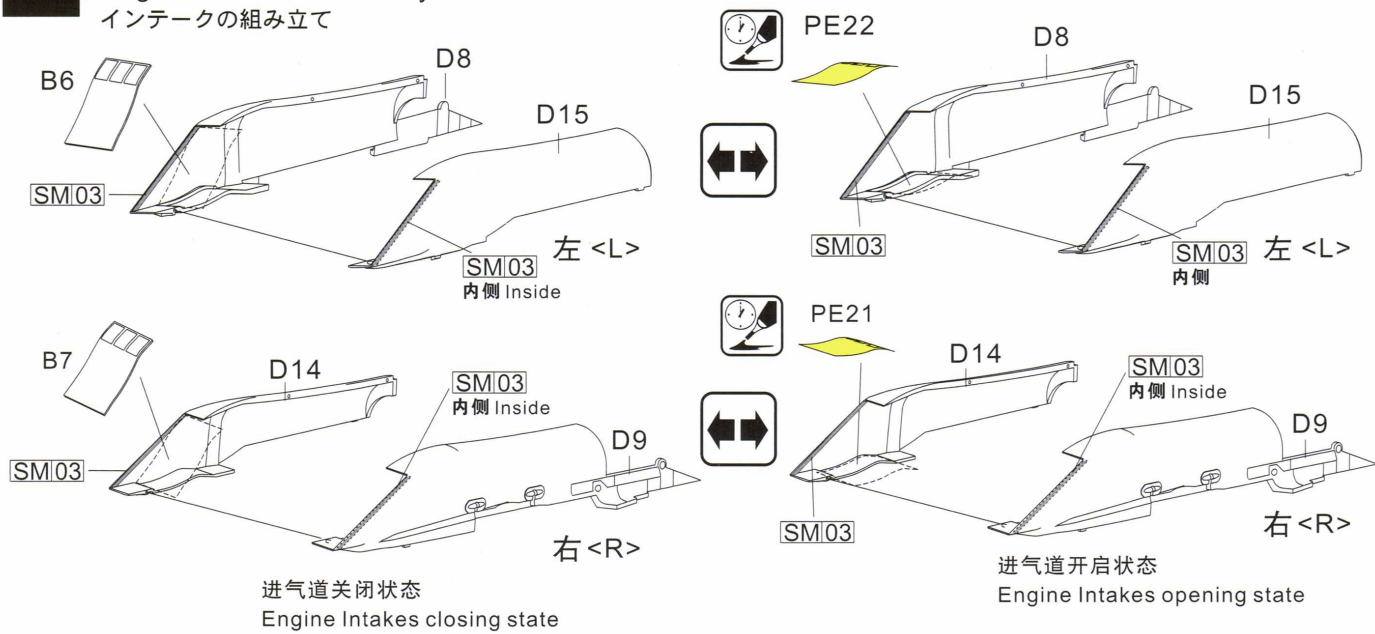

9

座舱舱盖组装
Canopy Assembly
キャノピーの組み立て

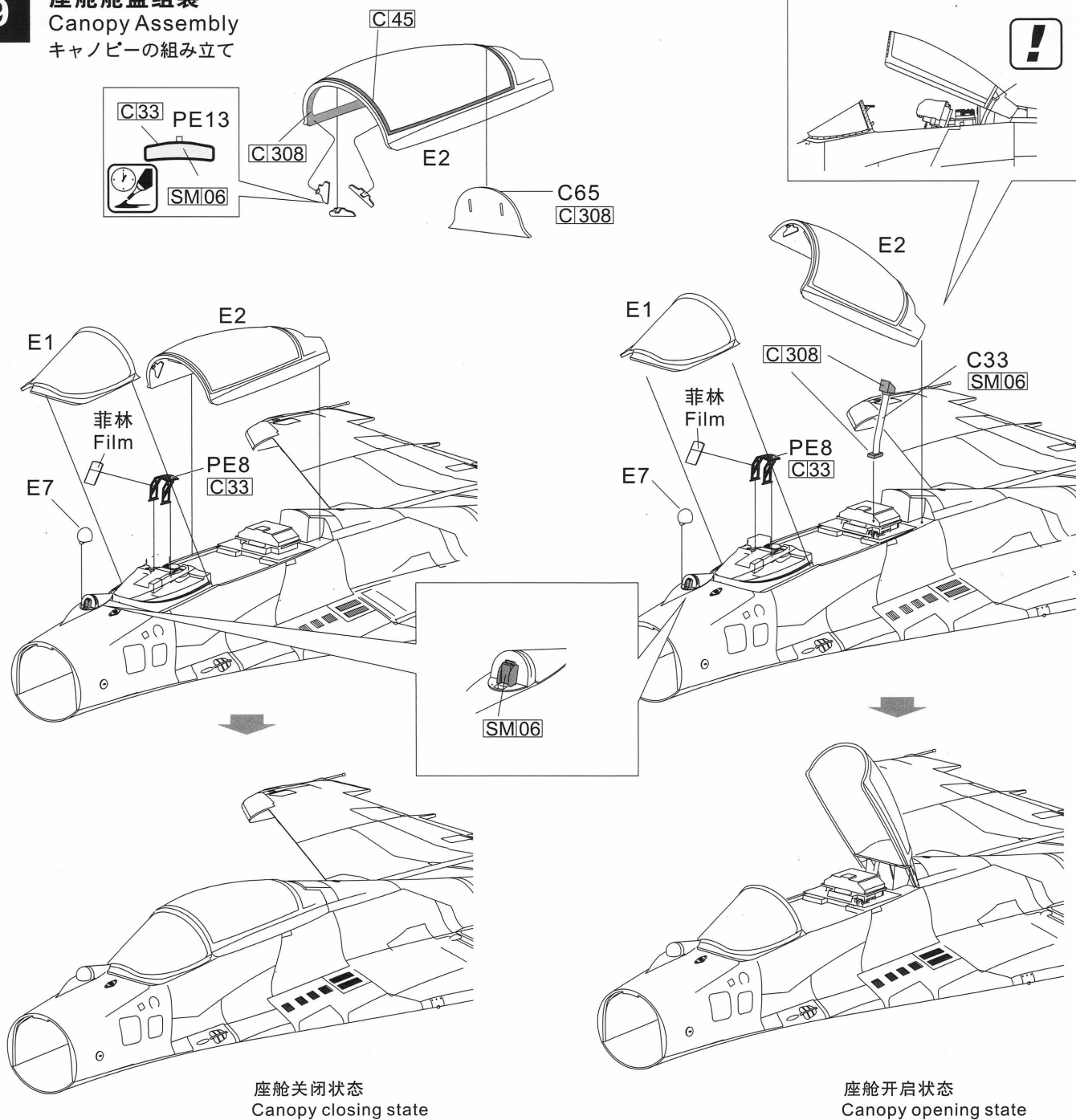

座舱关闭状态
Canopy closing state

座舱开启状态
Canopy opening state

10

雷达罩和天线组装
Nose Cone/Radar Antenna Assembly
機首/レーダーアンテナの組み立て

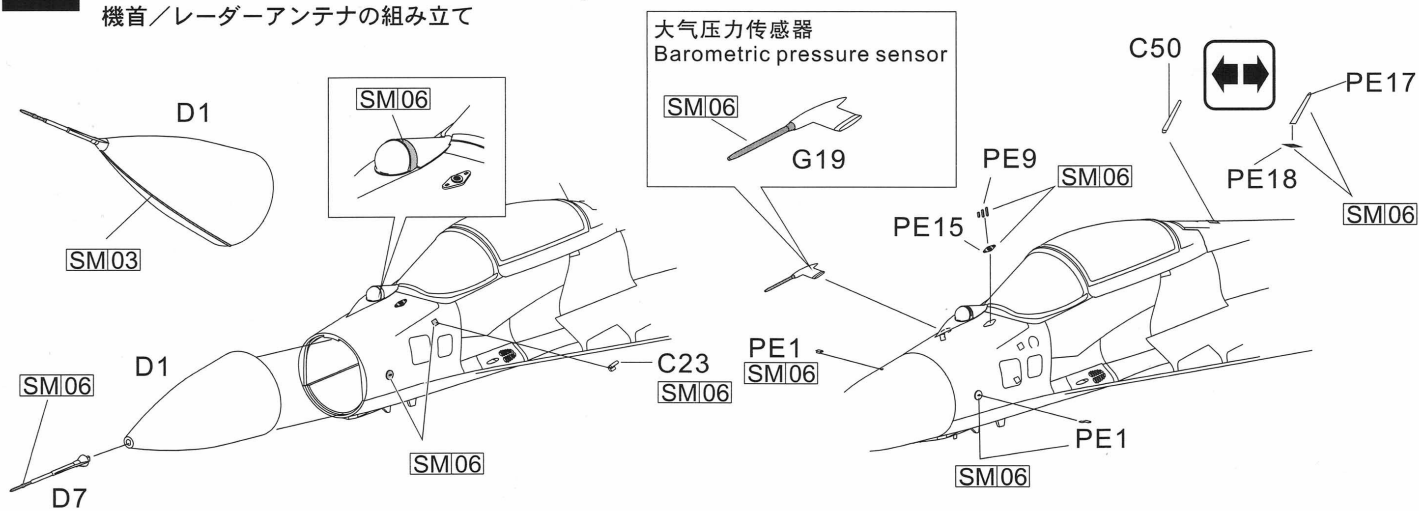

大气压力传感器
Barometric pressure sensor

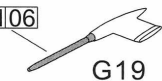

SM06

G19

SM06

SM06

SM06

11

前起落架组装

Front Landing Gear Assembly

前脚部の組み立て

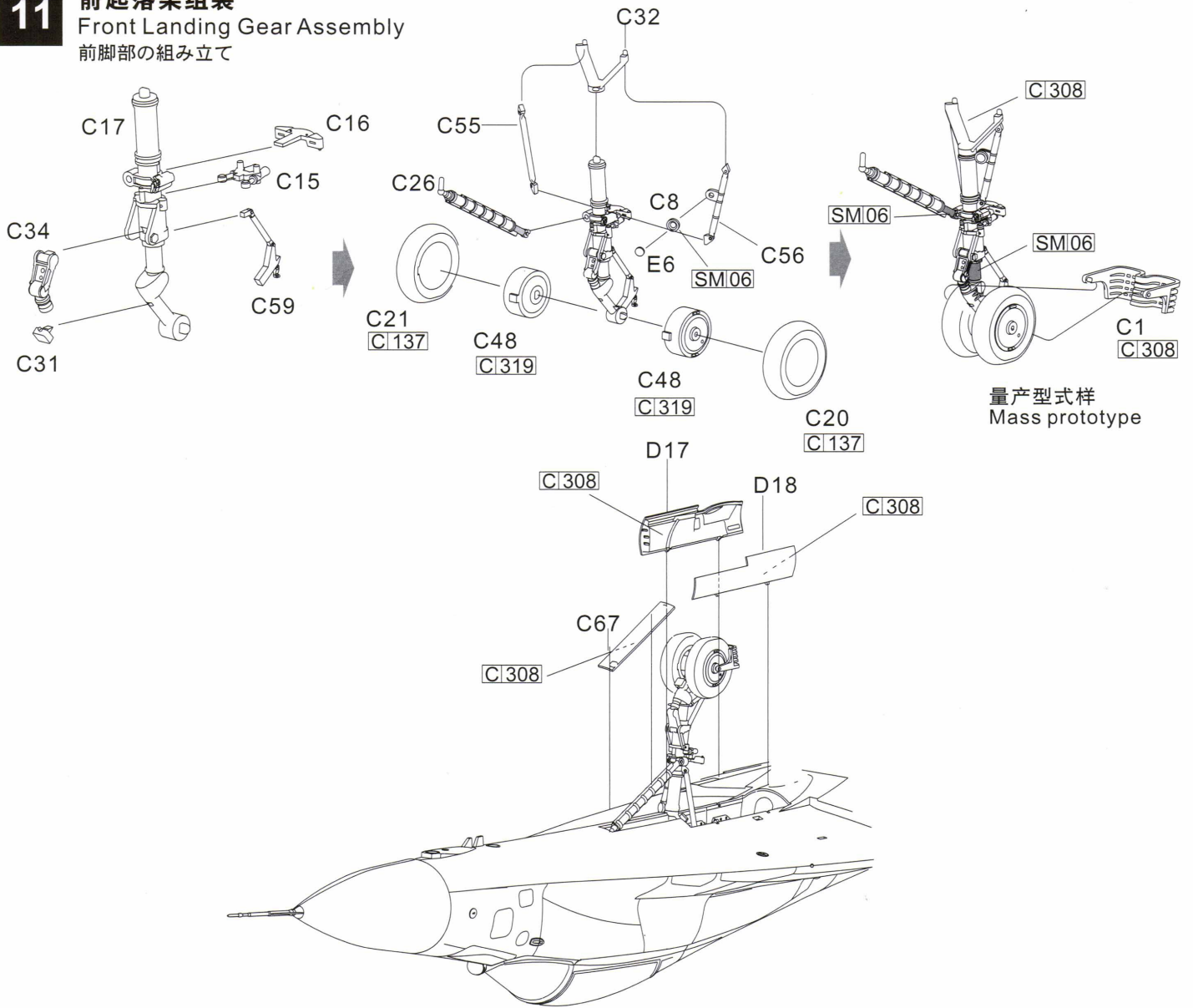

量产型式样
Mass prototype

12

起落架收起状态

Undercarriage up state assembly

着陸装置の組み立て

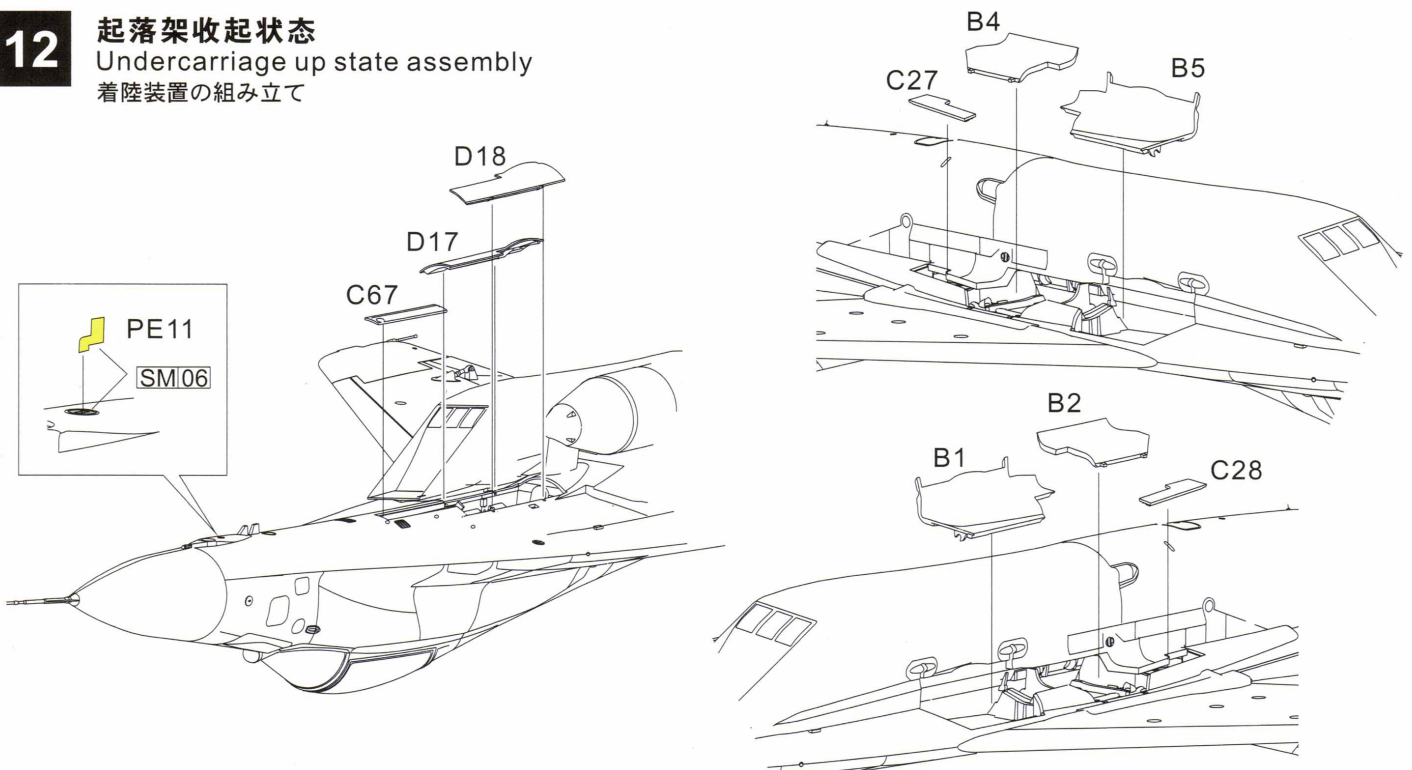

13

主起落架组装 Main Landing Gear Assembly 主脚部の組み立て

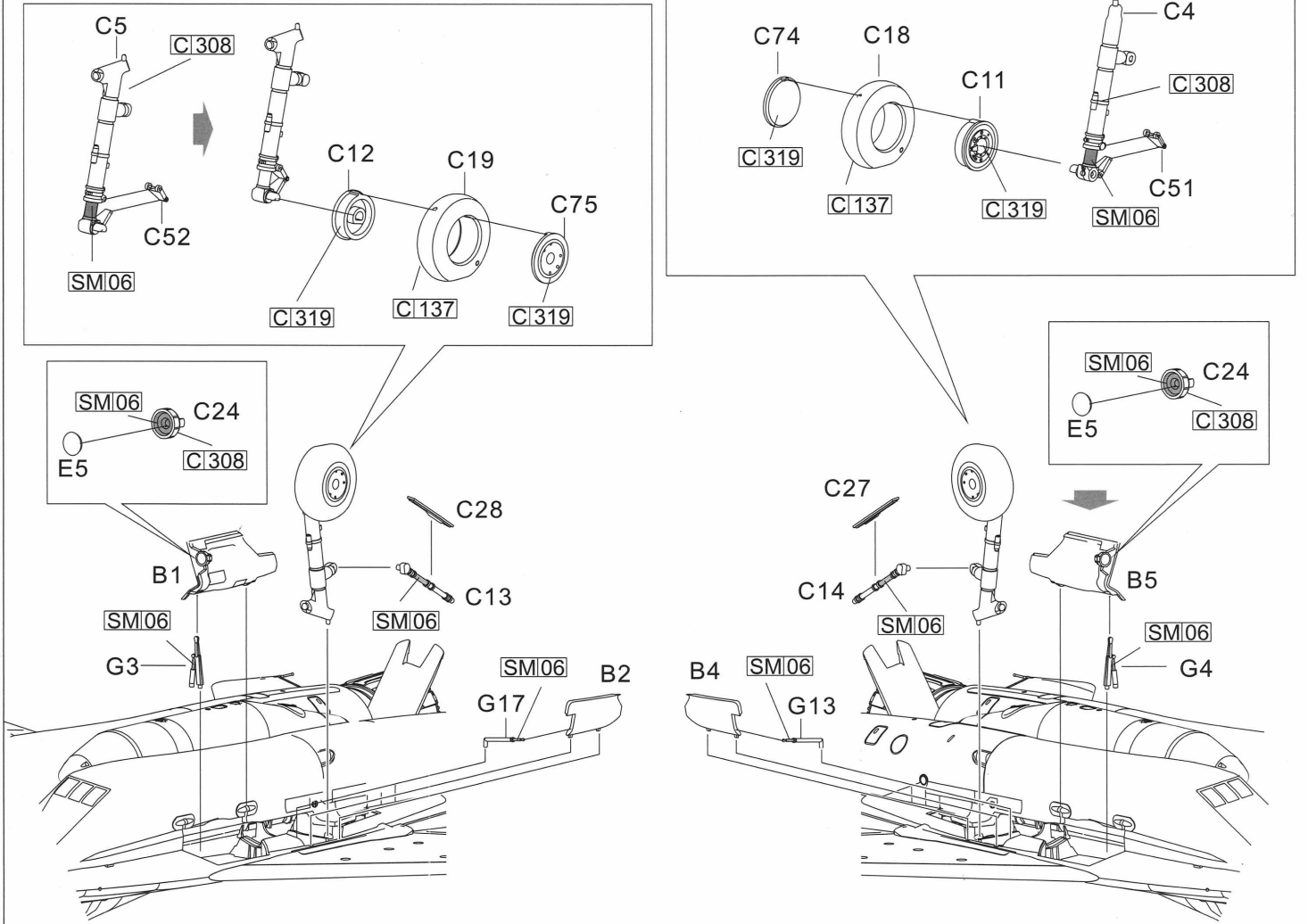

14

减速板组装 Airbrake Assembly エアブレーキの組み立て

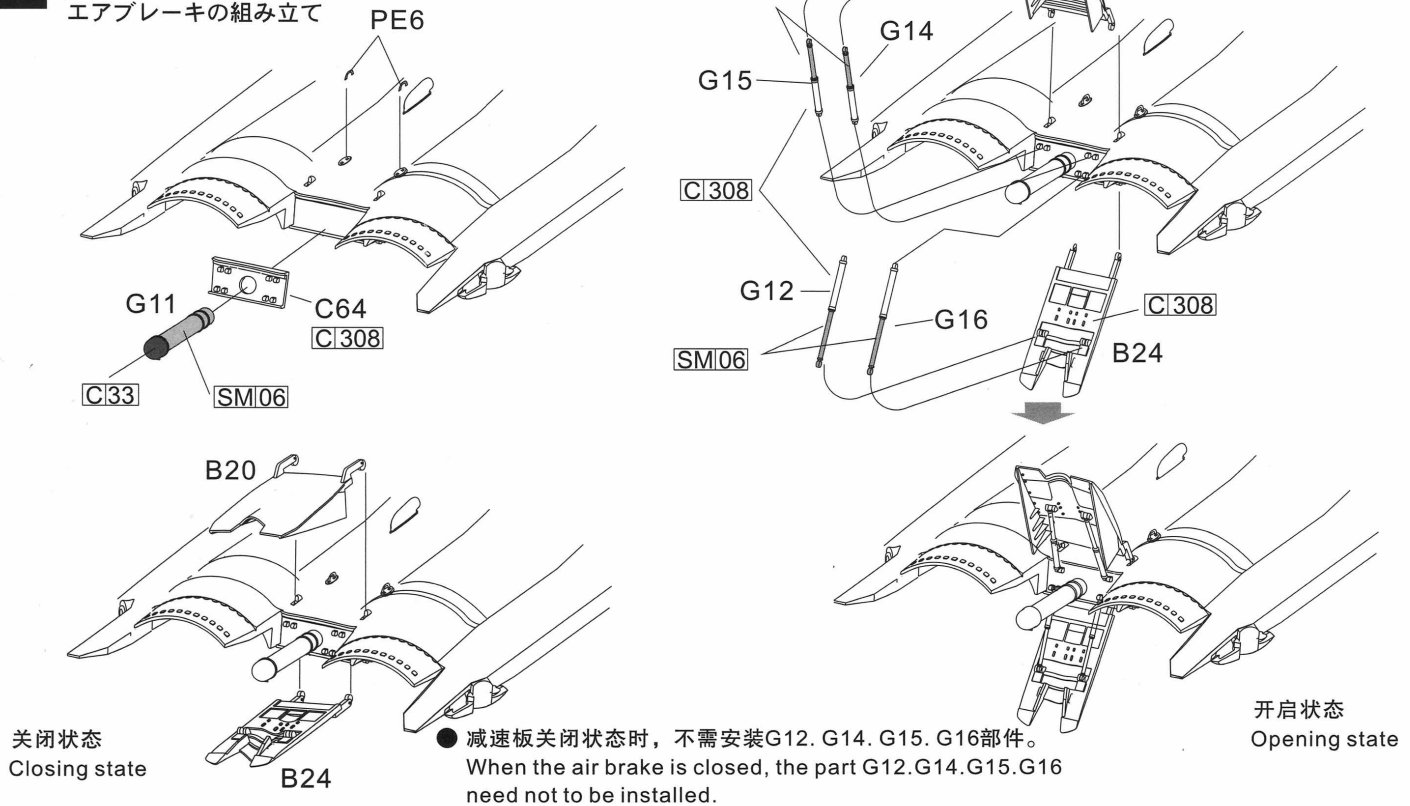

15

油箱和武器组装

Auxiliary Fuel Tanks / Weapons Assembly

増槽タンク / 兵装の組み立て

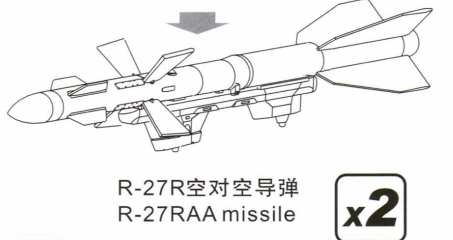
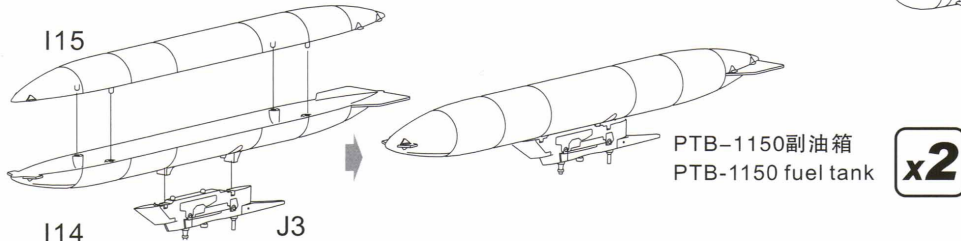
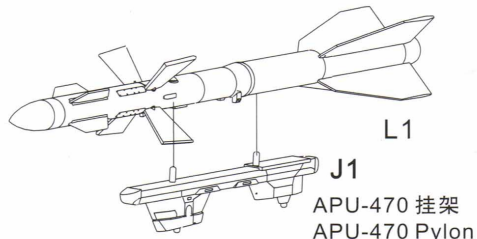
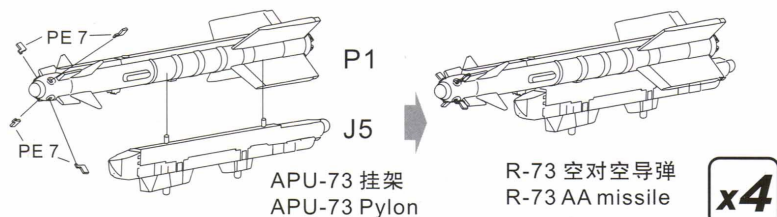

16

武器组装

Weapons Assembly

兵装の組み合わせ

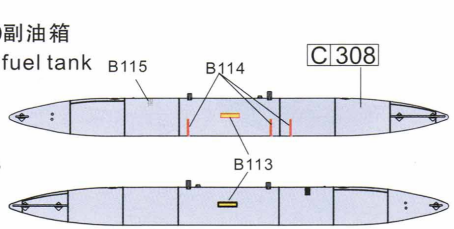
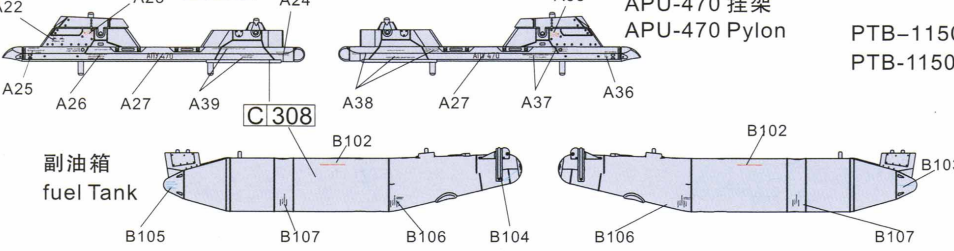
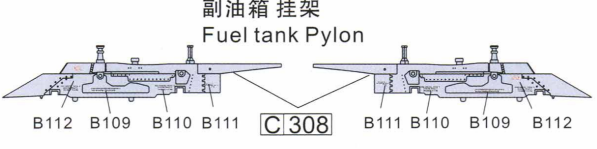
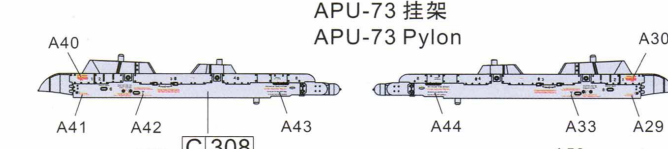
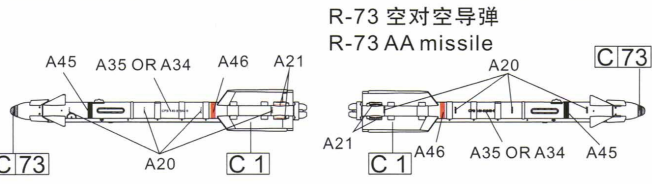
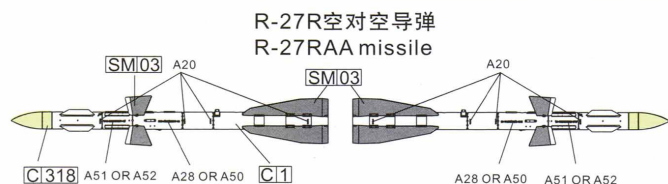
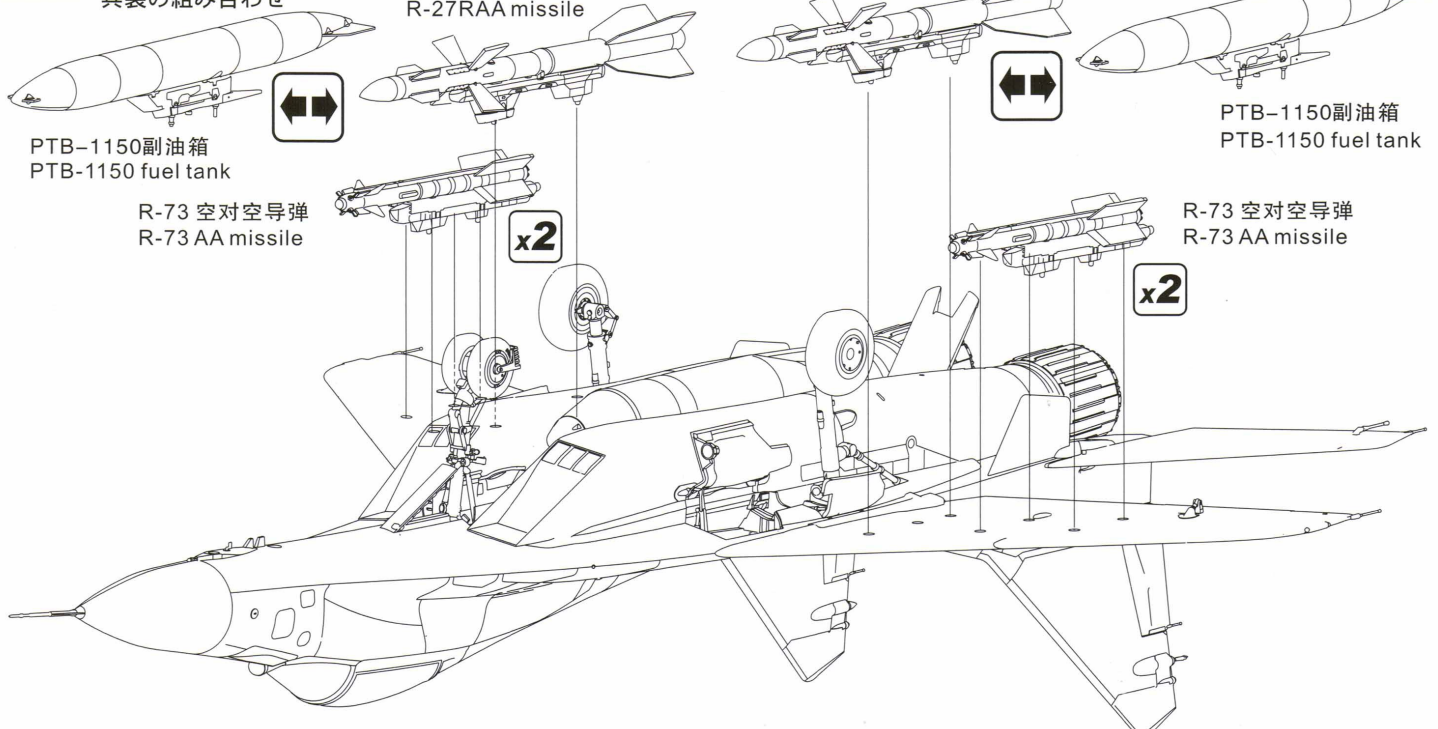

L4811 1/48 MIG-29 "FULCRUM" 9-12 LATE TYPE

MiG-29 "91 Blue", Soviet Navy/Black Sea Fleet, 119th MIAD 米格-29 "蓝色91号" 苏联海军黑海舰队海军航空兵 第119歼击团

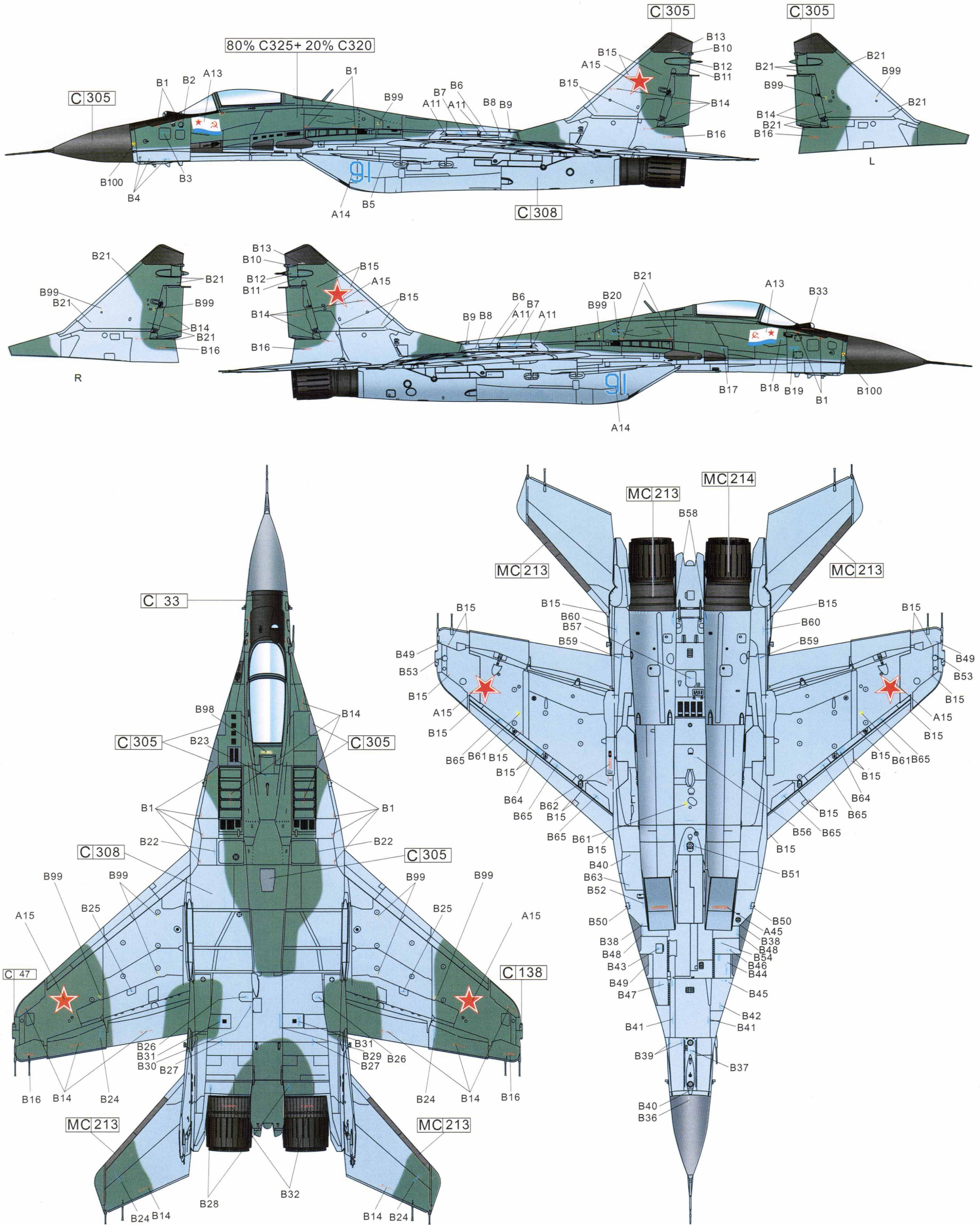

G.W.H™

MIG-29 "FULCRUM" 

1/48 SCALE L4811 9-12 LATE TYPE 米格-29“支点”战斗机
9-12 后期型

 **LionRoar**®

上海狮瑞工艺模型有限公司
SHANGHAI LION ROAR ART MODEL CO.,LTD

地址: 中国上海市零陵路631号25C室 邮编: 200030
Room 25C, No.631, Ling Ling Road, Shanghai, 200030, P.R.China
Tel:86-21-34230563 Fax:86-21-34230561 E-mail: marketing@lionroarmodel.com

www.lionroar.net www.lionroarmodel.cn