

Authentic Kits
Revell

CHANCE VOUGHT CORSAIR F4U-1D

IMPORTANT! READ THIS FIRST

1. NOTE: Do not let cement touch your eyes or clothing. This kit is moulded in Styrene Plastic. Use only REVELL TYPE S CEMENT.
 2. Apply cement to only those surfaces where parts join. Use sparingly, since any excess cement may run and damage the details on your model.
 3. All parts are numbered for easy identification, or the numbers are engraved on the bar next to each part. Break each part from its bar only when that part is to be used.
 4. For the best fit, carefully trim any excess plastic from parts before assembling.
 5. If you wish, paint all parts where indicated and allow them to dry before assembling. USE ONLY REVELL PAINT-SET ENAMEL COLOURS.
- NOW CAREFULLY FOLLOW ASSEMBLY INSTRUCTIONS FOR EASE IN BUILDING YOUR MODEL**

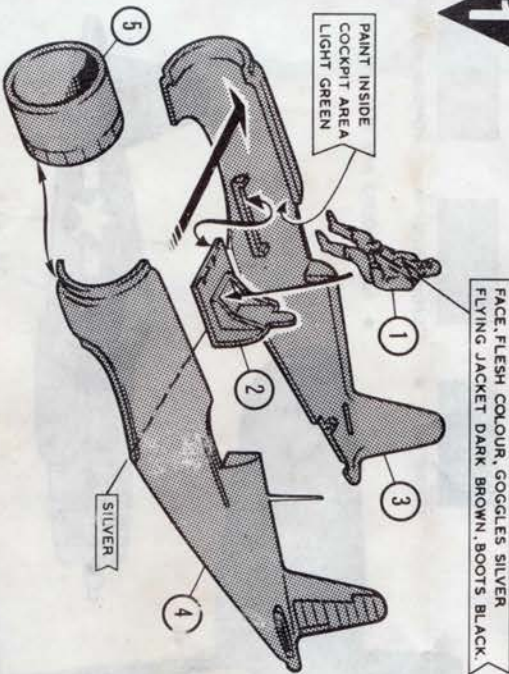

PAINT ALL DETAILS AND ALLOW TO DRY BEFORE ASSEMBLY
Cement part 1 to part 2, then apply cement to slots shown in parts 3 and 4 and then to their respective joining edges. Insert part 2 into position in part 3 and then press part 4 to part 3. Carefully apply cement to front of fuselage as indicated, then press part 5 into position.

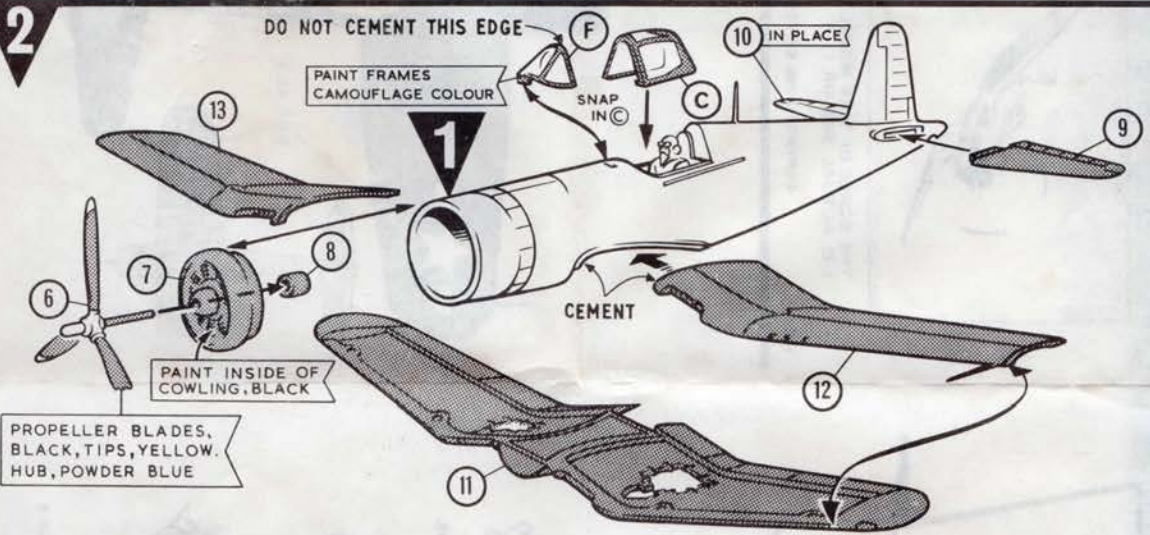

PAINT ALL DETAILS AND ALLOW TO DRY BEFORE ASSEMBLY

Push stem of part 6 through part 7, then carefully apply a dab of cement to the stem end, finally push part 8 into position—CHECK THAT THE PROPELLER REVOLVES FREELY—place assembly aside to dry. Locate and cement into position parts 9 and 10. Next locate and cement part 11 into its position on the fuselage. Now cement parts 12 and 13 to part 11. Next carefully cement part F into position, then carefully press—do not cement—part C into place, check that it slides freely. Finally cement propeller assembly into place on the fuselage.

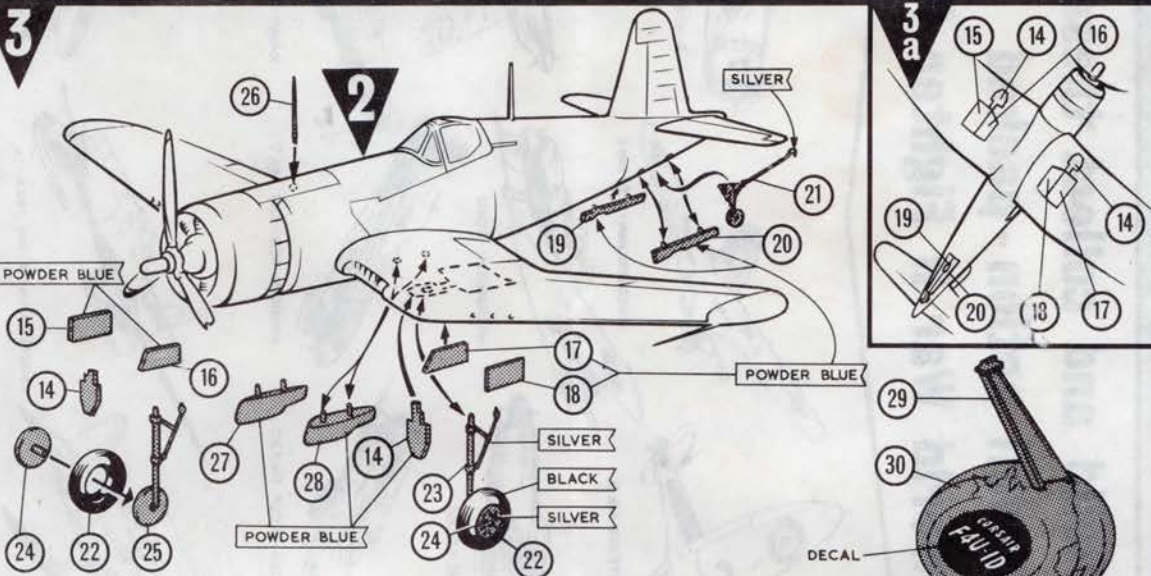

PAINT ALL DETAILS AND ALLOW TO DRY BEFORE ASSEMBLY

READ UNDERCARRIAGE INSTRUCTIONS CAREFULLY BEFORE CONSTRUCTION. If model is to be assembled with RETRACTED UNDERCARRIAGE—see drawing 3A. Cement (2) parts 14, parts 15, 16, 17, 18, 19 and 20 into position shown. Break hook from part 21 and cement into hole in rear of fuselage, hook opening pointing downwards. OR: if model is required with UNDERCARRIAGE IN LANDING POSITION see main drawing. Cement part 21 into position. Next place (1) part 22 over flange on part 23, apply a dab of cement to pin end of part 24, press it firmly into assembly. Check that part 22 rotates freely. Repeat assembly sequence with remaining parts 22 and 24 and part 25. Now cement (2) parts 14, parts 15, 16, 17, 18, 19 and 20 into position as open doors. Then cement parts 26, 27 and 28 into their positions on assembly 27. Finally cement part 29 to part 30, apply a dab of cement to tab of part 29 and carefully insert into slot in fuselage. You have now completed your Revell F4U-1D Corsair. See reverse side of Instruction Sheet for decal positions.

Build and collect these new Revell action - packed World War II Fighter Planes



SPITFIRE MK II



MESSERSCHMITT Bf 109E



P-47D THUNDERBOLT



P-51D MUSTANG



MITSUBISHI ZERO



HAWKER HURRICANE



FOCKE-WULF Fw 190

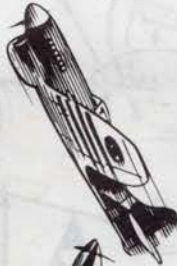

HAWKER TEMPEST MK V



KAWASAKI HIEN



CORSAIR F4U-1D



MESSERSCHMITT ME 262A-1A



CURTISS P-40 E



THE SCALE OF THIS MODEL IS
1/72 ACTUAL SIZE OR 1"-6"

INTERESTING FACTS ABOUT YOUR Vought CORSAIR

The Japanese called it the "Whistling Death"; the U.S. Navy called it the F4U. It was generally considered to be the best carrier-based fighter of World War II. The Chance Vought F4U-1 Corsair certainly qualified for these descriptions. During the early testing of this new aircraft it became the first American fighter to exceed 400 m.p.h. Its distinctive wing shape was dictated by the use of a Pratt & Whitney R-2800 Double Wasp engine, which required a large propeller to utilize its power. The inverted gull shaped wing was selected to avoid using an exceptionally long landing gear to provide sufficient propeller clearance. Revell's model of the Corsair is a replica of the fighter flown by Col. Gregory "Pappy" Boyington, leader of Marine Squadron VMF 214. Boyington, one of the most colourful figures of the war, had 28 victories to his credit before his capture by the Japanese in January, 1944. Following his release, Boyington was awarded the Congressional Medal of Honour and the Navy Cross. The Corsair had a wing span of 40 feet 11 inches; the length was 33 feet 4 inches; the height was 15 feet 1 inch. The maximum speed was 425 m.p.h. at 20,000 feet.

H-625

COPYRIGHT 1963 BY REVELL (G.B.) LTD., MAIDSTONE HOUSE, 25/27 BERNERS ST., LONDON, W.1.

PRINTED IN ENGLAND

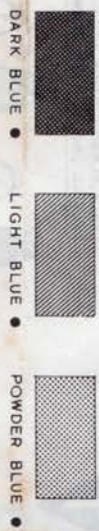
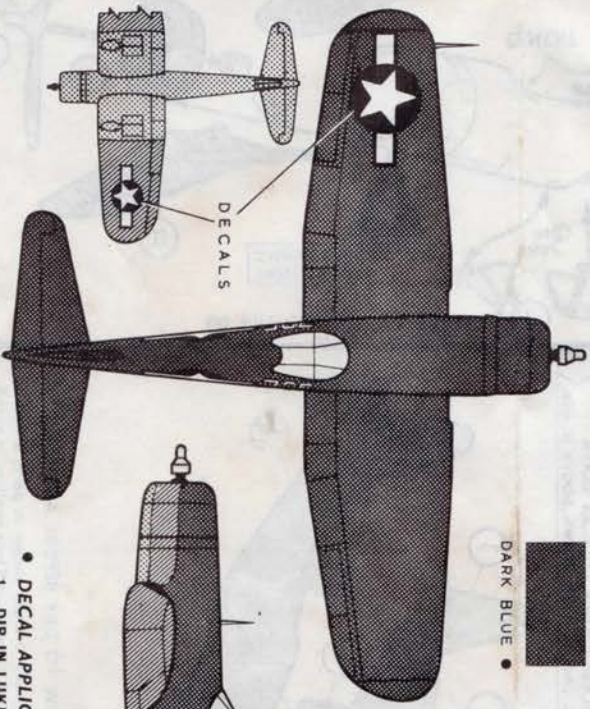

• ALL COLOURS ARE MATT FINISH

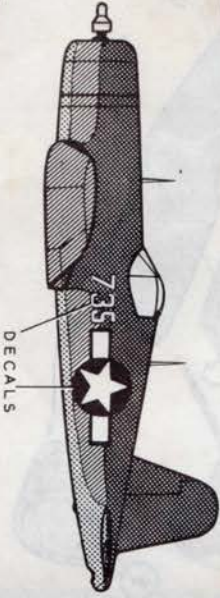

• DECAL APPLICATION INSTRUCTIONS

1. DIP IN LUKEWARM WATER.
2. SLIDE FROM PAPER FACE UP.
3. PRESS DOWN WITH BLOTTER.