



KIT 2982

85298200200

'26 Ford T Sedan Delivery

Ford's pre-1928 "Tall T" cars peaked in popularity with street rodders in the early to mid 70's, then seemed to fall out of favor as street rod fashion shifted to high tech and billet aluminum in the 80's and early 90's. Today, however, the early T body styles are making a comeback, as rodders are rediscovering their classic, formal proportions and old-timey details.

Of course, even with their old time flavor, most current street rods are running the trickiest of automotive technology underneath, and this '26 Ford T Sedan Delivery is no exception. Under the three piece hood is a healthy 289 Ford small block engine that's been treated to a set of Cobra valve covers and a Shelby oil pan. The engine sits in a very trick, custom-fabricated tubular chassis with independent front suspension and a fully decked out Jaguar XKE independent rear suspension, and Halibrand Sprint style wheels with knock-offs are at all four corners. A choice of graphic schemes for the delivery's side panels is also included to finish off your street rod replica.

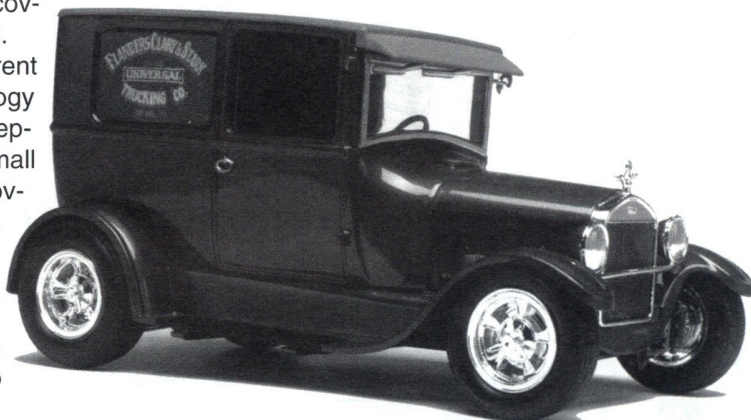

* REPEAT SEVERAL TIMES
* A REPETER PLUSIEURS FOIS



* OPTIONAL PARTS
* PIECES EN OPTION



* DECAL
* DECAL COMANIE



* ALTERNATIVE ASSEMBLY
* ENSEMBLAGE ALTERNATIVE



* CEMENT TOGETHER
* A COLLER



* REMOVE AND THROW AWAY
* A RETIRER ET JETER



* DO NOT CEMENT
* NE PAS COLLER

READ THIS BEFORE YOU BEGIN

- * Study the assembly drawings.
- * Each plastic part is identified by a number.
- * In the assembly drawings, some parts will be marked by a star (★) to indicate chrome plated plastic.
- * For better paint and decal adhesion, wash the plastic parts in a mild detergent solution. Rinse and let air dry.
- * Check the fit of each piece before cementing in place.
- * Use only cement for polystyrene plastic.
- * Scrape plating and paint from areas to be cemented.
- * Allow paint to dry thoroughly before handling parts.
- * Any unused parts may be discarded.

DECAL APPLICATION INSTRUCTIONS

1. Cut desired decal from sheet.
2. Dip decal in water for a few seconds.
3. Place wet decal on paper towel.
4. Wait until decal is movable on paper backing.
5. Place decal in position on model, face up and slide backing away.
6. Press out air bubbles with a soft damp cloth.
7. Milkiness that may appear is for better decal adhesion and will dry clear. Wipe away any excess adhesive.
8. Do not touch decal until fully dry.
9. Allow the decals 48 hours to dry before applying clear coat.

NOTE: Decals are not compatible with setting solutions or solvents.

LIRE CE QUI SUIT AVANT DE COMMENCER

- * Etudier les schémas de montage.
- * Chaque pièce en plastique est identifiée par un numéro.
- * Sur les schémas de montage, certaines pièces sont marquées d'une étoile (★) pour indiquer qu'elles sont en plastique chromé.
- * Pour une meilleure prise de la peinture et des autocollants, laver les pièces en plastique avec une solution détergente peu concentrée. Les rincer et les laisser sécher à l'air.
- * Vérifier que chaque pièce s'ajuste bien avant de la coller en place.
- * N'utiliser que de la colle pour polystyrène.
- * Gratter les parties à coller pour enlever le chrome et la peinture.
- * Laisser la peinture bien sécher avant de manipuler les pièces.
- * Toute pièce inutilisée peut être jetée.

DIRECTIVES D'APPLICATION DES AUTOCOLLANTS

1. Découper l'autocollant désiré de la feuille.
2. Tremper l'autocollant dans de l'eau pendant quelques secondes.
3. Placer l'autocollant mouillé sur une serviette en papier.
4. Attendez que l'autocollant puisse être déplacé sur son support en papier.
5. Mettre l'autocollant en position sur le modèle face sur le dessus et faire glisser le support pour l'enlever.
6. Appuyer avec un chiffon doux humide pour éliminer les bulles d'air.
7. La substance laiteuse qui peut apparaître est destinée à améliorer l'adhésion de l'autocollant et devient incolore au séchage. Essuyer pour enlever tout excédent d'adhésif.
8. Ne pas toucher l'autocollant tant qu'il n'est pas bien sec.
9. Laisser l'autocollant sécher pendant 48 heures avant d'appliquer une couche transparente.

REMARQUE: Les autocollants sont incompatibles avec les solutions de fixation ou les solvants.

This paint guide is provided to complete this kit as shown on the box.

Ce guide de peinture est fourni pour reproduire le modèle réduit qui apparaît sur la boîte.

Aluminum	Aluminium
Flat Black	Noir mat
Metallic Brown	Brun métallisé
Satin Black	Noir satin
Silver	Argent
Tan	Havane
Transparent Red	Rouge transparent
Turn Signal Amber	Feu de virage ambre

If you have any questions or comments, call our hotline at: (800) 833-3570 or, please write to:

Revell-Monogram Consumer Service Department, 8601 Waukegan Road, Morton Grove, Illinois 60053
Be sure to include the plan number (85298200200), part number, description, your return address and phone number.

Visit our website: www.revell-monogram.com

1

FRAME ASSEMBLY

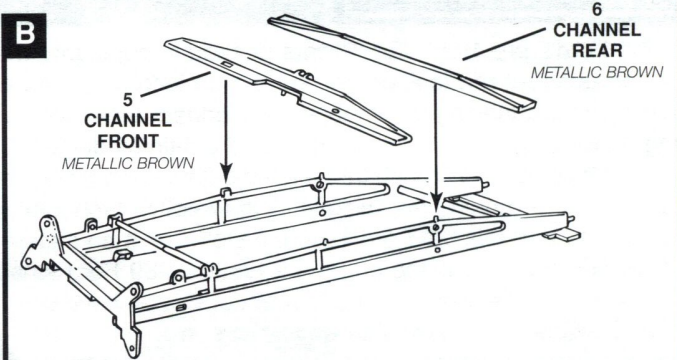
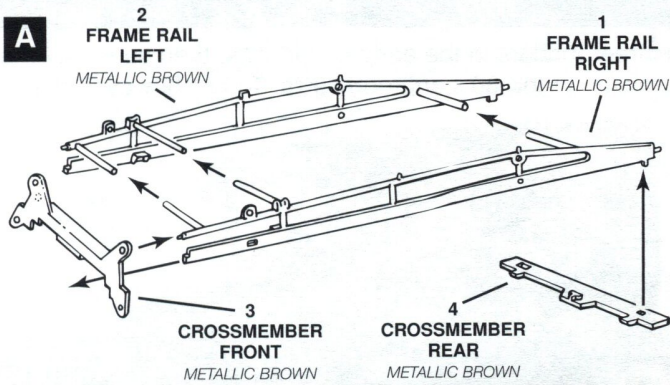

2

ENGINE/TRANSMISSION ASSEMBLY

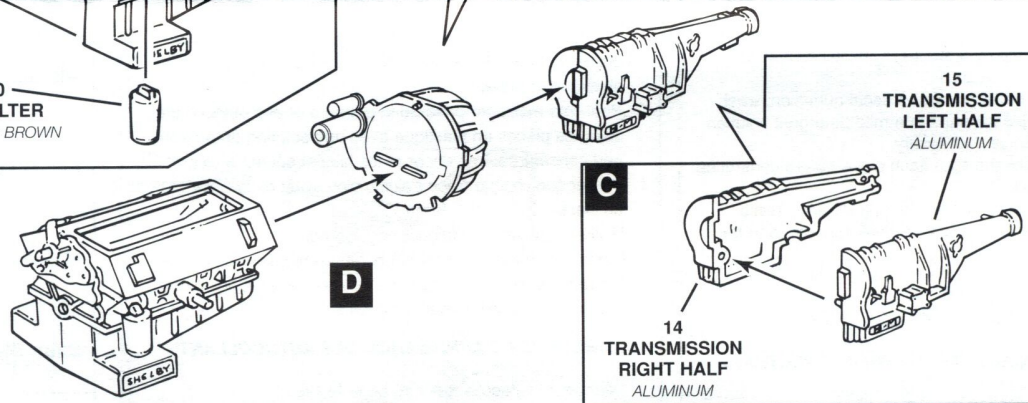
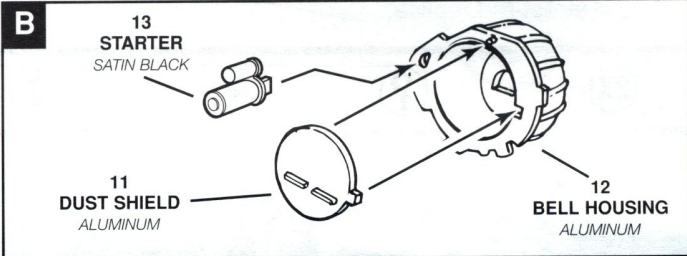
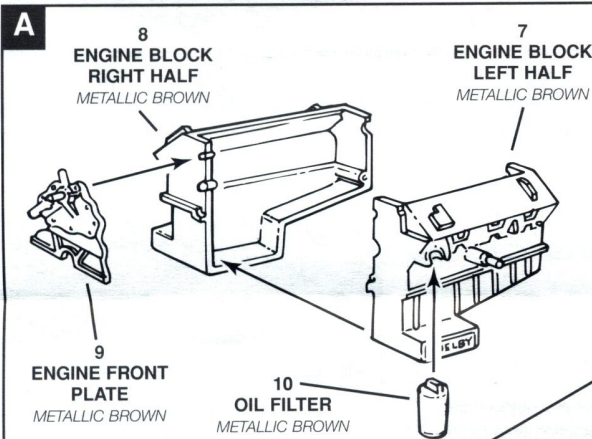

3

DIFFERENTIAL ASSEMBLY

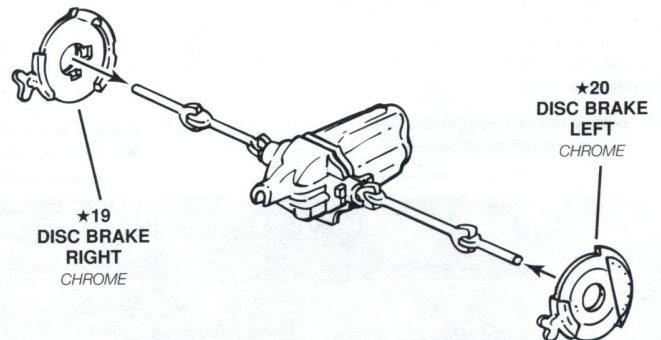
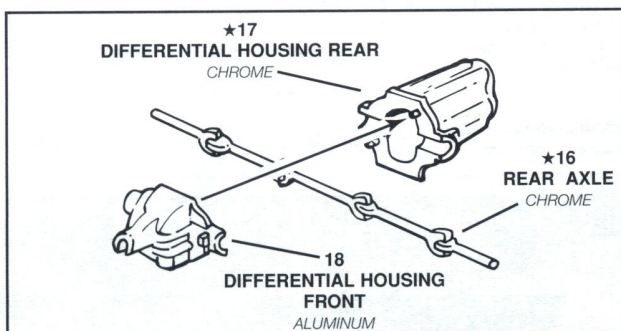

4

REAR SUSPENSION ASSEMBLY

A

COMPLETED DIFFERENTIAL ASSEMBLY

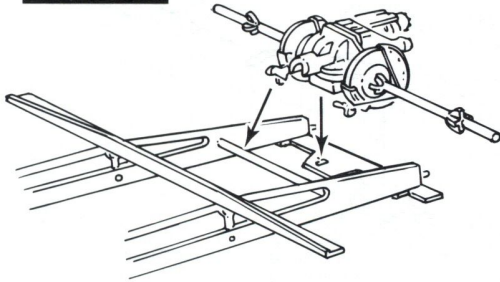

B

★22 TRAILING ARMS LEFT CHROME

★23 REAR SPRINGS / LINKS CHROME

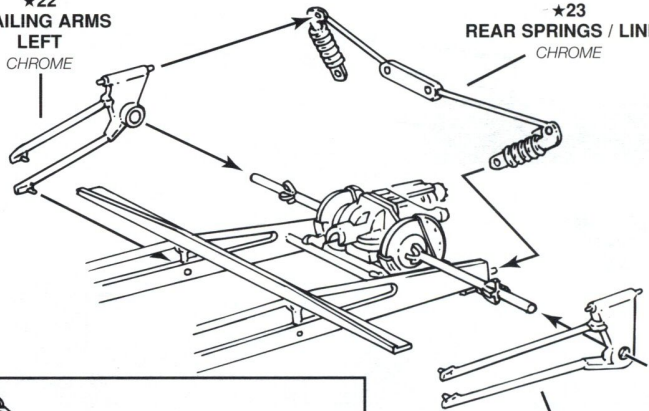

C

★24 SUSPENSION LINKS / MOUNT CHROME

★21 TRAILING ARMS RIGHT CHROME

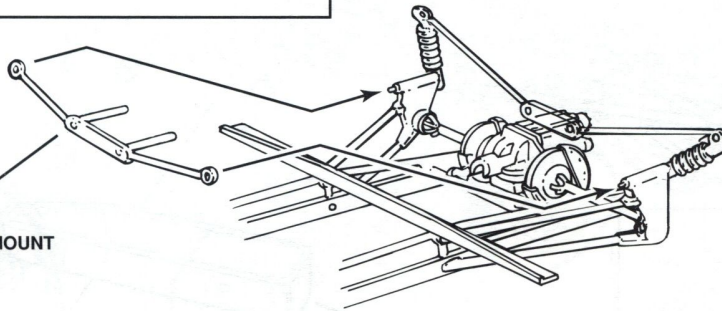

5

FRONT SUSPENSION ASSEMBLY

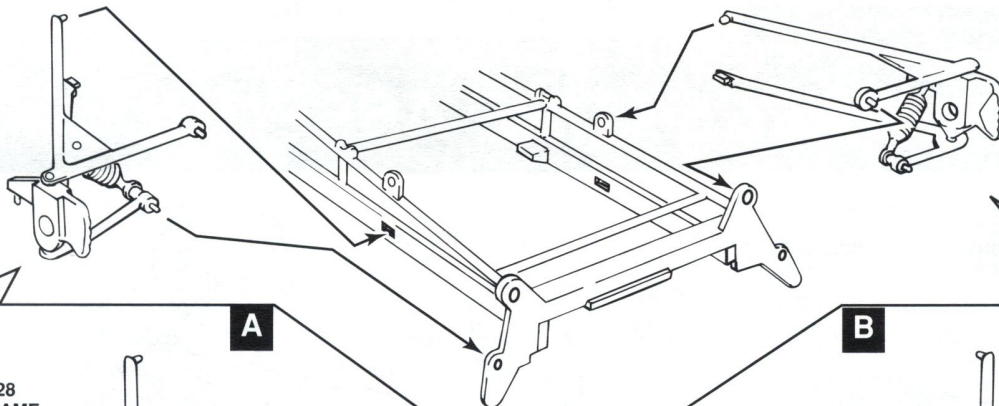

A

★28 A-FRAME UPPER LEFT CHROME

★27 SPRING / SHOCK ABSORBER LEFT CHROME

★26 SPINDLE LEFT CHROME

★25 A-FRAME UPPER LEFT CHROME

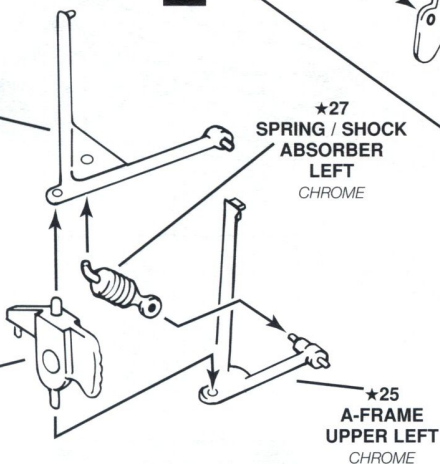

B

★32 A-FRAME LOWER RIGHT CHROME

★31 SPRING / SHOCK ABSORBER RIGHT CHROME

★29 A-FRAME UPPER RIGHT CHROME

★30 SPINDLE RIGHT CHROME

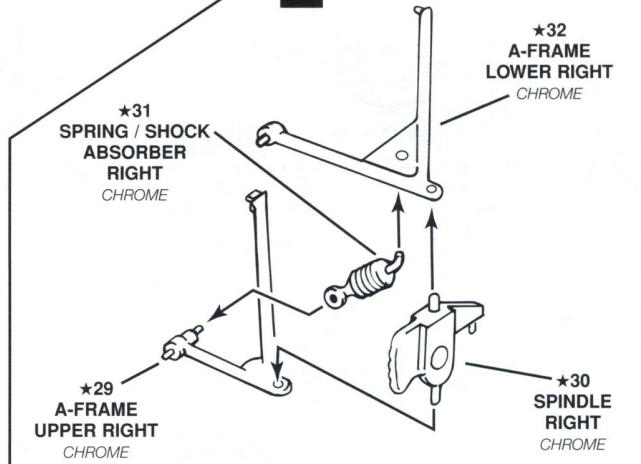

6

CHASSIS ASSEMBLY

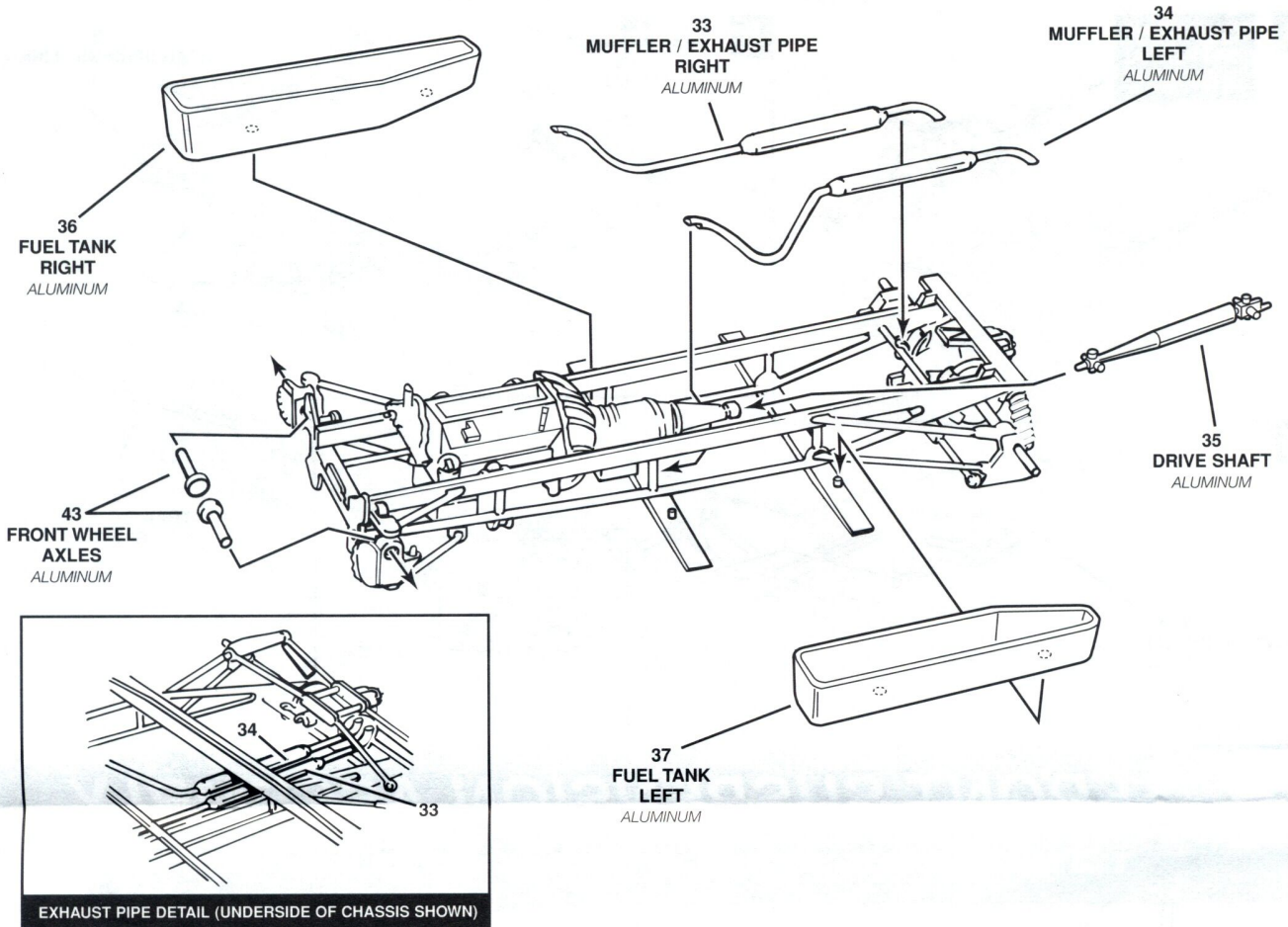

7

WHEEL / TIRE ASSEMBLY

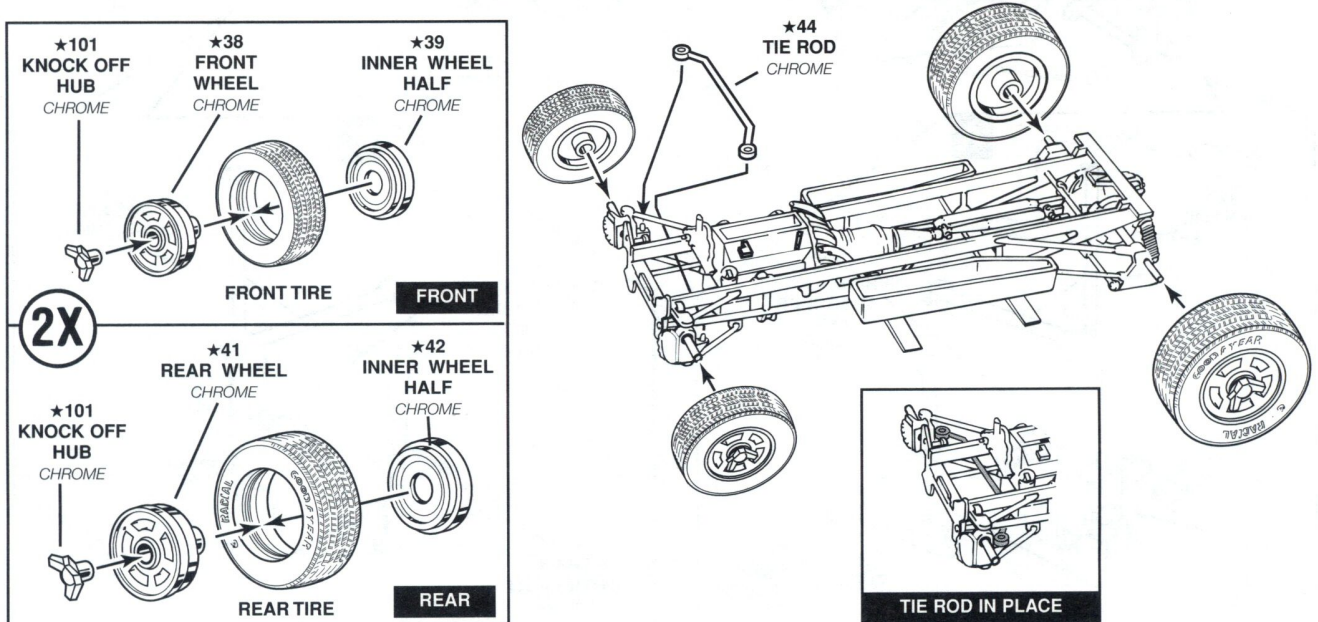

8

ENGINE COMPONENT ASSEMBLY

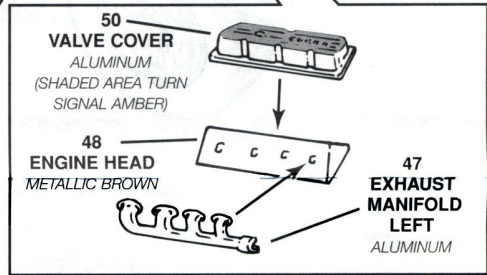
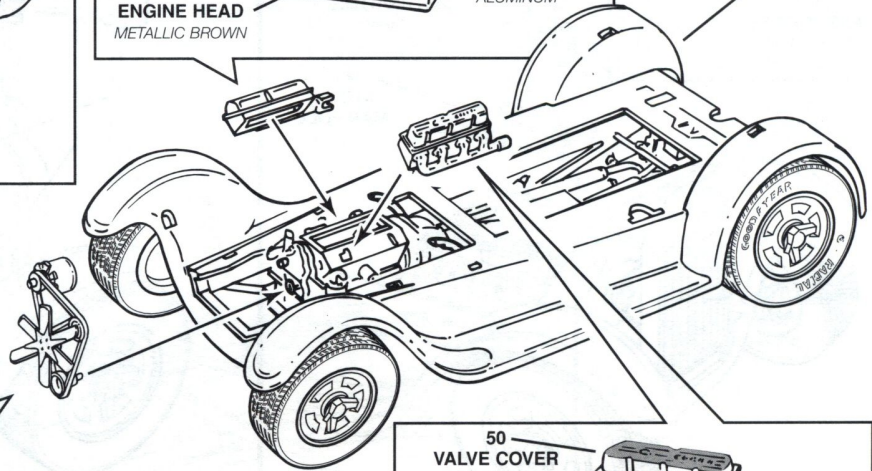
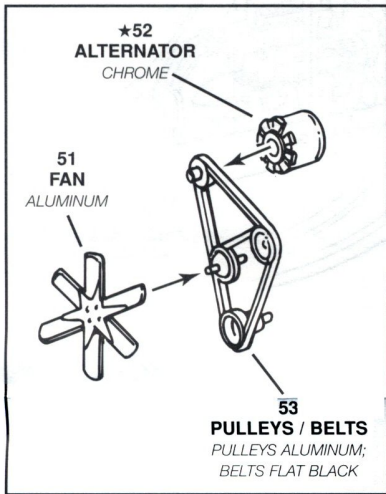
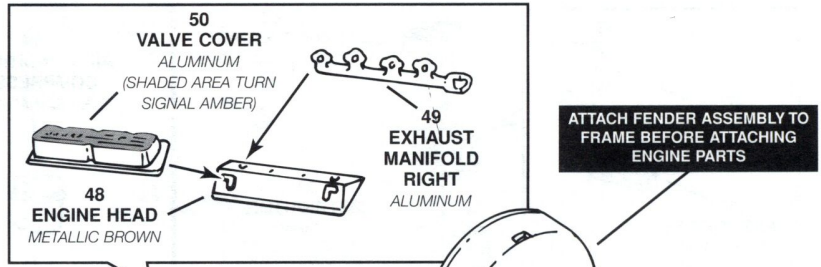
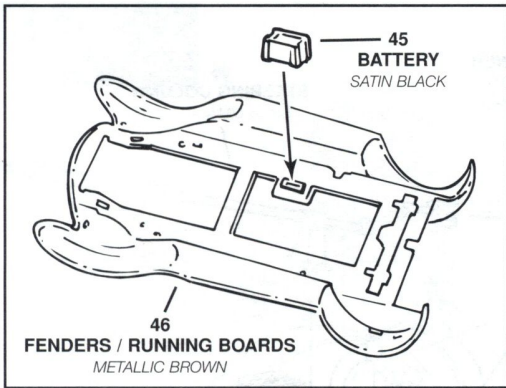

9

RADIATOR ASSEMBLY

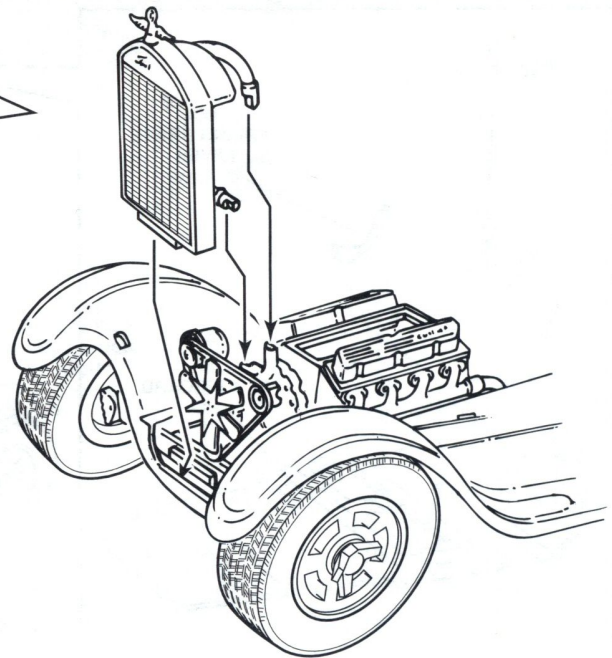
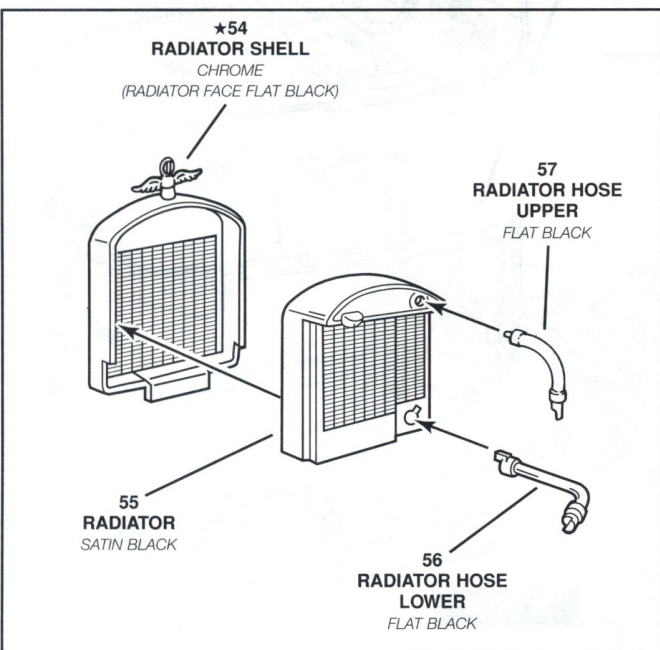

10

ENGINE DETAIL ASSEMBLY

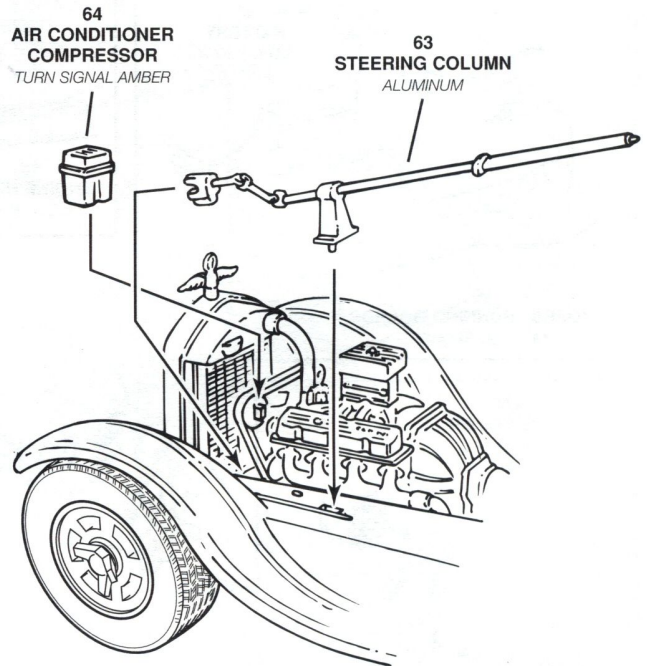
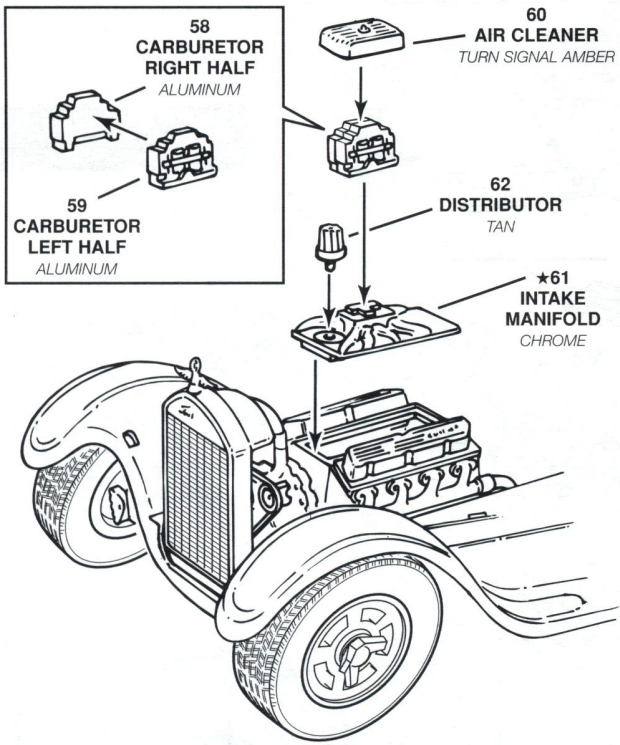

11

FLOORBOARD ASSEMBLY

