



# M54A2 5-TON 6X6 CARGO GUN TRUCK

For the French, the war in Indo-China came to a conclusion in 1954 with the French regime retreating out of the Indo-China peninsula and Vietnam separated at 17° parallel into North and South by the Geneva Conference. To counter the advance of communism from the North, the United States continued to serve as a military advisor to the South Vietnamese government. In 1960, guerrilla groups, controlled by the People's Liberation Armed Forces (also known as the NLF: National Liberation Front) or Vietcong, were organized with the objective of countering the influence of the United States in South Vietnam.

The Gulf of Tonkin incident of 1964 precipitated an increased US involvement in the conflict. In March of the following year U.S. troops landed at the coastal city of Da Nang. By this time however, many inland villages were under control of the Vietcong. This required multiple forward inland bases to be built from which US forces could stage counter offensives. These bases relied heavily on re-supply via many, small, meandering roads, which became a primary target for the Vietcong. Initial re-supply convoys, armed with only personnel light weapons, were often out-gunned by ambushing Vietcong. Increased firepower was required to counter the threat. This was especially true for the M113 tracked type troop carriers, which were unable to keep up with the speed of the wheeled convoy.

Prior to September, 1967 armed escorts for transport convoys were merely a Jeep armed with an M60 machine gun. On the night of September 2nd, an ambush of a considerable magnitude took place on highway 19 connecting Qui Nhon on the coast to the inland town of Pleiku. Thirty transport trucks were destroyed as the result of the attack making vulnerability of the convoys obvious. Weeks following the attack, a fleet of makeshift armed gun trucks, based on the M35 transport with wooden planks and sand bags to enclose the cab were fabricated. One armed M35 was assigned to every 10 transports in a convoy.

On November 24th, a convoy once again came under fire from an ambush. Even with the protection of the gun trucks, 6 transports and 4 gun trucks fell prey to the attackers. The concept of gun trucks underwent further development as a result of this ambush. The M35 platform became underpowered when loaded with guns and ammunition. Sand bags further bogged the truck down especially after becoming drenched from rain. The M54 was selected as the new platform for a gun truck. Multiple pre-cut armor plates were bolted to the cab of the M53 to form a box structure. Additional armor was installed as an inner layer with a gap from the outer layer for the purpose of dissipating energy from anti-tank rockets. Armament varied from M60, M2 50 caliber machine guns, or whatever the crew could procure for the best protection. A total of three to four hundred units of armed/armored trucks were fabricated and served until the emergence of the M706 armored vehicle in sufficient numbers. The M54 gun trucks served gallantly until the end of conflict.

Text edited by

John D. Miller, Ph.D.

Model Paint Solutions.com

1954年にインドシナ戦争終結後、ジュネーヴ協定によりベトナムは北緯17度線を基準に南北の2つの国家に分かれ、フランス軍はインドシナ半島から撤退しました。アメリカは共産主義が南ベトナムへ勢力を伸ばすのを阻止するため、軍事顧問として南ベトナム政府を支持し続けました。1960年、南ベトナムでゲリラ活動能力を持つ「南ベトナム解放民族戦線(NLF)=ベトコン」が結成され、南ベトナムでのアメリカの影響力を追放することが目的でした。

1964年、アメリカと北ベトナムがトンキン湾で武力衝突し、これによりアメリカがベトナムに対して戦争を行う姿勢を強めました。1965年3月、アメリカ軍地上部隊は沿岸都市ダナンに上陸しました。この時点で南ベトナムのほとんどの村はベトコンの支配下にありました。ベトコンのゲリラ部隊を駆逐するため、アメリカは内陸部に基地を建設する必要がありました。しかし基地を維持するための物資は港からの輸送に依存していたため、ベトコンの襲撃を受ける格好の標的となりました。

1967年9月以前は、輸送部隊を護衛したのはM60機関銃を装備したジープでした。9月2日の夜、クイニョン港と内陸の町ブレイクを結ぶ19号高速道路で大規模な待ち伏せに会い、30台のトラックが破壊されました。輸送部隊の明らかな脆弱性を補うために、今後数週間の緊急事態に備え、アメリカ軍は車体の周りに土嚢と厚板を追加したM35をベースとして、2丁のM60機関銃を設置してガントラックに改造しました。10台の輸送トラックに1台のガントラックの組み合わせで輸送部隊を再編成しました。

11月24日、輸送部隊は再び待ち伏せを受けました。ガントラックによる保護の効果もあって、輸送トラックの損失は6台に減少し、4台のガントラックが破壊されました。安全対策を強化したにも関わらず、輸送部隊は依然として攻撃を受けていたため、ガントラックの改善が続けられました。M35トラックは動力が不足しており、装甲と武器の増加により速度が低下しました。そこでM54トラックを新しいベースとして置き換えました。

M54をベースに改造されたガントラックは、車体に複数のカットされた装甲板とボルトで固定し、ボックス型に組み立てられ、内部には別の装甲板が追加されています。対戦車ロケットから身を守るために、2つの装甲層の間に空間を作りました。搭載する武器には、M60機関銃・M2.50口径機関銃などのさまざまな組み合わせが含まれていました。このような変更が加えられたガントラックは合計300~400台ありました。緊急処置として登場したガントラックは、後継のM706装甲車両の量産まで使用する予定だったが、アメリカ軍が撤退する1972年までベトナムの戦場で活躍し続けました。

1954年法越戰爭結束，簽訂的《日內瓦協定》將越南正式以北緯十七度劃分為南北兩個國家，法國的勢力由中南半島撤出。美國為了阻止共產勢力向南方擴張，持續以軍事顧問團的方式支持南方政府。1960年在南方的越南共和國境內，擁有游擊武力並接受北方指揮的「越南南方民族解放陣線」成立，目的在驅逐美國在南越的影響力。

1964年，美國與北越在東京灣海面爆發武裝衝突，自此美國對越戰態度轉為積極。1965年3月美軍地面部隊自岷港登陸，此時南越的農村已多數由越共所控制。為掃蕩鄉間的越共游擊隊，美軍著手修建處於內陸的基地，基地的維持仰賴由海岸港口輸送的物資，此時綿長的交通線便成為越共伏擊的重要目標。

在1967年9月之前，為運輸車隊提供武裝護送的，是搭載了M60機槍的吉普車。9月2日晚間，連結位於海岸的歸仁(Qui Nhon)與內陸的波來古(Pleiku)間的十九號公路發生了一起大規模的伏擊，伏擊中造成了30輛卡車被毀。為了彌補運輸車隊明顯的脆弱，接下來的幾週內美軍應急地選擇以M35卡車為基礎，在車體周圍增加沙包與木板做為保護，並安裝兩挺M60機槍成為武裝卡車。以十輛運輸卡車搭配一輛武裝卡車的方式重新組成車隊。

11月24日，運輸車隊又遭遇了伏擊，由於武裝卡車的保護，損失降低為6輛運輸卡車與4輛武裝卡車被毀。儘管加強了安全措施，運輸部隊仍然受到攻擊，因此繼續進行對武裝卡車進行改良。M35卡車的動力不足，增加的裝甲和武器降低了它們的速度，因此以M54卡車所取代，成為新的武裝卡車載臺。

以M54為基礎改裝的武裝卡車，以預先切割好的裝甲板在車斗上以螺栓組裝成箱型，並在內側增設另一層裝甲板。為了防禦反戰車火箭，兩層裝甲間還保持了一段空間。搭載的武器也包含了M60、M2.50口徑機槍等各種組合，總共有三、四百輛卡車經過這樣的改裝。雖然武裝卡車一開始以應急的身分出現，等待後繼的M706裝甲車在數量上滿足需求，但武裝卡車在越南戰場上仍然持續活躍，直到美軍撤離的1972年。

### Illustration:圖示說明



### Method For Applying Decals:

1. Clean Model Surface With Wet Cloth.
2. Cut Out Of Decal Sheet And Dip Them In Warm Water For 15 Seconds.
3. Place it on proper position on model.
4. Slide off base paper leaving decals On Model With Wet Finger Tip.
5. Move Decals To Exact Position, Push Out Excess Water Under Decal With Soft Cotton Cloth.
6. When Decals Get Dry Then Complete.

### 水貼紙使用說明:

- 1.將模型表面擦乾淨
- 2.將貼紙剪下泡入溫水中浸泡約15秒
- 3.將泡濕之貼紙取出置於欲貼處旁
- 4.用指尖輕推貼紙表面使其滑出底紙
- 5.將貼紙調整至適當位置並輕擦拭水份
- 6.待其自然乾燥後即完成

### Color list: 塗料表

Color	Brand	GSI Creos			Humbrol	AV Vallejo	Lifecolor
		Hobby Color	Mr.Color	Mr.Color Spray			
Flat black FS37038	消光黑	H12	C33	S33	33	70950	LC02
Flat red	消光紅	H13			153	70957	LC06
Flat white	消光白	H11	C62	S62	34	70919	LC01
Olive drab FS34087	橄欖褐	H304	C304		155	71043	UA03
Sail color	帆布	H85	C45		28	72149	UA099
Silver	銀	H8	C8	S8	11	70997	LC74
Smoke gray	煙灰	H95	C101			70939	
Steel	黑鐵	H18	C28	S28	53	77712	LC76
Tire black	輪胎黑	H77	C137		85	70950	LC02
Wood brown	木棕	H37	C43		186	70876	UA085

# M54 5t Cargo Truck series

## M41 6x6 Cargo Truck

(M54's prototype)

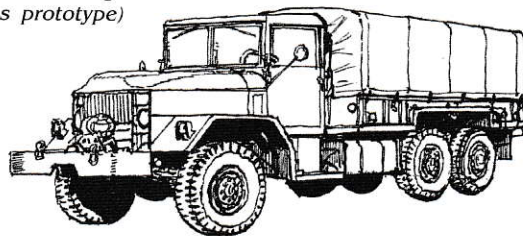

## M54 6x8 Cargo Truck

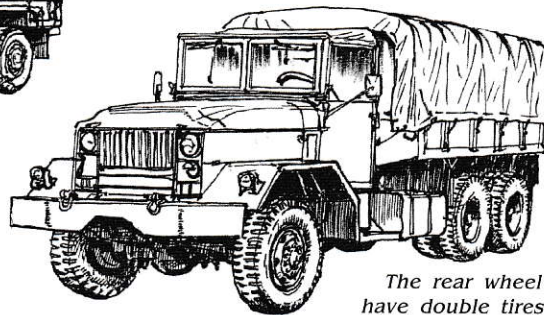

The rear wheel part have double tires and increase the carry load.

## M54A1 Cargo Truck

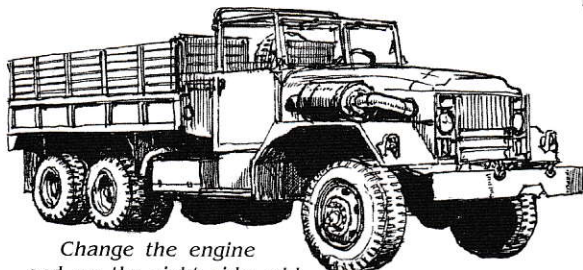

Change the engine and on the right side add a huge oil bus type air cleaner.

After the A1 type, having a chimney style exhaust pipe.

## M54A2 Cargo Truck

Having a Multi-fuel engine.

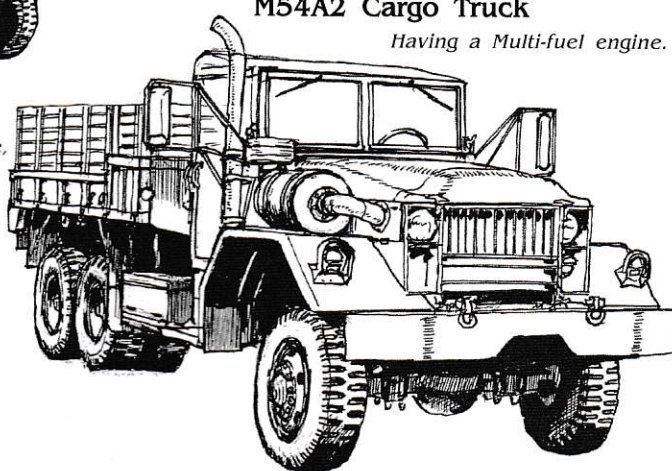

## M51 5t Dump Truck

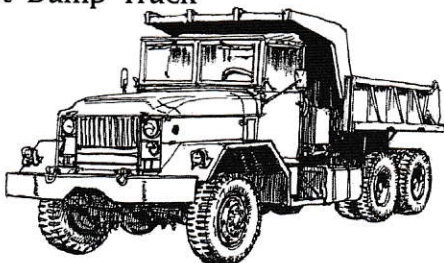

## M54A2 Gun Truck

Centered on M2 .50cal machine gun and equipped M60 7.62mm machine gun, ect.

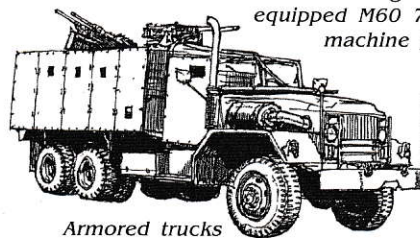

## M55 Cargo Truck

Long wheel base.

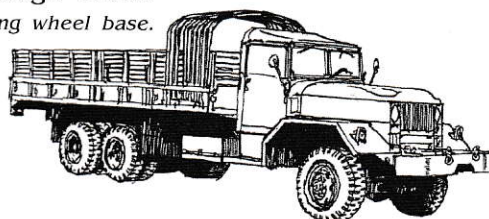

Armored trucks made to protect conroy during the Vietnam War.

## M543 Wrecker

It is a flexible and practical truck used to repair various types of vehicles and construction.

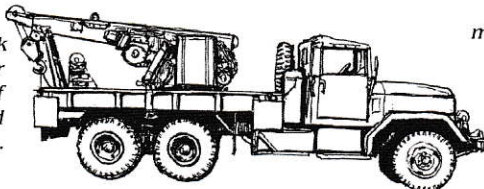

## Gun Truck with M113

The bucket load a M113 APC body's Gun Truck.

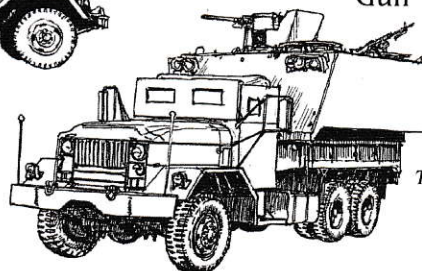

## M52 Tractor Truck

Used to tow all kinds of semi-trailers.

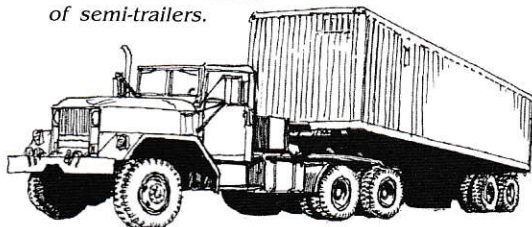

Shin.ueda  
上田 信

**1**

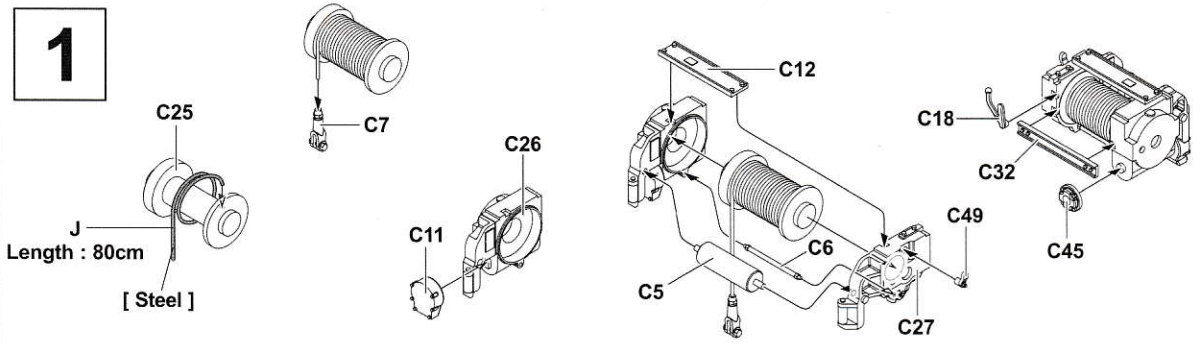

**2**

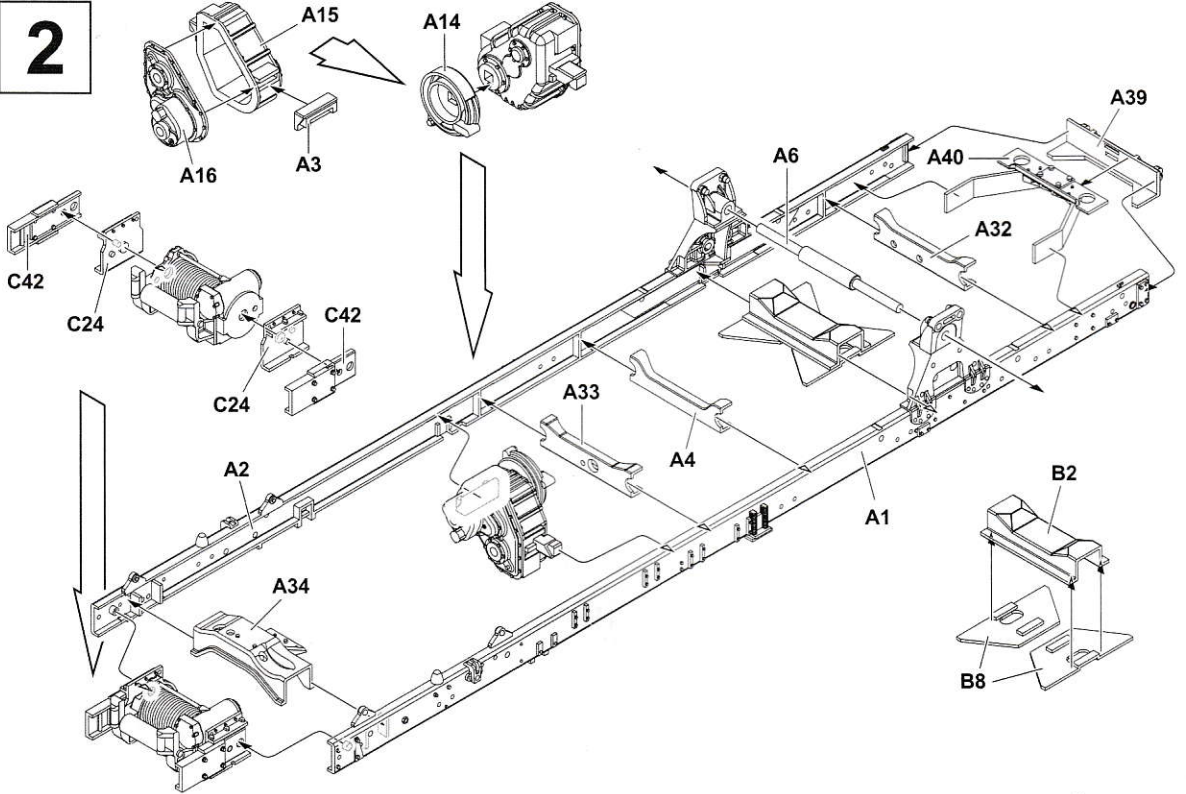

**3**

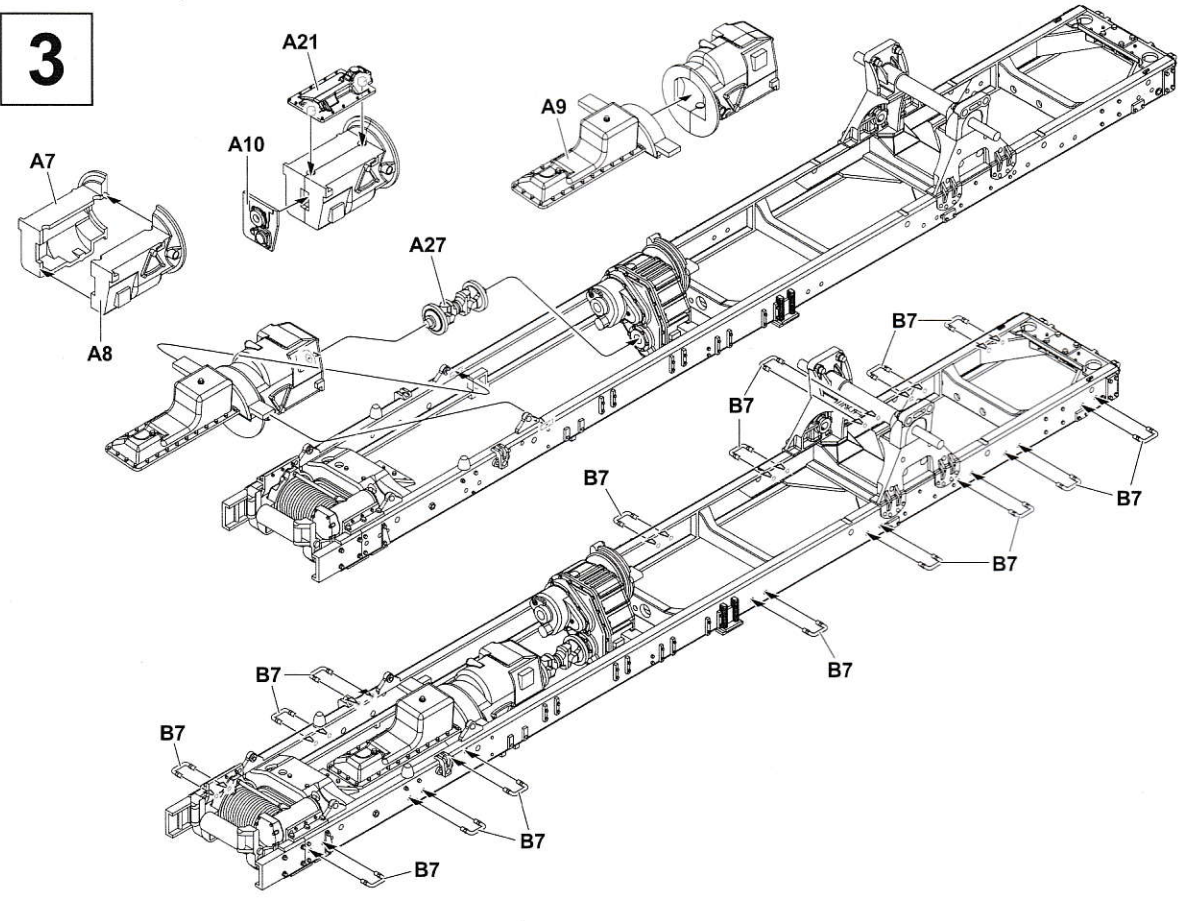

4

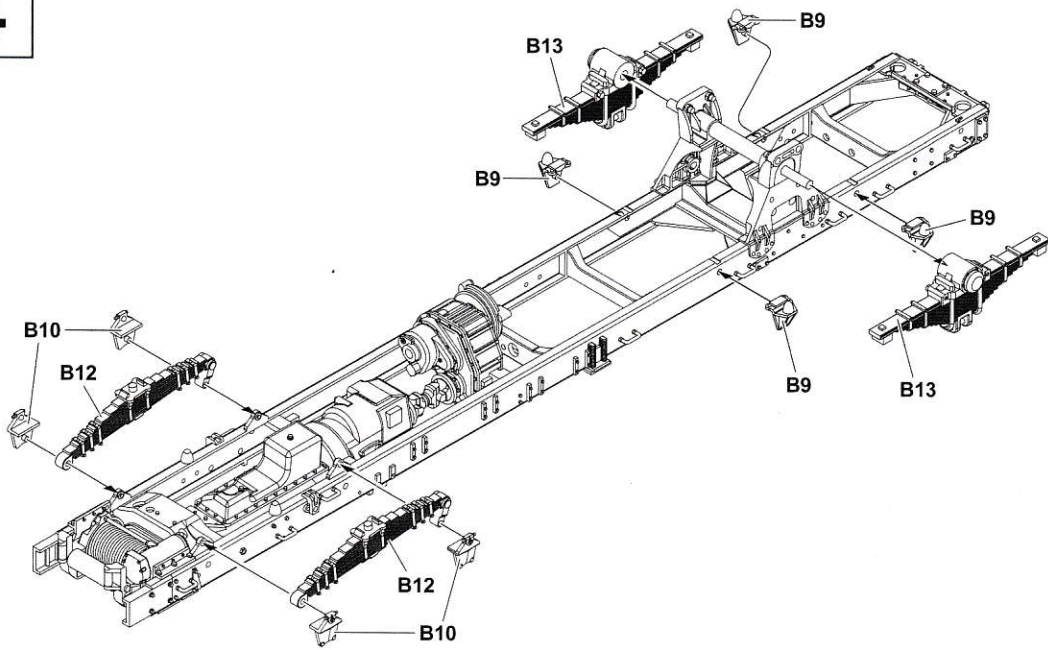

5

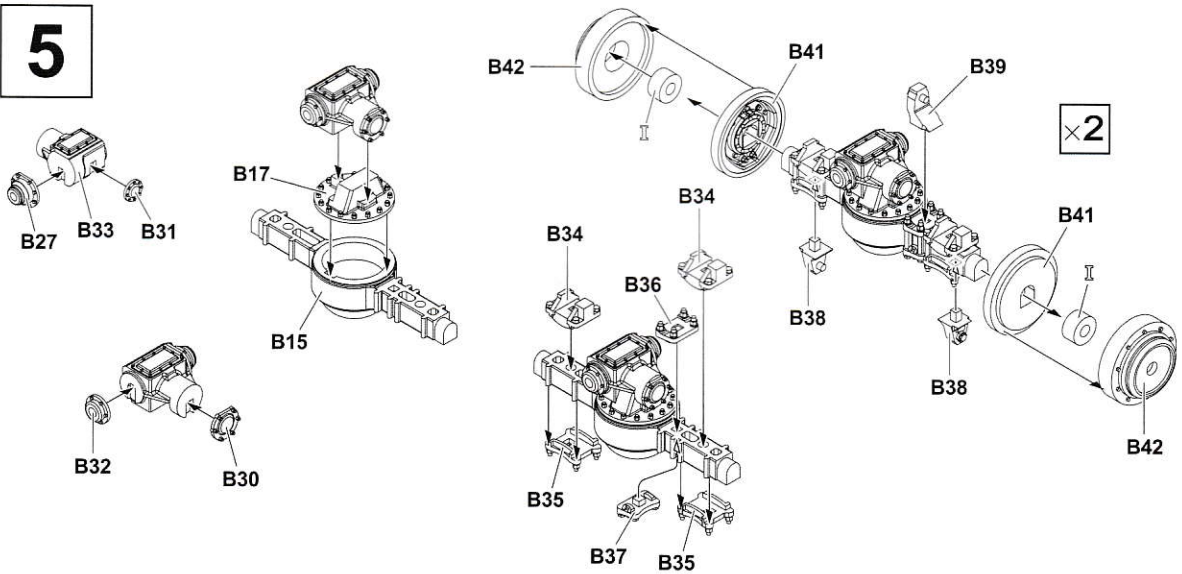

6

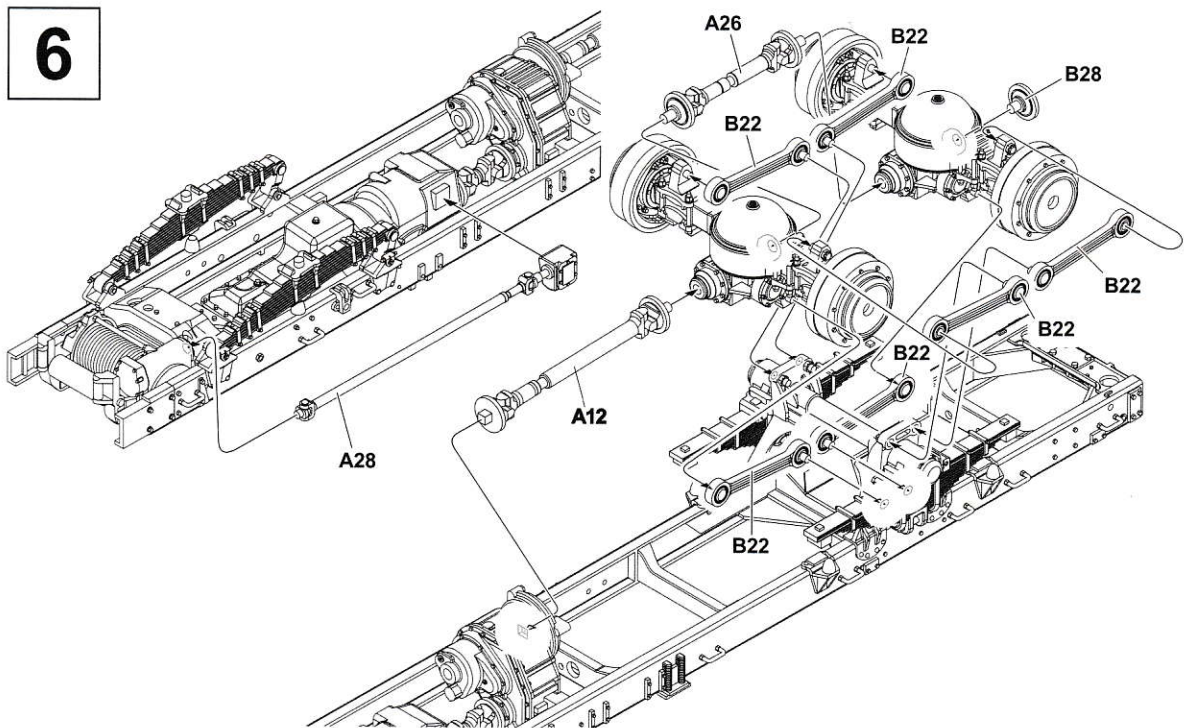

7

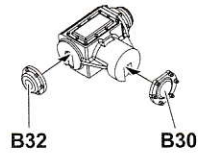
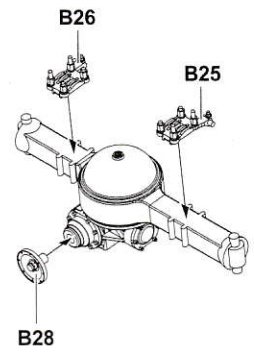
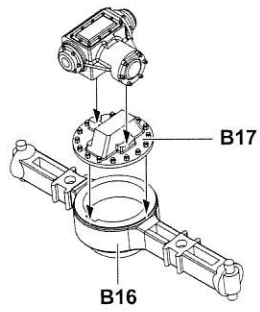
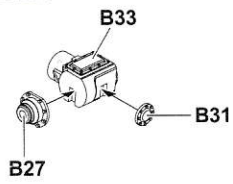

8

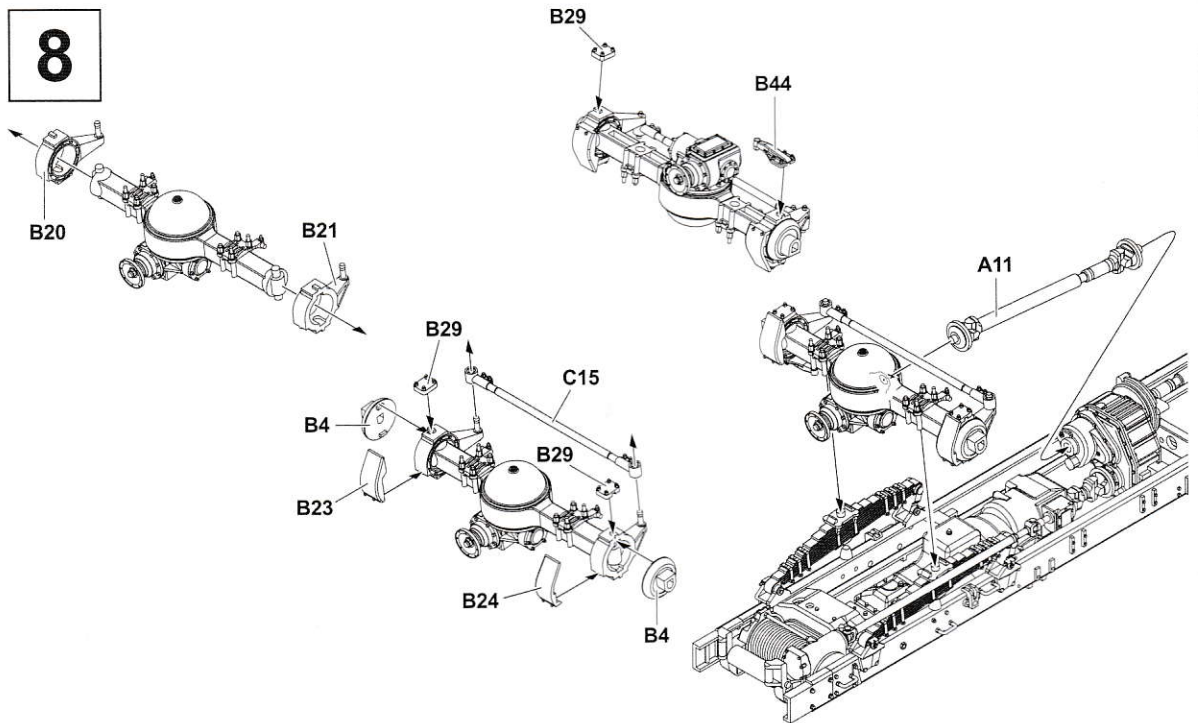

9

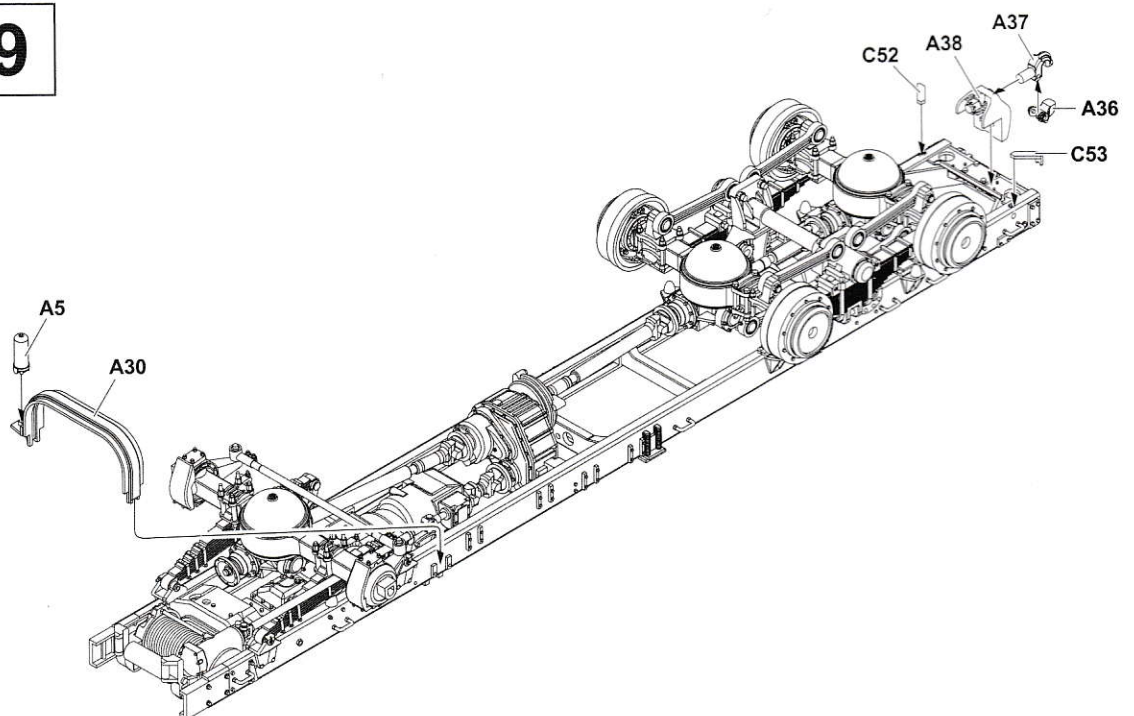

10

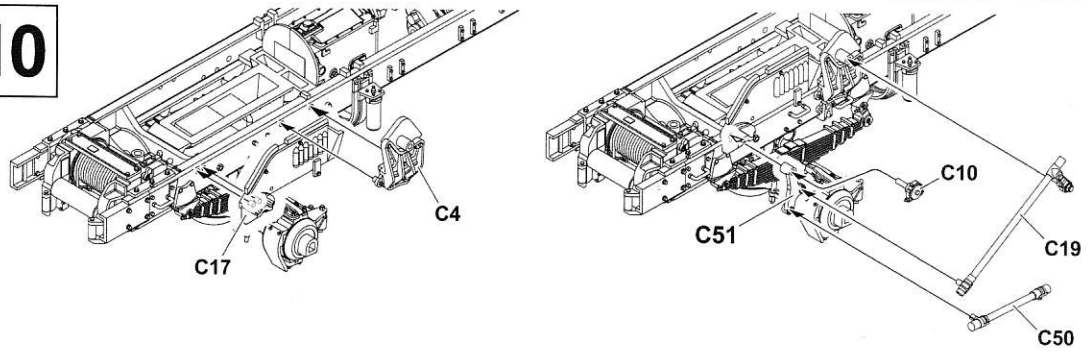

11

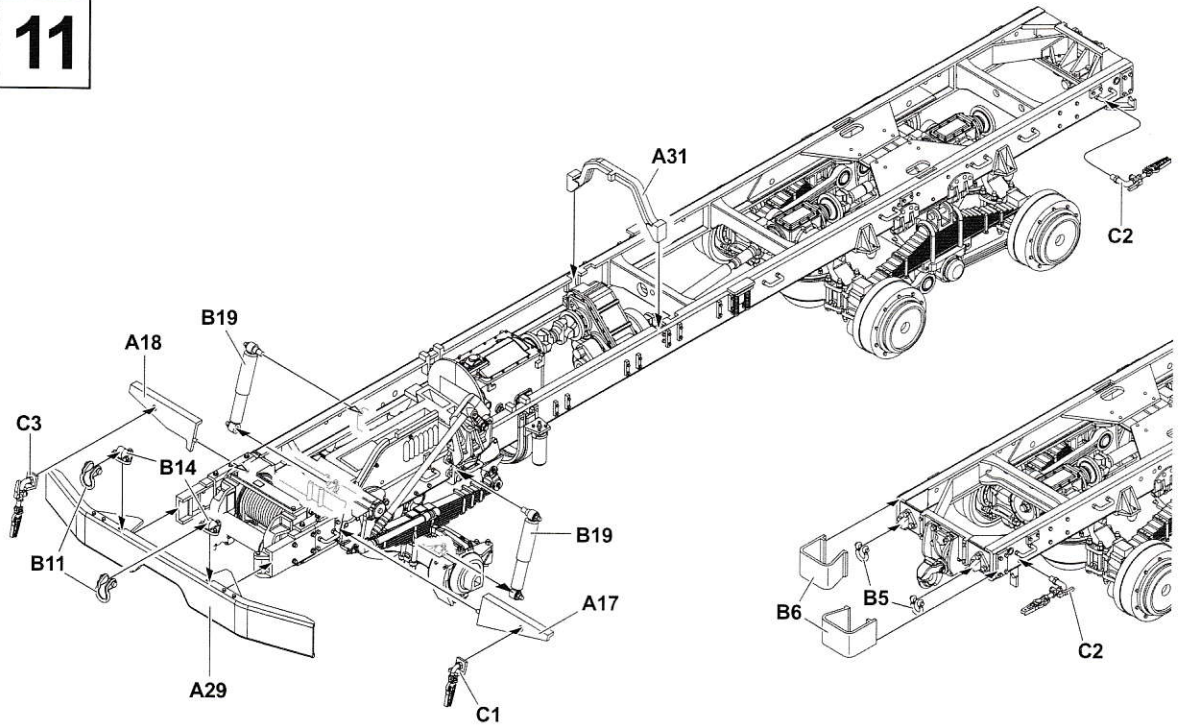

12

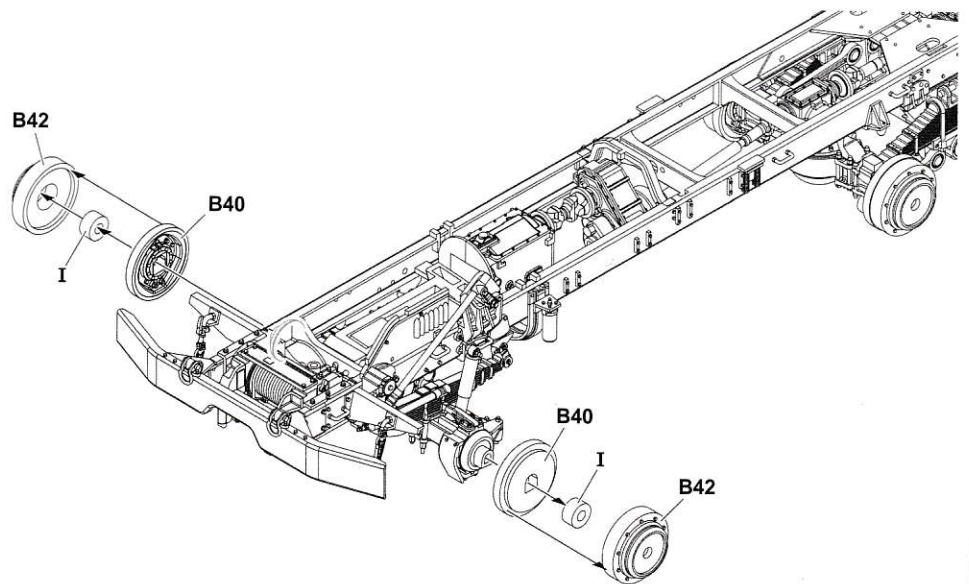

13

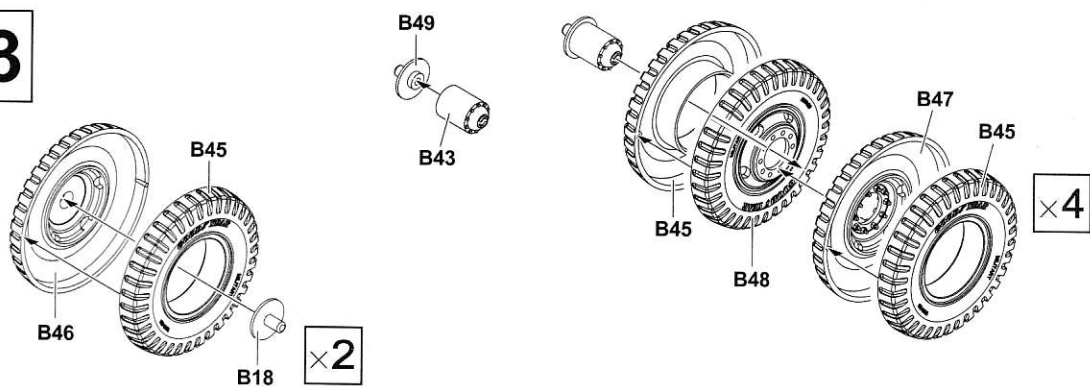

14

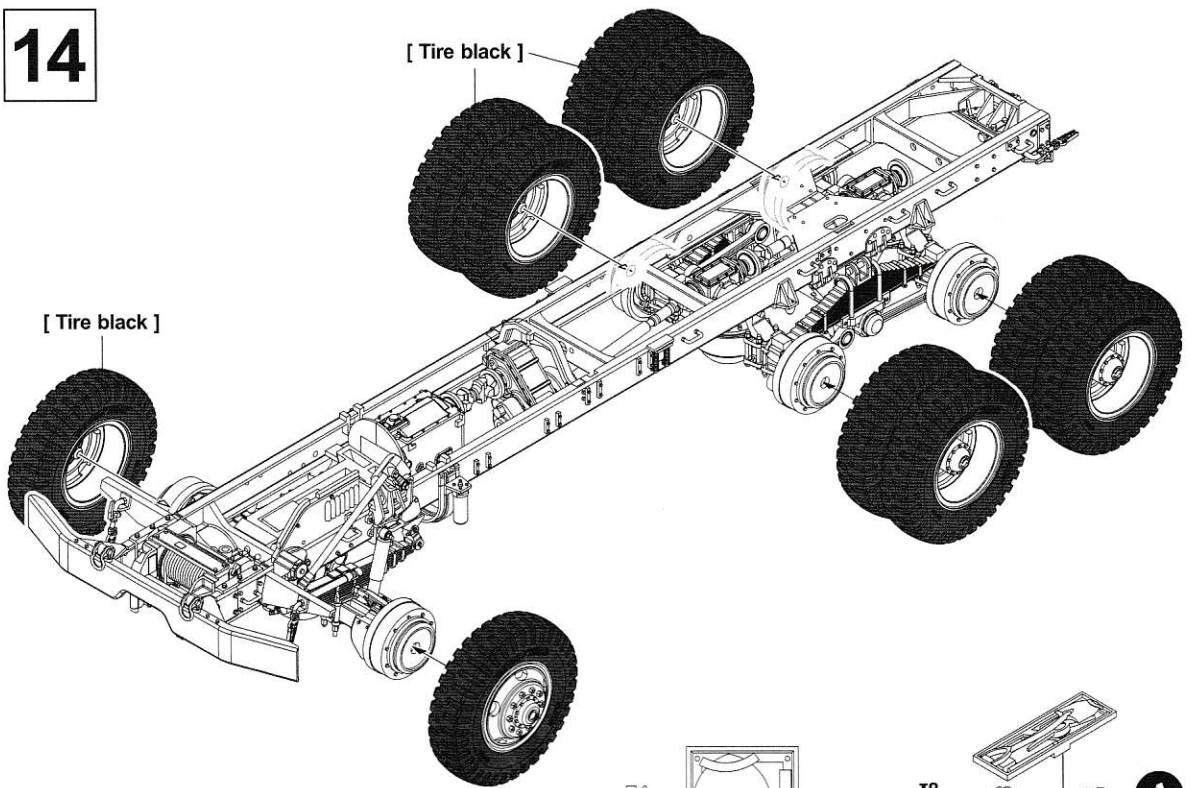

15

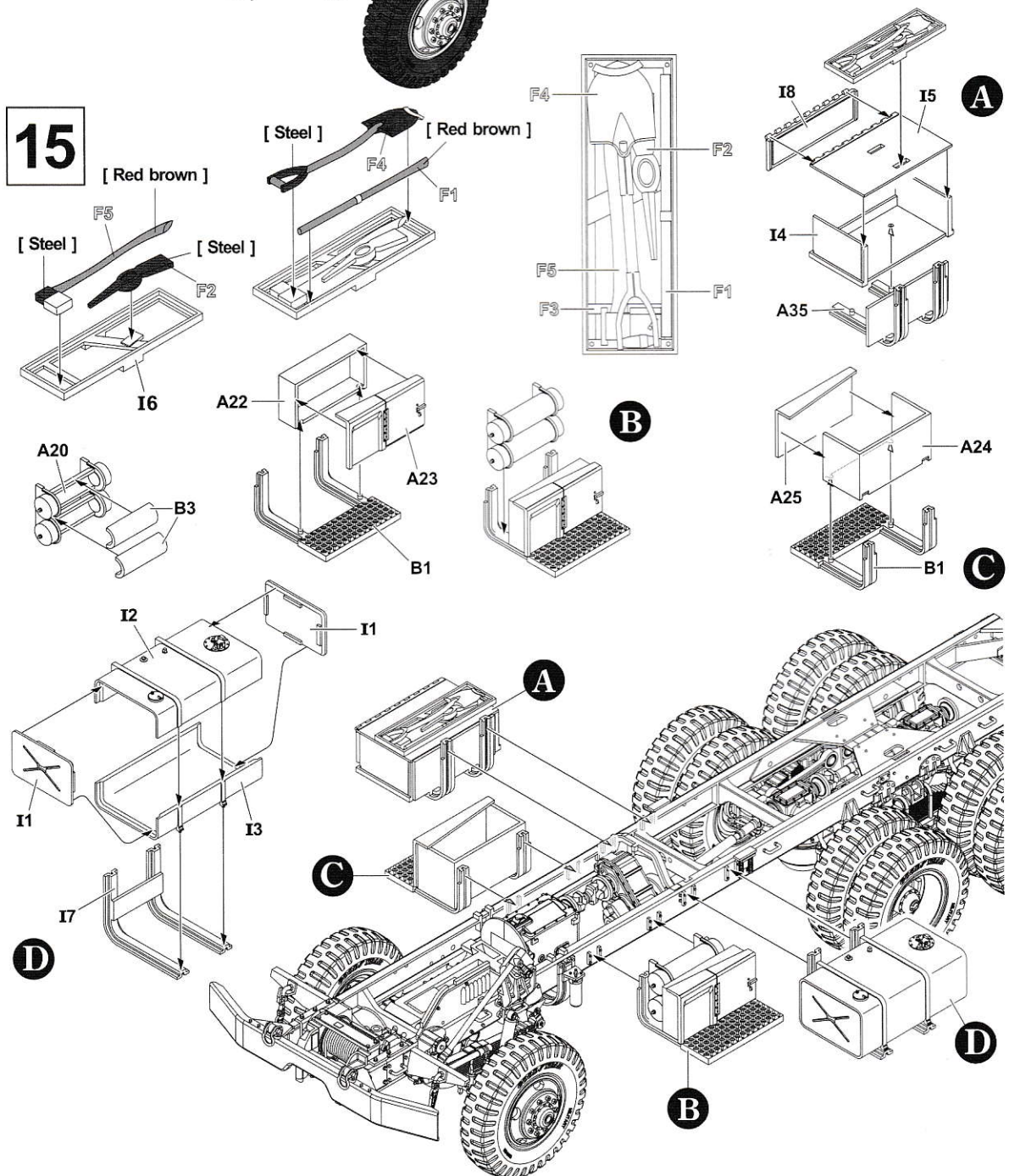



16

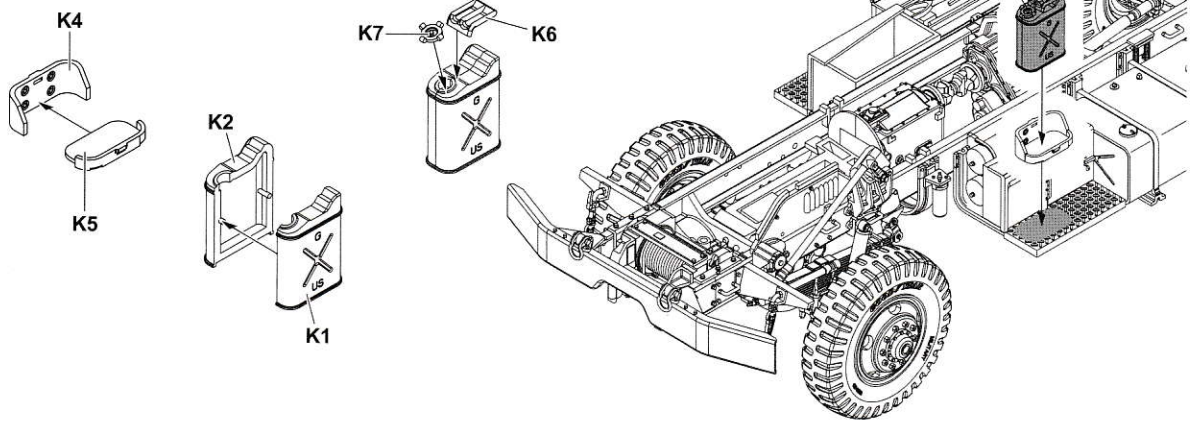

17

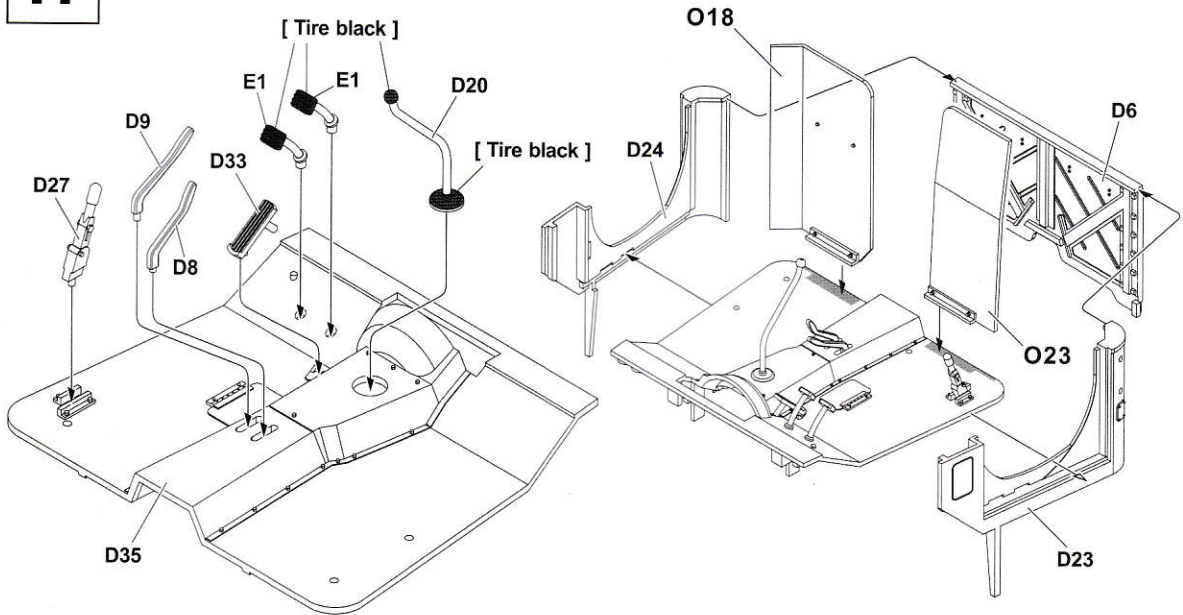

18

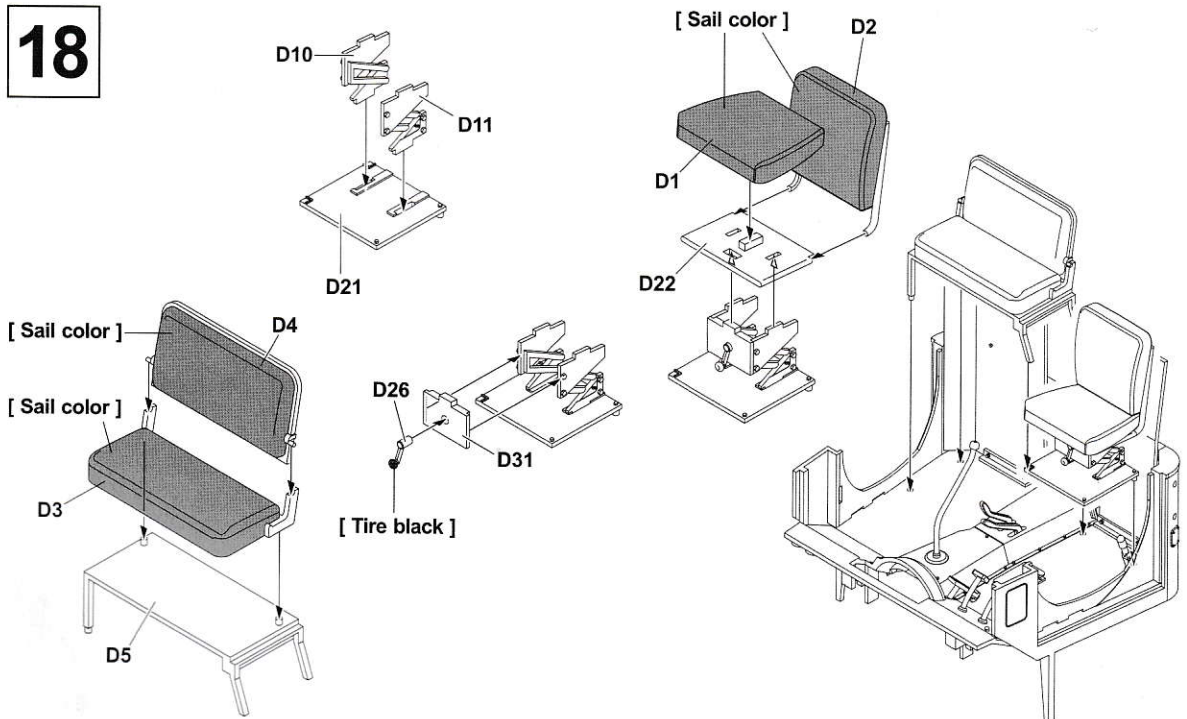

19

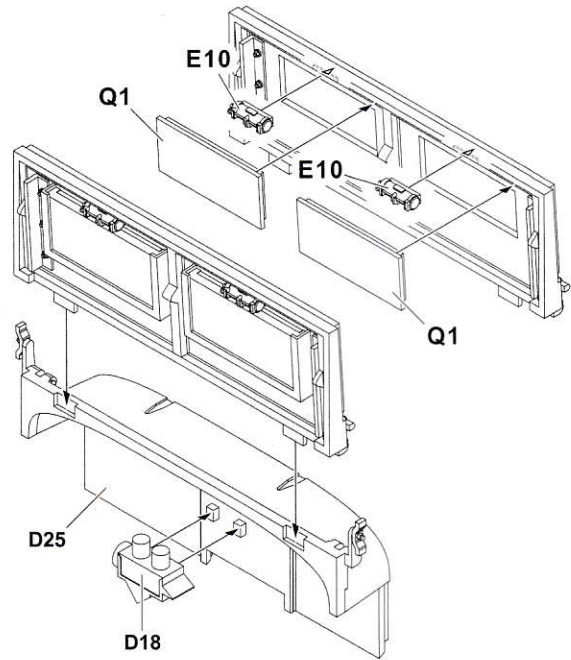
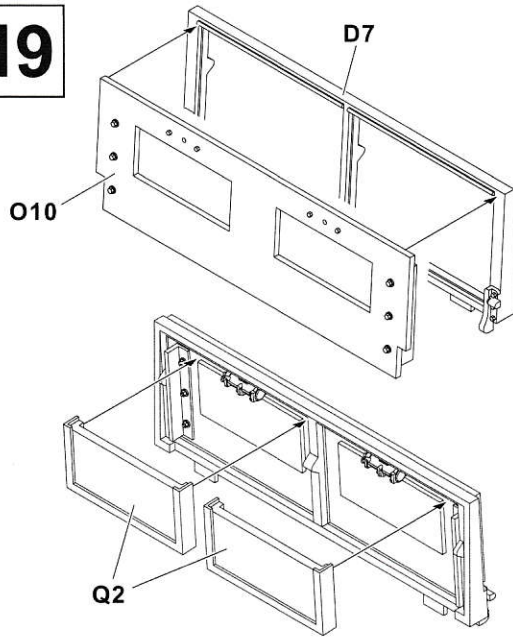

20

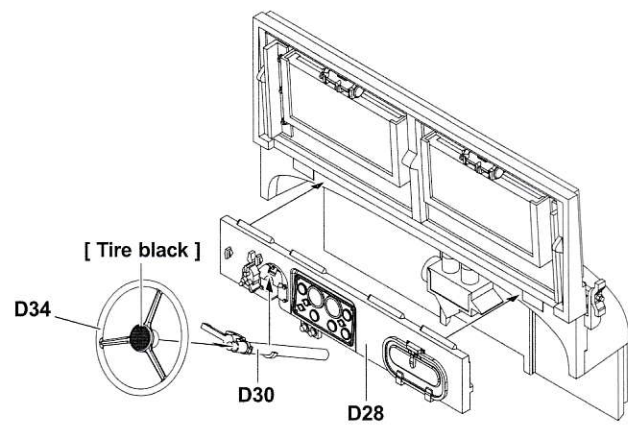
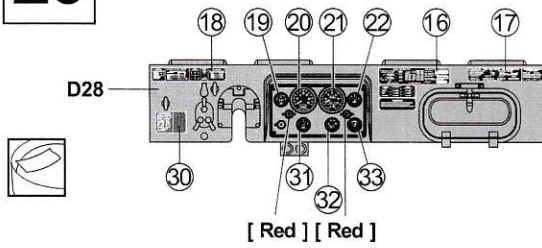

21

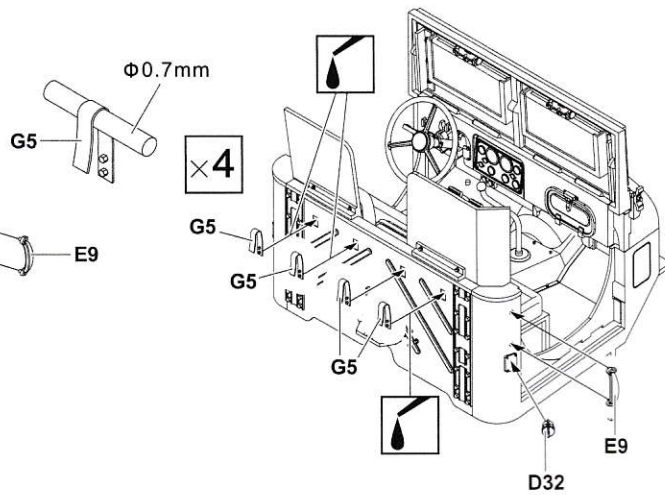
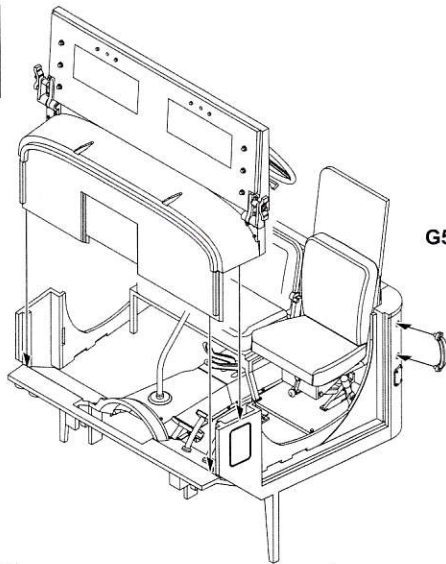

22

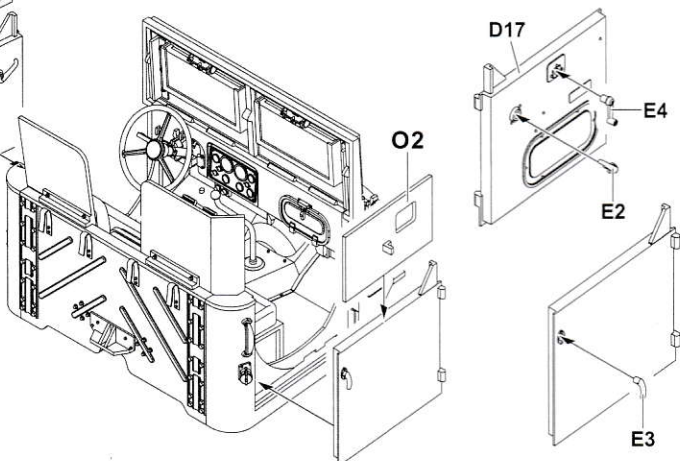
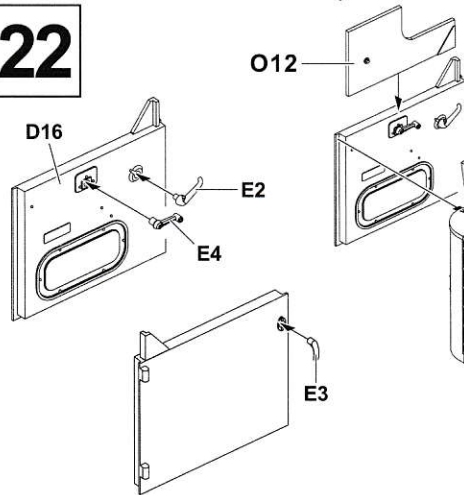

23

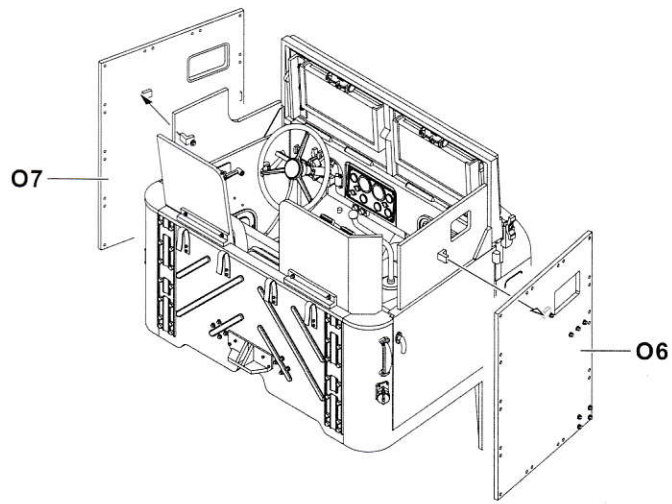

24

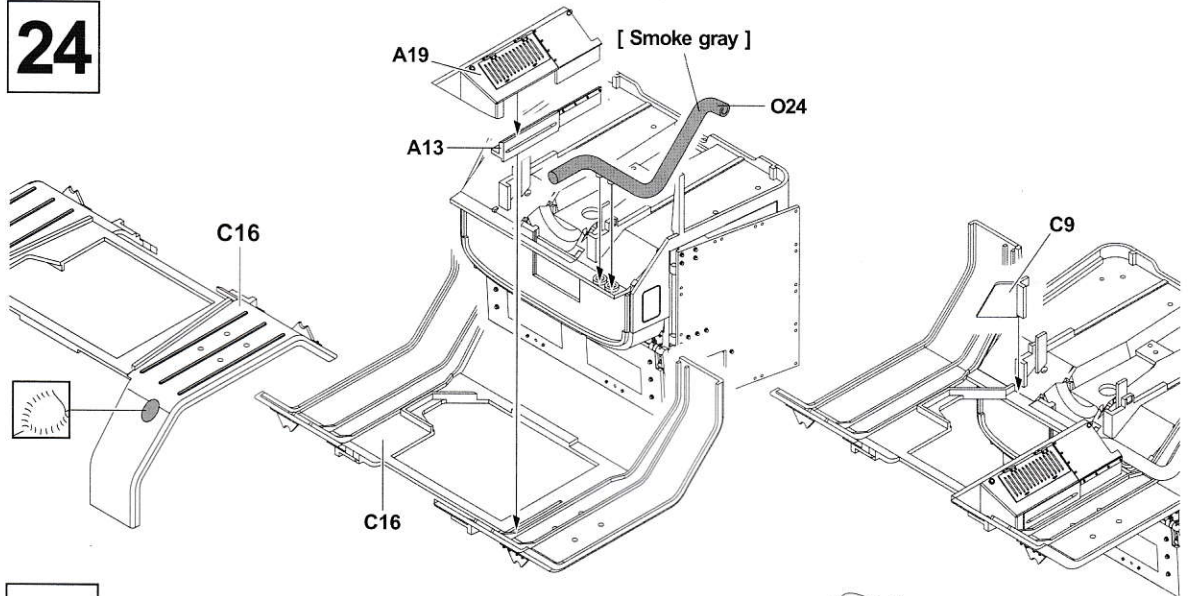

25

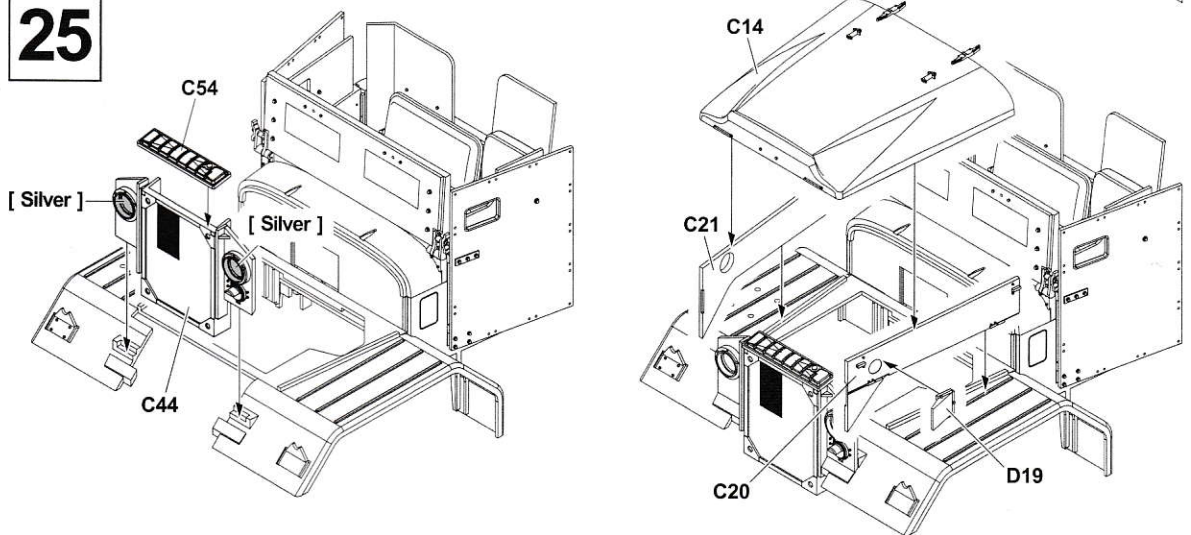

26

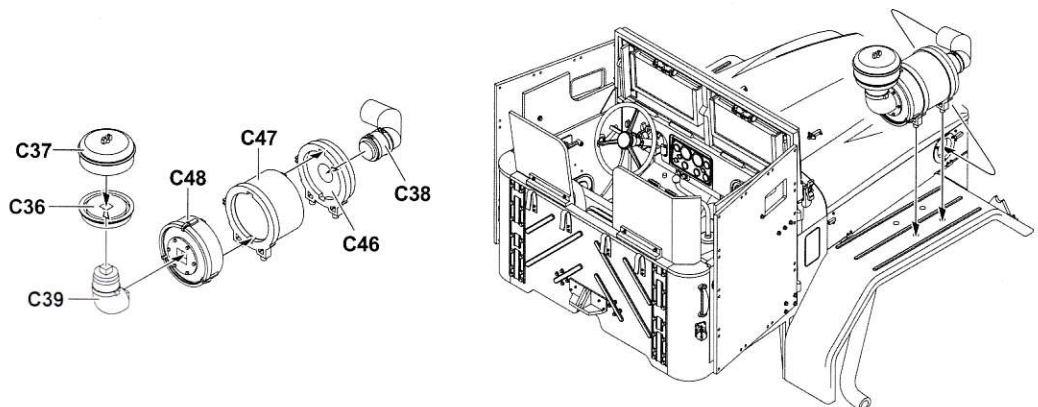

27

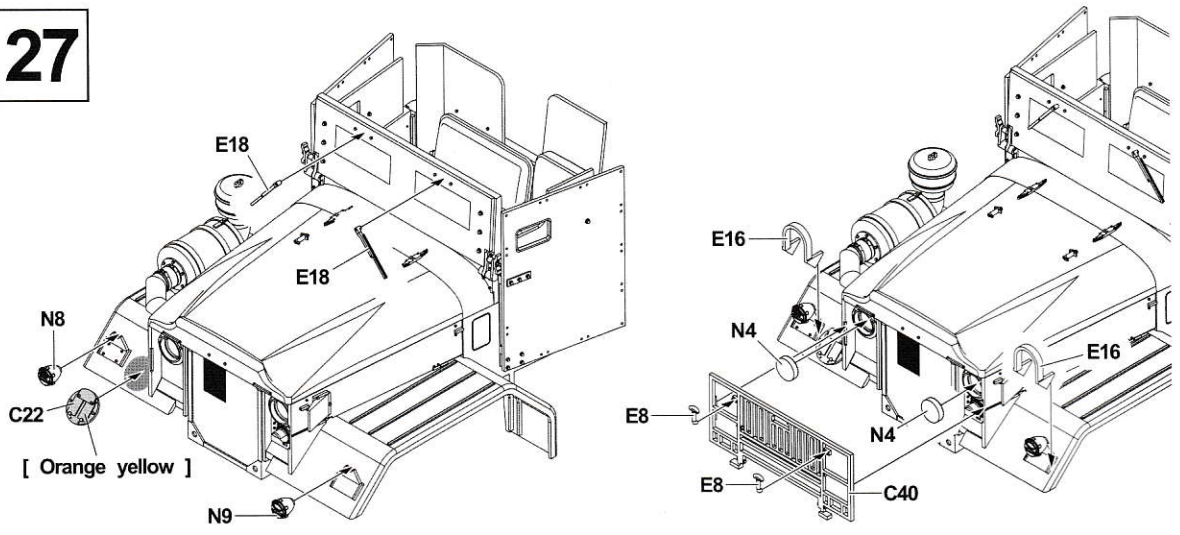

28

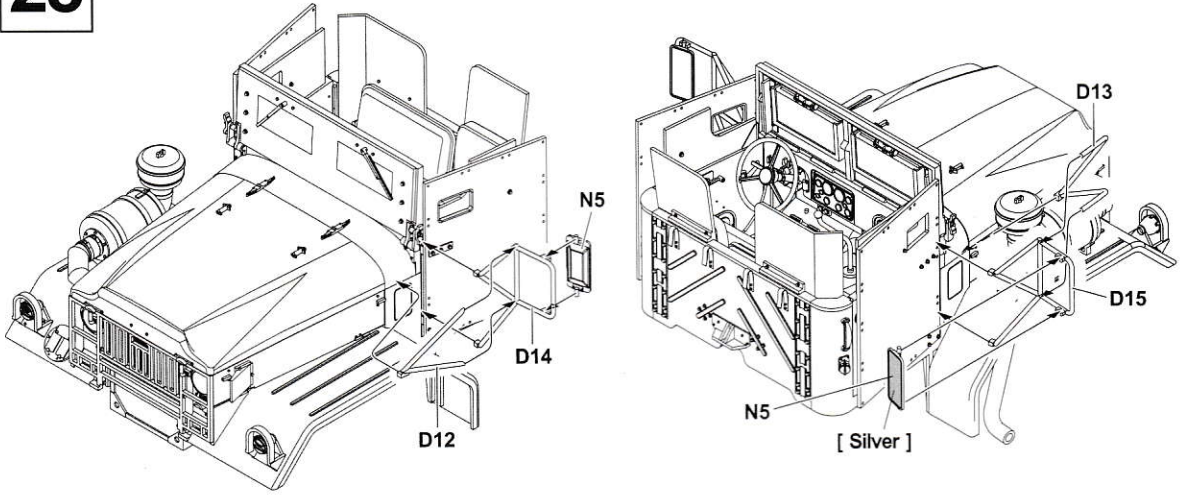

29

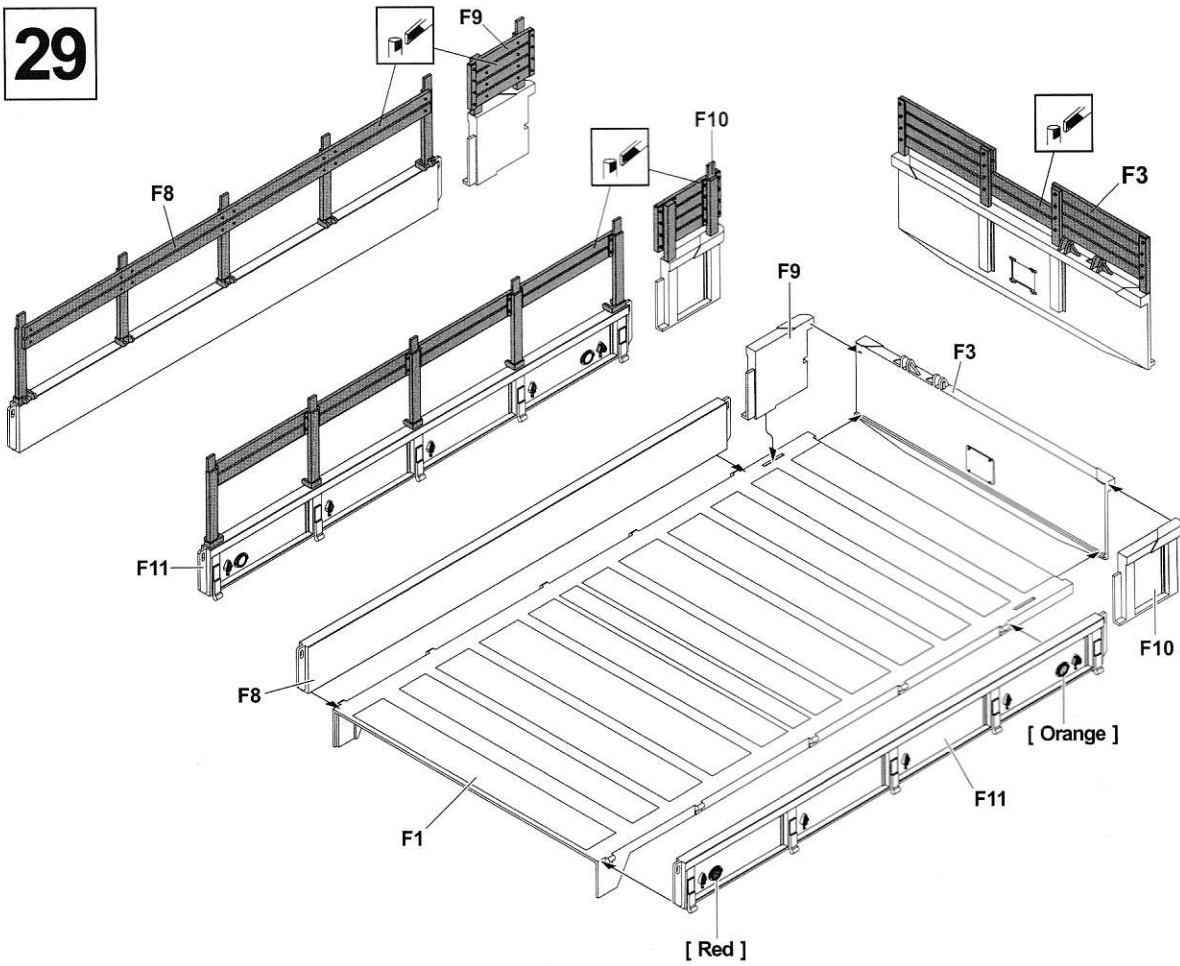

30

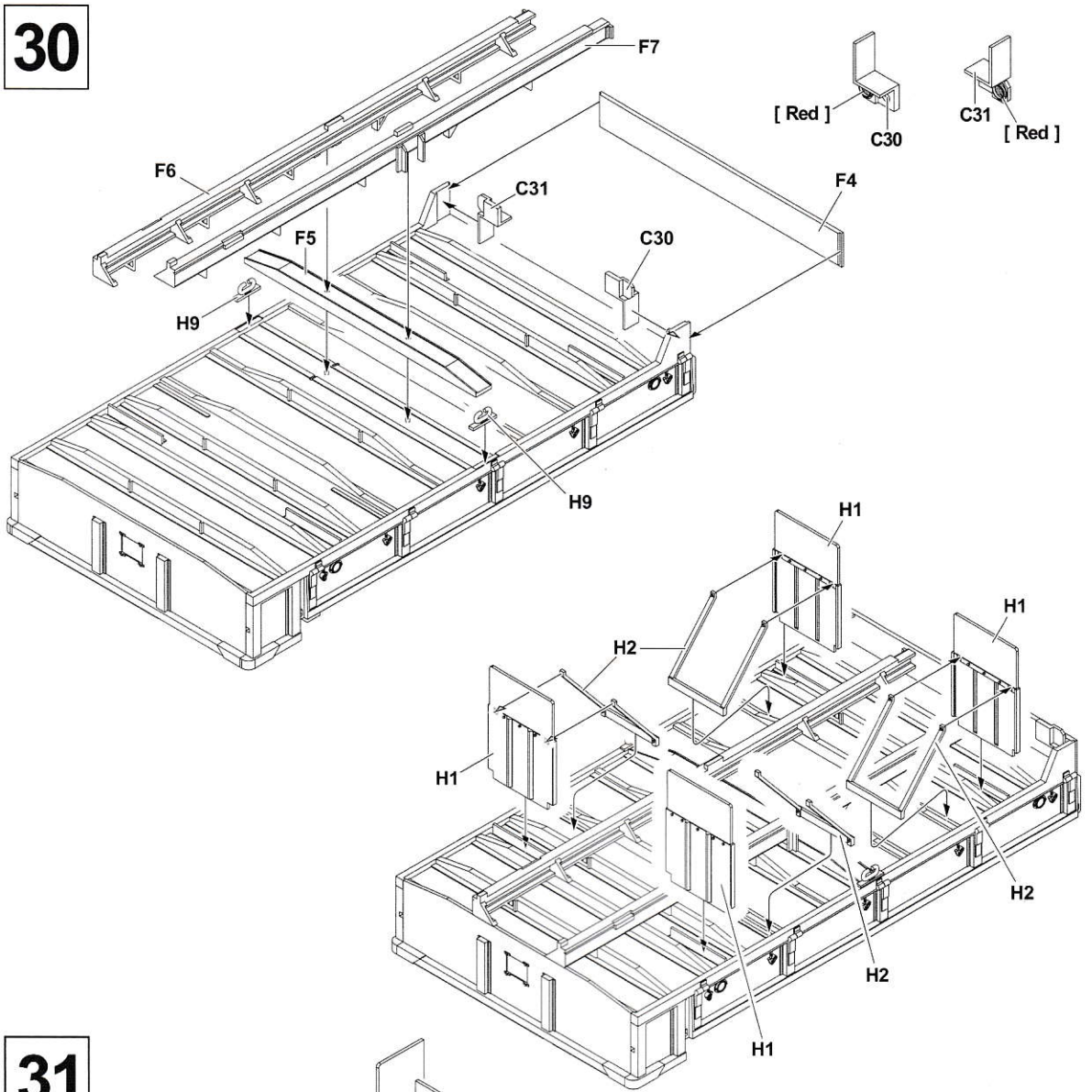

31

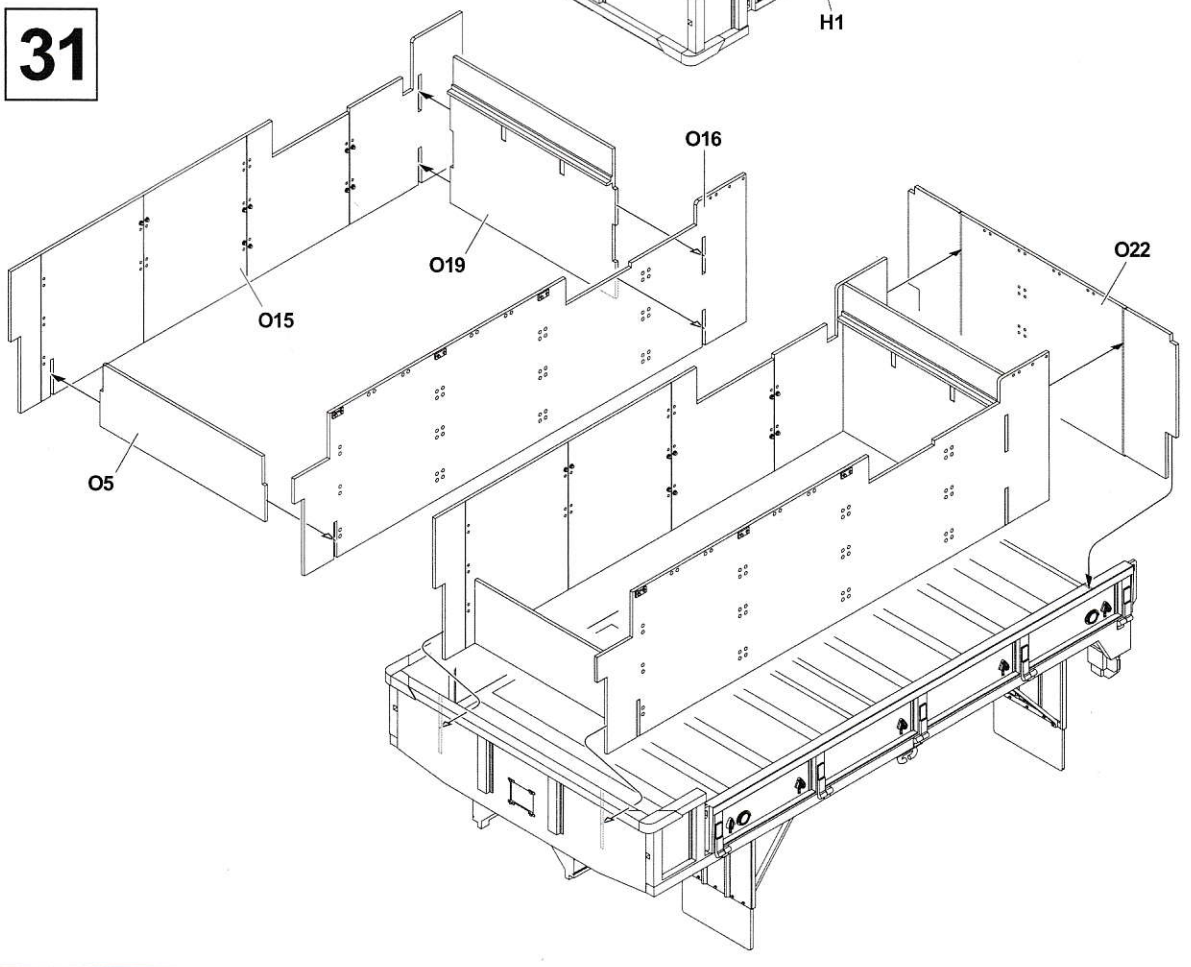

32

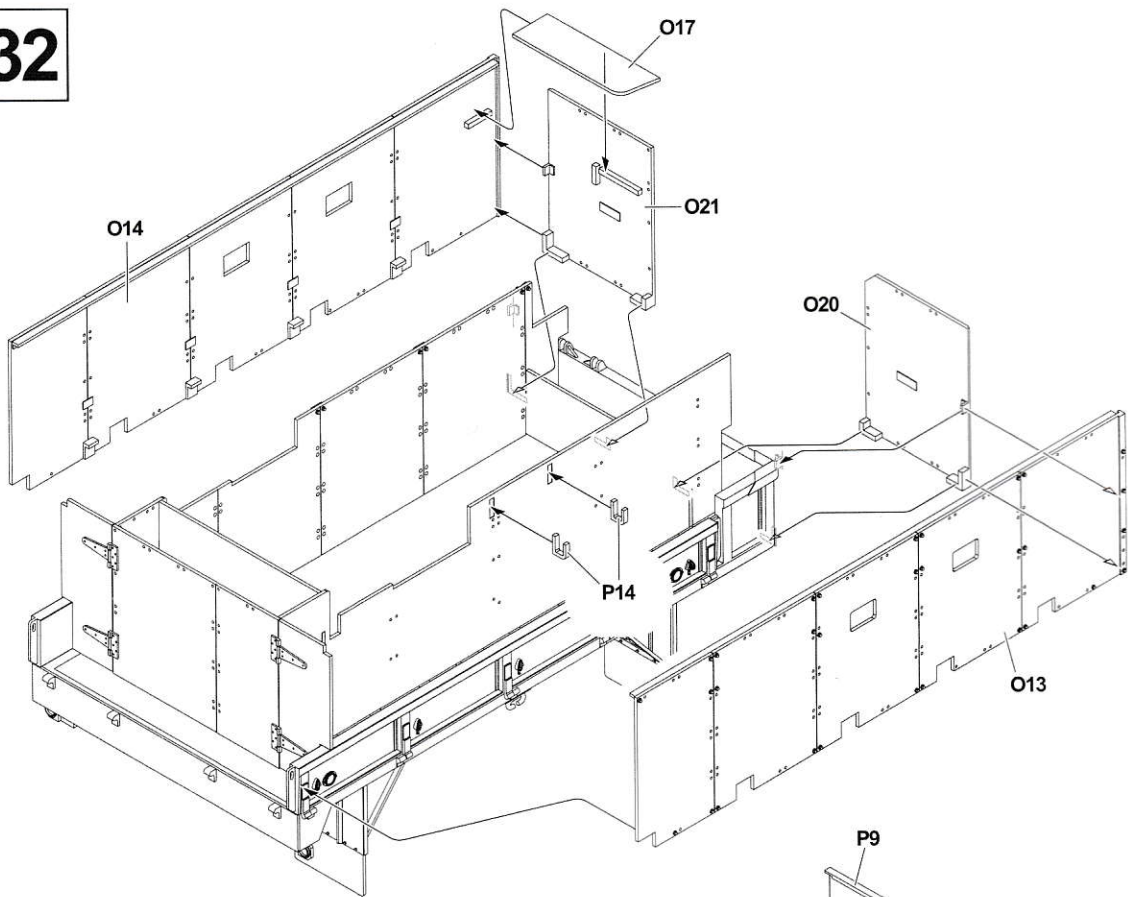

33

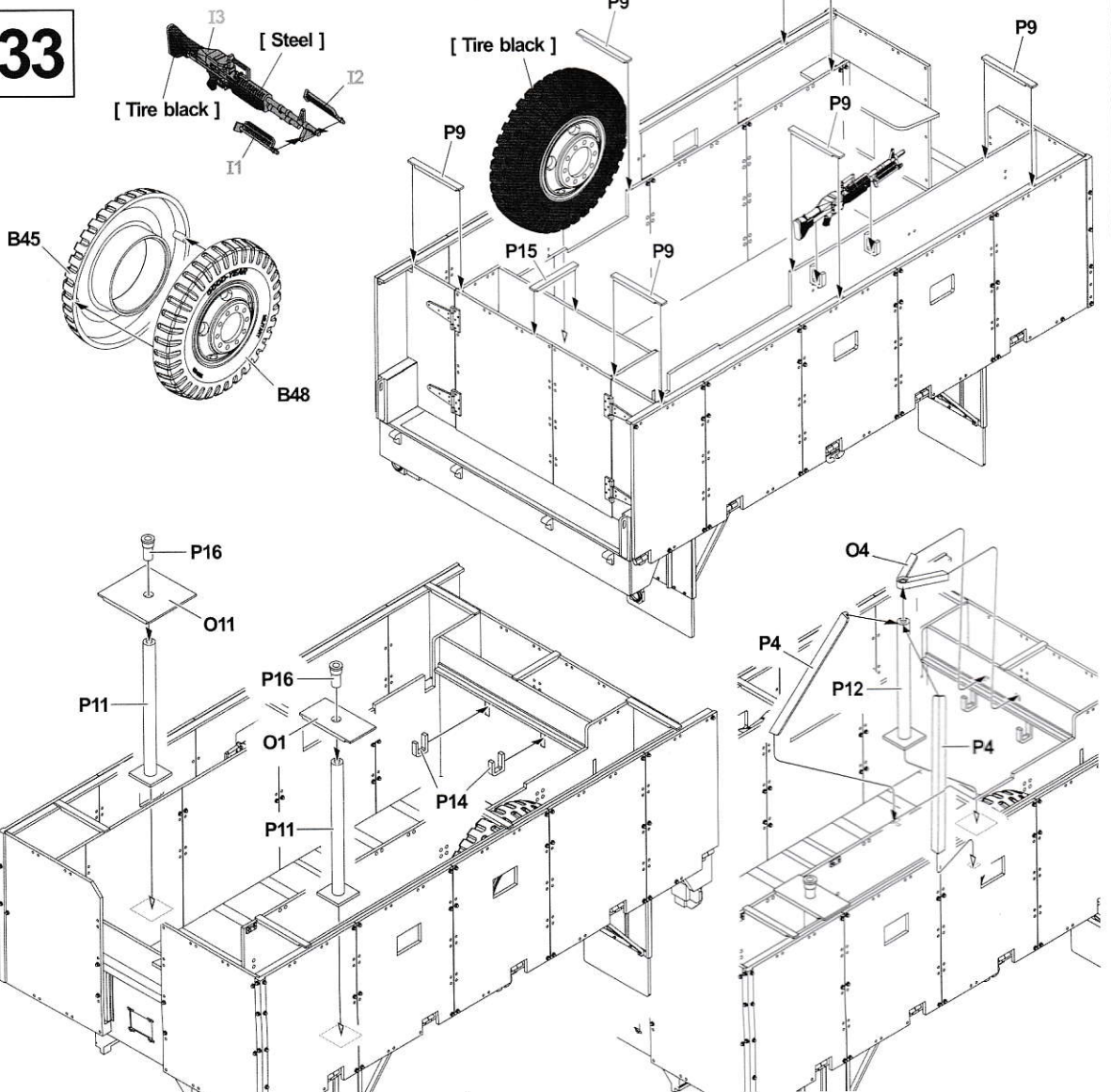

34

Cal.30 ammunition box

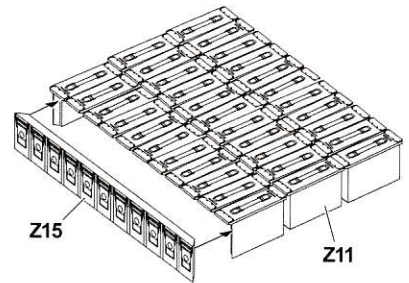
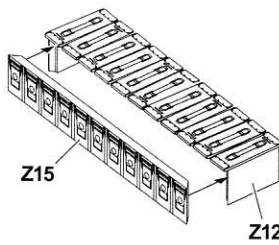
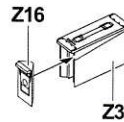

Cal.50 ammunition box

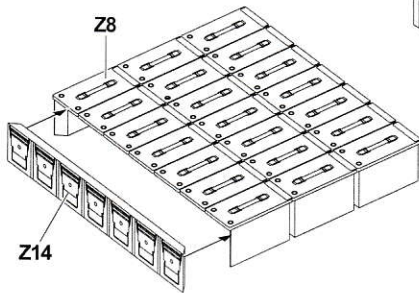
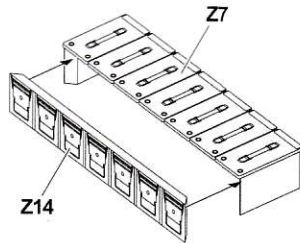
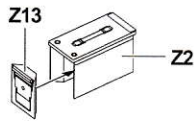

[ Olive drab FS34087 ]

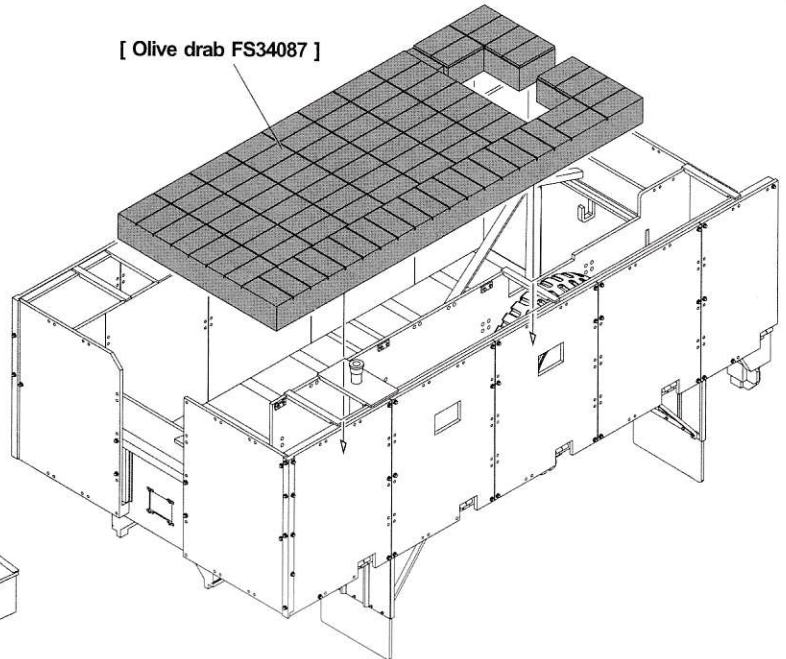

35

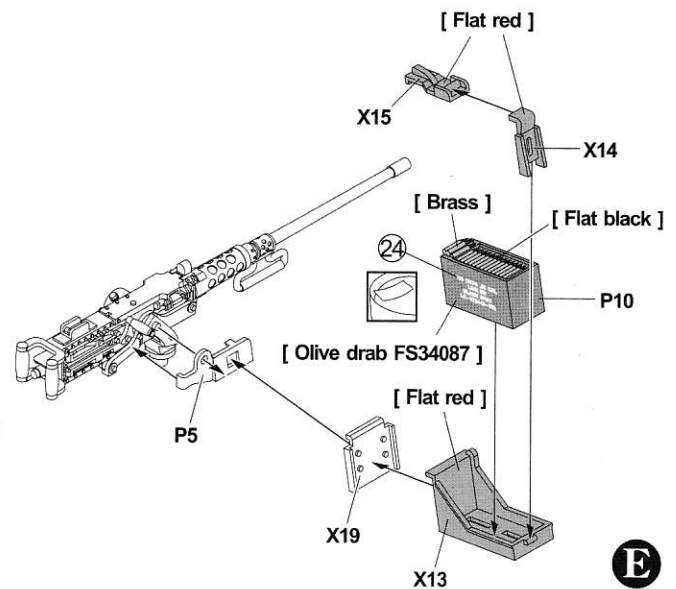
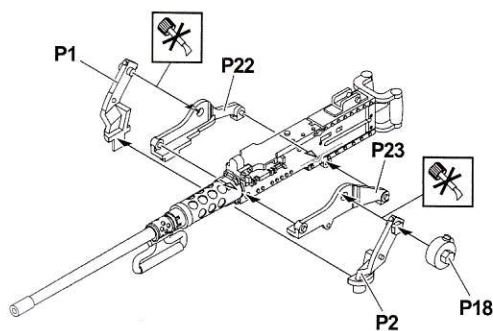
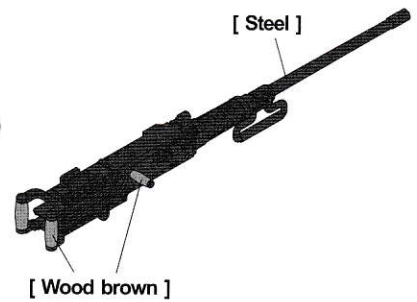
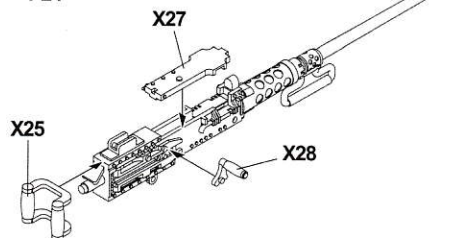
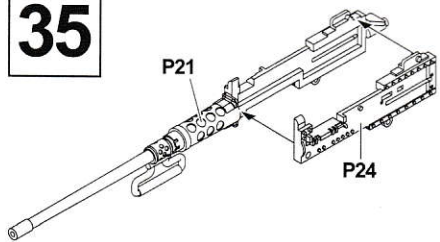

**36**

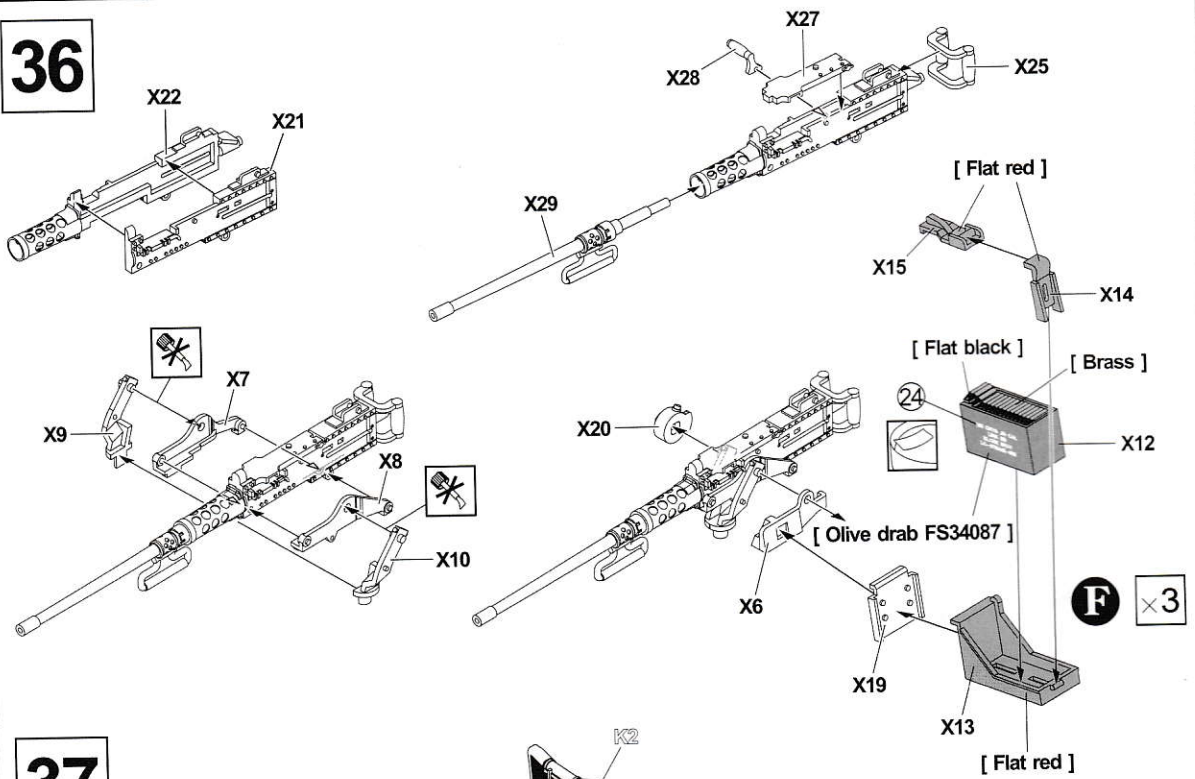

**37**

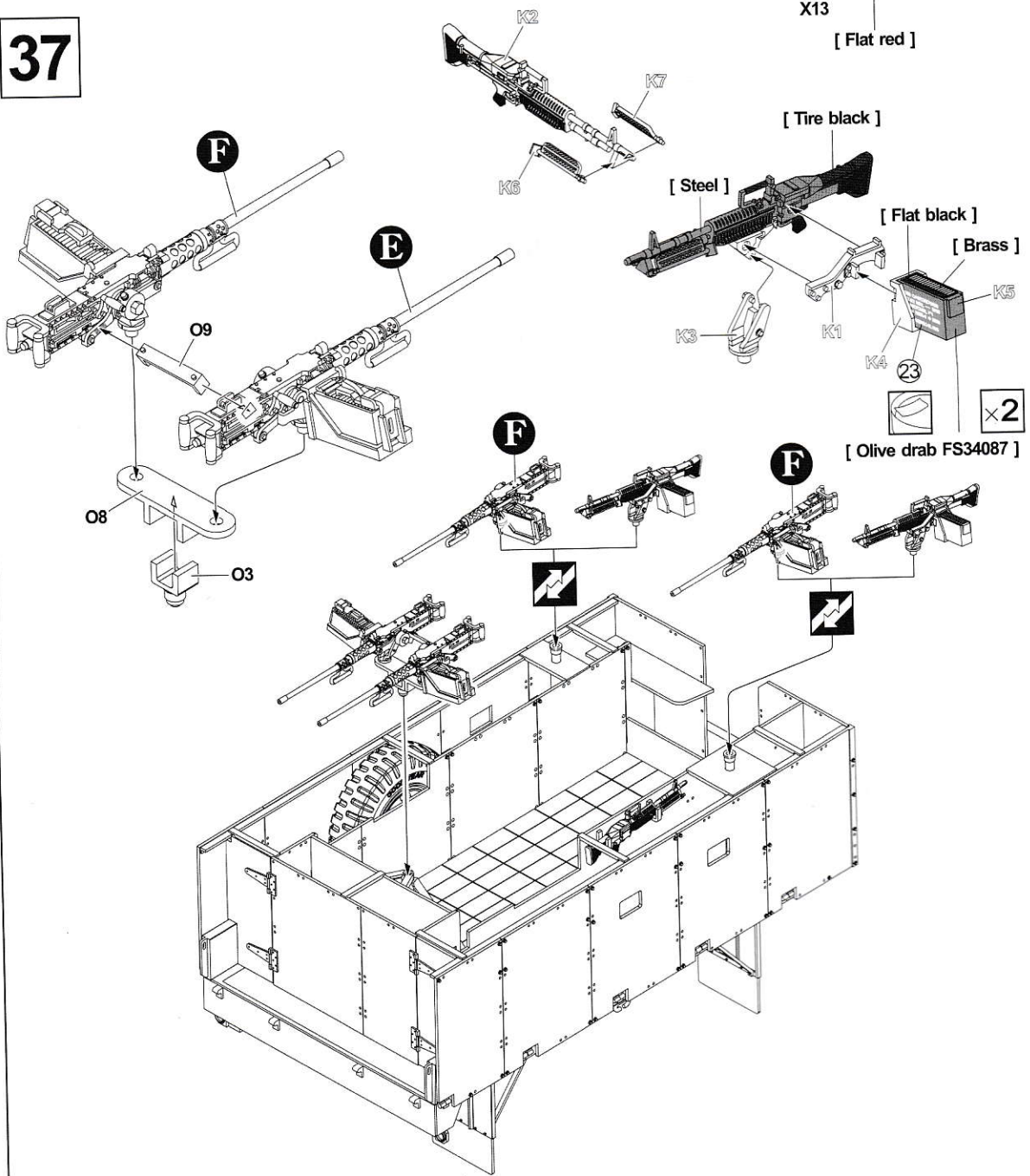



38

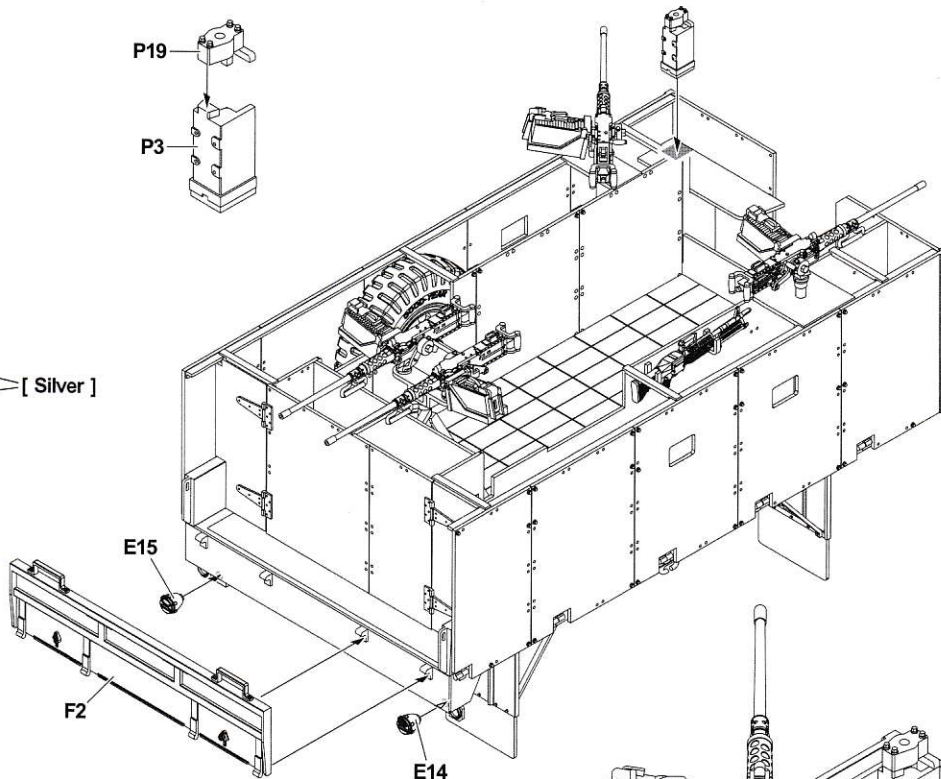
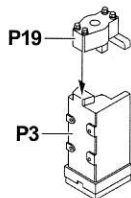
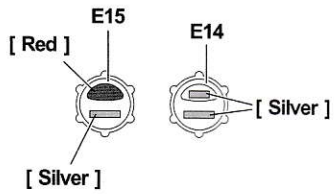

39

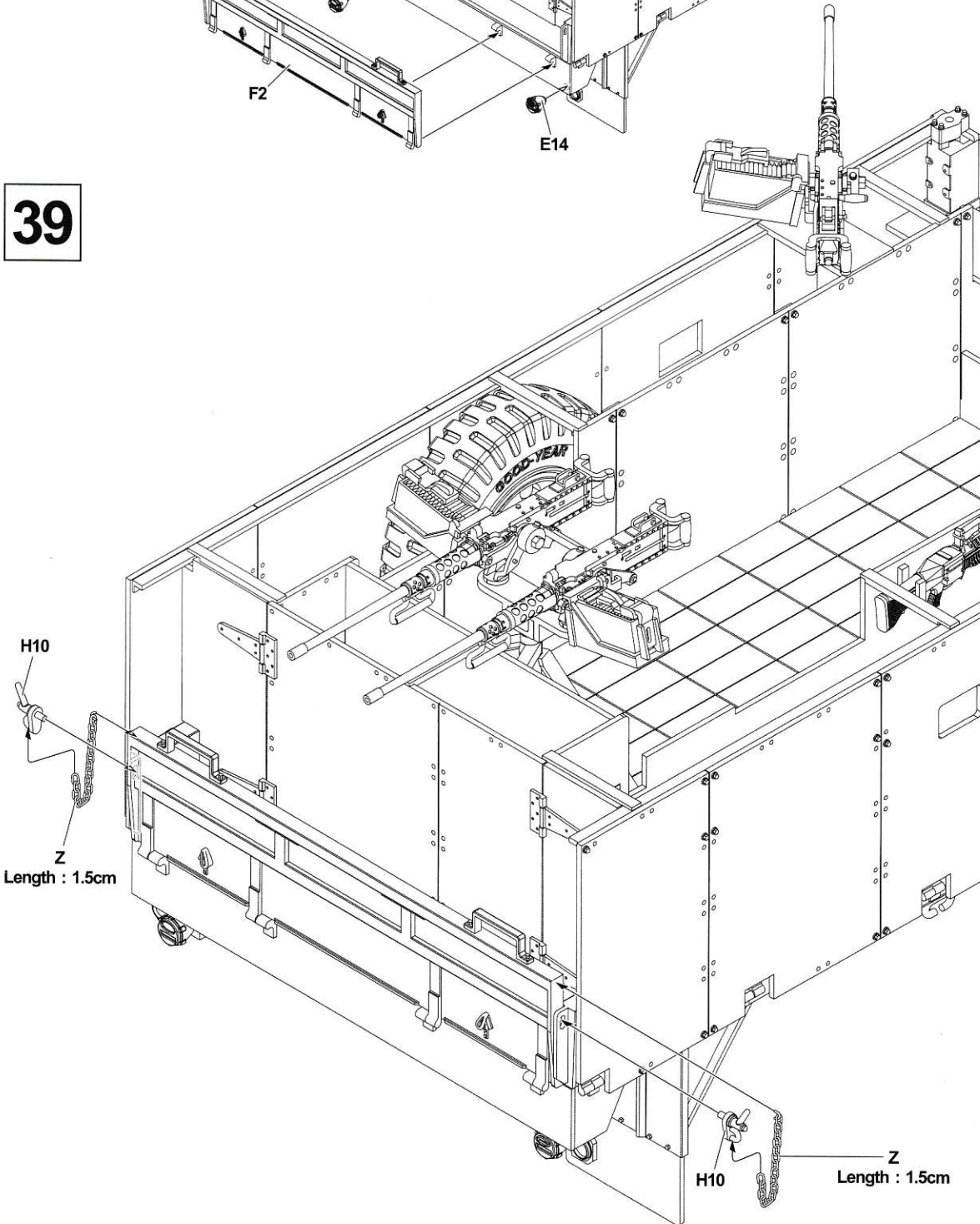
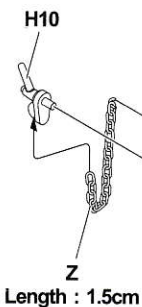

40

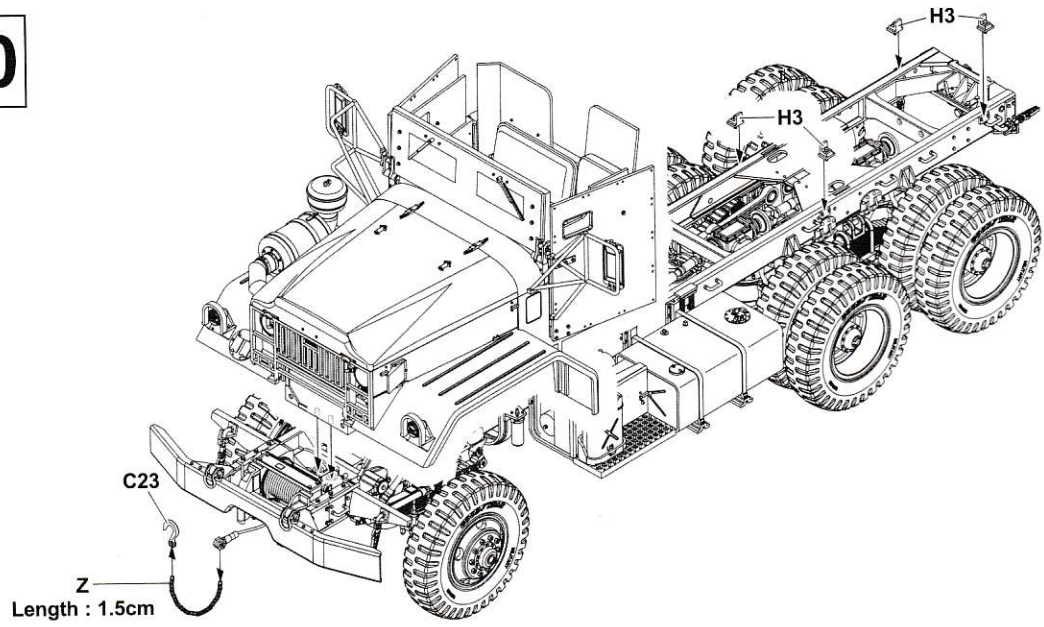

41

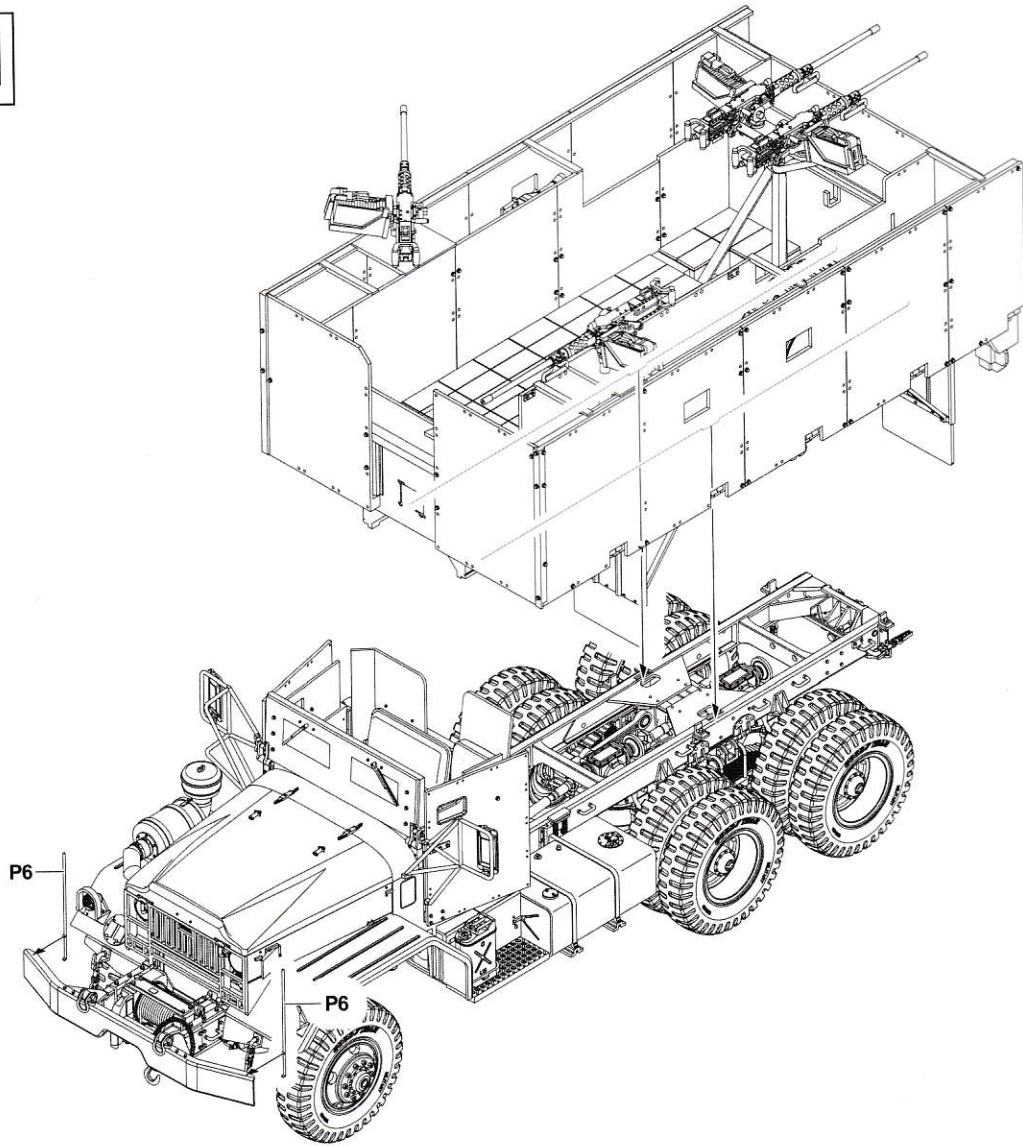

42

《 US Mermite Insulated Food Container 》  
 《 美國軍用保溫箱 》

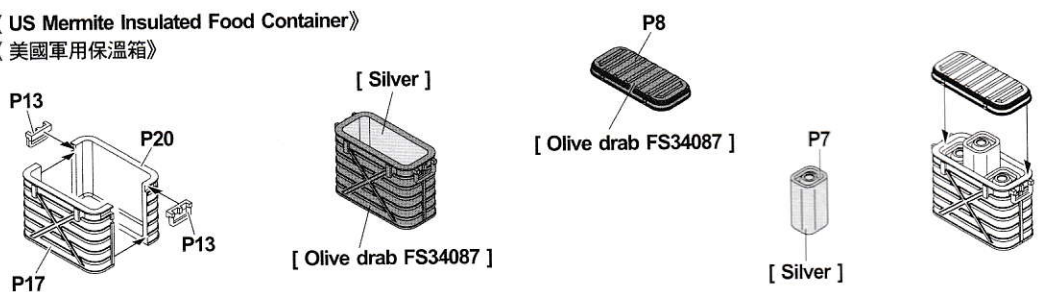

# PARTS LIST 零件表

**A X1** AF 35300

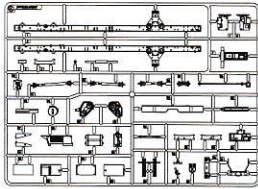

**B X2** AF 35300

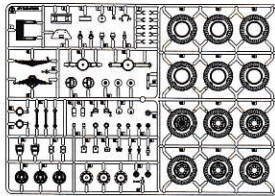

**C X1** AF 35300

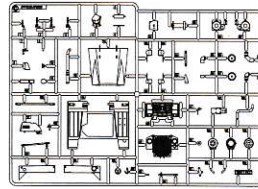

**D X1** AF 35300

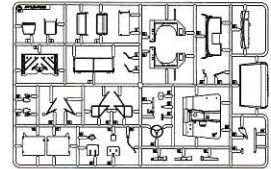

**E X2** AF 35300

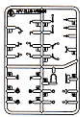

**F X1** AF 35300

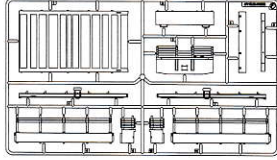

**Z X4** AF 35035

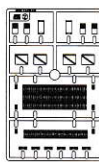

**O X1** AF 35327

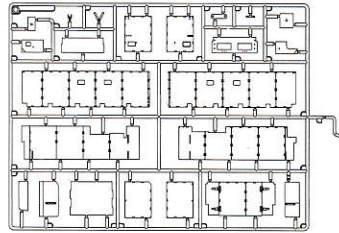

**P X2** AF 35327

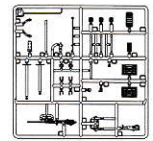

**Q X1** AF 35327

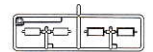

**F X1** AF 35S15



**G X1** AF 35300



**I X1** AF 35300

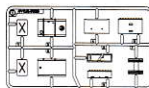

**I X1** AF 35S15



**I X1** AF 35113

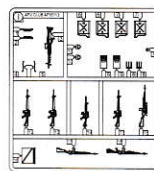

**J X1** AF 35327



**K X1** AF 35300

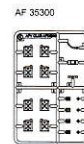

**K X2** AF 35042

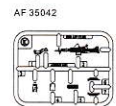

**H X2** AF 35300

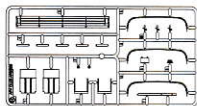

**N X1** AF 35300

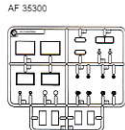

**X X4** AF 35246

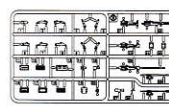

**Z X1** AF 35304



## Instructions:

If for some reason, you are not fully satisfied or have questions concerning our product; Please use the form provide, and send it to our nearest representative or mail it directly to our office.

We will deal with that A.S.A.P.



## AF 35327 Parts Replacement Form

- |                                     |                                     |                                     |
|-------------------------------------|-------------------------------------|-------------------------------------|
| <input type="checkbox"/> AF 35300-A | <input type="checkbox"/> AF 35300-H | <input type="checkbox"/> AF 35300-N |
| <input type="checkbox"/> AF 35300-B | <input type="checkbox"/> AF 35300-I | <input type="checkbox"/> AF 35327-O |
| <input type="checkbox"/> AF 35300-C | <input type="checkbox"/> AF 35113-I | <input type="checkbox"/> AF 35327-P |
| <input type="checkbox"/> AF 35300-D | <input type="checkbox"/> AF 35S15-I | <input type="checkbox"/> AF 35327-Q |
| <input type="checkbox"/> AF 35300-E | <input type="checkbox"/> AF 35327-J | <input type="checkbox"/> AF 35246-X |
| <input type="checkbox"/> AF 35300-F | <input type="checkbox"/> AF 35300-K | <input type="checkbox"/> AF 35304-Z |
| <input type="checkbox"/> AF 35S15-F | <input type="checkbox"/> AF 35042-K | <input type="checkbox"/> AF 35035-Z |
| <input type="checkbox"/> AF 35300-G |                                     |                                     |

Reason for replacement:  Missing

Signature: \_\_\_\_\_

Broken

限臺灣地區使用 For Taiwanese use only!



## AF 35327 零件補充申請表

申請人  
姓名 地址 電話

- |                                     |          |
|-------------------------------------|----------|
| <input type="checkbox"/> AF 35300-A | NT\$ 200 |
| <input type="checkbox"/> AF 35300-B | NT\$ 360 |
| <input type="checkbox"/> AF 35300-C | NT\$ 180 |
| <input type="checkbox"/> AF 35300-D | NT\$ 180 |
| <input type="checkbox"/> AF 35300-E | NT\$ 200 |
| <input type="checkbox"/> AF 35300-F | NT\$ 150 |
| <input type="checkbox"/> AF 35S15-F | NT\$ 80  |
| <input type="checkbox"/> AF 35300-G | NT\$ 280 |
| <input type="checkbox"/> AF 35300-H | NT\$ 240 |
| <input type="checkbox"/> AF 35300-I | NT\$ 120 |
| <input type="checkbox"/> AF 35113-I | NT\$ 140 |
| <input type="checkbox"/> AF 35S15-I | NT\$ 80  |
| <input type="checkbox"/> AF 35327-J | NT\$ 160 |
| <input type="checkbox"/> AF 35300-K | NT\$ 120 |
| <input type="checkbox"/> AF 35042-K | NT\$ 240 |
| <input type="checkbox"/> AF 35300-N | NT\$ 150 |
| <input type="checkbox"/> AF 35327-O | NT\$ 280 |
| <input type="checkbox"/> AF 35327-P | NT\$ 320 |
| <input type="checkbox"/> AF 35327-Q | NT\$ 150 |
| <input type="checkbox"/> AF 35246-X | NT\$ 720 |
| <input type="checkbox"/> AF 35304-Z | NT\$ 100 |
| <input type="checkbox"/> AF 35035-Z | NT\$ 260 |

+郵寄費 \_\_\_\_\_ NT\$ 80

(請填)總計NT\$ \_\_\_\_\_

零件補充原因: (請於  打 )

原包裝即  遺失或  毀損,

製作途中  遺失或  毀損,

其他原因 \_\_\_\_\_

總代理戰鷹企業有限公司收本公司將儘速為您處理。  
請將本表與該部品相同金額之郵政匯票一同寄至。



Body Color: Flat black

Flat red

Flat white

