

# U.S. MAIN BATTLE TANK

## M1A1 TUSK

# M1A2 SEP ABRAMS TUSK I/ M1A2 SEP ABRAMS TUSK II



RM-5004

The main instruction of this manual is for M1A2 SEP ABRAMS TUSK II. M1A2 SEP ABRAMS TUSK I and M1A1 TUSK are options. The green lines used for M1A1 TUSK, please read the instruction manual carefully before assembly.

本产品组装说明书主体型号为M1A2 SEP ABRAMS TUSK II，M1A2 SEP ABRAMS TUSK I 和M1A1 TUSK为选装，M1A1 TUSK用绿色区分，请在组装前仔细阅读说明书。



### Assembly Icon



OPTIONAL  
选择



CEMENT  
膠水



DO NOT CEMENT  
不使用膠水



INSTANT CEMENT  
瞬間接著劑



BEND  
彎折



MAKE 2pcs  
製作2組



OPEN HOLE  
鑽孔



CAT  
切除



BE CAREFUL  
注意



APPLY DECAL  
貼上水貼紙



Read carefully and fully understand the instructions before commencing assembly. Supervising adult should also read the instructions if a child assembles the model. When you used glue or paint, do not use near a naked flame, and use in a well-ventilated room. When assembling this kit, tools including knives are used. Extra care should be taken to avoid personal injury. Read and follow the instructions supplied with paints and/ or cement. Use plastic cement and paints only. Keep out of reach of small children. Children must not be allowed to suck any part, or pull vinyl bag over the head.

在裝配前仔細閱讀說明並完全理解。小孩裝配時需成人看護且需仔細閱讀說明。  
使用膠水和油漆時，應遠離火源並打開窗戶保持空氣流通。  
製作時請格外注意工具刀和零件的鋒利尖銳部分，避免對身體造成傷害。  
在使用膠水和油漆前仔細閱讀注意事項，按照說明正確使用膠水和油漆。  
請將本品放在兒童接觸不到的地方，套件中的塑膠包裝袋會對兒童造成窒息的危險。



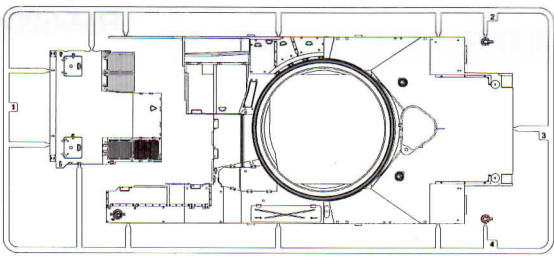

E x 1

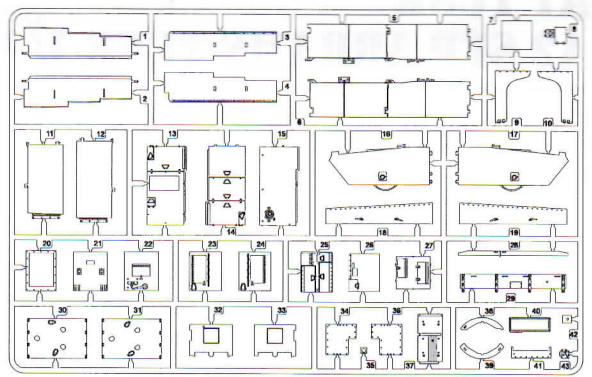
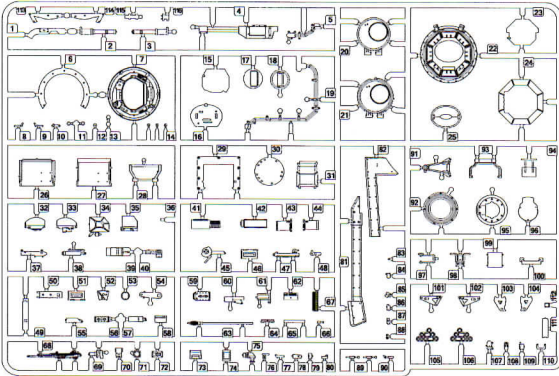

D x 1

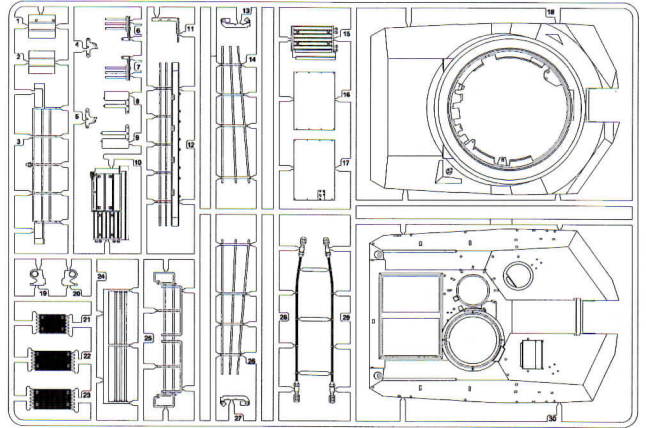

J x 1

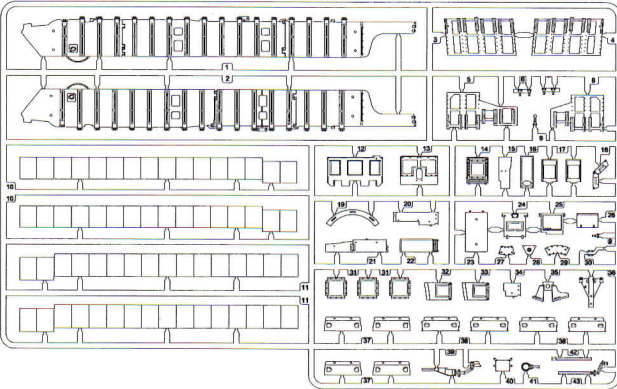

F x 1

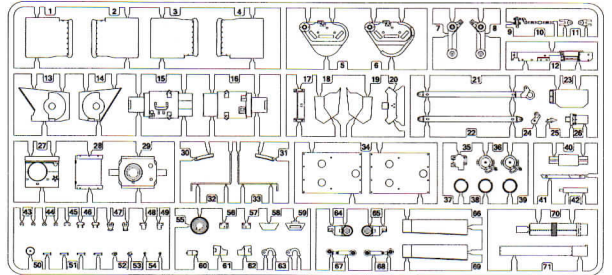

C x 2

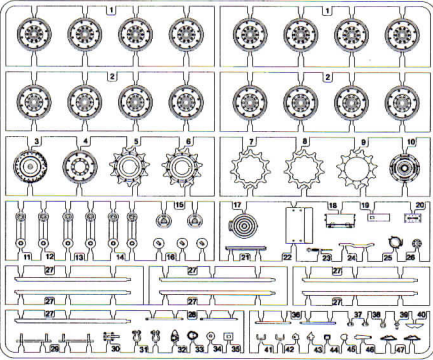

Lower Hull x 1

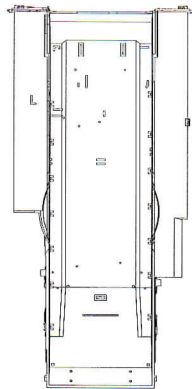

K x 1

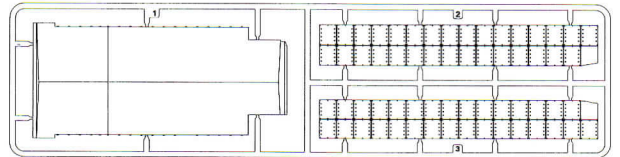

Tracks pins x 156



Assembly boards x 2



T x 2

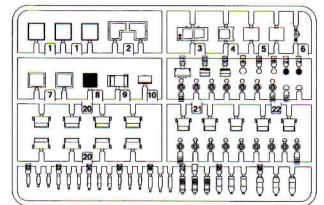

O x 2

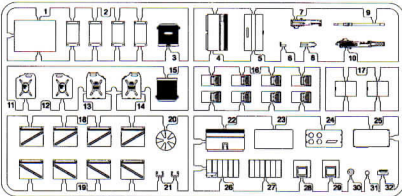

X x 6

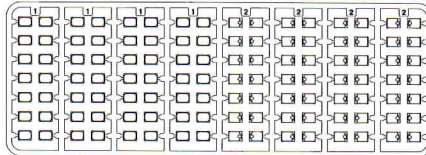

M x 2

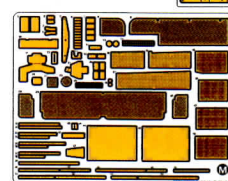

Decal x 1

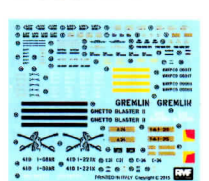

H x 1

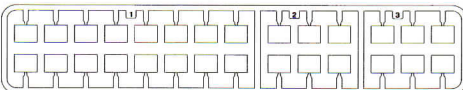

Y x 5

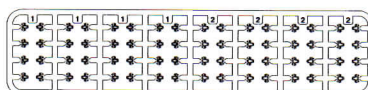



# U.S. Main Battle Tank M1A2 SEP Abrams TUSK II

## Painting and Marking Guide

Color info and profiles by



A.MIG 025 US Modern Vehicles

A.MIG 033 Rubber & Tires

A.MIG 035 Dark Tracks

A.MIG 045 Gun Metal

A.MIG 046 Matt Black

A.MIG 047 White

A.MIG 049 Red

A.MIG 084 NATO Green

A.MIG 086 Blue (RAL 5019)

1st Battalion, 22nd Infantry Regiment, 1st Brigade, 4th Infantry Division, Baghdad, July 2008

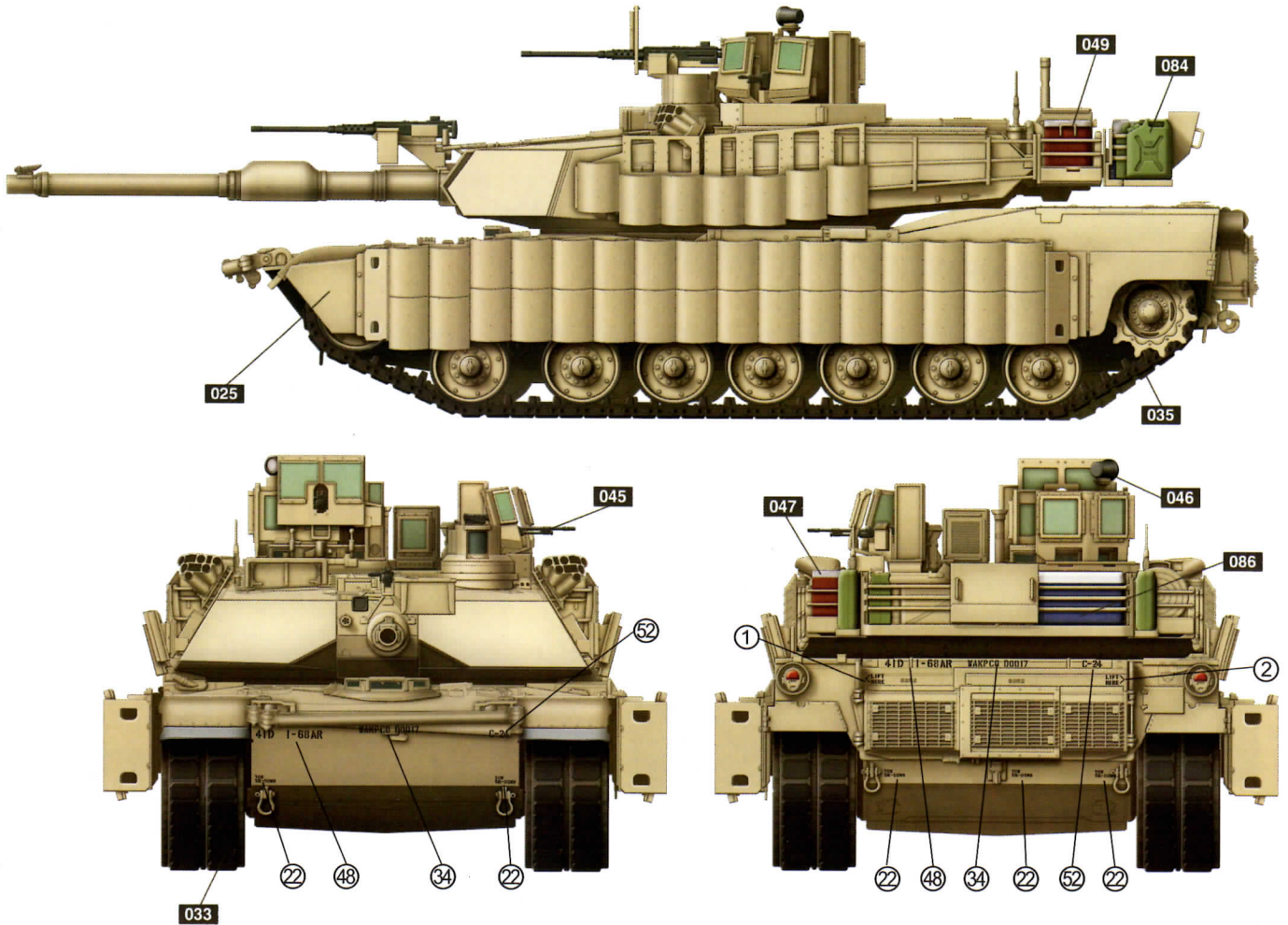





# U.S. Main Battle Tank M1A2 SEP Abrams TUSKI

## Painting and Marking Guide

Color info and profiles by



 A.MIG 025 US Modern Vehicles	 A.MIG 033 Rubber & Tires	 A.MIG 035 Dark Tracks
 A.MIG 045 Gun Metal	 A.MIG 046 Matt Black	 A.MIG 047 White
 A.MIG 049 Red	 A.MIG 084 NATO Green	 A.MIG 086 Blue (RAL 5019)

68th Armored Regiment, 1st Brigade, 4th Infantry Division, Iraq

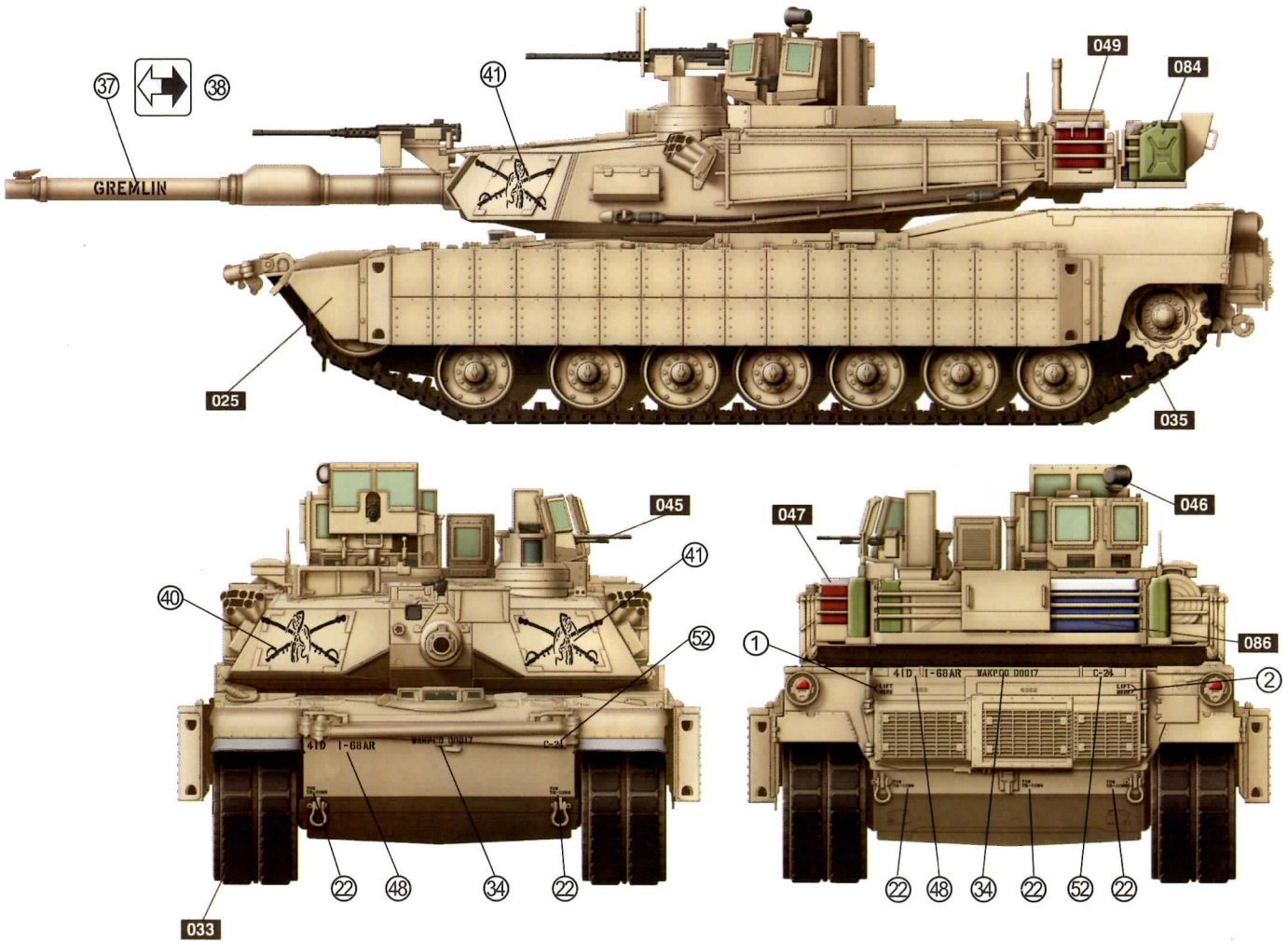





# U.S. Main Battle Tank M1A1 TUSK

## Painting and Marking Guide

Color info and profiles by



 A.MIG 025 US Modern Vehicles	 A.MIG 033 Rubber & Tires	 A.MIG 035 Dark Tracks
 A.MIG 045 Gun Metal	 A.MIG 046 Matt Black	 A.MIG 047 White
 A.MIG 049 Red	 A.MIG 084 NATO Green	 A.MIG 085 NATO Brown
 A.MIG 086 Blue (RAL 5019)		

1st Battalion, 35th Armor Regiment

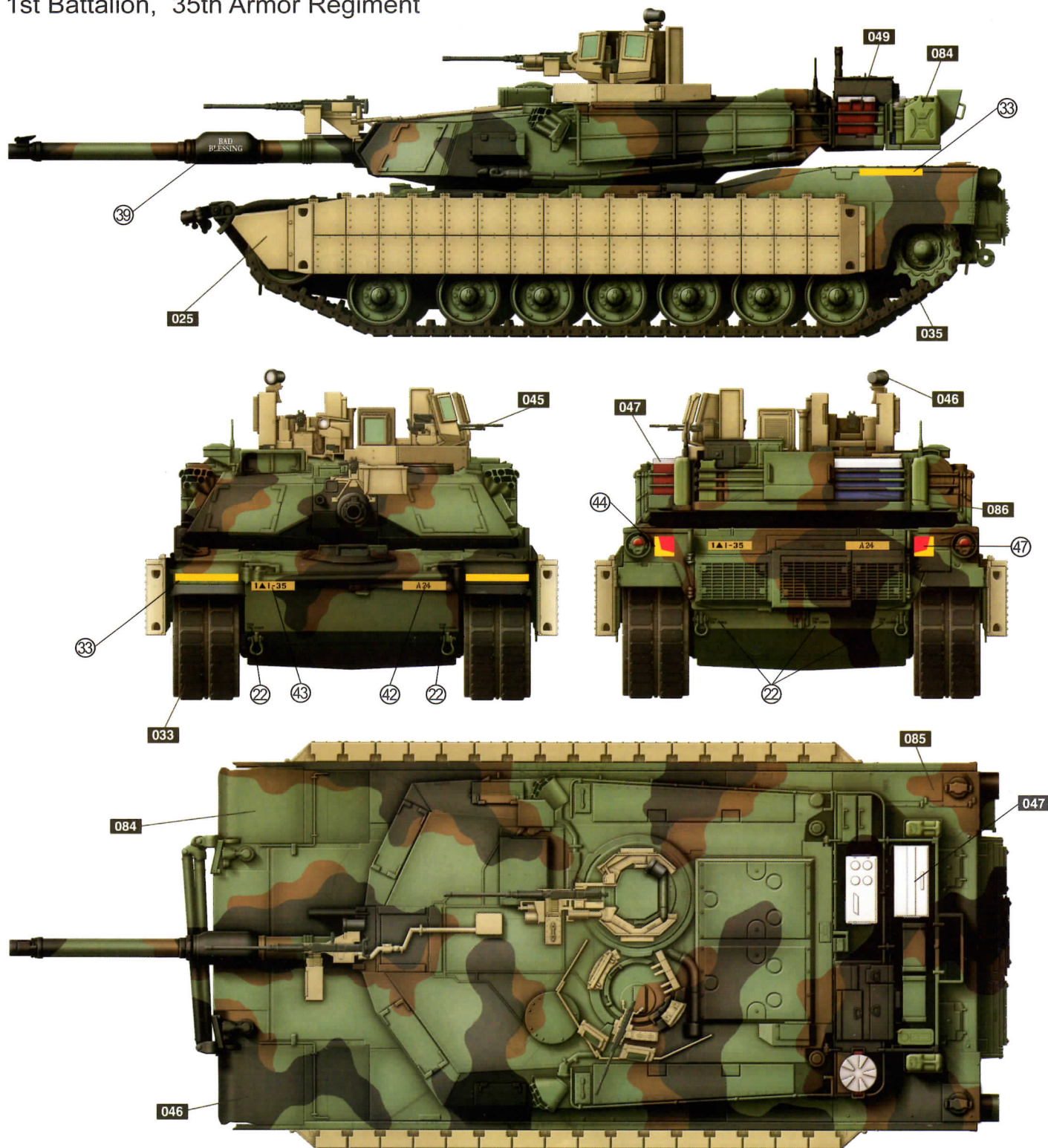

A

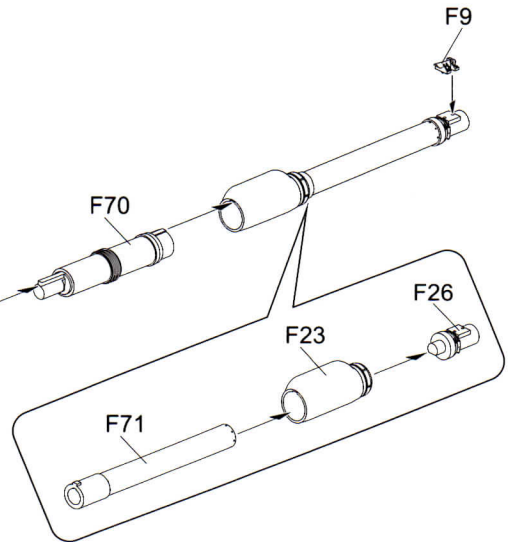
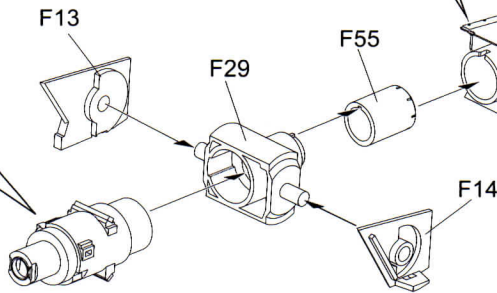
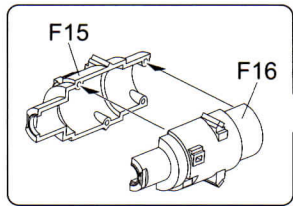
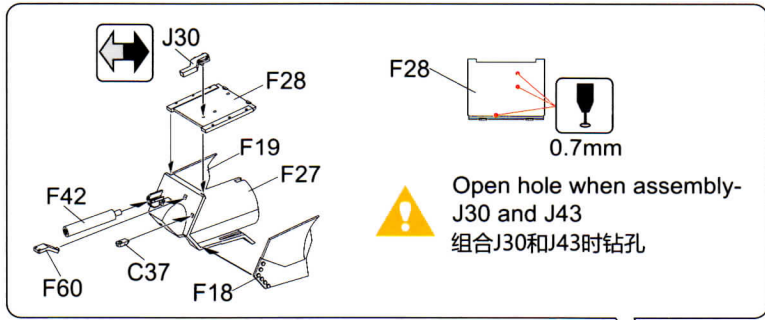

A-1

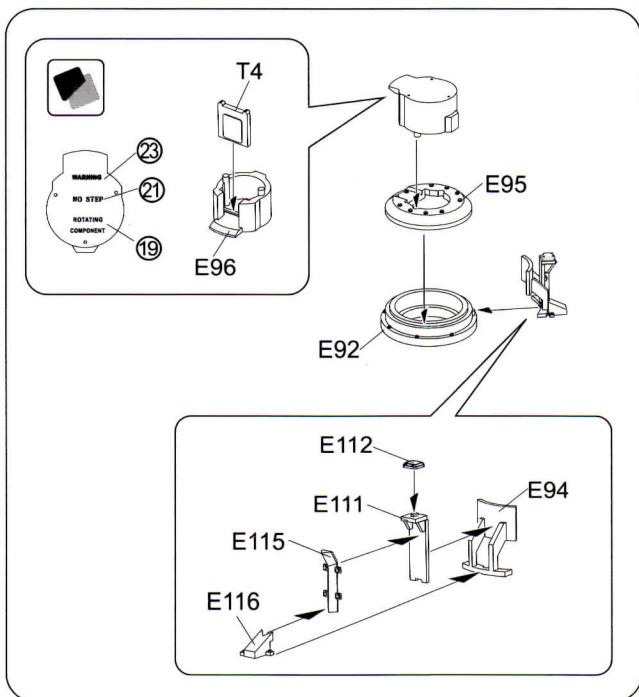
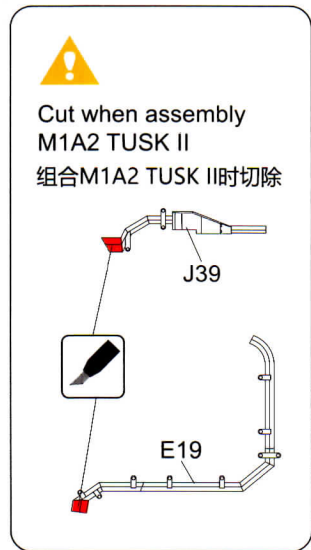
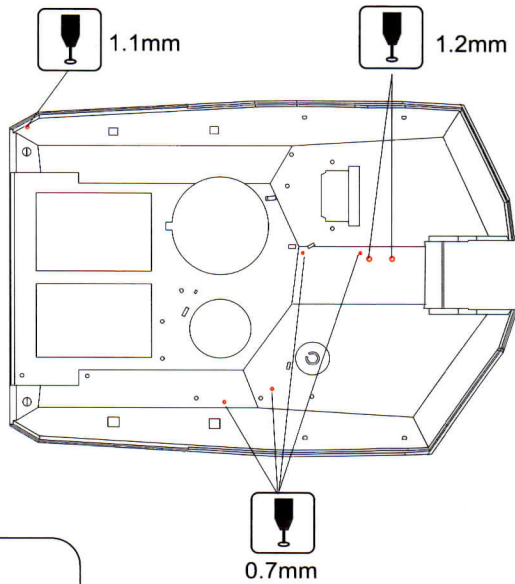
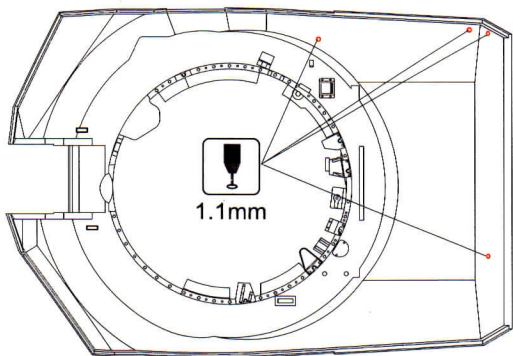

A-2

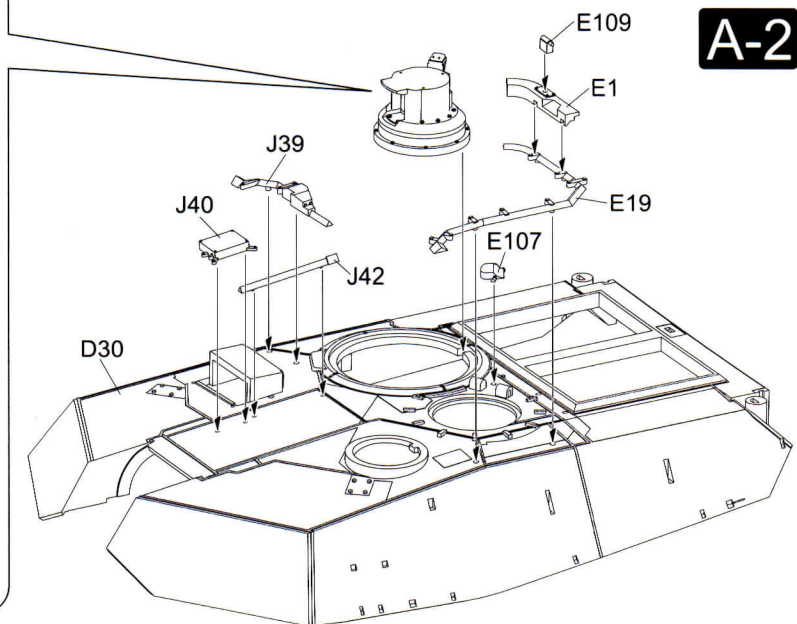



**A-3**

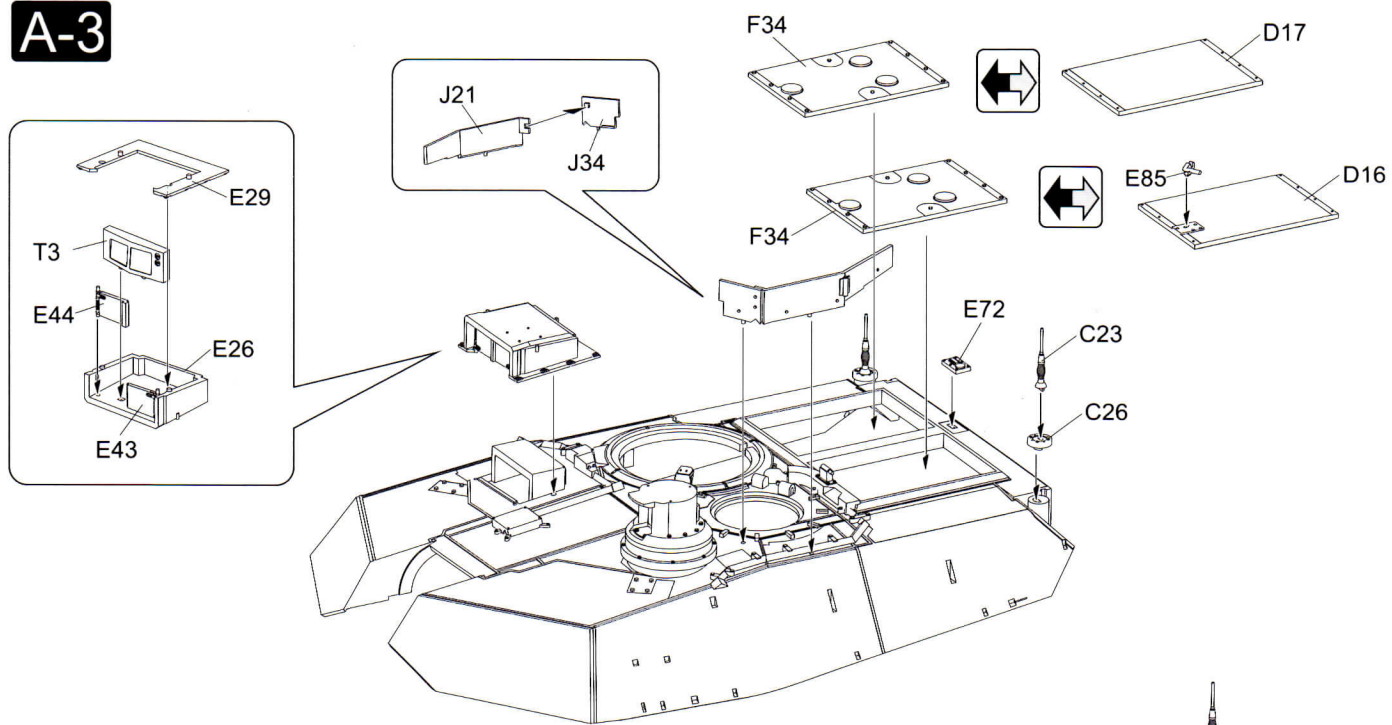

**A-4**

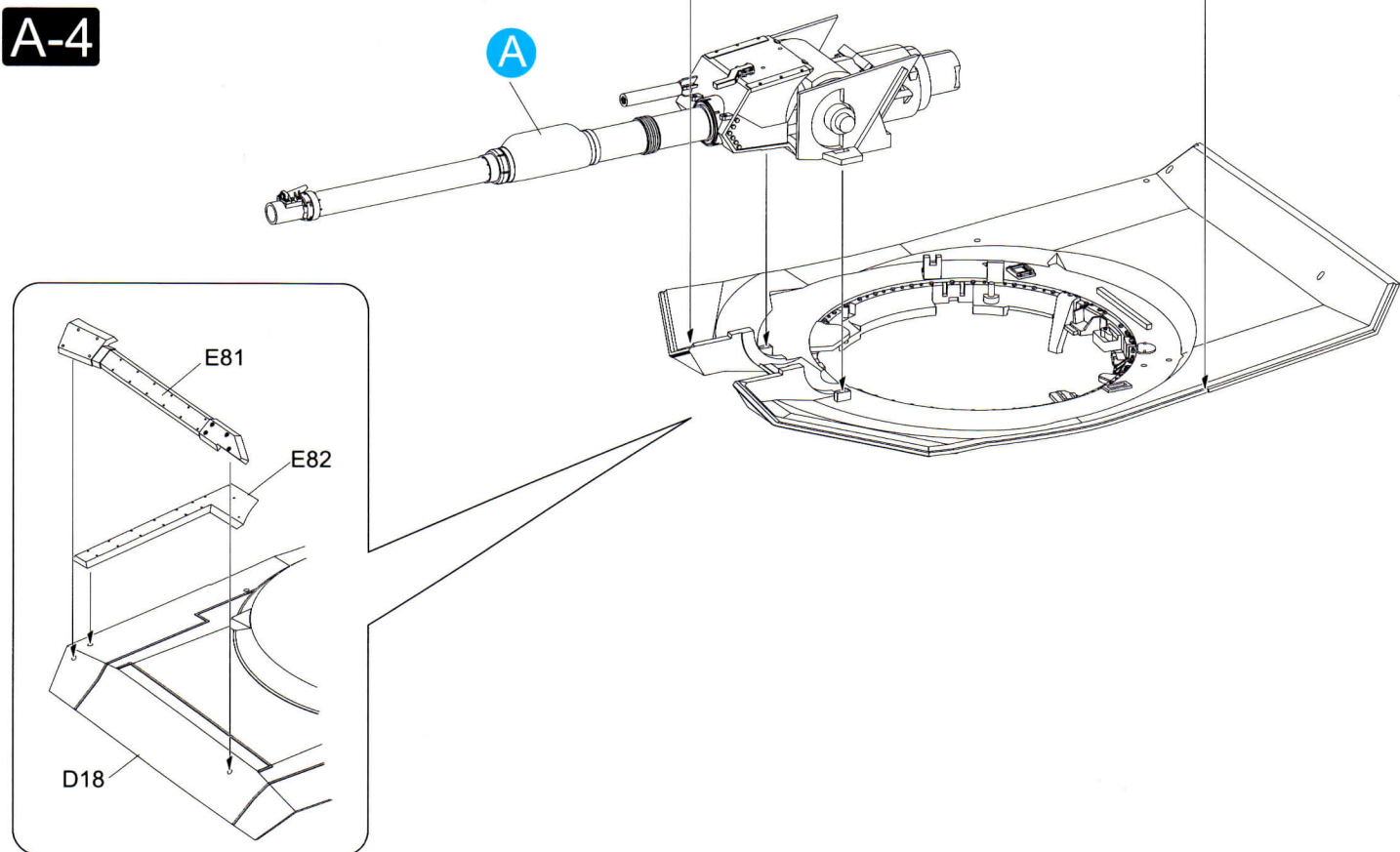

**A-5**

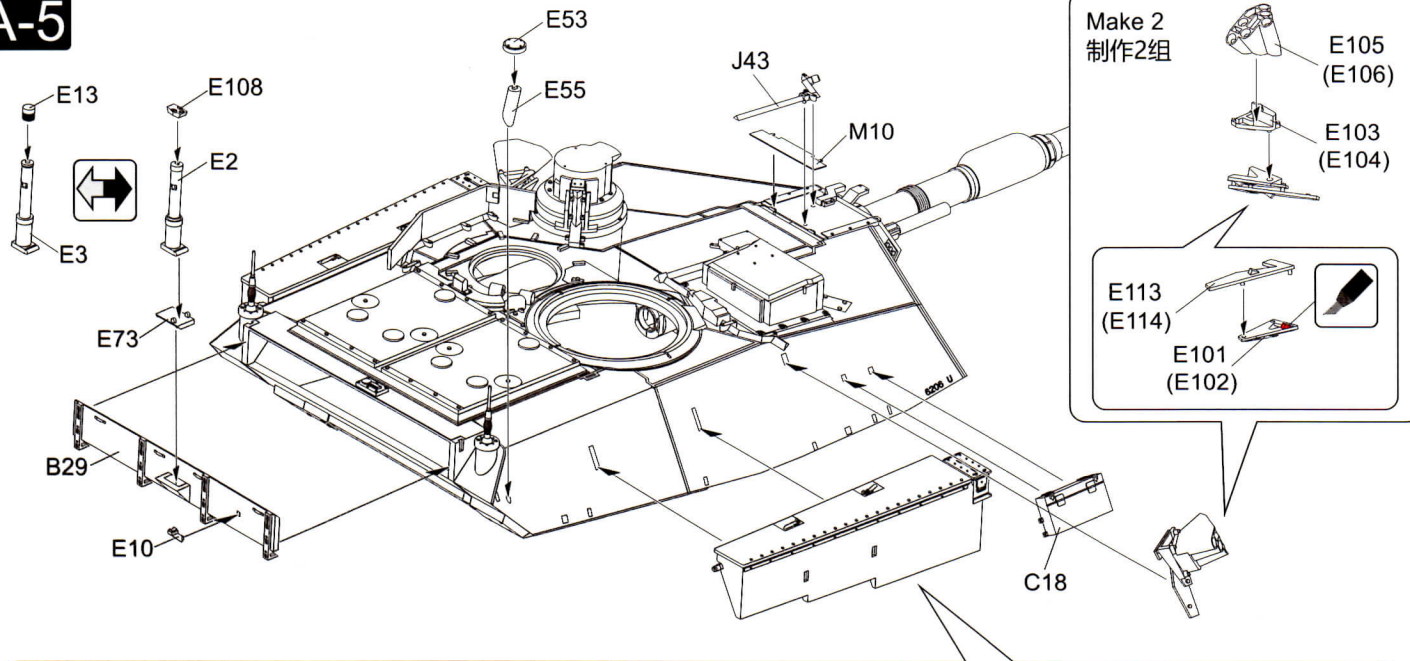

Make 2  
制作2组

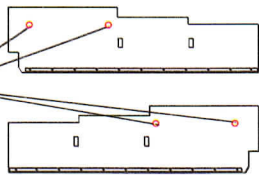

Open hold when assembly M1A2 TUSK II  
组合M1A2 TUSK II时钻孔

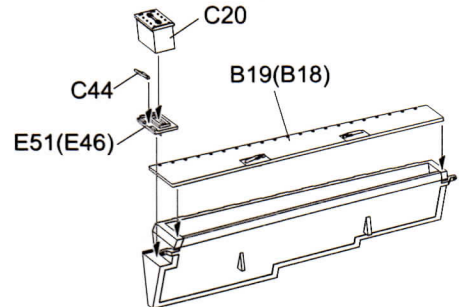
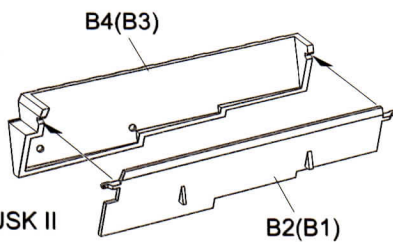

**B**

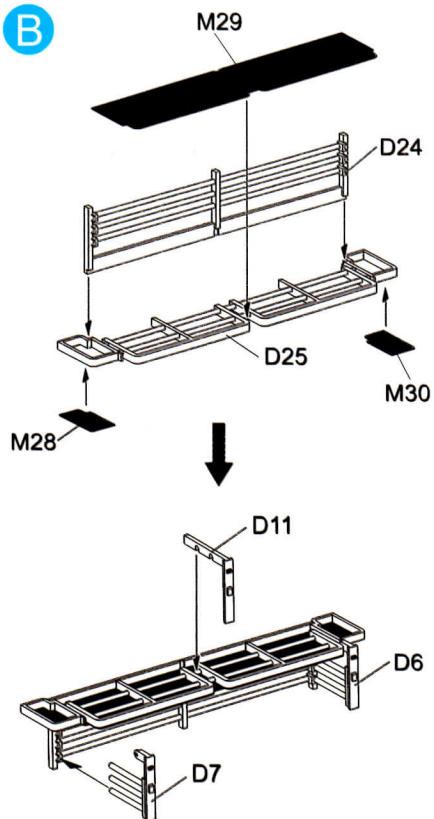

**C**

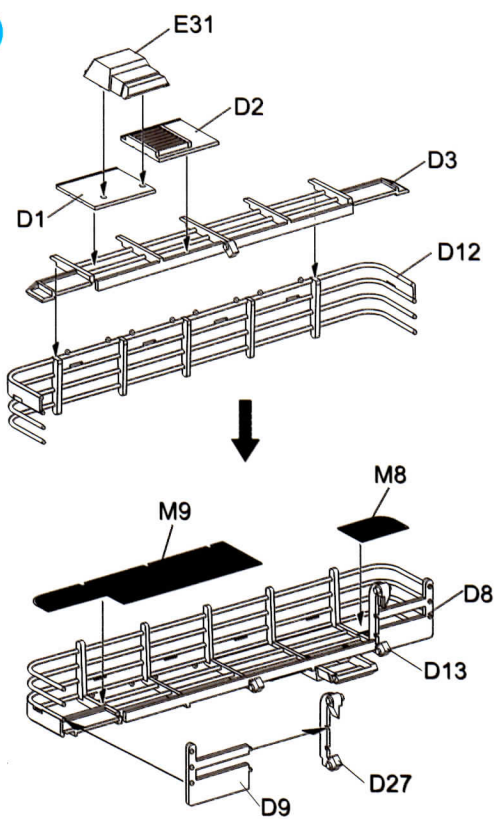



**A-6**

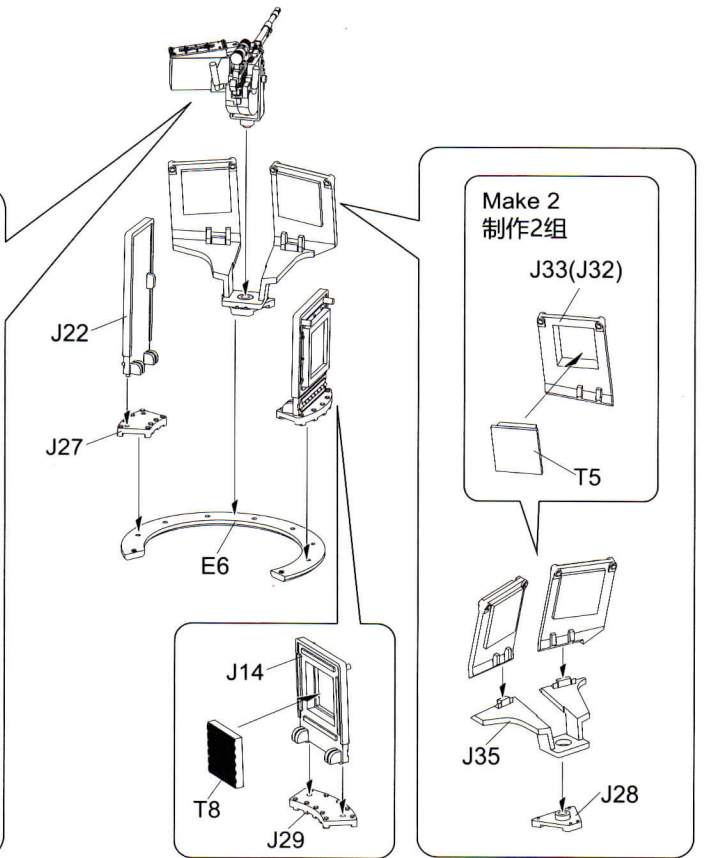
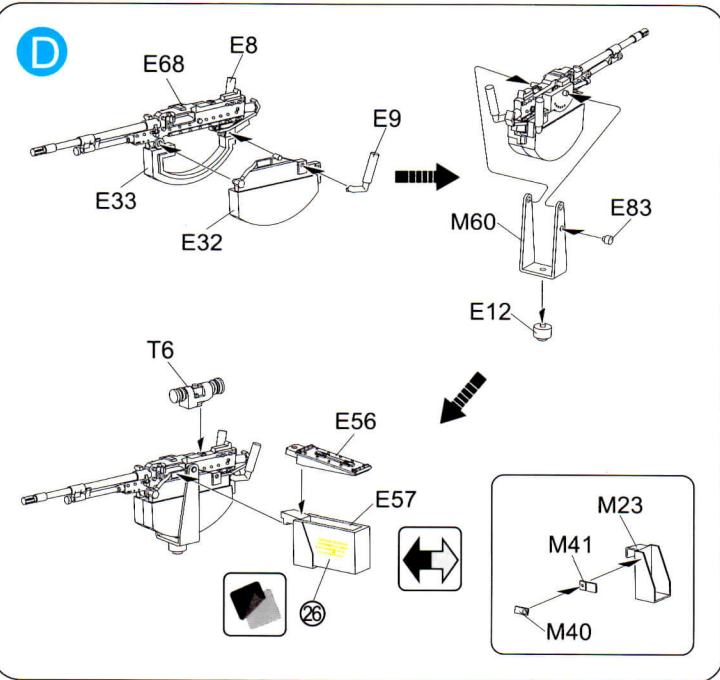
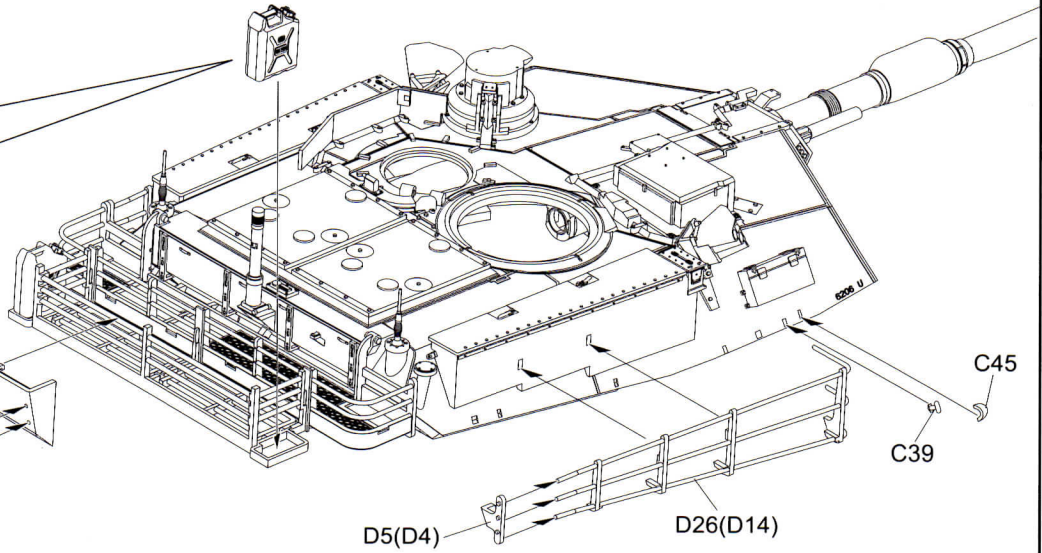
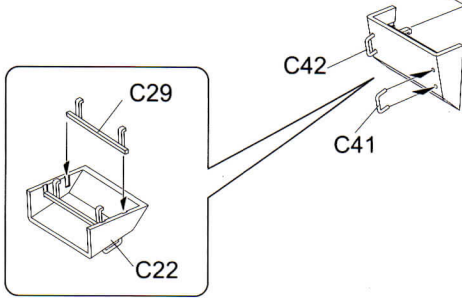
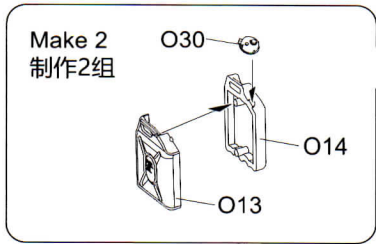
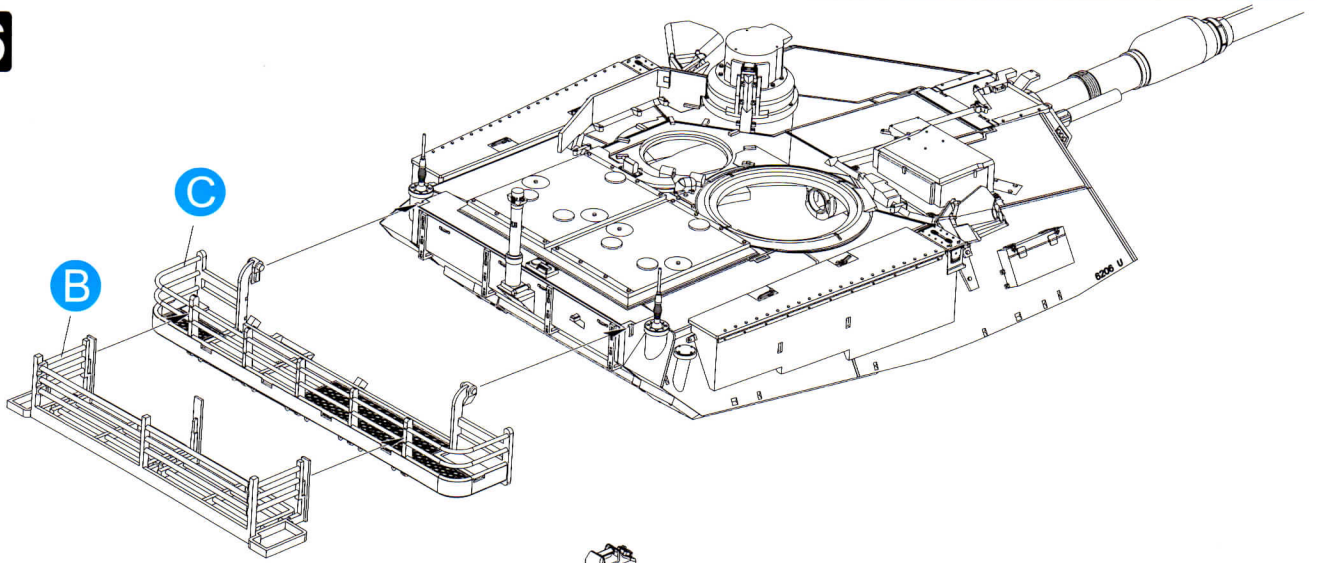

**E**

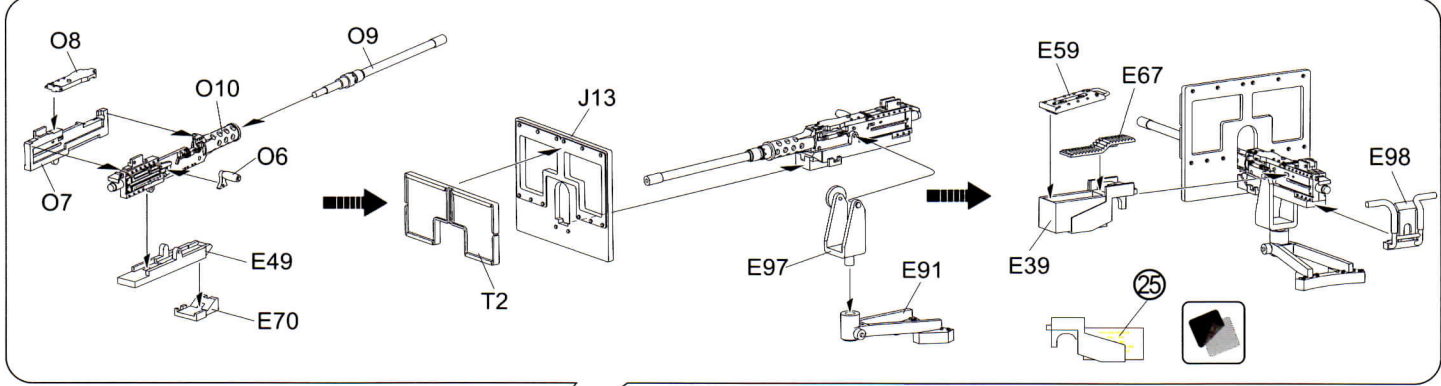
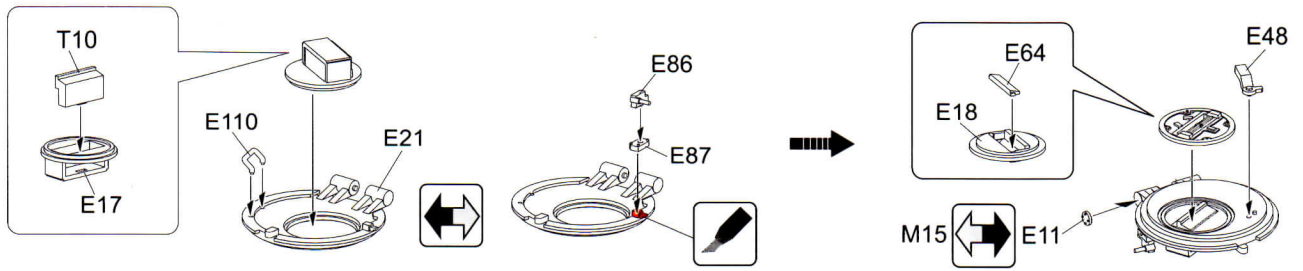

**F**

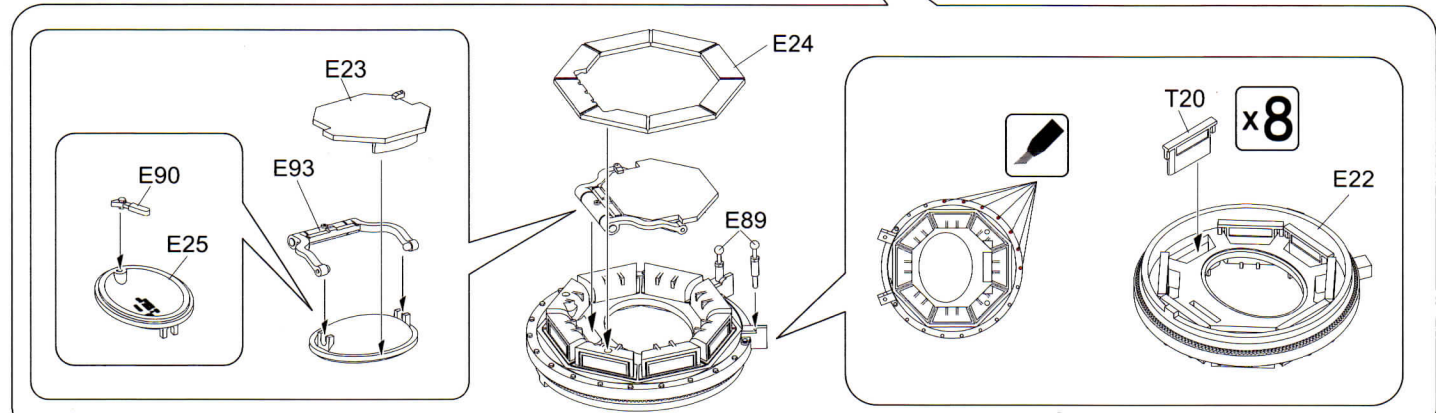
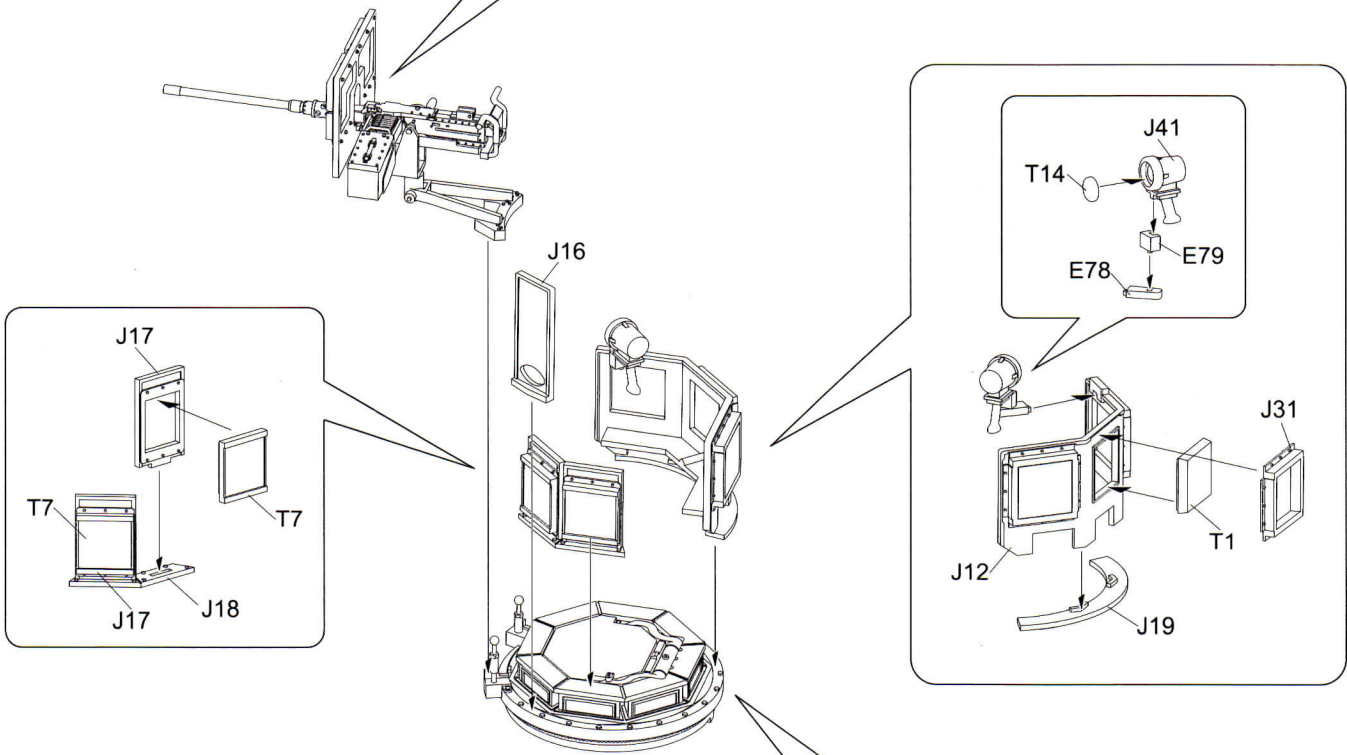



**A-7**

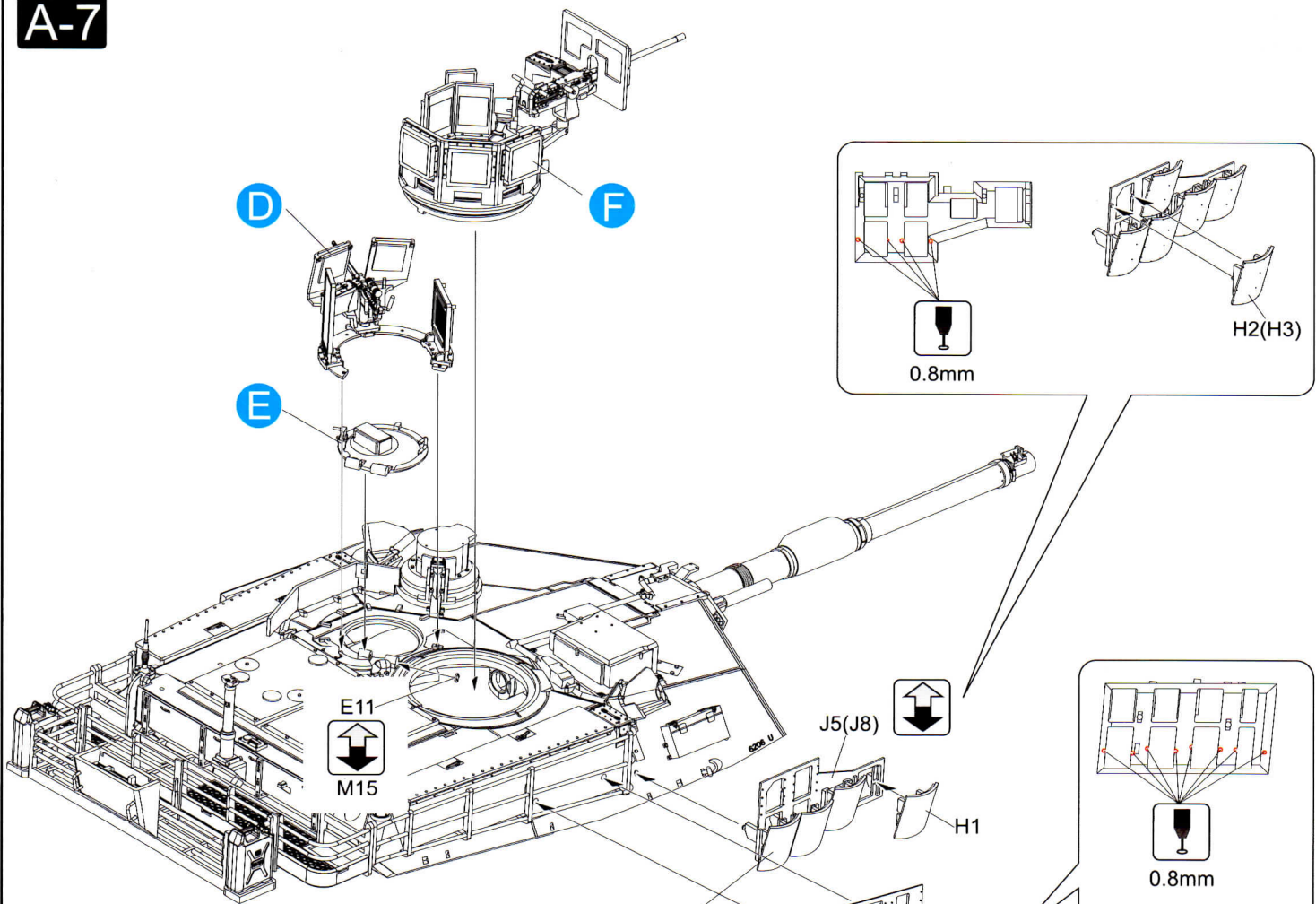

**!** M1A2 TUSK I Not Assembly  
M1A2 TUSK I 不组装

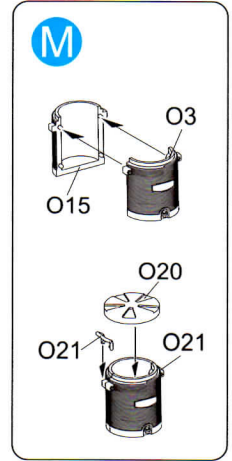
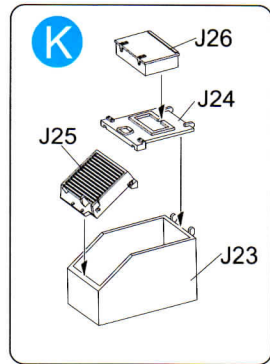
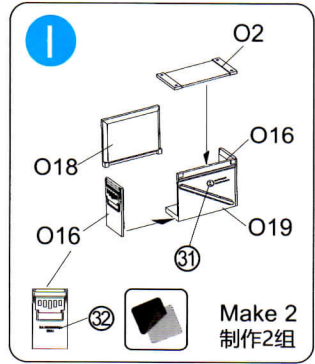
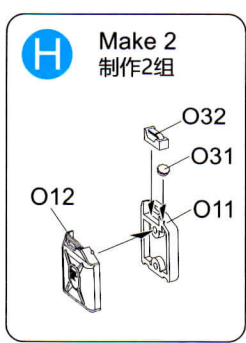
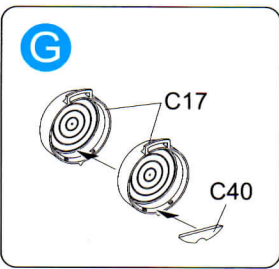
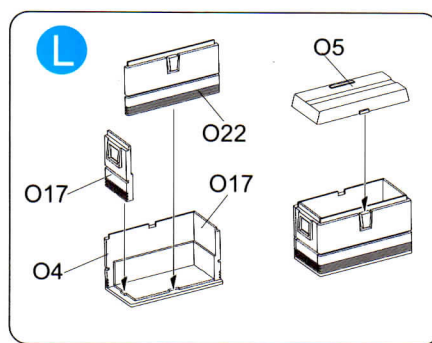
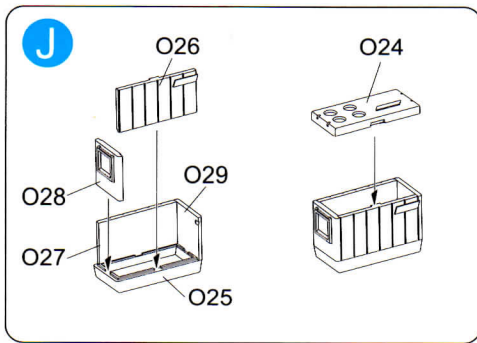
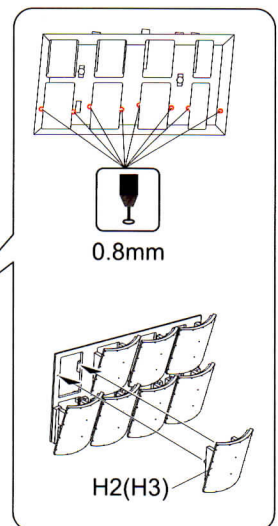
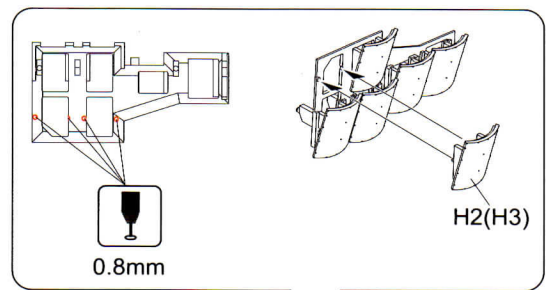

**B-1**

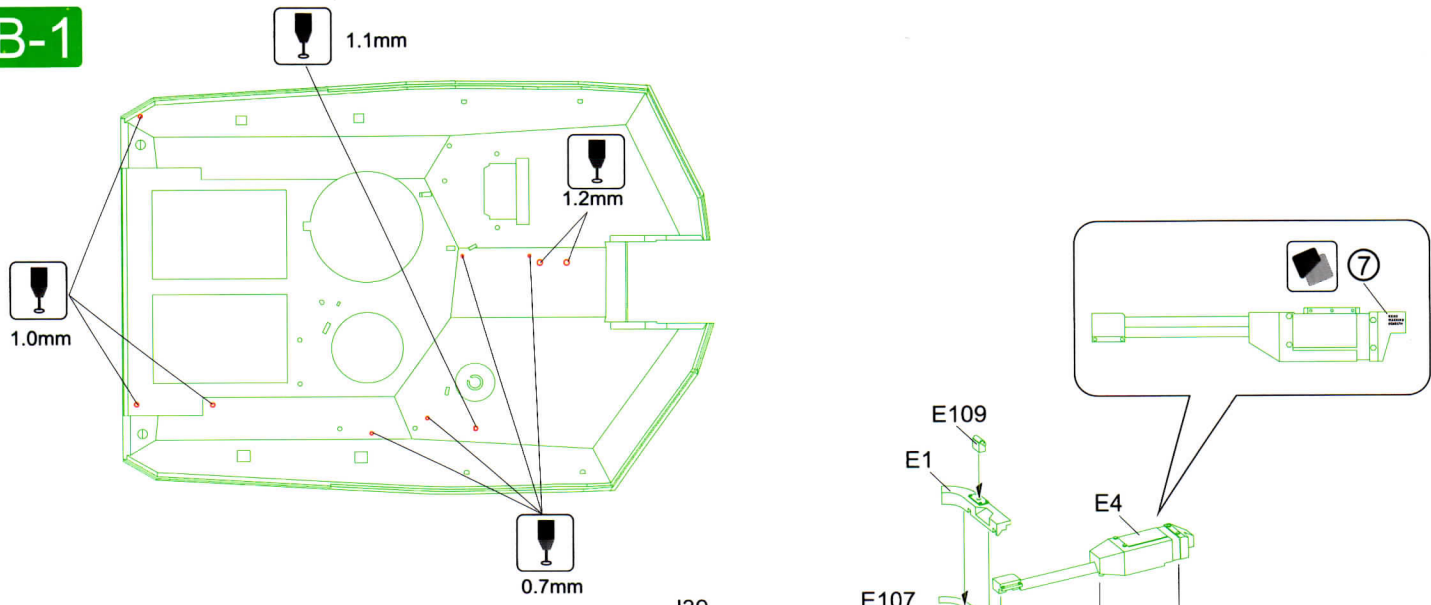

**B-2**

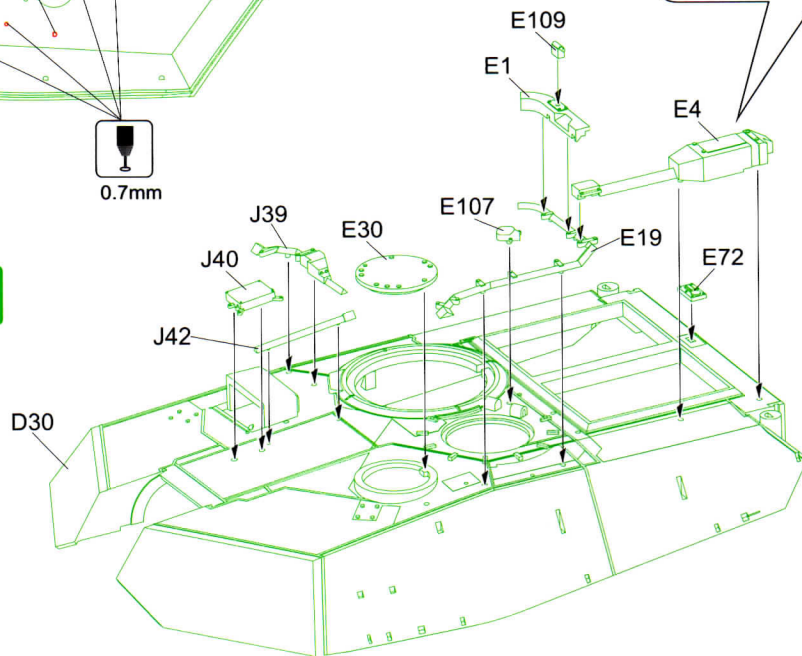

**B-3**

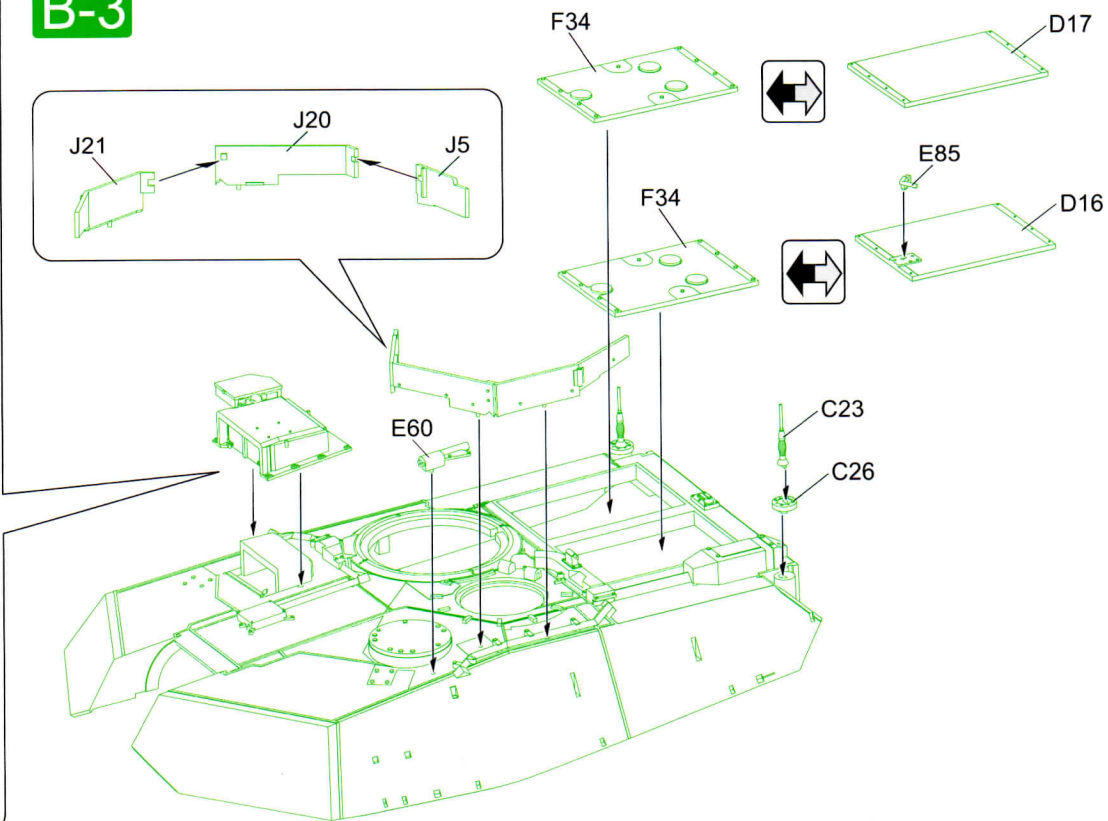
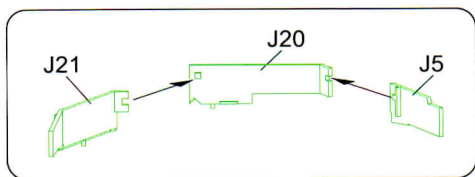
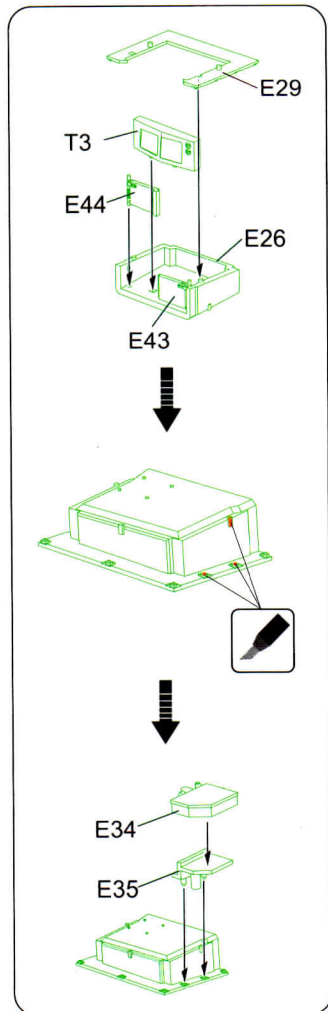



**B-4**

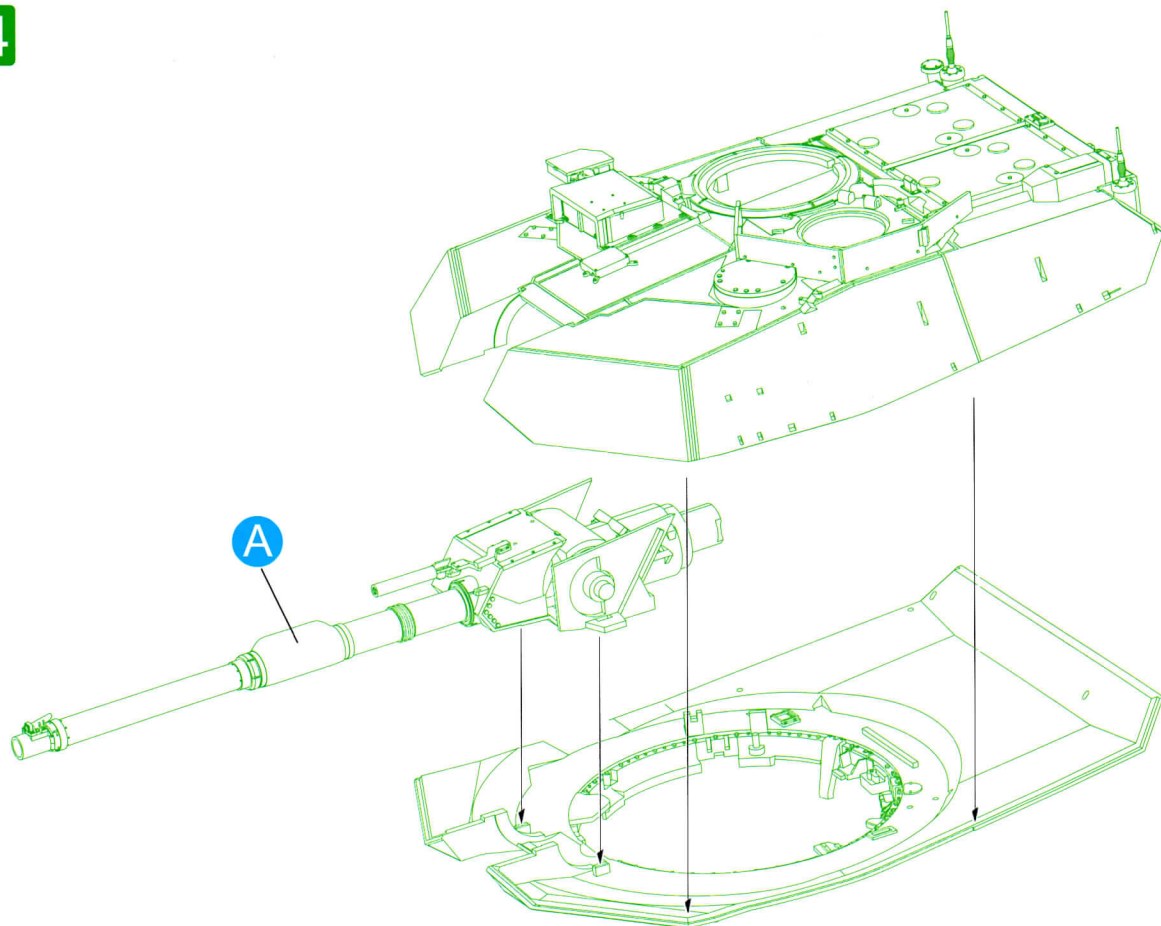

**B-5**

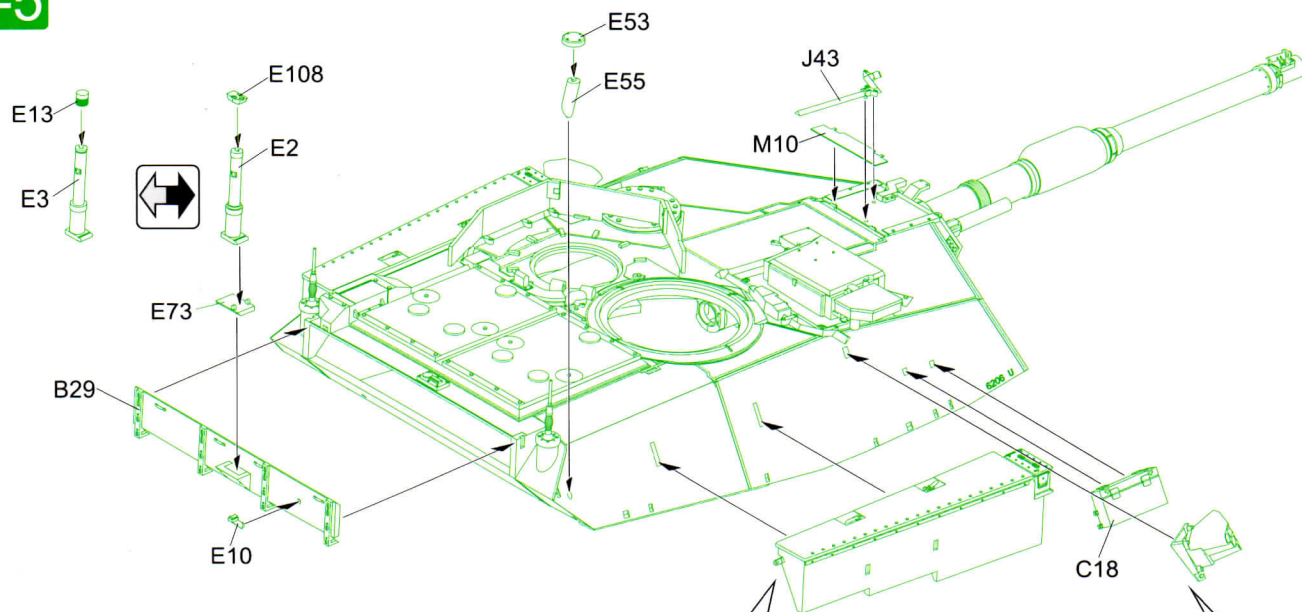

Make 2  
制作2组

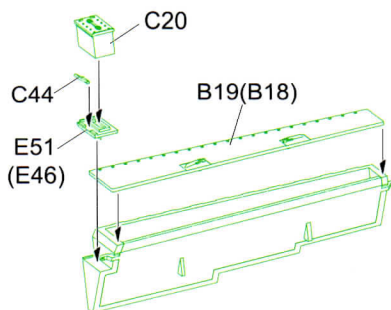
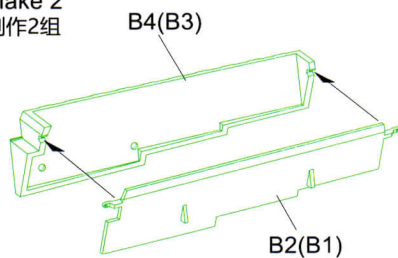

Make 2  
制作2组

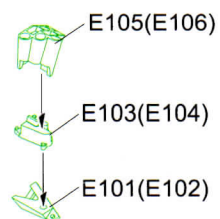

**B-6**

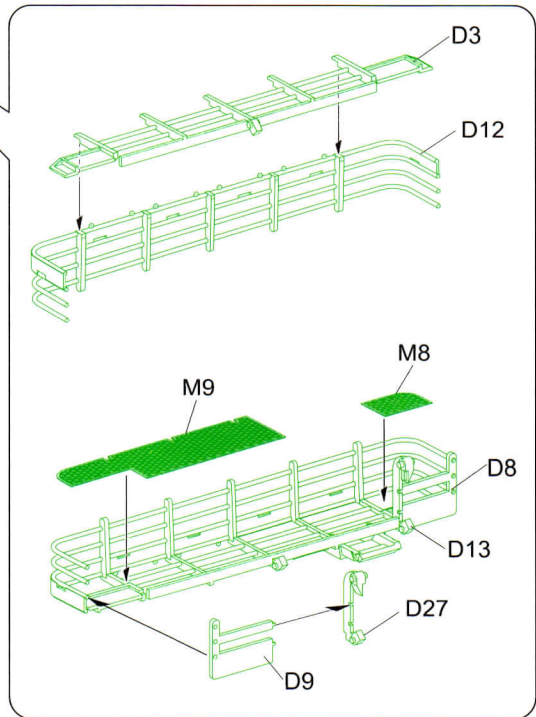
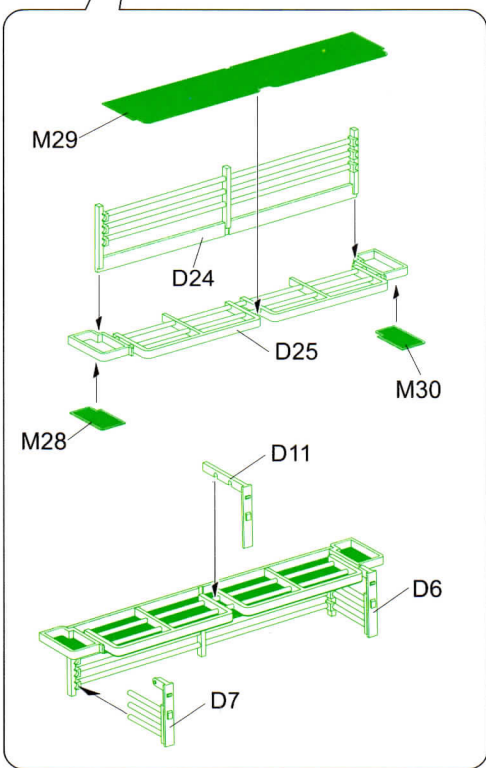
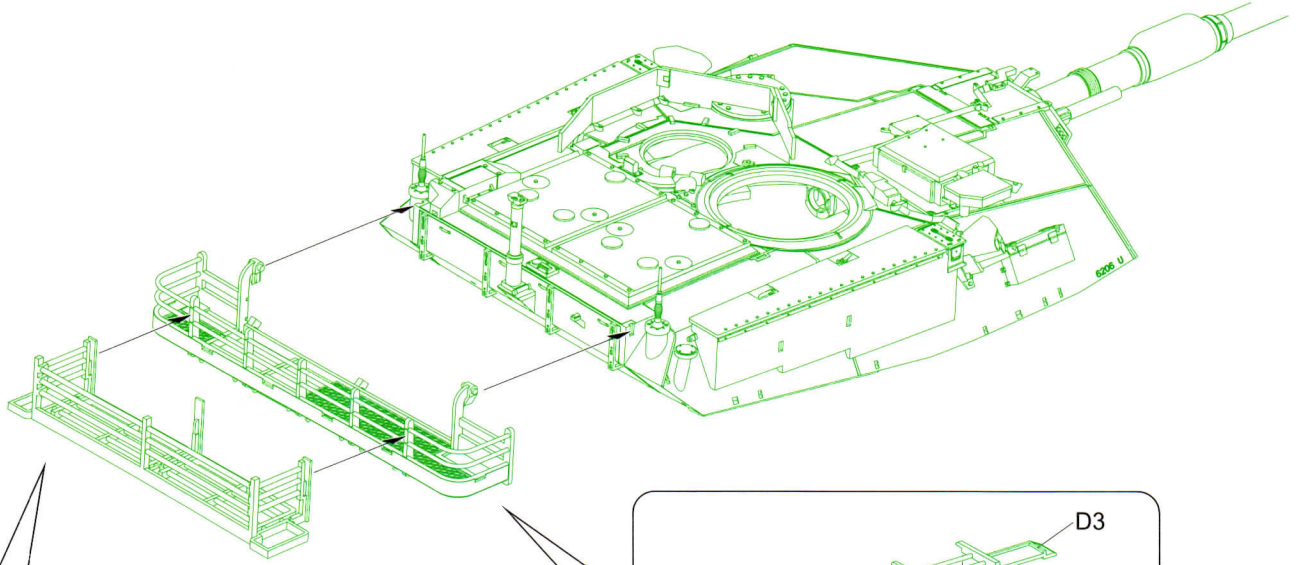

**B-7**

Make 2  
制作2组

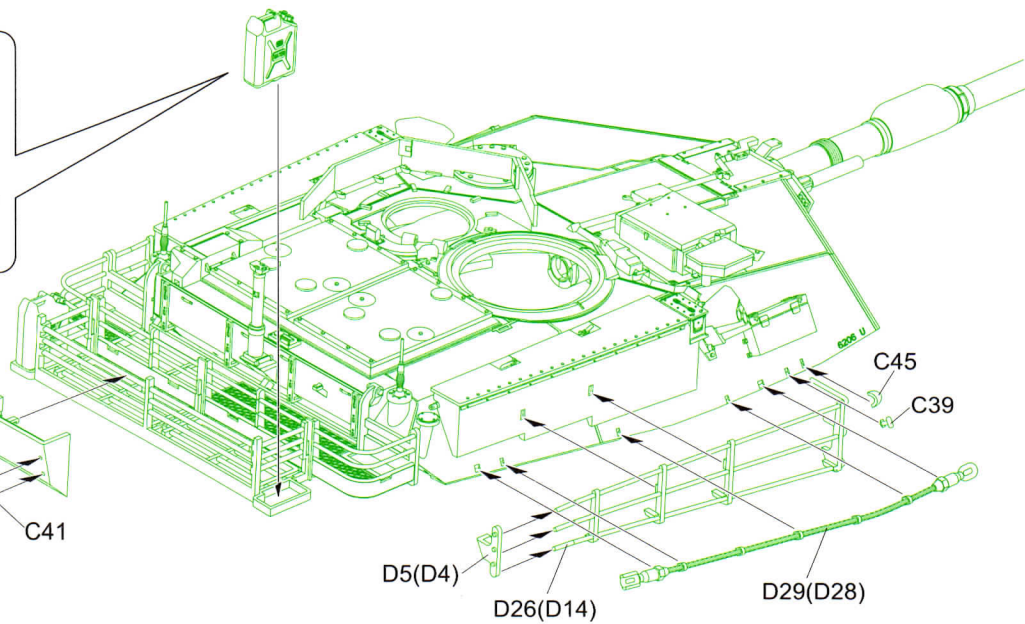
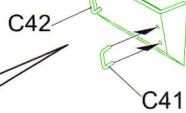
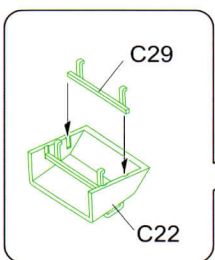
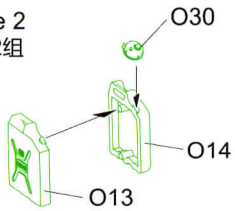



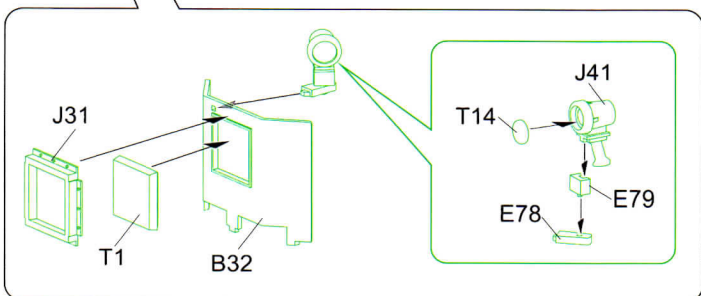
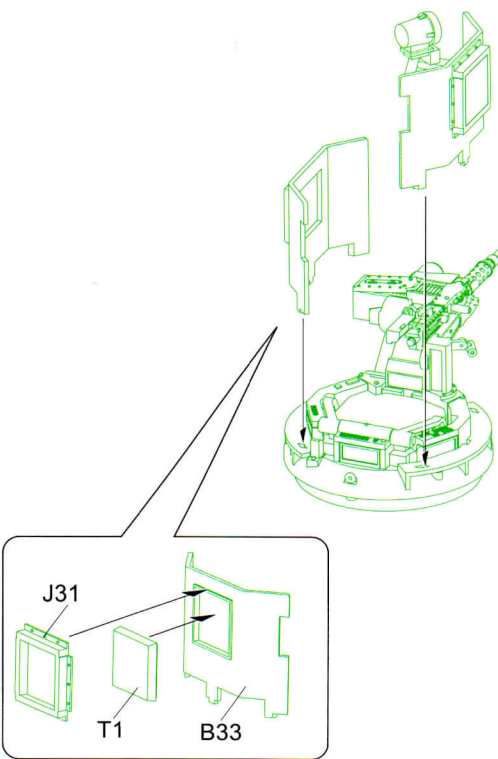
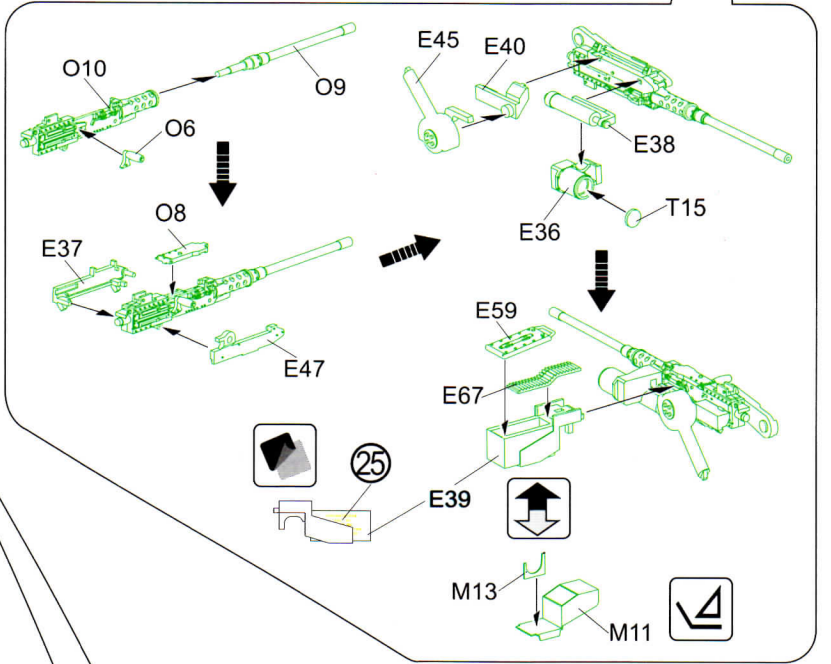
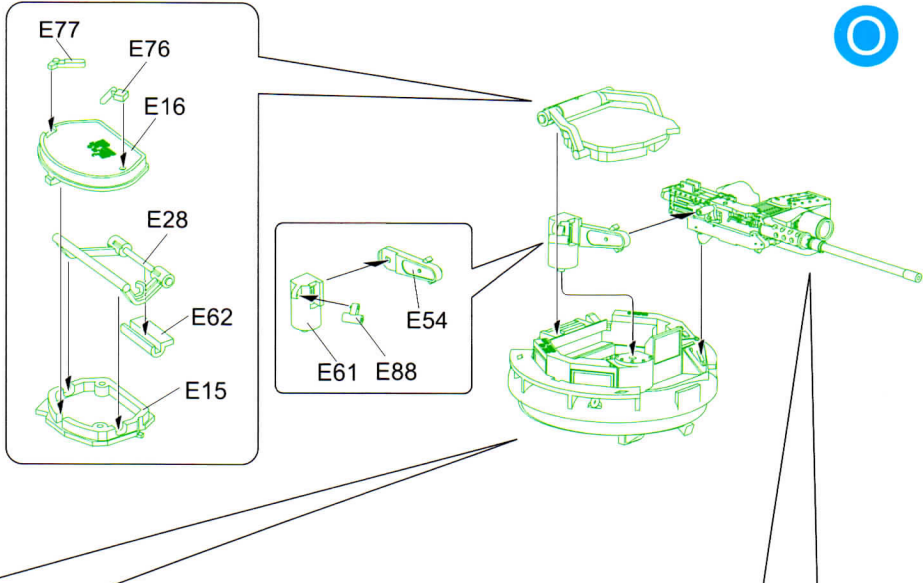
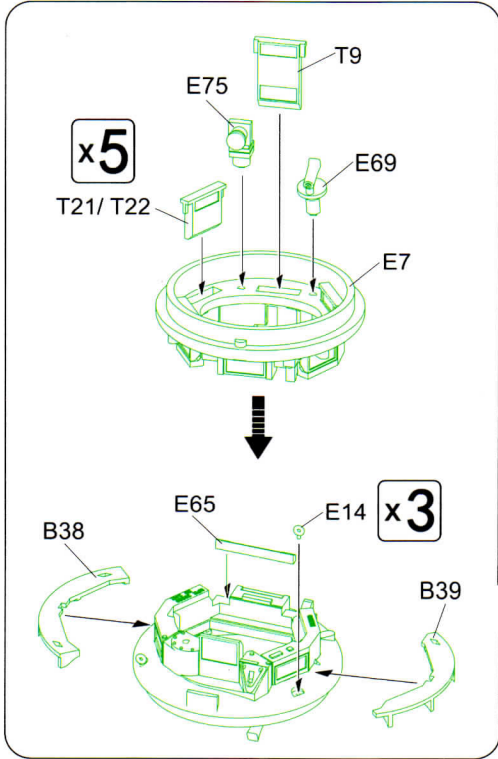
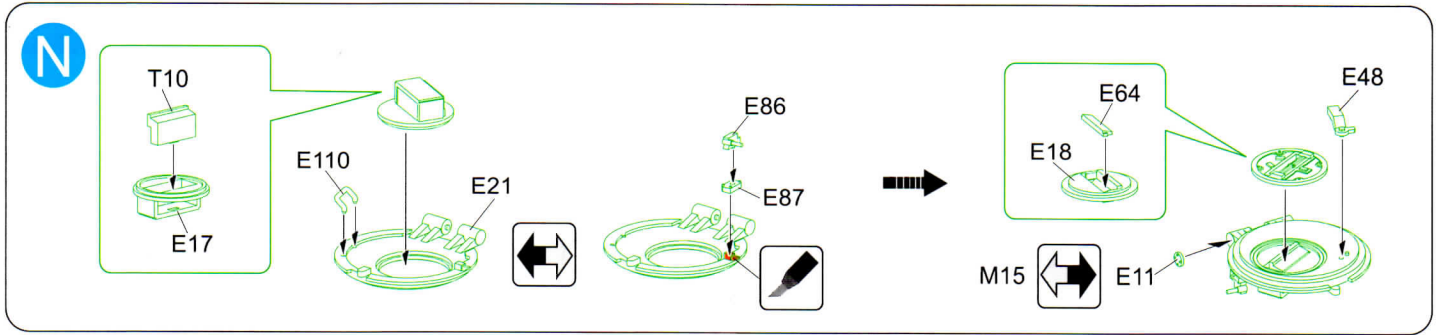

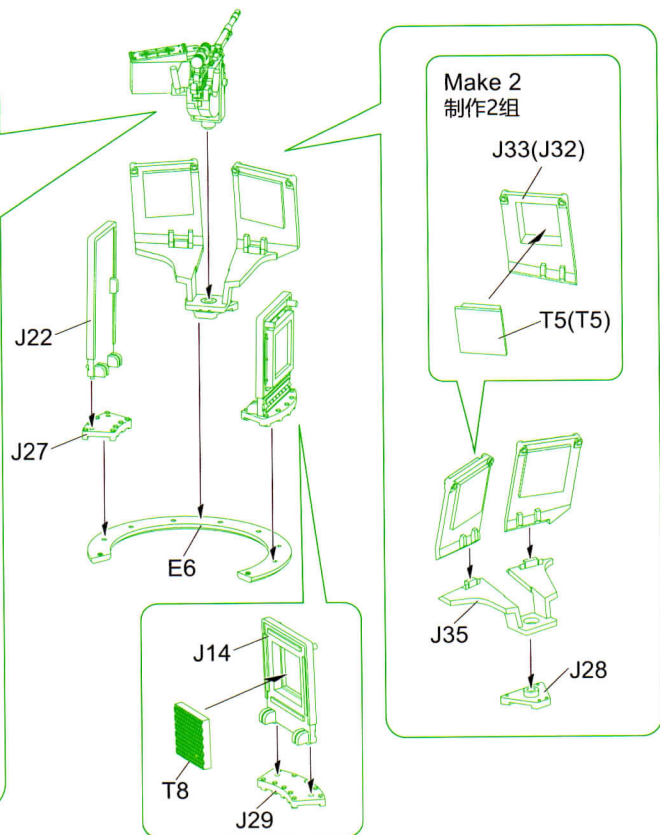
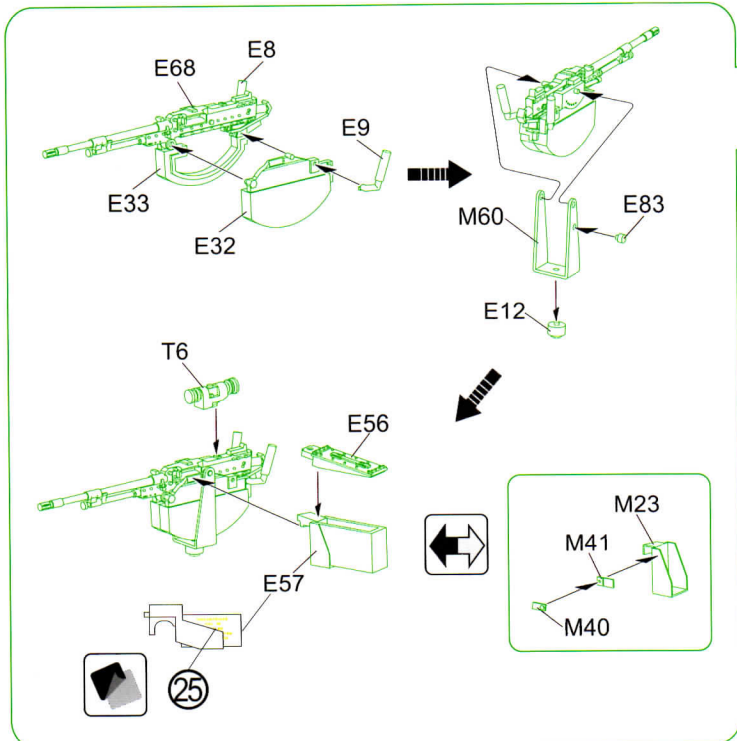

**B-8**

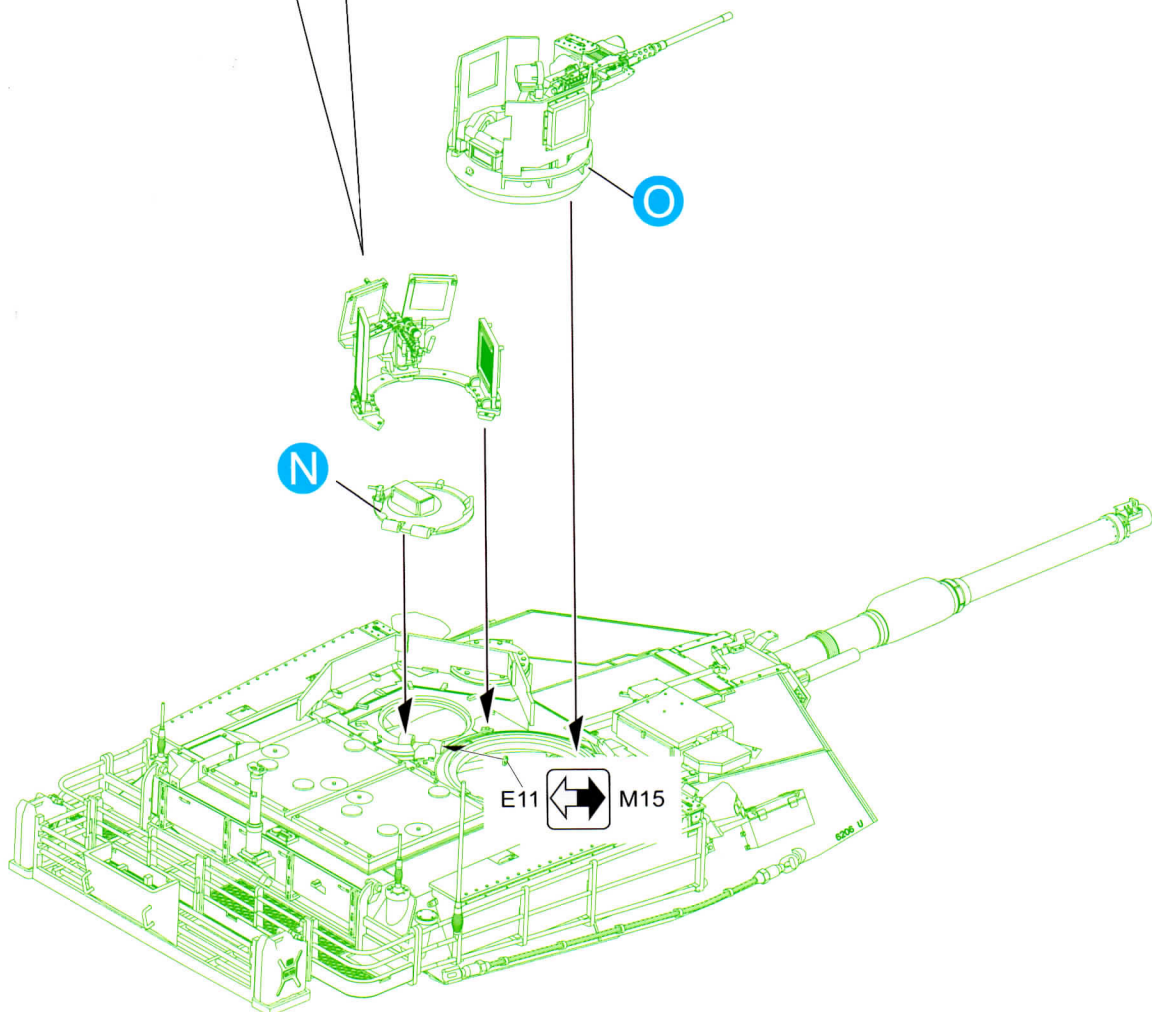



**C-1**

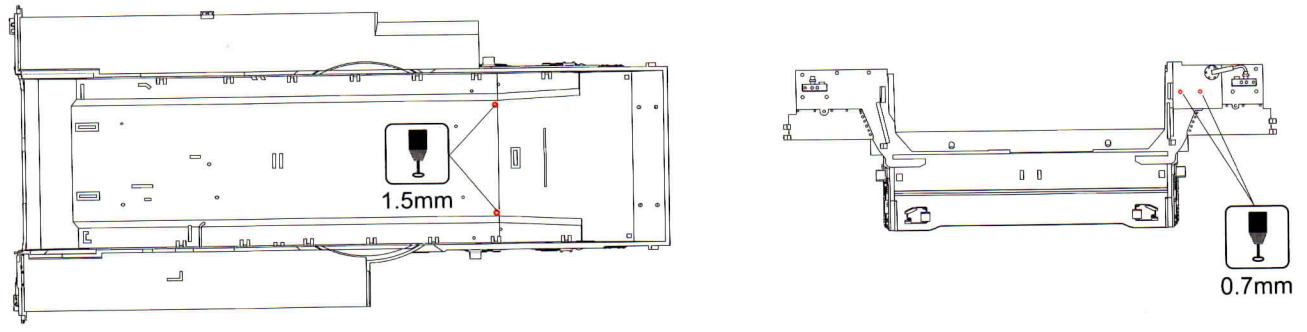

**C-2**

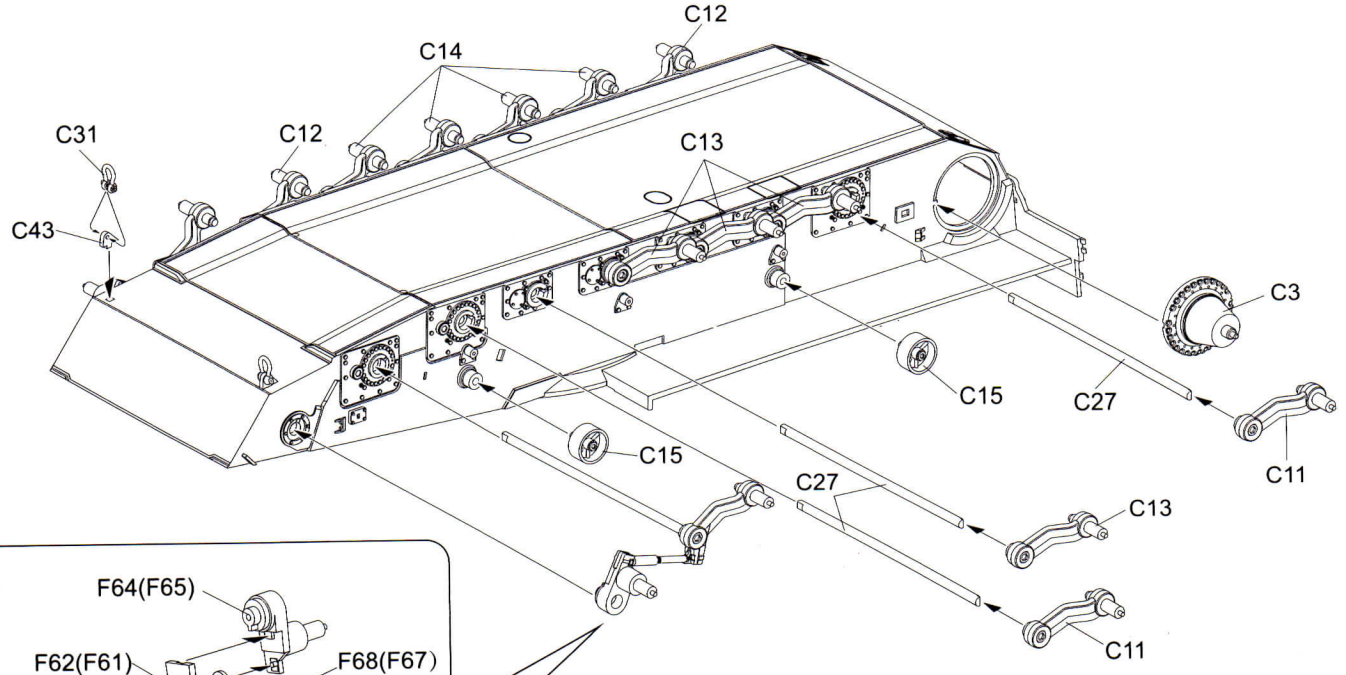

**C-3**

Applied for M1A1 TUSK  
M1A1 TUSK 适用

B8

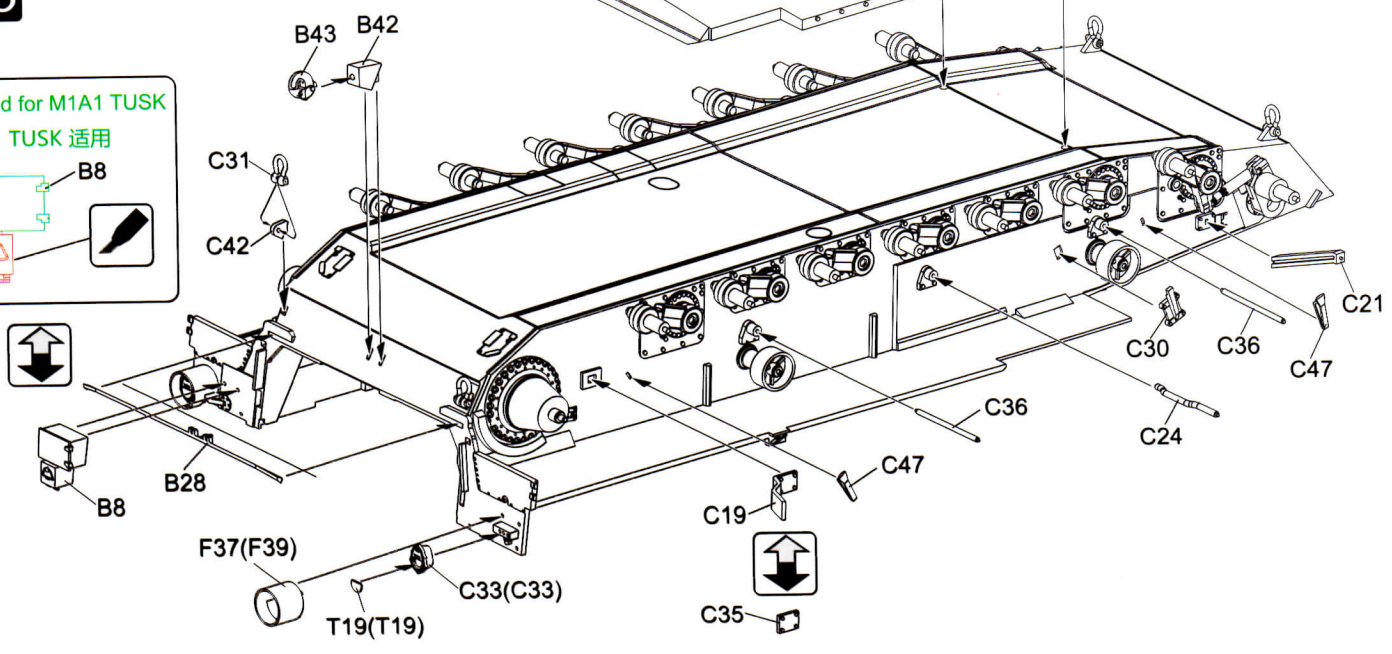

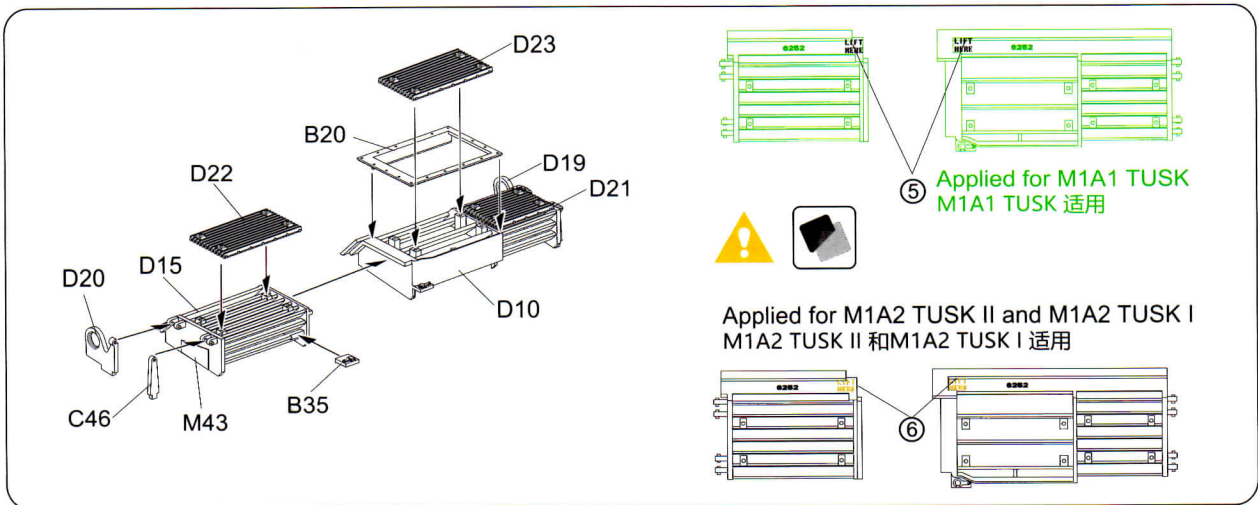

**C-4**

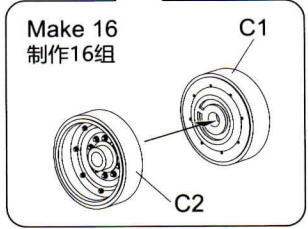
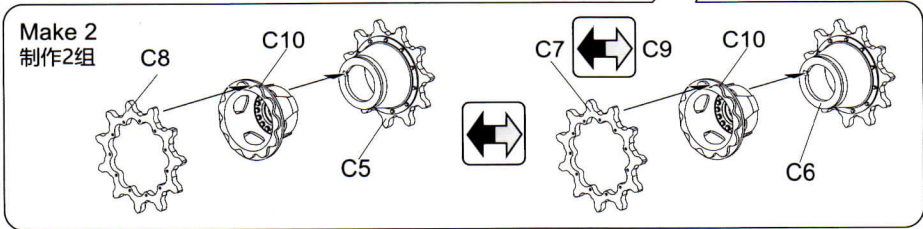
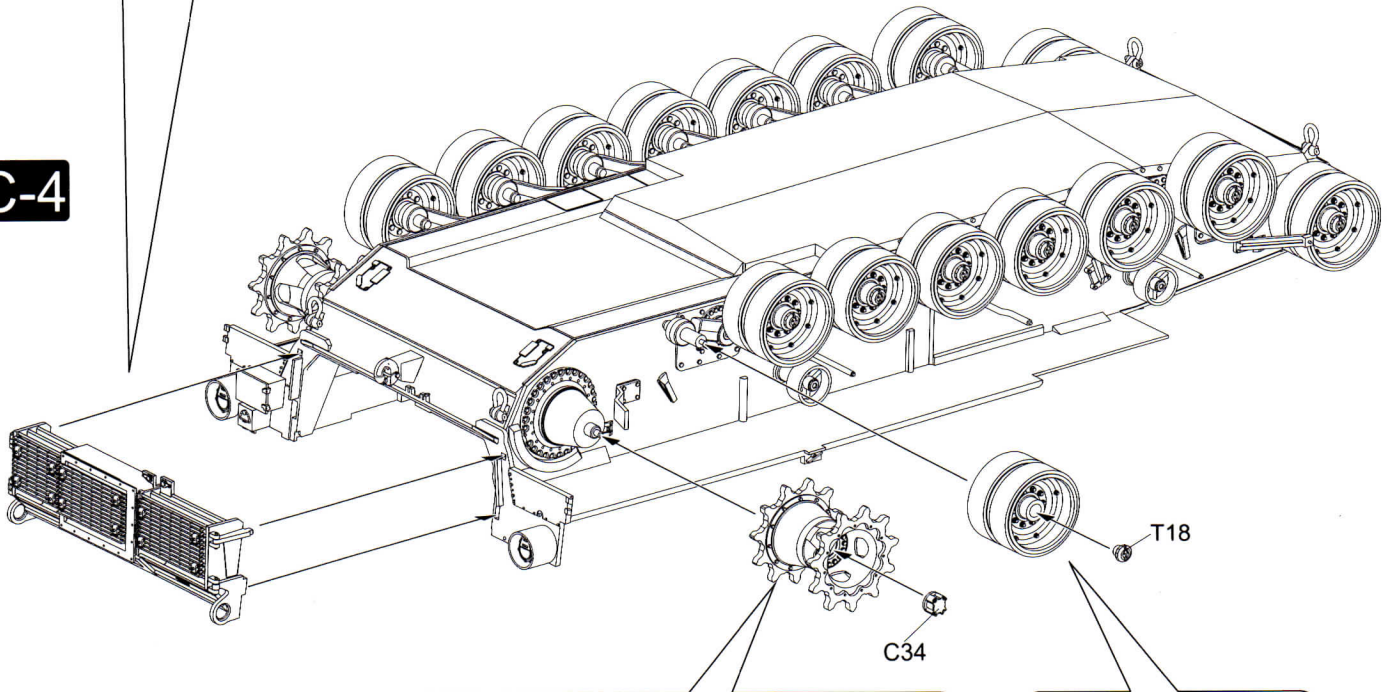

**C-5**

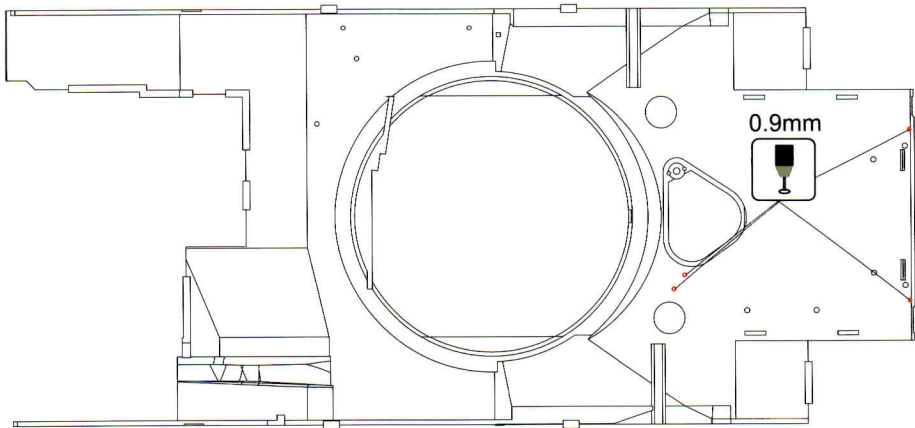



**C-6**

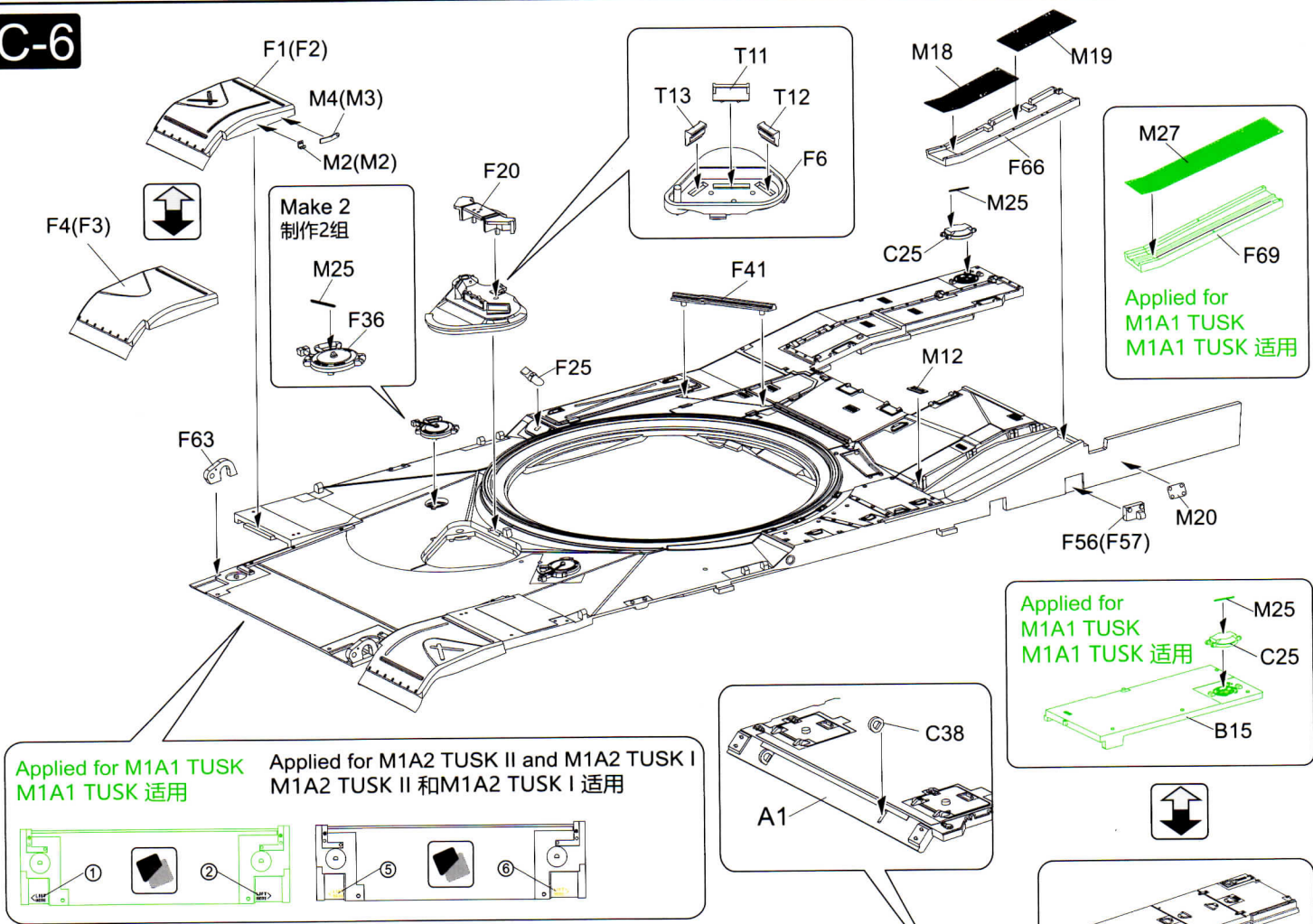

**C-7**

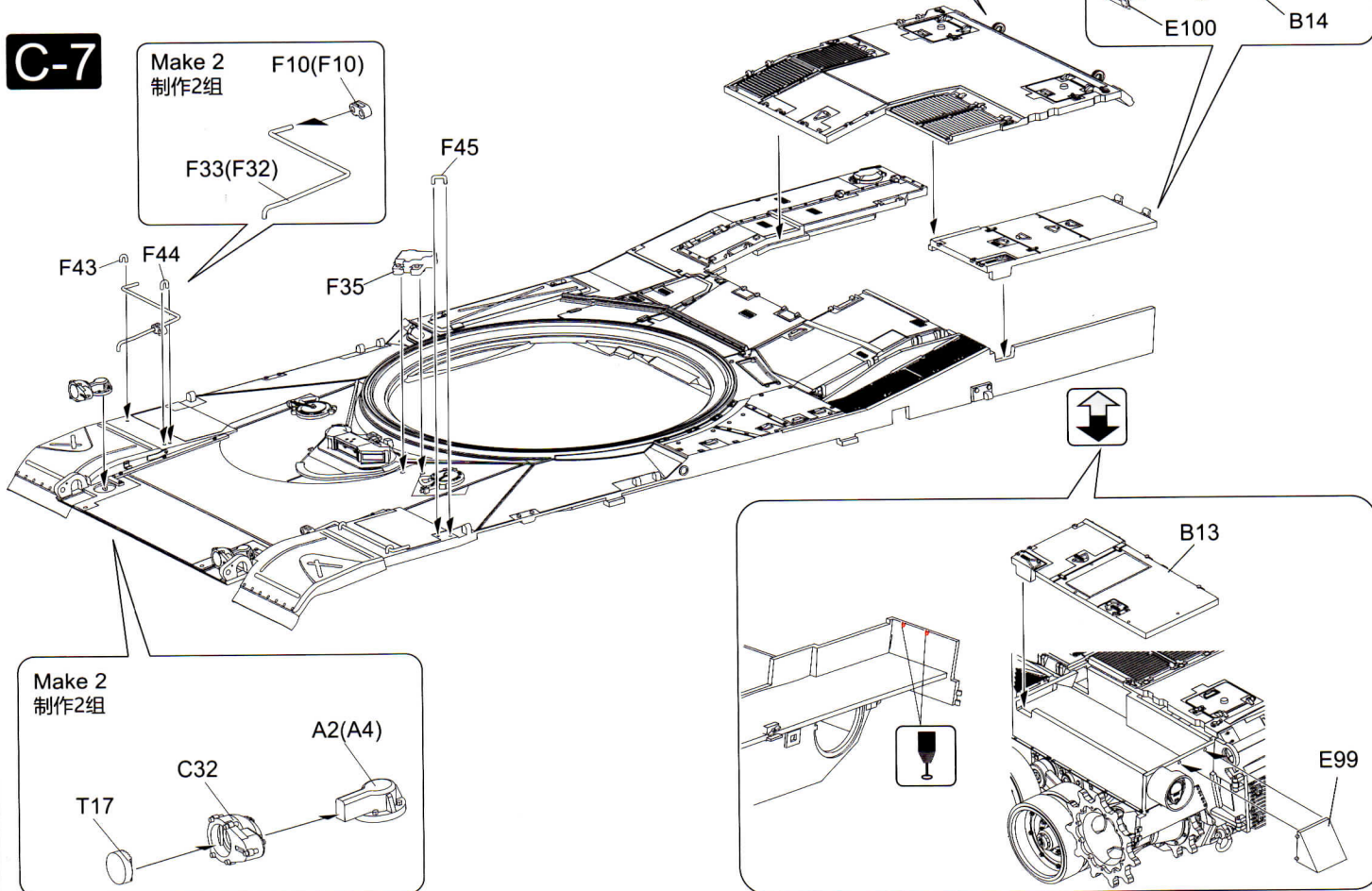



C-8

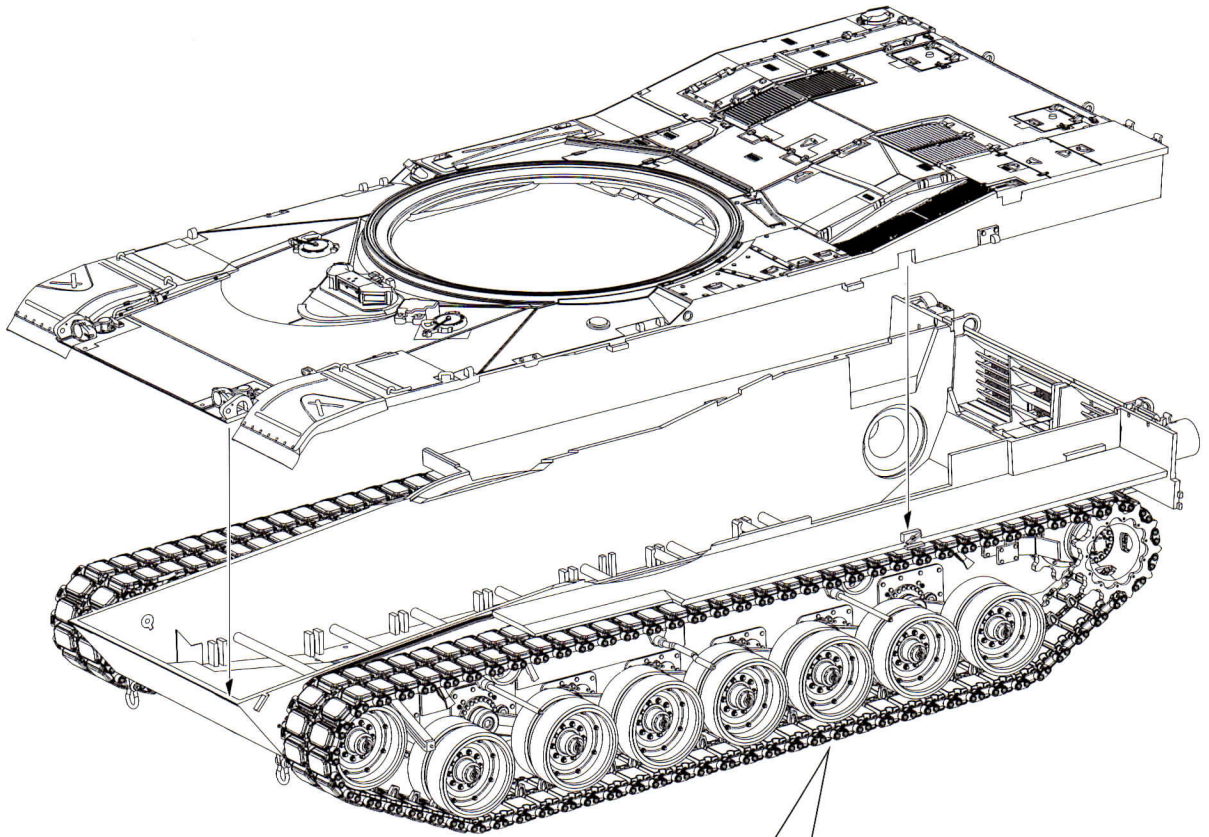

Track Links: 78pcs for each side.

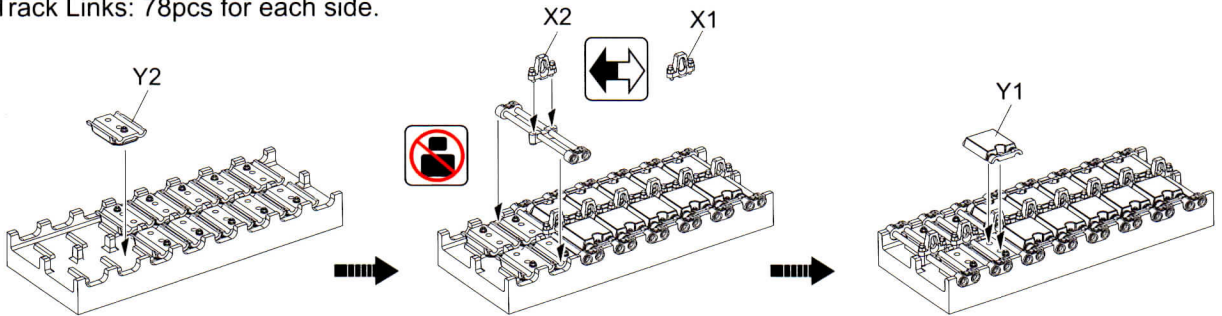

C-9

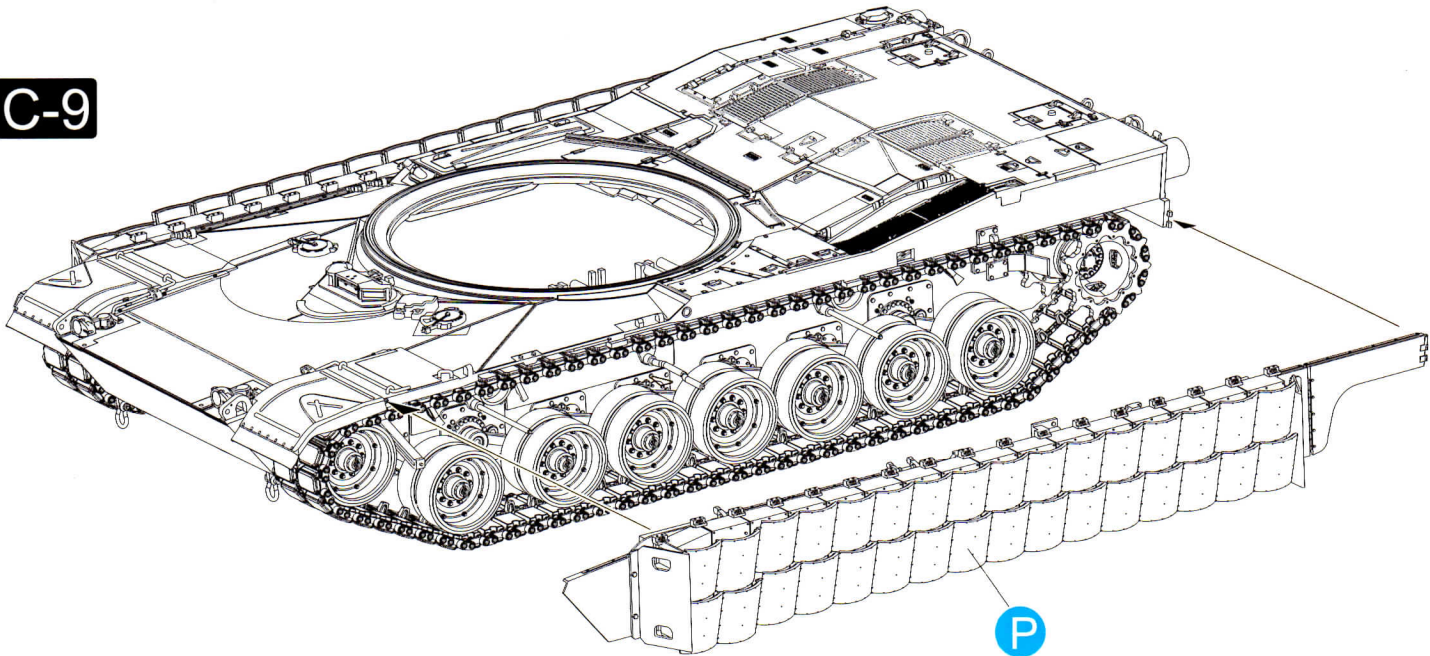

P



P

Applied for M1A2 TUSK II

M1A2 TUSK II 适用

Make 2  
制作2组

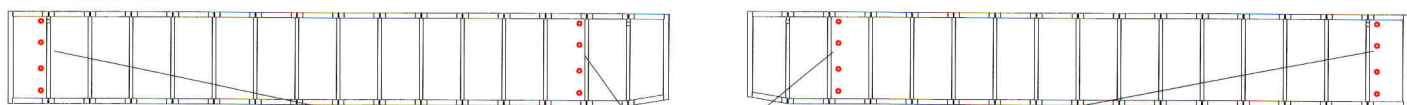

0.9mm

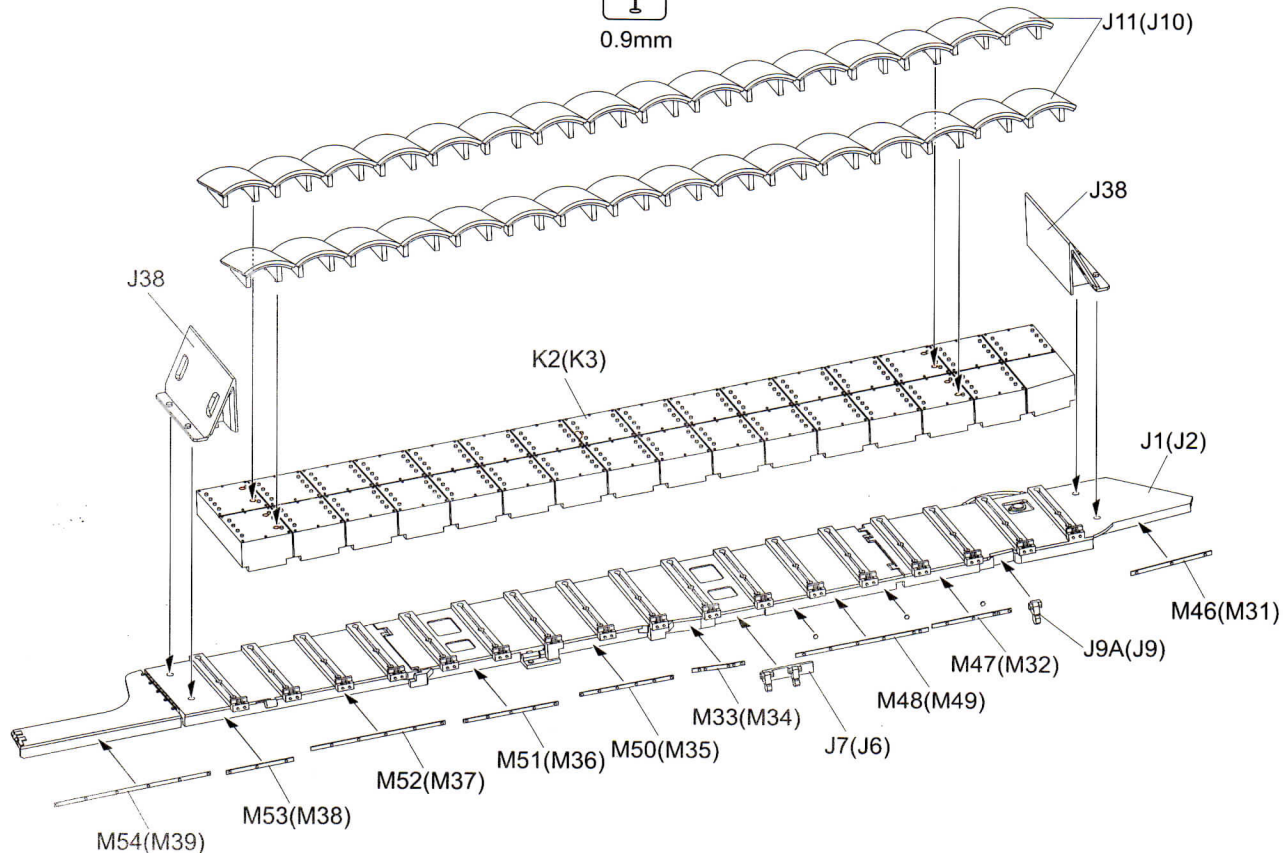

Applied for M1A1 TUSK

M1A1 TUSK 适用

Make 2  
制作2组

