

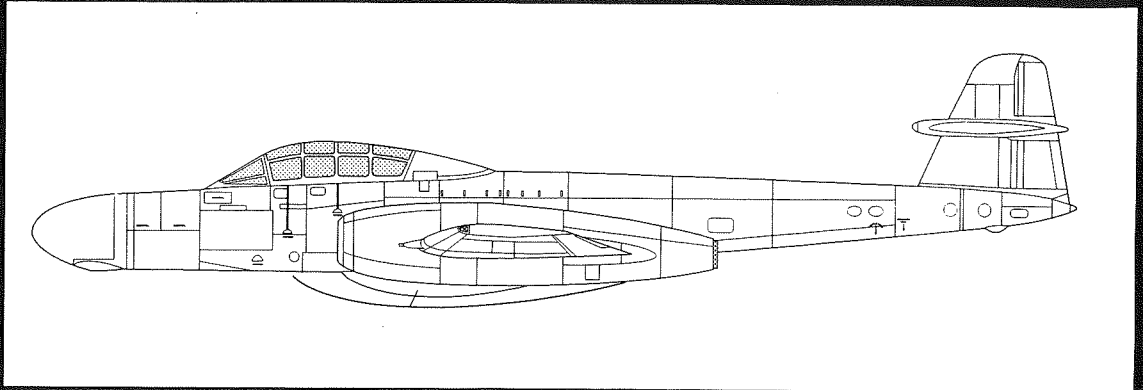

Classic Airframes



Gloster Meteor NF11/13

The Gloster Meteor holds the distinction of being the first British jet fighter to see active service under combat conditions. It entered service in the summer of 1944 to counter the menace of the V-1 rocket attacks over southern England. Numerous modifications to enhance power and serve in different roles, assured that the Meteor served for many years with the RAF and a host of other nations.

The Nightfighter version of the Meteor was born out of the realization for the need to replace the Mosquito night fighter. In 1949 production orders were placed with emphasis on using existing Meteor structure as much as possible; consequently the type resembled the Mk. 7 except for longer nose and new tail. The wings were the long span type to balance the extra weight. The cannon armament was moved to the wings.

The first production type was delivered on October 1950 and delivery to Squadrons began in earnest on 1951 and it was quickly deployed in Germany with the 2nd Tactical Air Force.

Export orders started to come in by 1952, the aircraft was also tropicalized (NF 13) and deployed in the Middle East and the type took part in the Suez invasion in November 1956 while based in Cyprus.

The NF variants saw service with many foreign countries, such as Australia, Belgium, Denmark, Egypt, France, Israel and Syria.

Meteor NF11/13 Specifications

Powerplant:	2x 3700lb. Rolls-Royce Derwent 8 jet engines	Armament:	4x20mm cannon in wings
Wing Span:	43'		
Length:	48'6"		
Maximum Speed:	580 mph		

This model kit is intended for experienced modelers. The nature of limited-run kits such as this require additional time and effort to clean up and fit the parts, as well as experience with the various media utilized to provide the most accurate effect on the finished model. Use CyA ('super') glue to assemble Resin (PU) parts.

Classic Airframes
P.O. Box 577580 Chicago, IL 60657-7580 USA

Assembly Instruction Symbols



MULTIPLE ASSEMBLIES

BEND

OPTIONAL

DRILL

CUT

SYMMETRICAL ASSEMBLIES

Paint Reference Guide

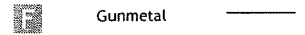
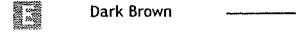
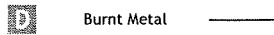
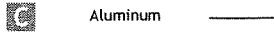
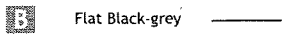

Parts

PLASTIC PARTS

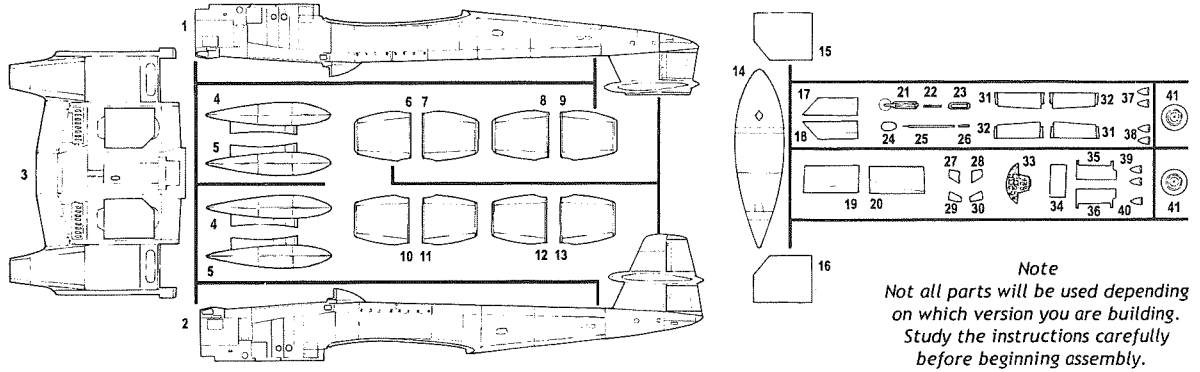

Note
Not all parts will be used depending on which version you are building. Study the instructions carefully before beginning assembly.

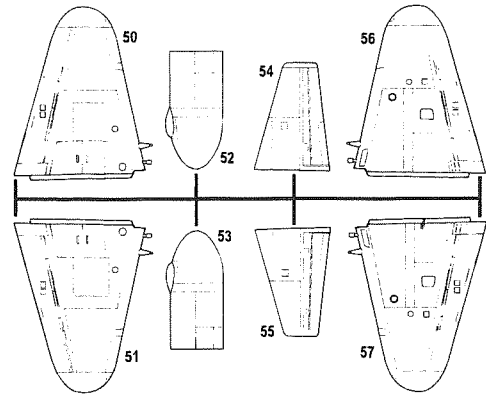
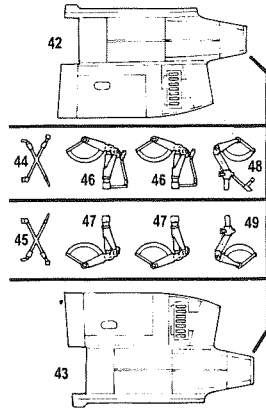

RESIN PARTS

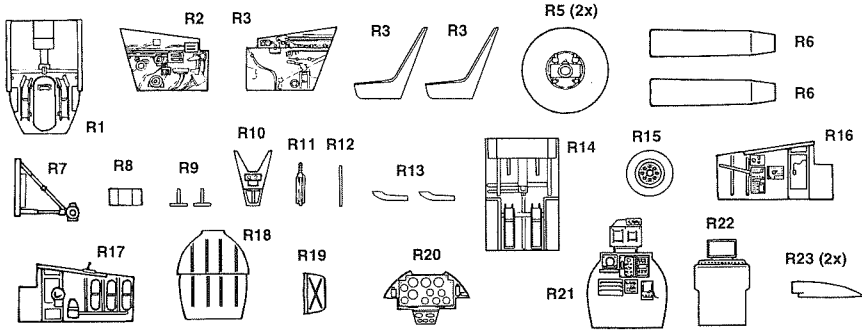

CLEAR PARTS

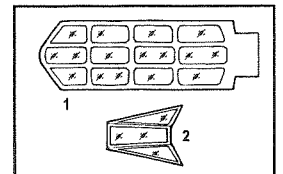

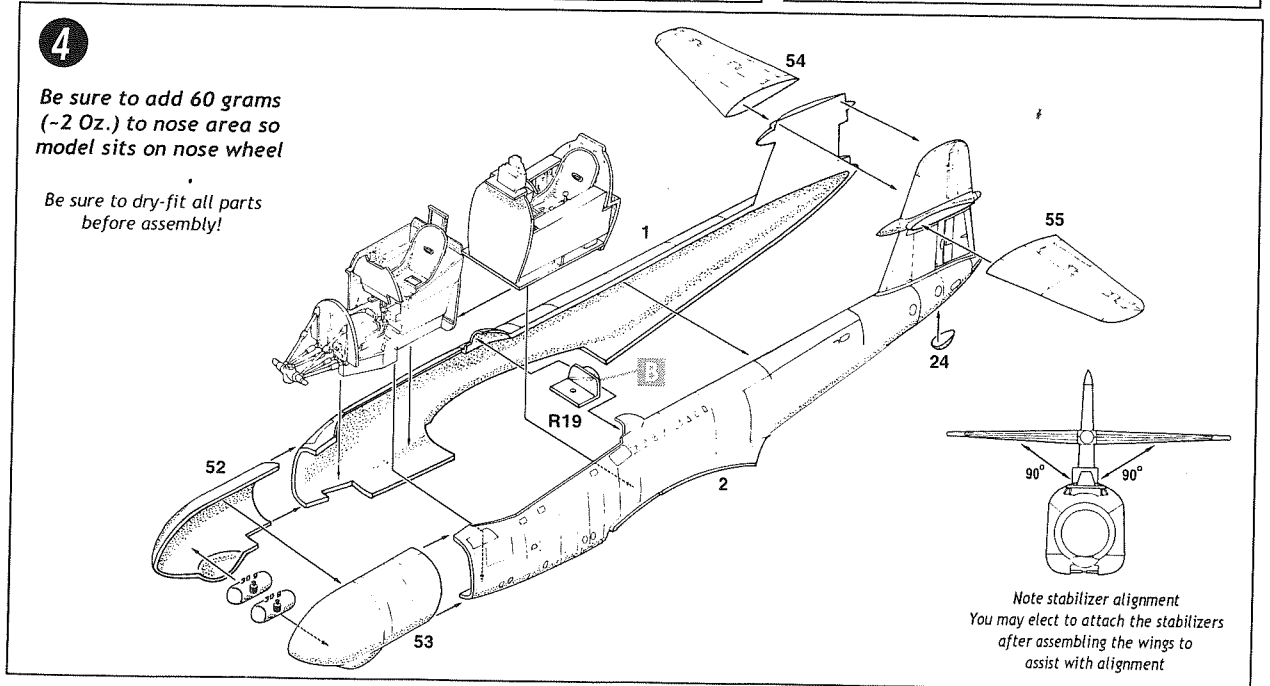
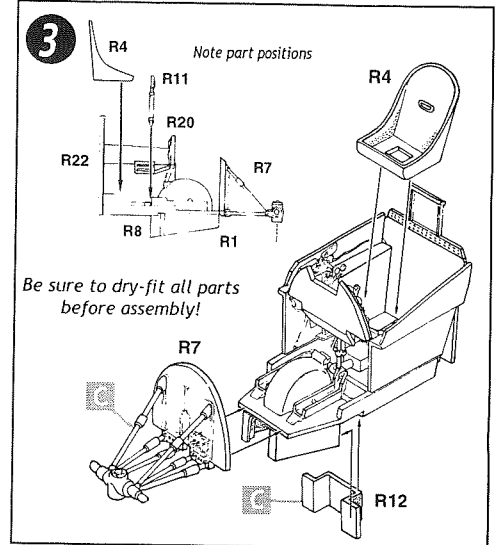
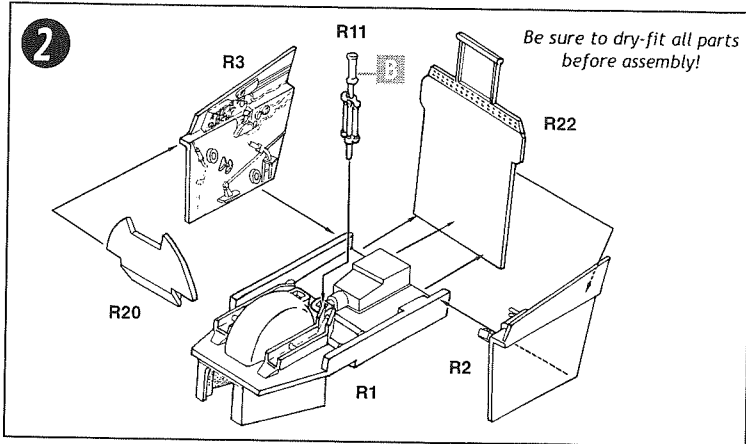
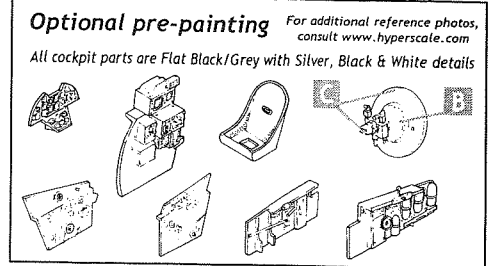
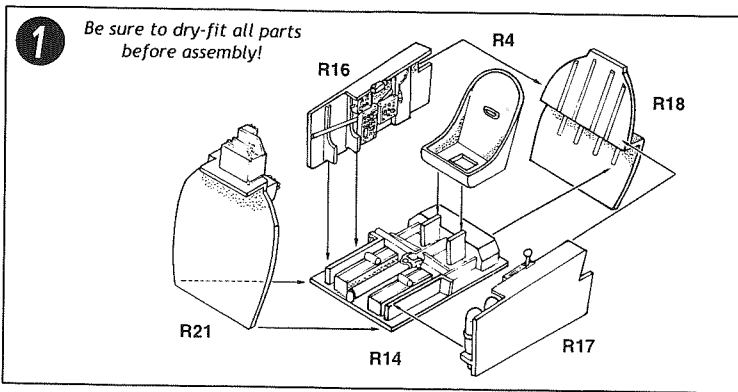

5 Intake interiors

Note
 Most photos show NF Meteors equipped with larger intakes (Parts 10/11/12/13). Check references for the aircraft you are modeling for the appropriate intake style.

Assembled View - Right Engine
 Top View
 Side View

Assembled View - Left Engine
 Top View
 Side View

Refer to Step 7 for assembling upper intake parts

6 Be sure to dry-fit all parts before assembly!

Interiors

7 Note - it is recommended to attach lower intake assemblies (from Step 5) to the lower wing (part 3), and attach upper intake halves to upper wings 42 and 43, before gluing upper and lower wing parts together.

Right Engine

Left Engine

Note relative positions of all parts. Be sure to dry-fit all parts before assembly!

Side View
 42/43
 3
 FWD

Top View

8

Be sure to dry-fit and check alignment of all parts during assembly.

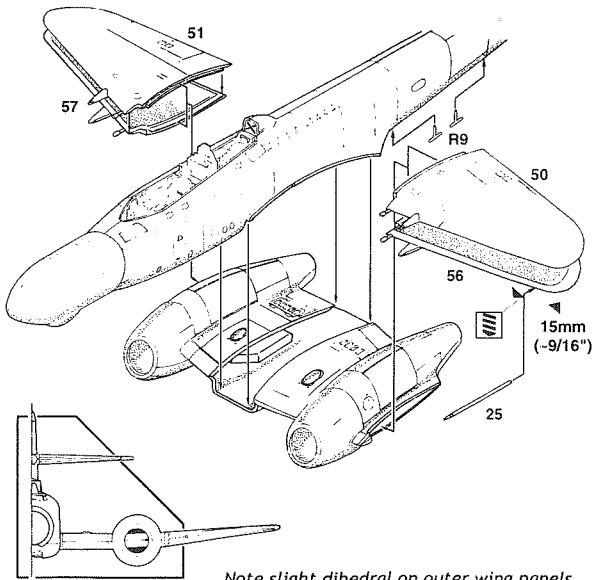

9

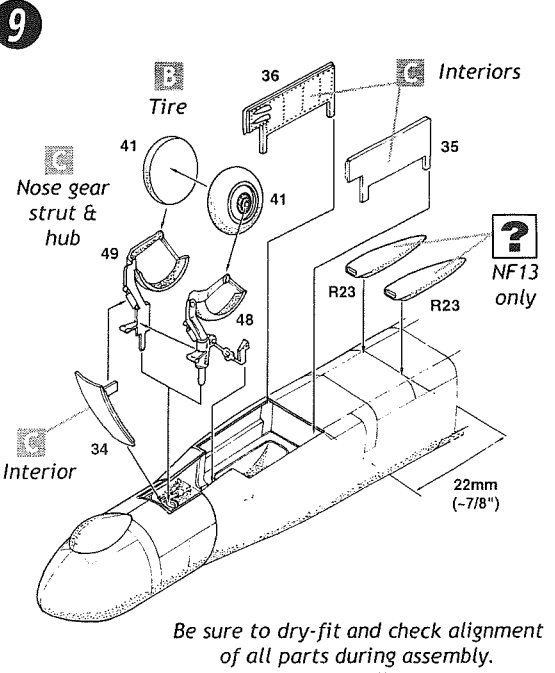

10

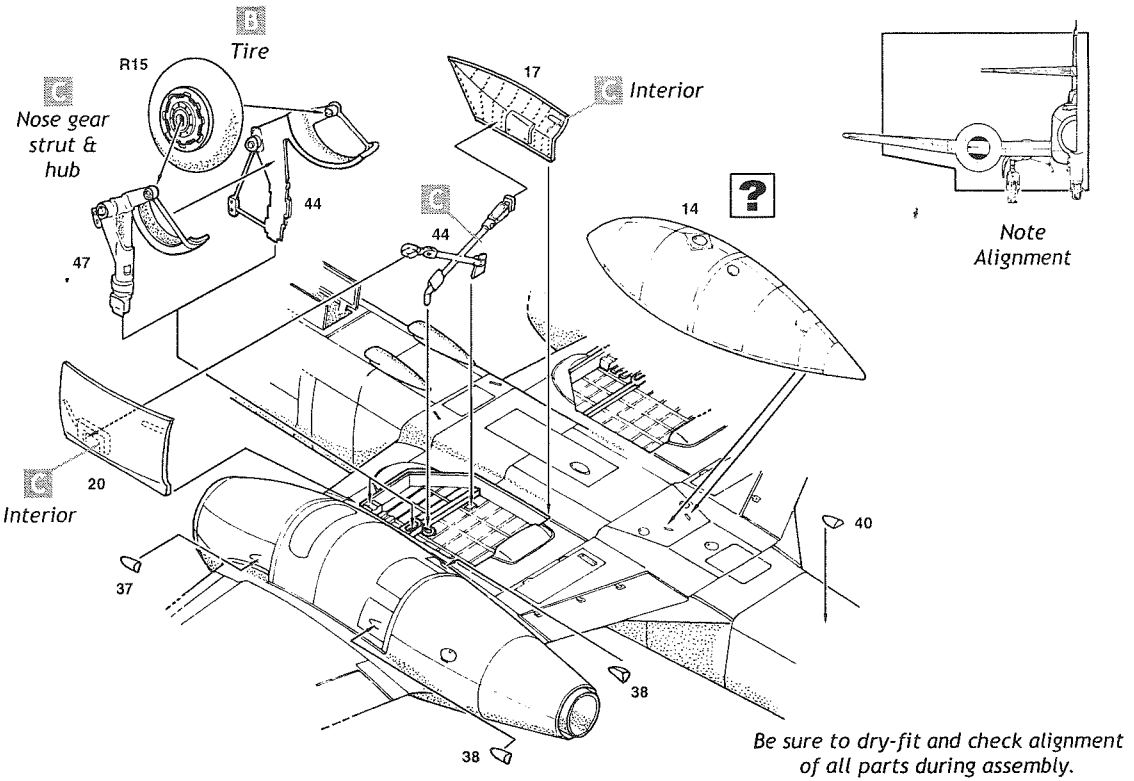

11

Be sure to dry-fit and check alignment of all parts during assembly.

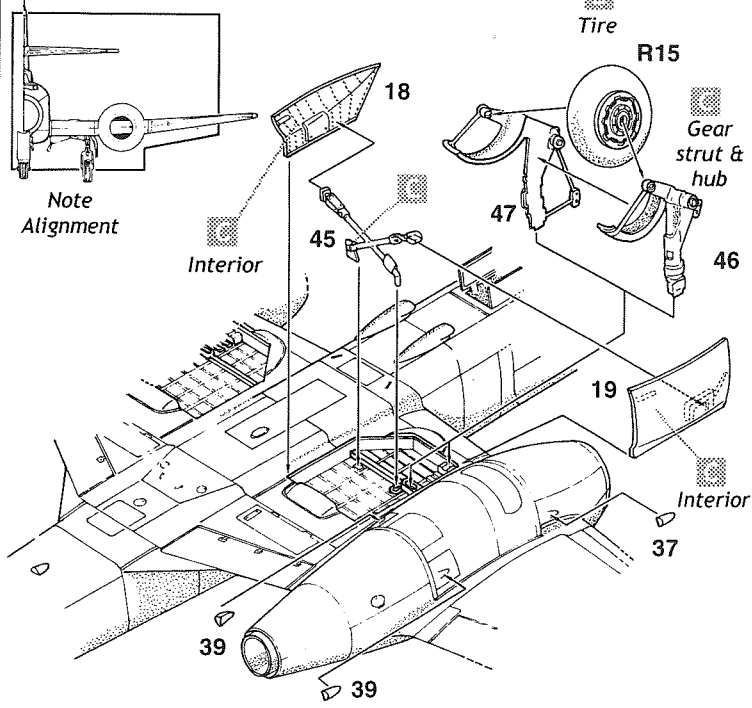

12

?

Wing tank

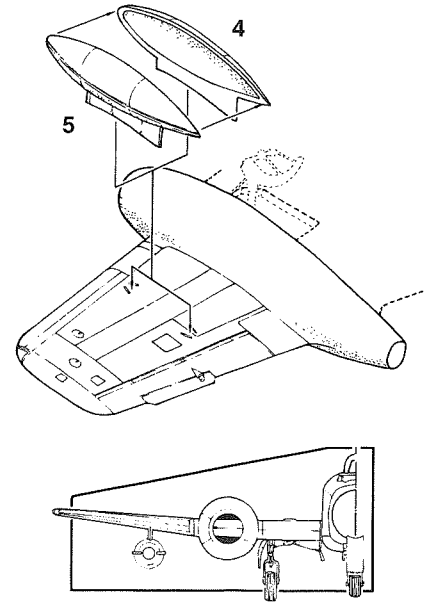

Note hanging tank is perpendicular to ground.

13

?

Wing tank

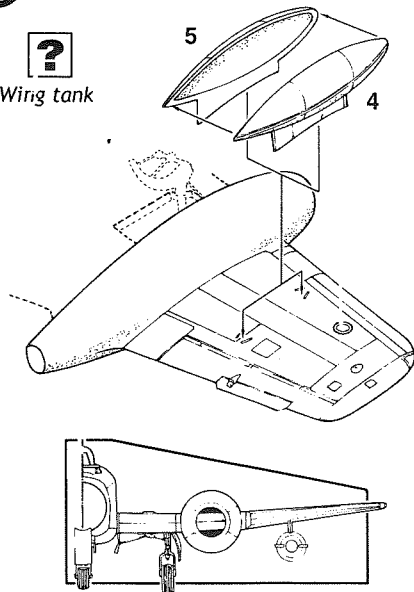

Note hanging tank is perpendicular to ground.

14

?

Check your references for antenna styles appropriate for your model.

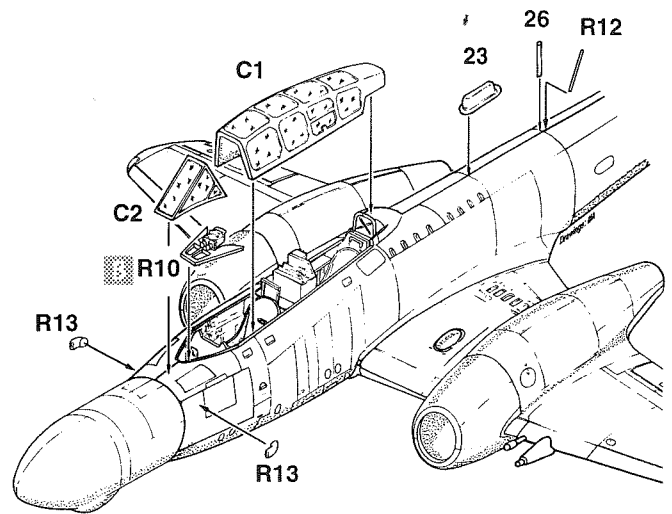

Gloster Meteor NF.13 PAINTING & MARKING GUIDE

39 Squadron, Suez Crisis, 1956

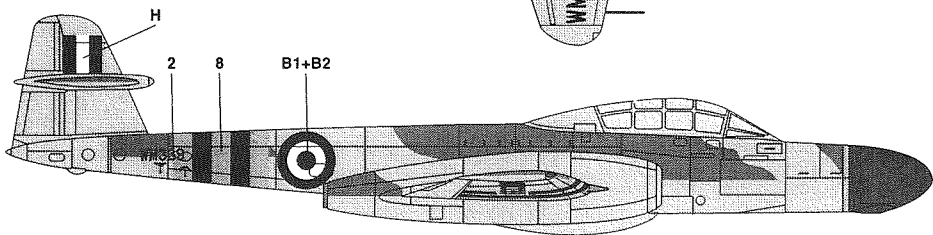
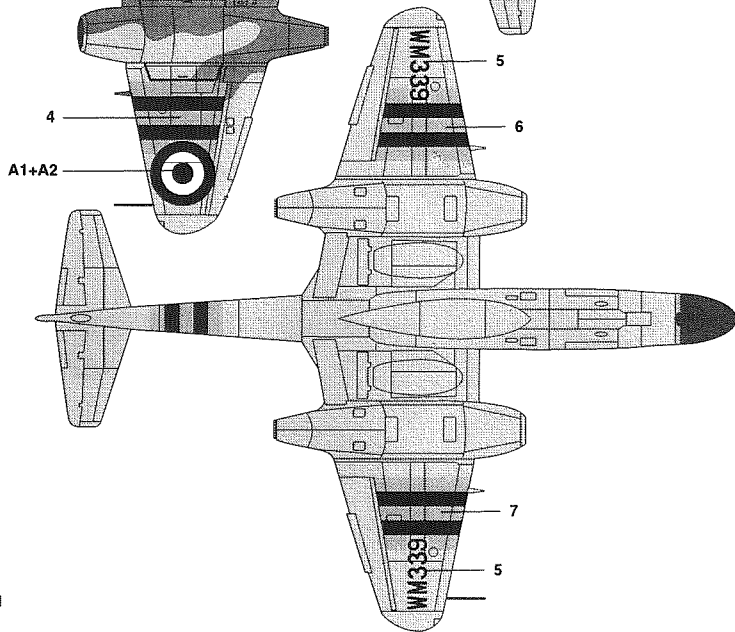
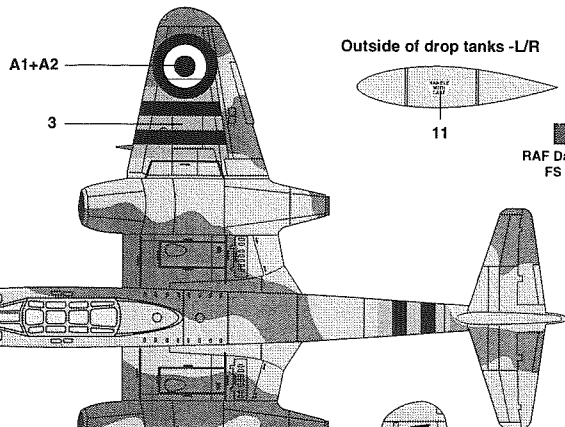
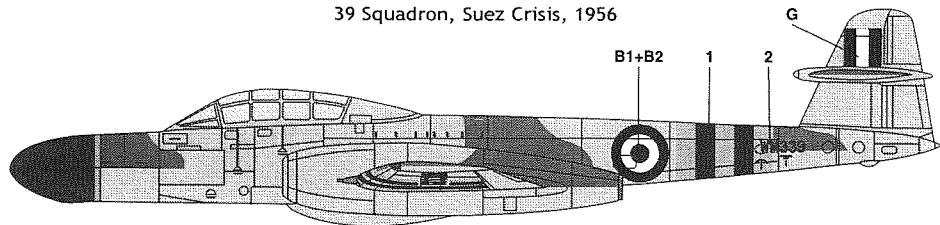

Outside of drop tanks -L/R

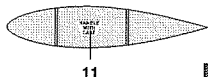

11

RAF Dark Green
FS 34079

RAF Medium Sea Grey
FS 36270

Gloster Meteor NF.11/13 STENCIL PLACEMENT GUIDE

J
Note 'ELECTRICAL'
stencils were applied
to most access doors
in nose area

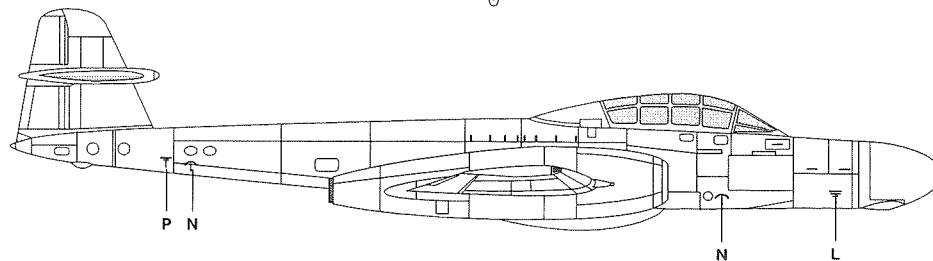
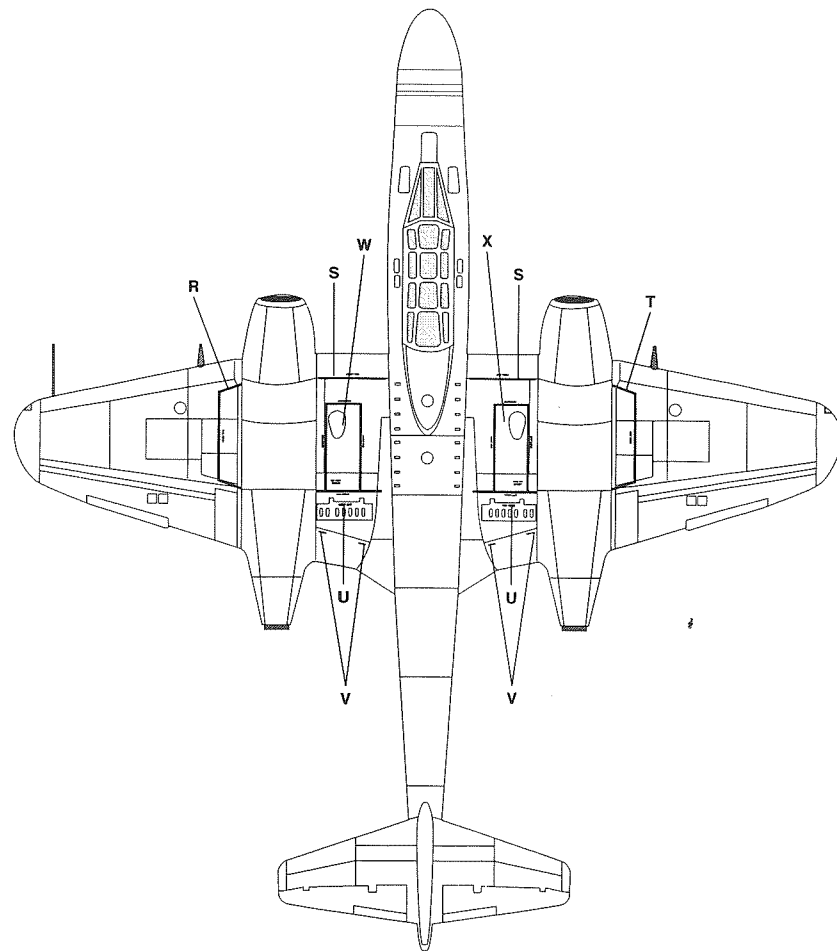
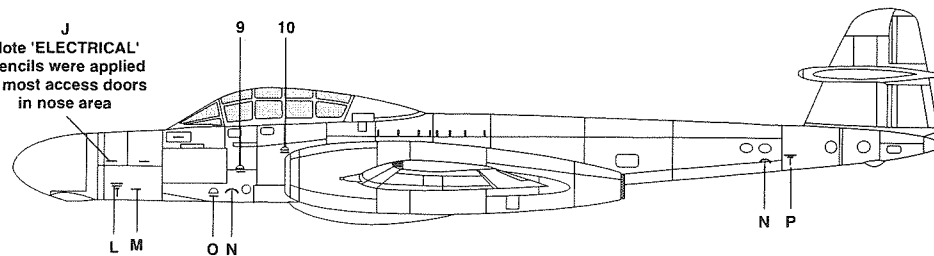

Gloster Meteor NF.13 PAINTING & MARKING GUIDE

Egyptian Air Force, 1955

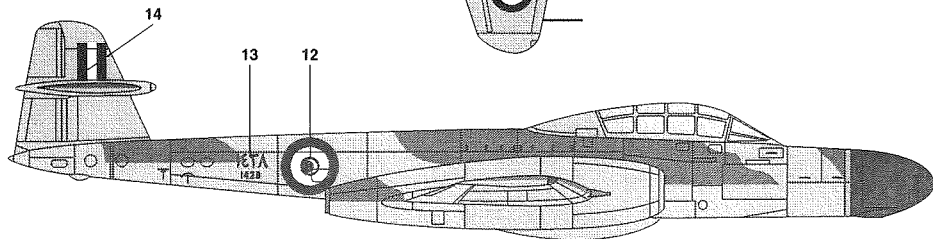
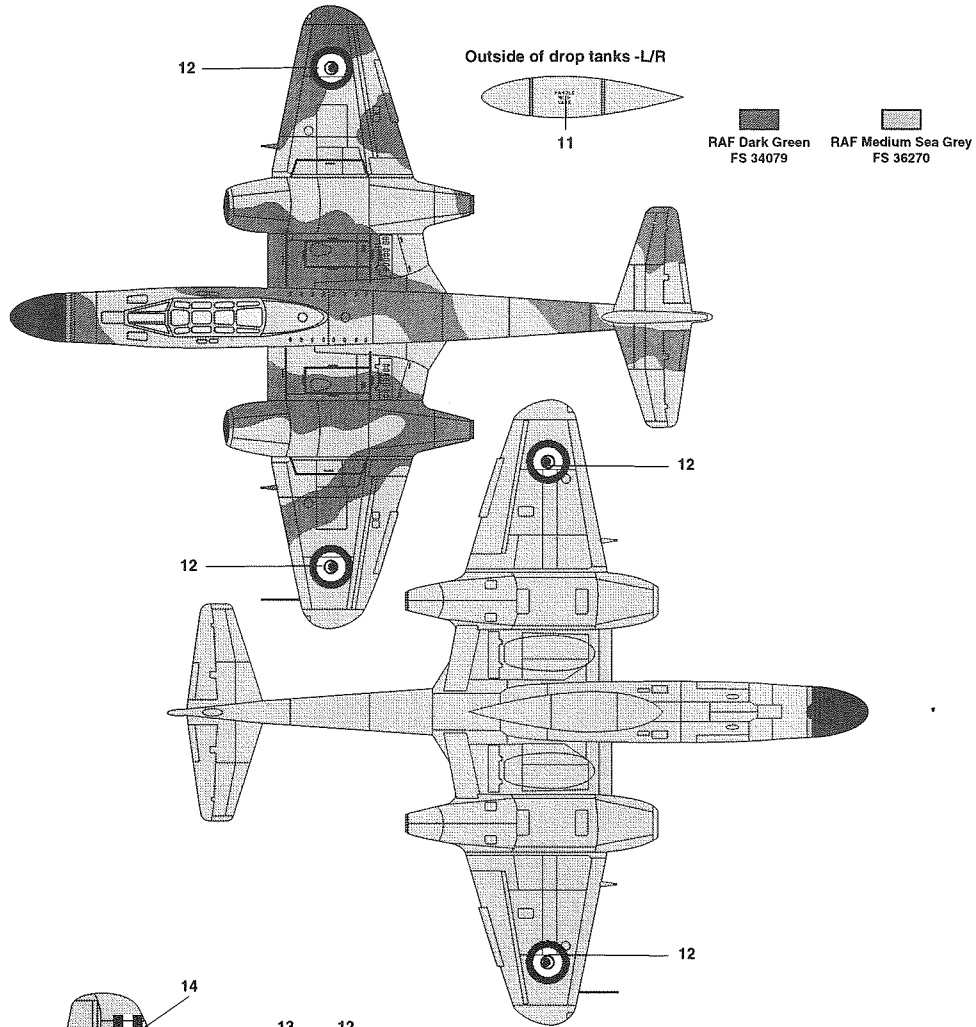
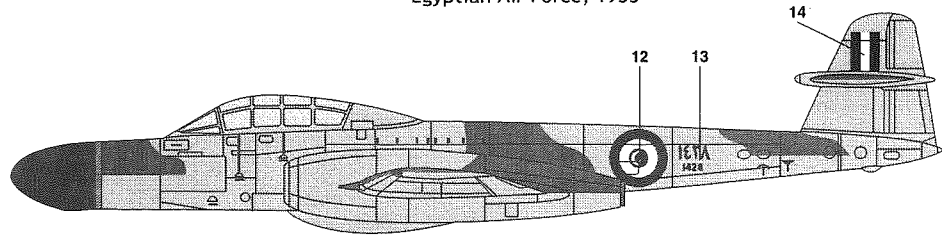

Gloster Meteor NF.11 PAINTING & MARKING GUIDE

5 Squadron, RAF Laarbruch, Germany, 1959

