

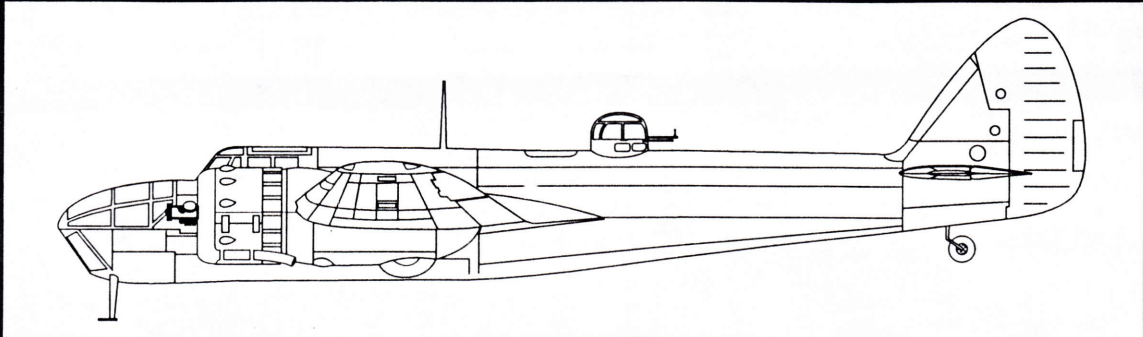

Classic Airframes



Bristol Blenheim Mk. IV / IVF

The Bristol Blenheim first flew in June 1936; initial deliveries of the Mk I version to RAF squadrons began in mid-March of 1937. The Blenheim immediately aroused much excitement with its high speed and modern appearance and went a long way to create the belief that the RAF had a world class light bomber. No fewer than 28 RAF squadrons were equipped with this type. However by the outbreak of WW II, few Mk Is remained in service with home based bomber squadrons, having been superseded by the Mk IV.

Their usefulness was by no means ended. About 200 were converted to serve as fighters and designated Mk IF with a special gun pack fitted to carry four .303 caliber machine-guns. The type was also used for training with OTUs.

The design of the Blenheim probably peaked with MK IV version, which was also produced in Canada under the name of Bolingbroke. Deliveries of this type commenced in March 1938 and was used by more than 70 squadrons. The Mk IV bore the brunt of the Bomber Command's "Daylight campaign" until replaced by Bostons and Mosquitos in 1942. This version was also used as a night fighter, designated Mk IVF.

The last development of the Blenheim was the Mk V, briefly known as the Bisley. This version however was seriously underpowered and it suffered accordingly when it went into action in the summer of 1942 on the Mediterranean Theater and in the Far East.

The Blenheim created much interest in foreign countries and was used by Canada, Finland, Greece, Portugal, Rumania, South Africa, Yugoslavia, Croatia and the Free French.

Classic Airframes would like to acknowledge contributors to making this kit a reality: Mr. Richard Franks, Mr. Jim Maas, Mr. George Silhanek and Mr. John Valo.

Thank you all in helping to create the first injection-molded 1/48th kit of the Bristol Blenheim Mk. IV.

Blenheim Mk. IV Specifications

Powerplant:	Two 995hp Bristol Mercury radial engines	Armament:	One .303 Browning mg in port wing, one/two .303 Vickers K or one/two Browning .303 mgs in turret.
Wing Span:	56' 4"		Bombload 1000 lbs.
Length:	42' 7"		Mk. IV carried one/two rear facing .303 Browning mgs.
Maximum Speed:	266 mph		Mk. IVF carried four Browning .303s in belly pack.

This model kit is intended for experienced modelers. The nature of limited-run kits such as this require additional time and effort to clean up and fit the parts, as well as experience with the various media utilized to provide the most accurate effect on the finished model. Use CyA ("super") glue to assemble Resin (PU) parts.

Classic Airframes • A Division of Bringuier Aviation Products
P.O. Box 577580 Chicago, IL 60657-7580 USA

Assembly Instruction Symbols



Paint Reference Guide

A Interior Green FS 34226

C Aluminum _____

E Light Tan (Buff) FS 33711

B Night (Black) FS 37030

D Rusty Brown _____

F Gunmetal _____

Parts

PLASTIC PARTS

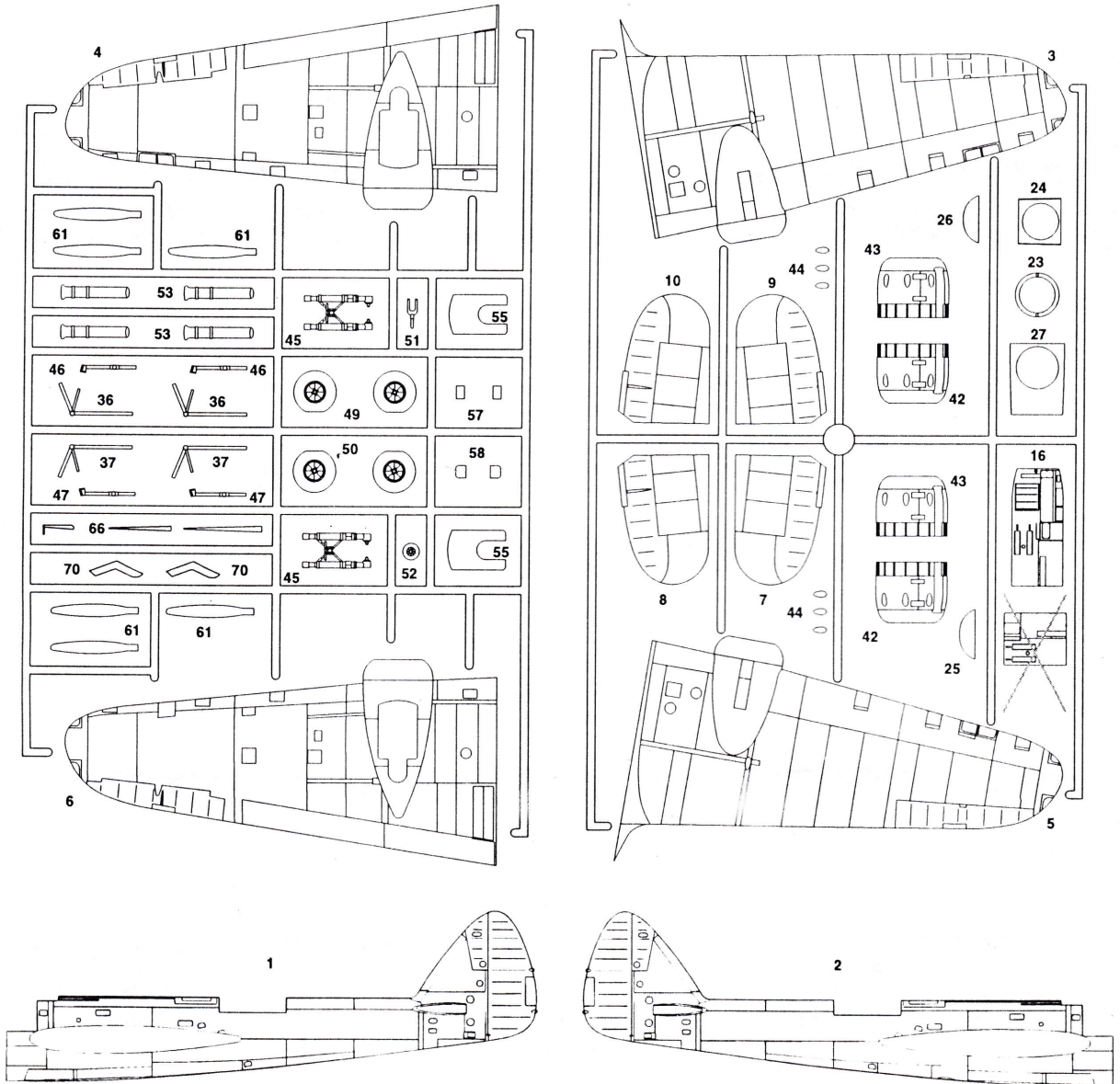

RESIN PARTS

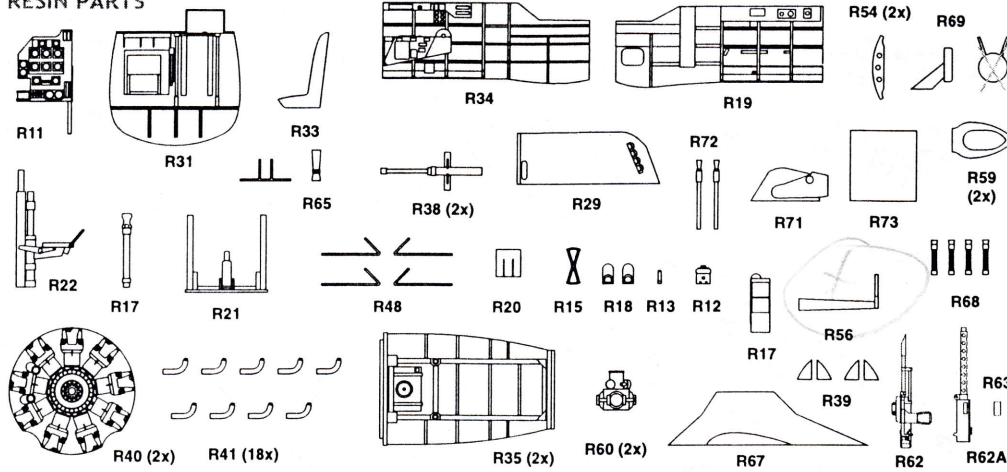

CLEAR PARTS

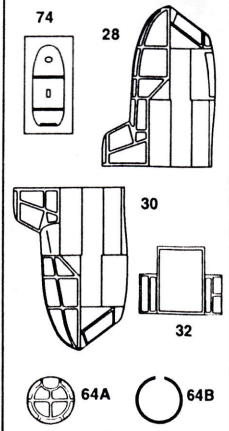

1 Instrument panel (part R11) and top of console (part R17) are Satin Black with Silver details

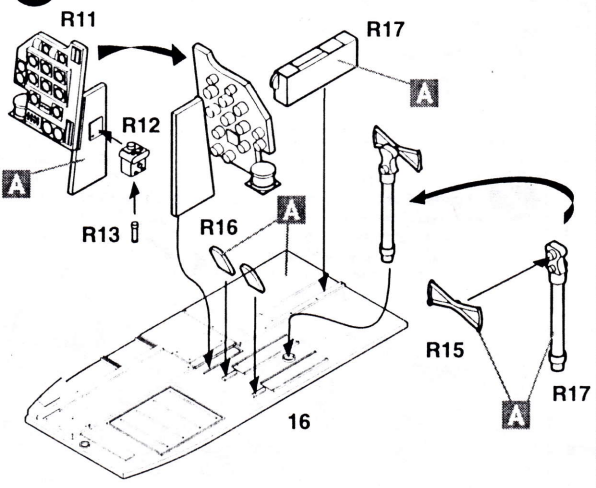

2

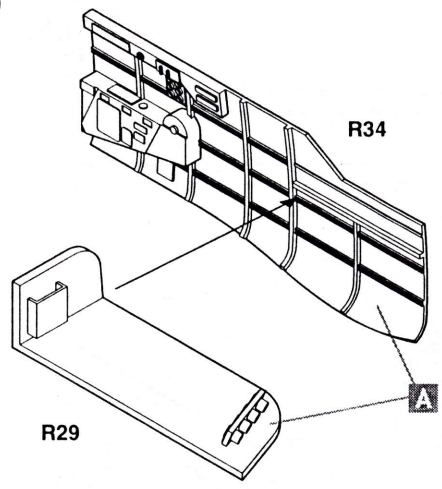

3

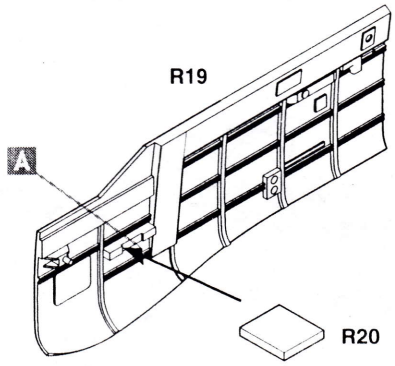

4

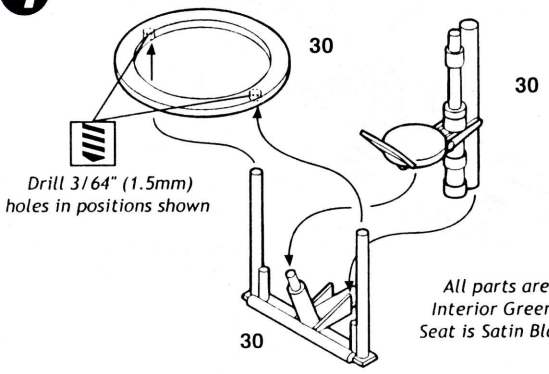

5

Paint inside canopy frames
Interior Green

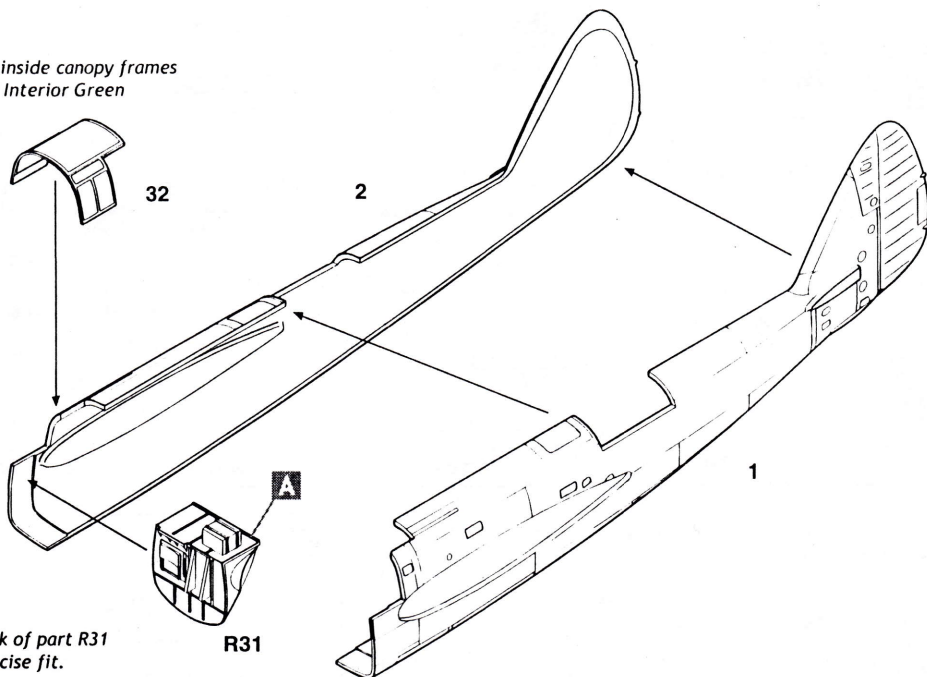

Trim excess resin from back of part R31
as necessary for a precise fit.

6

R33

A**E**

Belts



R69

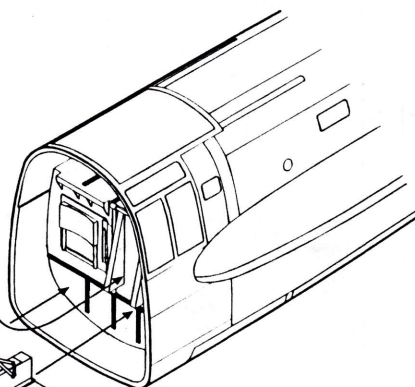

Seat cushion is Satin Black
or Satin Brown

7

NOTE

Coastal Command aircraft
occasionally mounted a 'K' gun
offset as shown in a gimbal mount.
You may use the second 'K' gun
provided for this purpose.

Paint inside canopy frames
Interior Green

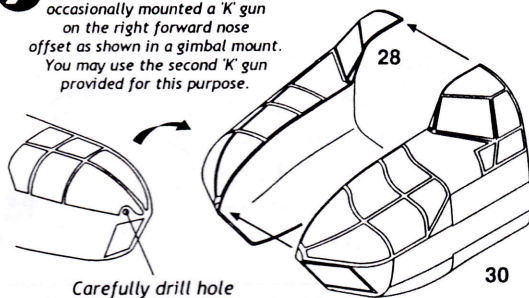
**8**

27

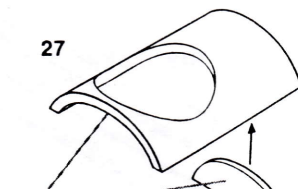

26

25

24

9

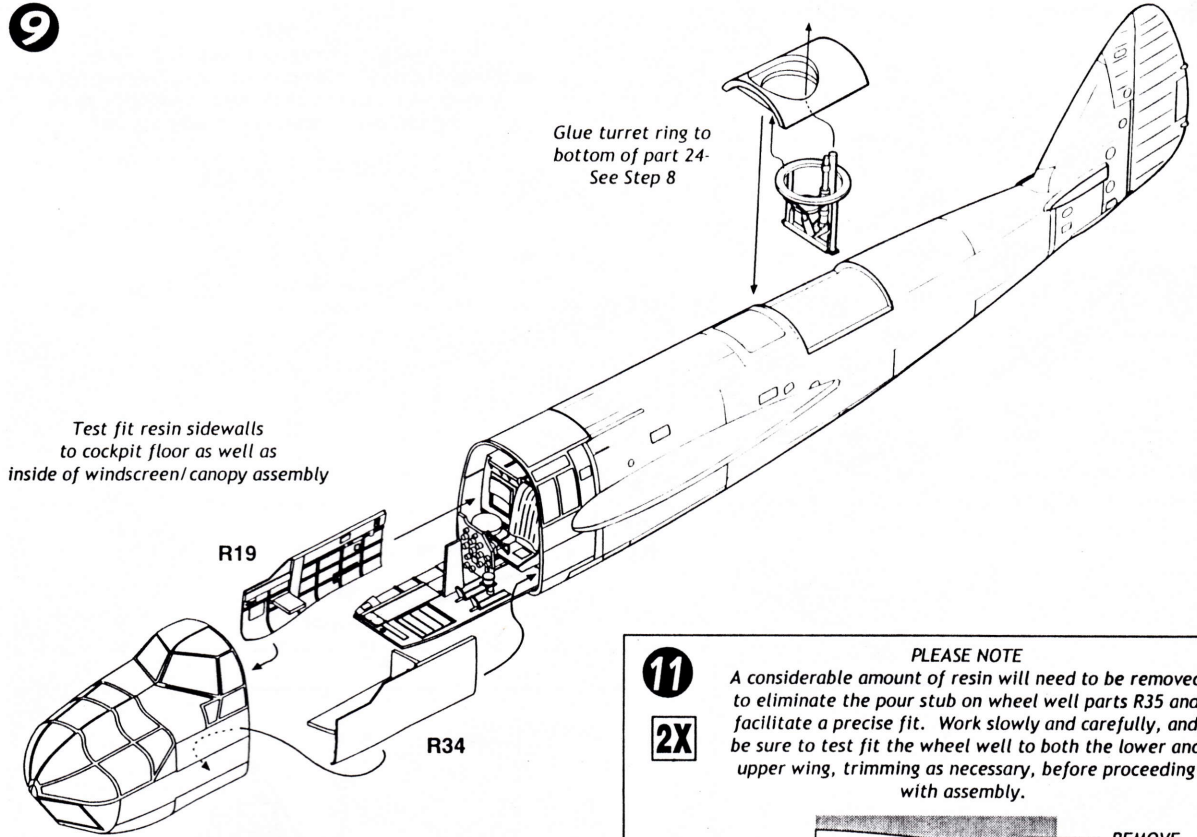

10

2X

NOTE

Blenheims were equipped with an exhaust collector which made up the front of the cowling. The small exhausts (parts R41) should be attached to the cylinders, then adjusted to touch the inside of the front cowling. This may be facilitated by use of a slower setting CyA glue or epoxy. As an alternative, you may find it easier to substitute lengths of flexible wire or tubing for parts R41.

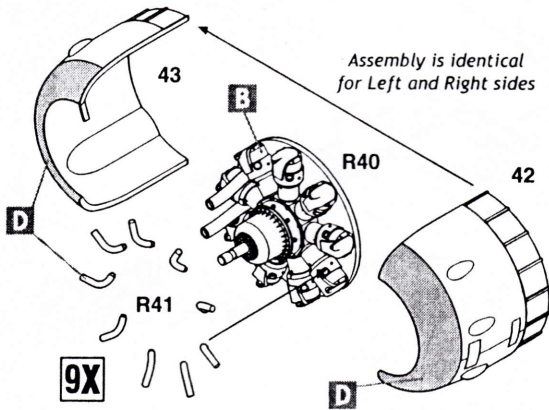

11

2X

PLEASE NOTE

A considerable amount of resin will need to be removed to eliminate the pour stub on wheel well parts R35 and facilitate a precise fit. Work slowly and carefully, and be sure to test fit the wheel well to both the lower and upper wing, trimming as necessary, before proceeding with assembly.

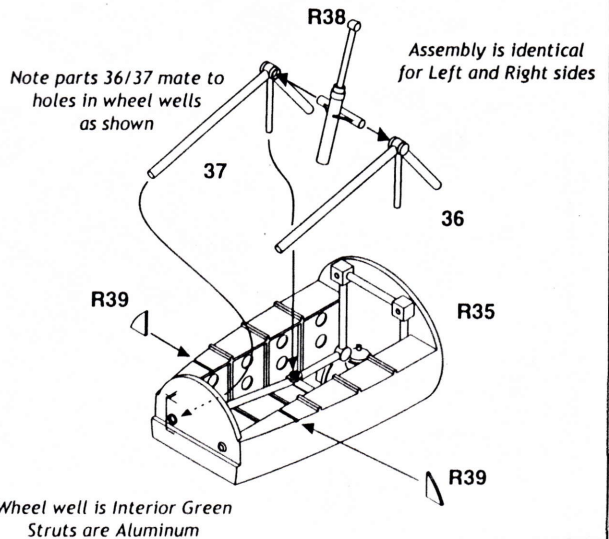
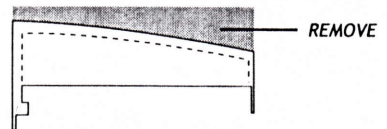

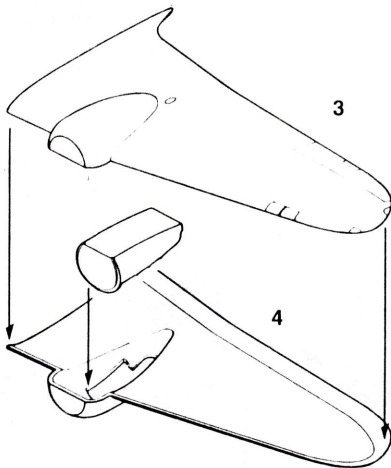
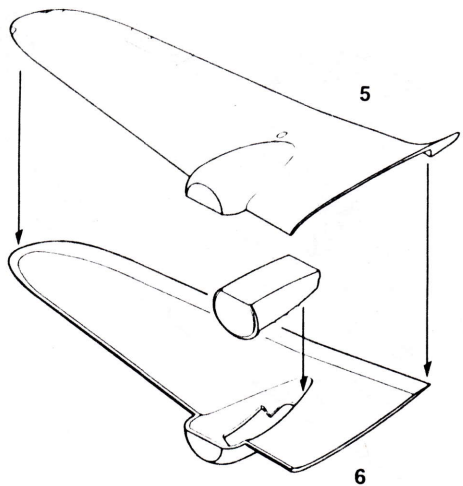
12

NOTE
Align rear bulkhead of wheel wells with the rear of the opening on the bottom wings. Pay special attention to aligning the wheel well so the landing gear mounts are parallel to the inboard lower wing surface.

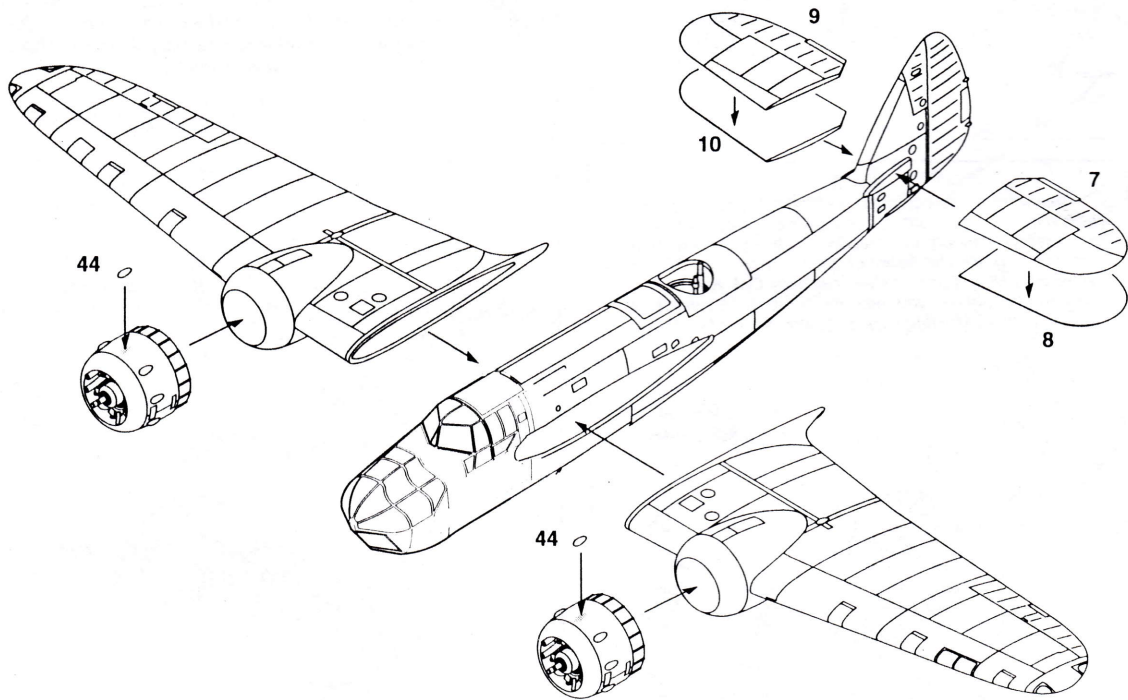
13

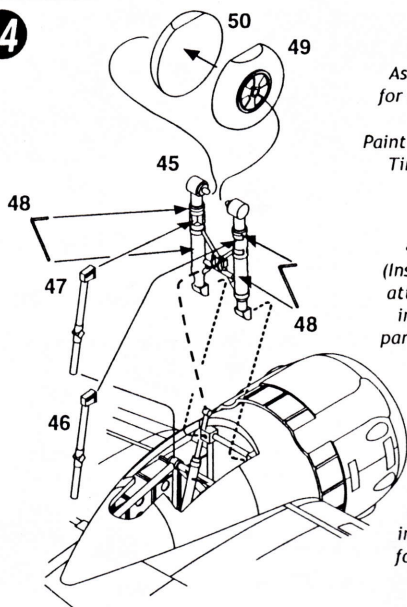
14**2X**

Assembly is identical for Left and Right sides

Paint all parts Aluminum,
Tires flat dark Grey

•End of part 38
(Installed in step 10)
attaches to bracket
in center of 'X' of
part 45 (Dashed line)

•Small stubs on
ends of parts 45
insert into holes in
forward wheel well
bulkhead
(Dotted line)

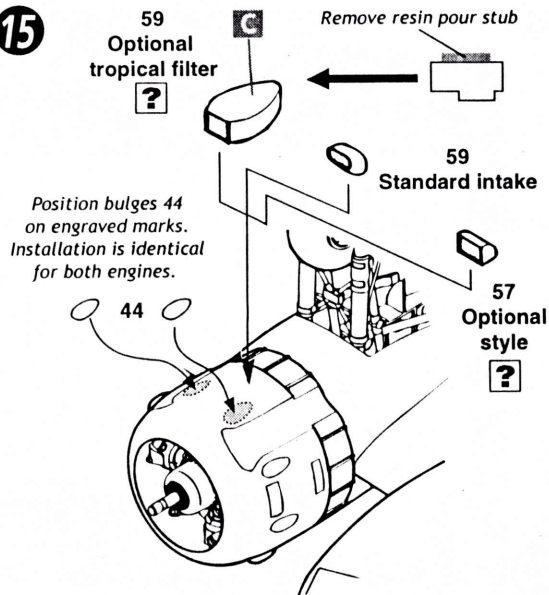
15

59
Optional
tropical filter
?

Remove resin pour stub

59
Standard intake

Position bulges 44
on engraved marks.
Installation is identical
for both engines.

57
Optional
style
?

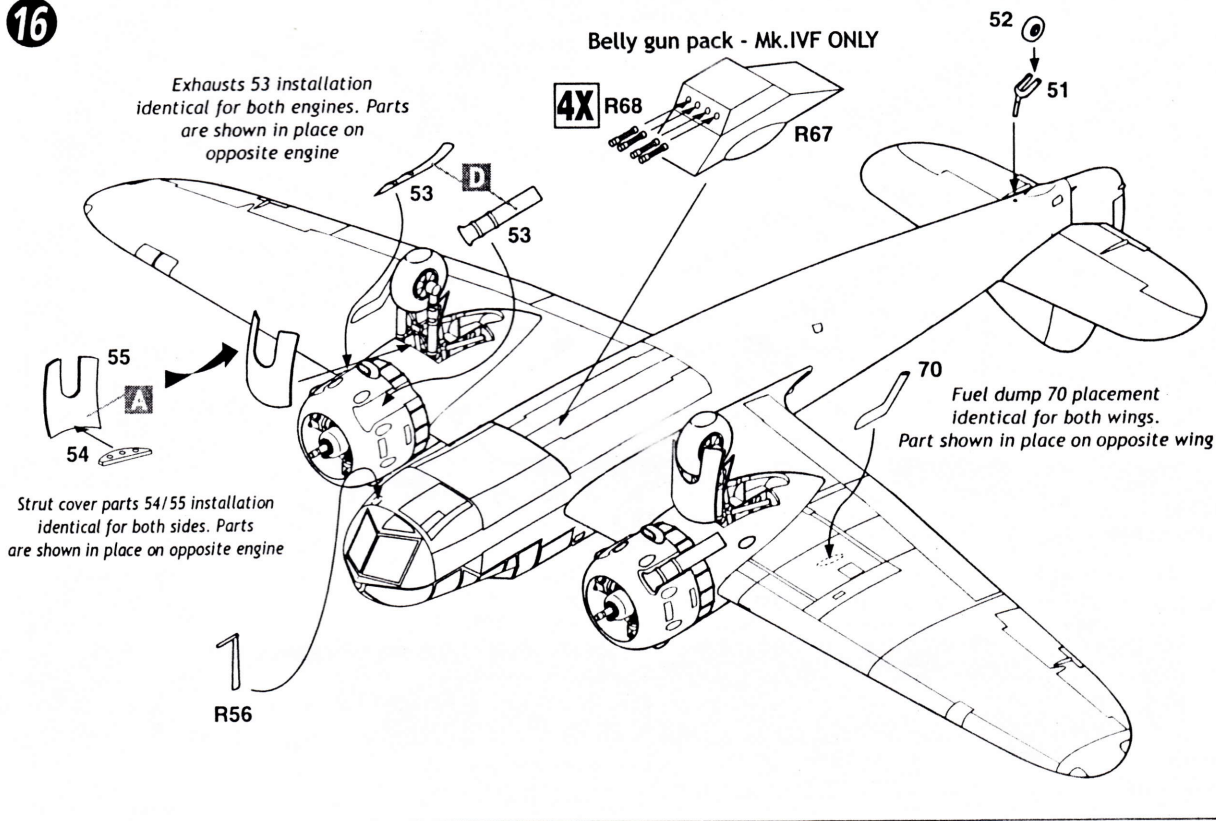
16

Belly gun pack - Mk.IV F ONLY

Exhausts 53 installation
identical for both engines. Parts
are shown in place on
opposite engine

4X R68

R67

52
51

55
54

Strut cover parts 54/55 installation
identical for both sides. Parts
are shown in place on opposite engine

70
Fuel dump 70 placement
identical for both wings.
Part shown in place on opposite wing

R56

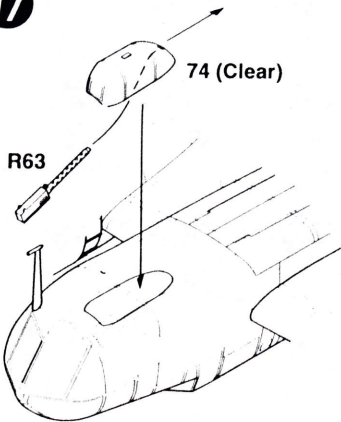
17

Frazer Nash FN-54 early style underside turret
as used on X+GB

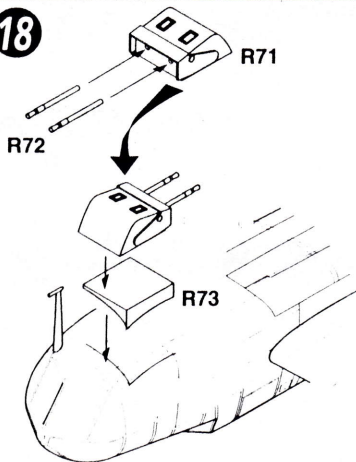
18

Frazer Nash FN-54 late style underside turret
as used on late Mk.IV bombers

19

?

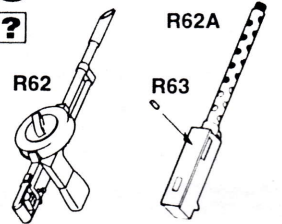

Vickers 'K' Browning .303

Blenheim Mk.IV turret armament originally consisted of one Vickers 'K' gun (R62), later augmented to two. Later Mk.IVs may have been retrofitted with one or two Browning .303 guns (R62A). Check your references for the appropriate choice.

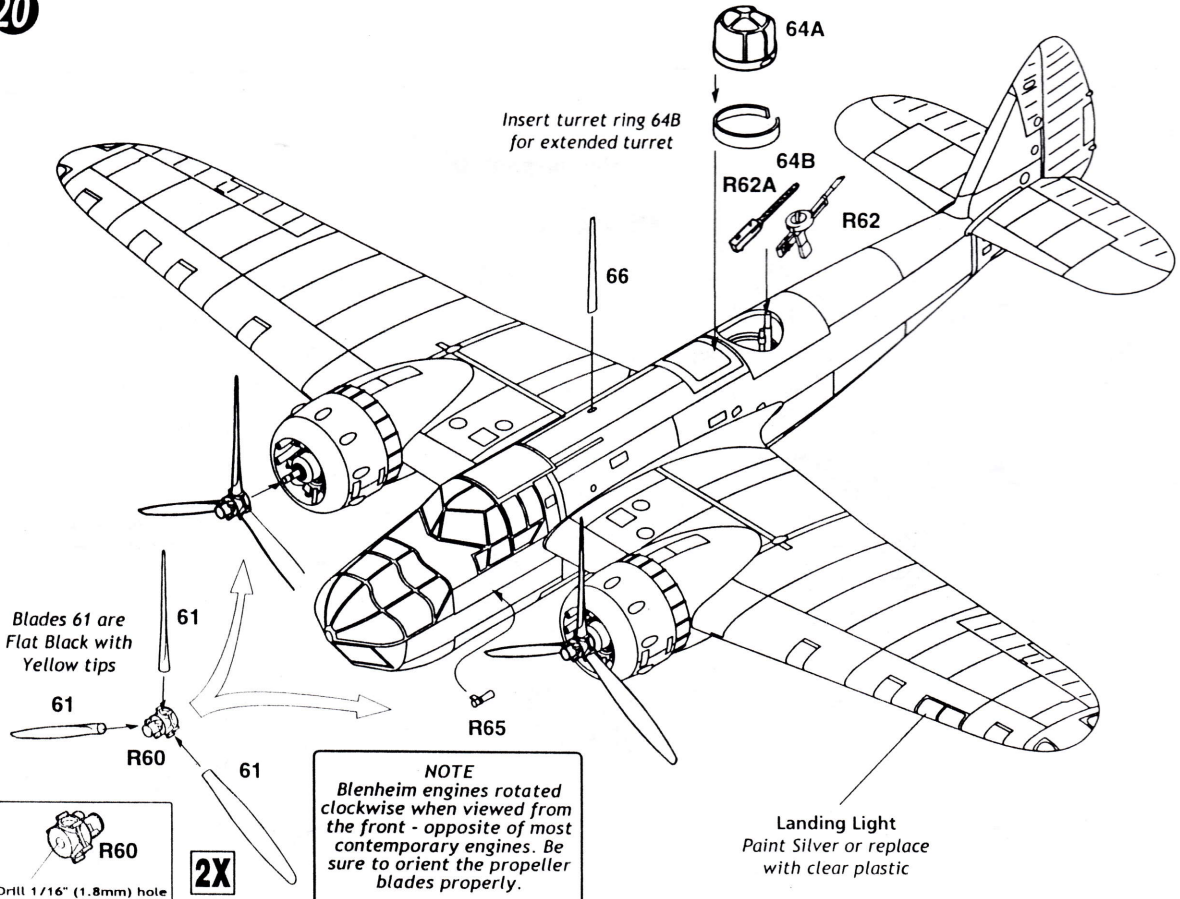
20

Bristol Blenheim Mk. IV *PAINTING & MARKING GUIDE*

No. 105 Squadron, Lossiemouth, late 1941

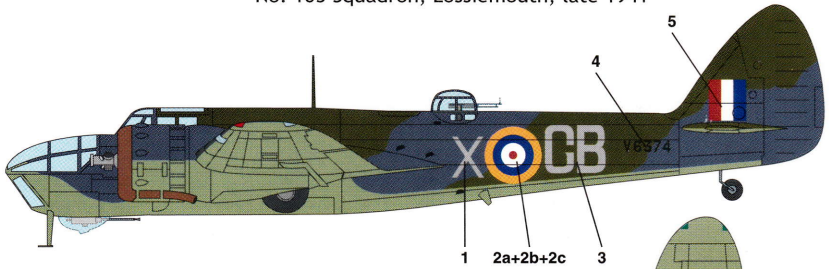

Extra Dark Sea Grey
FS 36118

Slate Grey
FS 34096

Sky
FS 34504

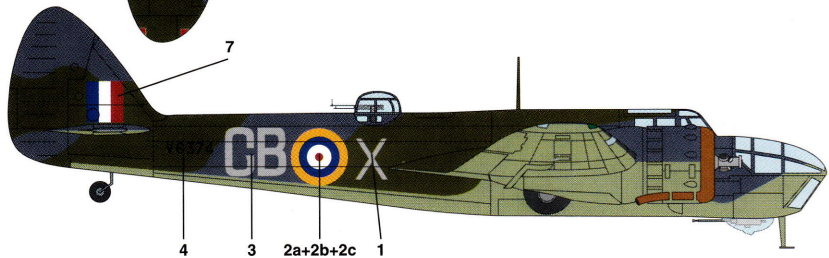
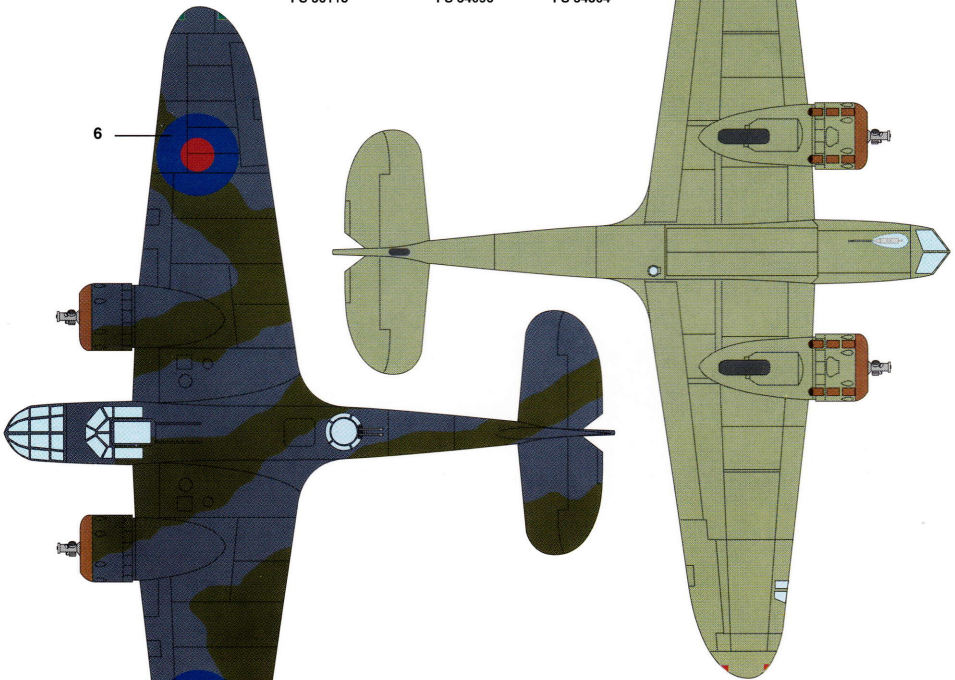

Bristol Blenheim Mk. IVF *PAINTING & MARKING GUIDE*

No. 68 Squadron, High Ercall, 1941

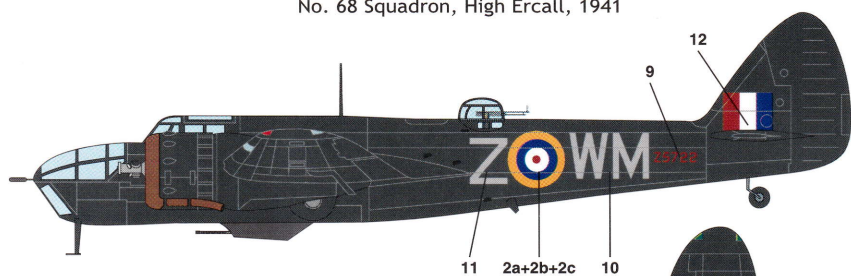

■
Night
FS 37038

