



Reggiane Re 2000GA/ Serie III

CZ

Italské letectvo před druhou světovou válkou velmi dlouho spoléhalo na stíhací dvouplošníky. Odrážely se v tom italské zkušenosti z občanské války ve Španělsku, kde vynikající obratnost Fiatů CR.32 vyvažovala rychlost dolnoplošných I-16. Ale vývoj v okolních státech ukazoval, že budoucnost patří stíhacím jednoplošníkům. Proto Regia Aeronautica vypsala v roce 1938 soutěž na stíhací dolnoplošník s hvězdicovým motorem.

Šéfkonstruktor firmy Reggiane, R. Longi navázal na své zkušenosti z práce u firmy Seversky a pro tuto soutěž připravil návrh Re 2000. Nový stroj jako by z oka vypadal typu Seversky P-35, včetně pětinosníkového křídla tvořícího integrální nádrž paliva. První prototyp MM408 vzlietl poprvé 24. května 1939. V srpnu byl porovnáván se stíhačkami dalších italských firem a s Bf 109E. Údajně obratností překonával i dvouplošný Fiat CR.42 a i dalšími vlastnostmi dominoval. Ale kvůli zranitelnému křídlu s integrálními nádržemi soutěž nevyhrál. Objednány byly další dva prototypy a série 200 ks. Ta byla ale záhy zrušena, i přes to, že výrobce přepracoval křídlo na třinosníkové s klasickými nádržemi.

O Re 2000 projevil zájem zahraniční letectva. Zájem britské RAF zastavilo vypuknutí druhé světové války. Ještě před koncem roku 1939 ale Re 2000 objednáno Maďarsko, podepsána byla i licenční výroba. Sedmdesát kusů bylo vyrobeno v Itálii, dostaly bojové jméno Héja I. Dodávky se protáhly a skončily až s koncem roku 1941. Další stodevadesát jedna Re 2000, s motorem Manfred Weiss WM K-14B a kulometry Gebauer ráže 12,7 mm bylo vyrobeno přímo v Maďarsku. Tyto stroje nesly jméno Héja II. V roce 1940 objednáno velké dodávky italských stíhaček Švédsko, včetně šedesáti kusů Re 2000. Opět italská výroba pokulhávala a poslední Re 2000 byly dodány až v červnu 1942. Dvacet strojů z výrobní linky zabavila Regia Aeronautica. Pět strojů bylo dokončeno jako Re 2000 ser. I, další ve verzi Re 2000 GA s prodlouženým doletem. Část strojů byla přestavěna na verzi Catapultabile, katapultovací verzi určenou jako náhrada Ro 43 a Ro 44.

Italské Re 2000 byly nasazeny hlavně nad Sicílií, při doprovodu konvojů. Podílely se i na útocích proti Maltě. Katapultovací stroje byly testovány z katapultů bitevních lodí, ale nakonec operovaly z pozemních základen.

Maďarské stroje byly nasazeny na východní frontě. V průběhu roku 1942 přestávaly Re 2000 stačit na rostoucí počty letadel protivníka a postupně byly staženy k protivzdušné obraně Maďarska a ke cvičným útvarům. Některé kusy údajně přežily válku a sloužily u cvičných útvarů letectva Maďarské lidové republiky až do roku 1959.

Švédské stroje dostaly vojenské označení J-20. Strážily neutralitu jako záchytné stíhací letouny celou válku. Zasahovaly proti narušitelům vzdušného prostoru obou nepřátelských stran. Několik jich bylo v těchto akcích poškozeno nebo ztraceno. Poslední 'válečnou' ztrátou byl Re 2000 sestřelený střelcem německého Do 24 v dubnu 1945, při snaze eskortovat Do 24 do nejbližšího přístavu. Až po konci války v roce 1945 začaly nahrazovat olétané Re 2000 domácí stíhačky FFTV J-22.

Rozpětí: 11 m, délka: 7,99 m, maximální rychlost: 525 km/h, dostup: 10 500 m, dolet: 1400 km (verze Catapultabile), výzbroj: 2x kulomet Breda SAFAT ráže 12,7 mm

EN

Before the outbreak of WW2, the Italian Air Force (Regia Aeronautica) fighter units had been equipped with and relied on biplane machines for quite a long time. Combat experience gained in the Spanish civil war seemed to have confirmed the advantages of such design over modern monoplanes as the excellent manoeuvrability of the Fiat CR.32 more than balanced out the sheer speed of the opposing I-16 fighters. However, the aviation development in neighbouring countries clearly showed that the future would simply belong to monoplane fighters. And thus, in 1938, the Regia Aeronautica issued requirements calling for a low wing, radial engine-equipped fighter design.

Reggiane's chief designer R.Longi, previously employed by Seversky, followed his experience achieved during his stay at the company and proposed a new design called the Re 2000. The machine bore more than a striking resemblance to Seversky's P-35 monoplane, including such features as the five-spar wing with integrated fuel tanks. The first prototype MM408 was taken aloft for the first time on 24 May 1939. In August, it underwent comparative trials with two other Italian fighter designs and a German Bf 109E. Reportedly, it was capable of outmanoeuvring the biplane Fiat CR.42 and its other characteristics were superior too. However, its wing with the integral fuel tanks was clearly prone to fatal combat damage and therefore, the Re2000 did not succeed in the competition. Nevertheless, the company received an order for two more prototypes and a batch of 200 production machines, which was shortly cancelled even though the wing design had been reworked to incorporate just three spars and standard style of fuel tanks.

Several other air forces showed their interest in the type though. The British RAF for example, but the outbreak of the war made that deal impossible. Hungarian military placed an order for the type in late 1939, and even the licence production was signed. Seventy examples were built in Italy, receiving the name Héja I, deliveries took delay and were finished only at the end of 1941. Further 191 airframes were produced in Hungary, equipped with Manfred Weiss WM K-14B powerplant and armed with 12.7mm Gebauer machine guns. These were named the Héja II.

Large numbers of various Italian fighters were requested by Sweden in 1940, including sixty Re2000s. The production in Italy took delays again and so the last examples of the Re2000s did not arrive until June 1942, with twenty of them being seized by Italians for their own force. Five airframes were finished in the standard of the Re 2000 ser.I, some others as the Re 2000 GA with extended range. A few of the machines were converted to so called Catapultabile variety, capable of being catapult launched from battle ships, and meant to replace the Ro 43 and Ro 44 biplanes.

The Italian Re 2000s were mainly deployed in convoy escort missions around the island of Sicily, they took part in attacks against Malta too. The Catapultabile variety was tested first from battle ship catapults, but in the end, they were used from ground bases.

Hungarian Re 2000s were used on the Eastern front, where in 1942 were found inferior to the still increasing numbers of the opposing fighters and were gradually sent back to Hungary to serve with air defence and training units. Several of them supposedly survived until the end of the war and went on to serve with the new Hungarian People's Republic air force training units as long as until 1959.

Swedish machines were known as the J-20. Being used as interceptors, they guarded Swedish neutrality throughout the long war years. They were scrambled against intruding warplanes of both the Allies and Axis air forces, with some of them being damaged or even lost in these missions. The last one to be lost during the war was a J-20 brought down by a gunner of a German Do 24 flying boat in April 1945, when the Swedish pilot was trying to accompany the plane and escort it to the nearest port. Only when the war had been over in 1945, the remaining, war weary J20s were put off service and replaced by new indigenous built FFTV J-22 fighter planes.

Wingspan: 11 m, length: 7.99 m, max. speed: 525 km/h, ceiling: 10,500 m, range: 1,400 km (Catapultabile), armament: twin 12.7mm Breda SAFAT machine gun

Plastic Parts

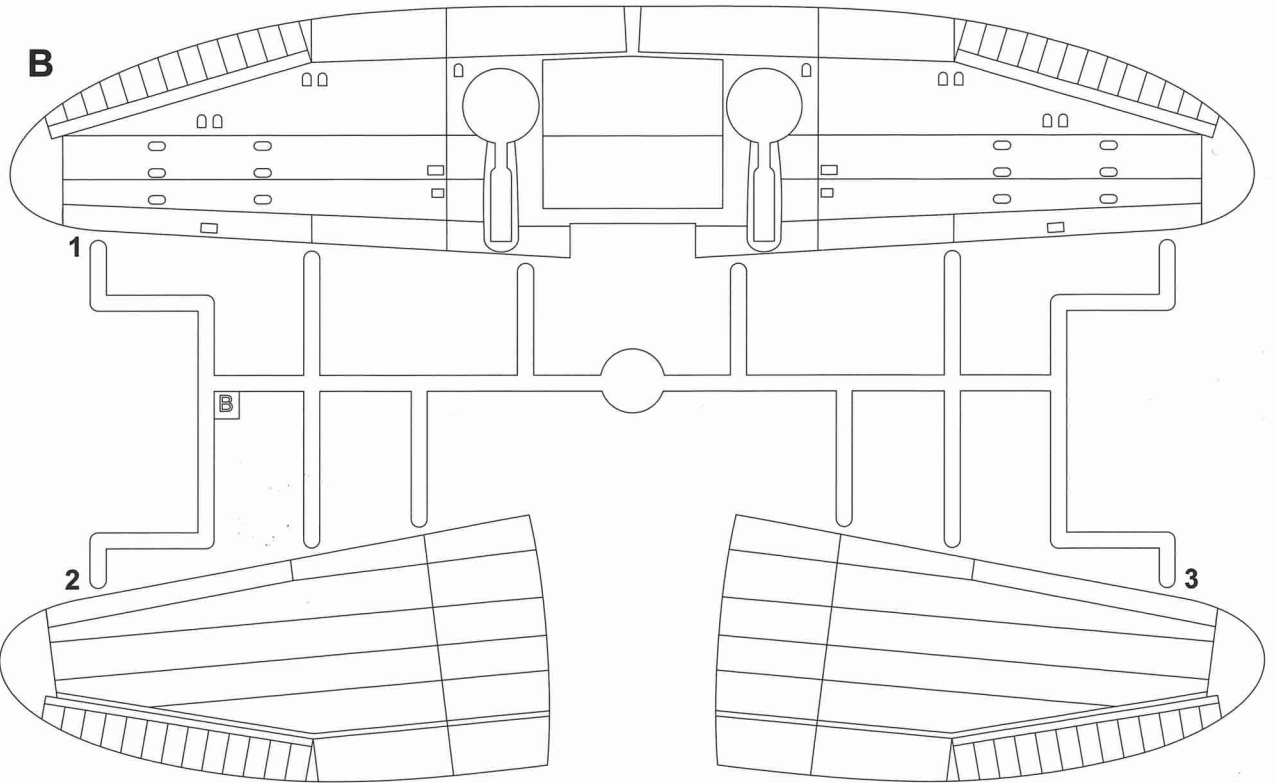
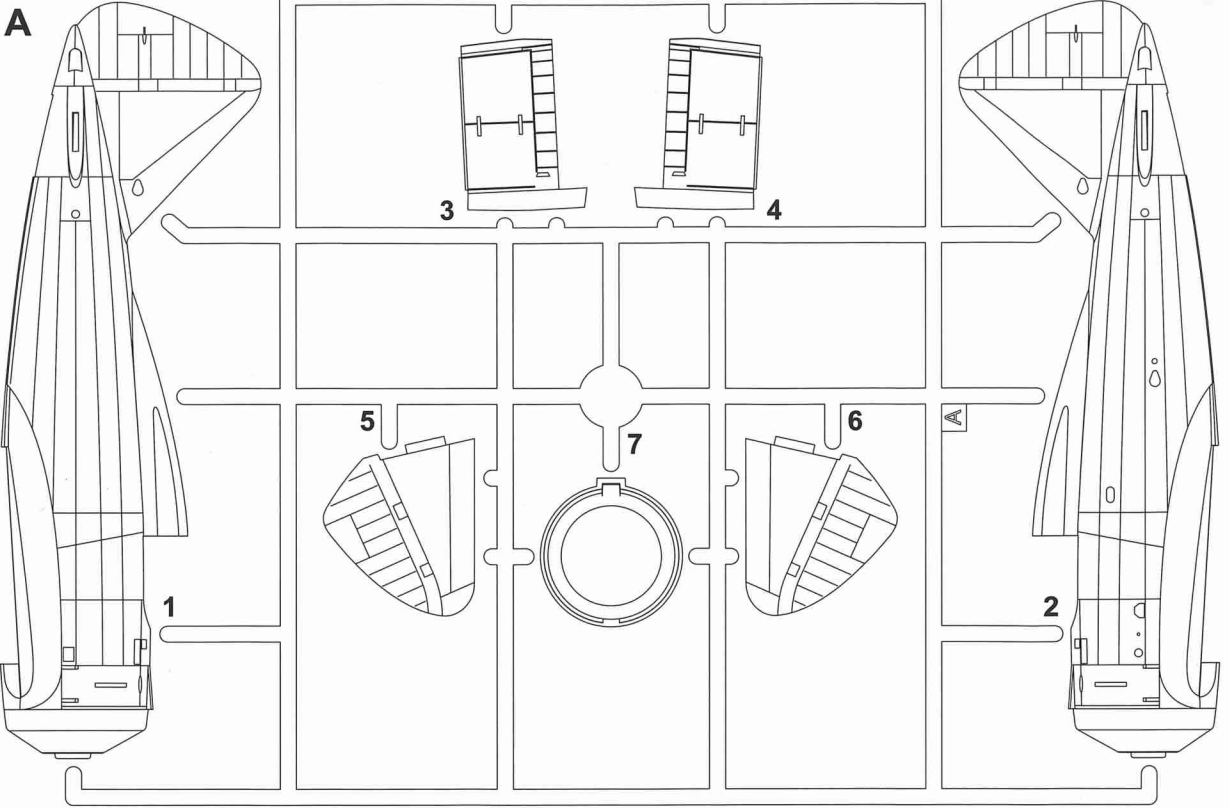

SYMBOLS



MOŽNOST VOLBY
OPTIONAL
NACH BELIEBEN
OPTION



POUŽÍŤ KYANOAKRYLÁTOVÉ LEPIDLO
INSTANT CYANOACRYLATE GLUE
ZYANOAKRYLATKLEBER
COLLE CYANOACRYLATE



OHNOUT
BEND
BIEGEN
COURBER



ZHOTOVIT NOVÉ
SCRATCH BUILD
FERTIGSTELLEN
ACHEVER



ŘEZAT/VRTAT
CUT OFF/DRILL
ENTFERNEN
DETACHER



GSI
colour code

NATRÍT
COLOUR
FARBEN
PEINDRE

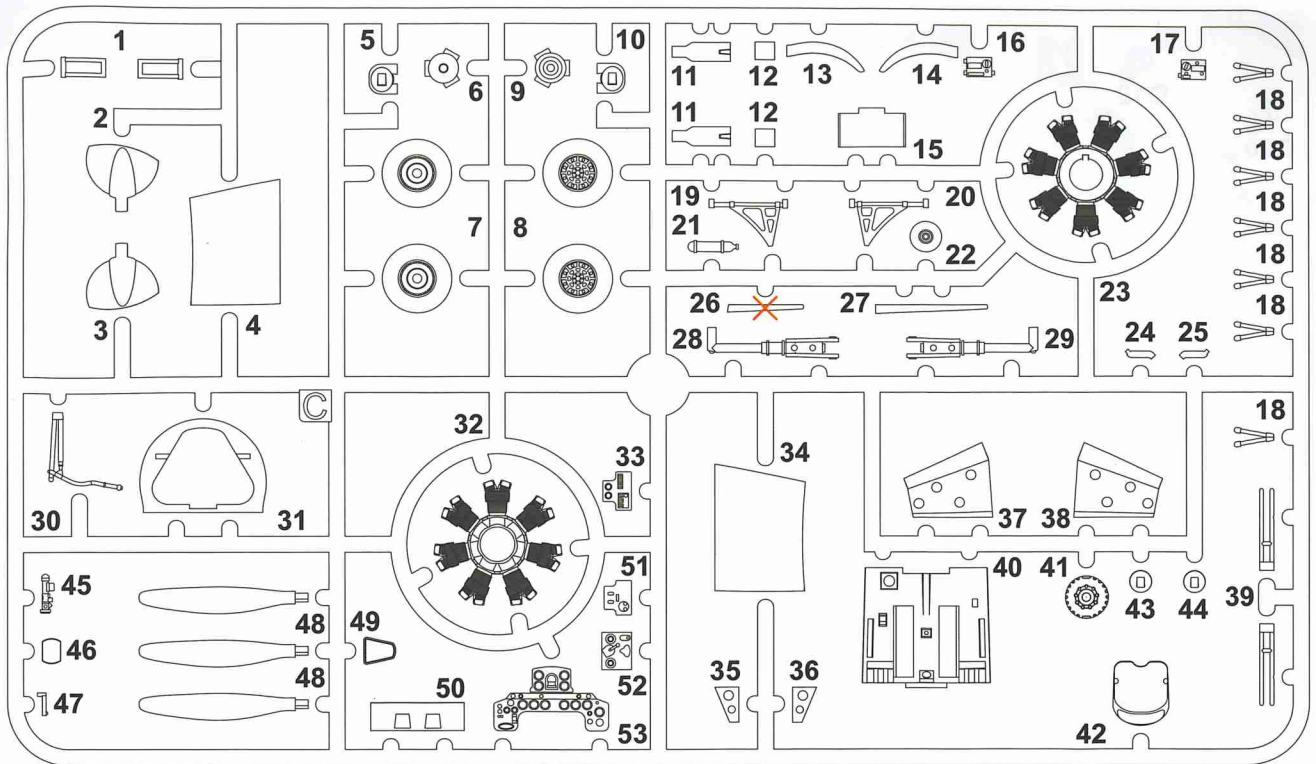

C

 *Tento díl nepoužít*
Do not use this part

D

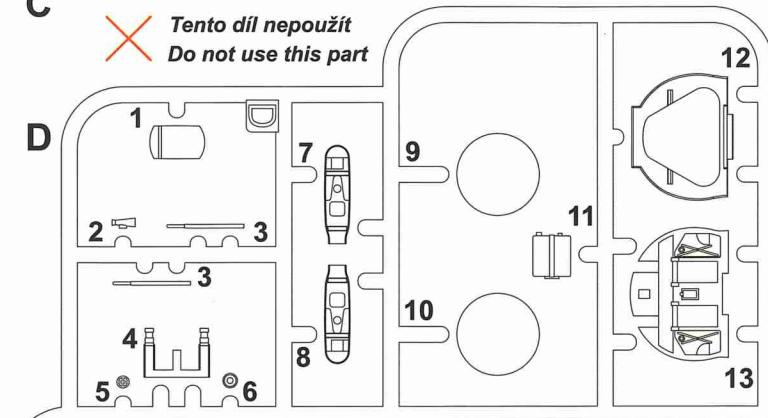

Clear Parts (CP)

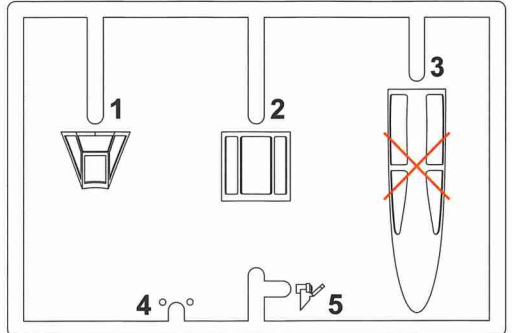

Barvy GUNZE / GUNZE Colour No.

- | | |
|---|--------------|
| A Černá / Black | H12 / C33 |
| B Barva pneu / Tire Black | H77 / C137 |
| C Tmavý kov / Gun Metal | H28 / C78 |
| D Opálený kov / Burnt Iron | H76 / C61 |
| E Hliníková / Aluminium | H8 / C8 |
| F Antikorozi zelená / Anticorrosive Green / Verde Anticorrosione | H74 / C26 |
| | +10% H1 / C1 |
| G Modrošedá / Blue Grey / Grigio Azzurro | H67 / C115 |

If you want to make the build easier and spruce up your Re.2000 we also offer the pre-cut M48003 MASK and CMK resin sets. More at www.specialhobby.eu



Q48371
Main Wheels



Q48372
Tailwheel with
Strengthened Leg



Q48373
Exhausts



Q48374
Headrest

STEP 1

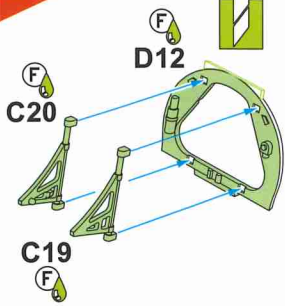

STEP 2

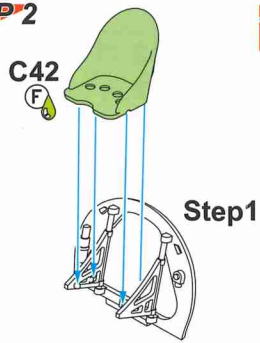

STEP 3

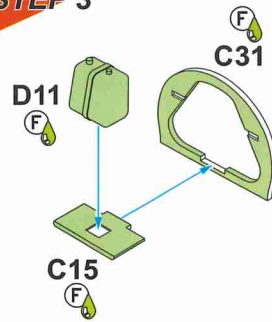

STEP 4

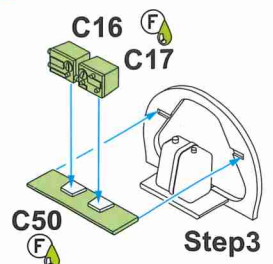

STEP 5

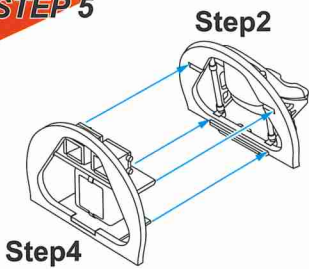

STEP 6

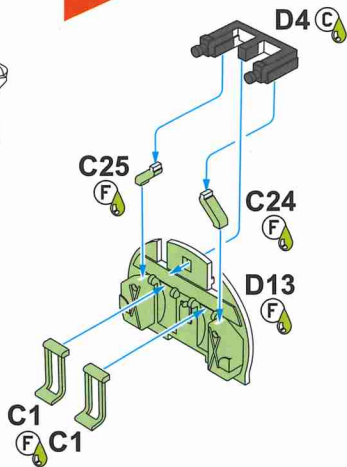

STEP 7

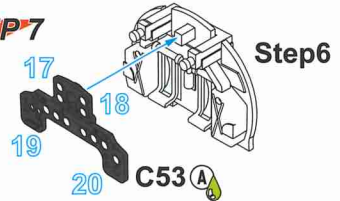

STEP 10

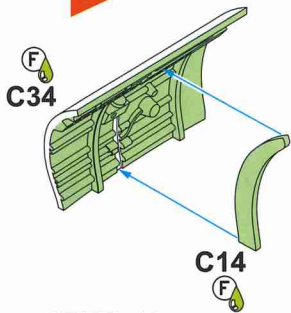

STEP 8

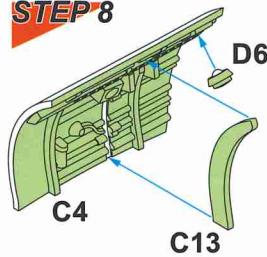

STEP 9

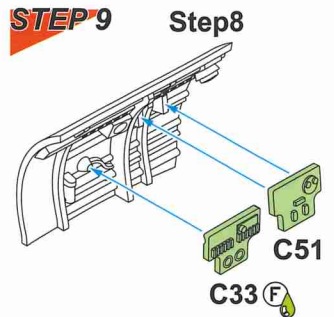

STEP 11

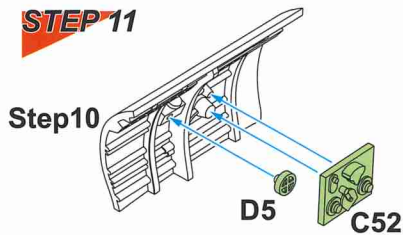

STEP 13

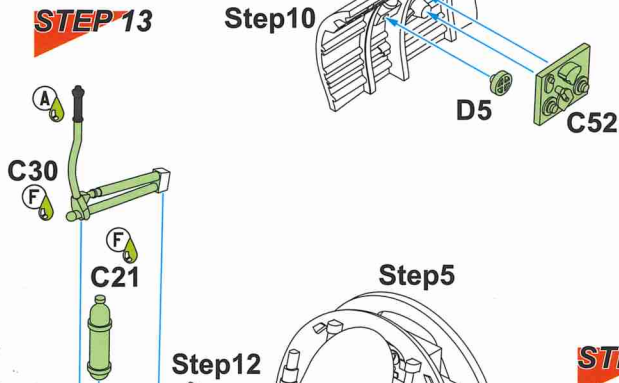

STEP 14

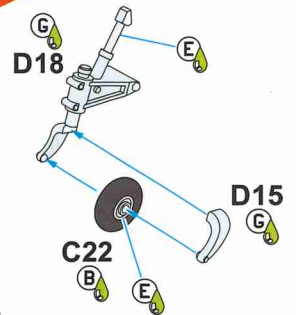

STEP 12

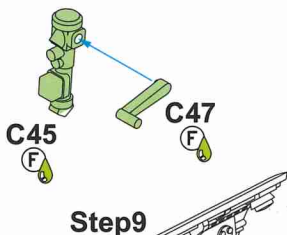

STEP 15

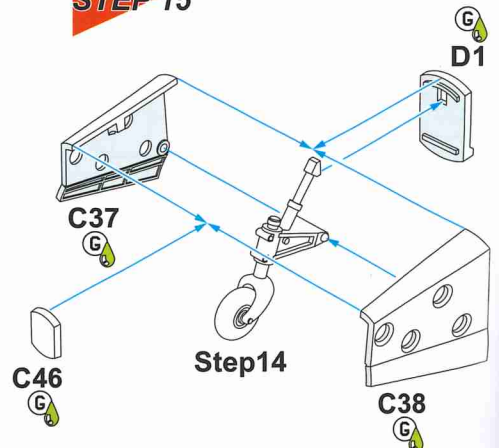

Step7

Step12

Step5

Step11

Step1

Step3

Step6

Step8

Step10

Step14

Step14

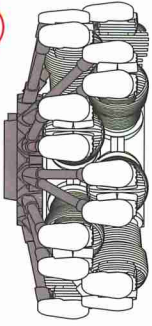

STEP 16

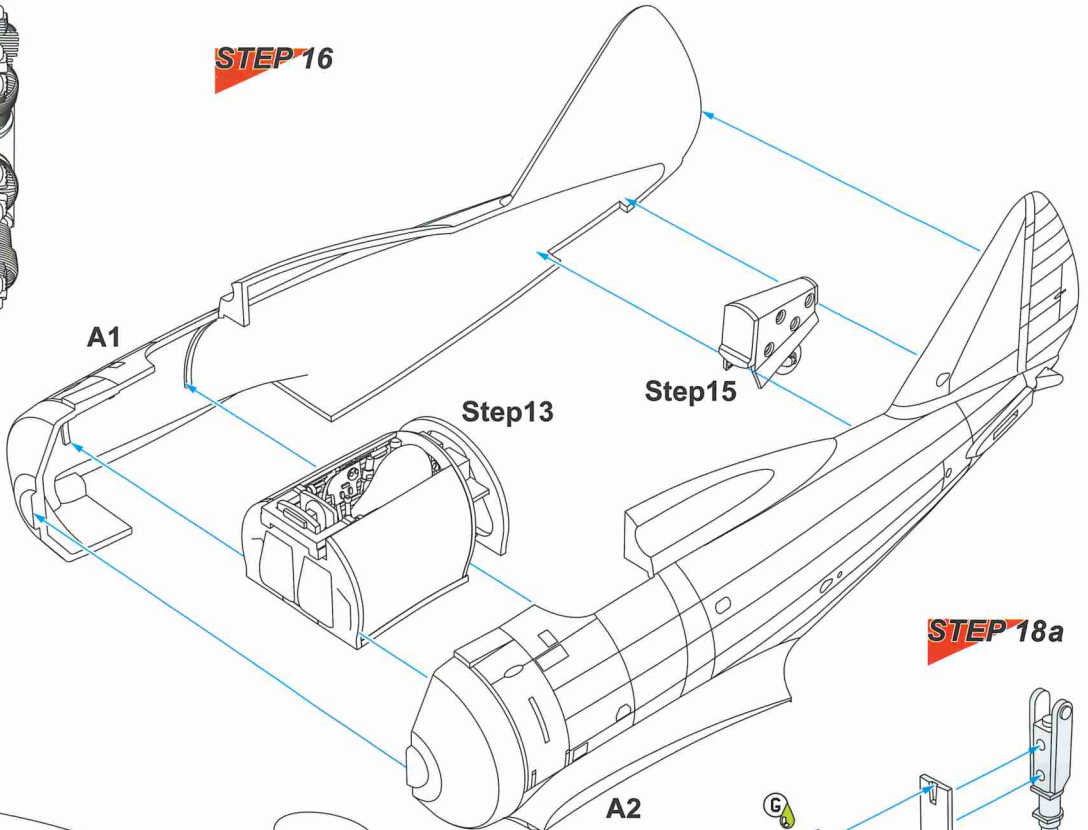

STEP 17

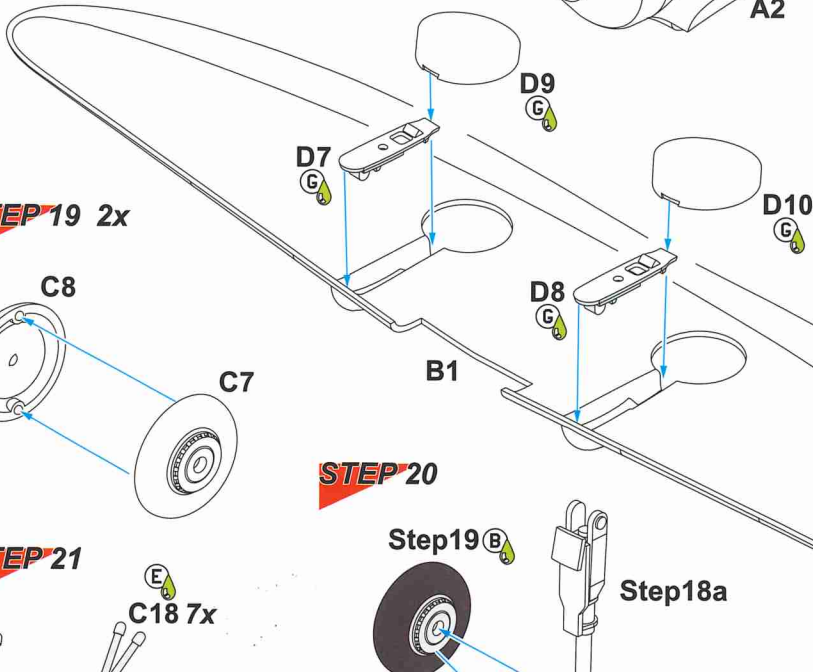

STEP 19 2x

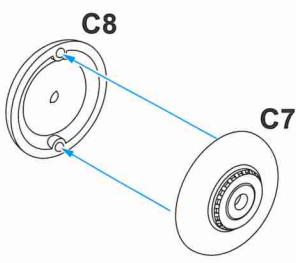

STEP 18a

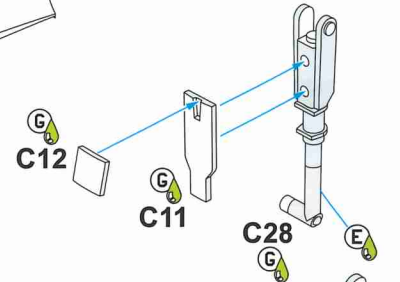

STEP 18b

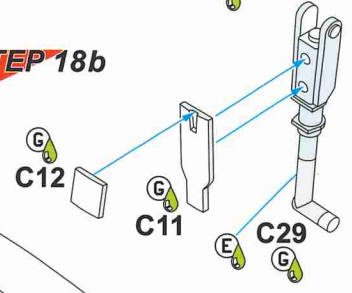

STEP 20

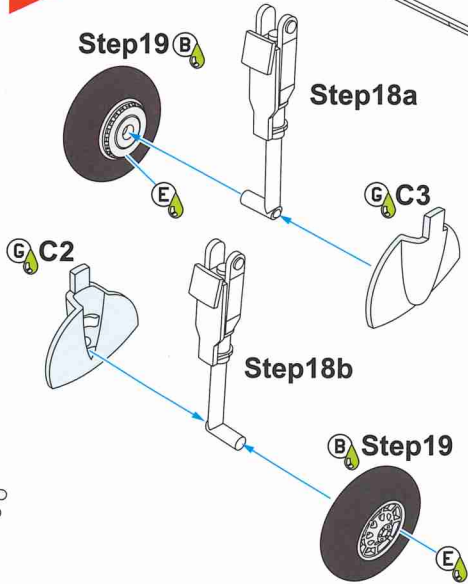

STEP 21

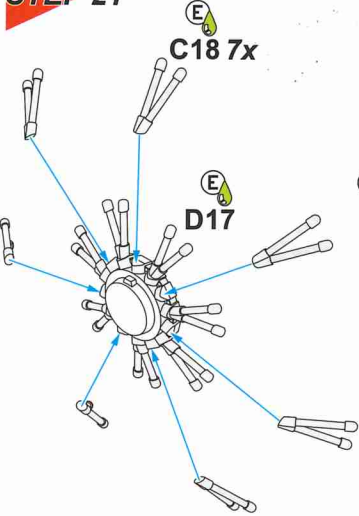

STEP 22

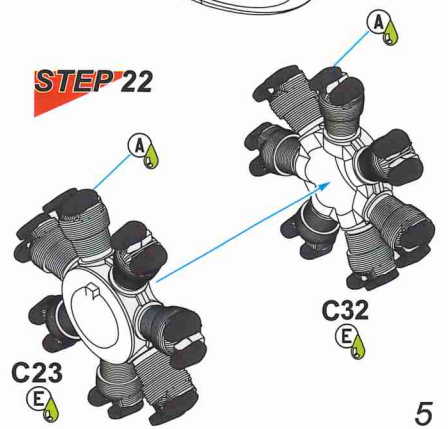

STEP 23

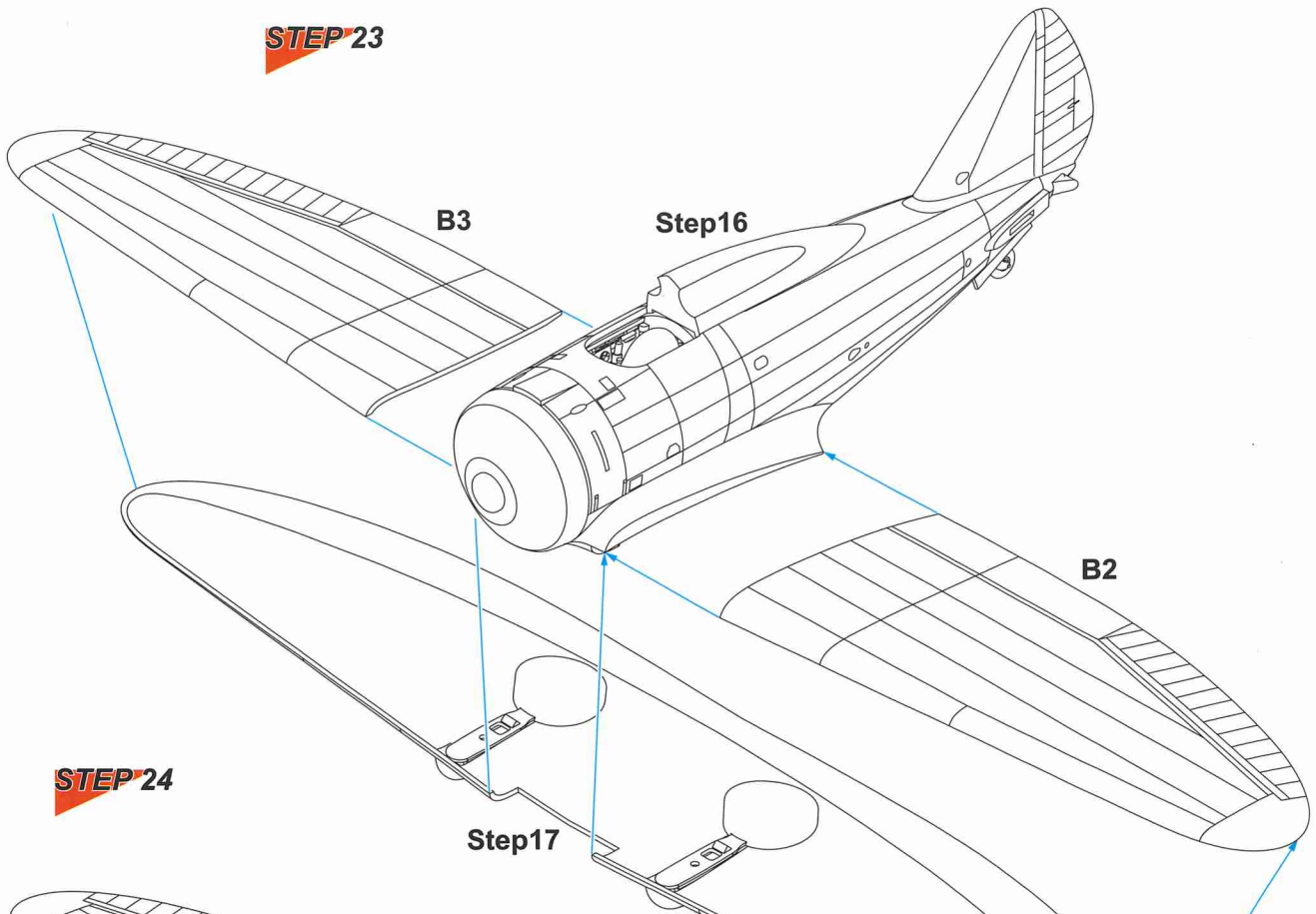

STEP 24

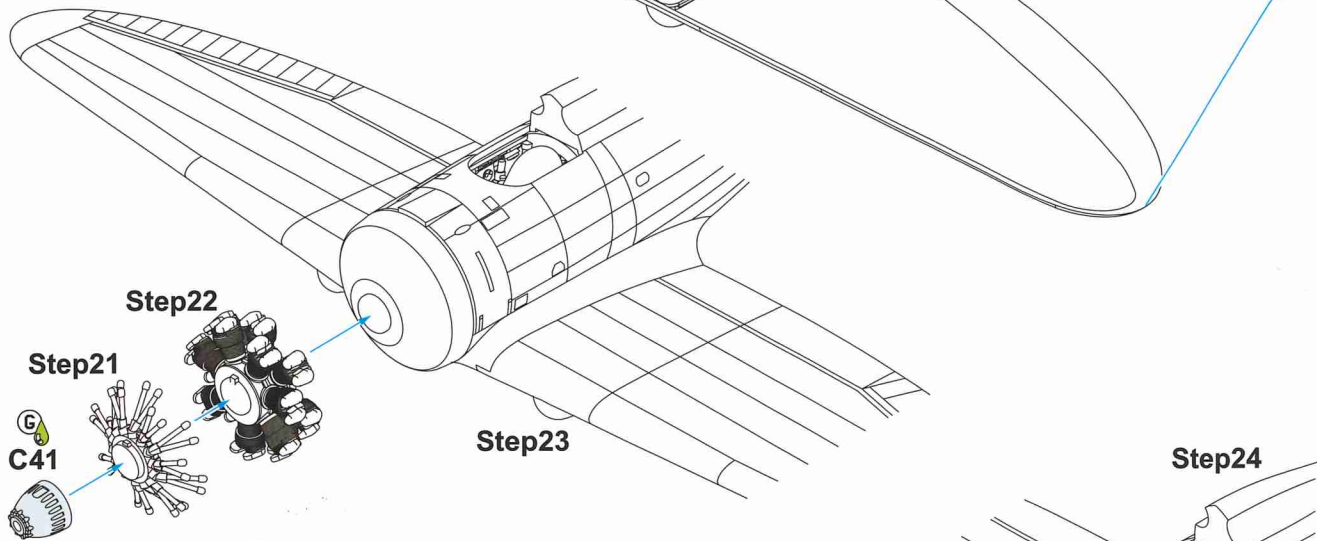

STEP 25

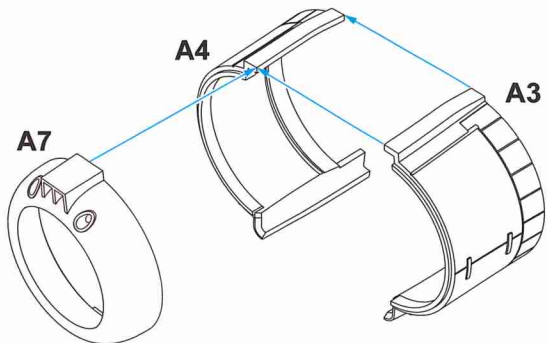

STEP 26

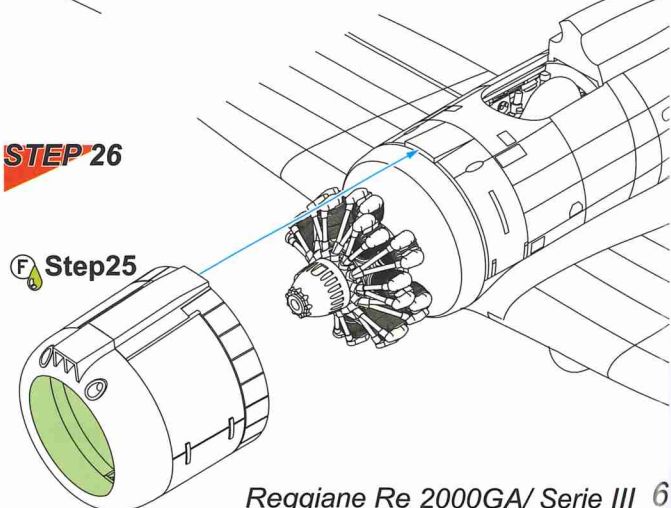

STEP 28



STEP 27

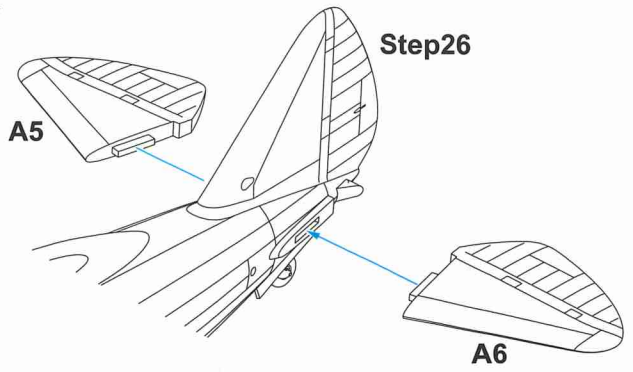

STEP 29

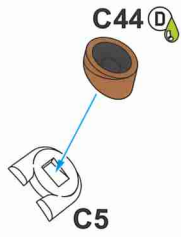

Step27

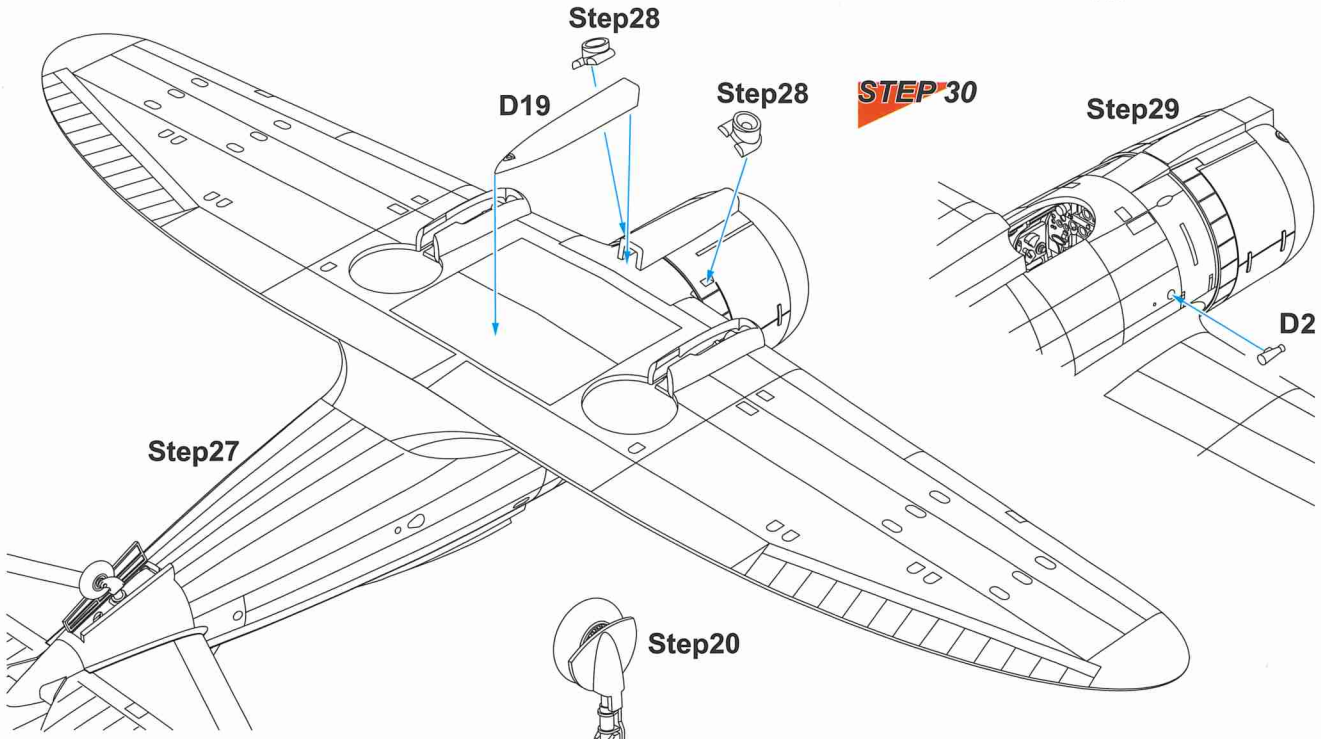

STEP 30

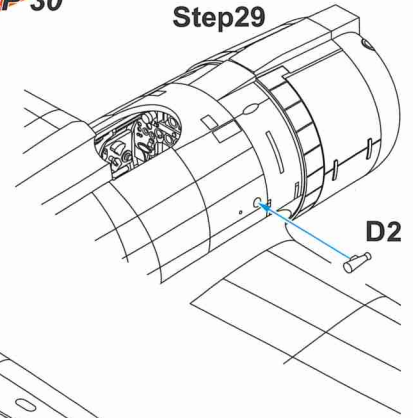

STEP 31

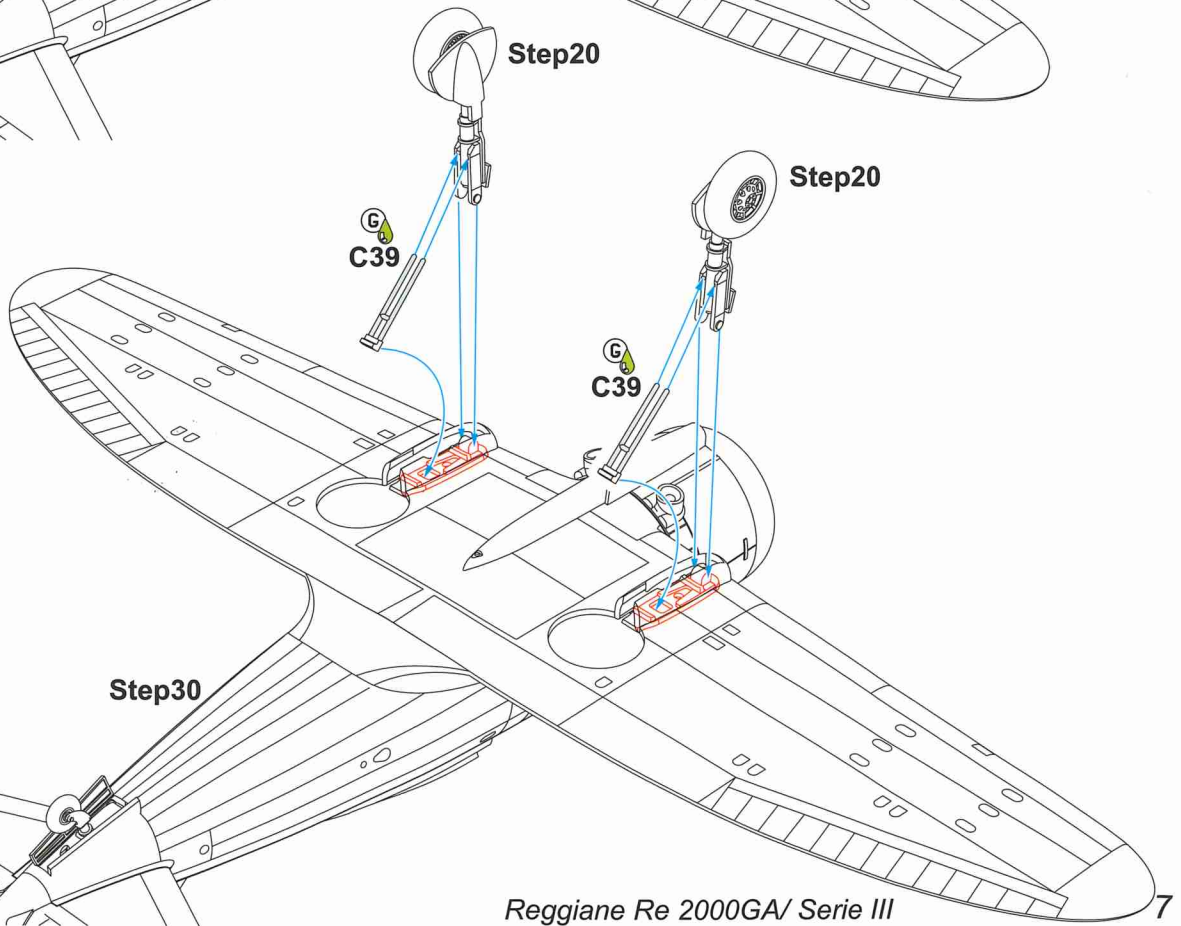

STEP 32

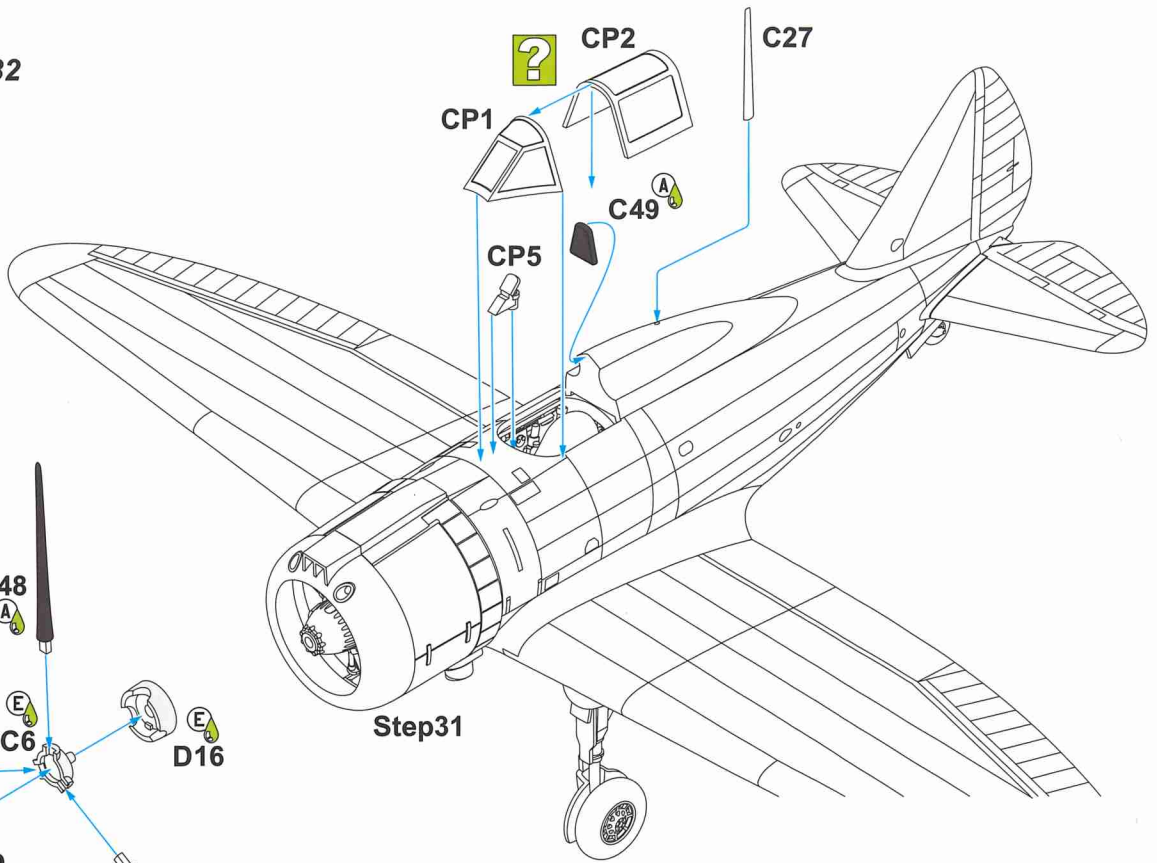

STEP 33

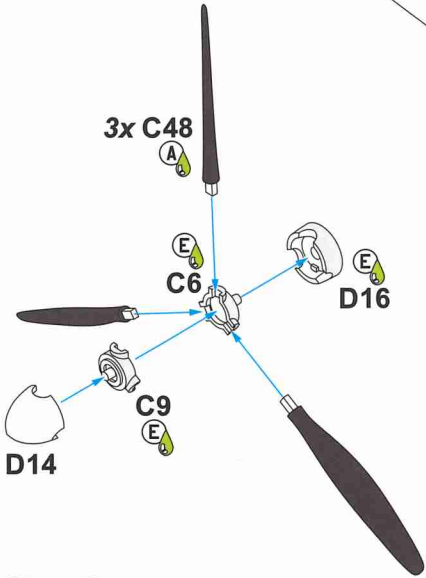

STEP 34

wire 0.2mm



Clear Green
H94/C138

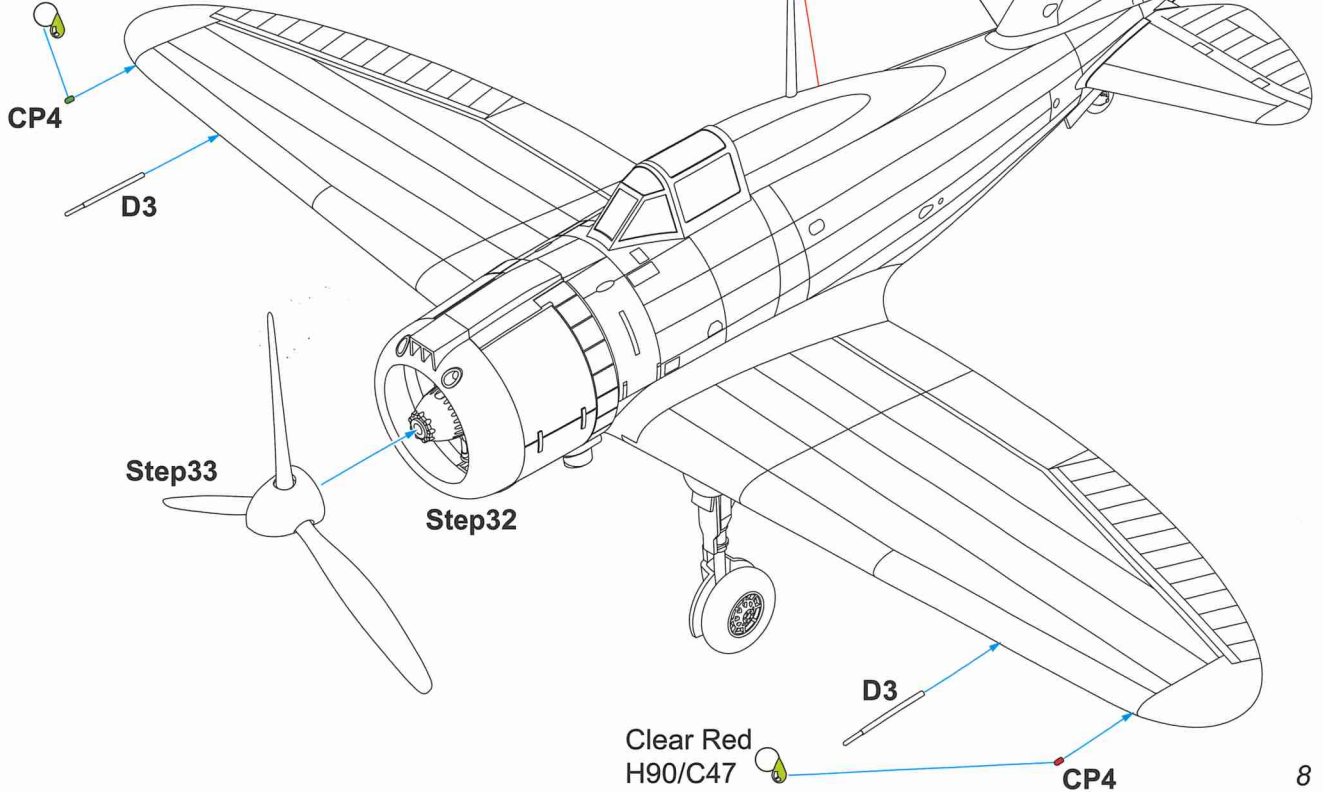

Reggiane Re.2000GA (III. serie), Red 5, unknown MM, 374a
Squadriglia Autonoma Intercettori, based at Boccadifalco, Sicily, Italy,
May 1942.

Reggiane Re.2000GA (III. serie), červená 5, MM.neznámé, 374a
Squadriglia Autonoma Intercettori, základna Boccadifalco, Sicílie,
Itálie, květen 1942.

Scheme A

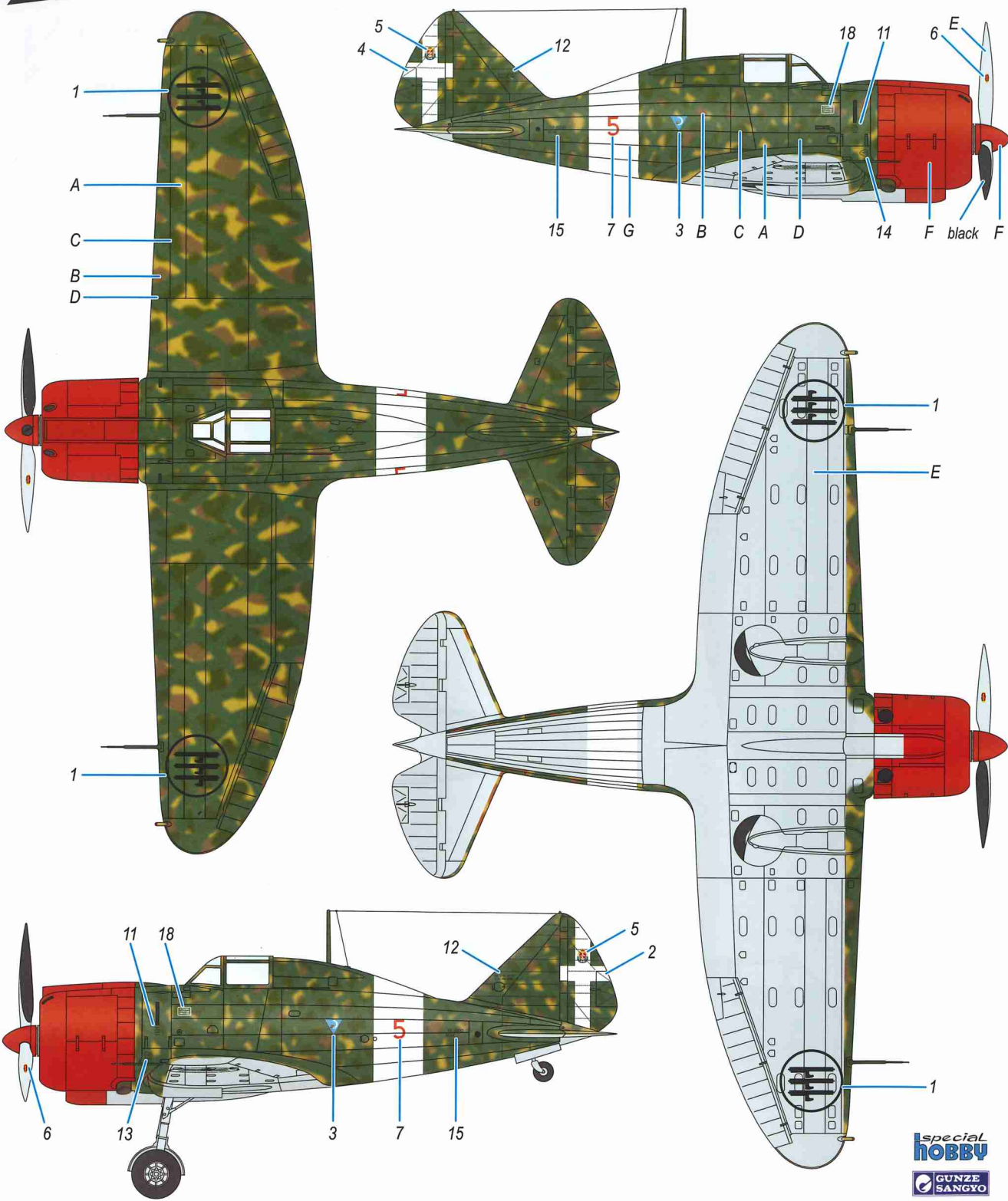

- | | | | | | | |
|---|--|--|--|--|---|---|
| A Giallo Mimetico 3
Sandy Yellow
Pískové žlutá
H79/C39
FS33434 | B Marrone Mimetico 2
Brown
Hnědá
H/C7
FS30109 | C Verde Mimetico 2
Dark Green
Tmavě zelená
H/C302
FS34092 | D Verde Oliva Scuro 2
Dk. Olive Green
tmavě olivově zelená
H78+H60 (2:1)
C38+C18 (2:1)
FS34052 | E Grigio Mimetico
Light Grey
Světle šedá
H/C317
FS36293 | F Rosso 8
Red
Červená
H/C3
FS11105 | G Bianco
White
Bílá
H/C1
FS36293 |
|---|--|--|--|--|---|---|



Reggiane Re.2000GA (III. serie), Red 8, unknown MM, 377a Squadriglia Autonoma CT, Sicily, Italy, May 1942. This unit's aircraft usually flew convoy escorts and ground attack missions against Malta.

Reggiane Re.2000GA (III. serie), červená 8, MM.neznámé, 377a Squadriglia Autonoma CT, Sicílie, Itálie, květen 1942. Letouny této jednotky byly používány k eskortování konvojų a útočné lety proti Maltě.

Scheme B

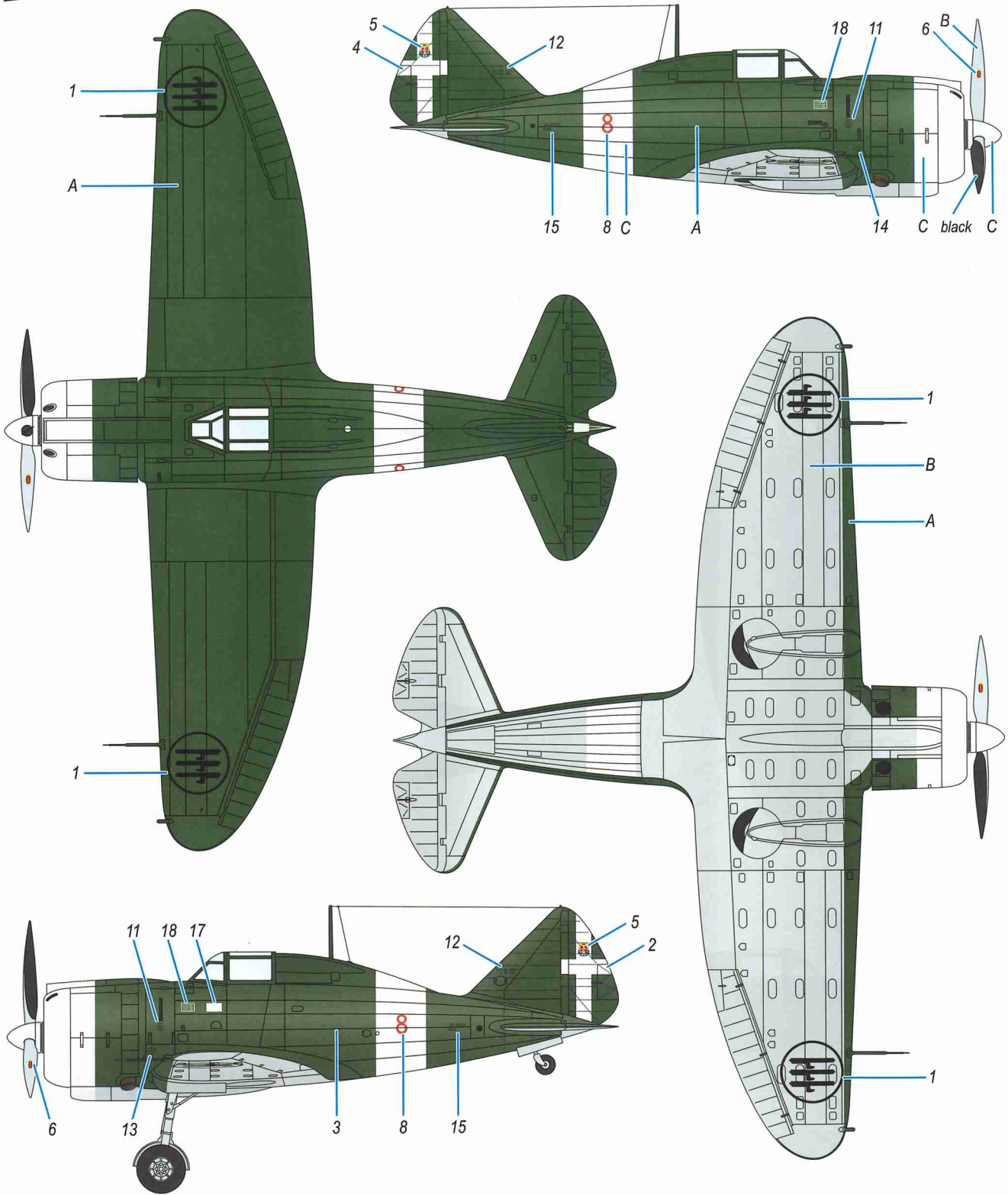

- | | | |
|--|---|--|
| <p>A Verde Oliva Scuro 2
Dk. Olive Green
Tmavě olivově zelená
H78+H60 (2:1)
C38+C18 (2:1)
FS34052</p> | <p>B Grigio Azzurro Chiaro I
Light Sea Grey
Světle šedomodrá
H324/C324
FS36307</p> | <p>C Bianco
White
Bílá
H/C1
FS36293</p> |
|--|---|--|



Scheme C

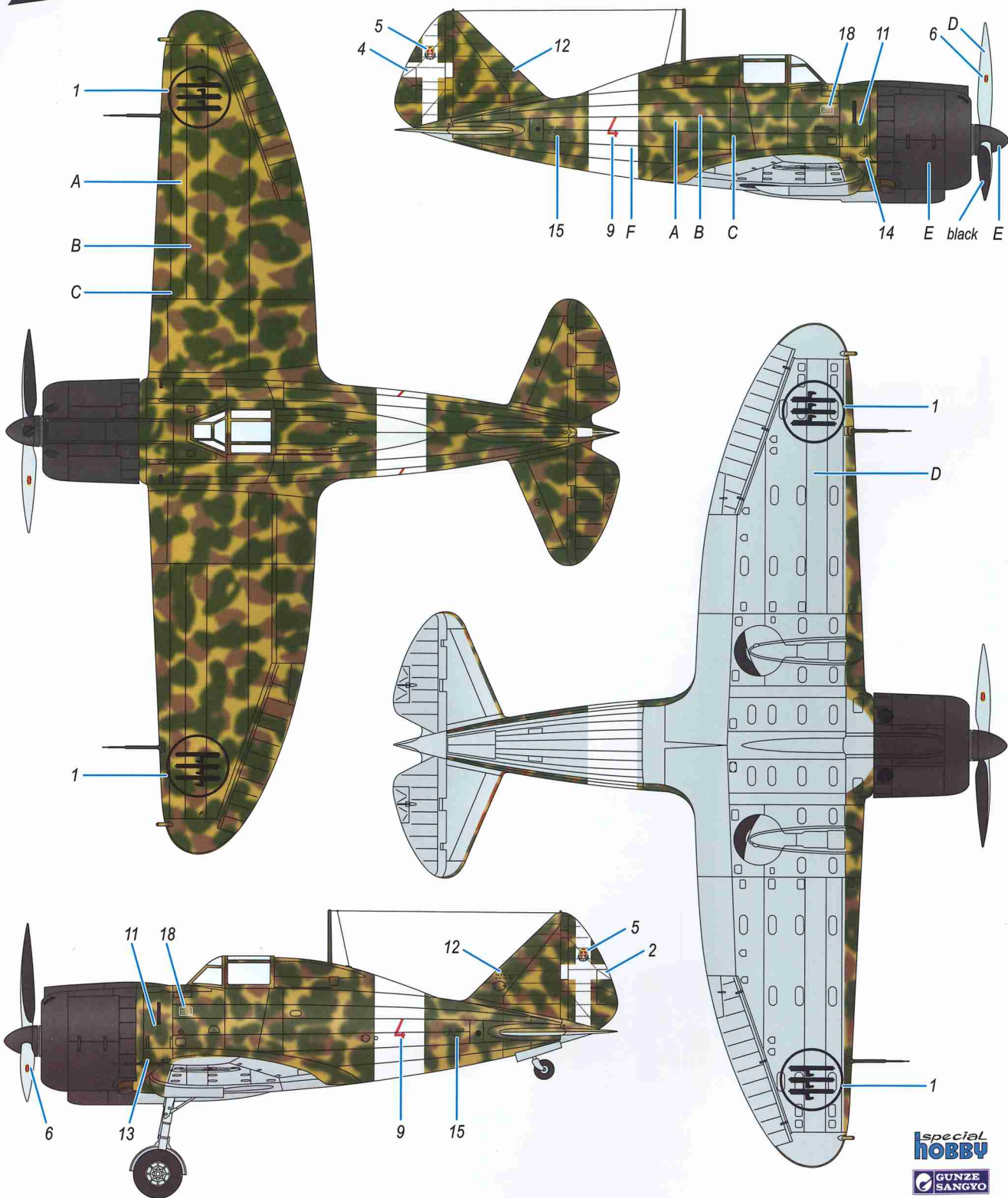

- | | | | | | |
|---|--|--|--|--|---|
| A Giallo Mimetico 3
Sandy Yellow
Pískově žlutá
H79/C39
FS33434 | B Marrone Mimetico 2
Brown
Hnědá
H/C7
FS30109 | C Verde Mimetico 2
Dark Green
Tmavě zelená
H/C302
FS34092 | D Grigio Mimetico
Light Grey
Světle šedá
H/C317
FS36293 | E Nero 12
Black
Černá
H/C2 | F Bianco
White
Bílá
H/C1
FS36293 |
|---|--|--|--|--|---|

Scheme D

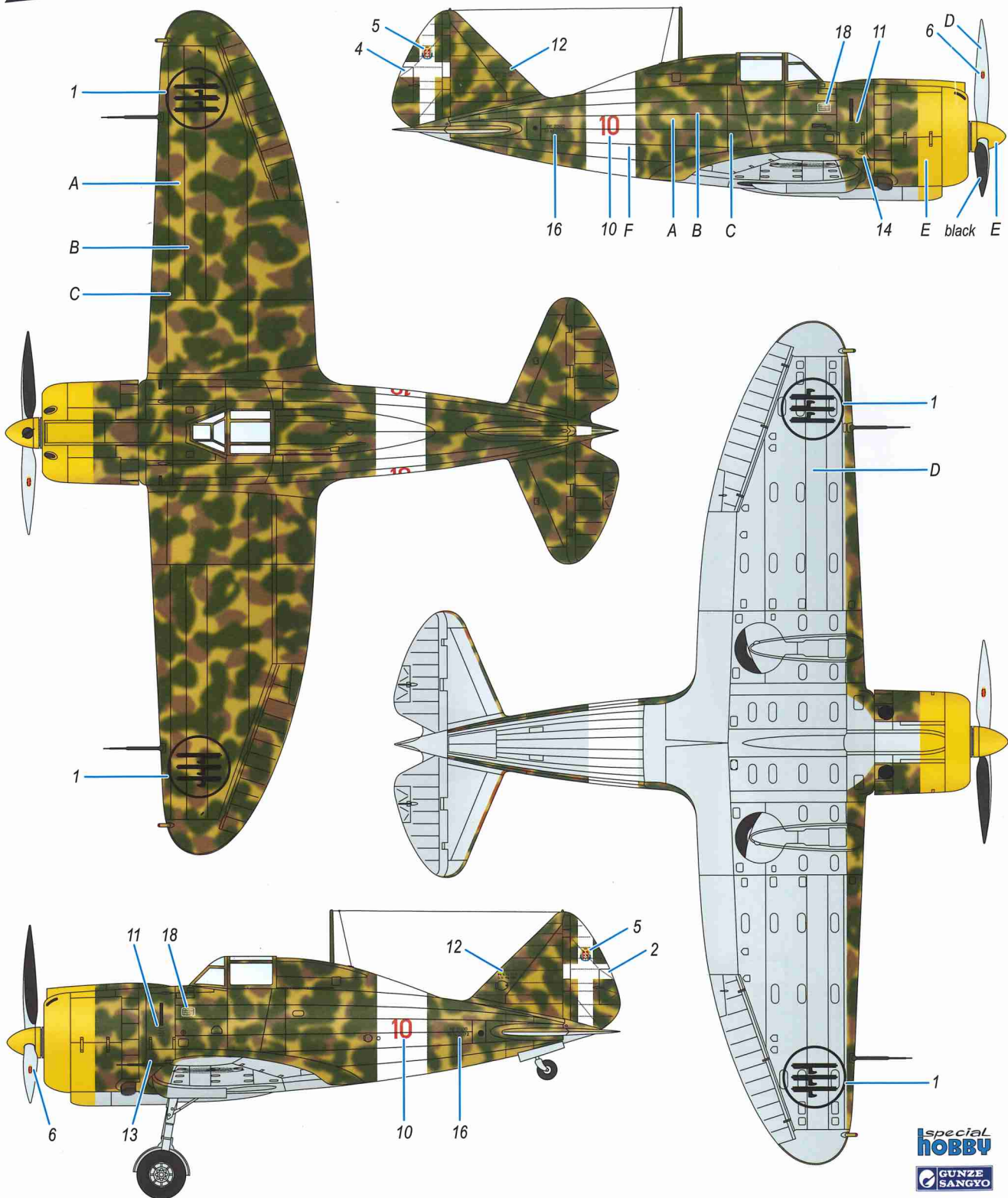

- | | | | | | |
|---|--|--|--|---|---|
| A Giallo Mimetico 3
Sandy Yellow
Pískově žlutá
H79/C39
FS33434 | B Marrone Mimetico 2
Brown
Hnědá
H/C7
FS30109 | C Verde Mimetico 2
Dark Green
Tmavě zelená
H/C302
FS34092 | D Grigio Mimetico
Light Grey
Světle šedá
H/C317
FS36293 | E Giallo Chromo 7
Yellow
Žlutá
H/C329 | F Bianco
White
Bílá
H/C1
FS36293 |
|---|--|--|--|---|---|

