

MONOGRAM

PBY-5 CATALINA

KIT 5609

1/48 SCALE

1/48 ECHELLE

ESCALA 1/48

MASSTAB 1:48

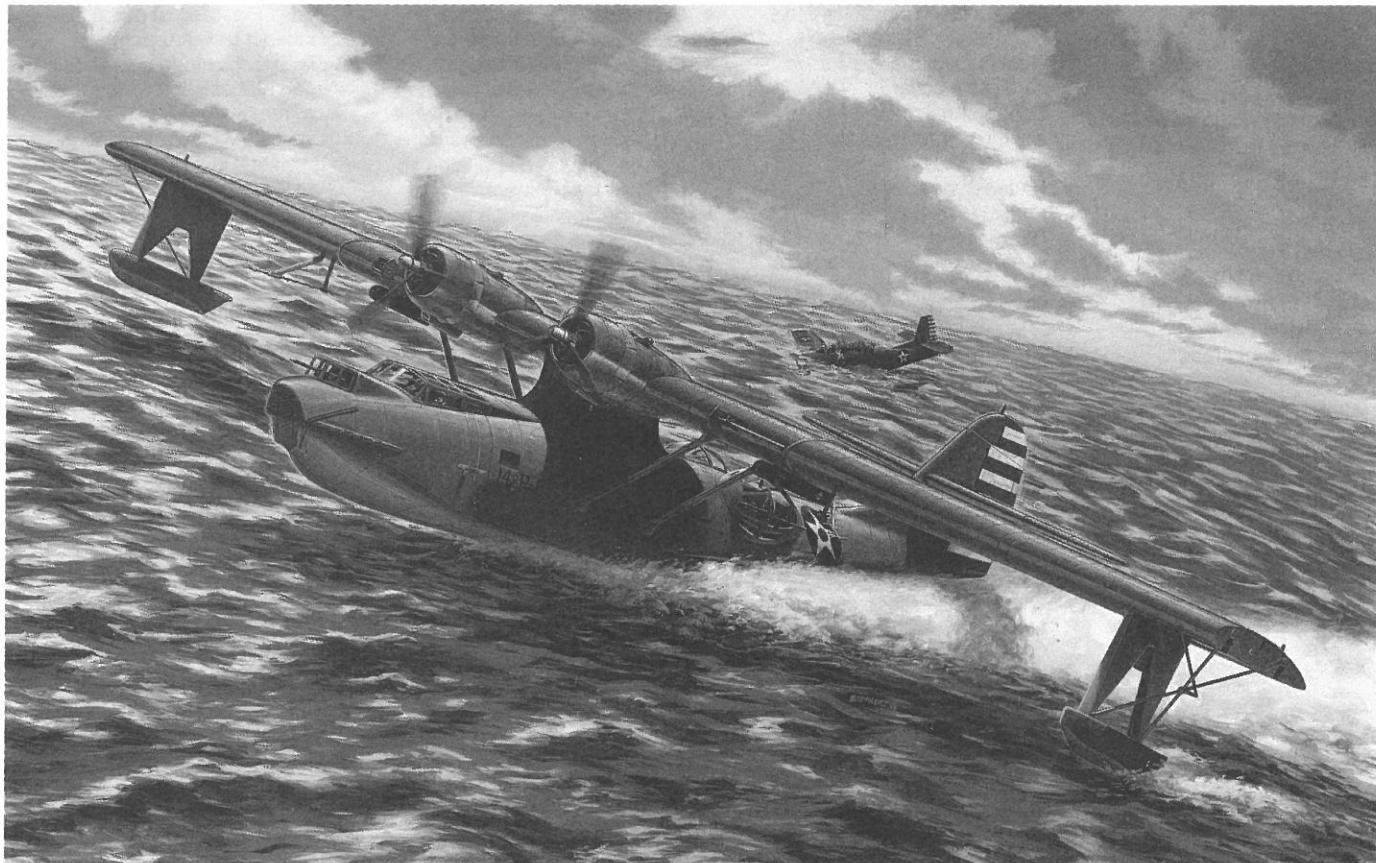

The Consolidated PBY Catalina was born of a U.S. Navy contract signed with Consolidated on October 28, 1933. This contract was for an improved flying boat of new design.

Consolidated, in competition with a Douglas aircraft design, submitted a prototype designated XP3Y. It was powered by two 14 cylinder air-cooled radial engines. It featured an all-metal stepped hull with an unusual semi-circular upper section. This was suspended beneath a broad wing with unique retractable floats under the wings which formed the wingtips when retracted.

Although the Douglas prototype took to the skies a month earlier than the XP3Y, the Navy decided upon the Consolidated aircraft, designed by Isaac M. Laddon.

Thus began the career of the Consolidated PBY Catalina. Built in greater numbers than any other flying boat, the Catalina served dependably with the U.S. Navy, U.S. Army Air Force, U.S. Coast Guard and half a dozen Allied air services.

The Catalina served in the bitter cold of the Aleutian Islands to the heat of the southwest Pacific and from the North Atlantic to South America, Although slow, the PBY, with a range of over 2000 miles, was made to

order for long range anti-shipping patrols, search and rescue missions and submarine hunting. With their incredible endurance, missions of 20 hours and more were not uncommon. Able to carry up to 4000 pounds of bombs, torpedoes or depth charges, the PBY did have a bite.

The Catalina played a noteworthy part in two major engagements of the Second World War. A Catalina I (PBY-5) of RAF Squadron 209 located and shadowed the German Battleship Bismarck until the Royal Navy was able to overtake and destroy it on May 26, 1941.

A PBY-5 Catalina of VP-44, almost 700 miles off Midway Island was the first to sight the approaching Japanese fleet on June 3, 1942 in that decisive battle that turned the tide in the Pacific War.

Your Monogram Models Catalina specifically represents PBY-5 Buno 2360. This aircraft, of VP-14 was stationed at NAS Kaneohe Bay, along the eastern coast of Oahu Island. It survived the Japanese attack on the Hawaiian Islands of December 7, 1941. Additional decals are provided to represent Department of the Navy changes in markings during its service life.

If you have any problems building this model, call our modeling tips hotline at: (800) 833-3570

5609M0200

REVELL-MONOGRAM, INC. Morton Grove, IL. Copyright©1996. All rights reserved. Made in U.S.A.

ASSEMBLY INSTRUCTIONS

READ THIS BEFORE YOU BEGIN

- Study the assembly drawings.
- Each plastic part is identified by a number.
- Scrape plating from areas to be cemented.
- Check the fit of each piece before cementing into place.
- Do not use too much cement to join parts.
- Use only cement for polystyrene plastic.
- Models may be painted to match photos on box.
- Allow paint to dry thoroughly before handling parts.
- Scrape paint from areas to be cemented.
- For better paint and decal adhesion, wash the plastic parts in a mild detergent solution. Rinse and let air dry.

LISEZ CE QUI SUIT AVANT DE COMMENCER LE MONTAGE

- Etudier les schémas d'assemblage.
- Chaque pièce plastique porte un numéro d'identification.
- Grattez le chromage sur les surfaces à coller.
- Contrôler que chaque pièce soit bien cinfirmé avant de la coller à sa place.
- N'utilisez pas trop de colle pour réunir les pièces.
- Utilisez uniquement une colle spéciale pour polystyrene.
- Le modele peut être peint conformément aux photos surboite.
- Laissez sécher la peinture complètement avant de manipuler les pièces.
- Grattez la peinture sur les surfaces devant être collées.
- Pour assurer la meilleure adhésion possible de la peinture des décalomanies, laver les pièces de plastique avec une légère solution savonneuse. Rinse et laissez sécher à l'air.

LEA ESTO ANTES DE EMPEZAR

- Estudie los dibujos de ensamblaje.
- Cada pieza de plástico se identificapor un número.
- Raspe el laminado de las superficies que serán pegadas.
- Verifique que cada pieza encaje bien antes de posición.
- No use demasiado pegamento para unir las piezas.
- Use unicamente pegamento paraplástico de poliestitina.
- El modelo puede pintarse de acuerdo con las fotografías de la caja.
- Permita que se seque la pintura completa mente antes de tocar las piezas.
- Raspe la pintura de las superficiea que serán pegadas.
- Para una mejor fijacion de la pintura y de las calcomanias lávenselas piezas plásti cas en una solu-ción de detergente suave. Enjua-guense y dejense secar al aire.

ALLGEMEINE HINWEISE

- Die Anordnung der Bauteile ist den Zeichnungen der Anieitung ersichtlich.
- Jedes Plastikteil ist durch eine Nummer gekennzeichnet.
- Die Beschichtung muss von allen Klebestellen vorher entfernt werden.
- Die Teile vor dem Verkieben ungeleimt zusam-menhalten um ihrer Pass itz zu prüfen.
- Klebstoff nicht zu dick auftragen.
- Nur Modellbaukleber für Polystyrol verwenden.
- Man Kann das modell nach den fotos auf der schachtel anstreichen.
- Bemalte Teile vor der Weiterverwendung gut trocknen lassen.
- Die Farbe muss von allen späteren Klebestellen abgeschabt werden.
- Damit sie Farbe und die Abziehbilder kleben sind die Plastikteile in einer milden Seifenlauge z waschen. Dann abspülen und an der Luft trocknen lassen.



CEMENT TOGETHER
A COLLER
UNIR CON PEGAMENTO
VERKLEBEN



DECAL (DIP IN WATER)
DECALCOMANIE (À PLONGER DANS L'EAU)
DECALCOMANIA (MOJE CON AGUA)
ABZIEHBILD



OPTIONAL PARTS
PIECES EN OPTION
PIEZAS OPCIONALES
BAUTEILE NACH WAHL



REMOVE AND THROW AWAY
A RETIRER ET JETER
QUITE Y TIRE
ENTFERNEN (ABFALL)



REPEAT SEVERAL TIMES
A REPETER PLUSIEURS FOIS
REPITA VARIAS VECES
ARBEITSGANG MEHRMALS WIEDERHOLEN

Every effort has been made to create and manufacture a model kit that is the finest available. If a part may be missing, please write to:

Revell-Monogram
Consumer Service Department
301 North Third Avenue
Des Plaines, Illinois 60016

Be sure to include the kit number, part number, description, and your return address.

TO COMPLETE THIS KIT AS SHOWN, WE RECOMMEND THE FOLLOWING PROMODELER PAINTS.

| ENGLISH | FRENCH | SPANISH | GERMAN |
|---------------------------|------------|---------------|------------------------|
| FLAT BLACK 88-0022 | NOIR TERNE | NEGRO APAGADO | GLANZLOSES SCHWARZ |
| SATIN BLACK 88-0016 | NOIR TERNE | NEGRO MATE | HÄLBGLANZENDES SCHWARZ |
| GLOSS YELLOW 88-0005 | JAUNE | AMARILLO | GELB |
| STEEL 88-0015 | MATALLIC | METALICO | METALLIC |
| SILVER 88-0013 | ARGENT | PLATA | SILBERN |
| ALUMINUM 88-0014 | ALUMINIUM | ALUMINIO | ALUMINIUMFARBEN |
| MILITARY BROWN 88-0027 | BRUN | MARRON | BRAUN |
| INTERMEDIATE BLUE 88-0039 | BLEU | AZUL | BLAU |
| FLAT GULL GRAY 88-0033 | GRIS | GRIS | GRAU |
| GUNSHIP GRAY 88-0037 | GRIS FONCE | GRIS OSCURO | DUNKELGRAU |
| OLIVE DRAB 88-0028 | VERT OLIVE | ACEITUNADO | OLIVGRUN |

1 COCKPIT ASSEMBLY

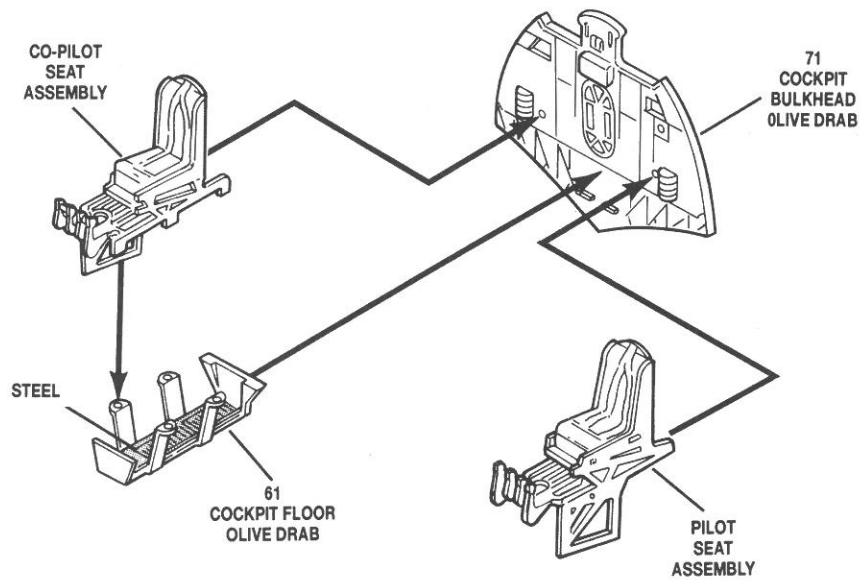
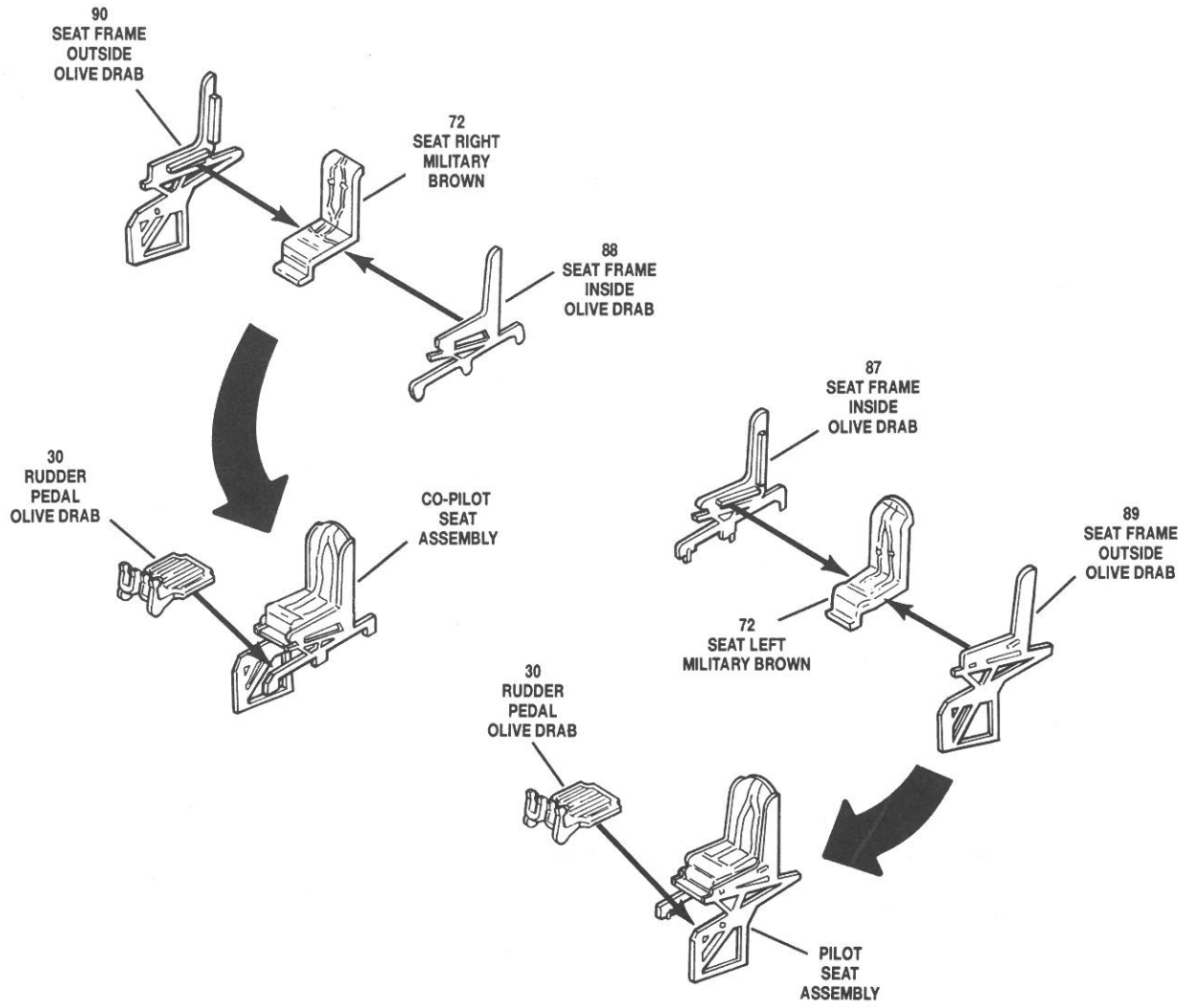

COCKPIT ASSEMBLY CONTINUED

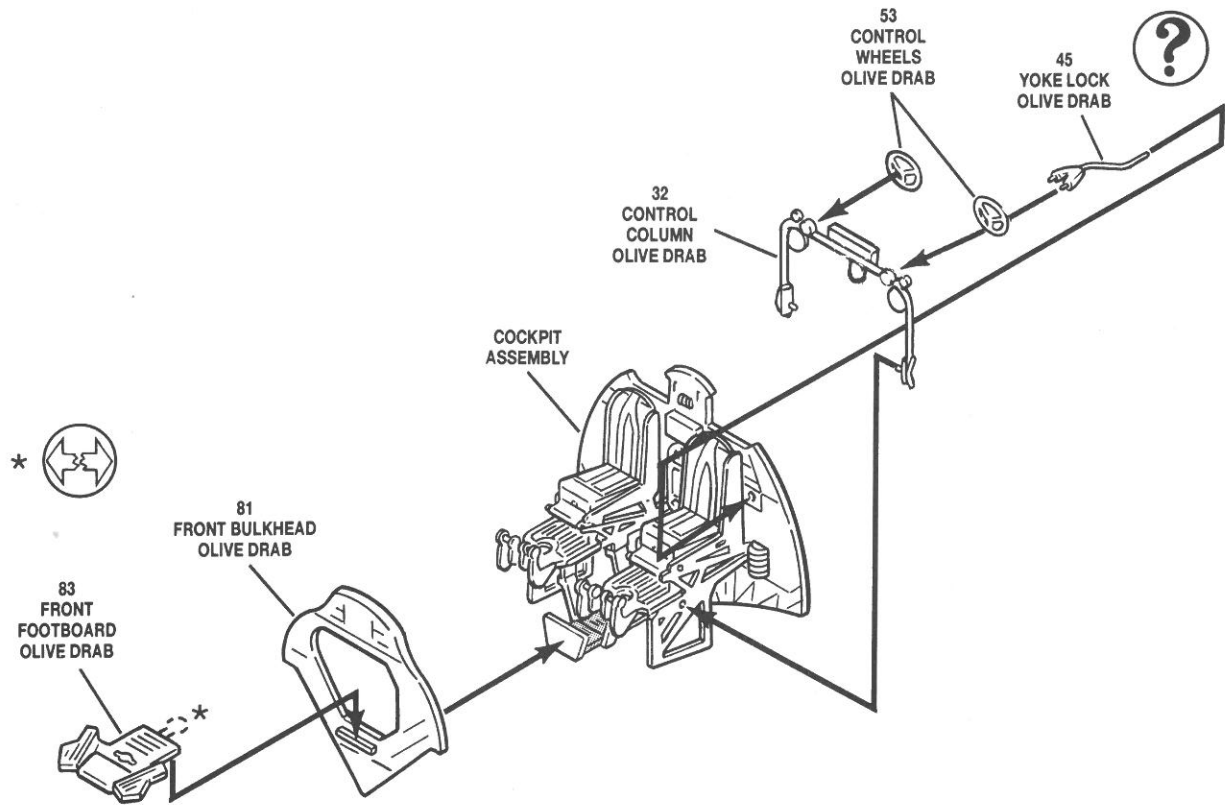

2 WAIST COMPARTMENT ASSEMBLY

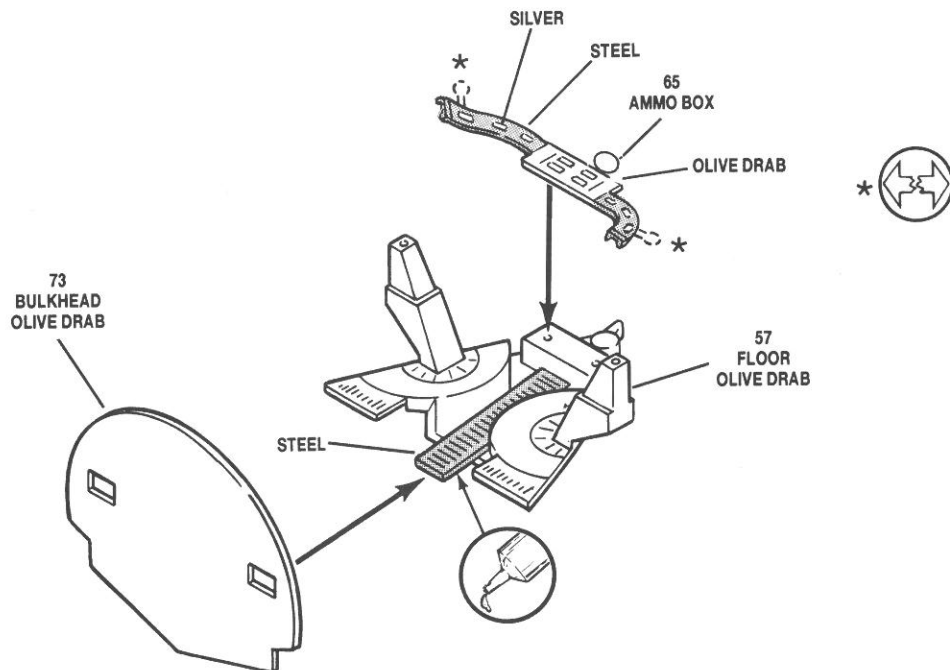

3 WINDOW GROUP



NOTE: IF INSTALLING THE BEACHING GEAR (LANDING GEAR), OPEN "FLASHED OVER" HOLE INSIDE FUSELAGE ON BOTH HALVES.

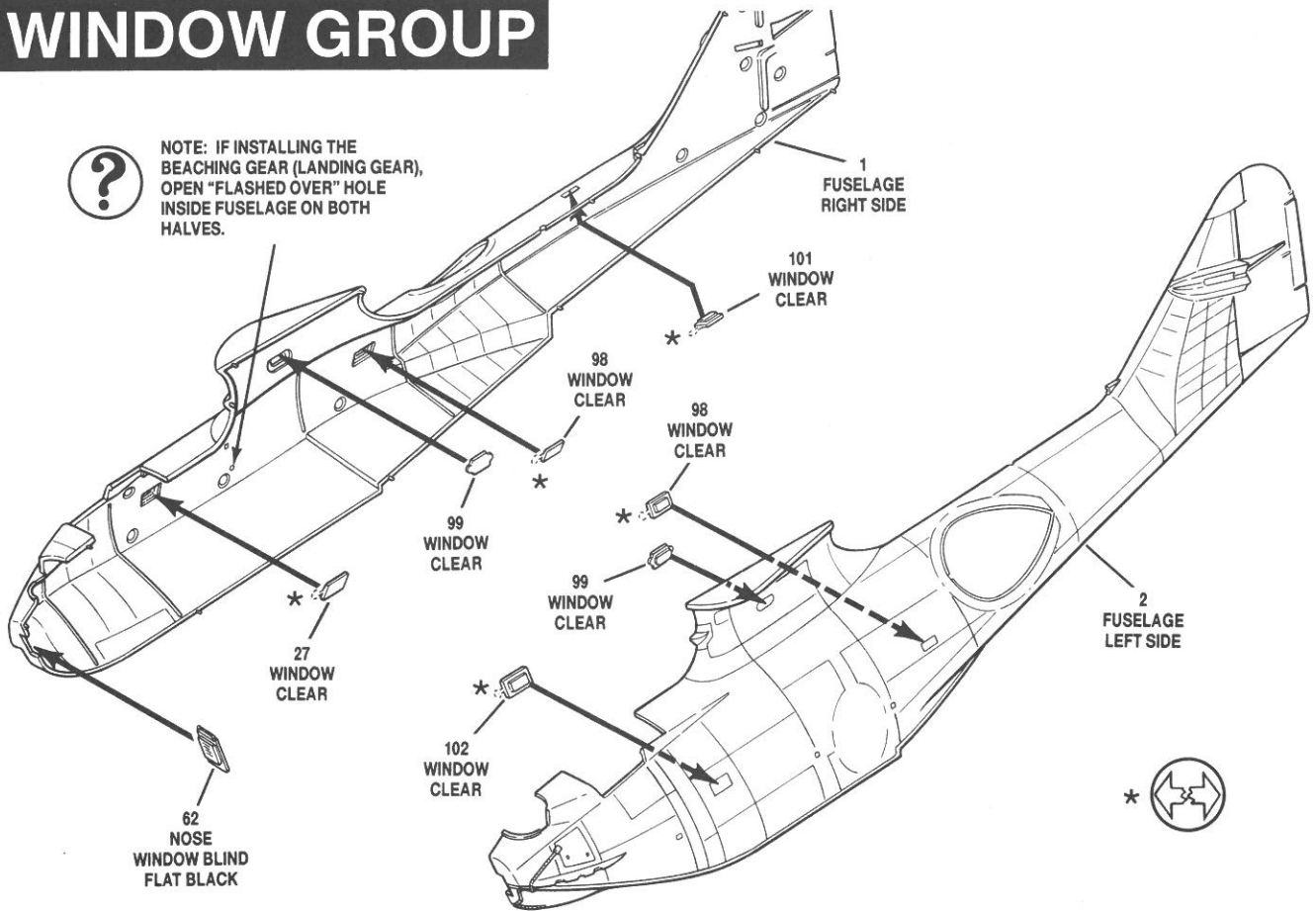

4 INTERIOR ASSEMBLY

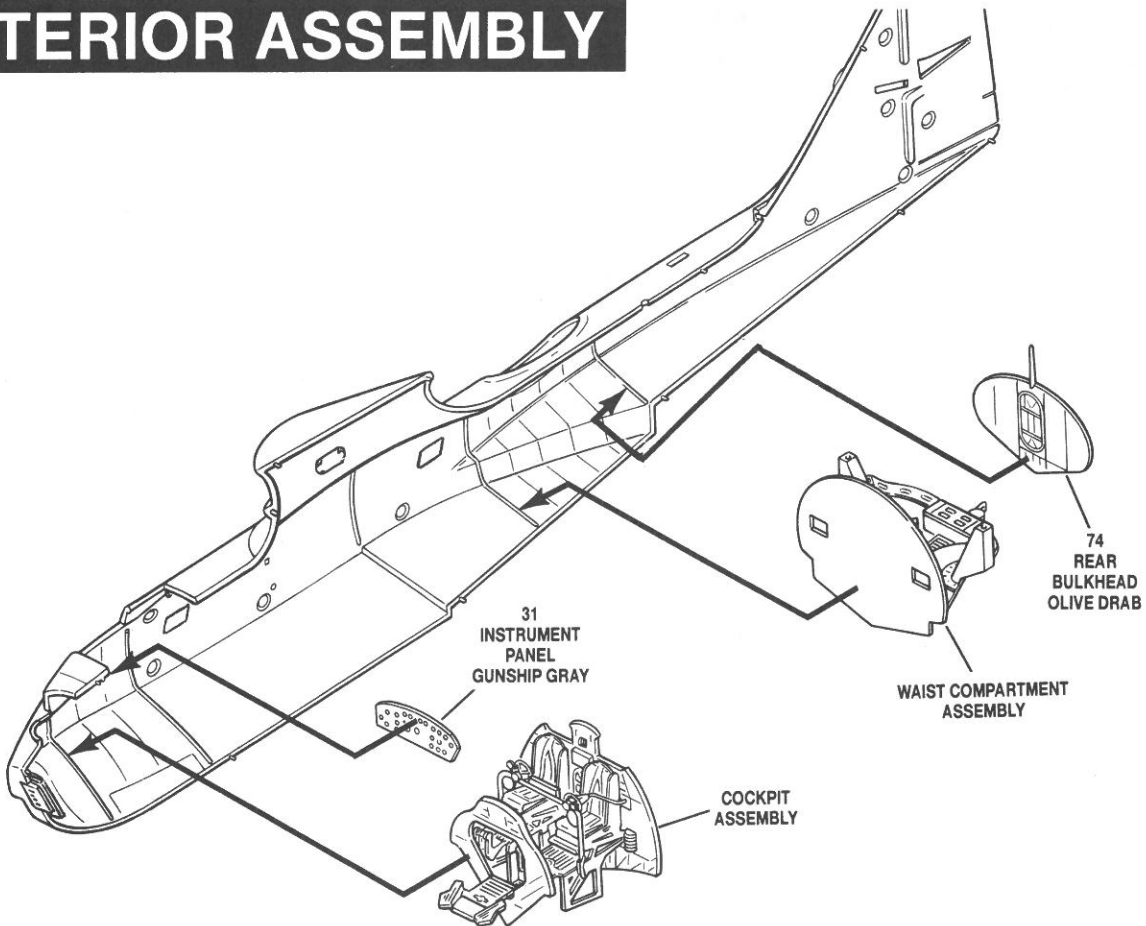

5 FUSELAGE ASSEMBLY

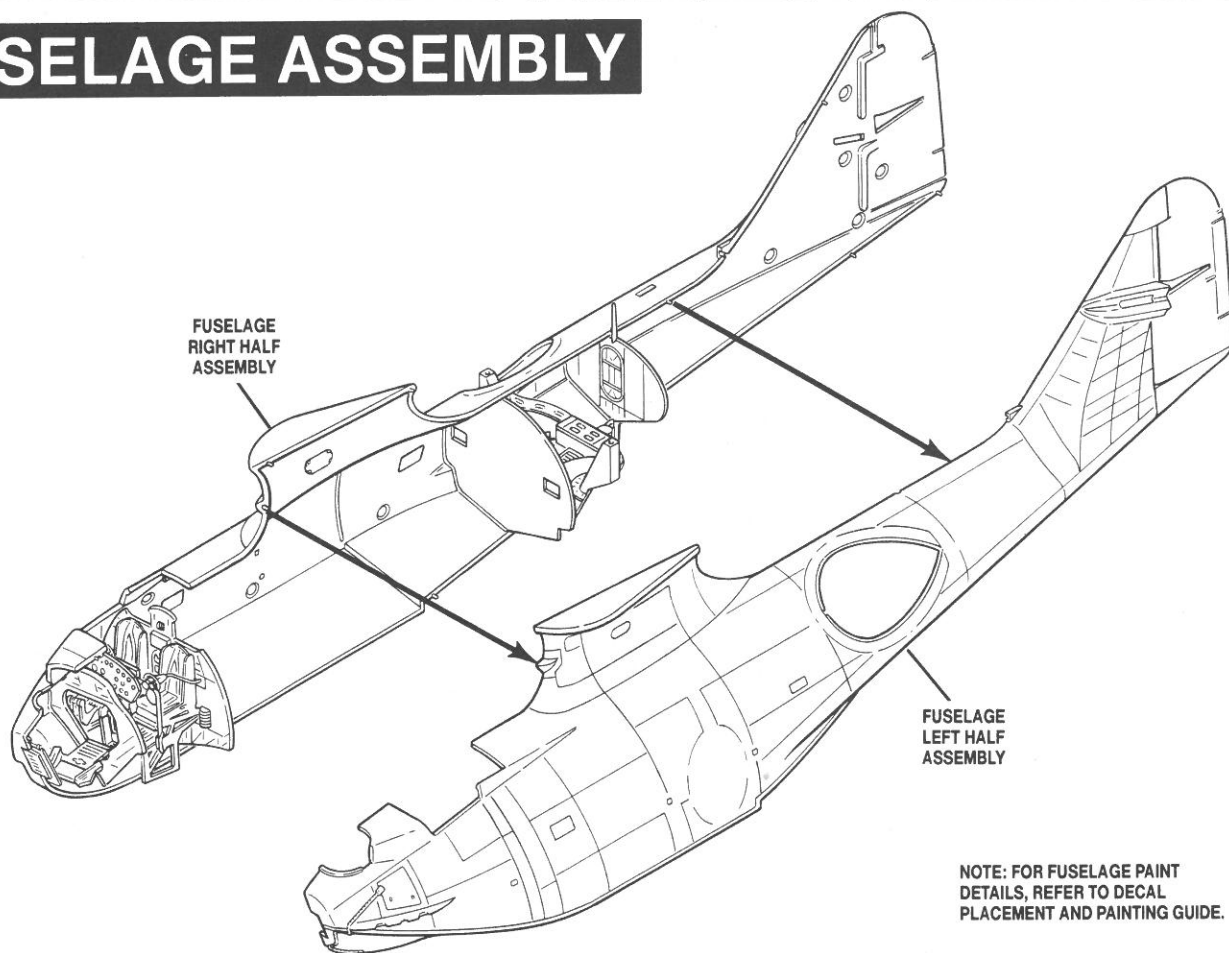

6 WING ASSEMBLY

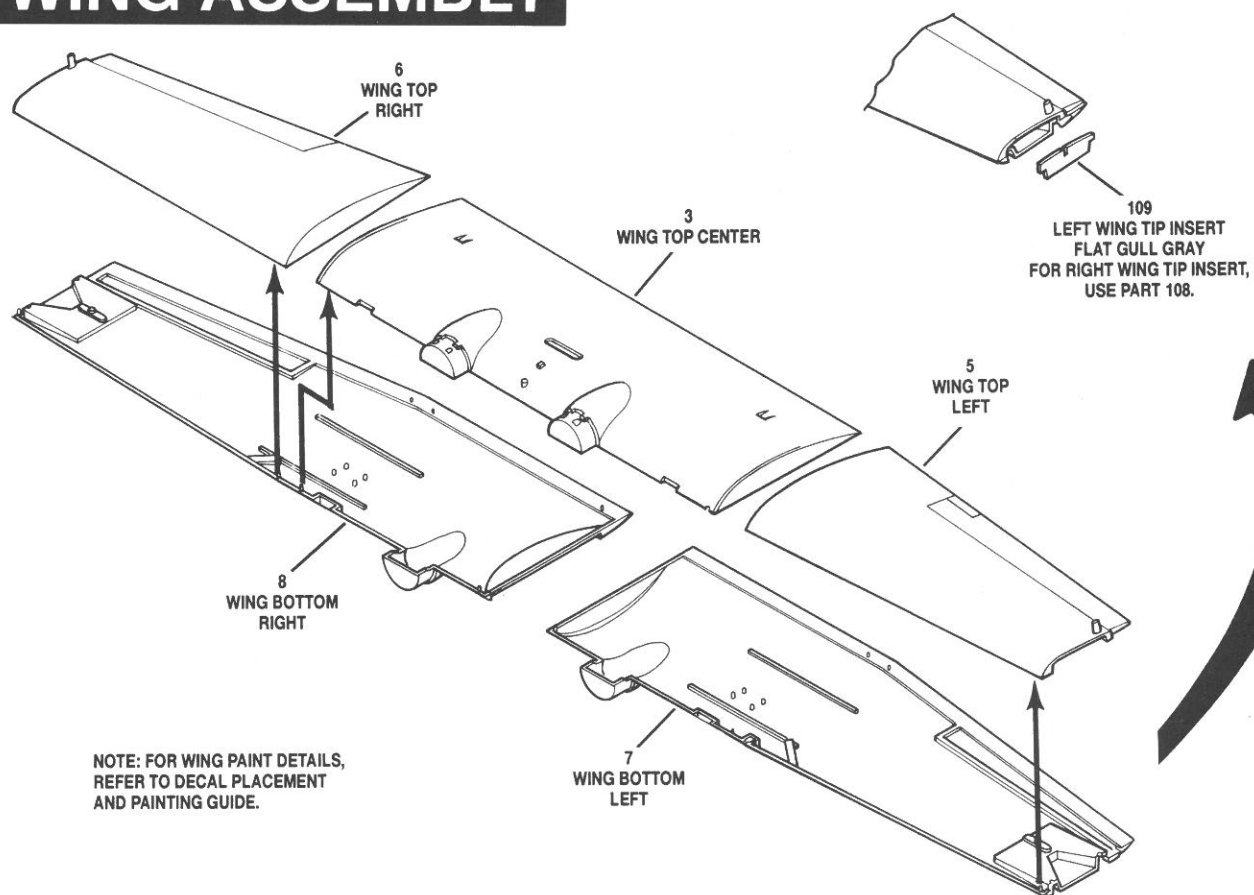

7 ENGINE ASSEMBLY

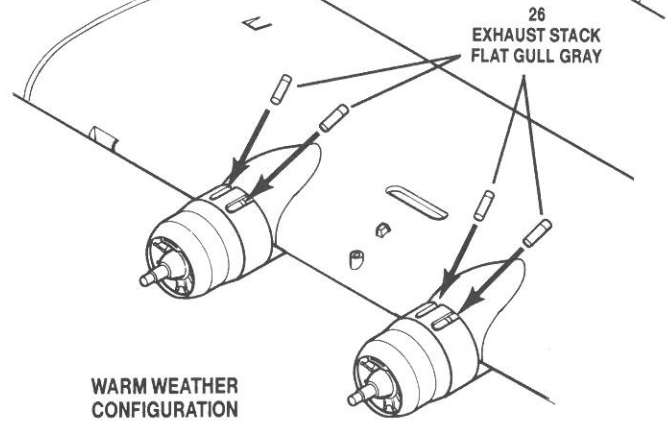
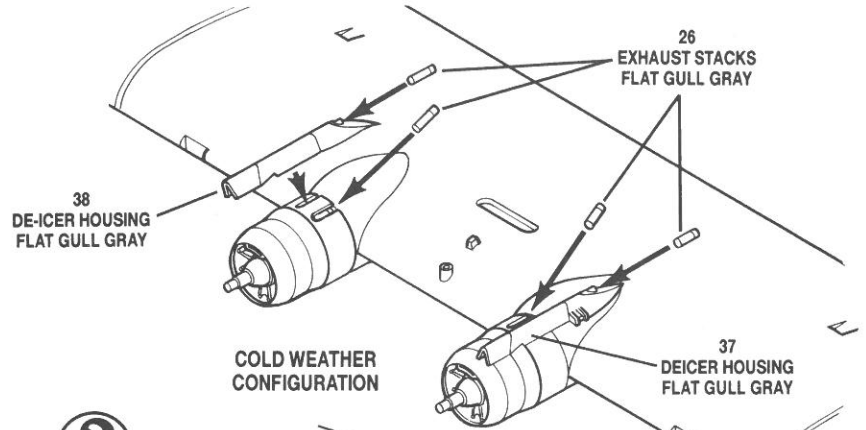
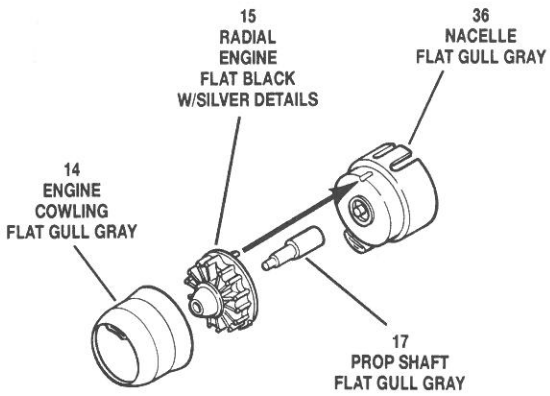

2X

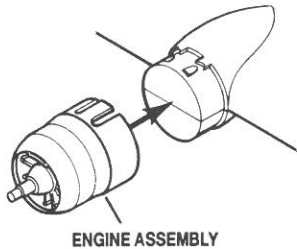

8 WING TIP FLOAT ASSEMBLY

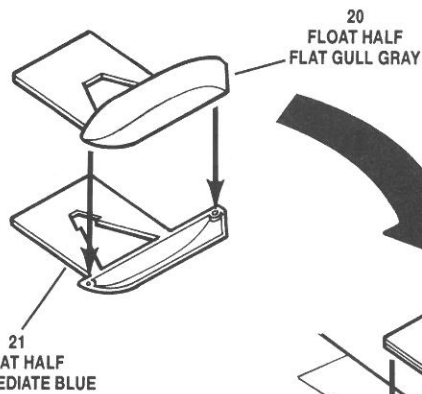
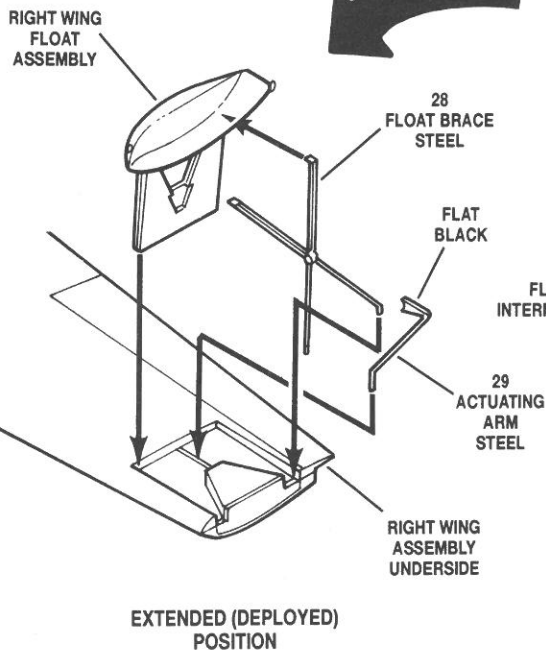

REPEAT FOR LEFT WING
FLOAT ASSEMBLY
USING PARTS 18 & 19

2X

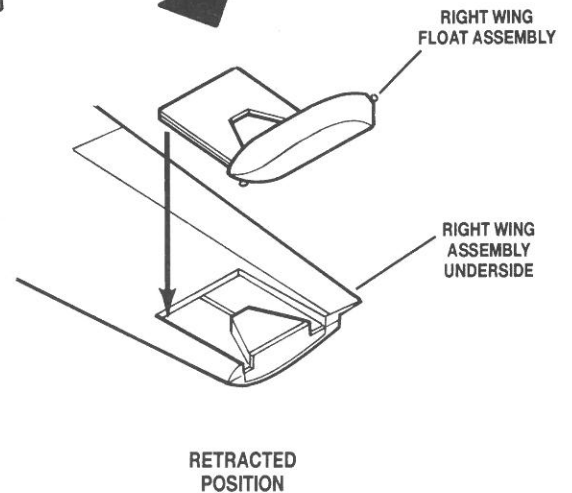

9 WING ASSEMBLIES

NOTE: FOR WING PAINT DETAILS,
REFER TO DECAL PLACEMENT
AND PAINTING GUIDE

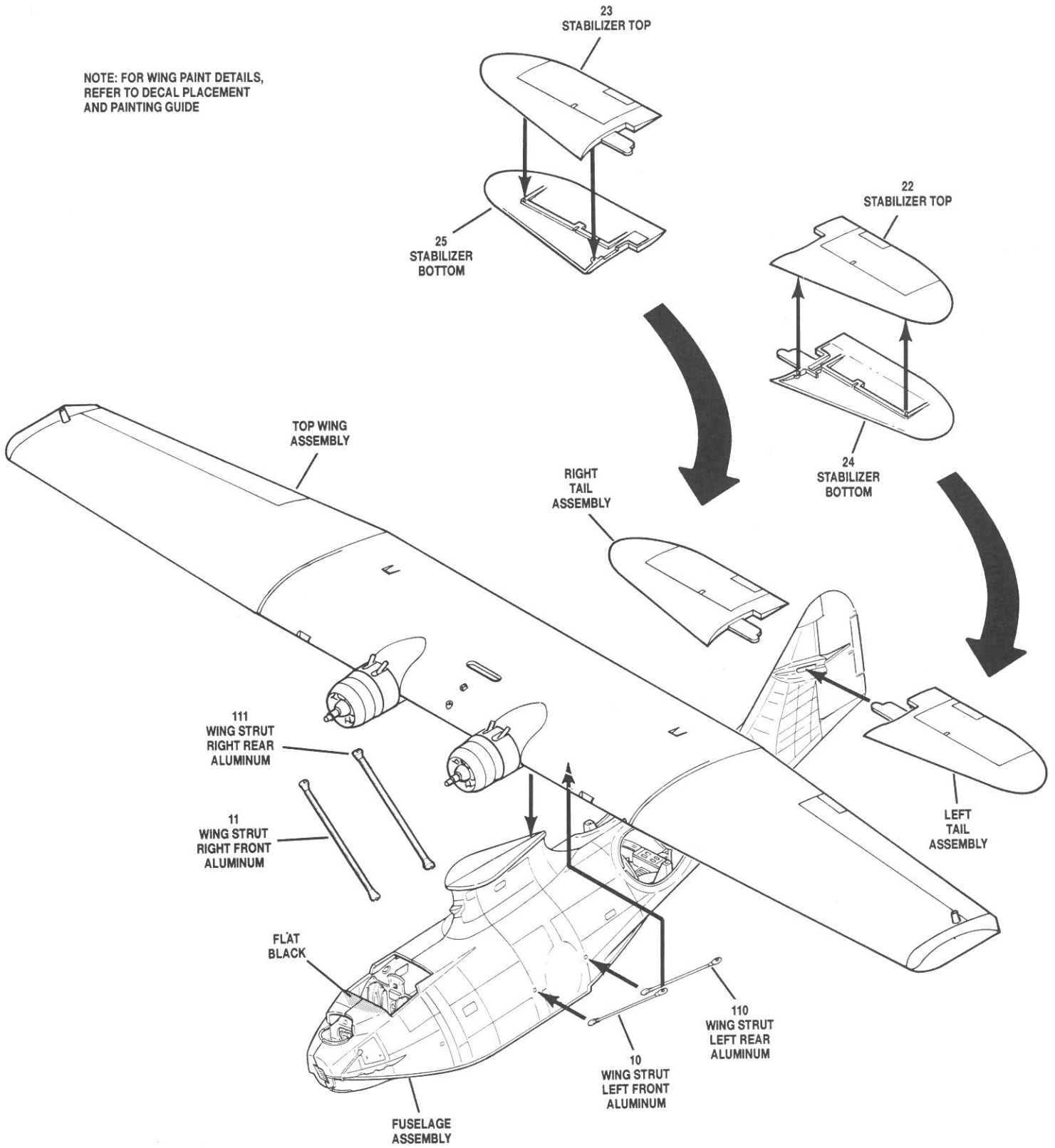

10 BEACHING GEAR OPTION

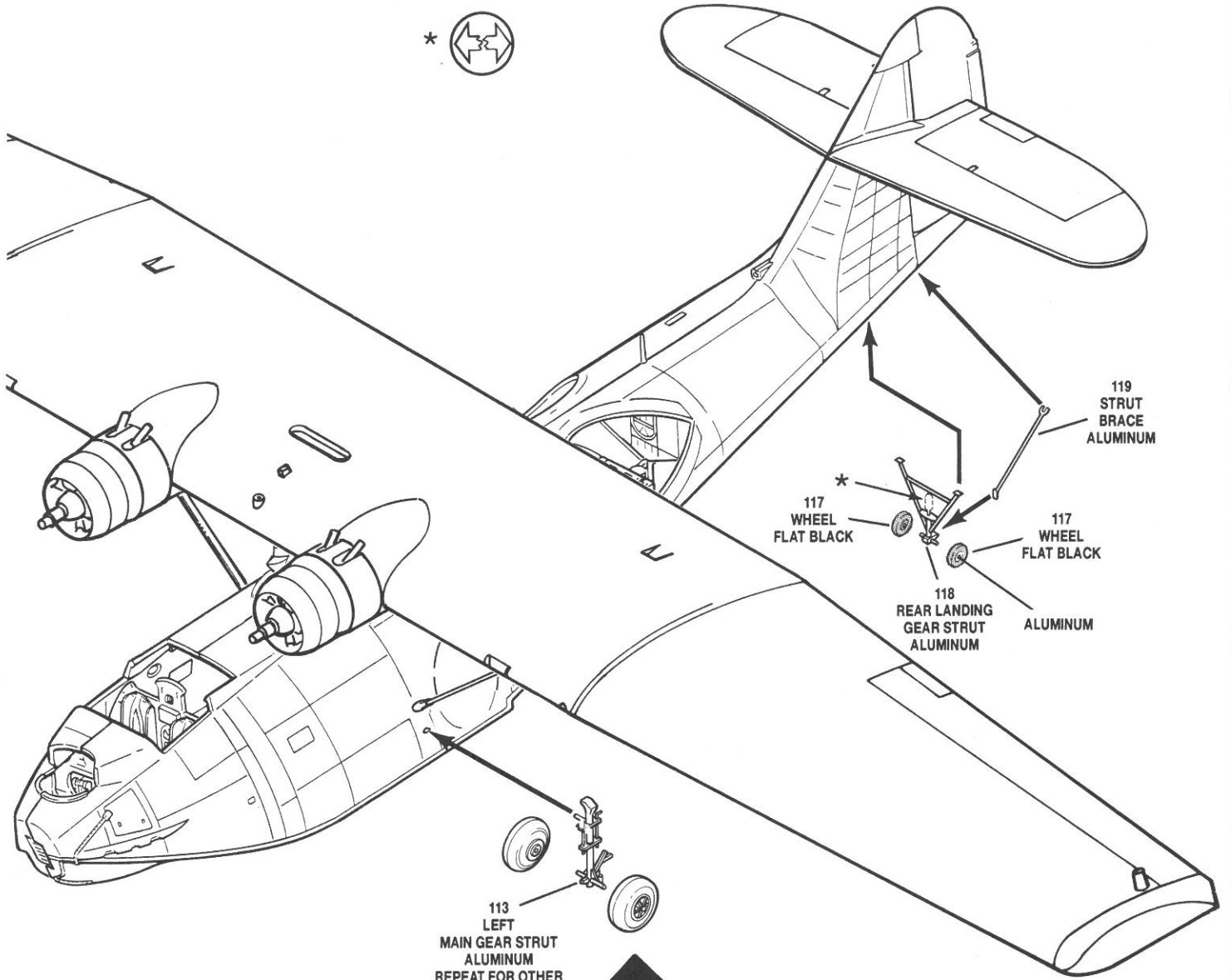

113
LEFT
MAIN GEAR STRUT
ALUMINUM
REPEAT FOR OTHER
SIDE WITH PART 114

116
INSIDE
WHEEL
HALF
FLAT BLACK

115
OUTSIDE
WHEEL
HALF
FLAT BLACK

ALUMINUM

4X

11 FINAL FUSELAGE ASSEMBLY

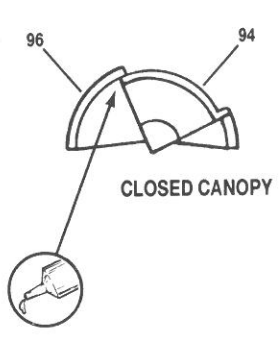

REPEAT FOR RIGHT SIDE USING PARTS 95, 97, 123, 77

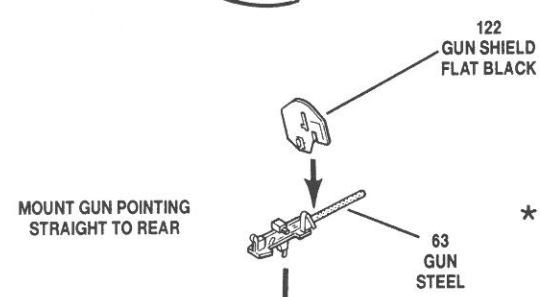
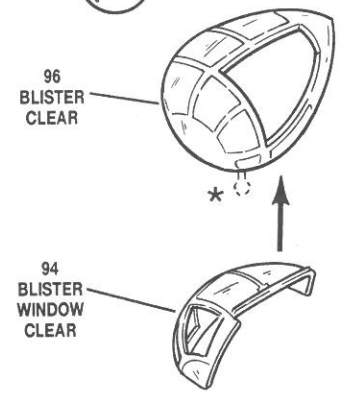
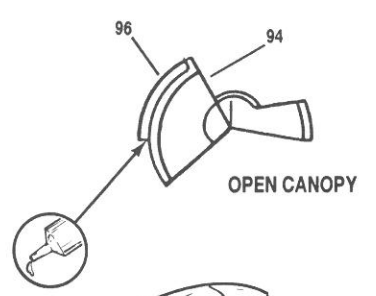
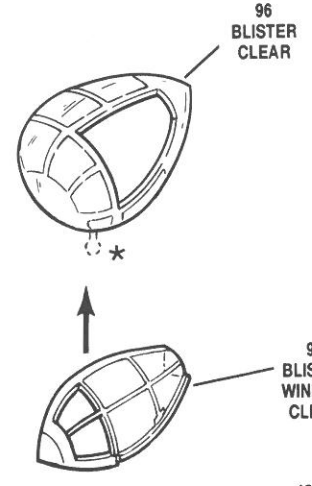

MOUNT GUN POINTING STRAIGHT TO REAR

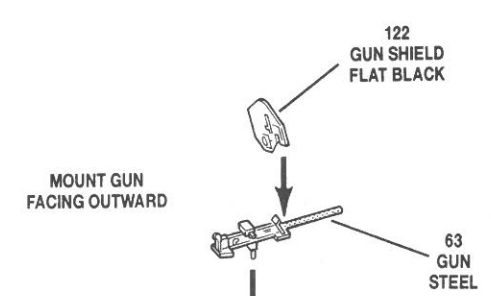

MOUNT GUN FACING OUTWARD

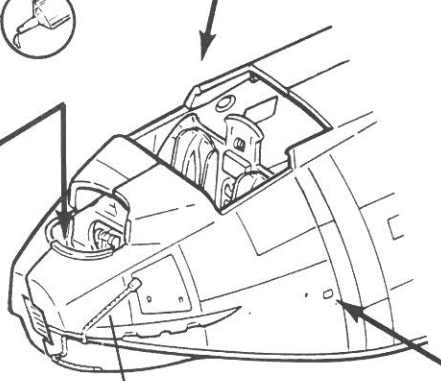
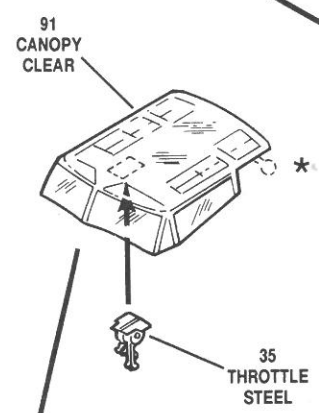
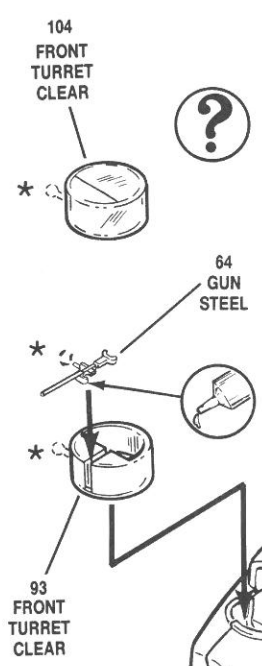

70
ANTENNA ARRAY FLAT BLACK

MILITARY BROWN

INTERMEDIATE BLUE



NOTE: INTERIOR FRAME STRUCTURES FOR BLISTERS, BLISTER WINDOWS, CANOPY AND FRONT TURRET FLAT GULL GRAY.

NOTE: EXTERIOR FRAME STRUCTURES FOR BLISTERS, BLISTER WINDOWS, CANOPY AND FRONT TURRET INTERMEDIATE BLUE.

12 FINAL WING ASSEMBLY

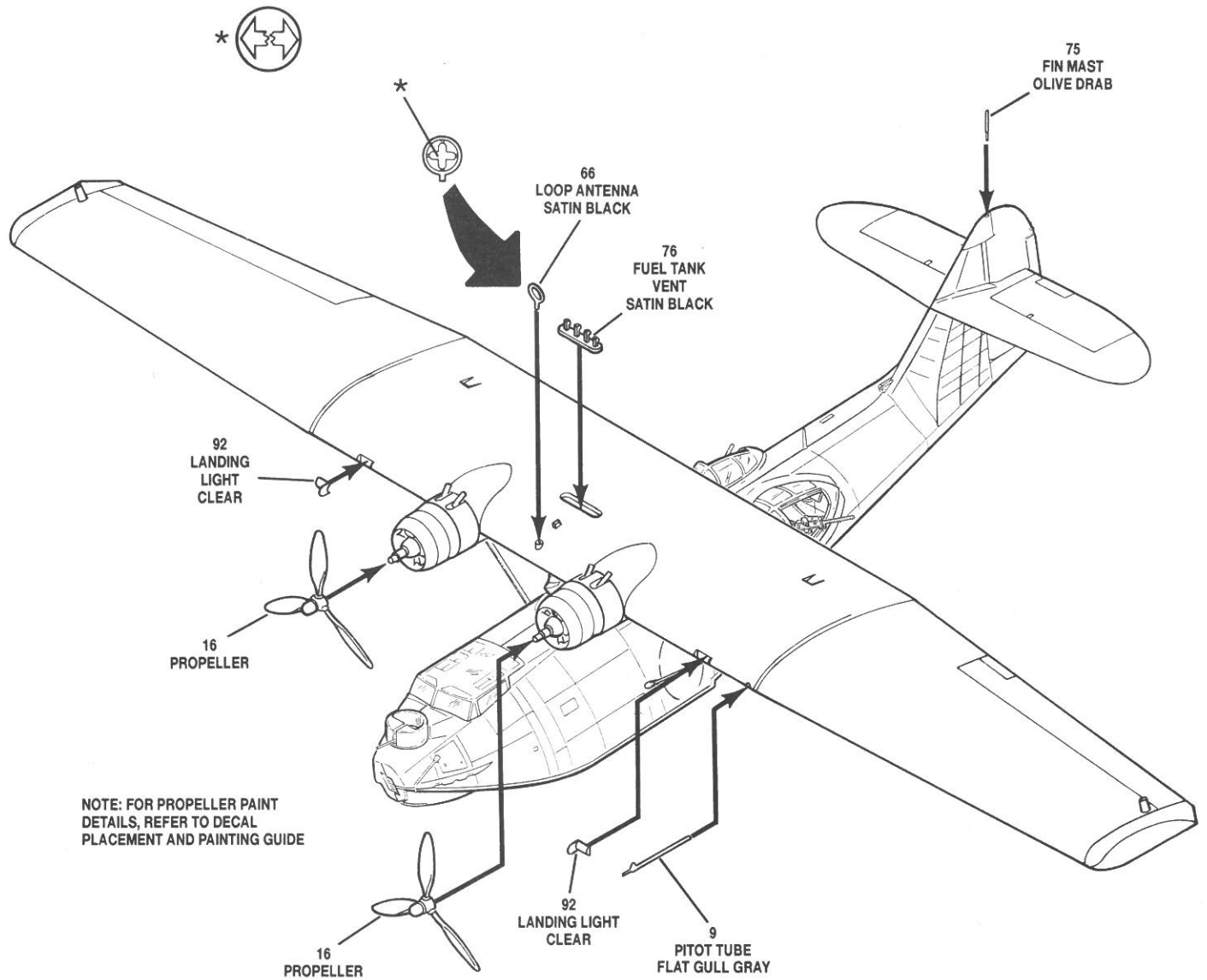

FINAL WING ASSEMBLY CONTINUED

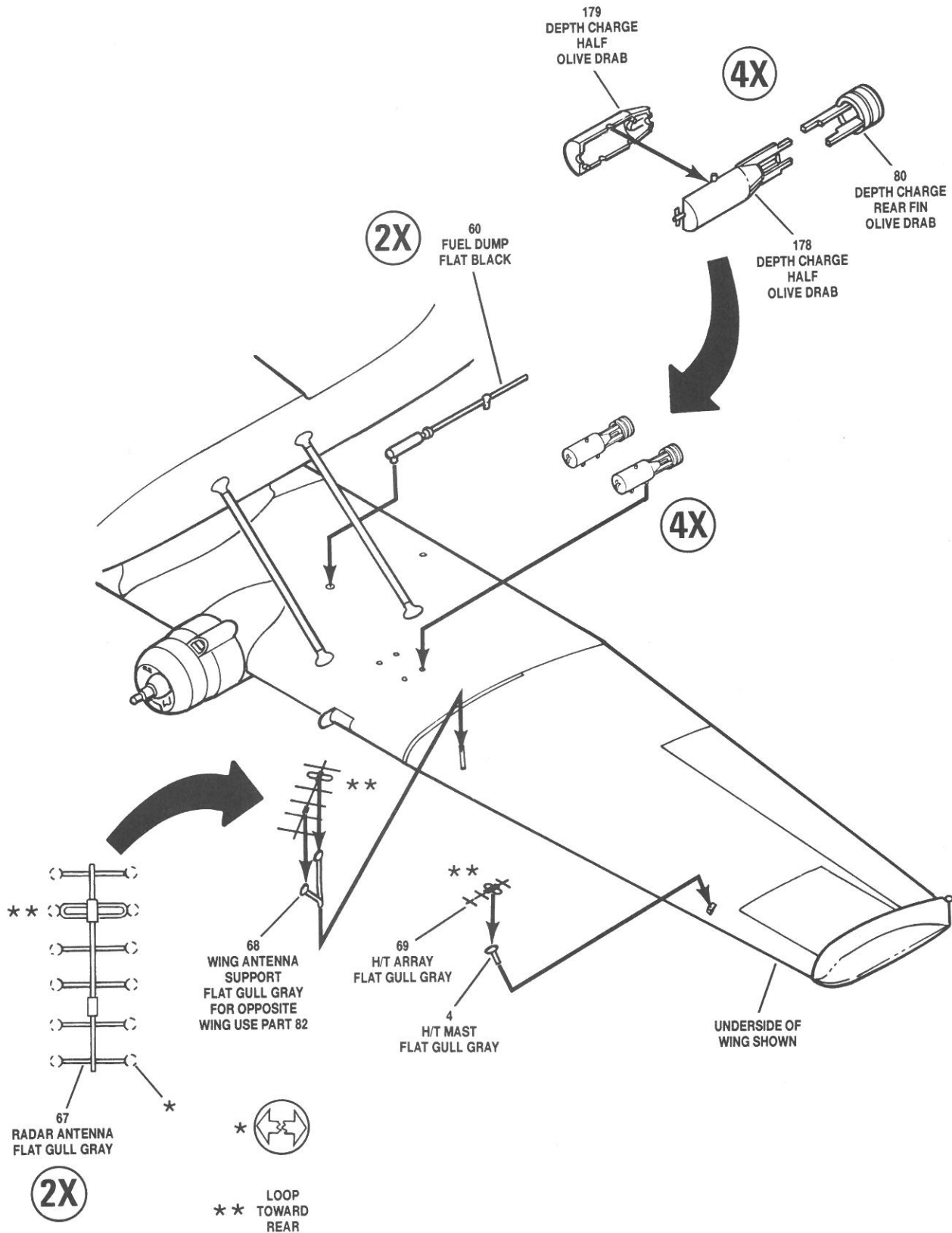

PBY-5 DECAL PLACEMENT AND PAINTING GUIDE



DECAL APPLICATION INSTRUCTIONS

- 1.) Wash plastic parts in mild detergent solution, then rinse and let dry.
- 2.) Cut the desired decal from the sheet.
- 3.) Dip the decal in water for a few seconds.
- 4.) Place the wet decal on a paper towel.
- 5.) Wait until the decal is movable on its backing paper.
- 6.) Place the decal in position on the model with its face up, then slide the backing away.
- 7.) Press out any air bubbles with a soft damp cloth.
- 8.) The milkiness that may appear is for better decal adhesion, but will dry clear.
- 9.) Wipe away any excess adhesive.
- 10.) Do not touch the decal until it is dry.

NOTE: ALL STENCILS ON THE WING READ FROM THE TRAILING EDGE.

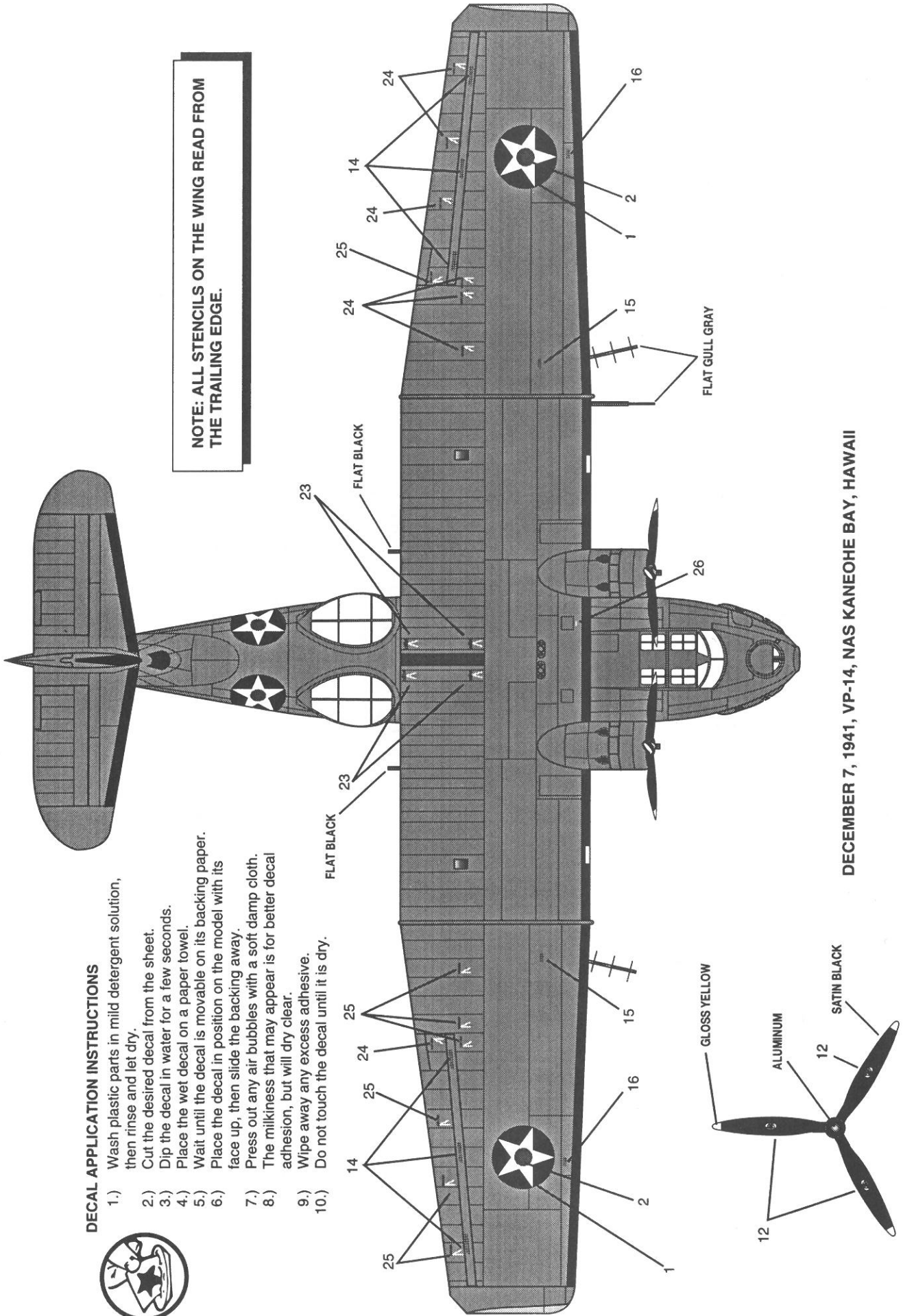

DECEMBER 7, 1941, VP-14, NAS KANEHOE BAY, HAWAII

PBY-5 DECAL PLACEMENT AND PAINTING GUIDE

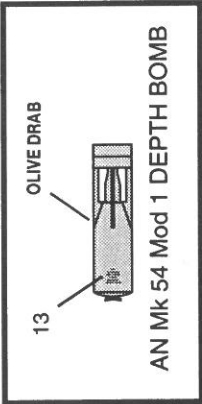
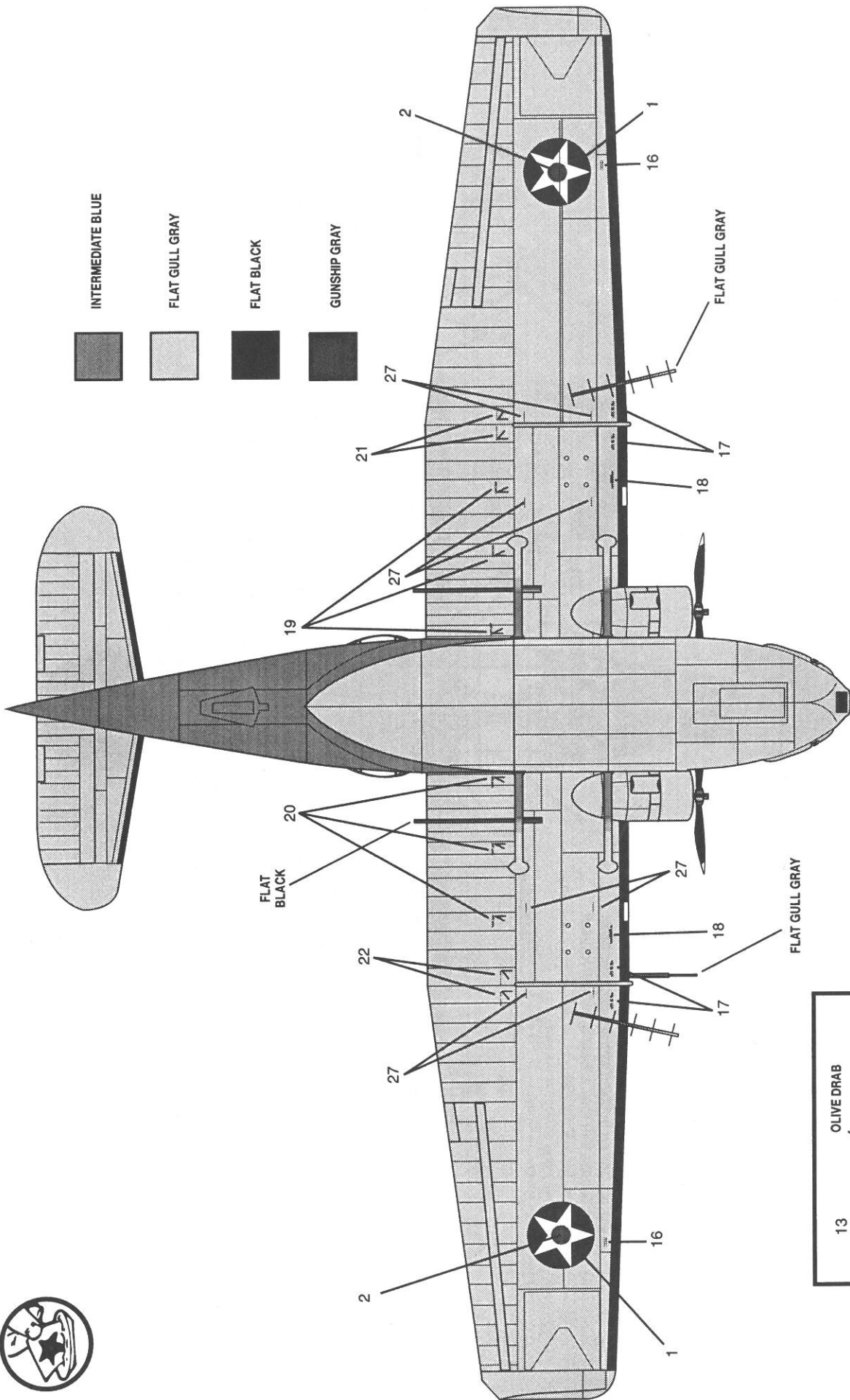

DECEMBER 7, 1941, VP-14, NAS Kaneohe Bay, Hawaii

PBY-5 DECAL PLACEMENT

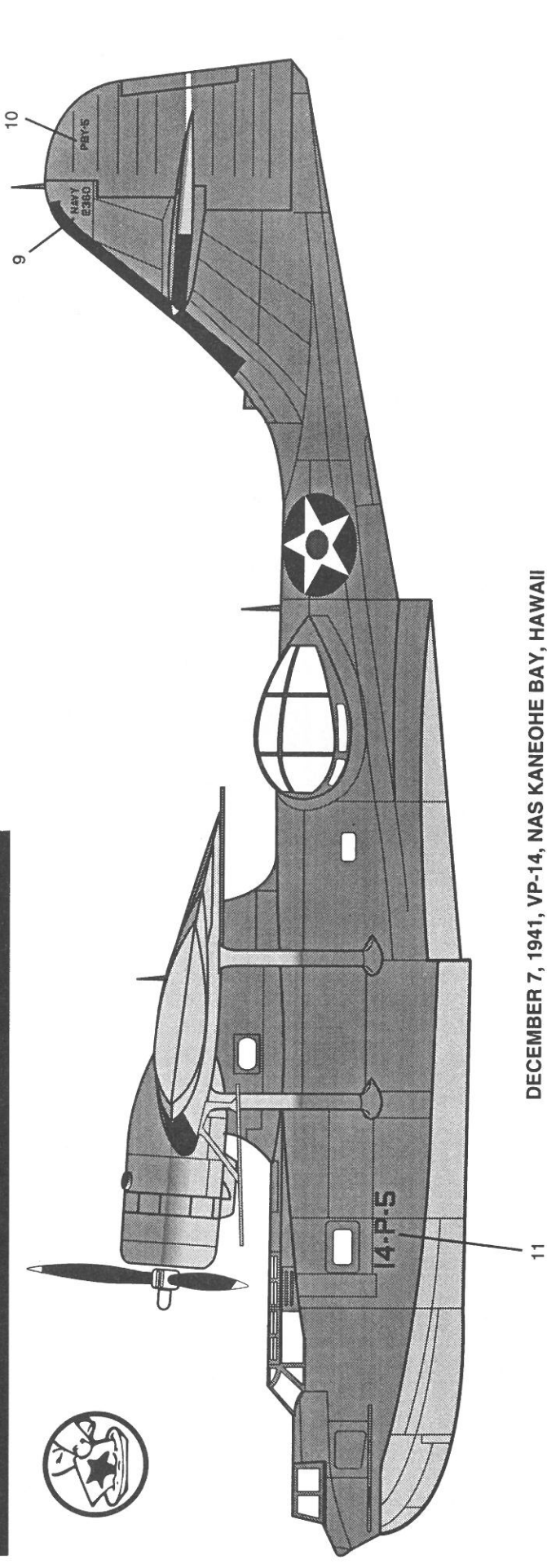

DECEMBER 7, 1941, VP-14, NAS KANEOHE BAY, HAWAII

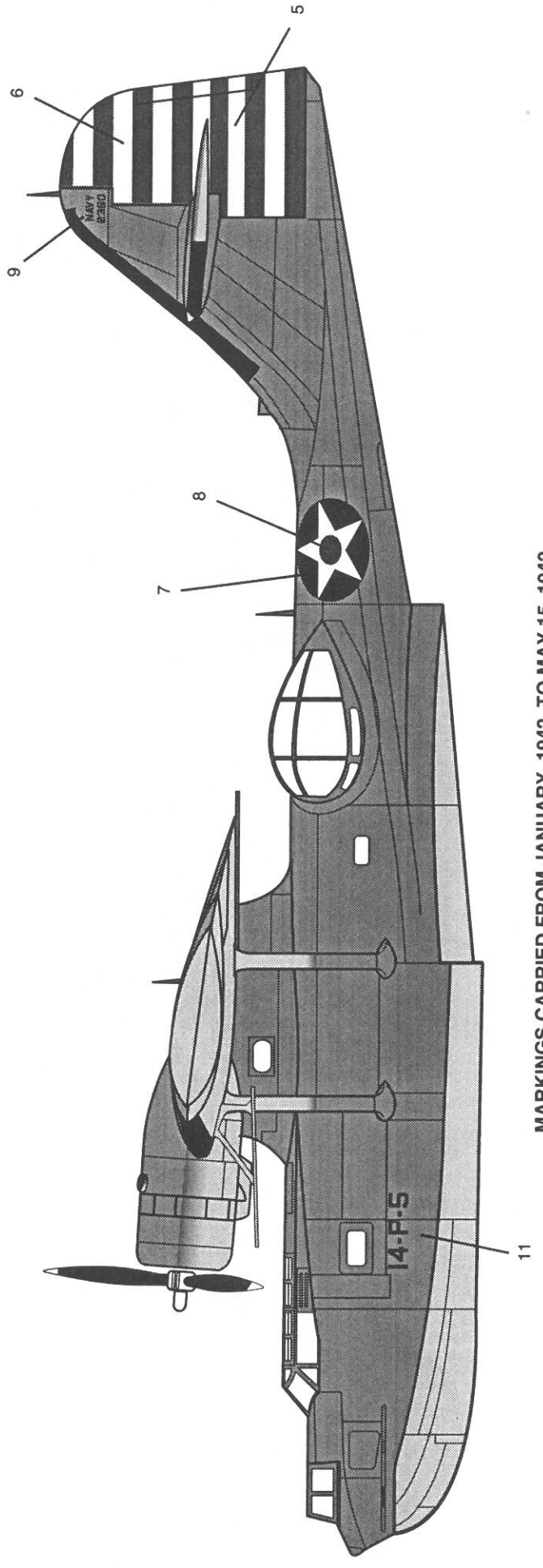

MARKINGS CARRIED FROM JANUARY, 1942, TO MAY 15, 1942

PBY-5 DECAL PLACEMENT

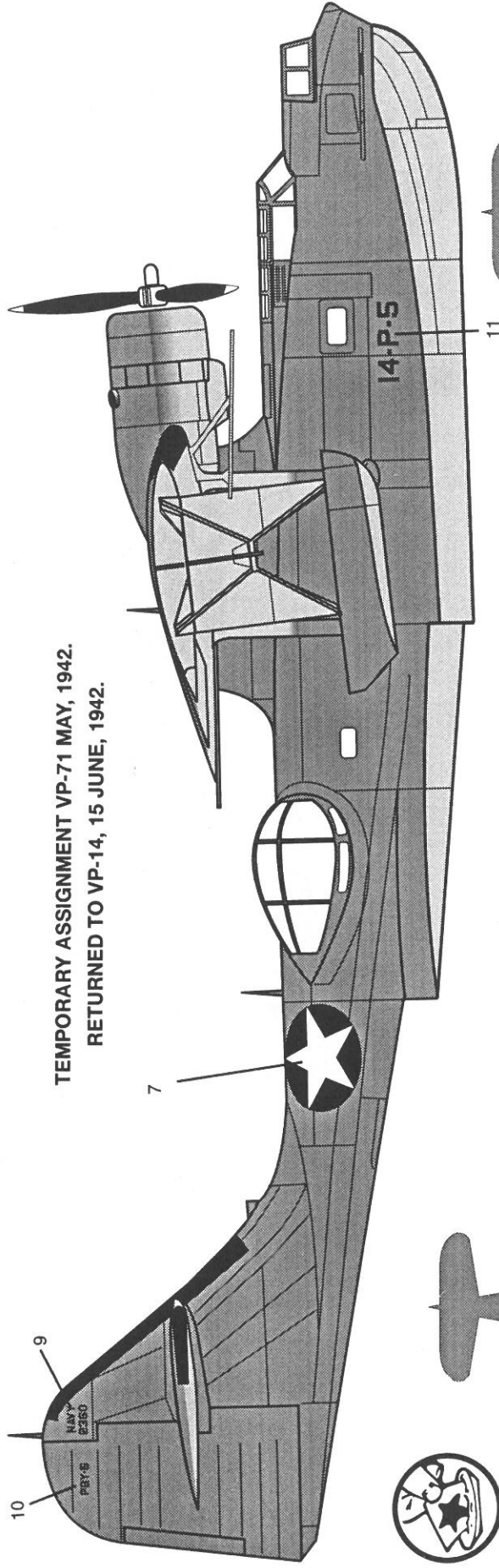

TEMPORARY ASSIGNMENT VP-71 MAY, 1942.
RETURNED TO VP-14, 15 JUNE, 1942.

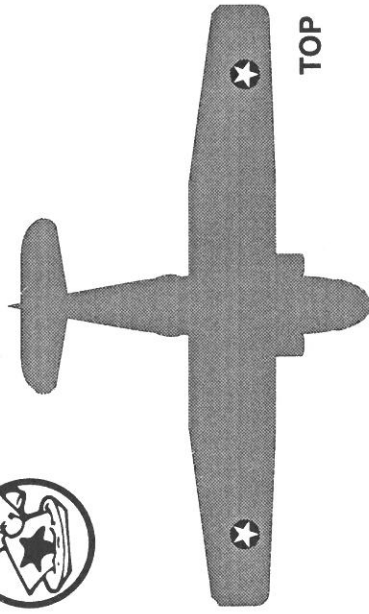

TOP

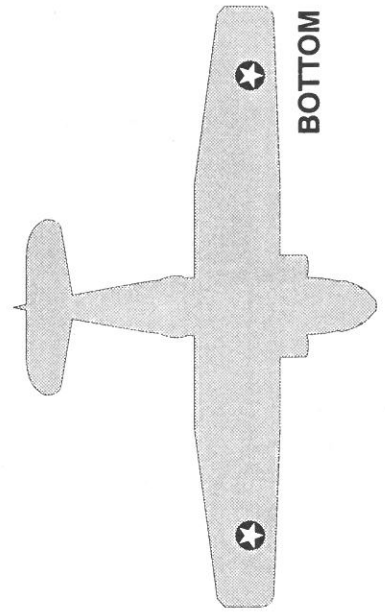

BOTTOM

JANUARY - MAY, 1942

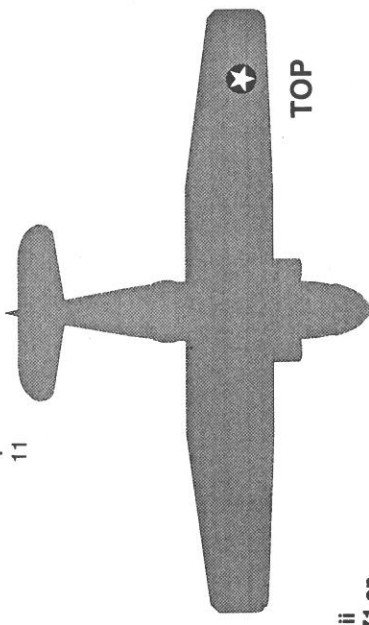

TOP

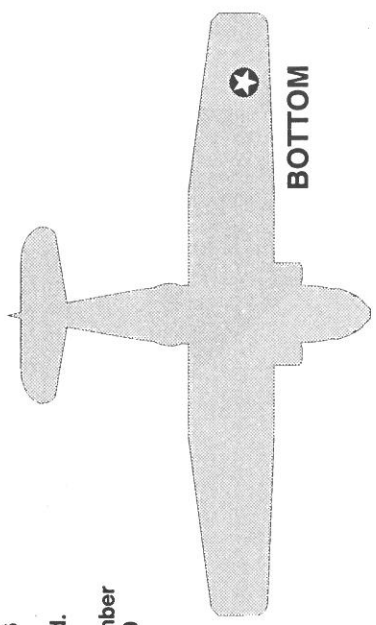

BOTTOM

MAY, 1942 - JUNE 1943

PBY-5, BUONO 2360, was assigned to NAS Kaneohe Bay, Hawaii at the outbreak of the war. It was temporarily assigned to VP-71 on 18 April, 1942, then returned to VP-14 on 15 June, 1942. On 26 August, 1942, 2360 was burned by its crew to avoid falling in the hands of the Japanese after it had been severely damaged.

During this time, U.S. insignia and markings underwent a number of changes. We have shown here the variety of markings 2360 carried during its year of operational service.