



독일육군 중전차 타이거-1 초기형

1/35TH SCALE

GERMAN ARMY HEAVY TANK **TIGER-I** EARLY VERSION

TECHNICAL SPECIFICATION

성능 및 제원

WEIGHT

*Combat weight : 56.9 tons
*Transport weight : 44.6 tons

DIMENSIONS

*Length overall : 8.24 m (27' - 9")
*Hull length : 6.20 m (20' - 8 1/2")
*Width : 3.07 m (12' - 10")
*Height : 3.00 m (9' - 10")

TRACKWORK

*Type : Single line
*Centers : 2.82 m (9' - 3 1/2")
*Width : 0.725 m (28 1/2")

MAIN ARMAMENT

1 x 88 mm (3.46 ins.) KwK 36 L/56
*Traverse : 360°
*Operation : 2 speed, hydraulic & hand
*Elevation : + 17°, - 6.5°

SECONDARY ARMAMENT

1 x 7.92 mm MG 34 co-axial
1 x 7.92 mm MG 34 bow
1 x 9 mm MP 38/40
1 x 27 mm WALTHER Signal pistol

AMMUNITION

*88 mm AP & HE : 92 rds.
*7.92 mm : 5,700 rds. (38 belts 150 rds.)

ENGINE

1 x MAYBACH HL-210-P45 V-12
Cylinder Watercooled Gasoline of 21,353cc developing 642 bhp at 3,000 r.p.m.

TRANSMISSION

*MAYBACH-OLVAR 40 12 16
Preselective, 8 forward 4 reverse.

STEERING UNIT

*HENSCHEL L600C Regenerative controlled differential, hydraulic operated.

SUSPENSION

*Torsion bar, Hydraulic shock absorbers on front & rear axle, housed in hull.

FUEL CAPACITY

*534 liters (125 Imp.gals. / 141 U.S.gals.)
*Fuel consumption (100 km) :
Road - 500 ltrs. Cross country - 900 ltrs.

PERFORMANCE

*Max speed (Road) : 38 km/h (23 mph)
*Max speed (Cross country) : 20 km/h (12 mph)
*Range (Road) : 117 km (73 miles)
*Range (Cross country) : 67 km (42 miles)
*Fording depth (first 495 vehicles) : 3.96 m (13' - 0")
*Fording depth (remainder) : 1.2 m (3' - 11")
*Max gradient : 35° (70%)
*Trench crossing : 1.8 m (5' 11")

ARMOR

*Type : Rolled homogenous plate interlocking stepped joints welded construction.
*Thickness : 26 ~ 110 mm

SIGHTING

*Main armament : 1 x TZF 9B binocular telescope
*Commander : 5 x vision slits in barrel type cupola

CREW

*5 men - commander, gunner, loader, driver, radio operator/MG gunner

PRODUCTION

*Manufacturer : HENSCHEL Werke.
*A total of 1,354 vehicles in Aug. 1942 until Aug. 1944.

중량

*전투 중량 : 56.9톤
*차체 중량 : 44.6톤

길이

*전장 : 8.24 m
*차체장 : 6.20 m
*전폭 : 3.07 m
*전고 : 3.00 m

캐터필러

*형식 : 싱글핀 방식
*중심선간 거리 : 2.82 m
*폭 : 0.725 m

주무장

88 mm KwK 36 L/56 1문
*선회각 : 360°
*조작 : 2단 변속, 유압 및 수동식
*앙각(仰角) : + 17°, - 6.5°

부무장

*7.92 mm MG 34 동축 기관총 1정
*7.92 mm MG 34 전면 기관총 1정
*9 mm MP 38/40 자동 소총 1정
*27 mm 윌터 신호 권총 1정

탄약

*88 mm 성형 작약탄 및 고폭탄 : 92발
*7.92 mm 5700발(150발들이 탄띠 38개)

엔진

*마이바하 HL-210-P45 12기통 가솔린 엔진, 배기량 21,353 cc - 3,000회전 642마력

트랜스미션

*마이바하-올바 40 12 16 가변 연동식, 전진 8단 - 후진 4단

조향장치

*헨셀 L600C 디퍼렌셜 록열 유압 조종식 서스펜션
*토션바 형식, 차체 내측 전,후 역셀에 쇼크 압소버 장착

연료적재량

*534 리터 (141 갤런)
*연료 소모량 (100km기준) :
도로 - 500 리터, 야지 - 900 리터

기동성

*최대 속도(도로) : 38 km/h
*최대 속도(야지) : 20 km/h
*행동 거리(도로) : 117 km
*행동 거리(야지) : 67 km
*도하 수심(양산 495대까지) : 3.96m
*도하 수심(중,후기형) : 1.2m
*등판 각도 : 35° (70%)
*초호(超濠) 반경 : 1.8m

장갑

*형식 : 주조 및 압연균질 방탄장갑
*두께 : 26 ~ 110 mm

조준장치

*주무장 : TZF 9B 쌍안 텔레스코프 1기
*전차장 큐포라 : 슬릿형 잠망경 5기

승무원

*5명 - 전차장, 포수, 조준수, 조종수, 무선수/기관총 사수

생산

*제조 회사 : 헨셀 중기
*1942년 8월부터 1944년 8월까지 총 1,354대 생산.

■ 조립하기전에

- 제품을 조립하기전에 설명서를 끝까지 잘 읽어본다.
- 부품을 자를때에는 칼이나 니퍼로 깨끗이 잘라준다.
- 접착하기전에 부품을 맞추어 확인한 후 접착한다.
- 접착제를 사용할 곳과 사용하지않는 곳에 주의하고 너무 많이 바르지 않도록 한다.
- 에나멜 페인트나 접착제를 사용할때에는 창문을 열어 환기를 시키고 화기를 멀리한다.

- 직매점 겸 A/S센터
- A/S센터
- 총판점 겸 A/S센터
- 유통사업부
- 홈페이지
- 고객상담문의

삼선교: 742-9293, 방배동: 552-9293, 양재동: 575-9997, 용산: 796-1214, 아셈허비센터: 6002-6293,
 본사: 908-7000(교환 147), 동대문: 745-9293
 원아카데미: 907-0940, 양천아카데미: 2691-7108, 강북아카데미: 762-0980, 강남아카데미: 485-6884
 AB허비: (031)458-5591, 서면아카데미: (051)816-9773, 대구아카데미: (053)744-9293
 아카데미피렌디: 904-0000
<http://www.academy.co.kr>
 080-969-7000

1

● → 접착한다. CEMENT ● - - - → 접착금지. DO NOT CEMENT
 ※ ()는 반대측 부품 번호임. () is opposite number.

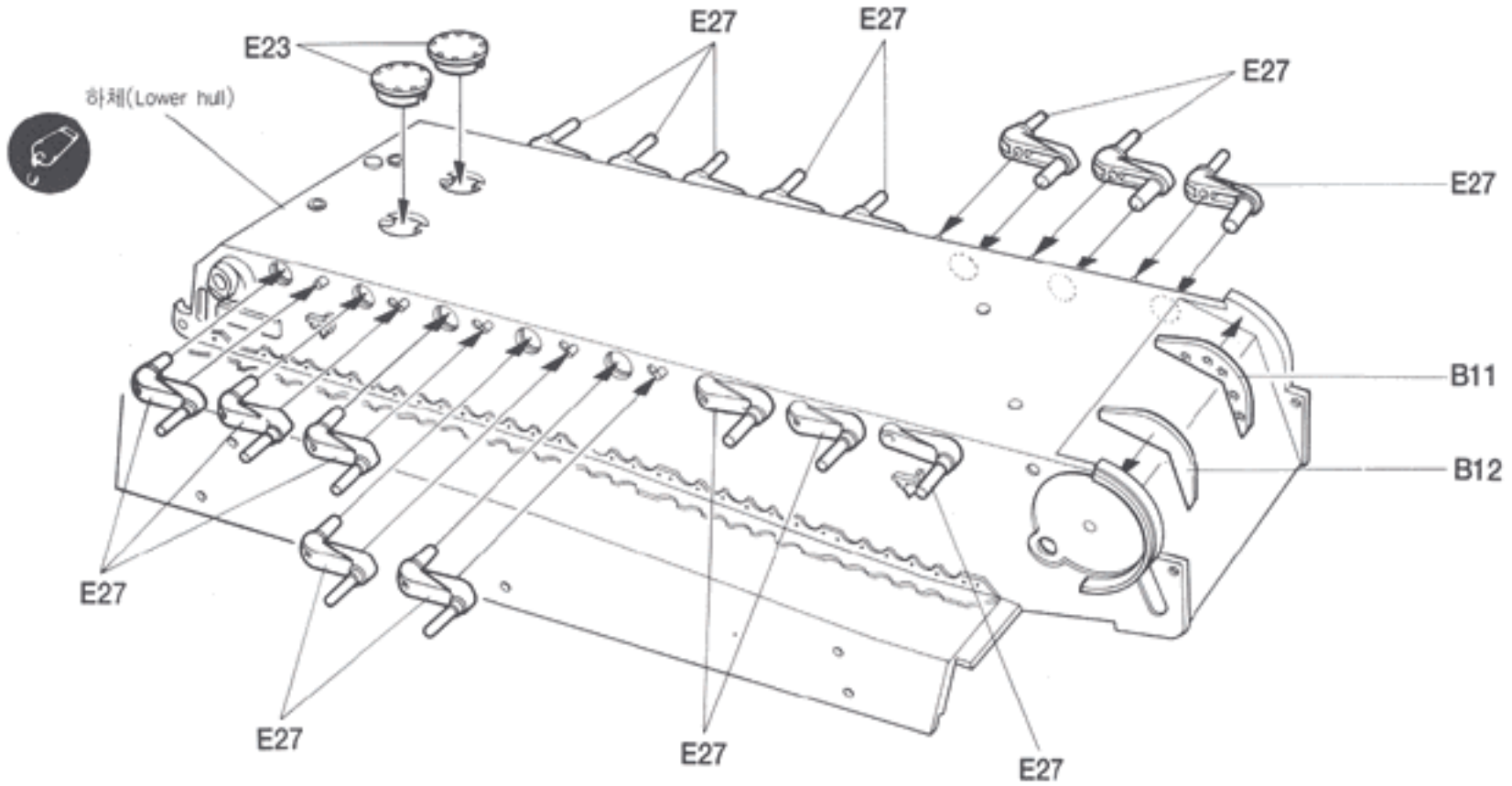

2

A 전륜 (Road wheel)

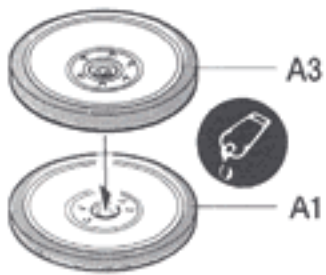

▶타이어: 무광검정색
 Tire: Flat Black



B 전륜 (Road wheel)



C 아이들러 휠 (Idler wheel)



D 기동륜 (Drive sprocket)

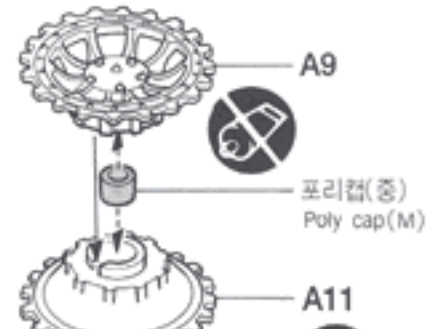

3

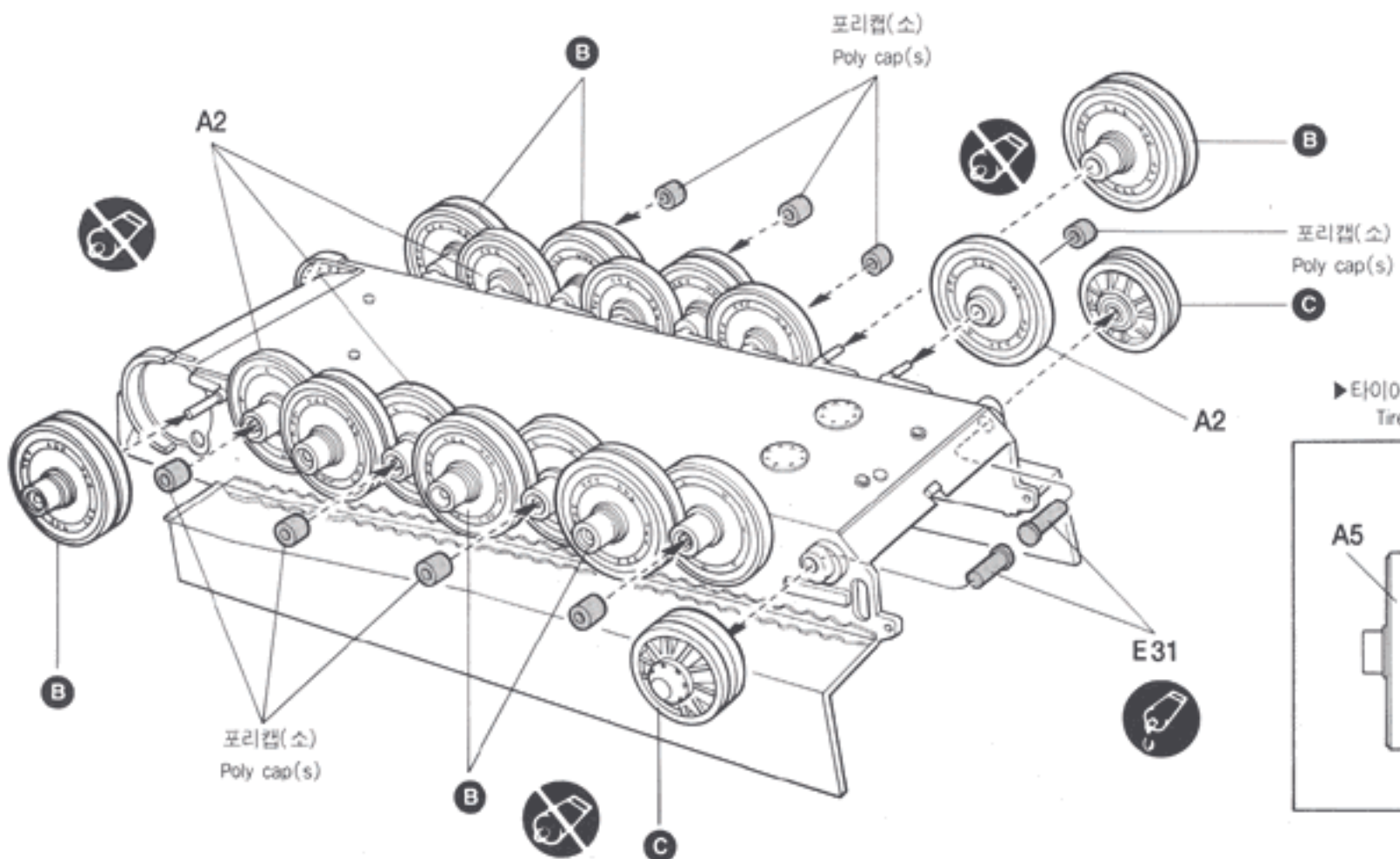

▶타이어: 무광검정색
 Tire: Flat Black

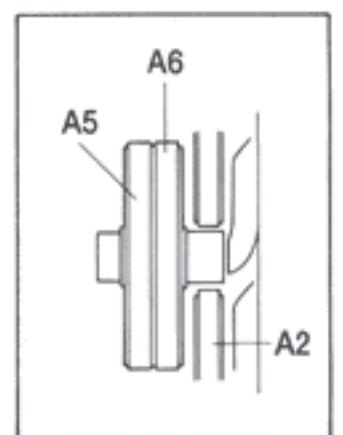

4

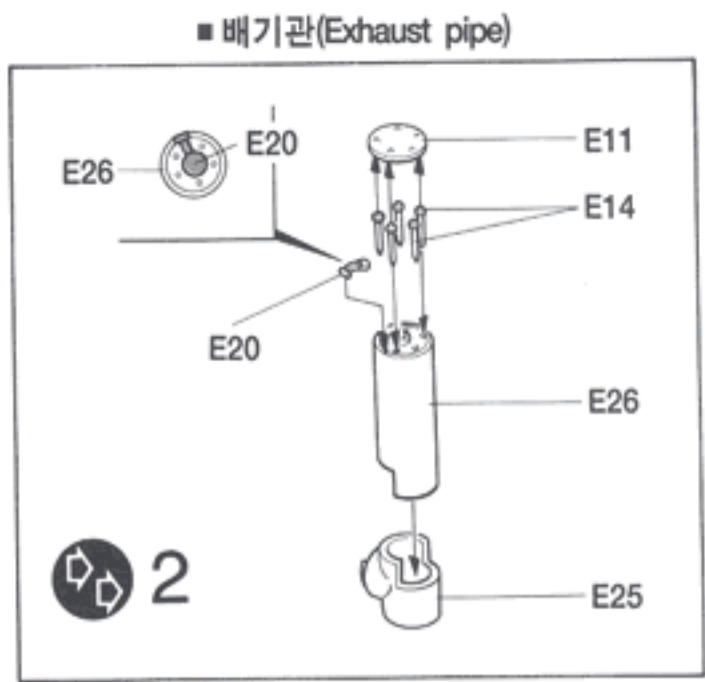
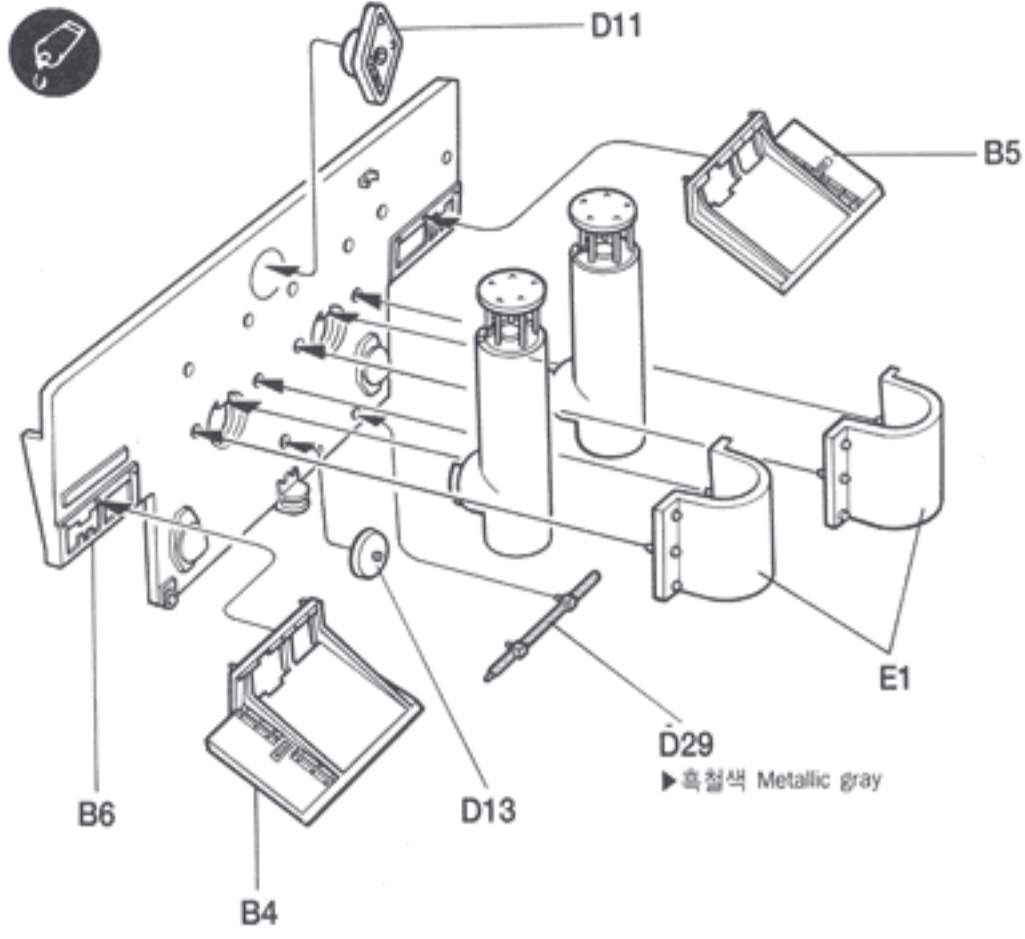

5

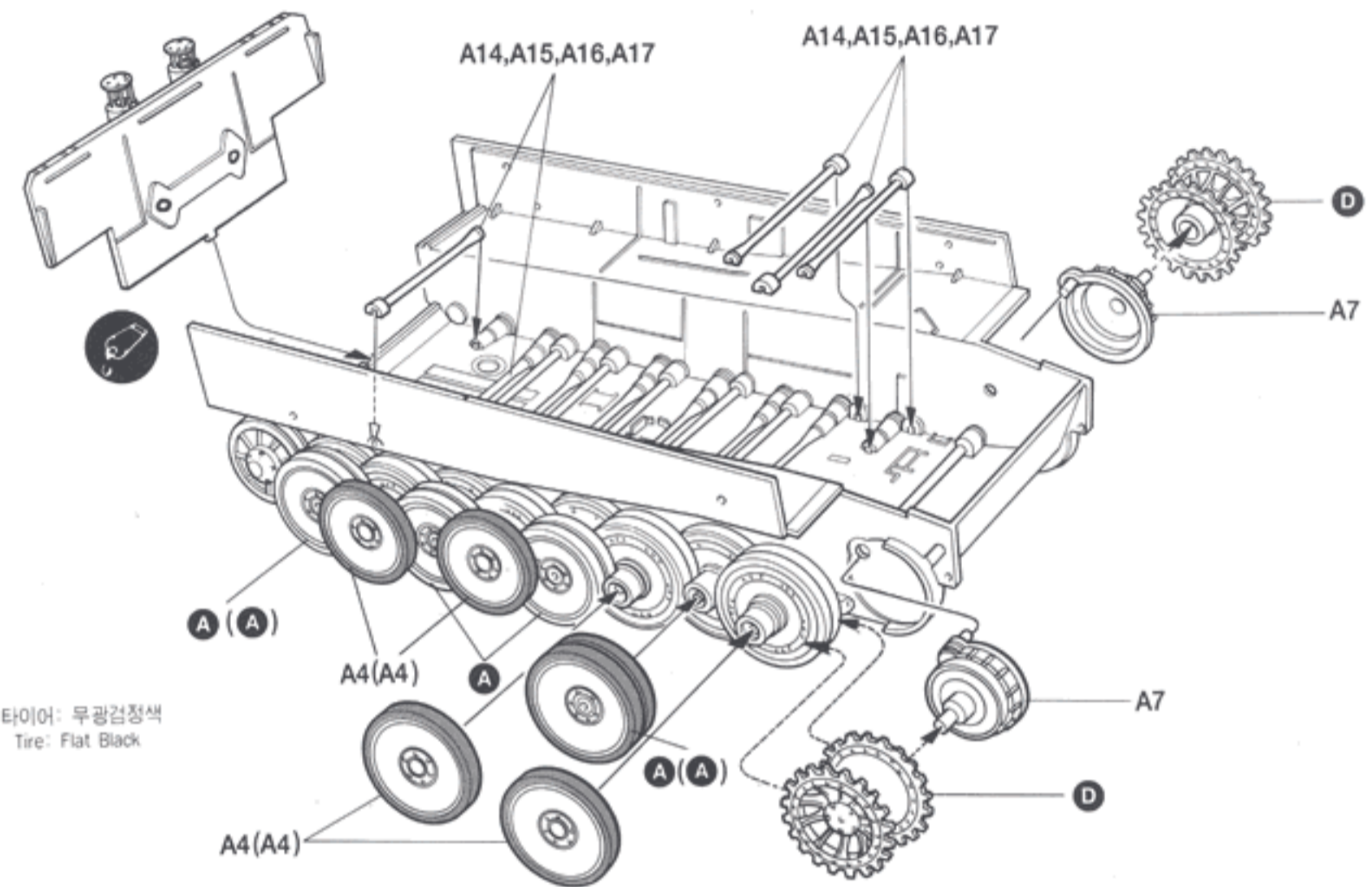

▶타이어: 무광검정색
Tire: Flat Black

6

■ 파이펠 에어필터(Feifel air filter)

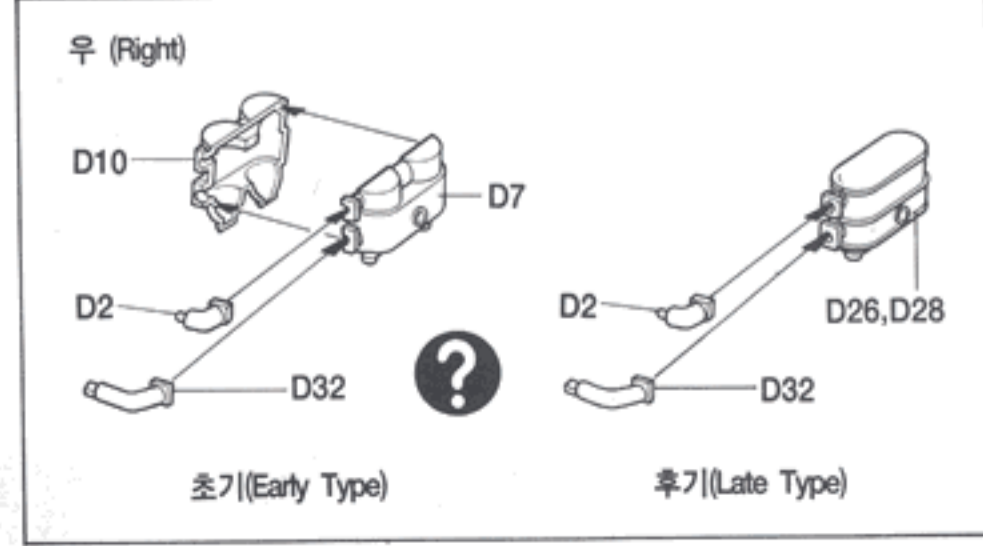
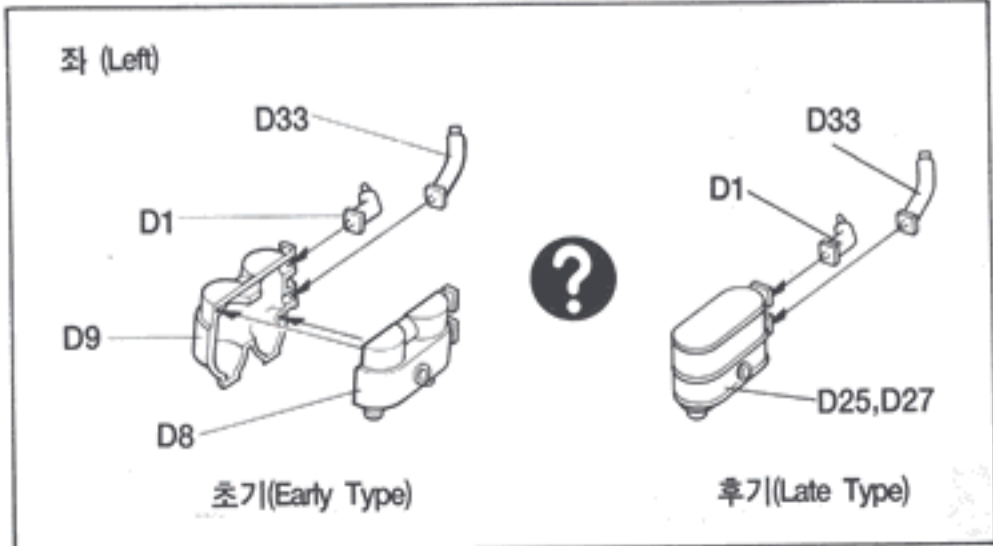

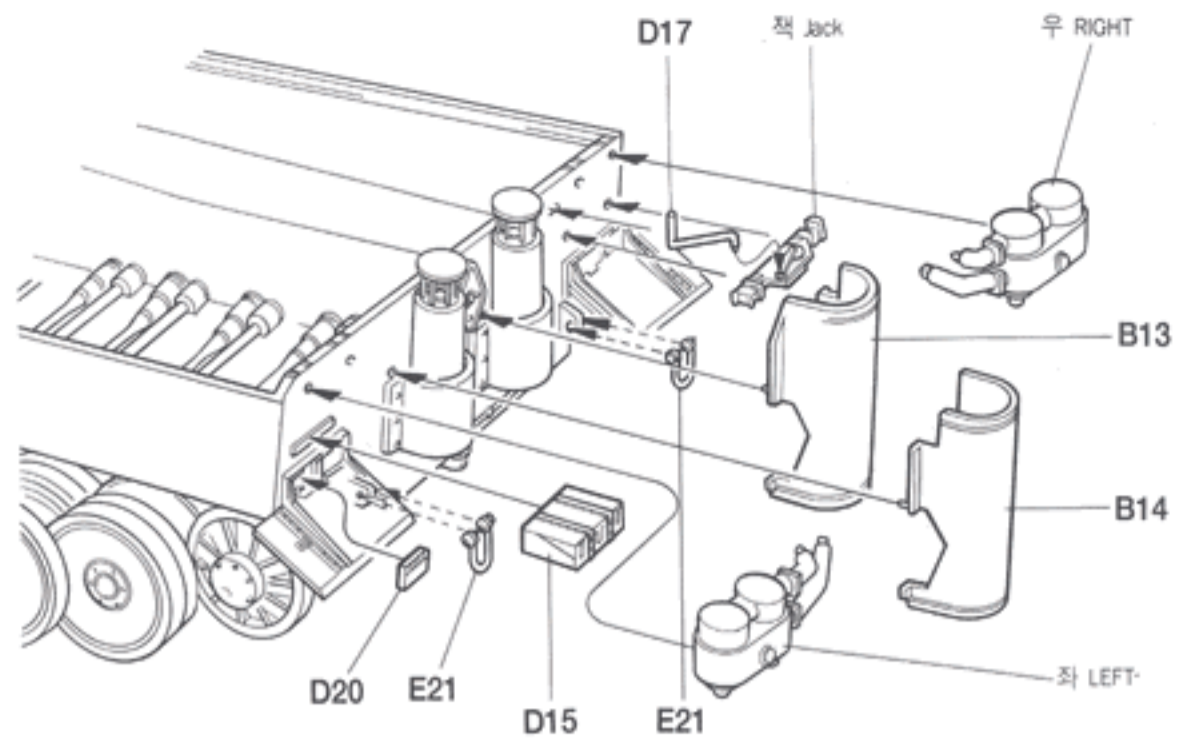
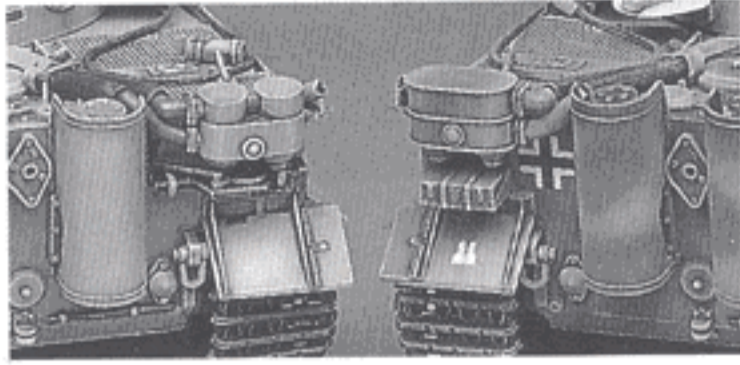
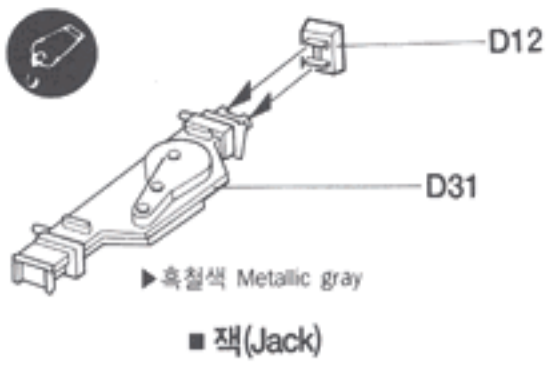

7

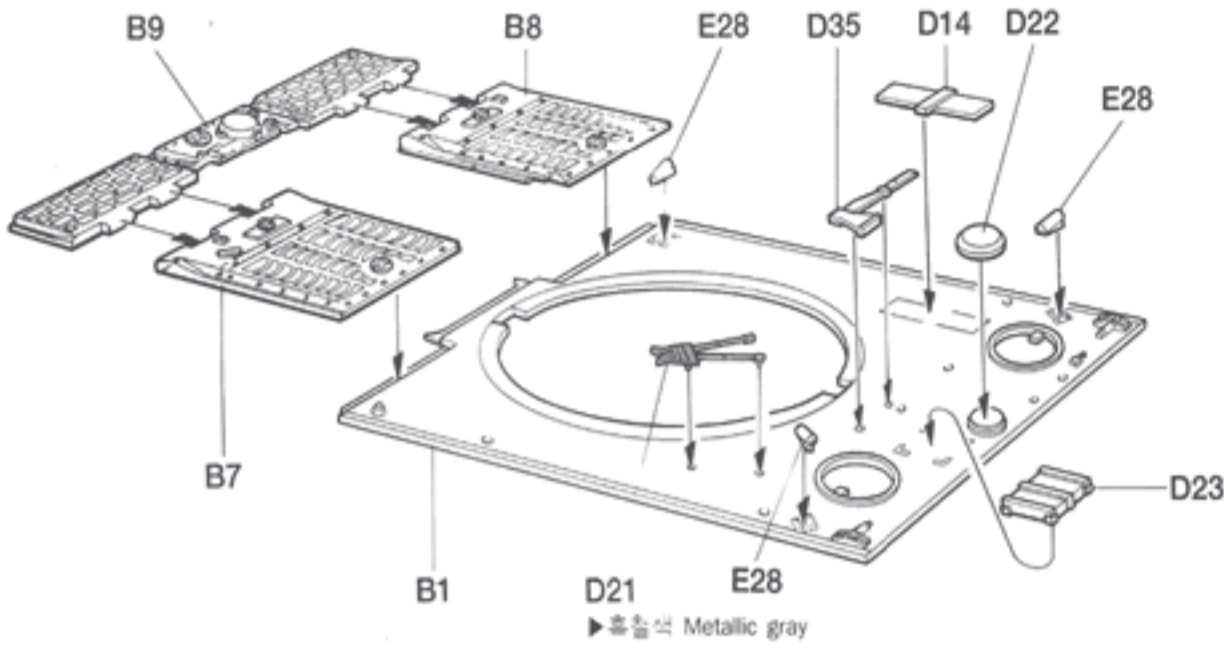

■ 열린 상태 (Open position)

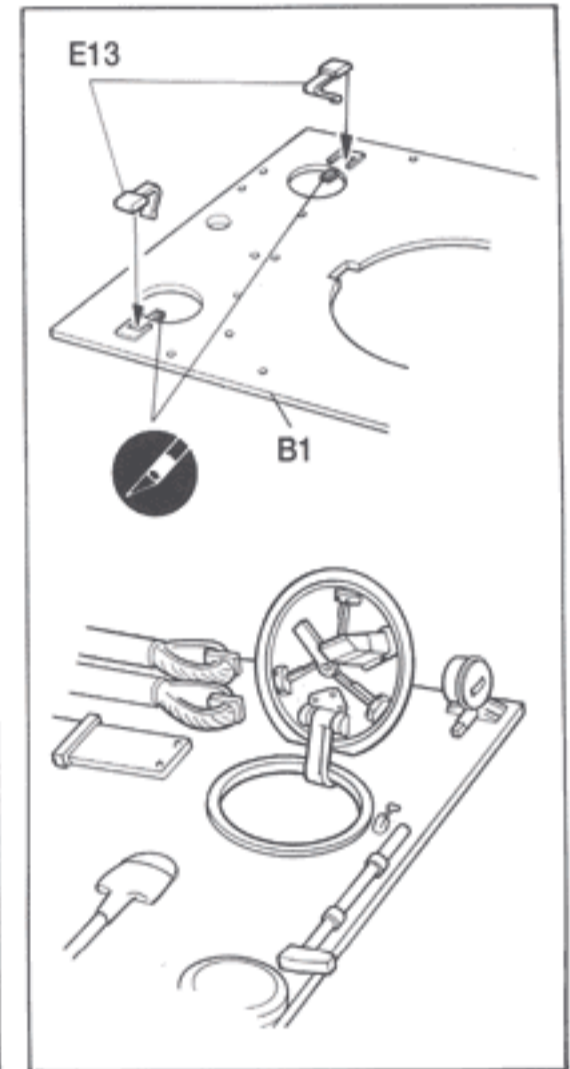

8

■ 전면 햇치 (Front hatch)

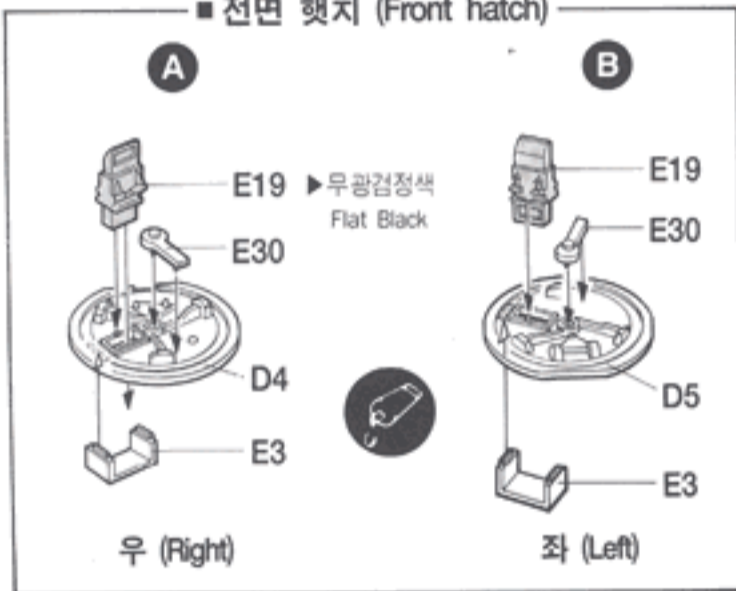

■ 엔진 햇치 (Engine access hatch)

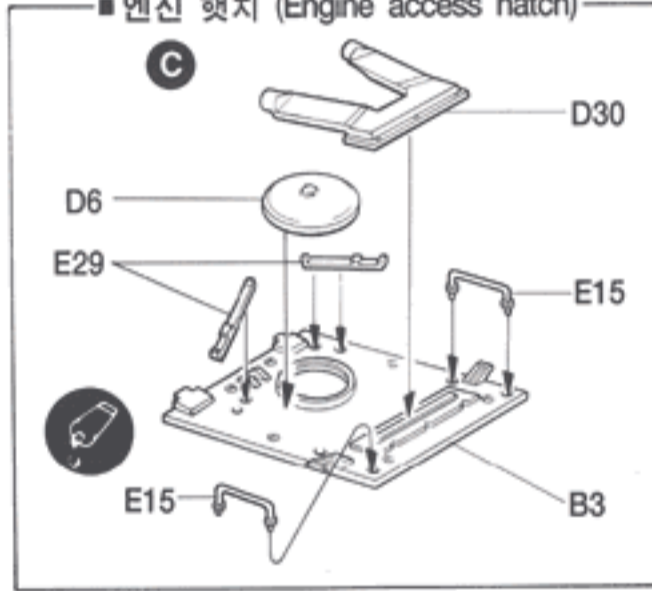

9

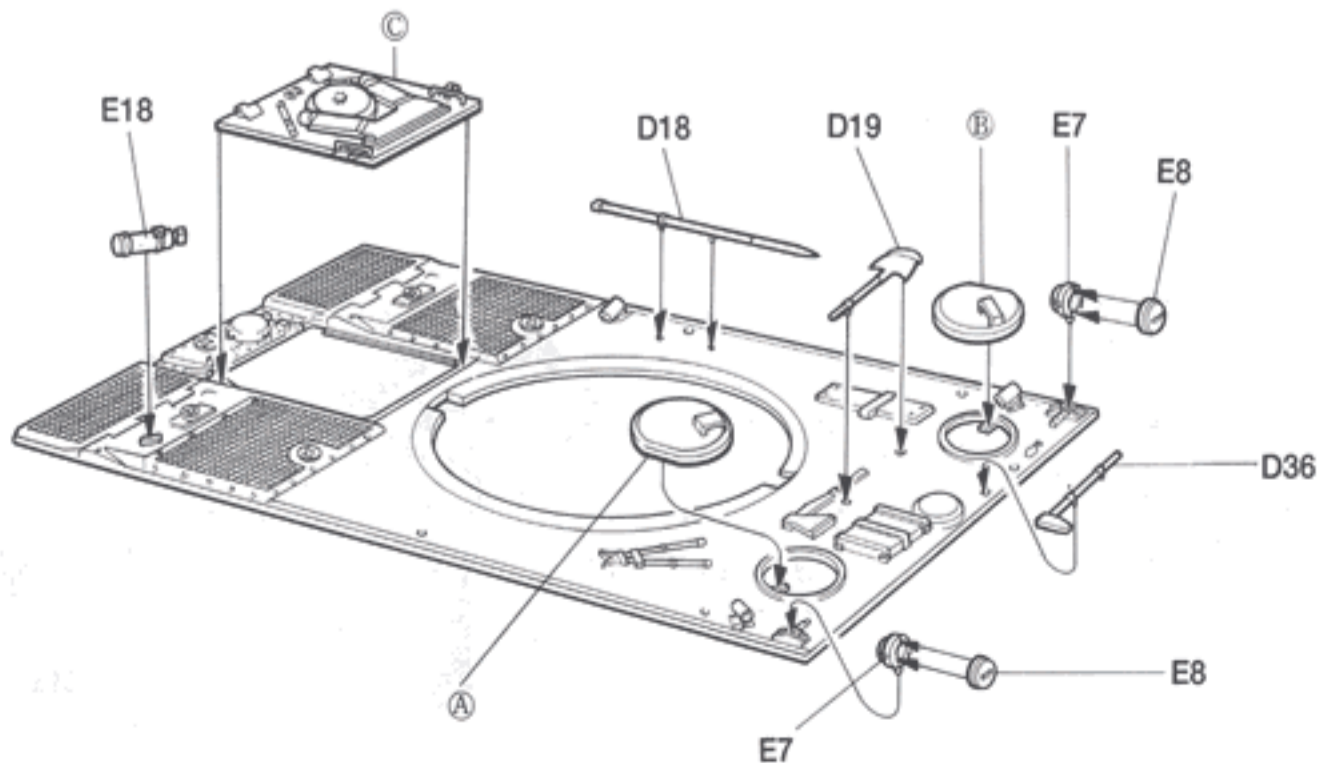

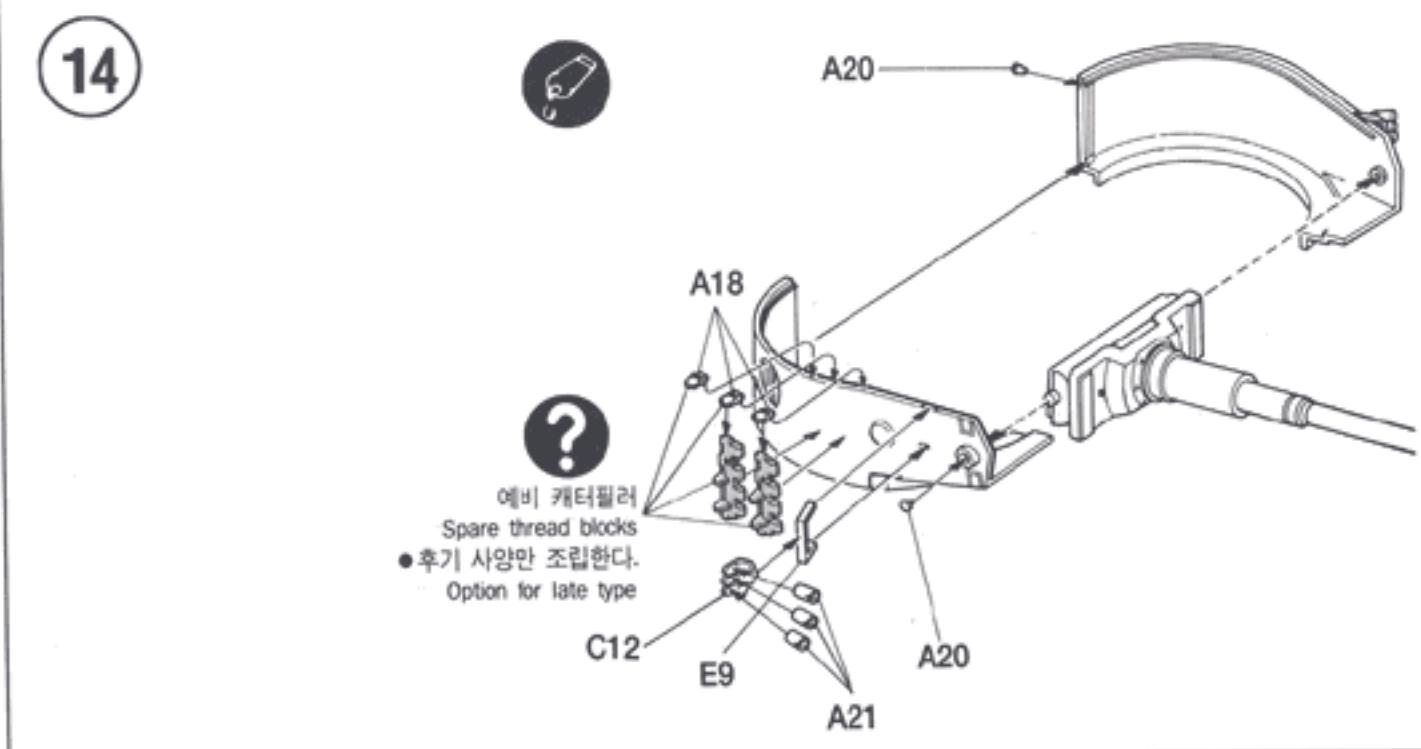
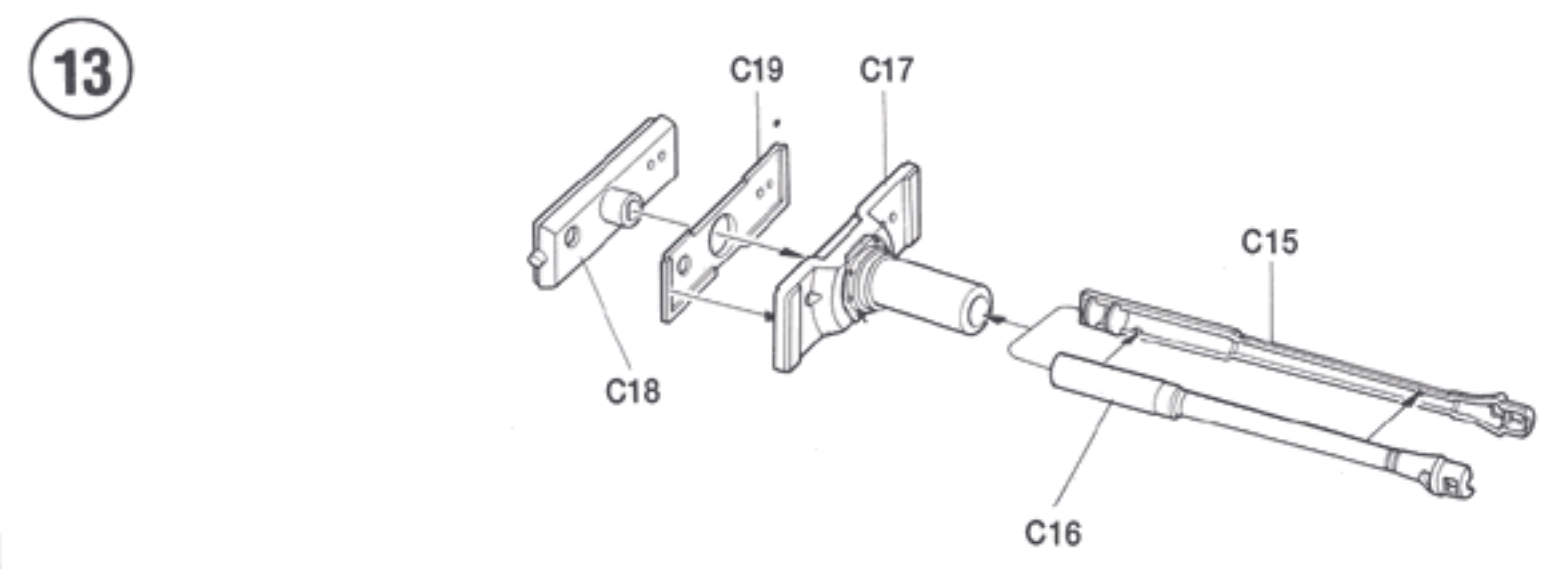
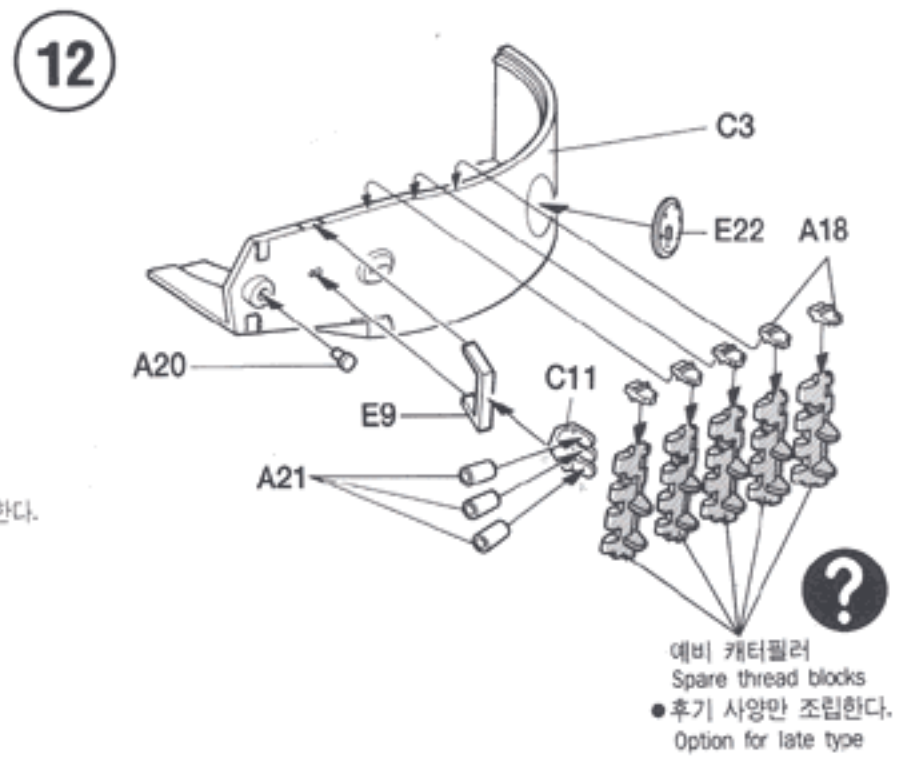
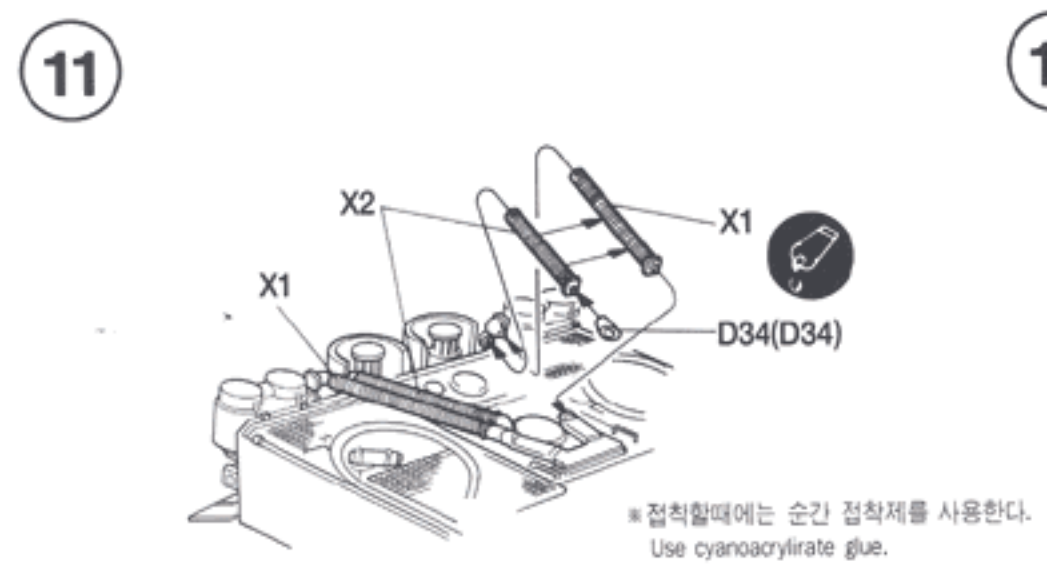
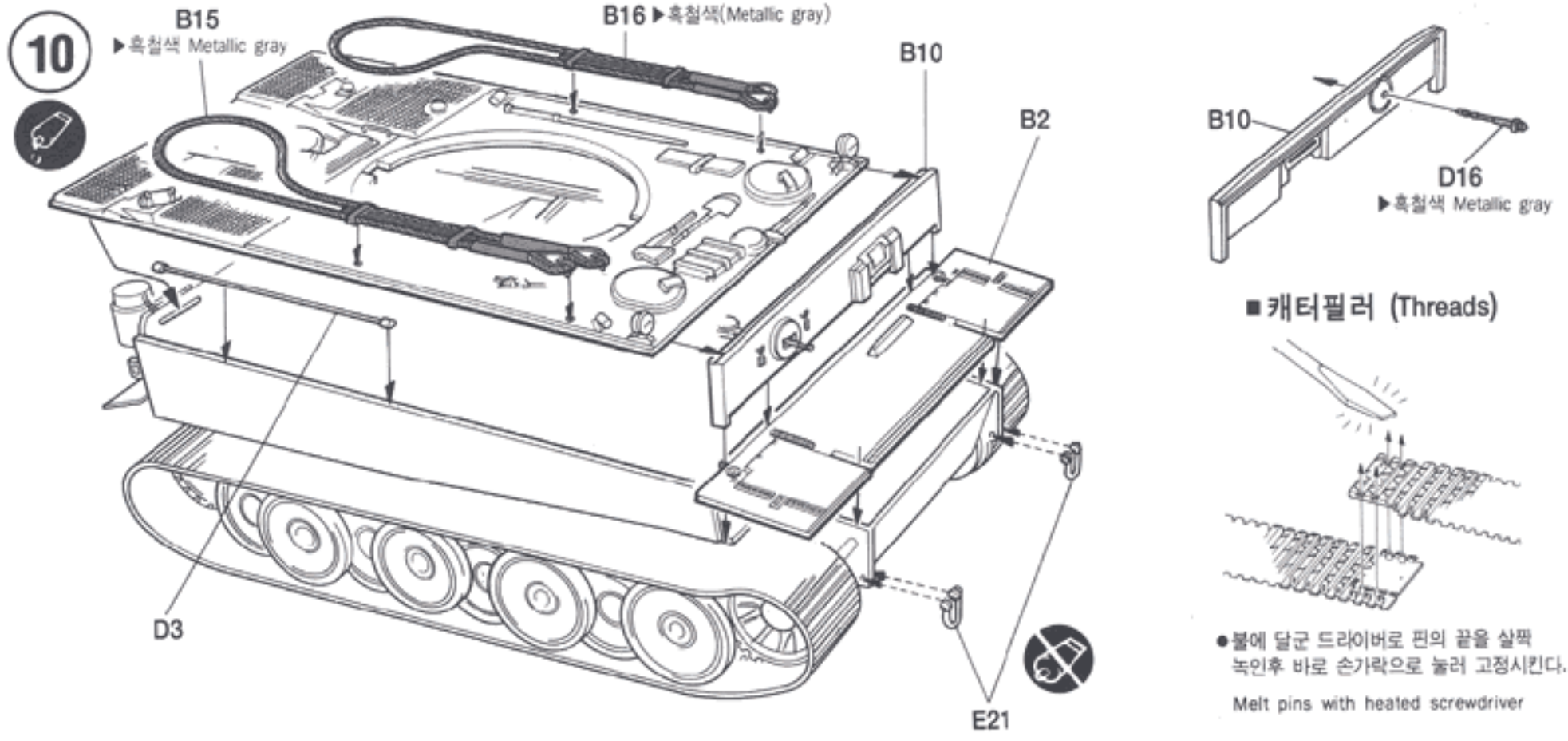

15

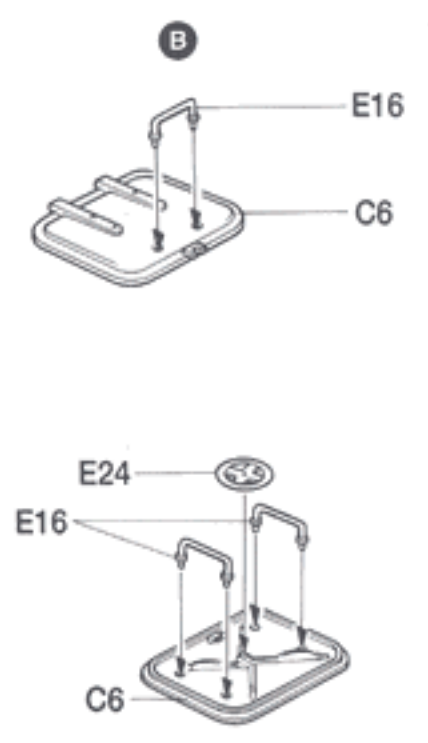
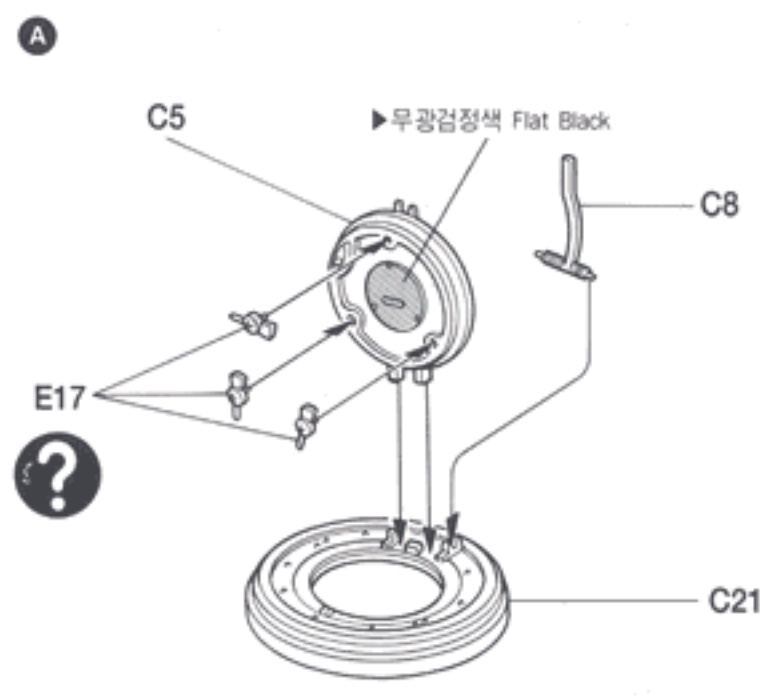
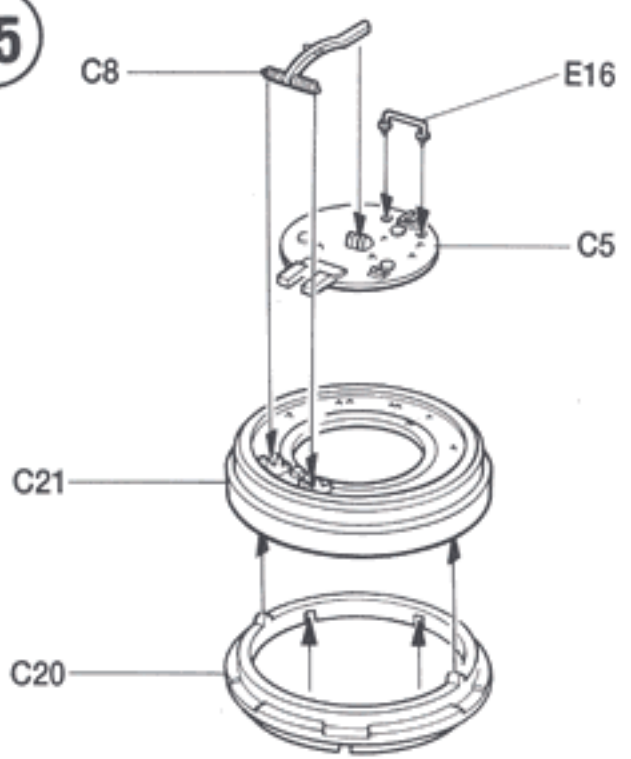

16

■ 수납상자 (Stowage bin)

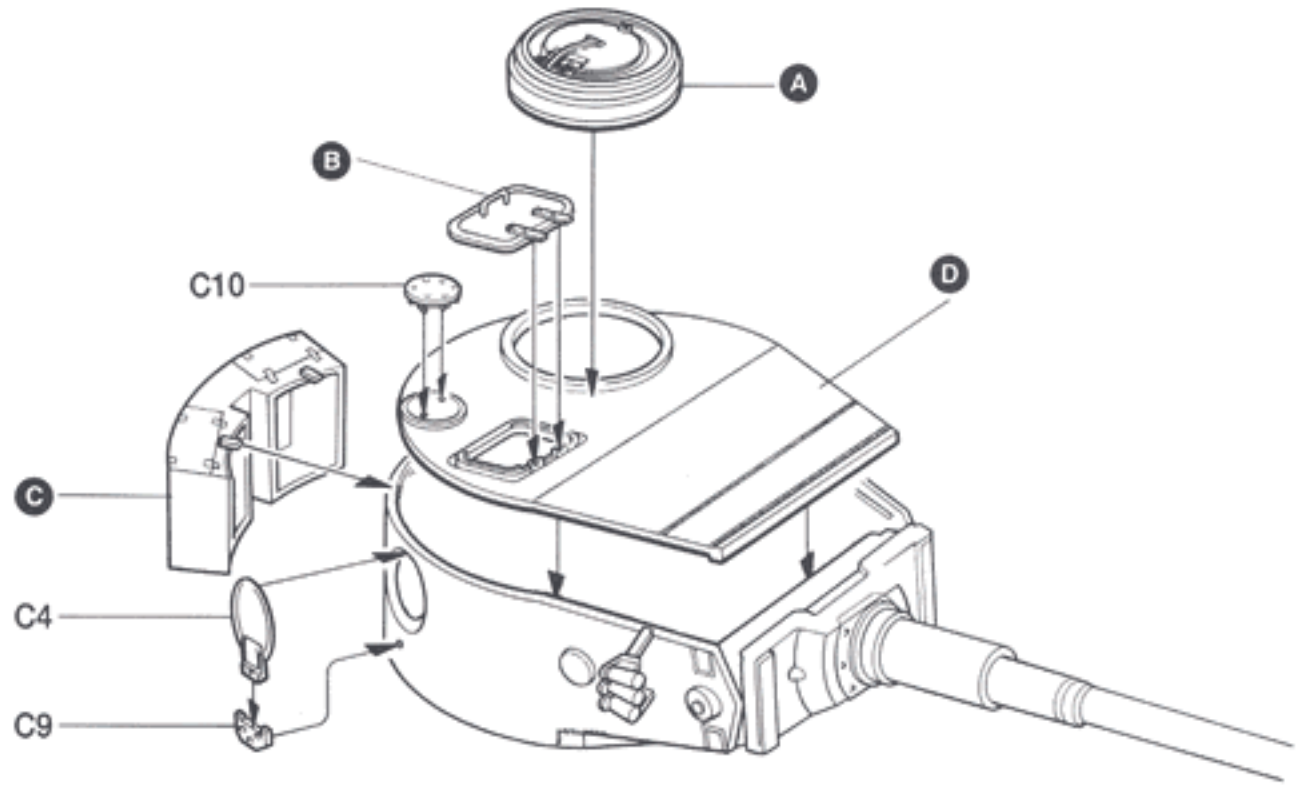
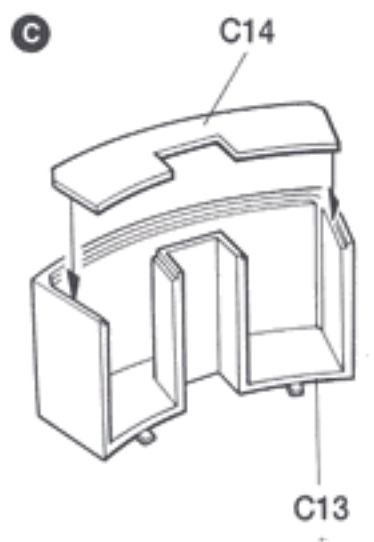

17

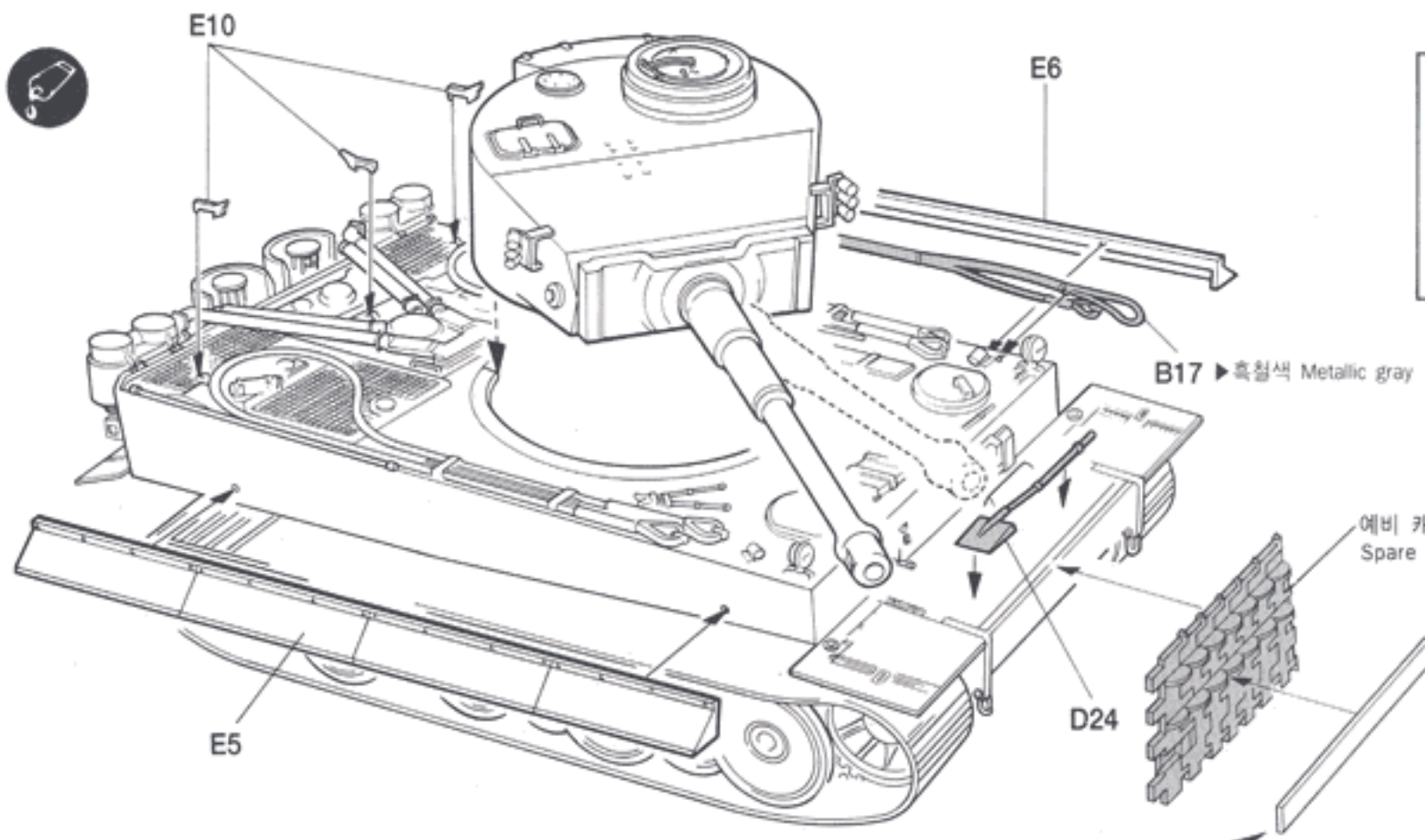

■ 예비 캐터필러 (Spare thread blocks)

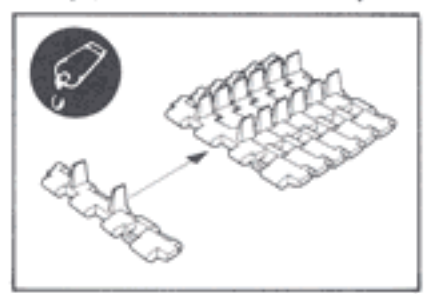

예비 캐터필러 Spare thread blocks

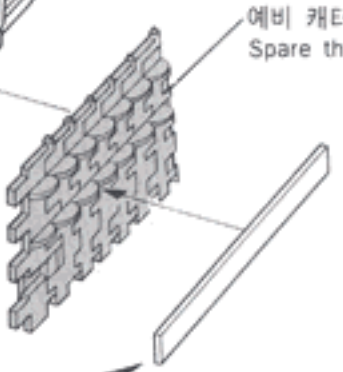

■ 예비 캐터필러 마운트 (Spare thread bracket)

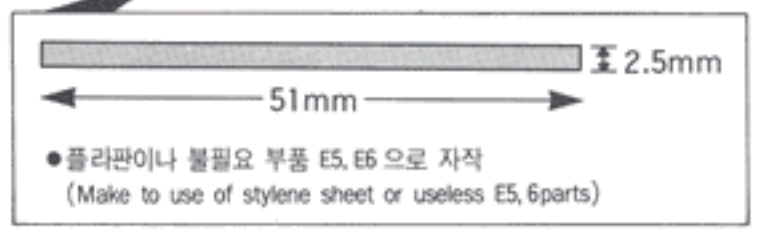

색칠 및 전사지 붙이기 Painting and Decal Placement

※ ()는 반대측 번호임
() is opposite number.

A-제2 SS 전차사단 '다스라이히' 1943년 쿠르스크, 러시아
2ND SS PANZER DIVISION 'DAS REICH', KURSK, RUSSIA, 1943

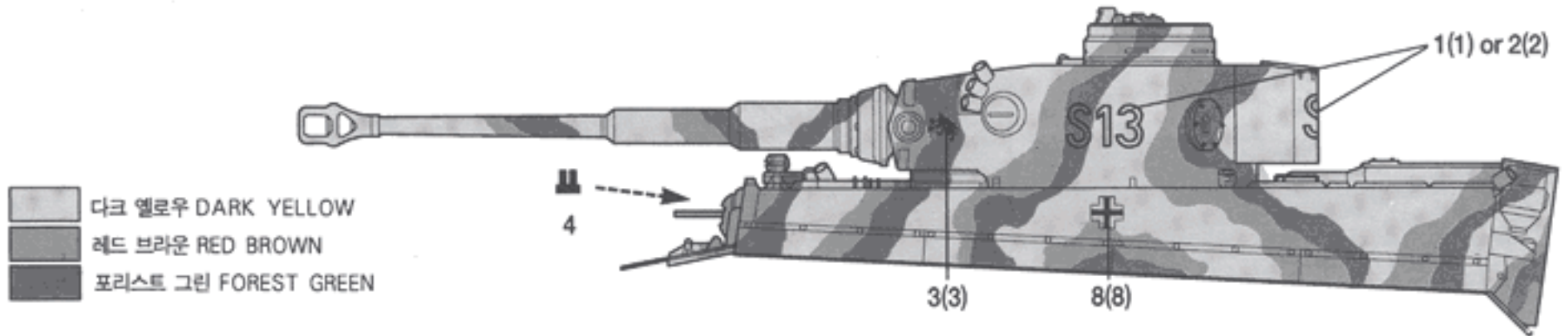

B-제1 SS 전차사단 '라이프스탄다르테 아돌프 히틀러'
1ST SS PANZER DIVISION 'LEIBSTANDARTE ADOLF HITLER'
미하일 비트만 중위 탑승차 1944년 1월 베르디체프, 러시아
COMMANDER LT. MICHAEL WITTMANN, BERDICHEV, RUSSIA, JANUARY 1944

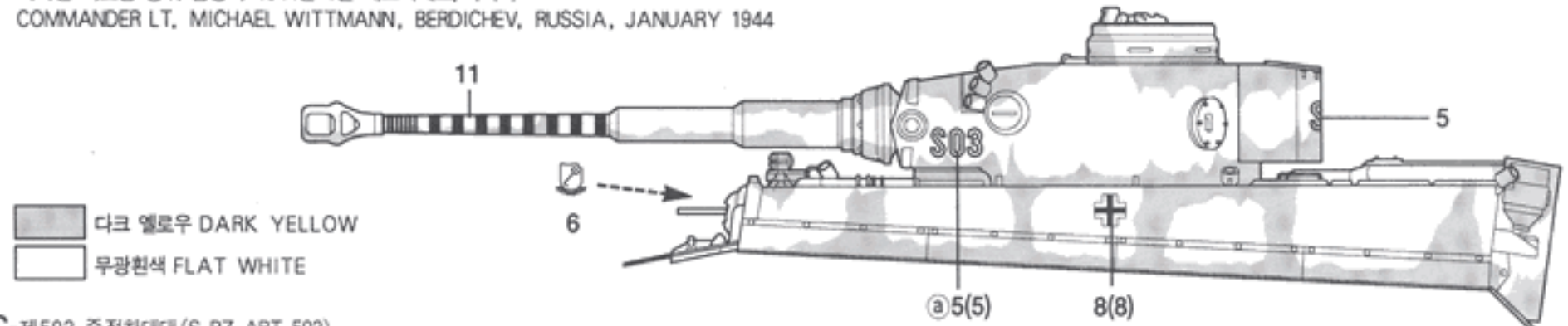

C-제502 중전차대대 (S. PZ. ABT. 502)
502ND HEAVY TANK BATTALION
a) 123호차 (NO. 123): 1942년, 레닌 그라드, 러시아 (LENINGRAD, RUSSIA, 1942)
b) 217호차 (NO. 217): 오토 카리우스 중위 탑승차 1943년 로베츠, 러시아
COMMANDER LT. OTTO CARIUS, LOVETZ, RUSSIA, 1943

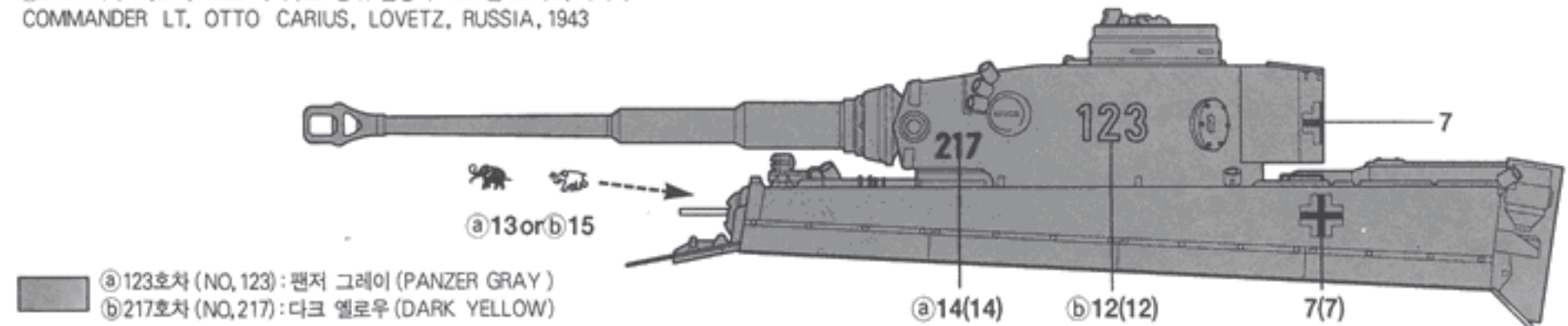

D-제504 중전차대대 (S. PZ. ABT. 504) 1943년 튀니지, 아프리카 군단
504TH HEAVY TANK BATTALION, TUNISIA, AFRIKA KORP, 1943

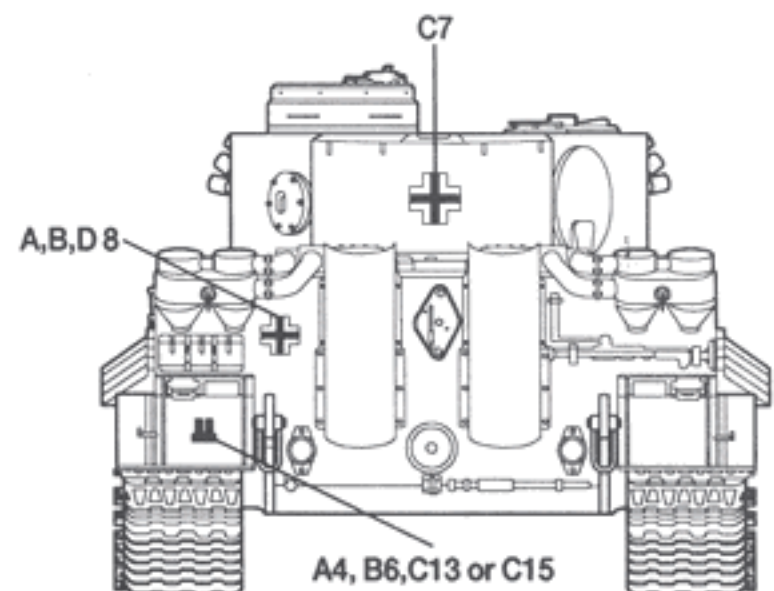
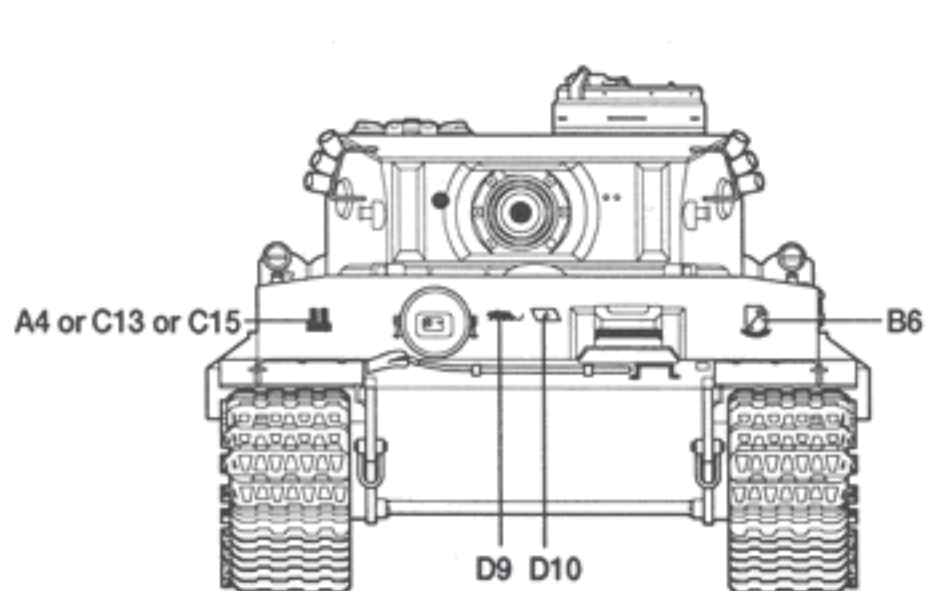
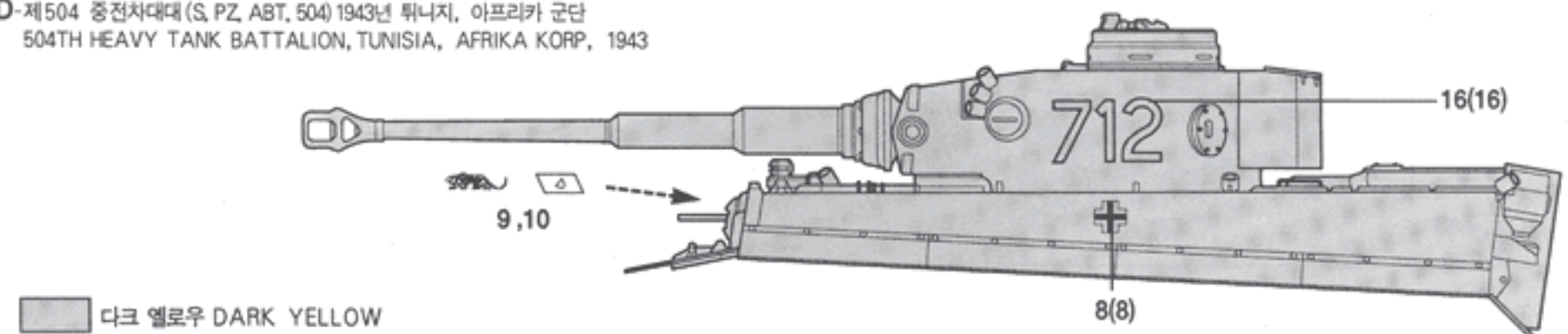

부품도 Parts Locating Diagram

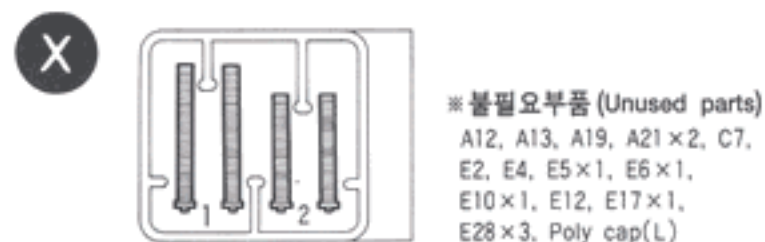
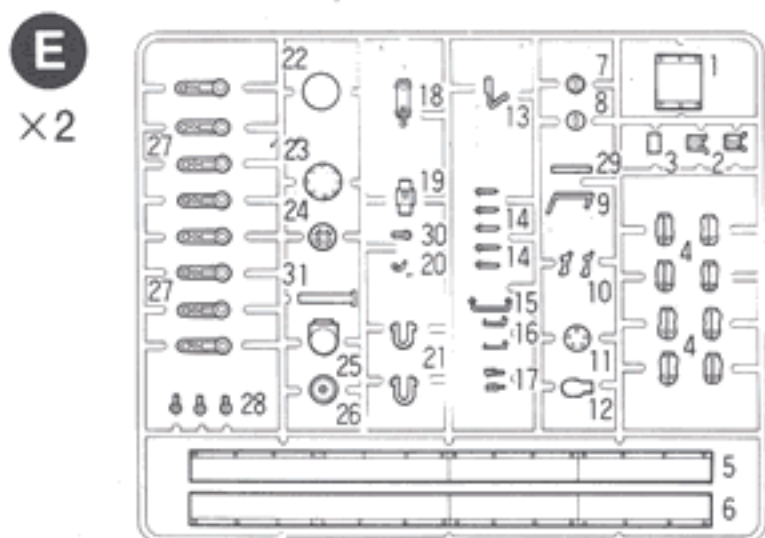
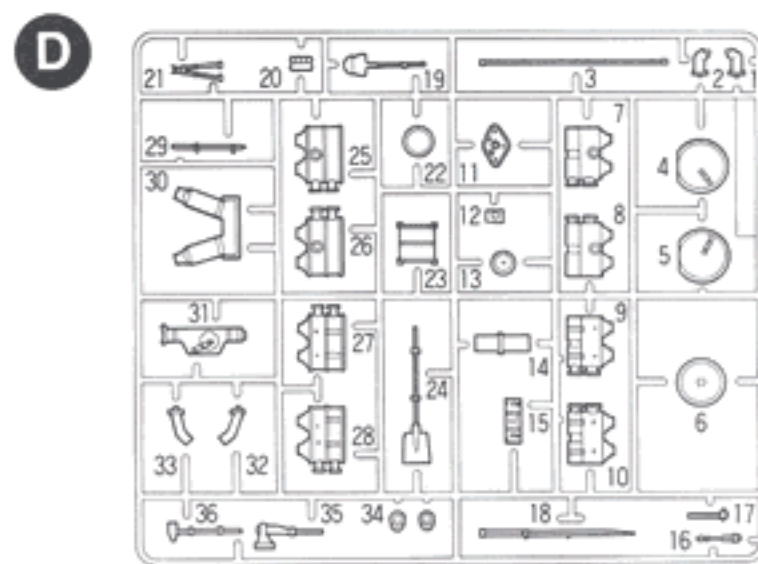
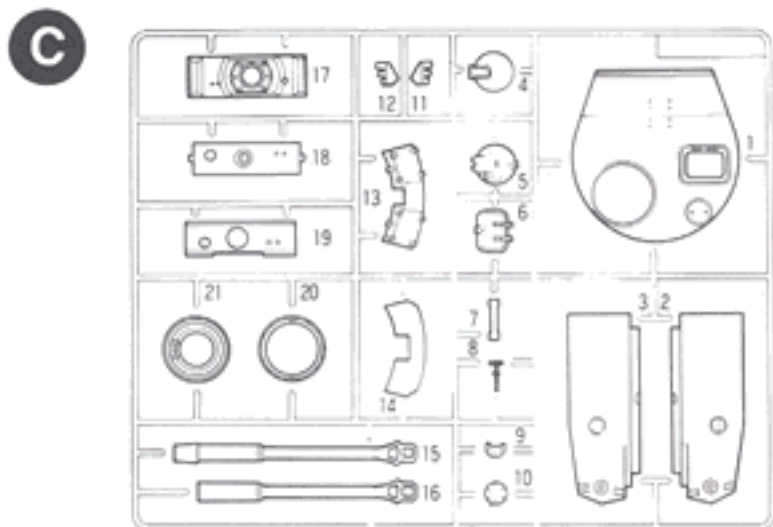
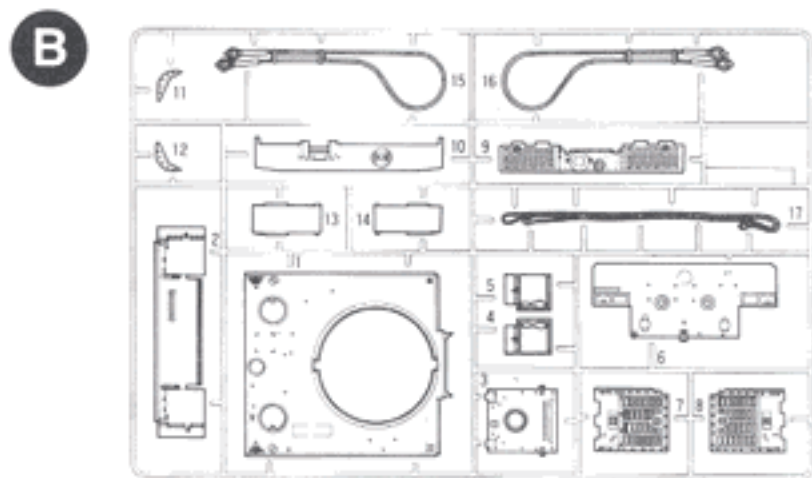
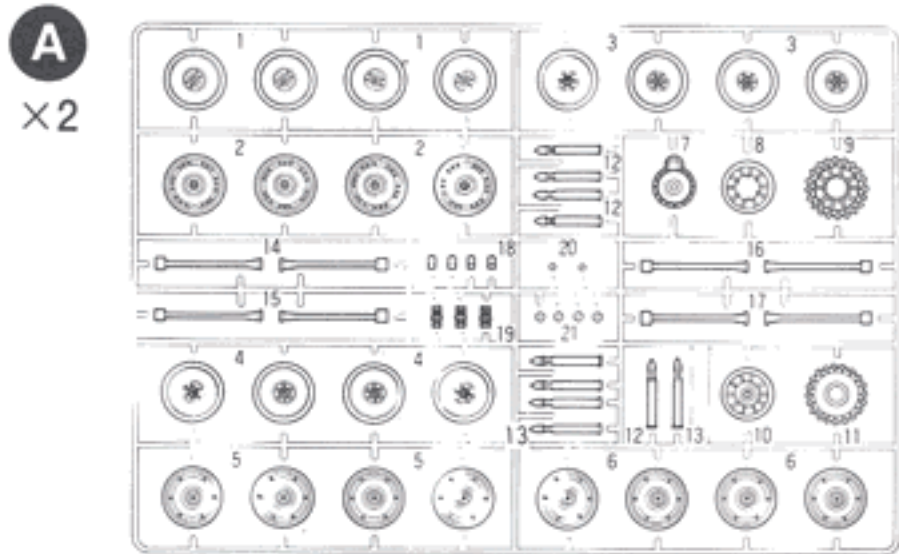

포리부품
POLY CAP

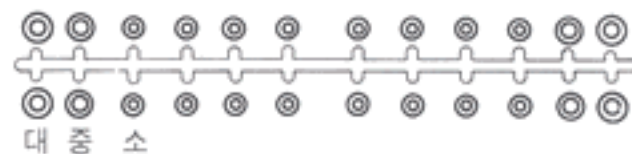

- 하체 Lower Hull ×1
- 인형부품 Figure part
- 연결 캐터필러 Flexible Thread ×2
- 예비 캐터필러 Thread Block ×1

인형의 조립 Assembly of Figures

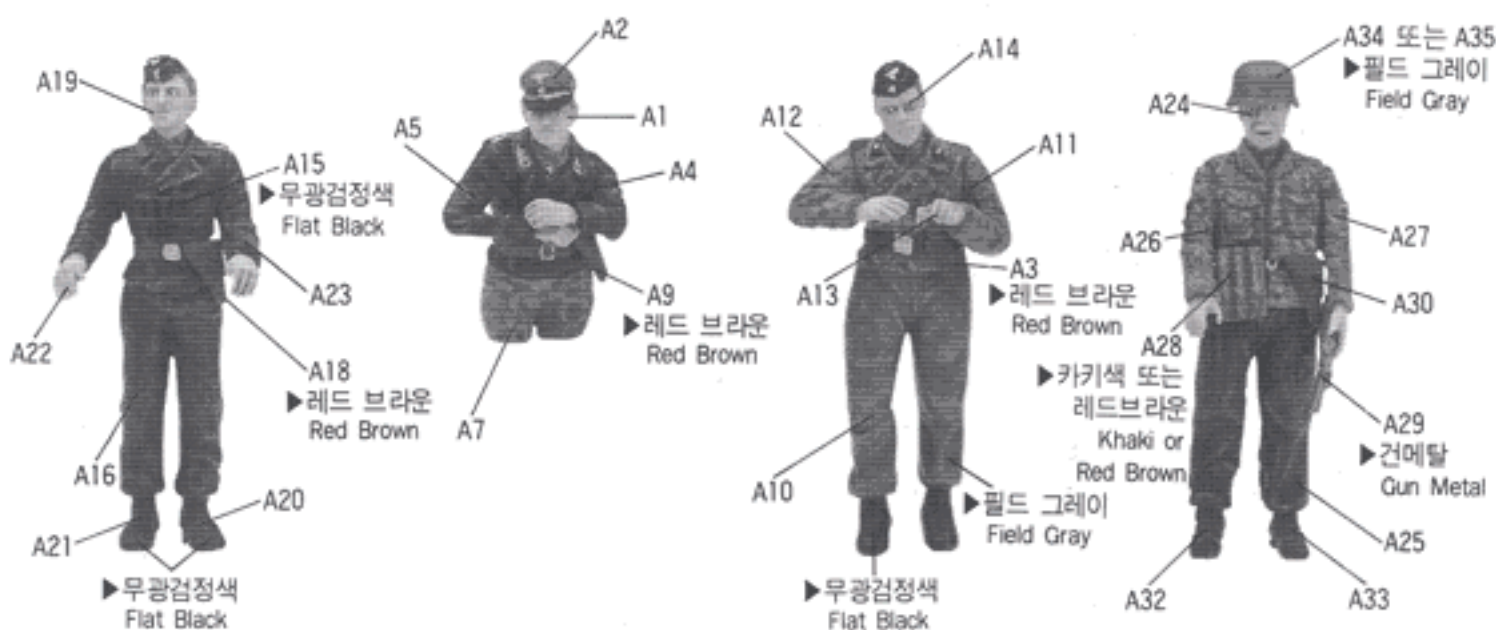

독일 전차병의 색칠

- 전투복 및 약모: 무광검정색
 - 위장복: 다크그린 + 필드그레이 + 레드 브라운 + 라이트 브라운의 반점 무늬 위장
 - 벨트: 무광검정색
 - ※ A6, A8, A17, A31은 불필요 부품
- PAINTING**
- UNIFORM & FIELD CAP: Flat Black
 - CAMOUFLAGED UNIFORM: Dark Green + Field Gray + Red Brown + Light Brown -SPOT CAMOUFLAGE
 - BELT: Flat Black
 - ※ UNUSED PARTS: A6, A8, A17, A31

