



Sd.Kfz.251/3 Ausf.D

Mittlerer Funkpanzerwagen

Developed from Borgward Sd.Kfz.11 half-track, the Sd.Kfz.251 transport vehicle is the backbone in the German Army throughout WWII. With armored chassis, including lowered body height and rearrangement of internal space, it services from '39 to '45. From basic A version to simplified D version to meet mass production demands, as well as all variations, total production is about 16000.

The Sd.Kfz.251/3 is a radio command version mainly for artillery, armoured units and Luftwaffe for air-ground control. There are handfuls of radio equipment variations to meet different requirements. Sd.Kfz.251/3 Ausf.D is the last version, with simplified armoured arrangements, and its Fu-8 frame antenna is replaced with a star-shape antenna on later versions. Other than the antenna, the appearance of Sd.Kfz.251/3 is very similar to that of Sd.Kfz.251/1.

Sd. Kfz. 11を基にして開発されたSd. Kfz251シリーズの各種輸送車輛は、第二次大戦を通じて、ドイツ軍地上部隊の根幹を成すものであった。装甲を施された車体と、低い車高、応用のきく車内空間は重宝され、1939年から45年にわたって製造された。初期のA型から、生産効率を上げるために車体形状を簡素化したD型まで、さまざまなバリエーションをあわせて約16,000輛あまりが生産されたのだった。

Sd. Kfz251/3は無線指揮車輛で、主に砲兵隊、機甲部隊、また空軍の地上連絡用として用いられ、それぞれ多くの種類の中から用途に応じた無線器が搭載された。Sd. Kfz251/3Ausf. Dは最後の生産型で、車体形状は簡素化され、後期の生産型ではFu-8フレームアンテナに替わって星型アンテナが装備された。 Sd. Kfz251/3の外見はアンテナ部分を除いては、Sd. Kfz251/1と、よく似たものとなっていた。

做為二次大戦中德軍装甲兵員運輸主力的SdKfz251型運輸車,原型是來自於Borgward公司的Sd.Kfz.11型半履帶式牽引車,將其底盤施以装甲化的修改,其中包括了降低車身的高度及重新佈局的兵員室等等,並保留了日後各種衍生型的發展可能,於1939年至1945年間在德軍中服役。基本架構從最早的A型開始,為擴大產量而逐步簡化生產工藝而至D型為止,同時也包括了為各種戰術需求所開發的衍生型在內,共生產了約一萬六千輛之譜。

在此一系列車輛中做為無線電通信指揮的型號為Sd.Kfz.251/3,主要供給砲兵、装甲兵單位及空軍的地面聯絡管制之用,由於對象的不同,Sd.Kfz.251/3在內裝上也有著不同的無線電機種搭載;Sd.Kfz.251/3 Ausf.D是其最後一種型式,有著更為洗練單純的裝甲構型,其所搭載的Fu8型無線電天線也由早期的框架型改成後期的星型,使得除了天線的數量外,在車輛外觀上與一般供裝甲擲彈兵所搭乘的Sd.Kfz.251/1型相仿。

Illustration:圖示說明



Method For Applying Decals:

1. Clean Model Surface With Wet Cloth.
2. Cut Out Of Decal Sheet And Dip Them In Water For 15 Seconds.
3. Place it on proper position on model.
4. Slide off base paper leaving decals On Model With Wet Finger Tip.
5. Move Decals To Exact Position, Push Out Excess Water Under Decal With Soft Cotton Cloth.
6. When Decals Get Dry Then Complete.

水貼紙使用說明:

1. 將模型表面擦乾淨
2. 將貼紙剪下泡入清水中約15秒
3. 將泡濕之貼紙取出置於欲貼處旁
4. 用指尖輕推貼紙表面使其滑出底紙
5. 將貼紙調整至適當位置並輕擦拭水份
6. 待其自然乾燥後即完成

Color list: 塗料表

| Color | Brand | GSI Creos (Gunze Sangyo) | | | Humbrol | Revell | Life Color |
|----------------|-------|--------------------------|----------|----------------|---------|--------|-----------------|
| | | Hobby Color | Mr.Color | Mr.Color Spray | | | |
| Wood brown | 木棕 | H-37 | C-43 | J-43 | 34 | 05 | UA085/ UA125 |
| Dark green | 深綠 | H-36/H-405 | C-70 | J-70 | 149 | 363 | UA083 |
| Dark yellow | 深黃 | H-79 | C-39 | J-39 | 83 | 16 | UA081 |
| Steel | 黑鐵 | H-18 | C-28 | J-28 | 53 | 91 | LC76 |
| Tire black | 輪胎黑 | H-77 | C-137 | | 85 | 302 | LC02 |
| Red brown | 紅褐 | H-47 | C-41 | J-44 | 160 | 383 | UA082 |
| Metallic green | 亮綠 | H-89 | C-77 | J-77 | 131 | 364 | |
| Red | 紅 | H-3 | C-3 | J-3 | 19 | 31 | LC56 |
| Flat white | 消光白 | H-11 | C-62 | J-62 | 34 | 05 | LC01 |
| RLM02 Gray | 灰 | H-70 | C-60 | | 92 | 79 | UA071 |
| German gray | 德國灰 | H-32 | C-40 | J-40 | 92 | 79 | UA073 |
| Silver | 銀 | H-8 | C-8 | J-8 | 11 | 90 | LC74 |

1

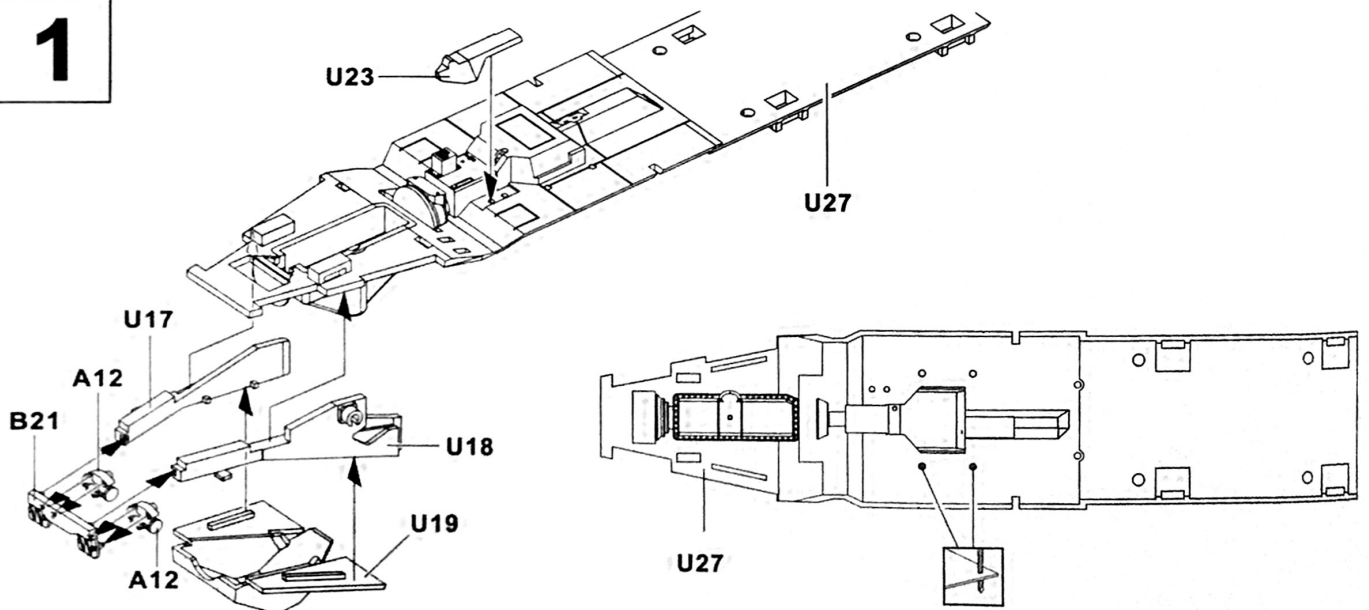

2

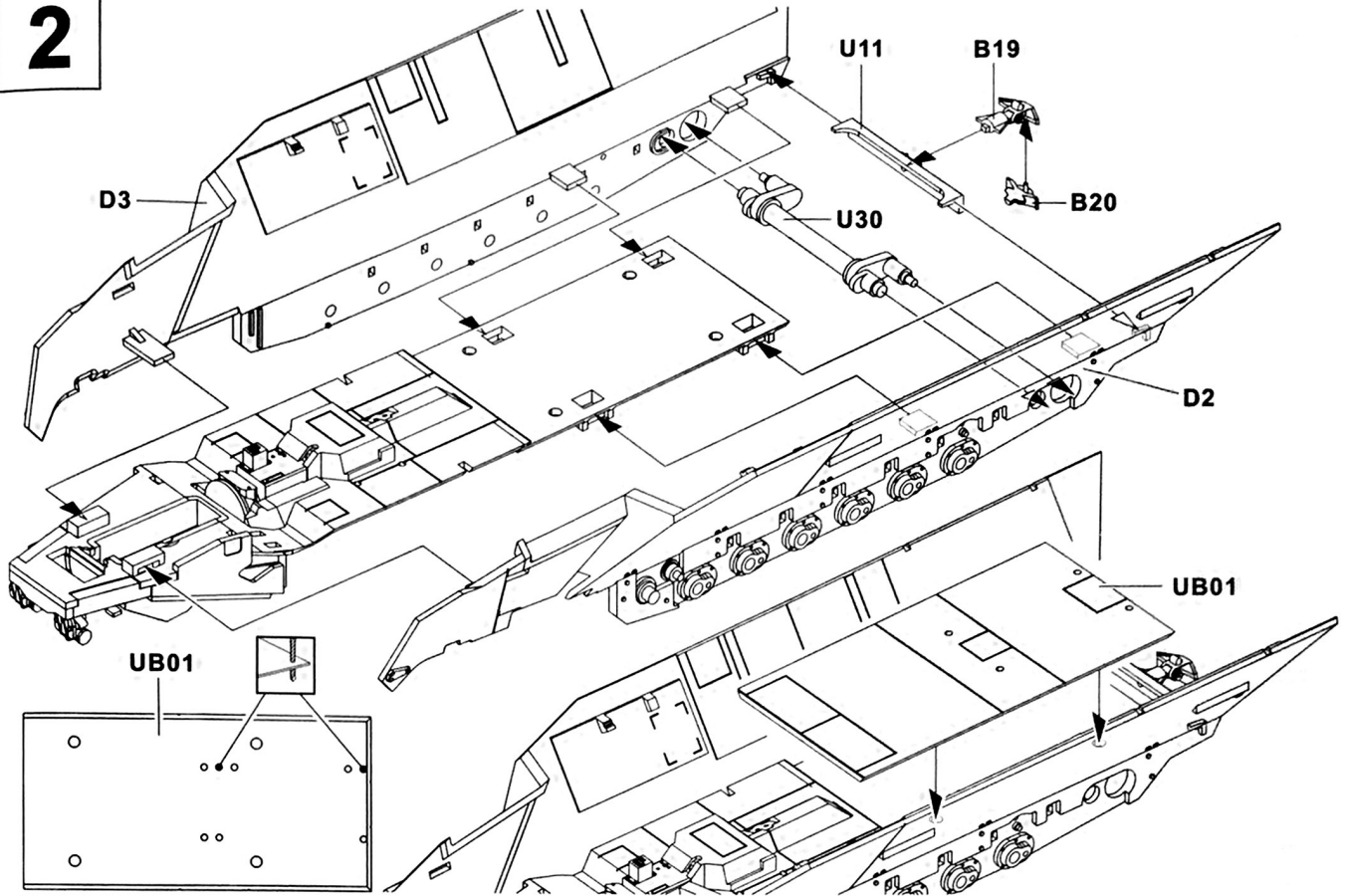

3

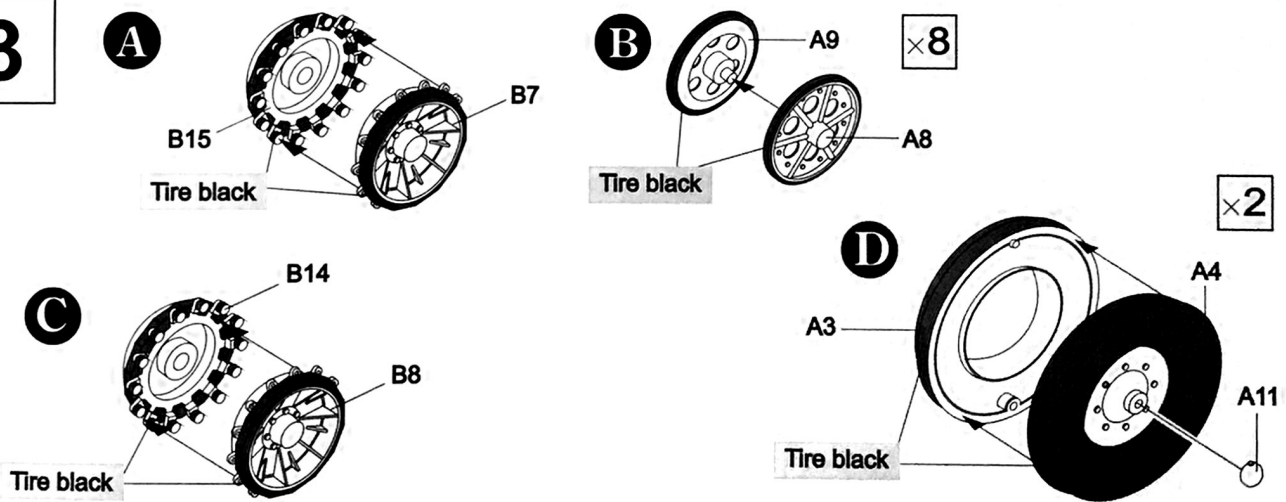

4

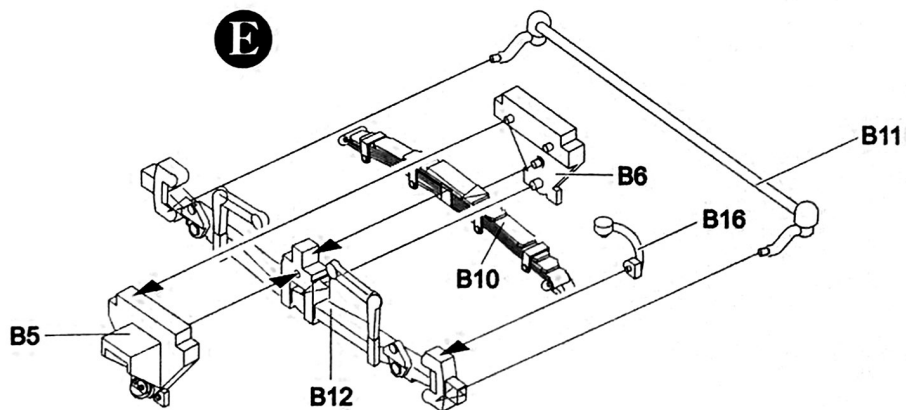

5

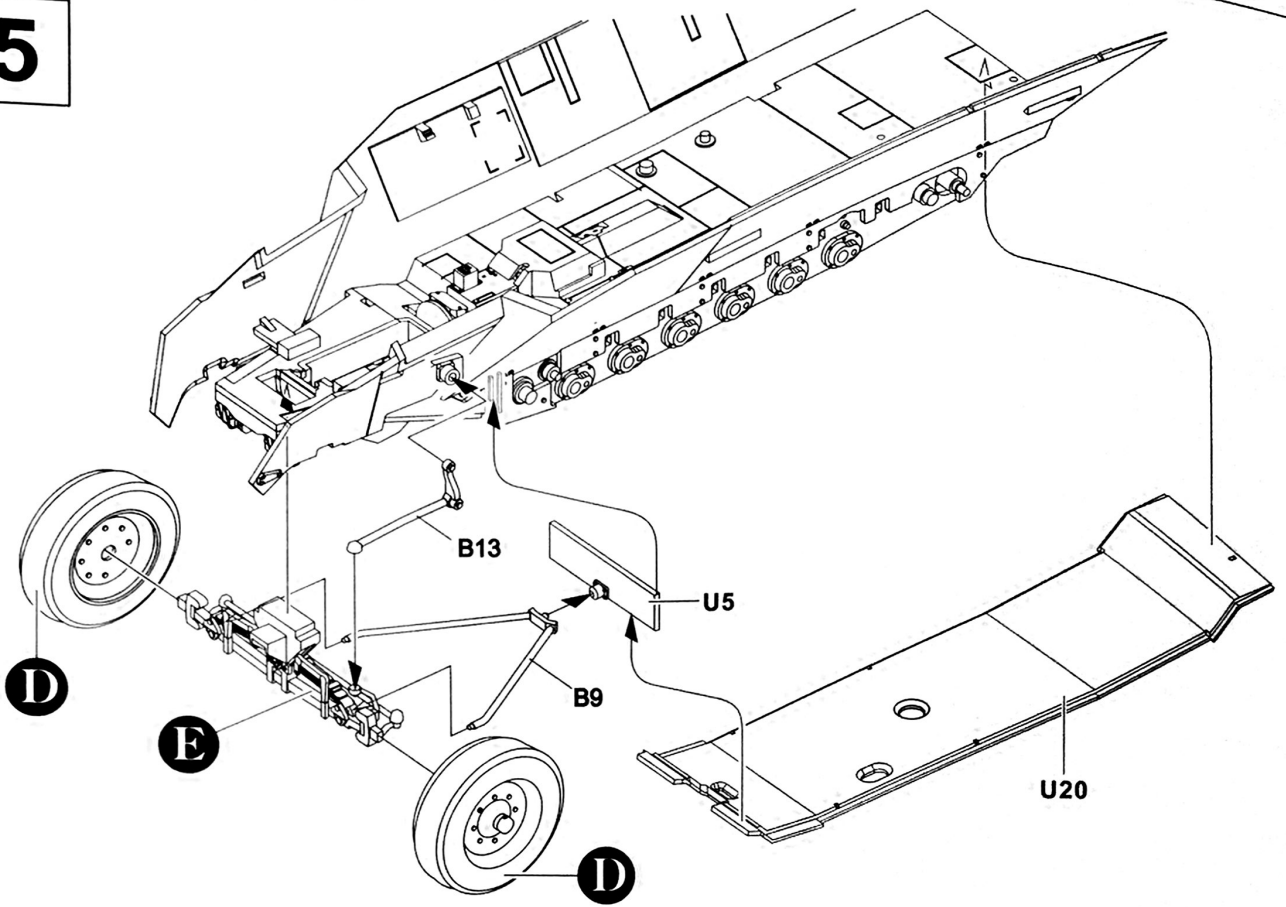

6

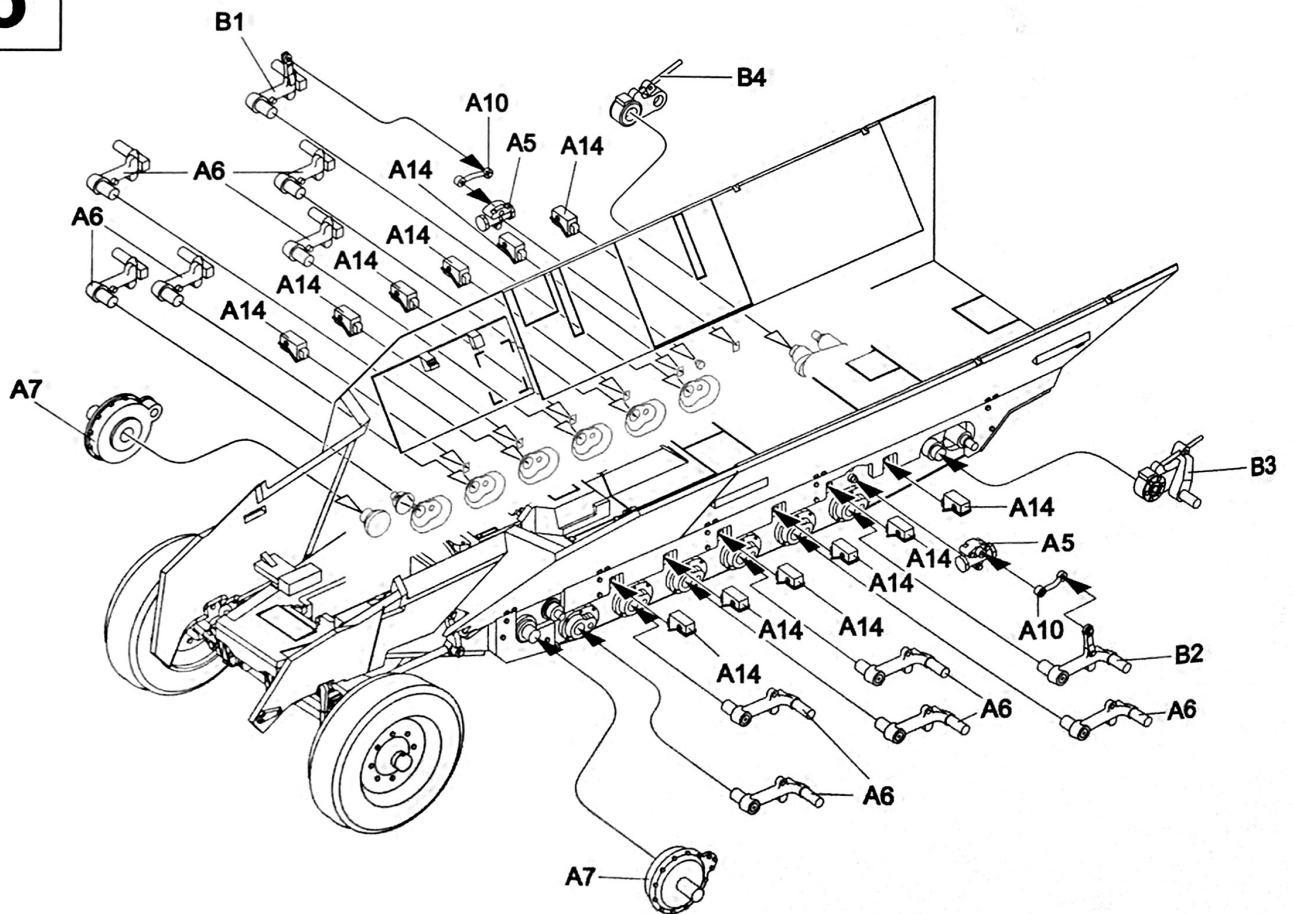

7

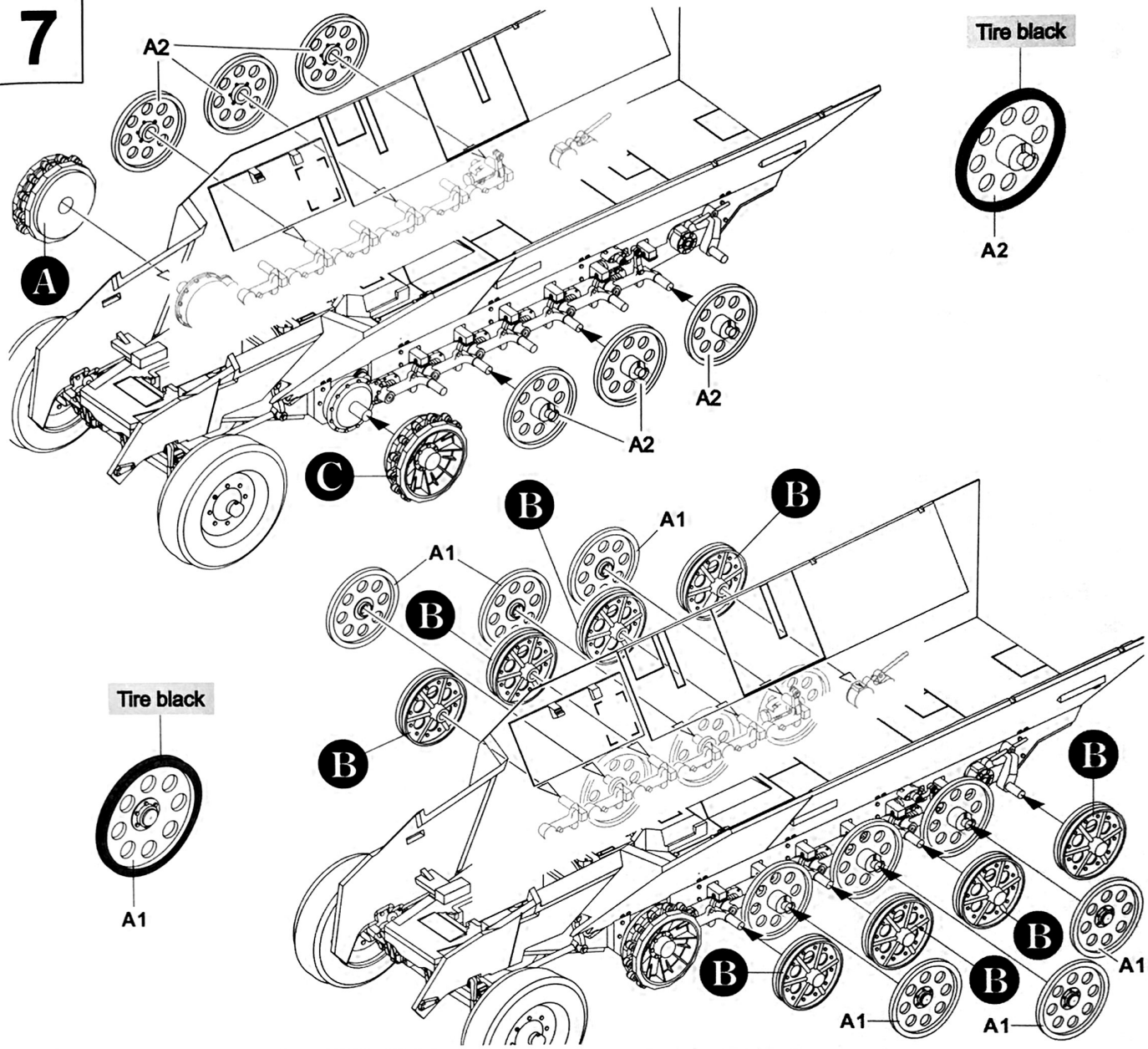

8

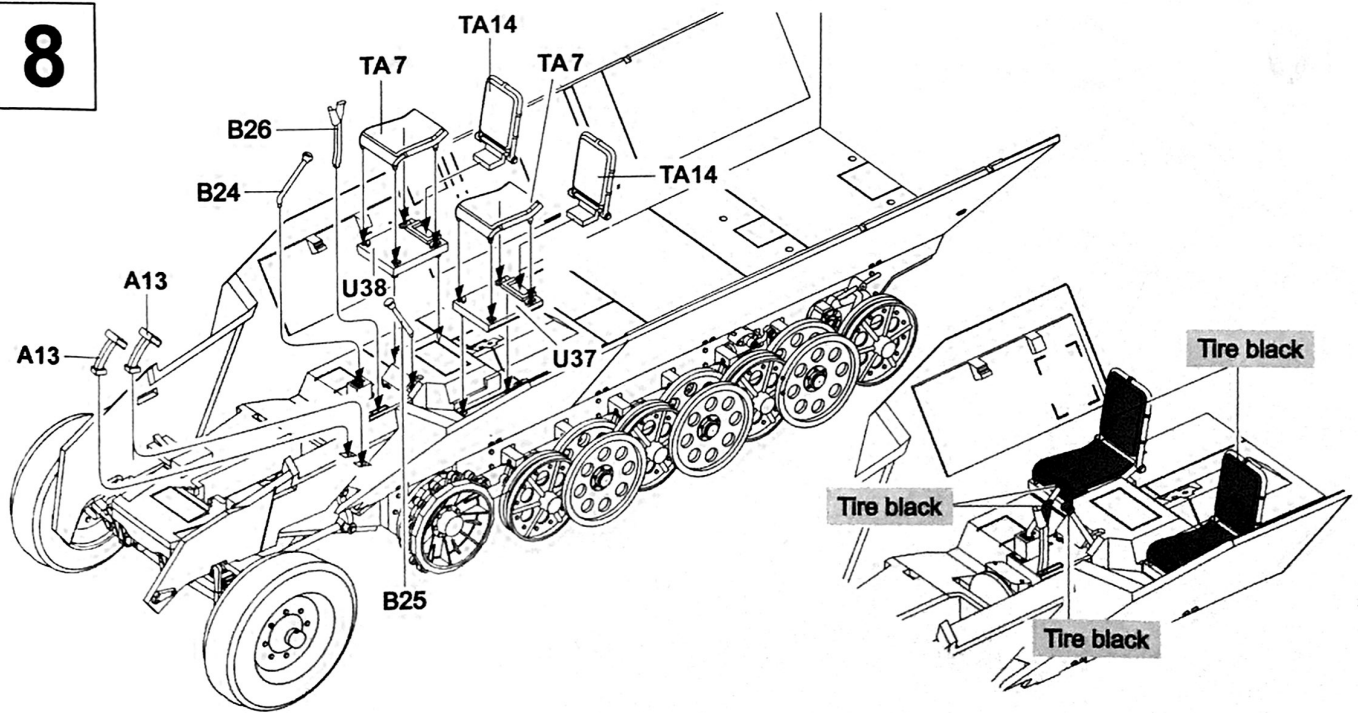

11

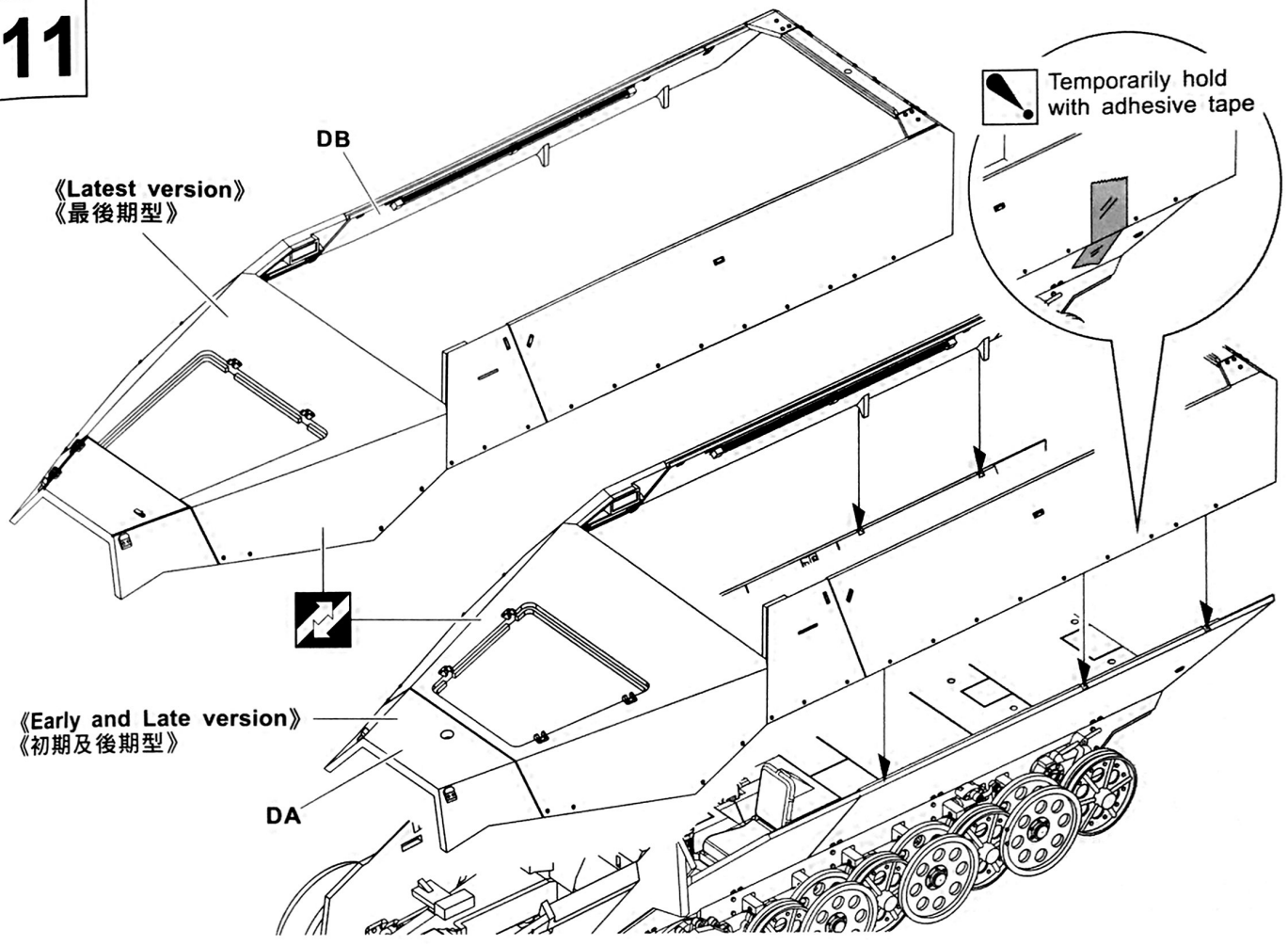

12

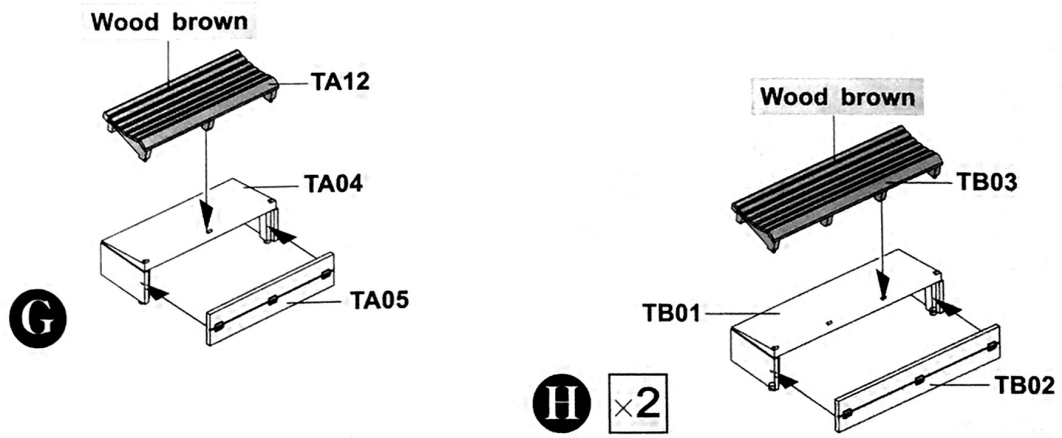

13

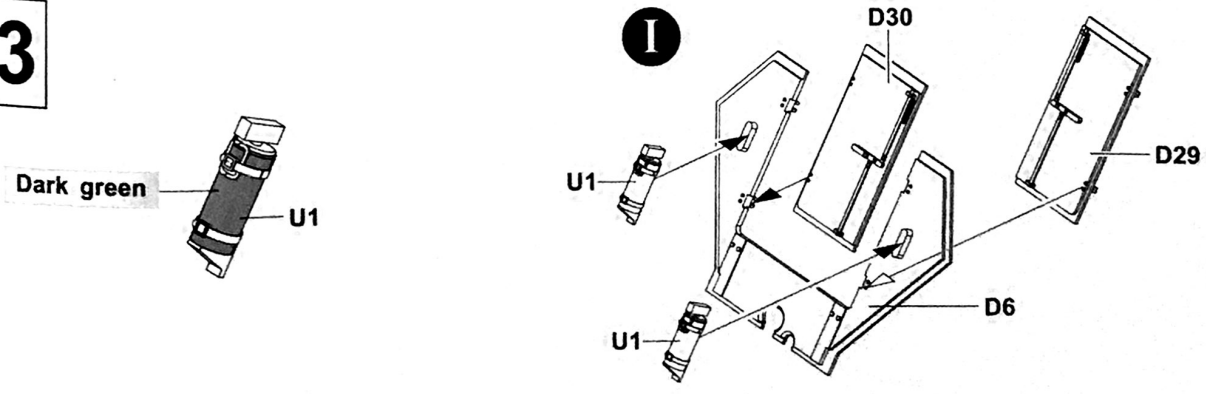

14

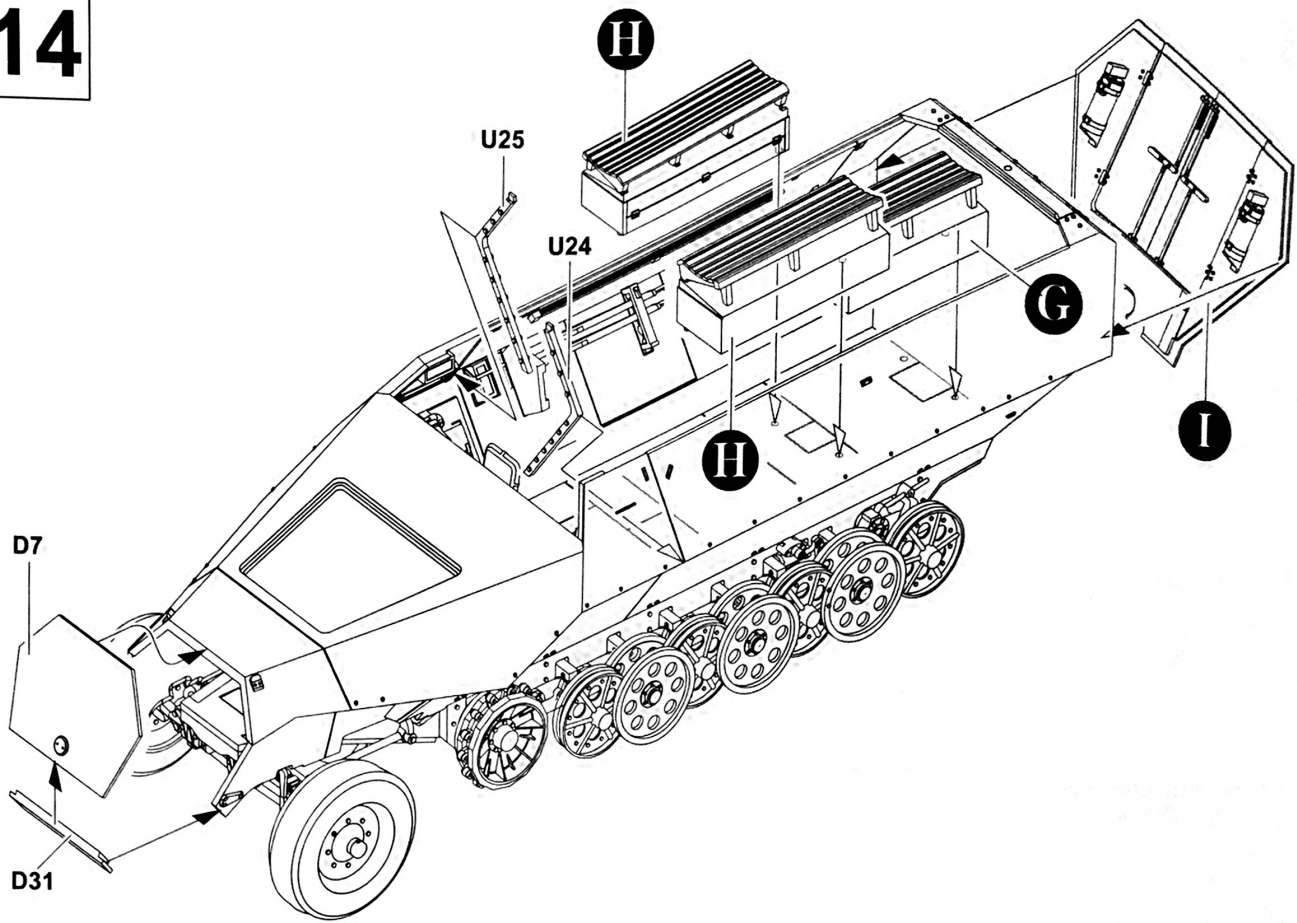

15

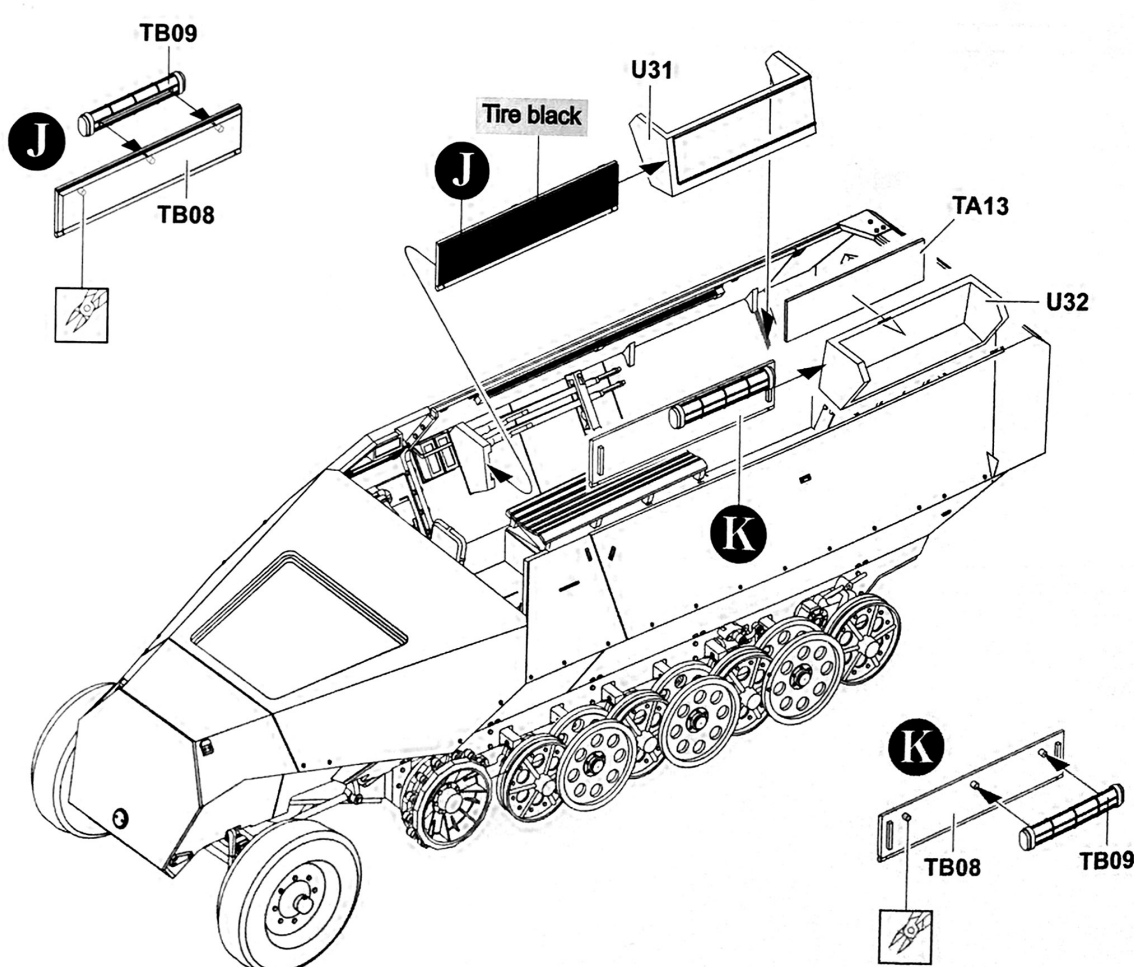

16

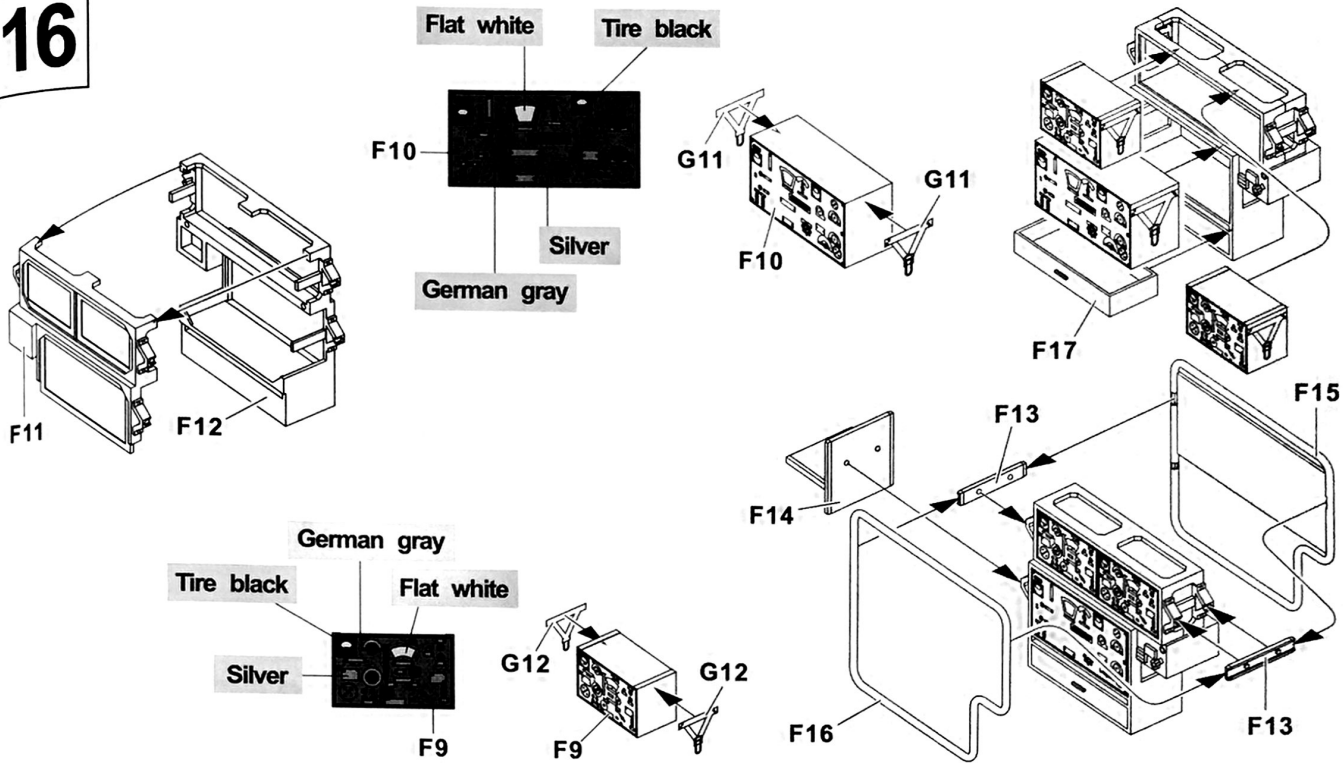

17

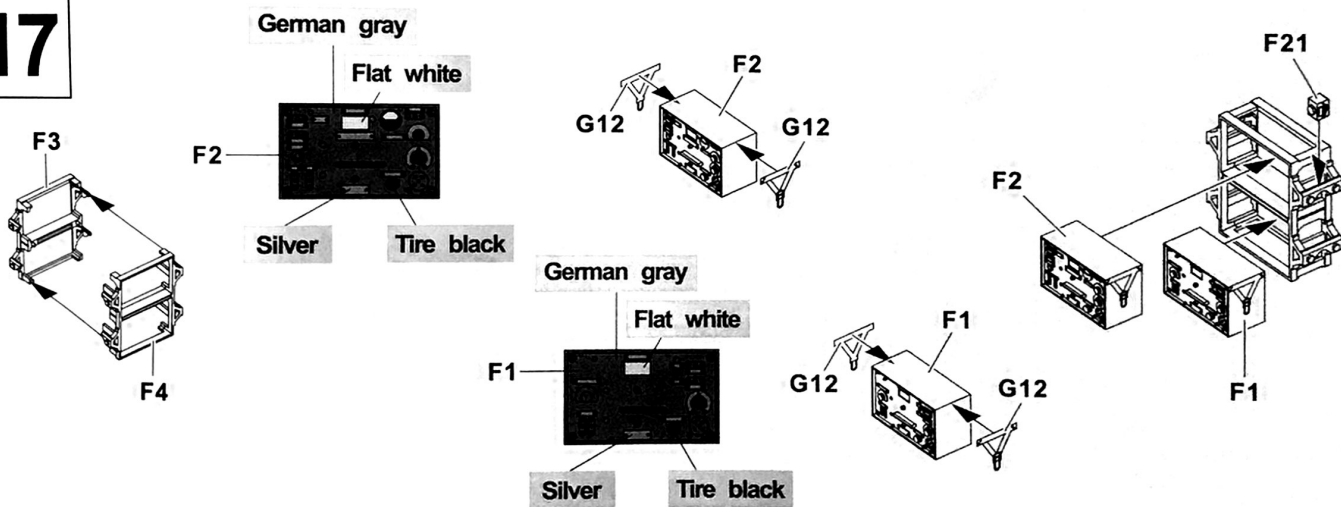

18

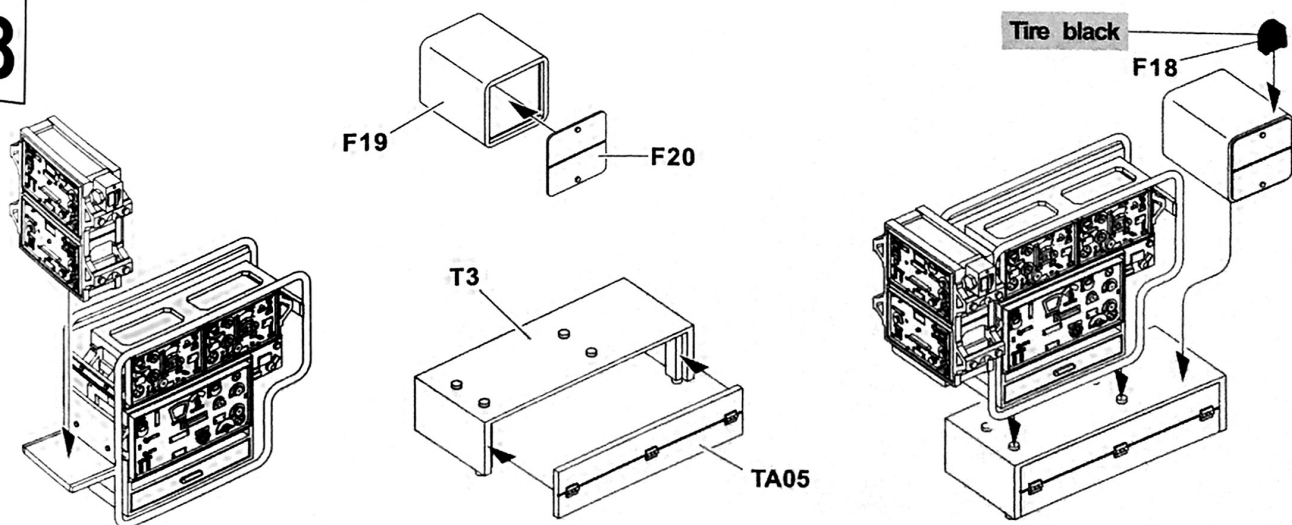

19

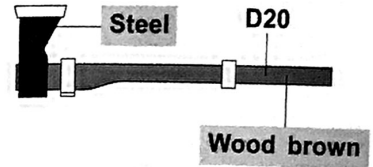
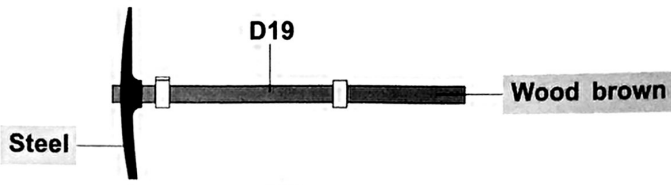

《Late and Latest version》
《後期及最後期型》

L

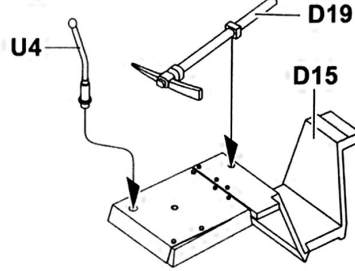
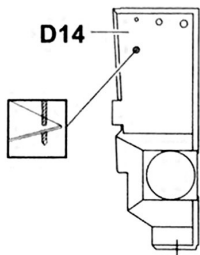

M

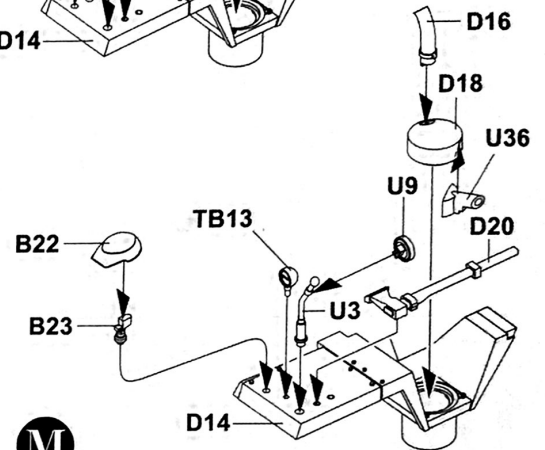
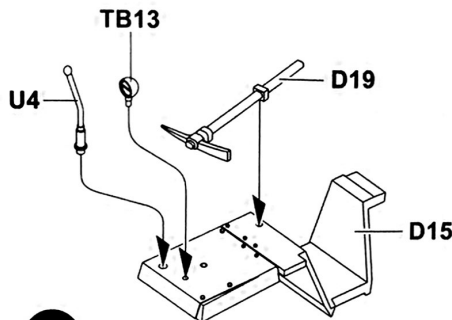
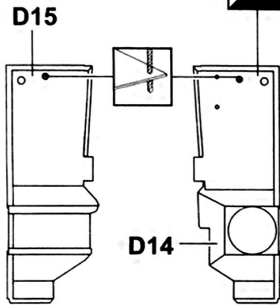
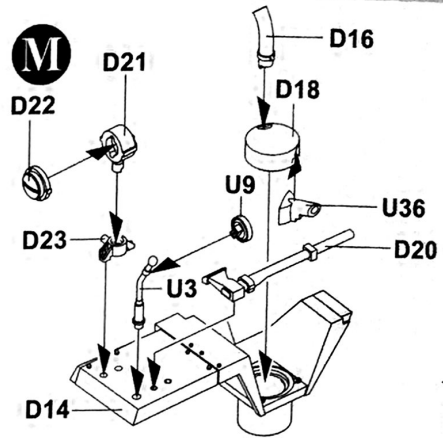

《Early version》
《初期型》

L

M

20

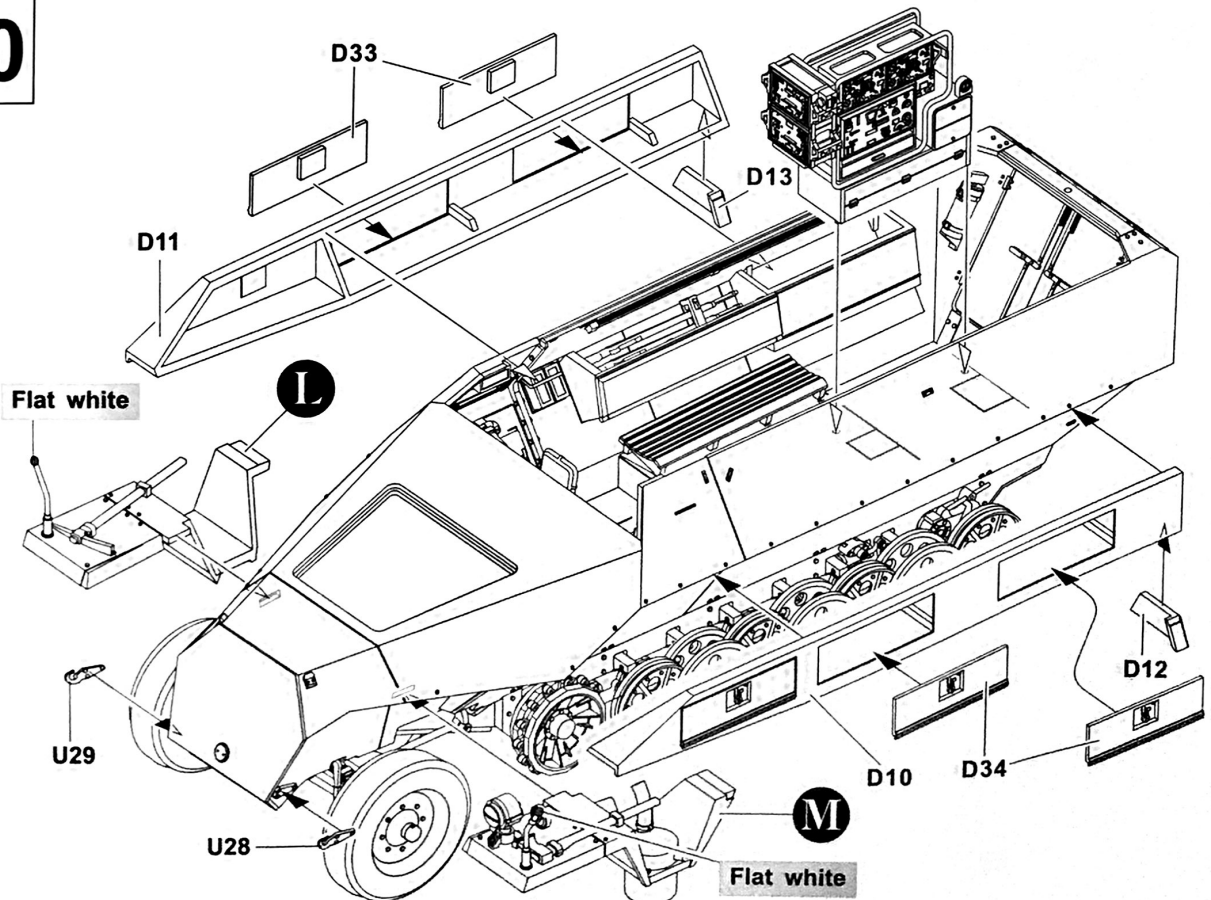

21

《Latest version》
《最後期型》

《Early and Late version》
《初期型及後期型》

《Latest version》
《最後期型》

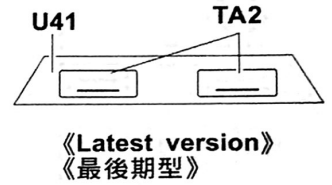
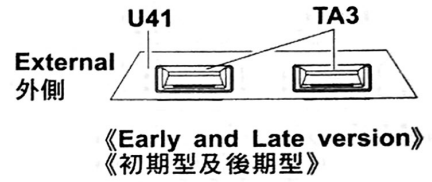
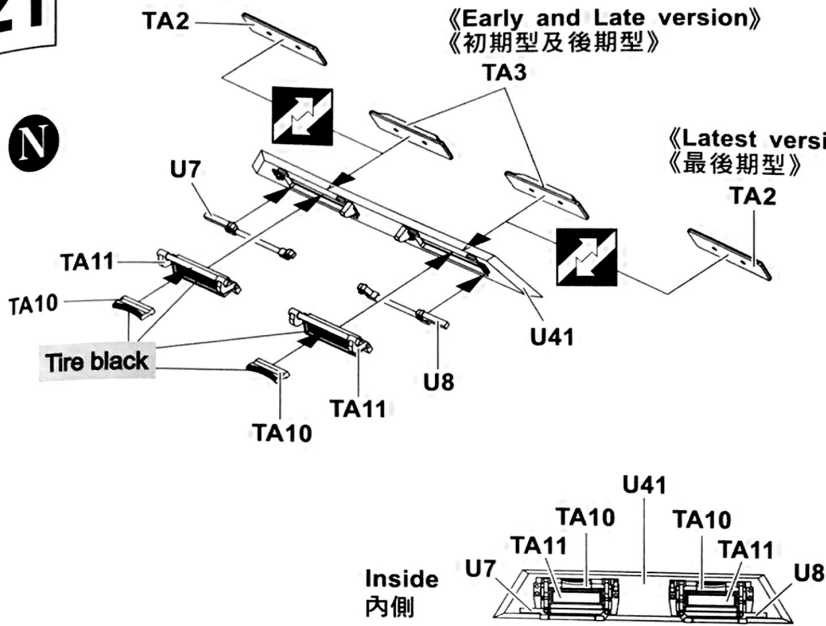

22

《Early and Late version》
《初期型及後期型》

TB12

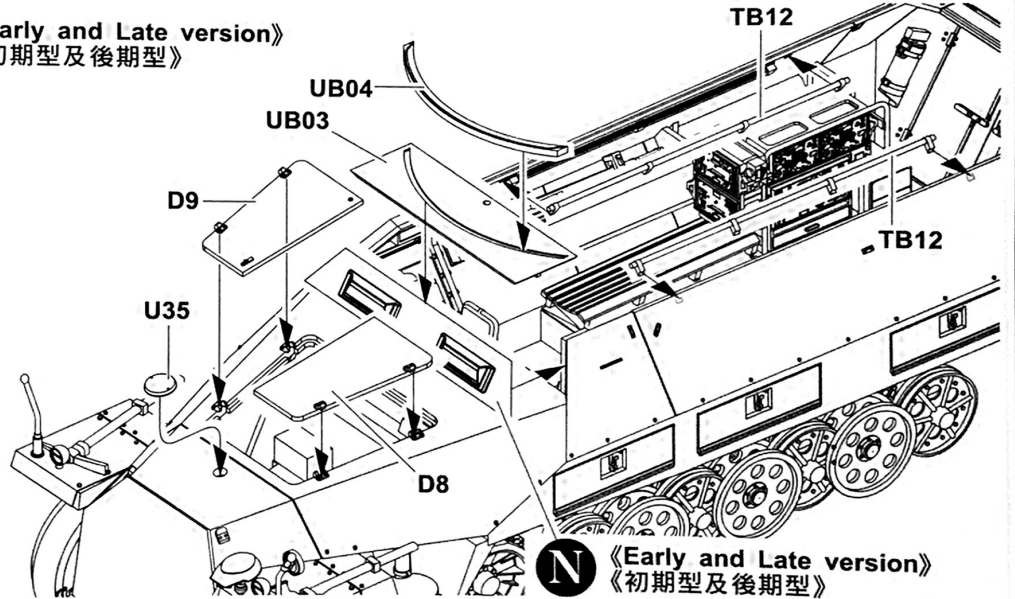
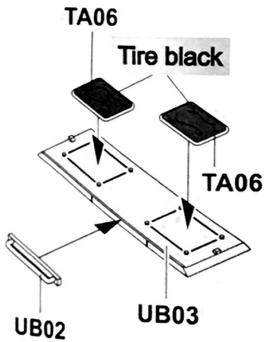

《Early and Late version》
《初期型及後期型》

《Latest version》
《最後期型》

UB04
UB03

TB12

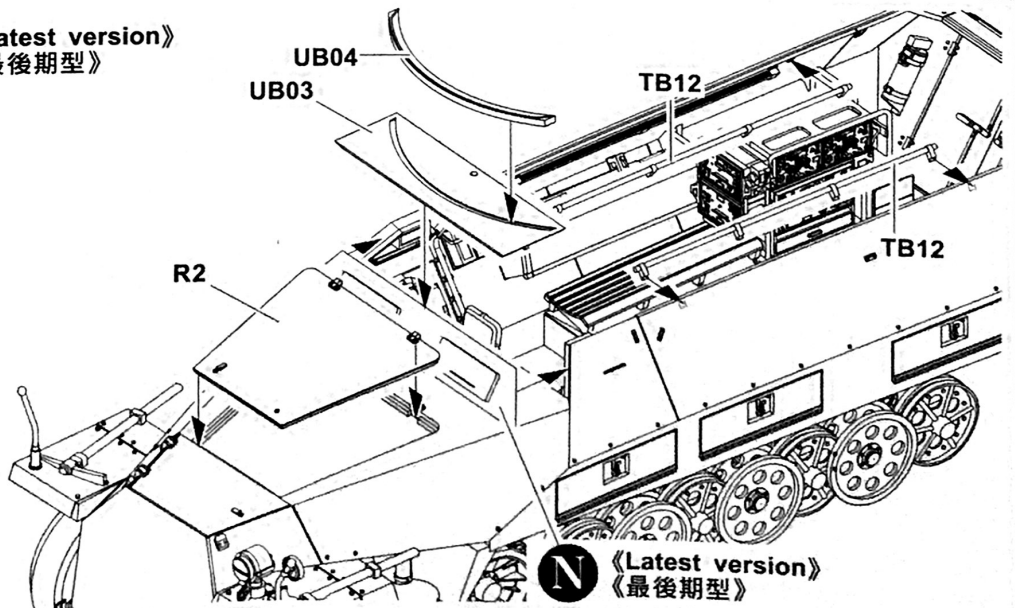

《Latest version》
《最後期型》

23a

《Early version》
《初期型》

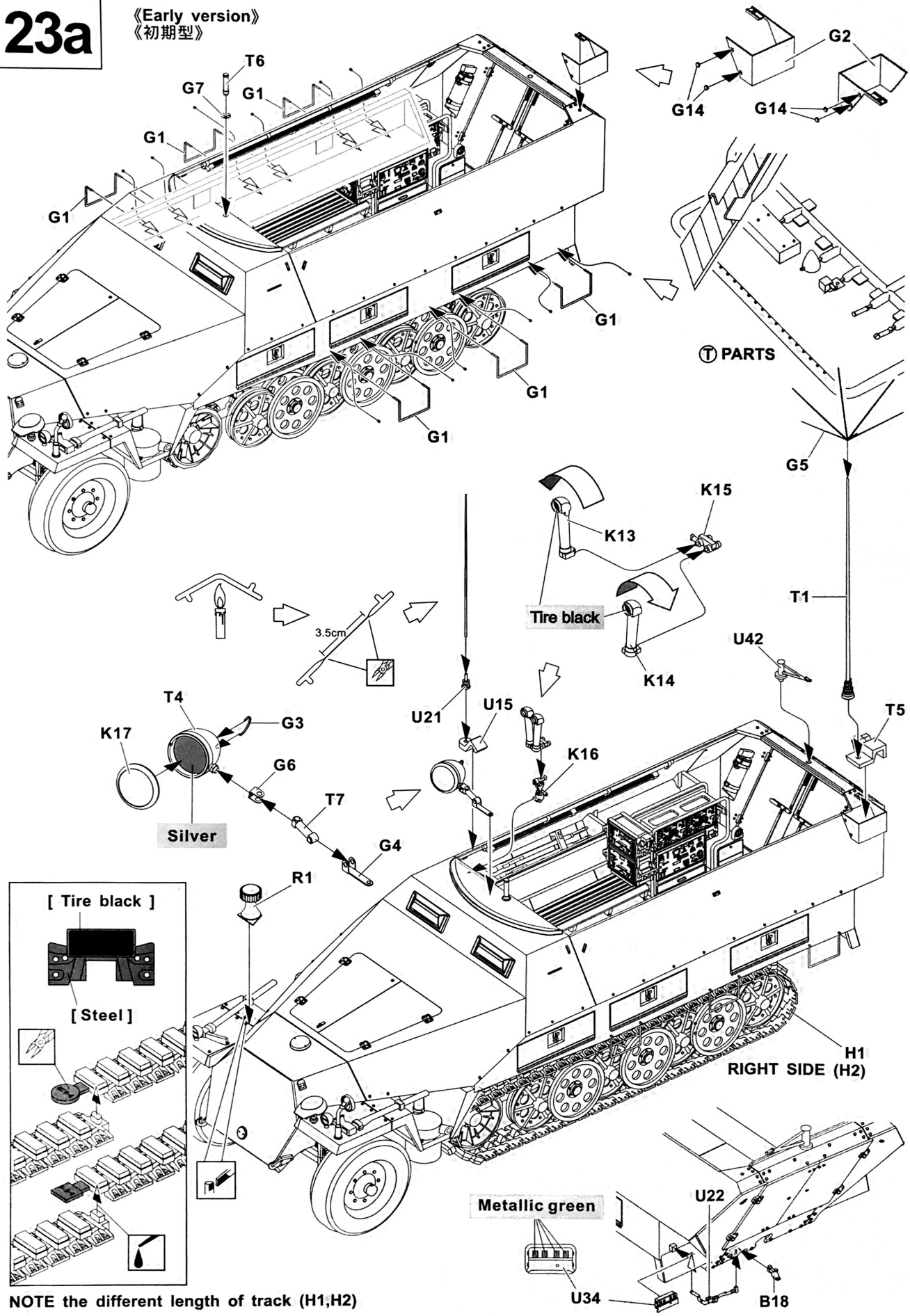

NOTE the different length of track (H1,H2)

23b

《Late version》
《後期型》

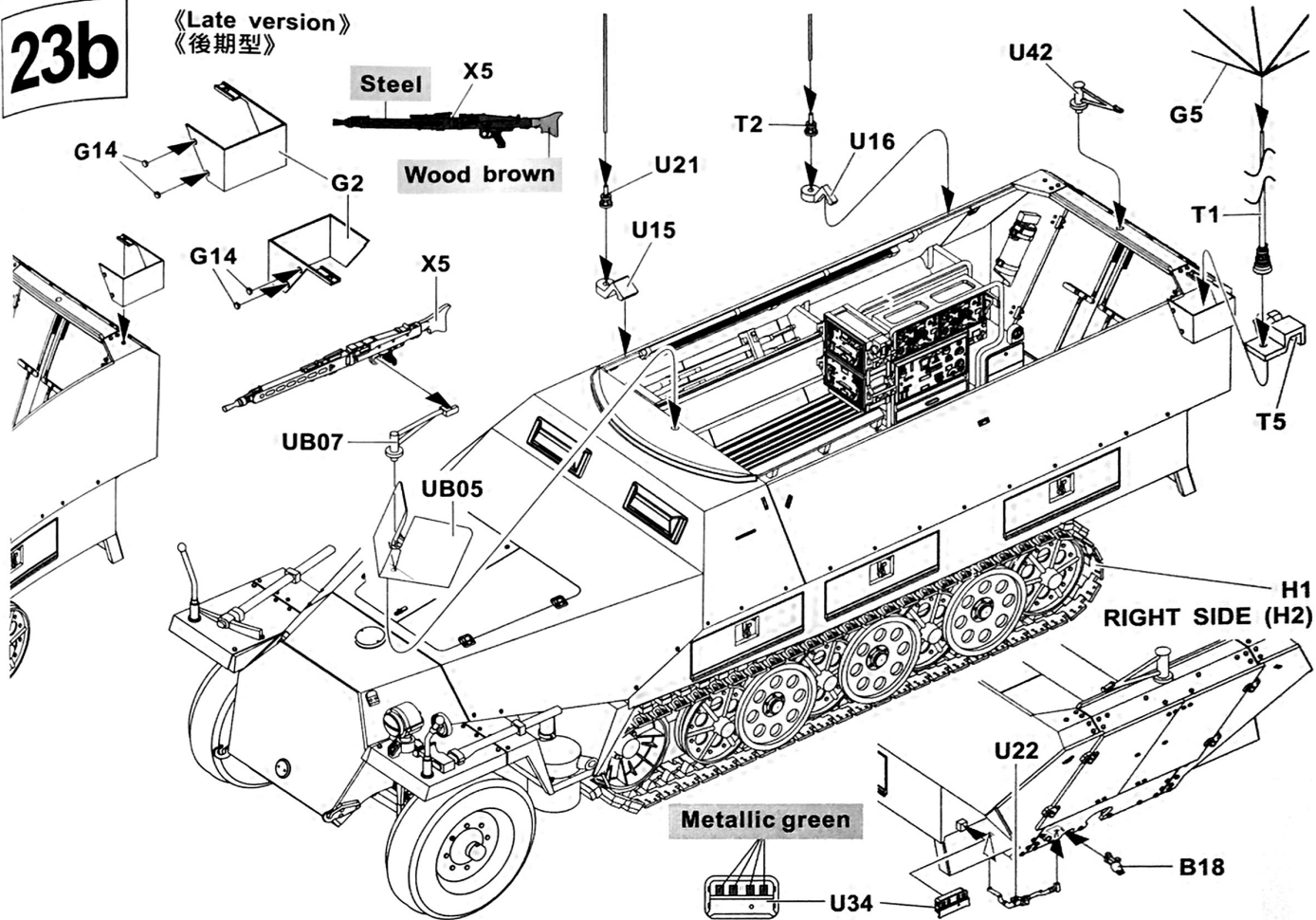

23c

《Latest version》
《最後期型》

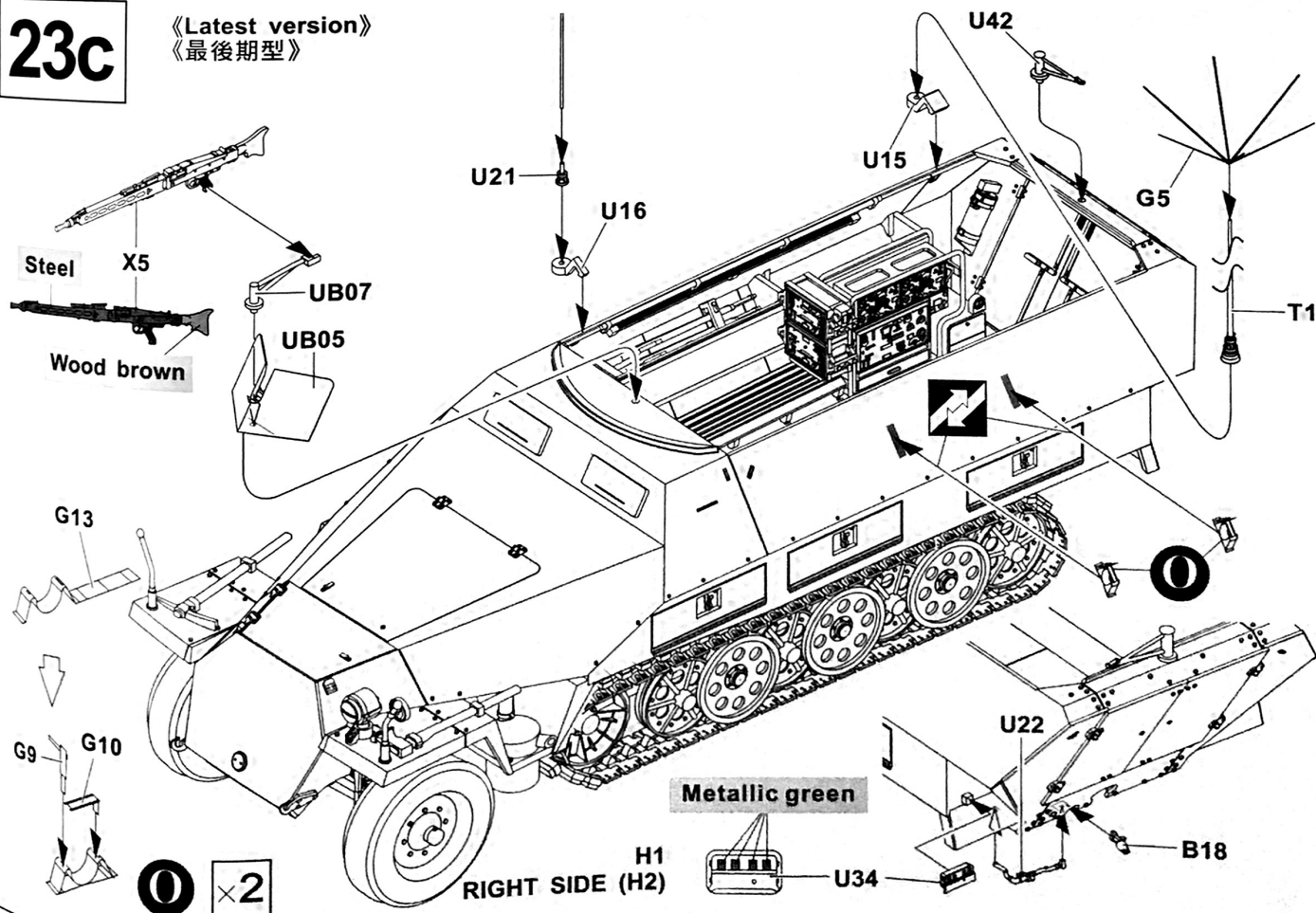

A 12.SS Panzer division, Belgium, Mar 1944.

黨衛軍第十二裝甲師, 1944年3月, 比利時

Body Color: Red Brown Olive Green
 Dark Yellow

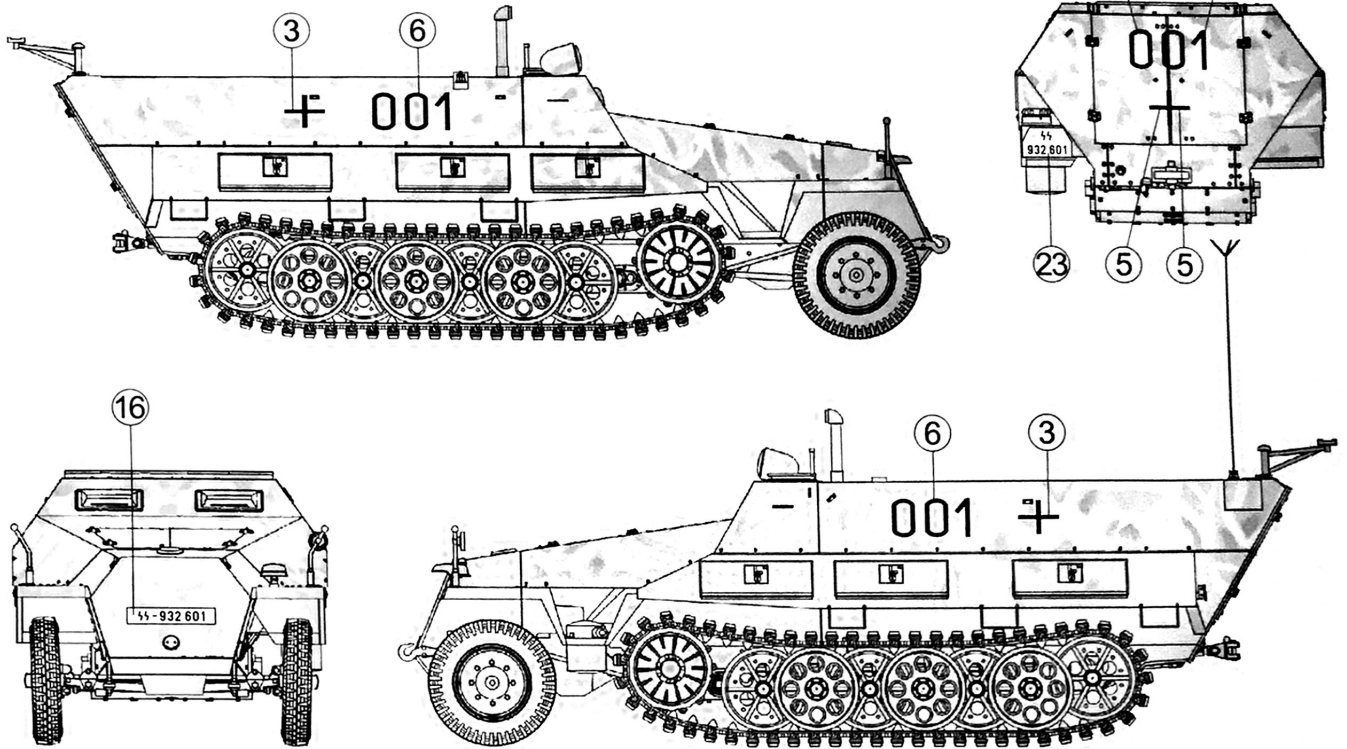

B 20.Panzer division, Eastern Front, Summer 1944.

第二十裝甲師, 1944年夏, 東部戰線

Body Color: Red Brown Olive Green
 Dark Yellow

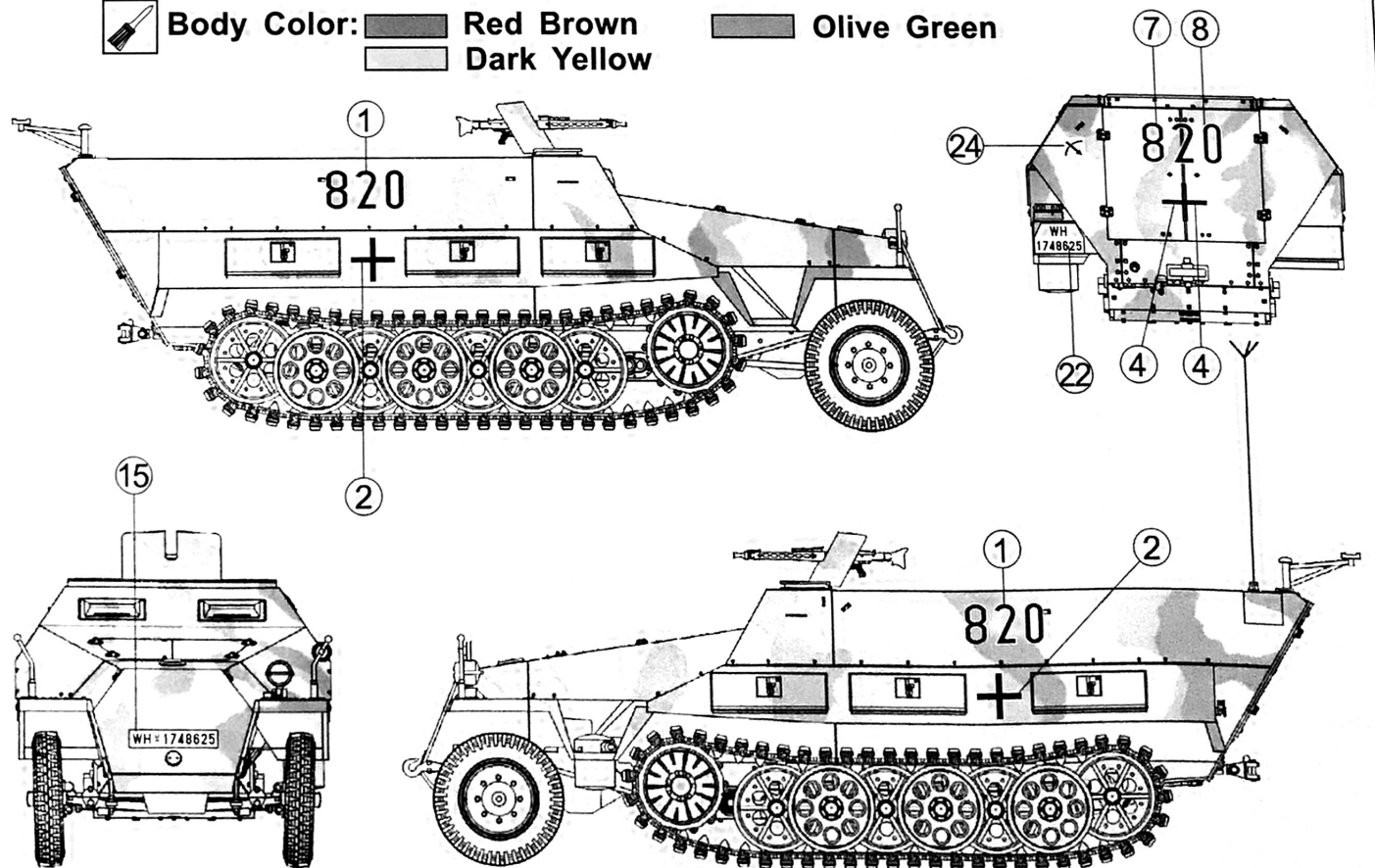

C 116.Pz. Div., Hurtegen Forest, Belgium, Nov 1944.

第116裝甲師, 1944年11月, 比利時許特根森林

Body Color:  Red Brown  Olive Green
 Dark Yellow

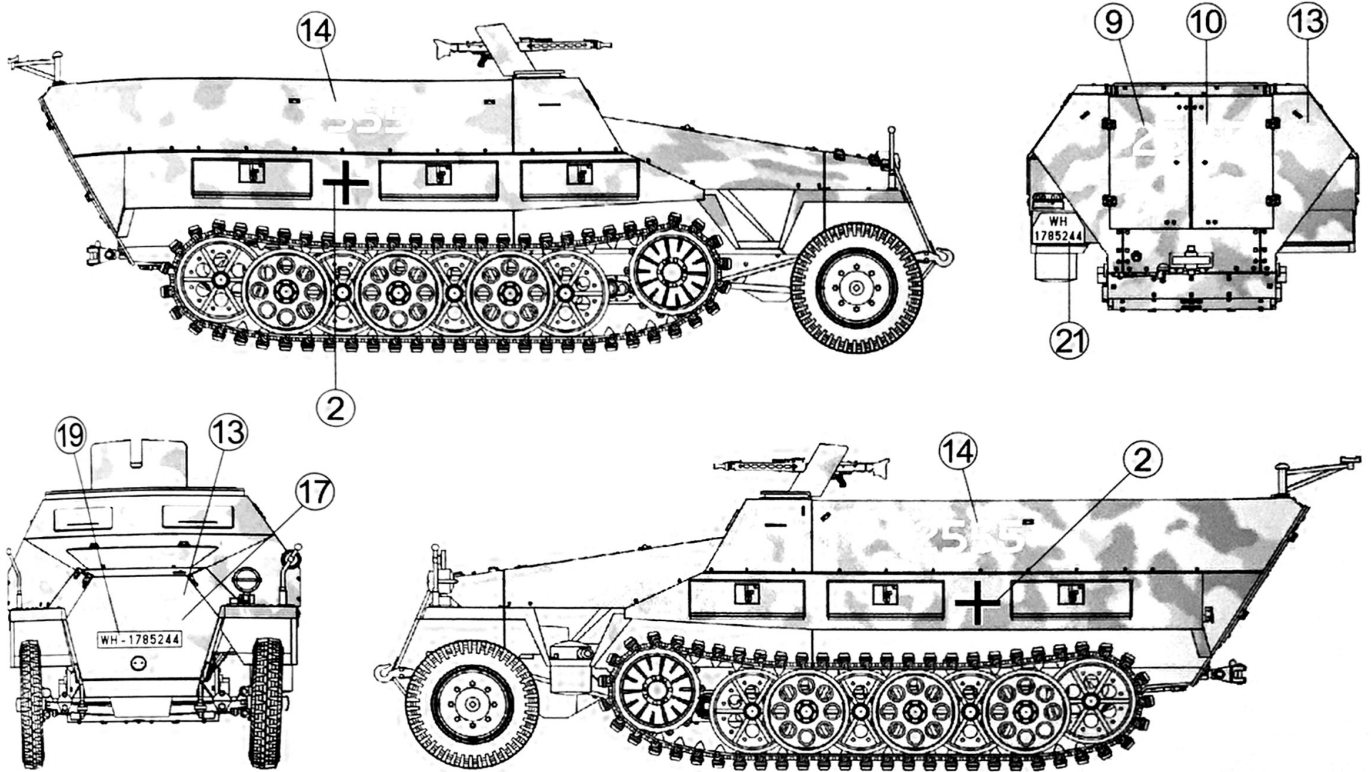

D Panzer Korps Feldherrnhalle, Czech, May 1945.

統帥堂裝甲軍, 1945年5月, 捷克

Body Color:  Red Brown  Dark Yellow

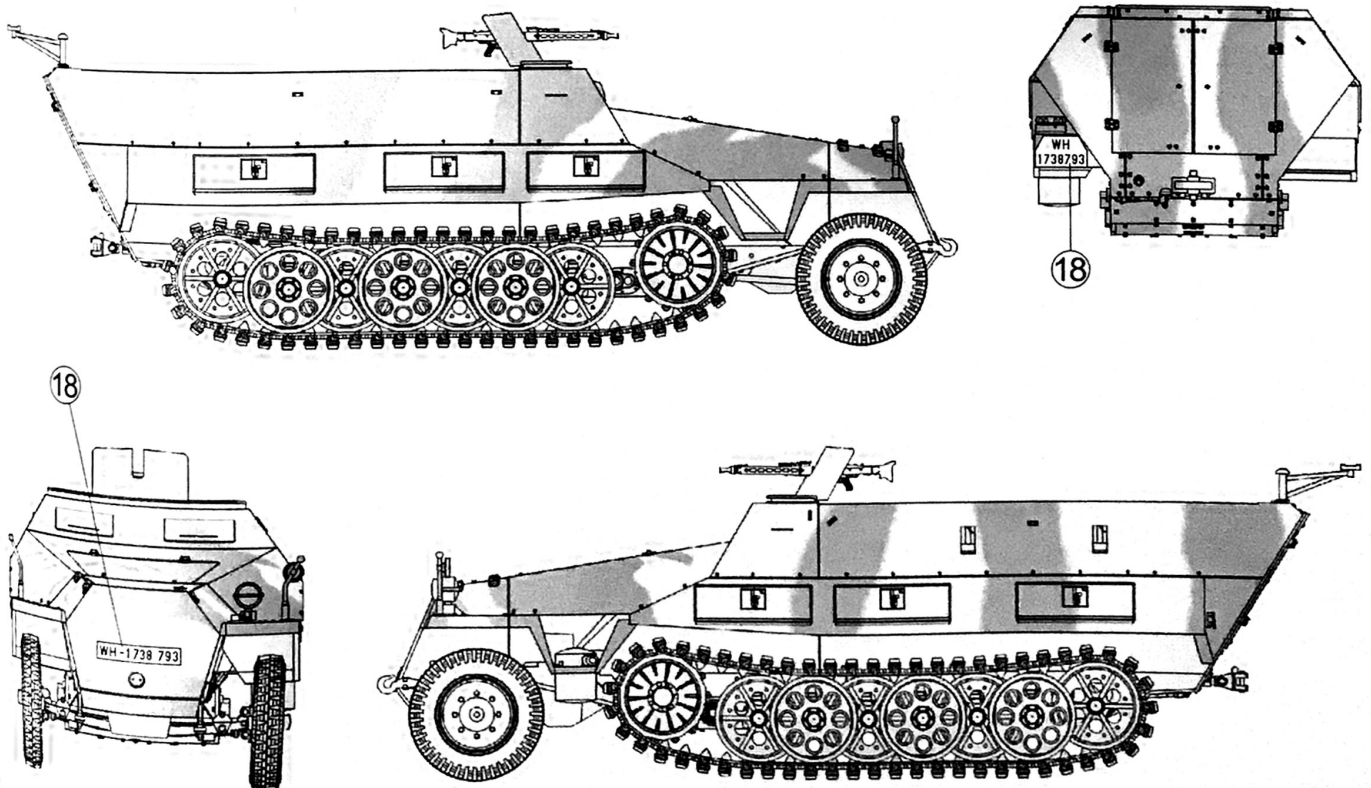

PARTS LIST 零件表

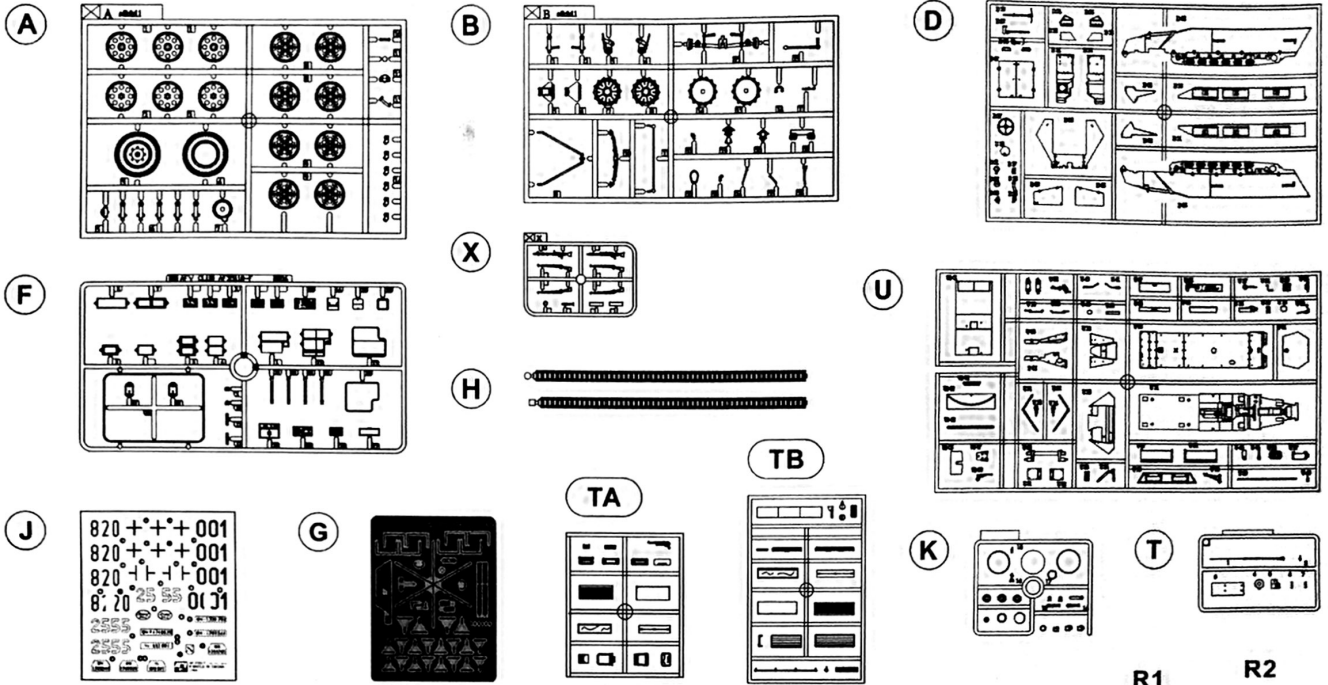
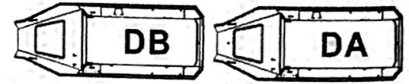

Parts :

| | | | |
|-----------|-----------|-----------|------------|
| (A) ——— 2 | (F) ——— 1 | (J) ——— 1 | (U) ——— 1 |
| (B) ——— 1 | (G) ——— 1 | (K) ——— 1 | (TA) ——— 2 |
| (D) ——— 1 | (H) ——— 1 | (R) ——— 1 | (TB) ——— 2 |
| | | | (T) ——— 1 |



Instructions:

If for some reason, you are not fully satisfied or have questions concerning our product; Please use the form provide, and send it to our nearest representative or mail it directly to our office.

We will deal with that A.S.A.P.

限台灣地區使用 For Taiwanese use only!

總代理：戰鷹企業 客服部收 本公司將盡速為您處理
請將本表與該部品相同金額之郵政匯票一同寄至

| | |
|--|--|
|  AF 35S47 Parts Replacement Form | |
| <input type="checkbox"/> A parts <input type="checkbox"/> B parts <input type="checkbox"/> D parts <input type="checkbox"/> F parts <input type="checkbox"/> G parts <input type="checkbox"/> H parts <input type="checkbox"/> J parts <input type="checkbox"/> K parts | <input type="checkbox"/> R parts <input type="checkbox"/> U parts <input type="checkbox"/> X parts <input type="checkbox"/> TA parts <input type="checkbox"/> TB parts <input type="checkbox"/> T parts |
| Reason for replacement: | <input type="checkbox"/> Missing <input type="checkbox"/> broken |
| Signature: _____ | |

| | | |
|---|--|--------------------------------|
|  AF 35S47 零件補充申請表 | | 申請人 姓 地 電 名 址 話 : : : |
| <input type="checkbox"/> A部品零件 ——— NT\$ 280 <input type="checkbox"/> B部品零件 ——— NT\$ 120 <input type="checkbox"/> D部品零件 ——— NT\$ 240 <input type="checkbox"/> F部品零件 ——— NT\$ 220 <input type="checkbox"/> G部品零件 ——— NT\$ 180 <input type="checkbox"/> H部品零件 ——— NT\$ 160 <input type="checkbox"/> J部品零件 ——— NT\$ 160 <input type="checkbox"/> K部品零件 ——— NT\$ 180 <input type="checkbox"/> R部品零件 ——— NT\$ 120 <input type="checkbox"/> U部品零件 ——— NT\$ 160 <input type="checkbox"/> X部品零件 ——— NT\$ 120 <input type="checkbox"/> TA部品零件 ——— NT\$ 120 <input type="checkbox"/> TB部品零件 ——— NT\$ 120 <input type="checkbox"/> T部品零件 ——— NT\$ 160 郵寄費 ——— NT\$ 80 | | |
| 請填 總計 NT\$ _____ | | |
| 零件補充原因:(請於 <input type="checkbox"/> 打√) 原包裝即 <input type="checkbox"/> 遺失或 <input type="checkbox"/> 毀損, 製作途中 <input type="checkbox"/> 遺失或 <input type="checkbox"/> 毀損, 其他原因 _____ | | |