

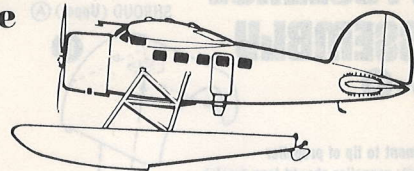

Lockheed VEGA

Floatplane

1/48
scale



INSTRUCTION SHEET

IMPORTANT! READ THESE POINTS BEFORE YOU BEGIN

- 1 "TEST FIT" all parts before cementing. Trim excess plastic from parts before joining.
- 2 Cement all parts unless otherwise indicated by the instructions.
- 3 Use paint and cement made for styrene plastic only.
- 4 Paint all sub-assemblies before attaching parts.
- 5 Scrape paint away from surfaces to be cemented together.
- 6 Follow all of the numbers on the instruction sheet beginning with number one.

TOOLS

IMPORTANT NOTE: Do not remove parts from runners until ready to use.



TWEEZERS TO PLACE, PICK UP AND HOLD SMALL PARTS.



KNIFE TO REMOVE AND TRIM PARTS. FILE TO REMOVE EXCESS PLASTIC.



CEMENT USE TOOTHPICK, PAINT BRUSH OR PIN TO APPLY IT

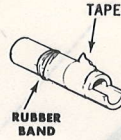

TAPE, RUBBER BAND AND CLOTHES PINS TO CLAMP AND HOLD PARTS UNTIL THEY ARE DRY.

PAINTING YOUR MODEL

Use only paint made for styrene plastic models. You can create your own color scheme or follow the box cover illustration. For additional color detailing refer to instruction sheet. The following paints are suggested to duplicate cover illustration:

- (A) Fuselage, engine cowling: Pactra Candy Pagan Gold over Insignia Orange
- (B) Wing, vertical tail: Pactra Flesh.
- (C) Floats, struts: Pactra Flat Aluminum.
- (D) Engine, cockpit: Pactra Flat Metallic Gray.

IMPORTANT NOTE: Layout shown below is an aid to identify parts in this kit. They are numbered according to assembly on instruction sheet only! These numbers DO NOT appear on actual parts.

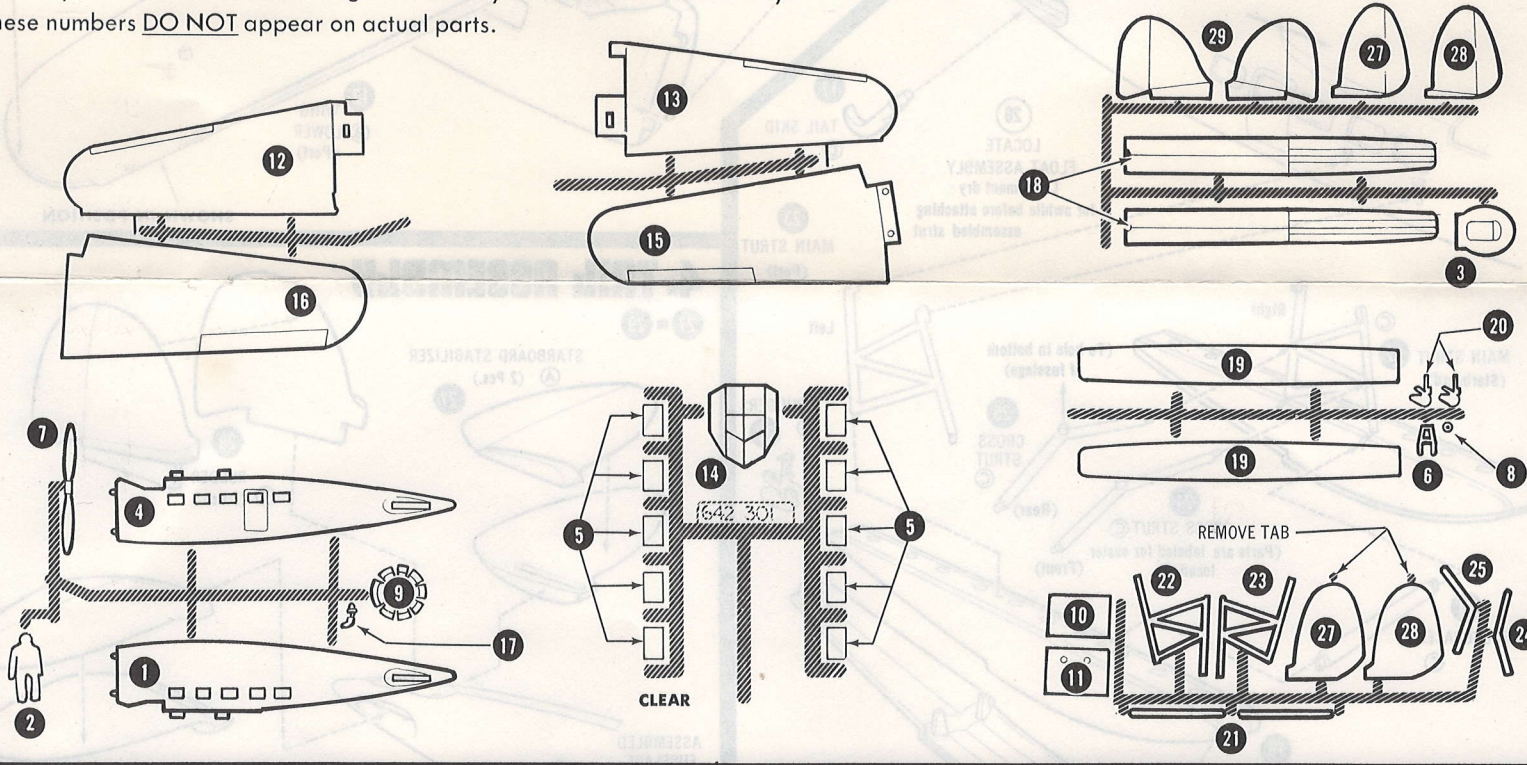

I. FUSELAGE ASSEMBLY 1-6

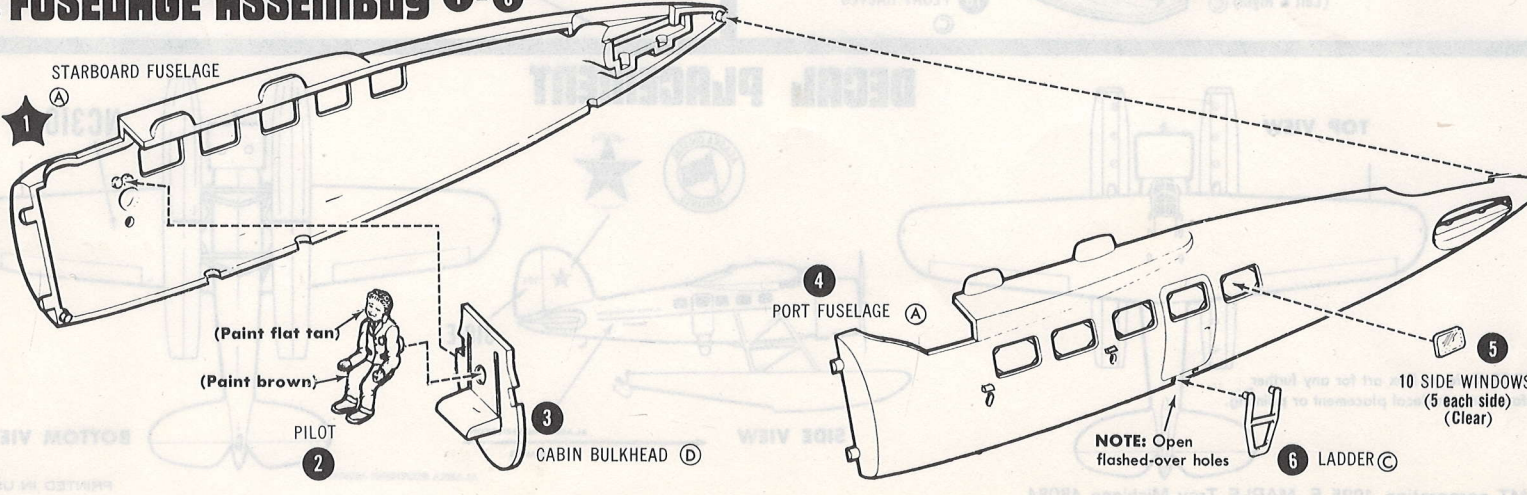

2. FUSELAGE ASSEMBLY

7-16

(Cement to tip of propeller shaft; propeller should turn freely)

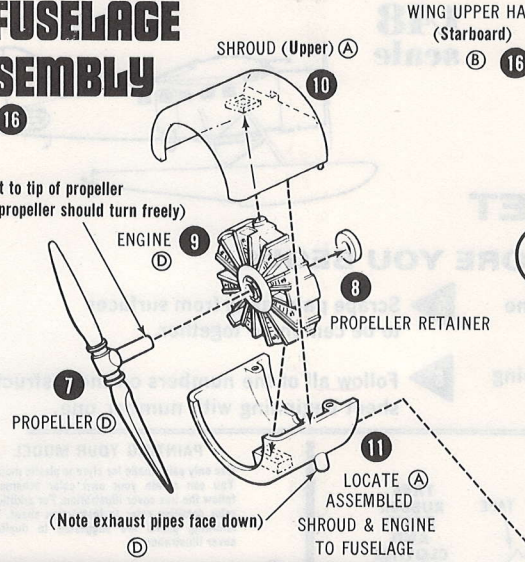

WING UPPER HALF (Starboard) (B) 16

NOTE: CEMENT UPPER WING HALVES TOGETHER, LAY ON FLAT SURFACE AND ALLOW TO DRY; THEN LOCATE TO LOWER WINGS

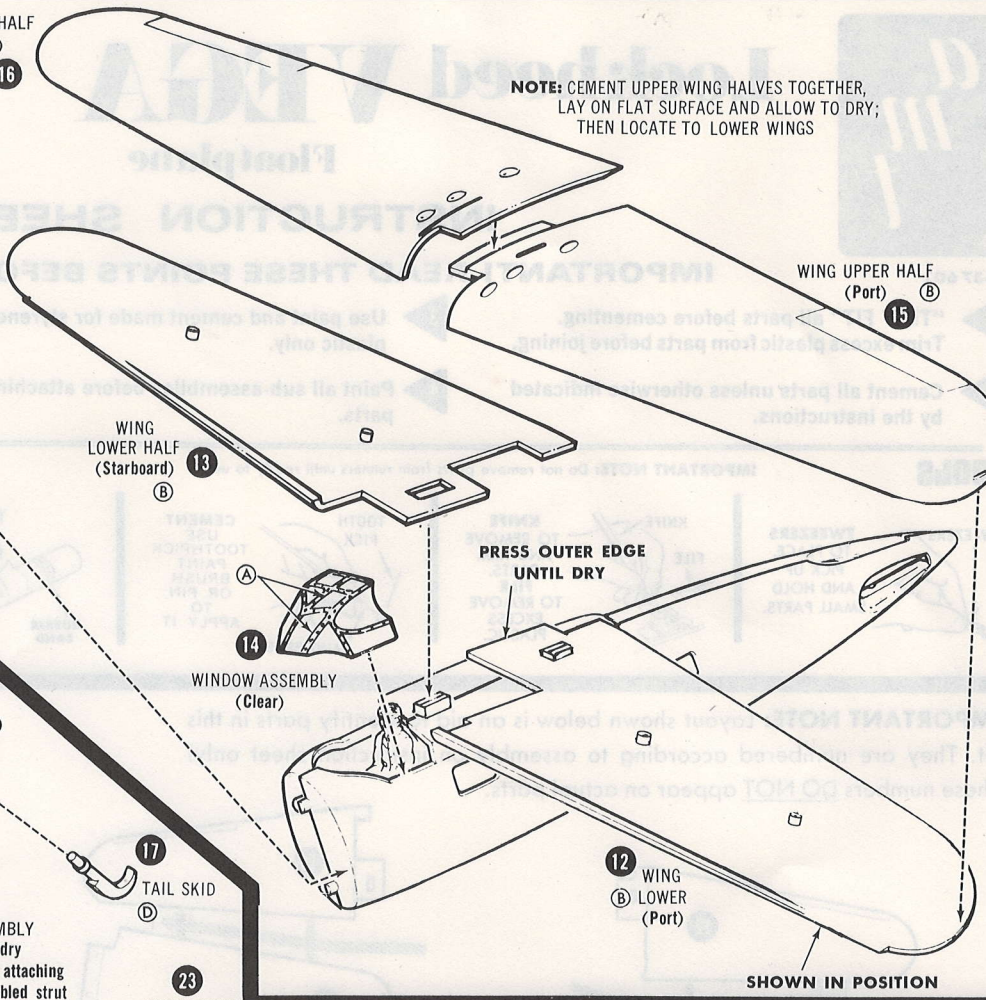

3. FLOAT ASSEMBLY

17-26

26 LOCATE FLOAT ASSEMBLY Let cement dry for awhile before attaching assembled strut

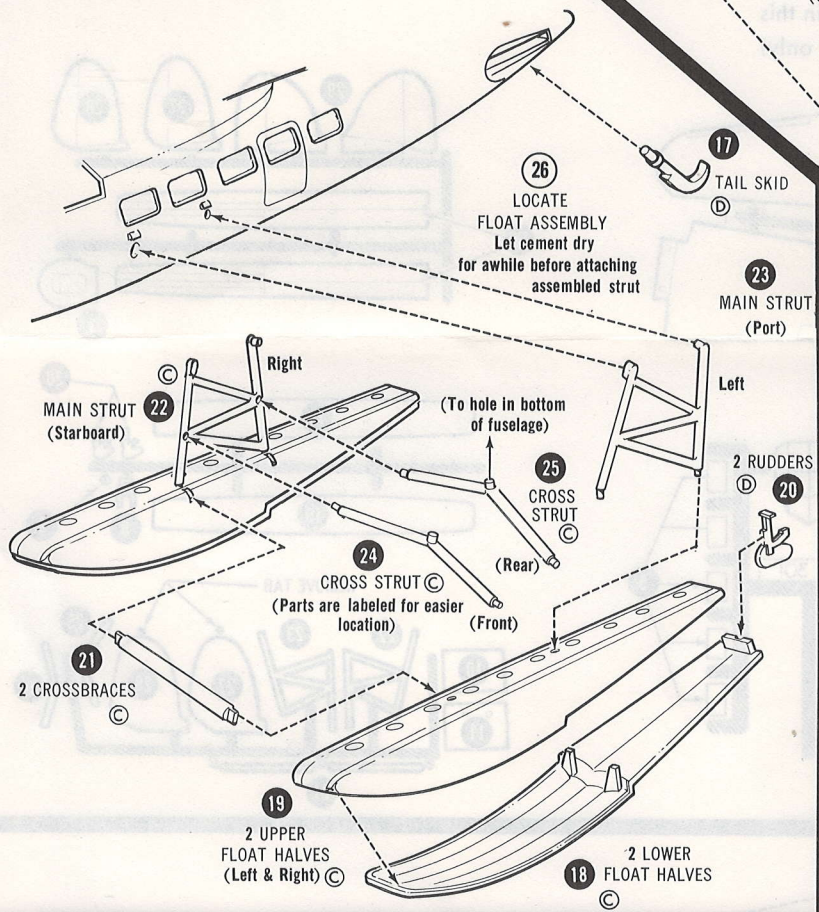

4. TAIL ASSEMBLY

27-29

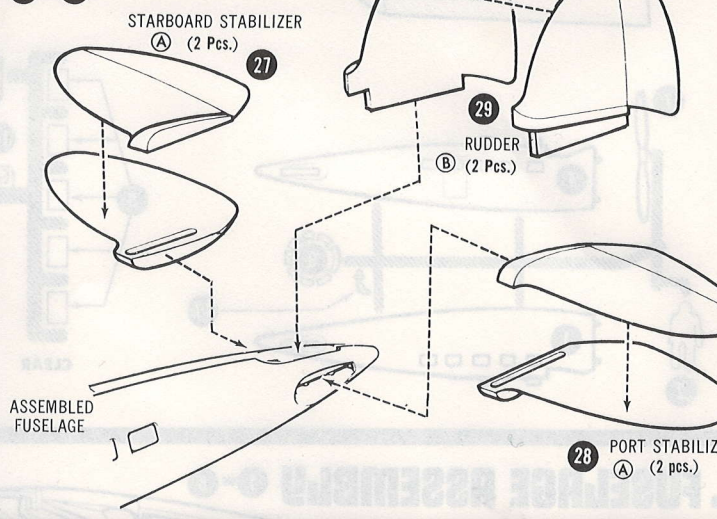

DECAL PLACEMENT

TOP VIEW

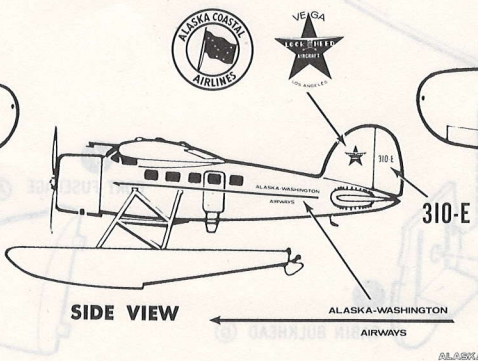
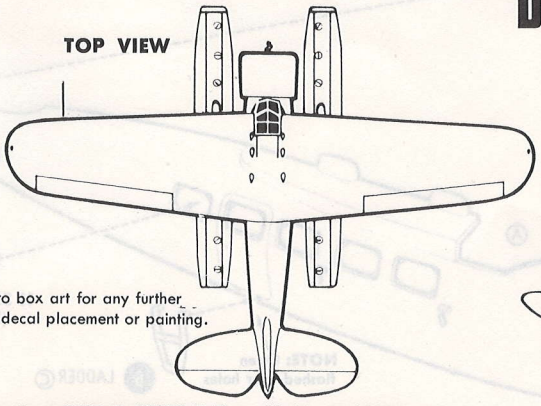

NC310-E

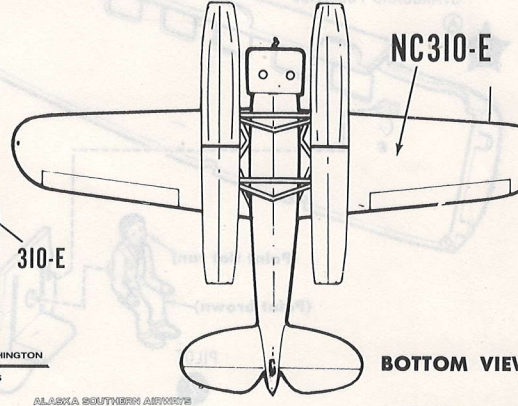

NOTE: Refer to box art for any further information on decal placement or painting.