

P-47D-30RE THUNDERBOLT

48023



**SCALE
1:48**

GENERAL INSTRUCTION

- HIGHLY DETAILED MODEL
- HATCHED CAN BE POSED OPEN & CLOSED
- 3 TYPES OF WHEELS INCLUDED
- CLEAR PARTS INCLUDED
- DECAL SHEET FOR 2 VARIANTS

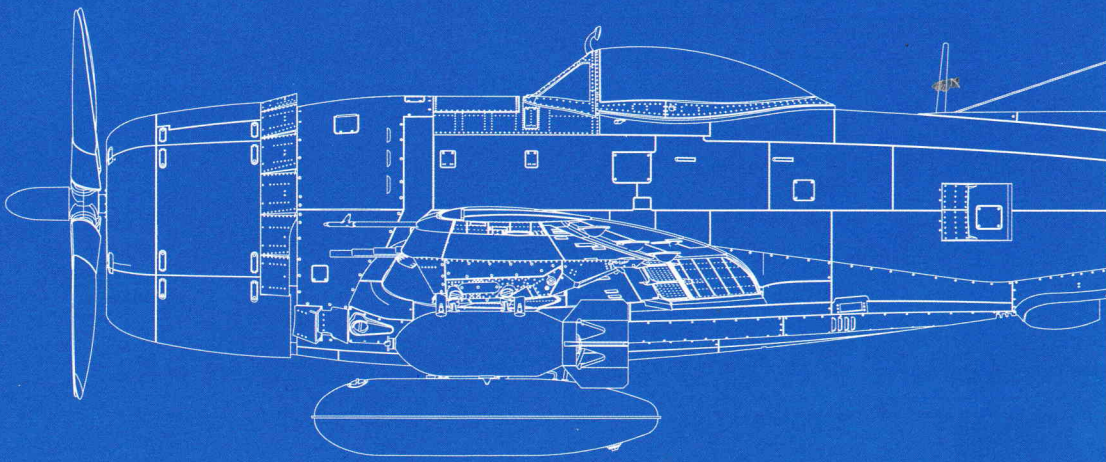

UWAGA

Przy stosowaniu kleju i farb wszystkie prace należy wykonywać w przewiewnym miejscu z dala od źródeł ognia.
Oddziel części od wlewków nożem lub innym ciętym narzędziem. Oczyść lampę błyskową i wytnij punkty pilnikiem igłowym i papier ścierny. Złóż modele zgodnie z schemat montażu.
Dla ułatwienia montażu każda część jest oznaczona numerem.
Po złożeniu zestawu mogą pozostać niewykorzystane części.

УВАГА

При використанні клею та фарб всі роботи проводити подалі від джерел вогню у приміщенні, що добре провітрюється.
Деталі відокремлювати від літників ножем або іншим ріжучим інструментом. Зачистити облой і місця зрізу за допомогою надфілю та наждачного паперу. Будівництво моделі виконувати згідно зі схемою. Для зручності побудови кожна деталь позначена номером.
Після складання можуть залишитися невикористані деталі.

CAUTION

When you use glue or paint, do not use near open flame, and use in well ventilated room. When you take parts off from the runner frame, use modeling scissors or cutter.
See the bottom of this column for the meaning of symbols.
Extra details can remain after assembling of the kit.

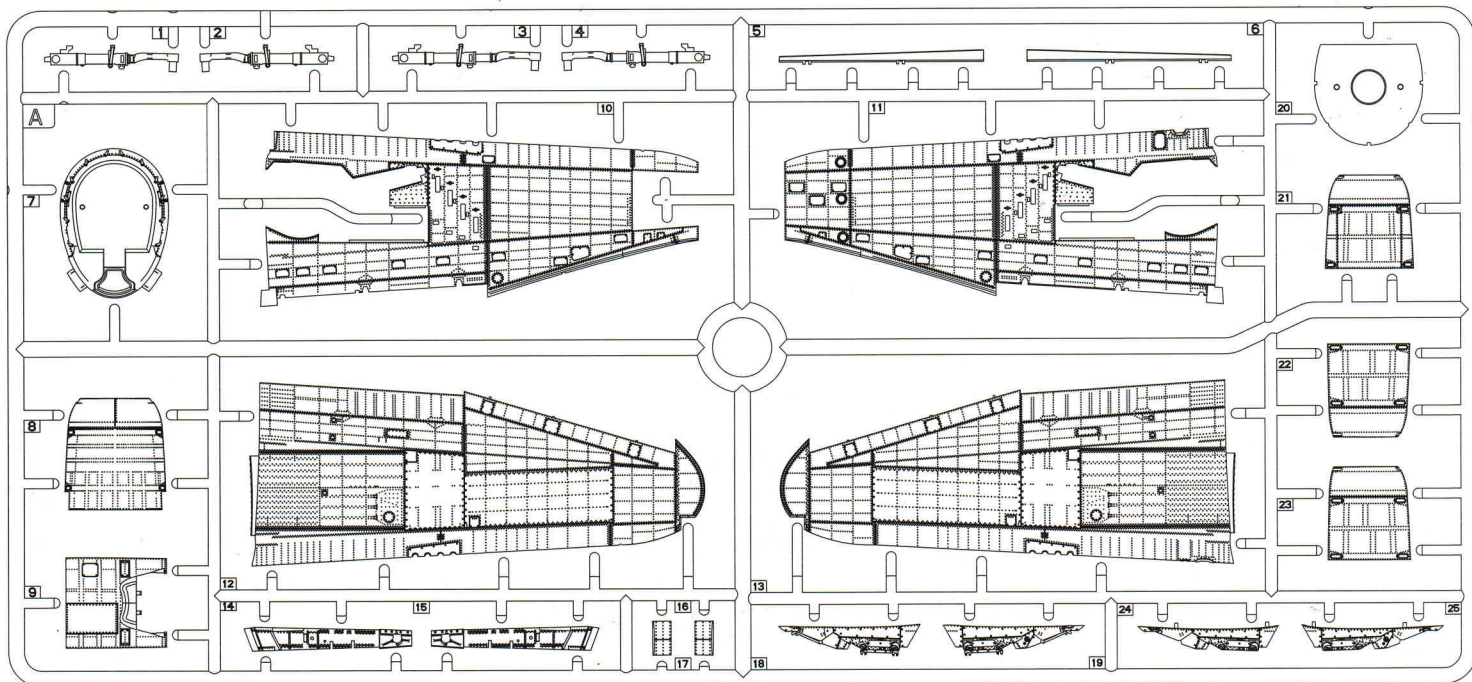
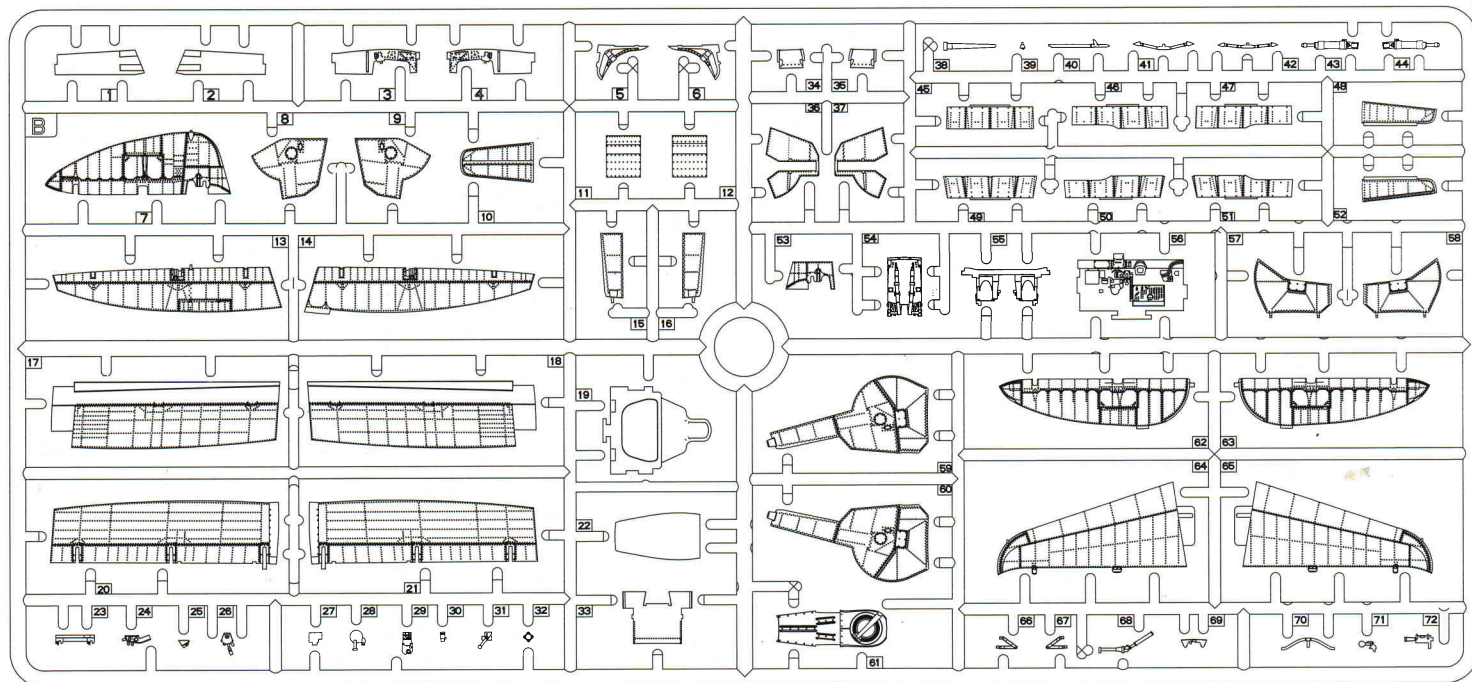
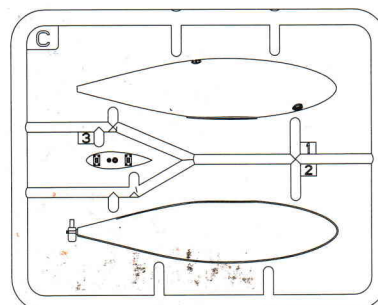
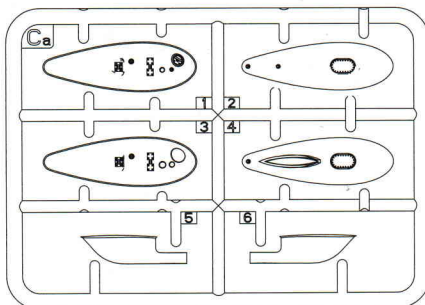
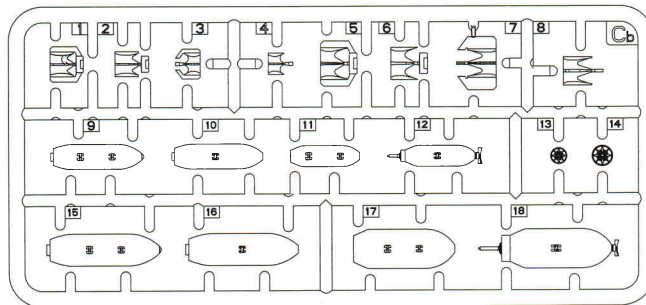
PARTS**A****B****C x2****Ca x2****Cb x2**



POWÓRZ DWA RAZY
MAKE 2PCS
2 TEILE FERTIGEN
EFFECTUER 2 PIECES
FARE DUE PEZZI
TEE 2 KPL
GOR 2 ST
КІЛЬКІСТЬ РАЗІВ

NIE UŻYWAJ KLEJU
DO NOT CEMENT
NICHT KLEBEN
NE PAS COLLER
NON INCOLLARE
EILIMÄÄ
LIMMAEJ
НЕ КЛЕЙТИ

OPCJE
OPTIONAL
NACH BELIEBEN
FACULTATIF
VALINNANVARAINEN
VALBAR
ВАРІАНТИ

ZROBIĆ DZIURĘ
OPEN HOLE
OFFNEN
FAIRE UN TROU
FORO APERTO
AVAA REIKA
OPPNÄ HALET
ЗРОБИТИ ОТВІР

ODCIĄC
REMOVE
ENTFERNEN
RETIRER
SEPARARE
POISTA
AVLÄGSNA
ВІДРІЗАТИ

ZGINAC
BEND
BITTE BIEGEN
PLIER S'IL VOUS PLAÏT
PIEGARE
TAITA
BOCKA
ВИГНУТИ

ZRÓB TO SAM
SCRATCHBUILD
AM MEISTEN ZU MACHEN
FAIRE LE PLUS
RENDITI
TEE ITSE
GOR DIG SJÄLV
ЗРОБИТИ САМОМУ

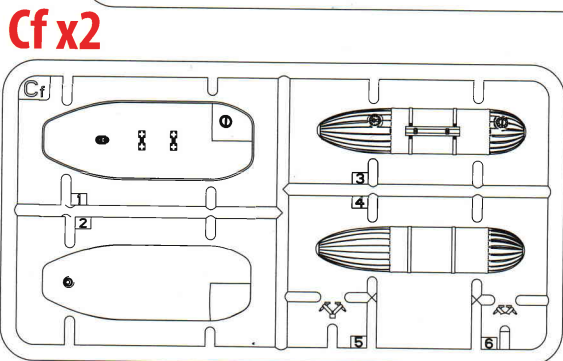
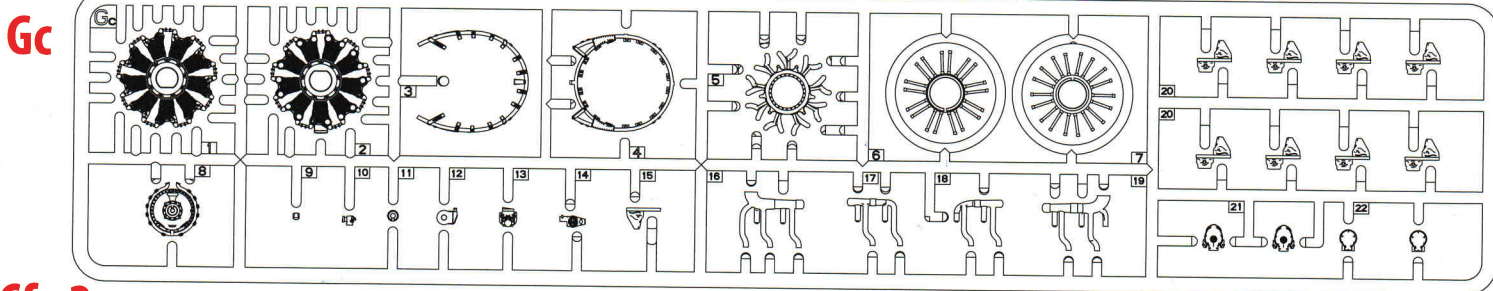
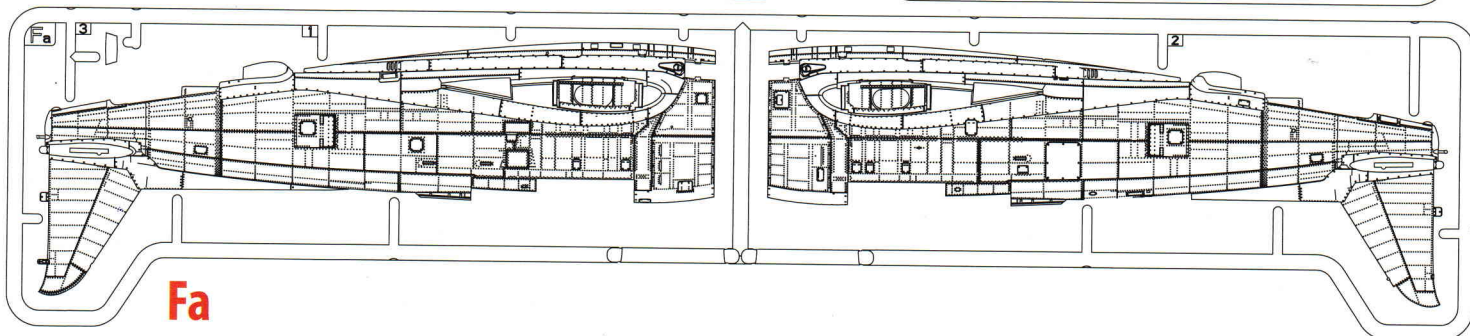
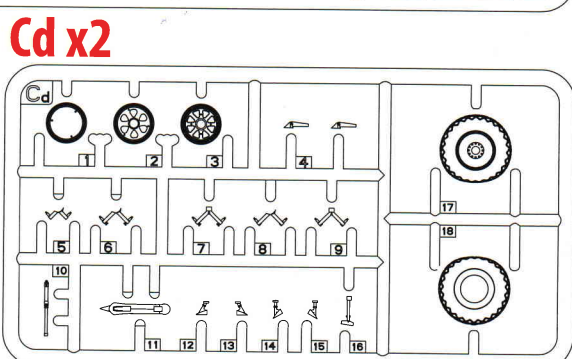
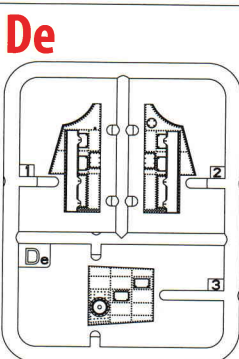
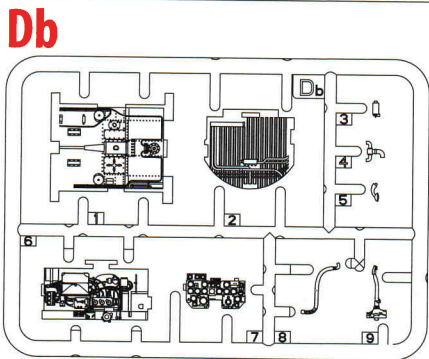
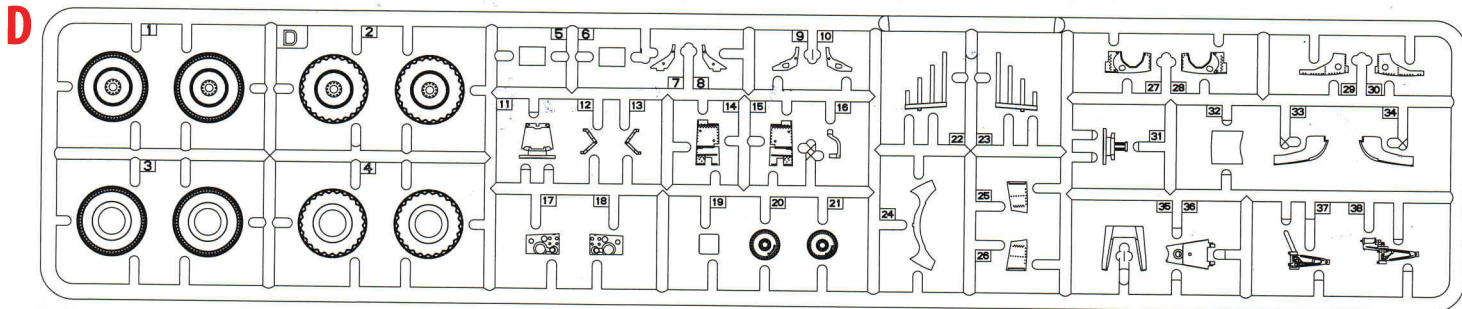

Decal Sheet

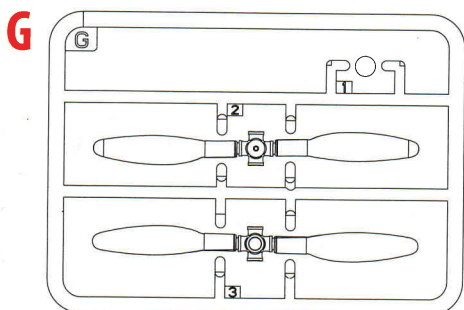

Clear Parts

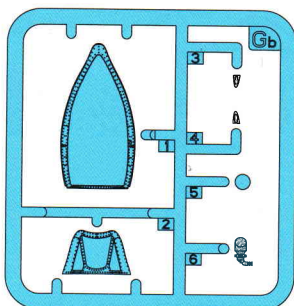

Decal Sheet STENCIL 48-01

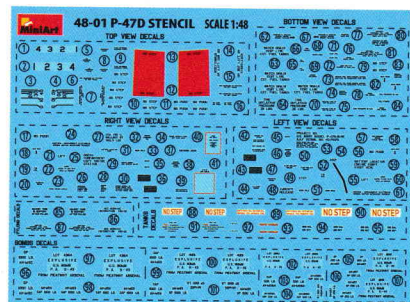

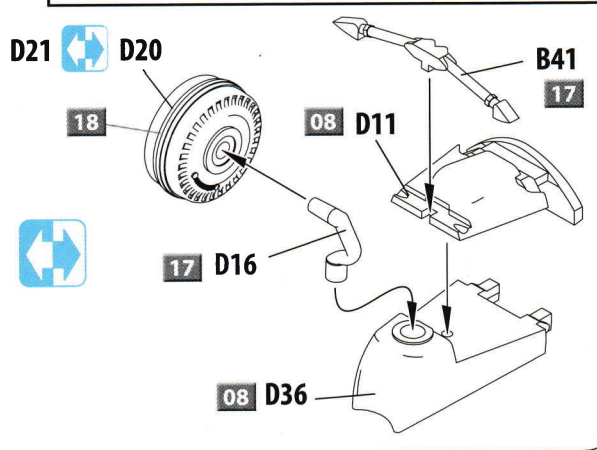
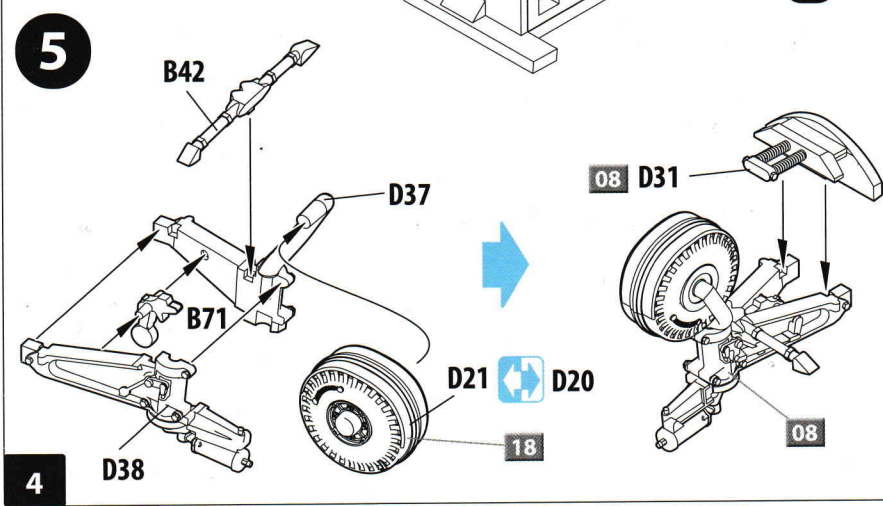
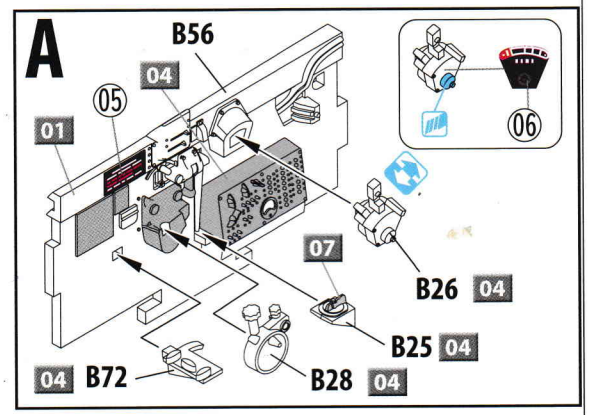
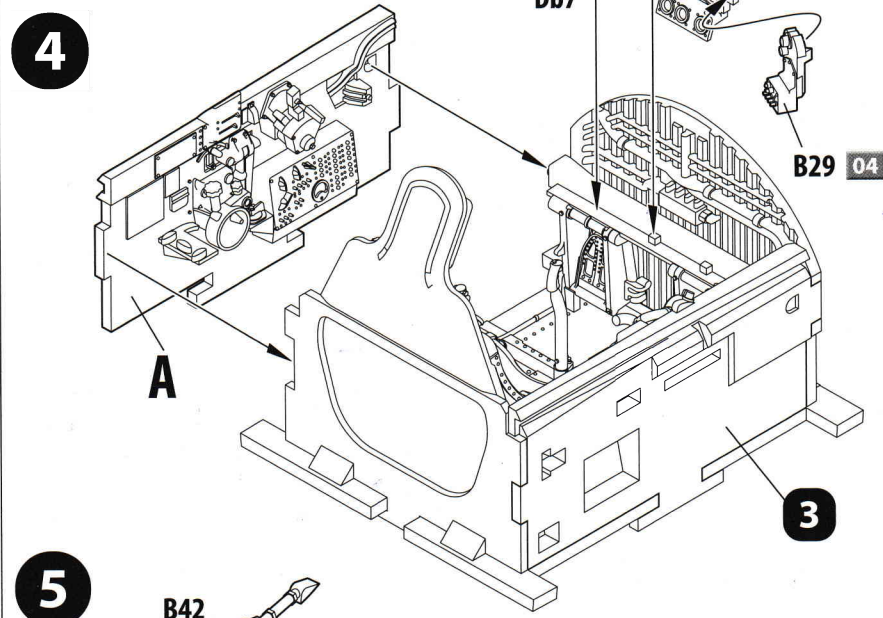
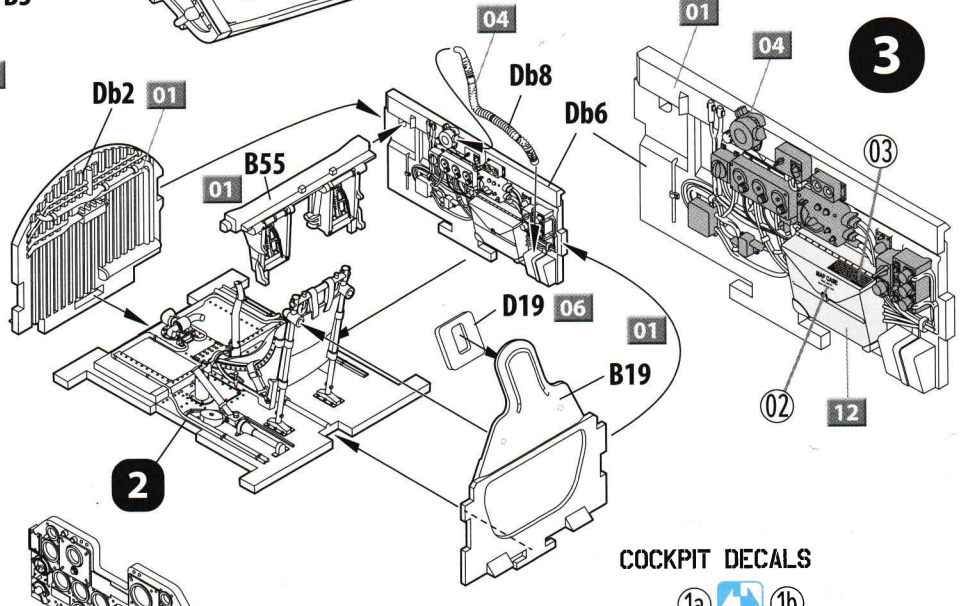
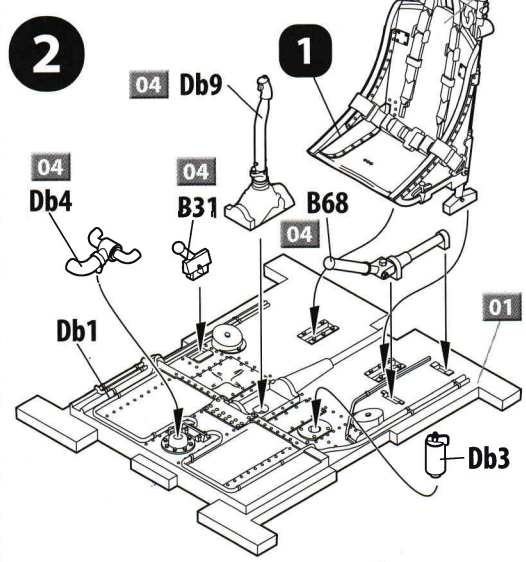
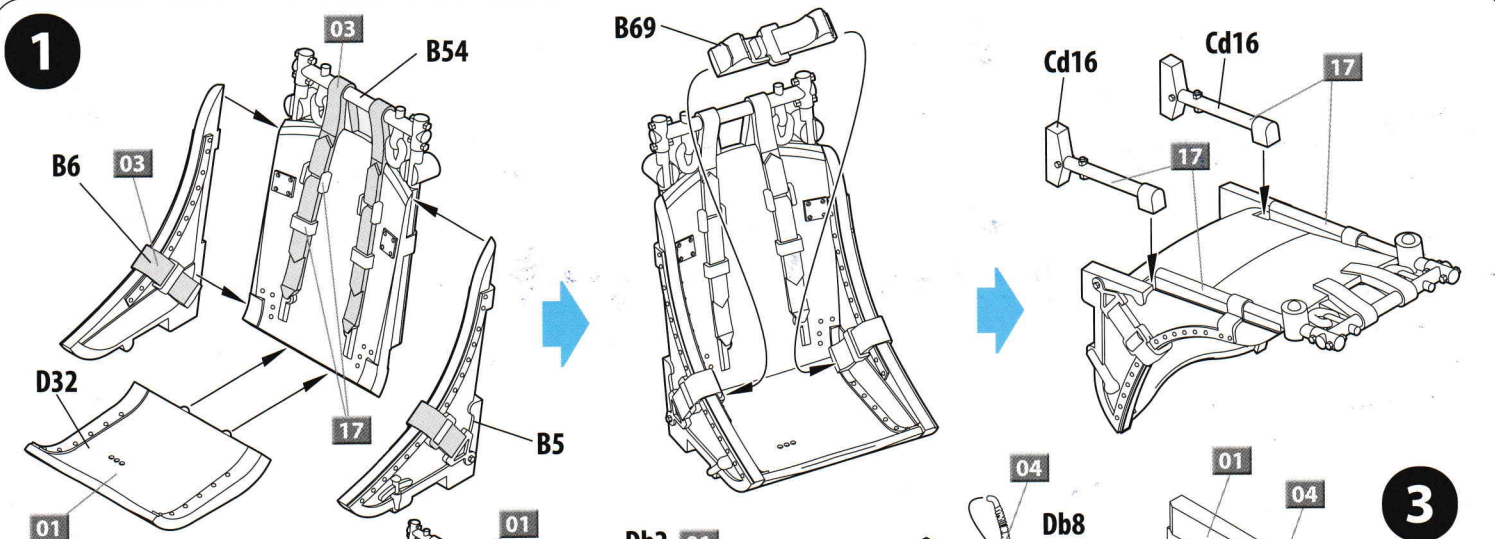

6

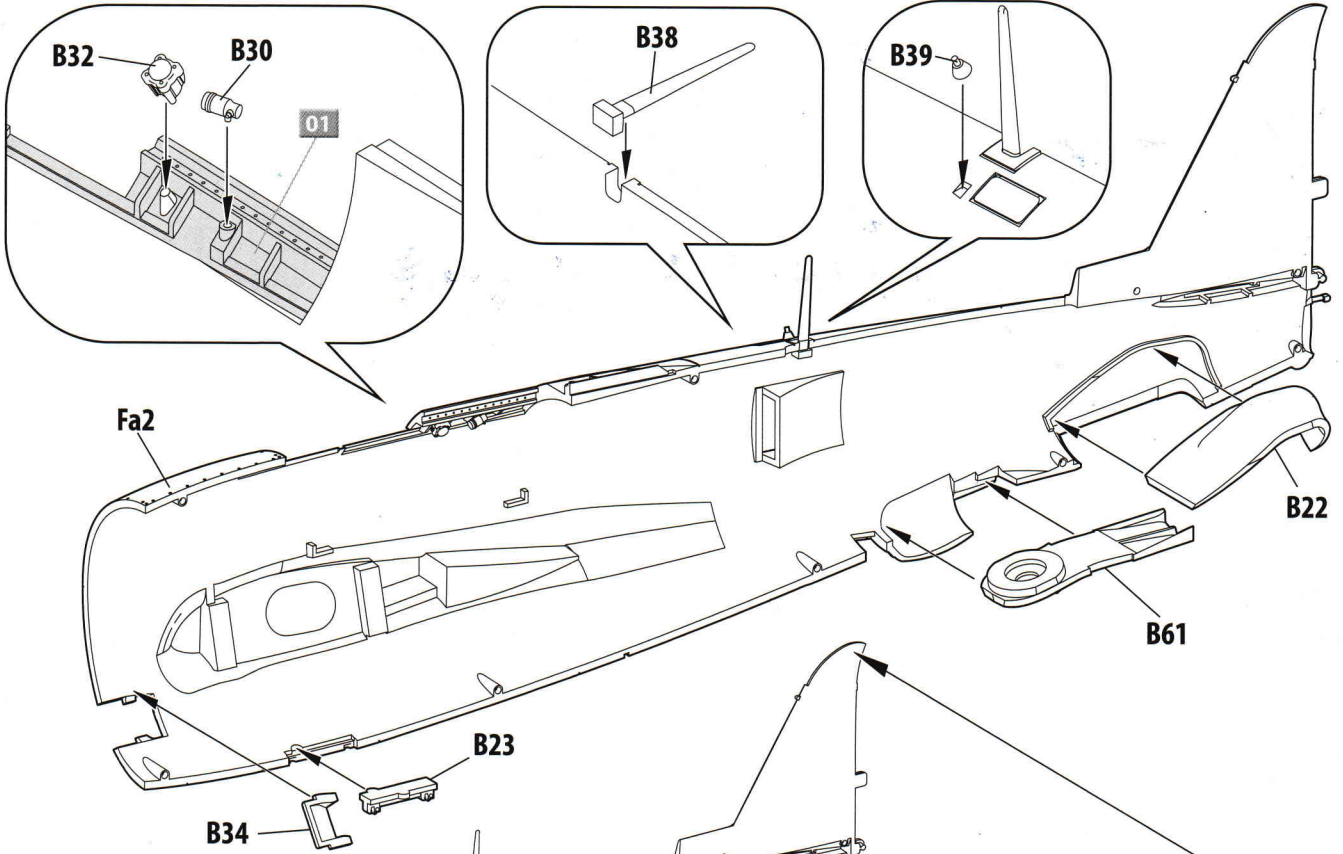

7

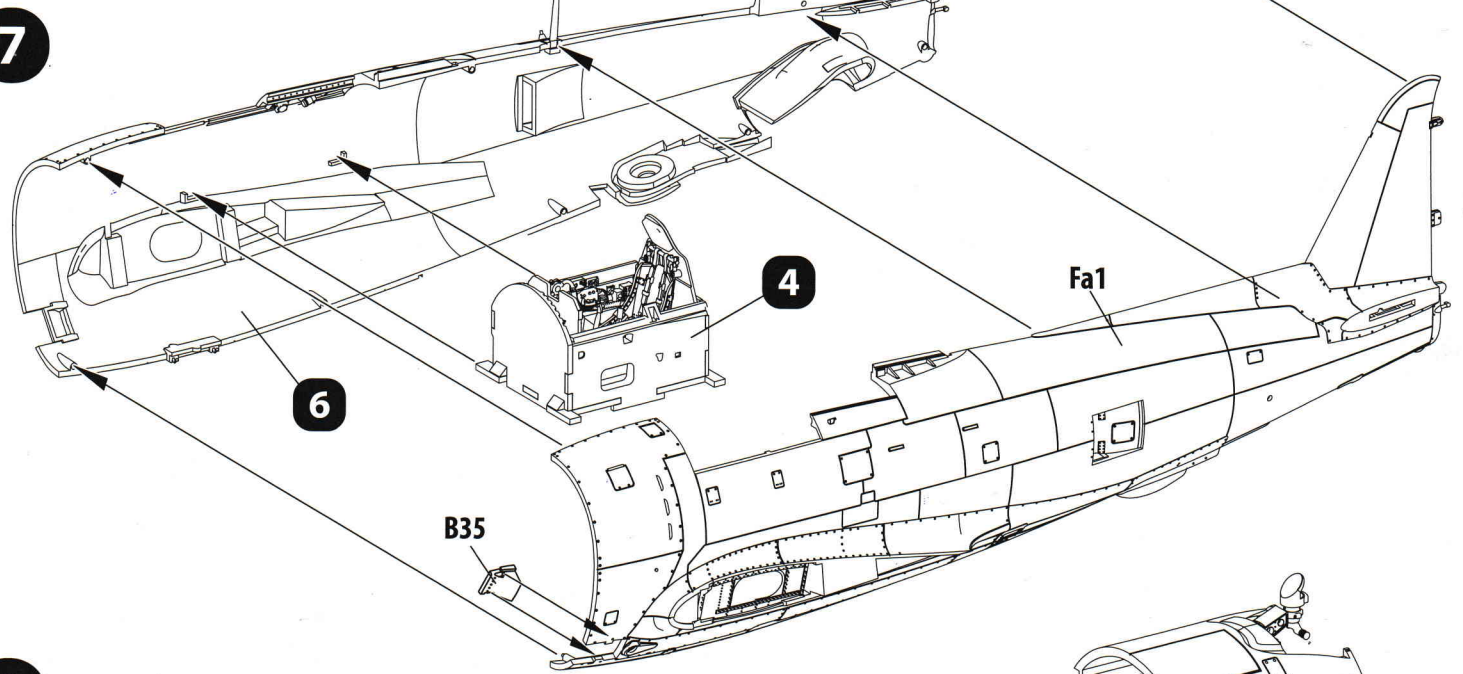

8

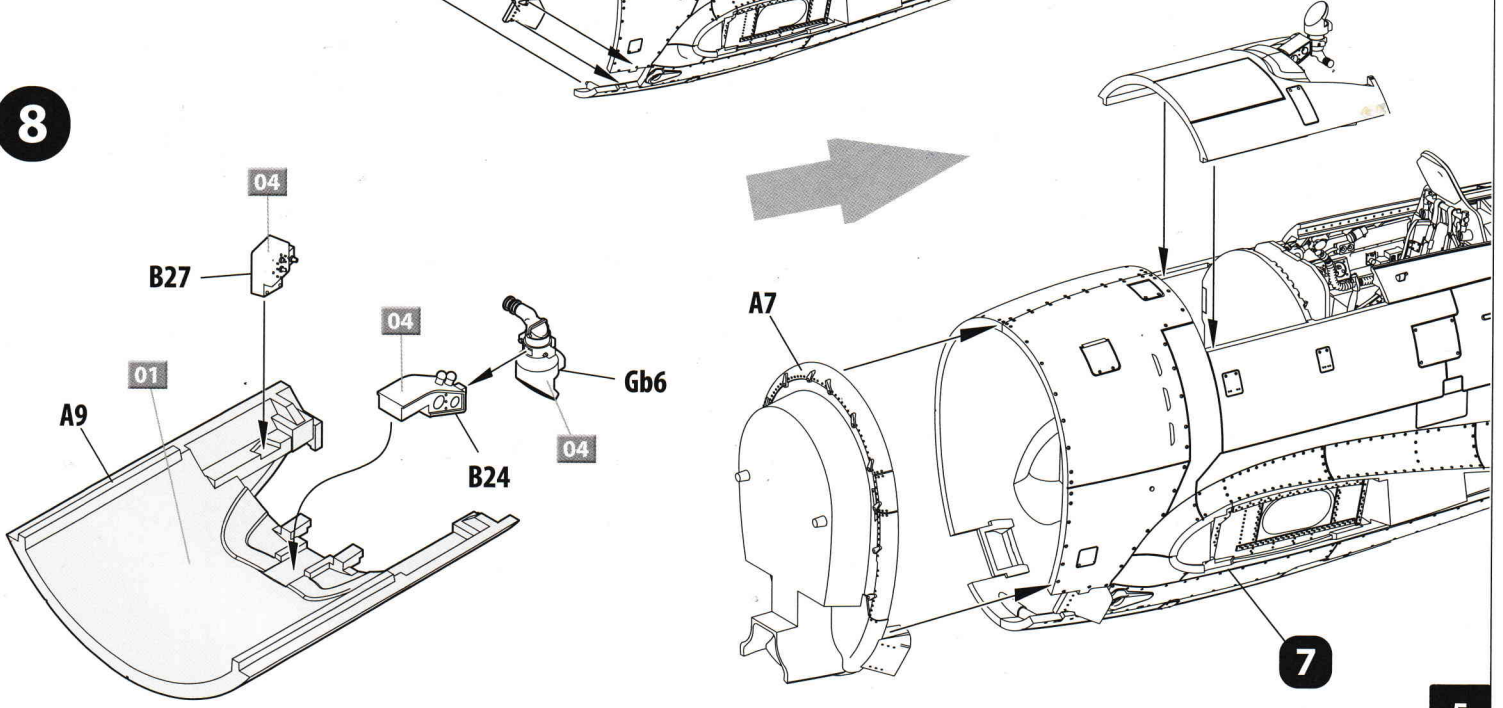

5

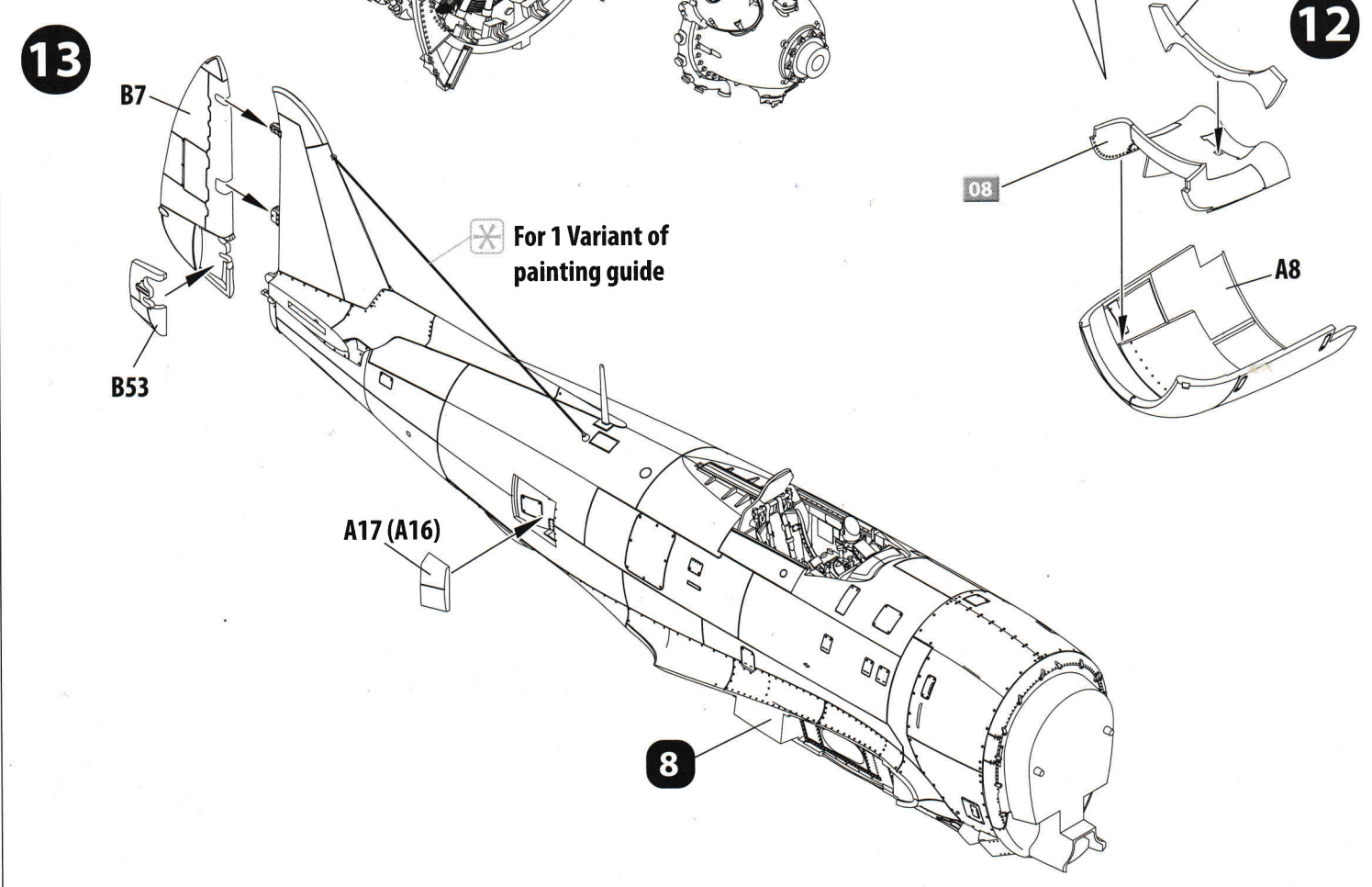
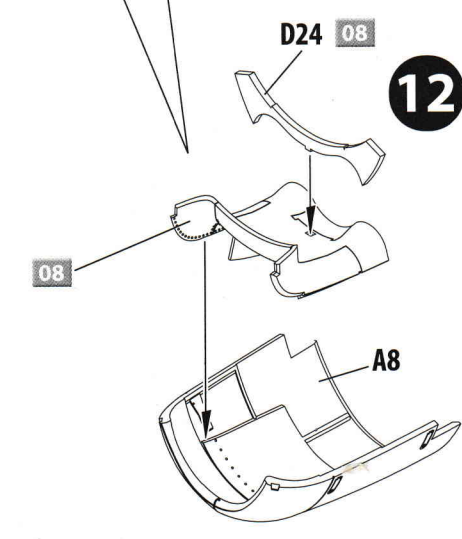
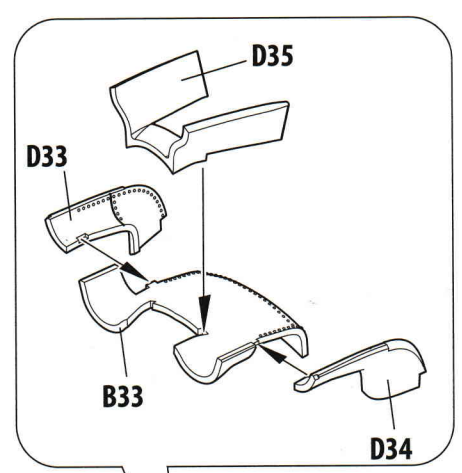
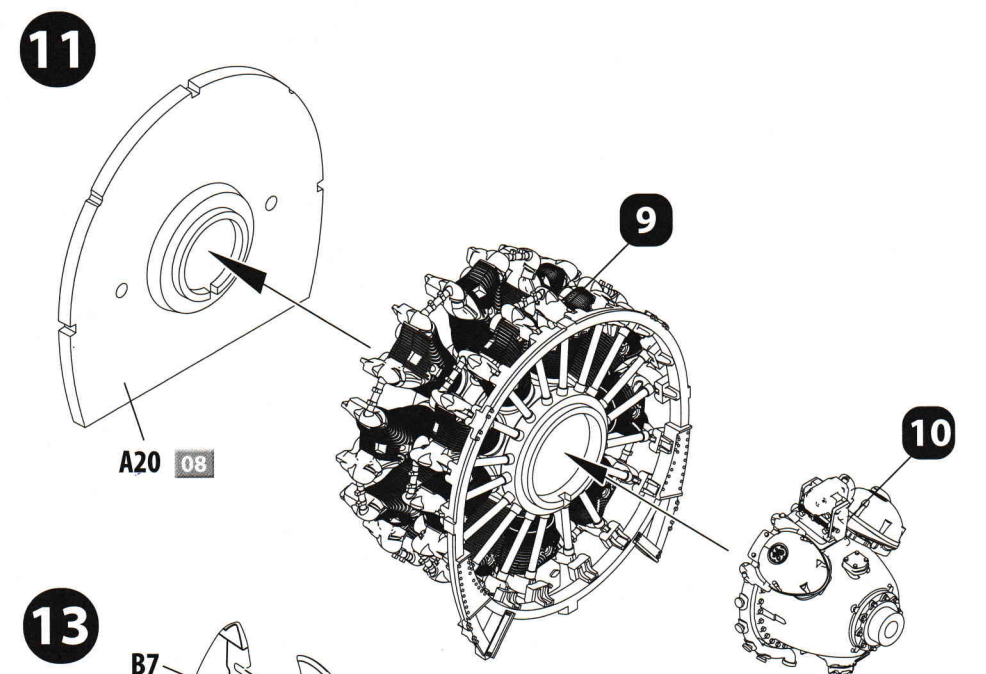
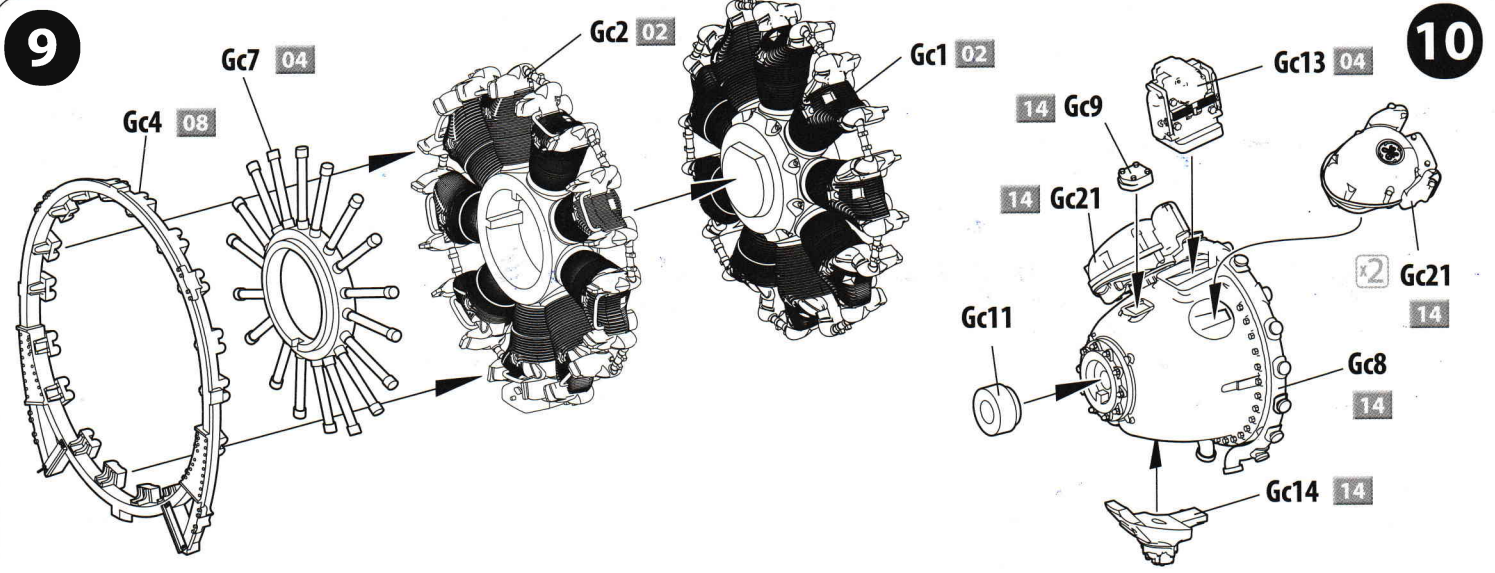

14

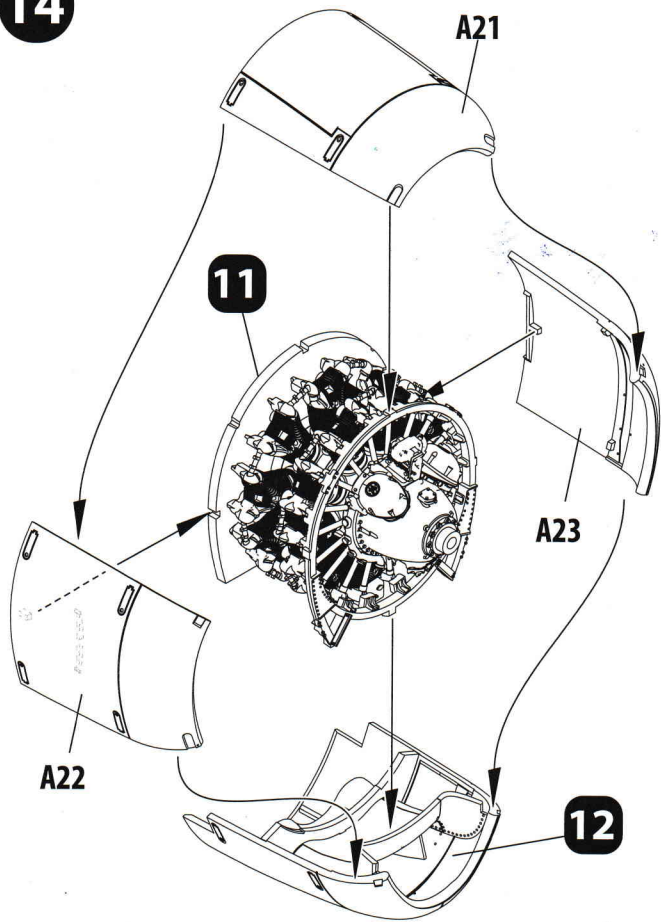

15

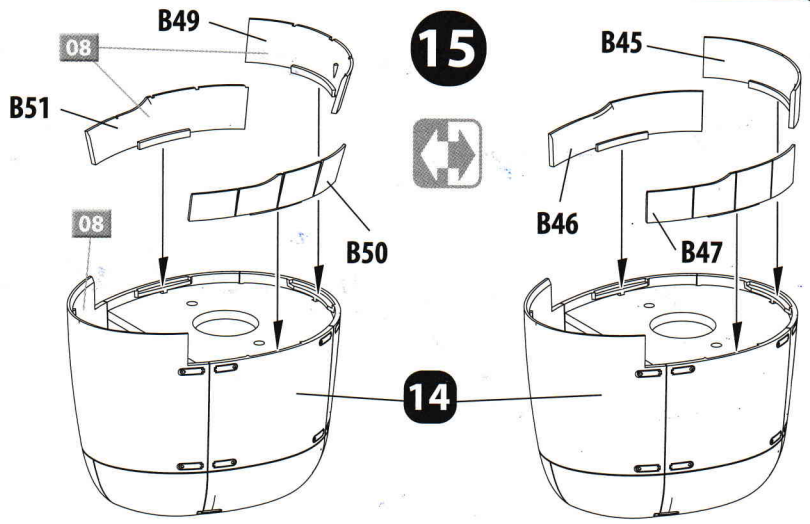

Open chassis option

16

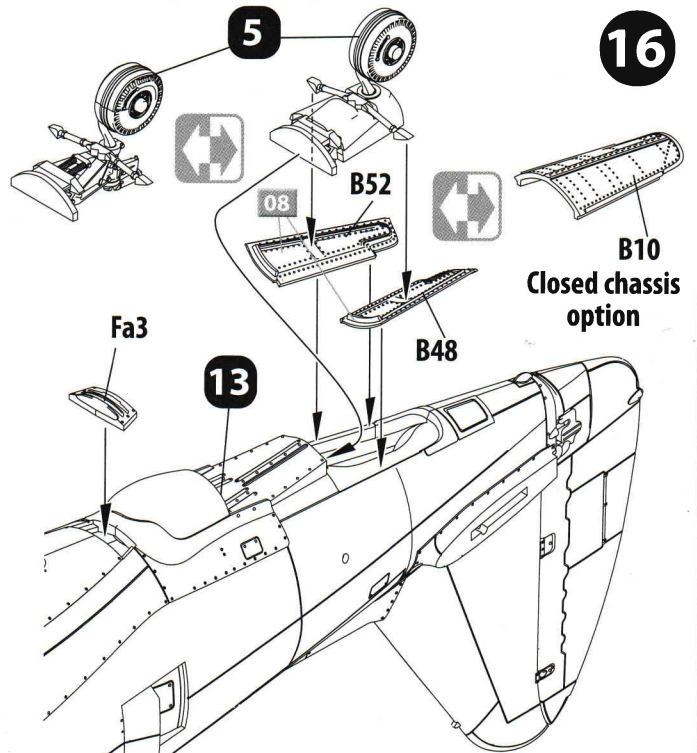

18

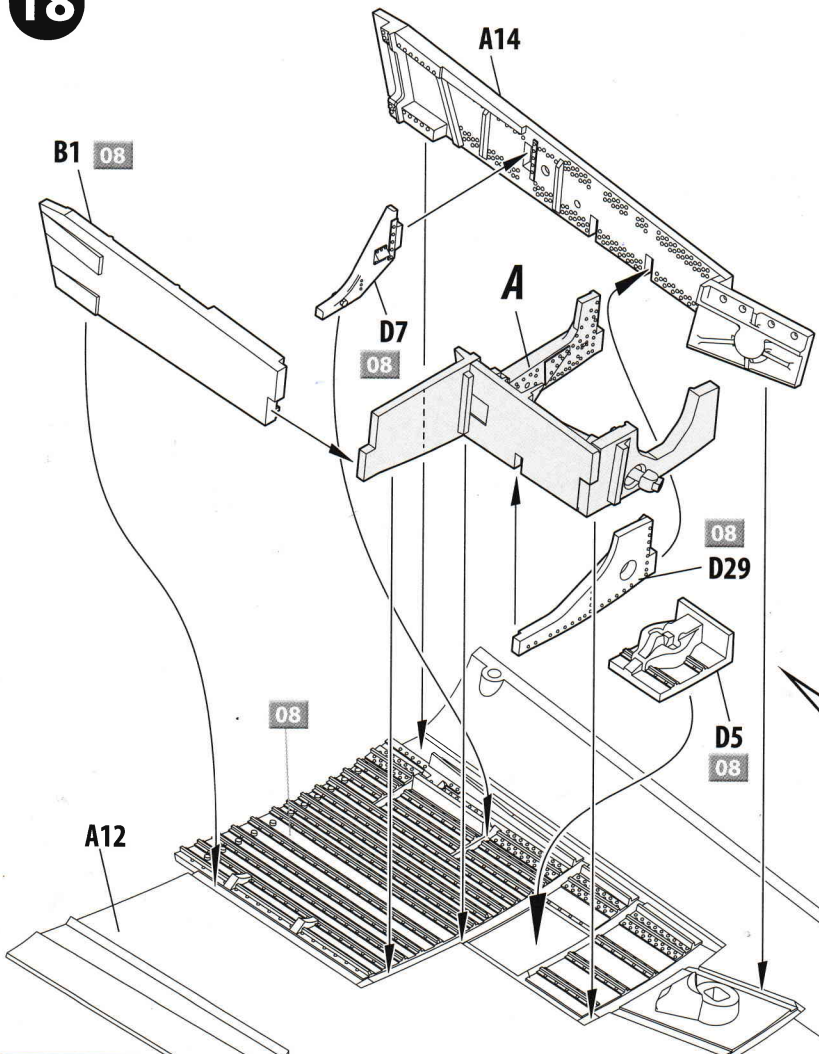

17

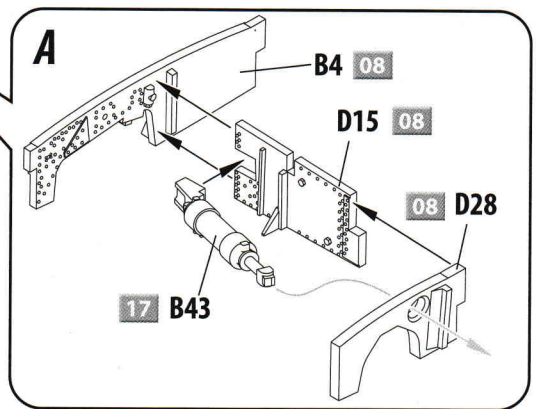
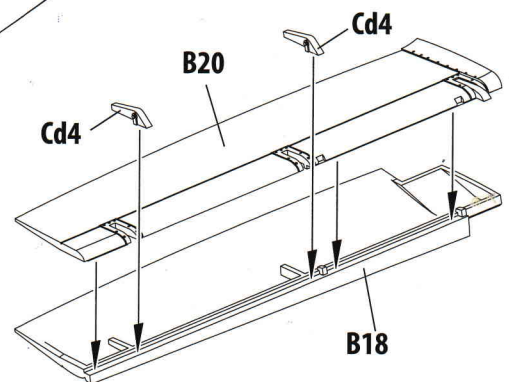

19

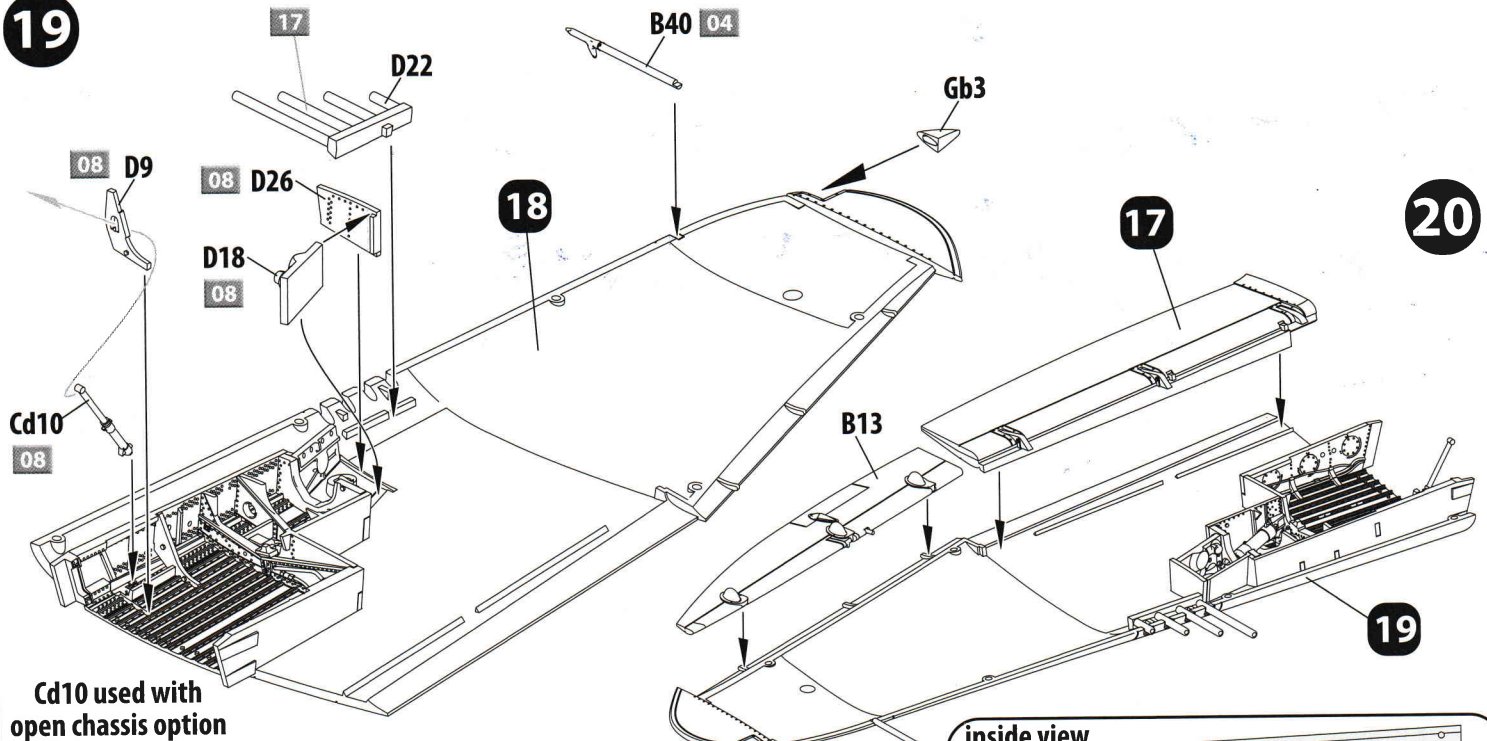

Cd10 used with open chassis option

21

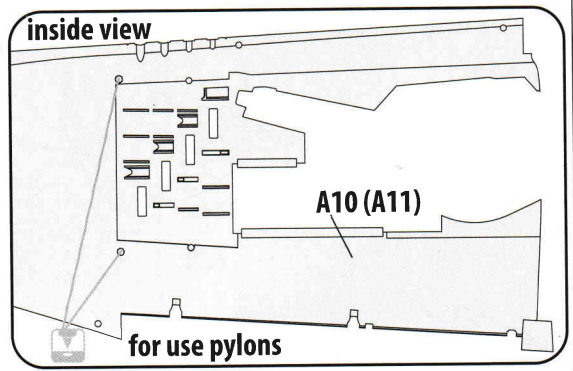
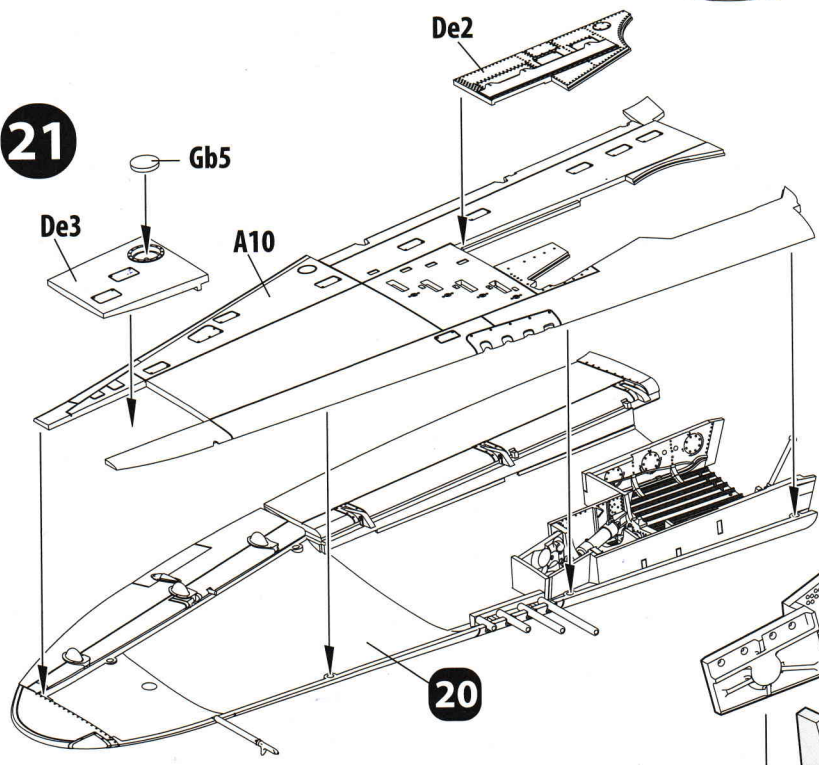

22

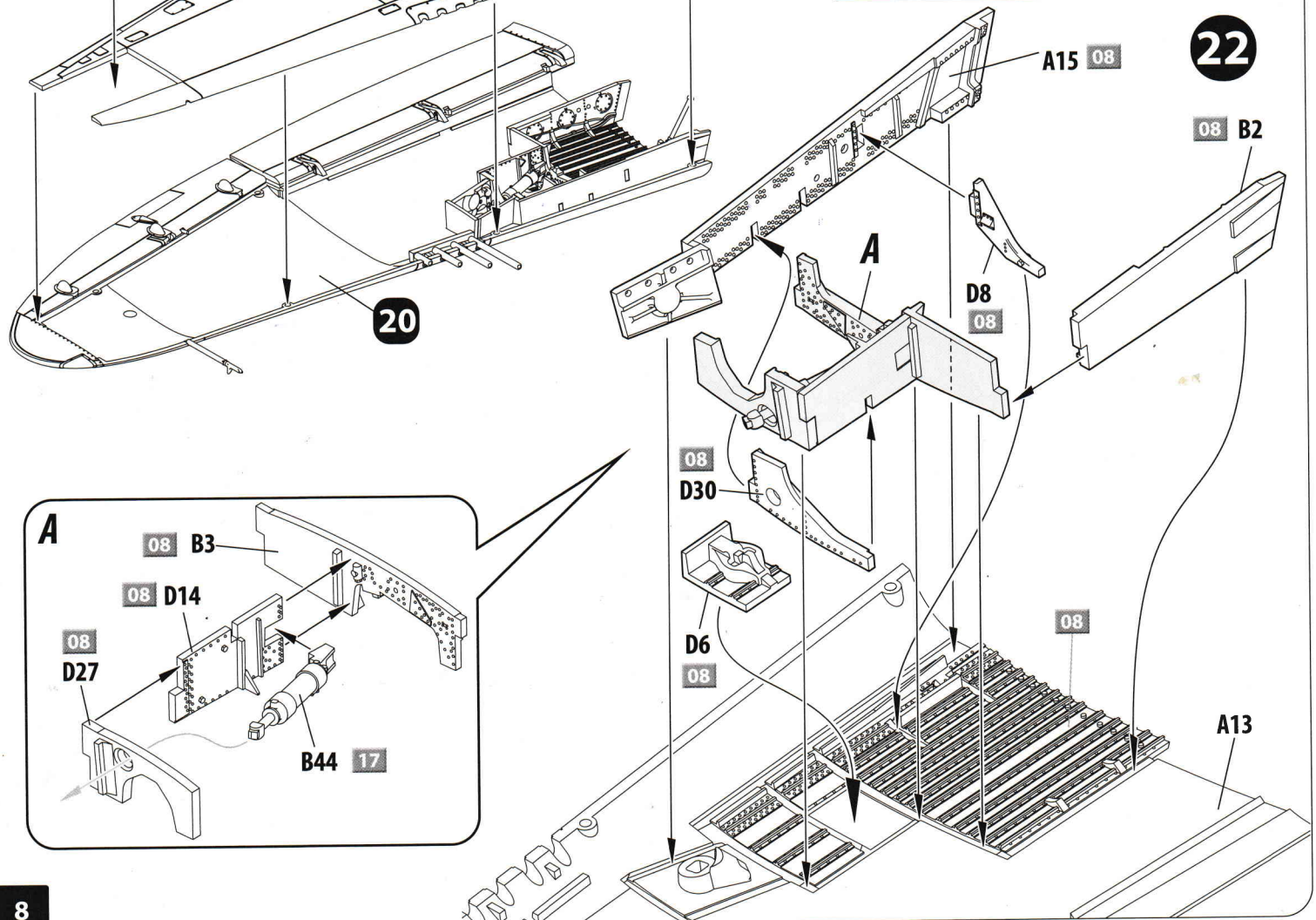

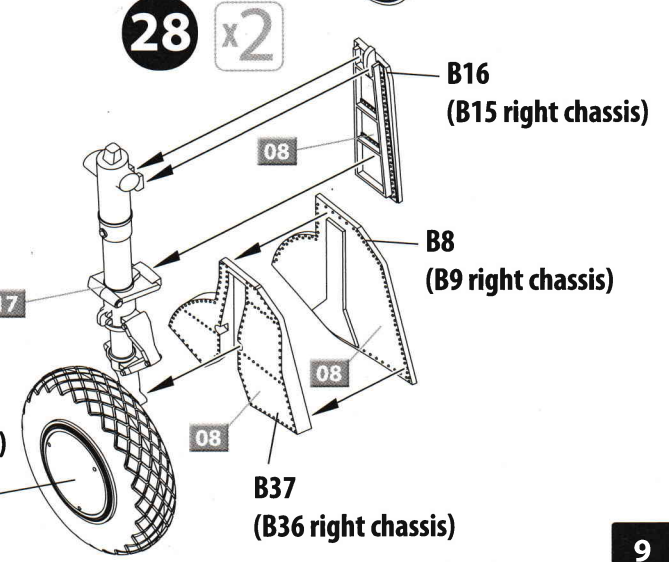
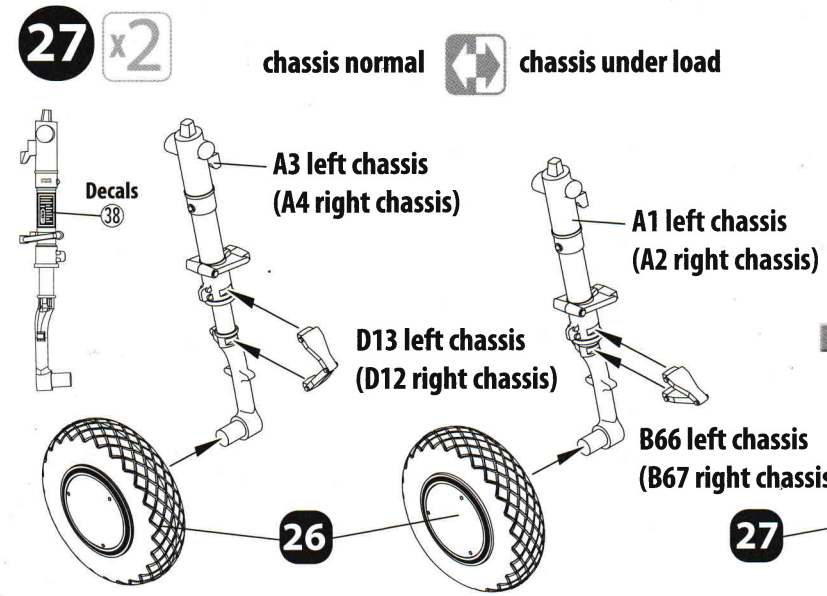
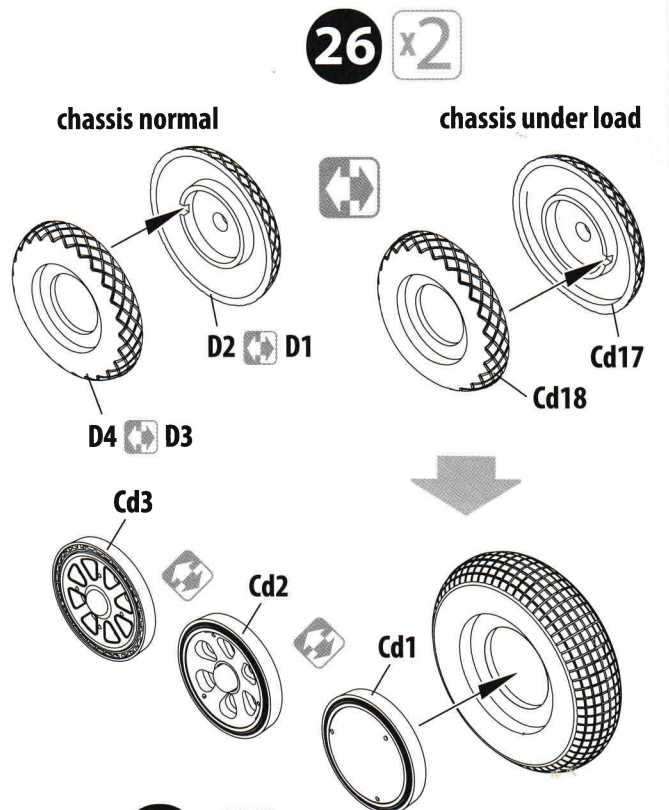
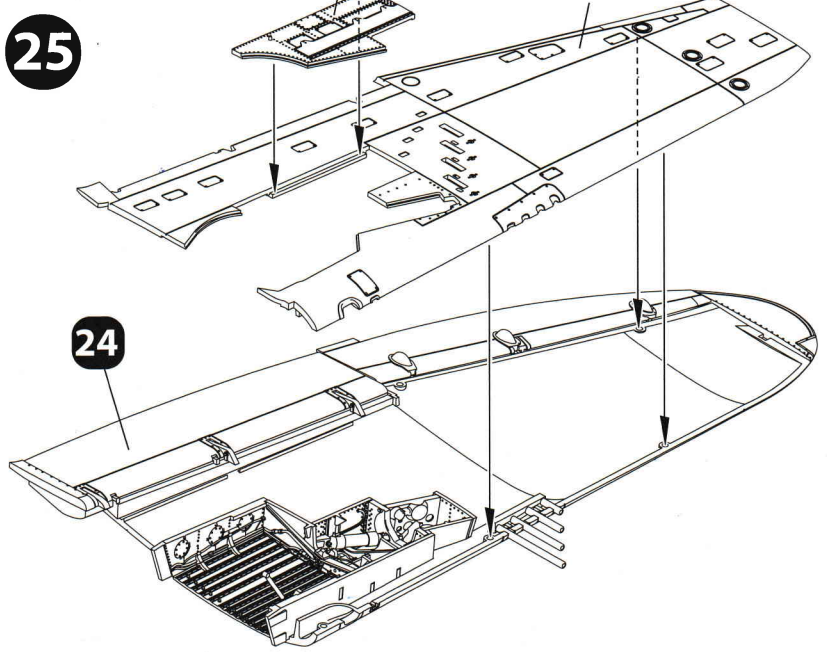
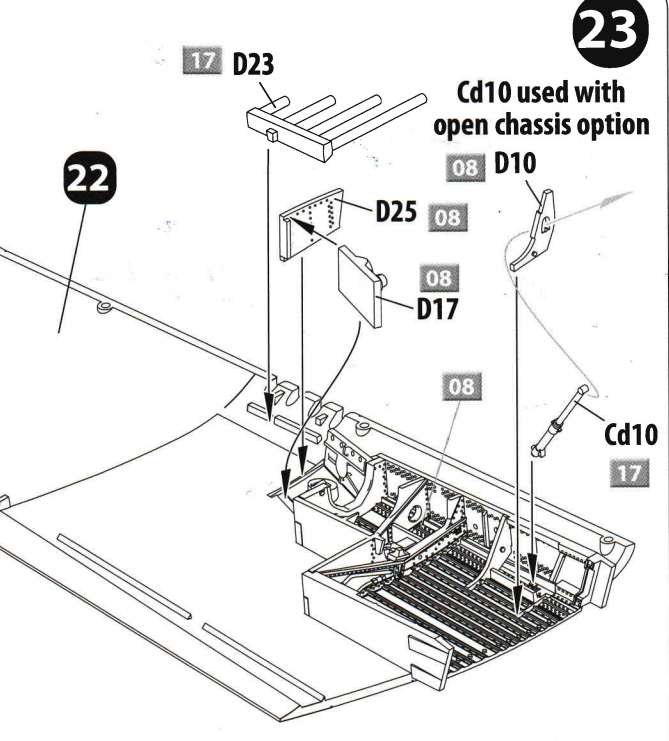
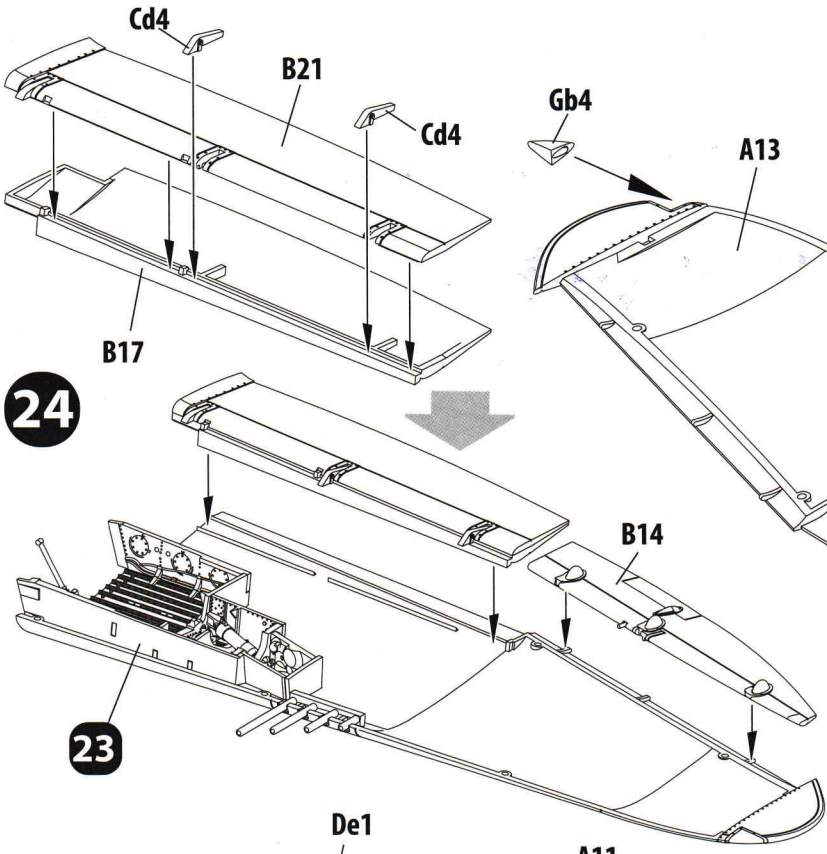

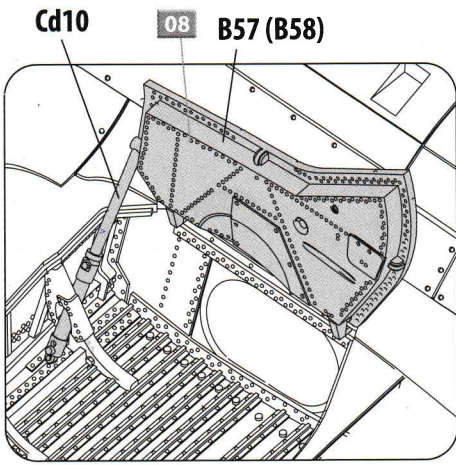
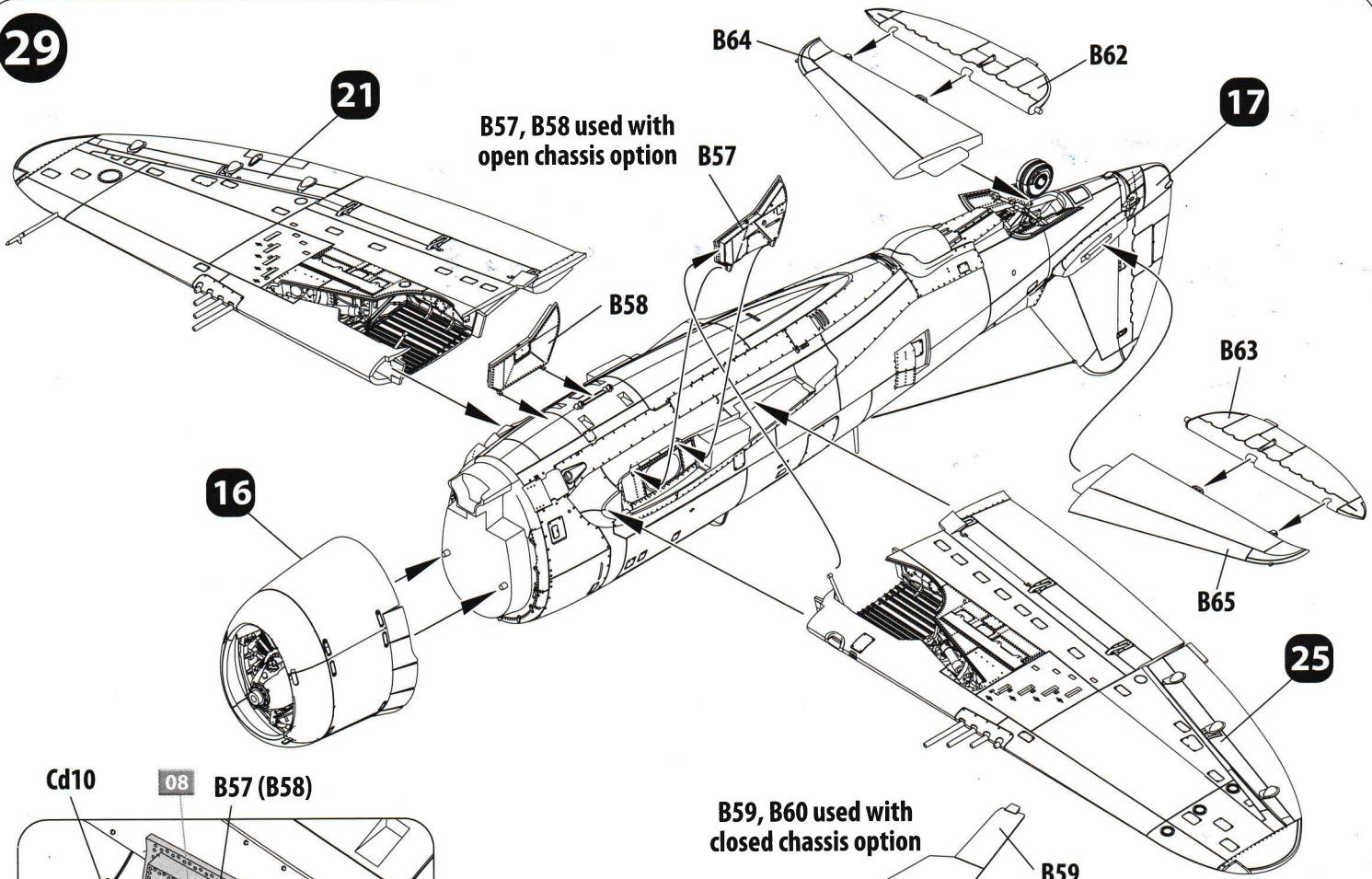

B59, B60 used with closed chassis option

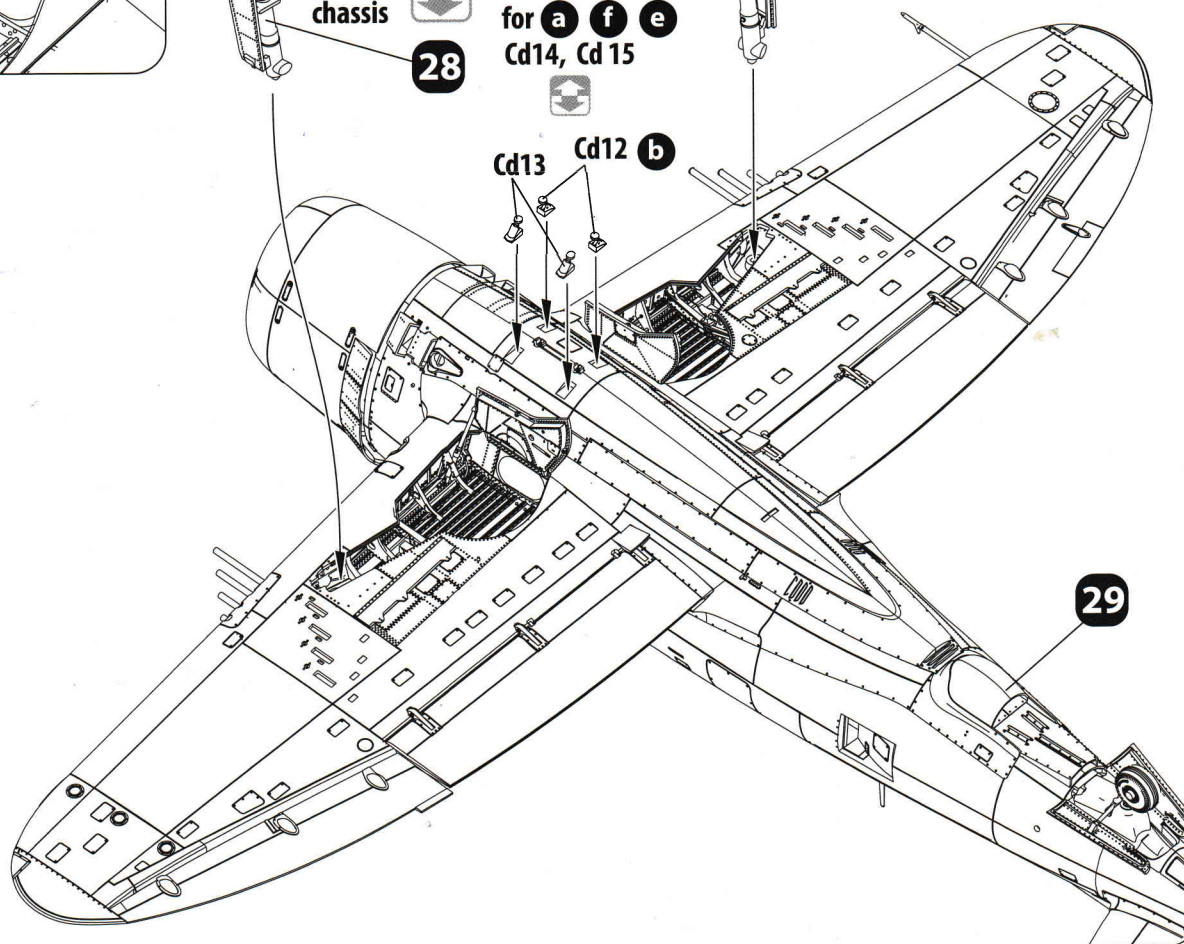
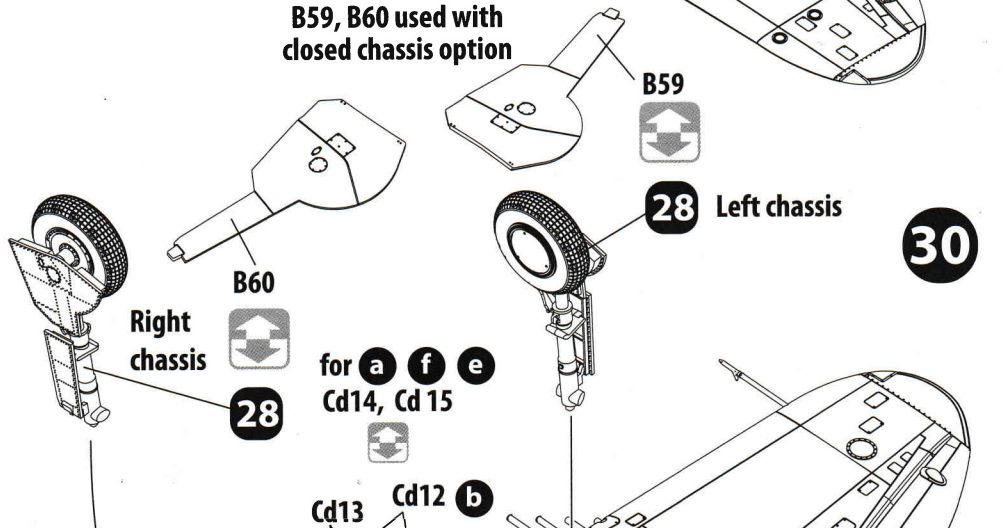

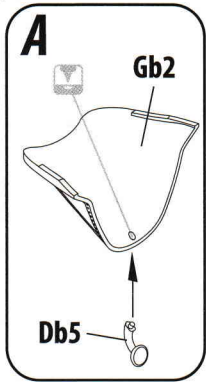

31

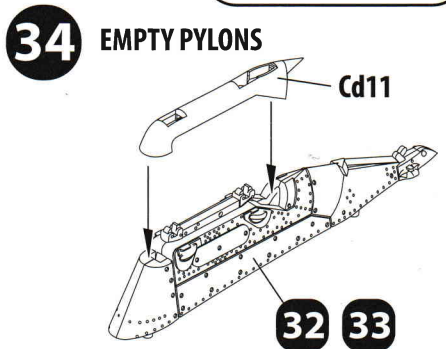
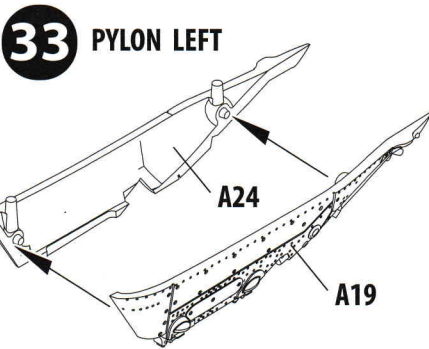
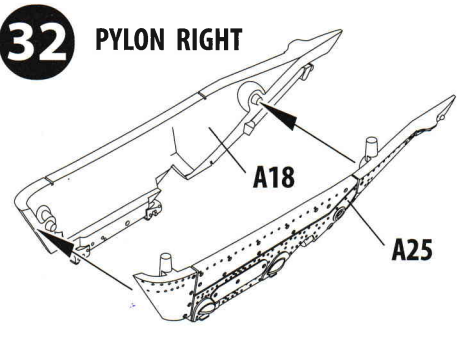
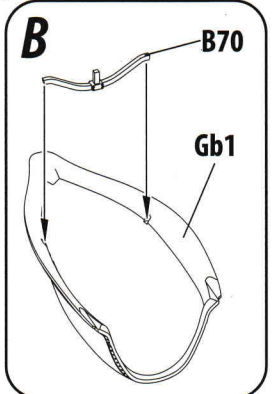
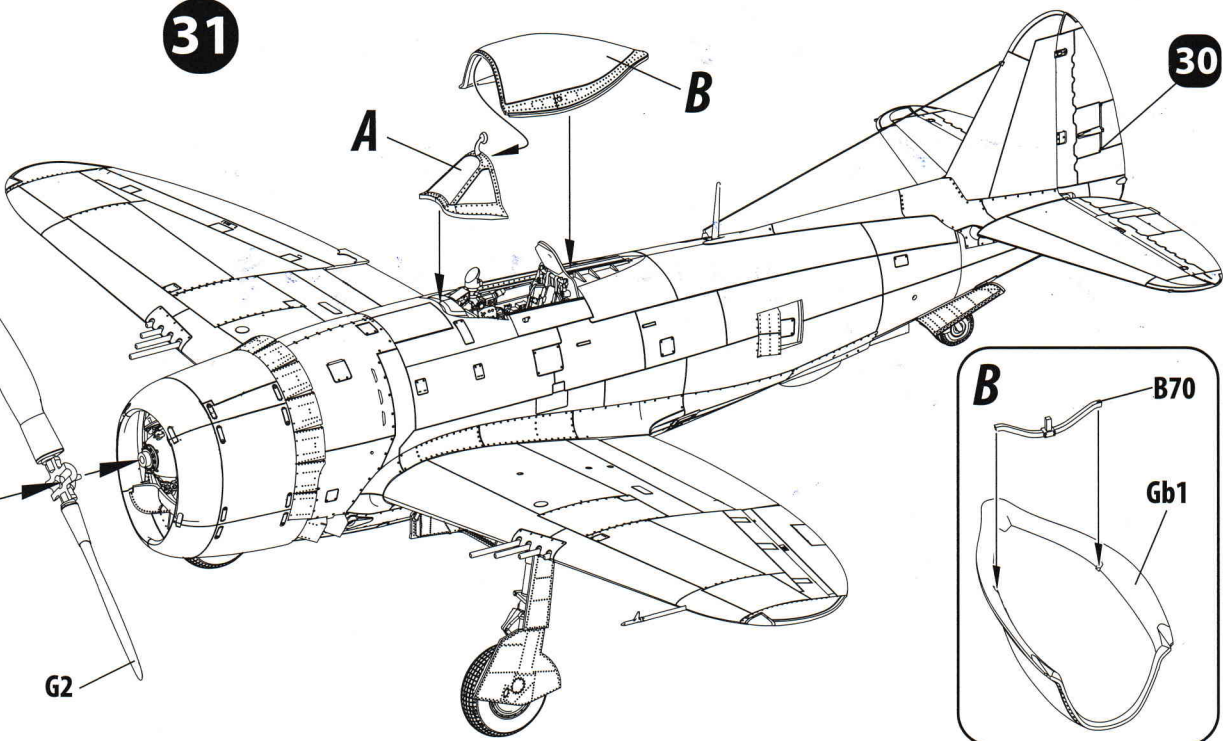

ARMAMENTS

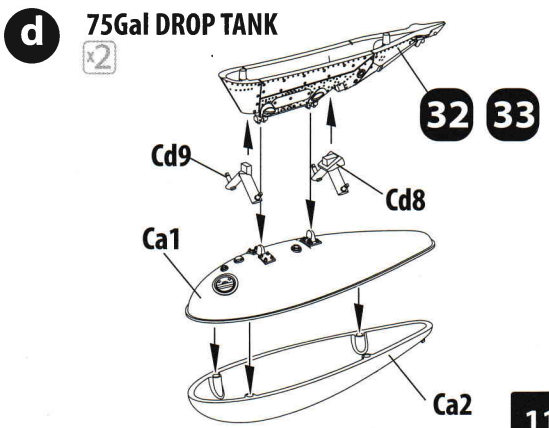
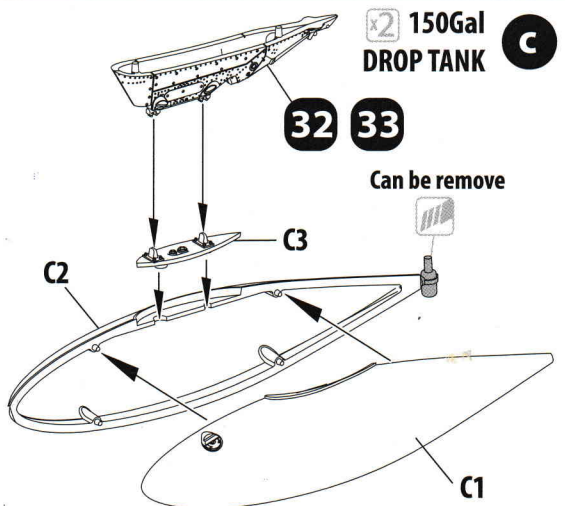
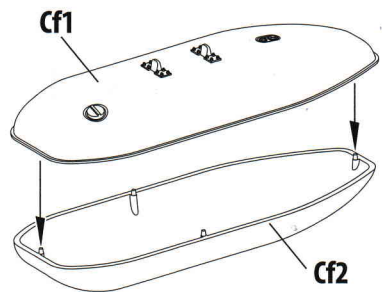
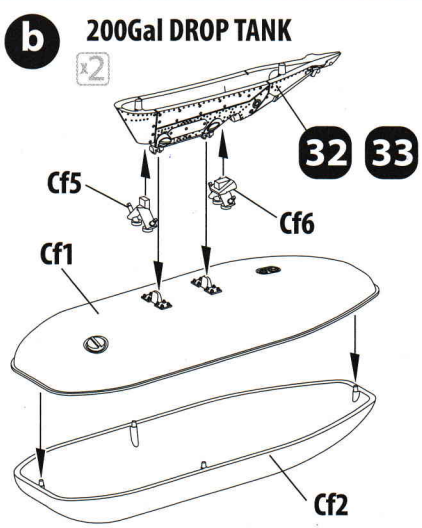
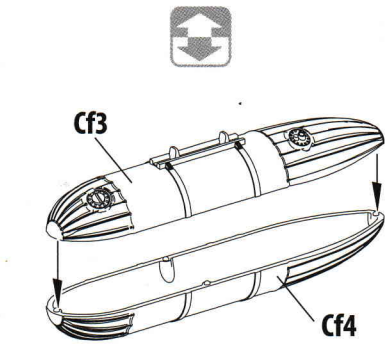
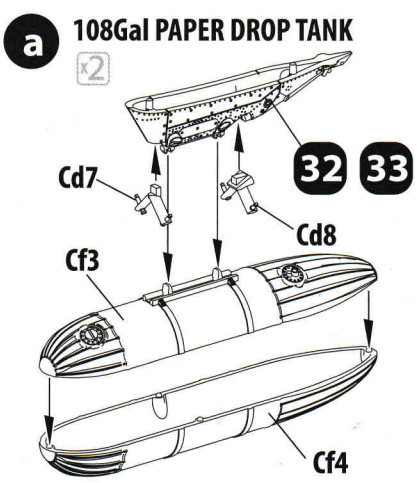

ARMAMENTS

e 2 1000lb AN-M65 BOMBS

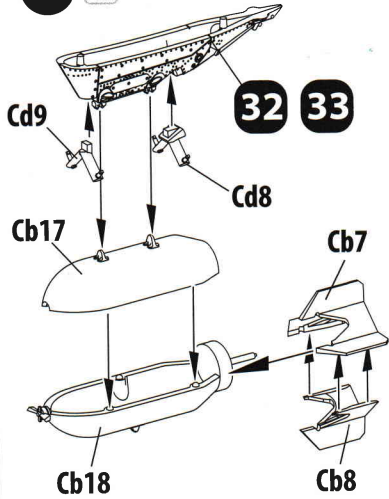

f 2 1000lb AN-M59 BOMBS

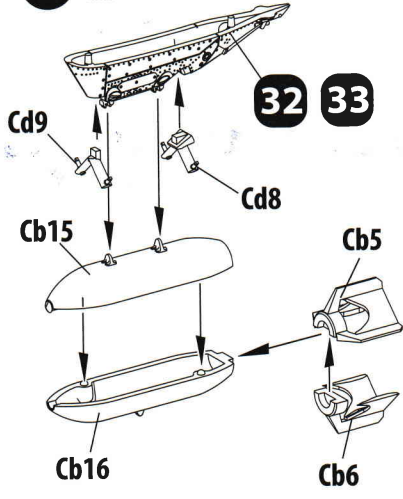

g 2 SMOKE GRENADE

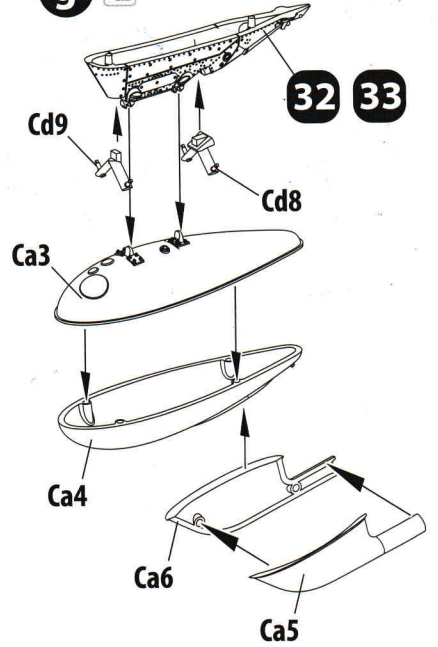

h 2 250lb AN-M57 BOMBS

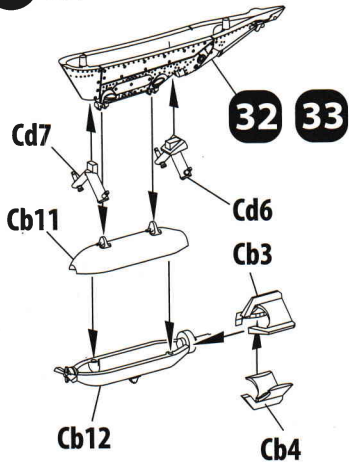

i 2 500lb AN-M58A1 BOMBS

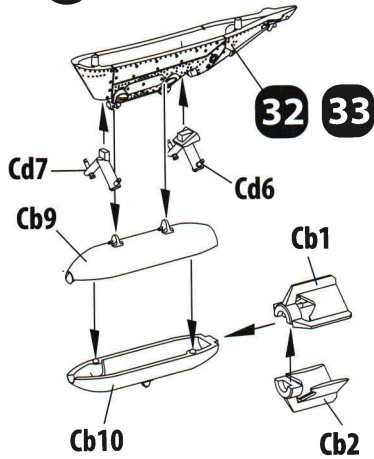

without pylons

f

e

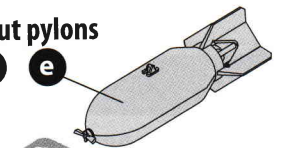

e

f

g

h

i

35

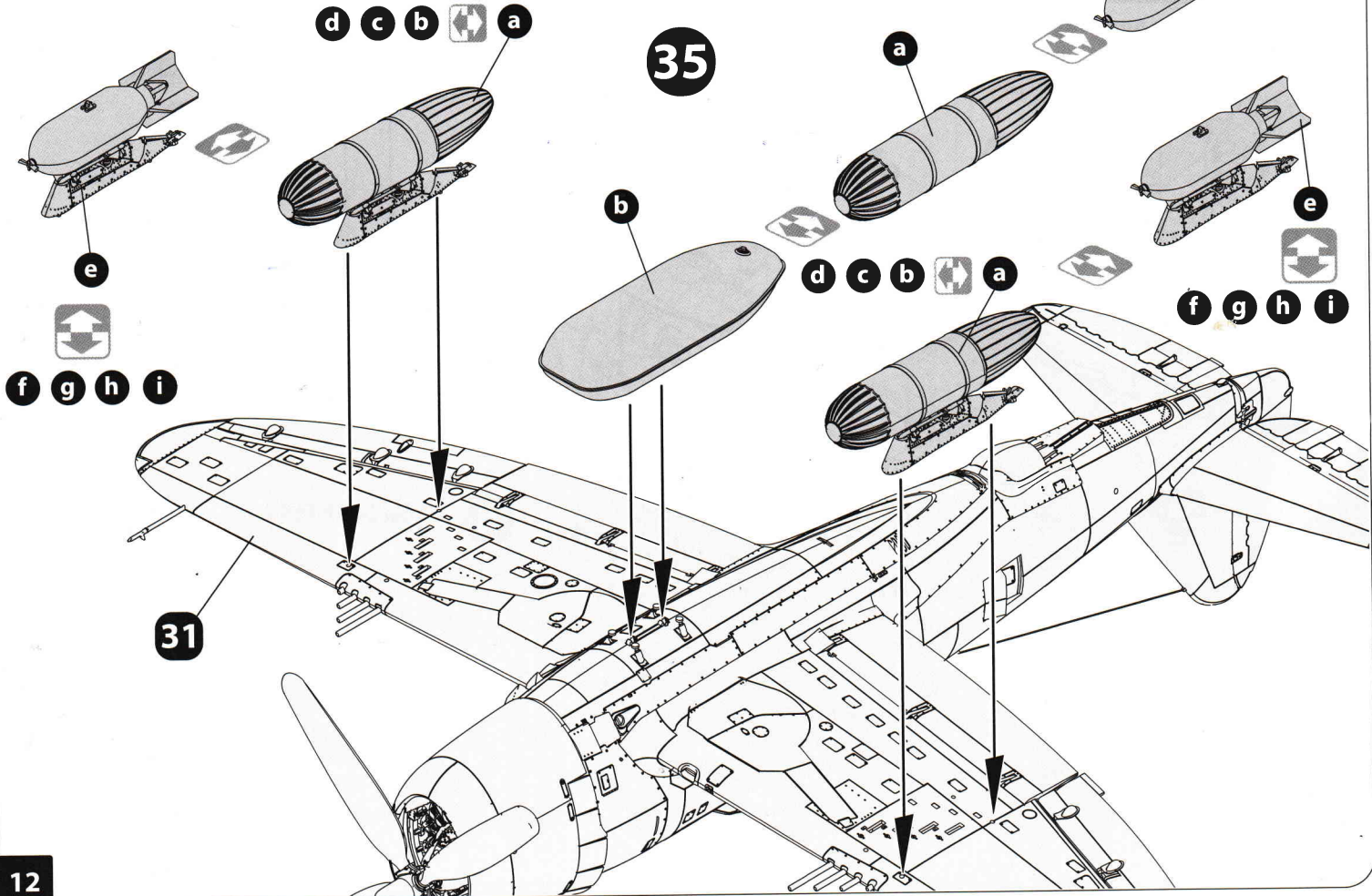

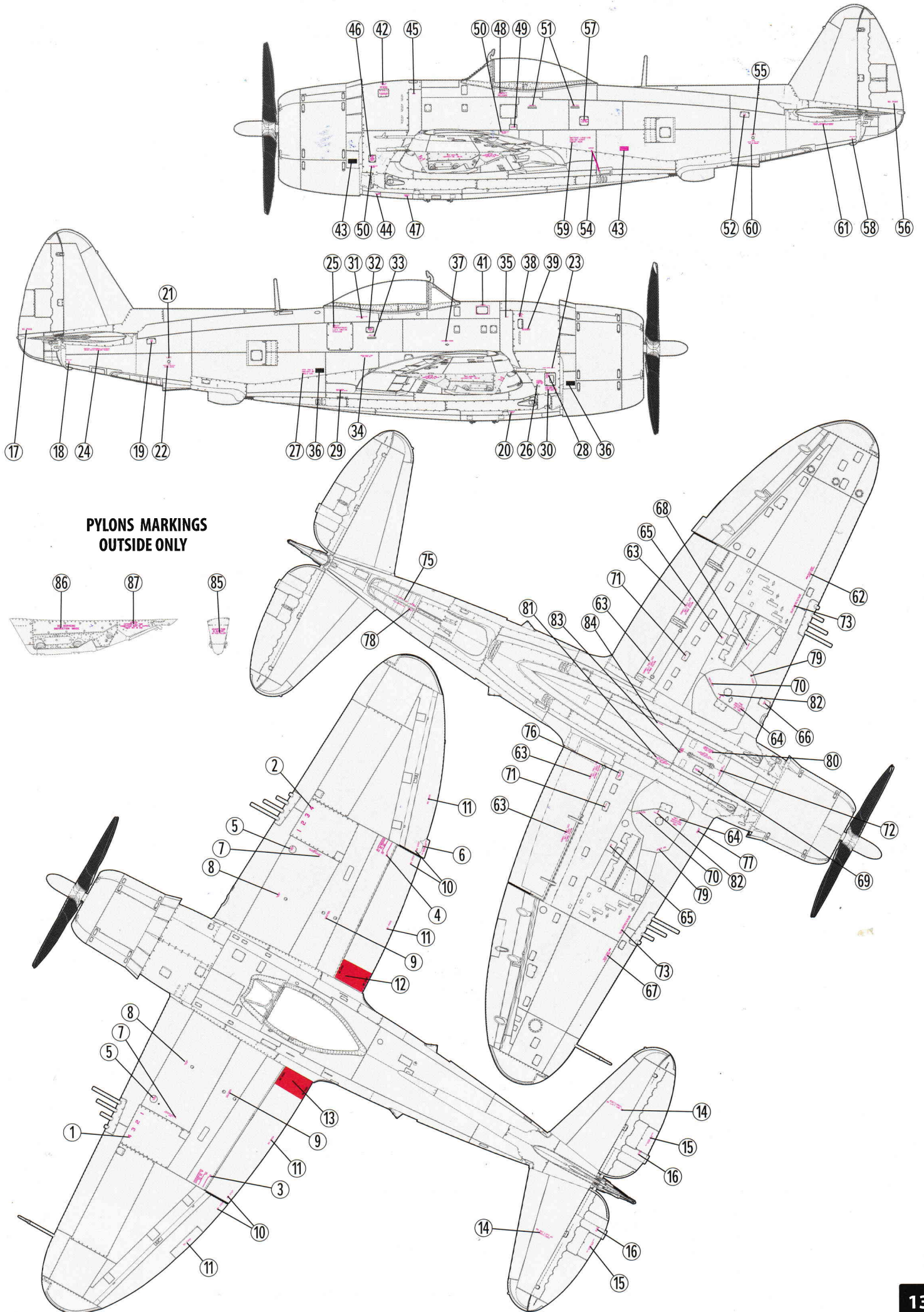

1 346th Fighter Squadron, 350th Fighter Group 12th Air Force, Italy 1945.
Pilots: Major Charles Gilbert II and 1st Lt. Homer J St. Onge

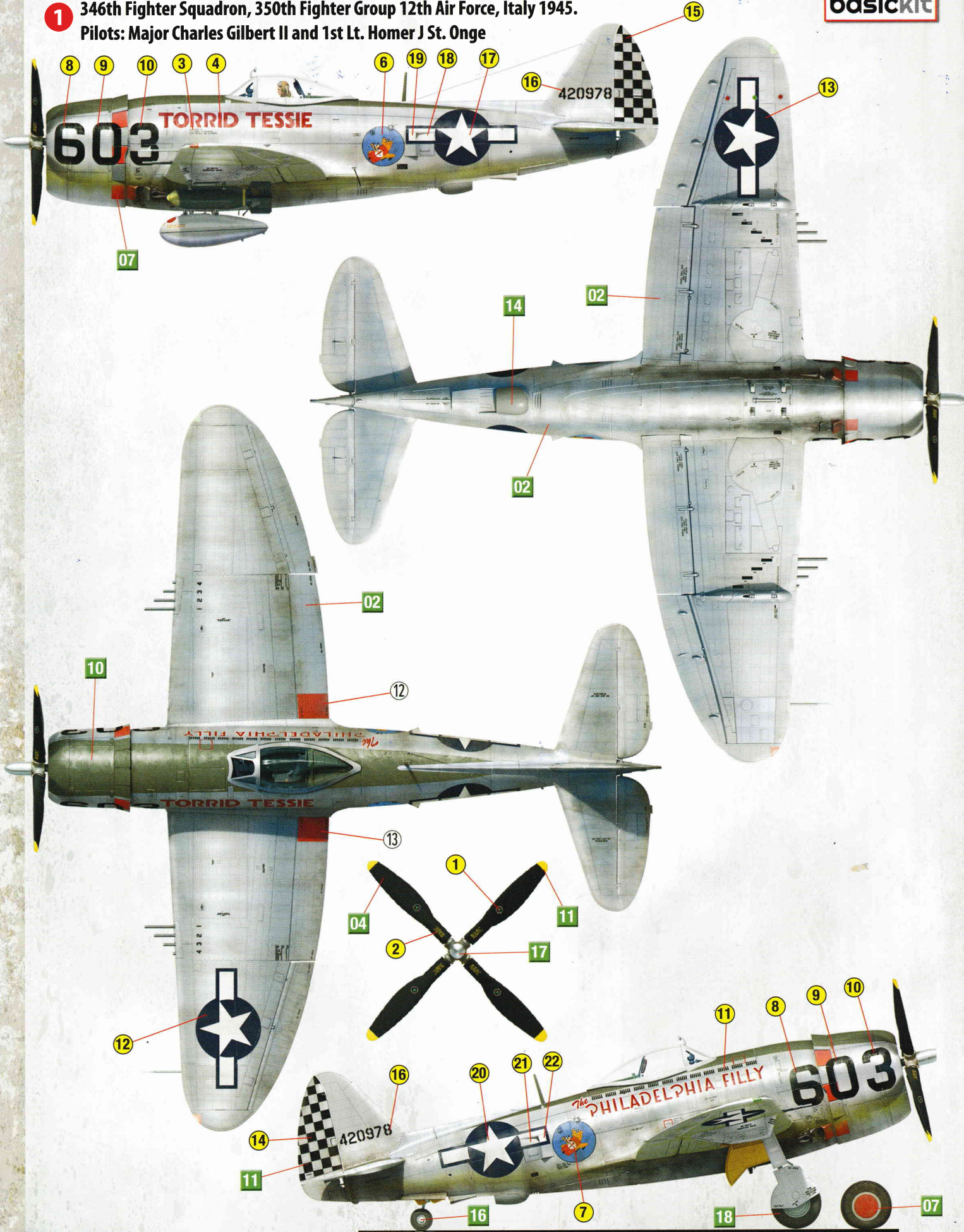

2 509th Fighter Squadron 405th Fighter Group, Spring 1945
Pilot: Col. Chester Van Etten



P-47D-30RE THUNDERBOLT ARMAMENT

250lb AN-M57 BOMBS



500lb AN-M58A1 BOMBS



1000lb AN-M59 BOMBS



1000lb AN-M65 BOMBS



108Gal PAPER DROP TANK



150Gal DROP TANK



75Gal DROP TANK

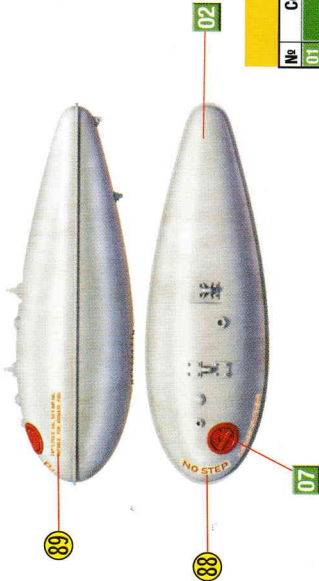

200Gal DROP TANK

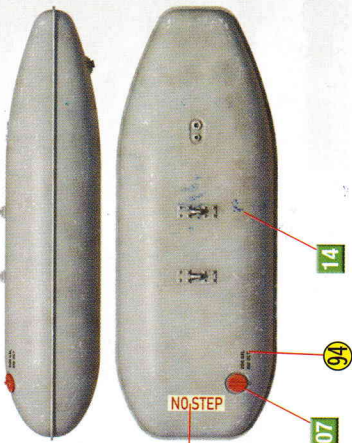

SMOKE GRENADE

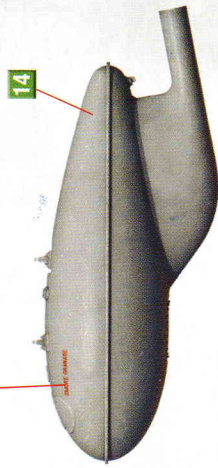

COLOR CHART

No	Color	Vallejo	Mr. Color	AK RC	Mission Models	AMMO MIG	Tamiya	Color name
01	Green	71.137	C-351	RC-262	MMP-059	A.MIG-0220	XF-05	FS 34151 (Interior Green)
02	White	71.062	C-090	RC-020	MMM-008	A.MIG-0194	XF-16	Aluminium
03	Yellow	71.326	C-321	RC-018	MMP-039	A.MIG-0057	XF-55	Yellow Grey
04	Black	71.057	C-033	RC-001	MMP-047	A.MIG-0046	XF-01	Black
05	Olive Drab	71.043	C-027	RC-262	MMP-059	A.MIG-0237	XF-04	Olive Drab
06	Brown	71.041	C-310	RC-035	MMP-033	A.MIG-0076	XF-10	Brown
07	Red	71.003	C-003	RC-006	MMP-003	A.MIG-0049	XF-07	Red
08	Blue	71.107	C-352	RC-263	MMP-067	A.MIG-0062	XF-18	FS 33481 Zinc Chromate Yellow
09	Blue	71.109	C-072	RC-297	MMP-071	A.MIG-0062	XF-18	FS 35164 Intermediate Blue
10	Green	71.325	C-518	RC-304	MMP-052	A.MIG-0240	XF-62	FS 34086 (ANA 613) Green Drab
11	Yellow	71.078	C-004	RC-007	MMP-041	A.MIG-0125	XF-03	Yellow
12	Olive Drab	71.016	C-012	RC-259	MMP-091	A.MIG-0237	XF-62	FS 23070 Dark Olive Drab
13	White	71.001	C-062	RC-004	MMP-001	A.MIG-0050	XF-02	White
14	White	71.274	C-013	RC-261	MMP-114	A.MIG-0239	XF-20	FS 36122 Neutral Gray
15	Green	71.124	C-302	RC-260	MMP-066	A.MIG-0238	XF-67	FS 34092 Medium Green
16	Green	71.046	C-603	RC-210	MMP-102	A.MIG-0911	XF-19	Light Grey
17	Black	71.072	C-028	AK-476	MMM-002	A.MIG-0191	XF-56	Steel
18	Black	71.251	C-137	RC-022	MMP-040	A.MIG-0033	XF-85	Tire Black