

Sd.Kfz.251/3 Ausf.C

Mittlere Funkpanzerwagen

Prior to WWII, the German Army was in need of a new cross-country personnel carrier to accompany tank columns for their future mobilized combat tactics. This vehicle would need to convey an infantry squadron, and possess adequate armor protection as well as firepower. After evaluating the quantitative need for this vehicle in their planned mobilized Army and the German industrial capability of that time, the German Army officials had selected the Sd.Kfz.11 3t halftrack as the basis for this project.

The Sd.Kfz.251/1 Ausf.A made its debut in 1937. It retained the chassis and engine of the original Sd.Kfz.11, with inclining armor plates added onto the chassis, with two MG34 machine guns mounted onto the armored hull. Fuel capacity was also increased from 110l. to 160l.. In order to reduce its height, the steering wheel was modified to a declining position. In addition to a crew of two, it was able to carry 10 infantrymen. Other than serving as an armored personnel carrier, the Sd.Kfz.251/1 served in diverse roles, and was produced or modified into many variants.

On the later Ausf.B adapted strengthen hull structure and an armor shield for the machine gun mount. Since 1940 the Sd. Kfz 251/1 Ausf C model entered service with German Army, this configuration is simplest type to the early A & B models, it consisted of one piece armor shield, also in the both sides of engine intakes.

The early C model were bolted onto the body, but all later model were spot welded, which manufactured until 1943, had been replaced by more simplistic D model.

Sd.Kfz.251/3 is a variation of the series, based on the personnel carrier Sd.Kfz.251/1, equipped with wireless radio communication devices. Various wireless devices were installed according to difference roles. Sd.Kfz.251/3 was widely serviced in the panzer, artillery and air force units.

第二次大戦に先立ってドイツ陸軍は将来の機械化戦術のために、戦車部隊に随伴できるだけの不整地走破能力を持った新たな兵員輸送車の必要に迫られた。この車輛には、歩兵部隊を輸送する能力とともに、十分な火力と装甲を持つことが求められた。計画された機械化部隊が求める必要条件と、当時のドイツ産業の生産能力とを勘案した結果、ドイツ陸軍の当局者は、この新型兵員輸送車のベースとして、Sd.Kfz.11 3トンハーフトラックを選択したのだった。

Sd.Kfz.251/1のA型は、1937年に登場した。シャーシとエンジンはオリジナルのSd.Kfz.11のままに、傾斜した装甲板と2丁のMG34機関銃を装備し、乗員2名に加え、10名の歩兵を載せることができた。燃料搭載量は、110リットルから160リットルに増やされており、また、車高を抑えるため、操縦ハンドルは傾斜した状態で装着されていた。Sd.Kfz.251は、装甲兵員輸送車としてだけでなくさまざまな役割は傾斜した状態で装着されていた。Sd.Kfz.251は、装甲兵員輸送車としてだけでなくさまざまな役割に用いられ、多くのバリエーションタイプが製造された。

その後のB型とC型では、装甲が強化されるとともに、機関銃に防盾が追加された。Sd.Kfz.251/1 C型は、1940年から配備が始まり、その形状は初期のA型、B型よりもシンプルなものだった。C型の初期生産型は車体をリベット止めしていたが、後期型ではスポット溶接が施され、さらにシンプルな形状を持つD型が登場する1943年まで生産が続けられた。

Sd.Kfz.251/3は、兵員輸送車であるSd.Kfz.251/1をベースとしたシリーズのバリエーションの一つであり、無線通信機器を搭載していた。様々な種類の無線装置が存在し、それらは目的・役割に応じて搭載された。Sd.Kfz.251/3は、機甲部隊や砲兵部隊、また空軍部隊などで、幅広く用いられたのだった。

早在二次大戰爆發前,德國陸軍便發覺極需一種具有足夠的越野能力,能夠伴隨戰車運動的裝甲運輸車輛,除了能夠搭載一個步兵班的乘員外還必須具備適當的火力與防護力,在這些前題下,同時綜合評估了德國當時的工業能力,Sd.Kfz. 11 3t牽引車雀屏中選被擇定成為未來運兵車的雛型。1937年Sd.Kfz. 251/1 Ausf. A登場,車身四周覆以傾斜裝甲,兩側有可開閉的射擊槍眼,油箱的容量比起3t牽引車也加以提昇,車前後各配置一挺MG 34機槍,為了降低車身的高度,駕駛的方向盤被修改的方向盤被修改成向下方傾斜,除了車內的兩名乘員外,還能夠搭載10名步兵,同時還保留修改的餘地。

稍晚出現的Ausf. B與Ausf. C在車前方的機槍上安裝了防盾,在1940年登場的C型,車體前方不再如A、B型構造之繁複,而改由一整塊裝甲所構成,引擎室兩側之吸氣孔,也增加了裝甲覆蓋,早期生產的部分車體採用鉚釘接合,後期則全為焊接構成,C型的生產期至1943年為止,爾後由結構更為簡潔的D型所取代。在供兵員輸送的Sd.Kfz.251/1 Ausf.C基礎上增設了無線電通訊設備使之成為Sd.Kf.251/3,因應著不同的聯絡用途而配備相異的無線器材,活躍於裝甲、砲兵及空軍等單位中。

Illustration:圖示說明



Method For Applying Decals:

1. Clean Model Surface With Wet Cloth.
2. Cut Out Of Decal Sheet And Dip Them In Water For 15 Seconds.
3. Place it on proper position on model.
4. Slide off base paper leaving decals On Model With Wet Finger Tip.
5. Move Decals To Exact Position, Push Out Excess Water Under Decal With Soft Cotton Cloth.
6. When Decals Get Dry Then Complete.

水貼紙使用說明:

1. 將模型表面擦乾淨
2. 將貼紙剪下泡入清水中約15秒
3. 將泡濕之貼紙取出置於欲貼處旁
4. 用指尖輕推貼紙表面使其滑出底紙
5. 將貼紙調整至適當位置並輕擦拭水份
6. 待其自然乾燥後即完成

Color list: 塗料表

Color	Brand	GSI Creos (Gunze Sangyo)			Humbrol	Revell	Life Color
		Hobby Color	Mr. Color	Mr. Color Spray			
German gray	德國灰	H-32	C-40	J-40	92	79	UA073
Wood brown	木棕	H-37	C-43	J-43	34	05	UA085/ UA125
Dark green	深綠	H-36/H-405	C-70	J-70	149	363	UA083
Dark yellow	深黃	H-79	C-39	J-39	83	16	UA081
Steel	黑鐵	H-18	C-28	J-28	53	91	LC76
Tire black	輪胎黑	H-77	C-137		85	302	LC02
Red brown	紅褐	H-47	C-41	J-44	160	383	UA082
Metallic green	亮綠	H-89	C-77	J-77	131	364	
Red	紅	H-3	C-3	J-3	19	31	LC56
Flat white	消光白	H-11	C-62	J-62	34	05	LC01

AFV CLUB Sd.Kfz.251 track set (workable)

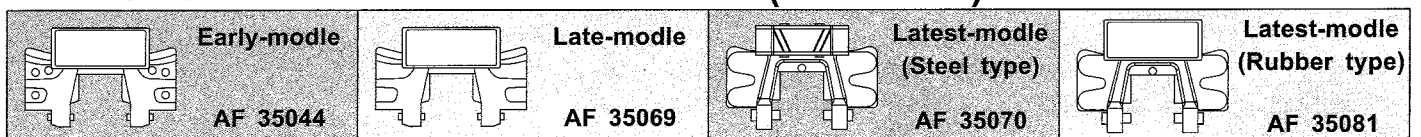

1

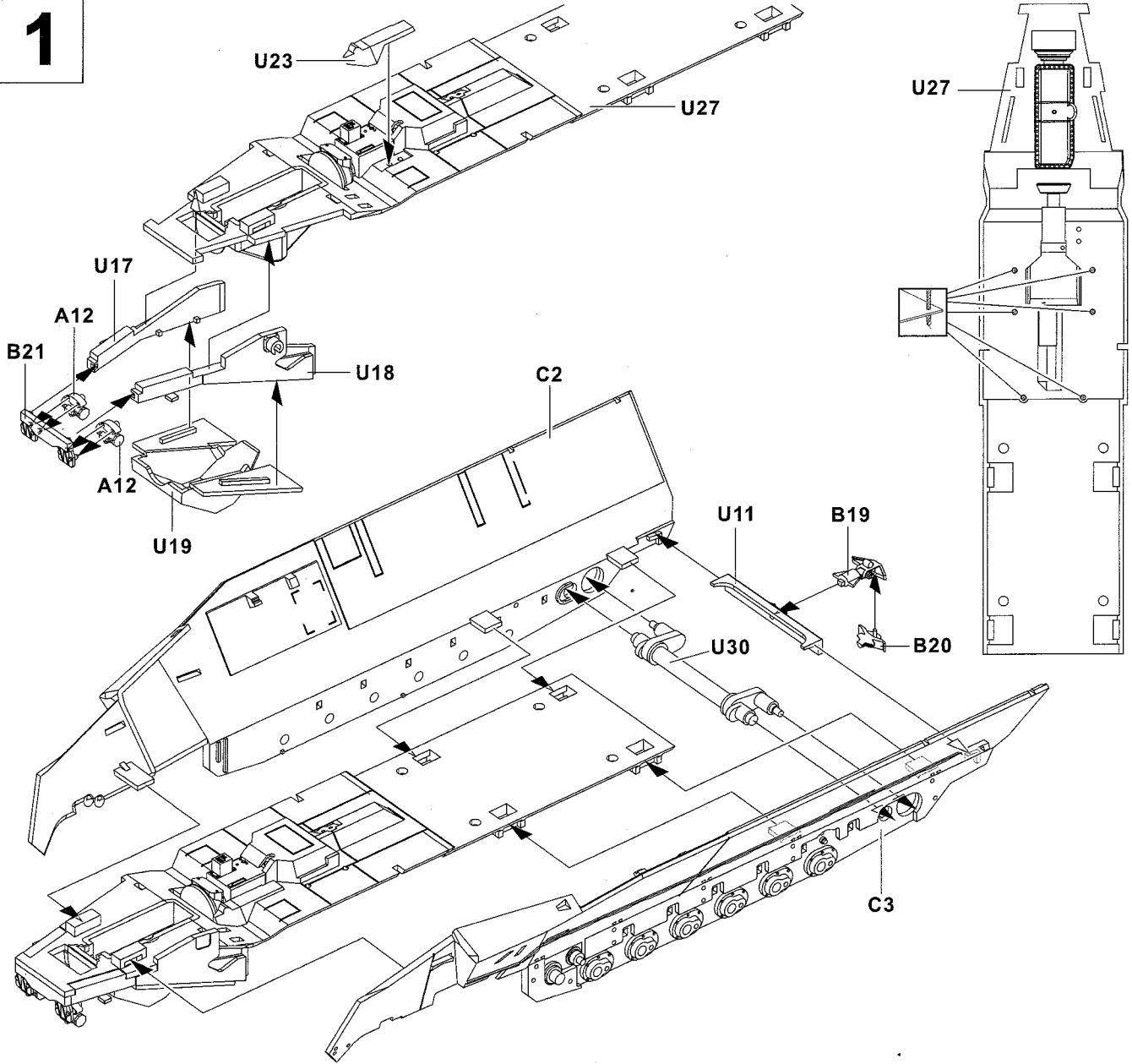

2

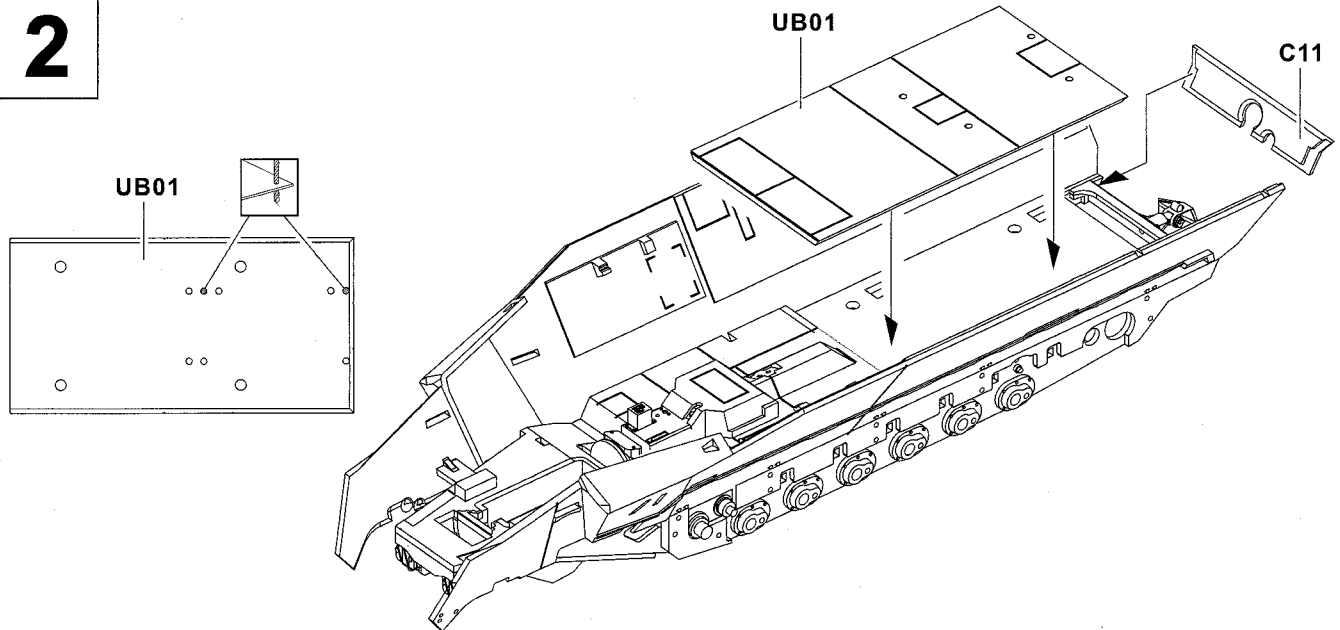

3

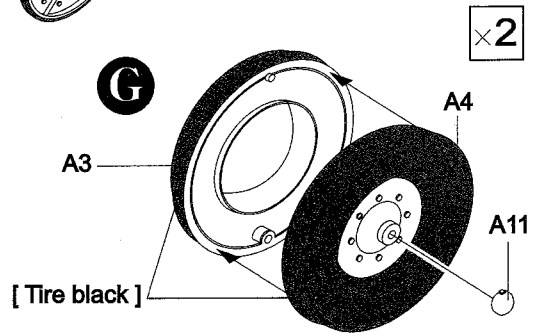
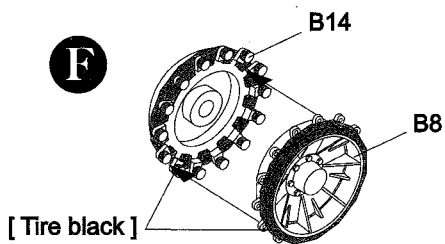
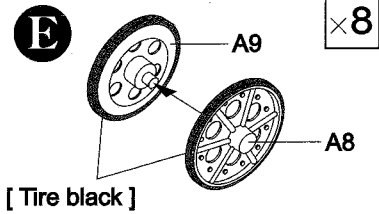
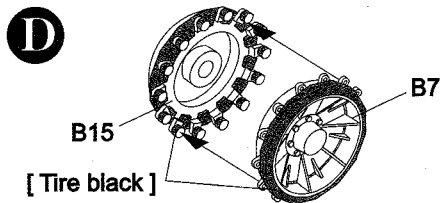

4

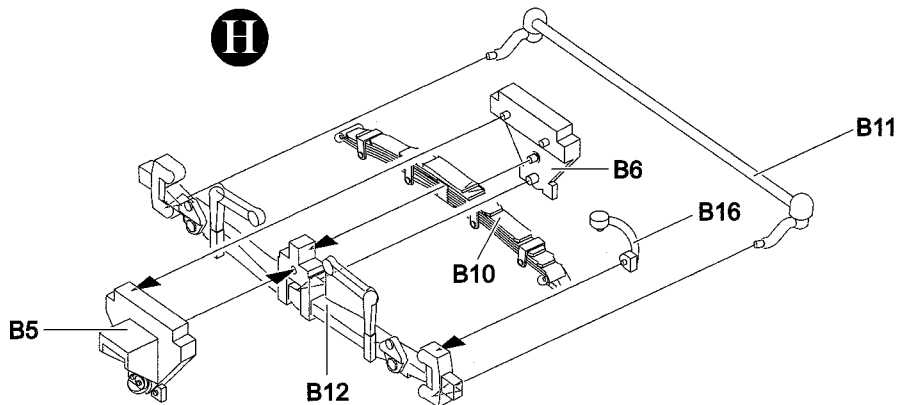

5

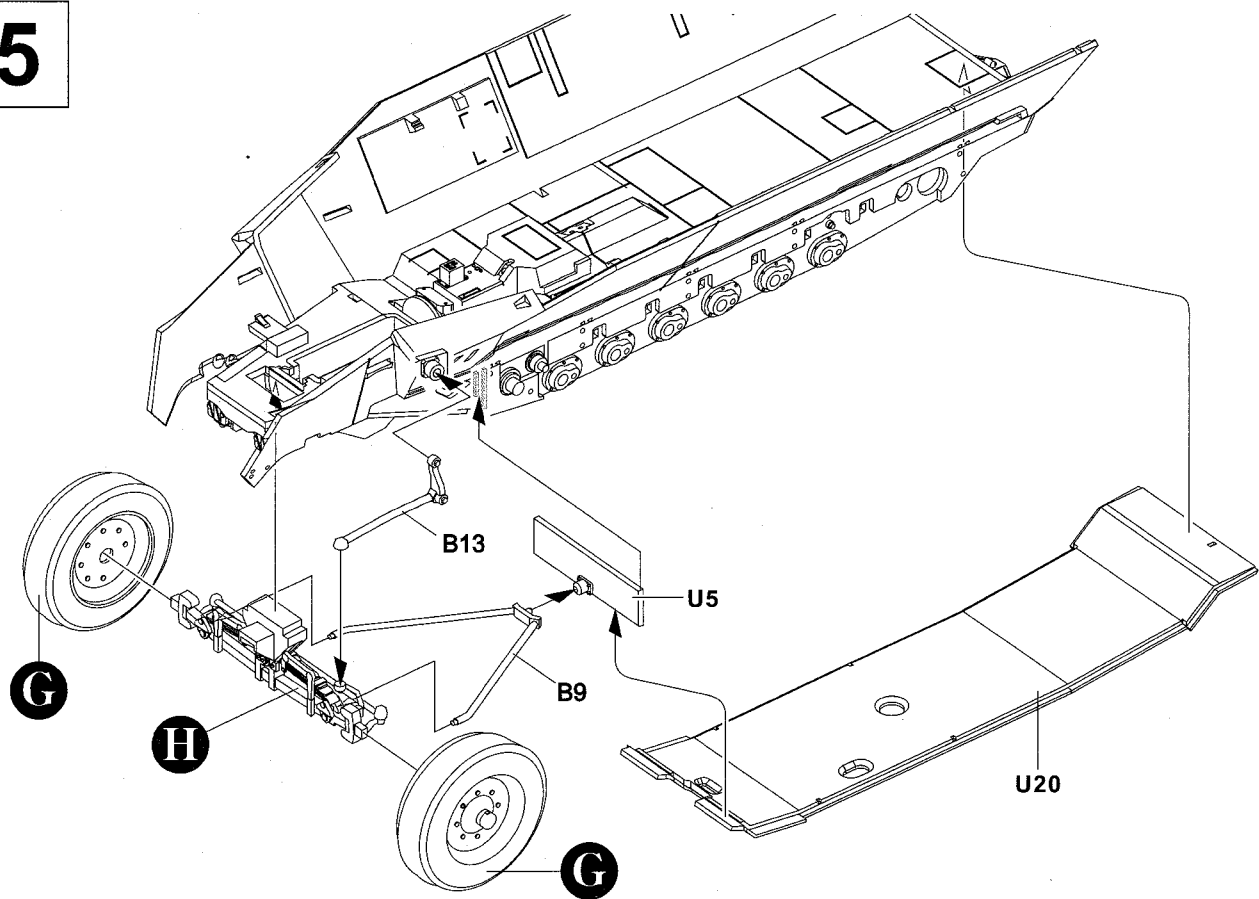

6

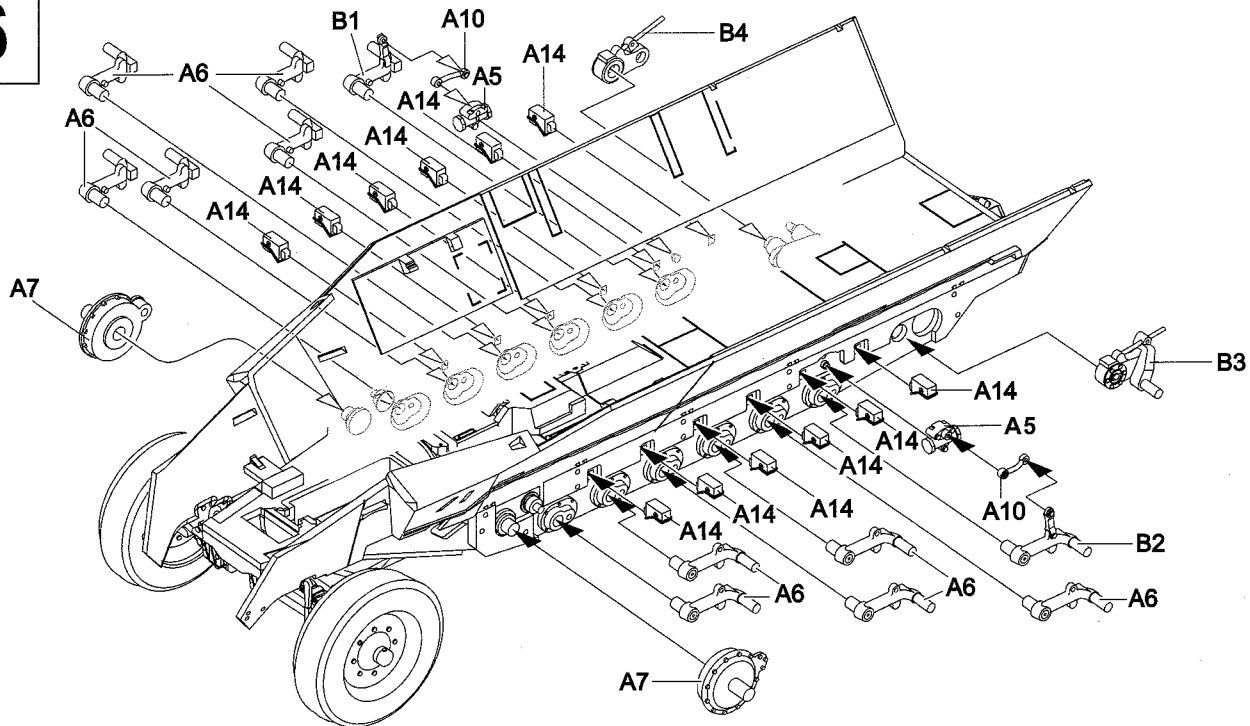

7

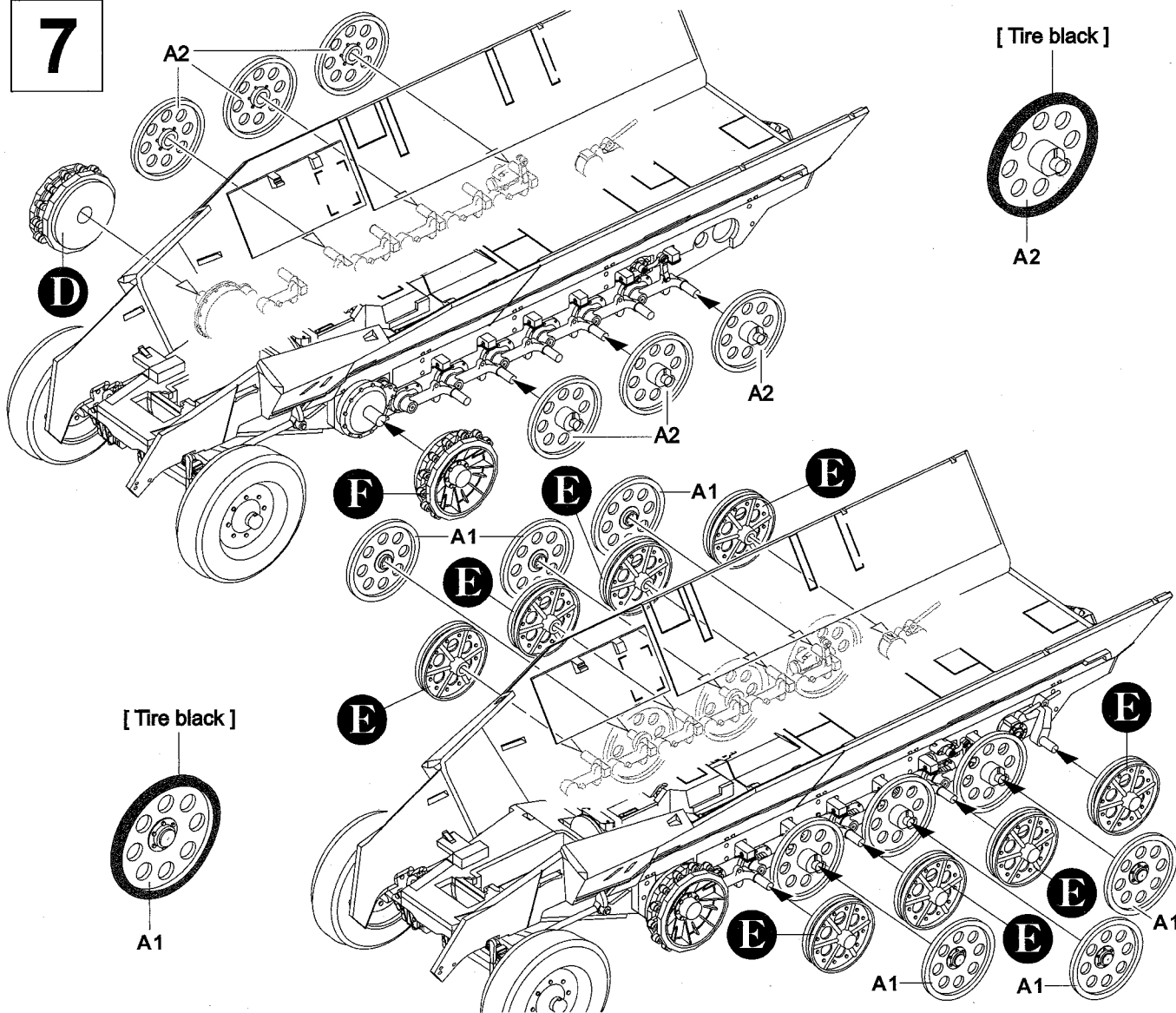

8

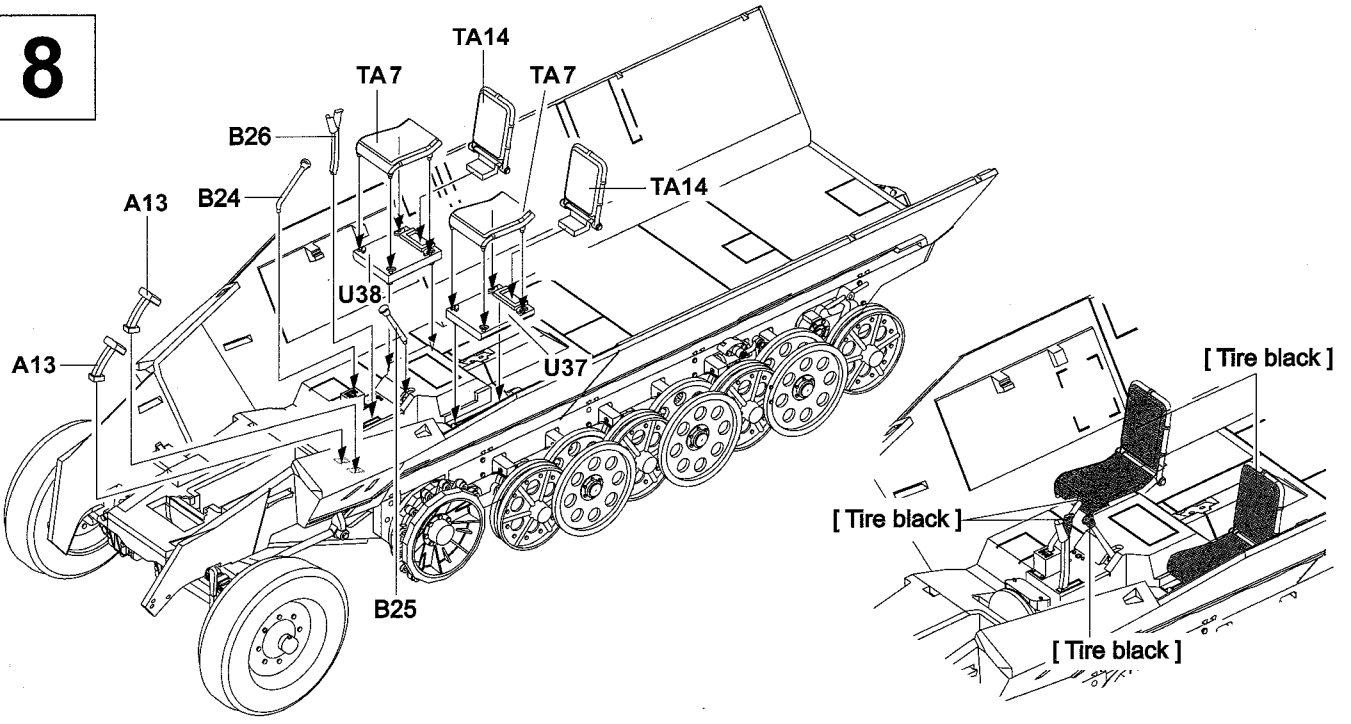

9

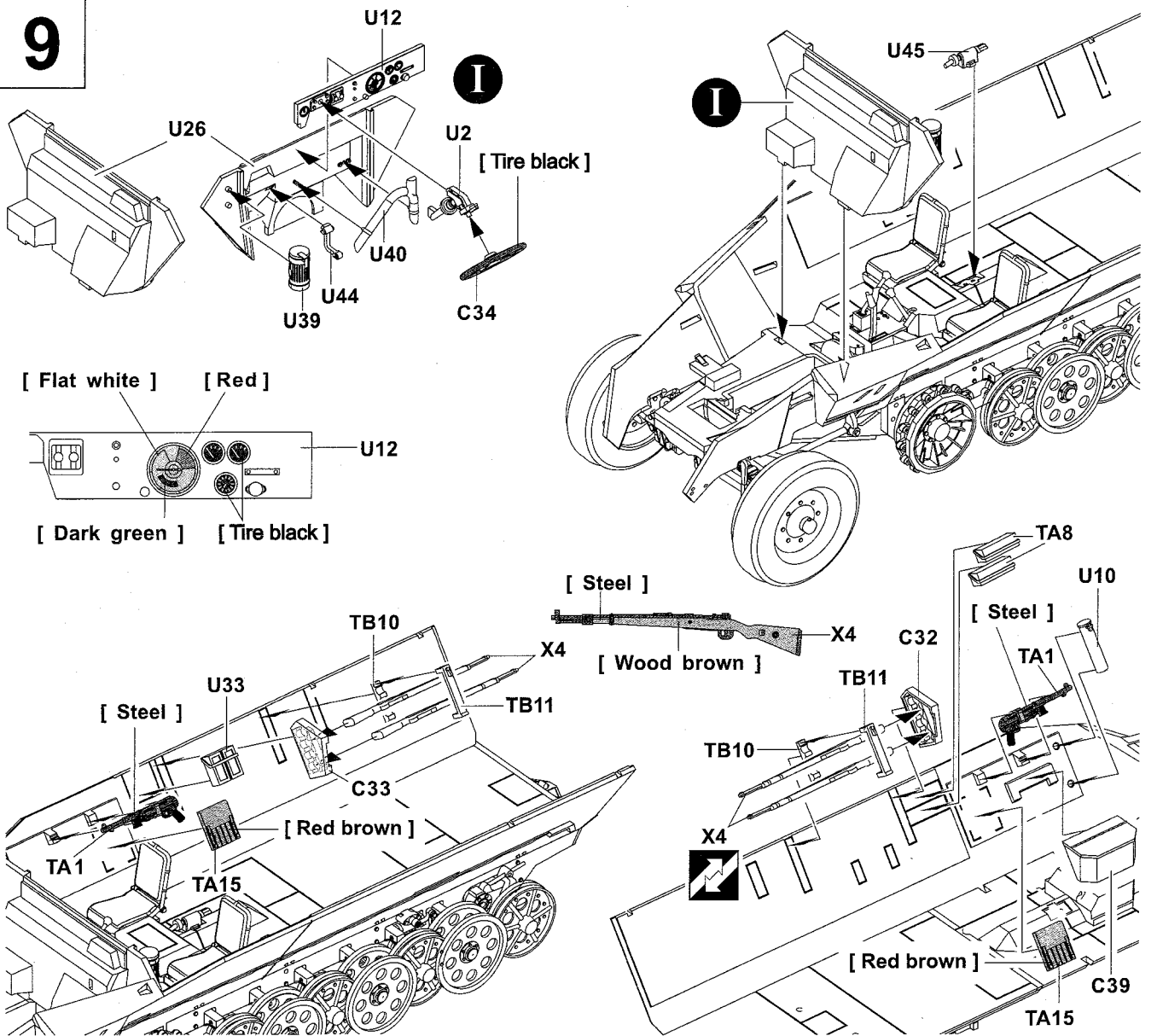

10

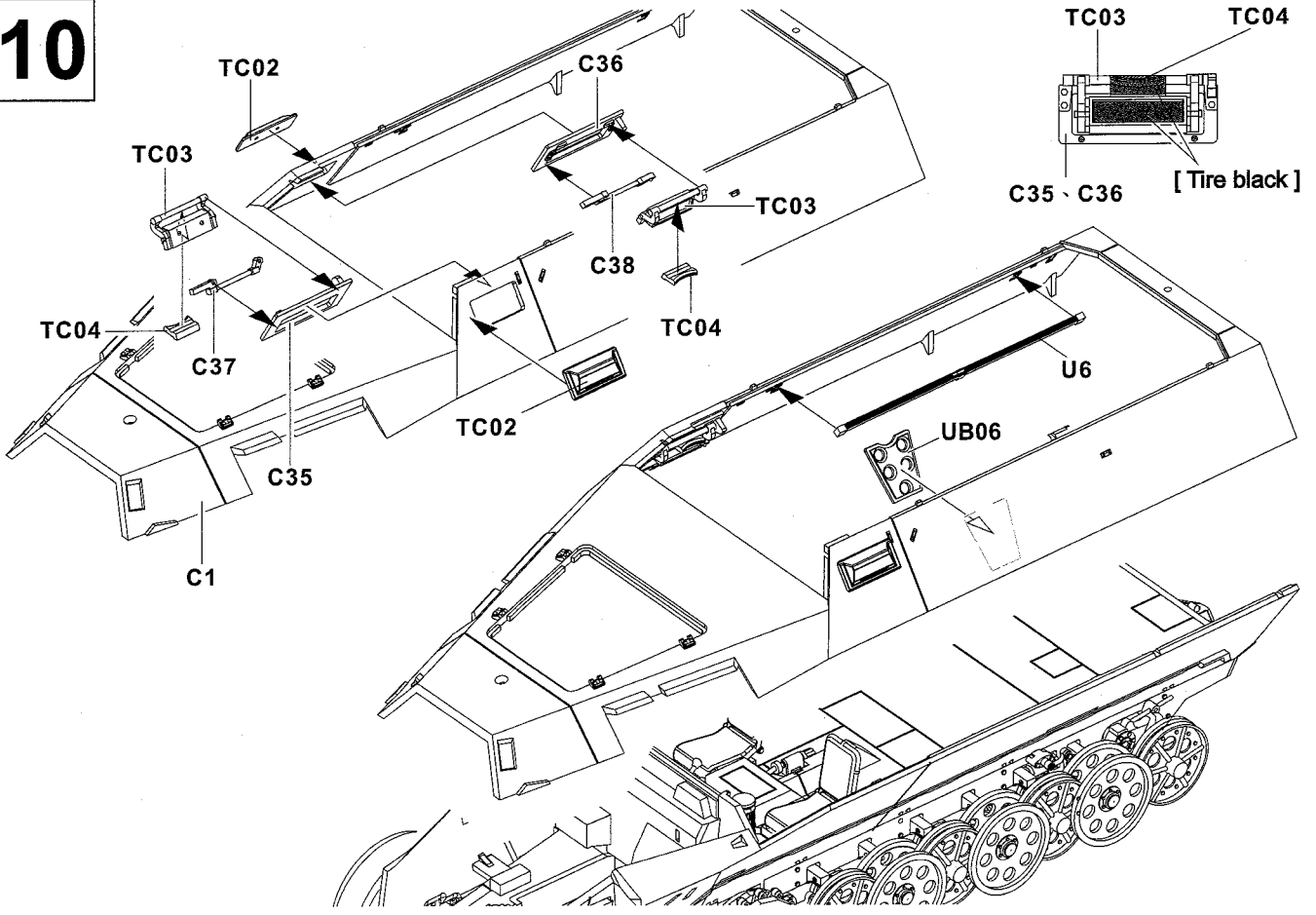

11

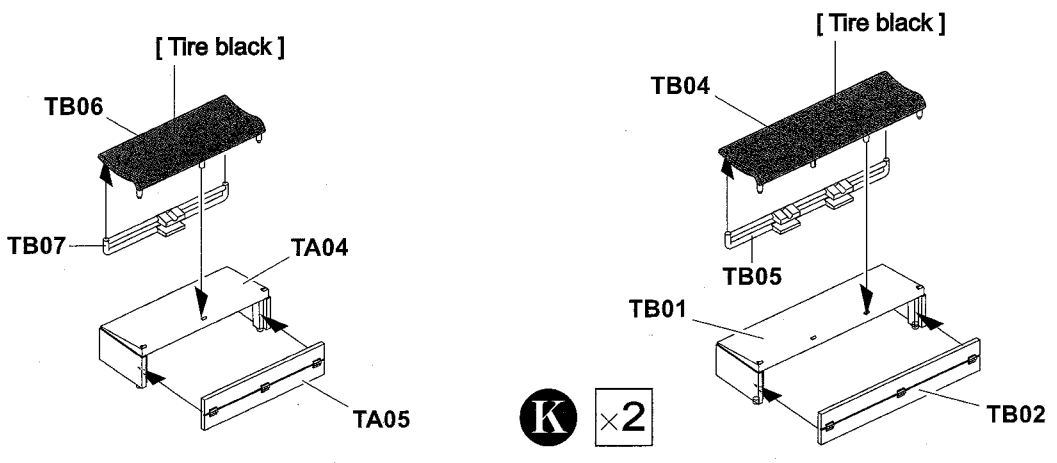

12

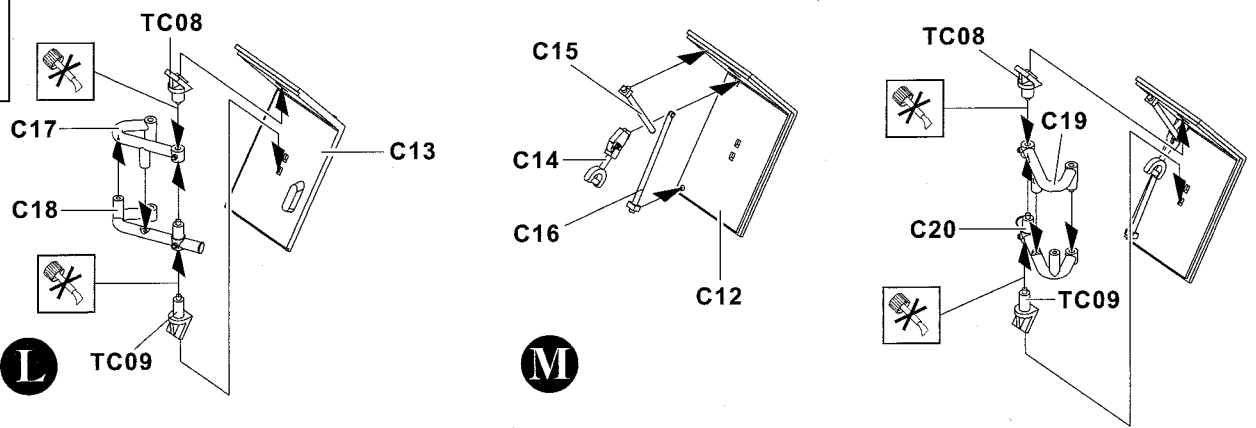

13

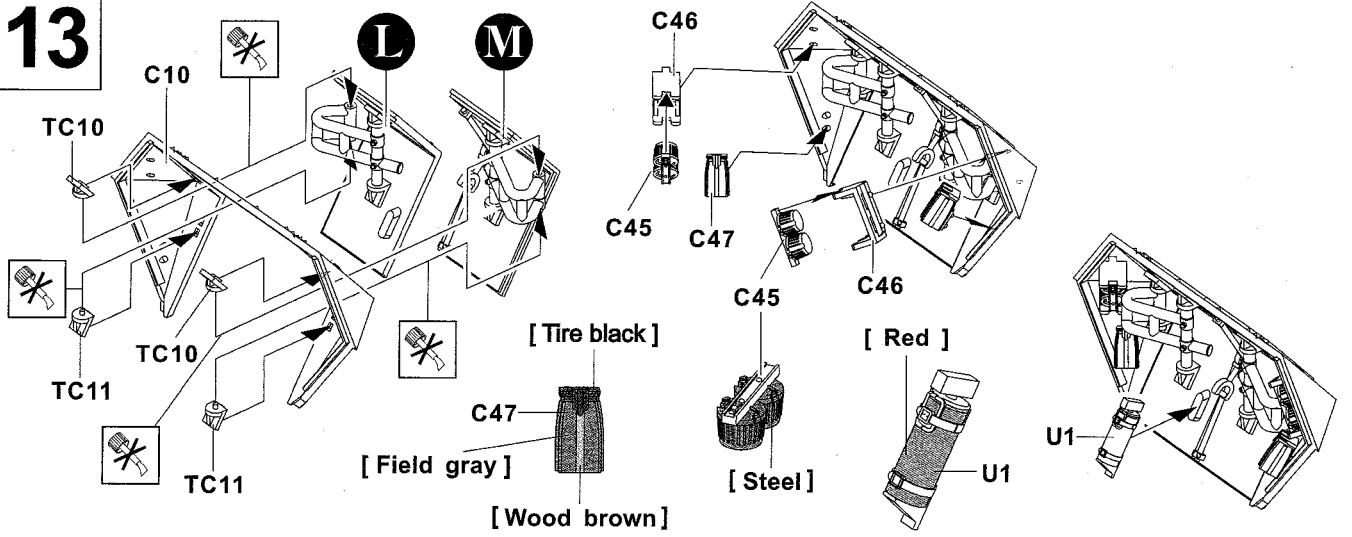

14

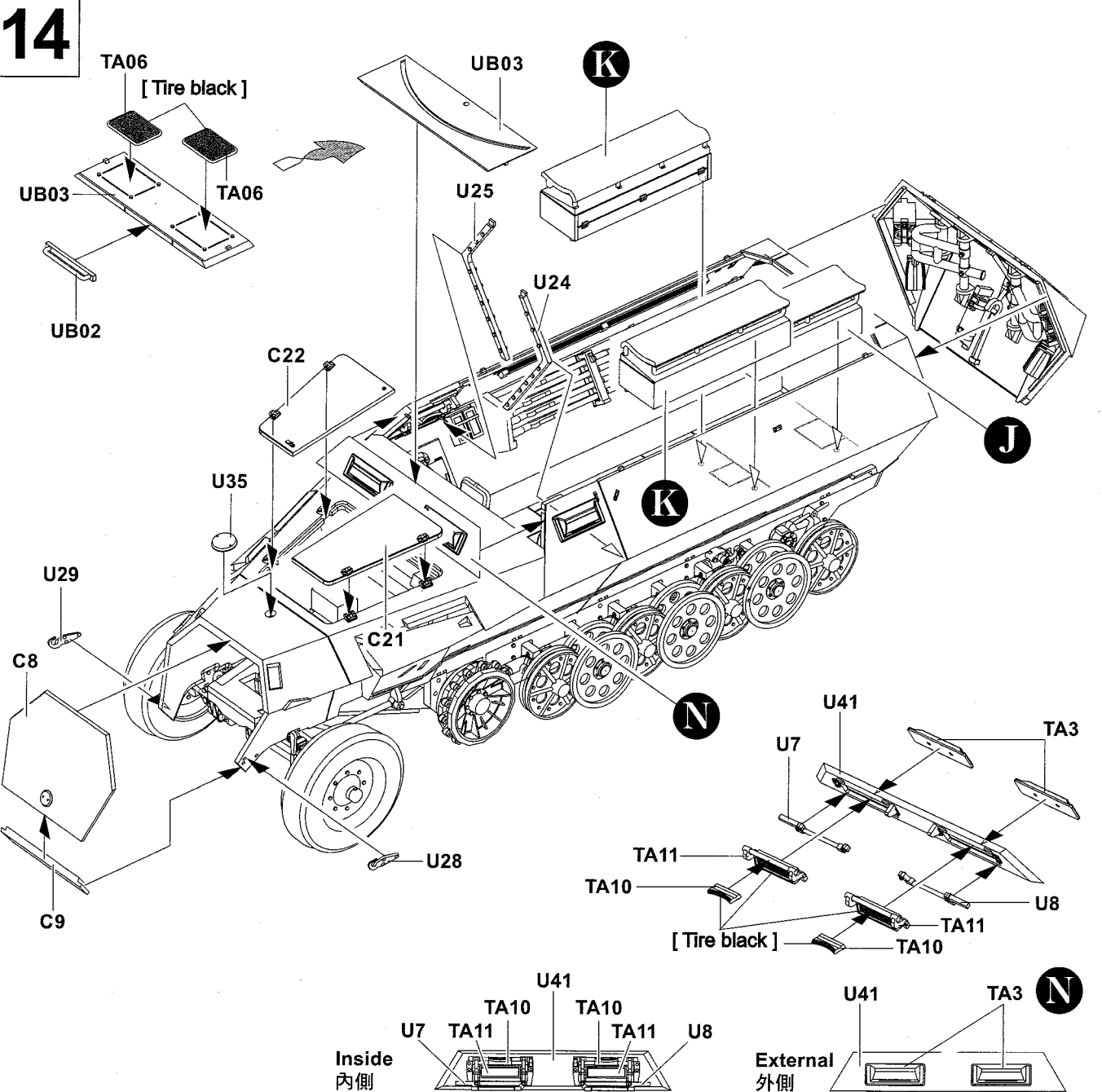

15

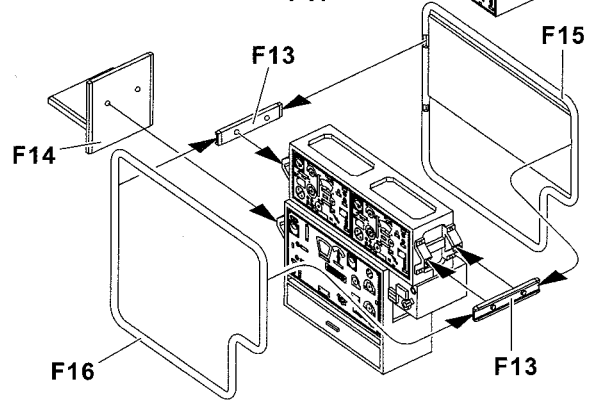
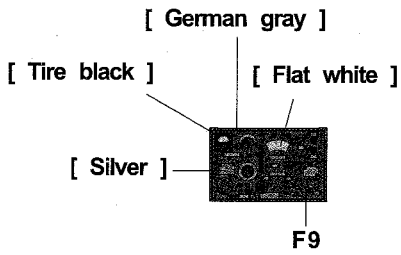
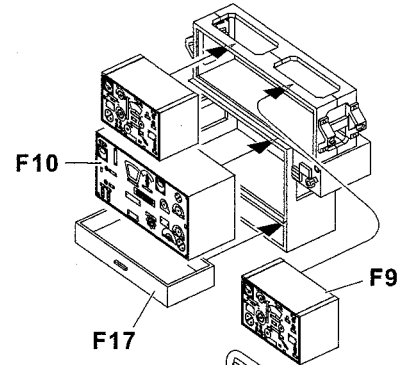
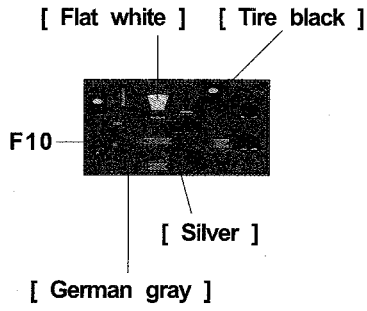
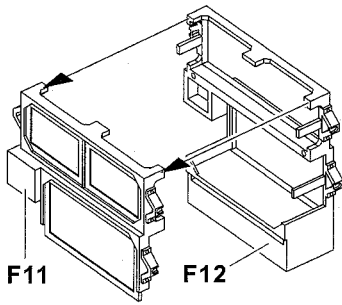

16

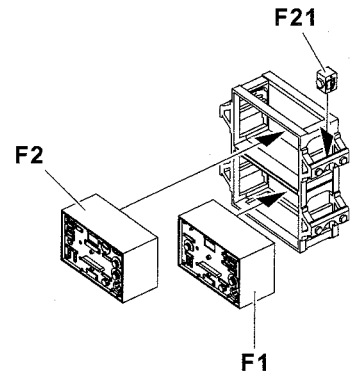
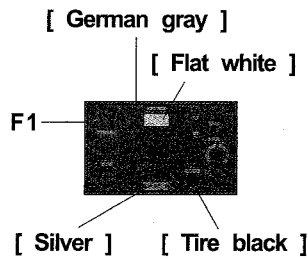
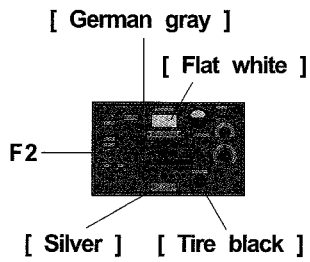
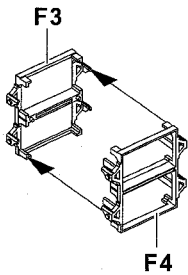

17

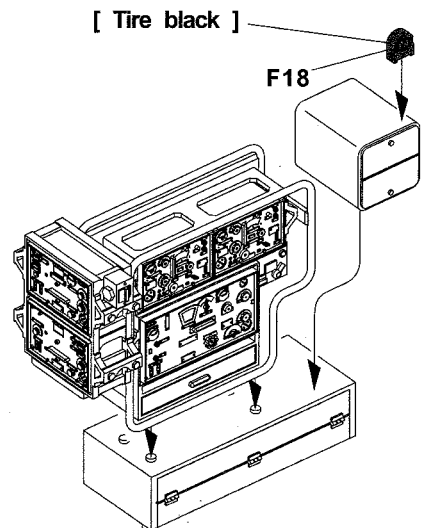
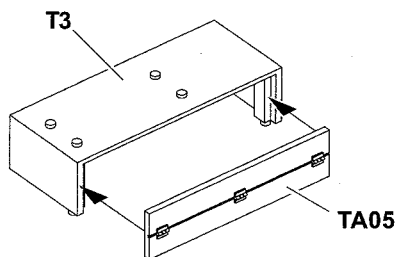
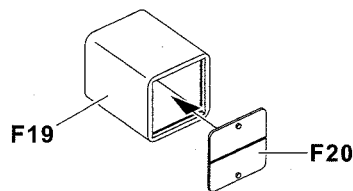
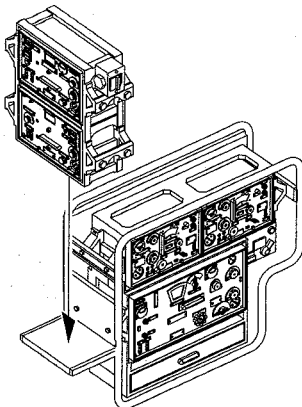

18

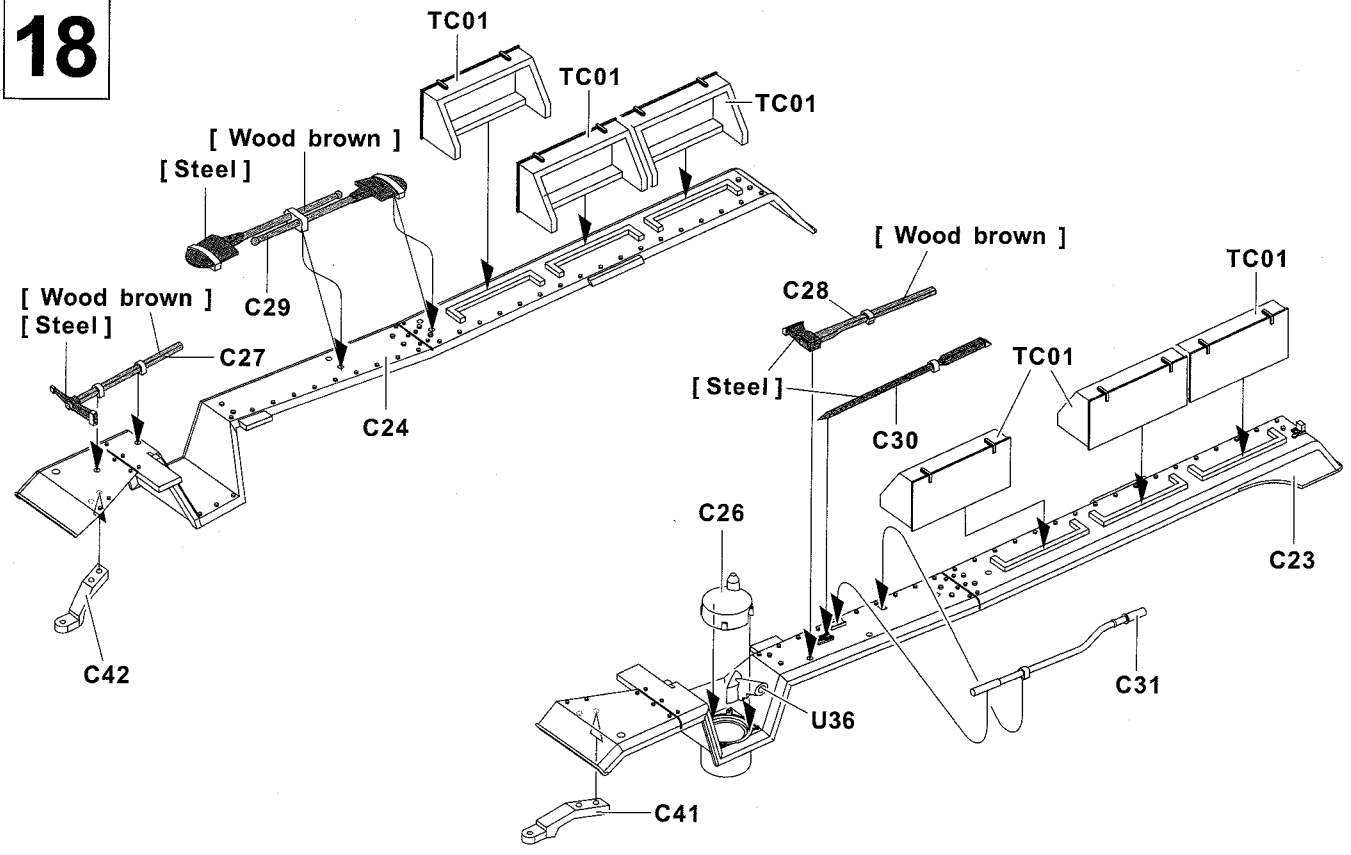

19

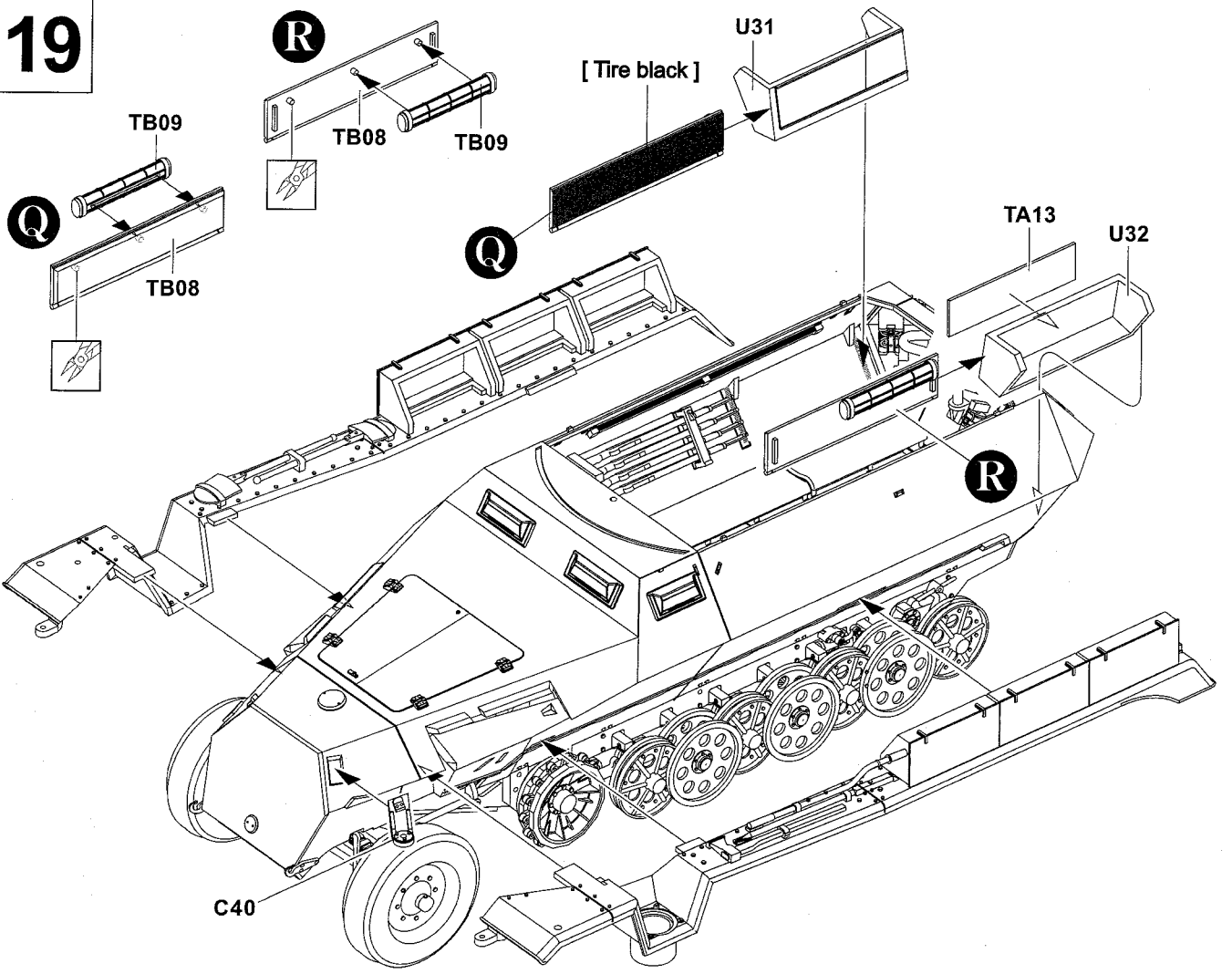

20

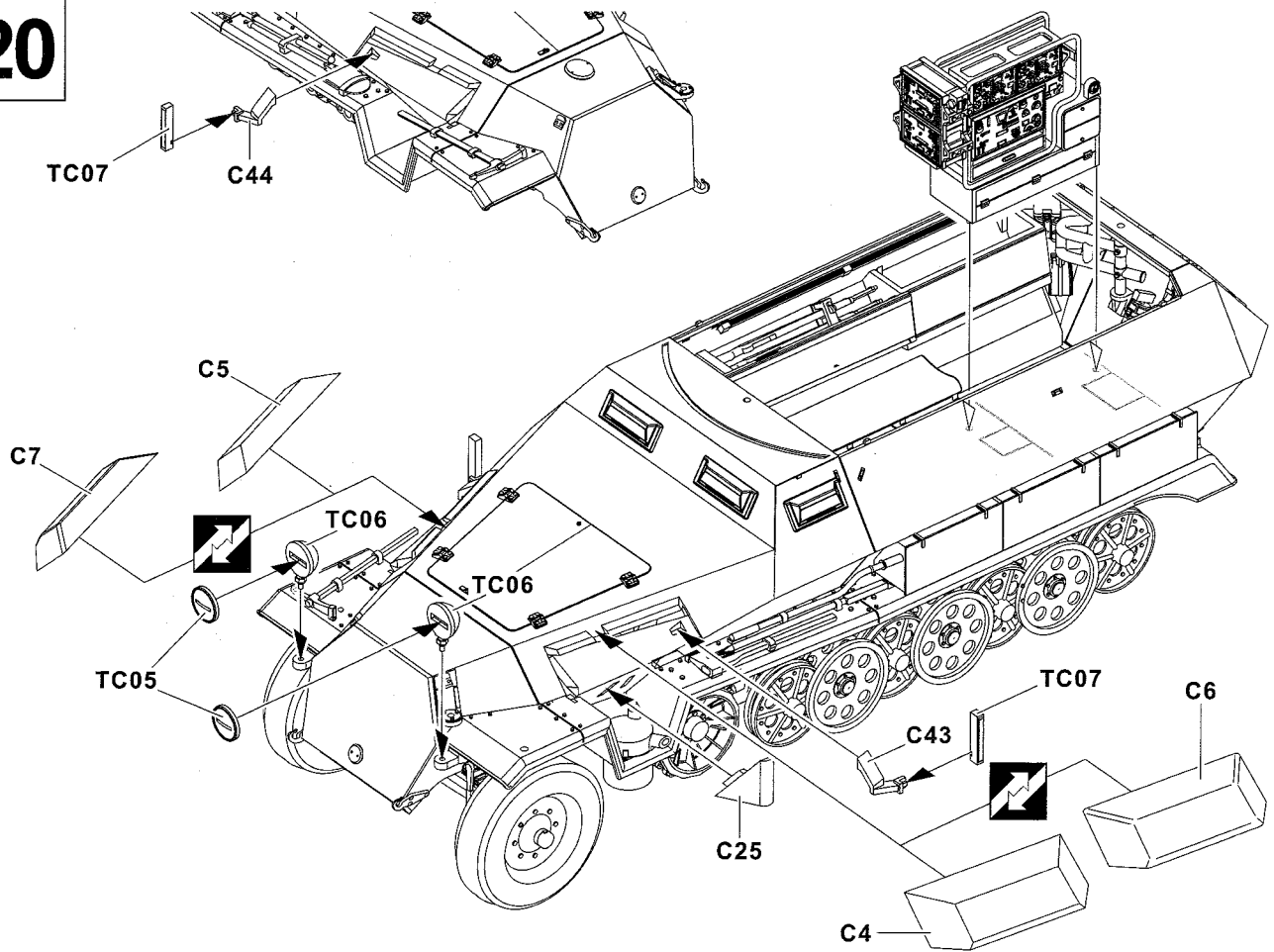

21

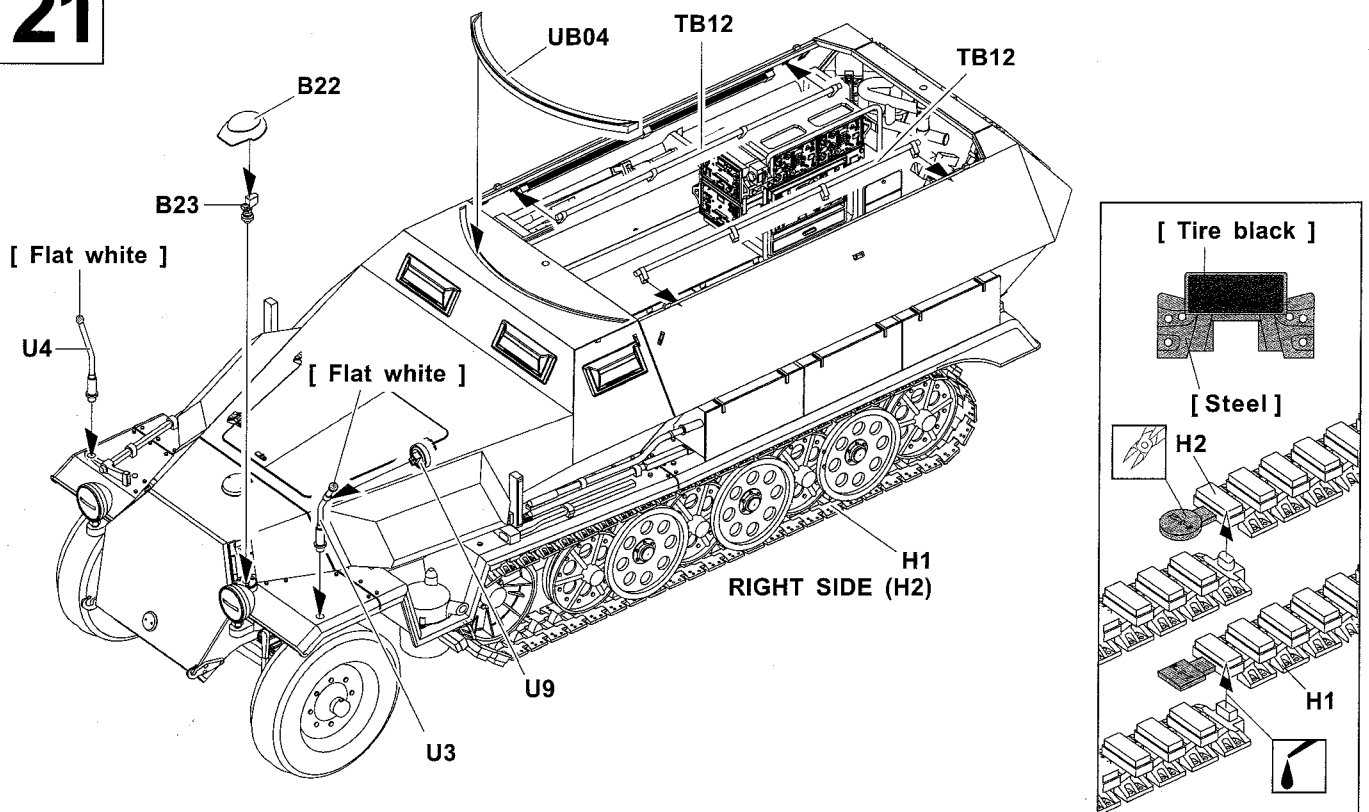

22

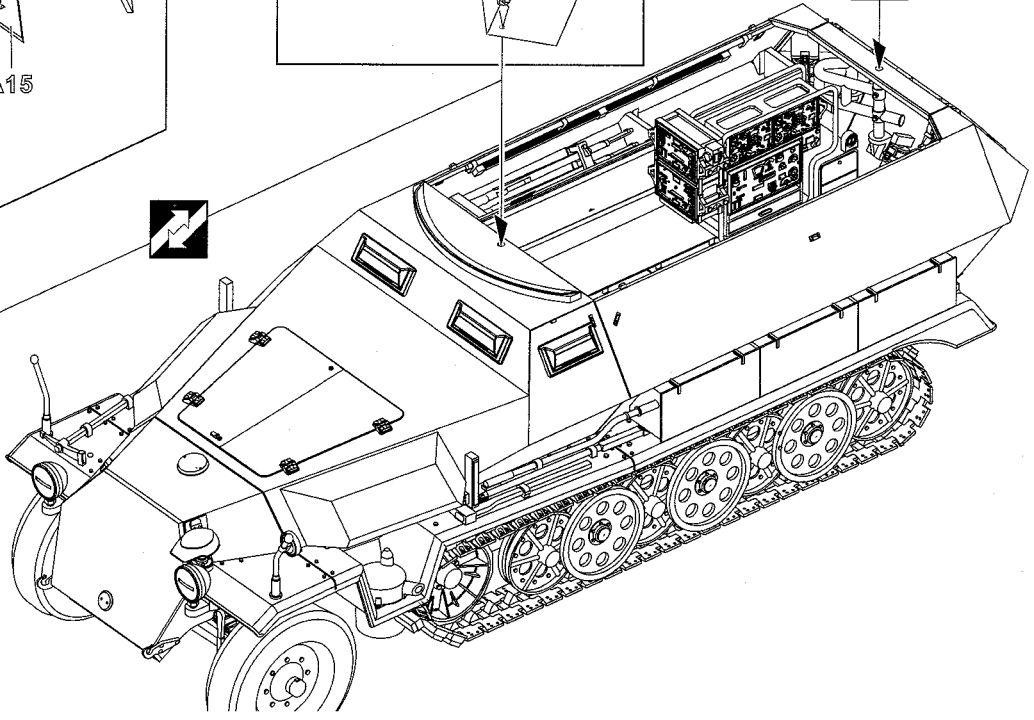
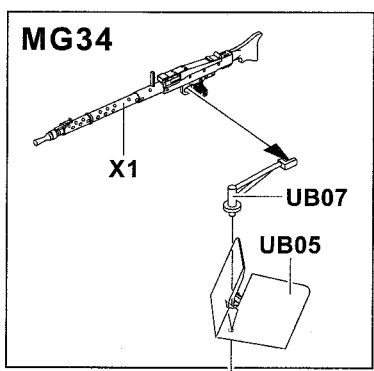
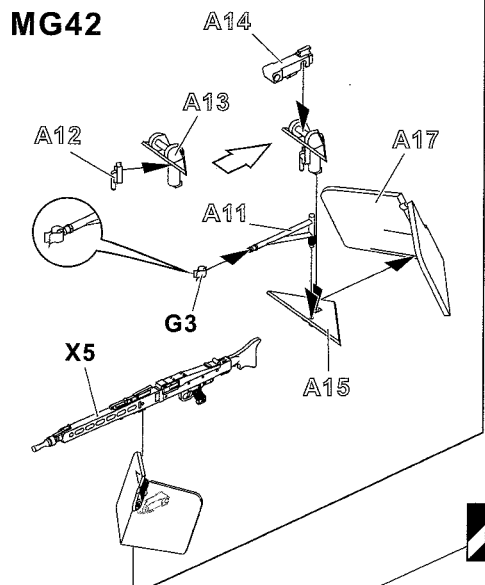
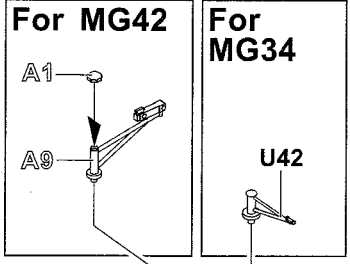
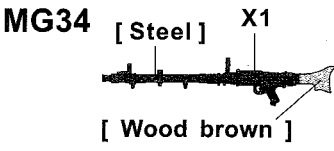
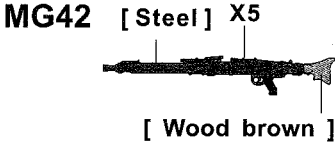

23

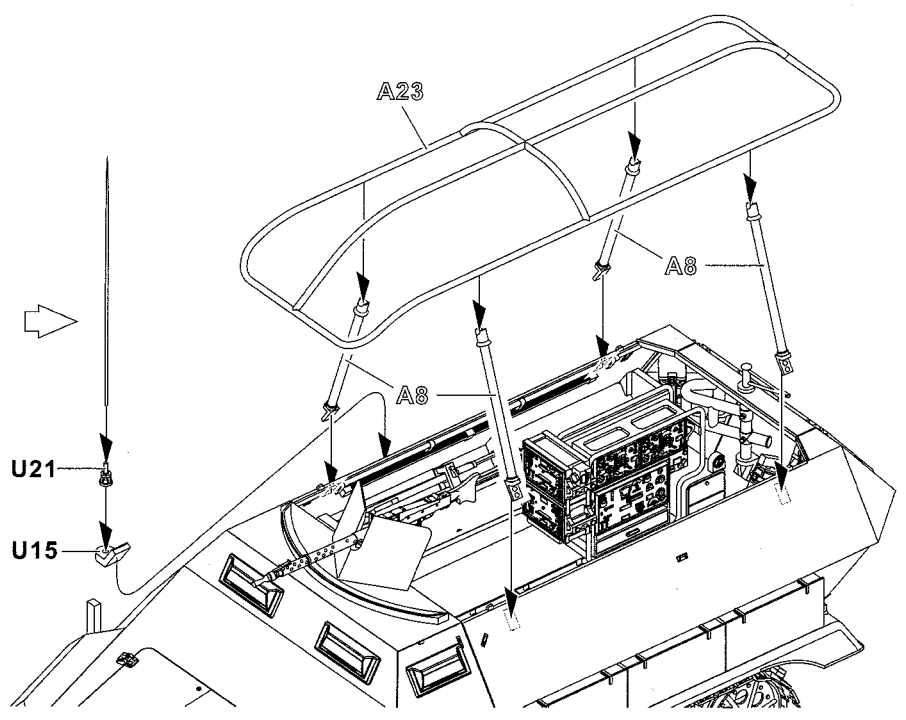
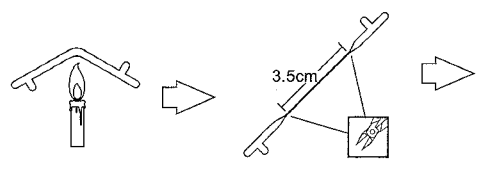

24

《 GG 400 generator 》

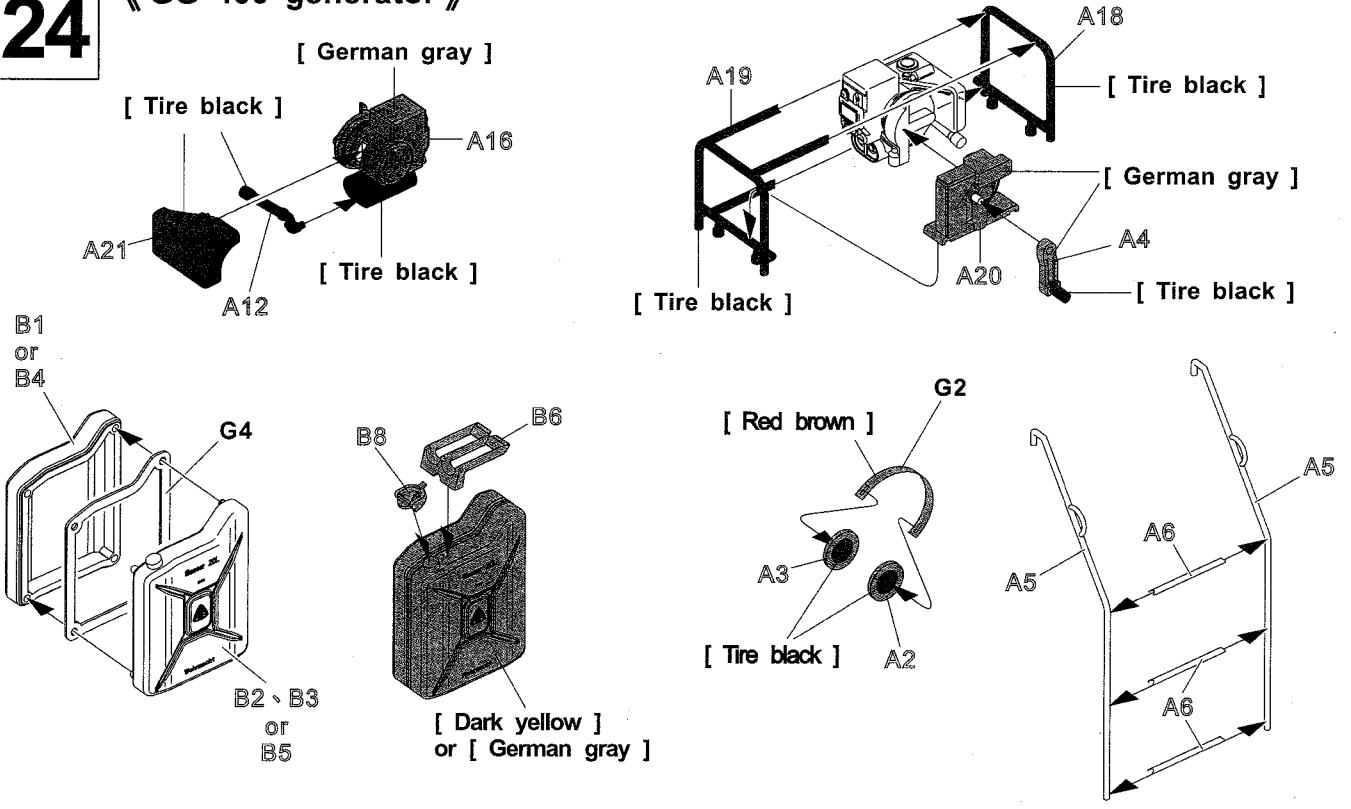

25

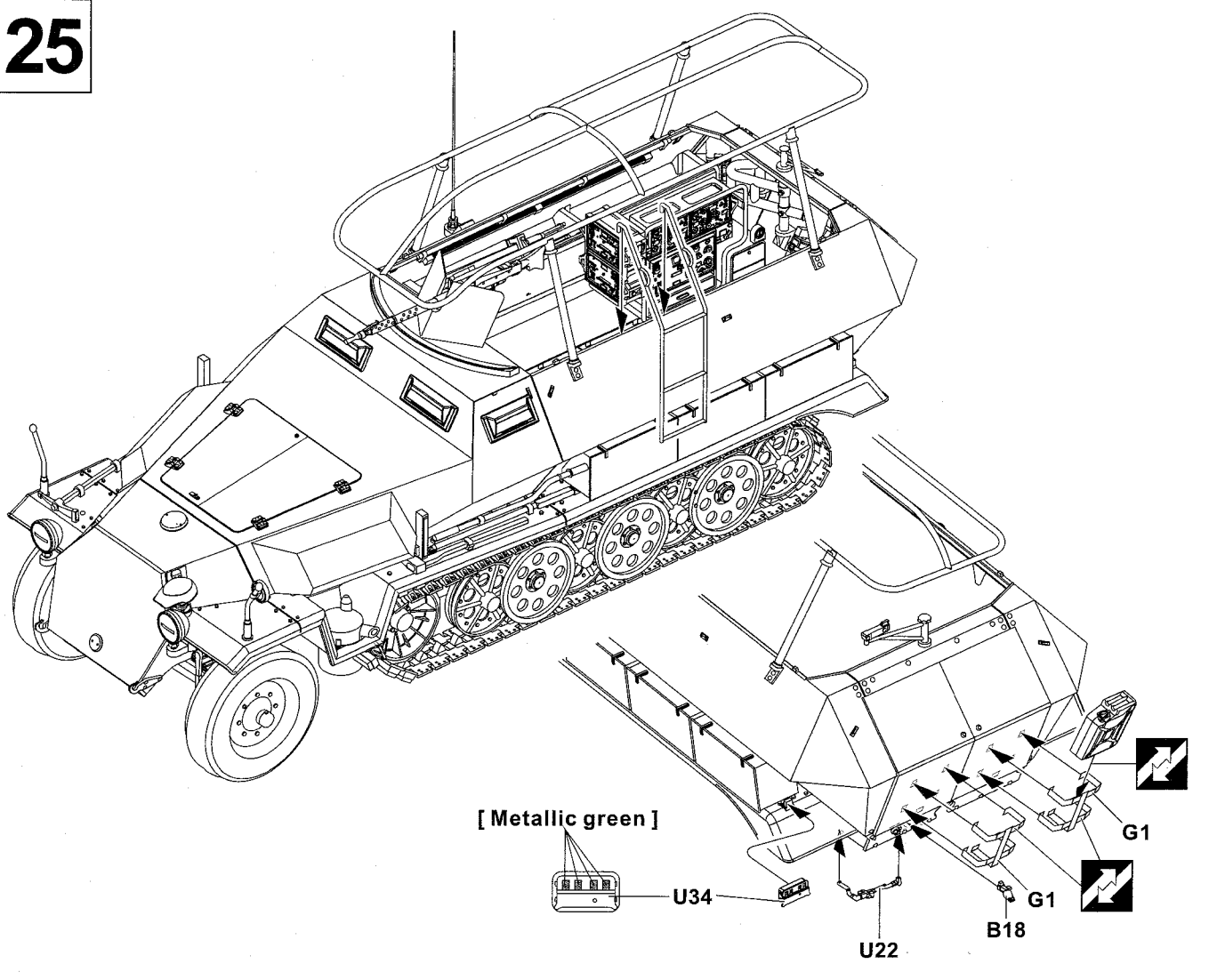

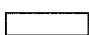

A 9.Pz.Div. Russia, Sept. 1941
 第9裝甲師, 1941年9月, 俄羅斯

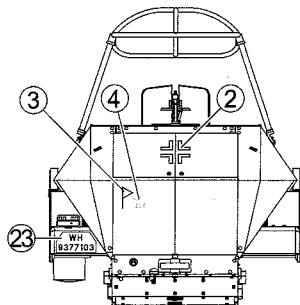
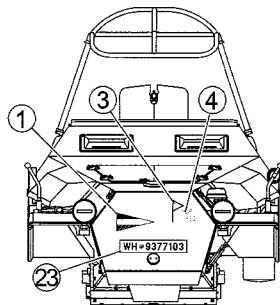
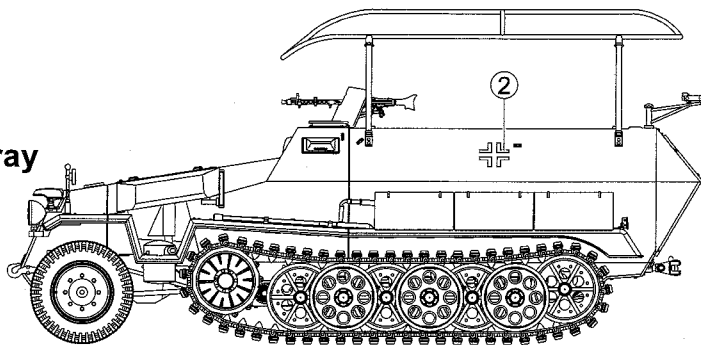
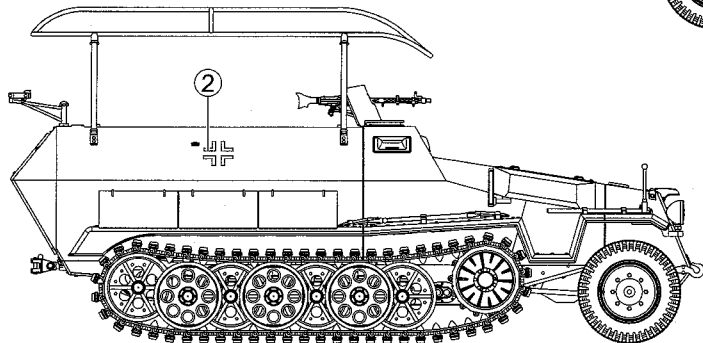
 Body Color:  German gray



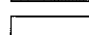

B 11.Pz.Div. Russia, winter 1942/43
 第11裝甲師, 1942/43年冬季, 俄羅斯

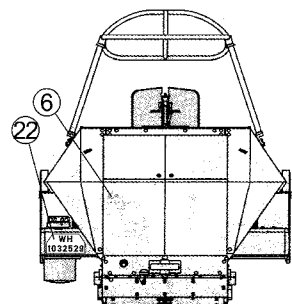
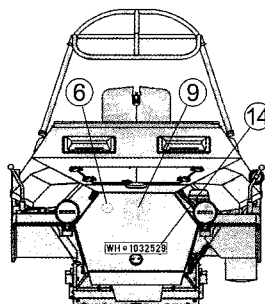
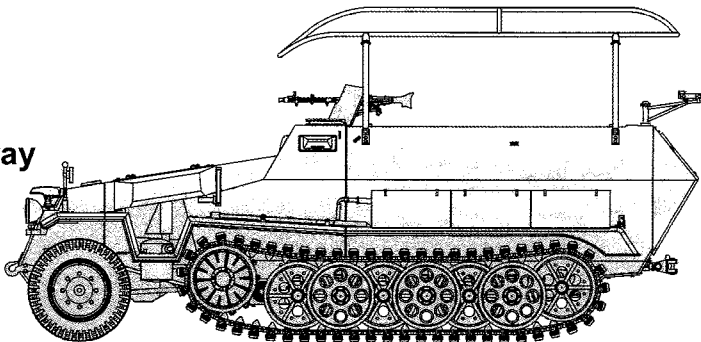
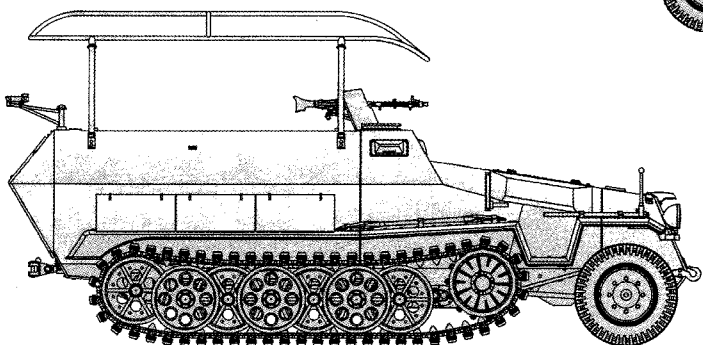
 Body Color:  German gray
 Flat White



C Ukraine, 1942, 14.Pz.Div
 第14裝甲師, 1942年, 烏克蘭

 Body Color:  German gray

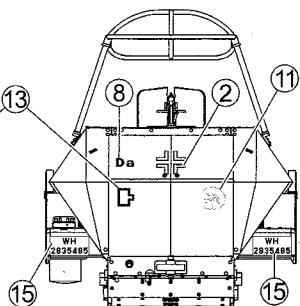
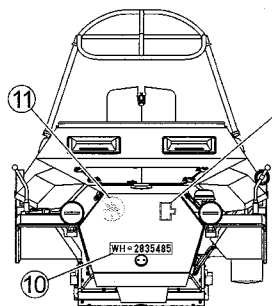
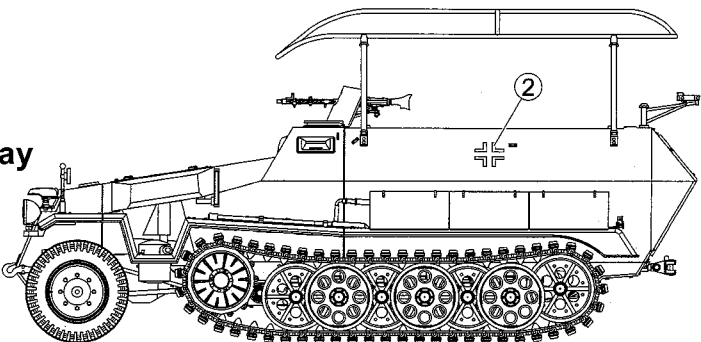
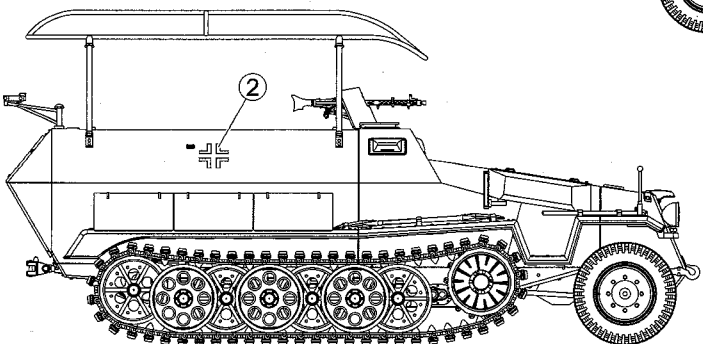

D

4.Pz.Div. Russia

第4裝甲師,俄羅斯



Body Color:  Flat White

 German gray

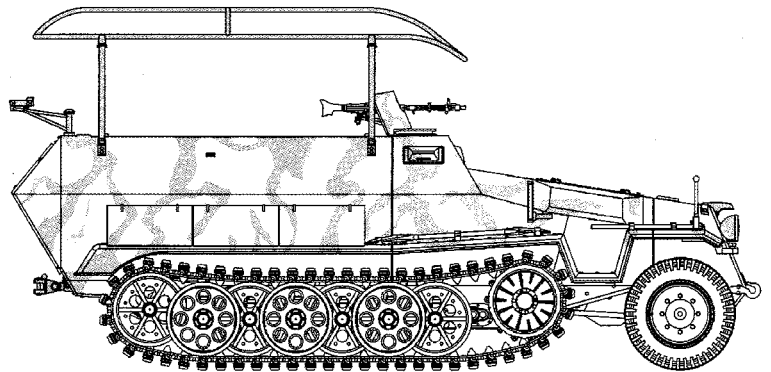
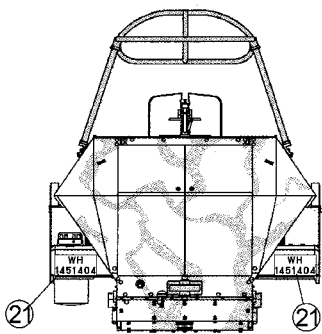
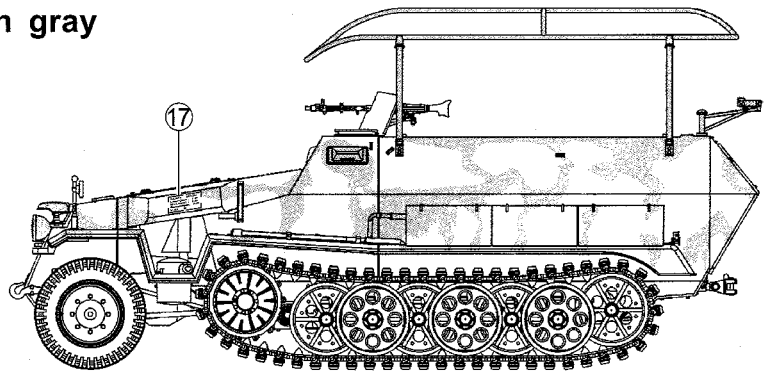
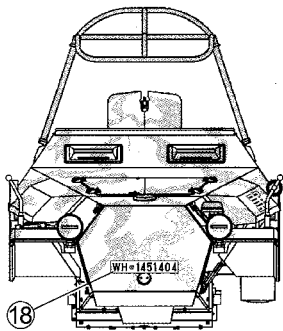

E

5.Leichte Division Libya, March 1941

第5輕裝師,1941年3月,利比亞



Body Color:  Dark Yellow

 German gray

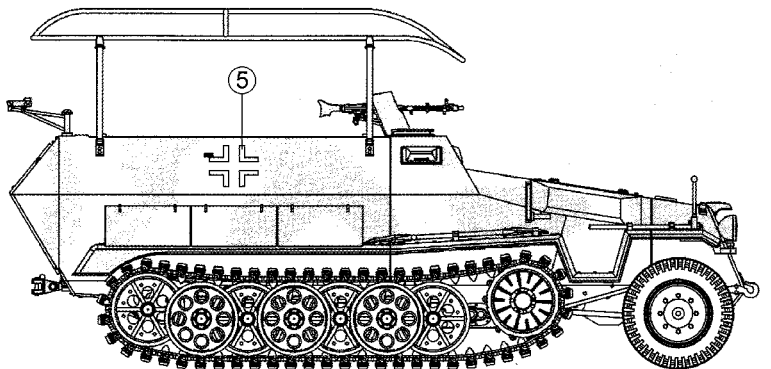
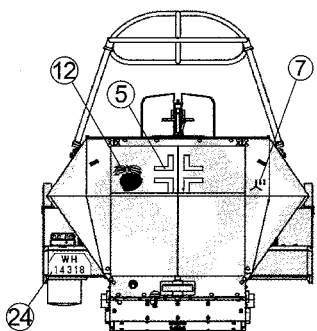
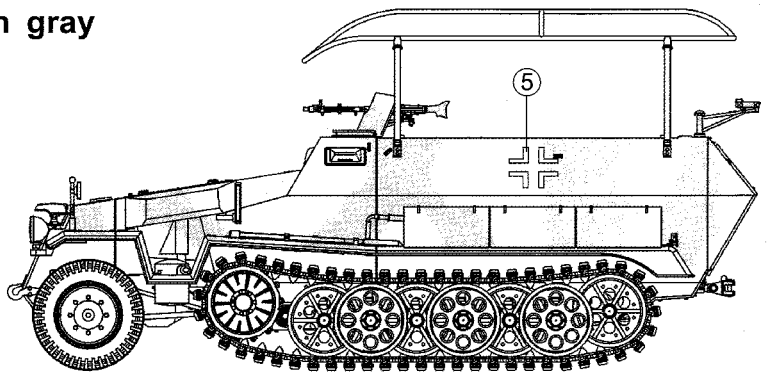
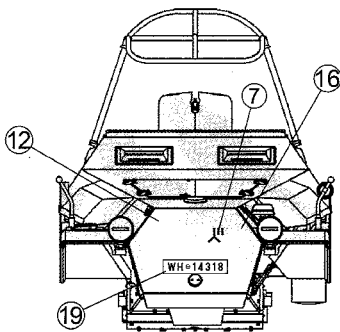

PARTS LIST 零件表

Diagram A: 12 circular components in a 3x4 grid.

Diagram B: Mechanical parts including gears and levers.

Diagram C: Various tools and small components.

Diagram F: Electrical components and wiring.

Diagram G: A grid of small square components.

Diagram H: A long, thin component with markings.

Diagram J: A small electronic board.

Diagram T: A rectangular component with a dial.

Diagram X: A small assembly with a handle.

Diagram TA: A large assembly with multiple sections.

Diagram TB: A component with a handle and a dial.

Diagram TC: A component with a handle and a dial.

Diagram U: A large assembly with multiple sections.

部品	A	2	G	1	U	1	TB	TC	2	
Parts:	B	1	H	1	X	2	A	1	B	1
	C	1	J	1	TA	2				
	F	1	T	1						



Instructions:

If for some reason, you are not fully satisfied or have questions concerning our product; Please use the form provide, and send it to our nearest representative or mail it directly to our office.

We will deal with that A.S.A.P.

限台灣地區使用 For Taiwanese use only!

總代理：戰鷹企業 請將本表與該部品相同金額之郵政匯票一同寄至本公司將儘速為您處理。

AF 35S50
Sd.Kfz.251/3 Ausf.C

Parts Replacement Form

<input type="checkbox"/> A parts	<input type="checkbox"/> U parts
<input type="checkbox"/> B parts	<input type="checkbox"/> X parts
<input type="checkbox"/> C parts	<input type="checkbox"/> TA parts
<input type="checkbox"/> F parts	<input type="checkbox"/> TB parts
<input type="checkbox"/> G parts	<input type="checkbox"/> TC parts
<input type="checkbox"/> H parts	<input type="checkbox"/> A parts
<input type="checkbox"/> J parts	<input type="checkbox"/> B parts
<input type="checkbox"/> T parts	

Reason for replacement: Missing broken

Signature: _____

AF 35S50
Sd.Kfz.251/3 Ausf.C
零件補充申請表

<input type="checkbox"/> A 部品零件	NT\$ 280
<input type="checkbox"/> B 部品零件	NT\$ 120
<input type="checkbox"/> C 部品零件	NT\$ 260
<input type="checkbox"/> F 部品零件	NT\$ 220
<input type="checkbox"/> G 部品零件	NT\$ 160
<input type="checkbox"/> H 部品零件	NT\$ 160
<input type="checkbox"/> J 部品零件	NT\$ 160
<input type="checkbox"/> T 部品零件	NT\$ 160
<input type="checkbox"/> U 部品零件	NT\$ 160
<input type="checkbox"/> X 部品零件	NT\$ 120
<input type="checkbox"/> TA 部品零件	NT\$ 120
<input type="checkbox"/> TB	
<input type="checkbox"/> TC 部品零件	NT\$ 150
<input type="checkbox"/> A 部品零件	NT\$ 180
<input type="checkbox"/> B 部品零件	NT\$ 160

+郵寄費 NT\$ 80
(請填)總計NT\$ _____

申請人
姓名 地址 電話

零件補充原因:(請於 打)
原包裝即 遺失或 毀損,
製作途中 遺失或 毀損,
其他原因 _____

