

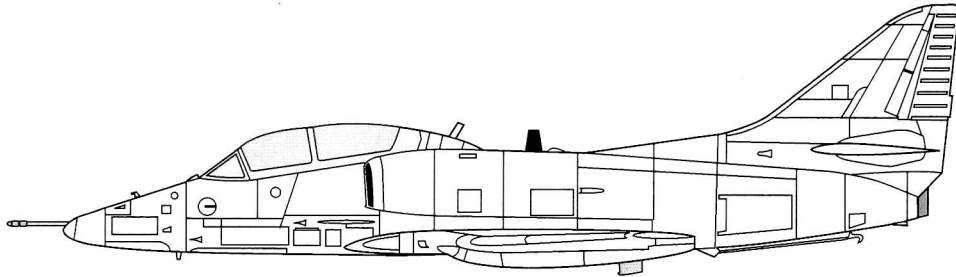

Classic Airframes



TA-4J Skyhawk

The A-4 Skyhawk was the first jet aircraft to succeed the propeller-driven Skyraider in the close air support and interdiction role in the early 1950's. The Skyhawk was intentionally kept light and simple in its design, earning nicknames like "Scooter" or "Bantam-bomber" (so-named after the small domestic chicken!).

Almost 2100 Skyhawks were built, of which 555 were two seat variants. The TA-4F first saw active duty in 1966 to train Navy and Marine pilots for the war in Vietnam. The TA-4J was the advanced flight trainer and was introduced in 1970 to replace the TA-9J two seat Cougar that was getting long in the tooth.

In 1998 the TA-4J was retired from the Navy at NAS Pensacola. However the TA-4J continued flying for the US as an adversary/aggressor and for launching aerial target drones. 40 years later the Skyhawk officially retired from the inventory in April of 2003, being replaced by the the T-45 Goshawk.

Classic Airframes would like to thank Mr. Fotios Rouch for his assistance with this project.

TA-4J Specifications

Powerplant:	J52-P-6 jet engine	Armament:	Usually none
Wing Span:	27' 6"		
Length:	43' 7"		
Maximum Speed:	675 mph		

This model kit is intended for *experienced* modelers. The nature of low-pressure molded kits such as this require additional time and effort to clean up and fit the parts, as well as experience with the various media utilized to provide the most accurate effect on the finished model. Use CyA ('super') glue to assemble Resin parts.

Classic Airframes, Inc.
P.O. Box 577580 Chicago, IL 60657-7580 USA

Assembly Instruction Symbols



MULTIPLE ASSEMBLIES



BEND



OPTIONAL



DRILL



CUT



SYMMETRICAL ASSEMBLIES

Paint Reference Guide

A

Light Gray



C

Burnt Metal



E

White



B

Flat Black-gray



D

Aluminum



F

Dark Grey



Parts

PLASTIC PARTS

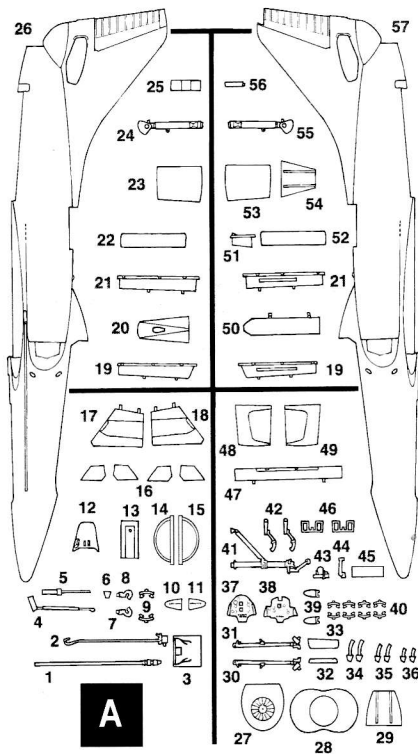

A

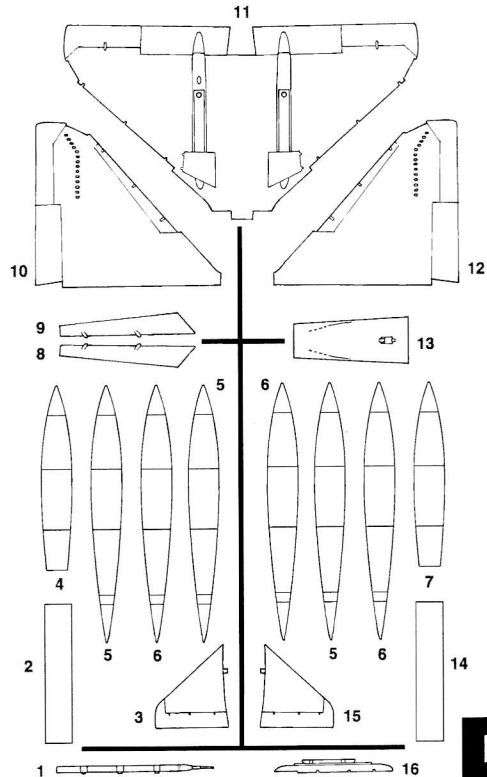

B

RESIN PARTS

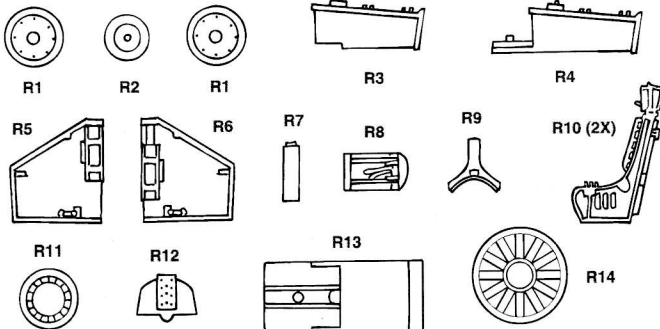

CLEAR PARTS (C)

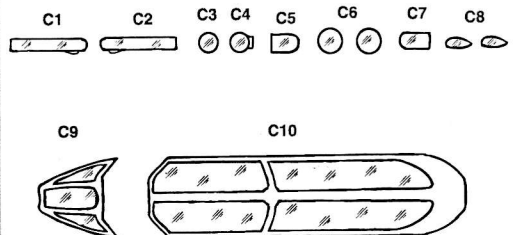

1

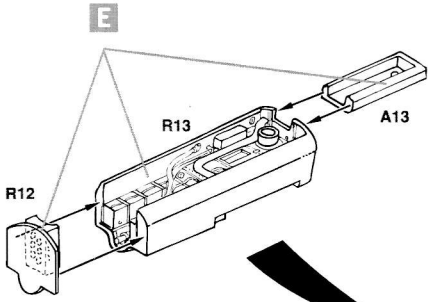

2

Instrument panel is Light Gray with Silver and White details

Ejection seat is Black-Gray with Brown or Green padding and Light Gray Belts

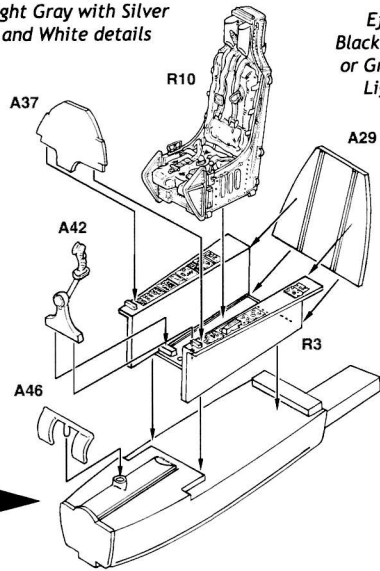

All cockpit areas

NOTE - Be sure to dry-fit and check alignment of all parts during assembly

3

Instrument panel is Light Gray with Silver and White details

Ejection seat is Black-Gray with Brown or Green padding and Light Gray Belts

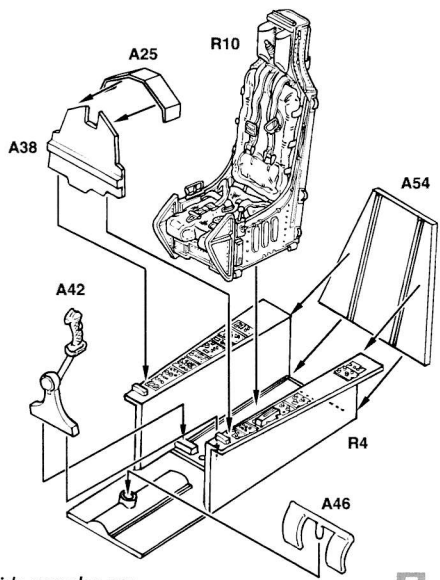

Side consoles are Black-gray with Silver and White details

All cockpit areas

4

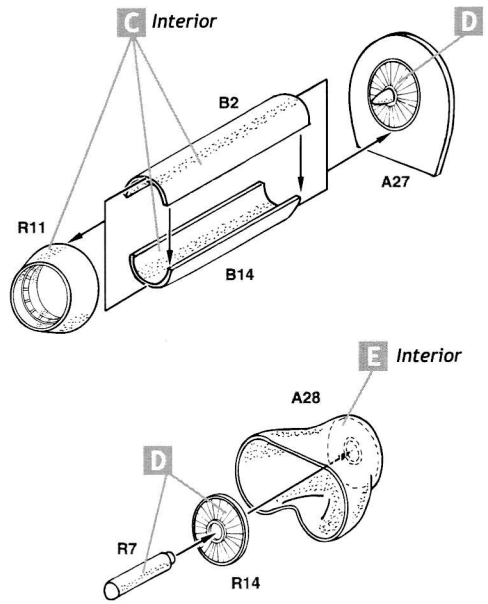

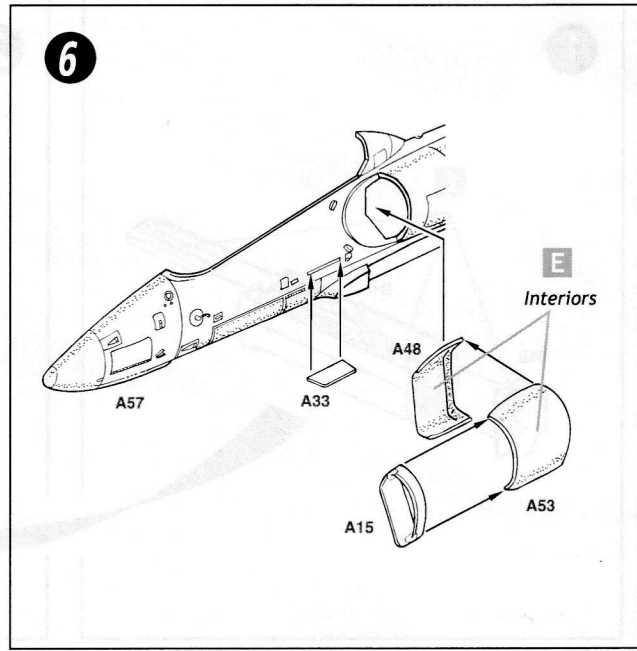
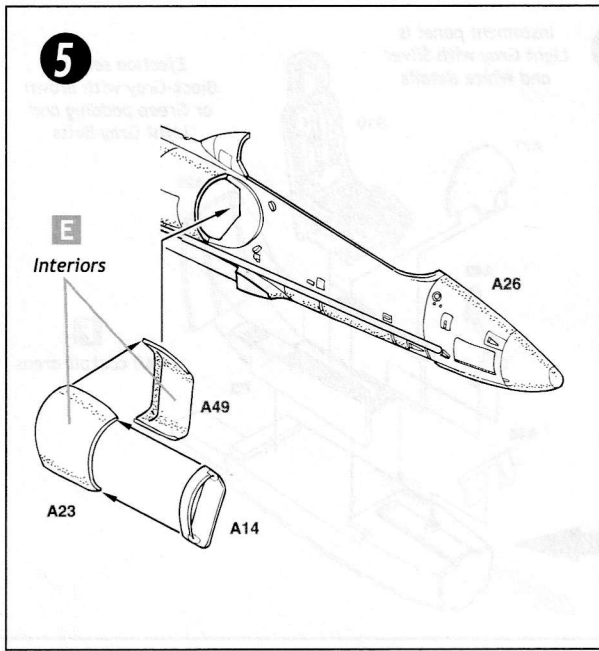

NOTE - Be sure to dry-fit and check alignment of all parts during assembly

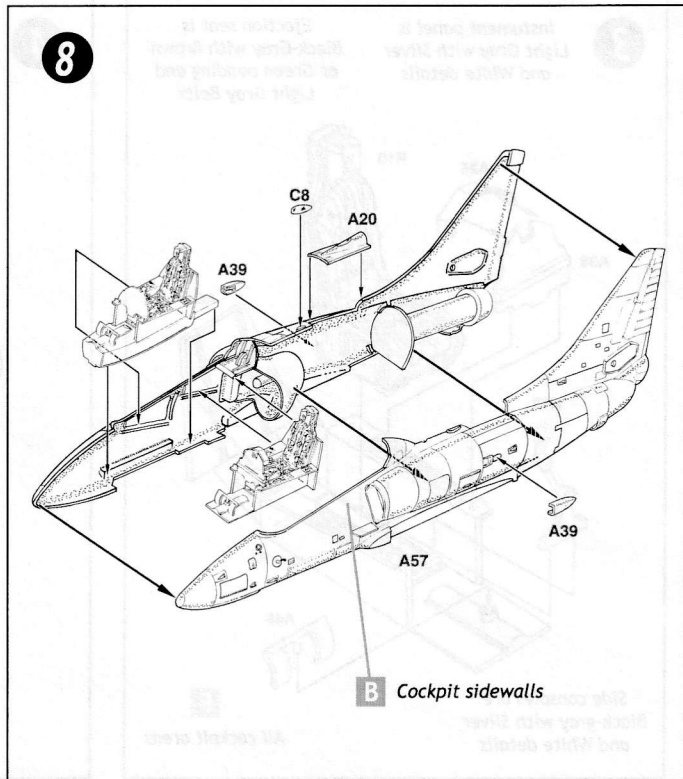
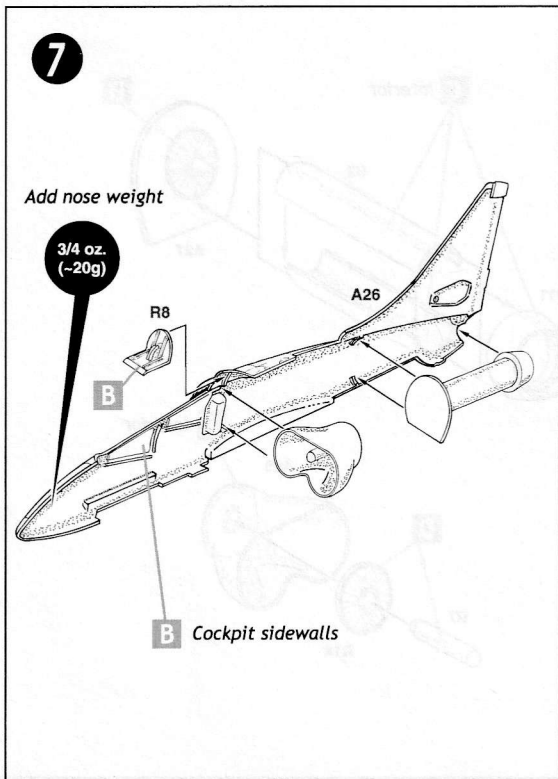

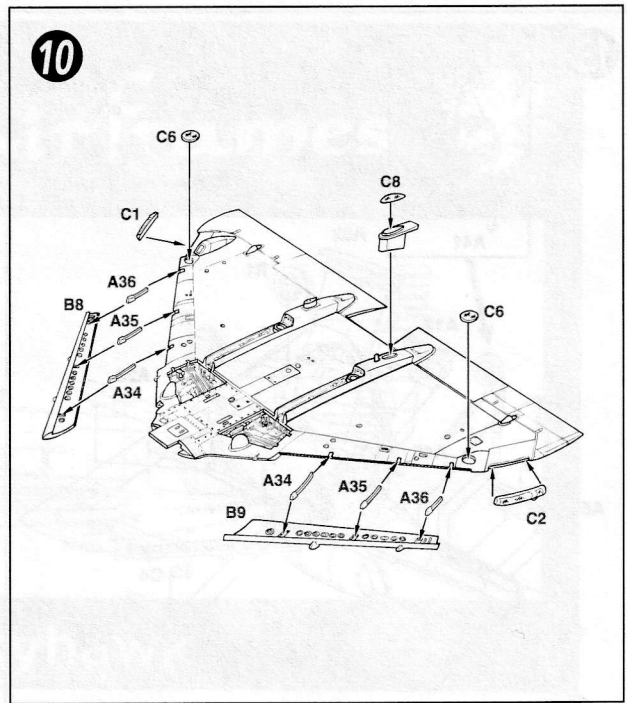
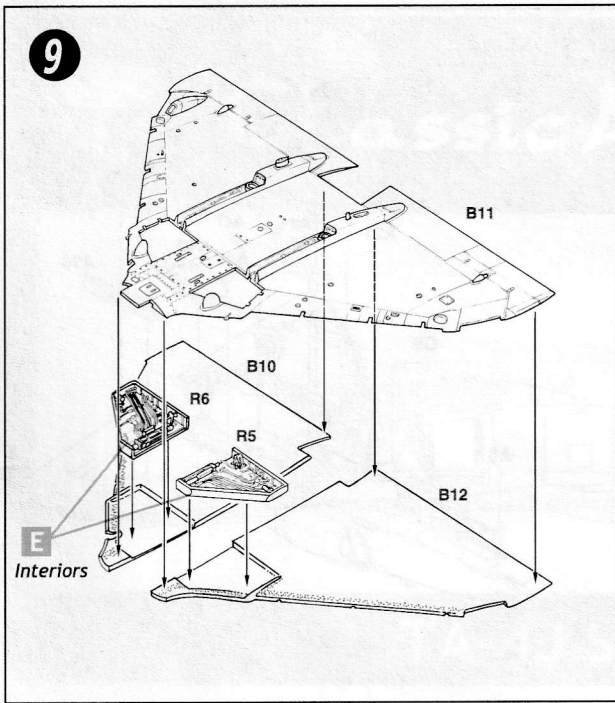

NOTE - Be sure to dry-fit and check alignment of all parts during assembly

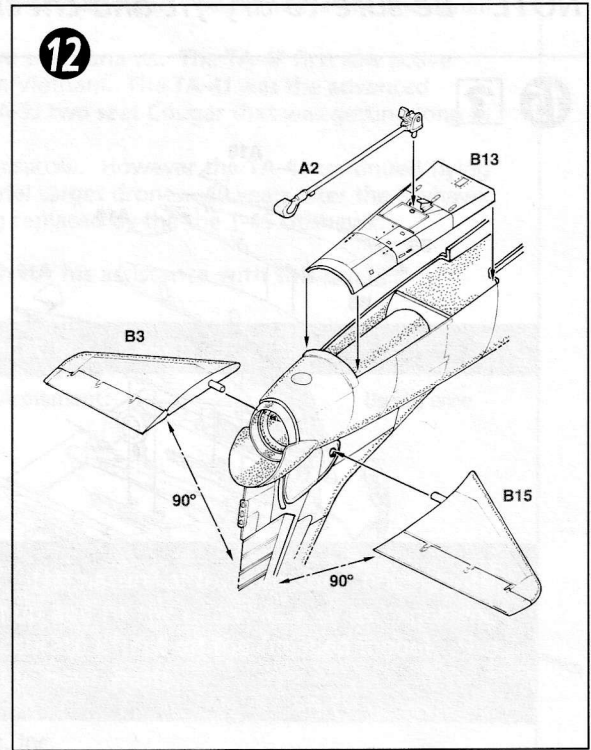
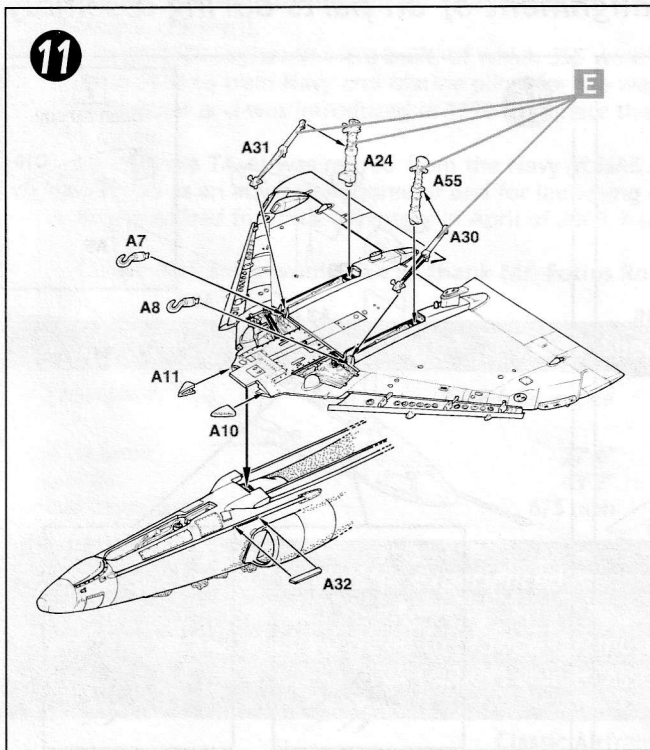

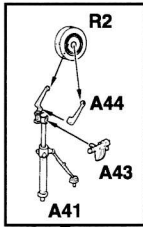
13

B Tires
E Gear struts and hubs
E Gear door interiors

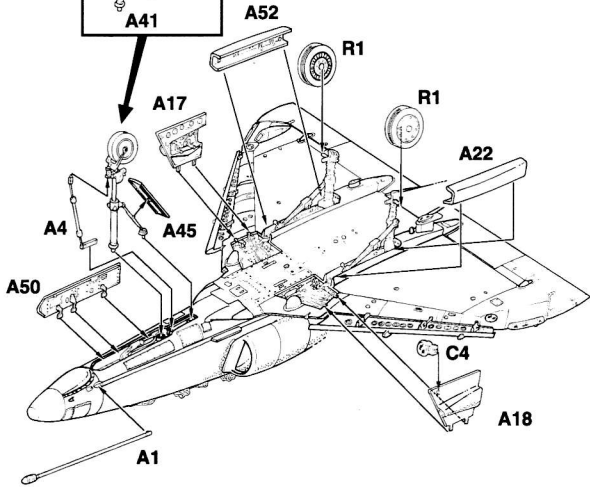
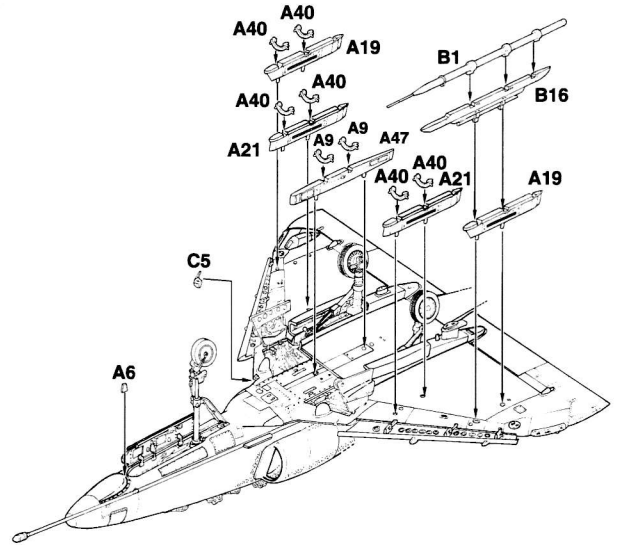
**14**

NOTE - Be sure to dry-fit and check alignment of all parts during assembly

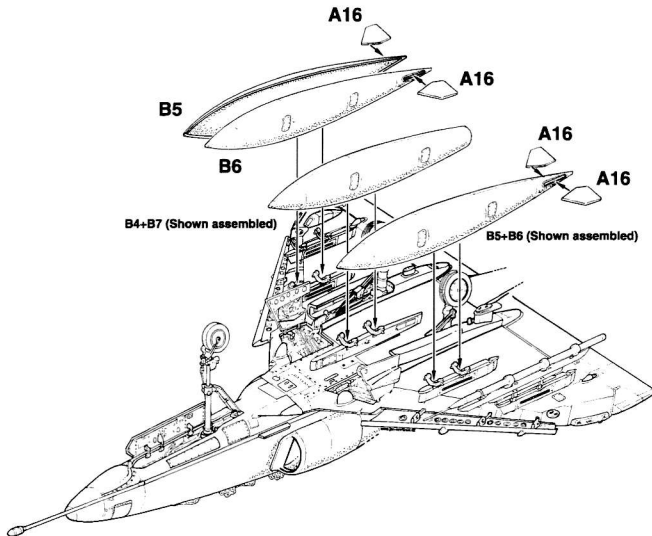
15**16**

Open canopy

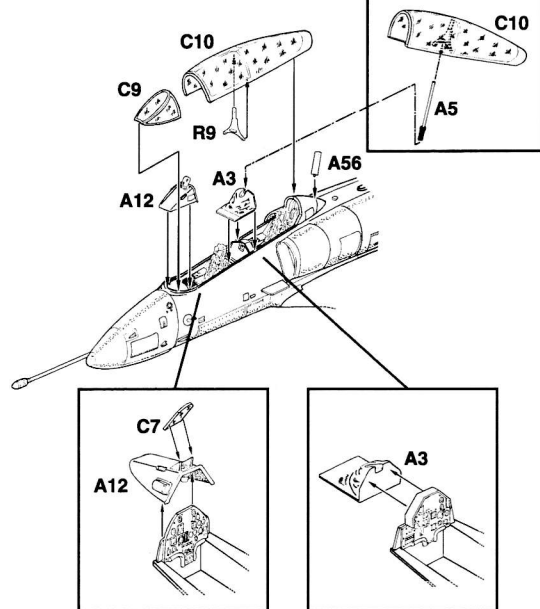

• VF-126, circa March 1984

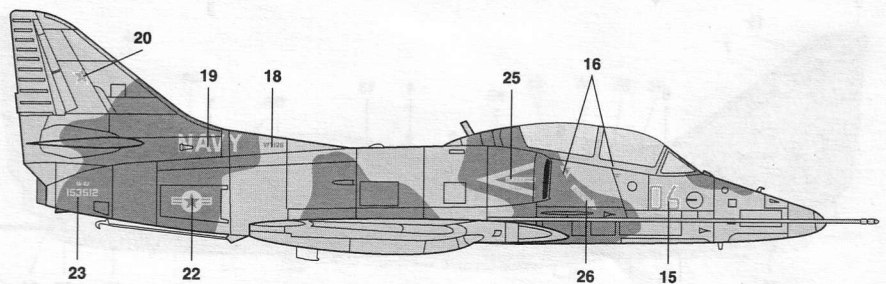
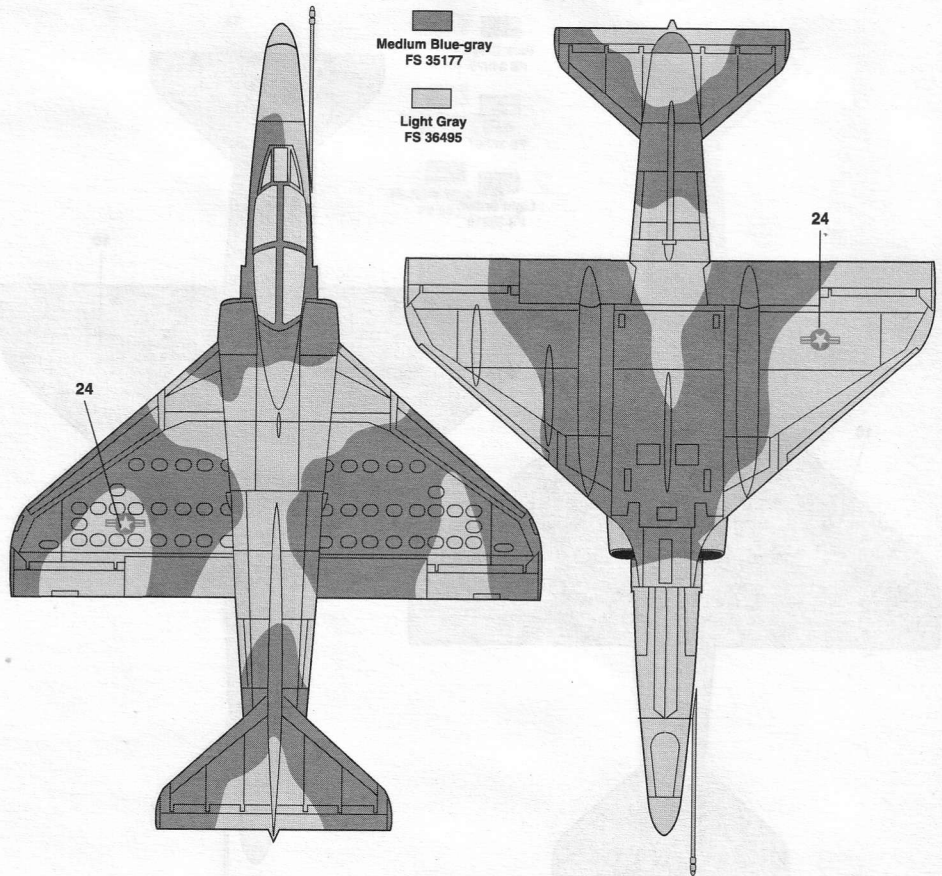
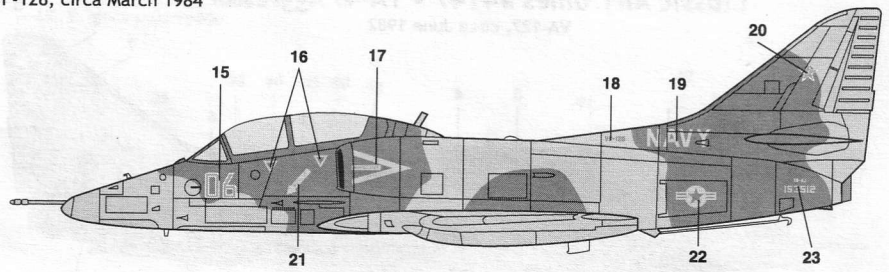

• VF-126, circa mid-1980s

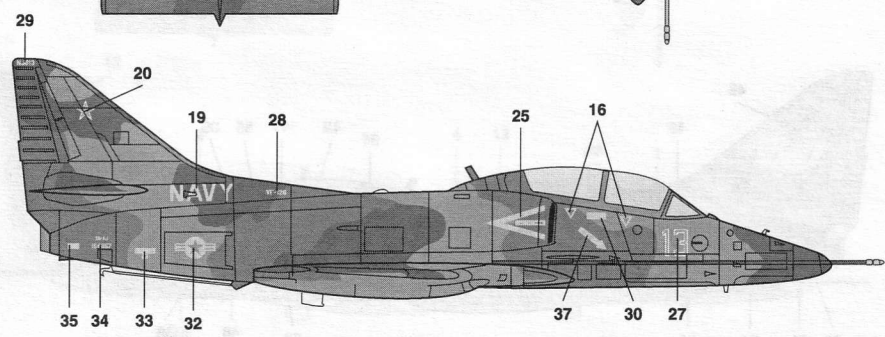
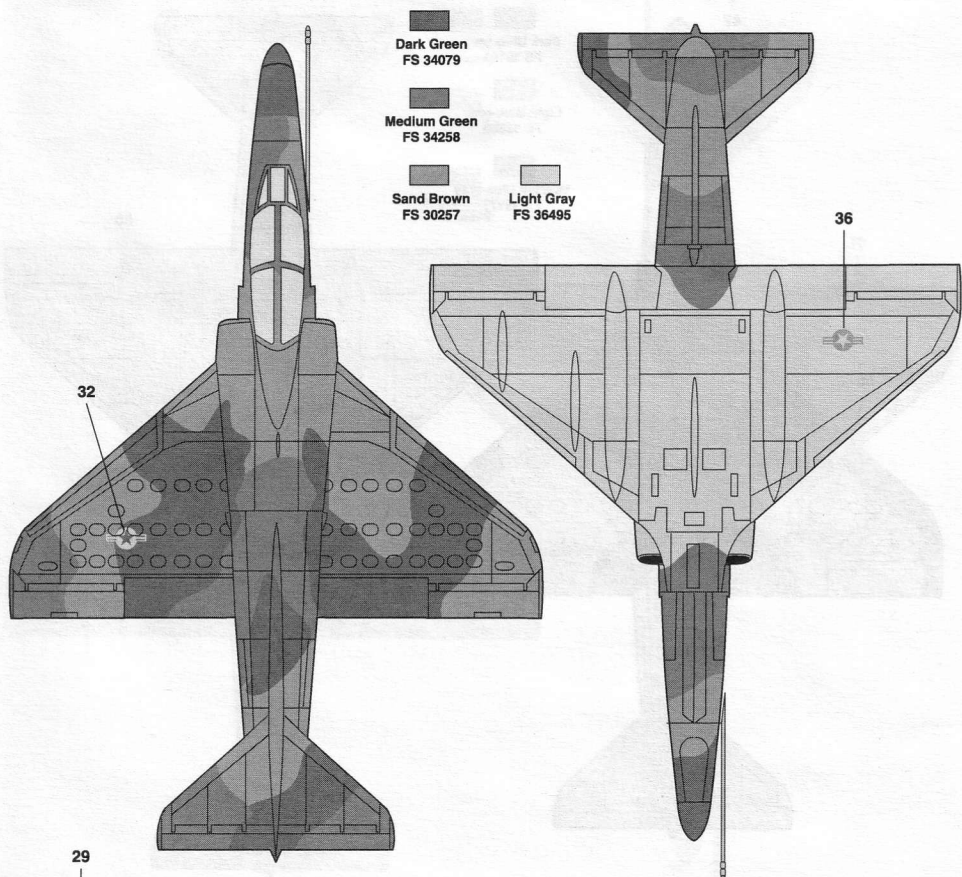
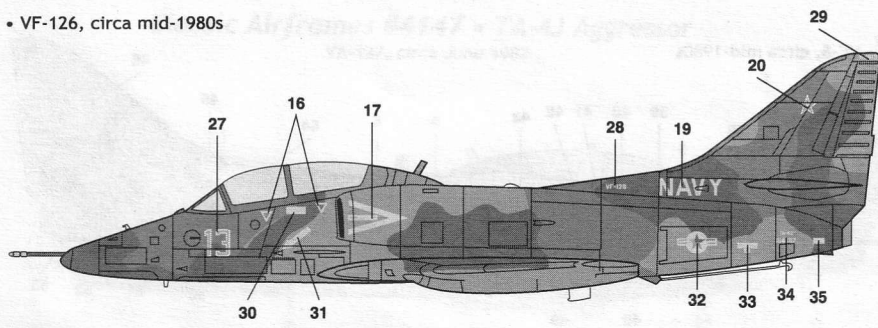

TA-4J
153672

TA-4J
153672



NAVY NAVY

707
707

S



VAI27



07 07

S



VAI27

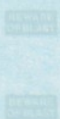

ACAN DURHAM
VANDENBURG KY

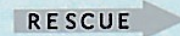

NAVY NAVY

00 00

00 00

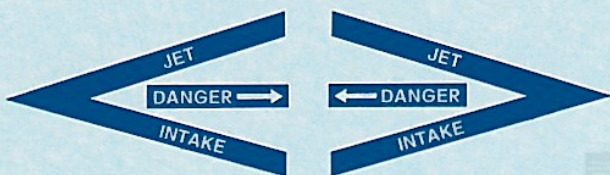

VC-8

VC-8

158137

158137



CDR TJ MC DONOUGH
COMMANDING OFFICER

CDR TJ MC DONOUGH
COMMANDING OFFICER



SE

ES

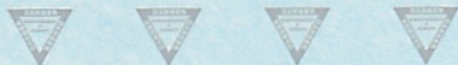

VF-126

VF-126

06 06

06 06

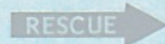
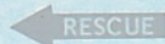
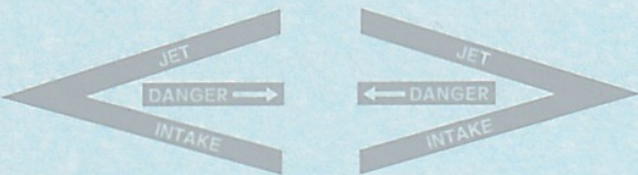

NAVY NAVY

TA-4J
153512

TA-4J
153512



BEWARE OF BLAST

BEWARE OF BLAST

13 13



VF-126

VF-126

NJ613

NJ613



TA-4J
154657

TA-4J
154657

