

SUPER44

COLORS BARVY FARBEN PEINTURE 色

GSI Creos (GUNZE)		MISSION MODELS	
AQUEOUS	Mr.COLOR	PAINTS	
[H2]	C2	[MMP-047]	BLACK
[H11]	C62	[MMP-001]	FLAT WHITE
[H12]	C33	[MMP-047]	FLAT BLACK
[H47]	C41	[MMP-012]	RED BROWN
[H65]	C18	[MMP-088]	RLM70 BLACK GREEN
[H69]	C37	[MMP-050]	RLM75 GRAY
[H70]	C60	[MMP-056]	GRAY
[H77]	C137	[MMP-040]	TIRE BLACK
[H43]	C113	[MMP-090]	RLM04 YELLOW
[H414]	C114	[MMP-003]	RLM23 RED

GSI Creos (GUNZE)		MISSION MODELS	
AQUEOUS	Mr.COLOR	PAINTS	
[H416]	C116	[MMP-089]	RLM66 BLACK GRAY
[H417]	C117	[MMP-051]	RLM76 LIGHT BLUE
[H421]	C121	[MMP-052]	RLM81 BROWN VIOLET
[H422]	C122	[MMP-053]	RLM82 LIGHT GREEN
[H423]	C123	[MMP-054]	RLM83 DARK GREEN
Mr.METAL COLOR		METALLICS	
[MC214]		[MMM-001]	DARK IRON
Mr.COLOR SUPER METALLIC		METALLICS	
[SM01]		[MMC-001]	SUPER CHROME

PLASTIKOVÝ MODEL

FOTOLEPTANÉ DÍLY, EXPRESS MASK,
NEOBSAHUJE BĀRVY A LEPIDLO
VYROBENO V ČESKÉ REPUBLICE

POZOR! OBSAHUJE DROBNÉ A OSTRÉ DÍLY
VÝROBEK NENÍ HRAČKOU

SCALE PLASTIC KIT

PE PARTS, MASK,
PAINT AND GLUE NOT INCLUDED
MADE IN CZECH REPUBLIC

CONTAINS SMALL AND SHARP PARTS.
COLLECTORS ITEM · NOT A TOY

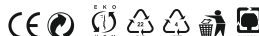

Fw 190D-9

1/144

Cat.No. 4461

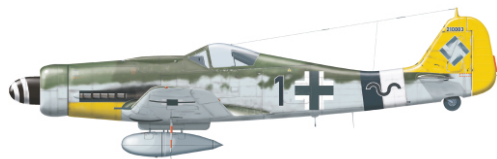

W. Nr. 210003, Oblt. Hans Dortenmann, IV./JG 26,
Germany, 1945



W.Nr. 600424, Lt. Heinz Sachsenberg, Munich - Riem airport,
Germany, April - May 1945



W. Nr. 211115, I./EKG(J) or V./EJG 2, Pilsen, Czechoslovakia,
May 1945



W. Nr. 211164, Stab/JG 6, Prag - Rusin, Czechoslovakia,
May 1945

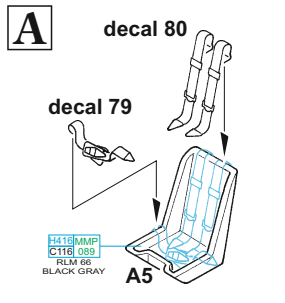

A12, G1 - MARKINGS A : B
A11, G2 - MARKINGS C : D

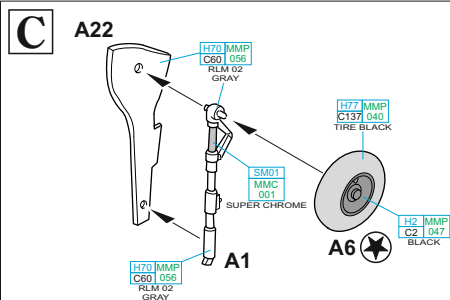
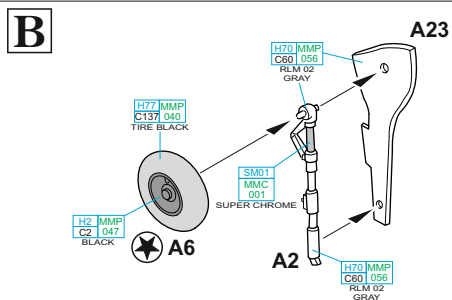
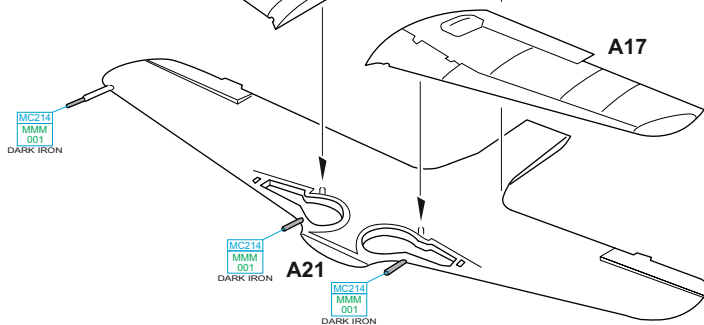
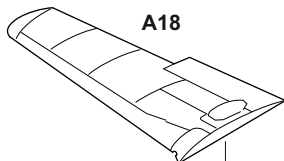
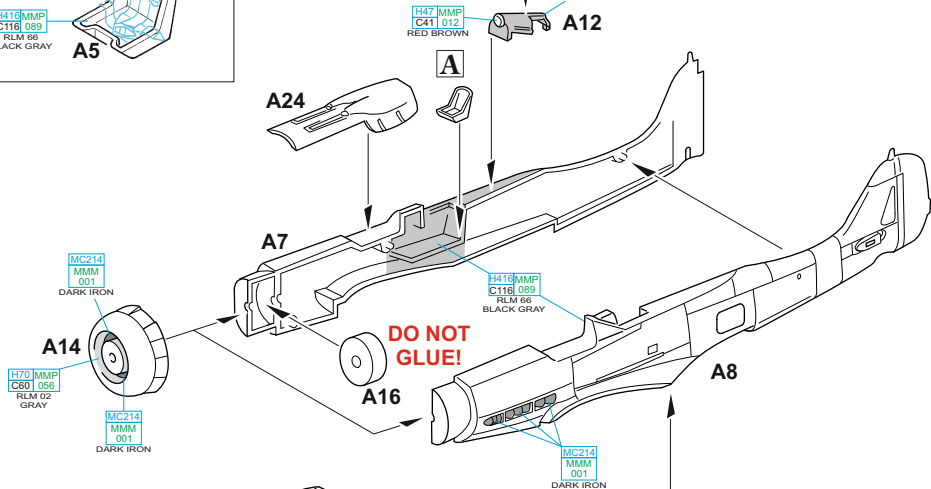
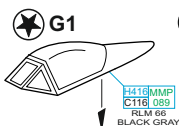
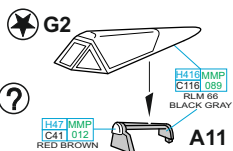

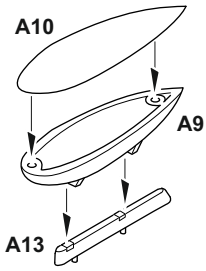
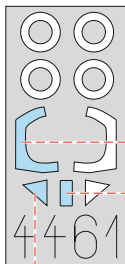
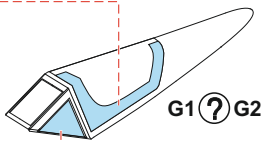
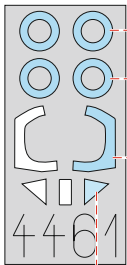
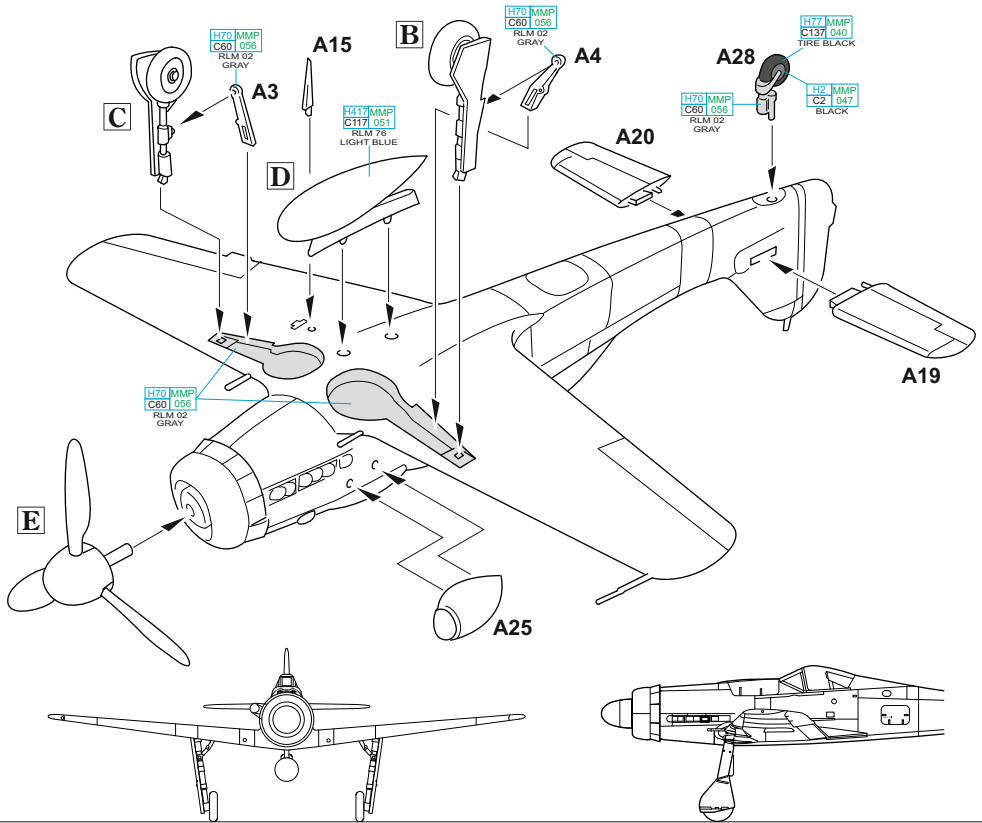
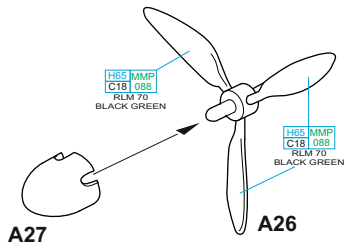
D**E**

G1 G2 LIQUID MASK

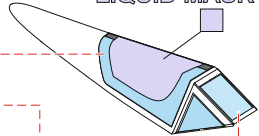

A W. Nr. 210003, Oblt. Hans Dortenmann, IV./JG 26, Germany, 1945

Hans Dortenmann, a 38 kill fighter ace and Knight's Cross holder, noted in his memoirs that he used Dora W. Nr. 210003 as a personal mount from September 1944 to the end of hostilities. He personally destroyed her at the end of hostilities to avoid falling into enemy hands. At first, during Dortenmann's service with III./JG 54, the airplane was marked 'Red 1'. In late February III./JG 54 was redesignated IV./JG 26, and Dortenmann was appointed Staffelkapitän of 12./JG 26. His Dora became 'Black 1'. The White-Black band appeared on the tail as well as IV. Gruppe's wave. According to Dortenmann's memoirs, the original RLM 74/75 camouflage scheme was changed to RLM 81/82, but the reason for re-painting remains unknown. A new-style blown canopy was installed instead of the original flat one. The vertical part of the tail unit was painted yellow from JG 54 days.

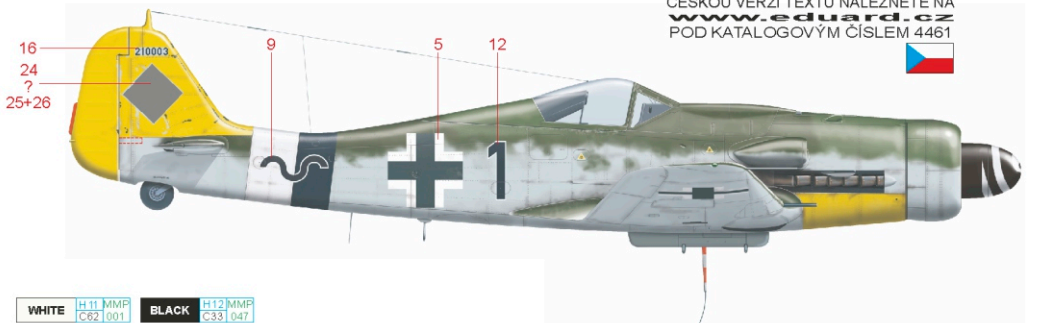
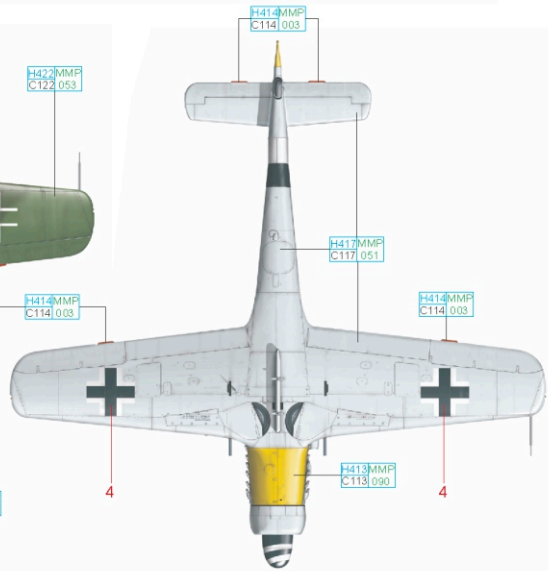
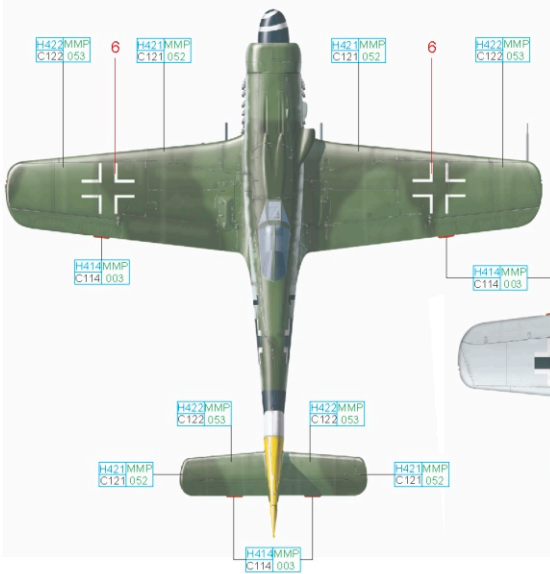
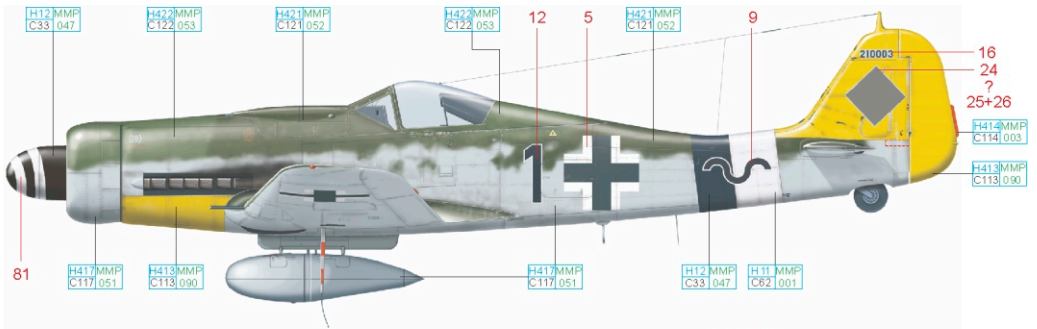

ČESKOU VERZI TEXTU NALEZNETE NA
www.eduard.cz
 POD KATALOGOVÝM ČÍSLEM 4461



WHITE H11 MMP C62 001 BLACK H12 MMP C33 047

RLM 76 H417 MMP C117 051 RLM 81 H422 MMP C121 052 RLM 82 H422 MMP C122 053 RLM 04 H413 MMP C113 090 RLM 23 H414 MMP C114 003

eduard

C W. Nr. 21115, I./EKG(J) or V./EJG 2, Pilsen, Czechoslovakia, May 1945

Dora captured by U.S. forces at Pilsen airfield in May 1945, formerly belonged to I./EKG(J) – I. Gruppe of Ergänzungskampfgeschwader (Jagd). This supplementary unit was redesignated as V./EJG 2 on March 29th, 1945, and was located in Pilsen by the end of hostilities. Unusual style of Gruppe wave in red indicates that this Dora belonged to V./EJG 2 rather than to I./EKG(J) as this Gruppe marking wasn't used by I. Gruppe. The upper surfaces were camouflaged in RLM 81/82, and the under surfaces in RLM 76. The forward part of wing under surfaces were RLM 81, while the remainder of the wing bottoms were left unpainted except for the RLM 76 ailerons. The small black circle with a stylized number 17 under the cockpit appeared on the aircraft after capture and its exact meaning is unknown.

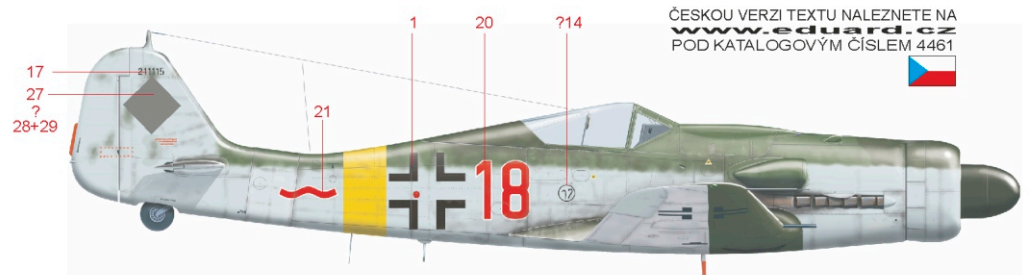
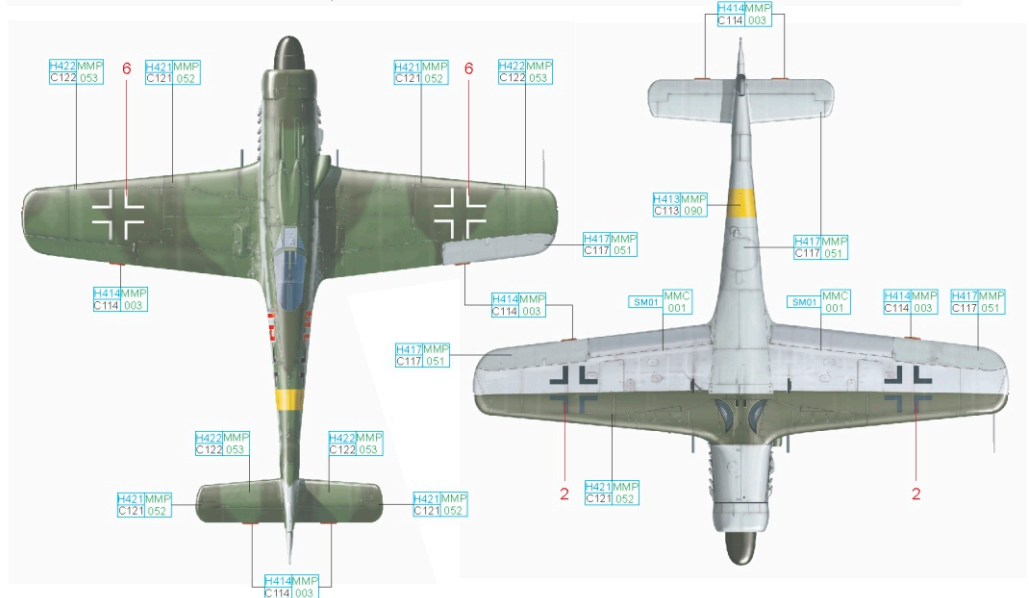
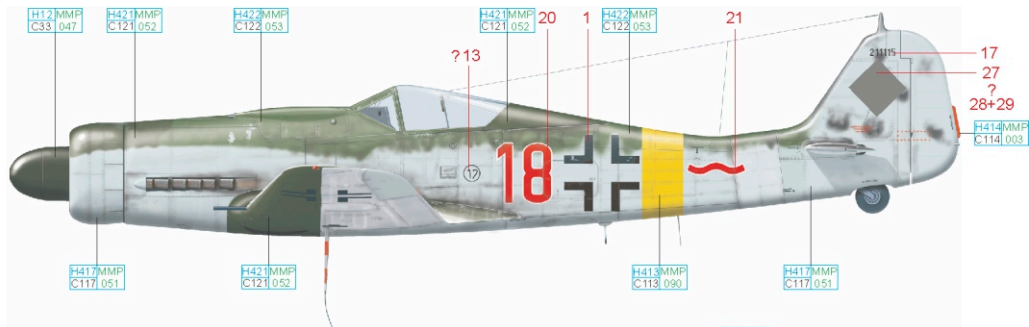

ČESKOU VERZI TEXTU NALEZNETE NA www.eduard.cz
POD KATALOGOVÝM ČÍSLEM 4461



RLM 23 H414/MMP C114_003 BLACK H12/MMP C38_047

RLM 76 H417/MMP C117_051 RLM 81 H421/MMP C121_052 RLM 82 H422/MMP C122_053 RLM 04 H413/MMP C113_090 SUPER CHROME SM01 MMC_001

eduard

