

US Medium Tank

M3 LEE Late

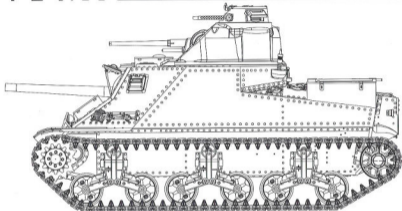

The outbreak of WWII in Europe caused the U.S. Army to recognize it was lacking an effective tank force. Design of the Medium Tank M3 commenced in July 1940, with production beginning in December, and the first units became operational in late 1941. The U.S. Army required a medium tank armed with a 75mm main gun and the United Kingdom had made an immediate demand for more medium tanks. The odd design archaically mounted the 75mm main gun in the right sponson, with another 37mm gun mounted in a small turret on top, which was a compromise meant to produce a tank as soon as possible until the M4 became available. In Britain, the tank was called by two names based on the turret configuration and crew size. Tanks fitted with the US style turrets were called the "Lee", named after Confederate general Robert E. Lee. Variants using British style turrets were known as the "Grant," named after Union general Ulysses S. Grant. The M3 offered potent firepower and sturdy armor, but had serious shortcomings in its general design and shape, including a high silhouette, and the sponson mounting of the 75mm main gun, which limited traverse and prevented the tank from taking a hull-down position. It also featured riveted construction (creating deadly internal projectiles with non-penetrating hits), and limited off-road performance. Multiple variants and derivatives were spawned from M3 production, including the M31 Armored Recovery Vehicle, M7 Priest Self Propelled Gun, and even the Canadian Ram cruiser tank.

Of the 6,258 M3 variants manufactured in the United States, 2,855 were officially handed over to the British government thanks to the Lend-Lease Agreement of 1941. The M3 Grant first saw action with the Royal Armoured Corps in North Africa during May 1942. However, most of the M3s ordered by the UK quickly became surplus to the requirements of the British Army, and 1,700 were transferred to the Australian Army for home defense and training duties in Australia. The British Indian Army also received 900 Grants, and a further 1,386 Lee's were exported directly from the US to the Soviet Union, although only 976 of these reached Russian ports due to German U-boat and air attacks on Allied convoys transporting the vehicles.

03.02.2087

READ BEFORE ASSEMBLY

CAUTION

- Read carefully and fully understand the instructions before commencing assembly. A supervising adult should also read the instructions if a child assembles the model.
- When assembling this kit, tools including knives used. Extra care should be taken to avoid personal injury.
- Keep out of reach of small children. Children must not be allowed to suck any part, or pull vinyl bag over their heads.



Optional



Do Not Cement



Remove



Dill



Instant Glue
for Metal



Healing

PAINTS REQUIRED

Color info and profiles by Mig Jimenez

APPLYING DECALS

1. Clean the model surface with a wet cloth.
2. Cut out each decal design from sheet, and dip it in tepid water for 15-20 sec.
3. Hold the backing sheet edge and slide decal onto the model.
4. Move decal into position by wetting decal with finger.
5. Press decal gently down with a soft cloth until excess water and air bubbles are gone.

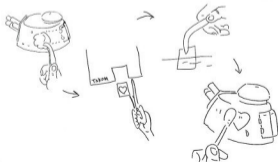

REMOVING PE



Be careful not to hurt when removing PE parts.



Secure using instant glue (not included).



Finish using file.

PARTS

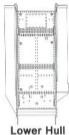
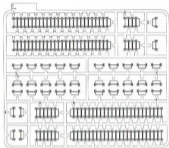
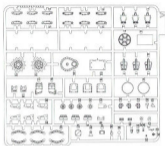
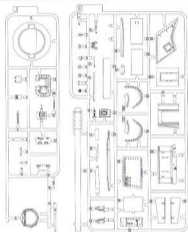

Lower Hull



T



TP



Turret

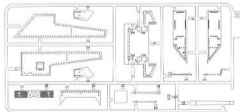

Decal

1

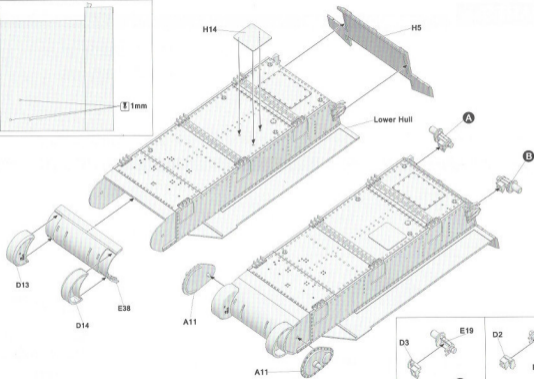
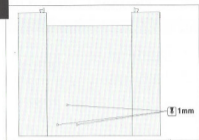

2

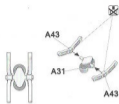
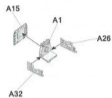
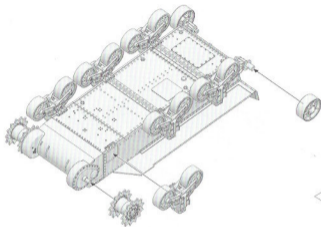

Make 6

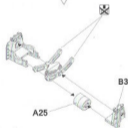
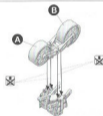

Make 6



Make 2

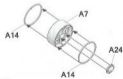

Make 12

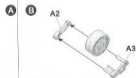

3

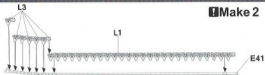

Make 2

5

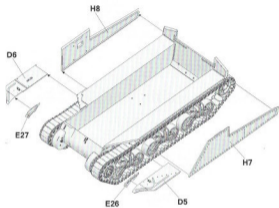
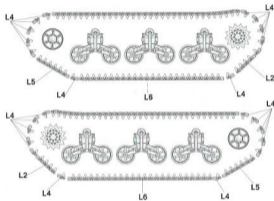

4

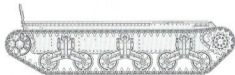

6

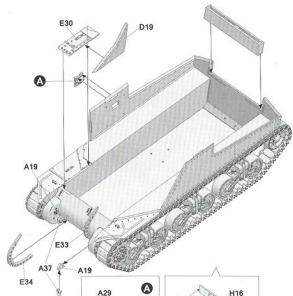

7

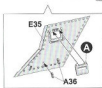
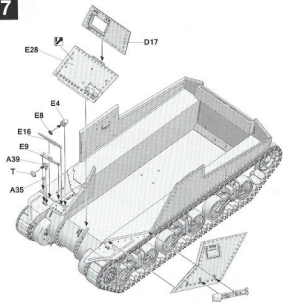

8

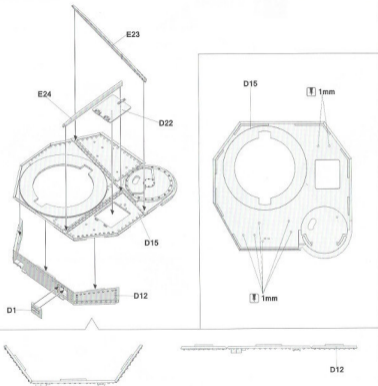

9

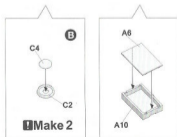
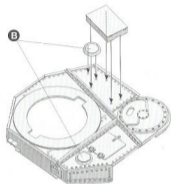

10

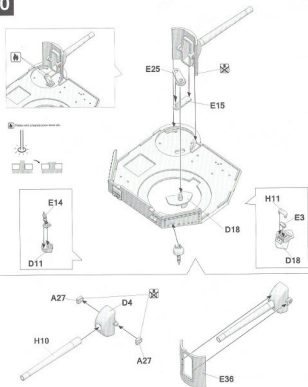

11

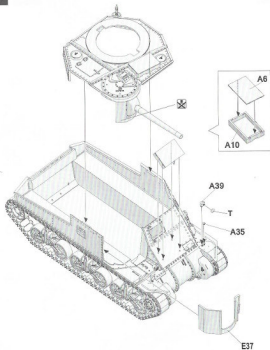

12

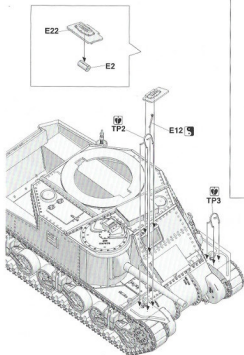

13

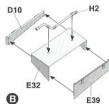
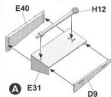
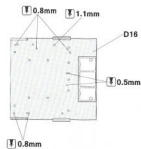
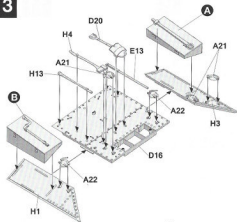

14

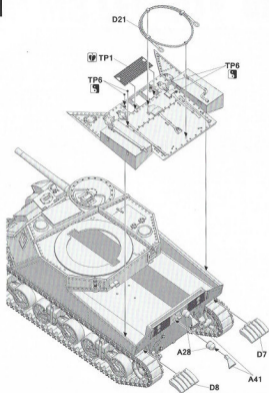

15

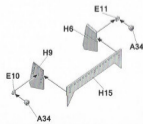
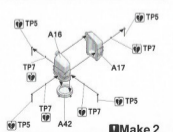
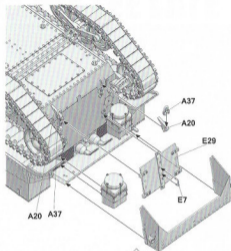

16

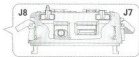
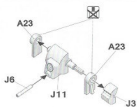
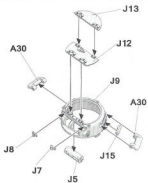
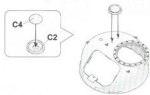

17

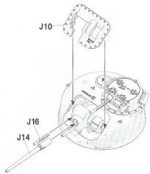
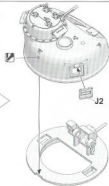
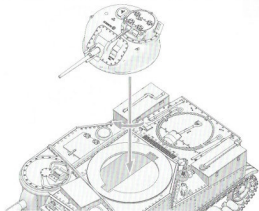

Painting and Marking Guide

A.MIG 035

Rubber & Tires

A.MIG 035

Dark Tracks

A.MIG 036

Old Wood

A.MIG 045

Gun Metal

A.MIG 071

Black

A.MIG 093

Crystal Red

A.MIG 094

Crystal Glass

A.MIG 096

Crystal
Periscope Green

A.MIG 195

Silver

A.MIG 908

Grey Blue

A.MIG 910

Grey Shale

Боепанцер Пз.Крпв М3 7.44 [а]. Date and location unknown.

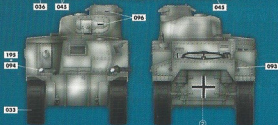
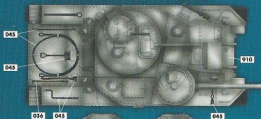

Painting and Marking Guide

1st Armored Division, Perham Downs, England,
December 1942.

AKS 033 Rubber & Tires

AKS 035 Dark Teak

AKS 05A Old Wood

AKS 045 Gun Metal

AKS 071 Khaki

AKS 093 Crystal Red

AKS 094 Crystal Glass

AKS 096 Crystal
Perspective Green

AKS 195 Silver

AKS 936 Olive Drab Base



Painting and Marking Guide

AMMO 033 Rubber & Tires

AMMO 035 Dark Tracks

AMMO 036 Old Wood

AMMO 045 Gun Metal

AMMO 071 Khaki

AMMO 093 Crystal Red

AMMO 094 Crystal Glass

AMMO 096 Crystal
Parascope Green

AMMO 075 Silver

AMMO 926 Olive Drab Base

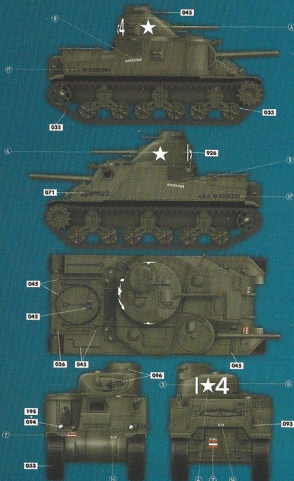
1st Armored Division, Perham Downes, England,
December 1942.

Painting and Marking Guide

AMMO 033

Rubber & Tires

AMMO 035

Dark Tracks

AMMO 036

Old Wood

AMMO 045

Gun Metal

AMMO 071

Khaki

AMMO 093

Crystal Red

AMMO 094

Crystal Green

AMMO 096

Crystal

1st Armored Division, Farham Downs, England,
December 1942.

AMMO 195

Silver

AMMO 926

Olive Drab Base

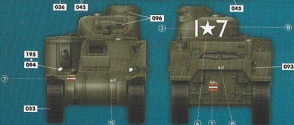

M31

- ▲ ALL HATCHES CAN BE BUILT IN OPEN OR CLOSED POSITION
- ▲ TRACK ASSEMBLY IS AIDED WITH THE USE OF A JIG
- ▲ DETAILED STATIC DISPLAY PLASTIC MODEL
- ▲ LINK & LENGTH STYLE TRACKS INCLUDED
- ▲ CLEAR PARTS INCLUDED
- ▲ FIGURE NOT INCLUDED
- ▲ 4 TYPES OF MARKINGS
- ▲ PE PARTS INCLUDED
- ▲ THIS IS NOT A TOY

**US TANK
RECOVERY VEHICLE**



TAKOM

▲ READY TO ASSEMBLE PRECISION MODEL KIT ▲ INTENDED FOR COLLECTORS OF AGE 14 YEARS AND ABOVE ▲ MODEL MAY VARY FROM IMAGE ON BOX ▲ CEMENT AND PAINT NOT INCLUDED

JASON 2017

1/35
No.2088

2017/2087

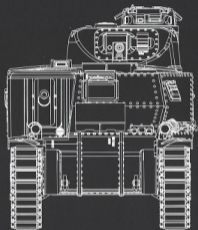

You can find TAKOM on Facebook.com