



Sopwith Triplane

ATTENTION * UPOZORNĚNÍ * ACHTUNG * ATTENTION * 注意



Carefully read instruction sheet before assembling. When you use glue or paint, do not use near open flame and use in well ventilated room. Keep out of reach of small children. Children must not be allowed to suck any part, or pull vinyl bag over the head.



Von dem Zusammensetzen die Bauanleitung gut durchlesen. Kleber und Farbe nicht nahe von offenem Feuer verwenden und das Fenster von Zeit zu Zeit Belüftung öffnen. Bausatz von kleinen Kindern fernhalten. Verhüten Sie, daß Kinder irgendwelche Bauteile in den Mund nehmen oder Plastiktüten über den Kopf ziehen.



lire soigneusement la fiche d'instructions avant d'assembler. Ne pas utiliser de colle ou de peinture à proximité d'une flamme nue, et aérer la pièce de temps en temps. Garder hors de portée des enfants en bas âge. Ne pas laisser les enfants mettre en bouche ou sucer les pièces, ou passer un sachet vinyl sur la tête.



Před započatím stavby si pečlivě prostudujte stavební návod. Při používání barev a lepidel pracujte v dobře větrané místnosti. Lepidla ani barvy nepouívejte v blízkosti otevřeného ohně. Model není určen malým dětem, mohlo by dojít k poí drobných dílů.



組み立てる前に必ず説明書をお読み下さい。接着剤や塗料をご使用の際は、窓を開けて十分な換気をおこない、火のそばでは使用しないで下さい。小さな子供の手の届かない所に必ず保管してください。部品や破片を囓んだり、なめたり、飲んだりすると大変危険です。又、部品を取り出した後のビニール袋は、小さな子供が頭から被ったりすると窒息する恐れがありますので、破り捨てて下さい。

INSTRUKTION SIGNS * INSTR. SYMBOLY * INSTRUKTION SINNBILDEN * SYMBOLES * 記号の説明



OPTIONAL
FACULTATIF
NACH BELIEBEN
VOLBA
選択する



BEND
PLIER SIL VOUS PLAIT
BITTE BIEGEN
OHNOUT
折る



OPEN HOLE
FAIRE UN TROU
OFFNEN
VYVRTAT OTVOR
穴を開ける



SYMMETRICAL ASSEMBLY
MONTAGE SYMÉTRIQUE
SYMMETRISCHE AUFBAU
SYMMETRICKÁ MONTÁ
左右均等に組み立てる



NOTCH
L INCISION
DER EINSCHNITT
ZÁŘEZ
切る



REMOVE
RETIRER
ENTFERNEN
ODŘÍZNOUT
移す



APPLY EXPRESS MASK
AND PAINT BEFORE
GLUING
POUÍT EXPRESS MASK
NABARVIT PŘED SLEPENÍM

| GUNZE | | APPROXIMATE COLOR MATCH | | | | |
|----------------|----------|---|--------|---------|--------|---------|
| AQUEOUS | Mr.COLOR | | TAMIYA | HUMBROL | REVELL | TESTORS |
| H 2 | 2 | BLACK / SCHWARTZ / NOIR / ČERNÁ | X 1 | 21 | 7 | 1747 |
| H 3 | 3 | RED / ROT / ROUGE / ČERVENÁ | X 8 | 69 | 12 | 1514 |
| H 5 | 5 | BLUE / BLAU / BLEU / MODRÁ | X 3 | 15 | 54 | |
| H 8 | 8 | SILVER / SILBER / ARGENT / STŘÍBRNÁ | X 11 | 11 | 90 | 1546 |
| H 18 | 28 | STEEL / STAHL / ACIER / OCEL | X 502 | 27003 | 91 | 1402 |
| H 37 | 43 | WOOD BROWN / HOLZ / BOIS / DŘEVO | XF 55 | 110 | 88 | 2021 |
| H 53 | 13 | GREY / GRAU / GRIS / ŠEDÁ | | 128 | 374 | 1741 |
| H 64 | 17 | DARK GREEN / DUNKELGRÜN / VERT FONCÉ / TMAVĚ ZELENÁ | XF 13 | 111 | | 1710 |
| H 84 | 131 | BROWN / BRAUN / BRUN / HNĚDÁ | XF 10 | 98 | | |
| H 85 | 45 | CLEAR DOPED LINNEN / LINNEN / TOILE / PLÁTNO | | 71 | 314 | |
| H 309 | 309 | GREEN / GRÜN / VERT / ZELENÁ | XF 13 | 116 | | 1710 |
| Mr.METAL COLOR | | | | | | |
| MC214 | | DARK IRON / DUNKEL EISEN / KOV. ČERNÁ | X 10 | 53 | | 1795 |

<A>

PLASTIC PARTS

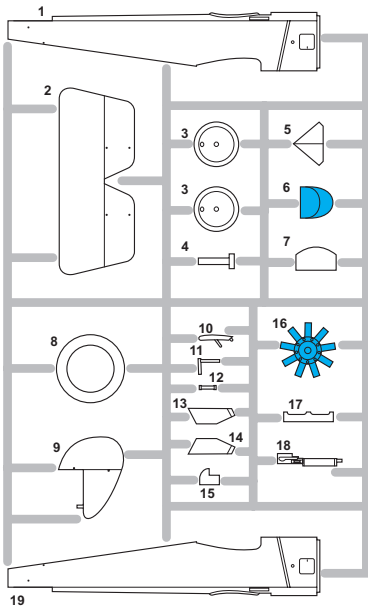

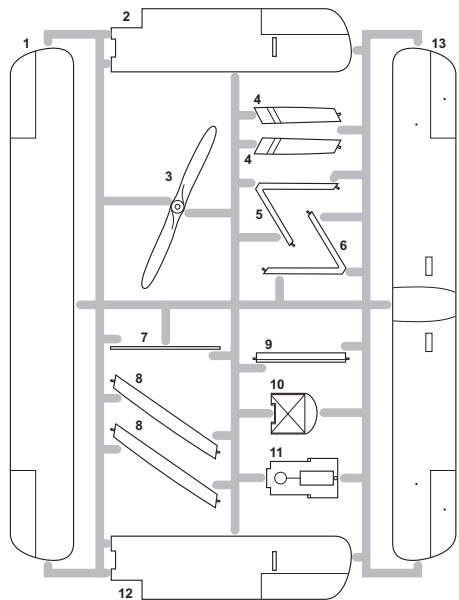

RP - RESIN PARTS

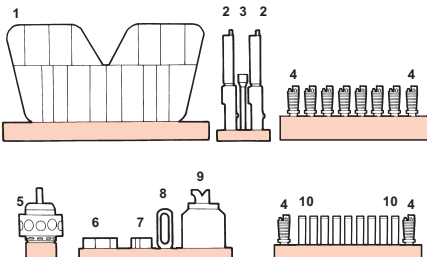

FILM



PE - PHOTO ETCHED DETAIL PARTS

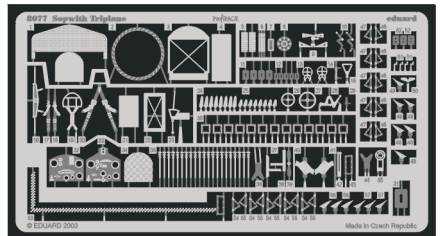

1

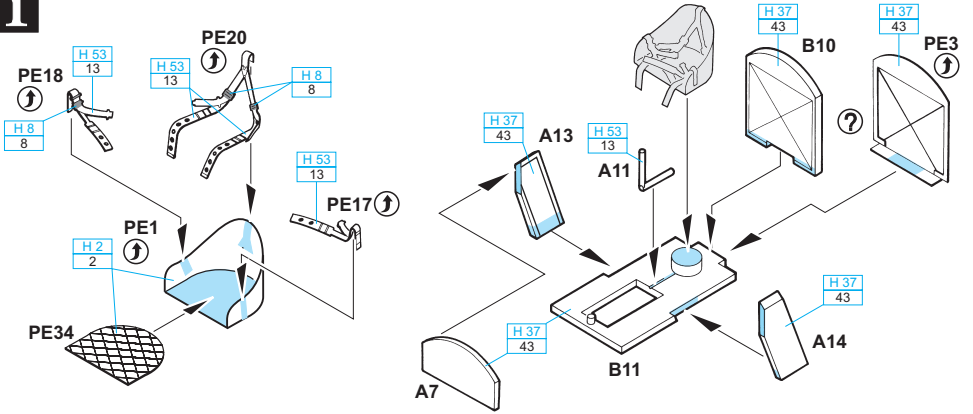

MARKING A; B; D

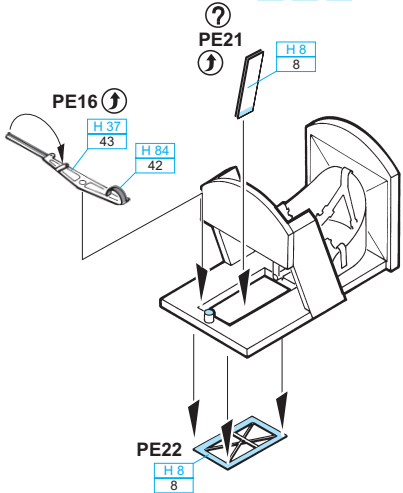

MARKING C **DECAL 23** **MARKING A; B; D**
FILM C

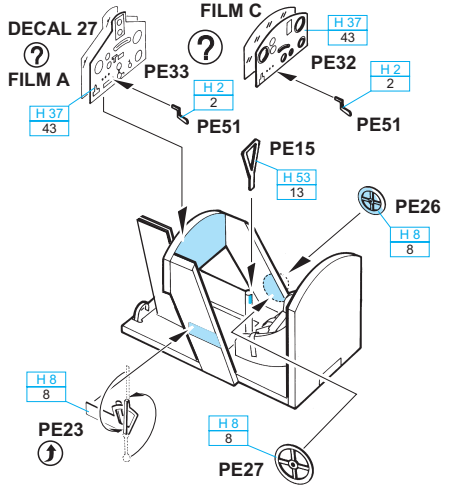

MARKING A; B; D

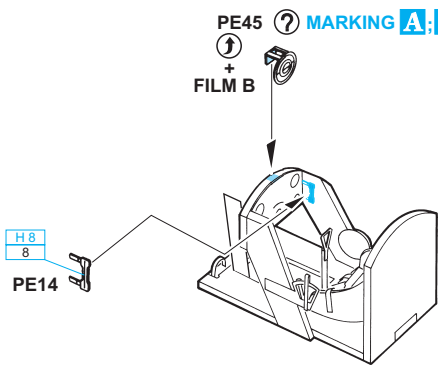

MARKING C

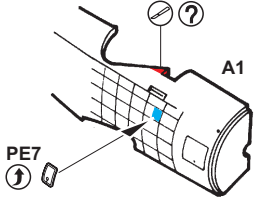

MARKING C 2mm

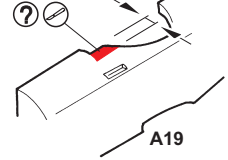

2

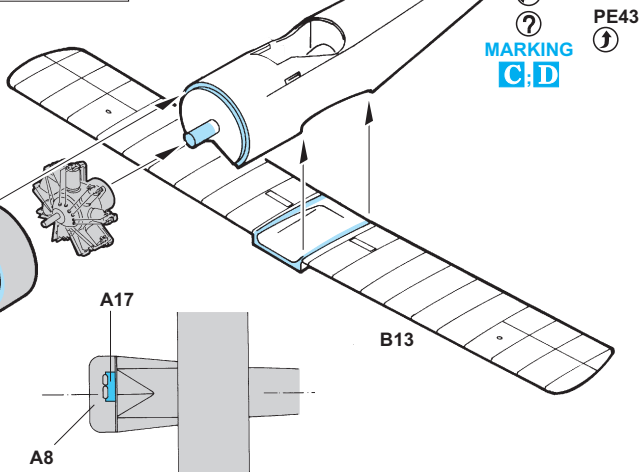
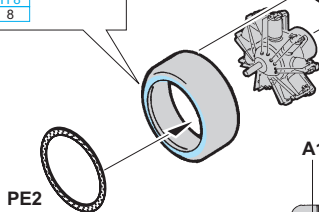
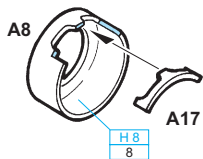
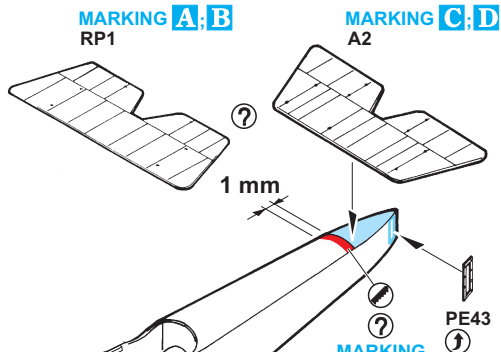
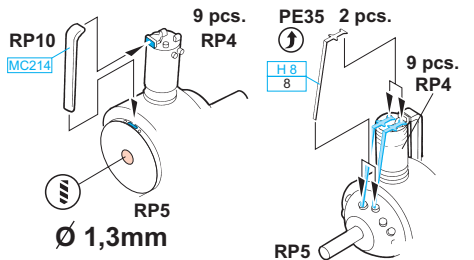
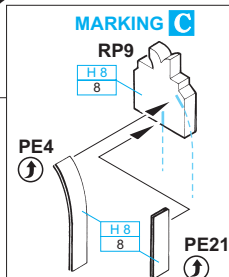
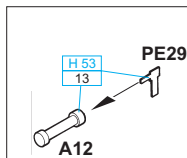
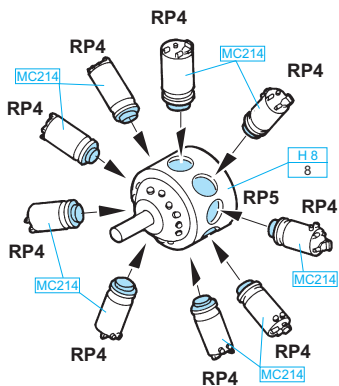
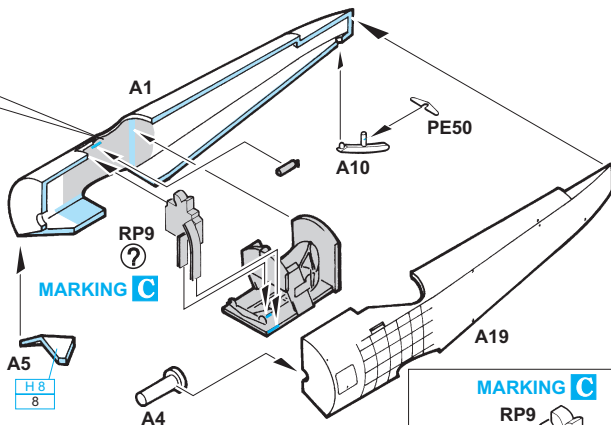
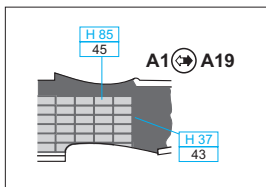

4

3

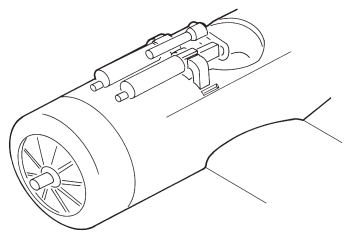
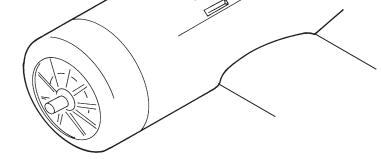
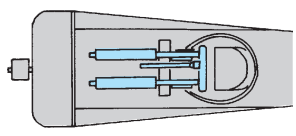
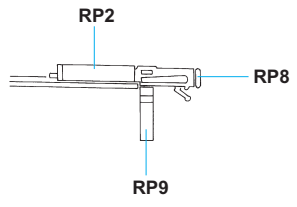
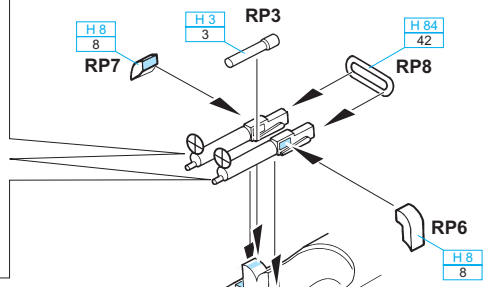
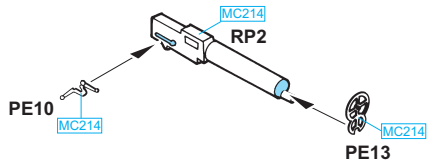

MARKING C



MARKING A; B; D

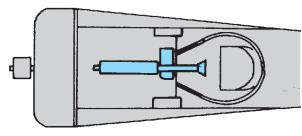
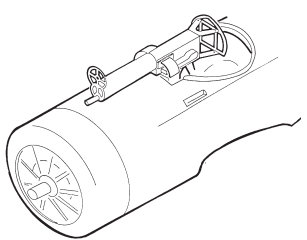
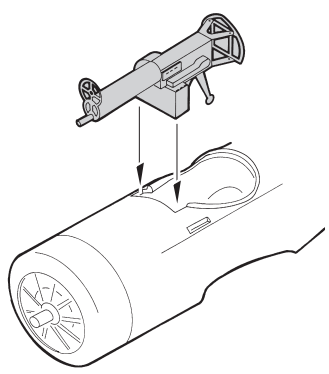
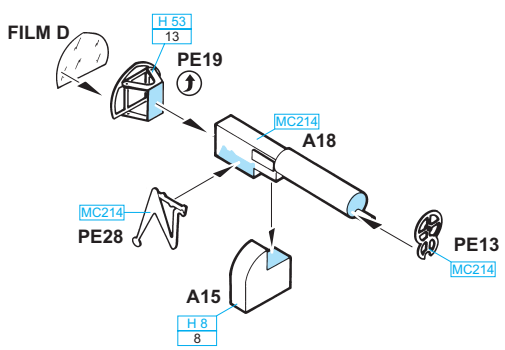

4

A MARKING A; B; D

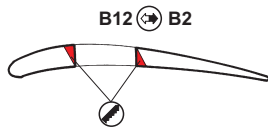
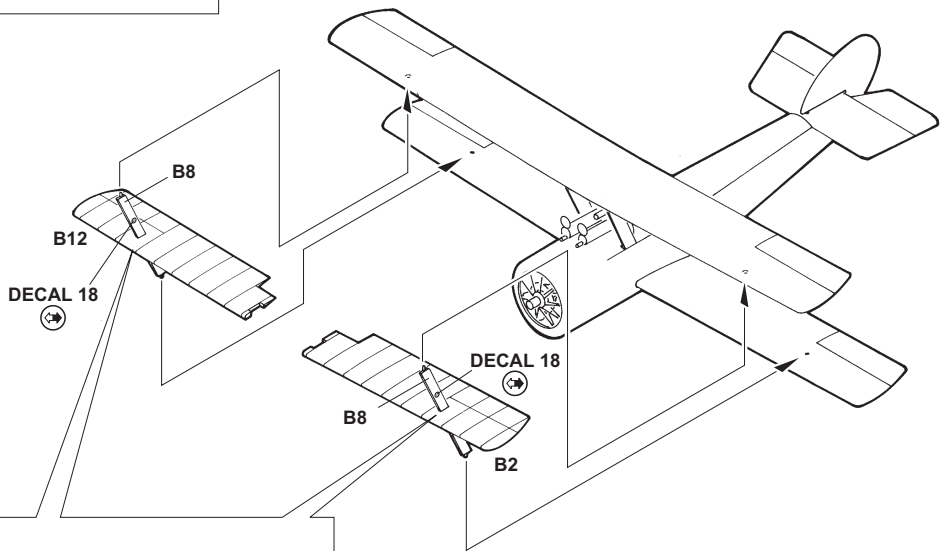
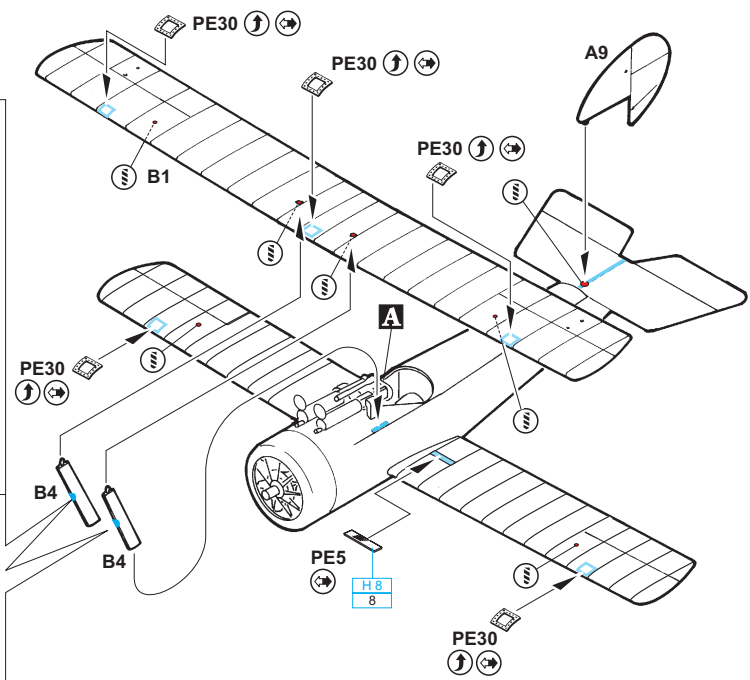
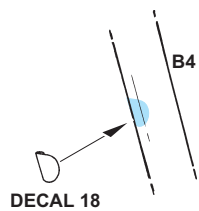
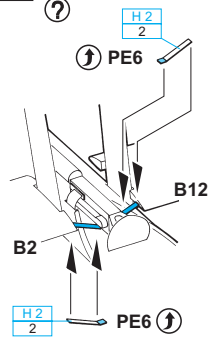

6

5

MARKING **A; B; D**

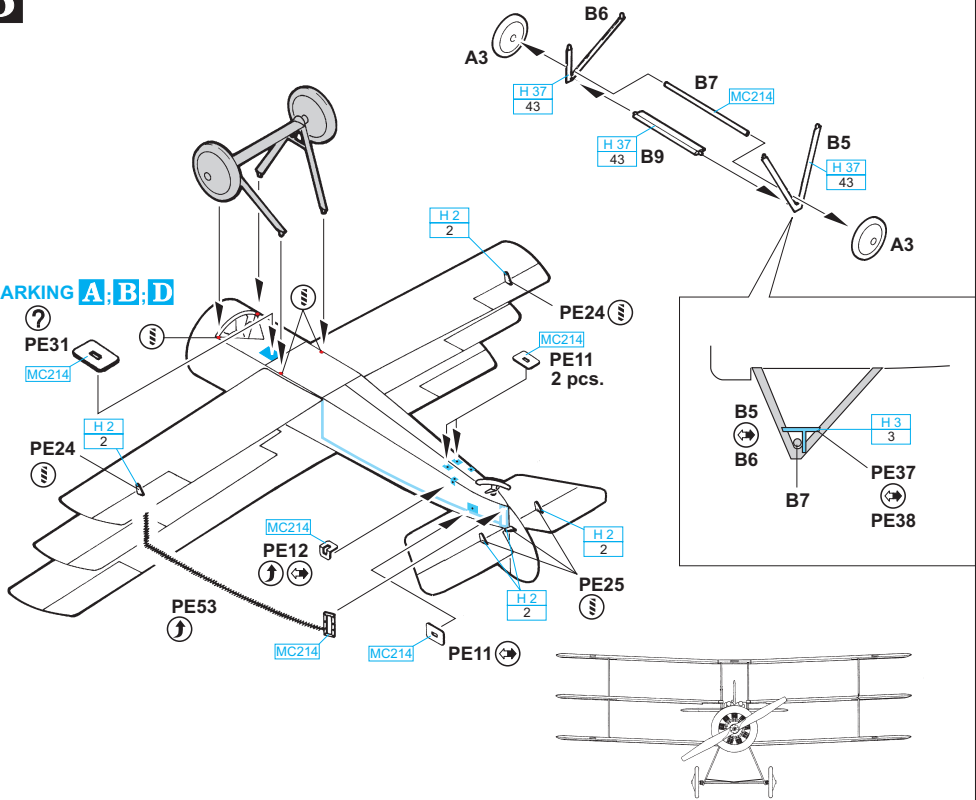

6

B

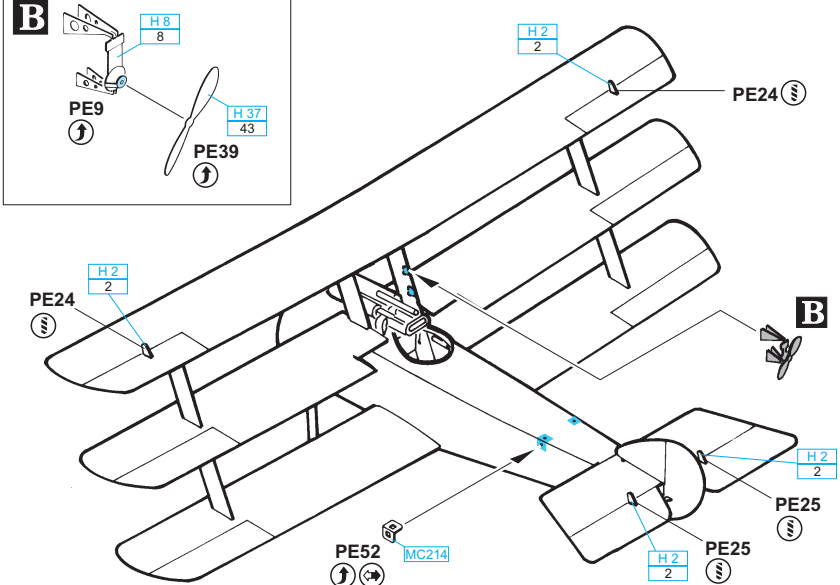

7

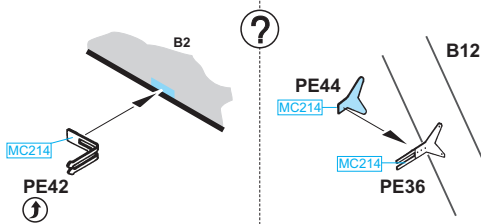
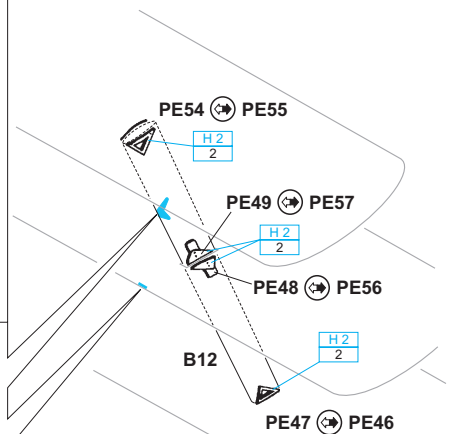
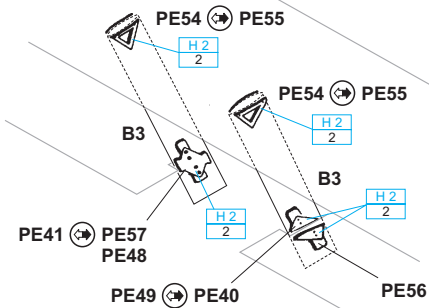
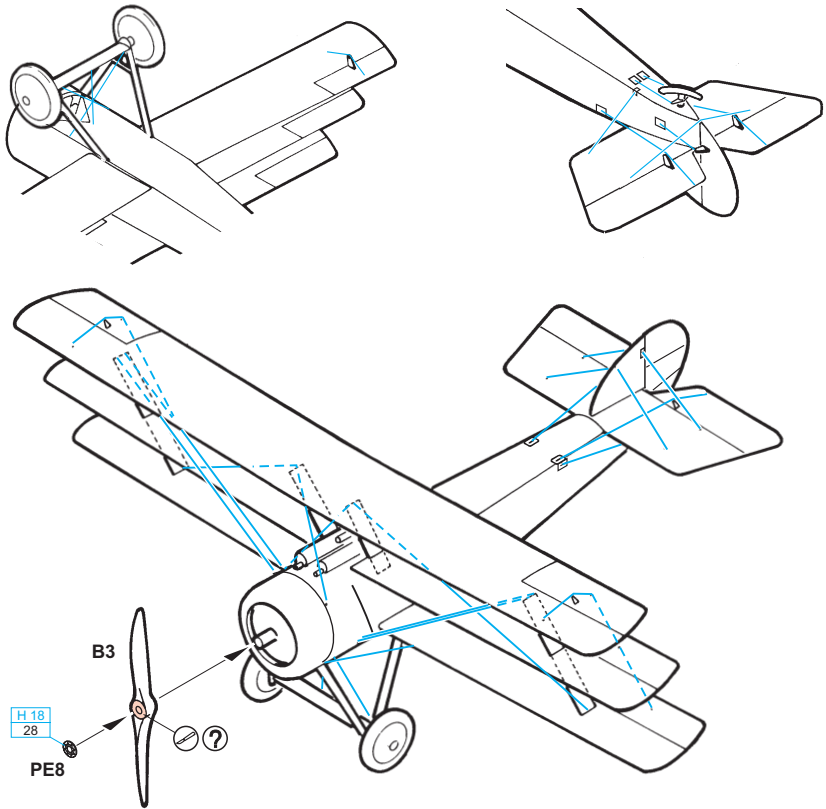

* MARKING & PAINTING * MARKIERUNGEN UND BEMALUNG *
 DECORATION ET PEINTURE * OZNAČENÍ A ZBARVENÍ *

A Sopwith Triplane N5459, 1 Naval Squadron, France 1917

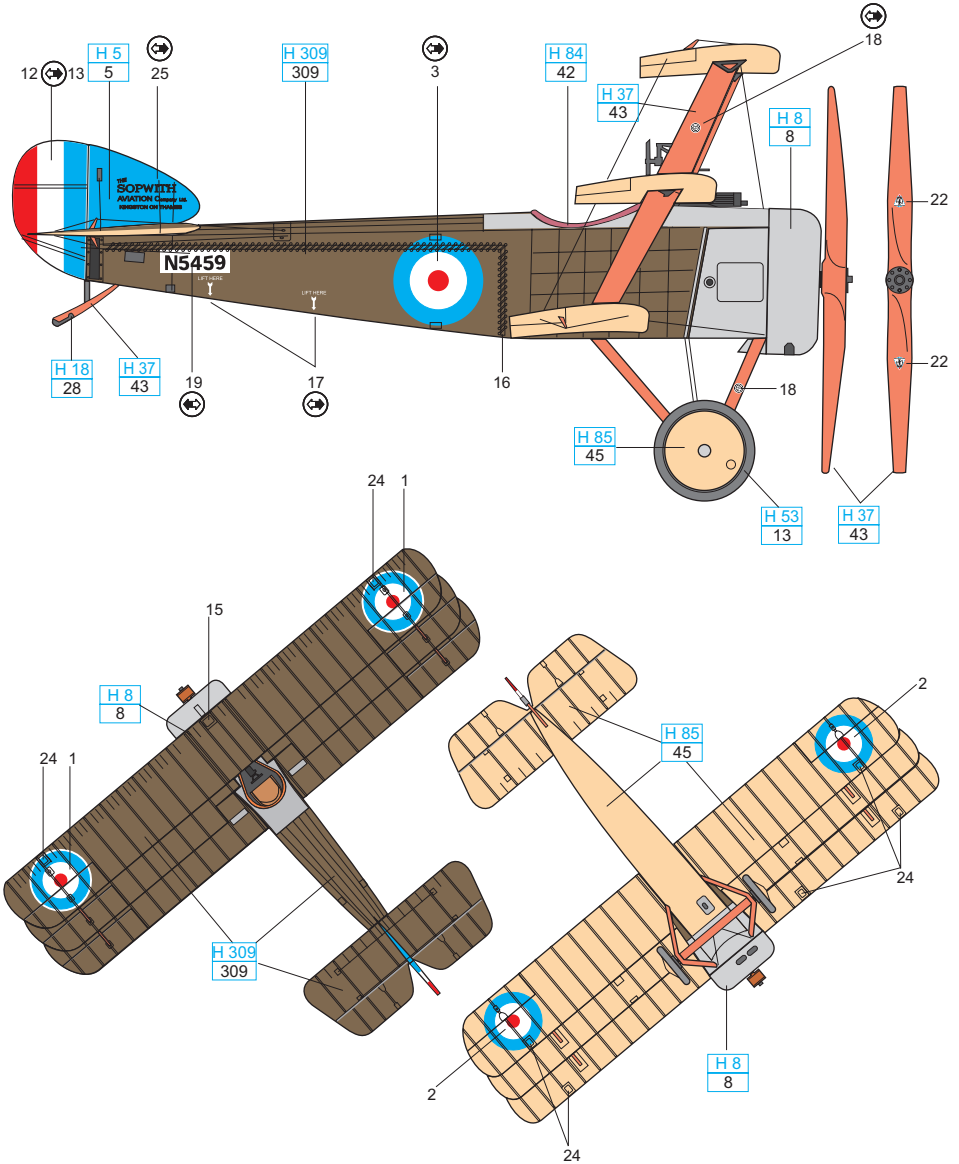

* MARKING & PAINTING * MARKIERUNGEN UND BEMALUNG *
 DECORATION ET PEINTURE * OZNAČENÍ A ZBARVENÍ *

B Sopwith Triplane N5377 1 Naval Squadron, France 1917

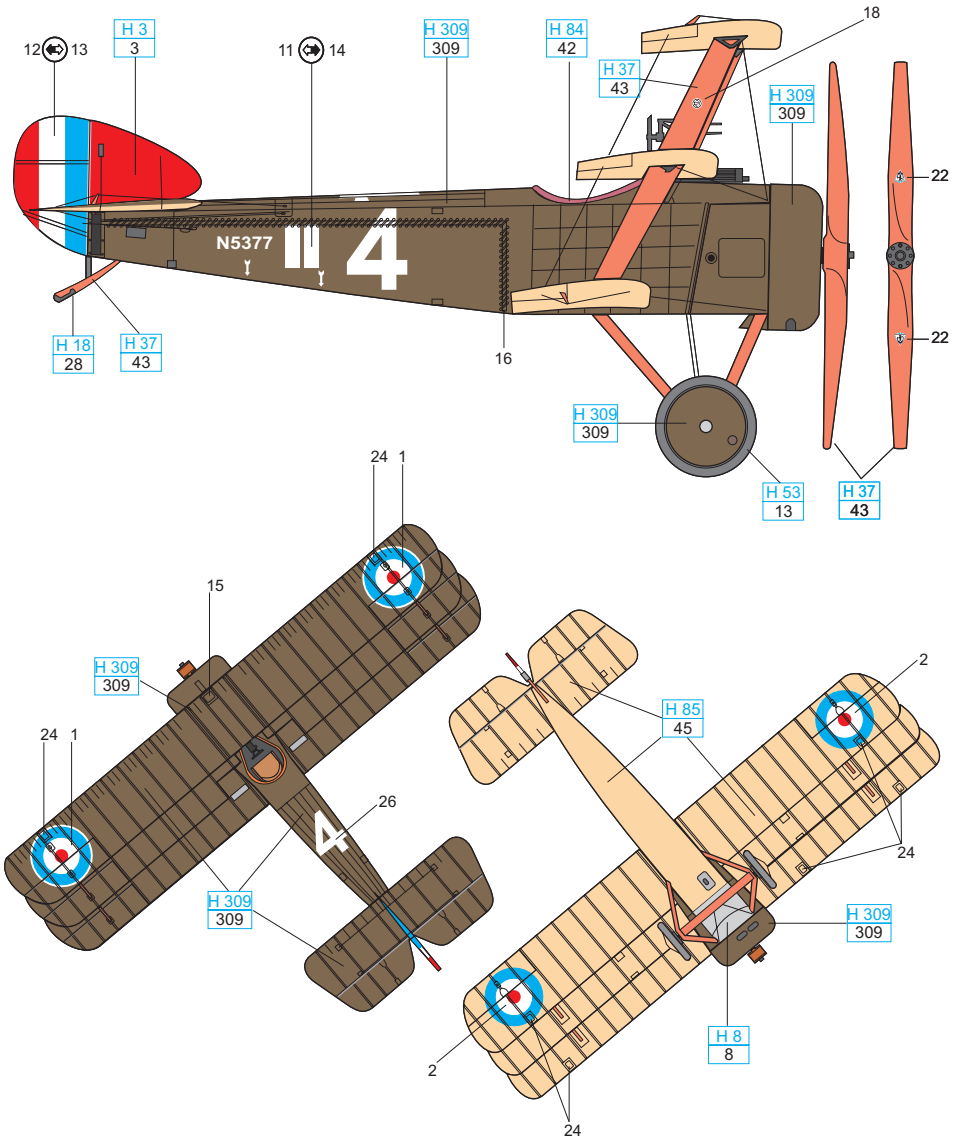

H 309
309

H 37
43

H 85
45

C Sopwith Triplane N534 1917

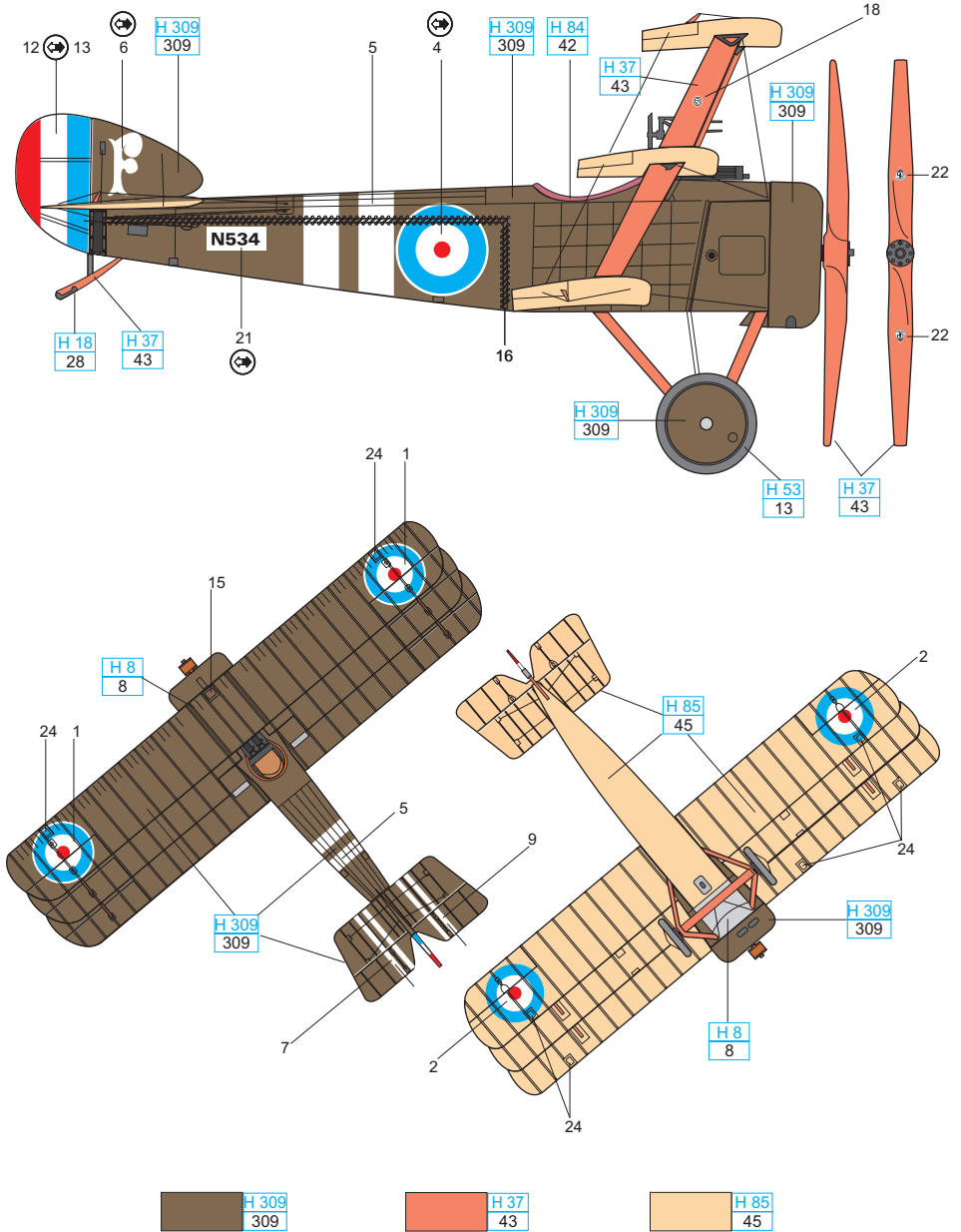

* MARKING & PAINTING * MARKIERUNGEN UND BEMALUNG *
 DECORATION ET PEINTURE * OZNAČENÍ A ZBARVENÍ *

D Sopwith Triplane N5493 July 1917

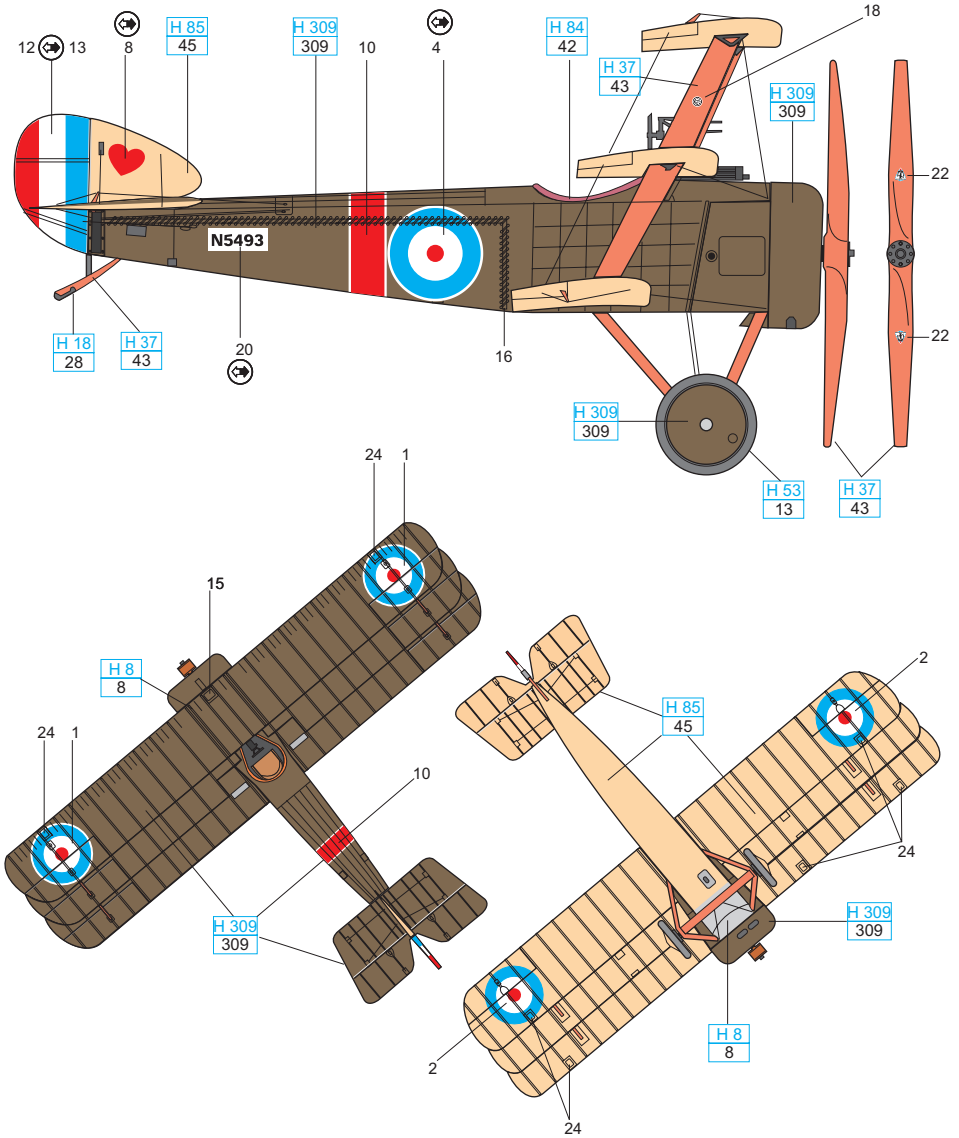

| | | | | | |
|--|--------------|--|------------|--|------------|
| | H 309 309 | | H 37 43 | | H 85 45 |
|--|--------------|--|------------|--|------------|