



Me 410B

eduard

49 338

1/48 scale detail set for Revell/Monogram kits • sada detailů pro model 1/48 Revell/Monogram

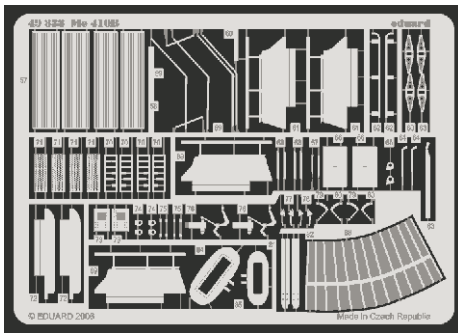
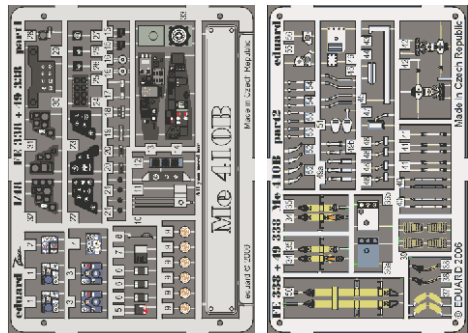

- APPLY EXPRESS MASK AND PAINT BEFORE GLUING
POUŽÍT EXPRESS MASK NABARVIT PŘED SLEPENÍM
- SYMMETRICAL ASSEMBLY
SYMETRICKÁ MONTÁŽ
- REMOVE
ODSTRANIT
- GRIND
OBROUSIT
- DRILL HOLE
VRTAT OTVOR
- BEND
OHNOUT
- OPTION
VOLBA
- REPLACE
NAHRADIT

ORIGINAL KIT PARTS
PŮVODNÍ DÍLY STAVEBNICE

PHOTO-ETCHED PARTS
LEPTANÉ DÍLY

PARTS TO BE REMOVED
DÍLY K ODSTRANĚNÍ

FILL
TMELIT

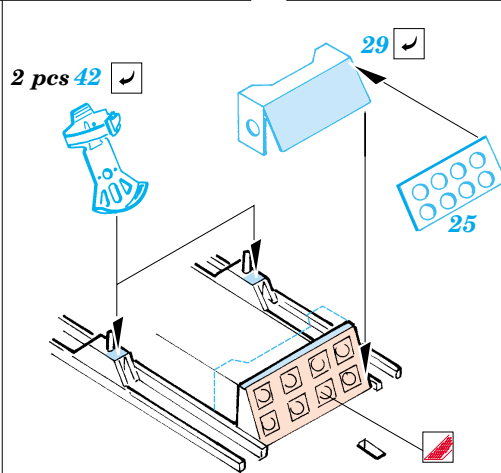
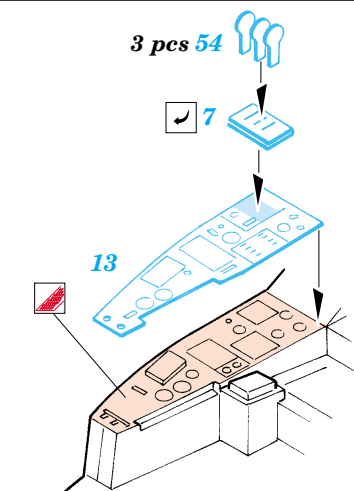
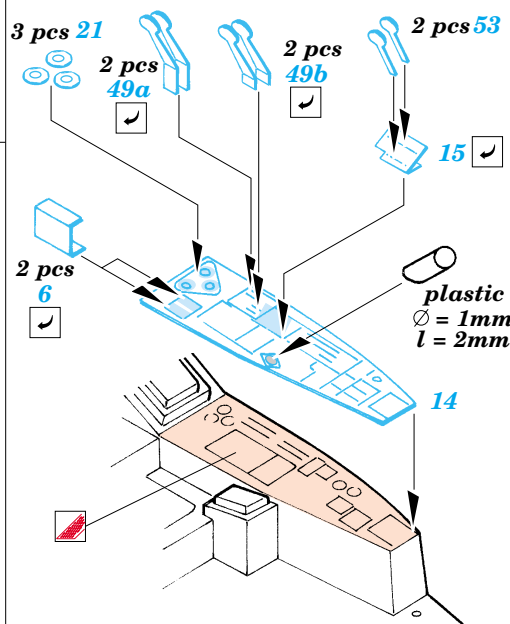
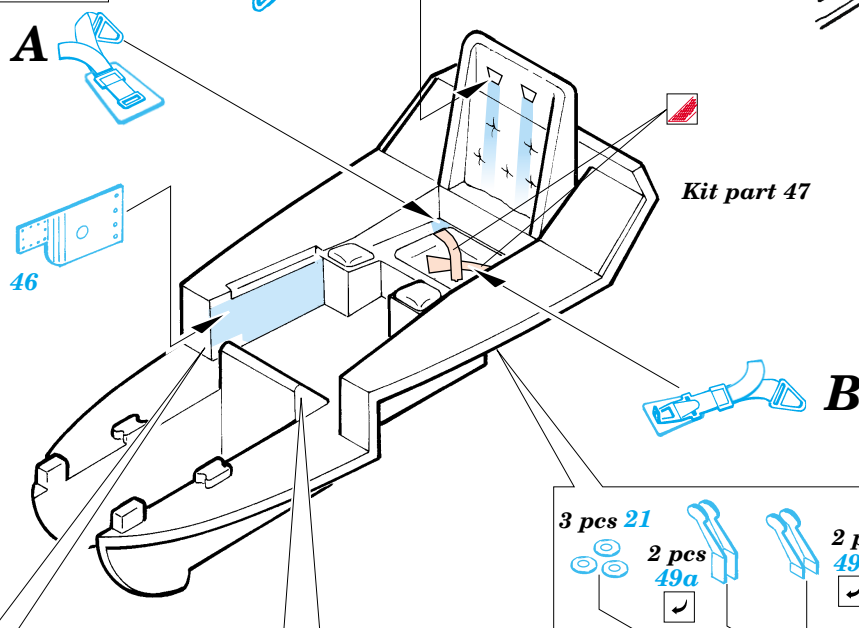
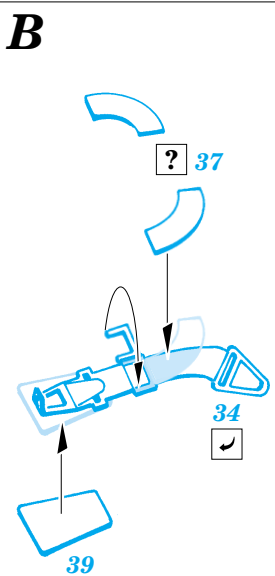
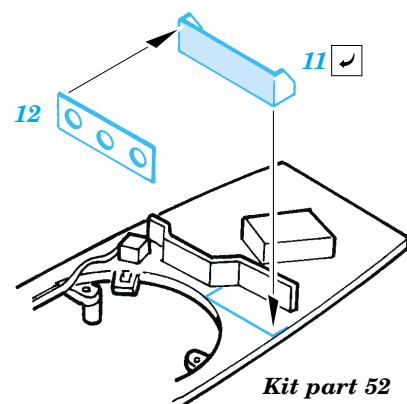
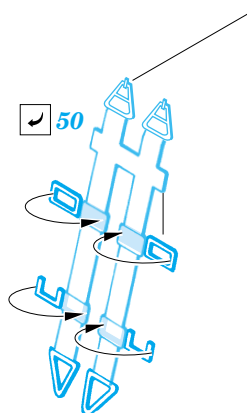
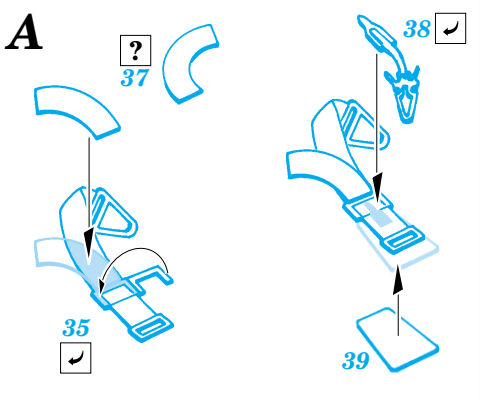

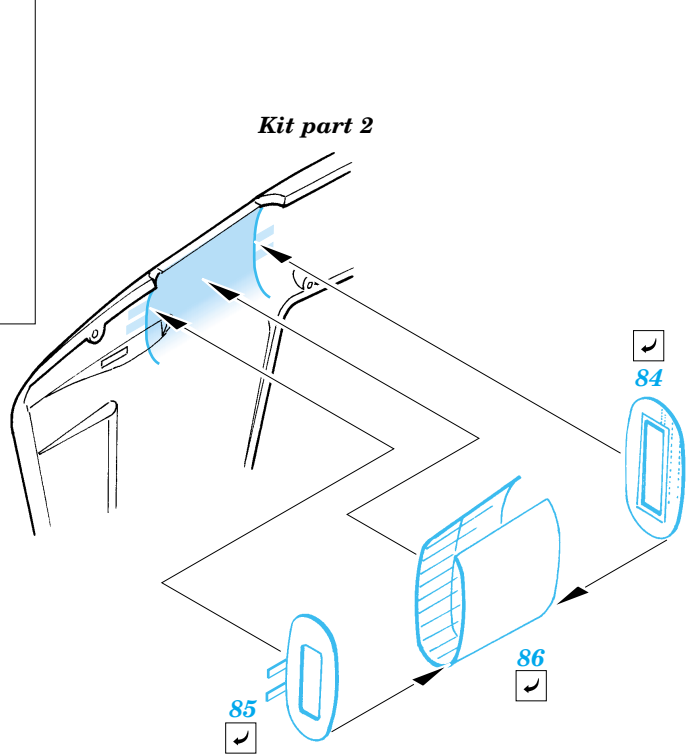
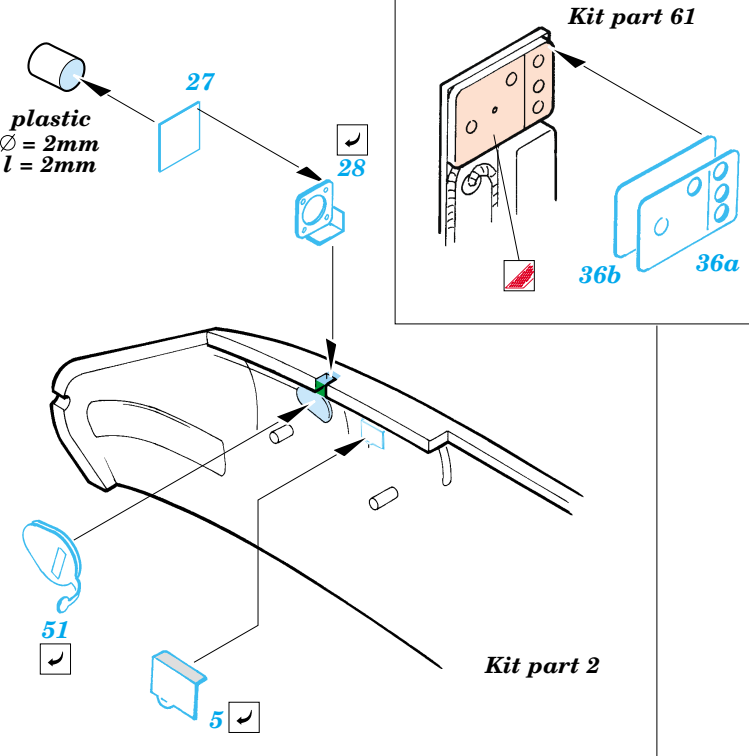
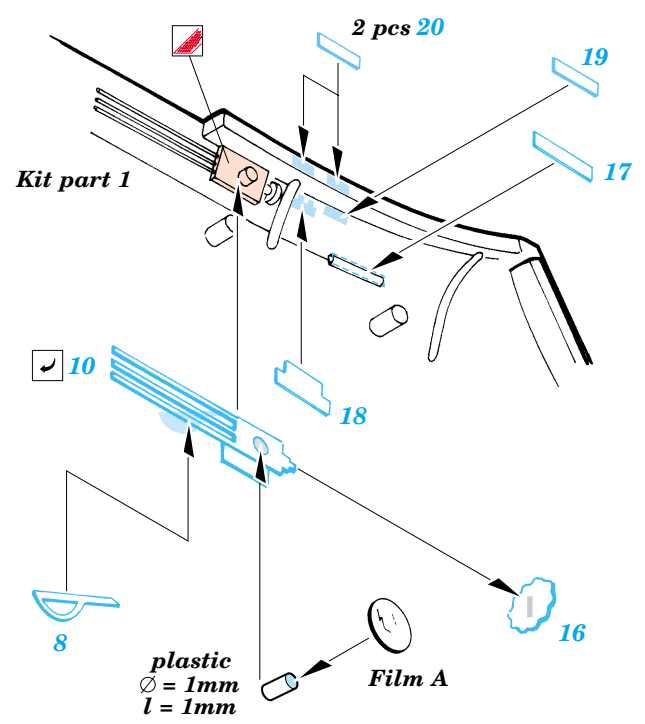
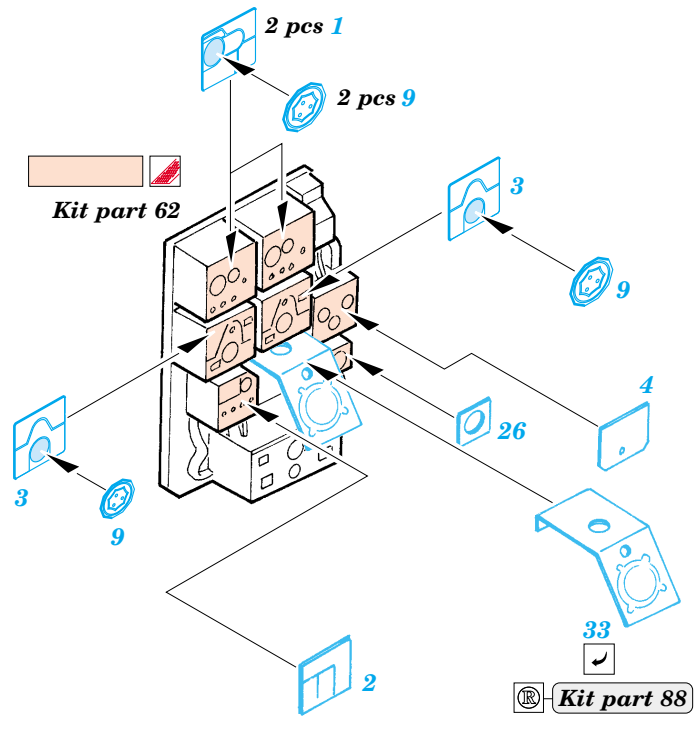
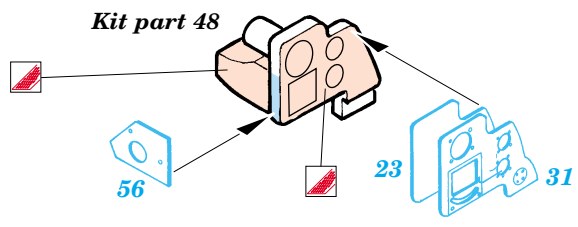
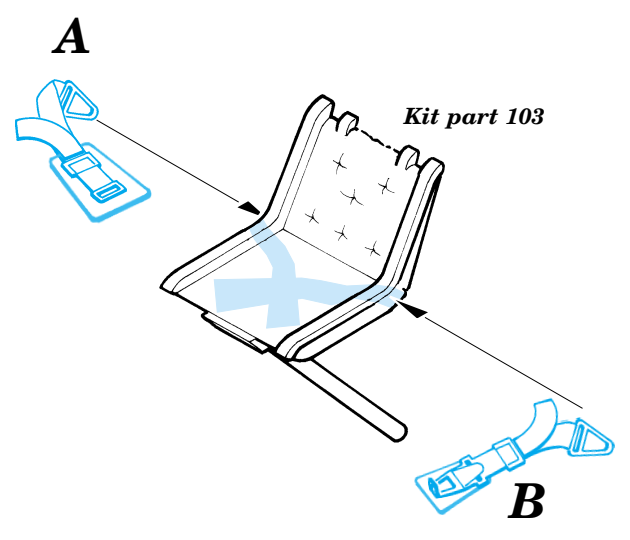
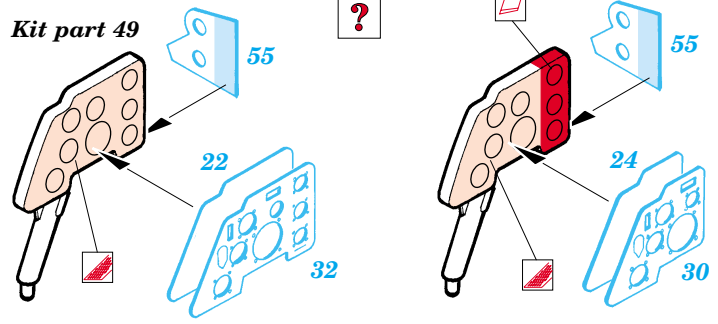

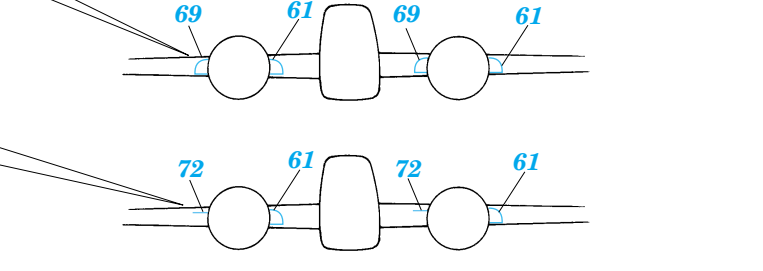
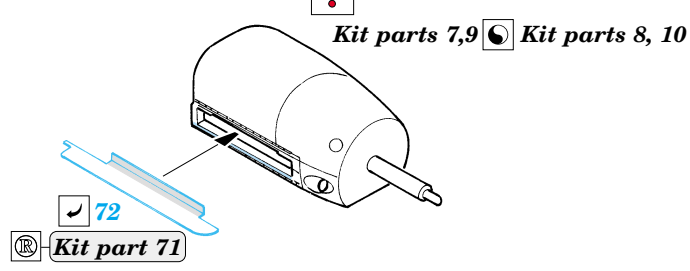
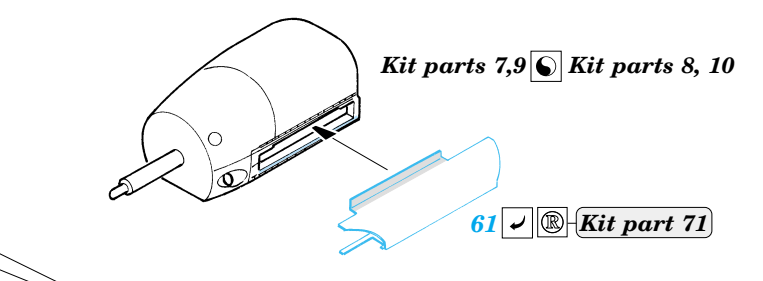
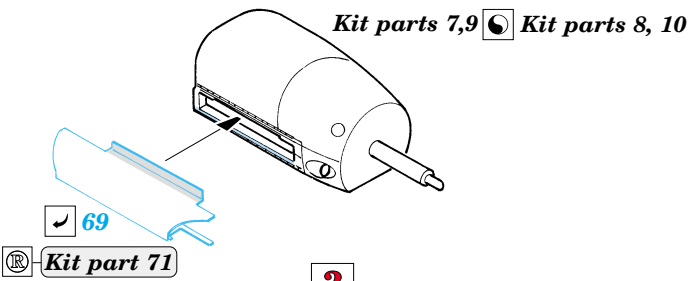
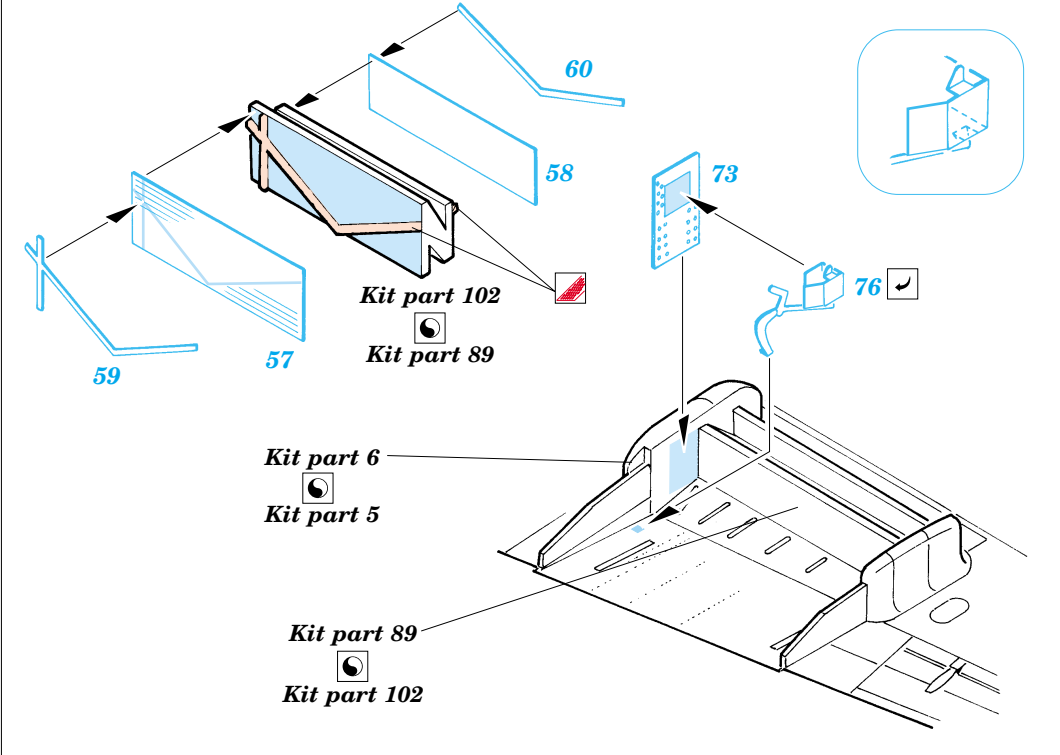
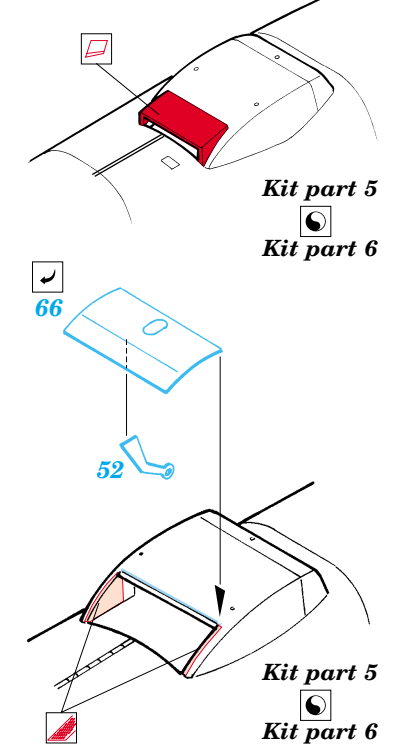
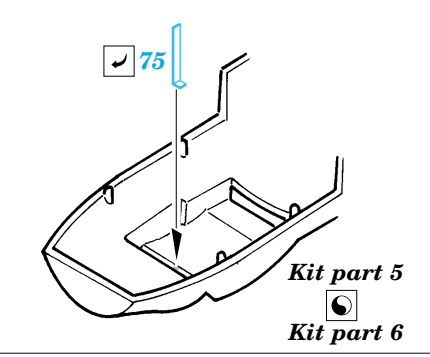
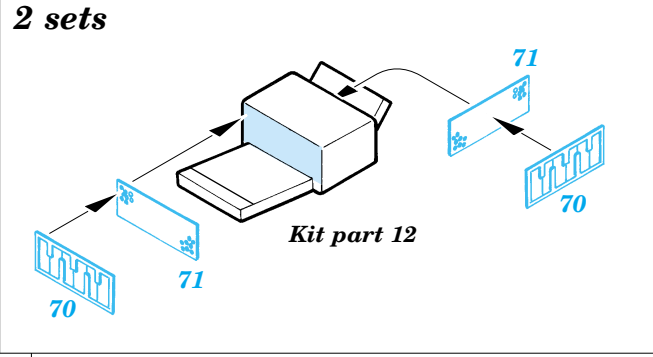
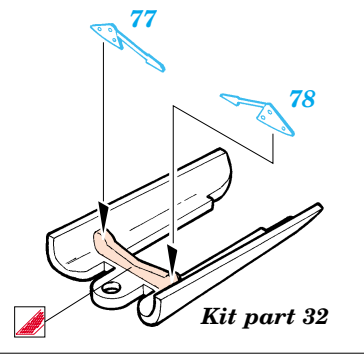
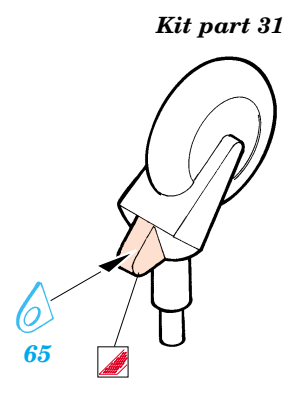
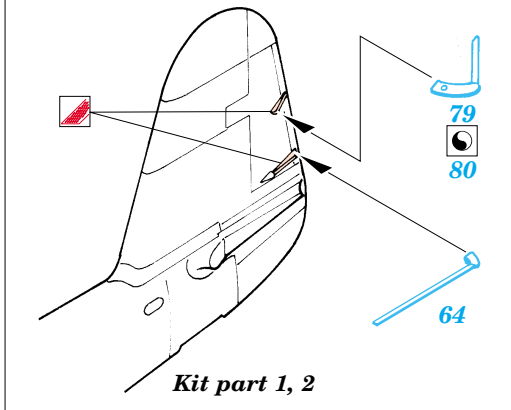
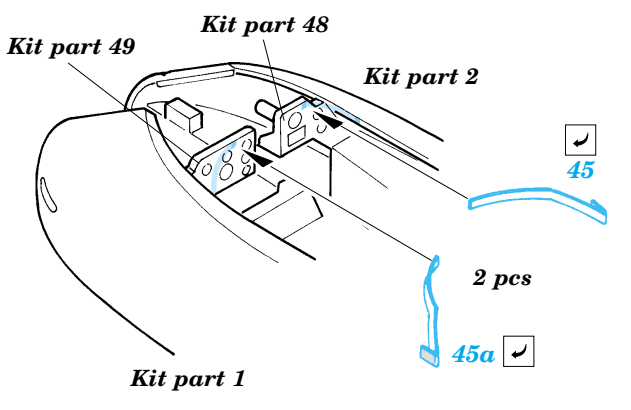

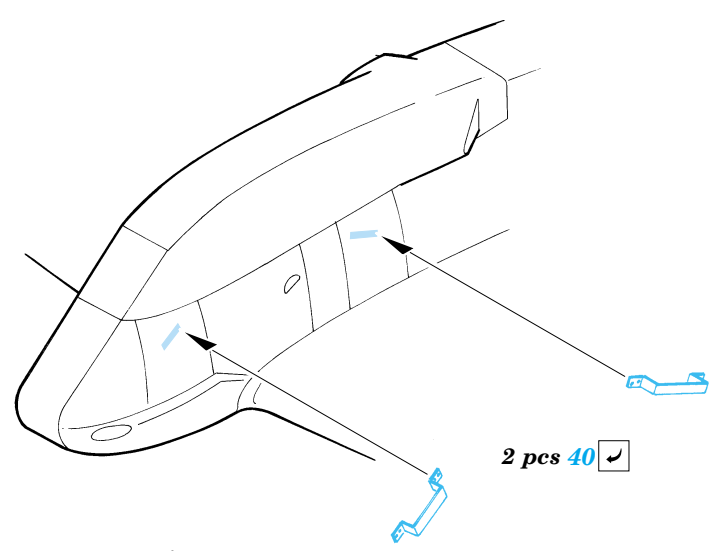
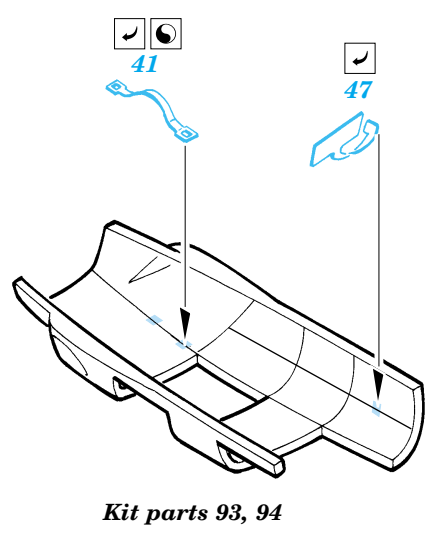
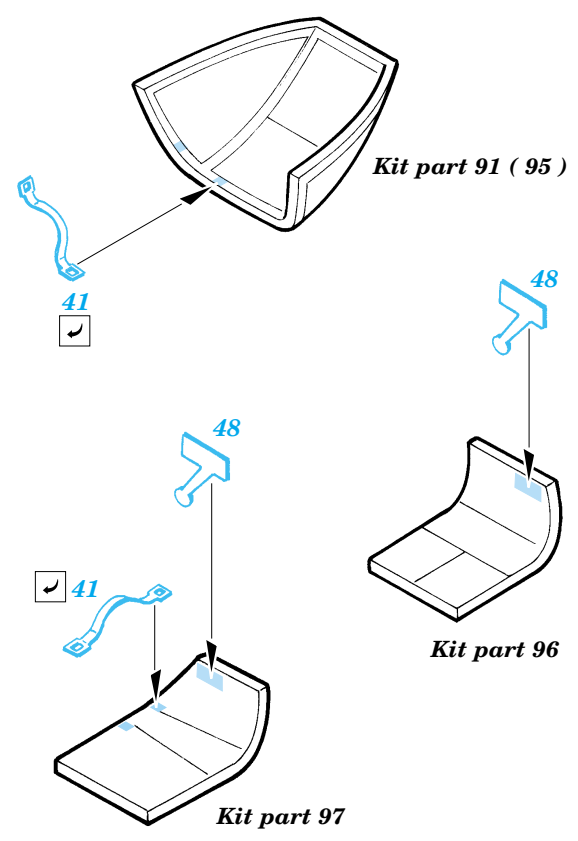
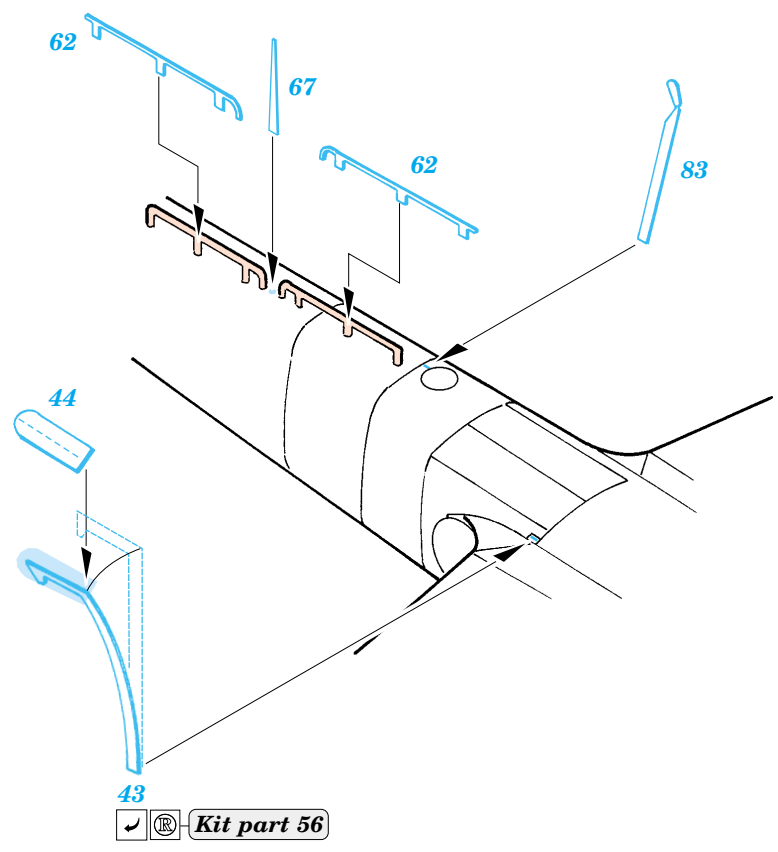
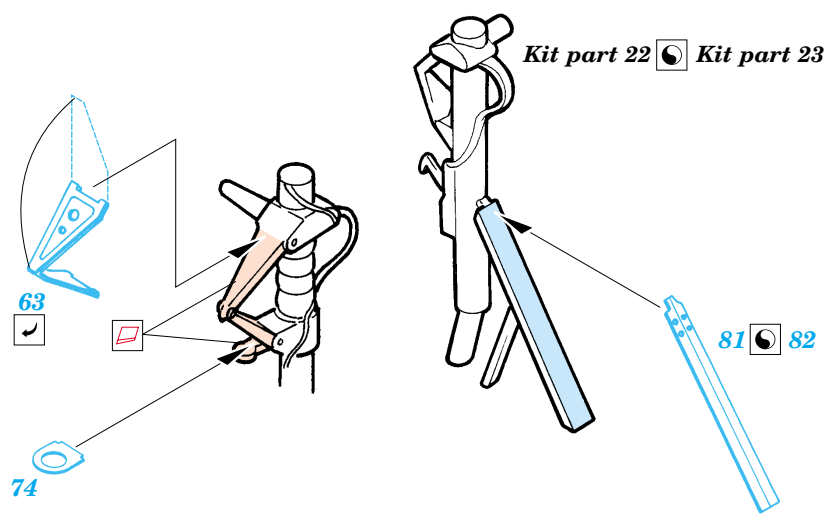
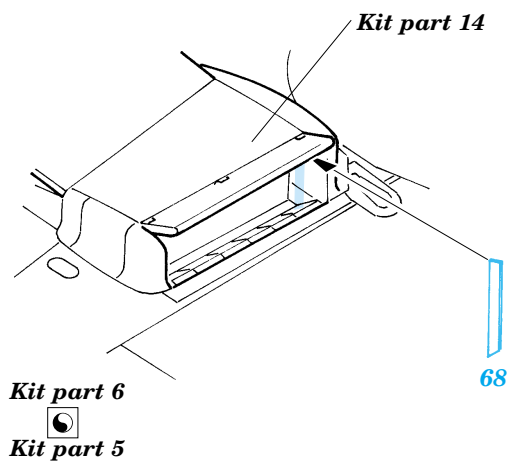

References: - WWP In Detail Spec. No.1 : Me 210/410
 - Squadron/Signal No.1147 : Me 210/410 in action
 - Replic No.63 11/1996