

'69 Dodge Charger

The Dodge Charger debuted in 1966 as Dodge attempted to capitalize on the fastback craze of the mid sixties. The fastback Ford Mustangs and Plymouth Barracudas were selling well, so Dodge plunked a fastback roof onto its mid-size Coronet and called it the Charger. The Charger sold reasonably well for '66 and '67, but sales skyrocketed in 1968, thanks to stylist William Brownlie's spectacular redesign. The fastback shape evolved into a handsome "coke-bottle" profile, with sculptured scoops in the doors and hood, and rakish "flying buttress" C-pillars that flanked a recessed rear window. Changes were minimal for '69- the '68's dual round taillights were replaced with two elongated lenses that covered most of the rear panel, and the broad grille opening was now split in the center by a louvered vertical divider bar.

Your Revell Monogram model represents a '69 Dodge Charger R/T equipped with the standard 375-horsepower 440 Magnum engine. The body features a vinyl top, separate racing-style gas cap, and a choice of red, white, or black "bumblebee" R/T stripes. The fully detailed chassis features poseable front steering and a detailed engine compartment with separate underhood components. Enjoy building your kit of this musclecar favorite!

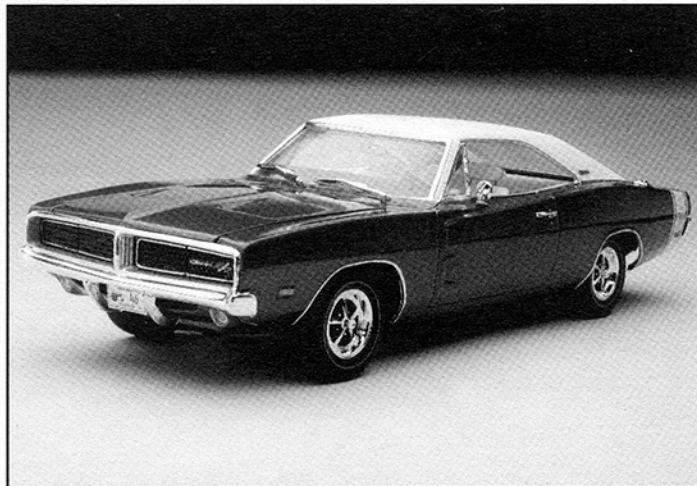

* REPEAT SEVERAL TIMES
* A REPETER PLUSIEURS FOIS



* OPTIONAL PARTS
* PIECES EN OPTION



* DECAL
* DECAL COMANIE



* ALTERNATIVE ASSEMBLY
* ENSEMBLAGE ALTERNATIVE



* CEMENT TOGETHER
* A COLLER



* REMOVE AND THROW AWAY
* A RETIRER ET JETER



* DO NOT CEMENT
* NE PAS COLLER

READ THIS BEFORE YOU BEGIN

- * Study the assembly drawings.
- * Each plastic part is identified by a number.
- * In the assembly drawings, some parts will be marked by a star (★) to indicate chrome plated plastic.
- * For better paint and decal adhesion, wash the plastic parts in a mild detergent solution. Rinse and let air dry.
- * Check the fit of each piece before cementing in place.
- * Use only cement for polystyrene plastic.
- * Scrape plating and paint from areas to be cemented.
- * Allow paint to dry thoroughly before handling parts.
- * Any unused parts may be discarded.

DECAL APPLICATION INSTRUCTIONS

(If Applicable)

1. Cut desired decal from sheet.
2. Dip decal in water for a few seconds.
3. Place wet decal on paper towel.
4. Wait until decal is movable on paper backing.
5. Place decal in position on model, face up and slide backing away.
6. Press out air bubbles with a soft damp cloth.
7. Milkyness that may appear is for better decal adhesion and will dry clear. Wipe away any excess adhesive.
8. Do not touch decal until fully dry.
9. Allow the decals 48 hours to dry before applying clear coat.

LIRE CE QUI SUIV AVANT DE COMMENCER

- * Etudier les schémas de montage.
- * Chaque pièce en plastique est identifiée par un numéro.
- * Sur les schémas de montage, certaines pièces sont marquées d'une étoile (★) pour indiquer qu'elles sont en plastique chromé.
- * Pour une meilleure prise de la peinture et des autocollants, laver les pièces en plastique avec une solution détergente peu concentrée. Les rincer et les laisser sécher à l'air.
- * Vérifier que chaque pièce s'ajuste bien avant de la coller en place.
- * N'utiliser que de la colle pour polystyrène.
- * Gratter les parties à coller pour enlever le chrome et la peinture.
- * Laisser la peinture bien sécher avant de manipuler les pièces.
- * Toute pièce inutilisée peut être jetée.

DIRECTIVES D'APPLICATION DES AUTOCOLLANTS

1. Découper l'autocollant désiré de la feuille.
2. Tremper l'autocollant dans de l'eau pendant quelques secondes.
3. Placer l'autocollant mouillé sur une serviette en papier.
4. Attendez que l'autocollant puisse être déplacé sur son support en papier.
5. Mettre l'autocollant en position sur le modèle face sur le dessus et faire glisser le support pour l'enlever.
6. Appuyer avec un chiffon doux humide pour éliminer les bulles d'air.
7. La substance laiteuse qui peut apparaître est destinée à améliorer l'adhésion de l'autocollant et devient incolore au séchage. Essuyer pour enlever tout excédent d'adhésif.
8. Ne pas toucher l'autocollant tant qu'il n'est pas bien sec.
9. Laisser l'autocollant sécher pendant 48 heures avant d'appliquer une couche transparente.

This paint guide is provided to complete this kit as shown on the box.

Ce guide de peinture est fourni pour reproduire le modèle réduit qui apparaît sur la boîte.

Flat Black	Noir mat
Satin Black	Noir satiné
Chrysler Engine Red	Rouge moteur Chrysler
Aluminum	Aluminium
Steel	Acier
Gloss Medium Blue Metallic	Bleu moyen métallisé
Gloss Green	Vert brillant
Flat White	Blanc mat
Gloss Black	Noir lustré
Transparent Red	Rouge transparent
Turn Signal Amber	Ambré
Gunmetal	Bronze
Satin White	Blanc satiné
Tan	Havane

If you have any questions or comments, call our hotline at: **(800) 833-3570**
or, please write to:

Revell-Monogram Consumer Service Department, 8601 Waukegan Road, Morton Grove, Illinois 60053
Be sure to include the plan number (85254600200), part number, description, your return address and phone number.

Visit our website: www.revell-monogram.com

1

ENGINE ASSEMBLY

A

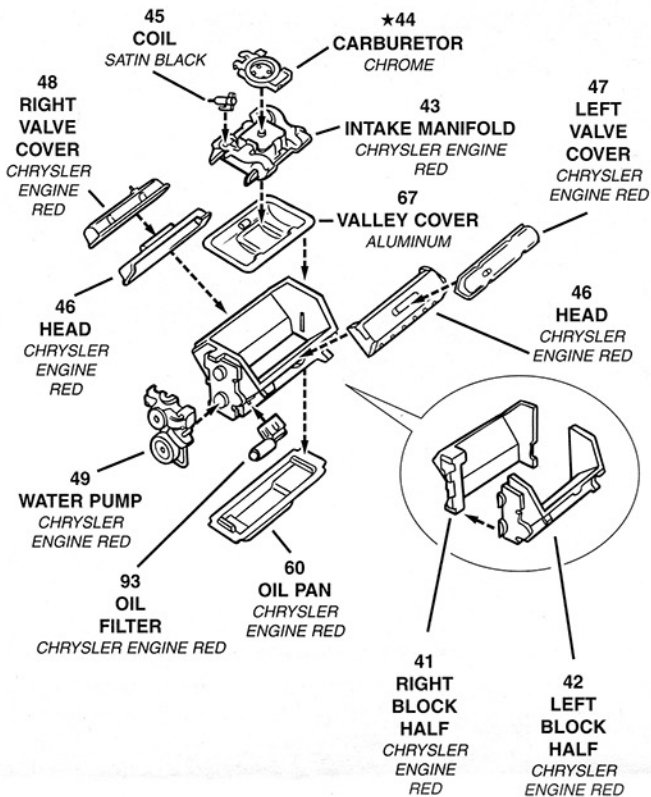

B

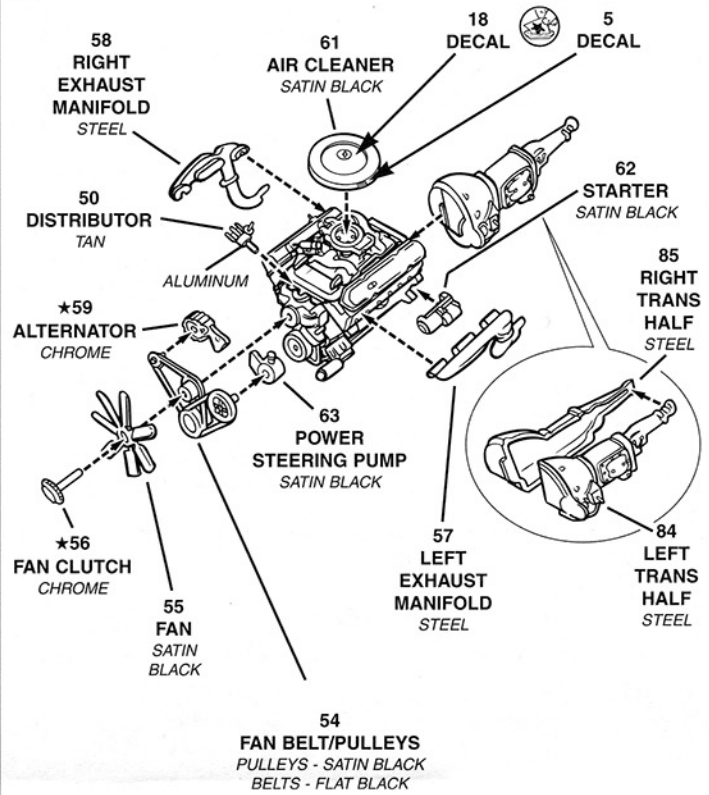

2

INTERIOR FLOOR ASSEMBLY

A

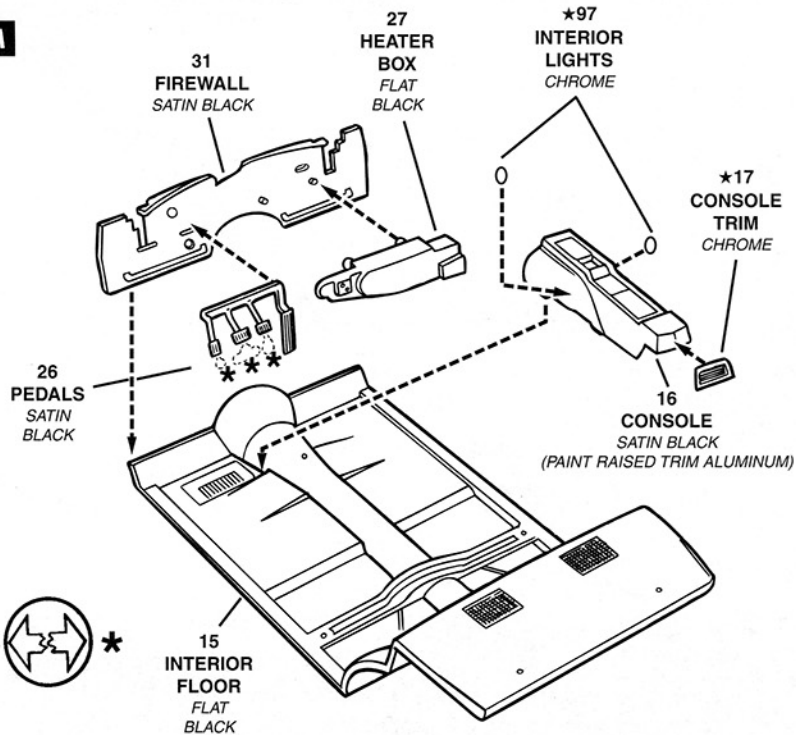

B

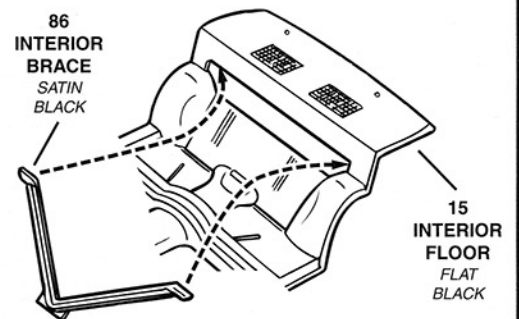

3

DASHBOARD ASSEMBLY

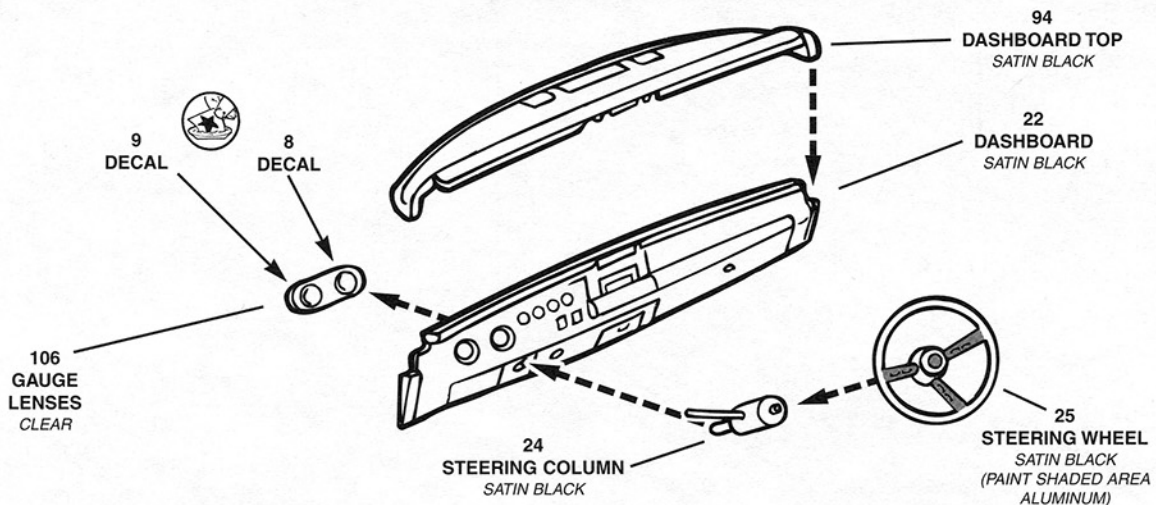

4

MAIN INTERIOR ASSEMBLY

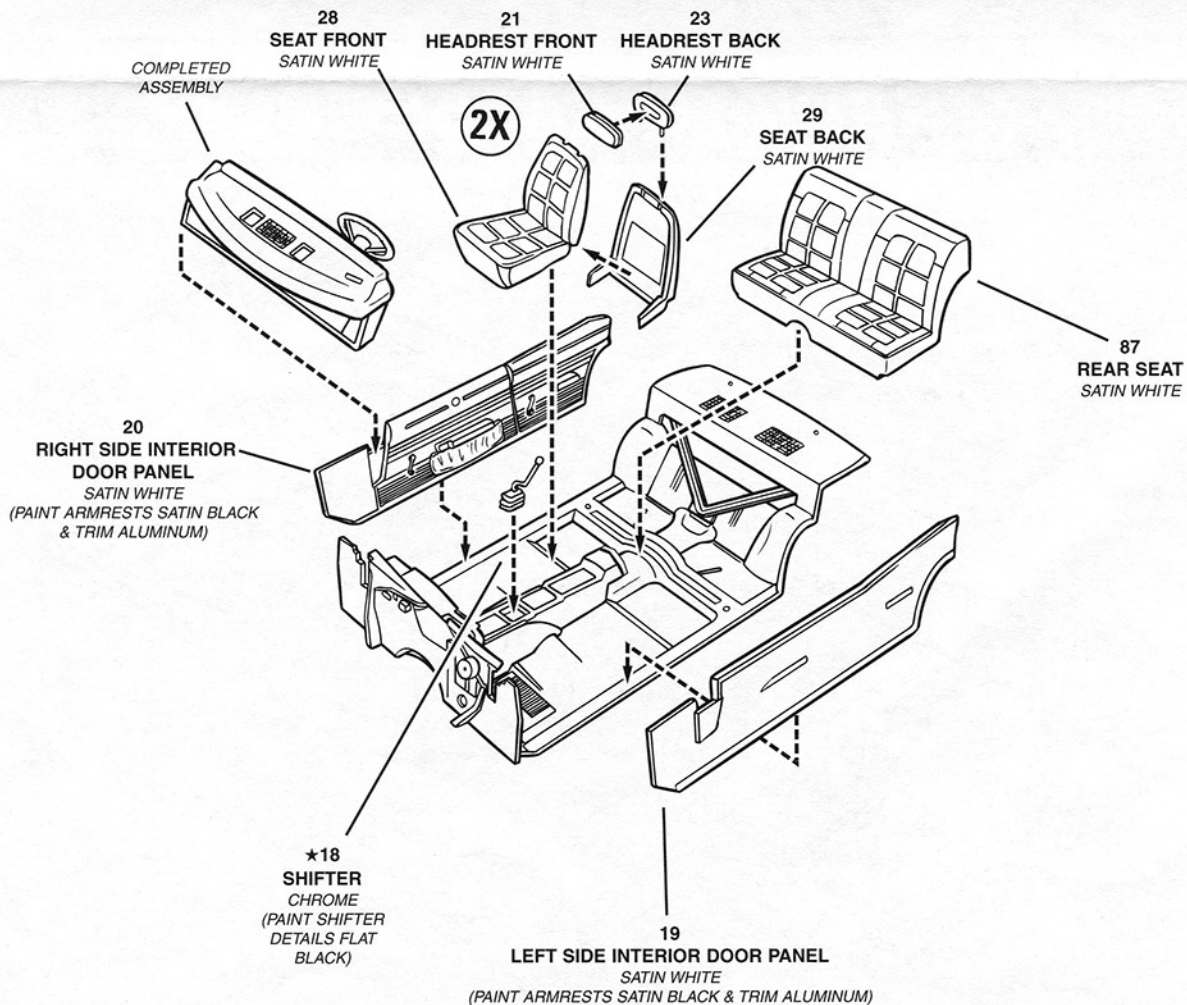

5

BODY ASSEMBLY

A

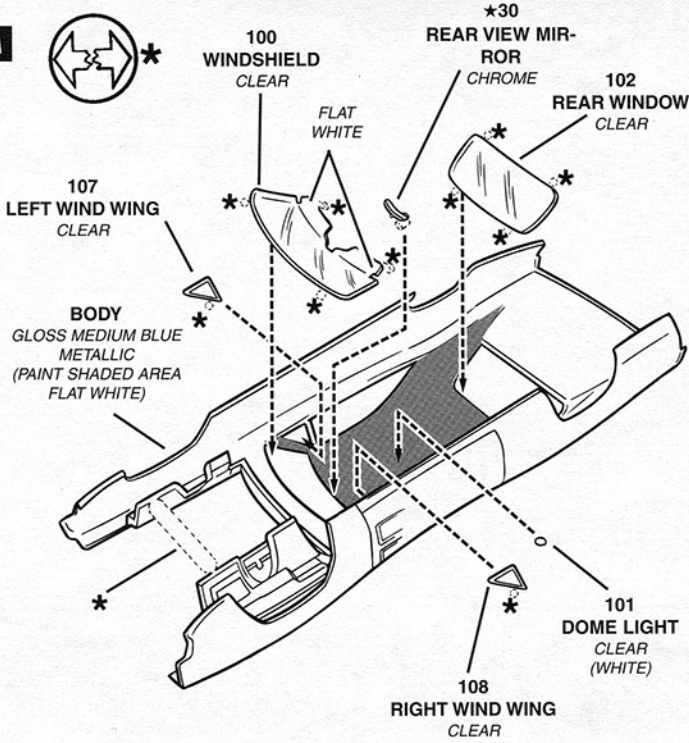

B

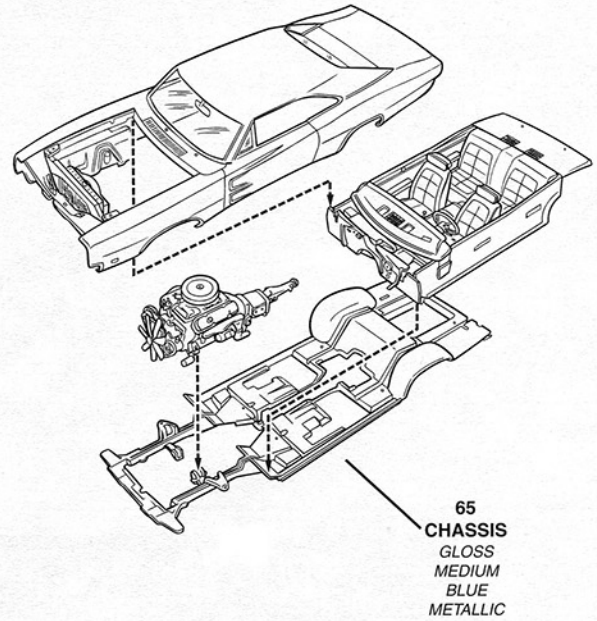

6

RADIATOR ASSEMBLY

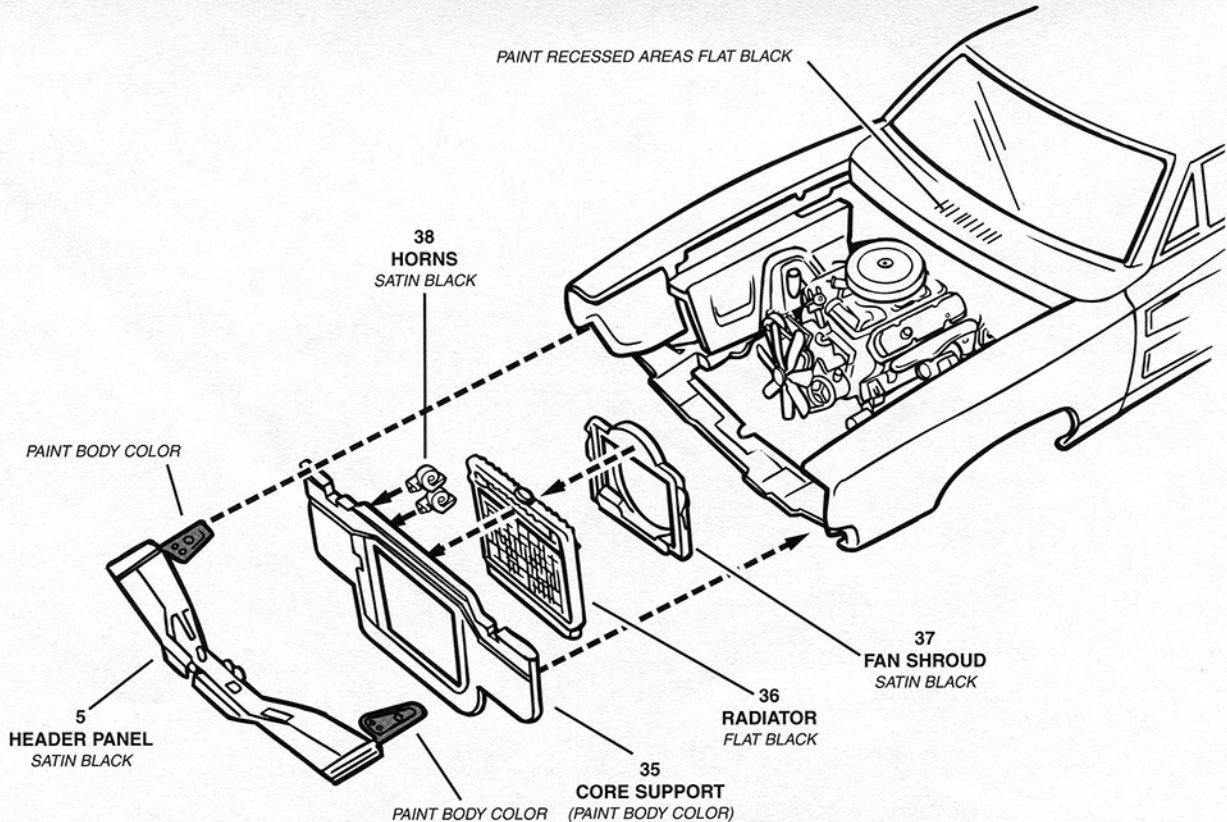

7

EXHAUST ASSEMBLY

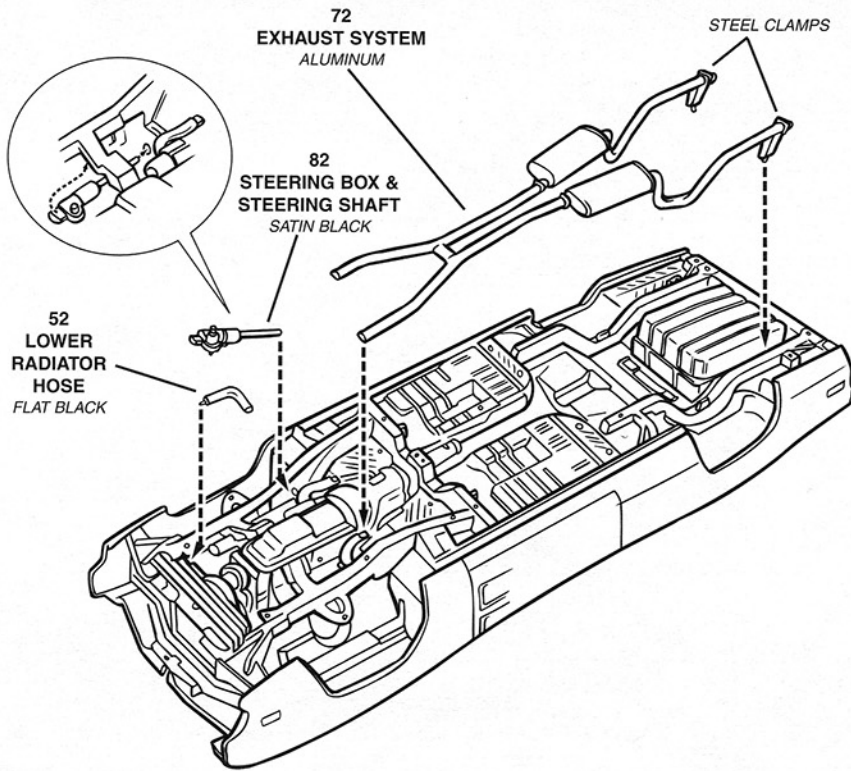

8

FRONT SUSPENSION ASSEMBLY

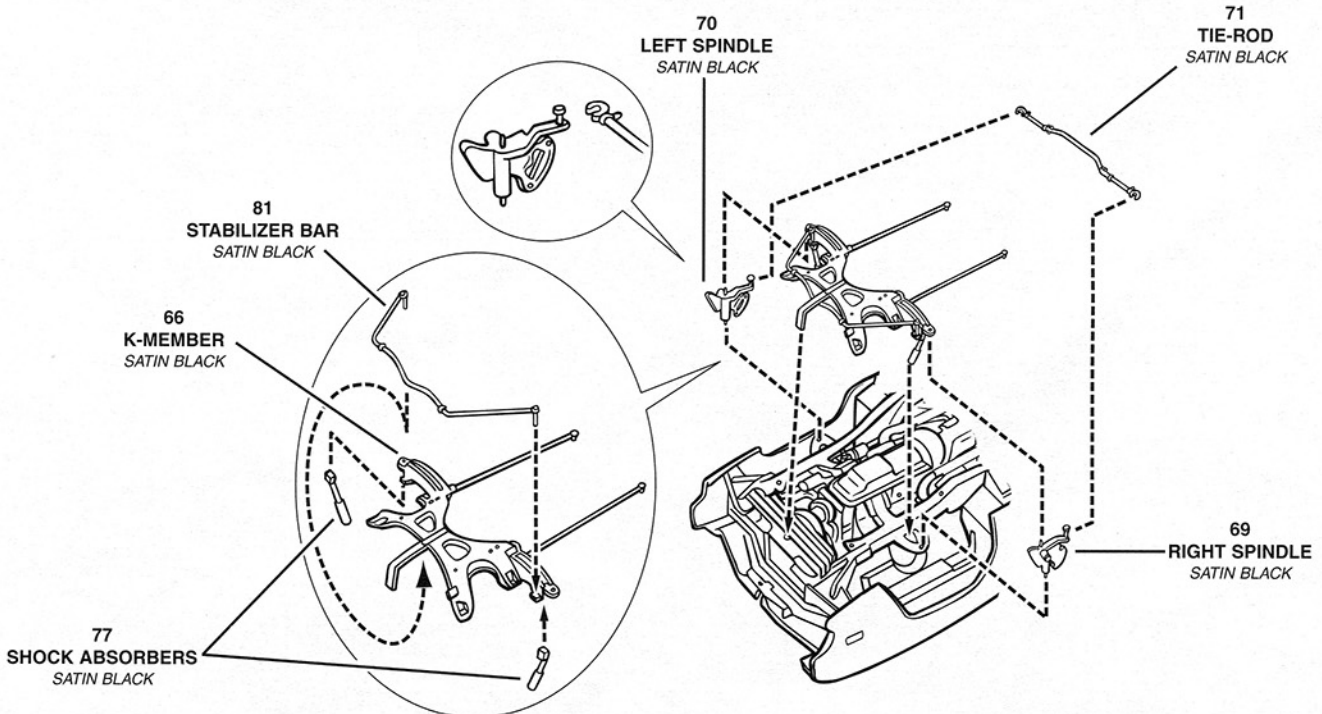

9

REAR SUSPENSION ASSEMBLY

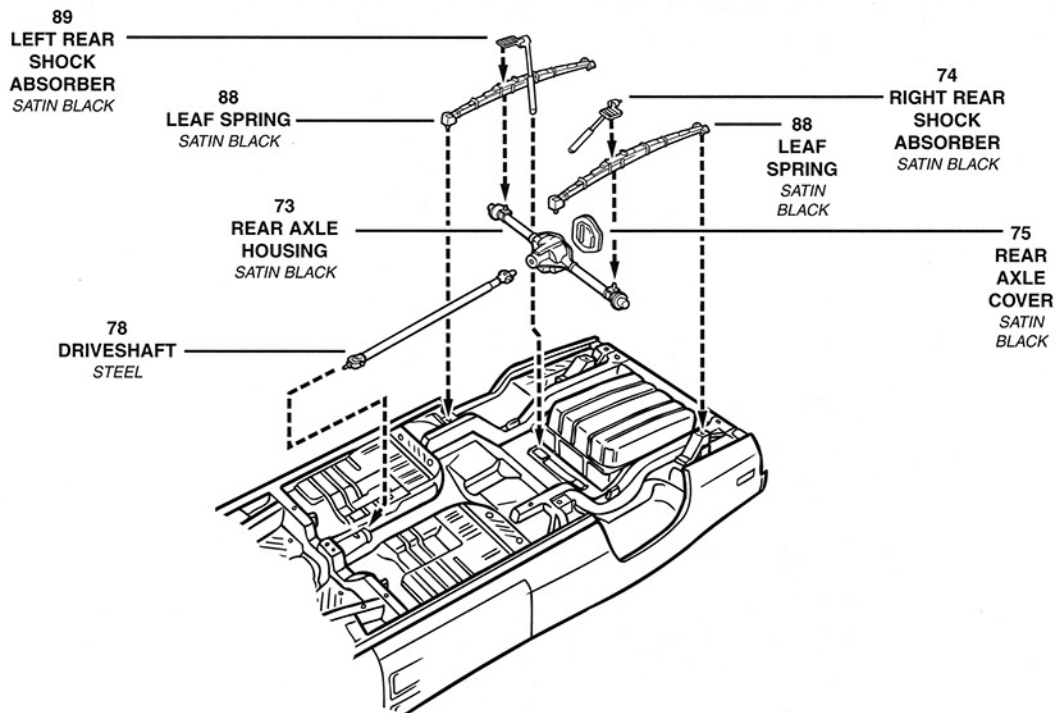

10

TIRE/WHEEL ASSEMBLY

FRONT

NOTE:
CAREFULLY CEMENT A FRONT WHEEL ASSEMBLY TO EACH OF THE FRONT SPINDLES TAKING CARE TO ONLY GET CEMENT ON THE WHEEL RETAINER AND THE SPINDLE.

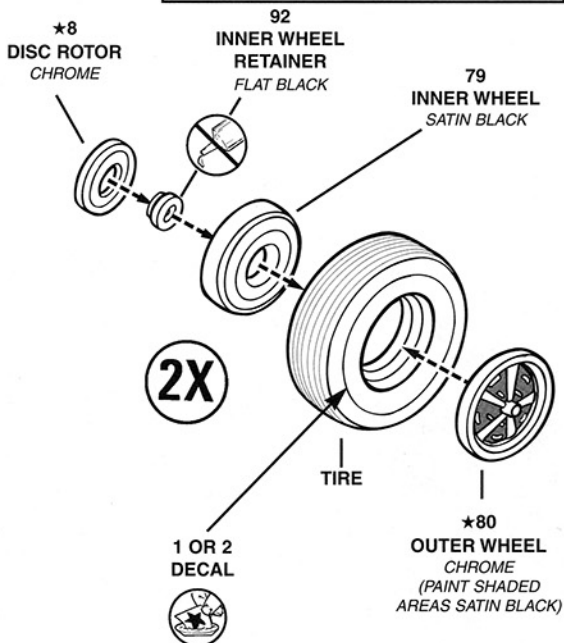

REAR

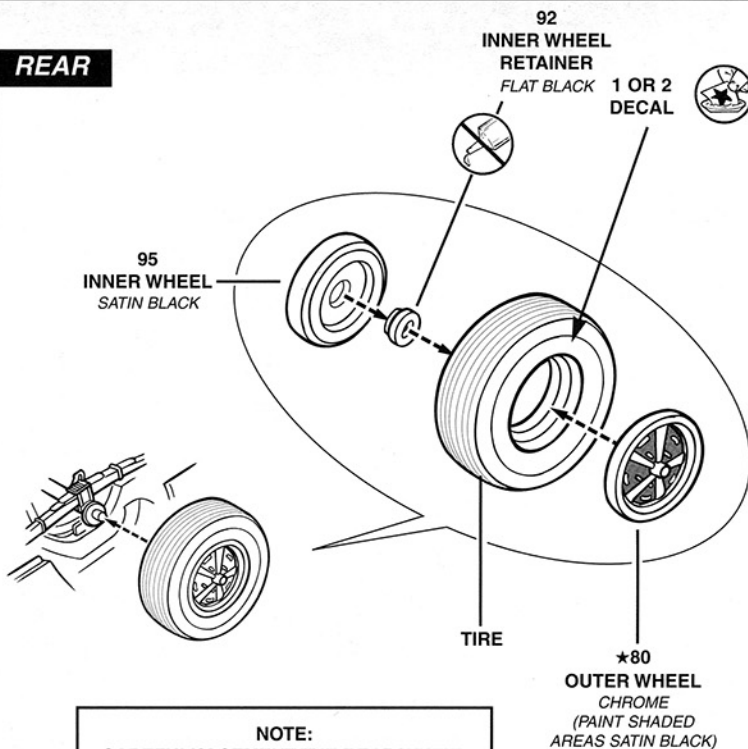

NOTE:
CAREFULLY CEMENT THE REAR WHEEL ASSEMBLY TO THE REAR AXLE TAKING CARE TO ONLY GET CEMENT ON THE WHEEL RETAINER AND THE AXLE.

11

REAR BODY ASSEMBLY

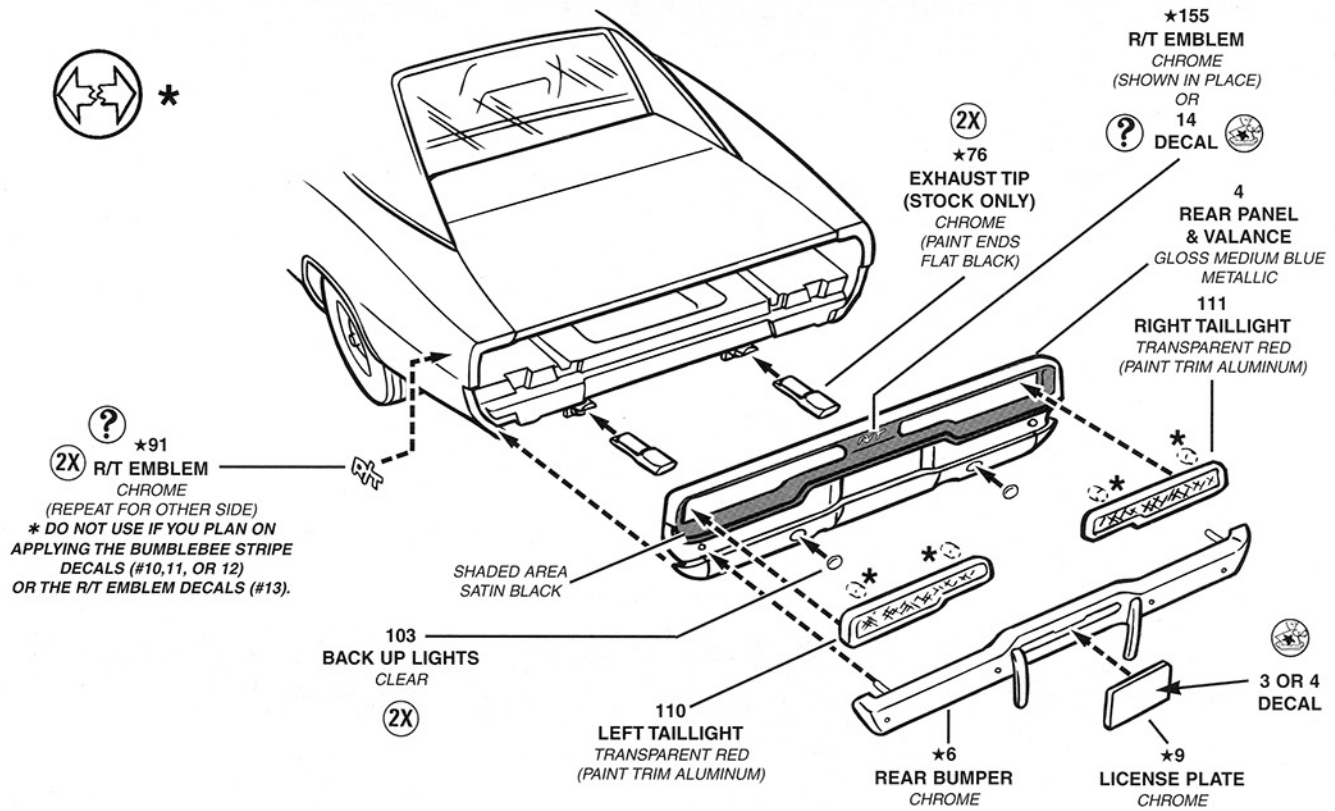

12

FRONT END ASSEMBLY

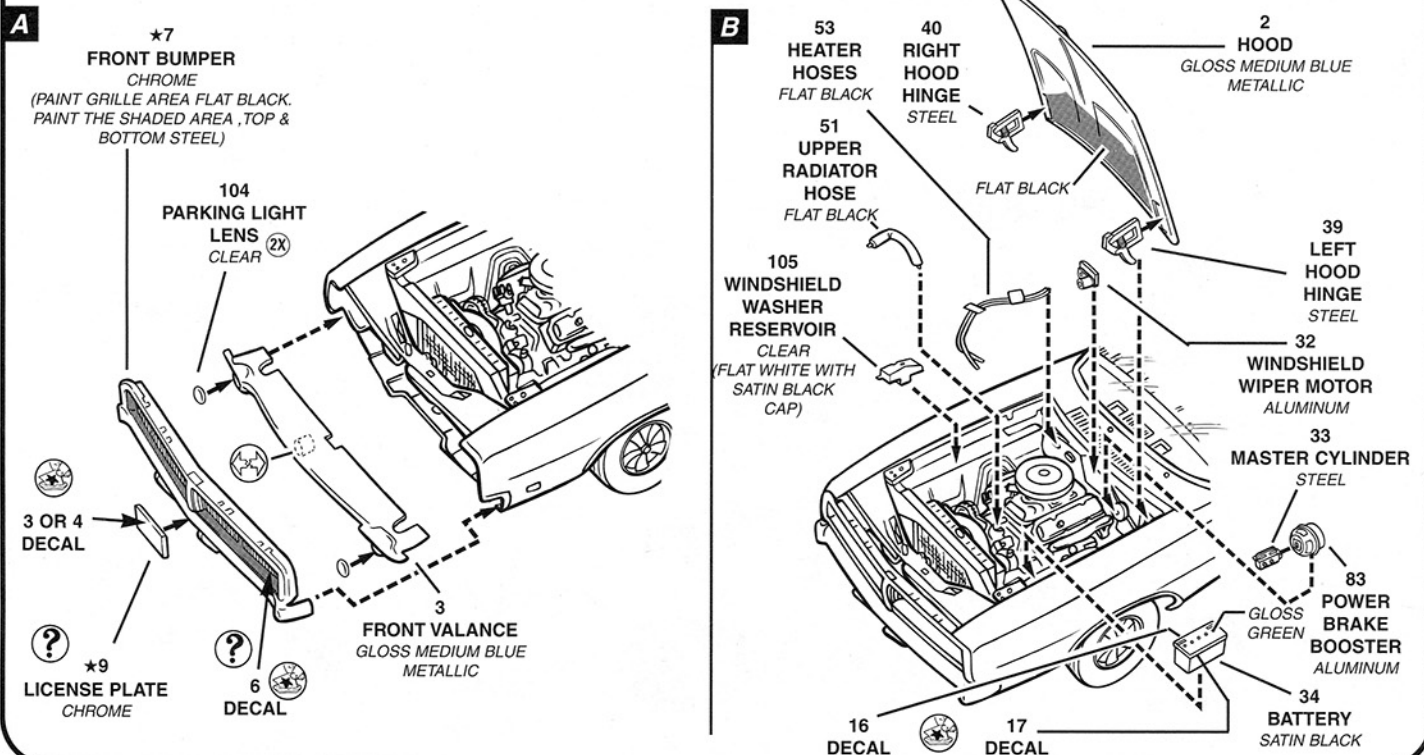

13

FINAL ASSEMBLY

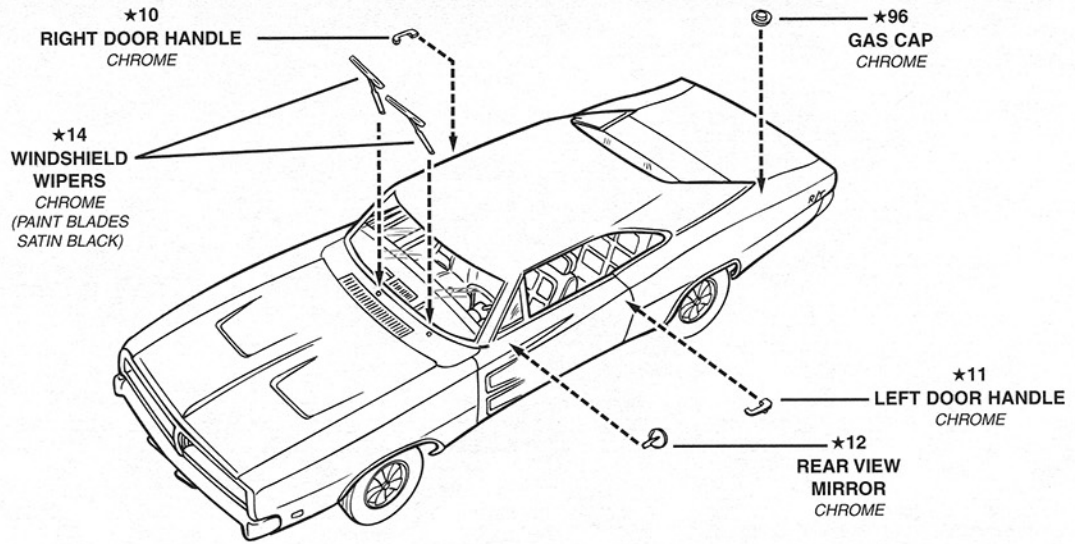

14

DECAL PLACEMENT

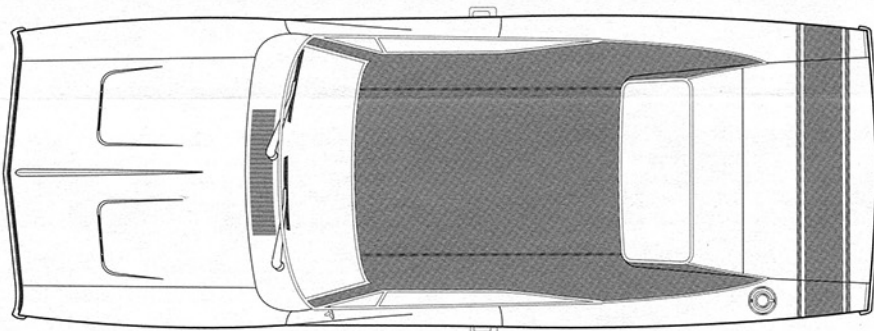

 GLOSS MEDIUM BLUE METALLIC
 SATIN WHITE

13
(OPTIONAL
SEE STEP #11)

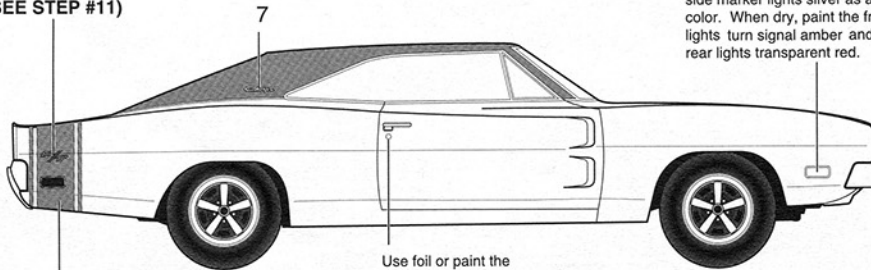

PAINTING TIP: Use foil or paint the side marker lights silver as a base color. When dry, paint the front lights turn signal amber and the rear lights transparent red.

Use foil or paint the door locks aluminum.

6 - Optional (See step 12)

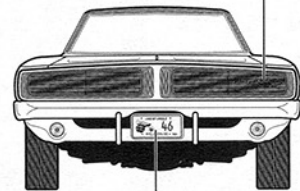

10,11 OR 12
(OPTIONAL SEE STEP #11)

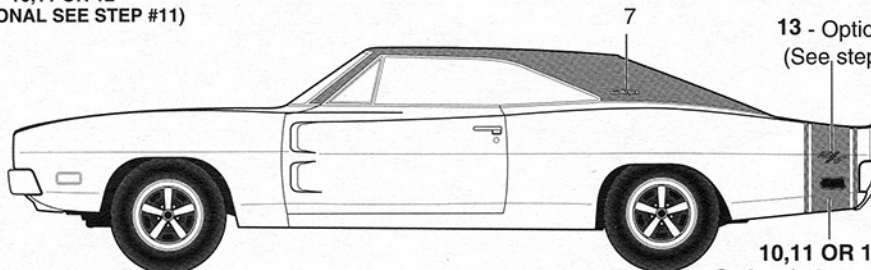

13 - Optional
(See step 11)
Optional (See step 11)

14- Optional 15- Optional

