

HC1604 • 1:48 • German Bomber DO-17E/F

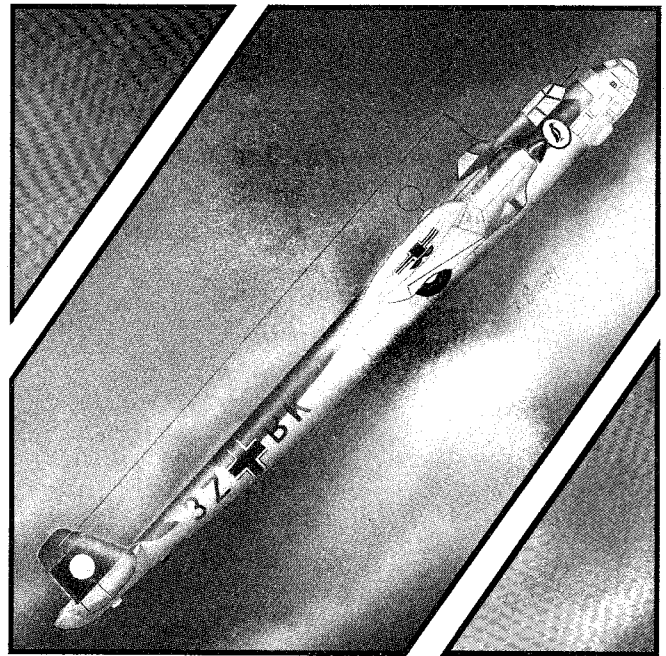

Aircraft Type: bomber
Scale: 1:48
Country Of Origin: Germany

The Dornier Do-17E/F "Flying Pencil" was the first major production version of this historic warplane. Do-17's first saw combat in the Spanish Civil War, and many soldiered on in German reconnaissance units during the early phases of World War II. Kit features: • detailed cockpit • landing gear • authentic markings.

Type d'avion: bombardier
Echelle: 1:48
Pays d'origine: Allemagne

La version Do-17E/F "Flying Pencil" fut fut la première produite en grande quantité du Dornier. Le Do-17 effectua ses premiers combats durant la guerre civile espagnole, alors que d'autres étaient utilisés comme avion de reconnaissance au début de la deuxième guerre mondiale. Particularités du kit: • cockpit et train d'atterrissage très détaillés • moulage précis • les marques authentiques.

Tipo di aereo: bombardamento
Scala: 1:48
Origine: tedesco













Il Dornier Do-17E/F "Flying Pencil" è stato la prima più importante versione di questo storico aereo da guerra. Il Do-17 combatté dapprima nella guerra civile spagnola, e molti servirono nelle unità ricognitive tedesche durante la prime fasi della il 2° guerra mondiale. Caratteristiche del modello: • carlinga dettagliata e carrello di atterraggio • dettagli incisi • decals autentici.

Typ: Bomber
Maßstab: 1:48
Ursprungsland: Deutschland

Die Dornier Do-17E/F "Fliegender Bleistift" war die erste Variante dieses historoschen Flugzeugs, das in großen Stückzahlen gebaut wurde. Die erste "Feuertaufe" erlebte dieses Muster im Spanischen Bürgerkrieg bei der "Legion Condor" und wurde danach bei vielen Aufklärungseinheiten der deutschen Luftwaffe im 2. Weltkrieg eingesetzt. Der Bausatz enthält: • detailliertes Cockpit und Fahrwerk • fein eingravierte Details • authentische Abziehbilder.

Typo de avion: bombardero
L'escala: 1:48
Pals de origen: Alemania

El Dornier Do-17E/F "Lapiz Volador" fue la primer gran producción de la versión de este histórico avión de guerra. El Do-17 combatió por primera vez en la Guerra Civil Española y muchos pilotearon las unidades de reconocimiento en Alemania durante la primera fase de la 2ª Guerra Mundial. Características del kit: • se detallan la cabina del piloto y el aterrizador • marcas auténticas.

 cyanoacrylate glue coller cyanoacrylate Cyanoacrylate kleben incollare cyanoacrylate pegar cyanoacrylate	 cut couper schneiden tagliare cortar	 bend plier sich biegen plegar doblar	 file / sand ponce verspachteln levigare lijar	 weight à lester Gewicht zavorra lastre	 drill or pierce percer bohren forare agujerear	 two deux zwei dos
 painting instructions mode d'emploi Anleitungen der Farben Istruzioni per la verniciatura instrucciones sobre la pintura	 caution! attention! vorsichten! attenzione! atención	 alternative en option Alternativ alternativo alternativa	 cement coller kleben incollare pegar	 paint peindre bemalen verniciare pintar	 decal decalcomania Abziehbild decalcomania calcomanías	 no! no! nein! no! ¡no!



Read This Before You Begin!

- study the assembly drawings
- each plastic part is identified by number
- check the fit of each piece before cementing
- do not use too much cement to join parts
- model may be painted to match box illustration

Lisez Ce Qui Suit Avant De Commencer Le Montage!

- étudier les schémas d'assemblage
- chaque pièce plastique porte un numéro d'identification
- contrôler que chaque pièce soit bien conforme avant de la coller à sa place
- utilisez uniquement une colle spéciale pour polystyrène
- le modèle peut être peint conformément aux illustrations de la boîte

Vor Zusammenbau lesen sie bitte!

- studiere die Bauanleitung
- die Plastikteile sind gekennzeichnet durch ihre Nummern
- vor dem Kleben prüfe ob die Teile zusammenpassen können
- benutze nicht zuviel Klebstoff
- die Bemalung des Modells kann auf dem Becketbild zeigen

1

Cockpit Assembly / Assemblage de L' Interieur

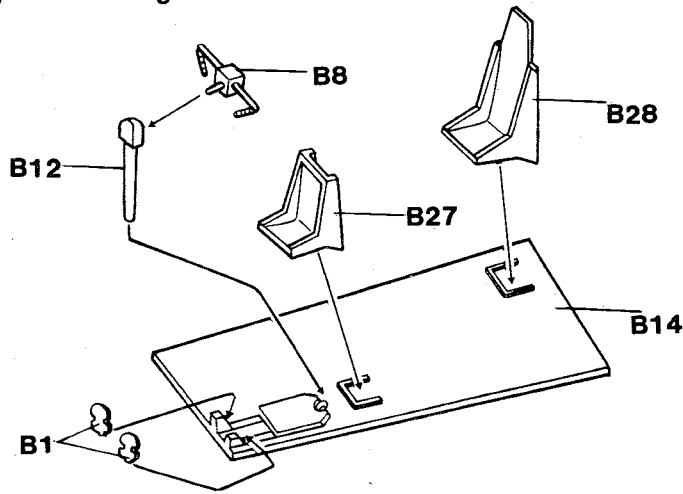

2

Fuselage Assembly / Assemblage du Fuselage

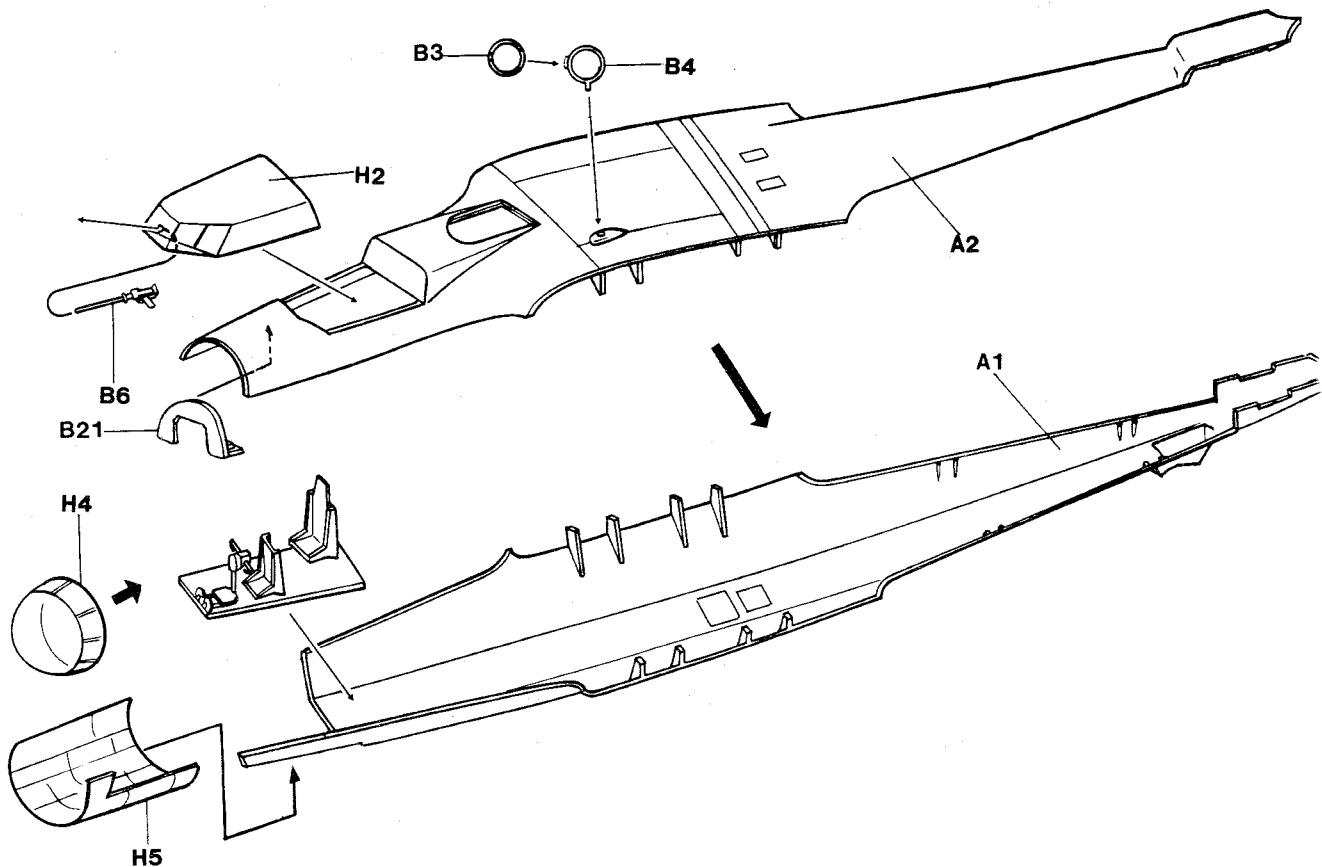

3

Wing Assembly / Assemblage des Ailes

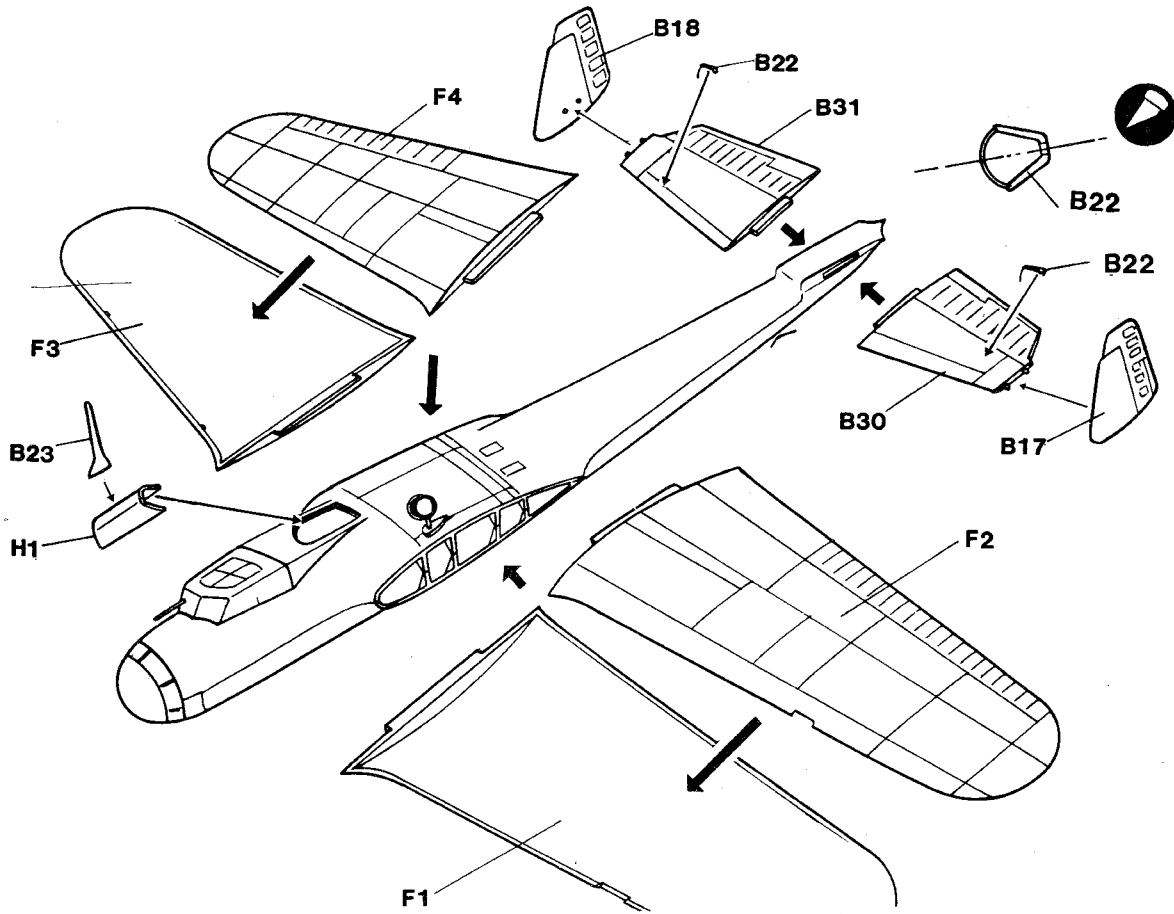

4

Propeller & Engine Assembly / Assemblage de Helice & Moteur

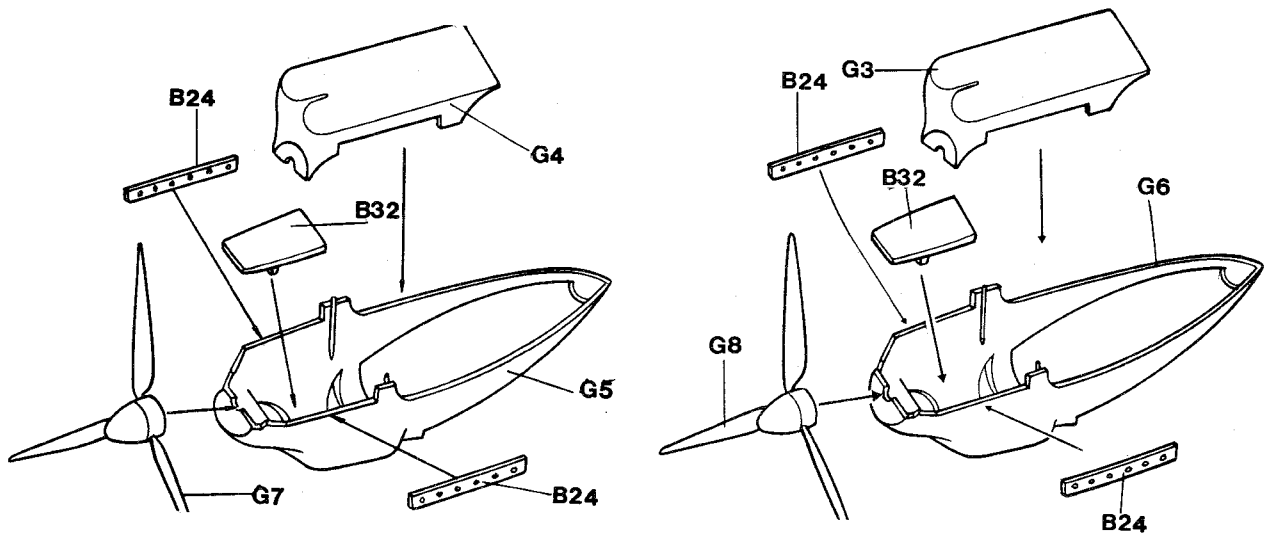

5

Landing Gear Assembly / Train D' Atterrissage

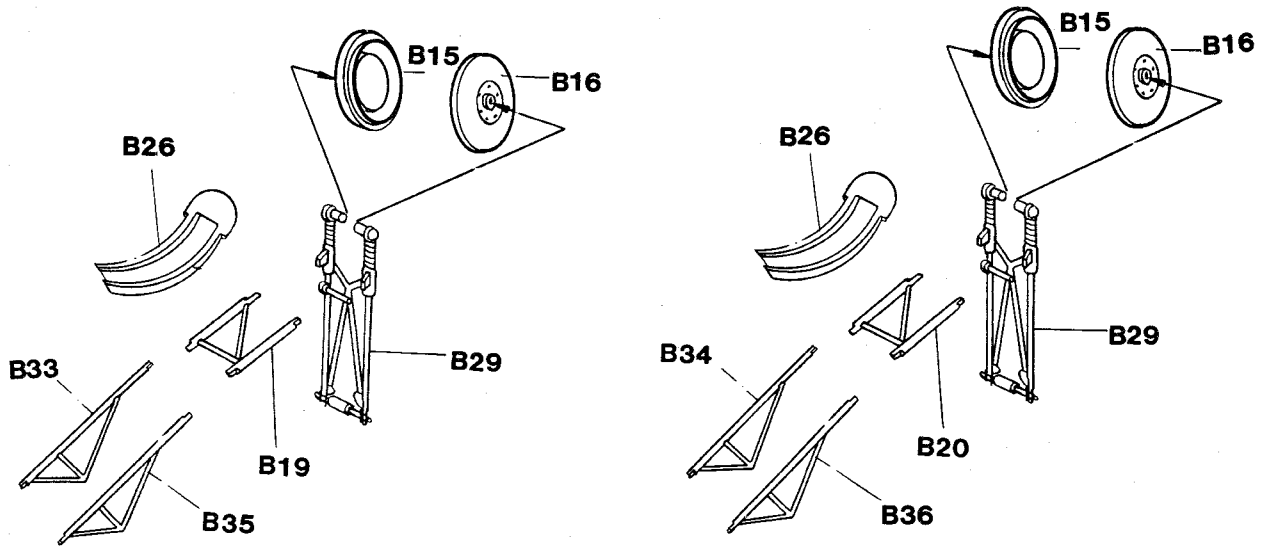

6

Engine, Landing Gear & Cover Assembly / Moteur, Train D' Atterrissage & Couverture

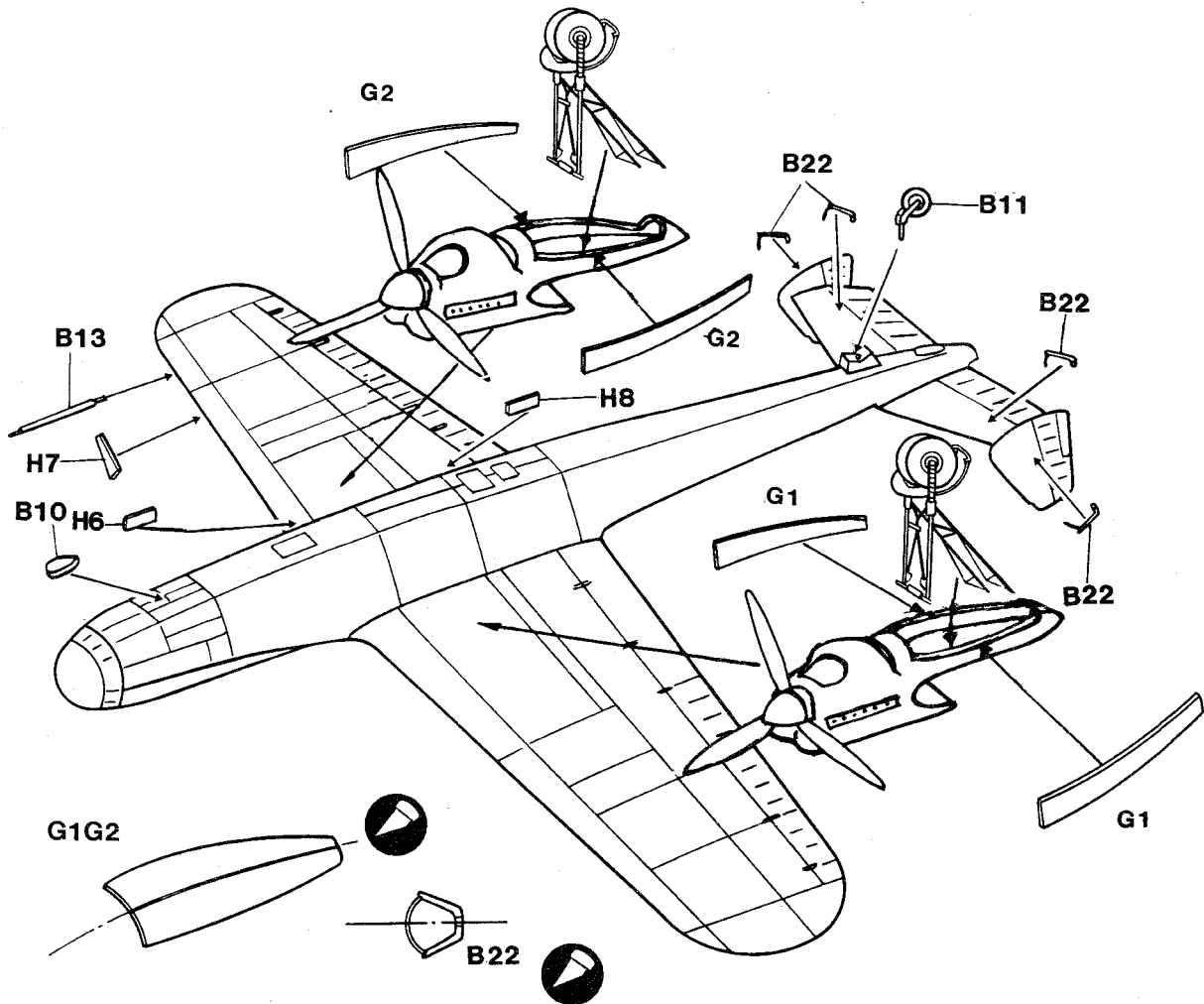

Camouflage & Markings • Appliques et Couleurs



I D0 17E-1, Germany, III/KG 255, 1938

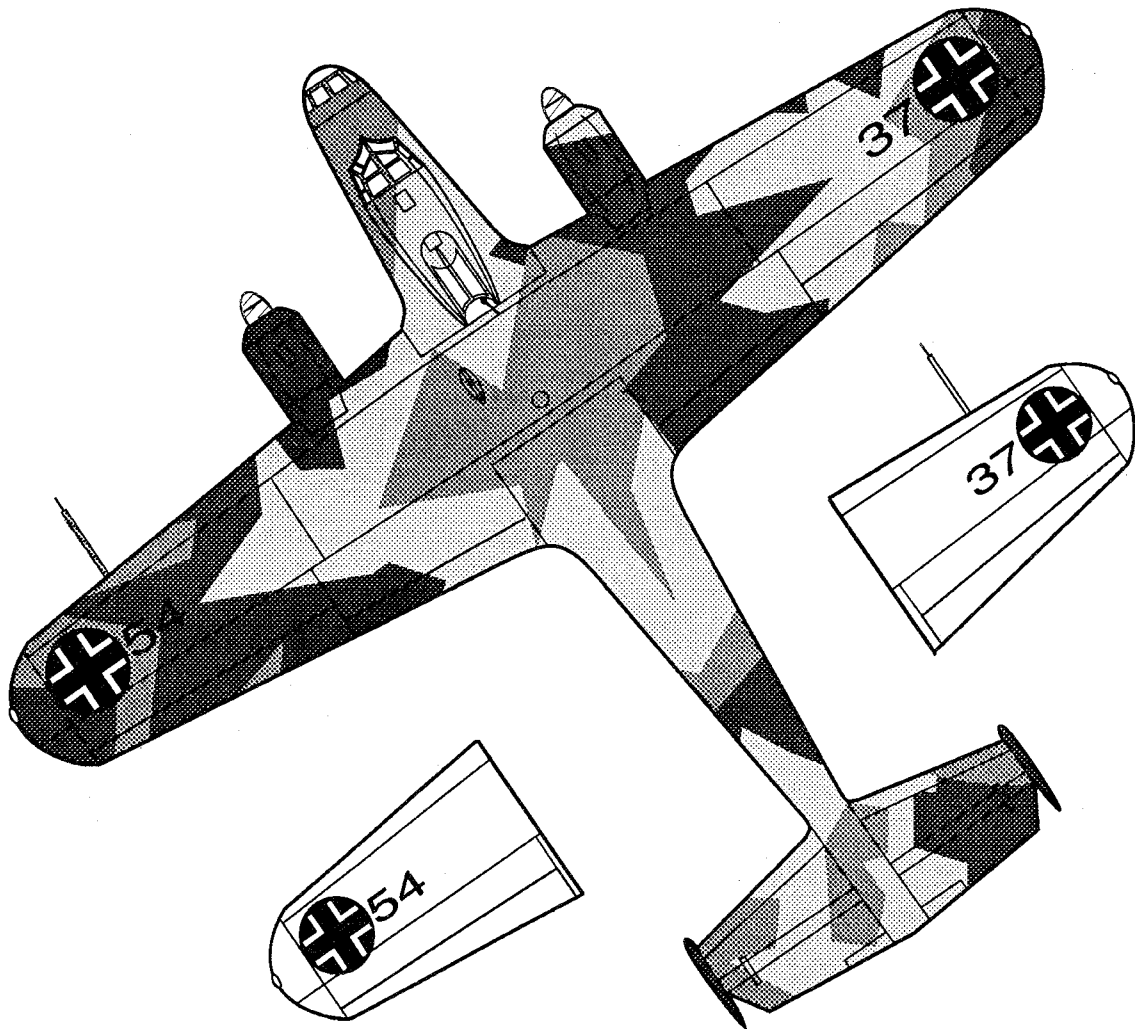
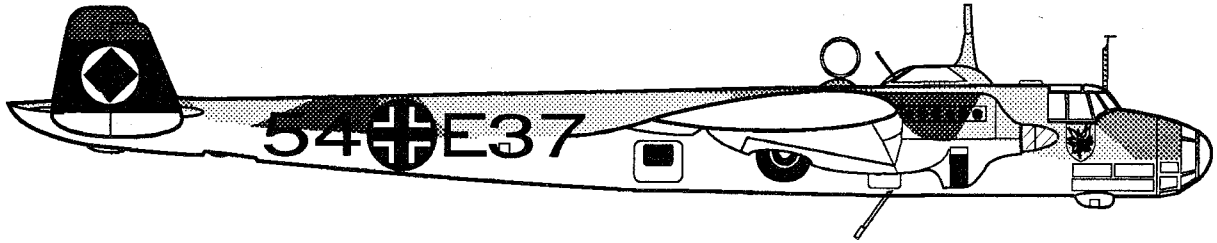
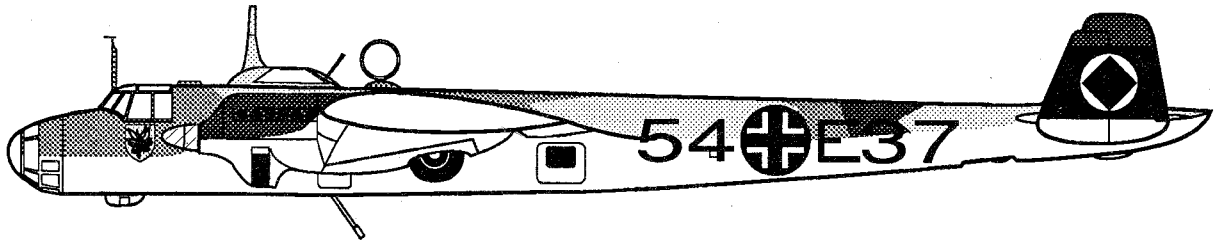



RLM 21



RLM 22



RLM 61



RLM 62



RLM 63



RLM 65

II Do 17E-1, "Nationalist" Spain, K/88, 1938

