

3 INTERIOR ASSEMBLY

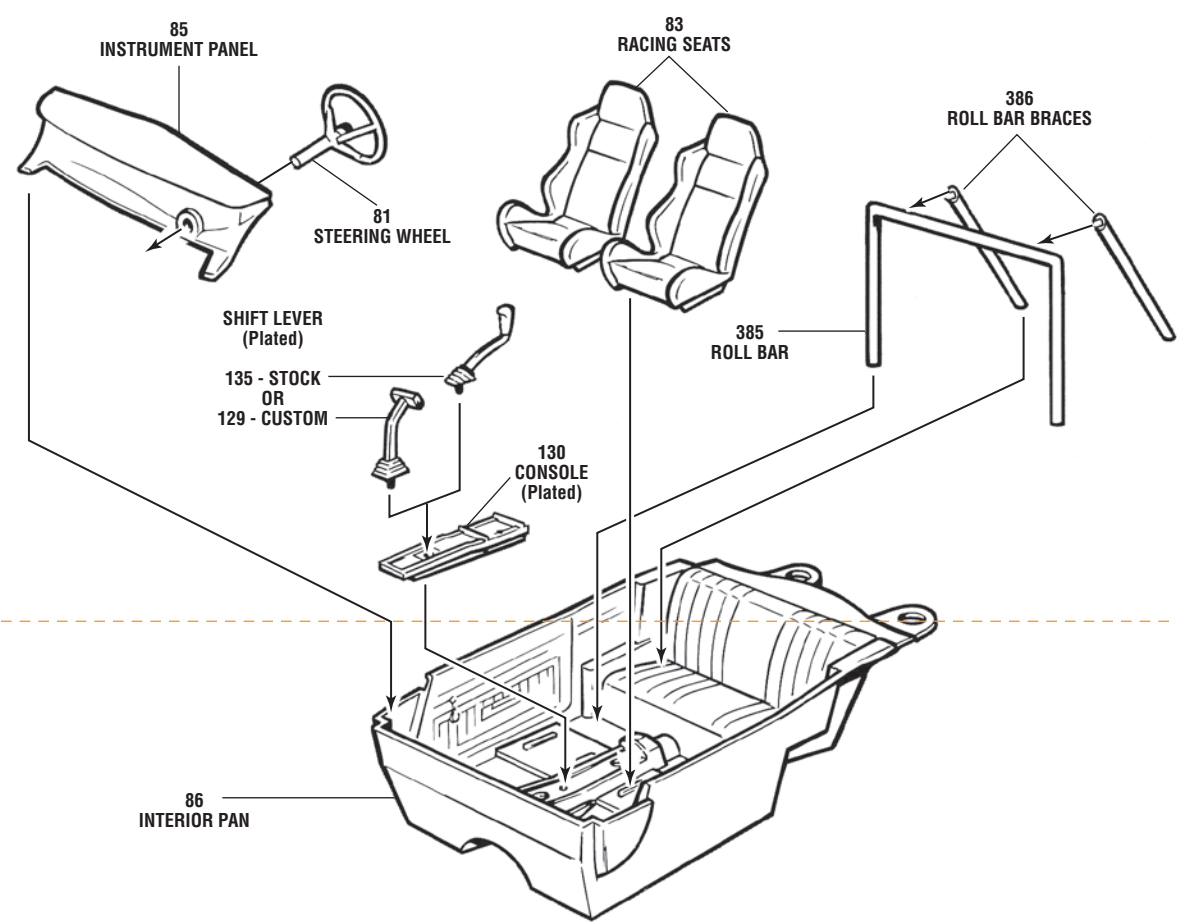

4 BODY ASSEMBLY

WINDSHIELD A PREPARATION

NOTE: Carefully saw or file 1/16" off the bottom of the wing vent area before installing the windshield into the body.

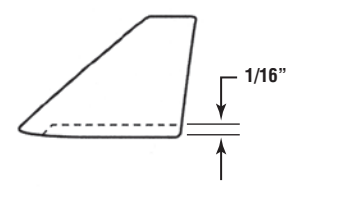

BODY/CHASSIS ASSEMBLY B

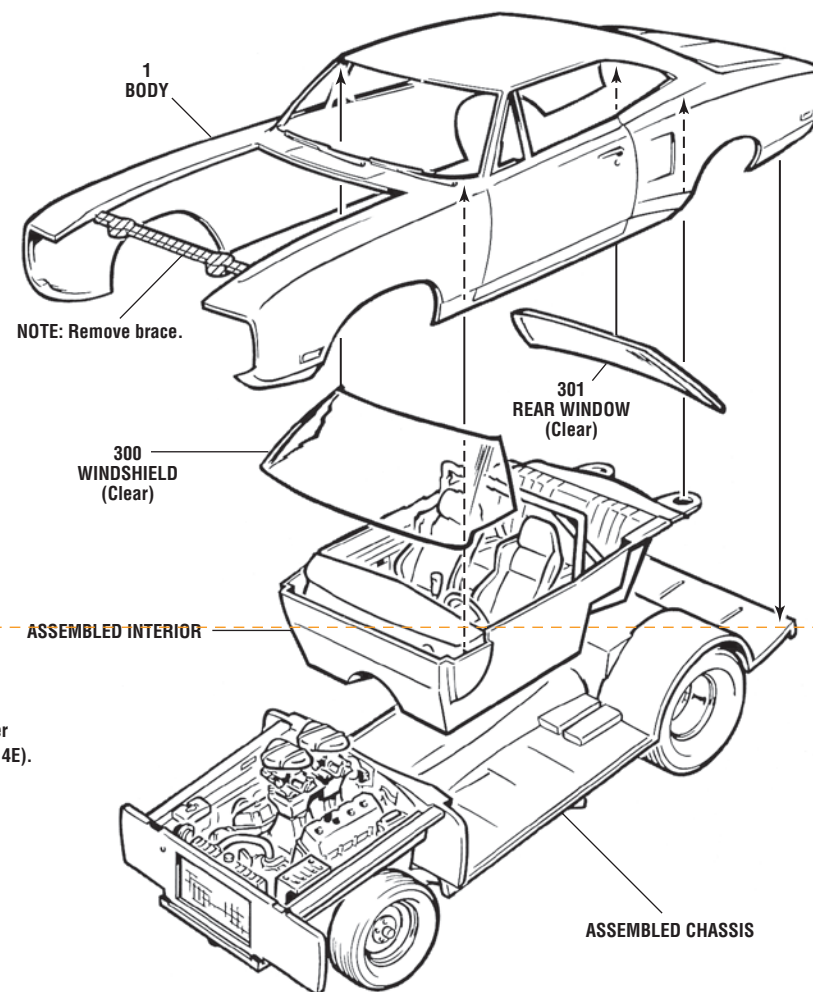

HOOD PREPARATION C

NOTE: Cut opening ONLY when using the TUNNEL RAM INTAKE MANIFOLD (See PANEL 1B). Carefully remove opening in HOOD prior to painting.

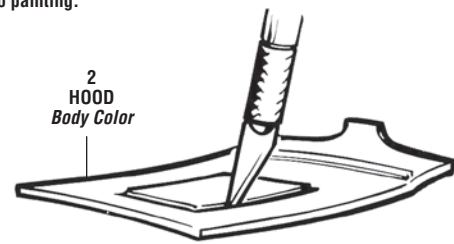

NOTE: HOOD HINGES are optional. Omit HINGES if you wish to display with the HOOD down (DO NOT CEMENT).

FRONT BUMPER/GRILLE PREPARATION D

NOTE: Carefully paint the center section of the FRONT BUMPER to match the color of the body.

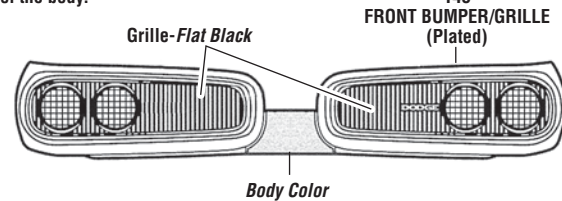

FRONT END ASSEMBLY E

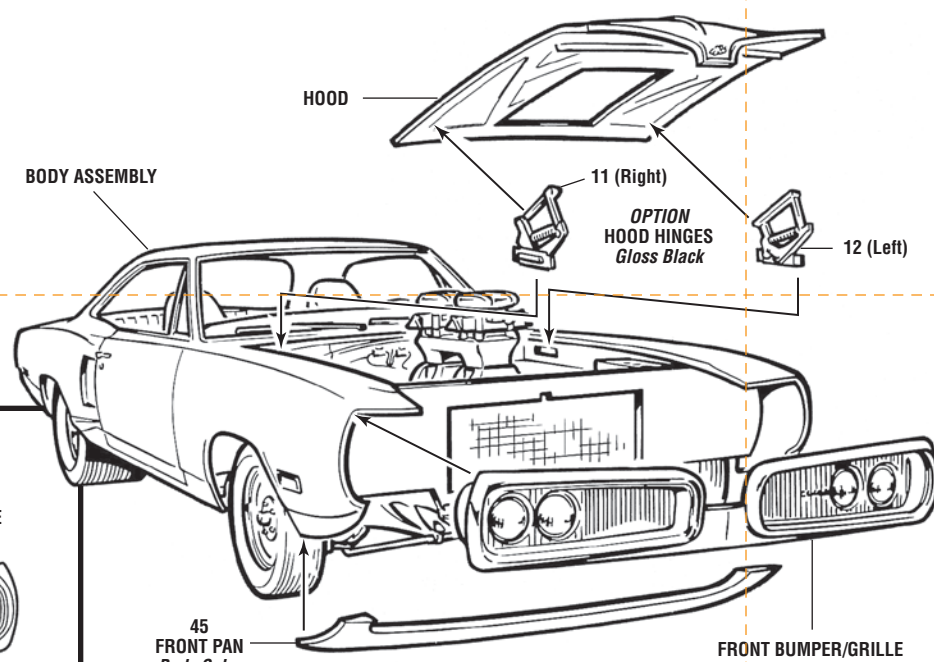

TAILLIGHT PANEL PREPARATION F

NOTE: Carefully paint the center section of the TAILLIGHT PANEL Aluminum.

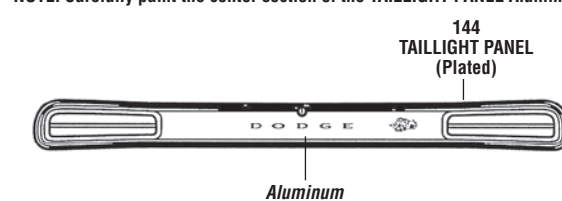

REAR END ASSEMBLY G

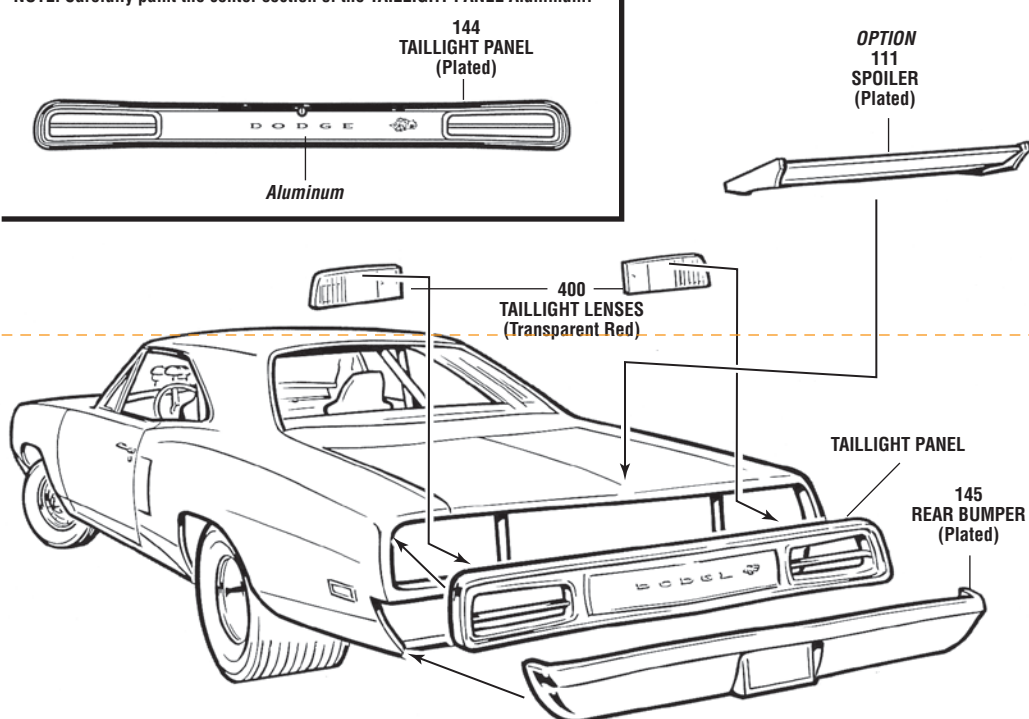

5 DECAL APPLICATION

Your model kit comes with multiple decal options to customize your own Super Bee Pro Street. Choose from two factory stripe options or go wild with AMT exclusive markings from Dirty Donny!

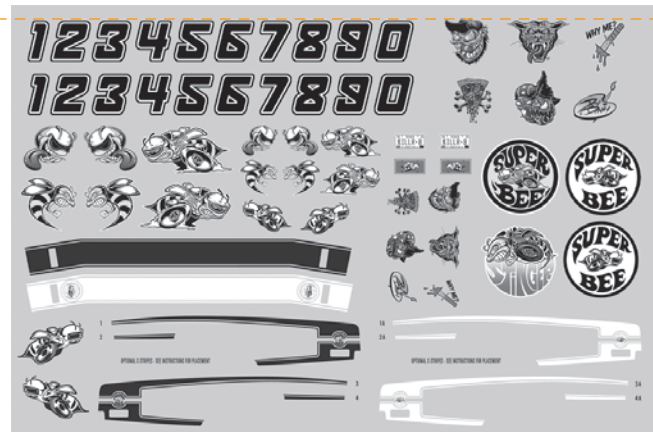

FACTORY SUPER BEE STRIPES

FRONT FENDER TURN SIGNAL (Both sides)
Amber/Chrome Trim

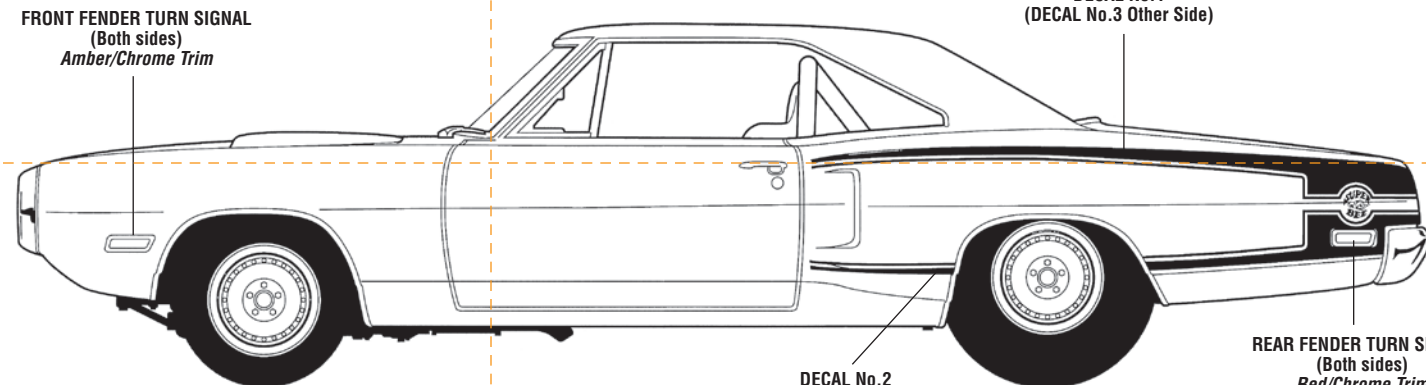

CUSTOM DECAL OPTIONS

You can personalize your model by using the custom Dirty Donny numerals and alternate Super Bee icons and markings. Below are some suggested ideas.

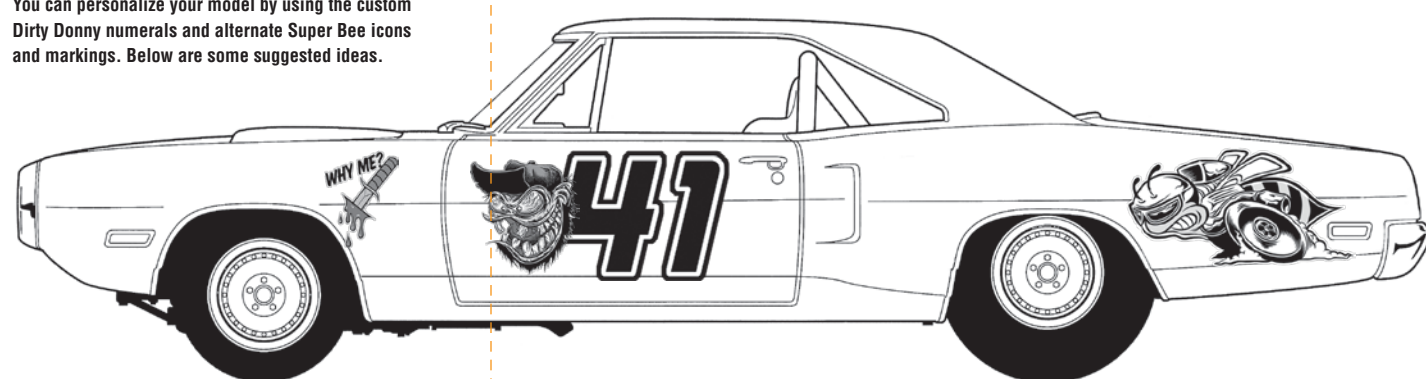

A806-200

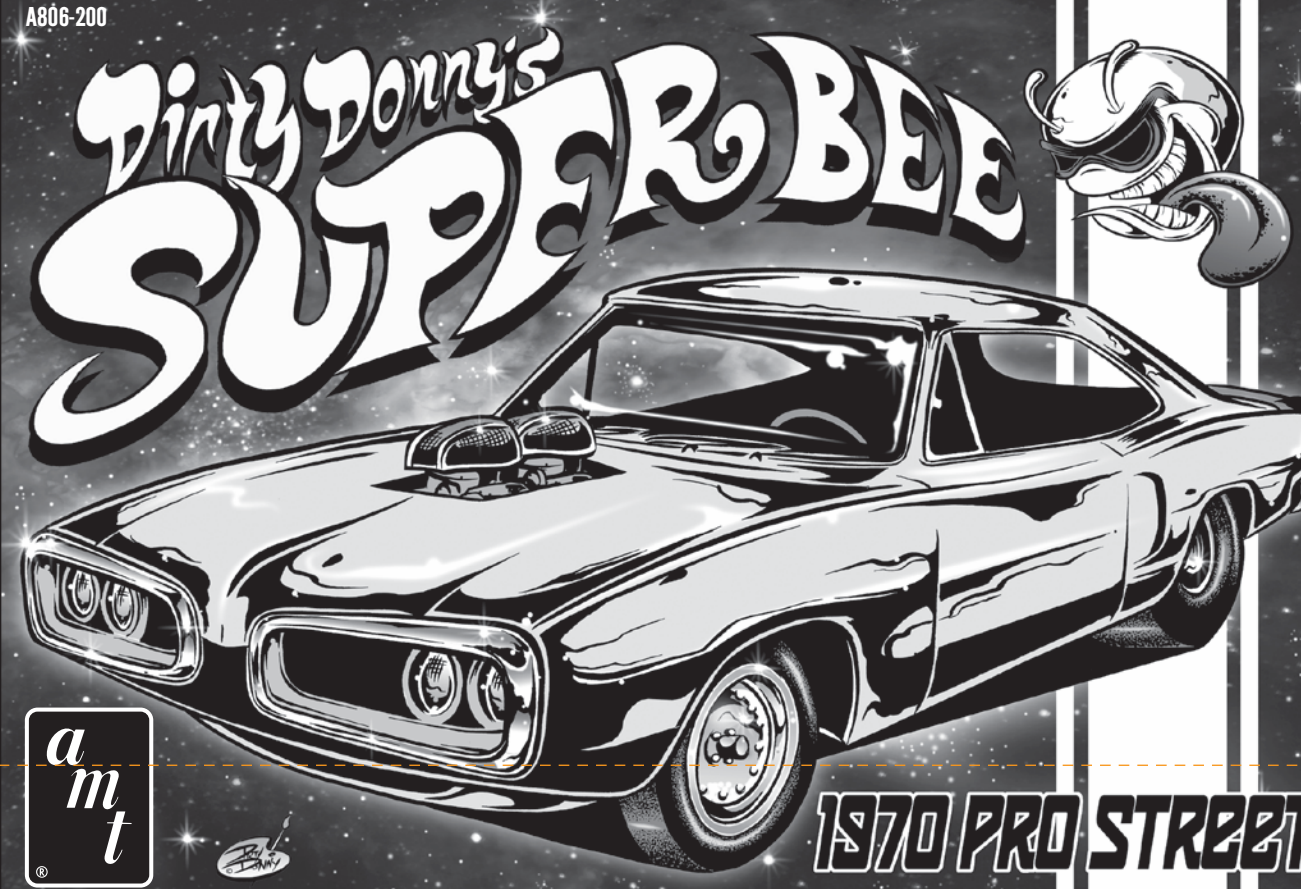

DEEMED TO BE ONE OF THE MOST INFLUENTIAL ARTISTS TO INVAD THE POP CULTURE SCENES OF THE PUNK, ROCK N ROLL AND HEAVY METAL UNDERGROUND, DIRTY DONNY HAS BEEN SPREADING HIS ART ACROSS ALL MEDIUMS FOR DECADES; RANGING FROM TOYS AND DECKS TO PAINTINGS, HOT RODS AND ALBUM COVERS.

IMPORTANT

Assembly: Carefully study and understand the entire instruction sheet. Compare the parts in the box to the instruction sheet to be sure you have received all the parts required. Carefully remove parts from trees. Before cementing, "TEST FIT" parts together to insure proper location and alignment. Scrape paint and plating from surfaces to be cemented. Subassemblies and components should be painted before any parts are attached. Use only cement and paint made for styrene plastic.

Painting: Wash parts thoroughly with mild soap and water. Parting lines, glue joints, and sharp edges should be sanded or filled with filler putty designed for plastic. Apply a "primer" coat and allow to dry. Check parts for imperfections and repeat the procedure if necessary. Remove any lint or dust. Apply paint evenly, in several thin coats rather than one heavy coat. Allow each coat to thoroughly dry before the next is applied. Each coat should be carefully "wet sanded" using slightly damp No. 1200 sandpaper. Be careful not to remove any detail while sanding. Lightest colors should be painted first. Use frosted tape to mask off areas not to be painted. Remove tape after paint is dry to the touch. Use a very fine brush to touch up edges.

Decals: See back of instruction sheet for proper application. Decals should be added after applying a gloss coat. Apply a final clear coat after decals are dry.

BUILDING TIPS FOR THE ADVANCED MODELER

For the best possible finish, your kit should be painted, even if molded in color. Paint should be applied evenly, in several thin coats rather than one heavy coat. The first coat should not completely cover the surface. Each layer should be allowed to thoroughly dry before the next is applied. Also, each coat should be "wet sanded", except for the final coat, using No.1200 wet or dry sandpaper which is slightly damp. Be careful not to remove any detail while sanding.

Decals: It is important to keep your hands clean when working with your model and wash parts thoroughly before painting to remove any mold release agent that may have been used during manufacture, body oil from your hands, sanding residue, and dust, which is naturally attracted to plastic by static electricity. Use a mild solution of dishwashing detergent and water. A tack rag should be used to dry the parts, DO NOT use paper towels or tissues, since they will leave lint on the part.

Parting lines and glue joints should be sanded or filed prior to painting and cementing. Because paint has a tendency to draw away from sharp edges, they should be lightly filed. Use filler putty designed for plastic to fill small gaps that may occur between parts and to blend contours. This should be done only after the first, or "primer," coat of paint is applied.

When painting a two-tone body, the lightest color should be painted first. Use frosted, or "magic," tape to mask off the area you do not want painted. After the second color is dry to the touch, the tape can be removed. Use a very fine brush to touch up edges if necessary. If decals are to be added, do so before adding any gloss coat. A gloss coat will help even out the edges between the two colors as well as set the decals.

RECOMMENDED TOOLS

HOBBY KNIFE

Use a sharp hobby knife to remove parts from the trees. The knife may also be used to remove parting lines and flash.

TWEEZERS

Use tweezers to hold small parts during assembly, painting and when applying cement.

BRUSH

We recommend the use of liquid polystyrene cement. Apply with a fine brush. Use sparingly or a sloppy job will result.

WANT MORE? DON'T MISS
DIRTY DONNY'S VANTASY
ONLY FROM AMT!

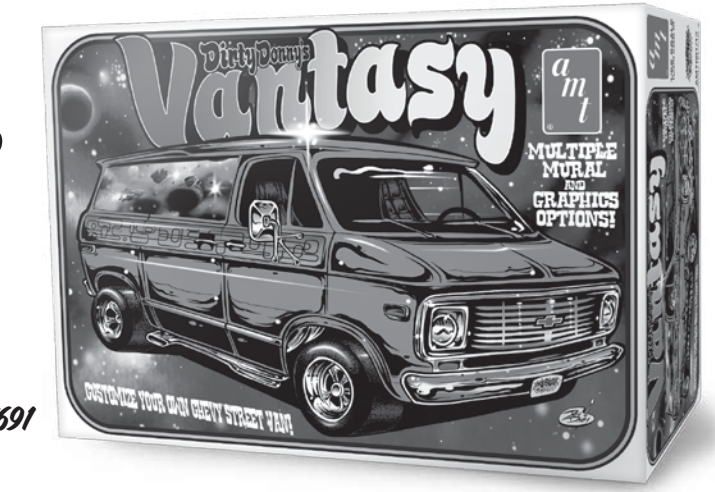

AMT691

1 ENGINE ASSEMBLY

SUB-ASSEMBLY A

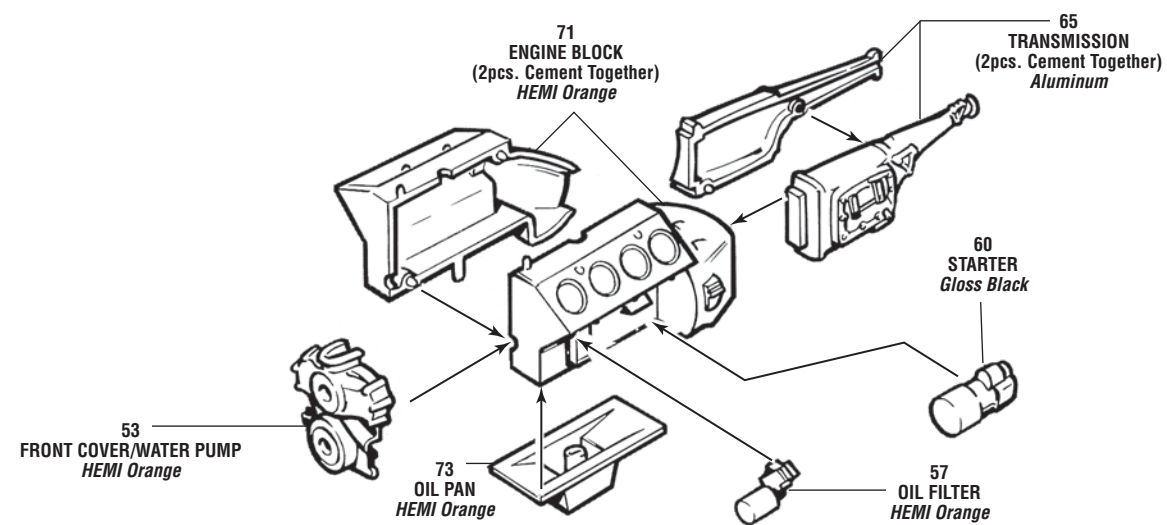

HEMI ENGINE ASSEMBLY

SUB-ASSEMBLY B

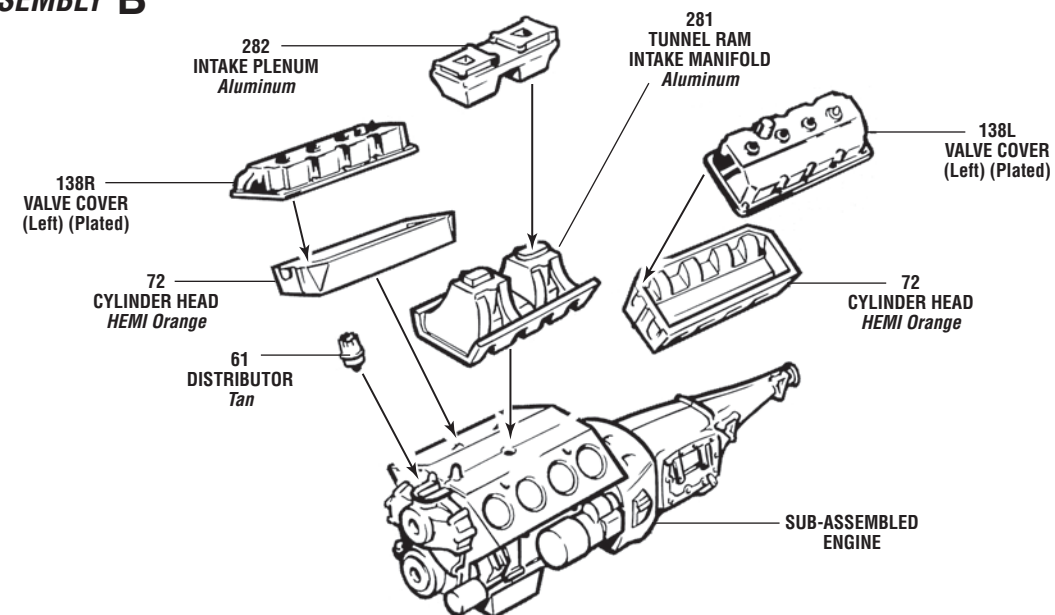

SUB-ASSEMBLY C

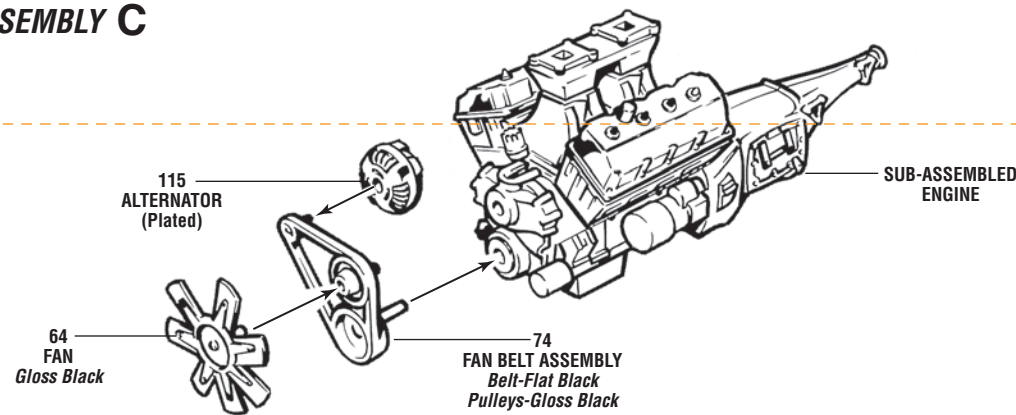

DOHC ENGINE ASSEMBLY

SUB-ASSEMBLY B

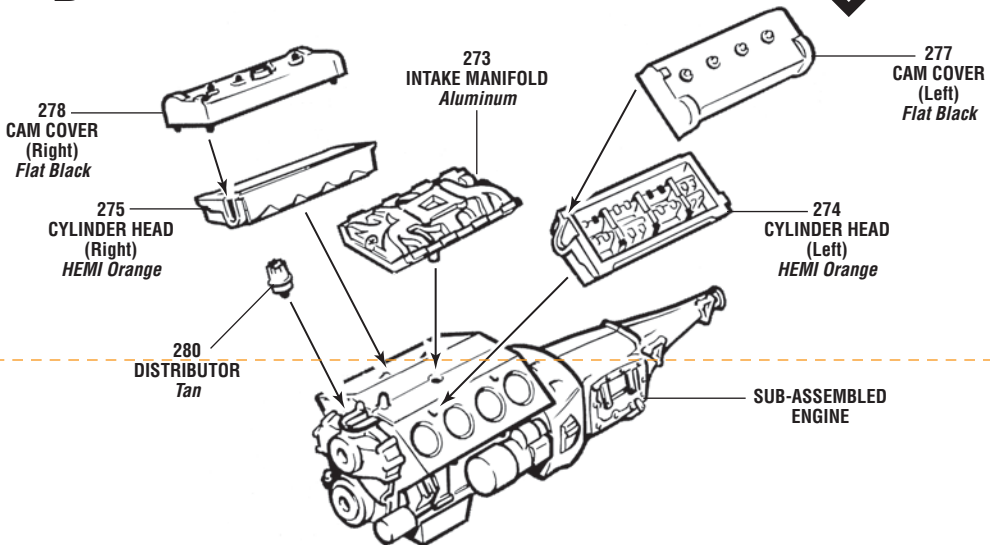

SUB-ASSEMBLY C

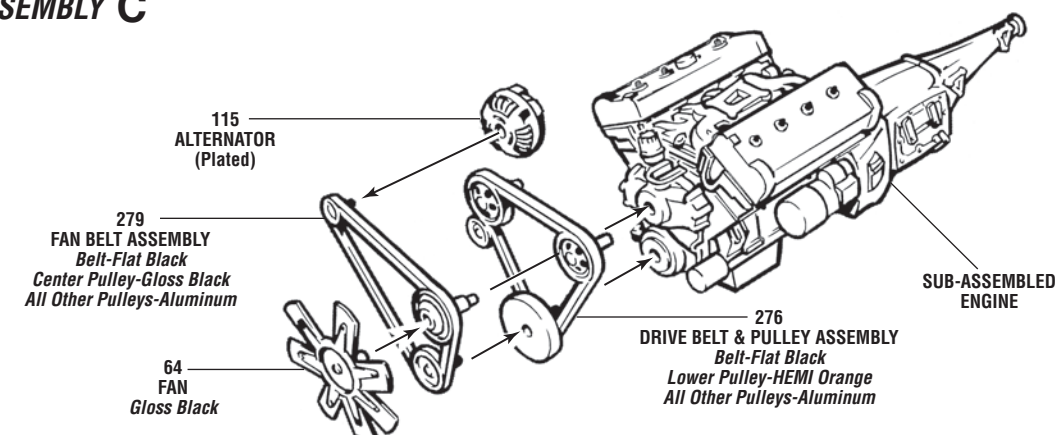

OR

1 ENGINE ASSEMBLY continued

HEMI ENGINE FINAL ASSEMBLY

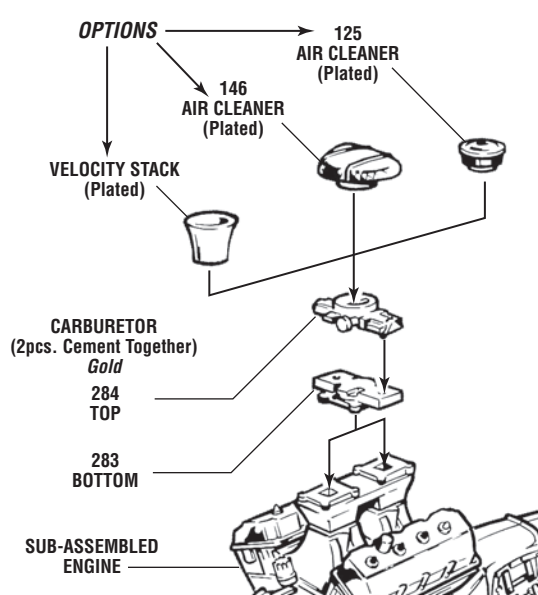

DOHC ENGINE FINAL ASSEMBLY

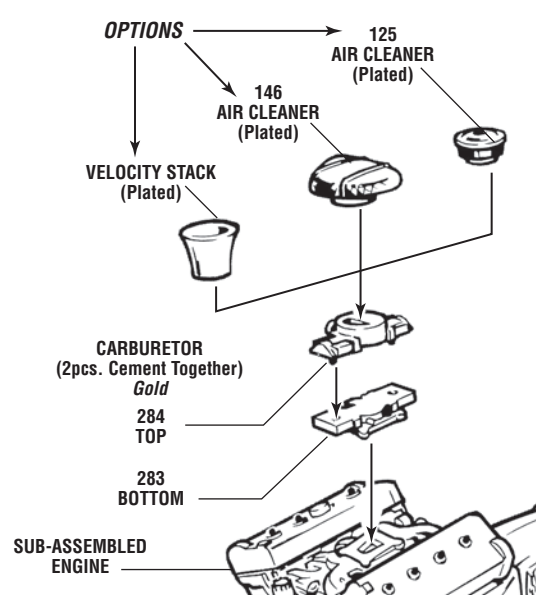

2 CHASSIS ASSEMBLY

ENGINE BAY ASSEMBLY A

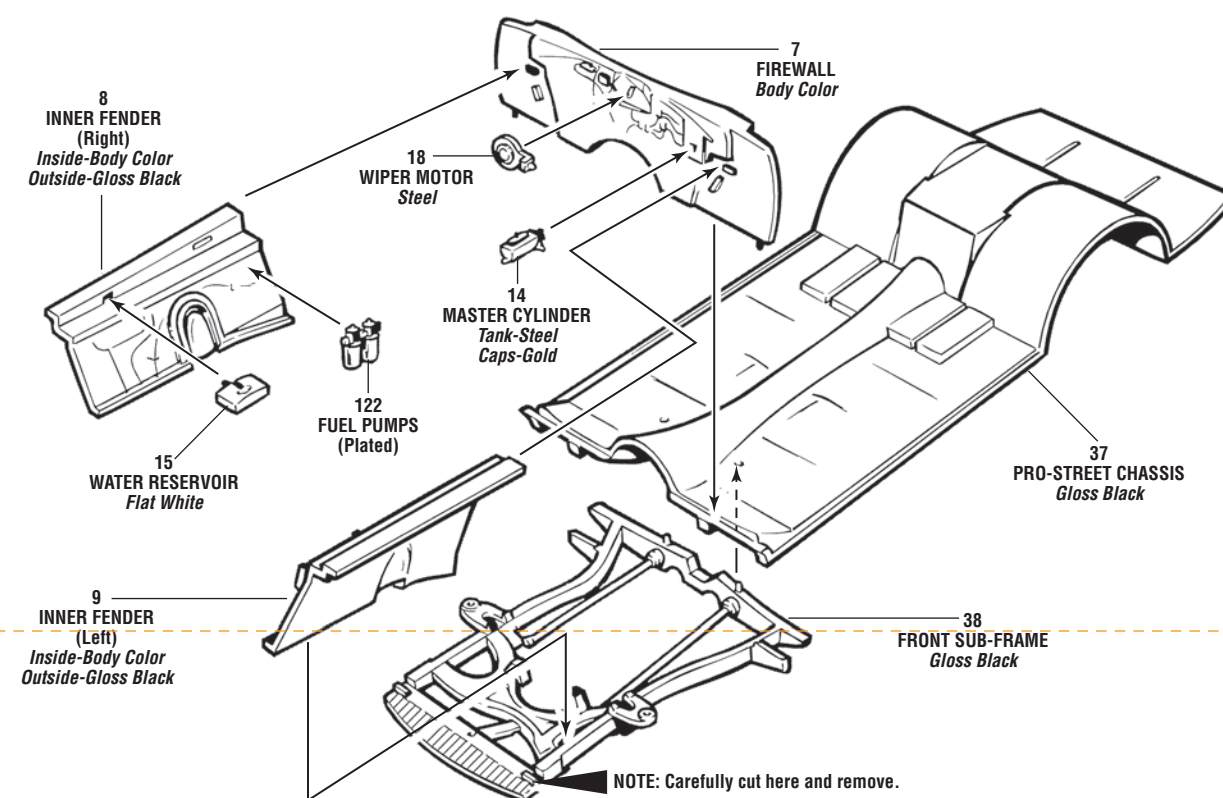

FRONT SUSPENSION ASSEMBLY

TIRE PREPARATION B1



FRONT WHEEL ASSEMBLY B2

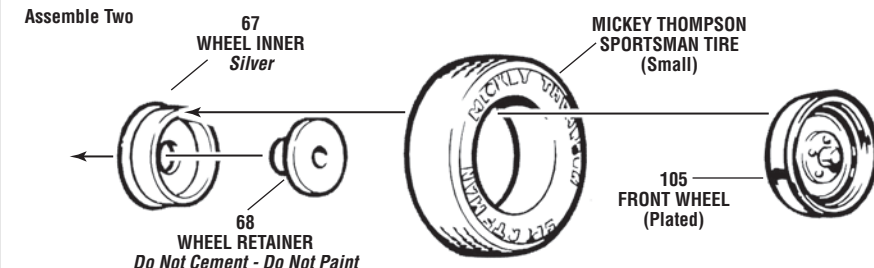

FRONT SUSPENSION ASSEMBLY B3

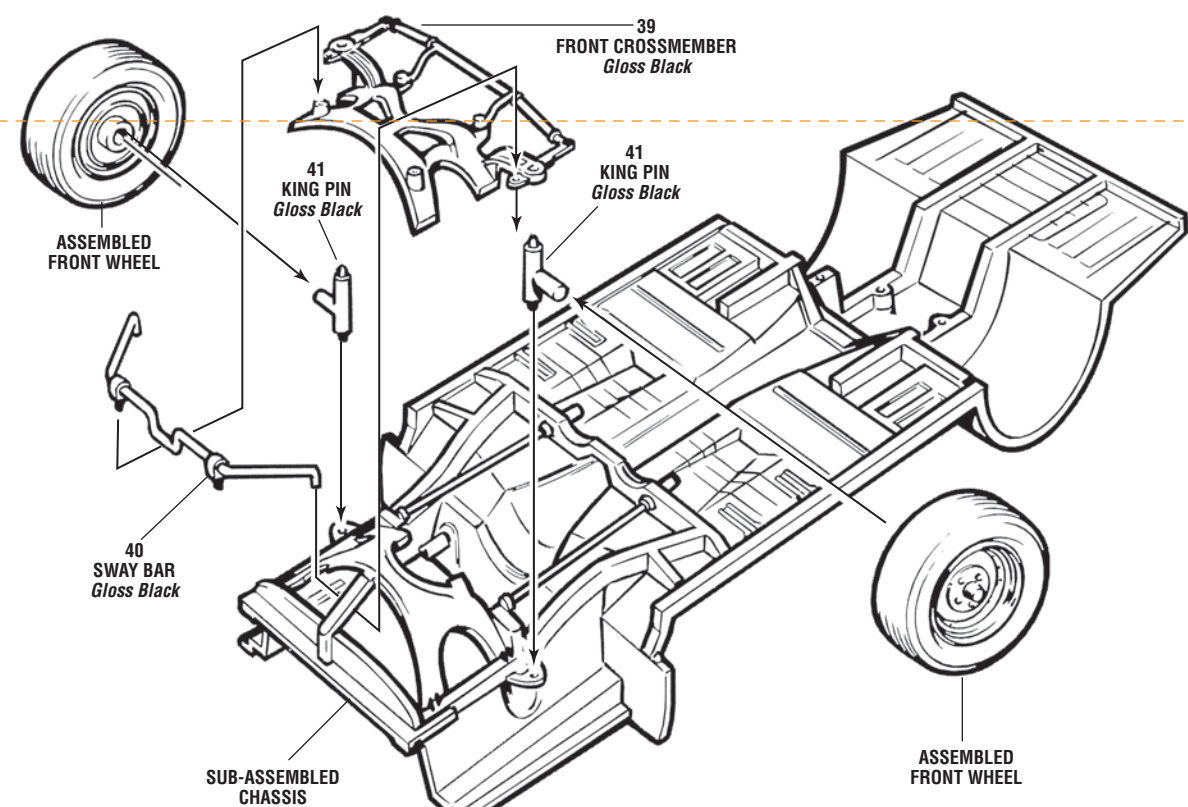

2 CHASSIS ASSEMBLY continued

ENGINE/CHASSIS ASSEMBLY C

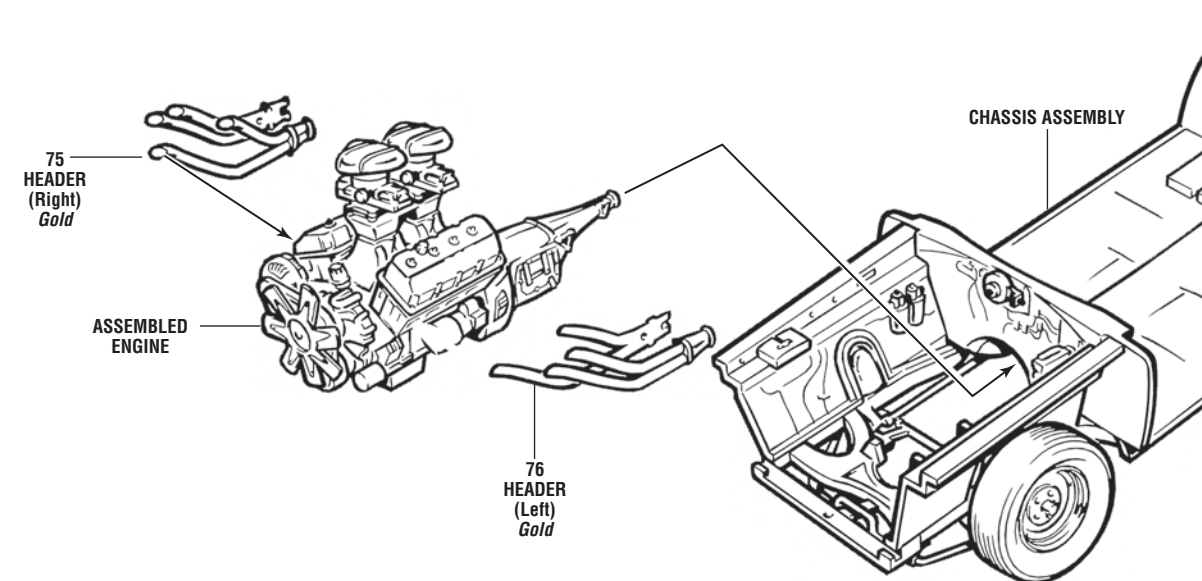

COOLANT SYSTEM/MISC ASSEMBLY D

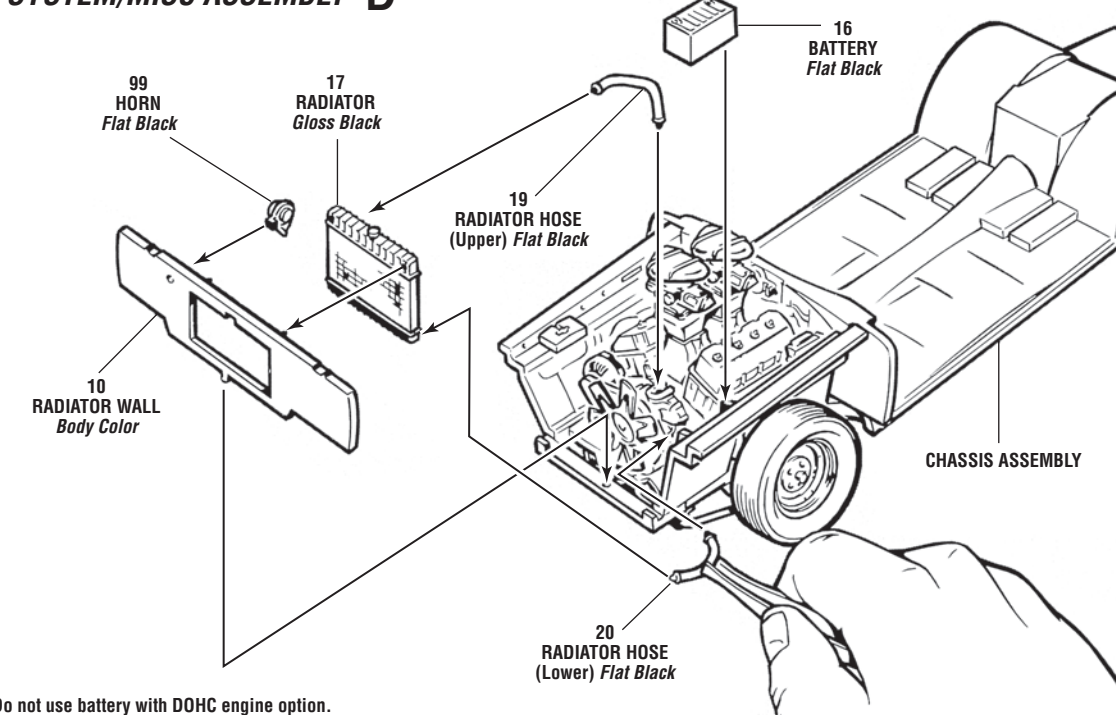

NOTE: Do not use battery with DOHC engine option.

REAR SUSPENSION/DRIVE-TRAIN ASSEMBLY

TIRE PREPARATION E1



REAR WHEEL ASSEMBLY E2

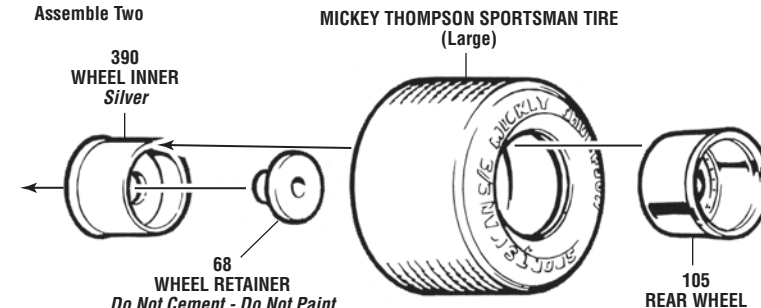

REAR AXLE ASSEMBLY E3

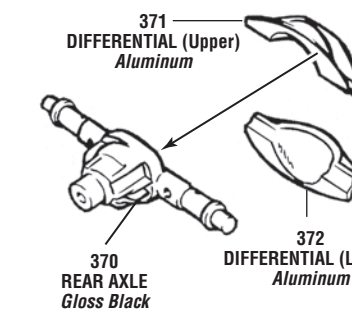

REAR SUSPENSION/DRIVE-TRAIN ASSEMBLY E4

