

Albatros D.V

The D.V and similar D.Va were the final production developments of a significant family of WWI fighters built by the Albatros Flugzeugwerke. The type was characterized by a very aesthetic appearance that was carefully refined from its predecessors: The fuselage was a smooth plywood veneer semi-monocoque structure with gracefully transitioned cross-section changing from circular at the front to elliptical throughout the length of the fuselage and finishing with a horizontal knife edge at the rear. The nose was capped by a bulbous spinner and the forward fuselage was closely cowled by metal panels leaving only the top of the engine exposed to spoil the streamlined contours. The tail surfaces were pleasantly rounded giving the empennage a fish-like flair and the tail skid was supported by a swept triangular ventral fin. The wing cellule was a sesquiplane configuration, the upper plane being notably larger in span and cord than the lower, attached with 'V' strut interplane bracing and splayed 'N' cabane struts - both upper and lower wingtips were aggressively raked to complete the clean and racy lines of the Albatros.

While the D.V did not deliver the hoped-for increase in performance needed to outpace contemporary Allied machines at the time of its introduction, it was mass produced and began to enter service in May of 1917. Often colorfully decorated by the units and individual pilots of the Luftstreitkräfte, the Albatros D.V was a common sight over the Western Front until the end of the Great War. Although it was not a dominating combat aircraft, it was able to hold its own against any opponent when handled with skill and courage; many of Germany's leading aces had notable success flying the D.V. The markings represented in this kit are for Munich-born Eduard Ritter von Schleich, a Pour le Mérite winner destined to survive WWI with 35 victories. During August of 1917 his D.V was fully camouflaged, but decoratively emblazoned with a rampant Bavarian Lion on a field of blue and white lozenges and black-white fuselage band.

Performance

Wingspan 29 feet 8 inches	Wing Area 228.5 Sq Ft	Speed (Max) 116 mph
Length 24 feet 0.5 inch	Take Off Weight 2132 pounds	Service Ceiling 9840 feet
Engine: 180 h.p. Mercedes D.IIIaU	Armament: (2x) LMG 08/15 Spandau machine guns	Endurance 2 hours

ATTENTION - Read the instructions carefully prior to assembly. Remove parts from frame with a sharp knife or a pair of scissors and trim away excess plastic. Do not pull off parts. Part numbers are marked as such: **1,2,3...** Frames, in which the parts are situated, are marked by capital letters: **A,B,C...** Parts (which need painting prior to mounting) are given colors for paint: **A B C...** Use plastic cement ONLY.

Decals: Cut from the sheet as needed (numbers of decals are marked by figures in squares **1 2 3 ...**); submerge in water until decal loosens from paper; apply the decal to the kit and blot with a clean rag.

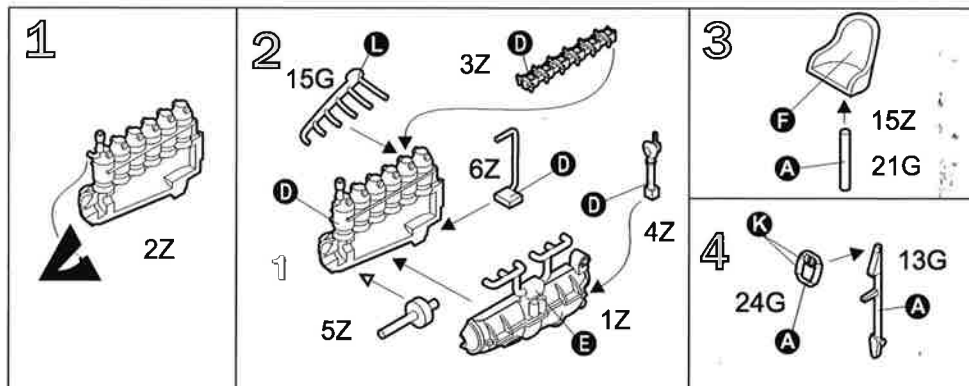

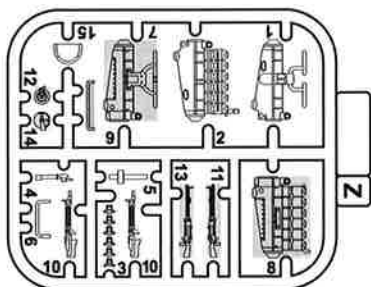
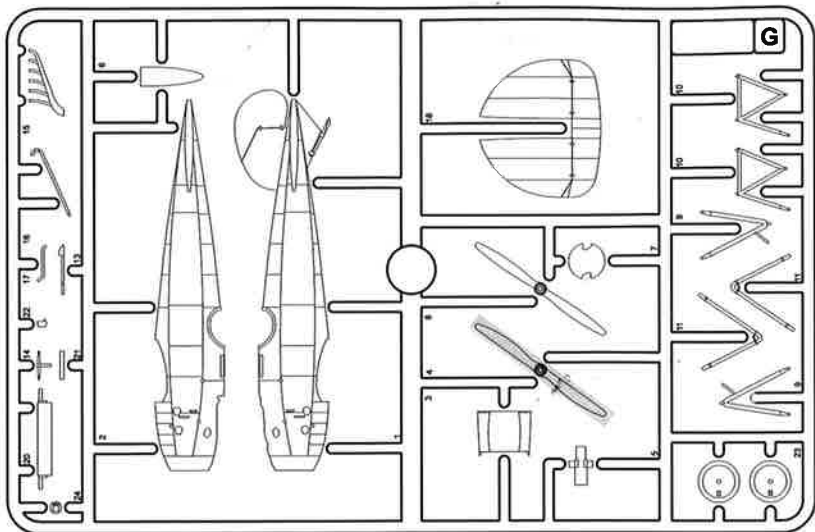

Unused Parts

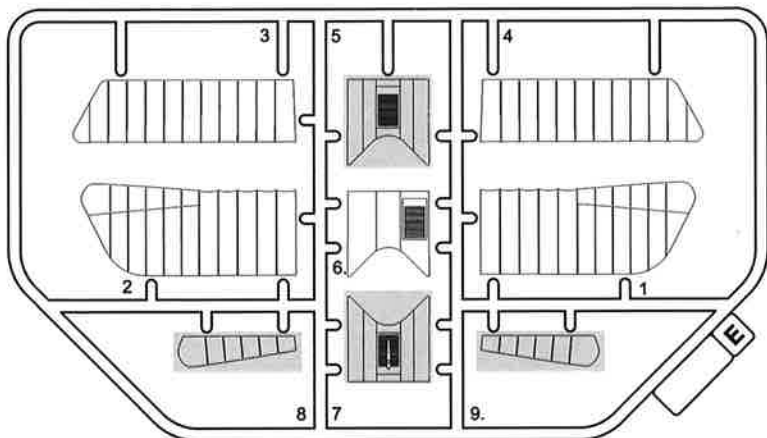

5

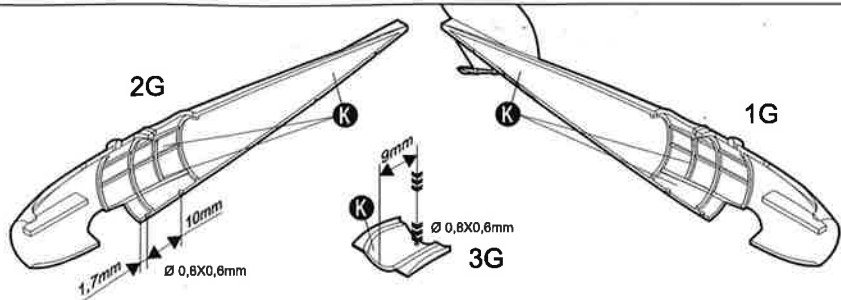

6

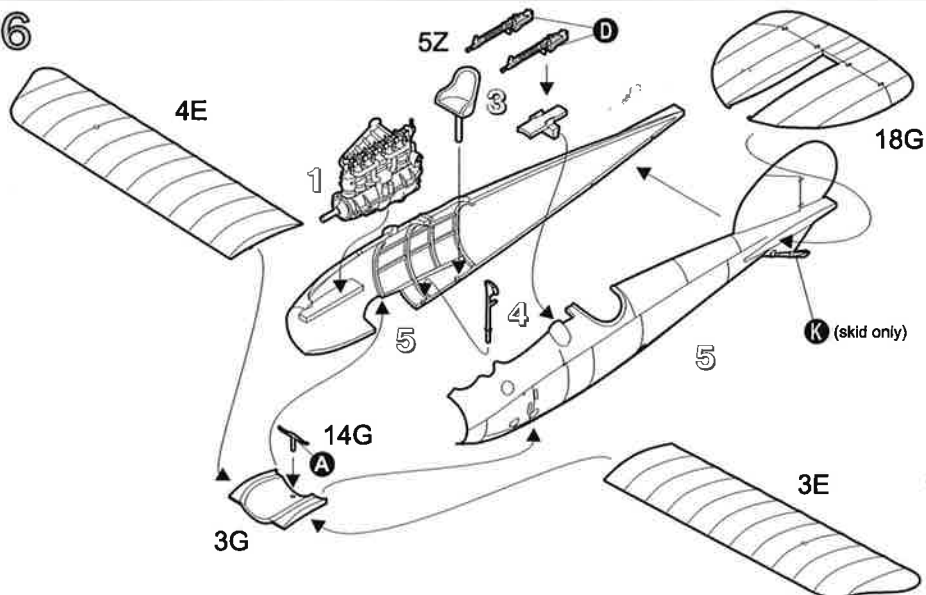

7

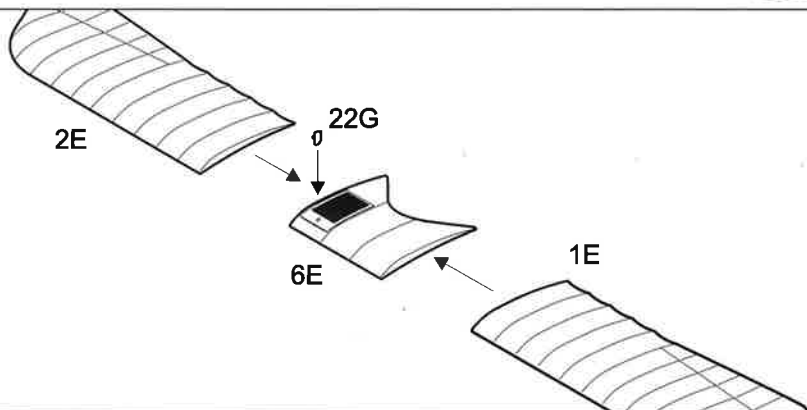

8

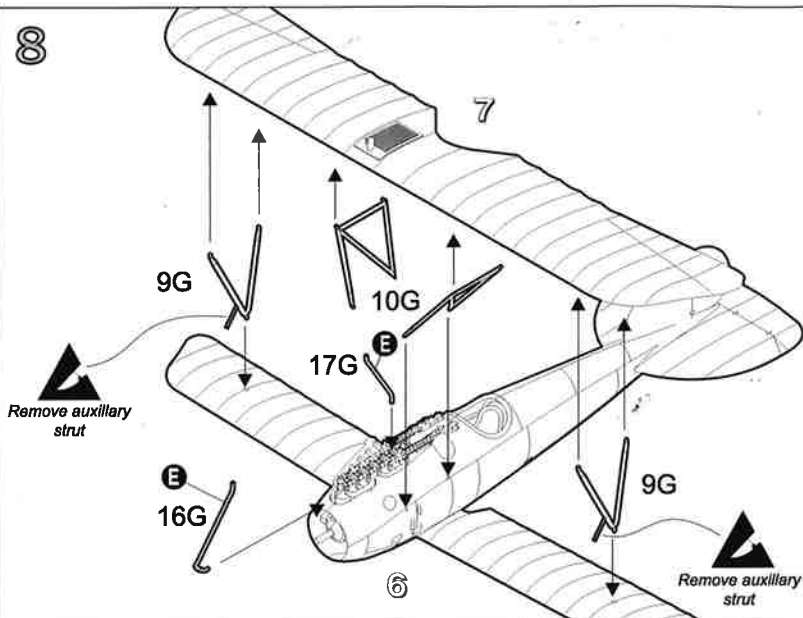

9

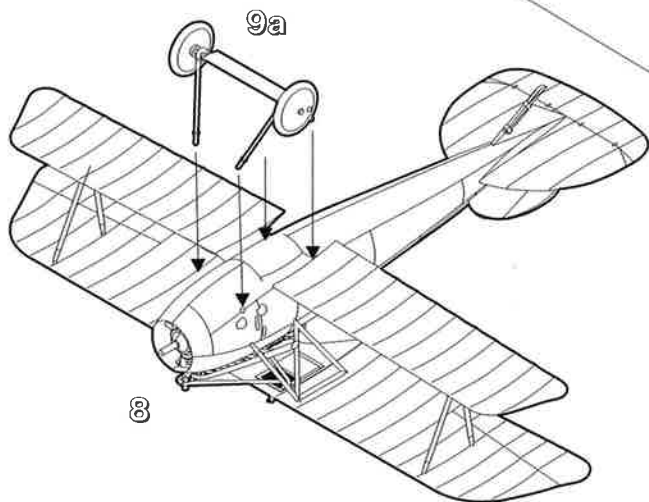

9a

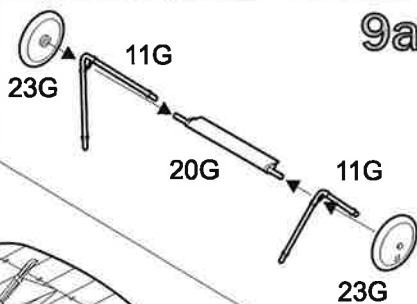

See back of painting
guide for STEP 10.

10

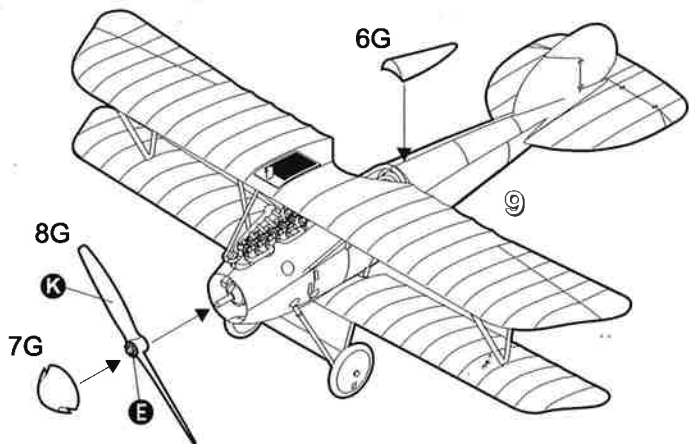

RIGGING

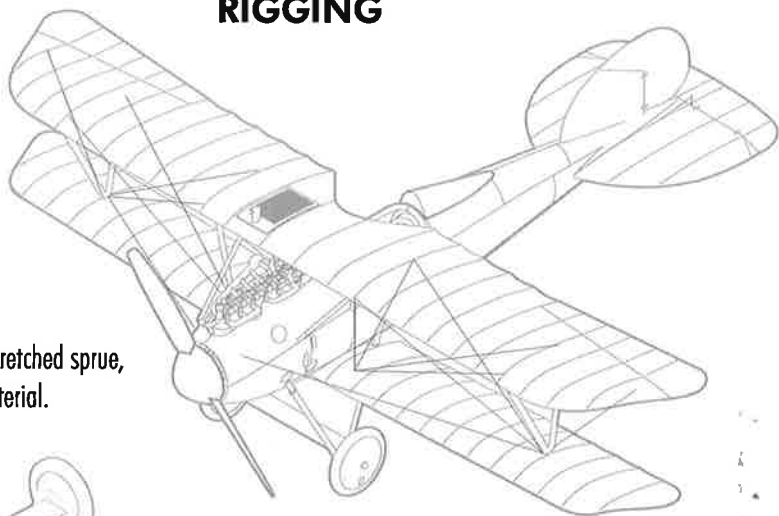

Rig with fine wire, stretched sprue, or your choice of material.

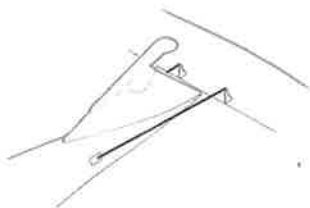
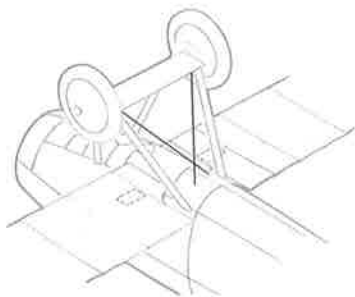

Albatros D.V

Albatros D.V of
Eduard Ritter von Schleich,
Jasta 21, 1917.

EconoKit

Painting Reference

 A	 B
FS36165 Matt Gray-Green	FS37038 Matt Black
 C	 D
FS37875 Matt White	Gun Metal
 E	 F
Aluminum	FS30117 Leather
 G	 H
FS35237 Medium Gray	FS34097 Matt Green
 I	 J
Mauve	FS35414 Matt Light Blue
 K	 L
FS30260 Natural Wood	Rust

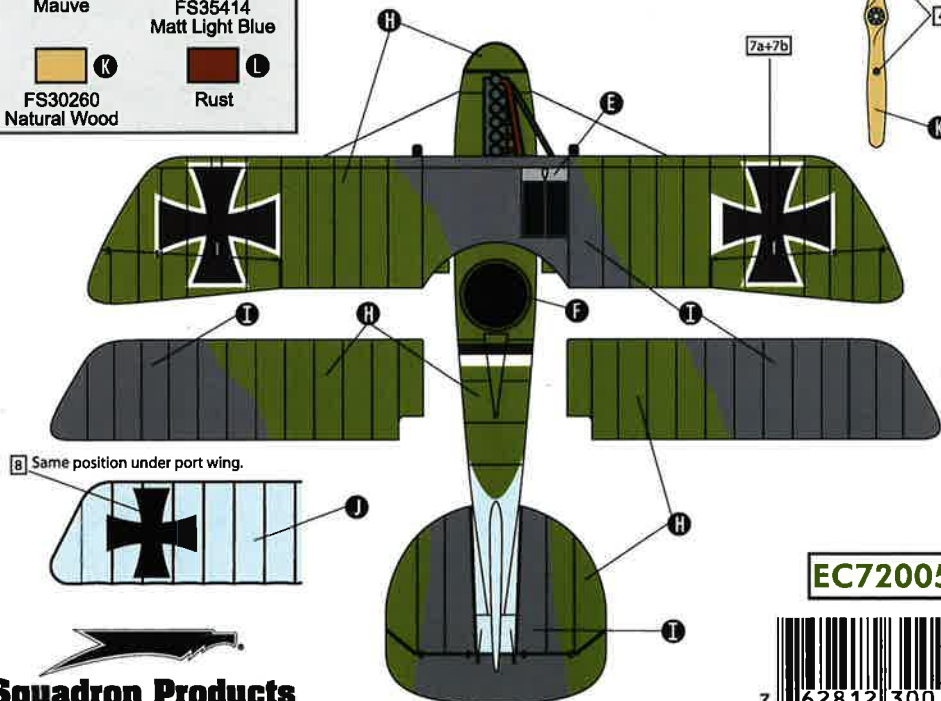
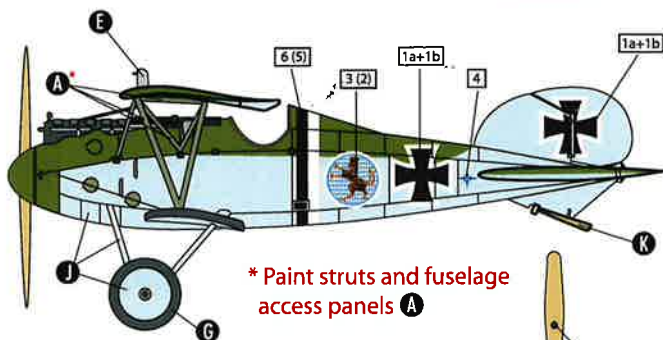

EC72005



Squadron Products