



BR48349

Sea Fury Engine Front & Spinner Correction

Designed for the new tool Airfix
1/48 scale Hawker Sea Fury kit

This set directly replaces the Airfix engine front, cowl ring and spinner.
It also works well with our Sea Fury Cowling Upgrade BR48350.

- 1) Begin by carefully sawing the engine casting from the base, or by paring down the outside diameter of the base, so it slides into the assembled engine cowling, locating by the small and large tabs.
- 2) Carefully saw cowling ring from base. Clean up & test fit. Remove spinner baseplate. Sand rear face flush. Remove prop shaft and test fit to engine front. Attach with CA.
- 3) Remove spinner from plug by sawing casting web off at the base. Clip off main casting channel with nippers. Cut or clip off the four support ribs as shown. Carefully block sand base of spinner until casting web becomes paper thin. Peel off. Clean out blade slots and cleanup. Build rest of model per kit instructions.

Happy modelling!

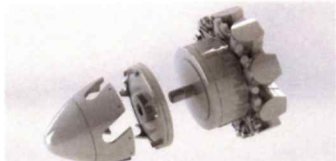

Check out more cool 1/48 Sea Fury sets and decals at
www.barracudacals.com



Master Patterns by Roy Sutherland

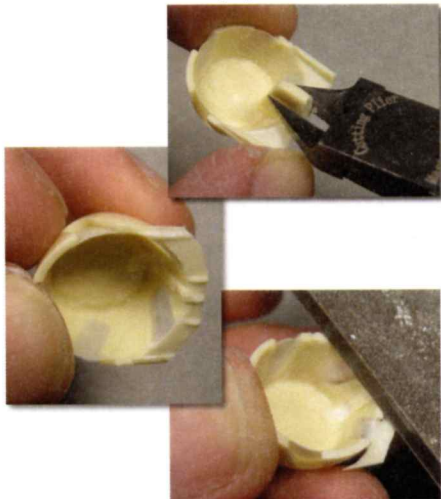

You can download and print a larger version of these
instructions from the product page on our website.