

ITEM NO.02222

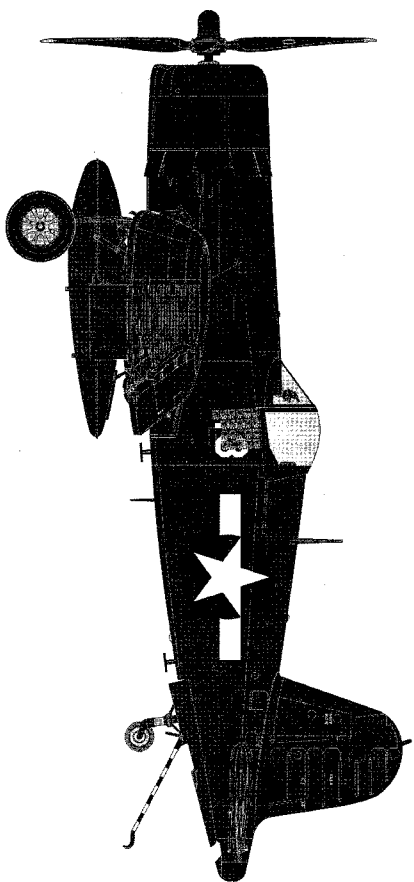

# Vought F4U-4 Corsair

1:32 SCALE

美国F4U-4海盗

## READ BEFORE ASSEMBLY

- Study and understand this instructions thoroughly before beginning assembly.
- Remove all injection pins carefully using a modeling file.
- Cut off the photo-etched parts carefully using a modeling knife. Be sure not to lose small parts.
- Apply instant cement to photo etched parts and shafts. Apply too much instant cement will cause movable parts to stick. Apply cement carefully.
- Extra care should be taken to avoid personal injury when handling the photo etched parts.
- Some parts should depend on decals: Select prior to assembly.
- Tools recommended: (Not included in this kit)  
Cement; Side cutters; Long nose pliers; Modeling knife; Modeling file; Tweezers; Pin vise; Scissors; Instant cement.
- Soft cloth and sand paper will also assist in construction.
- Glue and paints are not included in the kit. Use plastic cement or paints only.
- Keep out of reach of small children. Children must not be allowed to suck any part, or pull vinyl bag over the head.

## 装配之前仔细阅读

- 小心用模型锉刀锉平所有零件表面的注射浇口。
- 小心用刀片切下蚀刻片零件，不要遗失小零件。
- 用强力快干胶水粘合蚀刻片零件和金属轴。过量的快干胶水使用可能导致可动零件会粘住，小心涂胶。
- 取蚀刻片时应特别注意安全，防止利边划伤手指。
- 某些零件表面需贴上水贴纸，请选择在装配的同时进行。
- 推荐模型工具(自备)：胶水，水口剪刀，长咀钳，刀片，镊子，镊子钳，钻，剪刀，瞬间快干胶。
- 软布同砂纸同时也应该是必备工具。
- 请使用塑料胶水和油漆，模型内不含。
- 谨防小孩吮吸塑料零件，或者将塑料袋套在头上，制作时应将套材远离小孩接触。

## 水贴纸的使用:

1. 从水贴纸上剪下印花;
2. 将印花放入温水中浸10秒, 然后放在干净布上.
3. 拿着印花纸板将印花移到模型上;
4. 手指蘸水将印花移到适当的位置;
5. 用软布轻压印花直至水干, 汽泡消失.

## DECAL APPLICATION

1. Cut off decal from sheet.
2. Dip the decal in tepid water 40° C for about 10 sec. and place on a clean cloth.
3. Hold the backing sheet edge and slide decal onto the model.
4. Move decal into position by wetting decal with finger.
5. Press decal gently down with a soft cloth until excess water and air bubbles are gone.



cyanoacrylate glue  
使用强力胶



weight  
配置



make hole  
钻孔



cut / remove  
切除



bend  
弯曲



file / sand  
锉平



option  
选择



no cement  
不涂胶水



decal  
贴纸

部品图  
Parts

A

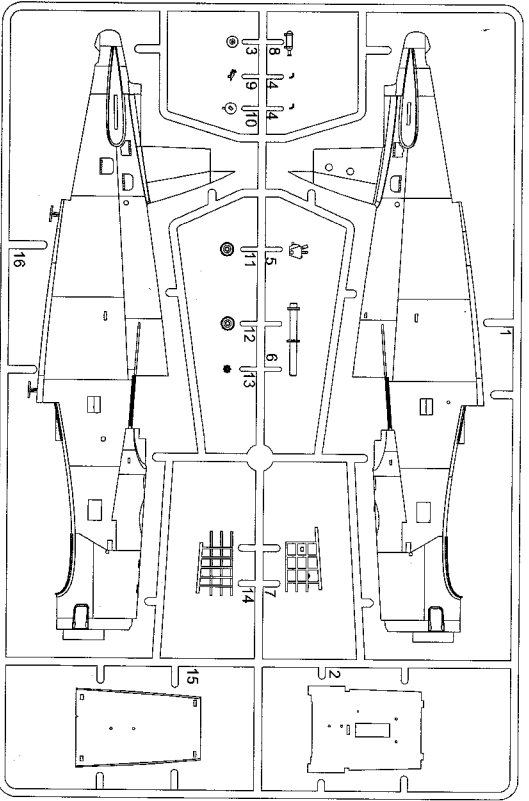

B

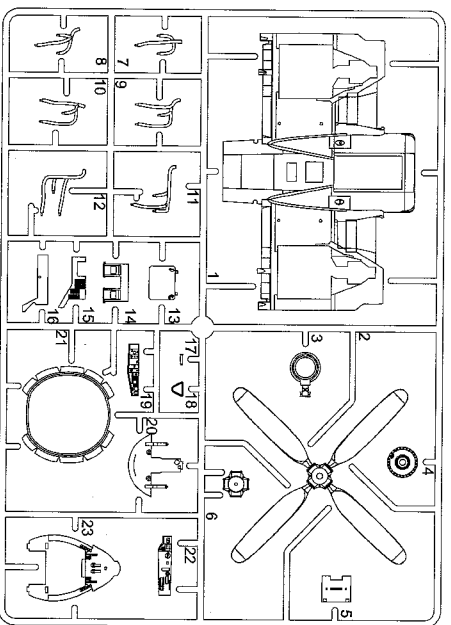

C

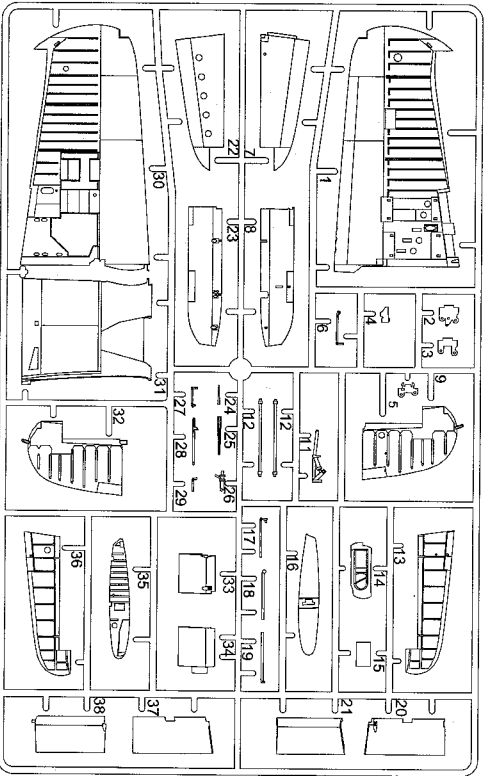

D

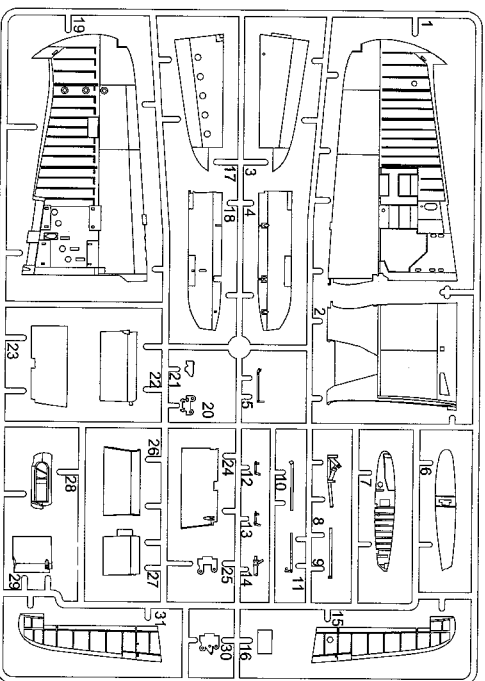

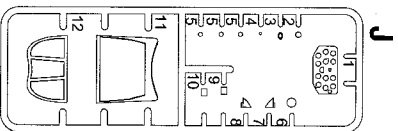
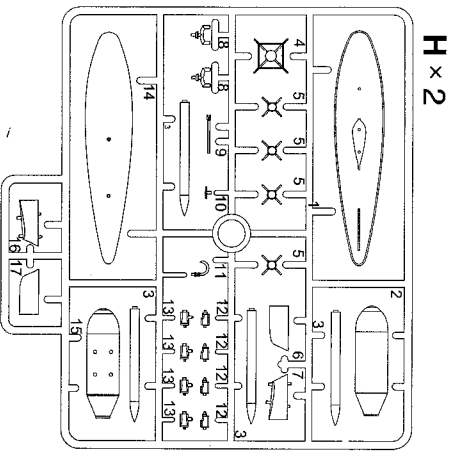
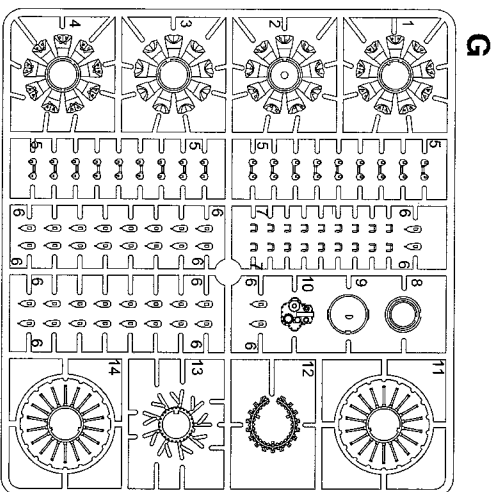
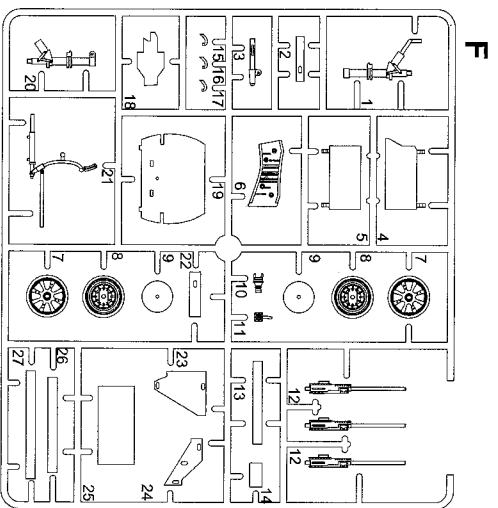
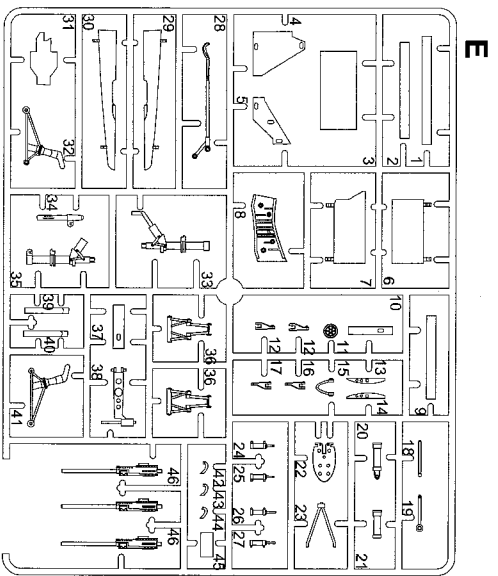

H × 2

J

《尾轮胎》  
Tail tire



《主轮胎》  
Main tire

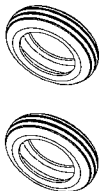

《引擎罩》  
Cowling

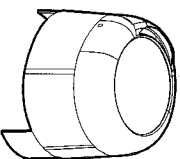

《菲林》  
Film



轴  
Shaft

铜丝  
Brass wire

- ø1.0 × 47mm 4PCS
- ø1.0 × 8mm 1PCS
- ø1.0 × 3.8mm 2PCS
- ø0.8 × 70mm 1PCS

《蚀刻片》  
Photo etched part(PE)

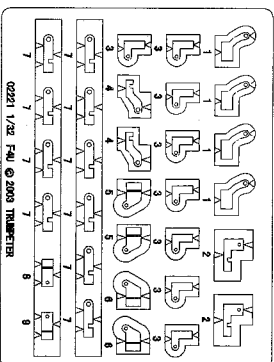

《水贴纸》  
Decal

02221 1/32 F4U © 2008 TRUMPETER

**1** 发动机的组装  
Engine assembly

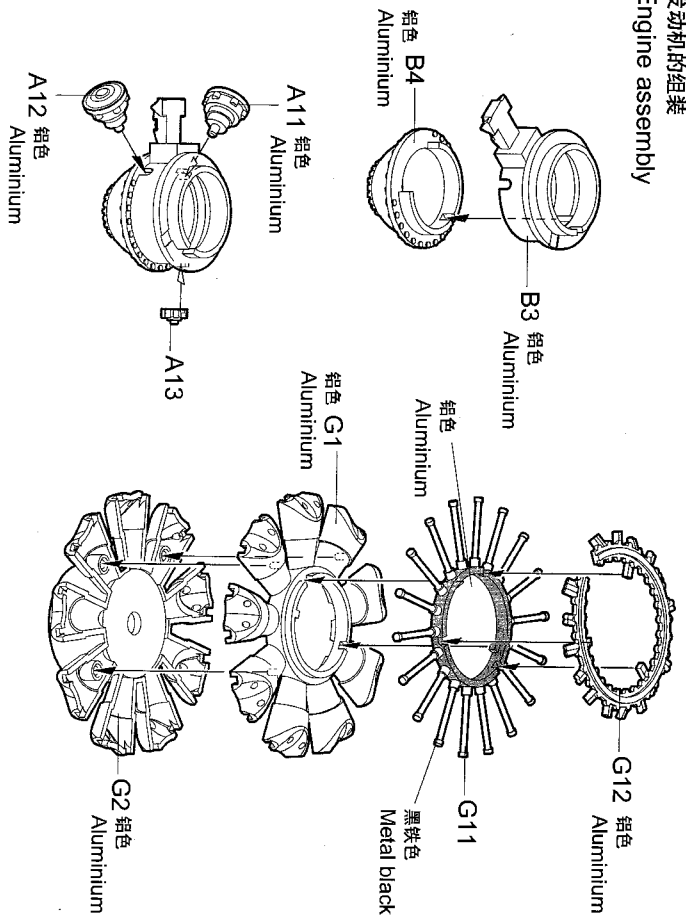

**2** 发动机的组装  
Engine assembly

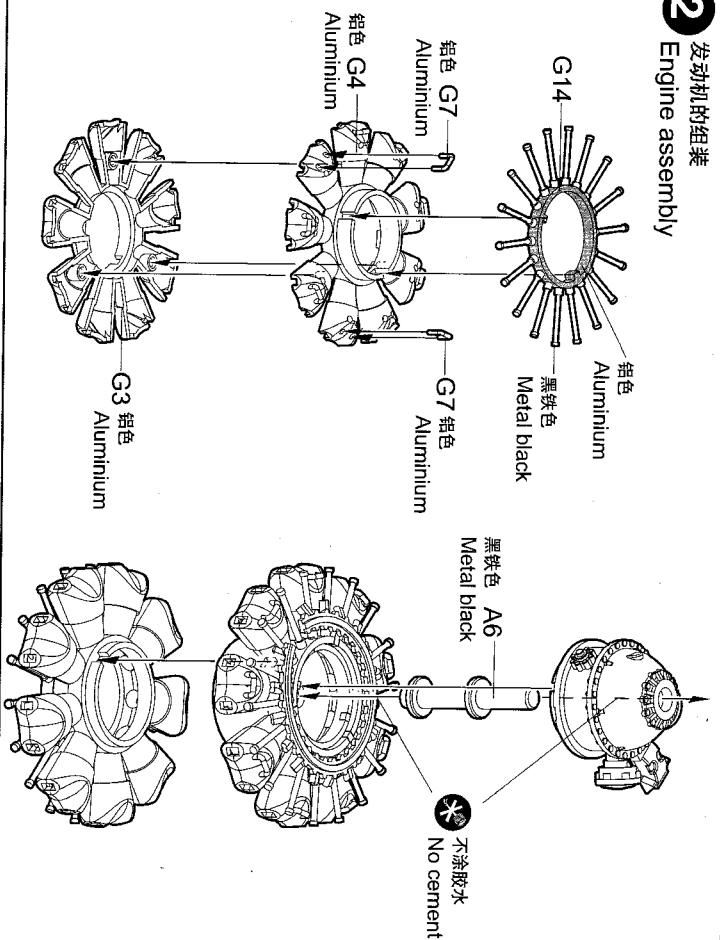

**3** 发动机的组装  
Engine assembly

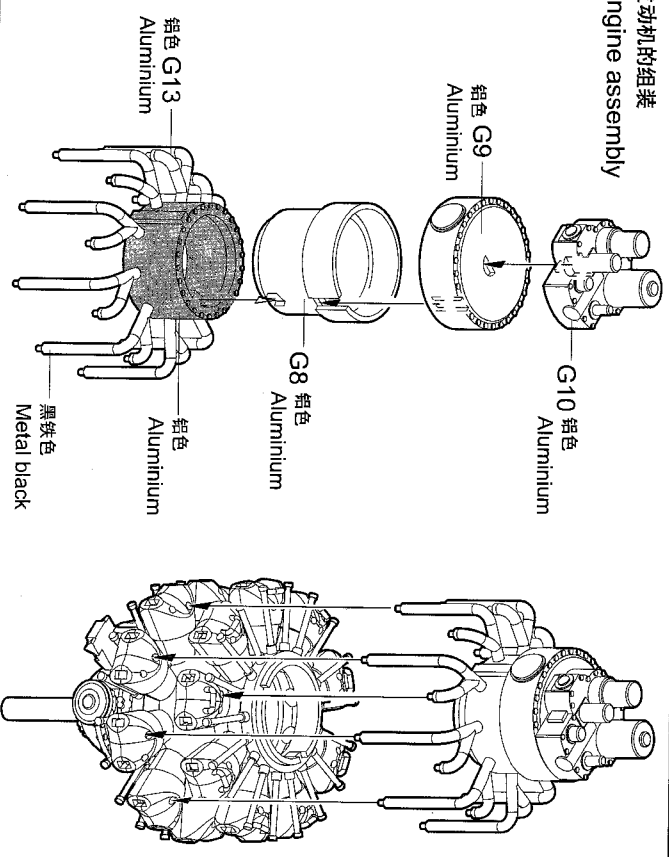

**4** 发动机的组装  
Engine assembly

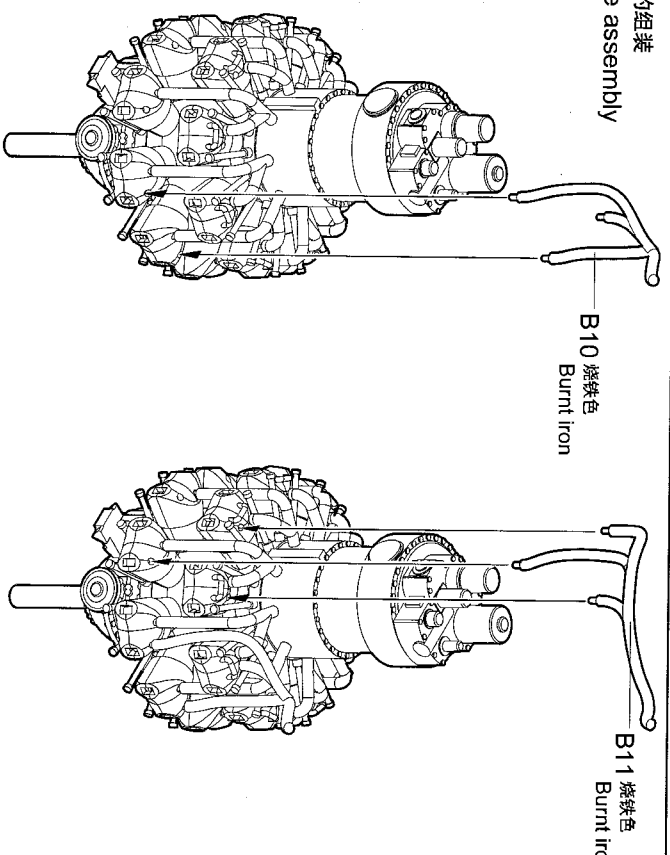

**5** 发动机的组裝  
Engine assembly

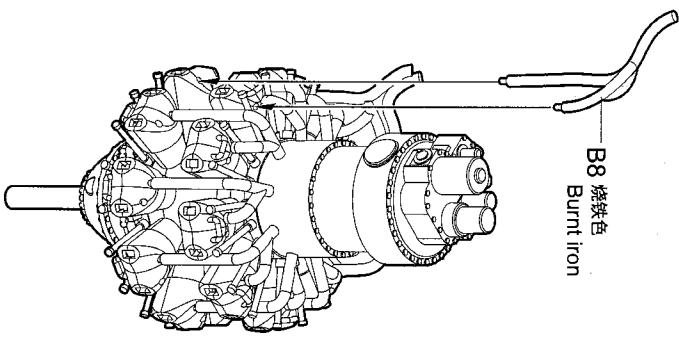

B8 烧铁色  
Burnt iron

**6** 发动机的组裝  
Engine assembly

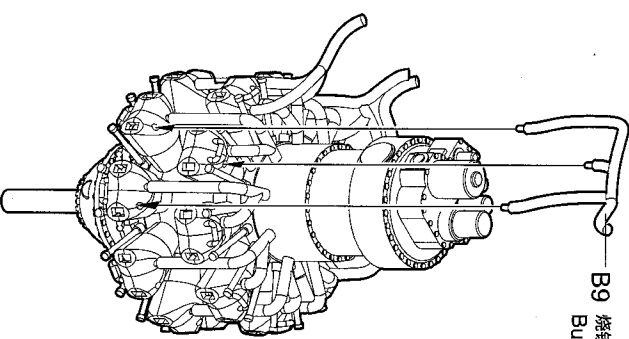

B9 烧铁色  
Burnt iron

**7** 发动机的组裝  
Engine assembly

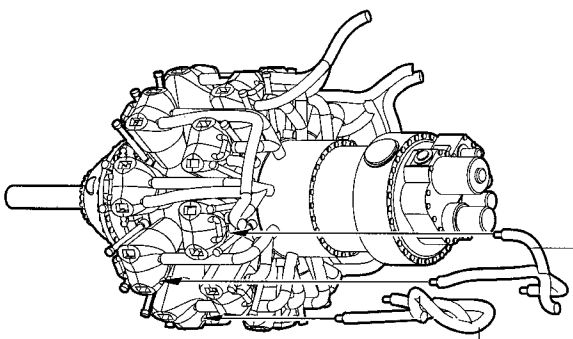

B7 烧铁色  
Burnt iron

B12 烧铁色  
Burnt iron

**8** 发动机的组裝  
Engine assembly

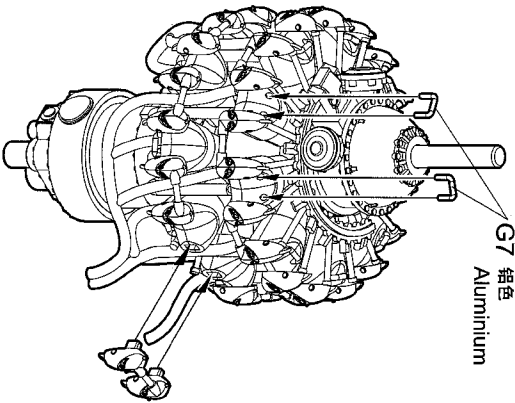

G7 铝色  
Aluminium

**9** 仪表板和座椅的组裝  
Instrument panel & pilot seat assembly

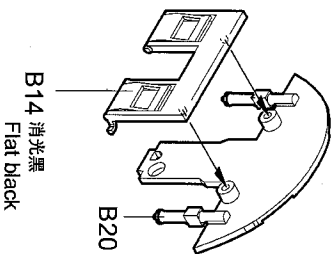

B14 消光黑  
Flat black

B20 消光黑  
Flat black

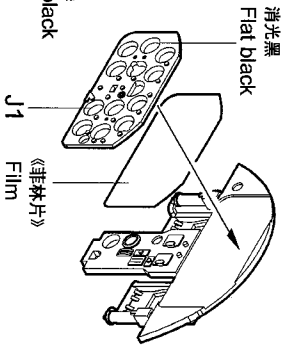

消光黑  
Flat black

J1  
「菲林片」  
Film

B13

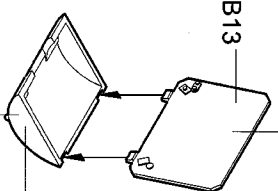

B5

机体内部绿  
US Interior green AN611

机体内部绿  
US Interior green AN611

制作18组  
Make eighteen

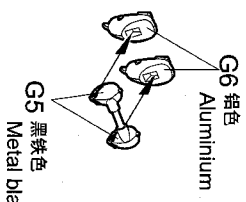

G6 铝色  
Aluminium

G5 黑铁色  
Metal black

**10** 仪表板和座椅的安装  
Instrument panel & pilot seat installation

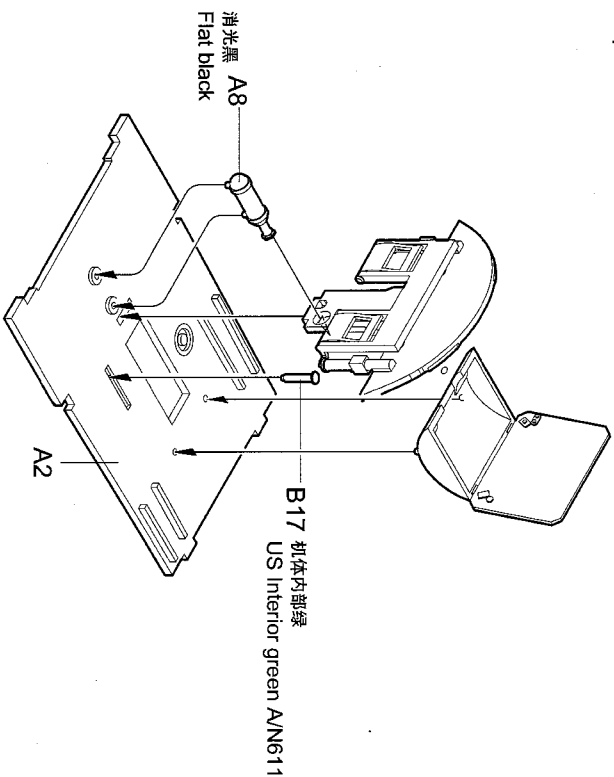

**11** 座舱的组装  
Cockpit assembly

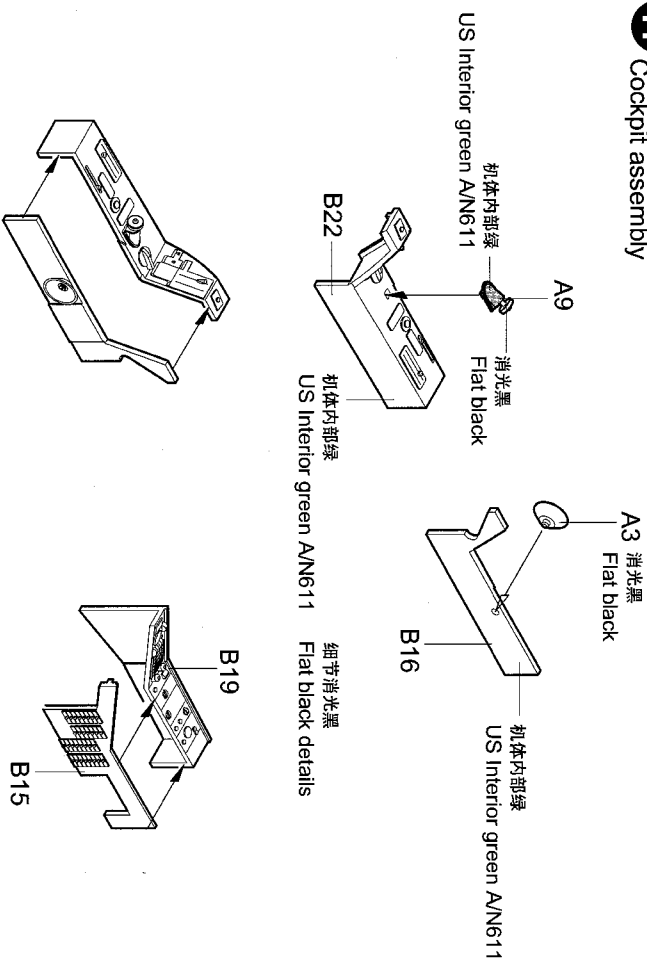

**12** 座舱的组装  
Cockpit assembly

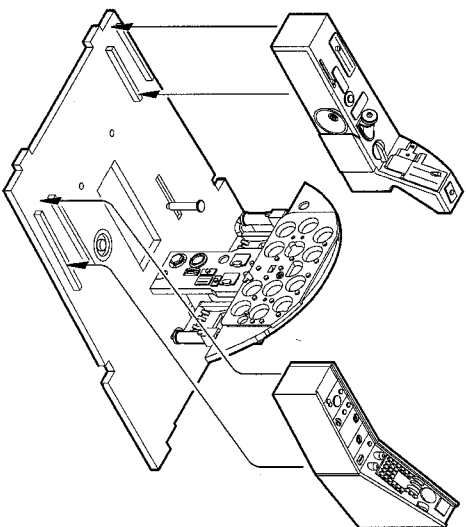

**13** 座舱的组装  
Cockpit assembly

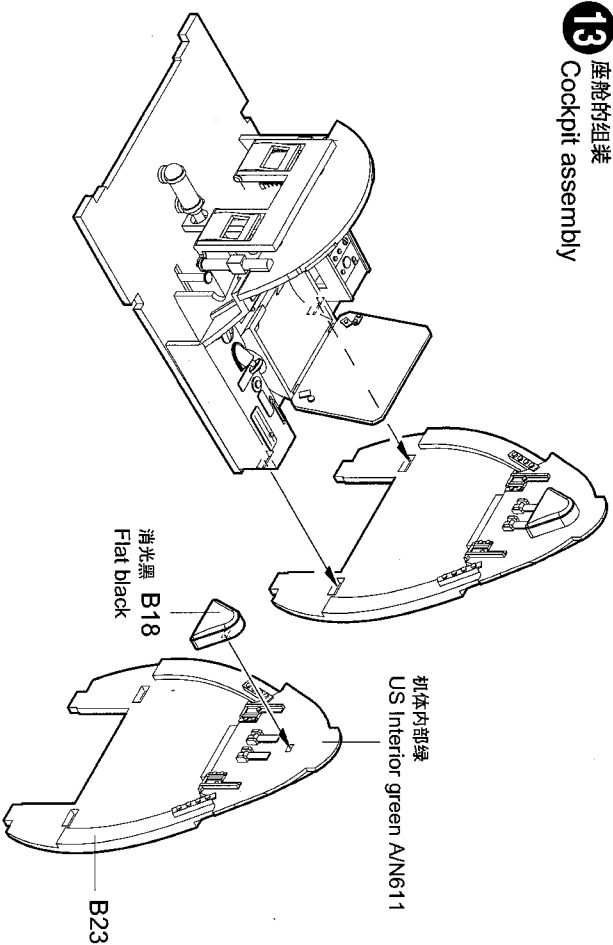

**14** 座舱的组装  
Cockpit assembly

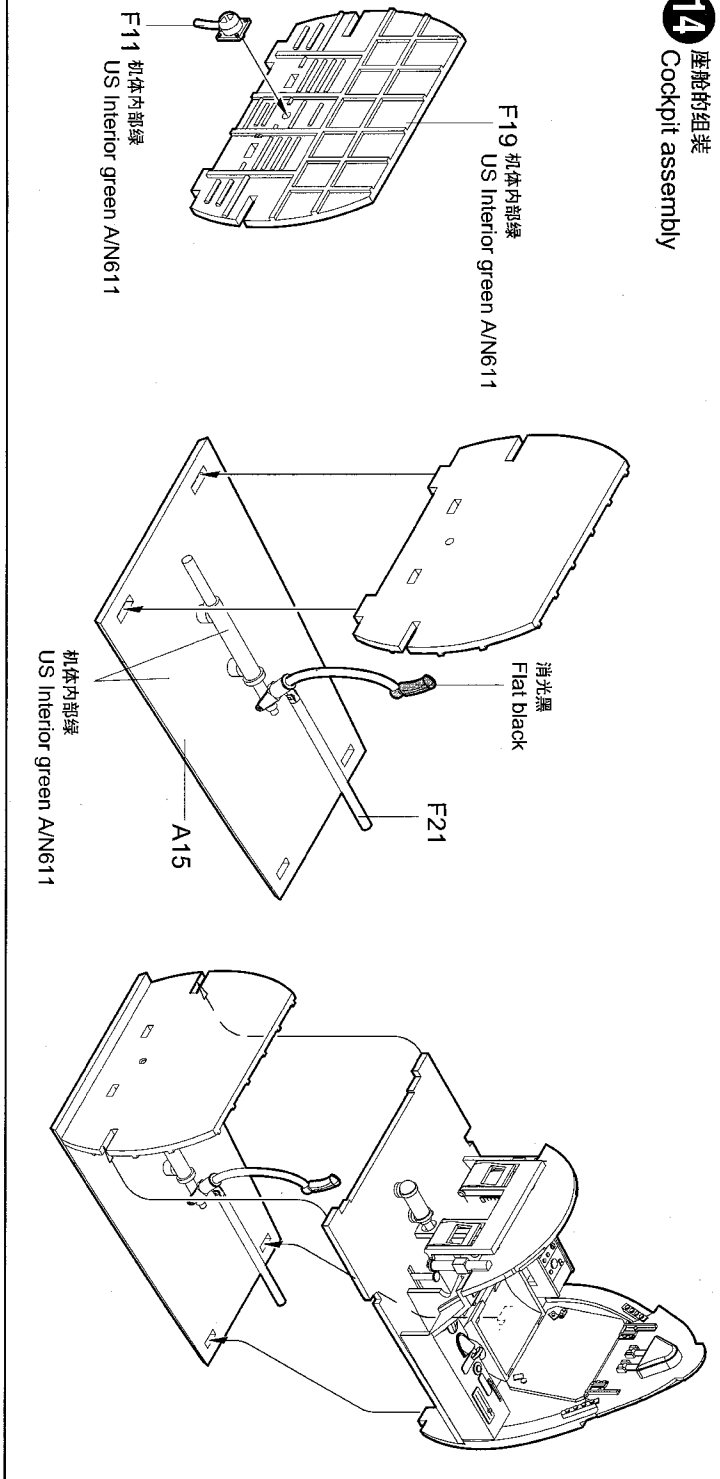

**15** 尾轮的组装  
Tail gear assembly

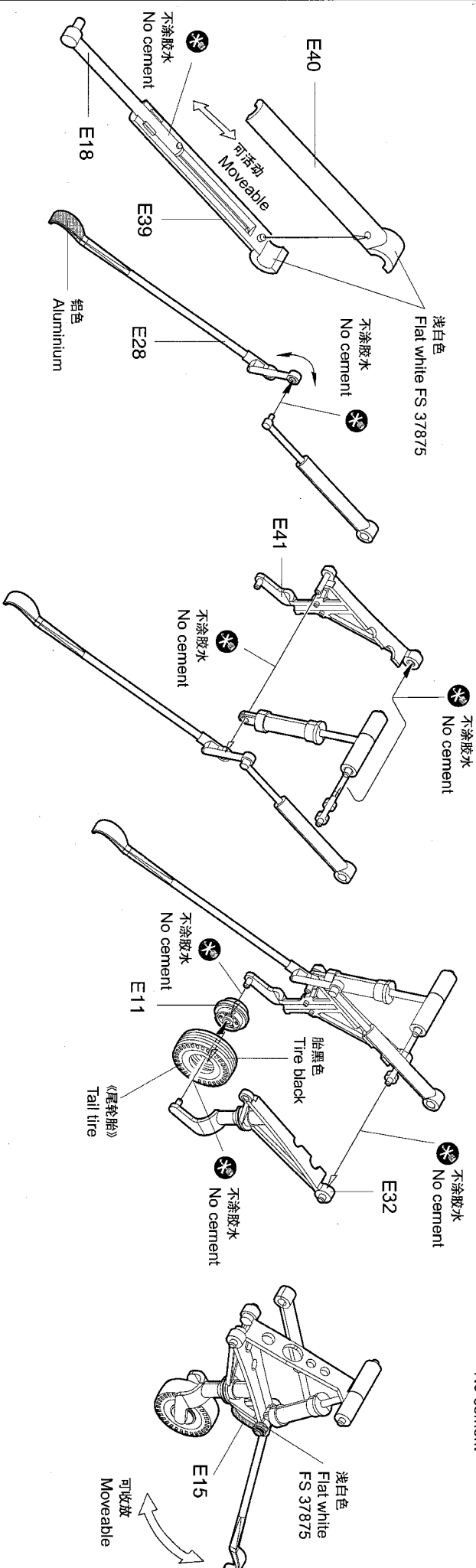
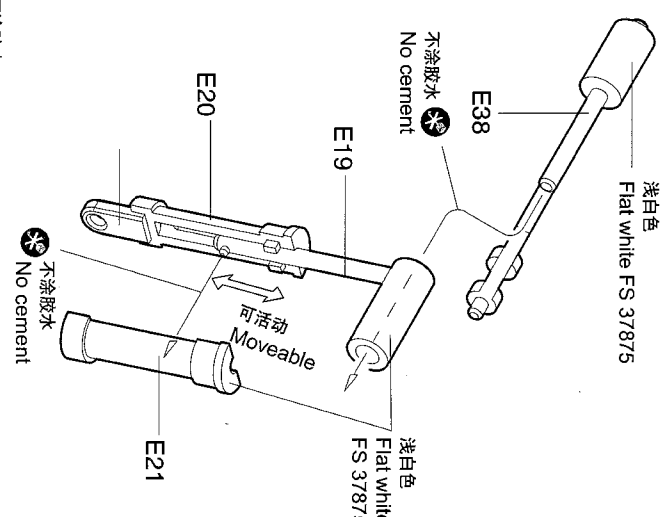

**16** 右侧机身的安装  
Right fuselage installation

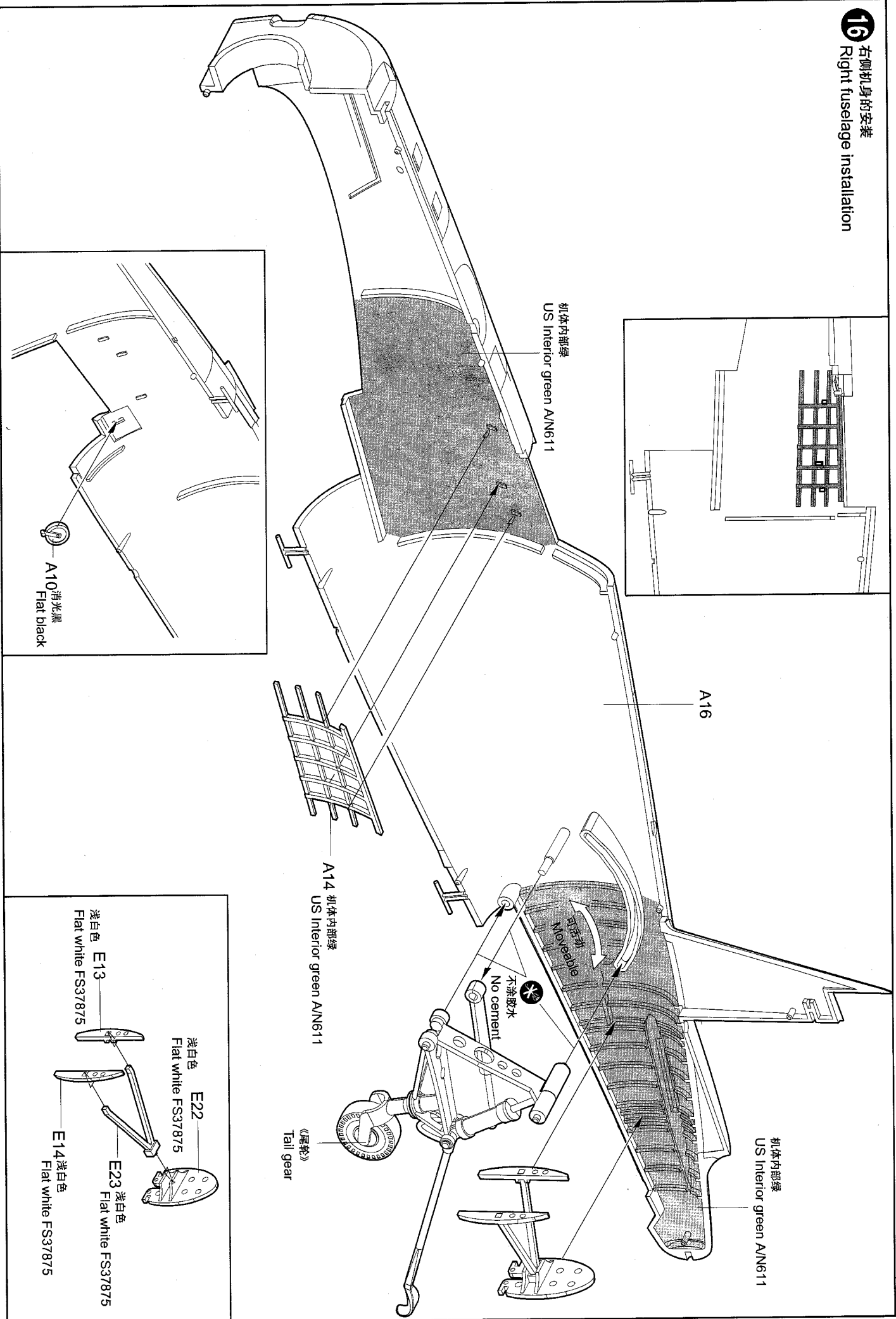

022222



**17** 机身的组装  
Fuselage assembly

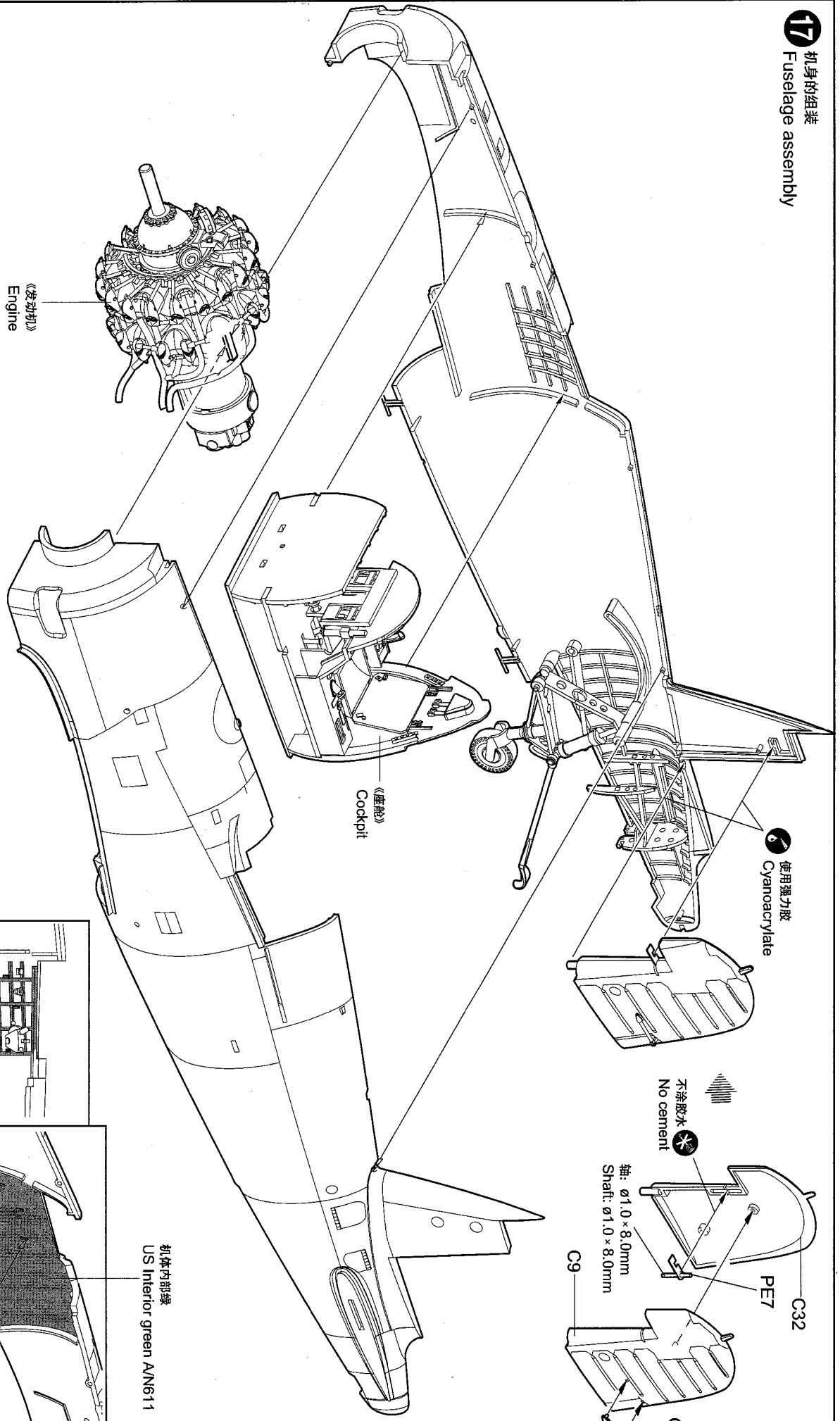

不涂胶水  
No cement

轴:  $\phi 1.0 \times 8.0\text{mm}$   
Shaft:  $\phi 1.0 \times 8.0\text{mm}$

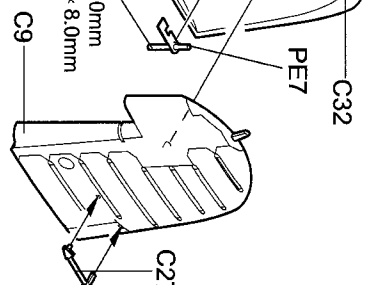

机体内部绿  
US Interior green AN/611

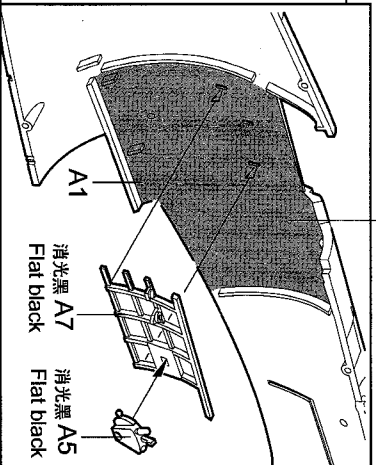
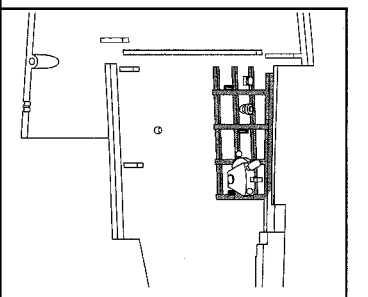

**18** 左侧水平尾翼的组装  
Left horizontal stabilizer assembly

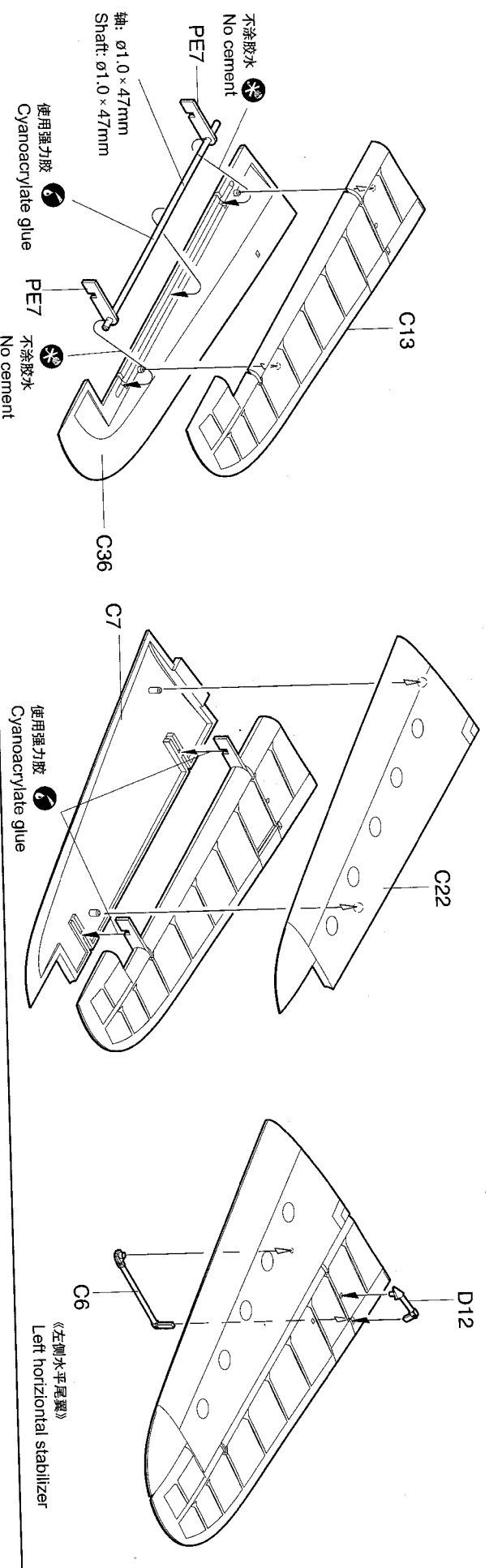

**19** 右侧水平尾翼的组装  
Right horizontal stabilizer assembly

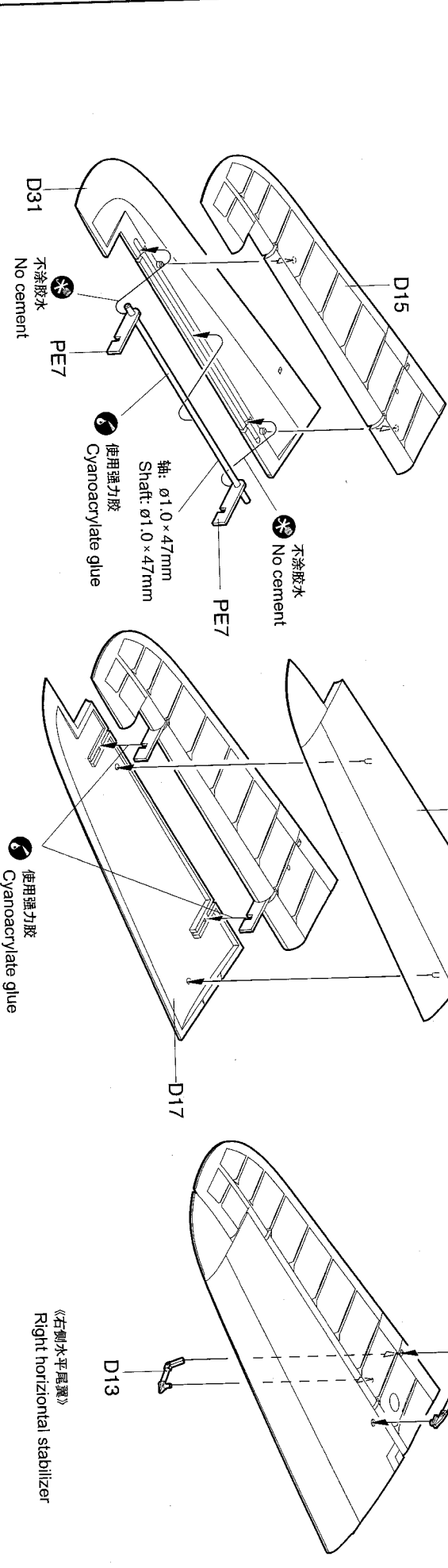

**20** 襟翼与副翼的组装  
Wing aileron and  
outboard flap  
assembly

将铜丝穿过蚀刻片，切下所需长度，然后修整两端。  
Insert brass wire into PE parts and cut to required length and trim the ends.

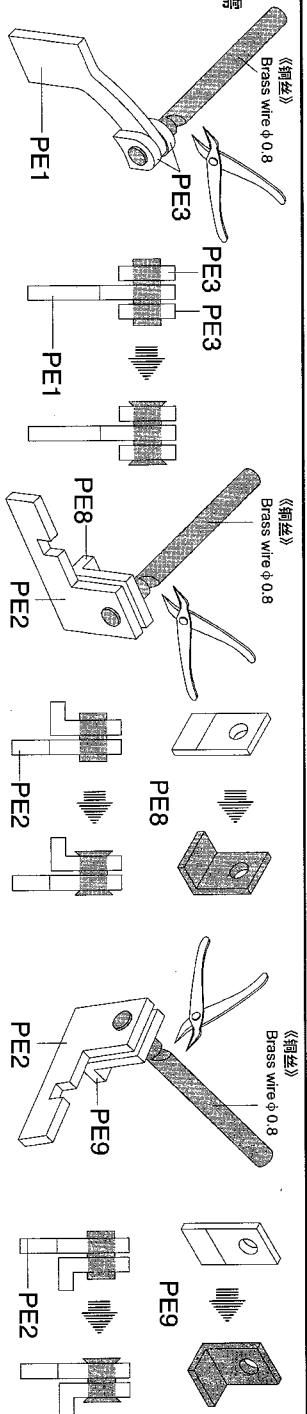

《右侧副翼》  
Right flap

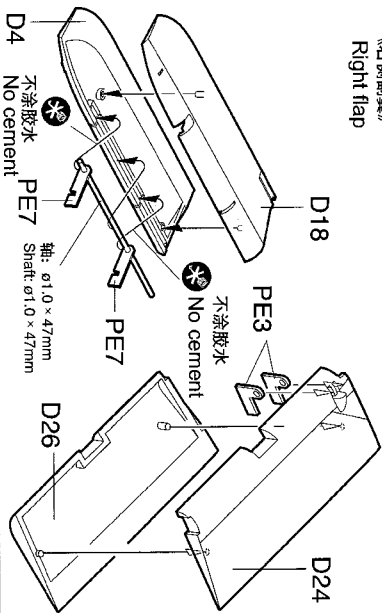

《右侧襟翼》  
Right aileron

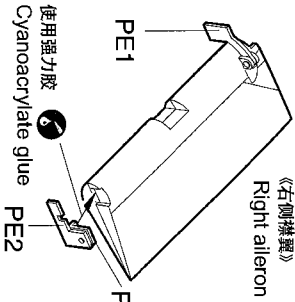

《左侧副翼》  
Left flap

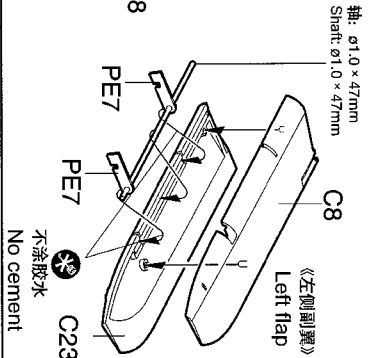

C20

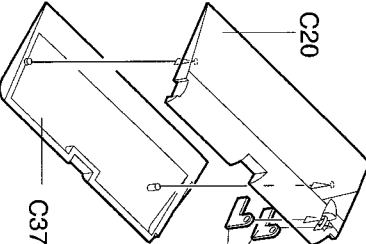

《左侧襟翼》  
Left aileron

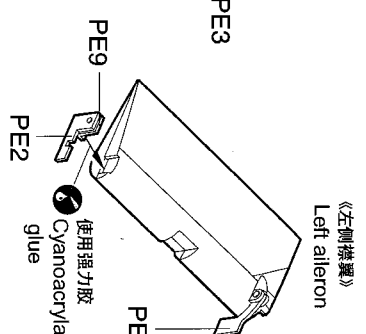

**21** M2机枪的安装  
M2 machine gun installation

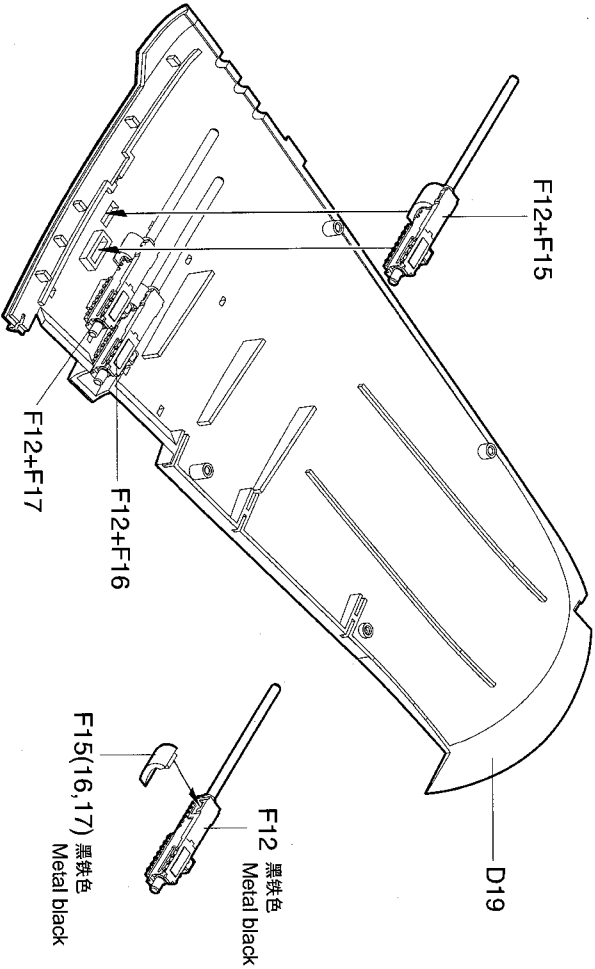

**22** 弹仓的安装  
Gun bay installation

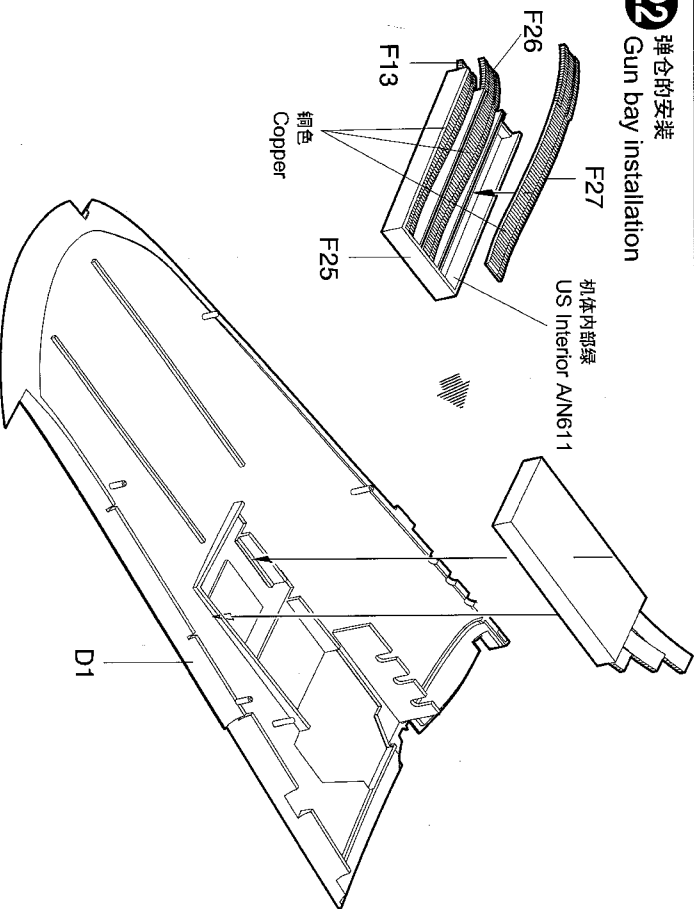

**23** 右侧机翼的组装  
Right wing assembly

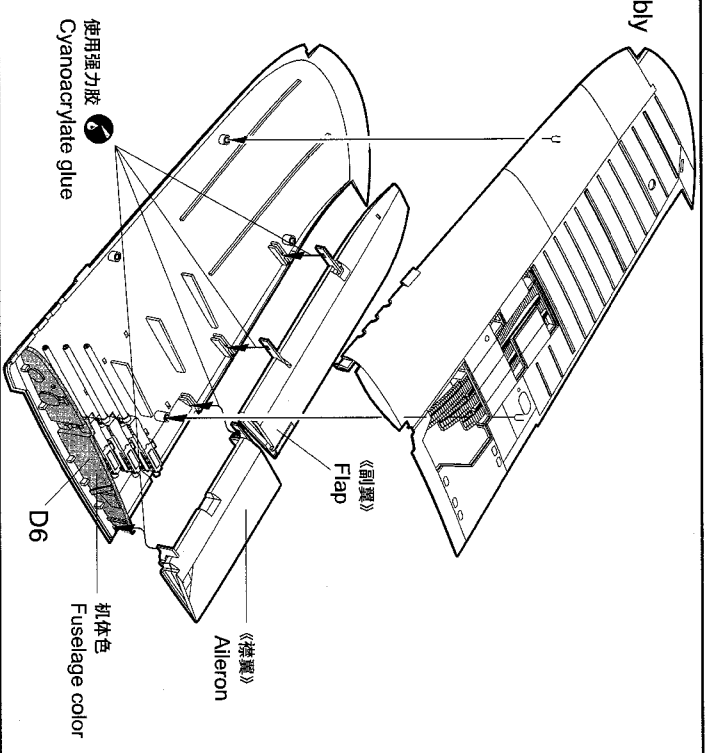

**24** 弹仓盖板的安装  
Gun access panel installation

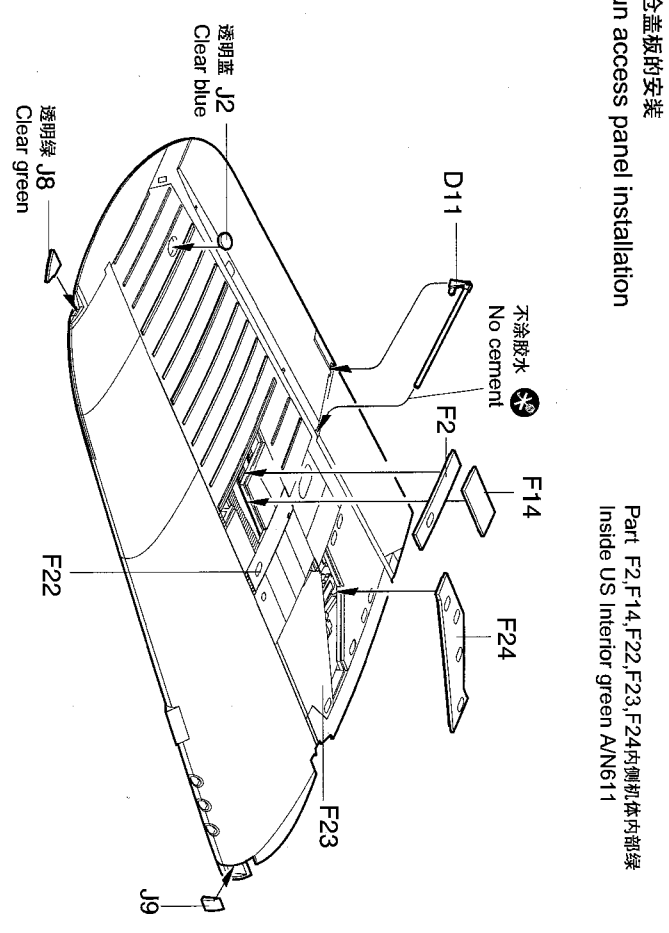

Part F2,F14,F22,F23,F24内侧机体内部绿  
Inside US Interior green AN611

**25** M2机枪的安装  
M2 machine gun installation

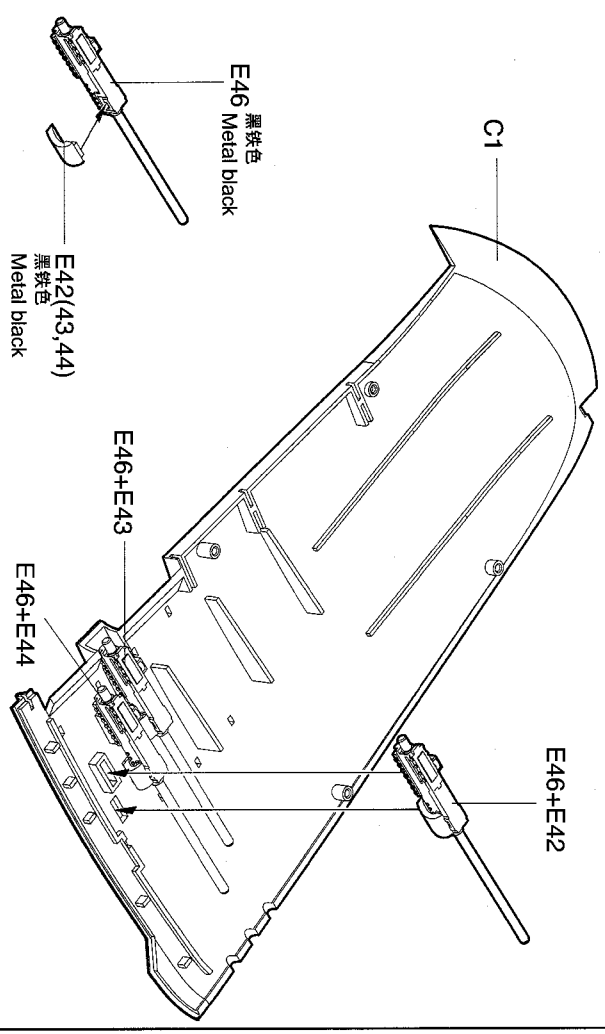

**26** 弹仓的安装  
Gun bay installation

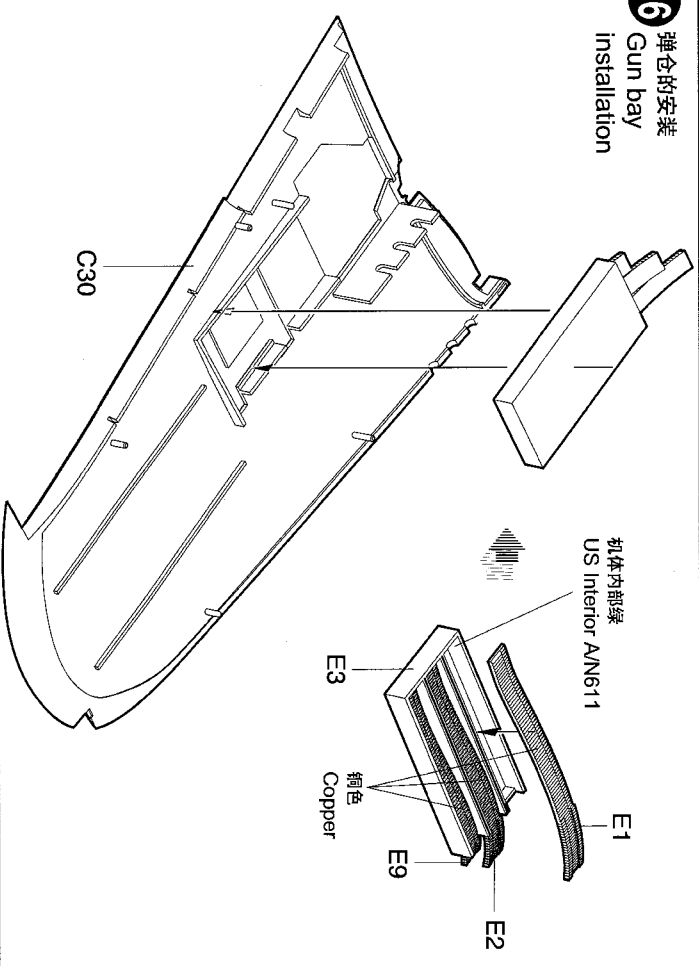

**27** 左侧机翼的组装  
Left wing assembly

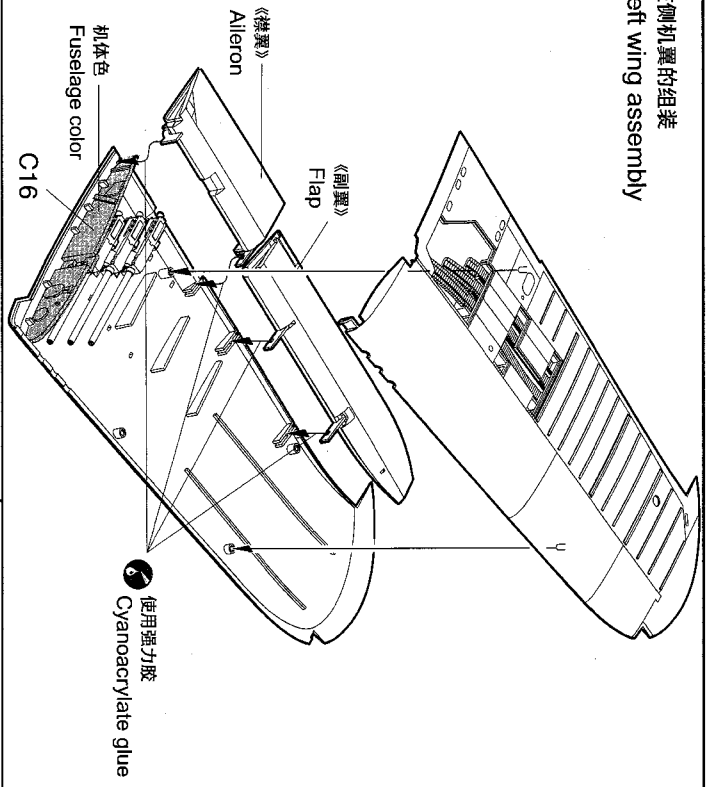

**28** 弹仓盖板的安装  
Gun access panel hatch installation

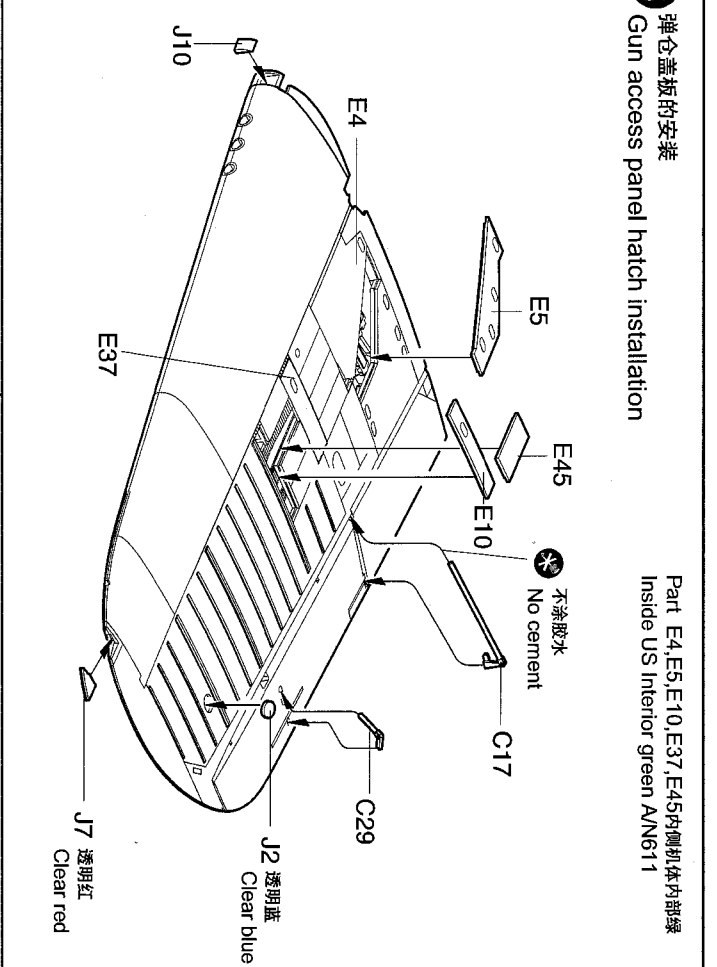

Part E4,E5,E10,E37,E45内机体内部绿  
Inside US Interior green AVN611

**29** 左内侧襟翼的组装  
Left inboard aileron assembly

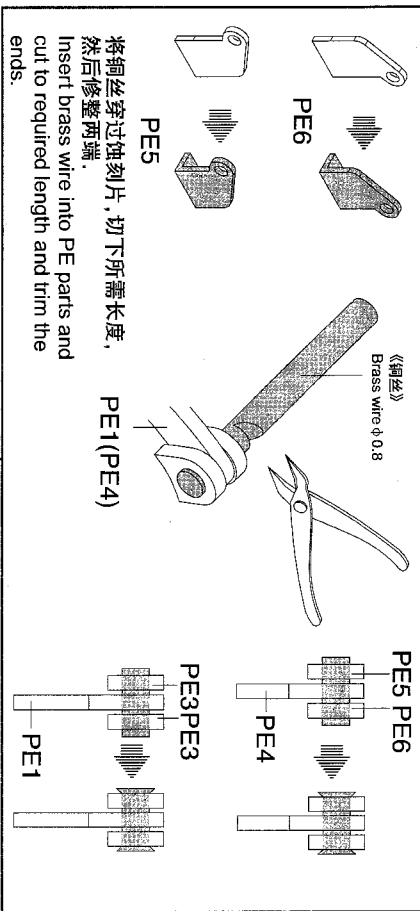
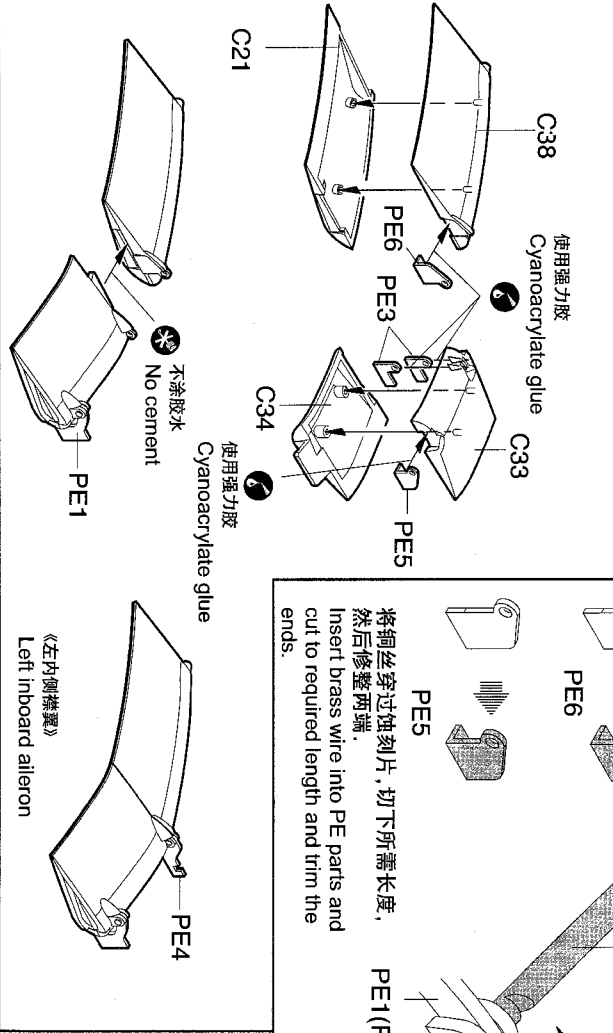

**30** 右内侧襟翼的组装  
Right inboard aileron assembly

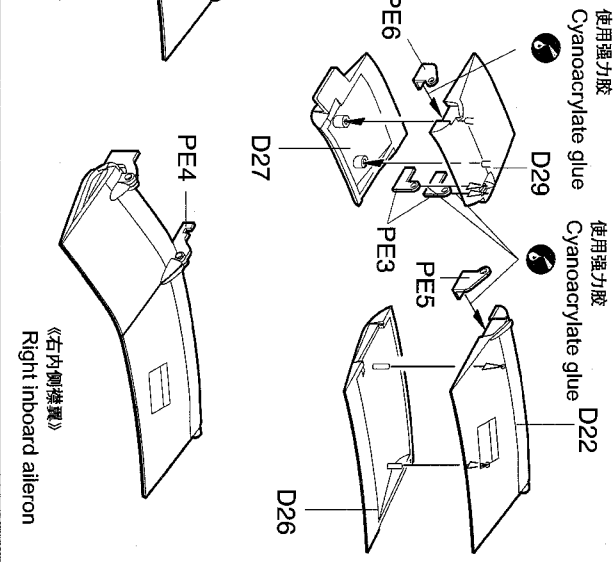

**31** 左侧机翼折叠机构的组装  
Left wing folding mechanism assembly

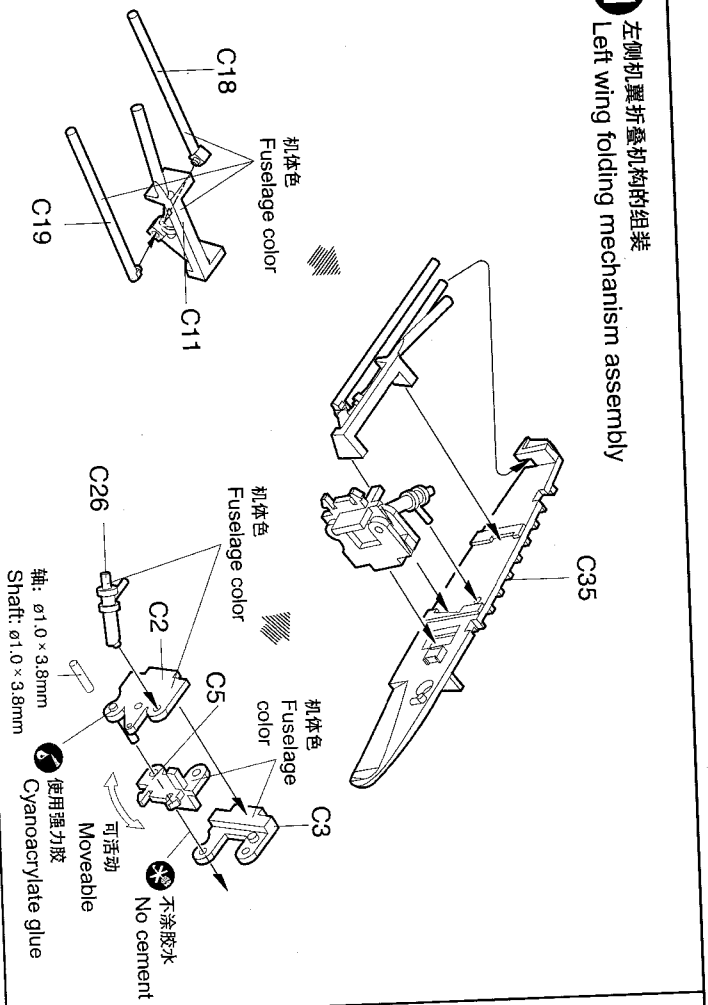

**32** 内右侧机翼折叠机构的组装  
Right wing folding mechanism assembly

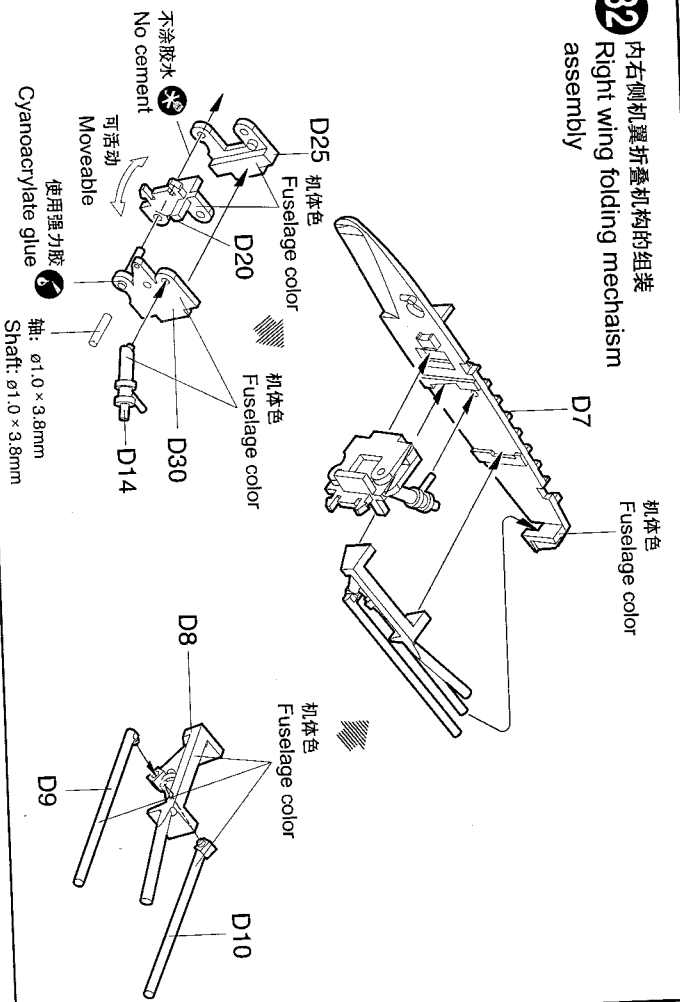

**33** 固定机翼的组装  
Fixed wing assembly

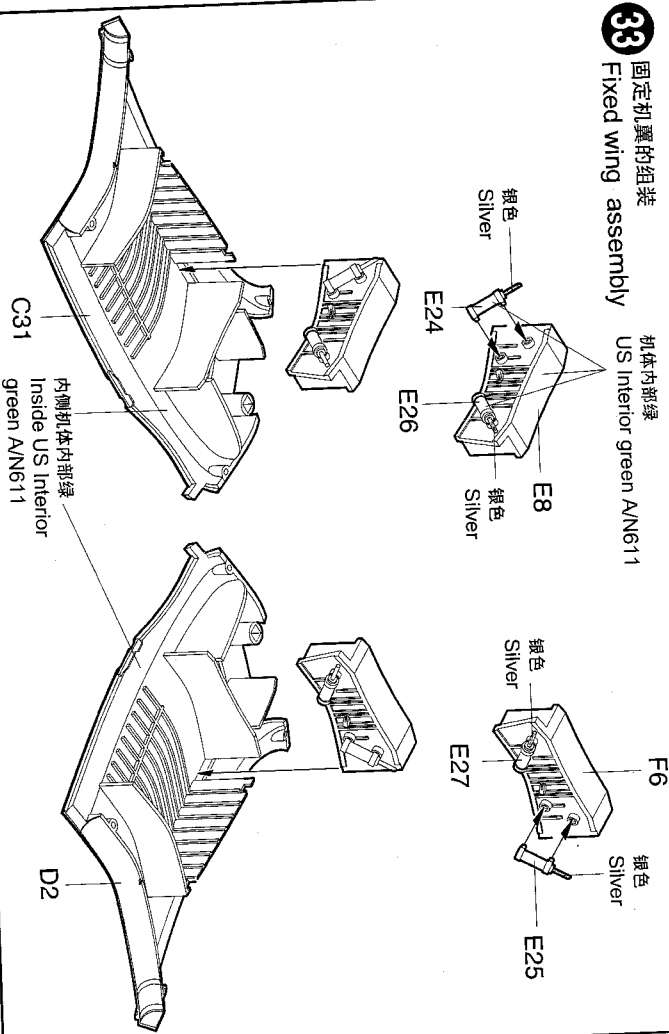

**34** 内侧襟翼的组装  
Inboard aileron installation

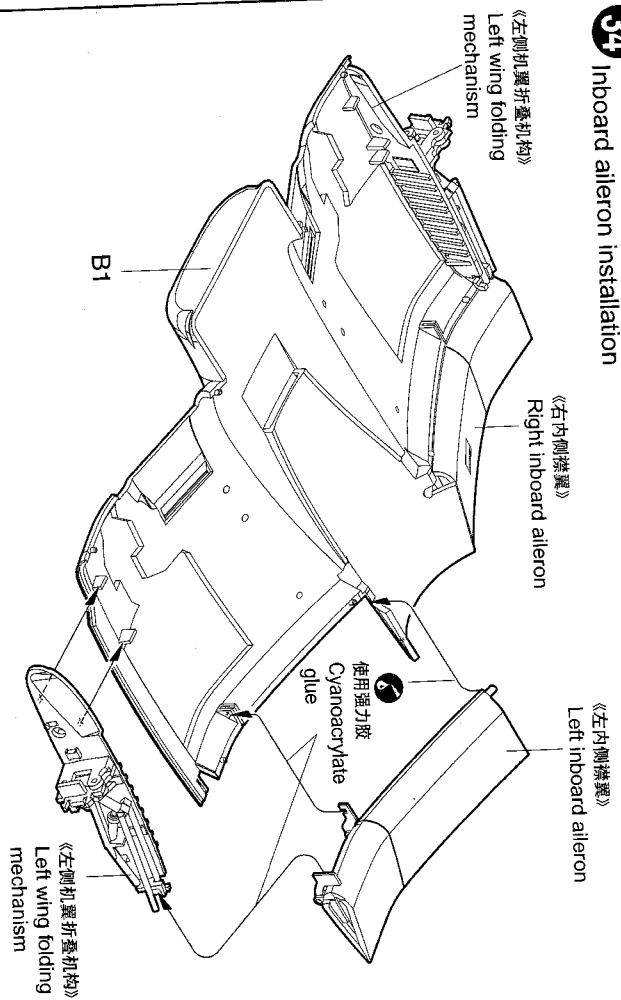

**35** 固定机翼的组装  
Fixed wing assembly

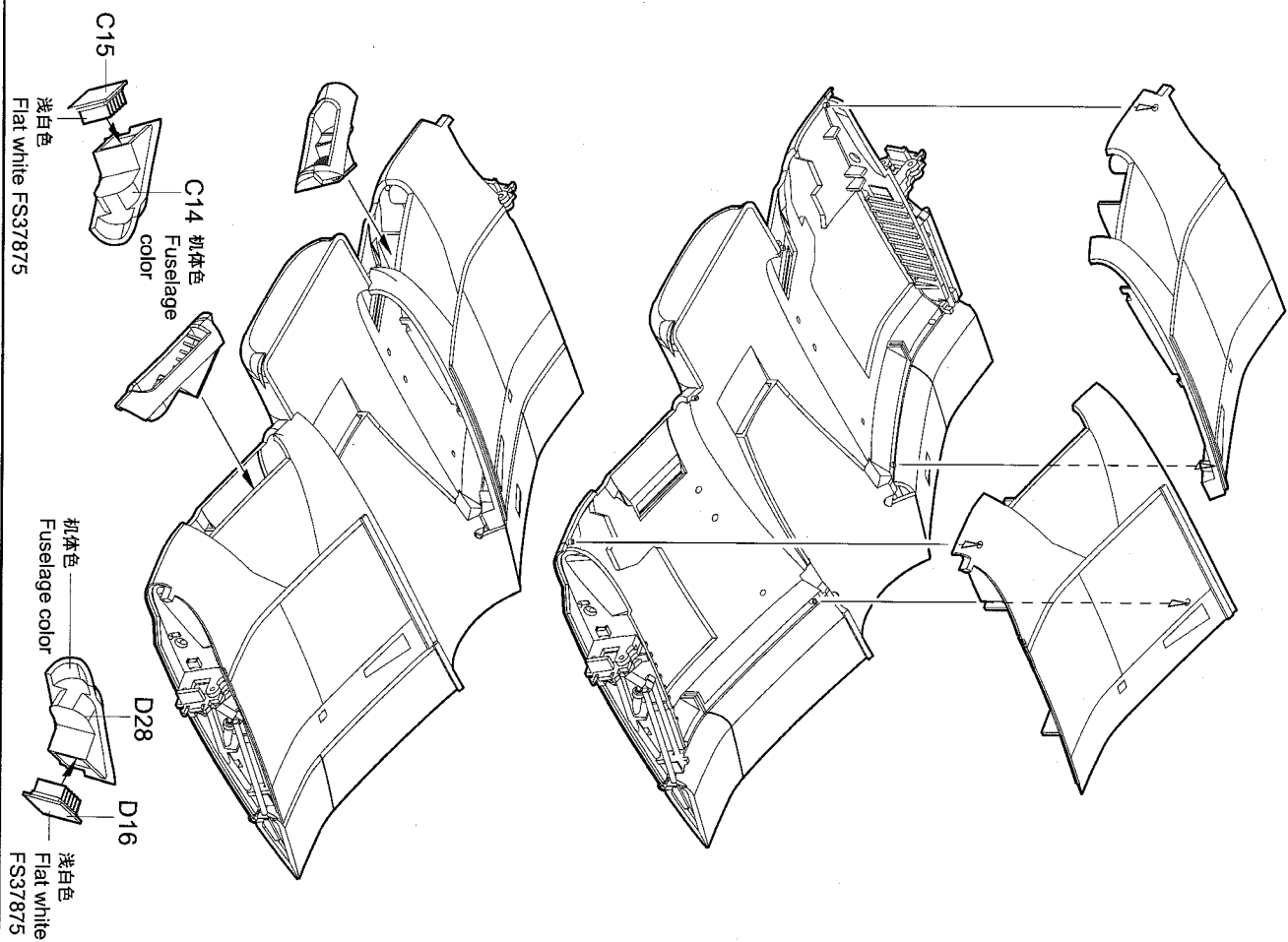

**36** 固定机翼的安装  
Fixed wing installation

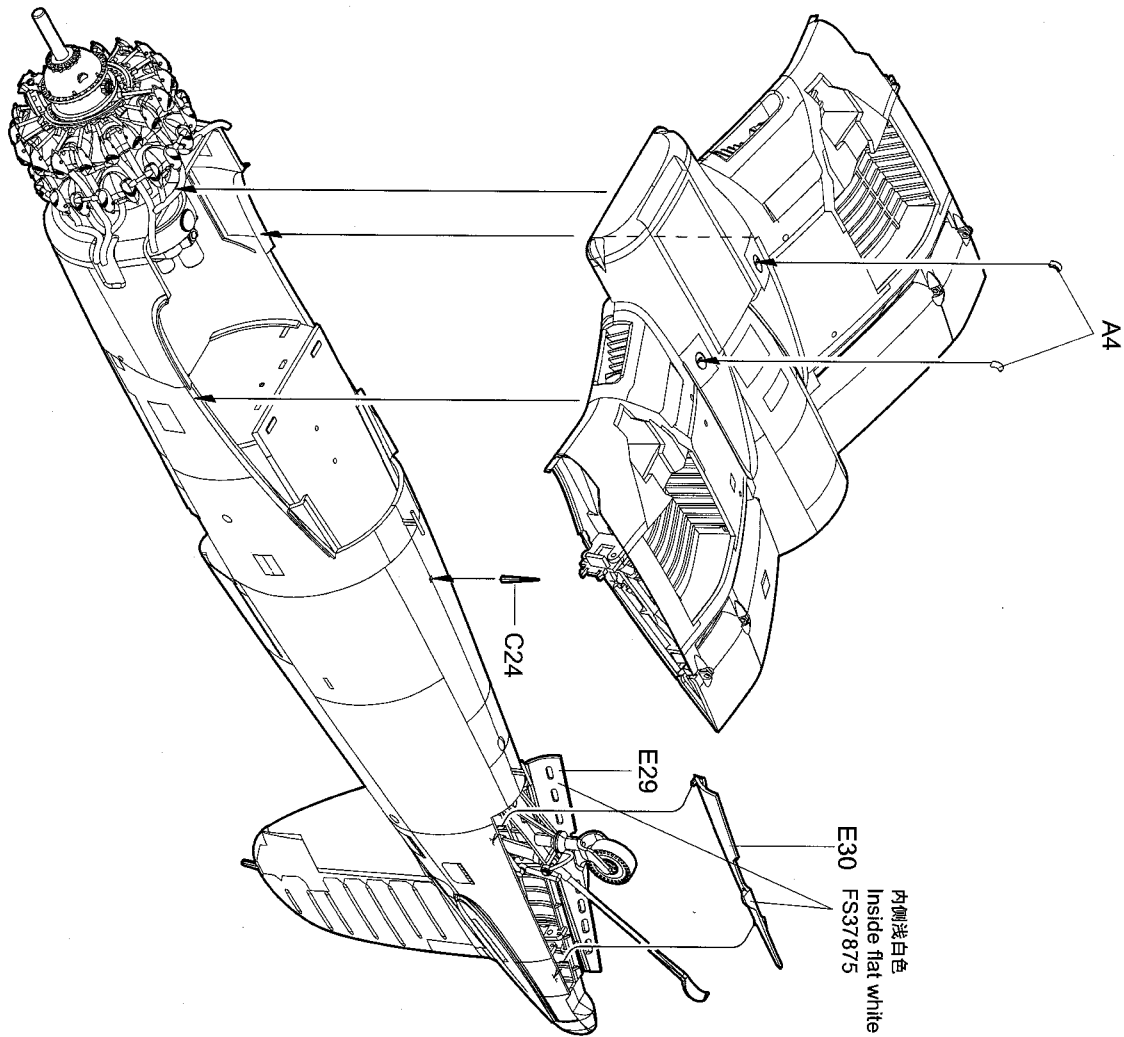

**37** 引擎罩的安装  
Cowling installation

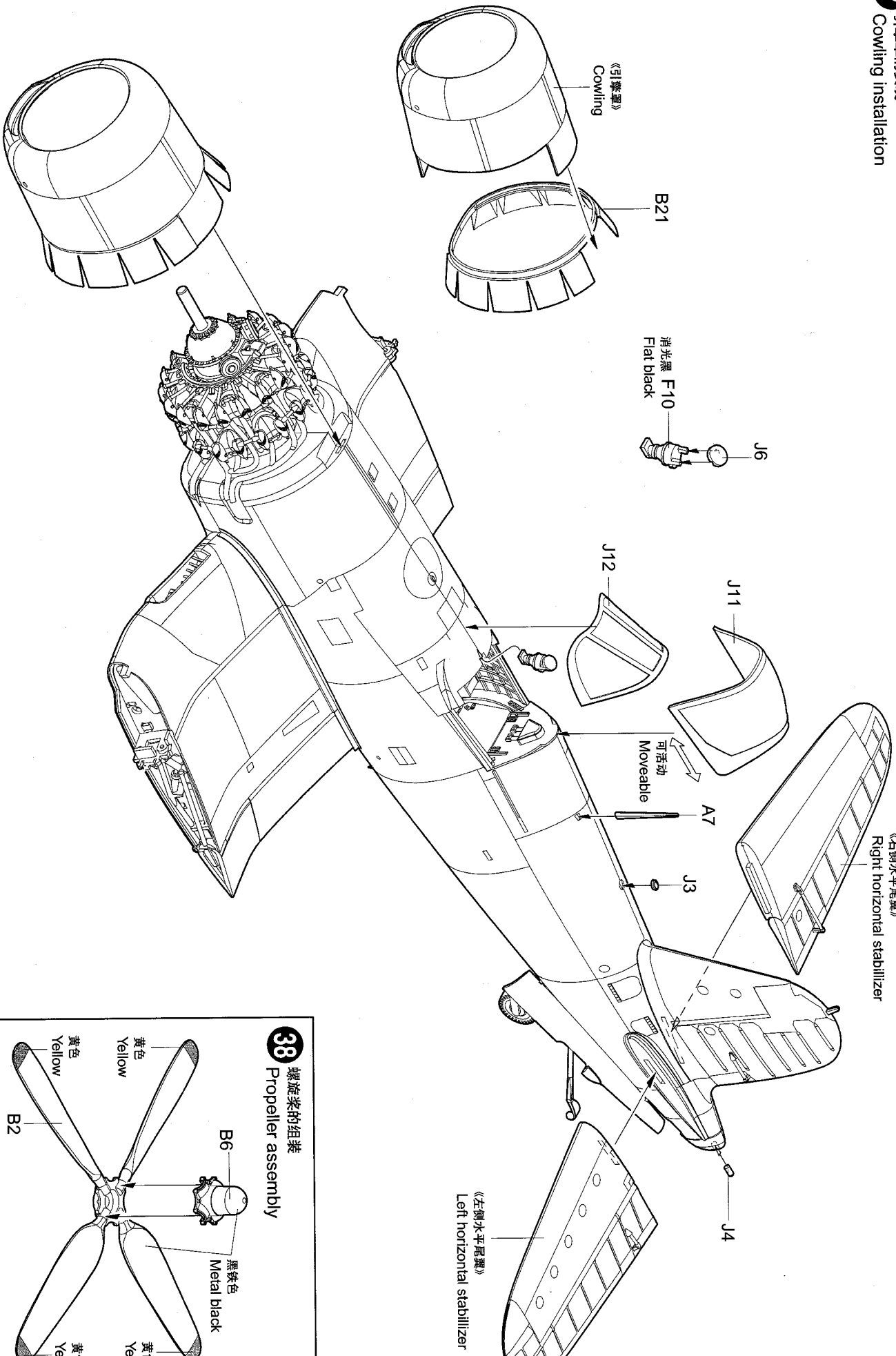

**38** 螺旋桨的组装  
Propeller assembly

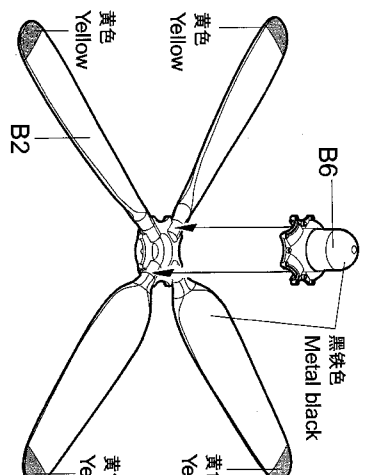



**39** 主起落架的组装  
Main undercarriage assembly

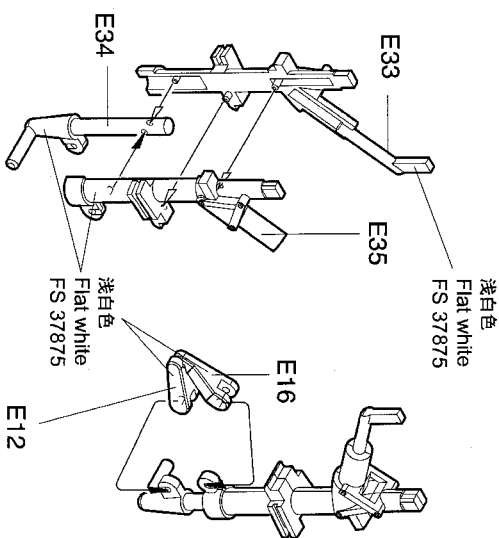
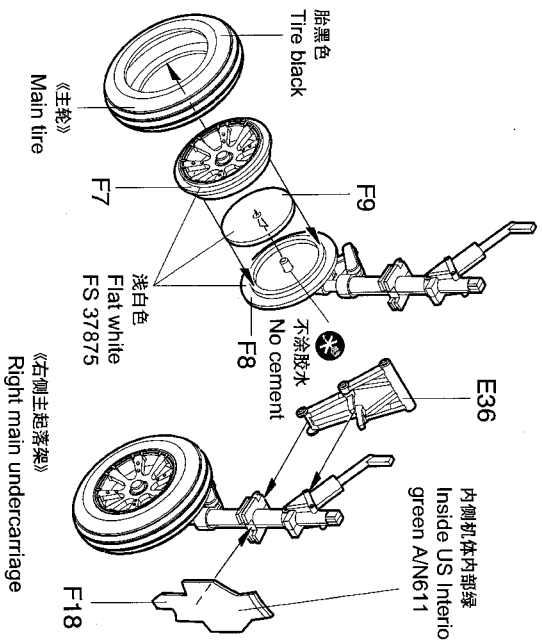
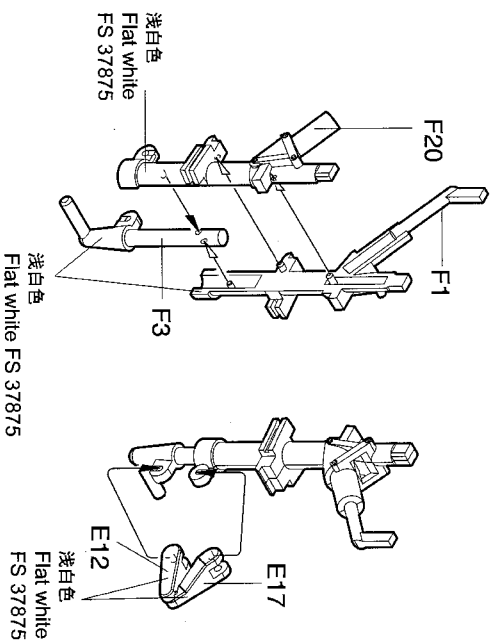

**40** 火箭弹的组装  
Rocket assembly

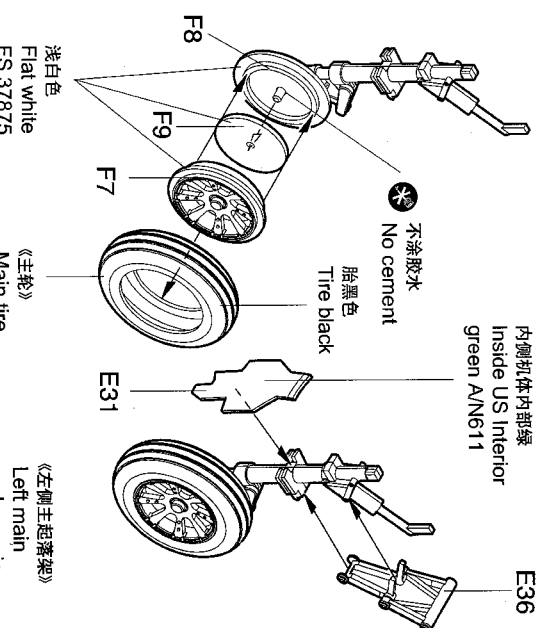
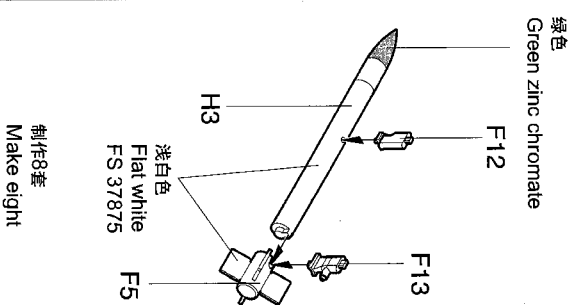

**41** 主起落架的安装  
Main undercarriage installation

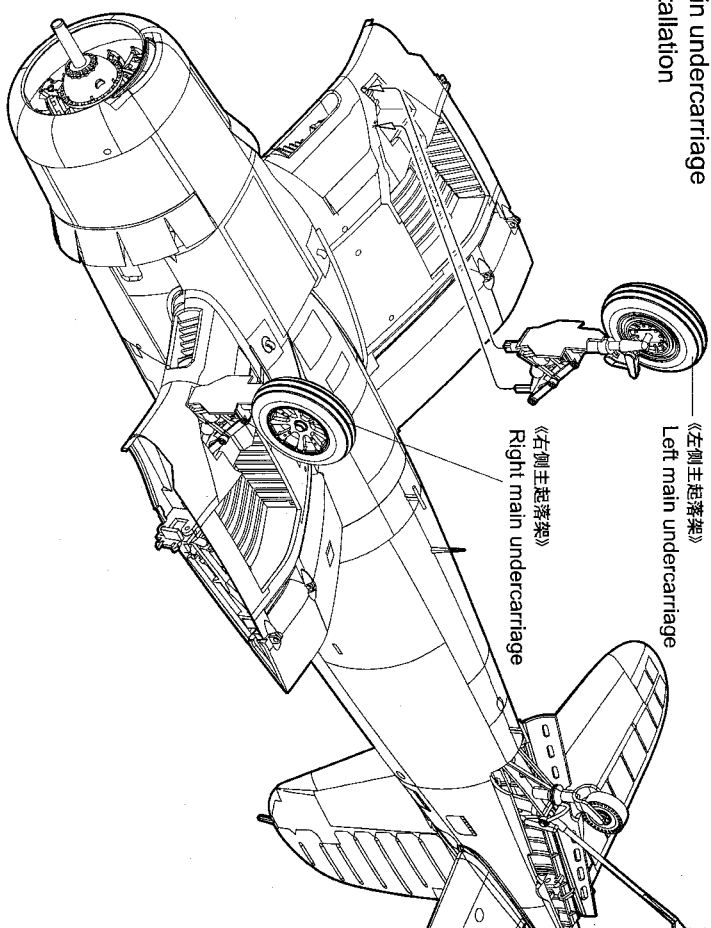

**42** 火箭弹的安装  
Rocket Installation

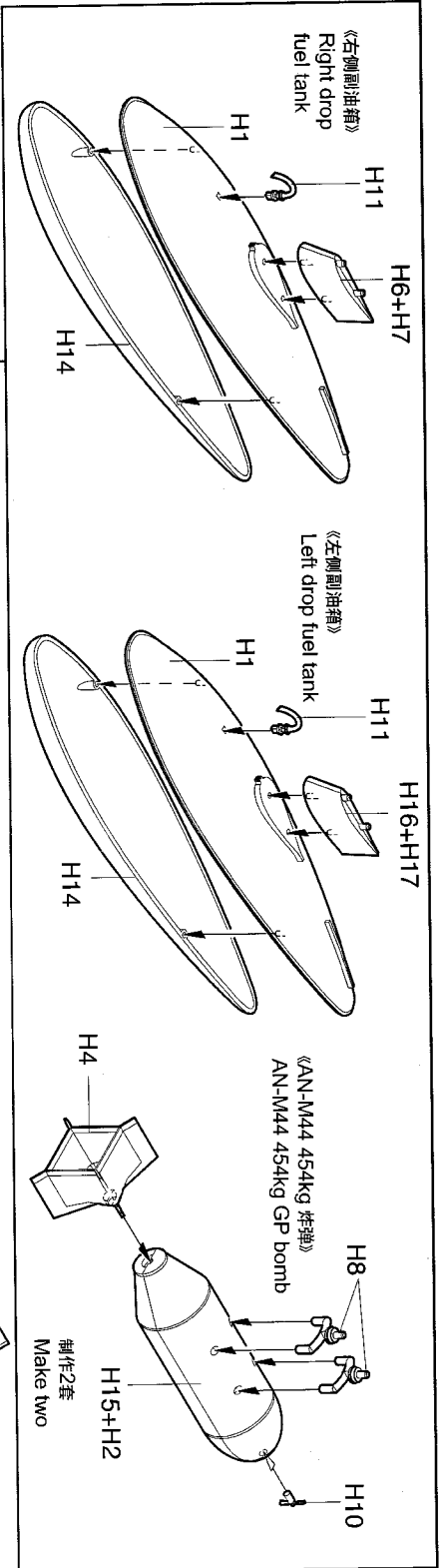
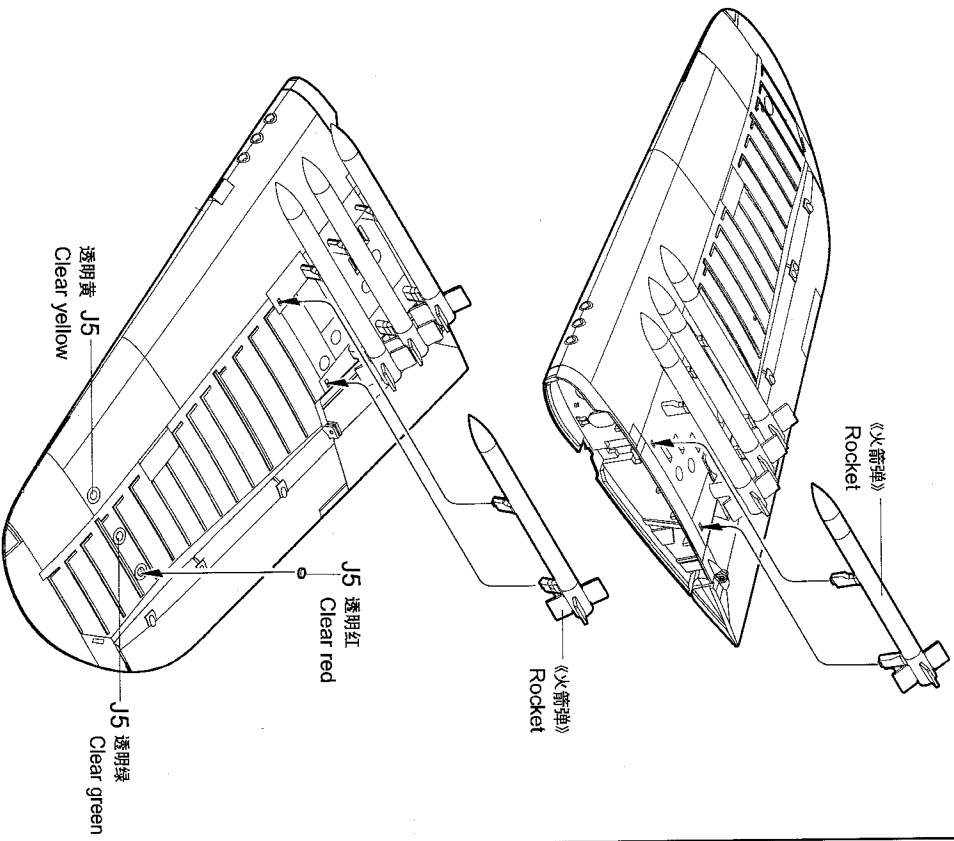

**43** 副油箱的安装  
Drop fuel tank installation

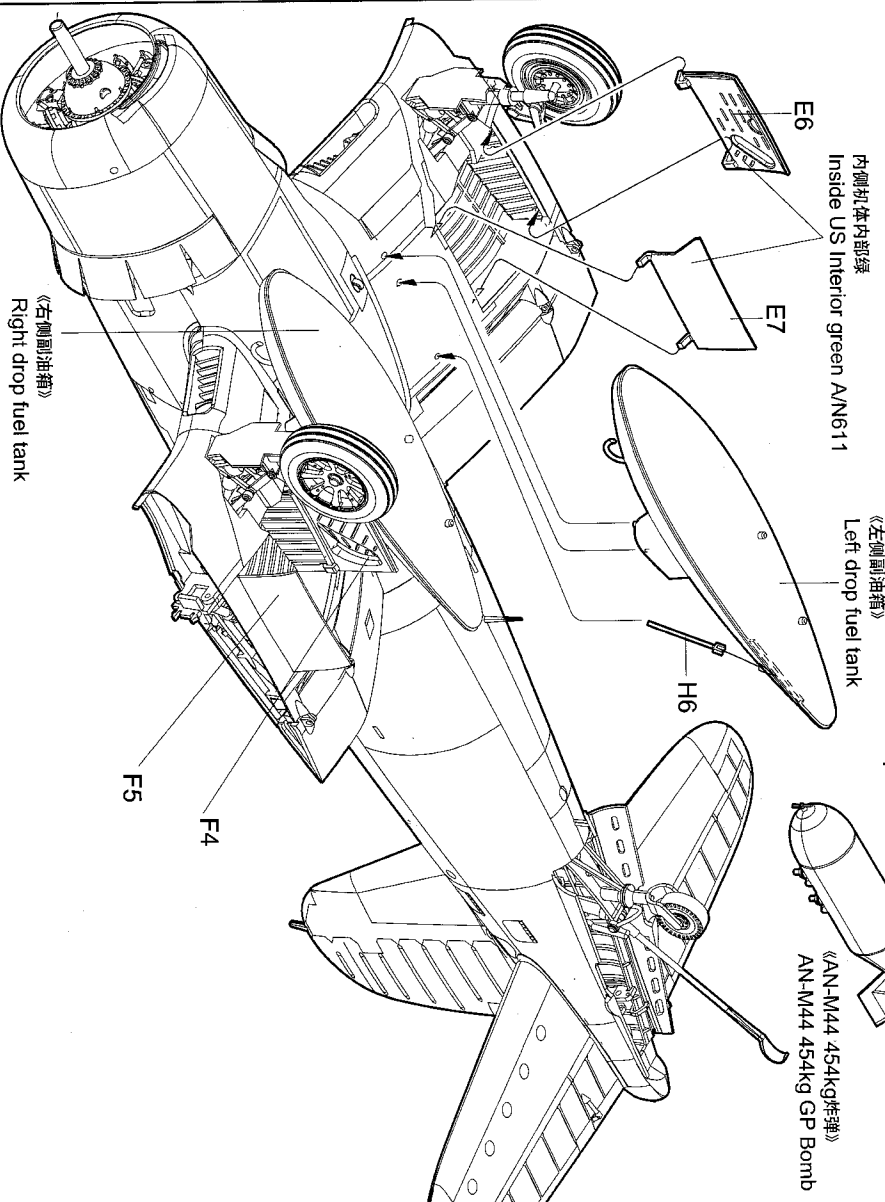

**44** 螺旋桨的安装  
Propeller installation

折叠机翼时不装 C4, D21  
Part C4, D21 not use for folding wing

D21 对侧 C4  
Opposite C4

《右侧机翼》  
Right wing

可旋转  
Rotating

《左侧机翼》  
Left wing

银色  
Silver

C28

机体色  
Fuselage color

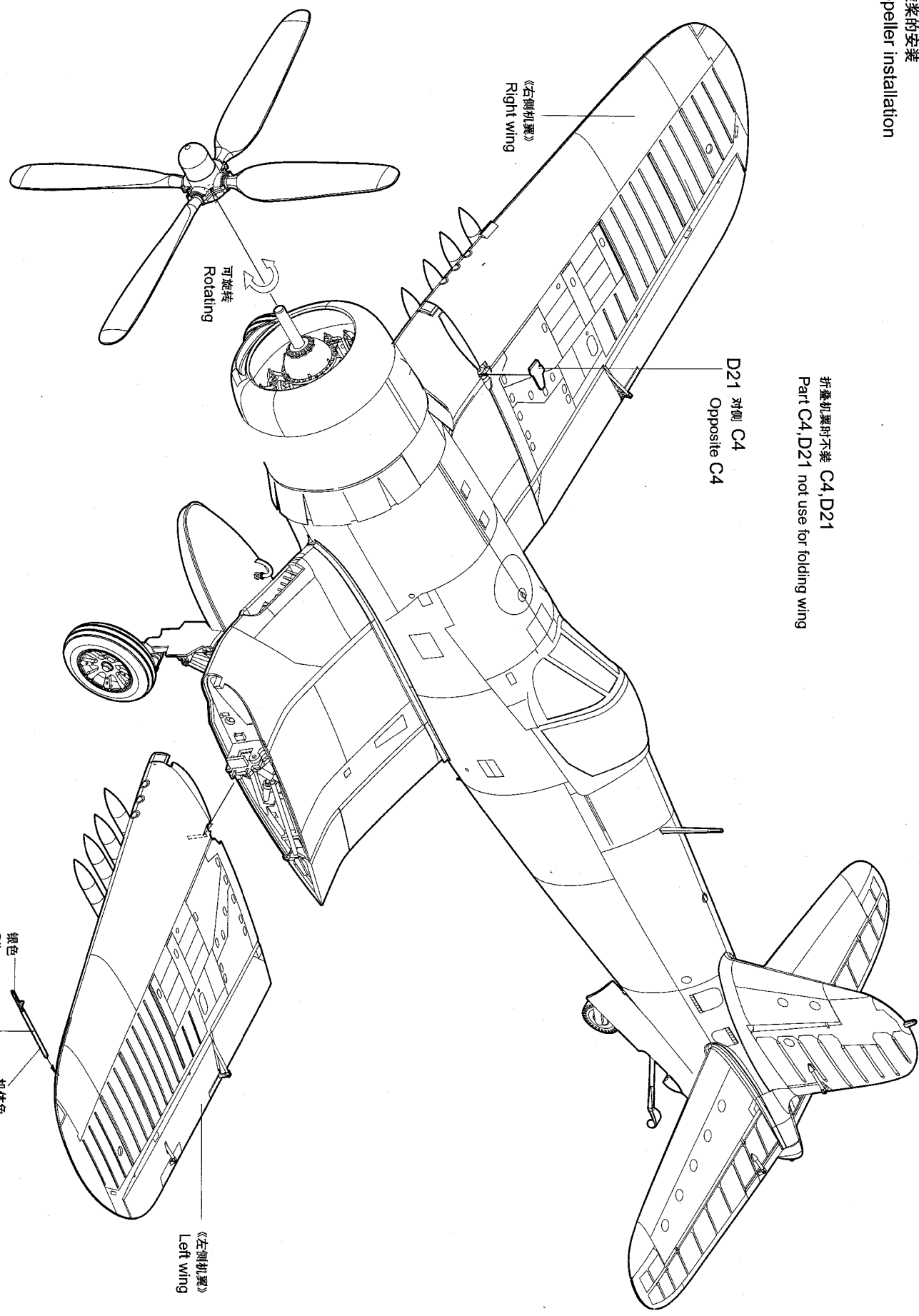

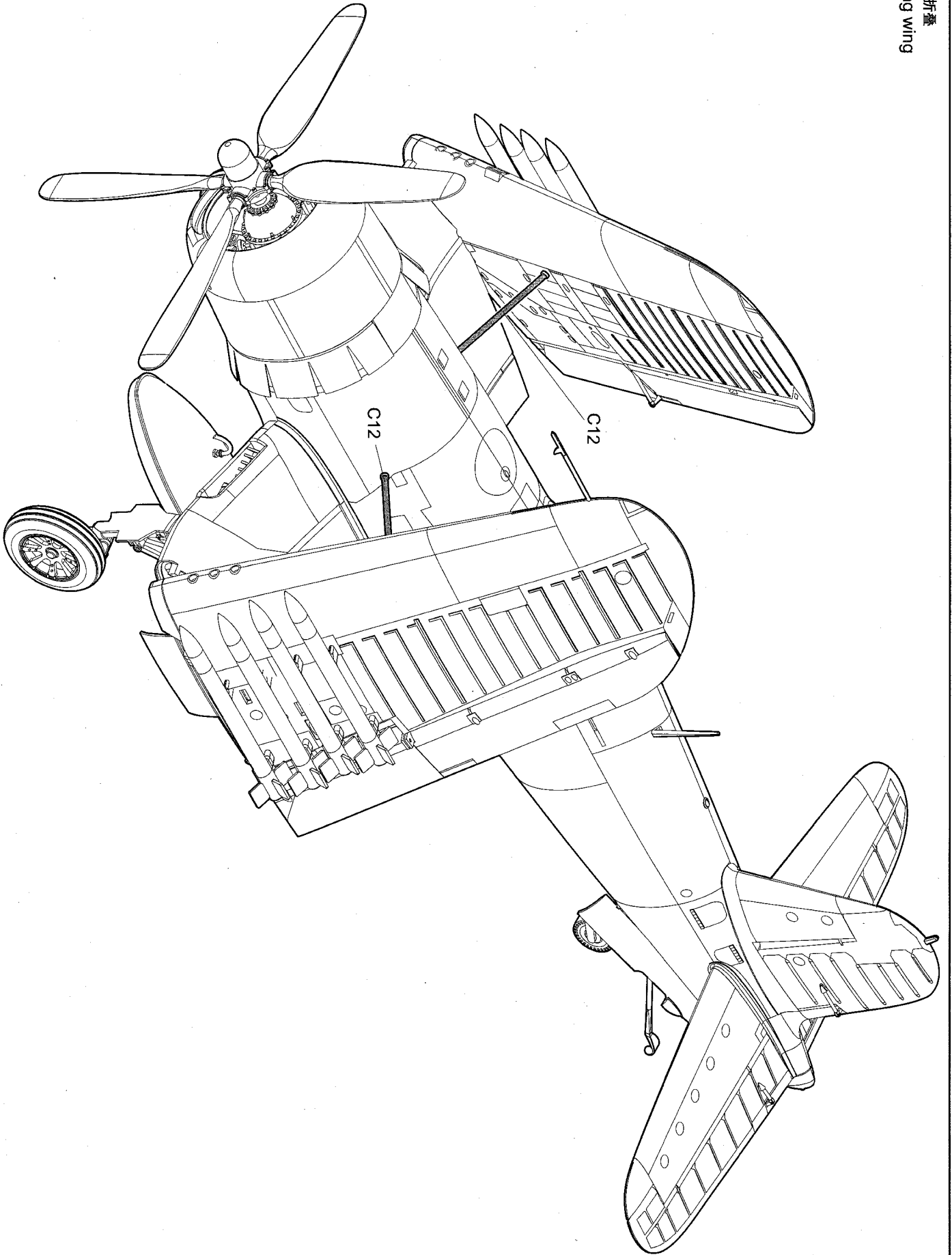

**AeroMaster** PRODUCTS  
 12982 SW 132nd Ave • Miami, Florida 33186 • USA •  
 Tel. (786) 293-5859 • Fax (786) 293-9286

**cartograf**

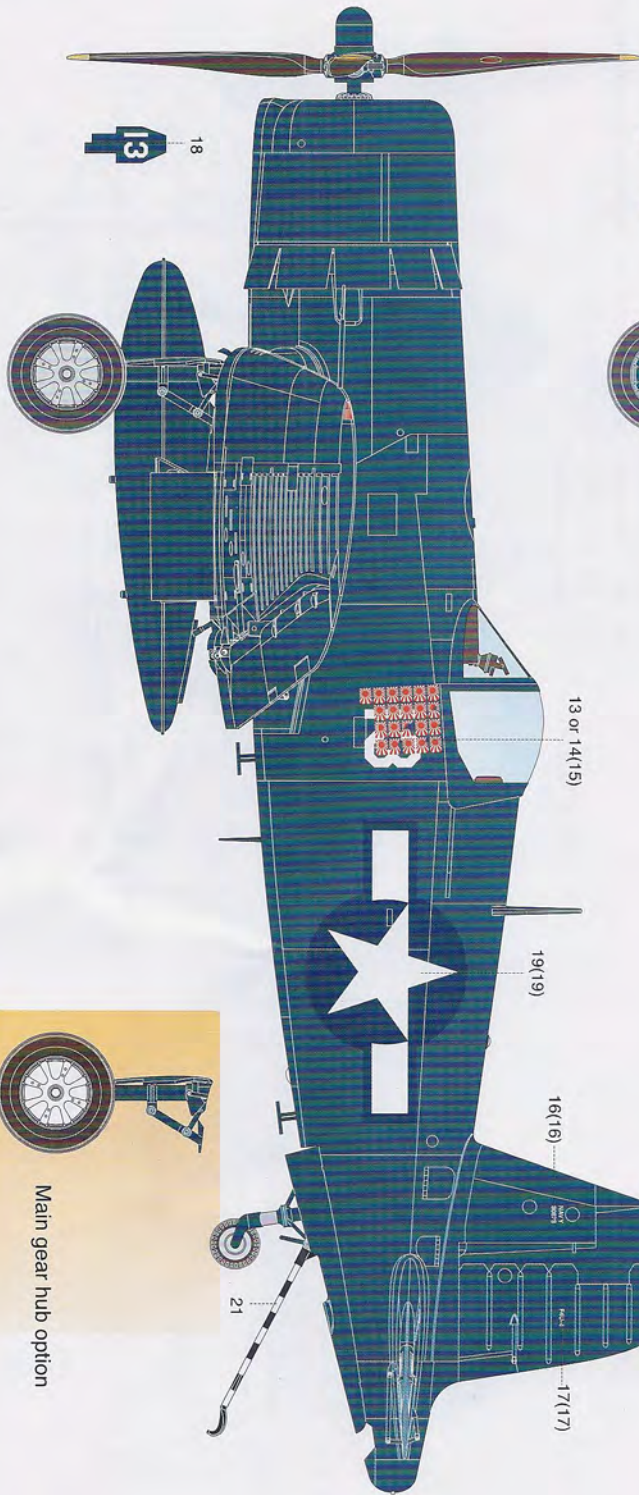
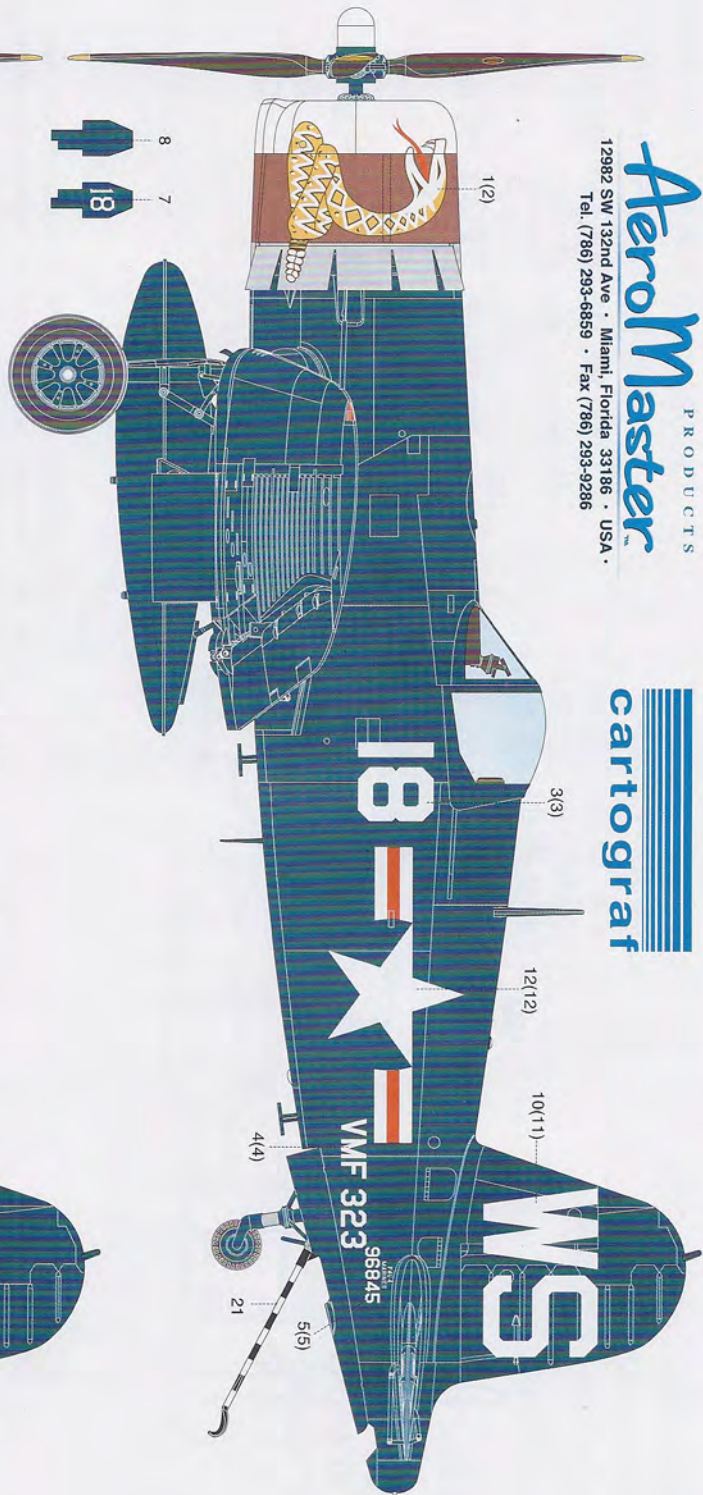

Main gear hub option

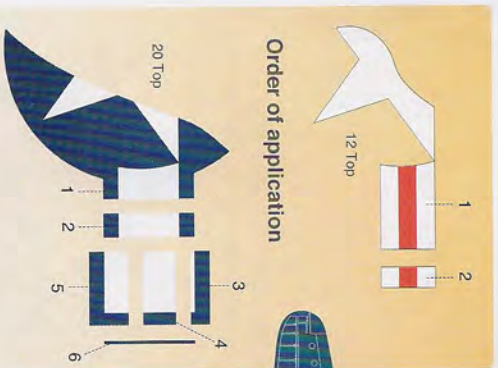
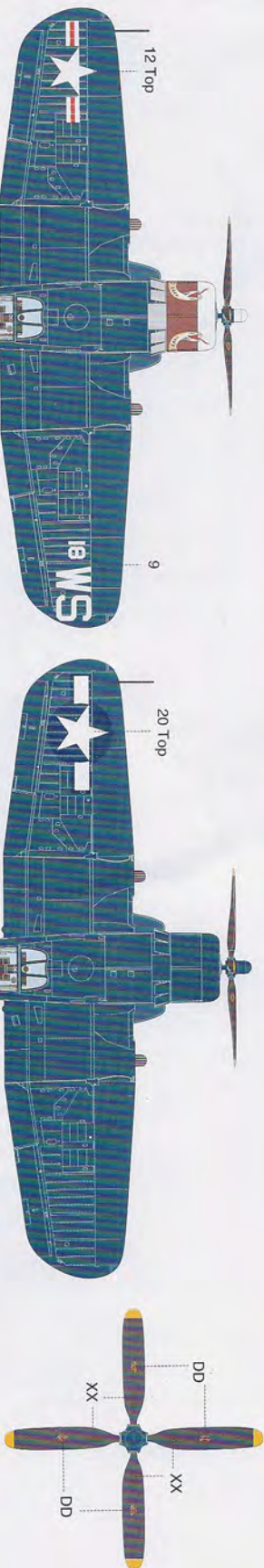

Upper wing star application: We recommend that you cover the machine gun ammo belts with its respective covers. Apply insignia beginning with main star and working towards the wingtips allowing for decal parts positioning as you go along before they dry. "Patience pays!"

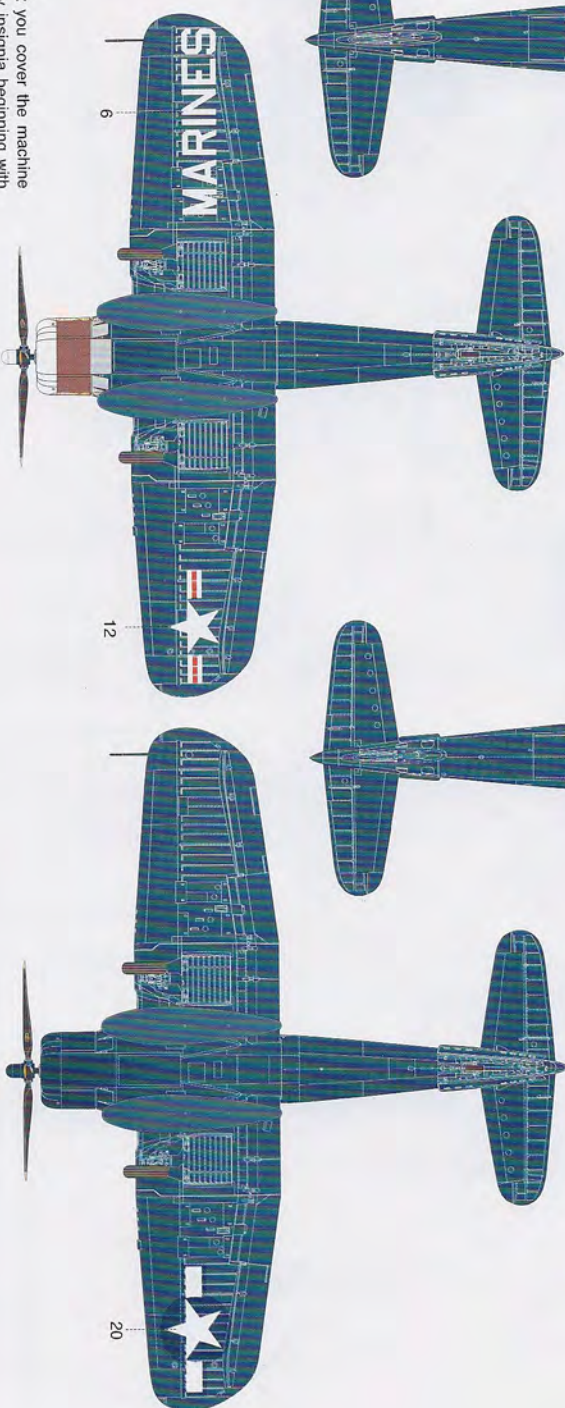

1

2

Aircraft # 1 F4U-4 Bu no. 96845 of VMF-323, sometime between July 14, 1950 and February 7, 1951, aboard either the U.S.S. Sicily or U.S.S. Badoeng Strait, Korean Waters. One of the most colorful Marine Squadrons of the era. Aircraft was overall Gloss Sea Blue, including wheel wells, L.G. Struts, inner wing folds, etc.  
The Cowling was white, maroon and possibly a shade of Gray similar to Dark Gull Gray (F.S. 26231). A beautiful rattle snake overlapped the cowling on both sides, and it seems that every snake on the Squadron aircraft were slightly different. The Prop Hub was Gloss Sea Blue with a White Spinner. Aircraft was aboard the U.S.S. Badoeng Strait during August of 1950, when it overturned on the deck.  
We have pictures of this aircraft with White and with Sea Blue wheel hubs, so it is your choice.

Aircraft # 2 F4U-4 Flown by Captain Ken, A. Walsh, Okinawa Campaign, June, 1945. White 13 was decorated with 21 Japanese kill markings showing the claimed score by its pilot. Capt. Walsh claimed his last kill, a Kamikaze Zero while flying this aircraft on June 22, 1945.  
As it was the case with most late war Navy Corsairs, this aircraft was painted Overall Glossy Sea Blue, including wheel bays, L.G. Struts, inner wing folds, etc. Prop hub and Spinner were also Gloss Sea Blue. Main wheel hubs may have been Sea Blue or White. Take into consideration that during wartime conditions, the upper surface finish on these A/C weathered heavily, and a semigloss finished surface would be more realistic.

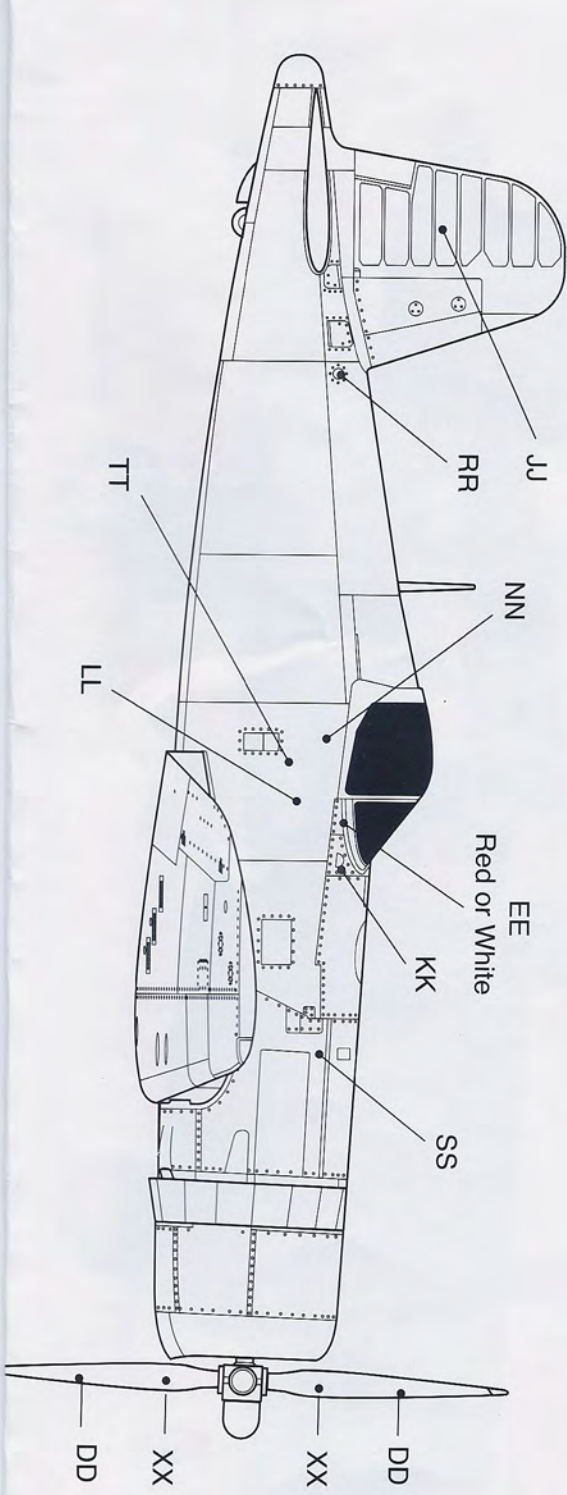

Note:  
 We have provided you the most important stencils used on these aircraft. However, they were hardly visible or completely removed after the first mayor maintenance or overhaul. Use conservatively.

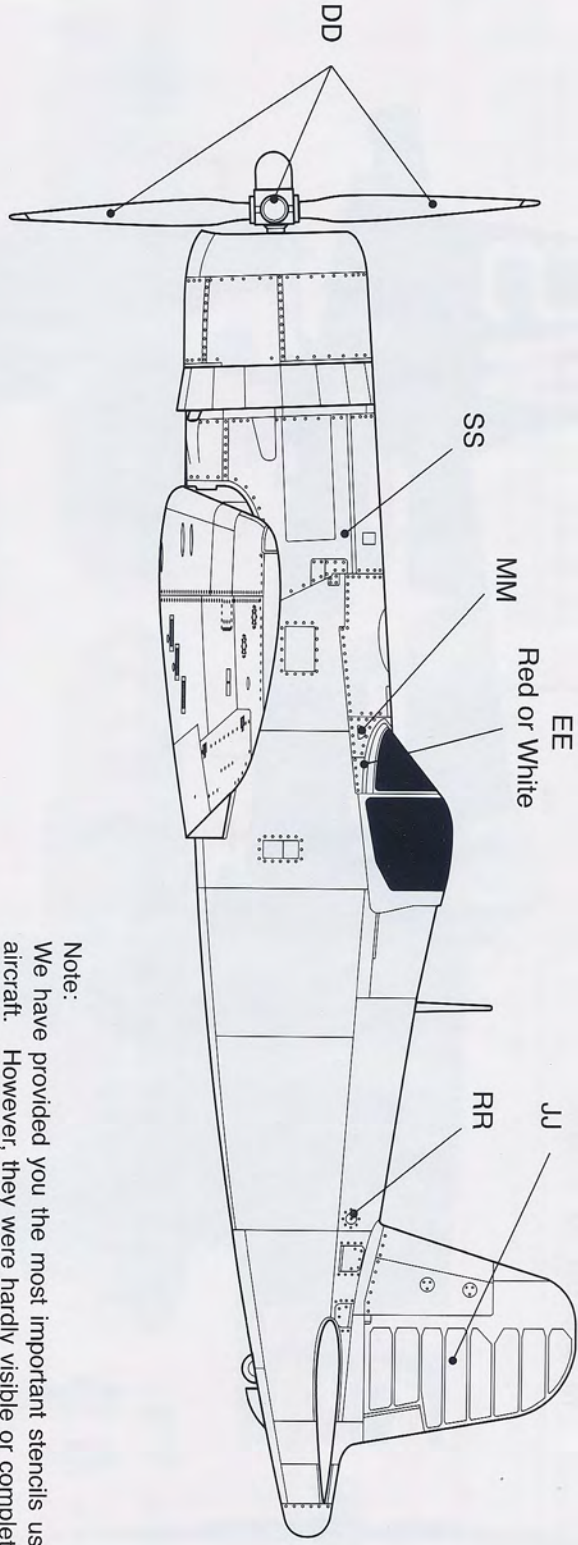

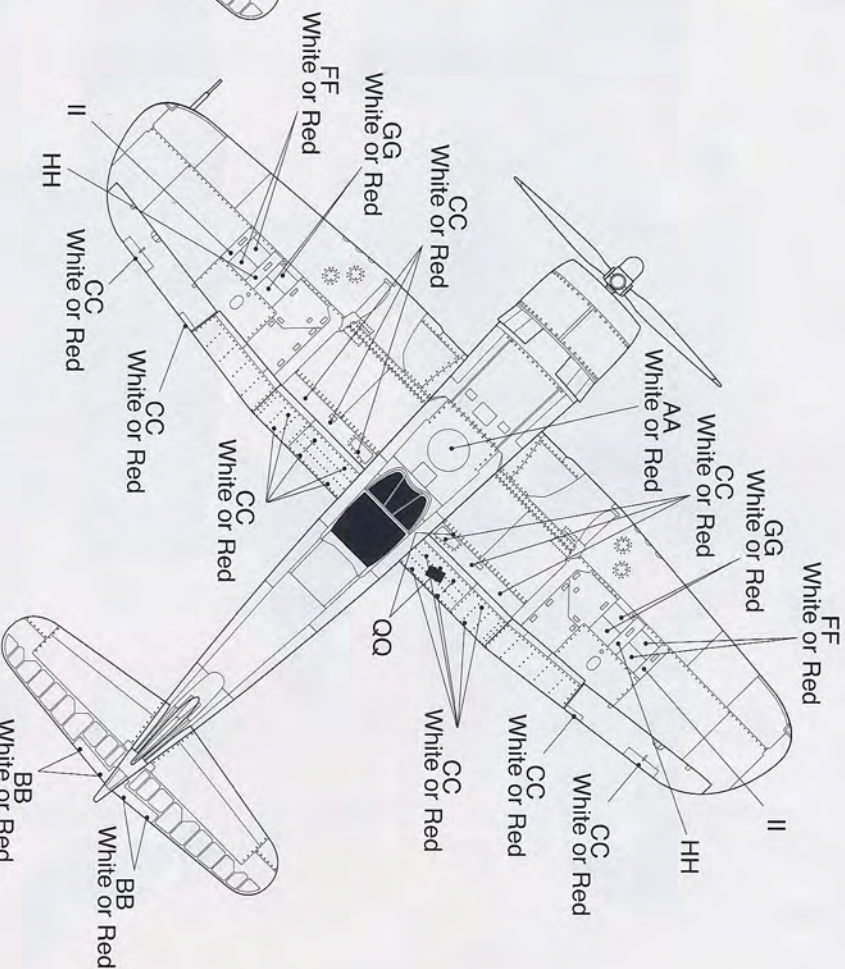
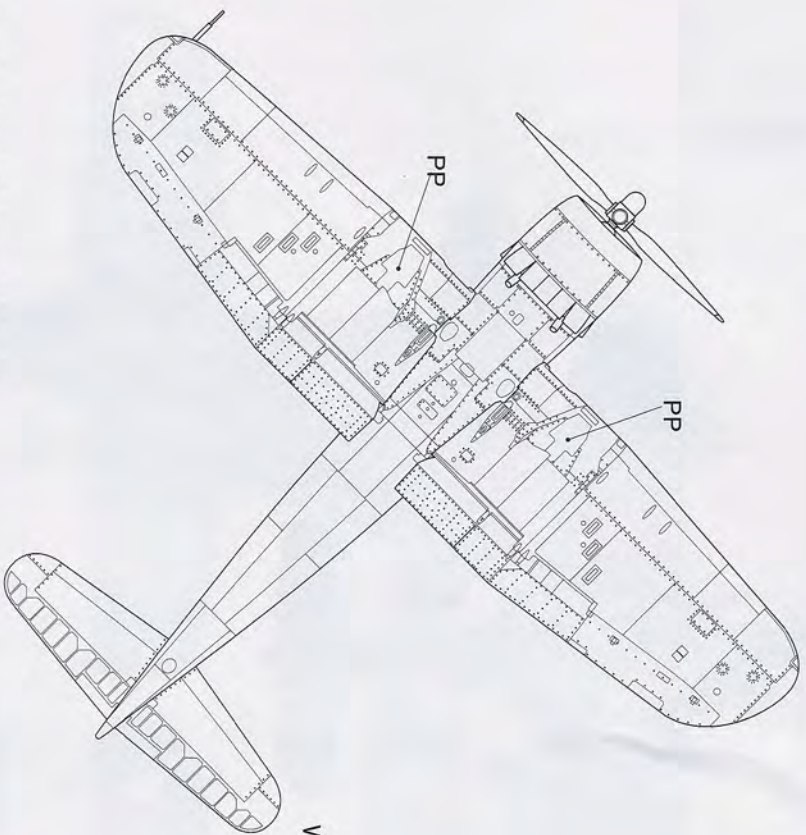

**VOUGHT F4U-4 CORSAIR**  
**U.S. WW II & KOREAN WAR COLORS**  
 (as used in all operational theaters)

**MODEL MASTER ACRYL:**

- 4226 Sea Blue AN623
- 4686 FS15042 Dark Sea Blue
- 4742 FS35044 Insignia Blue
- 4744 FS35164 Intermediate Blue

**MODEL MASTER II ENAMELS:**

- 1718 Flat Sea Blue FS 35042
- 1719 Insignia Blue FS 35044
- 1720 Intermediate Blue FS 35164
- 1734 Green Zinc Chromate
- 1768 Flat White FS 37875

**Floquil POLLY SCALE MILITARY ACRYLICS:**

- F505011 White
- F505092 US Sea Blue A/N607
- F505094 US Intermediate Blue A/N608
- F505096 US Interior Green A/N611