

STP

PONTIAC GRAND PRIX

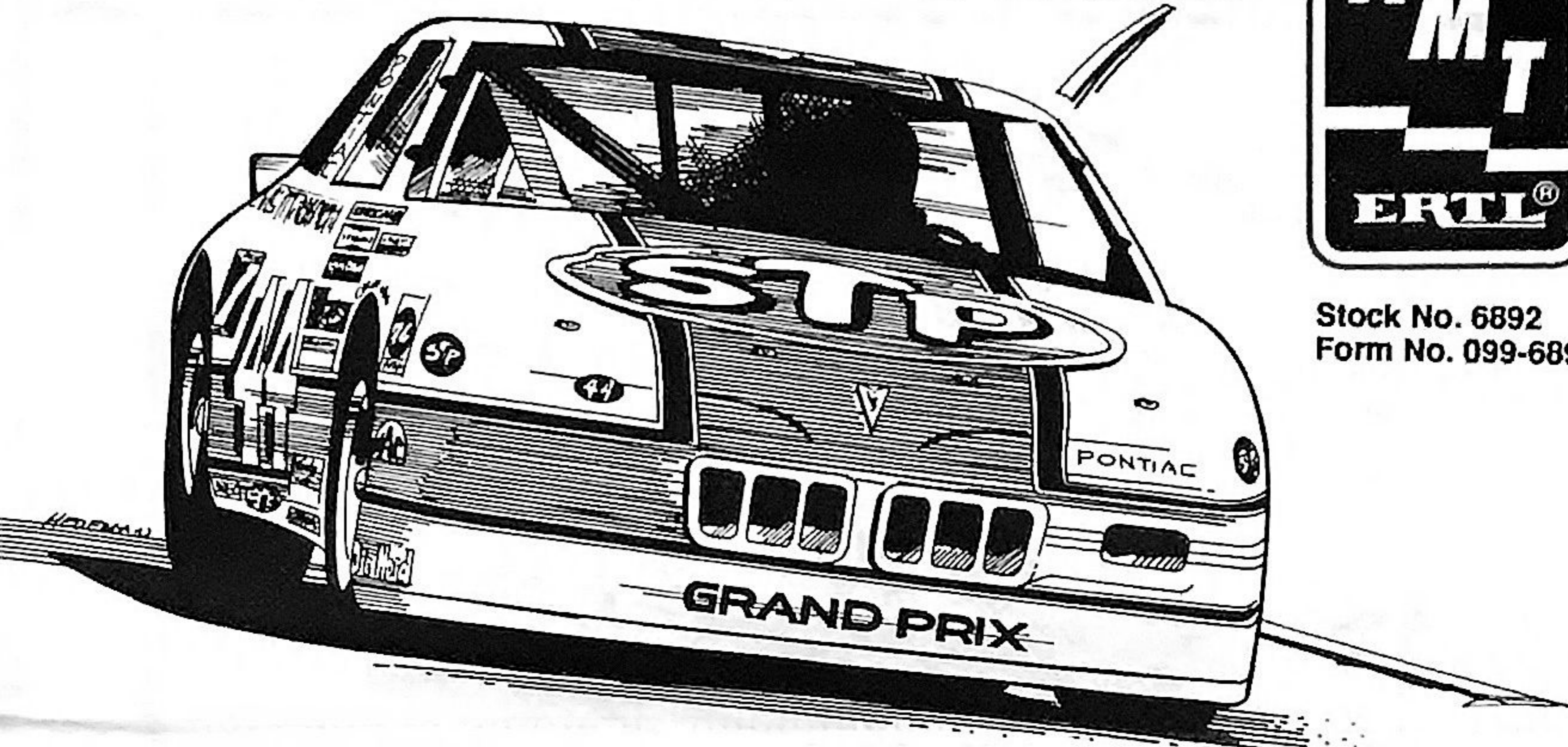

Stock No. 6892
Form No. 099-6892



Probably the best known NASCAR driver ever, Richard "The King" Petty, with over 200 wins and 7 Winston Cup championships to his credit, hung up his racing helmet at the end of the 1992 season. But this hardly means that Richard is out of racing or that the blue and STP red race car has turned its last lap, far from it. For 1993 "The King" dons the owner/crew chief hat and ushers the number 44 STP Pontiac onto the starting grid, piloted by Rick Wilson.

Rick is a five year veteran of the Winston Cup wars and knows he has to fill some mighty big cowboy boots while sitting in the "King's" chair. The maturing of a new team and driver takes some time and a few races under the belt. Nonetheless, Rick has made improvements during his inaugural racing season, and the STP Pontiac has shown it can run with the crowd, big tracks and small.

The Petty Pontiac Grand Prix is a marvel of stock car engineering, and over the years the Petty garage has developed several innovations both for safety and speed that are now standard on other Winston Cup cars. Powered by a small block GM V-8 engine, the 358 cubic inch power plant is a real racing motor despite its stock car origins. The chassis is almost totally tubular comprising a stout roll cage, heavy frame side rails and a carefully developed suspension made up of many stock components.

Winston Cup stock car racing is a competition between drivers and their cars, crew chiefs and teams, and in the background out of the spotlight, engineers and designers. Color is added by corporate and individual sponsors, television and the biggest crowds for any USA spectator event.

Enjoy your model of the Petty Enterprises STP Rick Wilson Grand Prix in authentic 1/25th scale. For more information, you may want to see Circle Track, Stock Car Racing or Winston Cup Illustrated magazines, and if you get a chance to take in a race, there is nothing like witnessing the thunder of a full-bore Winston Cup event.

IMPORTANT

Before you begin to assemble your model kit, study the instructions carefully. This will help you to familiarize yourself with the part locations as you proceed. Prior to cementing parts together, be sure to "TEST FIT" them in order to assure proper alignment and also to check for excess "FLASH" that may occur along parting lines. Use a sharp hobby knife or file to remove flash if necessary.

If you wish to paint your model, various sub-assemblies and components should be painted before any parts are attached. During assembly, you may note that the recommended color is stated after the part name.

This model kit is molded from the finest high-impact styrene plastic. Use only paints and cements which are specifically formulated for styrene. Read all labels and warnings carefully.

Because the cement will only adhere to bare plastic, it is necessary to remove any paint or "plating" from the area to which the cement is to be applied.

BUILDING TIPS FOR THE ADVANCED MODELER

For the best possible finish, your kit should be painted, even if molded in color. Paint should be applied evenly, in several thin coats rather than one heavy coat. The first coat should not completely cover the surface. Each layer should be allowed to thoroughly dry before the next is applied. Also, each coat should be "wet sanded", except for the final coat, using No.1200 wet or dry sandpaper which is slightly damp. Be careful not to remove any detail while sanding.

It is important to keep your hands clean when working with your model and wash parts thoroughly before painting to remove any mold release agent that may have been used during manufacture, body oil from your hands, sanding residue, and dust, which is naturally attracted to plastic by static electricity. Use a mild solution of dishwashing detergent and water. A tack rag should be used to dry the parts, DO NOT use paper towels or tissues, since they will leave lint on the part.

Parting lines and glue joints should be sanded or filed prior to painting and cementing. Because paint has a tendency to draw away from sharp edges, they should be lightly filed. Use filler putty designed for plastic to fill small gaps that may occur between parts and to blend contours. This should be done only after the first, or "primer," coat of paint is applied.

When painting a two-tone body, the lightest color should be painted first. Use frosted, or "magic," tape to mask off the area you do not want painted. After the second color is dry to the touch, the tape can be removed. Use a very fine brush to touch up edges if necessary. If decals are to be added, do so before adding any gloss coat. A gloss coat will help even out the edges between the two colors as well as set the decals.

RECOMMENDED TOOLS

HOBBY KNIFE

Use a sharp hobby knife to remove parts from the trees. The knife may also be used to remove parting lines and flash.

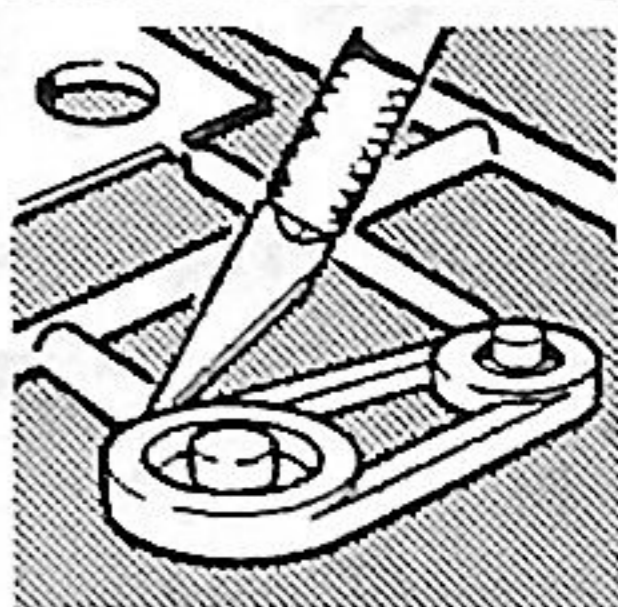

TWEEZERS

Use tweezers to hold small parts during assembly, painting and when applying cement.

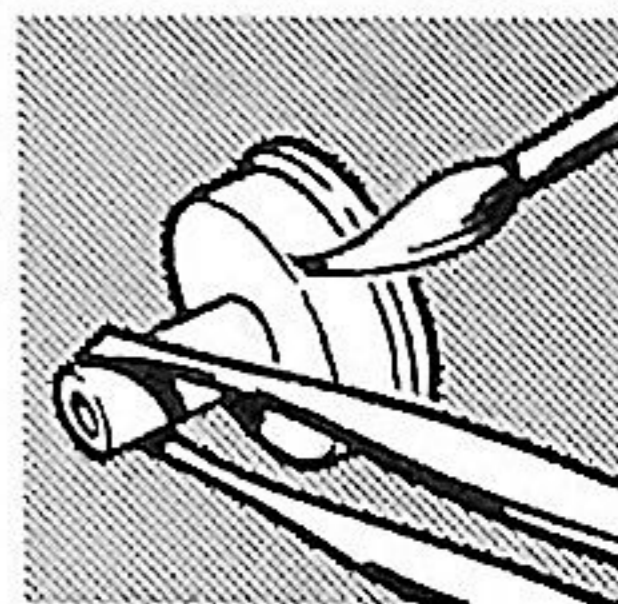

BRUSH

We recommend the use of liquid polystyrene cement. Apply with a fine brush. Use sparingly or a sloppy job will result.

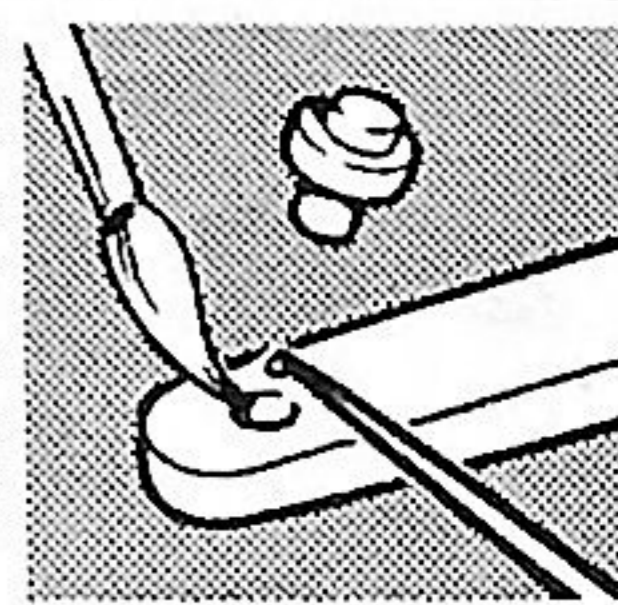

READ ALL LABELS AND WARNINGS CAREFULLY

We take great pride in providing the finest model kits available, giving strong attention to detail and craftsmanship. Should you have any difficulty with assembly or missing parts, please call the appropriate number listed below between the hours of 8:00 am to 4:30 pm central time, Monday through Friday.

In the U.S.A. call toll free

800 - 553 - 4886

Outside of the United States call

1 - 319 - 875 - 2000

When in the Midwest, please visit the ERTL Company for a tour of the AMT production facilities, 10am & 1pm weekdays. Reservations suggested.

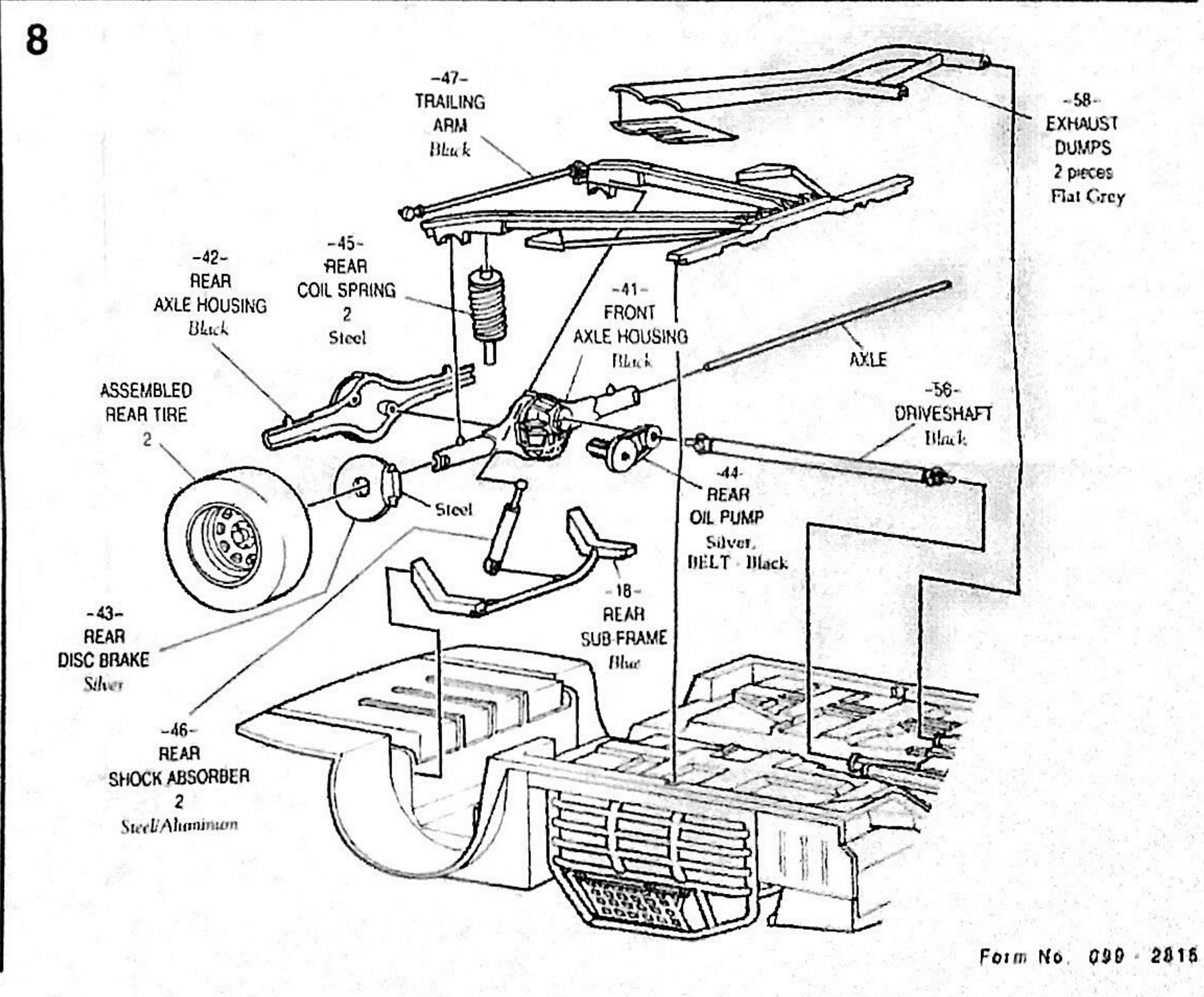
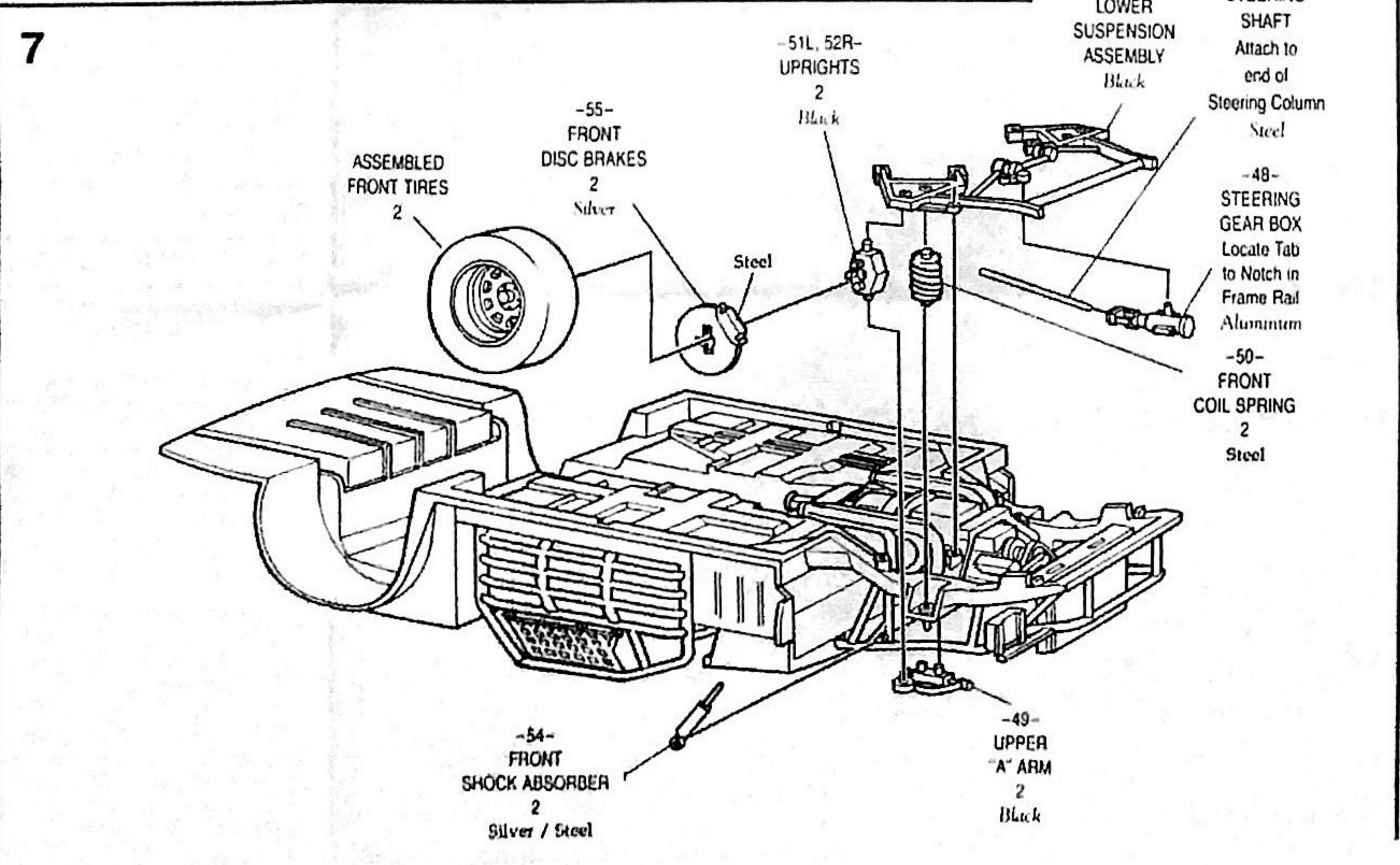
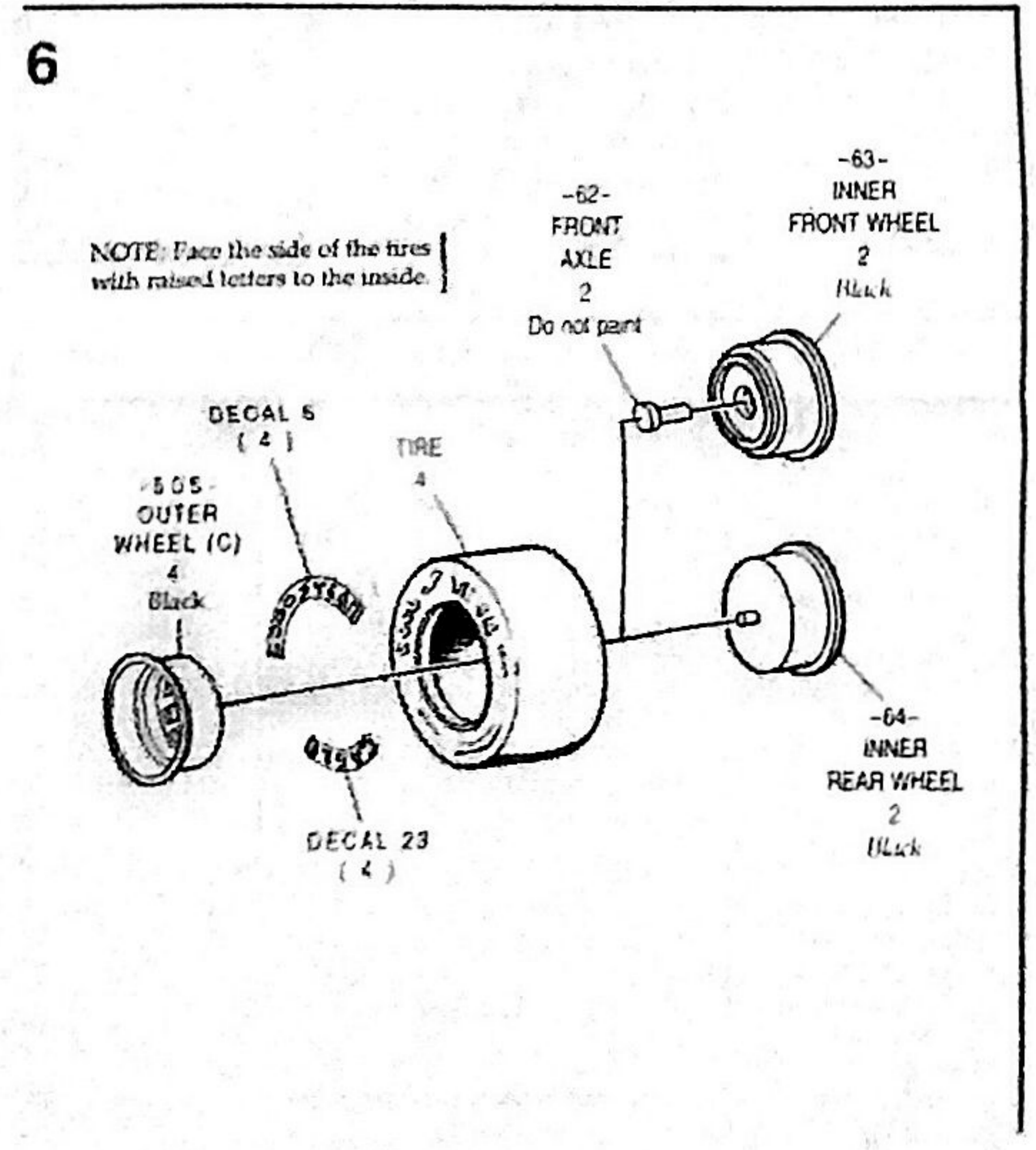
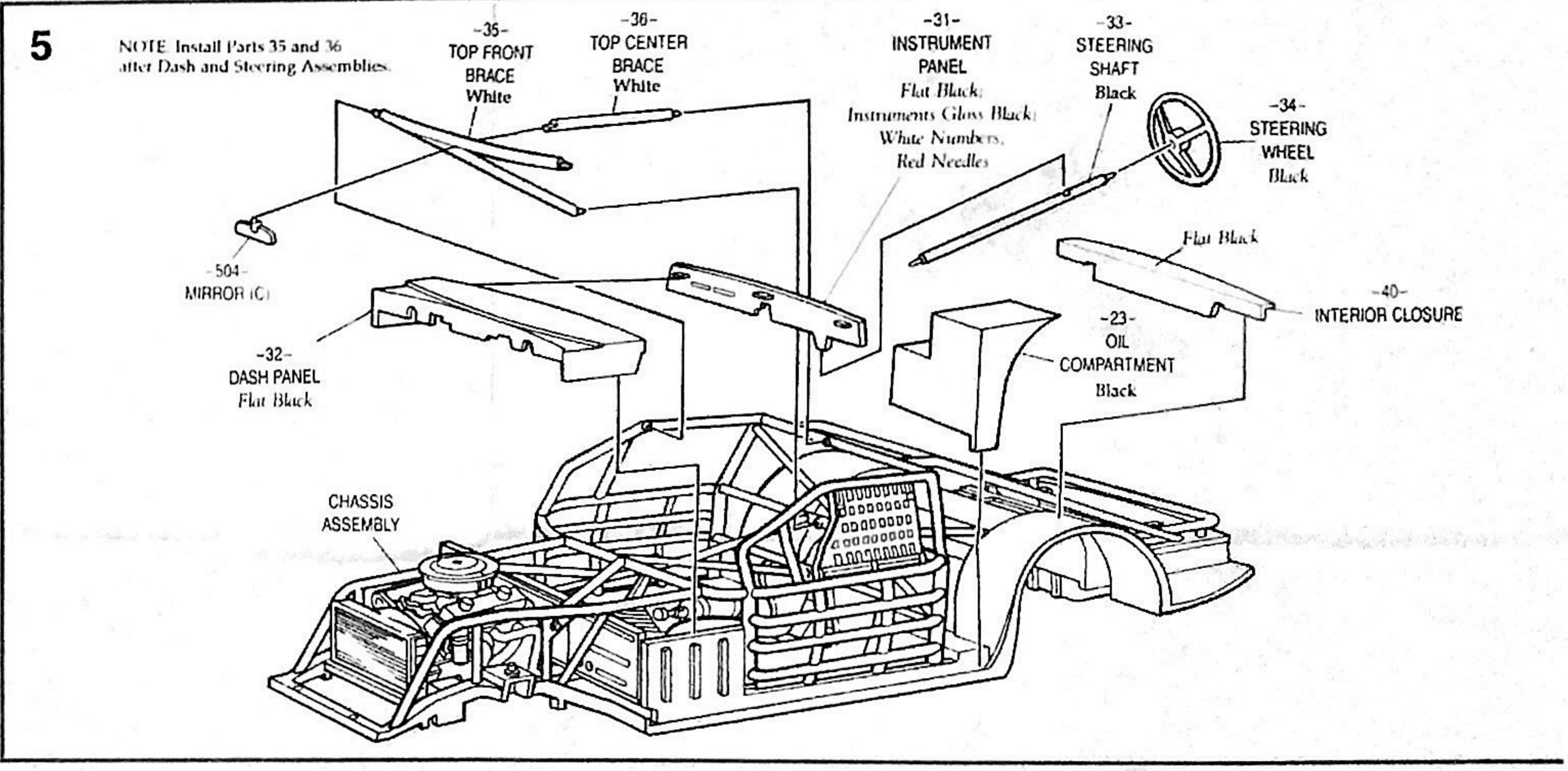
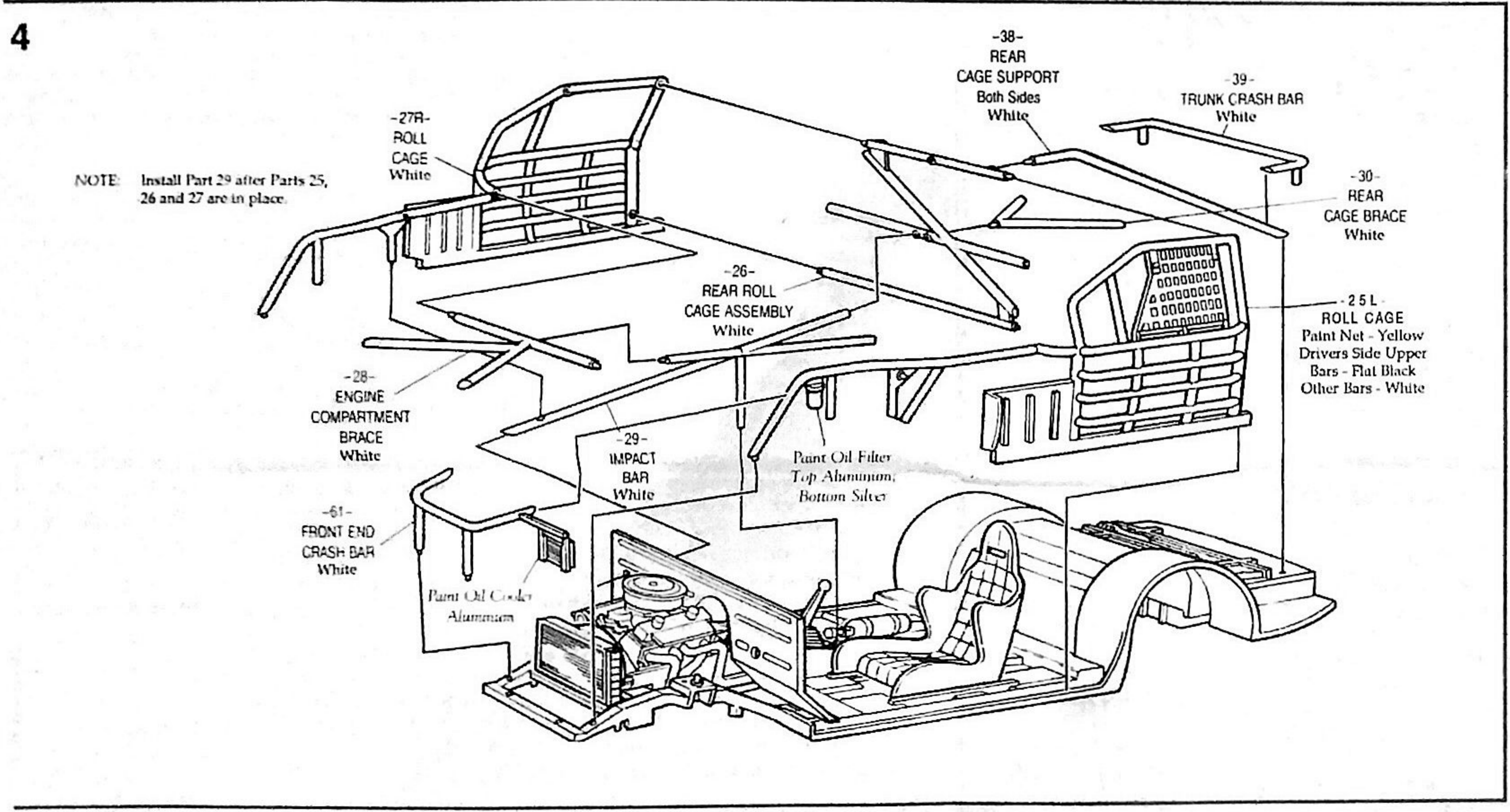
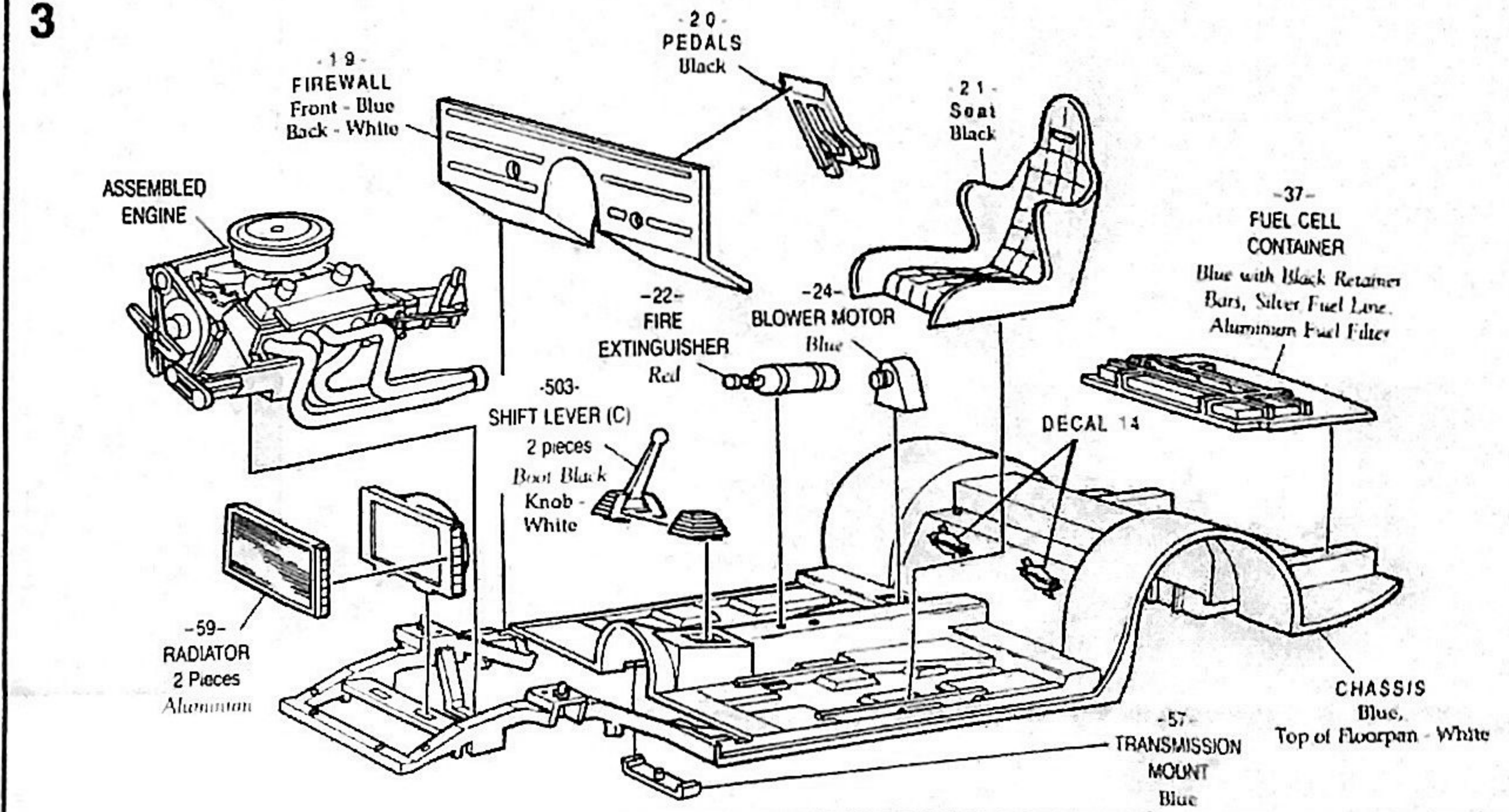
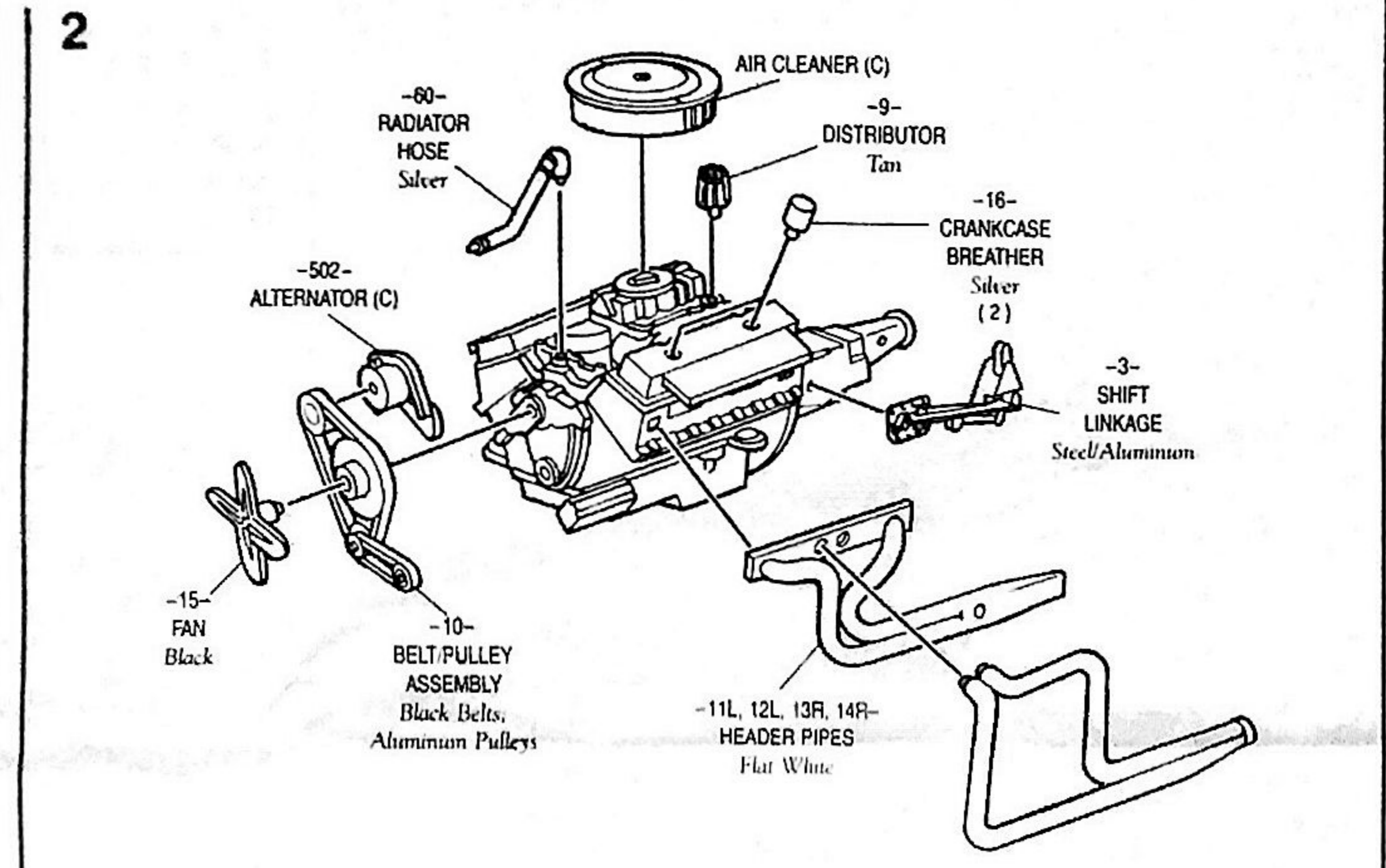
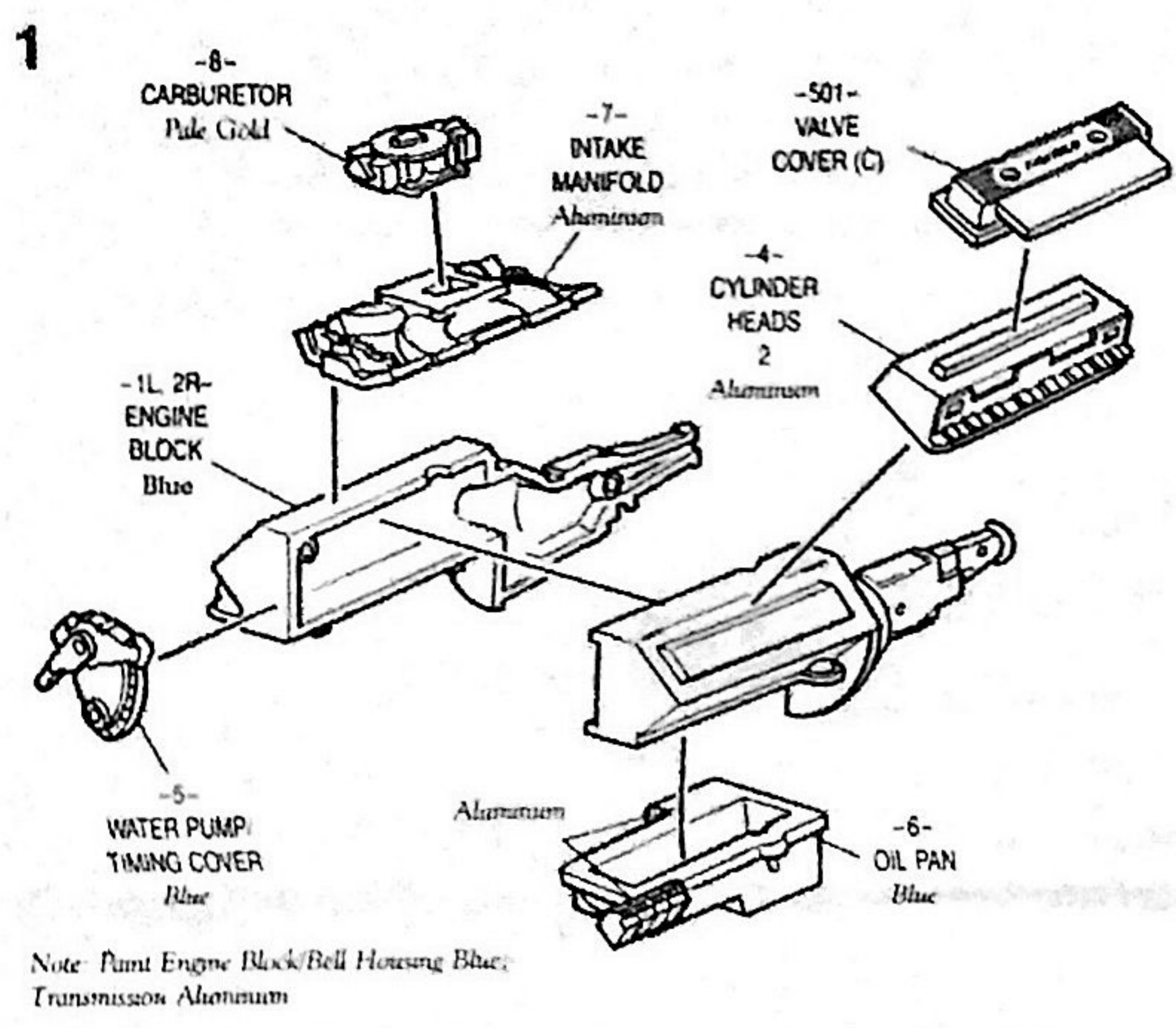

STEP 9

NOTE: Paint Body, Front Bumper, Hood, Deck Lid, Rear Spoiler, and Rear Bumper Metallic Blue and Day Glo Red before proceeding with STEP 9. Tape the parts together from the inside and paint as a unit. Use the DECAL PLACEMENT panel below as a painting guide.

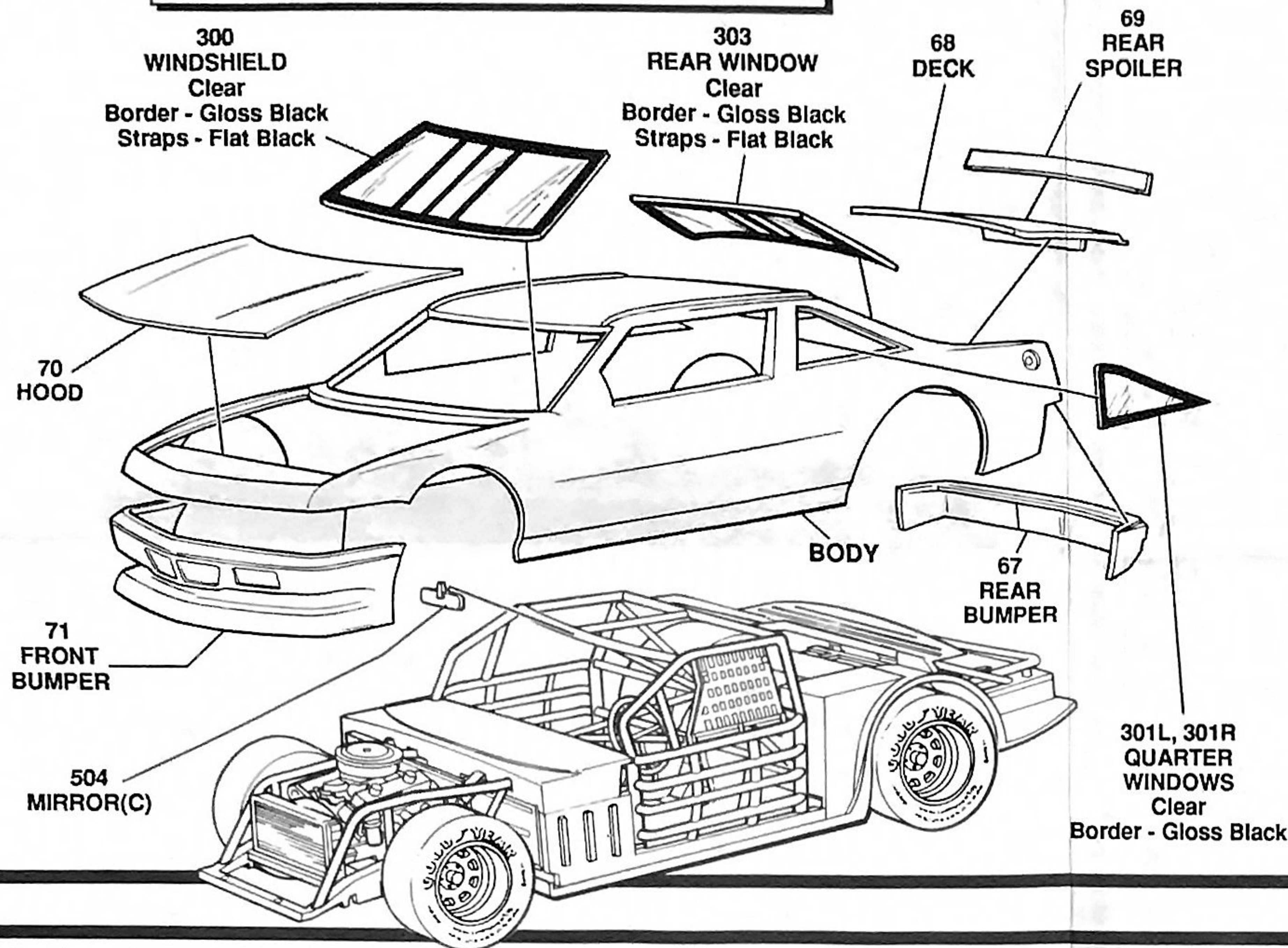

STEP 10

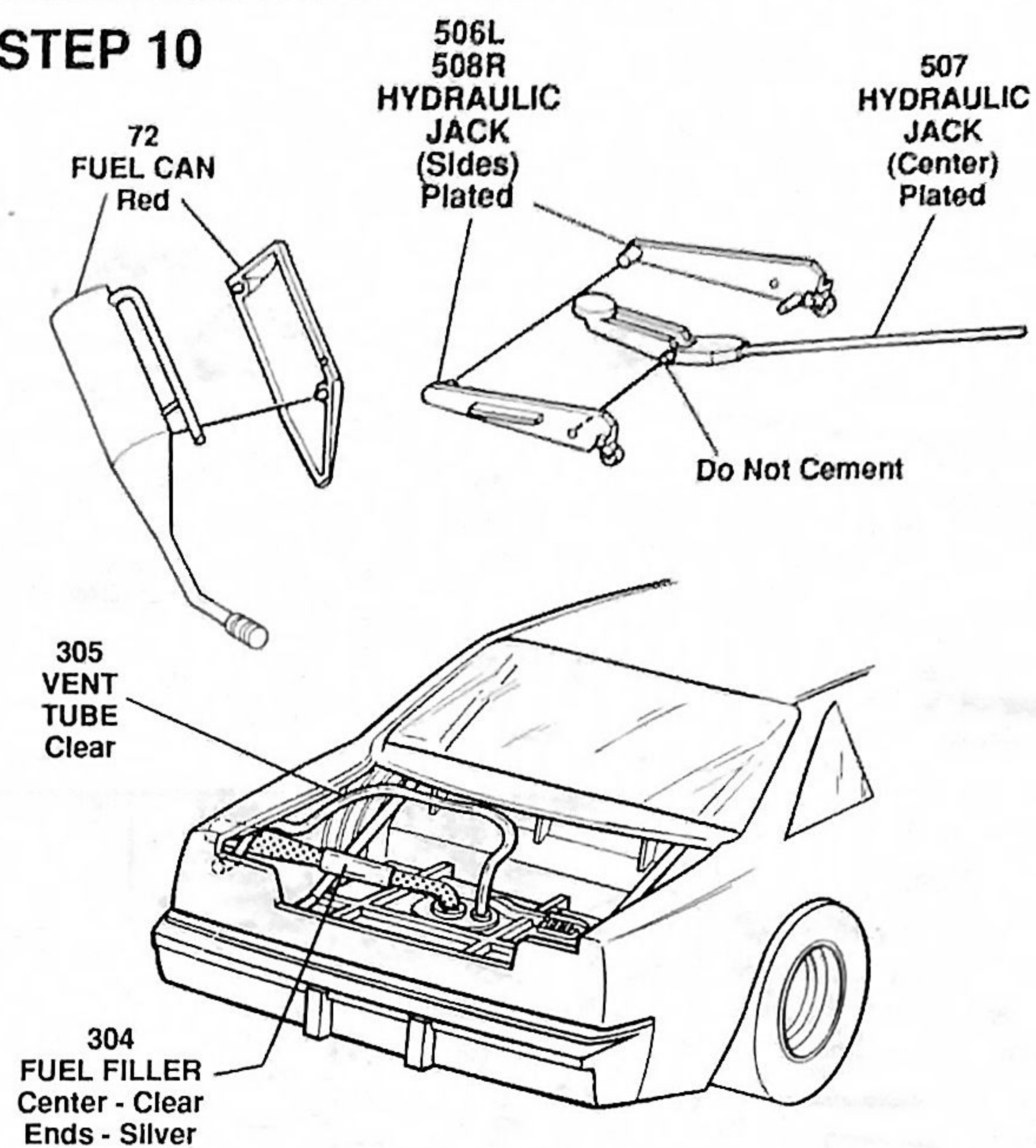

DECAL APPLICATION

