

PartELEMENTY FOTOTRAWIONE
DO MODELI PLASTIKOWYCH**Mi-24V Hind-E cargo cabin**

DETAIL SET FOR PLASTIC KIT

"Part" (0-42) 640-40-76

www.part.pl

1:35 scale detail set for **TRUMPETER** kitPO DRUGIEJ STRONIE
OPPOSITE SIDEODCIĄĆ
REMOVEZAGIĄĆ
BENDDO WYBORU
OPTIONAL**UWAGA**

Elementy fototrawione należy przycinać
kierując się symbolami. Przed wykończeniem
i malowaniem należy sprawdzić
czy nie ma uszkodzeń i czy nie ma
nieczystości.

CAUTION

Photo-etched parts can only be glued
with cyanoacrylate glue. Work in a well
ventilated area. Do not smoke during
glueing process and dry thoroughly. Wash your
hands after using.

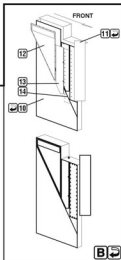
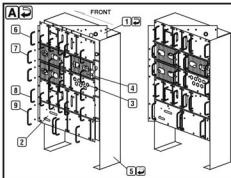
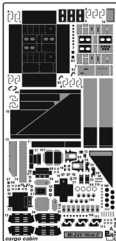

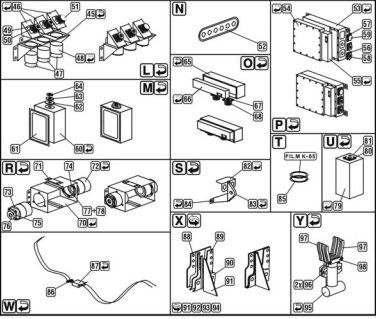
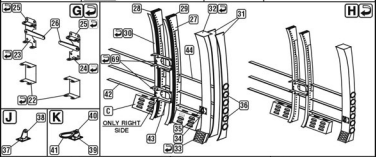
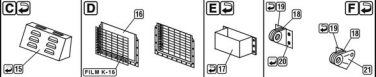

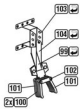
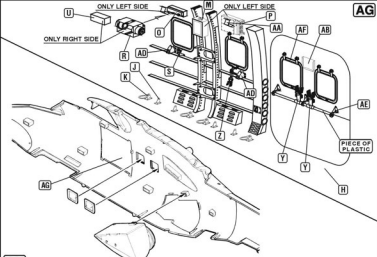
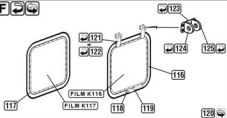
Z**AA****AC****AD****AE****AF****AH**

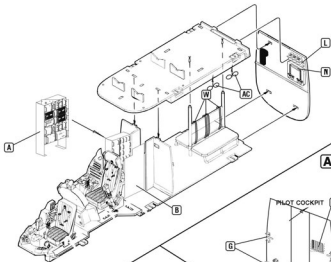
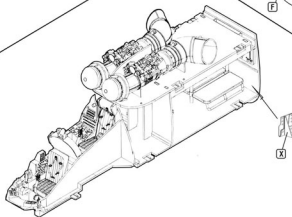
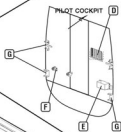
AJ**AK****AL**