

# M1114 Up-Armoured Vehicle w/XM153 Crows II

## 1/35 SCALE

M1114 装甲战术车辆搭载XM 153 遥控武器站



Both in Iraq and Afghanistan many patrol vehicles were armed with hand operated weapons mounted on the roof of the vehicle. Even though such weapons were protected by armor plate and bullet proof glass, operators were still vulnerable to sniper fire and the blast from explosive devices. The XM153 CROWS (Common Remotely Operated Weapon Station) was developed to replace these manned weapons. The system allows the operator to stay within the vehicle, sighting and firing the weapon by remote control. A sensor module used to sight the weapon has a video camera, thermal image device and laser range finder. CROWS II can mount a variety of weapons including .50 M2, M240B and M249 machine guns and the MK19 automatic grenade launcher. Since 2004 over 1000 systems have been fitted to the M1114 Humvee, M1A2 Abrams, M1126 Stryker and many MRAP vehicles including Buffalo MRCV's. 

Short Story by Phil Greenwood

Im Irak sowie in Afghanistan waren viele Patrouillen Fahrzeuge mit dachmontierten Waffen bestückt, welche von Hand bedient wurden. Trotz Panzerplatten und kugelsicherem Glas war das Bedienungspersonal immer noch durch Scharfschützen und Sprengladungen verwundbar. Das XM153 CROWS (Common Remotely Operated Weapon Station) wurde als Ersatz für diese handbedienten Waffen entwickelt. Das System erlaubt ferngesteuertes Sichten, Zielen und Feuern vom Fahrzeuginneren aus. Ein Sensormodul zur Ausrichtung der Waffe ist mit Video- und Wärmebildkamera sowie einem Laserentfernungsmesser bestückt. Das CROWS II kann verschiedene Waffen steuern: 0.50 M2, M240B und M249 MGs sowie den MK19 Granatwerfer. Seit 2004 wurden über 1000 Systeme auf M1114 Humvee, M1A2 Abrams, M1126 Stryker und vielen Minenräumern wie dem Buffalo MRCV installiert. 

© Translation Michael Knoblich Academy Europe

同时期在伊拉克和阿富汗的许多执行巡逻任务的车辆顶部都会安装用人手操作的武器。即使这种武器装置都被围上了装甲板和防弹玻璃，但外露的操作人员仍然很容易遭受到周边火力狙击和爆炸装置的伤害。因此 XM153 乌鸦（通用远程操作武器站）被应运而生去替换这些人手操作的武器。系统可容许操作人员藏身于车体内，瞄准和发射过程可透过遥控的方式去执行。这武器站装有传感器模块及视频摄像机、热成像装置和激光测距仪。乌鸦二型可灵活搭载各种武器，包括 .50 M2, M240B 和 M259 机枪及 MK19 自动榴弹发射器。自 2004 年起超过 1000 套这种系统被装上到 M1114 悍马、M1A2 艾布拉姆斯、M1126 史崔克和许多 MRAP 车辆包括大水牛 MRCV。 



**CORRECT METHOD FOR APPLYING DECALS: HINWEISE ZUM ANBRINGEN DER DECALS**  
**正确使用水贴纸的方法:**

- Clean model parts surface with wet cloth. Entsprechende Stellen am Modell feucht reinigen.  
将需要贴水贴纸之部位表面擦干净。
- Cut out the decal parts and dip them in cold water for 15 ~20 seconds. Decal ausschneiden und für 15-20 Sek. ins Wasser legen.  
将所需之贴纸剪下泡在清水里约15至20秒。
- Place it on correct position of the model kit. Decal an der richtigen Stelle auflegen.  
将湿透之贴纸取出置于正确之位置旁。
- Slide off the decal from the base paper on to the model kit surface with a cotton stick. Decal mit Wattestäbchen festhalten und Papier darunter wegziehen.  
用棉花棒轻推贴纸表面使其从底纸滑出至模型表面之正确位置。
- When decal get dry then complete. Decal mit Papiertuch andrücken und trocknen.  
待其自然干透后即完成。

**ICON INSTRUCTION: 图标说明:**

- |  |  |  |   |  |   |  |                                       |  |                               |
|--|--|--|---|--|---|--|---------------------------------------|--|-------------------------------|
|  | Open Hole<br>Loch bohren<br>钻孔         |  | Remove<br>Abtrennen<br>切除                                       |  | 2 Sets needed<br>Vorgang wiederholen<br>同样的制作二组 |  | Bend<br>Biegen<br>曲折                  |  | Optional<br>Auswahl<br>可以选择采用 |
|  | Apply Decal<br>Decal anbringen<br>贴水贴纸 |  | Instant Glue For Metal<br>Sekundenkleber verwenden<br>瞬间接着剂,金属用 |  | Fill Hole<br>Verspachteln<br>把孔填平               |  | Do not cement<br>Nicht kleben<br>不用粘合 |  |                               |

**COLOR SUGGESTION: FARBTABELLE: 涂装指引:**

Color	涂料表	MR. Hobby	Hobby Color	Humbrol	Tamiya
Steel	Stahl	黑铁色	H-18	53	X-10
NATO brown	NATO Braun	北约棕	/	/	TS-62/XF-68
Silver	Silber	银色	H-8	11	X-11
Flat white	Matt Weiss	消光白	H-11	34	XF-2
Light sand	Heil-Sandfarben	浅沙色	/	/	TS-46
NATO green	NATO Grün	北约绿	/	/	TS-61/XF-67
Tyre black	Reifenschwarz	轮胎黑	H-77	85	XF-1
Semi gloss black	Schwarz Seidenmatt	半光黑色	/	/	X-18/TS-29
NATO black	NATO Black	北约黑	/	/	TS-63/XF-69
Clear red	Klar-Rot	透明红色	H-90	/	X-27
Clear orange	Klar-Orange	透明橙色	H-92	/	X-26
Flat black	Matt Schwarz	消光黑色	H-12	33	XF-1
Hull red	Rumpfröt	铁锈红色	/	/	XF-9
Flat red	Matt Rot	消光红色	H-13	73	XF-7
Olive drab	Braun-Oliv	橄榄绿	H-304	116	XF-62
Titanium silver	Titan-Silber	钛银色	/	/	X-32
Titanium gold	Titan-Gold	钛金色	/	/	X-31
Buff	Lederfarben	浅黄色	/	/	XF-57
Khaki	Khaki	卡其色	H-80	/	XF-49
Gold	Gold	金色	H-9	/	X-12
Green	Grün	绿色	H-6	3	X-5

**READ BEFORE ASSEMBLING: VOR ZUSAMMENBAU LESEN: 组装必读:**

- Carefully Study instruction before assembling. Anleitung studieren und verständlich machen. 组装前请阅读清楚制作指引。
- Keep plastic model glue and tools away from children. Kleber, Farben, Werkzeuge und Plastiktitäten von Kindern fernhalten. 胶水、油漆及工具勿让小孩接触。
- Do not use cement or paint near open flame or sparks. Kleber/Farbe nicht in Nähe von offenen Flammen. 胶水及油漆勿接触火种。
- Do not work in closed room. Nur in ausreichend belüfteten Räumen arbeiten. 勿在密封地方制作模型。

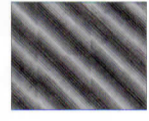

Parts list showing various components with their respective quantities and reference numbers:

- Ca × 1
- G × 1
- F × 1
- C × 1
- Ed × 1
- J × 5
- Ec × 1
- P × 1
- T × 1
- H × 1
- DECAL × 1
- G × 1
- Q × 1

CB35136



ILLUSTRATION 图示说明:

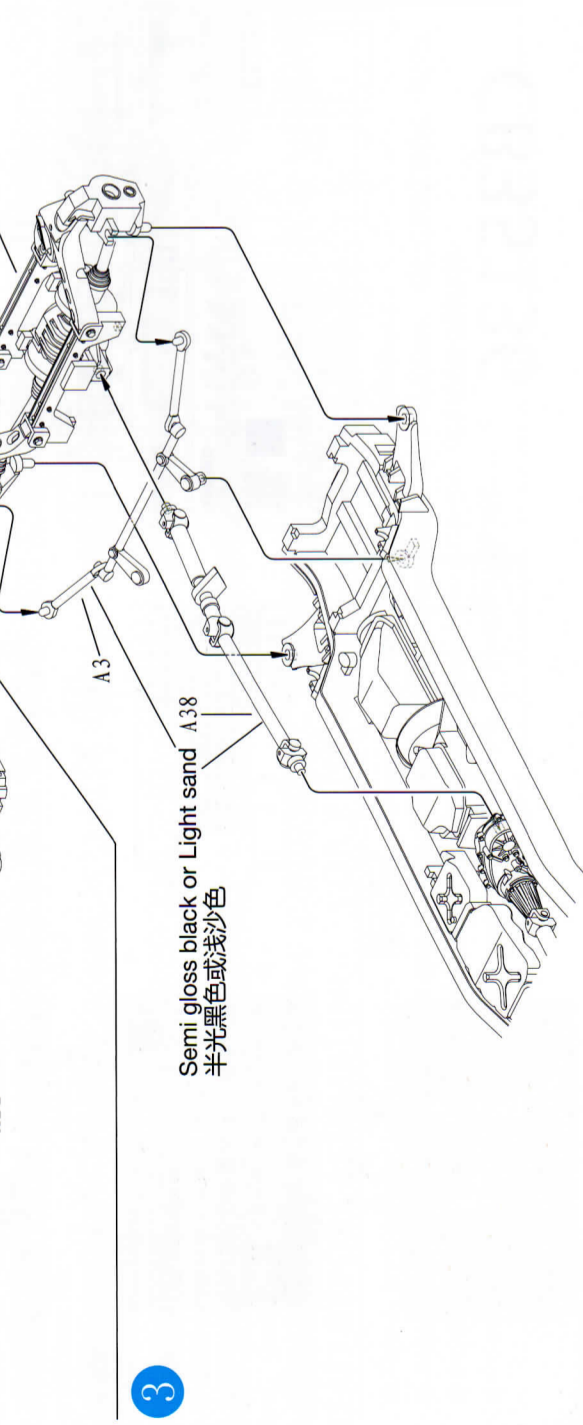
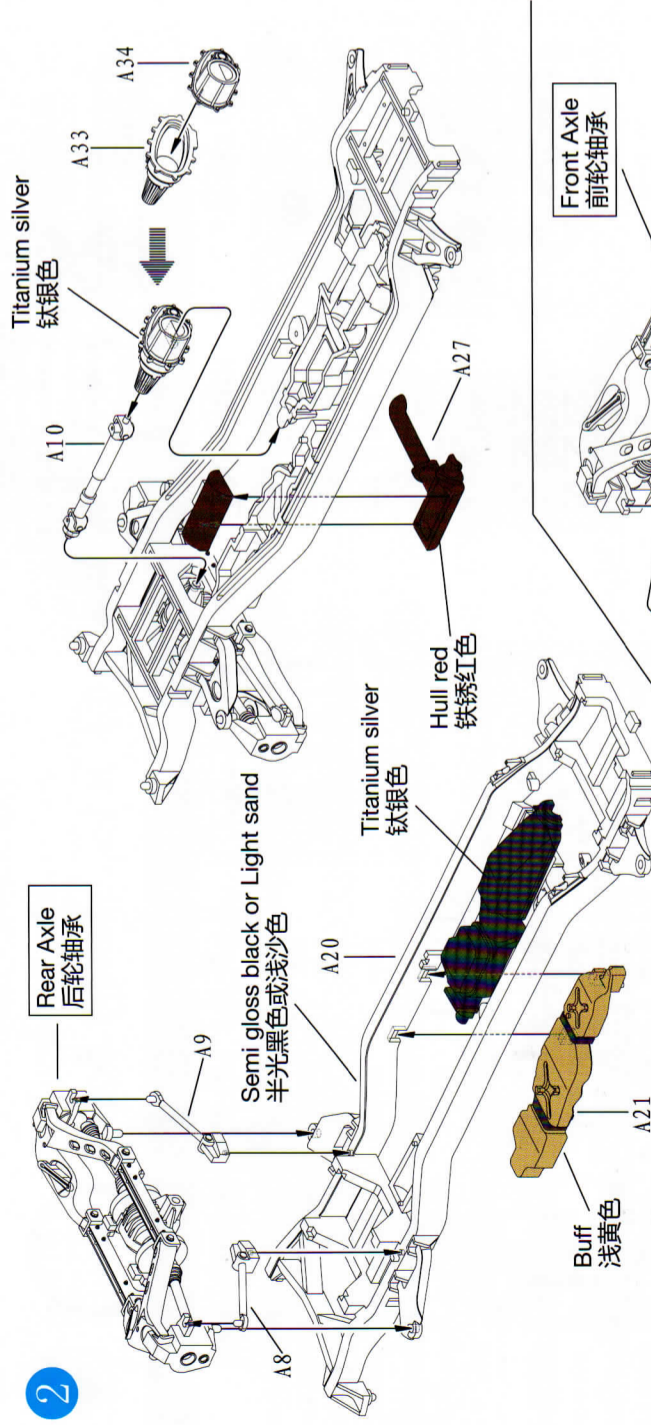
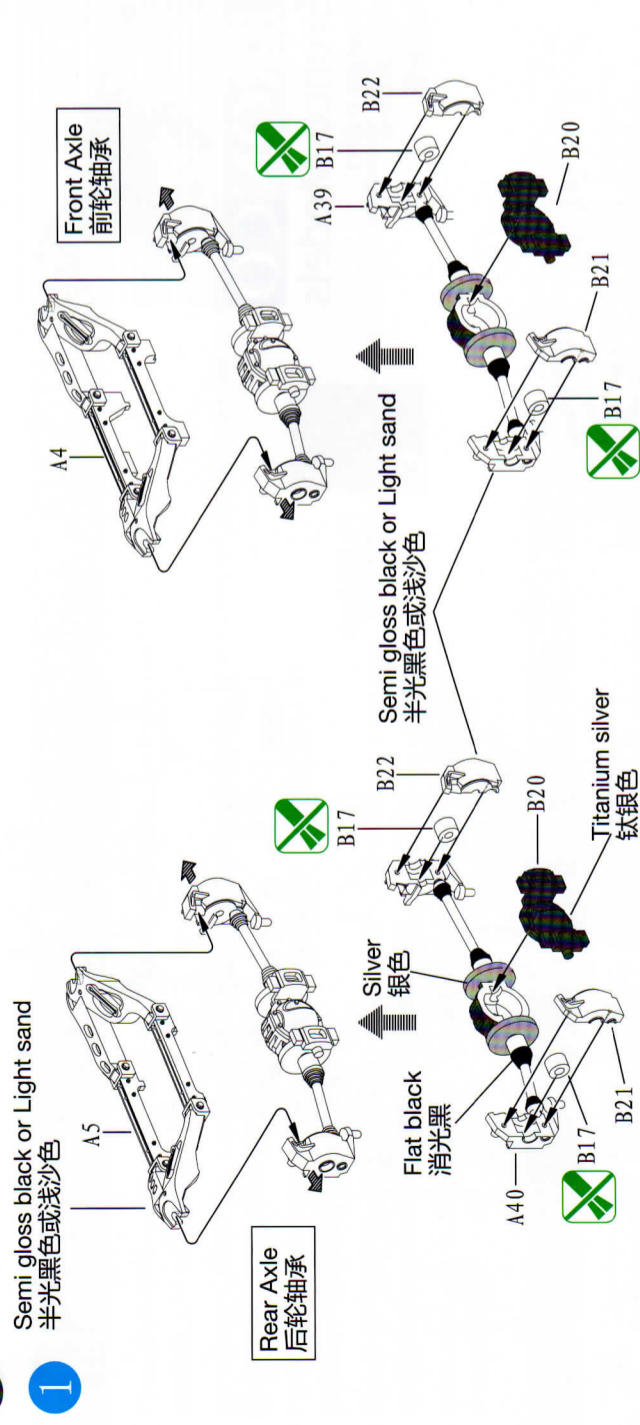
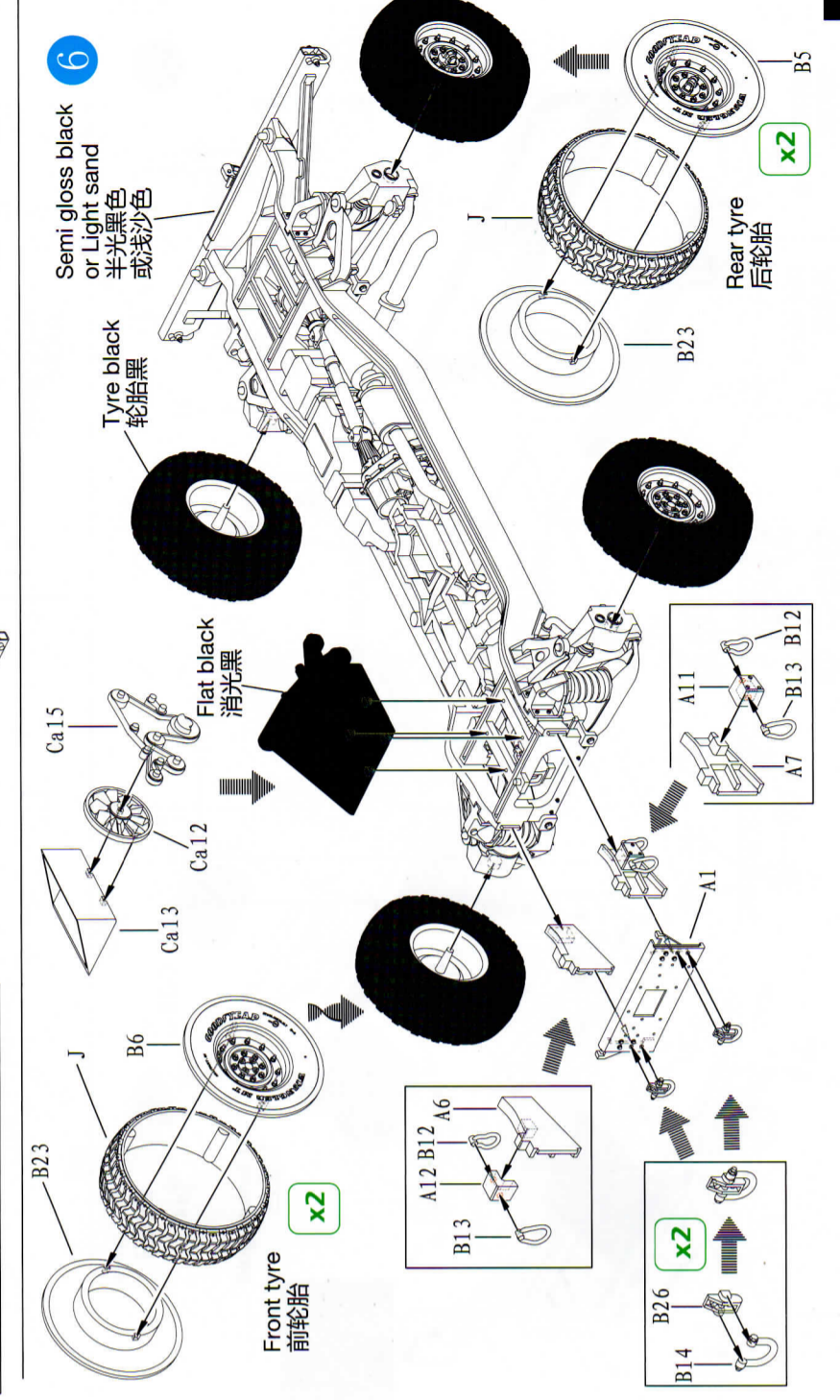
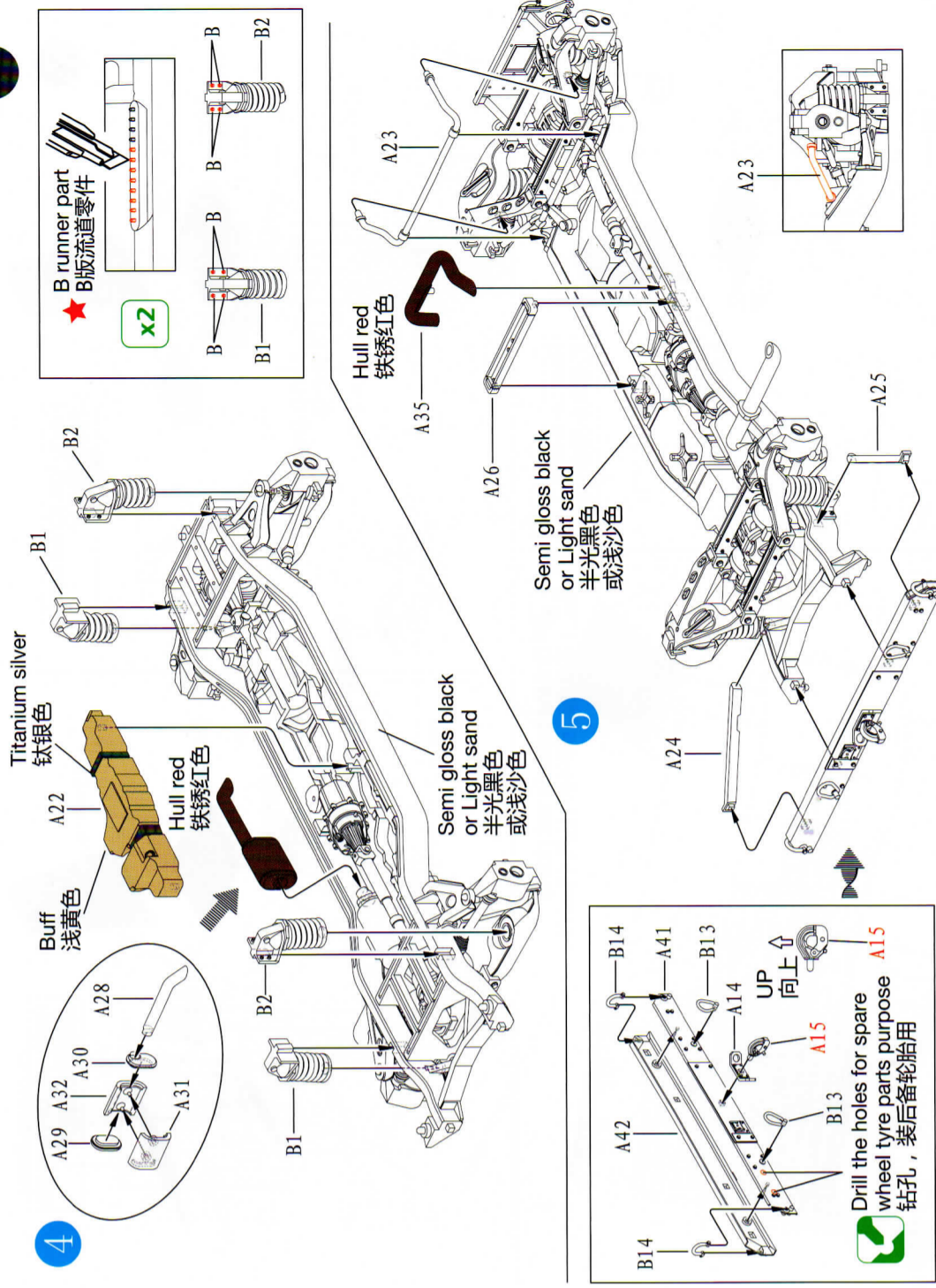
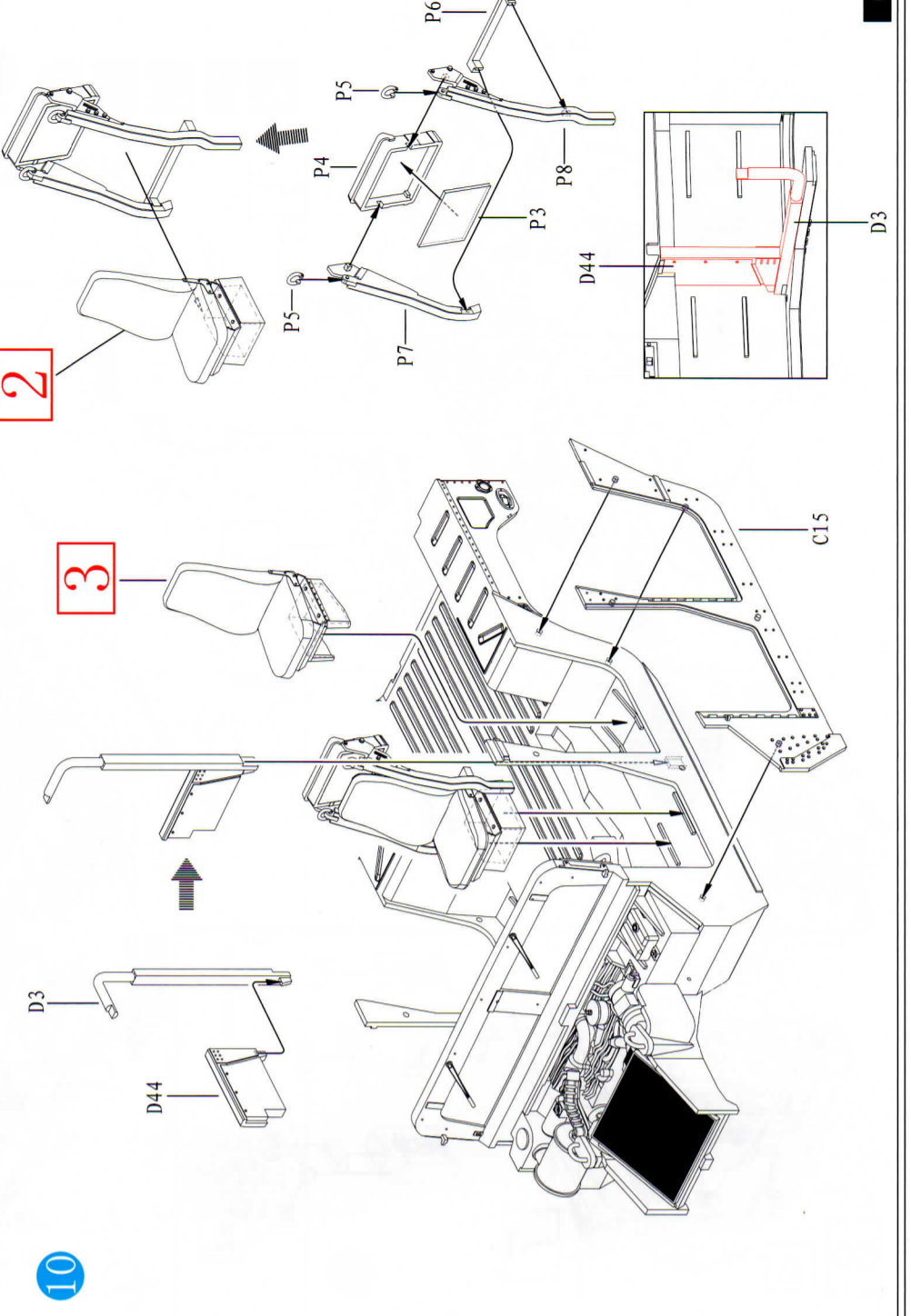
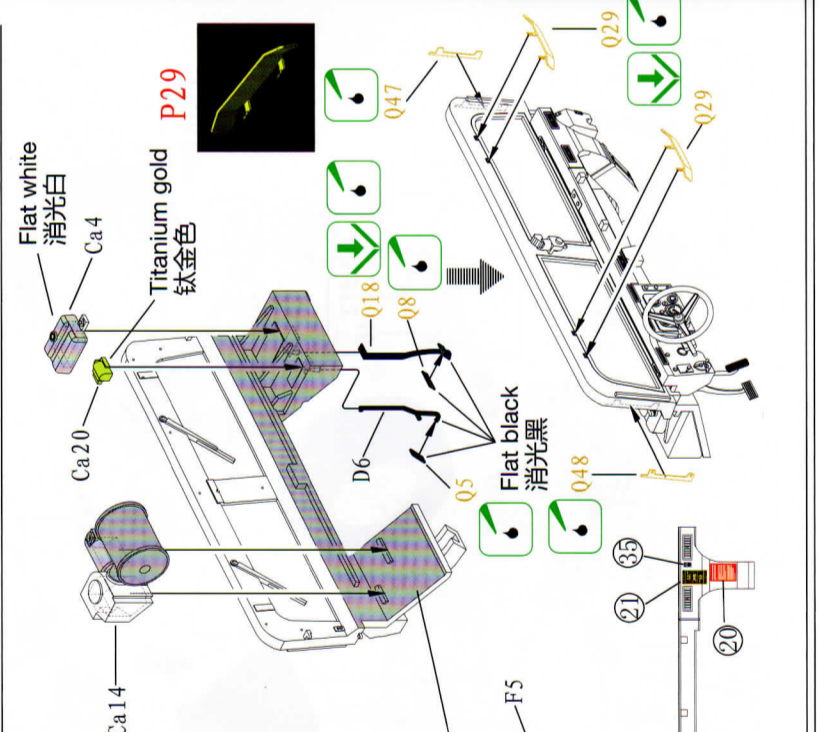
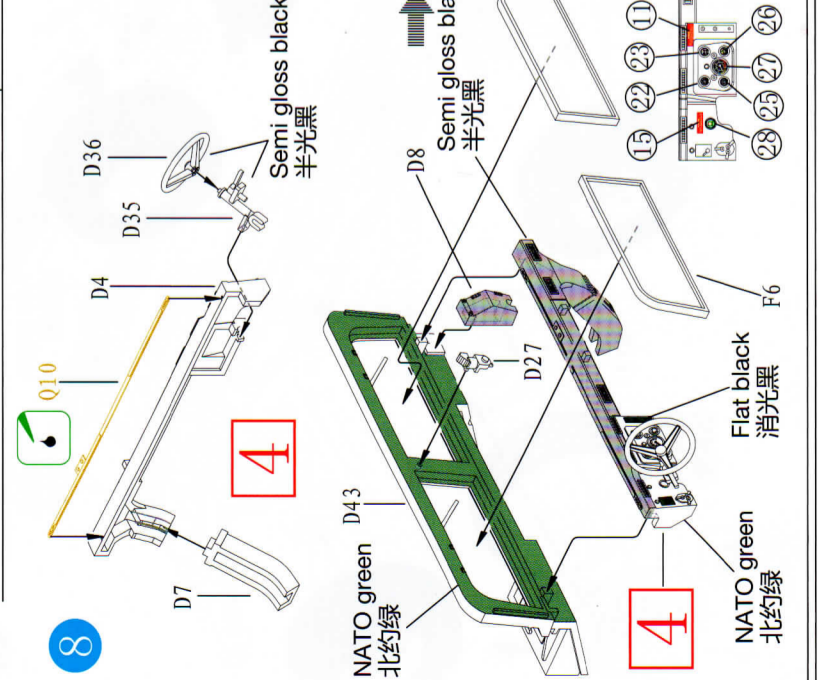
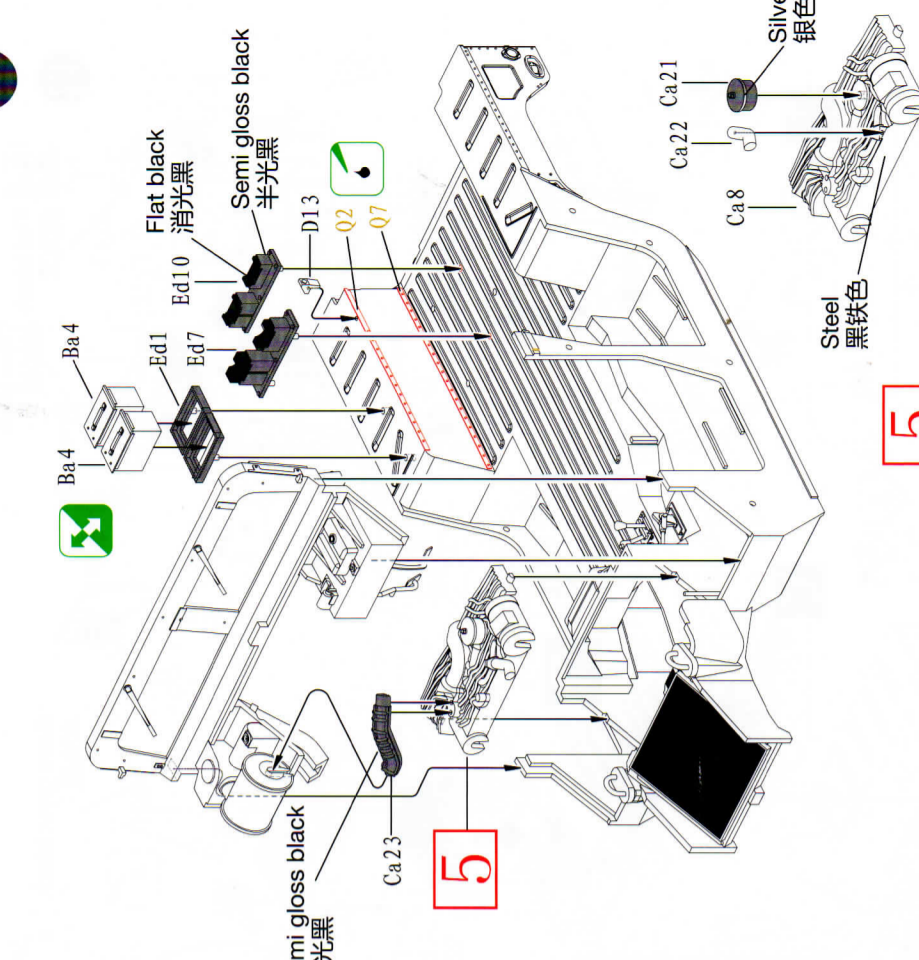
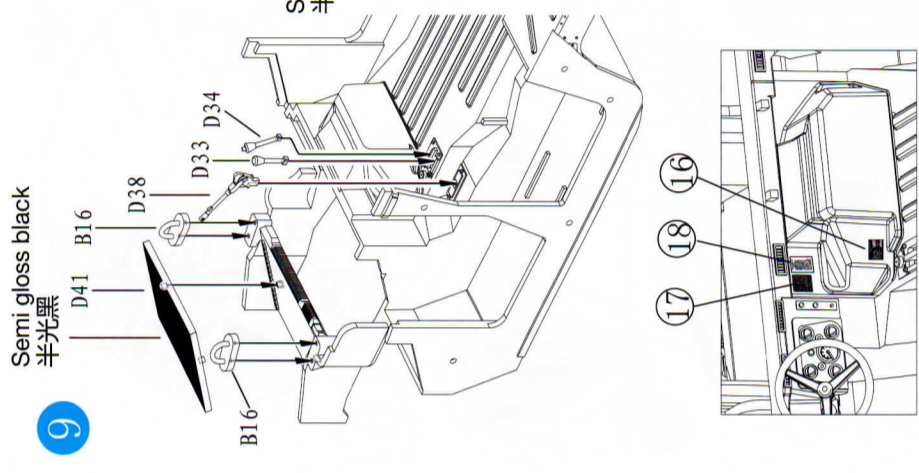
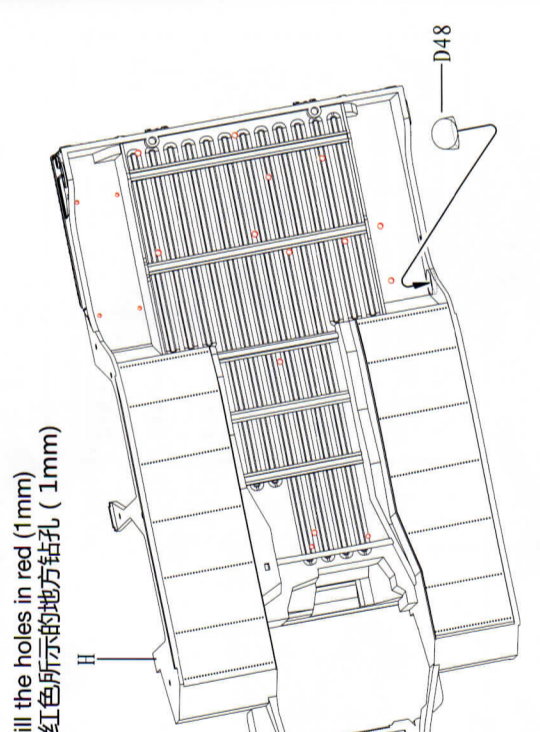
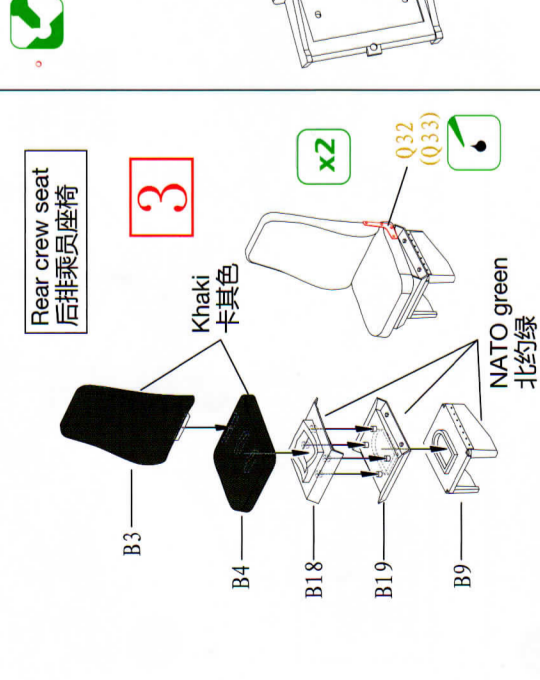
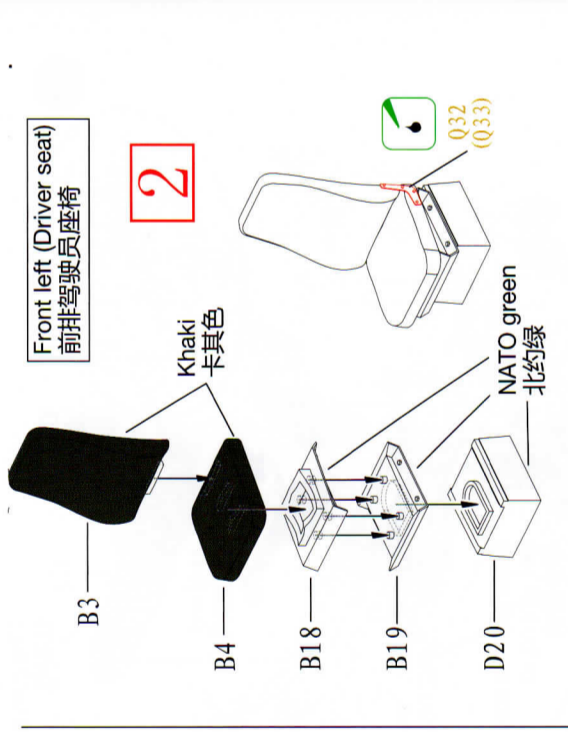
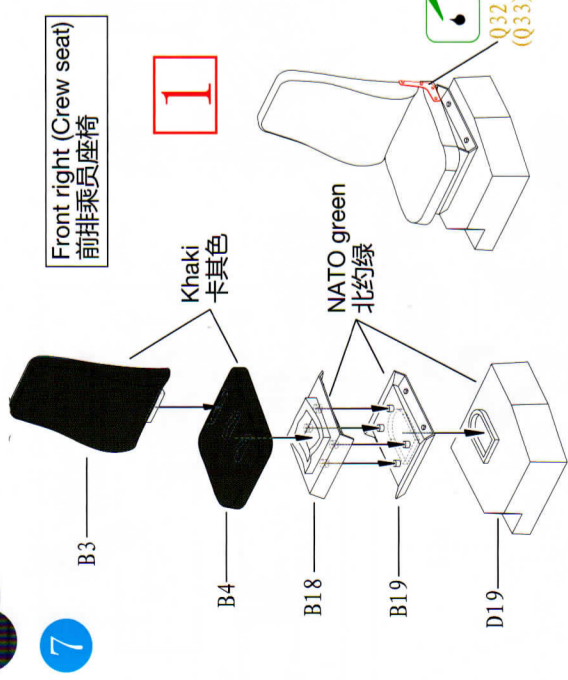

ILLUSTRATION 图示说明:









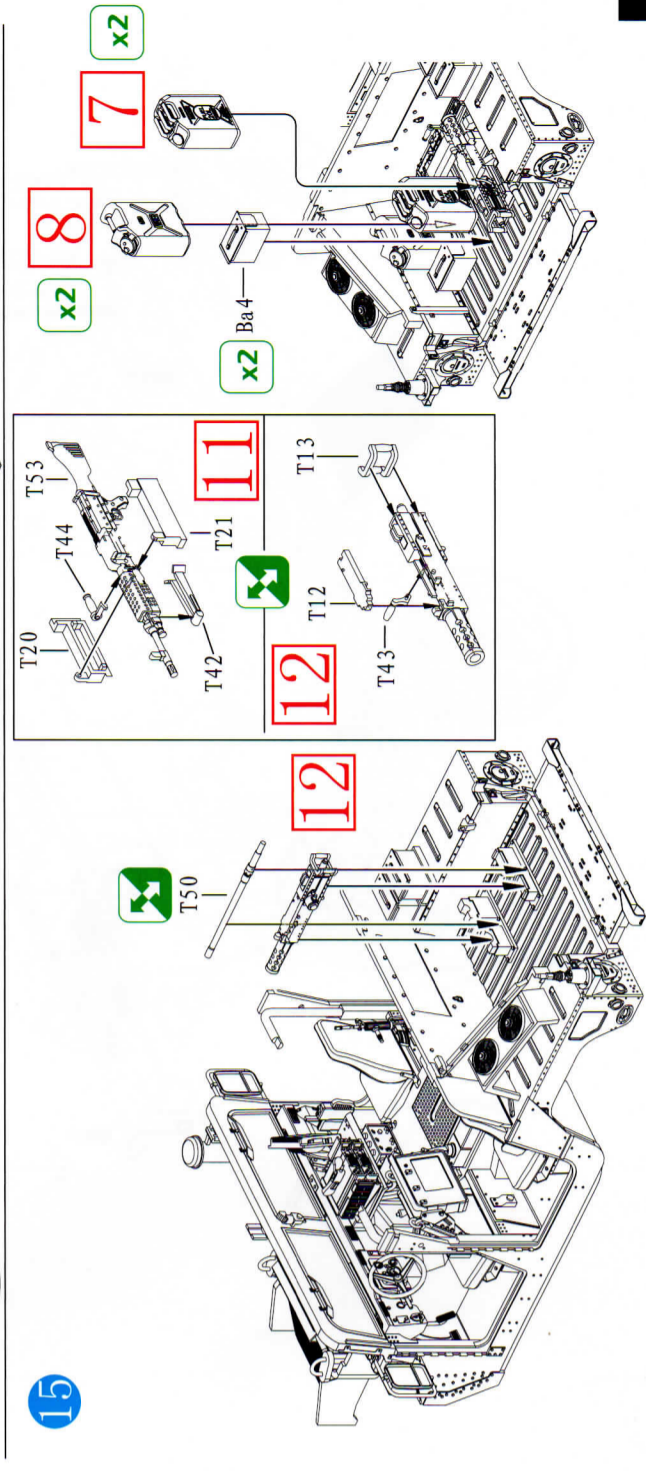
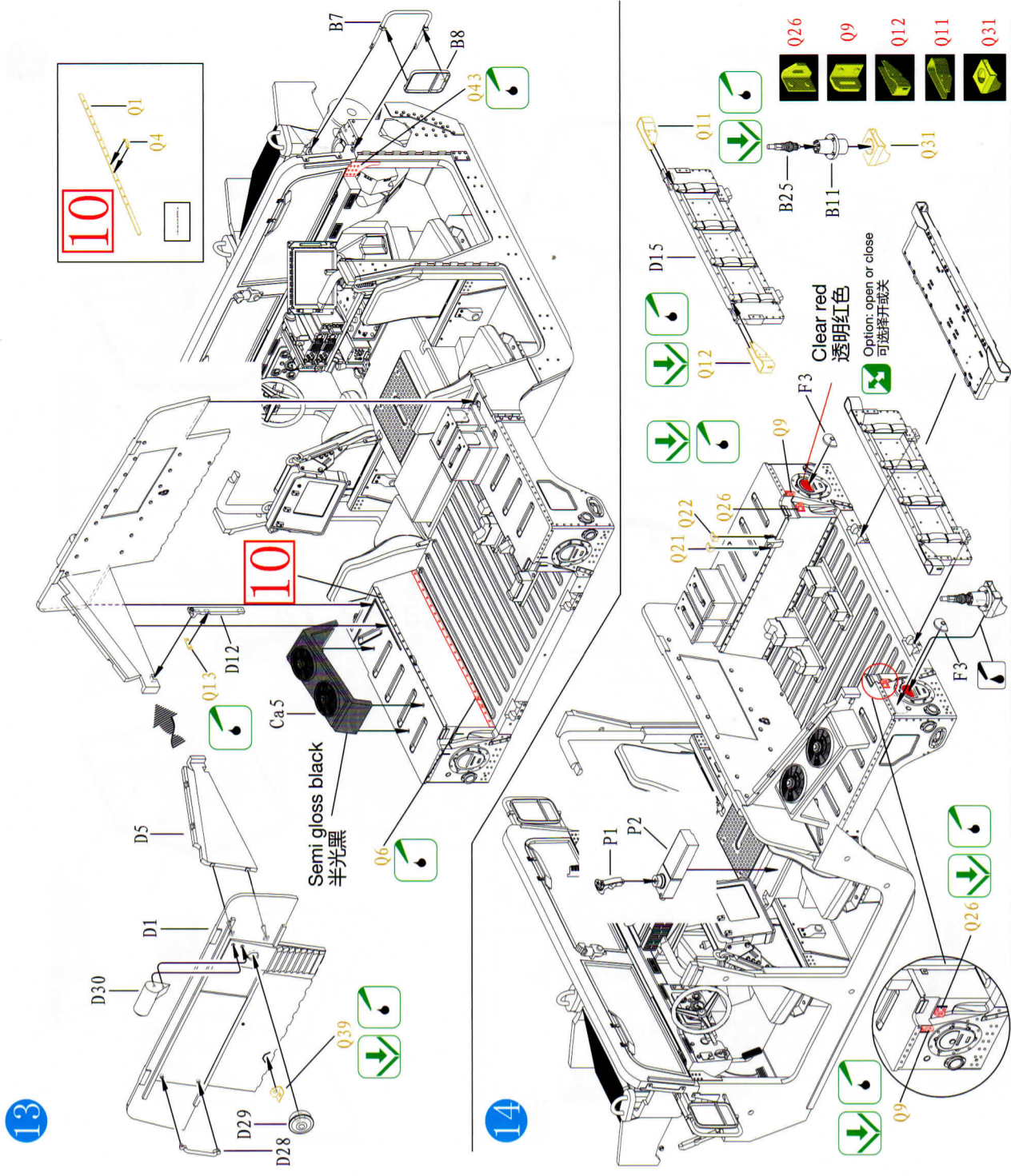
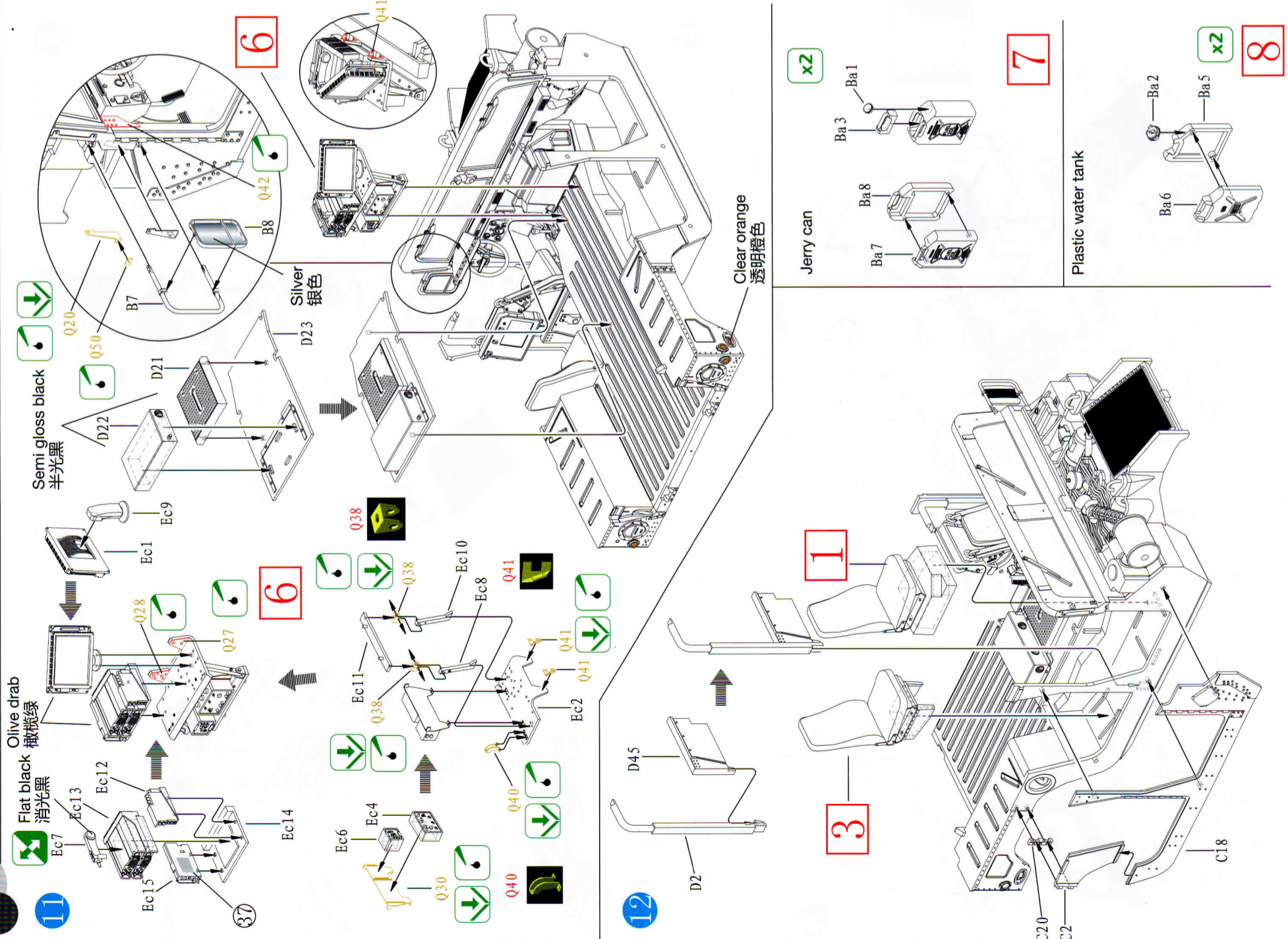



16

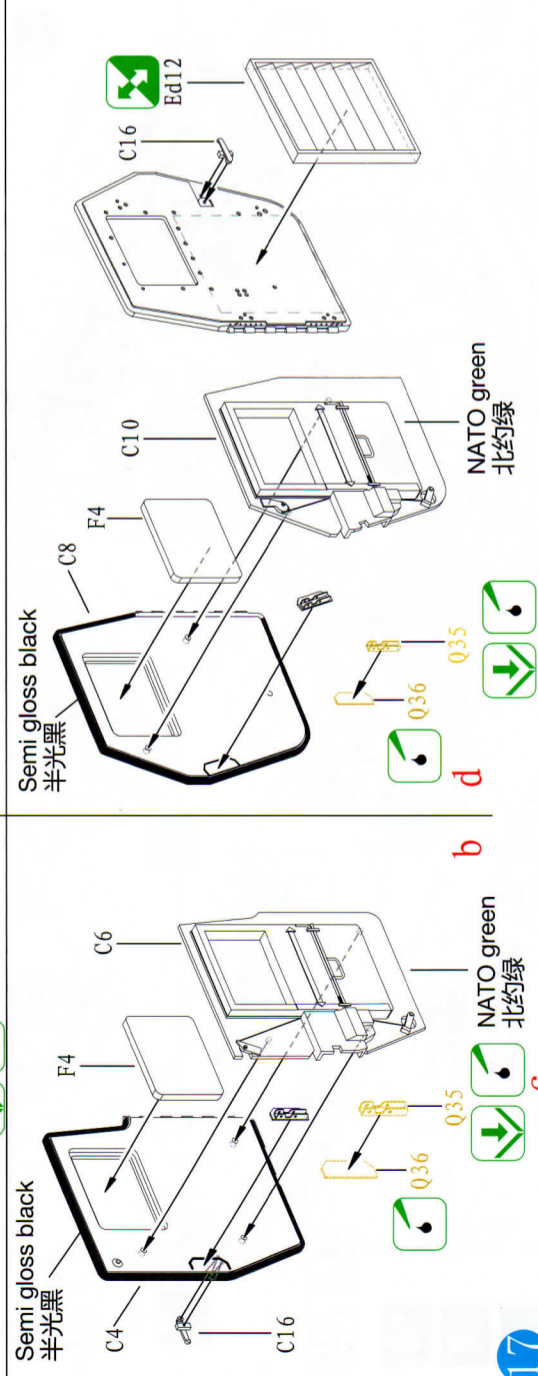
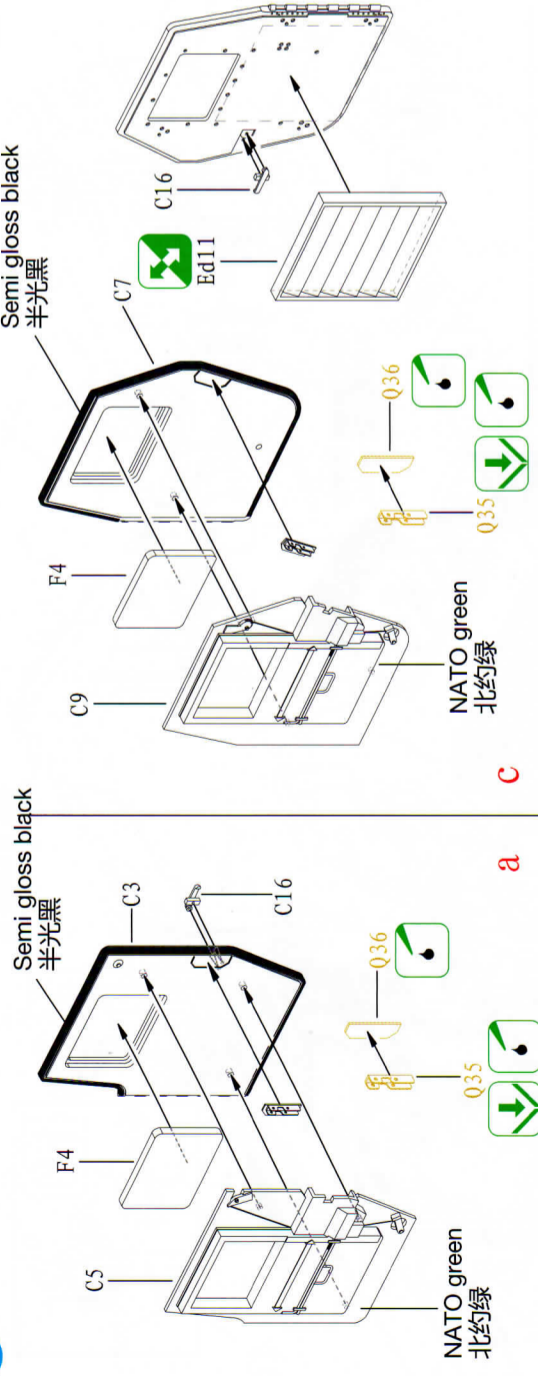

Close position  
关闭状态

17

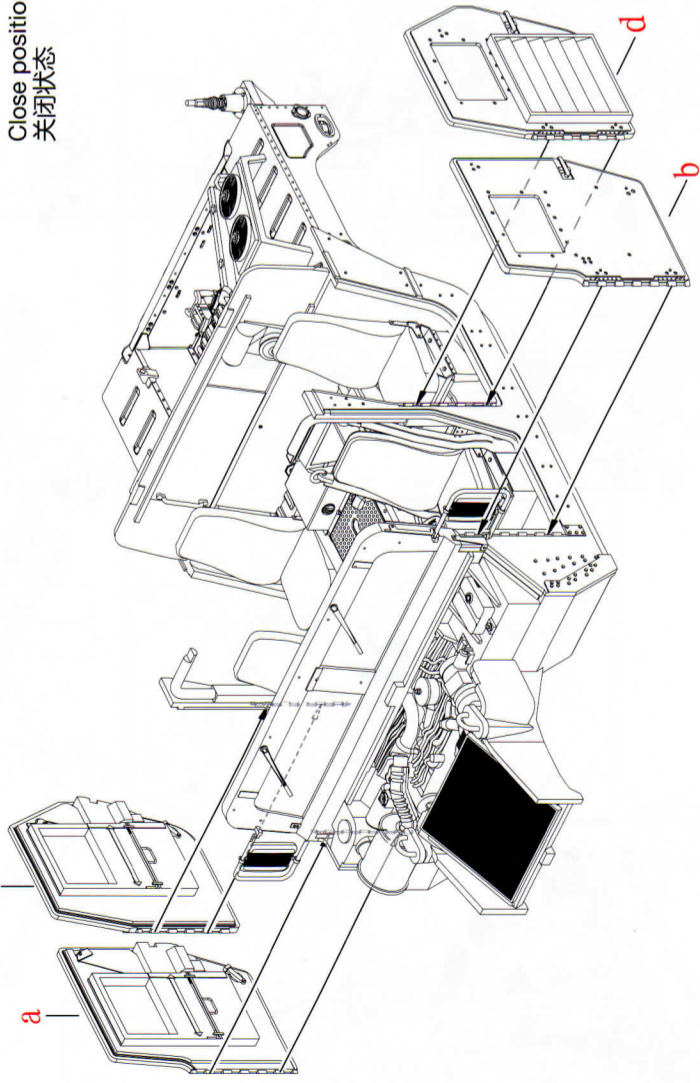

18

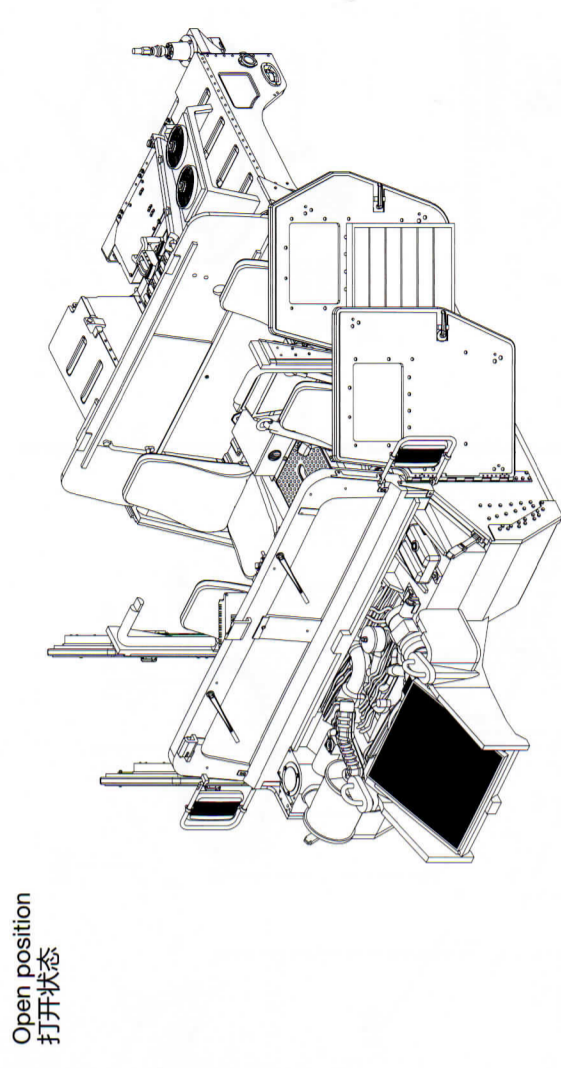

19

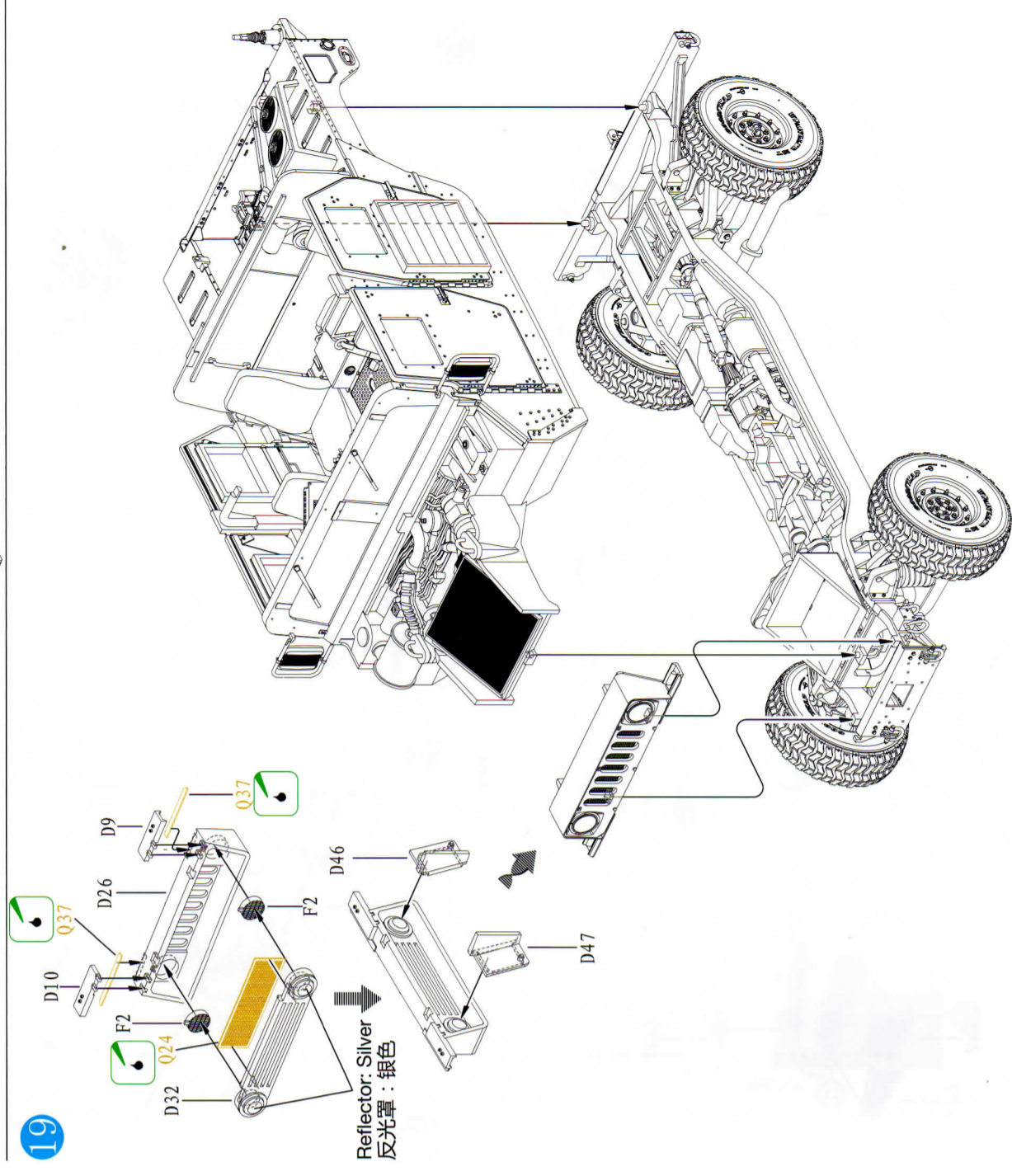



20

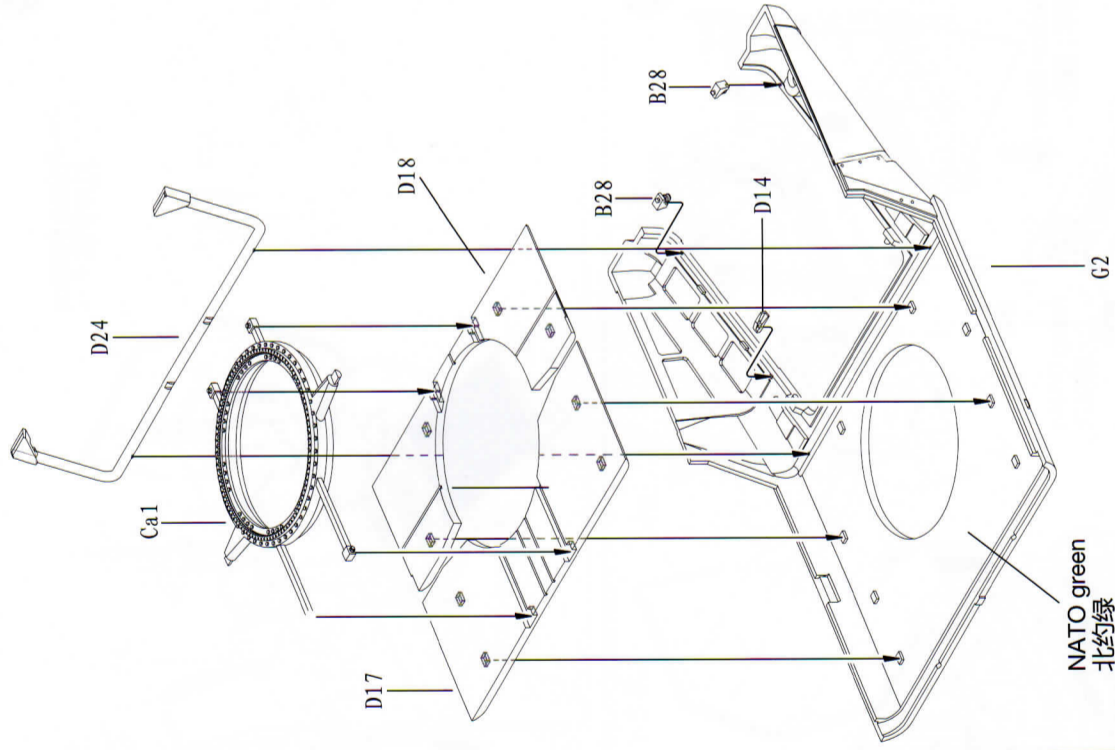
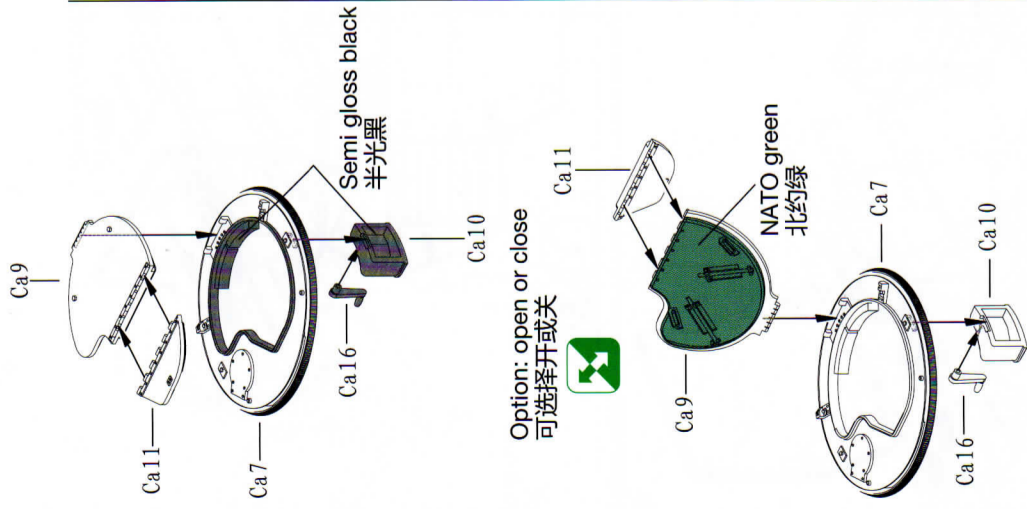

21

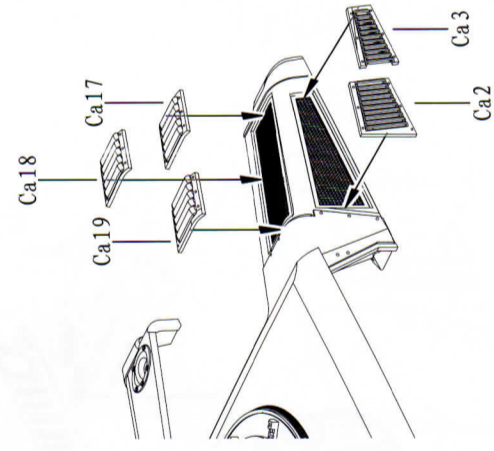
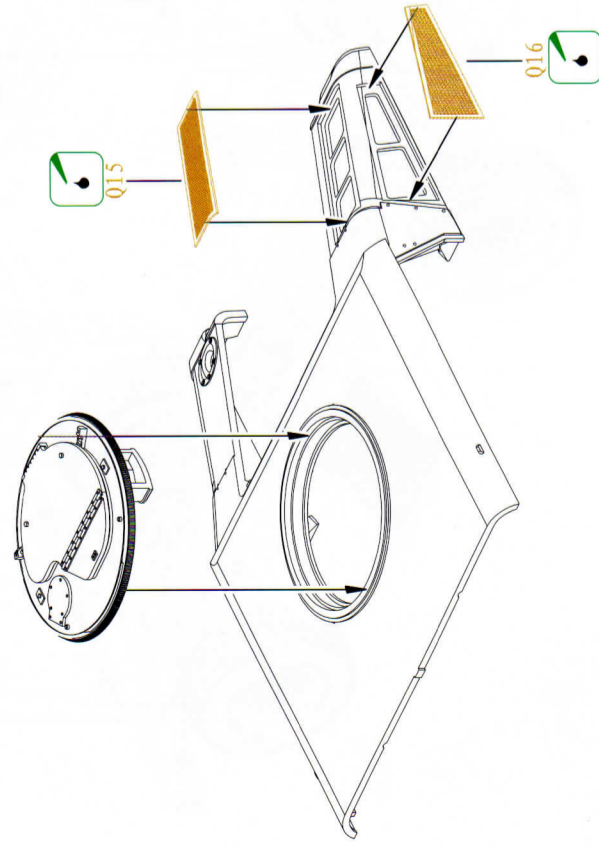

22

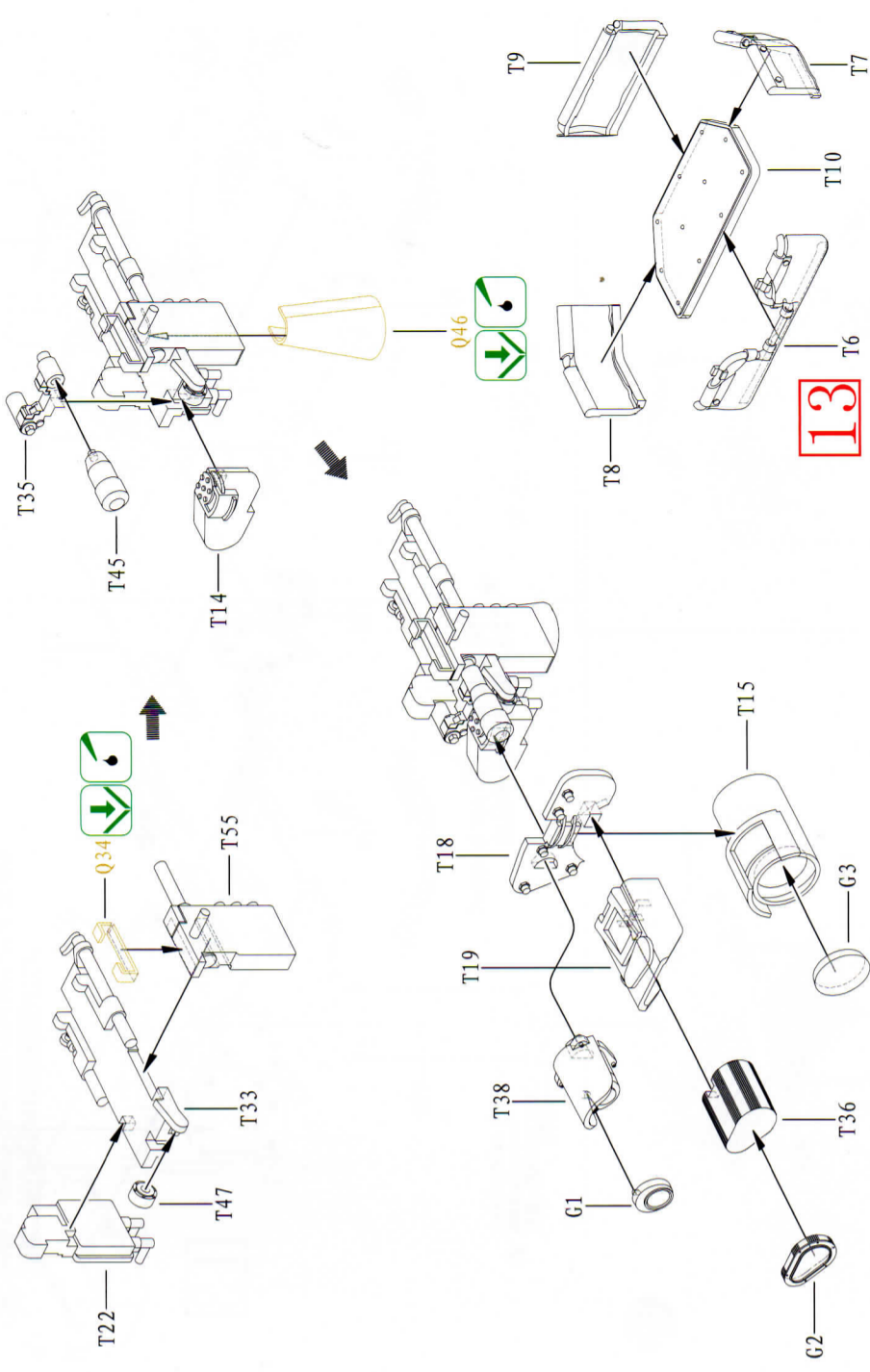

23

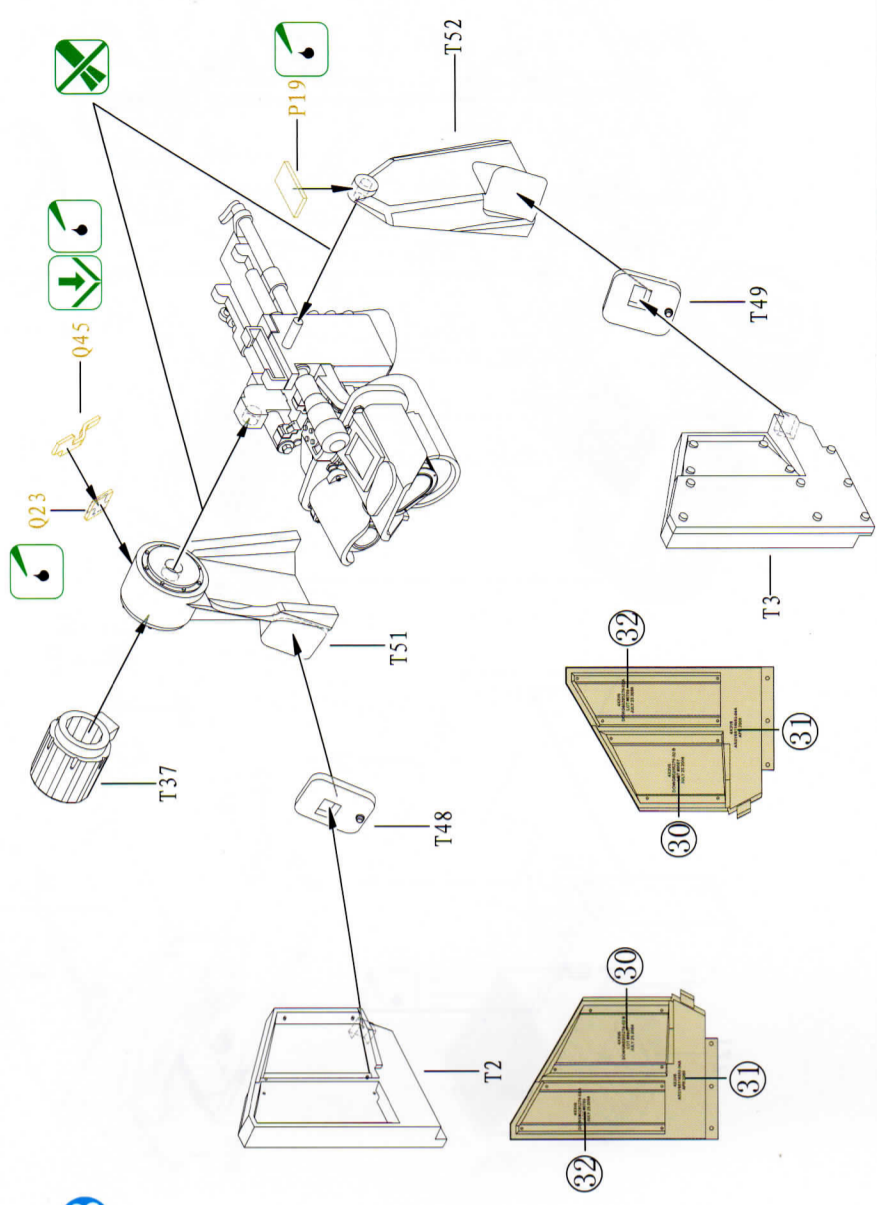



24

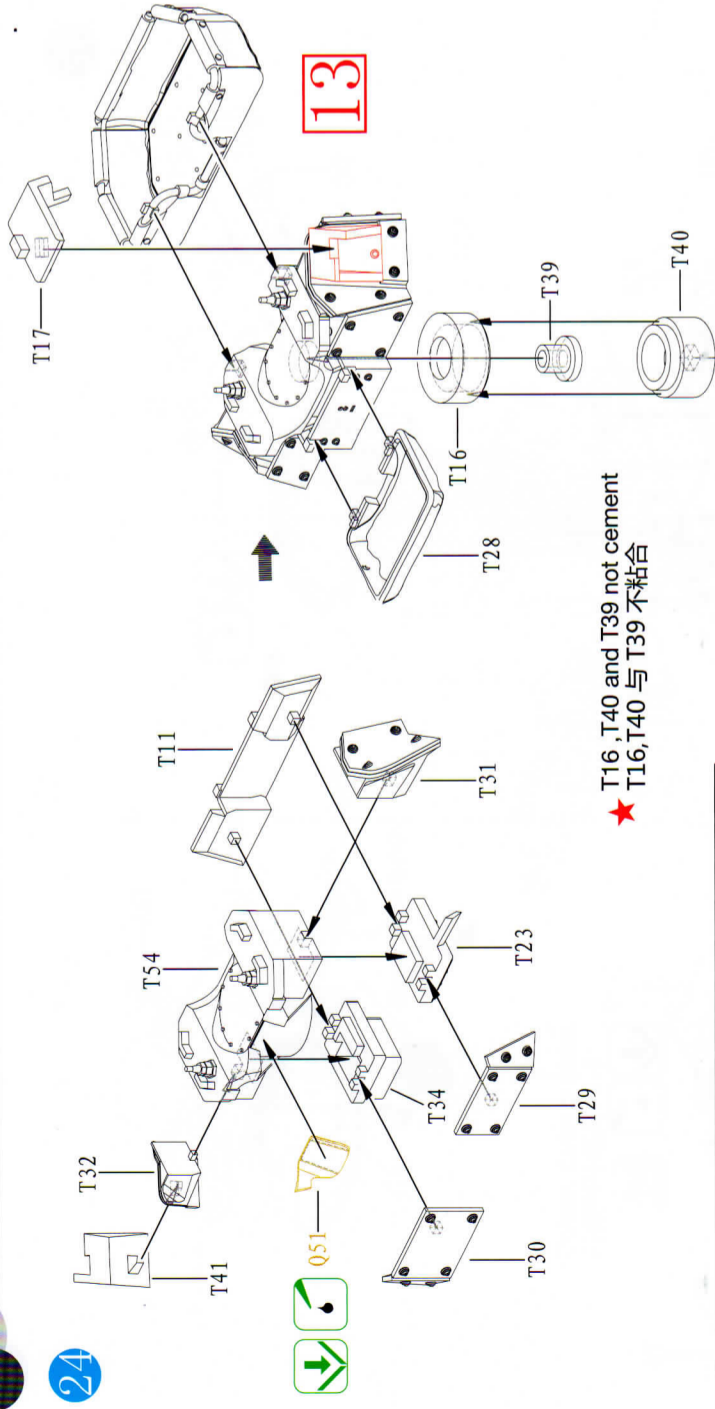

25

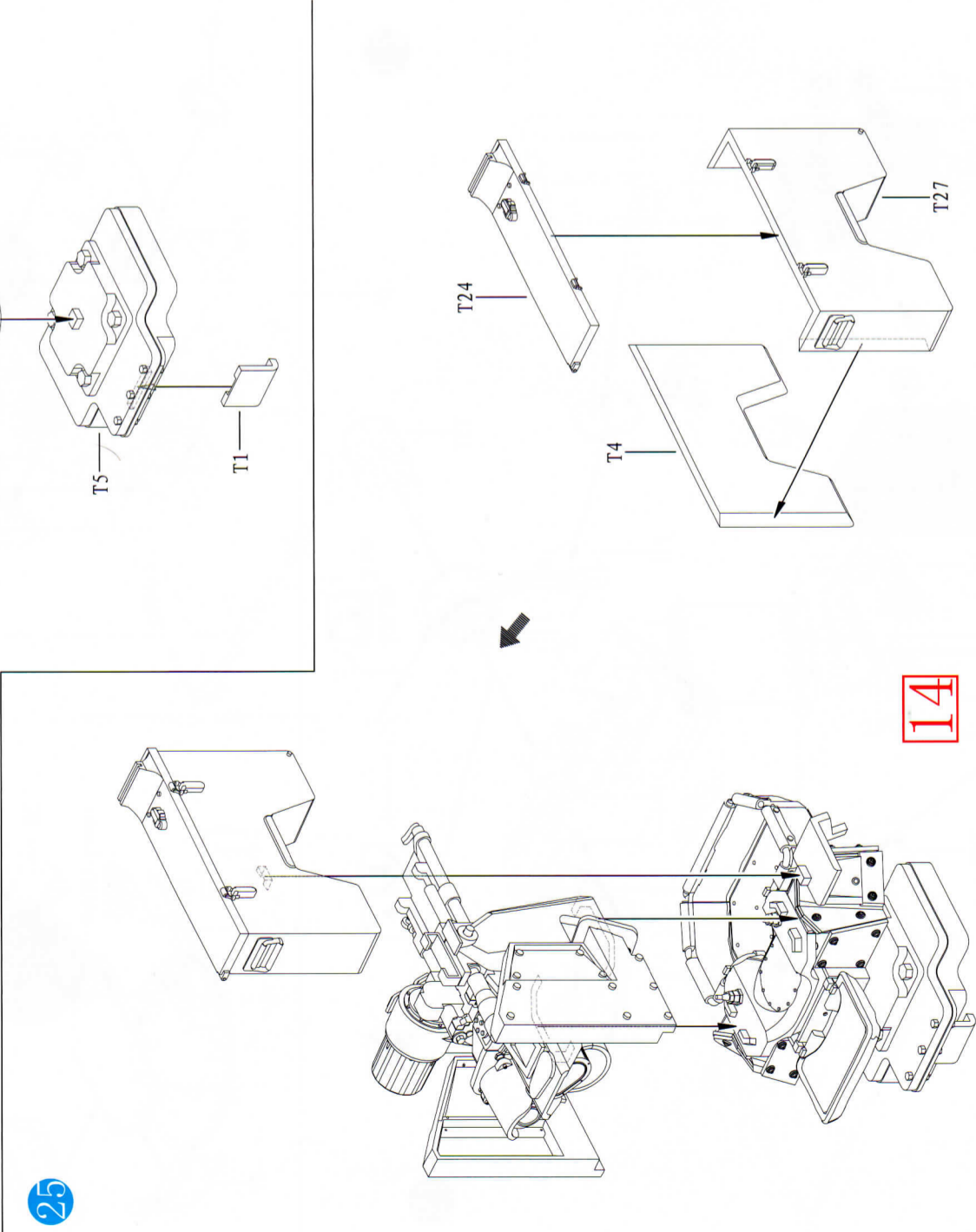

26

★ Caution: Make the antenna from the plastic frame channel with the heat of fire.  
注意: 制作天线用流道加热拉丝。

12

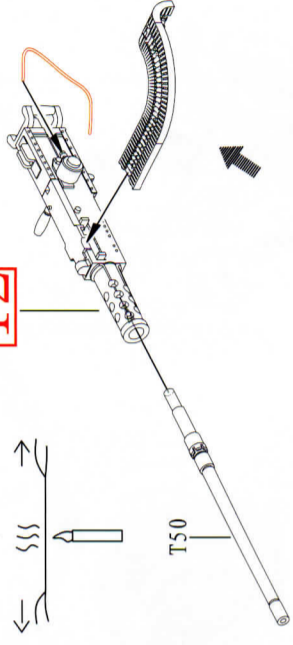

★ Caution: Make the correct shape with the fire heat.  
注意: 加热制作弯曲。

11

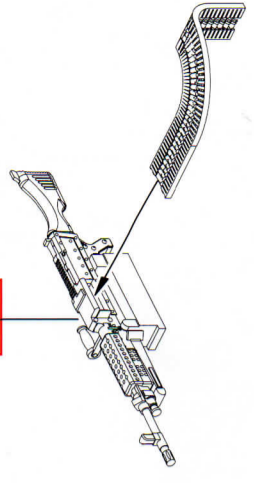

★ Caution: Make the correct shape with the fire heat.  
注意: 加热制作弯曲。

27

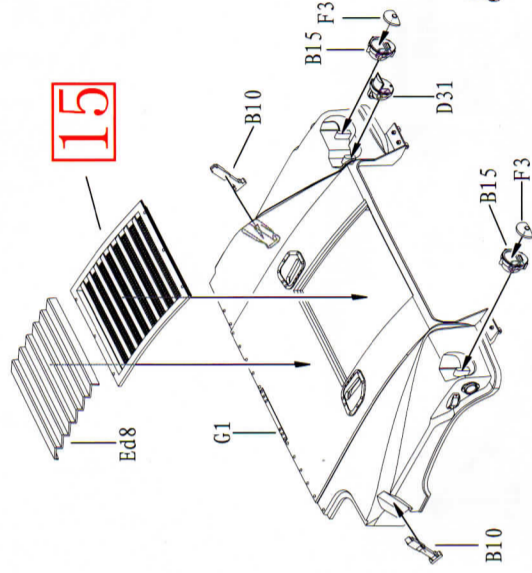

15

14



Q14

15

D42



28

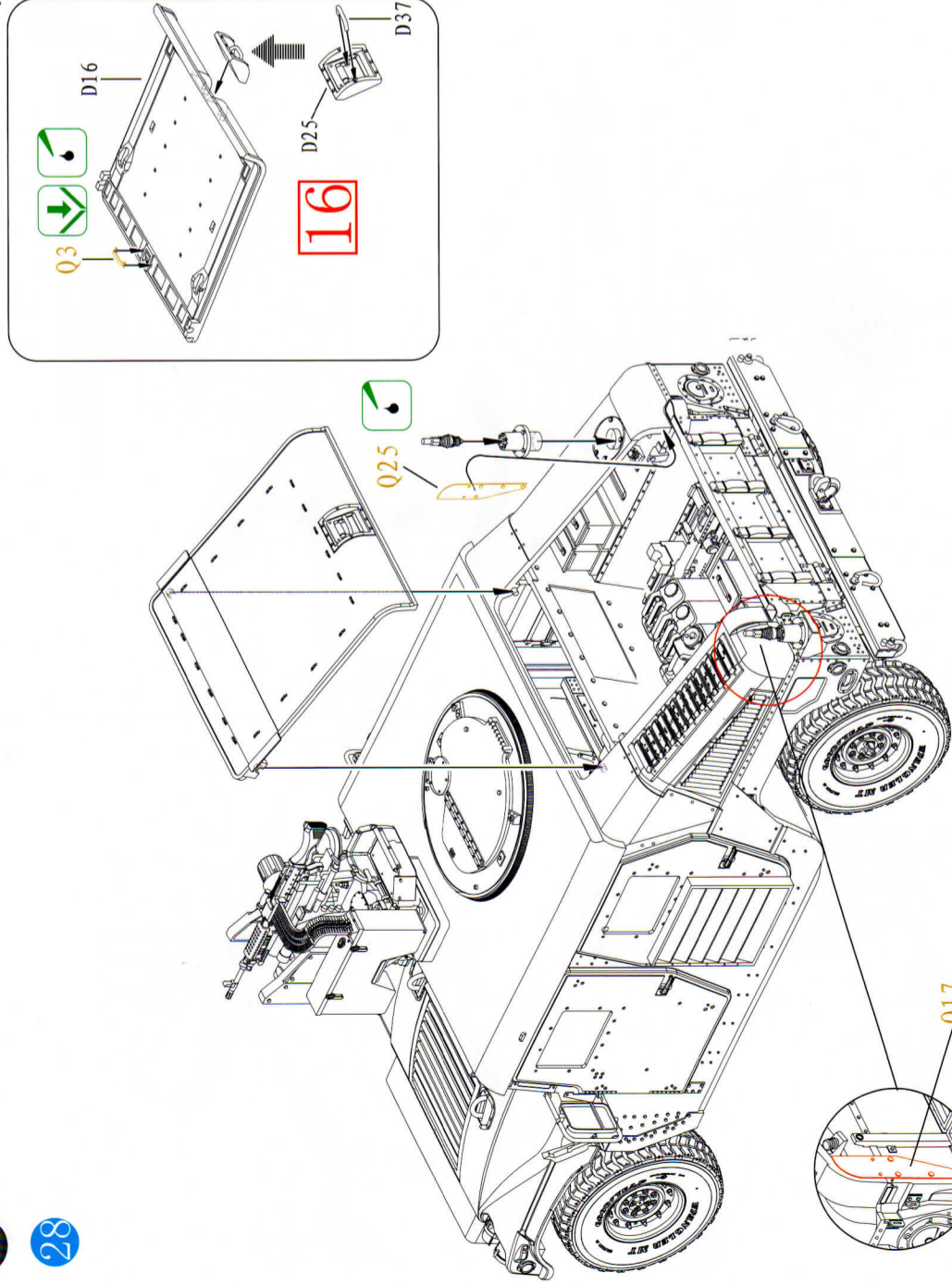

30

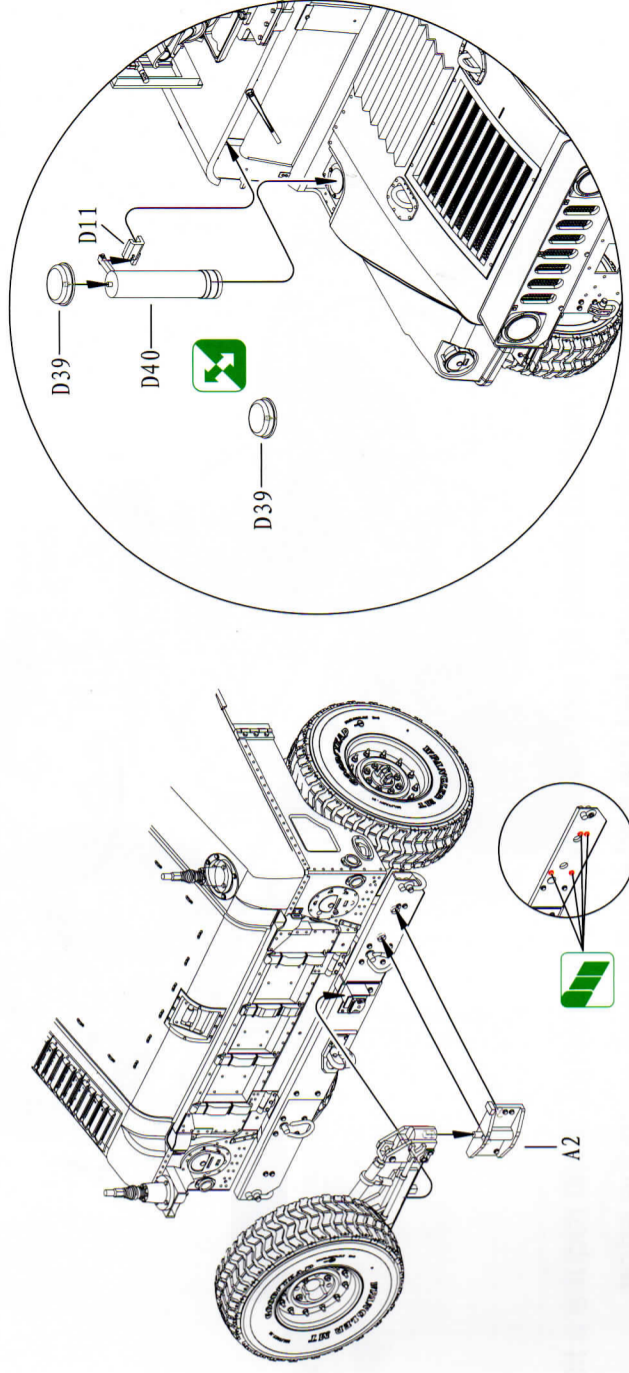

31

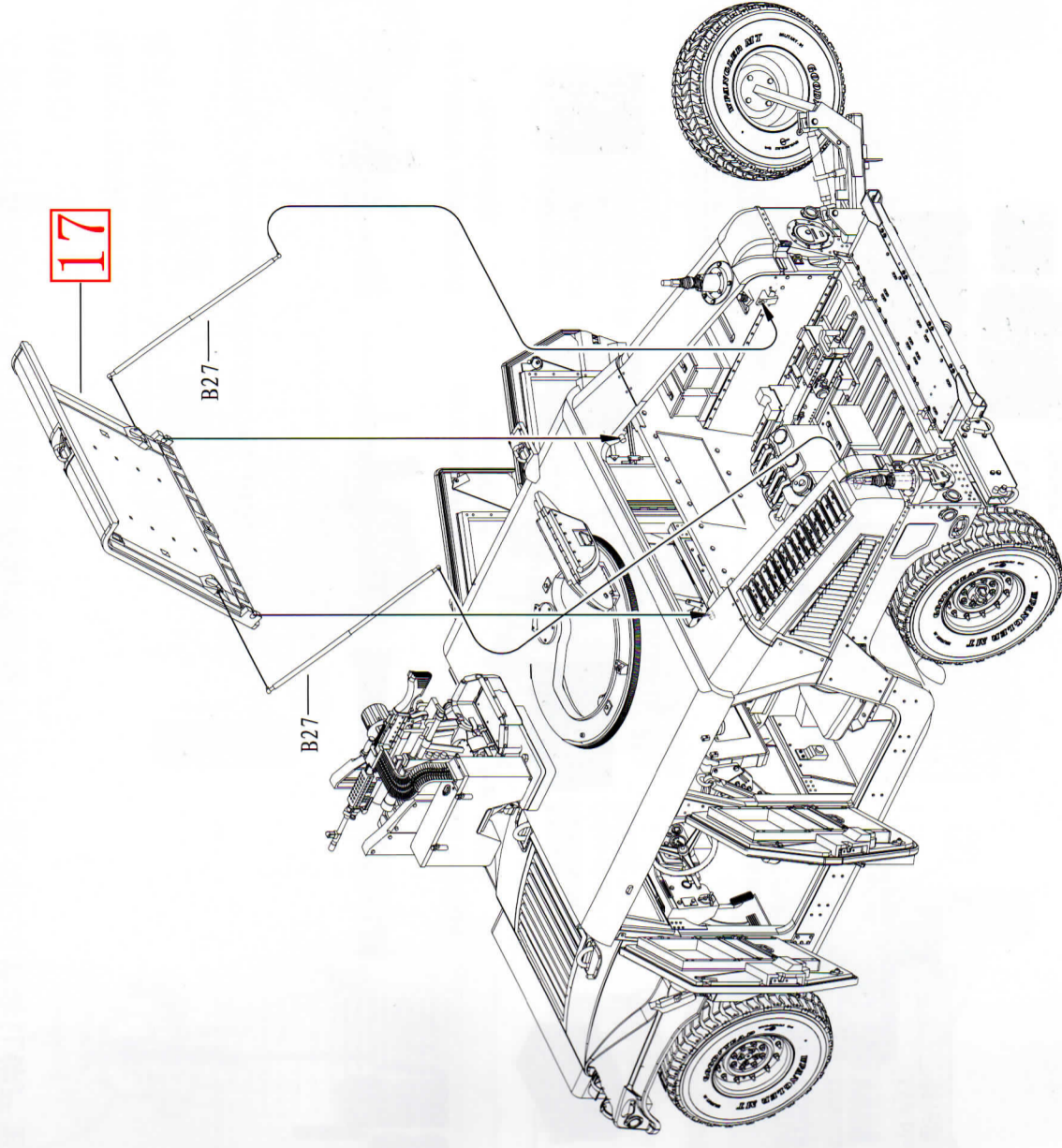

29

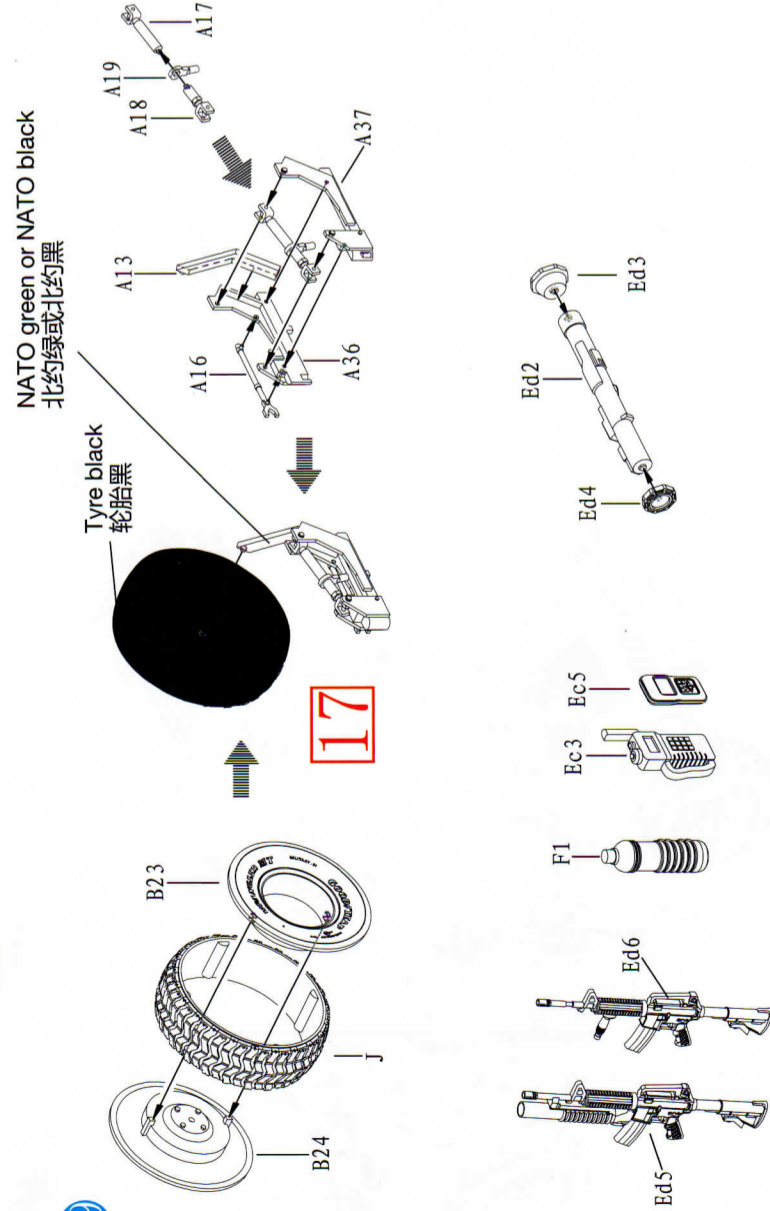



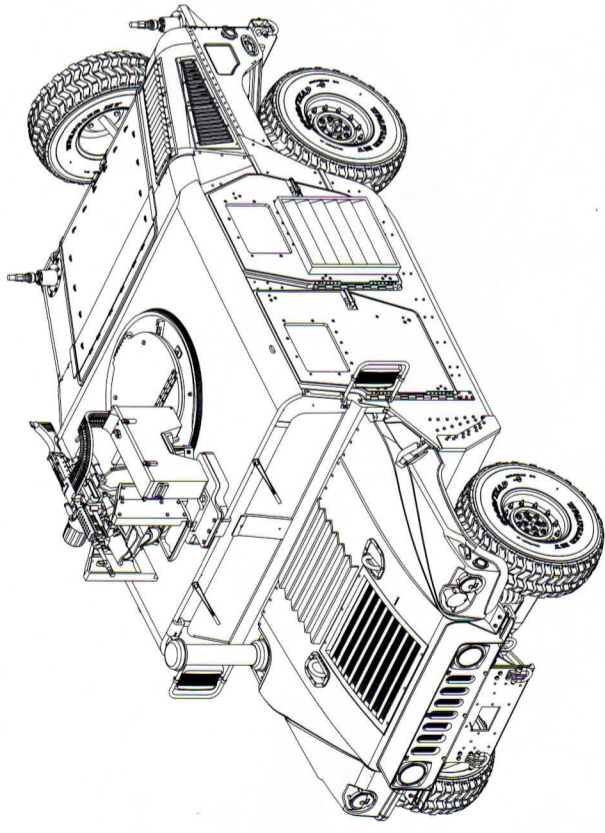

★ This is a precision molded plastic kit with exceptionally fine detail. It will require a little more care during assembly, but you feel the end result is well worth the effort.  
本套件设计精密,零件繁多可能让你在制作过程中有所不便,但完成后会让你产生无穷之成就感。

Happy modelling!  
祝愿制作愉快!

VEHICLE ACCESSORIES DECAL AND COLOUR

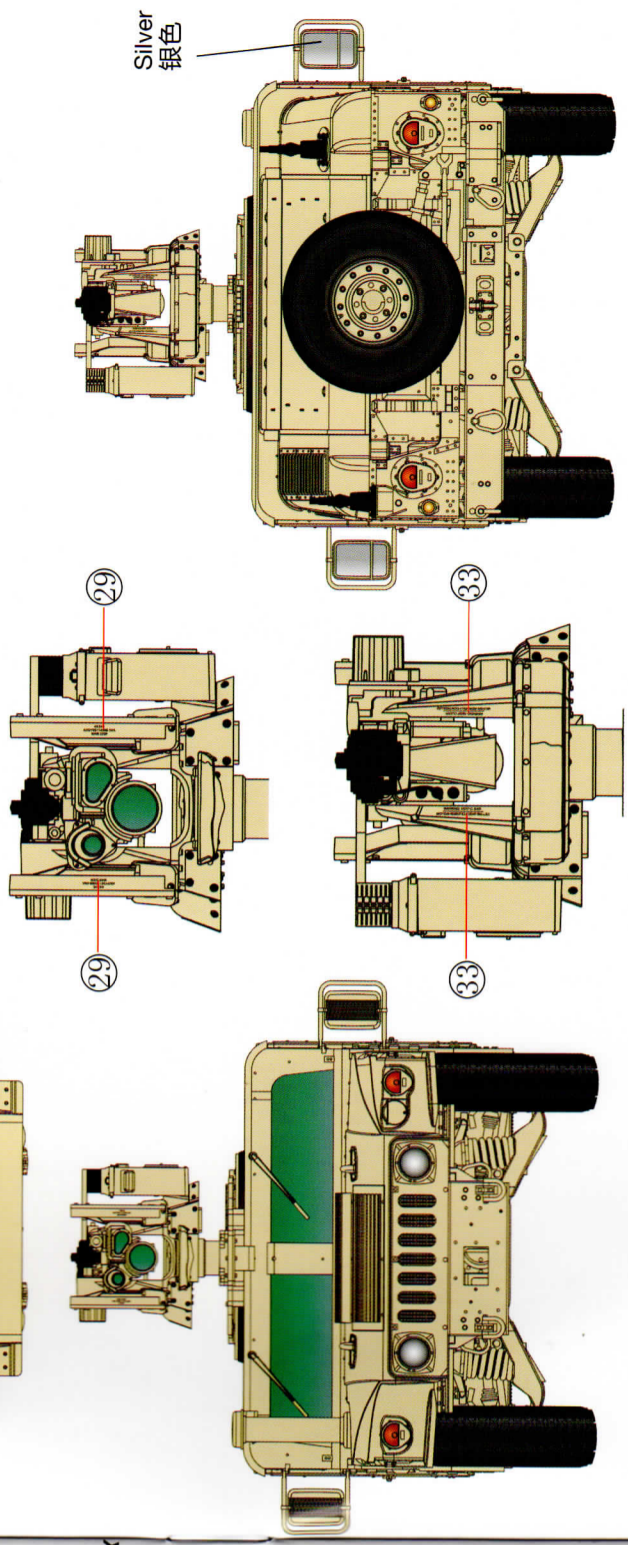
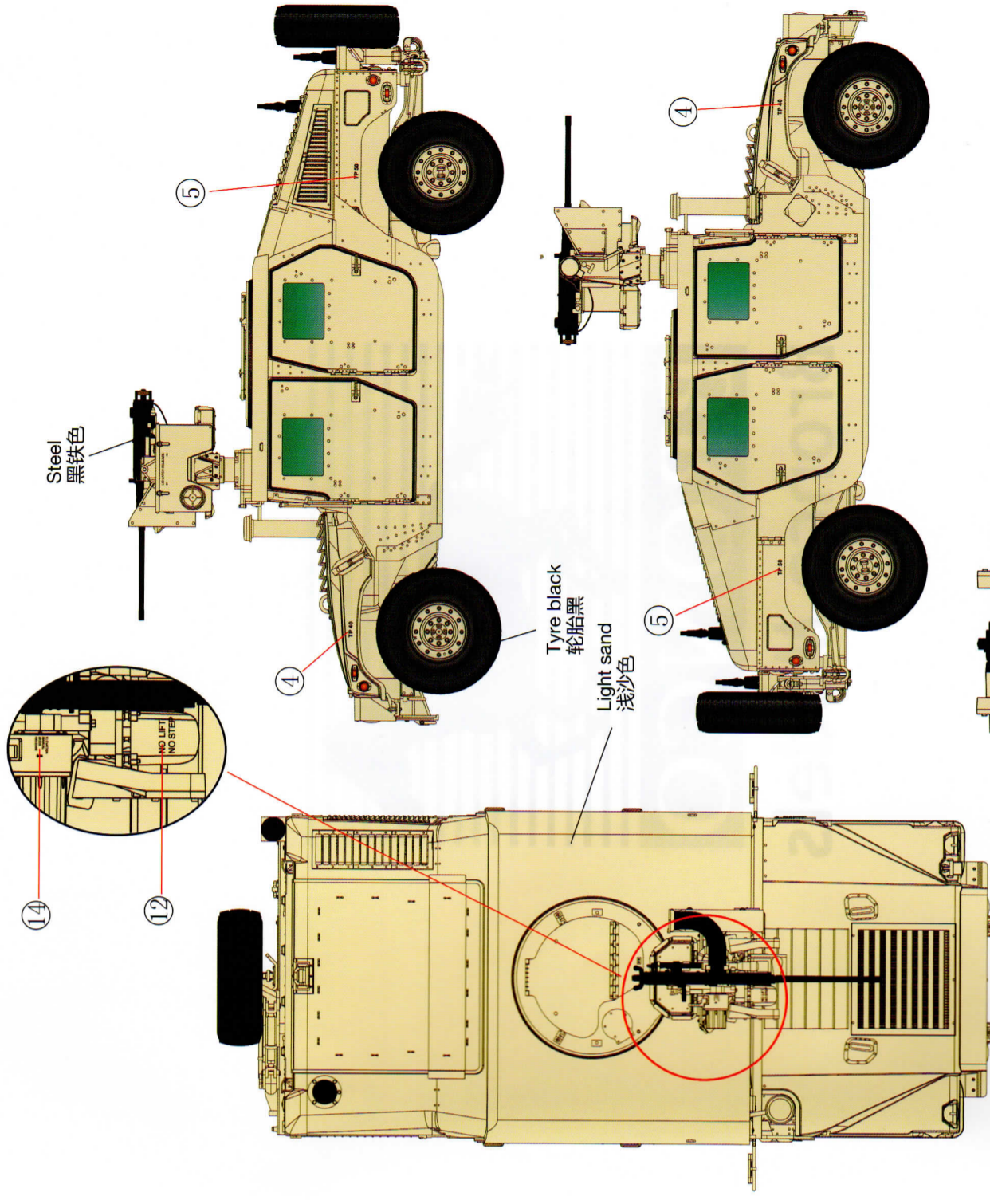



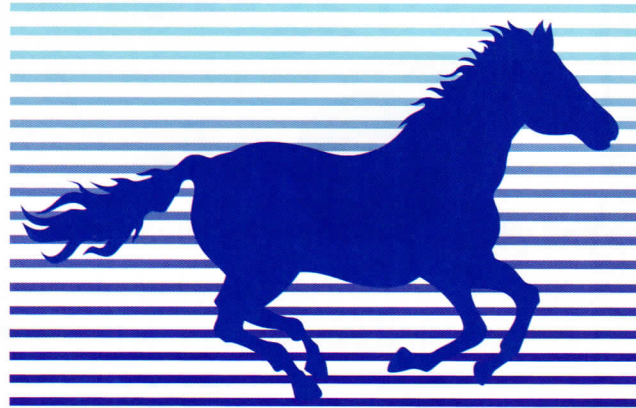
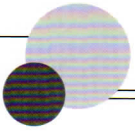

**BRONCO**

**Bronco Models**