



FALCON

Clear-Vax

1/72 SCALE CANOPY SET No.9 -LUFTWAFFE BOMBERS WORLD WAR II

USING REPLACEMENT CANOPIES

TRIMMING: Insert a new blade into your modelling knife or scalpel. To separate the canopy from its base, score very gently around the ledge moulded at the bottom. Do this very lightly at first, with minimum pressure. Repeat the process until the canopy pops away from the ledge. If you score too heavily at first you risk slipping and ruining the canopy. Finally, any rough edges can be cleaned up by lightly sanding with fine wet-and-dry paper.

GLUING: Cyanoacrylate (superglue) can be used to fix the canopy to the kit and gives a fast setting permanent joint, but fumes given off when setting can cause frosting on clear parts. Where possible, mask around the joint with masking fluid or tape. PVA (white glue) is also useful as it is partly gap filling, doesn't attack the plastic and dries clear.

PAINING: The best way to achieve crisp and convincing frame lines is by applying pre-painted strips of decal film. Paint part of a sheet of clear decal film, then cut strips of the correct width with a sharp blade and a straight-edge. Decal film sticks better to a painted surface than to bare plastic, so you will have to paint an undercoat on frame lines marked on the canopy.

WHICH KIT? Please note that where we suggest a certain kitset as suitable for our replacement canopy, the suggested kit is generally regarded as the most accurate model to the given scale. We can not guarantee that our canopy will fit other kits of the same subject.

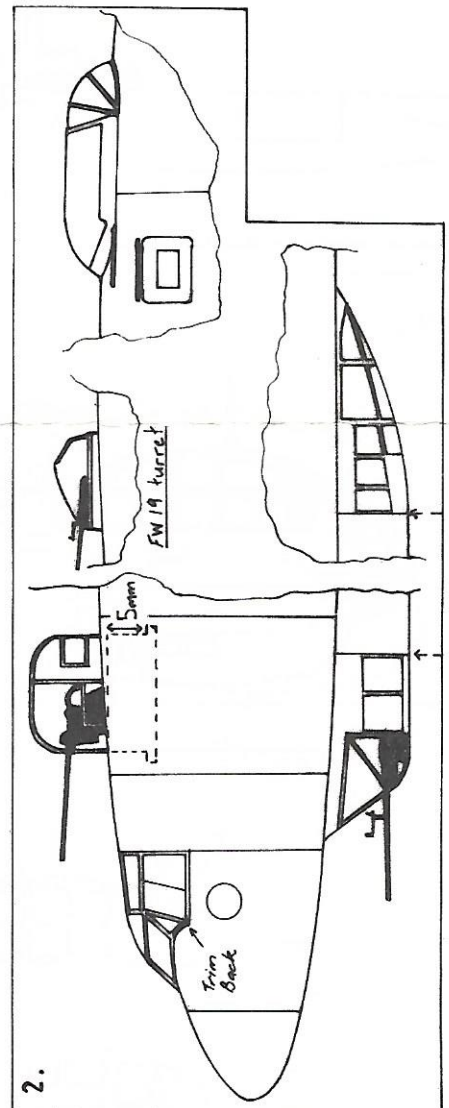
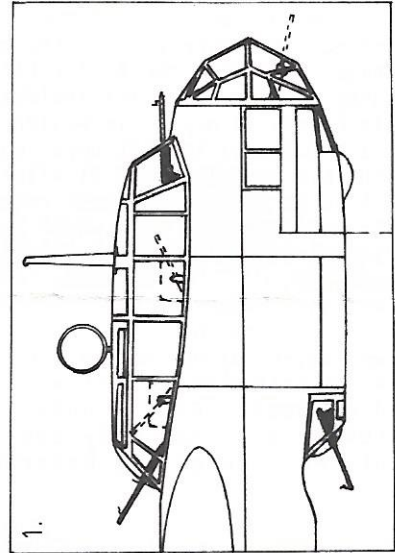

1. **Dornier Do17Z:** Suggested Kit: Frog/Revell Do 17Z. Note that the side nose transparency has been moulded with part of the lower solid area included. It may prove easier to fit this part in its entirety rather than cut out the individual windows. Early Do 17Z aircraft only had three defensive MGs as shown solid. Many were upgunned with MGs in the side windows and nose as shown dotted. Suggested References: Scale Models Aircraft of the Battle of Britain (useful Do17Z cutaway). Profile 164. Warplanes of the Third Reich William Green (McDonald) Air Enthusiast 30 (Do17E/F)
2. **Focke Wulf FW200 Condor:** Suggested Kit: Revell FW200C-4. Alternative HDL 151 and FW19 dorsal turrets are provided. To fit the HDL 151 turret cut the top off kit part No. 6 as shown and replace with the clear-vax top. When fitting the main pilots canopy trim back the shaded area on the port fuselage half as shown. Cut the front and rear areas from the kit gondola (part 41) and fit the clear-vax items in place. We suggest replacing the kit gun barrels which are far too thick. The rear dorsal canopy has been widened for greater accuracy. Suggested References: Profile 99
3. **Heinkel He177:** Suggested Kit: Airfix He 177A-5. Notice how the upper cabin windows have been altered to a flatter section and that the bombsight window has been repositioned lower down. To fit the upper cabin windows cut off the lugs moulded onto the fuselage and replace with the entire clear-vax upper section. The kit dorsal turret is underwidth as is its mounting which will need to be opened to 12.5mm diameter to fit the clear-vax replacement turret. The turret drawing illustrates how the clear gun slot was folded down to meet the gun shield. Carefully cut this area and bend the plastic slot down as on the drawing. The rear turret drawing shows the gunners escape hatch open. Suggested References: Profile 234, Air International Apr 1975

4. Do 17E/F: Suggested Kit: Airfix Do17E/F. Only the main production canopy with MG position has been provided. It is applicable to both versions. Remove the moulded bulge aft of this canopy and the hump over the rear wing/fuselage joint (shown dotted)

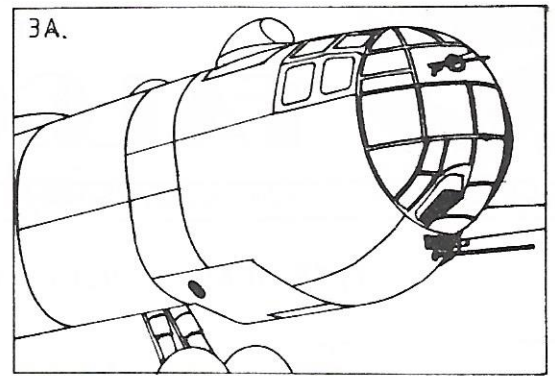

5. Junkers 88A-1: Suggested Kits: Italaerei Ju188, Airfix Ju88A, Revell Ju 88A-4. If using the Italaerei Ju188 (Fig 5A) the fin and rudder, tailplanes, wingtips and engine nacelles will need alteration. Using the drawing as a guide cut away the kit nose at the lines arrowed. The dotted lines indicate the kit outline. Small triangles of plastic (shown shaded) will need to be added and then sanded round in order to fit the nose transparency. The Bola underside MG position is of the later type, the early mounting is supplied separately. In order to minimise overthinning of the plastic only half of the small nose windows marked x are moulded. We suggest cutting out and fitting correct size windows from the backing sheet to accurately portray these. If using the Airfix kit (Fig 5B) the wingtips will need shortening. The dotted line indicates the kit outline. When fitting the main canopy it may prove easier to cut the rear part at the line marked z. Cut away the kit upper nose decking shown shaded. Replace the kit gondola (part 9) after trimming back the kit fuselage to the line marked y. The best reference for the Ju88A series is Aerodate International No 9 which has detailed 1/72 scale plans. Squadron/Signal in Action No85 is also very useful.

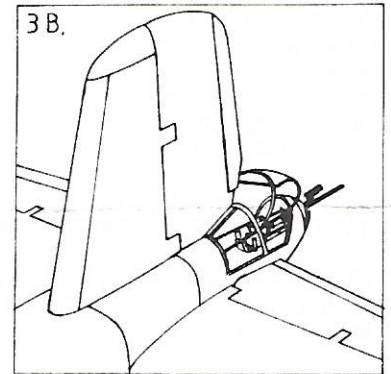

6. Arado Ar234B: Suggested Kit: Frog/Revell Ar234B/C. Although the clear-vax parts may be cut out to fit the solid plastic kit parts 8 and 9 we suggest using the clear-vax parts in their entirety. Considerable interior detail will need to be added whichever method is used. Please note that all the cockpit framing is internal and that only the rivet heads are visible on the outside. Suggested Reference: Monogram Close-up No23

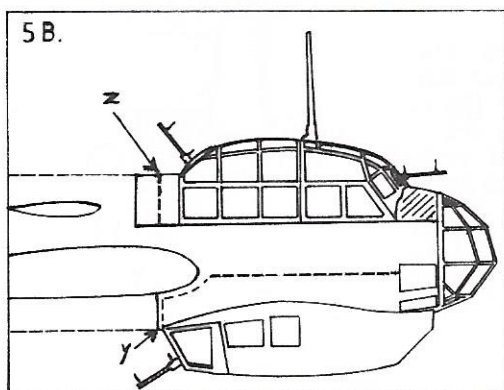
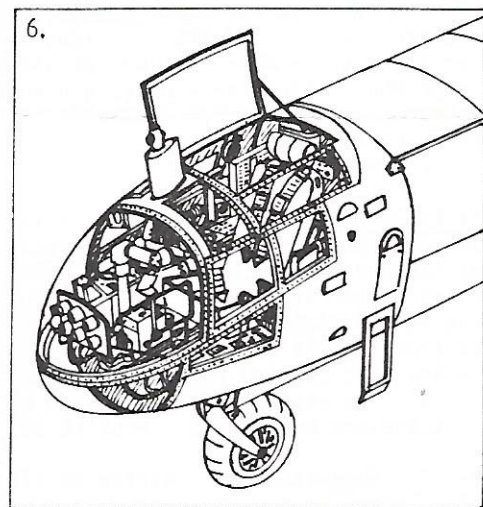
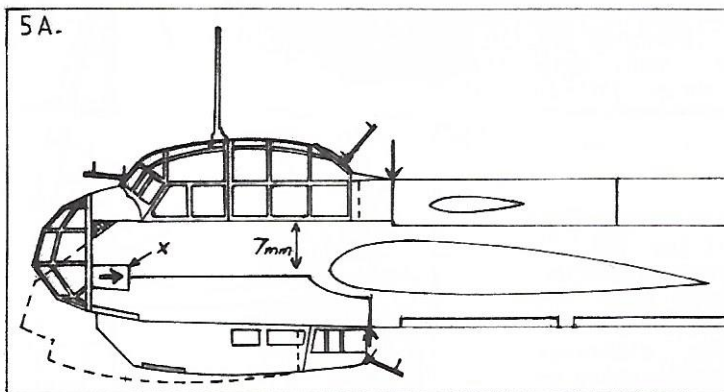
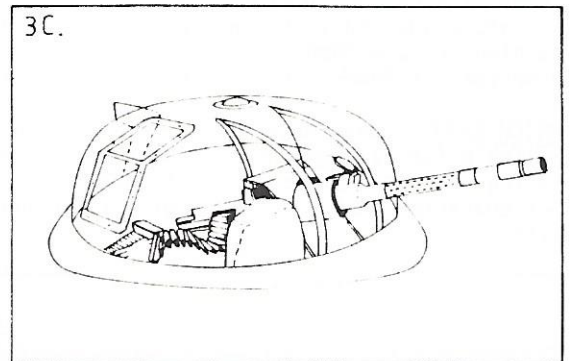
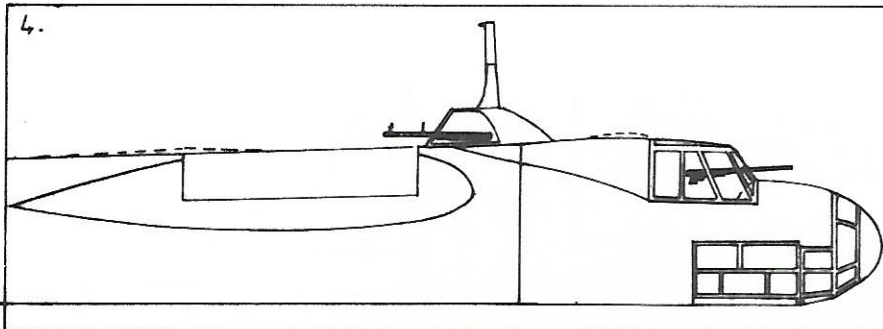

Produced by
FALCON INDUSTRIES
 P.O. BOX 42-093
 WELLINGTON
 NEW ZEALAND

Falcon Industries is an
 associate member of
 I.P.M.S. New Zealand