

MARTLET MK VI

Plastic model

scale :1/72

The first production FM-2 left the Easter Aircraft production in the middle of 1943. The FM-2 had a more powerful Wright R-1820 radial engine. Additionally, the plane could carry four rather than six .50 caliber machine guns and was often fitted with HVARs. The FM-2 also had a larger tail than standard F4F to counter the increased torque produced by the Wright engine. The General Motors FM-2 was the most numerous Wildcat variant produced. From mid-1943 to the end of the war, General Motors built 4,127 FM-2s nearly 70% of all Wildcats produced. Of those, 340 planes went to the RAF as Martlet VI. The U.S. Navy FM-2s operate exclusively from escort carriers (CVEs).

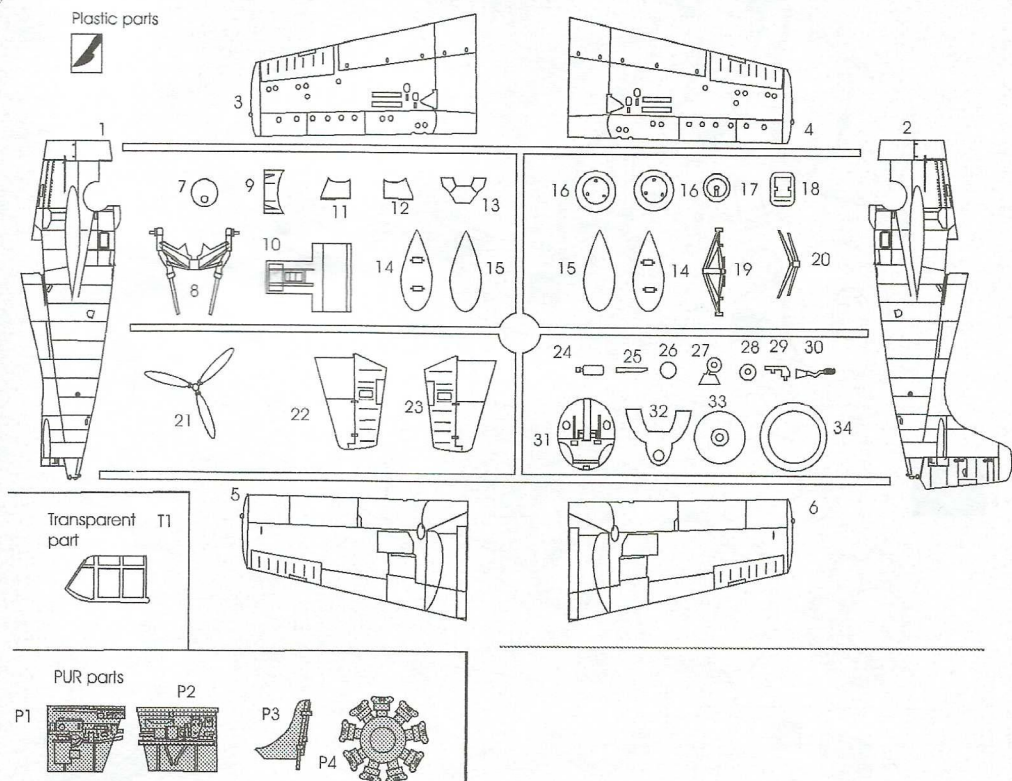

OPTIONAL
VOLBA



BEND
OHNOUT



OPEN HOLE
VYVRTAT OTVOR



SYMMETRICAL ASSEMBLY
SYMETRICKÁ MONTÁŽ



A NOTH
ŽÁŘEZ



REMOVE
ODŘÍZNOUT

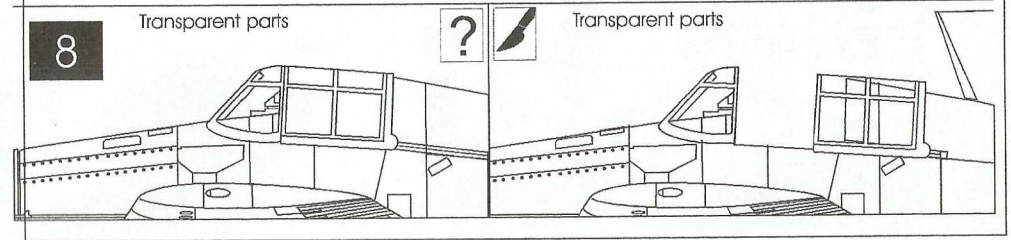
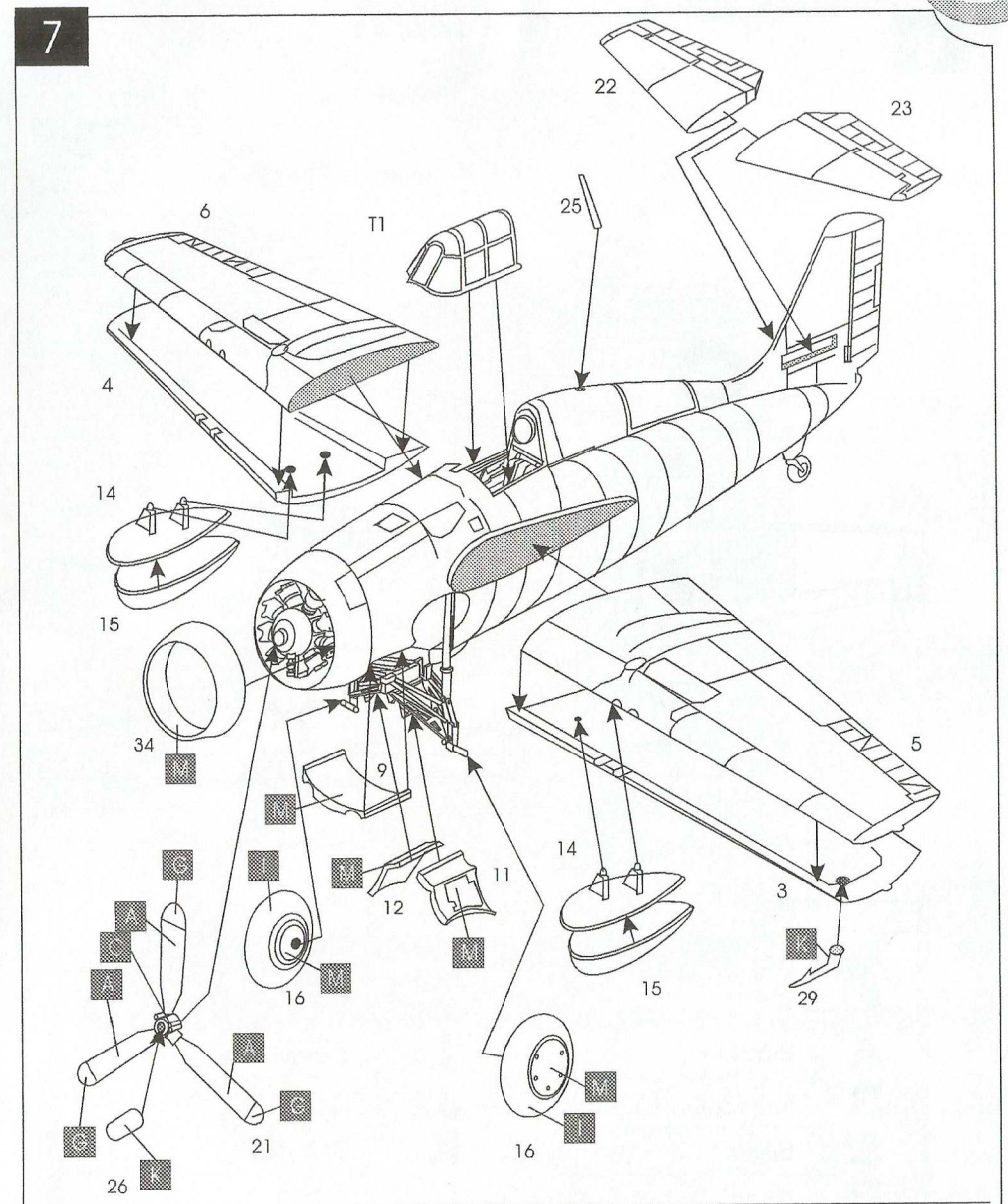
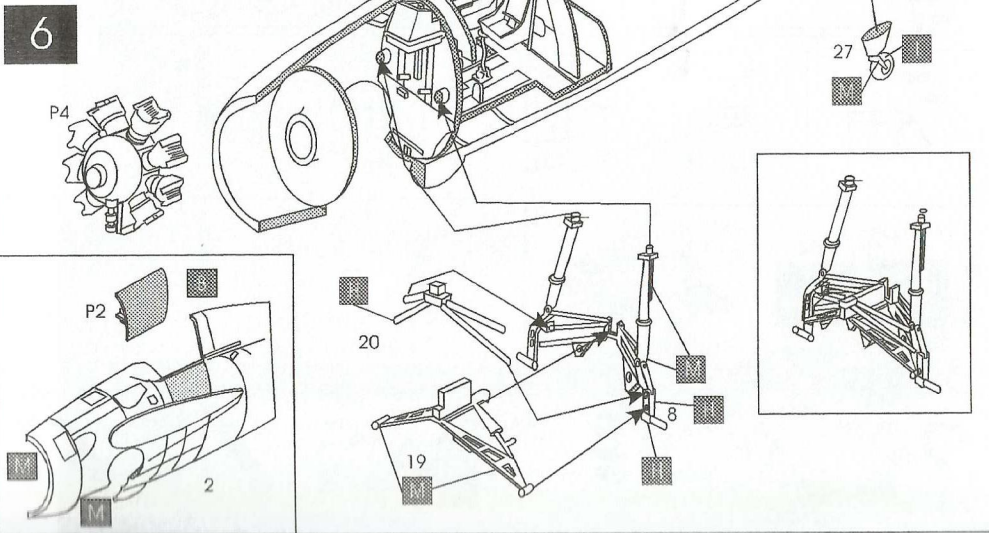
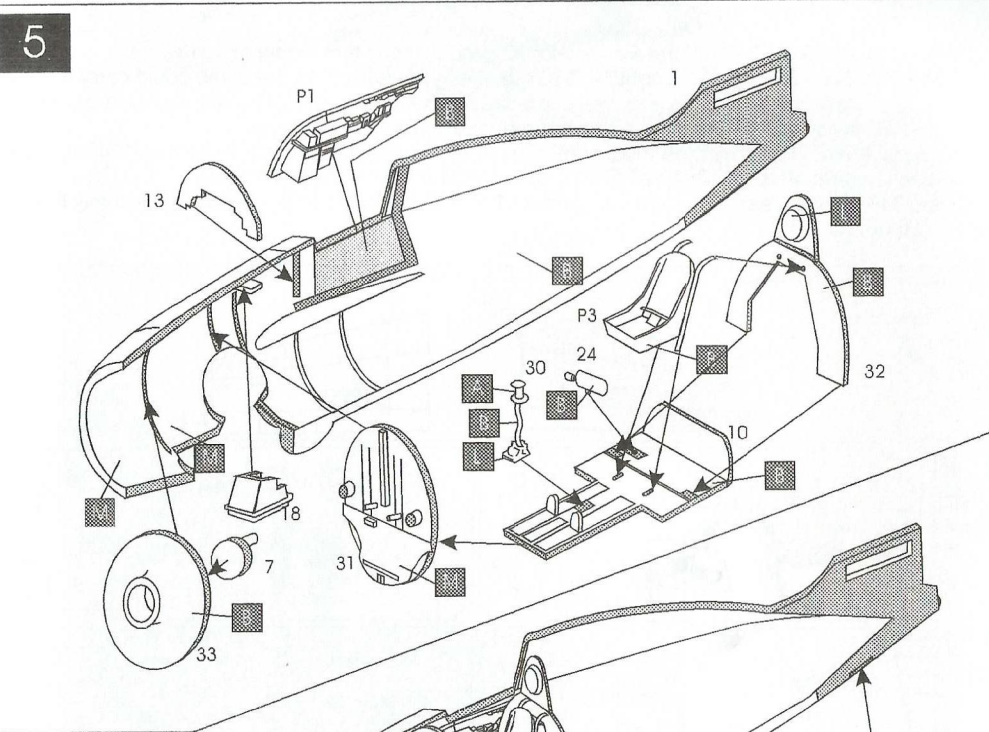
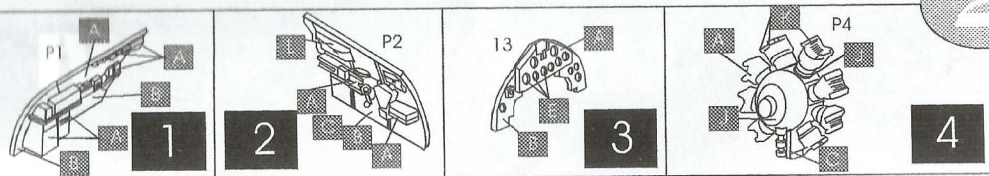

9

Martlet Mk VI

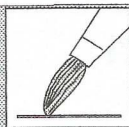
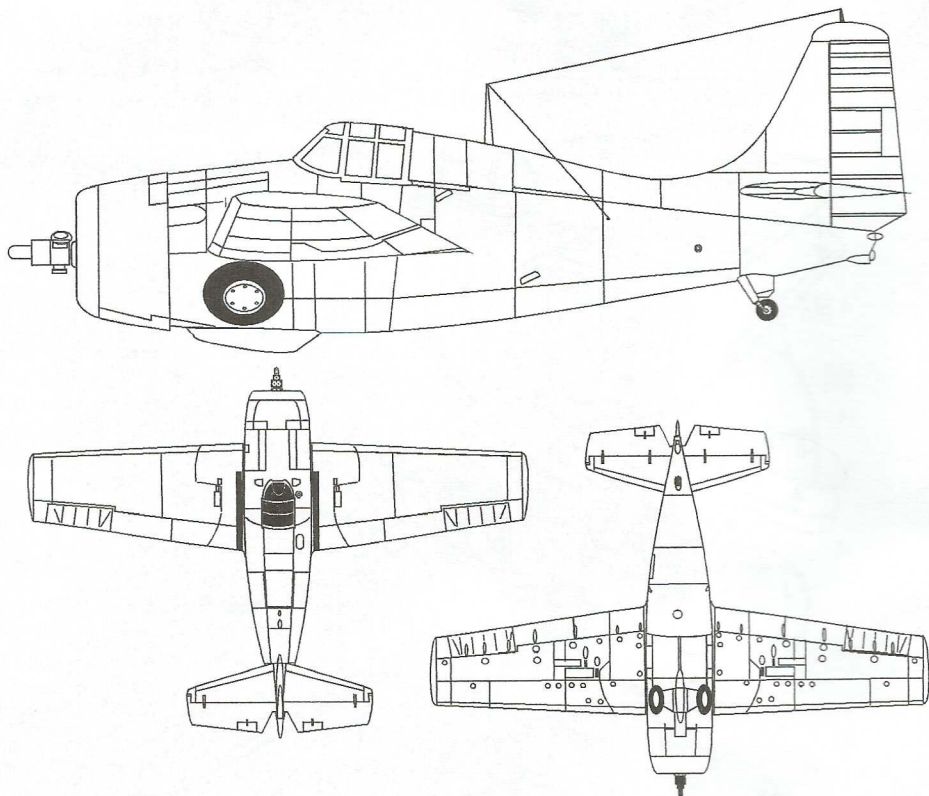
A
B
C
D
E
F
G
H

Black
 Interior Green
 Silver
 Linen
 Light Grey
 Red
 Yellow
 Blue

I
J
K
L
M
N
O
P

Tyres Black
 Grey
 Chrome
 Brown
 White