

**ACADEMY**  
아카데미  
**MINICRAFT**

## PANZER IV H4

1/35 Scale

One of the most important tanks used by Germany in World War II was the Panzerkampfwagen IV, (Also known as PzKpf IV, or Panzer IV.) The Panzer IV was proposed as the heavy support tank for the fourth company of the tank battalion. The first three battalions were equipped with the Panzer III. The new machine was actually classified as a medium tank, weighing in at about 17.5 tons.

The Panzer IV was originally developed in 1936, a design so sound and well conceived, it ultimately became the main tank of the German Panzer force. It remained in production until the end of the war, with some 8,500 units of various models delivered.

The Panzer IV was based on the Panzer III format, which consisted of an angular hull with a box-like turret. The Panzer IV's tracks rolled on eight road wheels and had four upper return rollers. This was a distinctive feature and led to quick recognition of the Panzer IV series. The power from a huge V-

12 Maybach engine was delivered to the wheels via a five-speed gearbox, later upgraded to six speeds. The engine was located in the rear of the hull with the drive shaft going to the forward wheels. During the tanks development, Germany's plans included the invasion of England, so a snorkel device was provided to allow for underwater missions.

The first production models were not well received by the troops, who complained about poor performance and inadequate armor protection. These conditions were corrected in the second, or Ausführung B version which was fitted with a more powerful 300 hp Maybach HL 120 TR engine, thicker armor and minor improvements.

The effectiveness and versatility of the Panzer IV was displayed during the Polish campaign and it was soon accepted as the standard German combat tank. Initially, the Panzer IV was armed with a short-barreled 75mm

cannon, but by the Ausf F model, this was replaced by a longer barrel version of the gun. This was due in part to the fact that the shorter gun was ineffective on the Russian T-34 tank unless the Soviet vehicle could be attacked from the rear.

The Panzer IV Ausf H model, depicted by this model, was introduced in April, of 1943. It carried a thicker armor (3.1 Inches), and a new transmission. It was also equipped with an anti-aircraft gun, 3,774 examples of this machine were constructed by July of 1944.

The Panzer IV series had a top speed of 25 mph with a range of about 125 miles. It was operated by a crew of five.

During some operations heavy panels of armor were bolted to the sides of the Panzer IV to protect the turret and driving gear from Allied armor-piercing shells. A set of these unique protective panels is provided with this Minicraft kit of this significant example of military weaponry.

Refer to box top for additional decal and painting information.

Copyright 1987 Minicraft Models, Inc.



Cement Parts  
Coller  
Kleben  
Pegar  
Incollare  
Colar  
Kleven



DO NOT cement  
Ne pas coller  
Nicht kleben  
No pegar  
Non incollare  
Não colar  
Niet kleven



Cut away  
Couper  
Scheiden  
Cortar  
Tagliare  
Cortar  
Snijden



Optional parts  
Choix  
Auswahlmöglichkeit  
Eleccion  
Scelta  
Opcao  
Keuze



Repeat operation  
Répéter l'opération  
Vorgang wiederholen  
Repitir la operacion  
Ripetere  
Repitir a operacão  
Herhalen

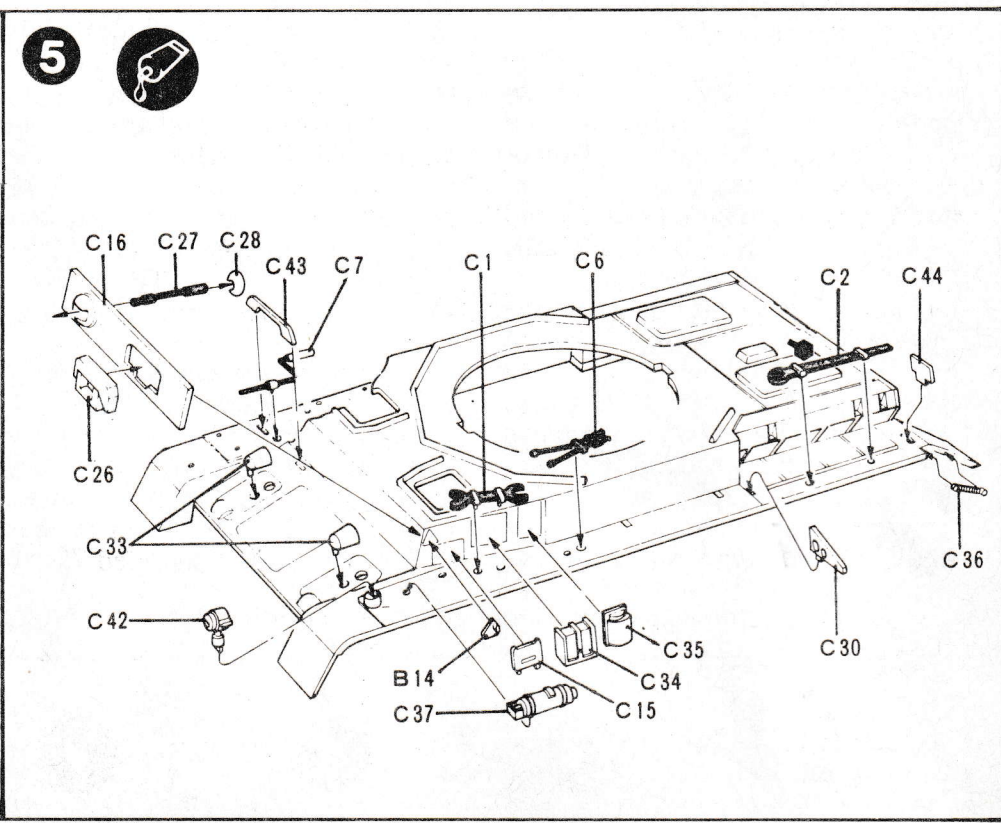
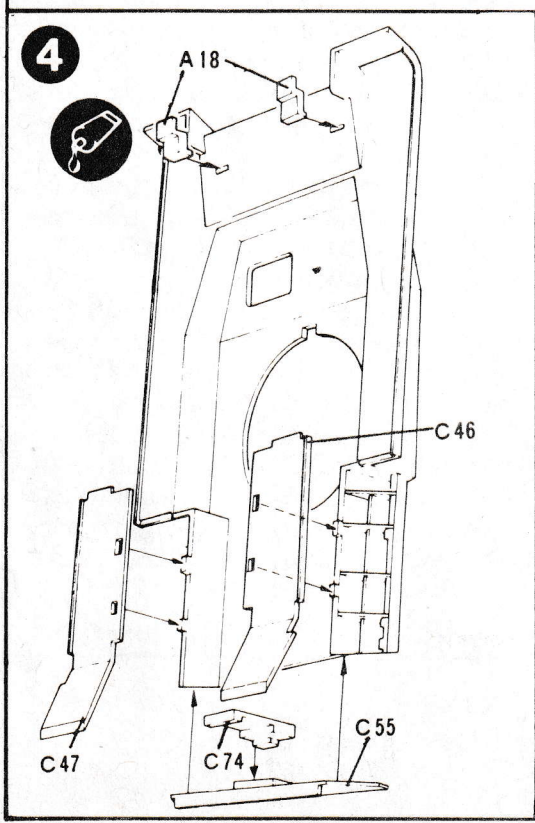
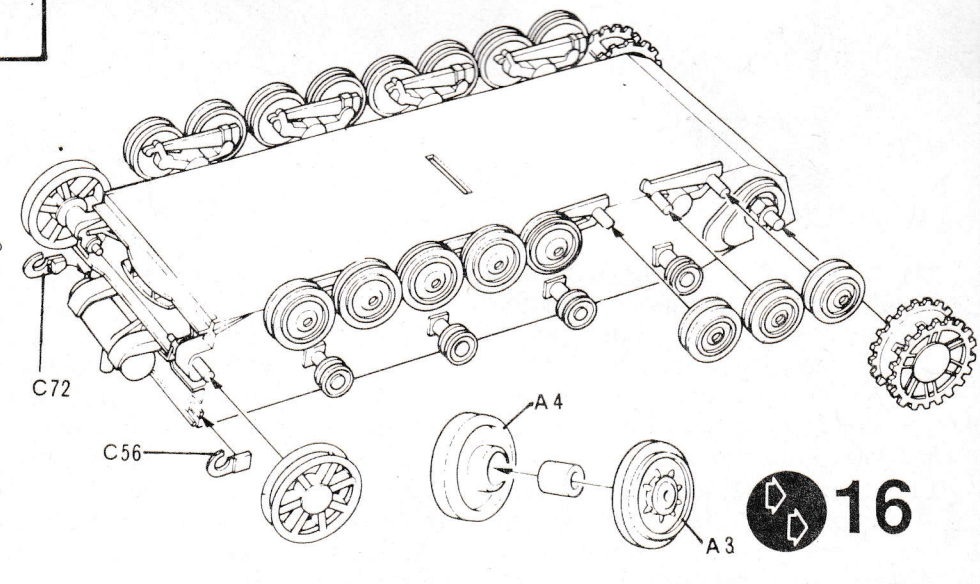
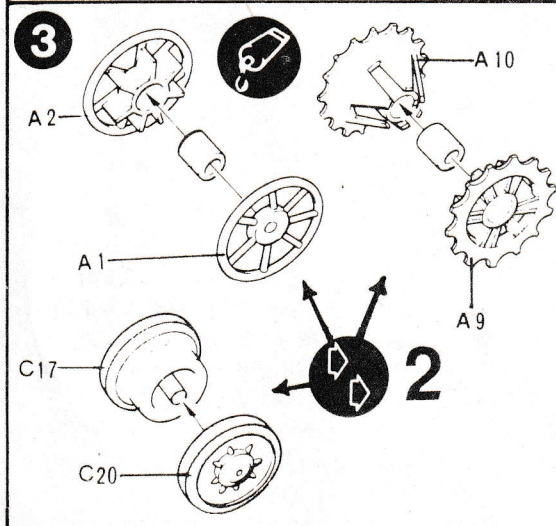
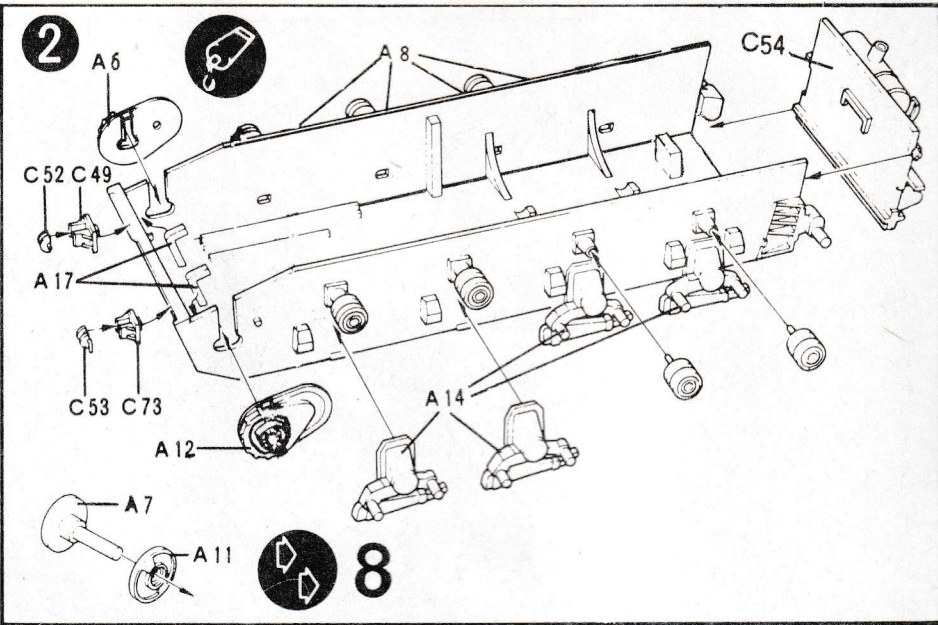
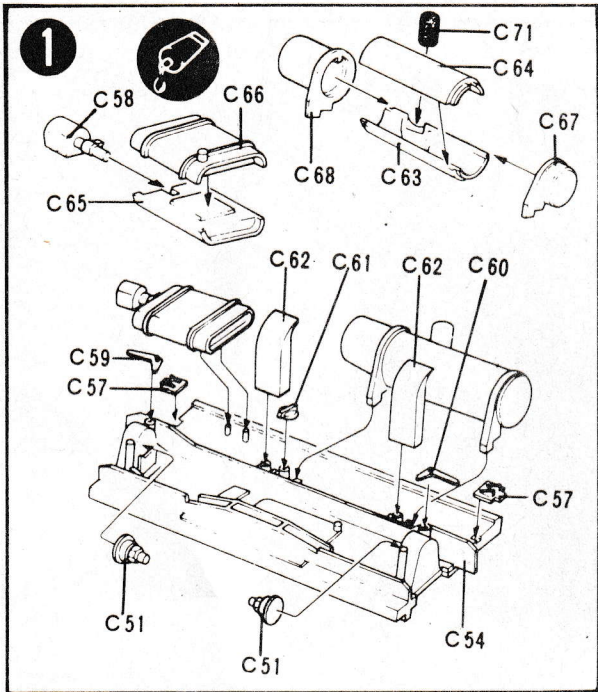

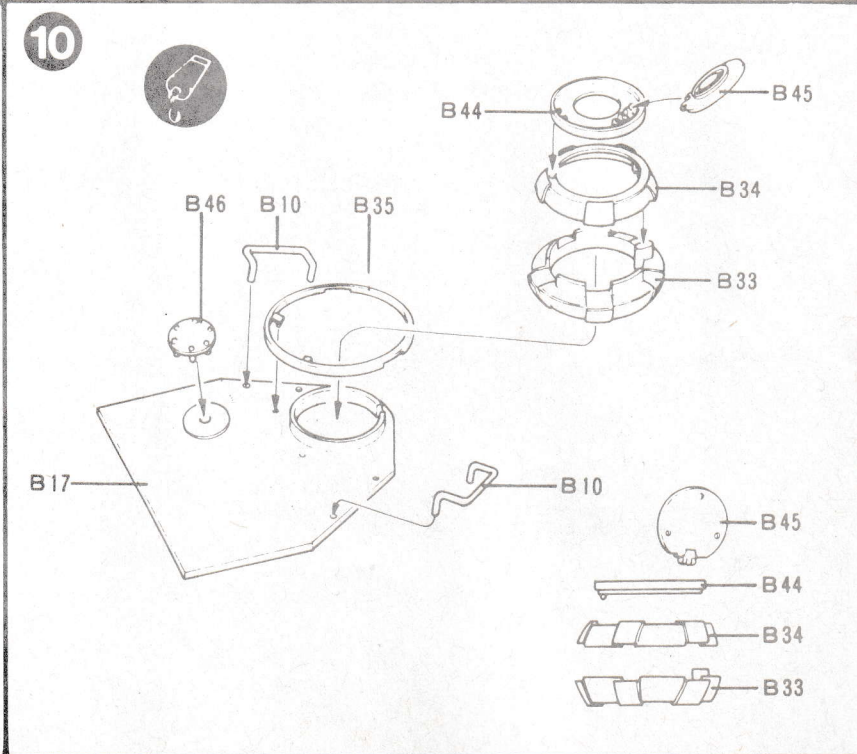
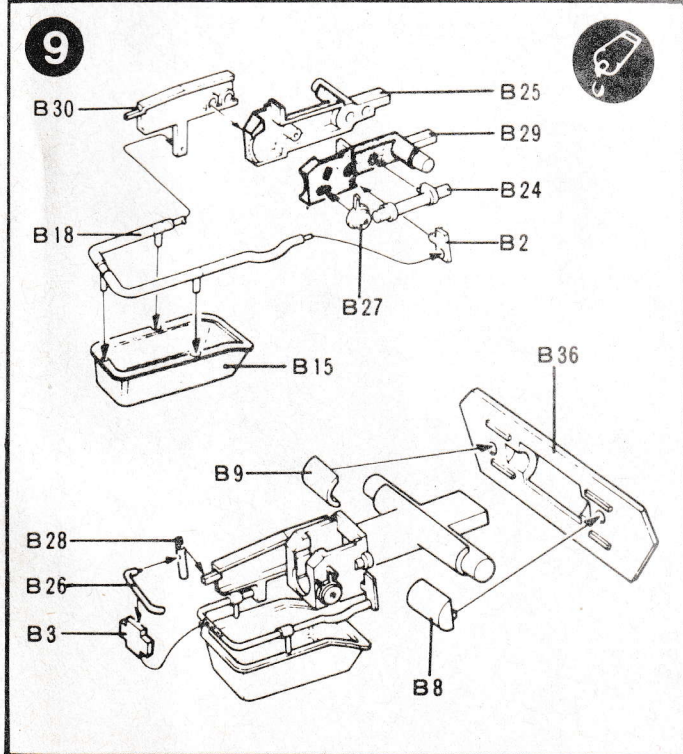
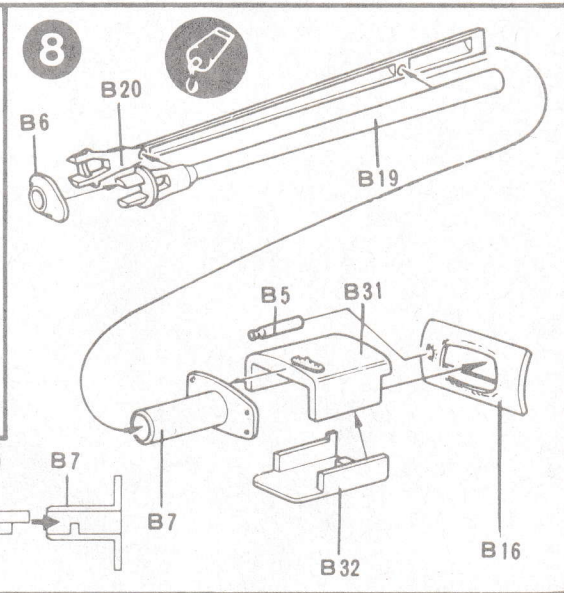
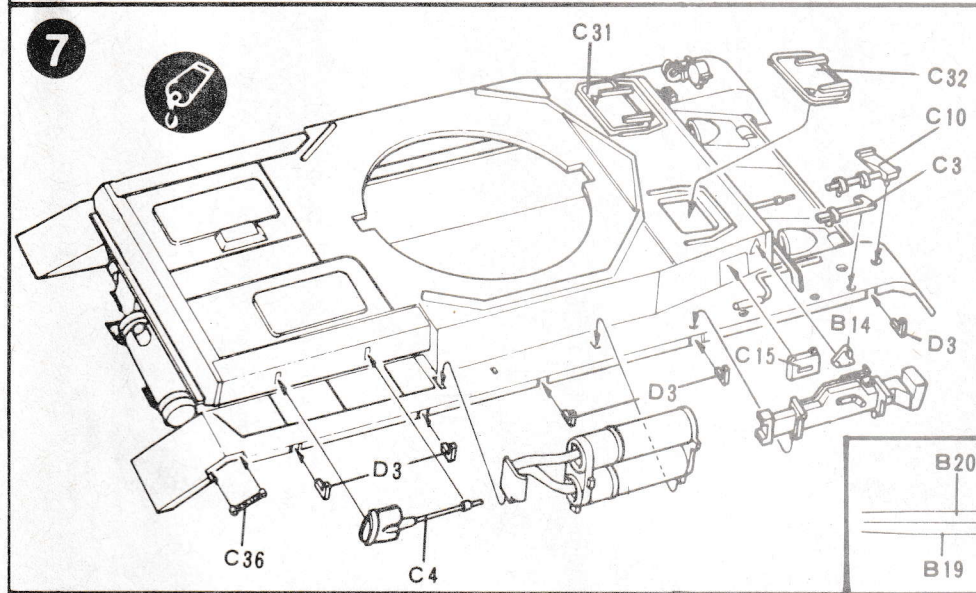
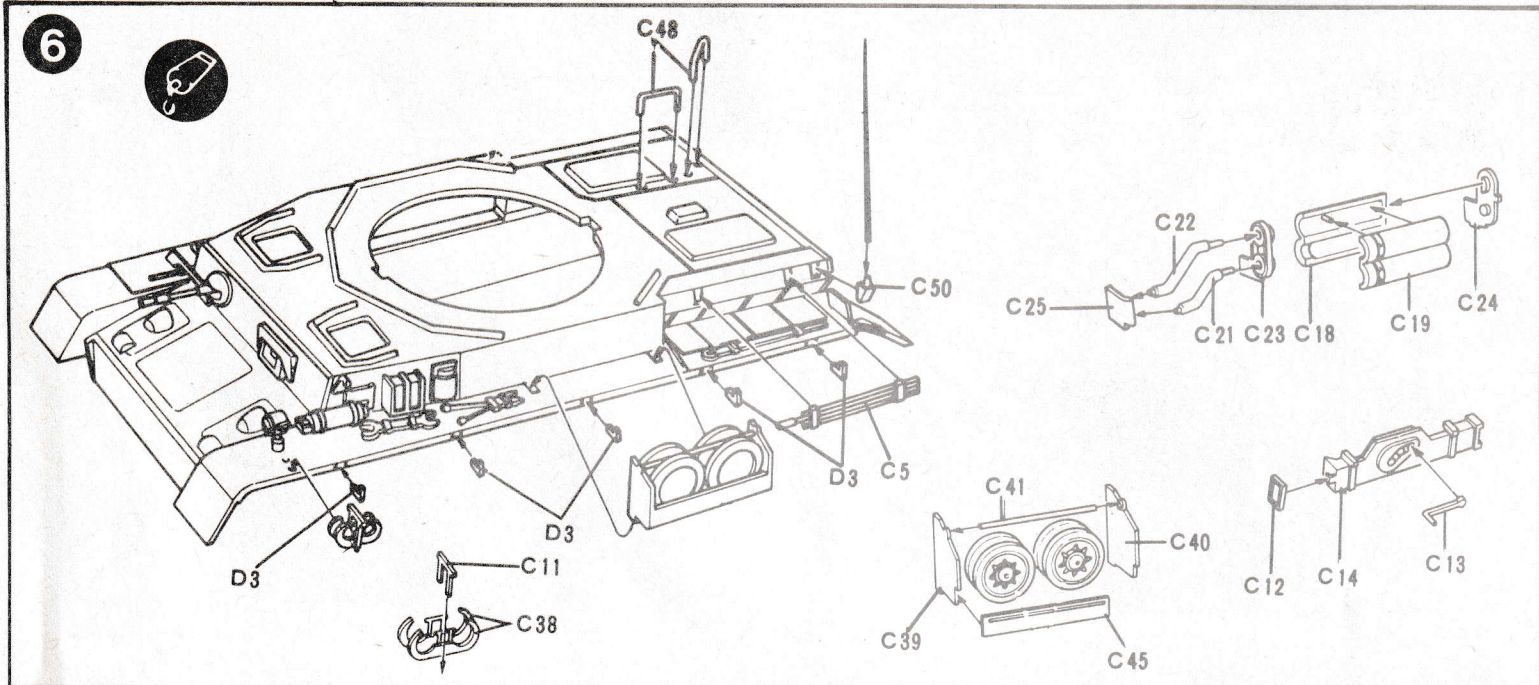

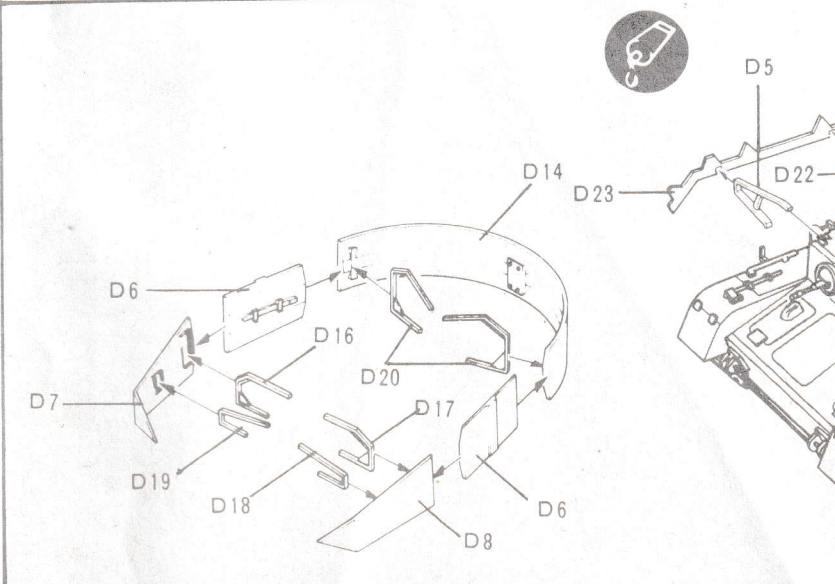
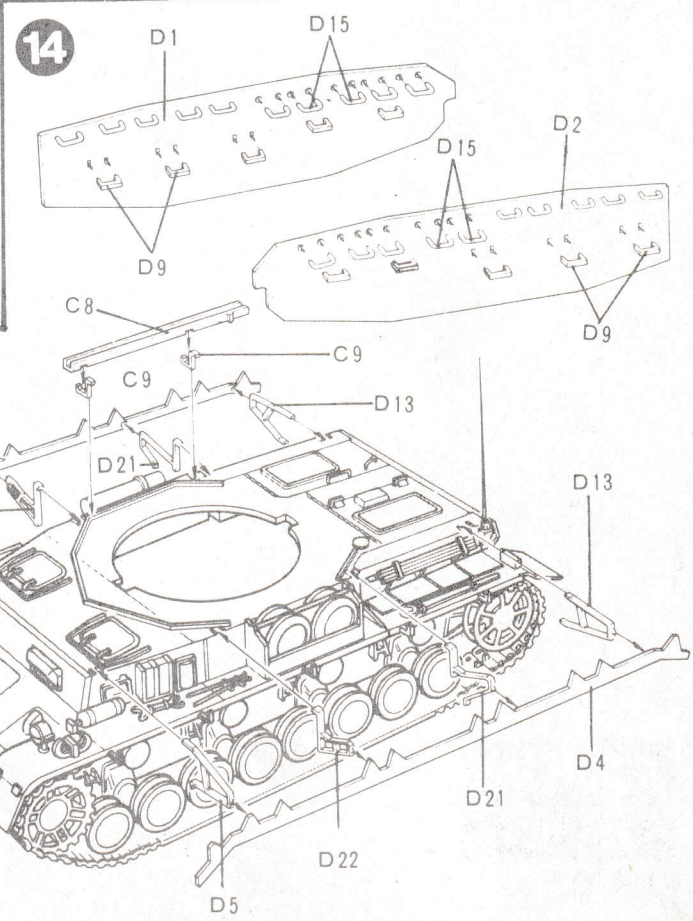
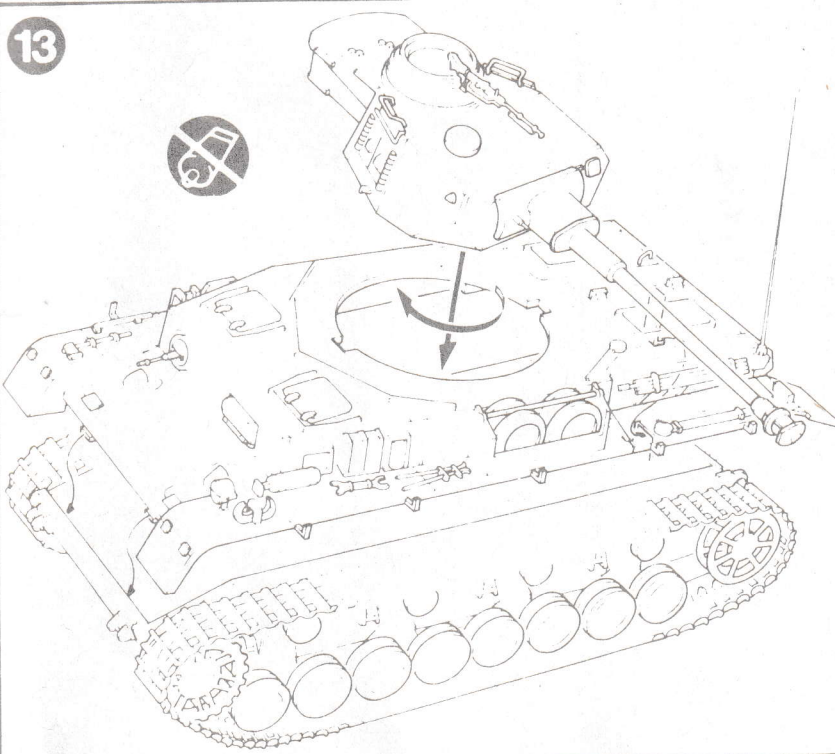
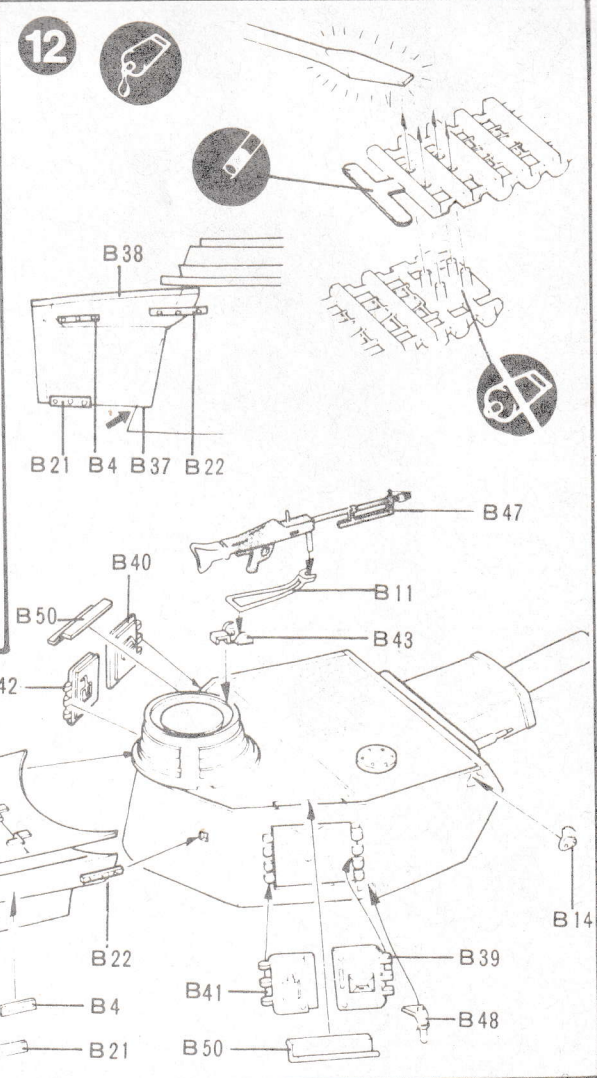
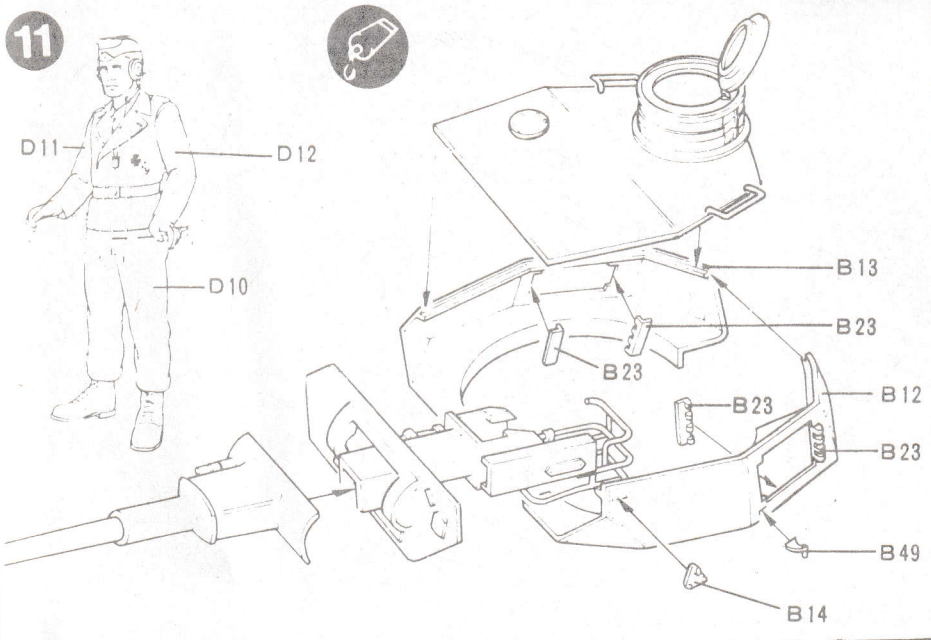

15

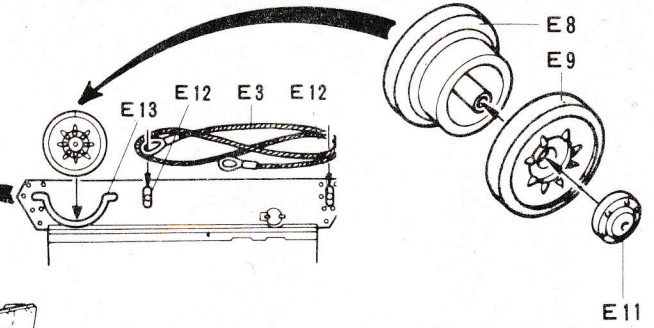
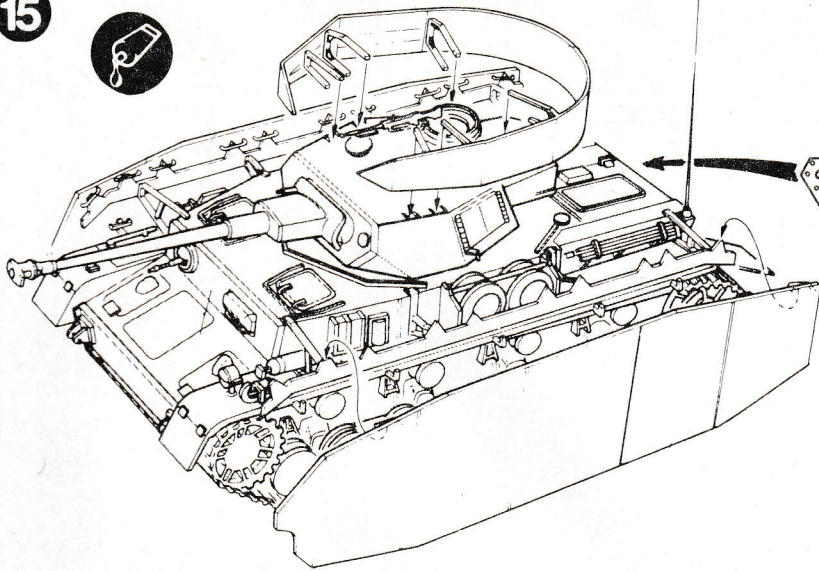

16

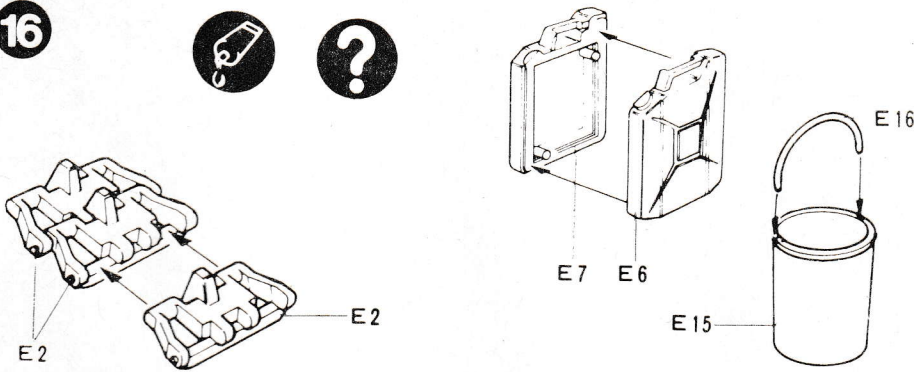

A

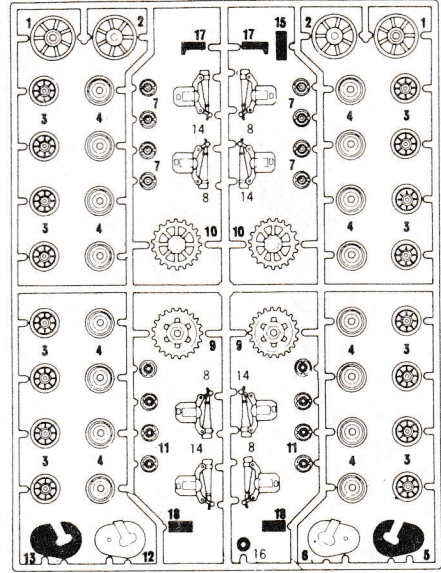

B

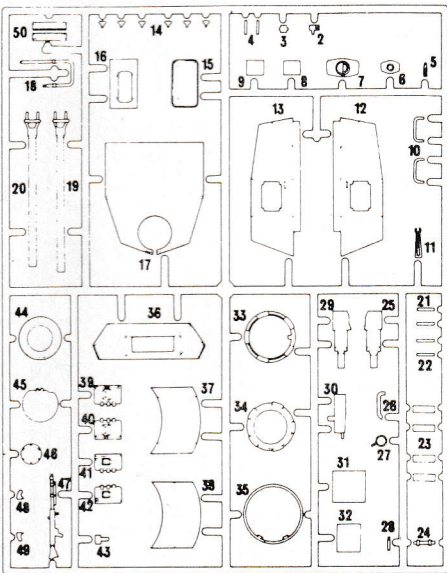

C

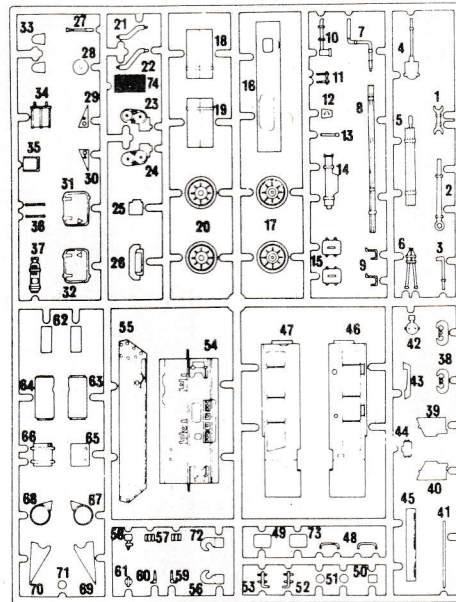

D

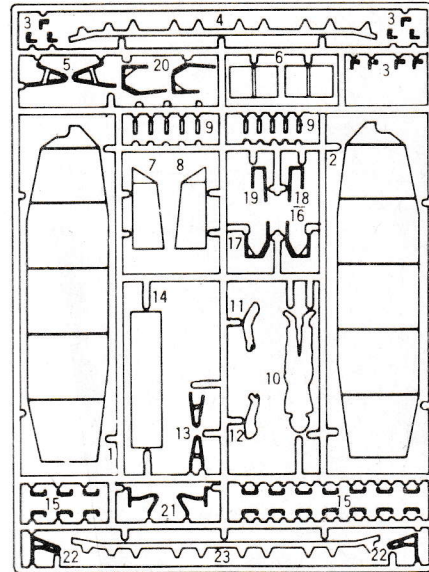

1327

ACADEMY  
아카데미  
MINICRAFT

E

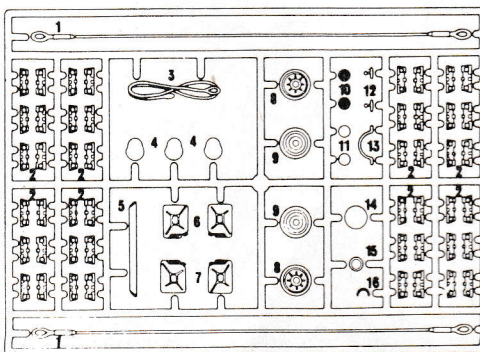

Minicraft Models, Inc.  
1510 W. 228th St.  
Torrance, Calif. 90501



1/35 M-10 TANK DESTROYER 1308



1/35 M-36 JACKSON TANK DESTROYER 1309

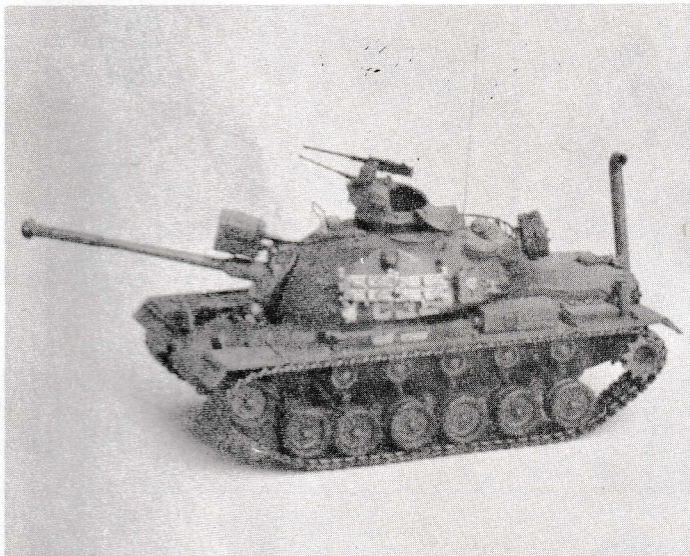

1/35 M48A3 PATTON TANK 1310



1/35 CENTURION MK3 TANK 1311



1/35 GERMAN LEOPARD A4 TANK 1312

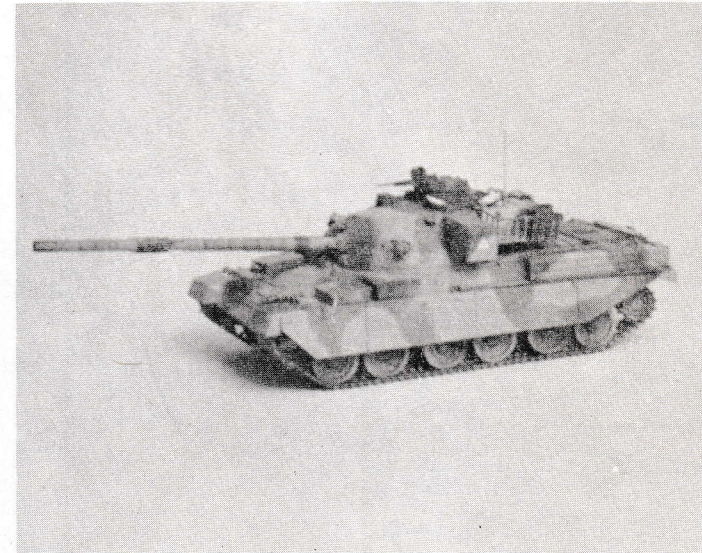

1/35 CHIEFTAN MK 5 TANK 1313