

Boeing 707 Intercontinental Detail Set

For use with the Airfix RAF E.3D Sentry kit, this set provides new window inlays for all the cabin windows, together with new engine turbine blades and other details for the airframe and undercarriage. This set can also be used with the Heller 707 airliner kit - either using the etched window strips or not, as preferred.

Assembly -

a. remove 'Recess Cutting Templates' panel from the etched sheet, for use in assembly. Template 'h' is not used in the context of this kit.

b. ignore part 23 on the etched sheet in the context of this kit.

Cabin Window Inlays -

1. Remove the five partly cut through windows from the two Port side window inlays [these are only retained when these parts are used in our EC.18 Aria Conversion Set]. It is now recommended that

you anneal the four etched cabin window inlays, by heating them over a flame until red, and then allow them to cool naturally. This will take the spring out of them.

2. Using the contours of the kit fuselage halves where the inlays are eventually to be fitted, as a former, form the inlays around the fuselage at the relevant points. Note that the inlays are fitted either side of the central emergency doors moulded in the kit fuselage sides.

3. Remove the areas of the fuselage where the inlays are to be fitted with a piercing saw, leaving approx. a 1mm ledge around the edges of the cut outs. These ledges can then be sanded back by the thickness of the brass [.008"], using masking tape to protect the adjoining areas of the fuselage. The resulting ledges around the fuselage cut outs can then be used as bonding surfaces when you fit the inlays in their appropriate positions - leaving them flush with the surrounding airframe. Note that the forward Starboard inlay must have the area for the lower part of the forward Starboard door included in

the area to be cut out - use the part itself as a template when marking out. Similarly, the forward Port and Starboard inlays have the additional emergency doors in them, which must also be allowed for when cutting out.

Doors -

1. The Port side doors [both forward and aft] should be detailed using parts 7-11, and 15-16, as shown in the diagram - .008" recesses should be made for all these parts [except parts 11], using the recess cutting templates a-f provided. All these parts will then fit flush with the surrounding airframe. Rainstrips [11] are fitted proud of the fuselage, above each door, as indicated.

2. If desired, you can portray these doors in the open position, and to help you in this, inner door fascias are provided [12 for the forward door, and 17 for the aft door]. Parts 13 & 14 and 18 & 19 should be added as shown.

3. Part 20 is an overlay for the rear starboard door which should be faired into the fuselage side, via a

recess cut with the aid of recess cutting template 'g', with part 21 added above the door. The upper hinge on part 20 can be shaped so as to fit over the rear vertical edge of the rear panel of the Starboard aft window inlay etching.

The glazing of all the passenger windows is best undertaken with clear acetate sheet. This will transform the model, but opens up the problem of increased internal visibility - all those seats to make and fit!

Remainder of Airframe -

1. Laminate aerials using from parts 24 & 25, and 26 & 27 - these can be fitted as required - positioning would depend on exact model and the airline and period being portrayed. Parts for more aerials than would usually be fitted are supplied.

2. Laminate four pitot heads from parts 5 & 6, and use these to replace those in kit.

3. Parts 28 are static dischargers and should be added to the wing, fin and tail plane trailing edges,

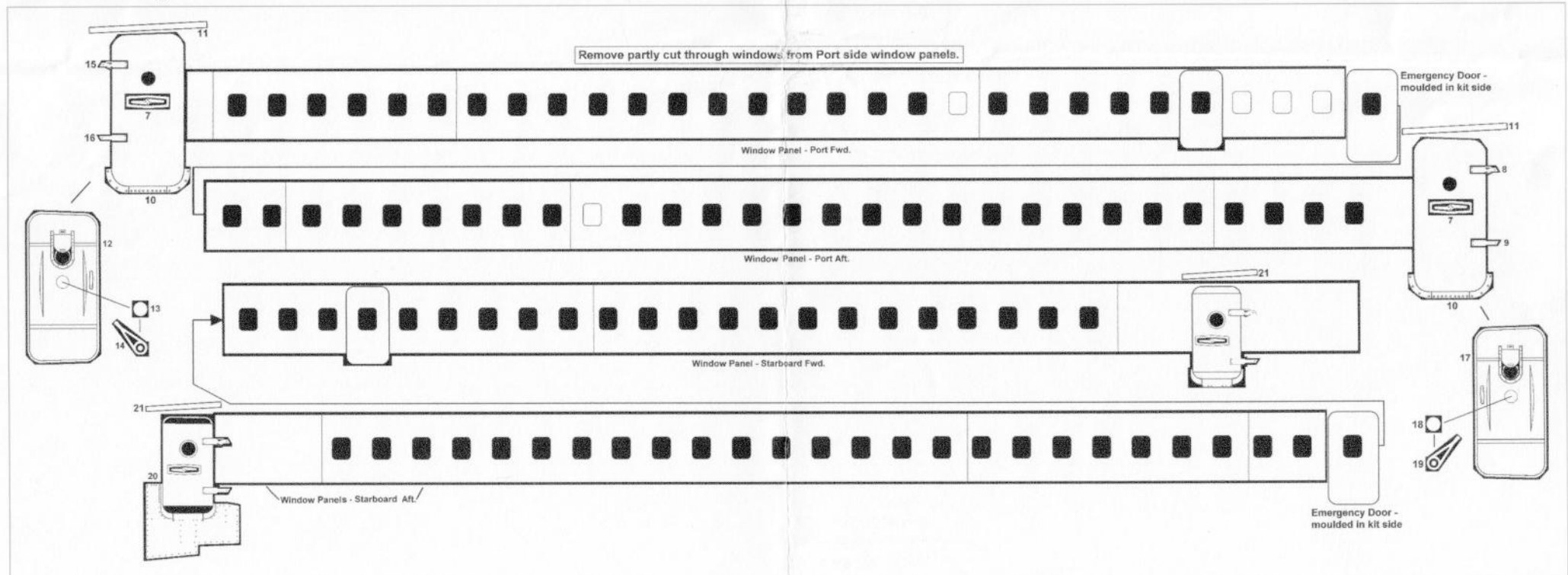

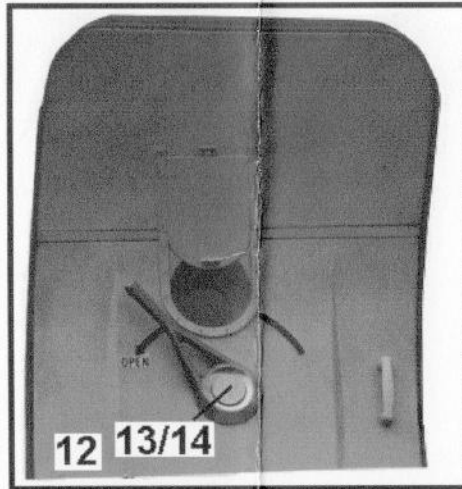
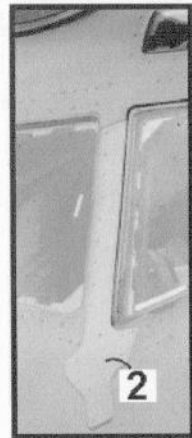
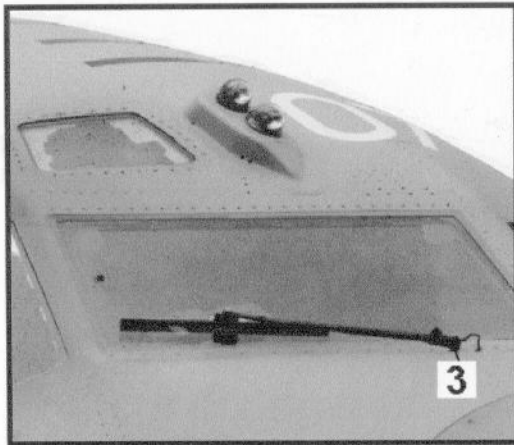

Photographs of
RAF E.3D Sentry
- but numbered
details
applicable to
Boeing 707

Static Dischargers [Parts 28]

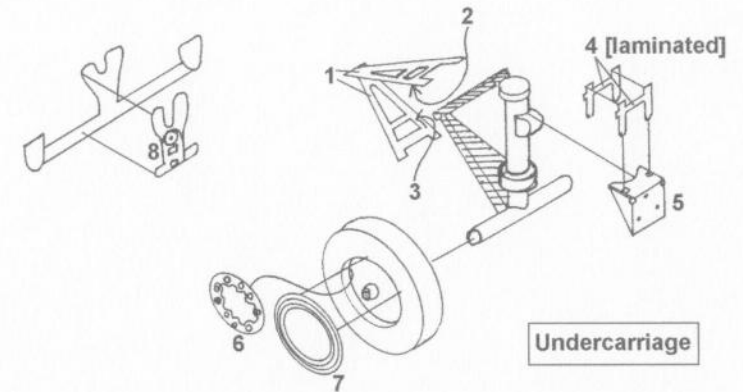
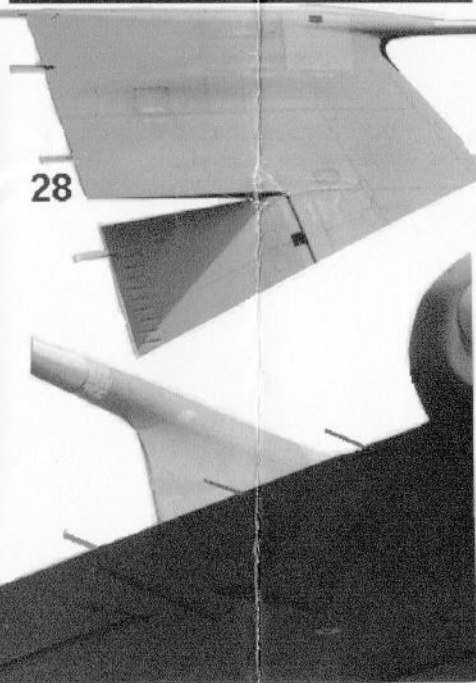
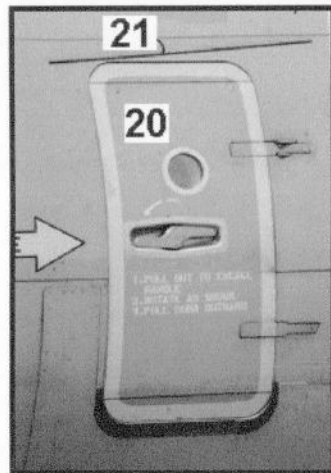
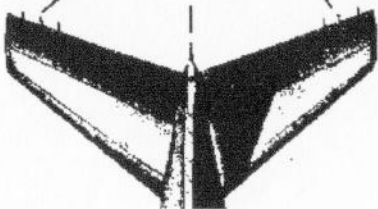

parts 1-3 and fit to kit part 3. Fit kit parts 45 [with the etched fans and the shaded plastic bullets attached, *[and with the moulded turbine blade detail now facing aft]*] within the engine nacelles as you construct the engines in the normal front of kit part 35, as shown. Fit part 6 into the hubs of kit parts 56, adding parts 7 around the hubs.

Main Undercarriage -

Fit parts 8 over the centre sections of kit parts 23 and 24. Fit parts 9 around the hubs of the main inner wheel faces [kit parts 15]. Add parts 10 around the hubs on the outer wheels [16].

Engines -

1. Remove the bullets from the four engine turbine blade mouldings [kit parts 45]. Shape the etched turbine blades [29], bending each blade slightly with fine pliers, and fit these centrally the smooth *[rear]* faces of kit parts 45.

as shown.

4. Fit part 22 to rear starboard fuselage in place of decal 73.

5. Fit parts 1 & 2 [handed] to outer wind screen pillars, adding wind screen wipers [3 & 4].

Front Undercarriage -
Assemble front undercarriage leg torque links from

2. Fit the bullets [removed earlier] to the centre of etched parts 29, after first sanding approx. 1mm from the rear faces of these parts.