

<Scribed Brass Parts : 210 Pcs.>

- 01. 14in Main Barrel : 10Pcs.
- 02. 14in Axis : 10Pcs.
- 03. 5.25in Barrel : 16Pcs.
- 04. 5.25in Axis : 8Pcs.
- 05. 40mmPom-Pom Barrel Short : 24 Pcs.
- 06. 40mmPom-Pom Barrel Long : 24 Pcs.
- 07. 20mm Oerikon Barrel : 8 Pcs.
- 08. 20mm Oerikon Base : 8 Pcs.
- 09. Main mast : 1Pc.
- 10. Main mast Strut : 2Pcs.
- 11. Main mast bar : 1Pc.
- 12. Main Top mast : 1Pc.
- 13. Fore mast : 1Pc.
- 14. Fore mast Strut : 2Pc.
- 15. Fore mast 2 : 1Pc.
- 16. Fore Top mast 1 : 1Pc.
- 17. 40ft Yardarm : 1 Pc.
- 18. 24ft Yardarm : 1 Pc.
- 19. 30ft Yardarm : 1 Pc.
- 20. 45 Yardarm : 1 Pc.
- 21. Type 279 RDF Pole : 2 Pcs.
- 22. ADO : 6 Pcs.
- 23. ALO : 6 Pcs.
- 24. Pole : 1 Pc.
- 25. 50ft Swinging Boom : 2 Pcs.
- 26. 40ft Derrick : 6 Pcs.
- 27. 34ft Derrick : 2 Pcs.
- 28. 30ft Derrick : 2 Pcs.
- 29. 20ft Derrick : 2 Pcs.
- 30. 12ft Derrick : 2 Pcs.
- 31. Crane Axis: 2Pcs.
- 32. Crane Top Axis: 2Pcs.
- 33. 20in Bitt : 22Pcs.
- 34. Wildcat Control Wheel 1 : 3Pcs.
- 35. Bell : 1Pcs.
- 36. Jascck staff : 1Pc.
- 37. Ensign staff : 1Pc.
- 38. Mushroom Vent 1 : 10Pcs.
- 39. Mushroom Vent 2 : 10Pcs.
- 40. Up launcher Axis : 4Pcs.
- 41. 40mm Bofors Barrel : 1 Pc.

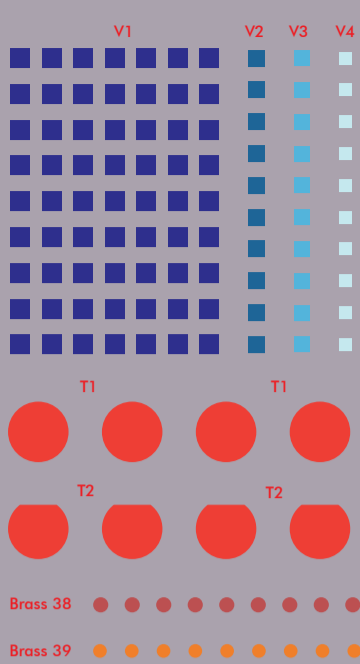

35015F1 1/350 HMS PRINCE OF WALES 1941 DETAIL UP SET

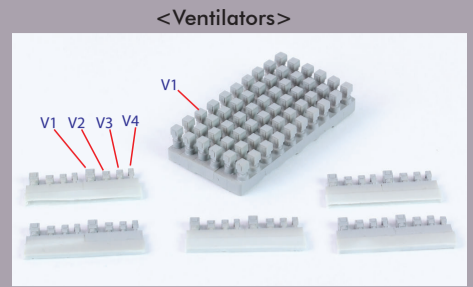

- < Contents >
- 1. Stained Wooden Deck
 - 2. Scribed Brass : 210 Pcs
 - 3. Photo Etching : 6 Sheets
 - 4. Resin Parts : 131 Pcs.
 - 5. Dry Transfer : 1 Sheet

<Resin Parts>

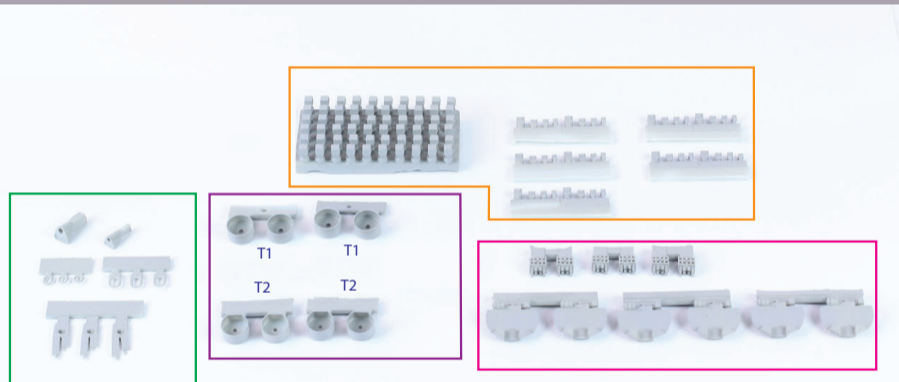

<Break Water>

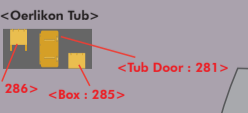
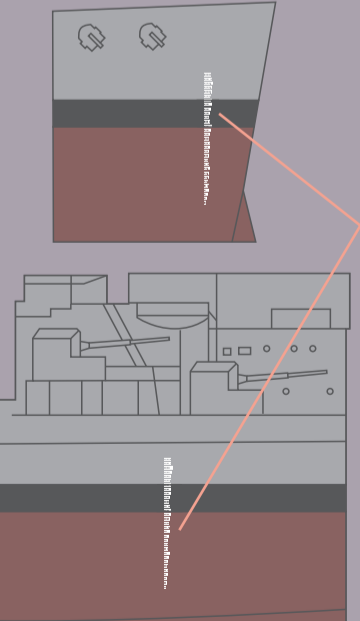
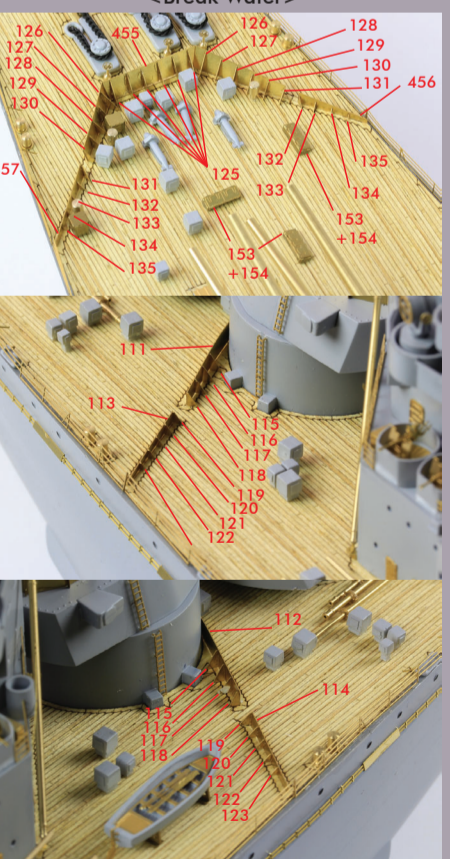

<References>

- 1. Warship Volume III, London, Conway Maritime Press, 1979
- 2. V.E. Tarrant, King George V Class Battleships, London, Arms & Armour, 1991
- 3. R A Burt, British Battleships 1919-1945, Annapolis, Naval Institute Press, 1993
- 4. Roger Chesneau, King George V Class Battleships, Barnsley, Seaforth Publishing, 2004
- 5. Alan Raven, Ensign 1 : King George the Fifth Class Battleships, London, BIVOUAC Books Ltd., 1972

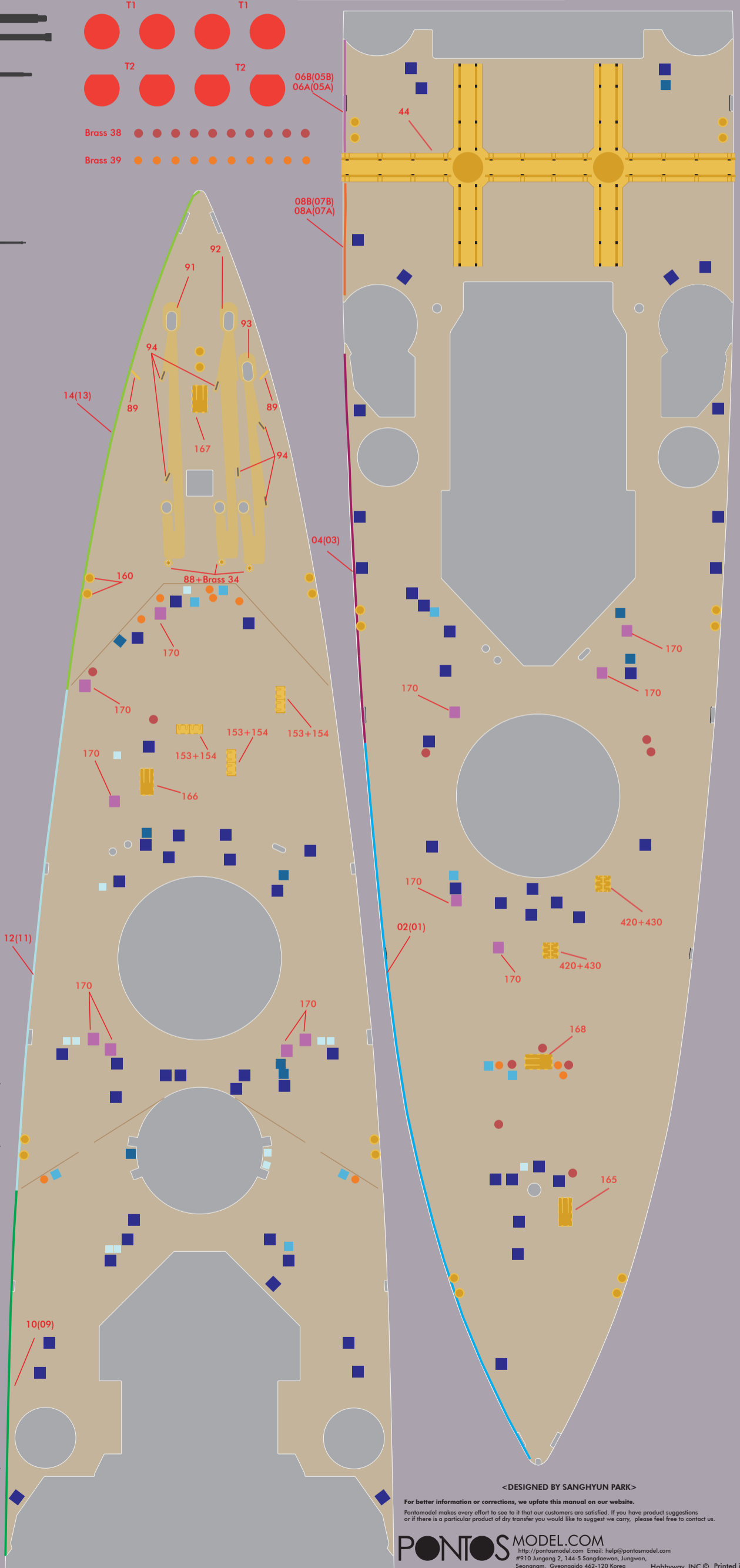

<DESIGNED BY SANGHYUN PARK>

For better information or corrections, we update this manual on our website.
Pontosmodel makes every effort to see to it that our customers are satisfied. If you have product suggestions or if there is a particular product of dry transfer you would like to suggest we carry, please feel free to contact us.

<Type 279 Radar>

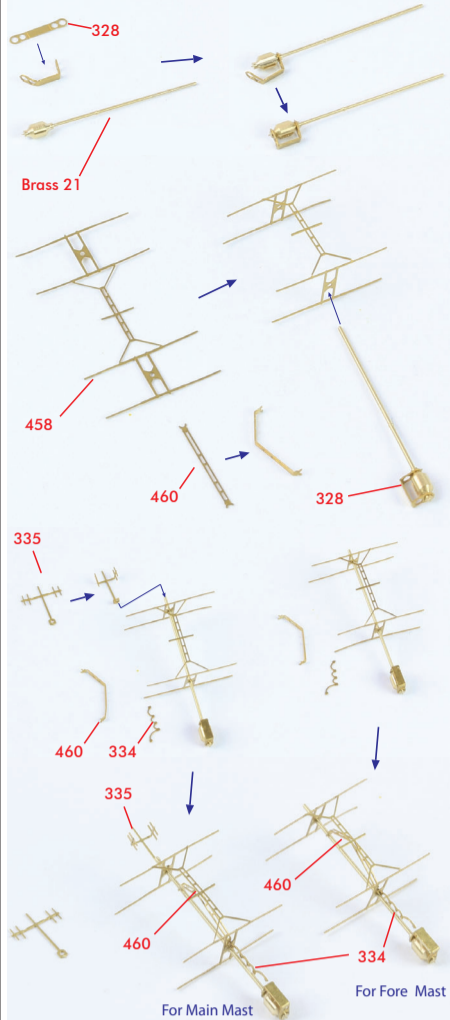

<Starfish Platform>

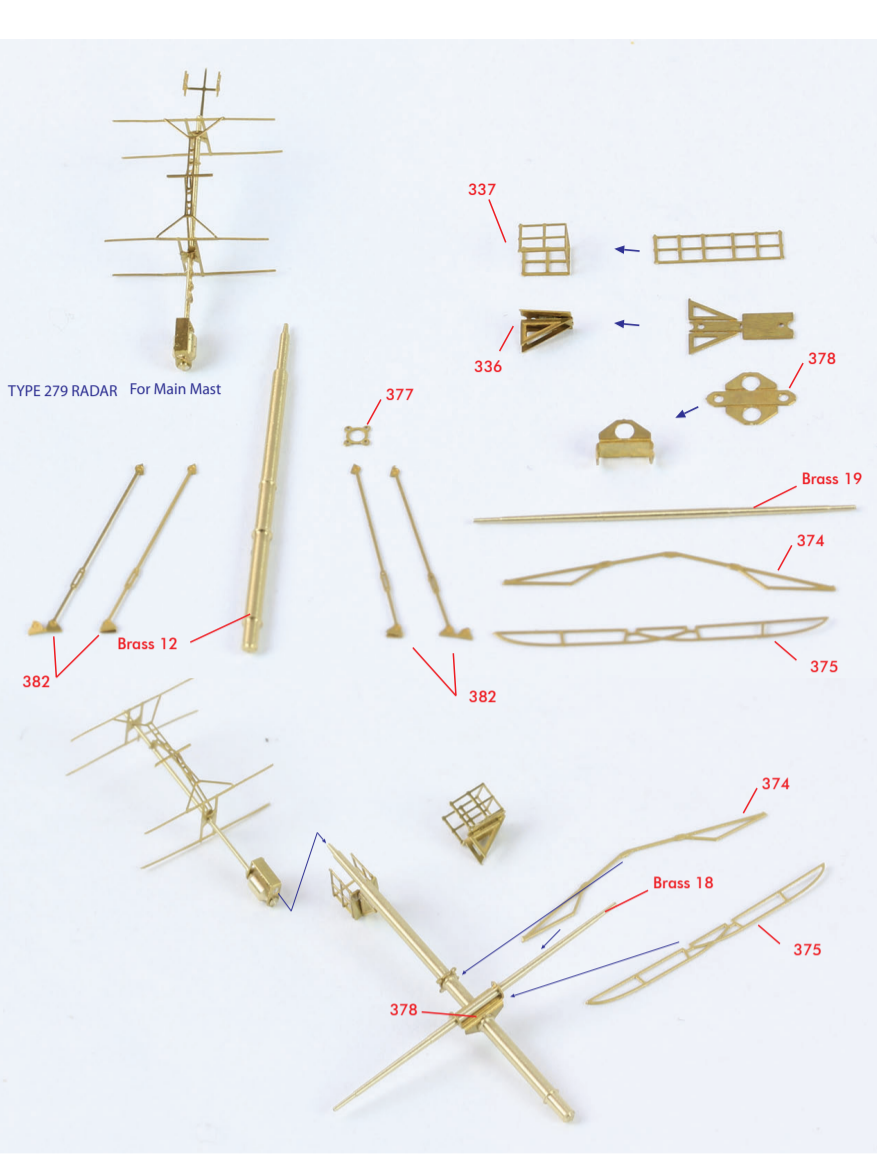
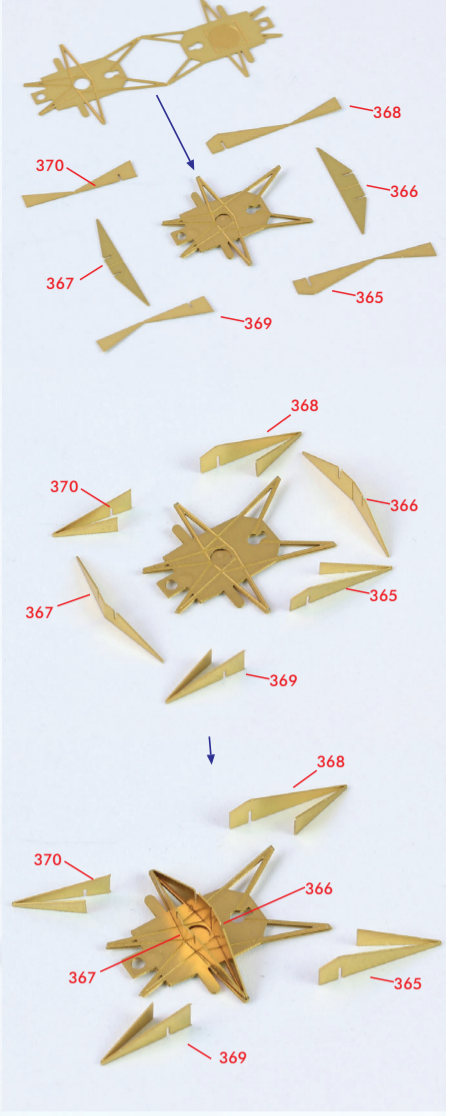

<5.25in. Gun Director>

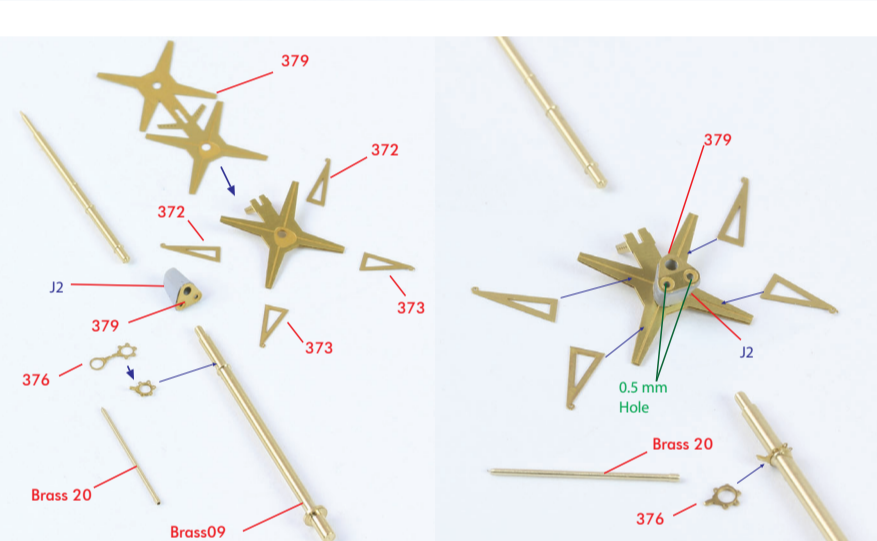
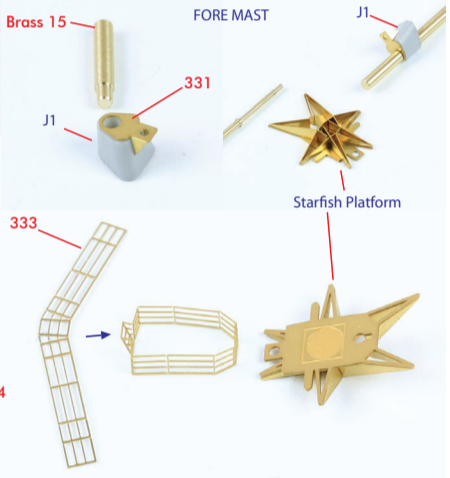
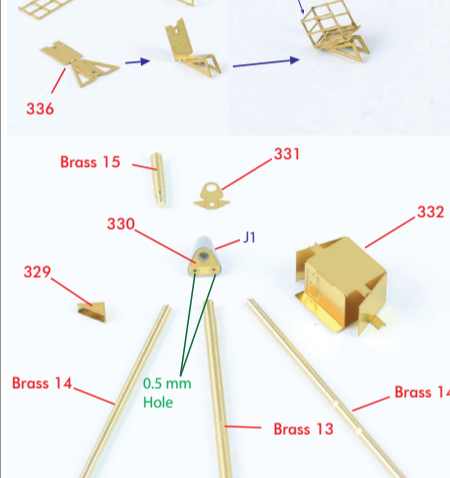
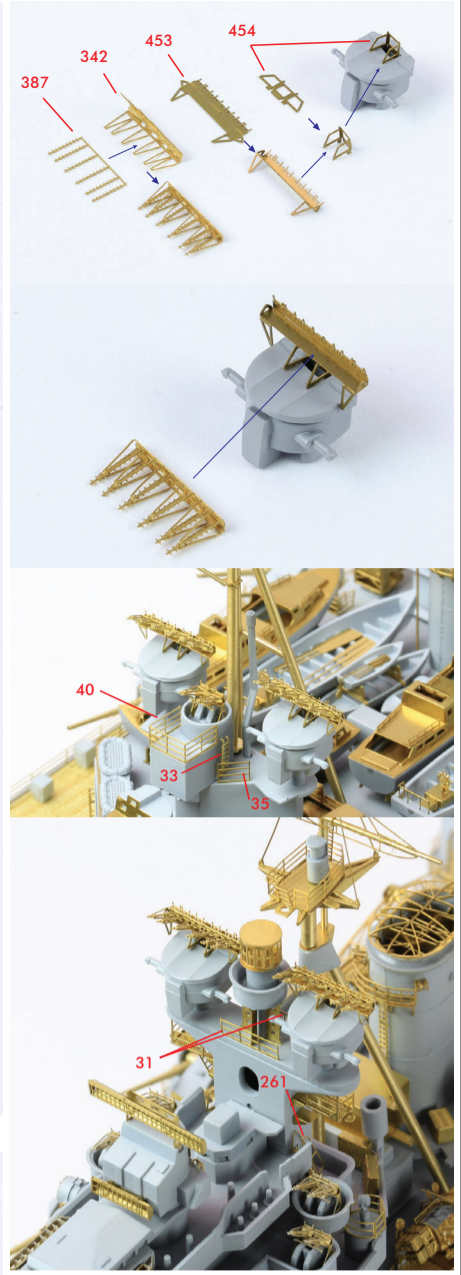

<Main Gun Director>

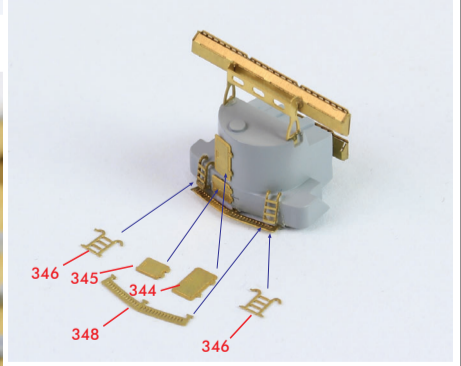
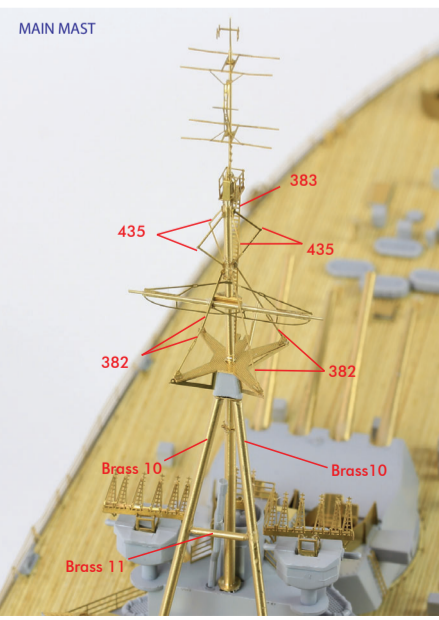
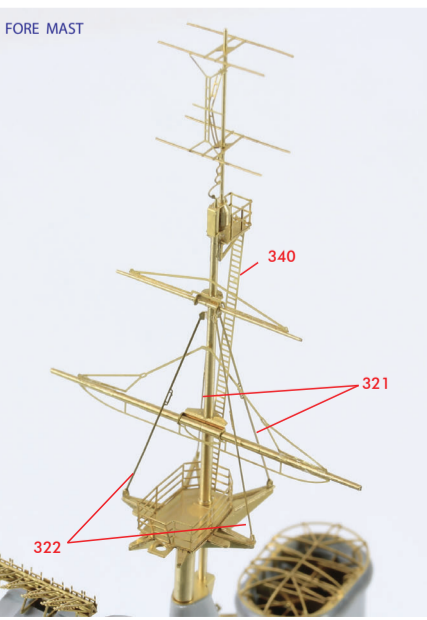
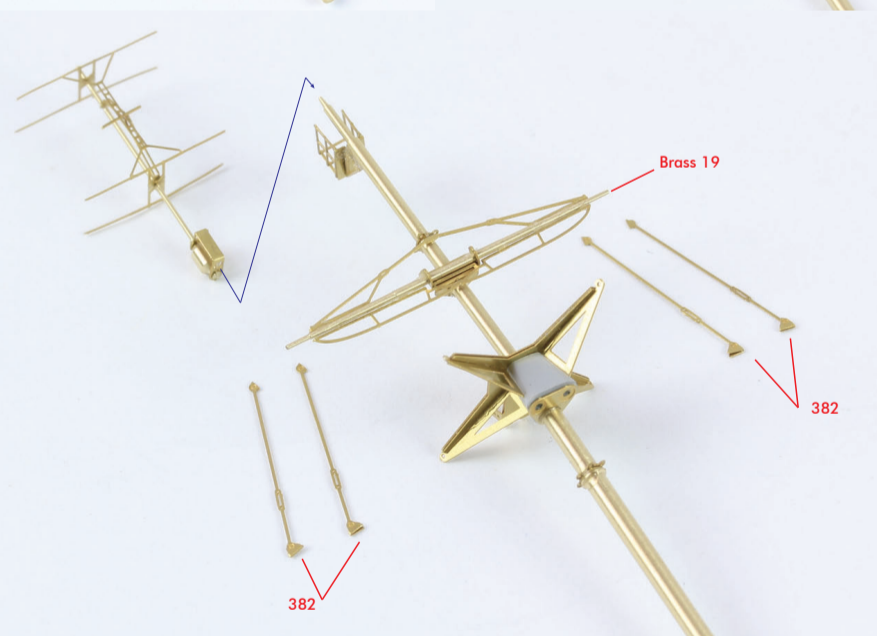
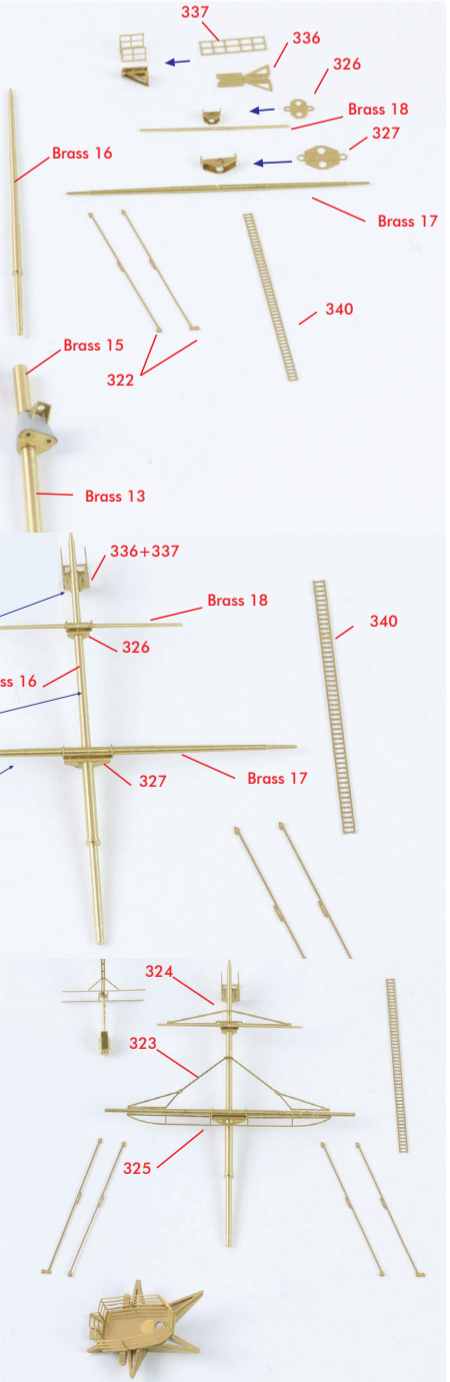
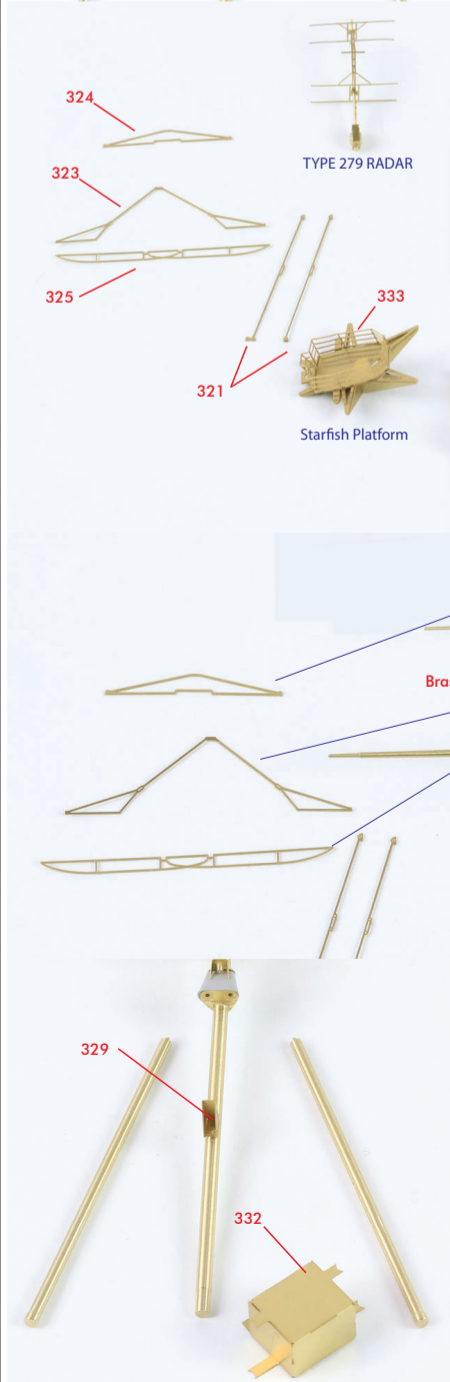
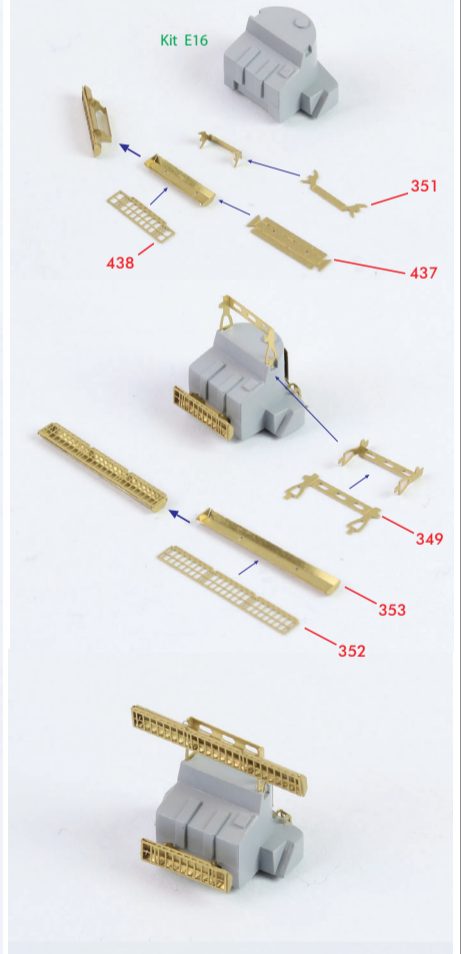

<Boats>

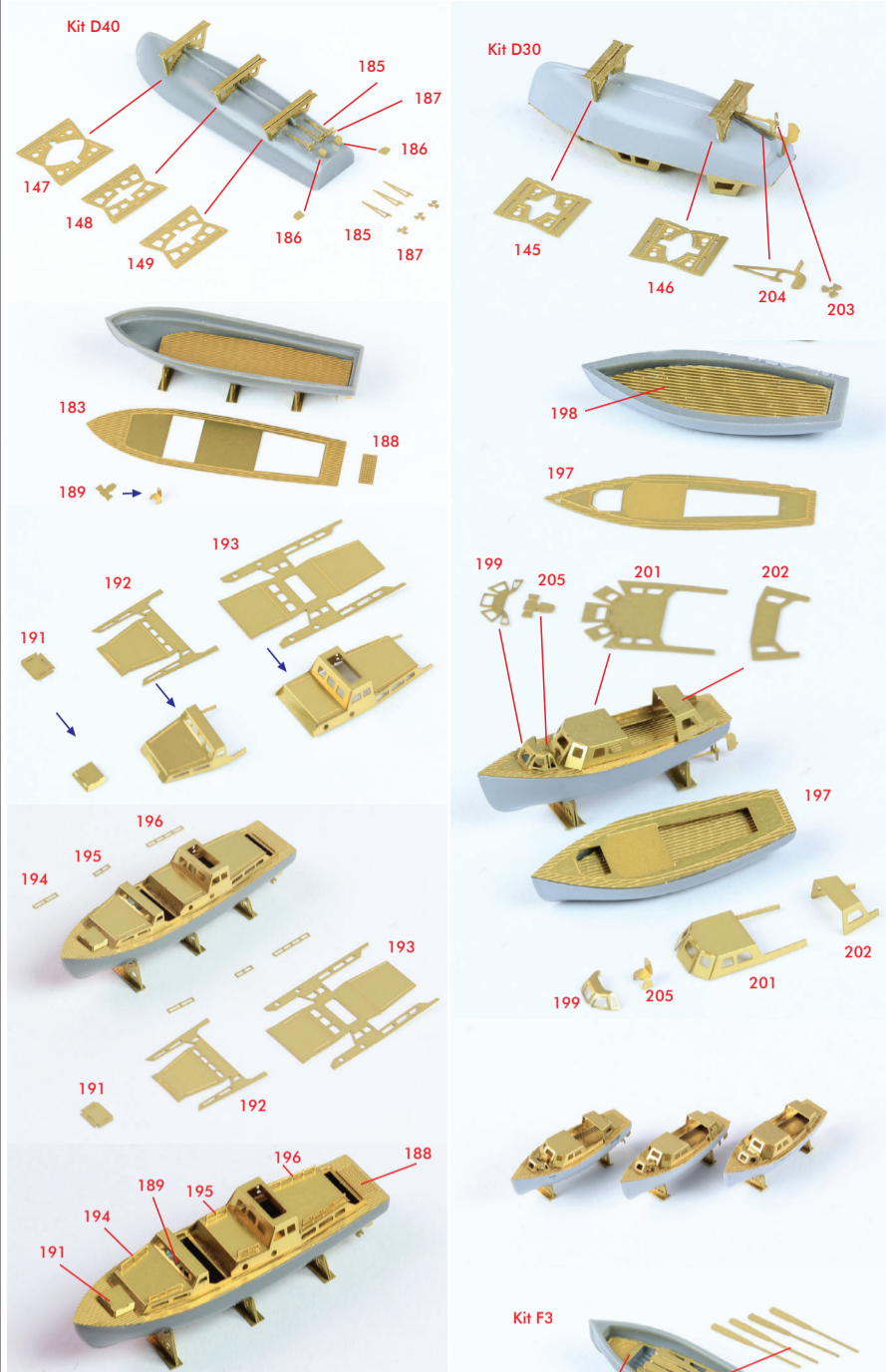

<Turrets>

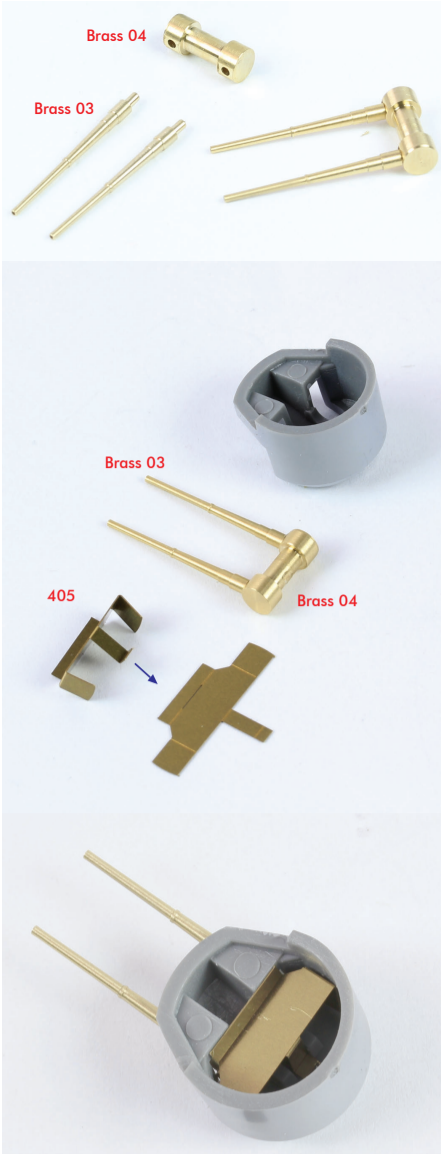
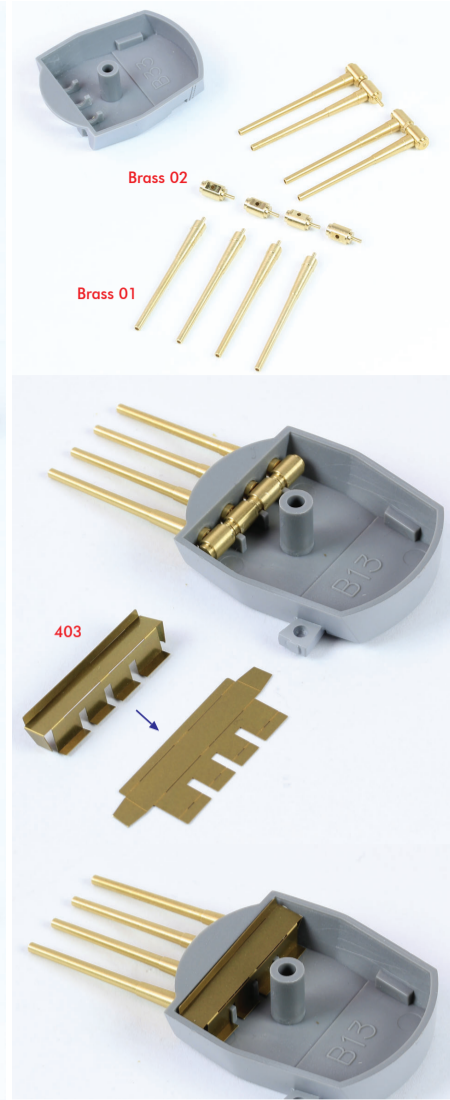

<Wind Deflect>

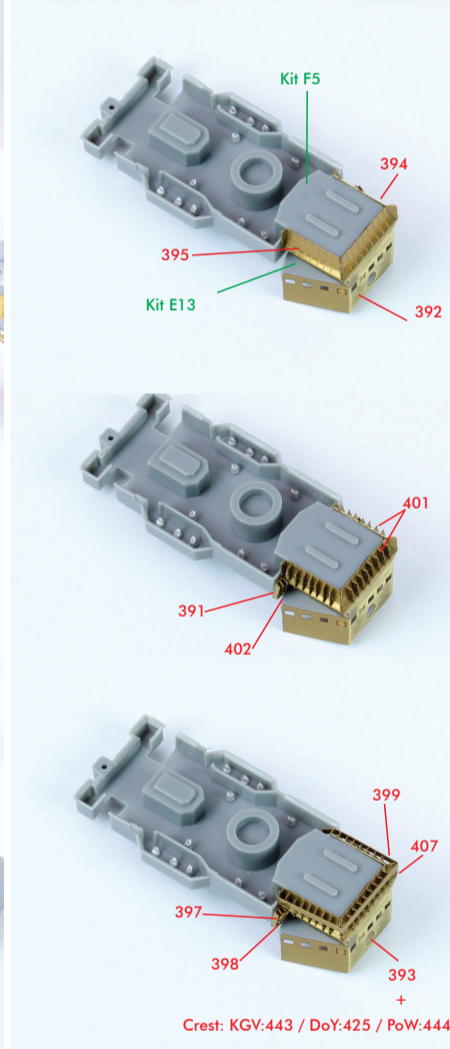
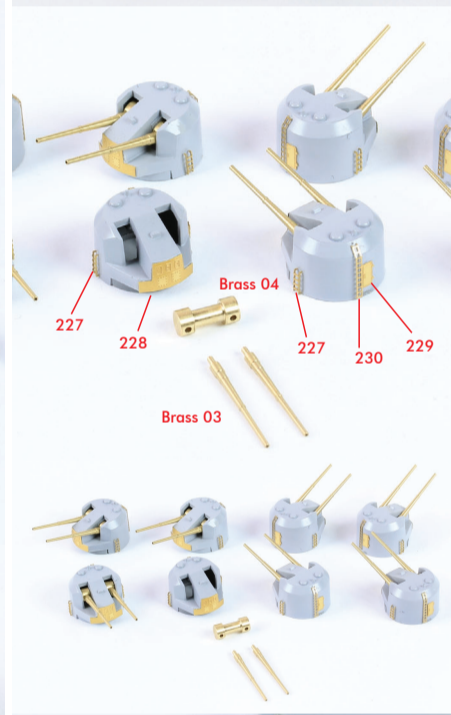
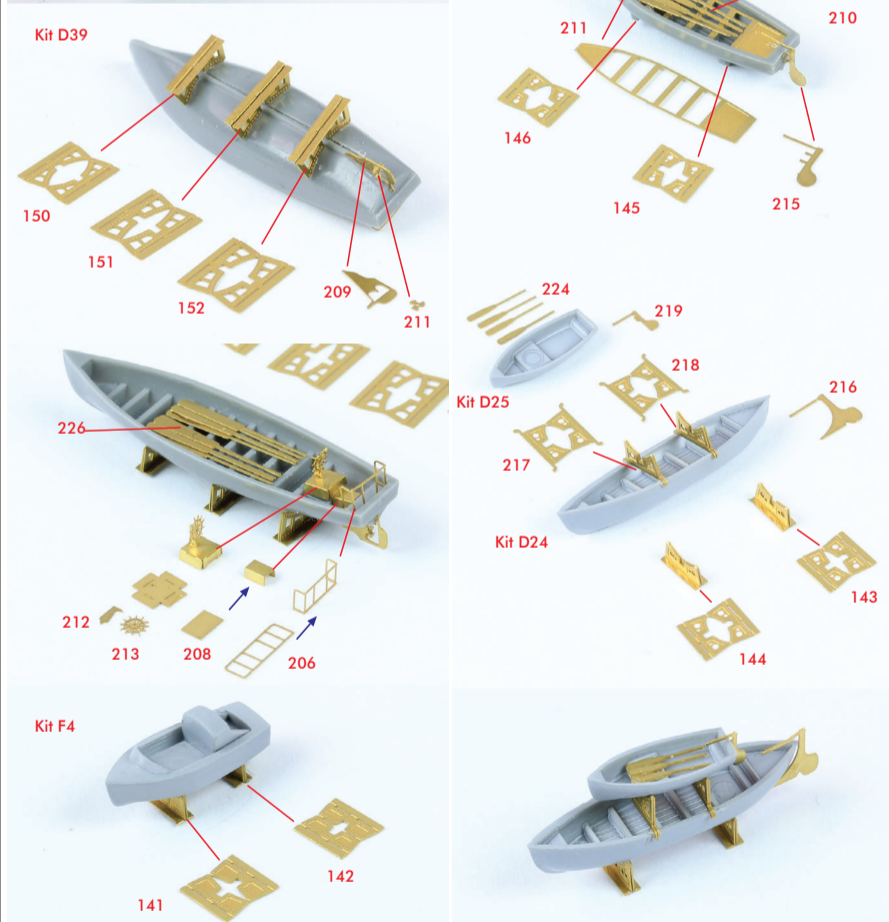
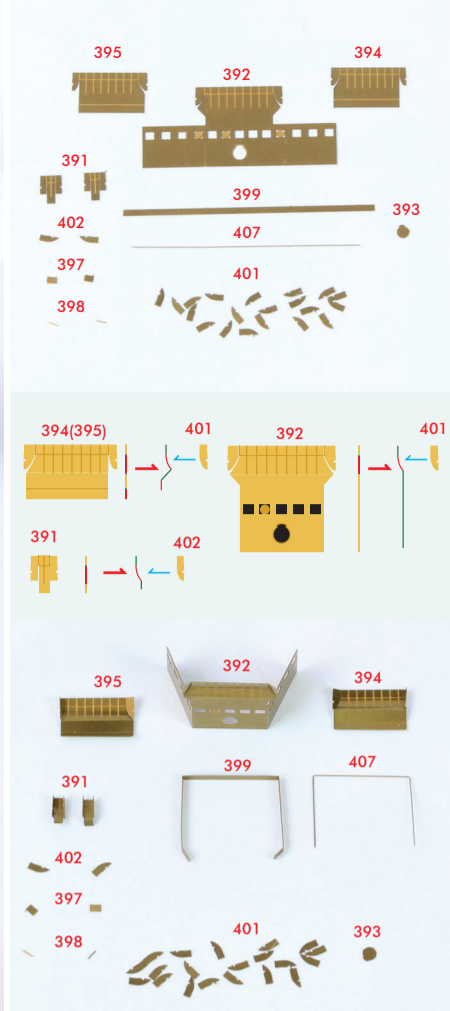

<Box B 291>

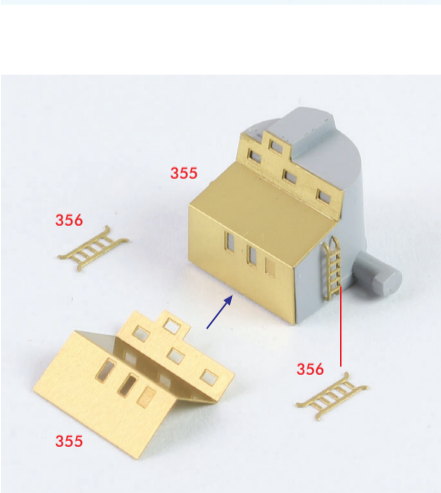
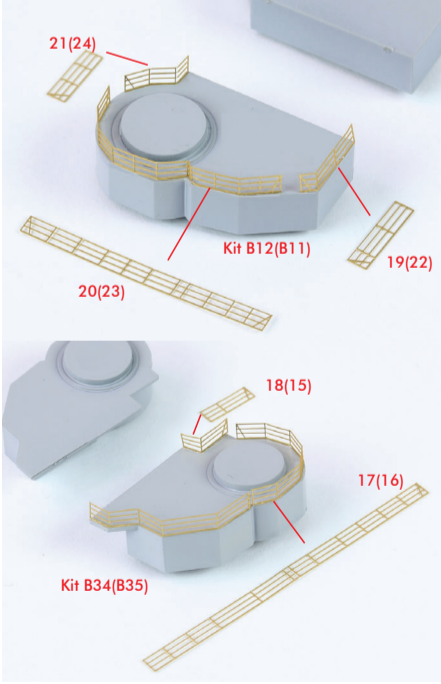
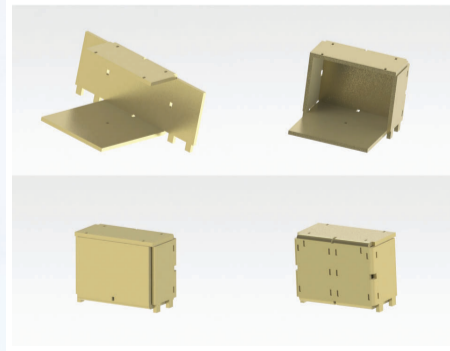

<Box A 286>

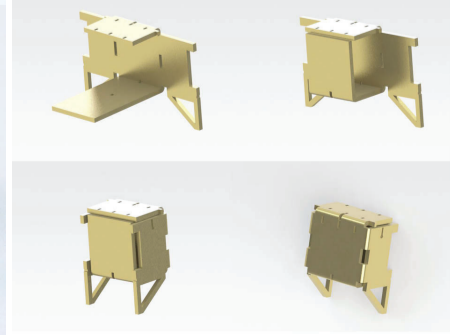

<Staffs>



<Walrus>

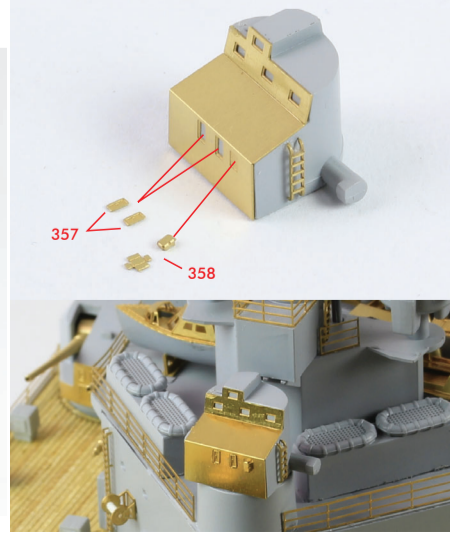
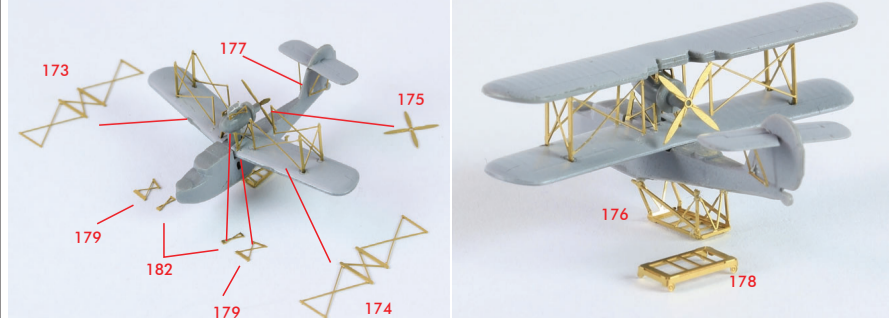

<Front Funnel>



<After Funnel>

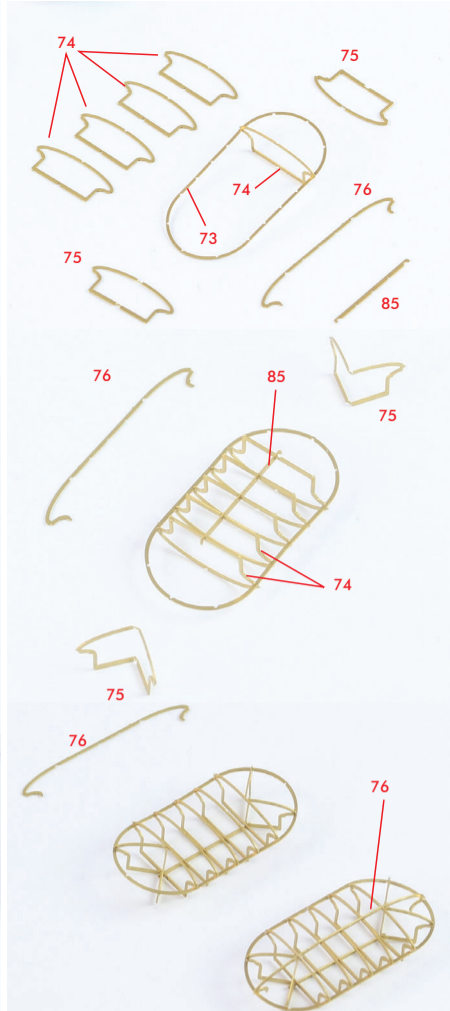

<Flag Locker>

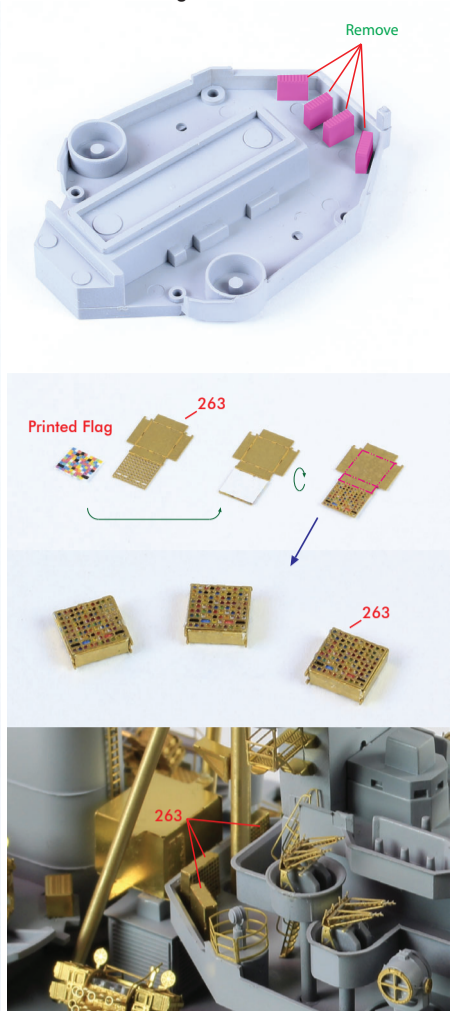

<Catapult>

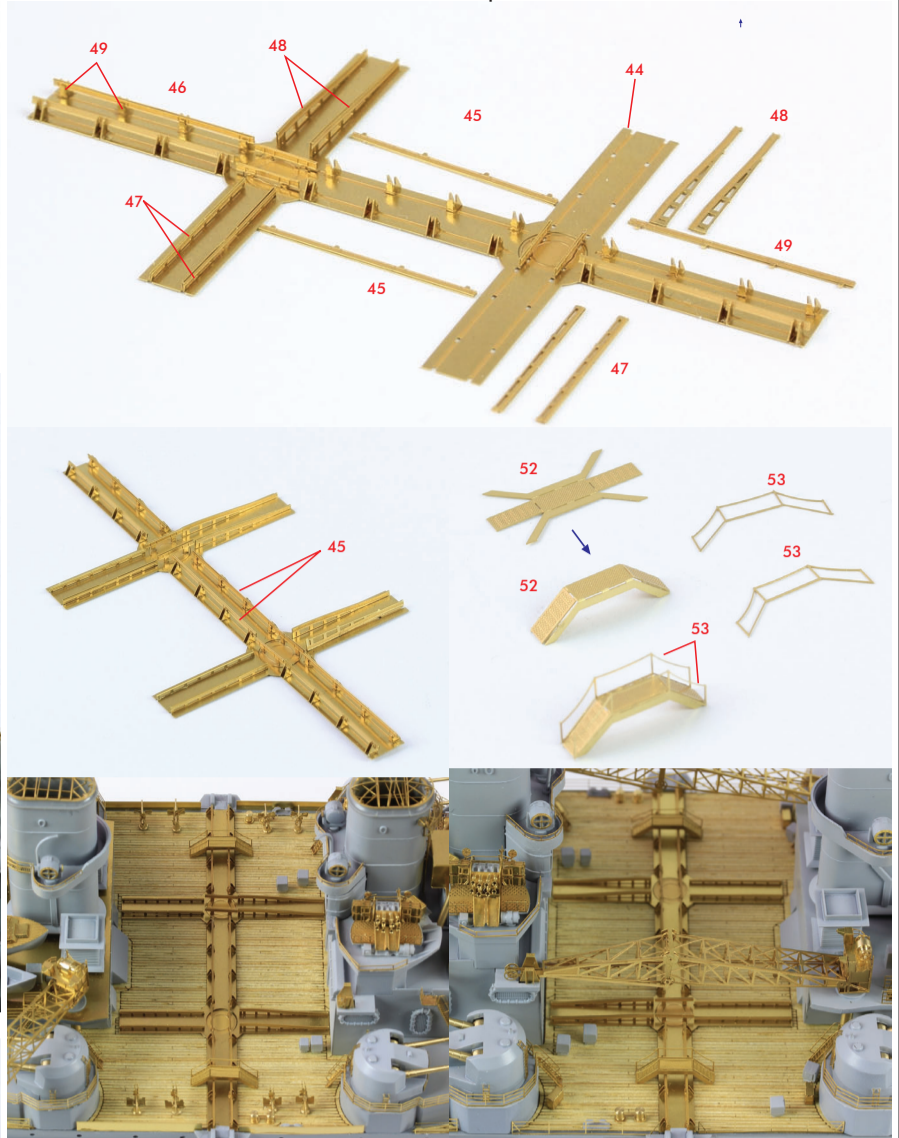

<POM POM Director>

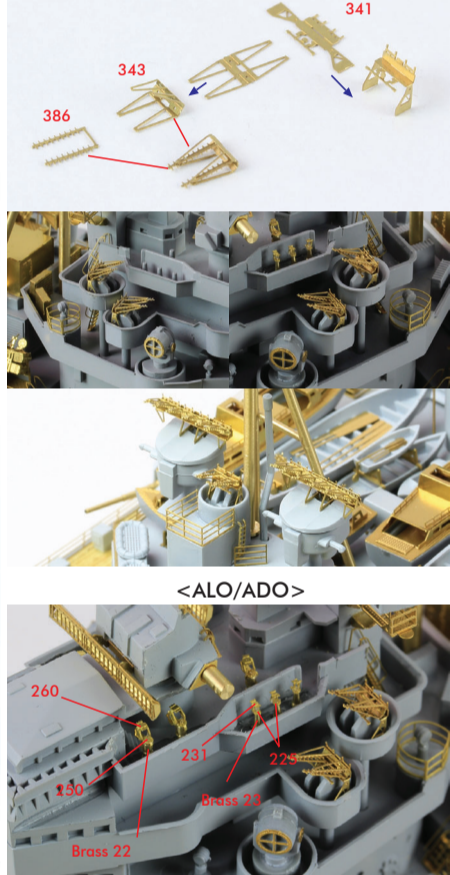

<Crane>

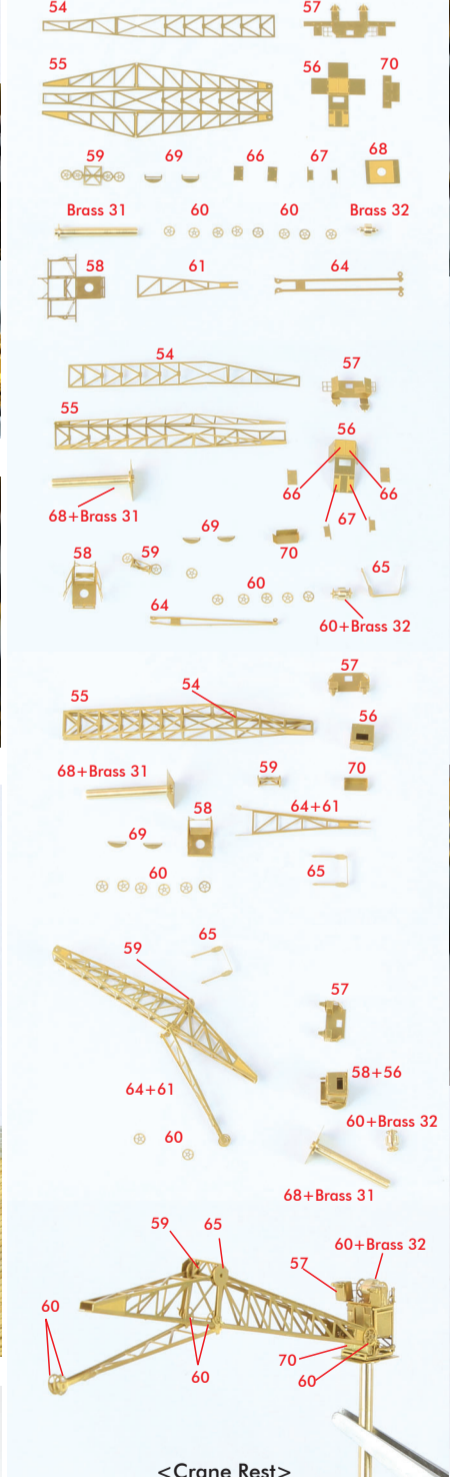

<Searchlight>

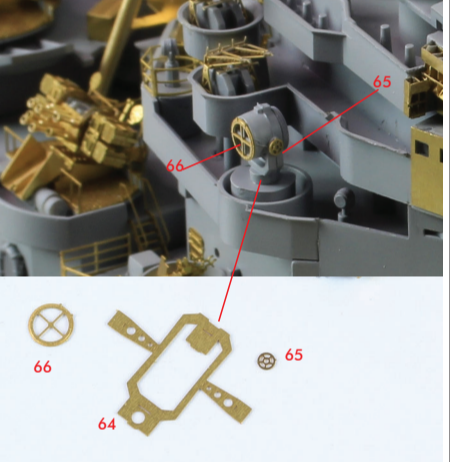

<Accommodation Ladder>

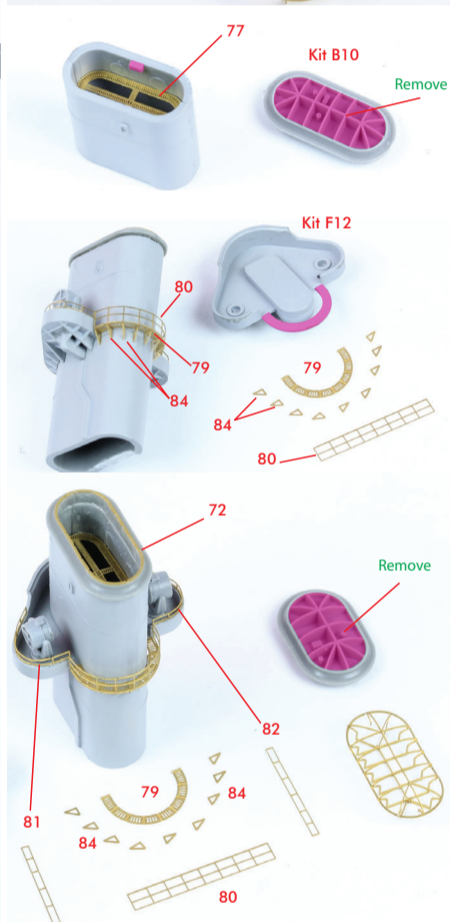
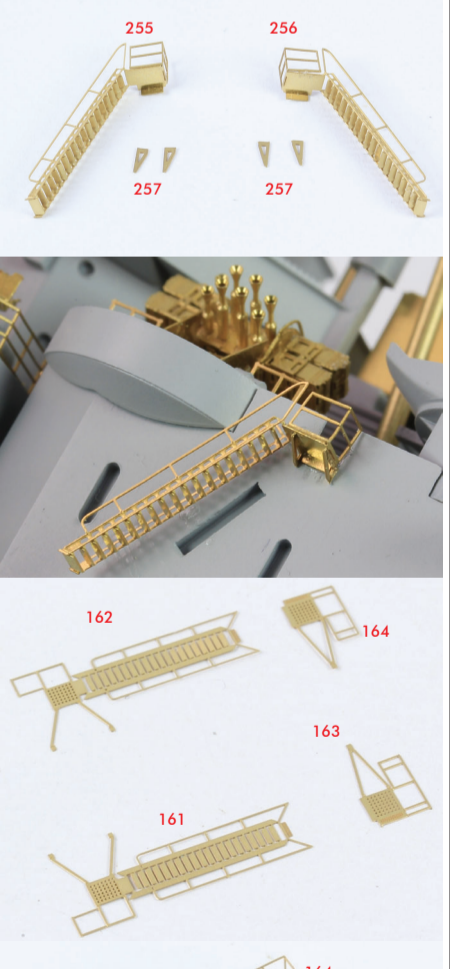

<20mm Oerlikon>

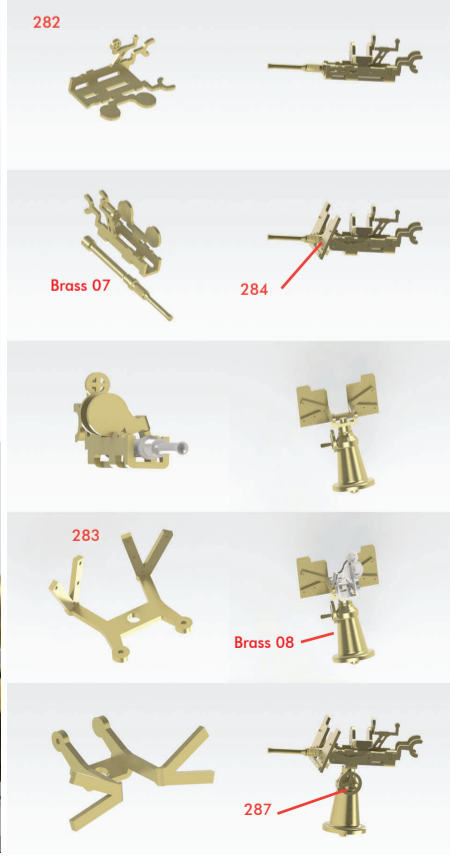

<Bits>

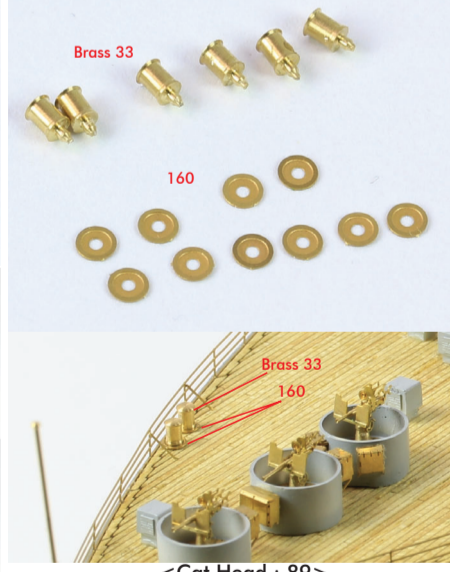

<Cat Head : 89>

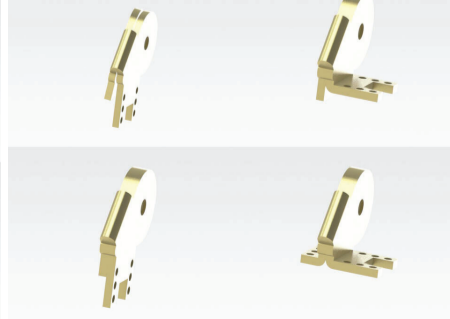

<Bell>

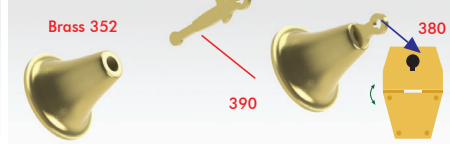

<Crane Rest>

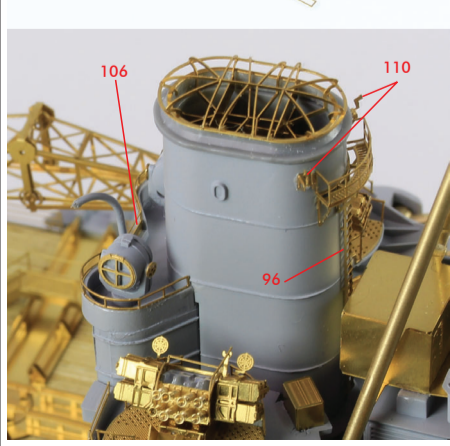
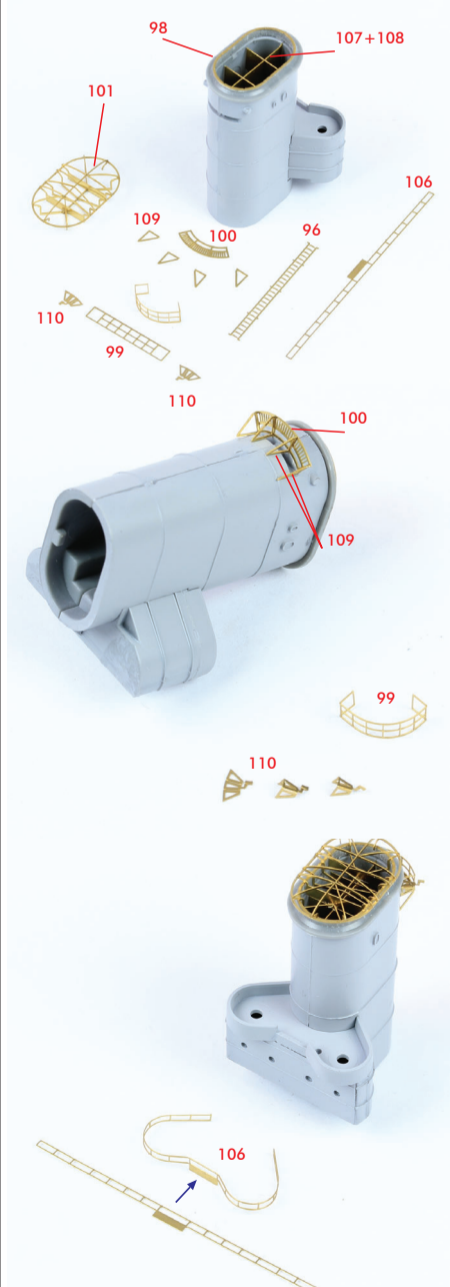
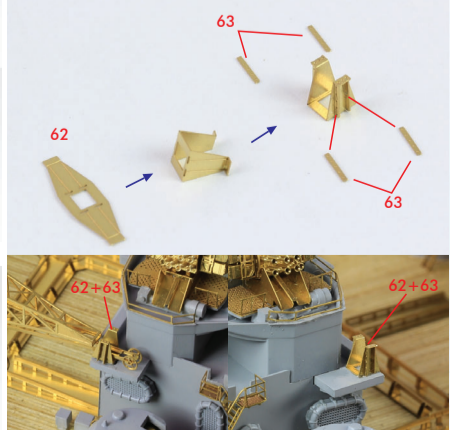

<UP launcher > <PoW/KGV only>

<Derrick/Boom>

<2pdr Pom Pom>

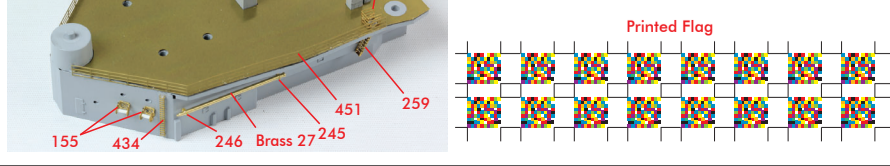
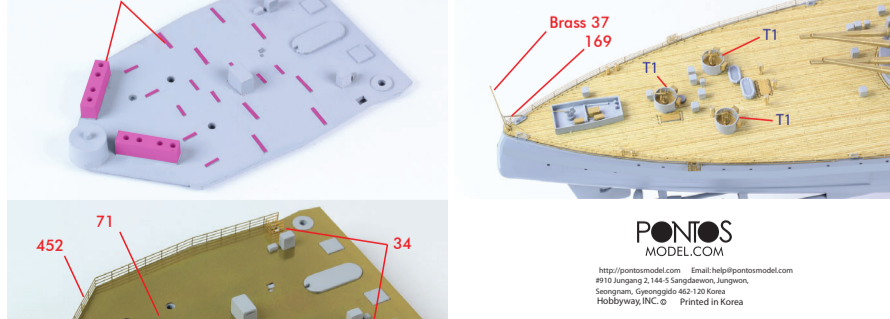
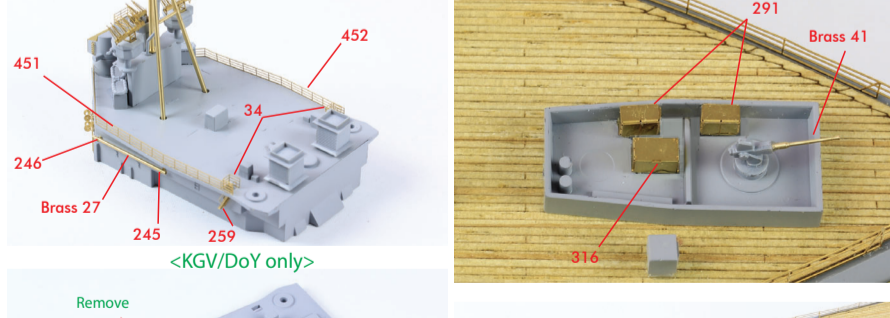
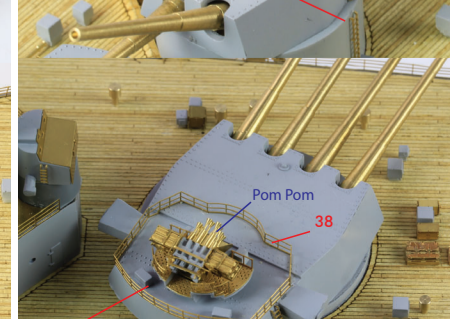
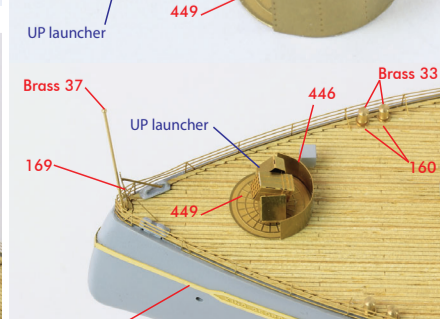
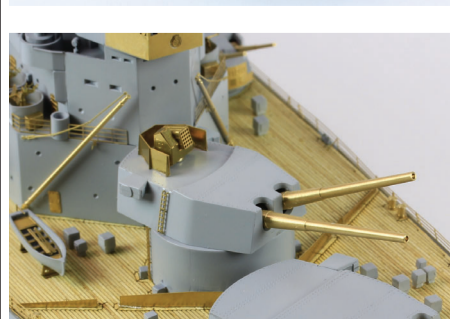
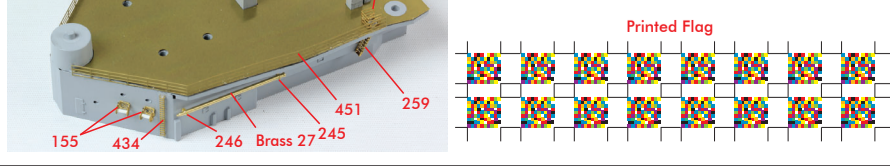
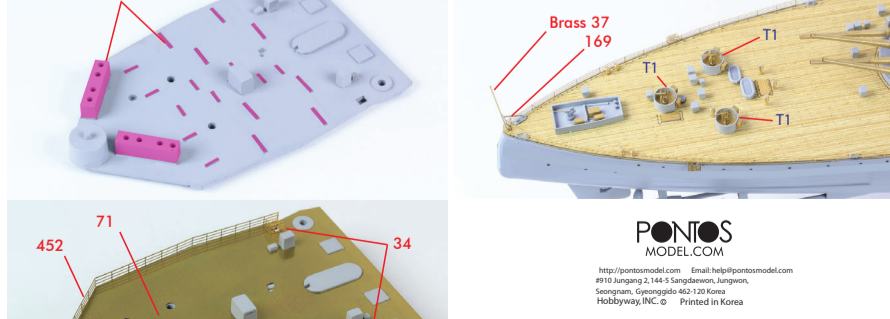
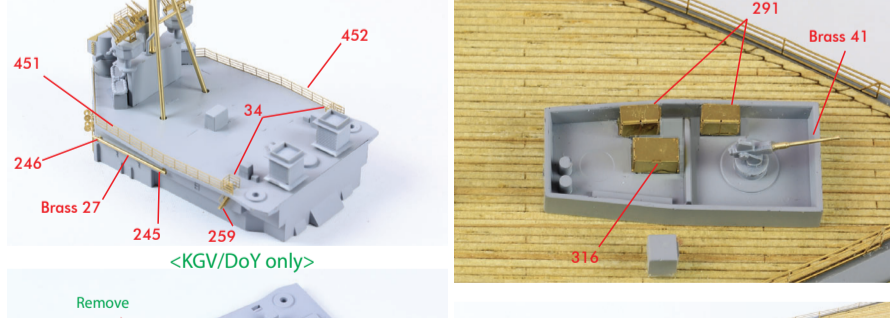
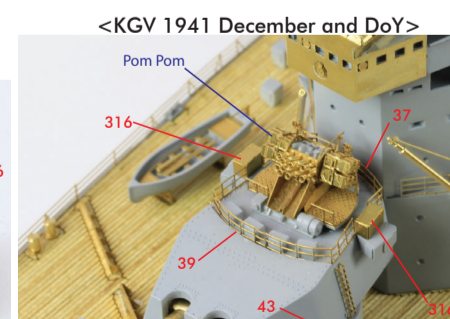
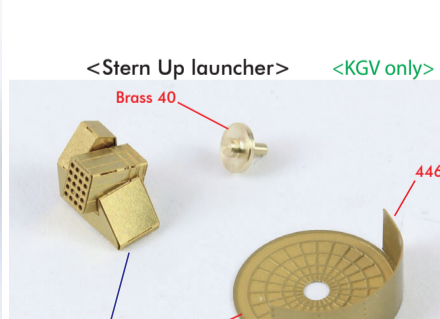
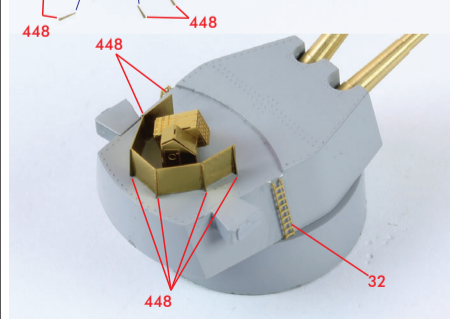
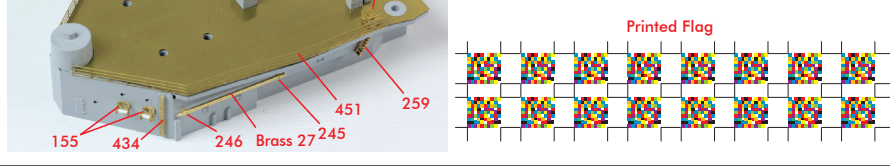
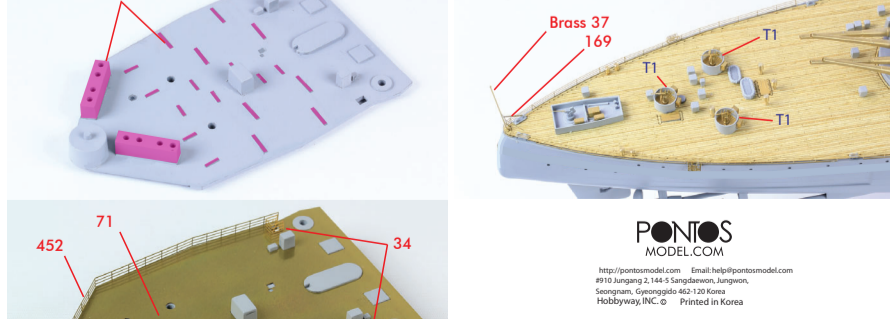
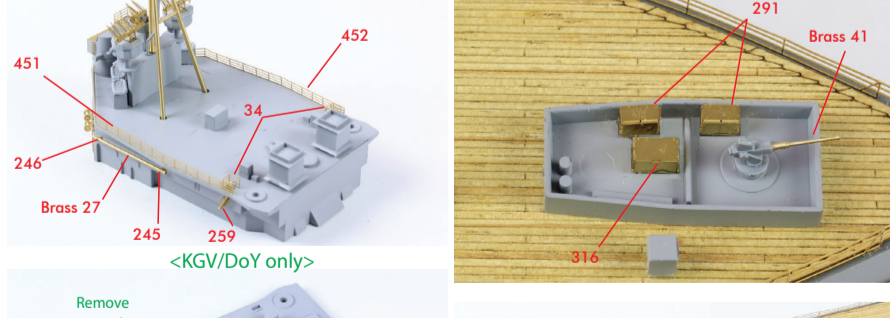
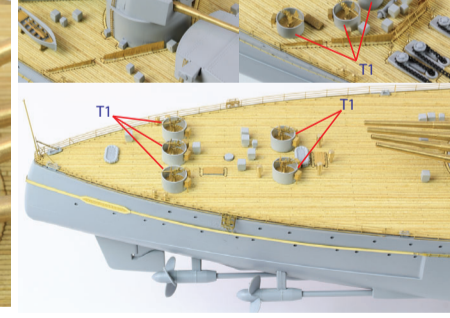
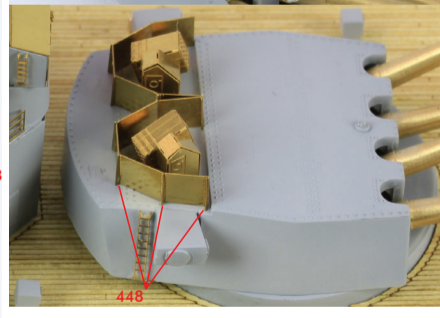
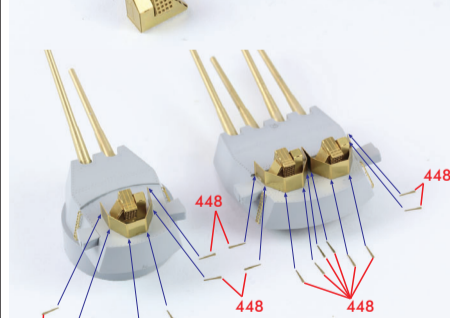
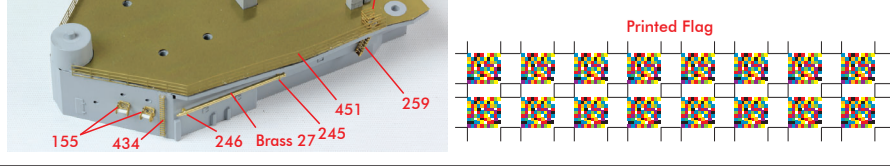
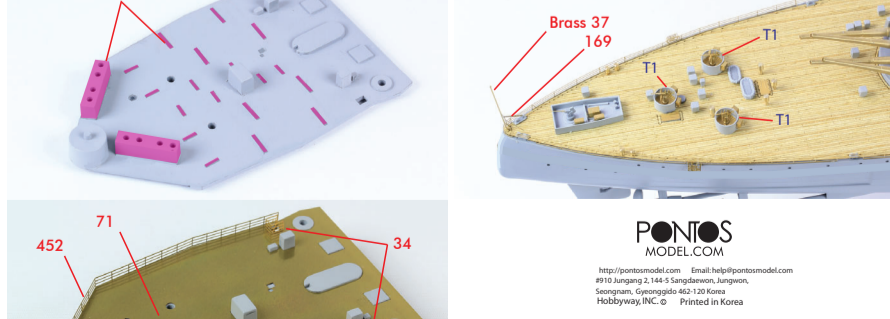
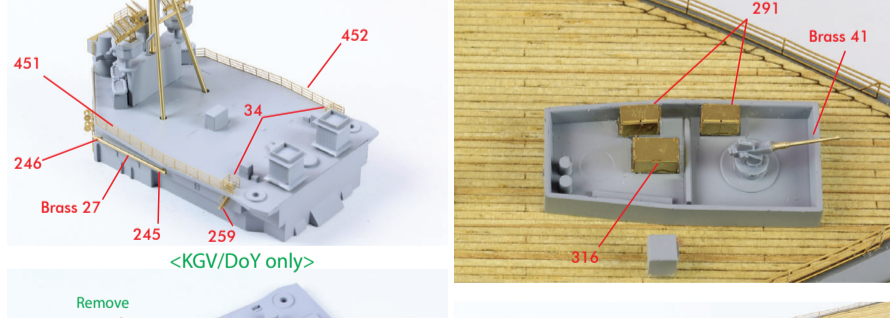
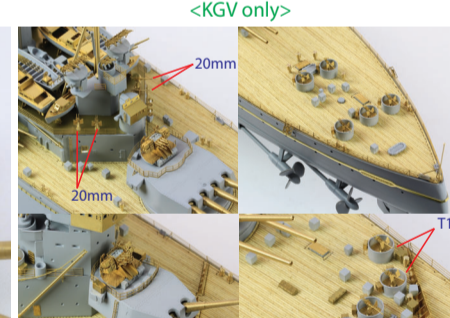
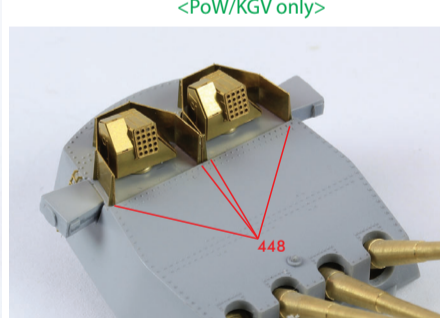
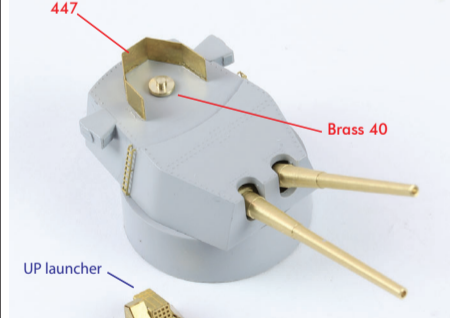
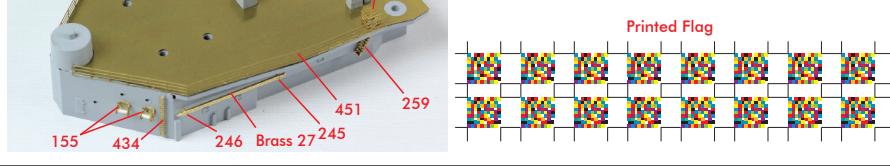
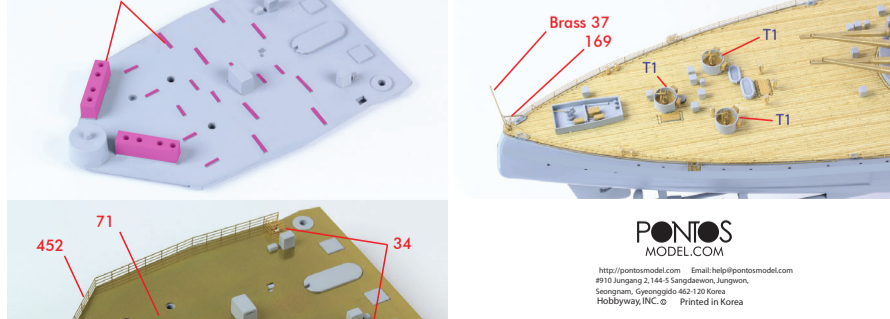
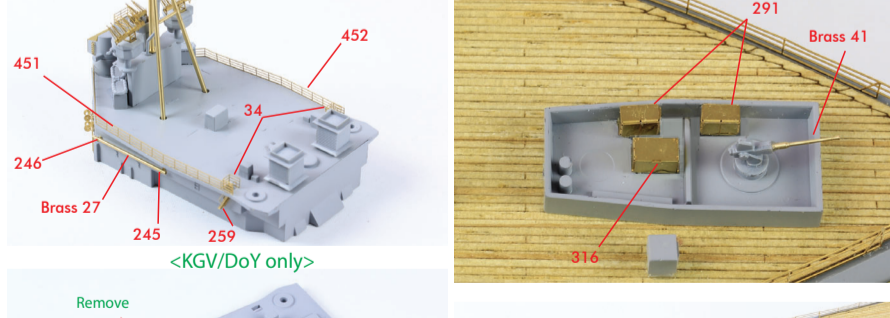
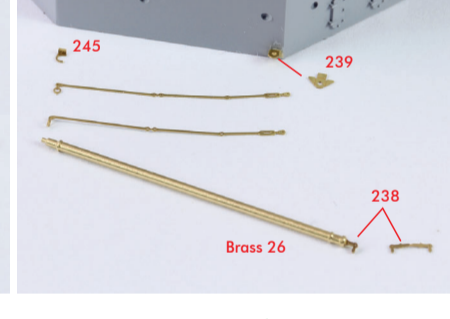
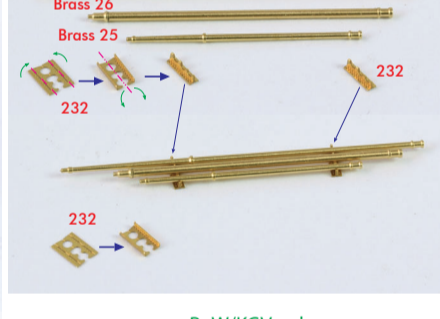
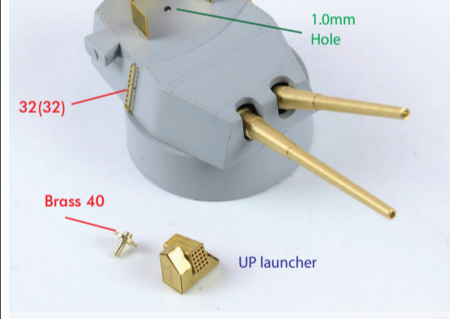
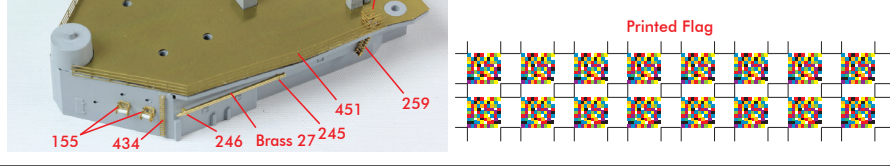
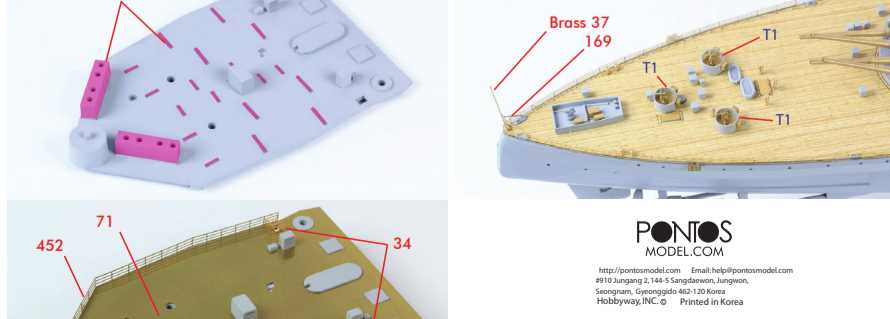
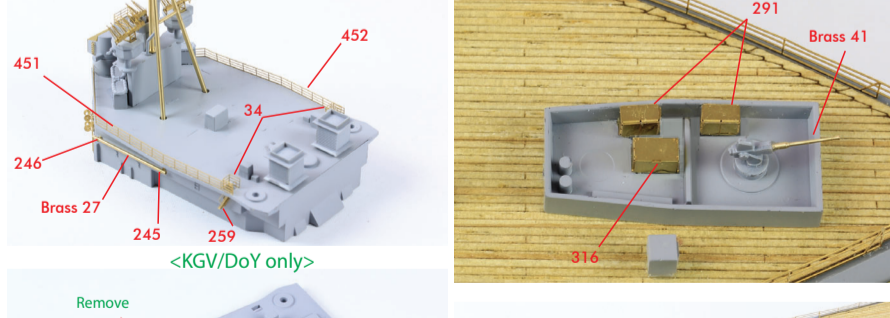
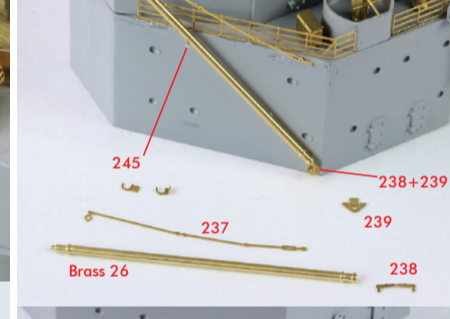
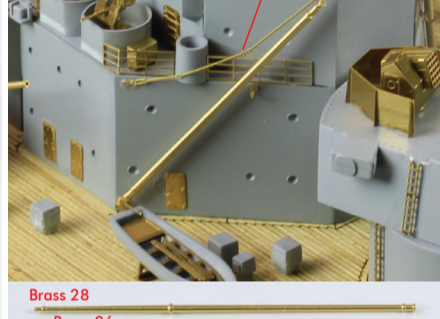
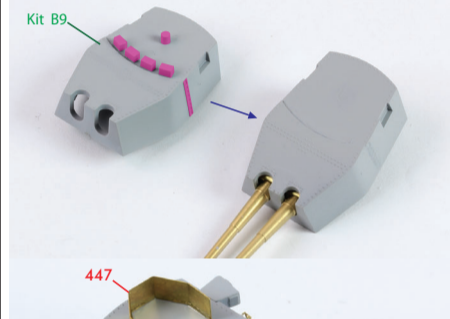
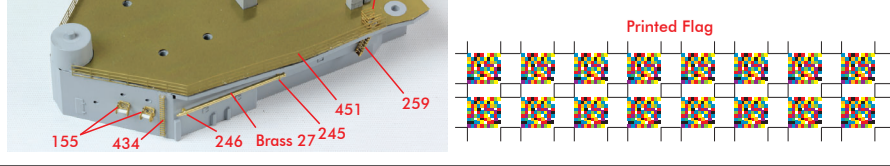
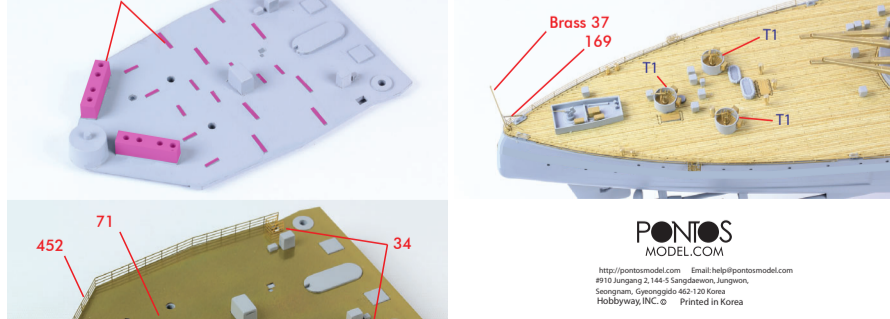
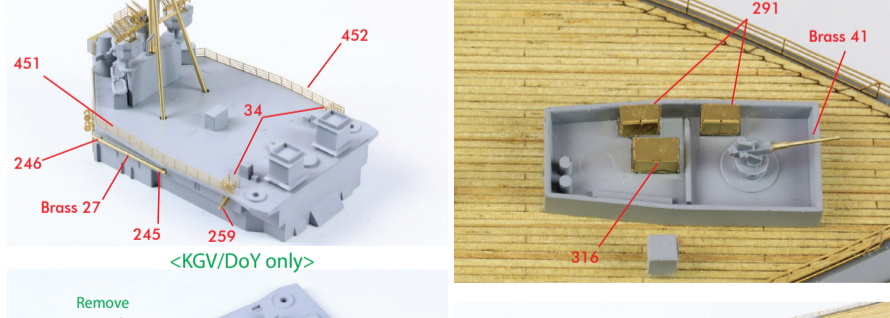
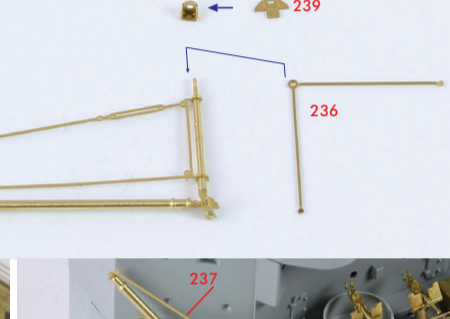
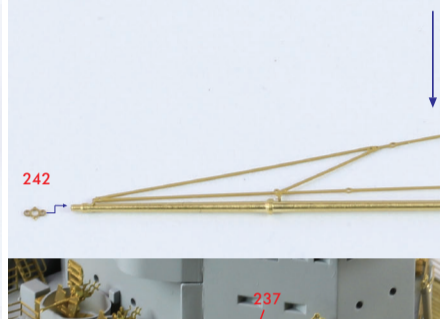
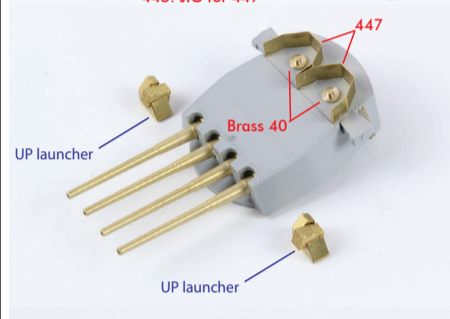
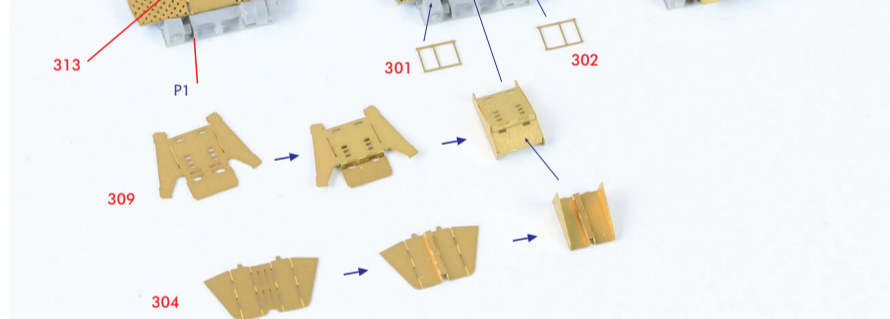
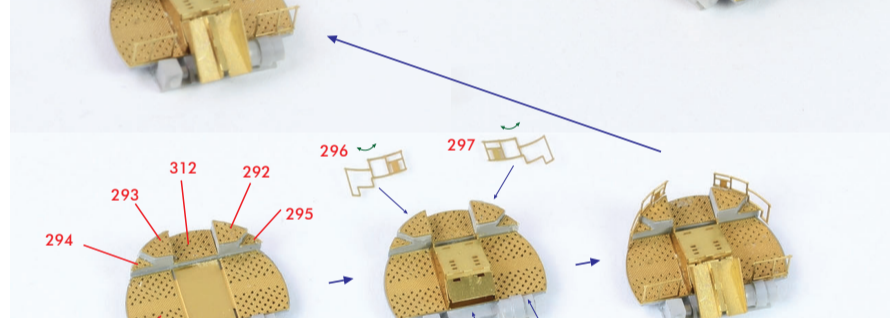
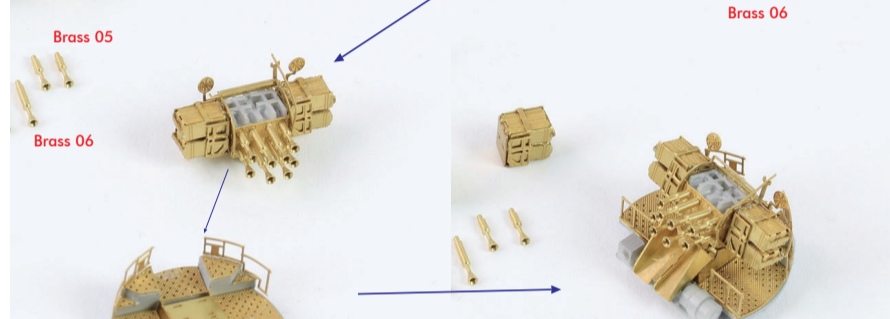
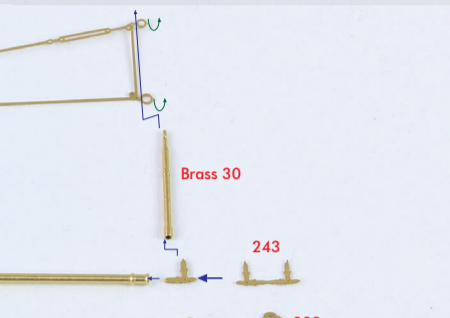
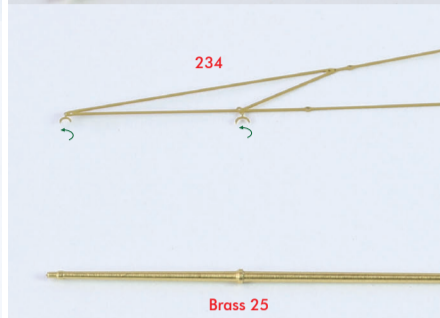
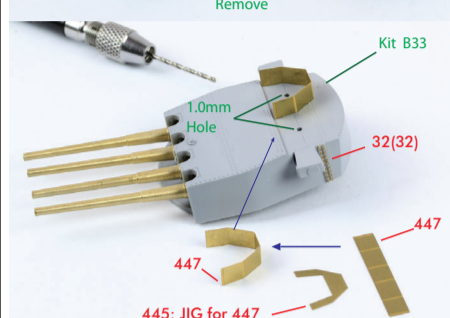
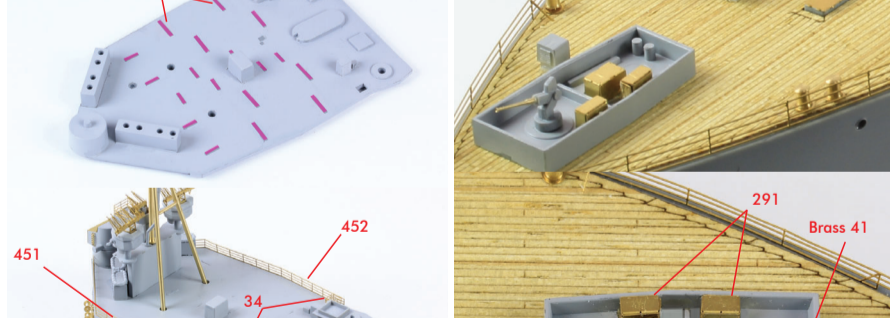
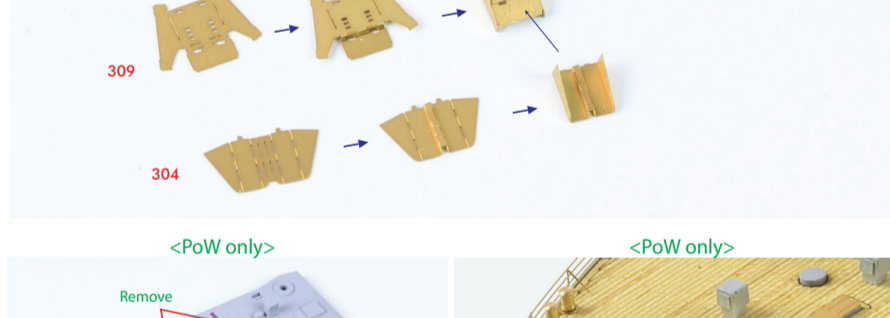
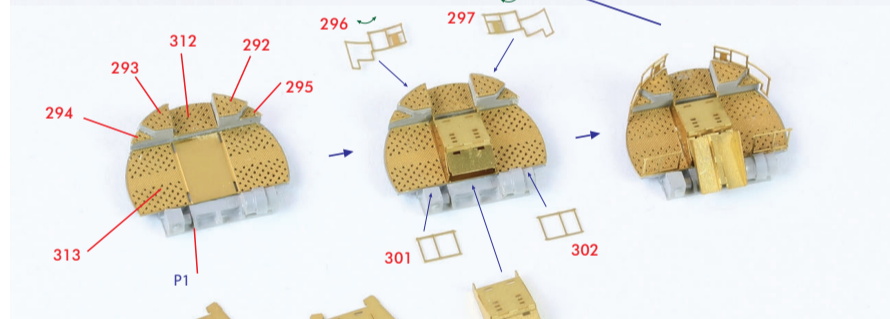
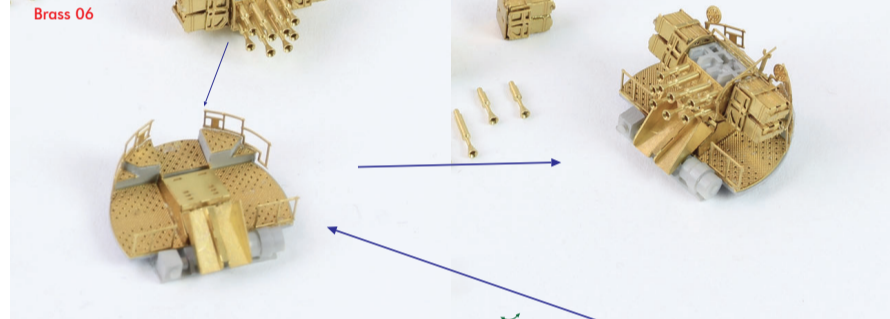
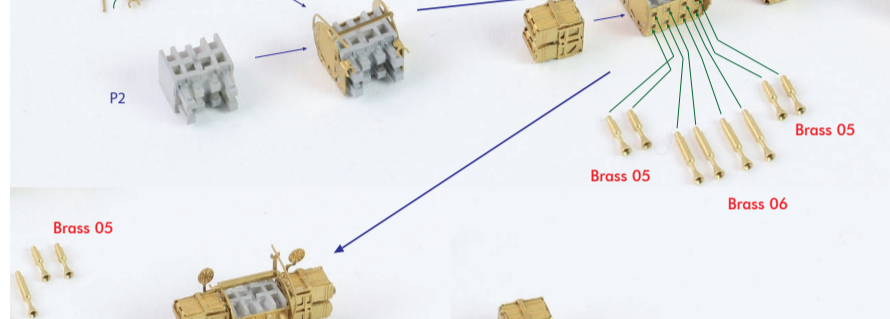
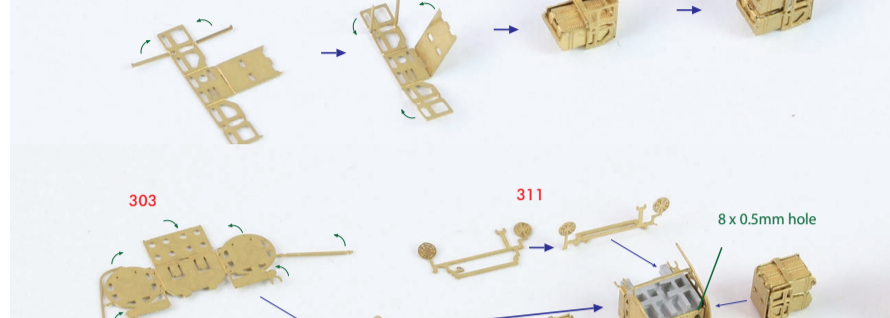
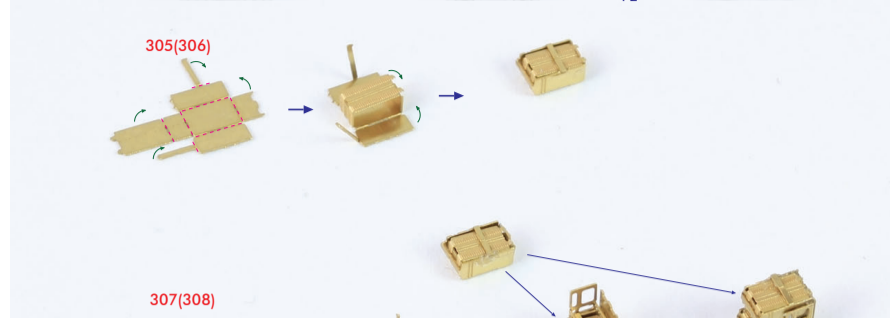
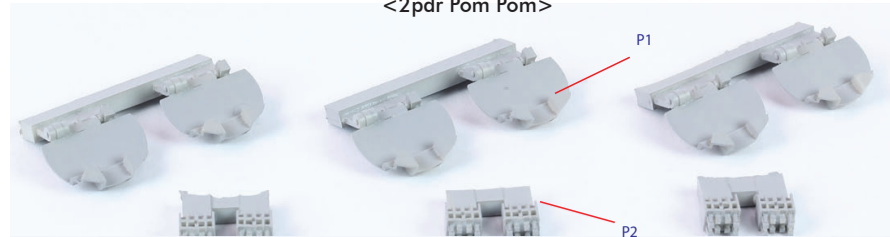
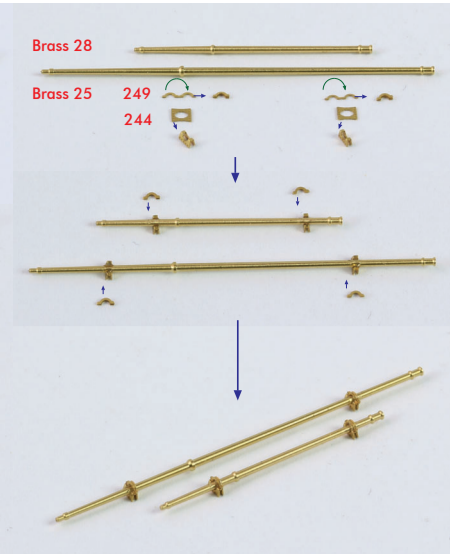
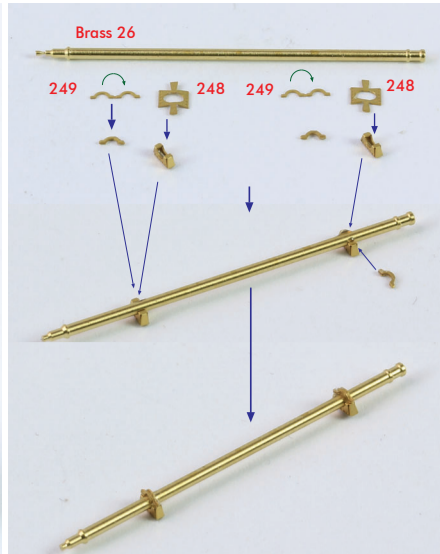
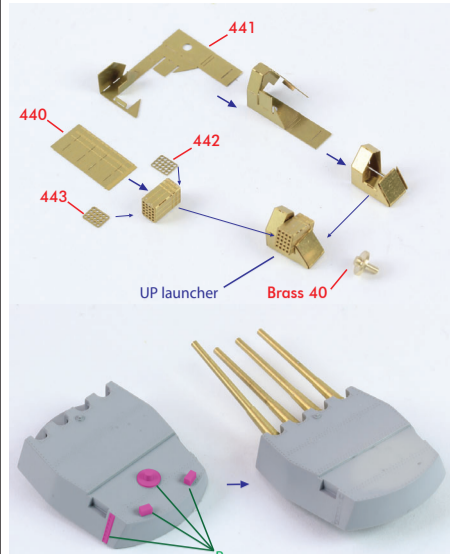

<Stern Up launcher > <KGV only>

<KGV 1941 December and DoY>

<PoW only>

<PoW only>

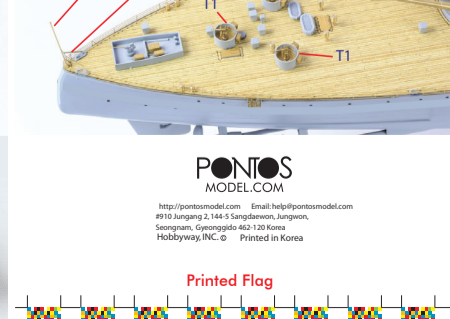
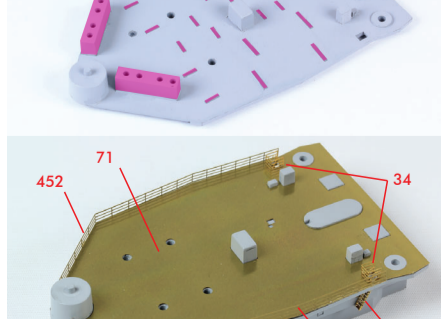
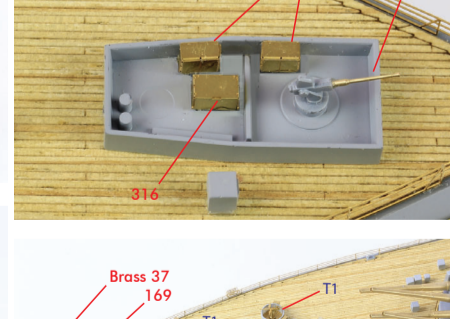
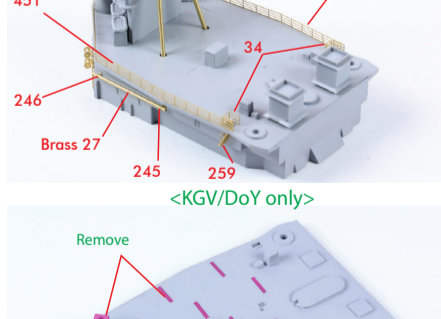
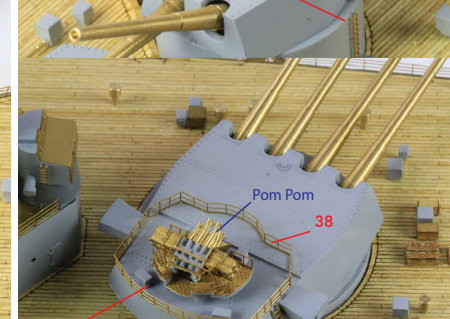
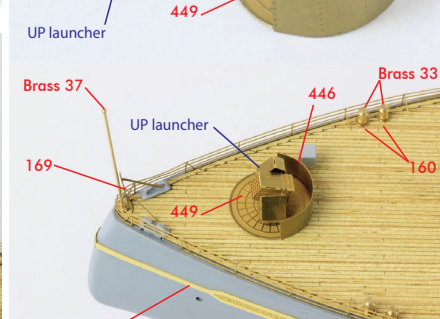
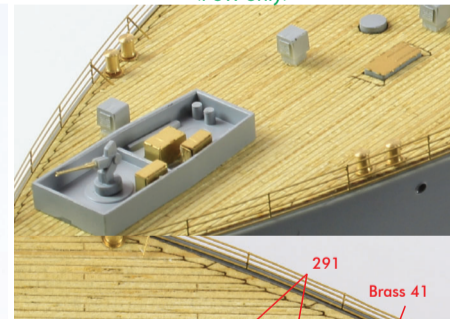
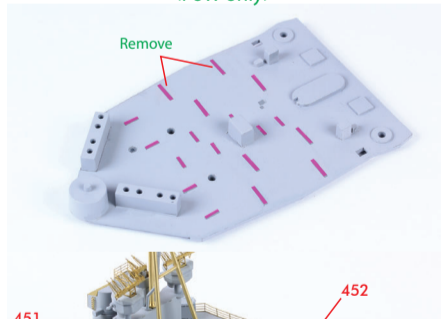
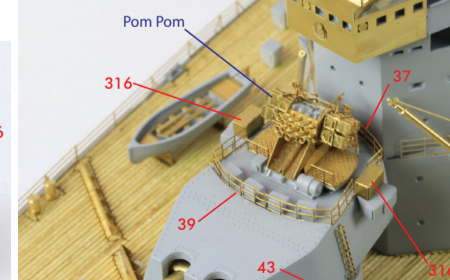
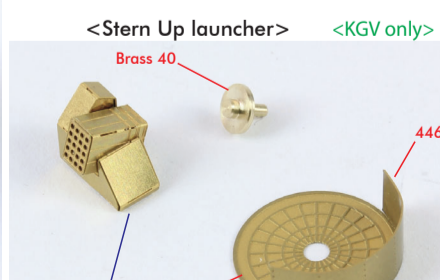

Printed Flag



PONOS MODEL.COM
<http://ponosmodel.com> Email: help@ponosmodel.com
 #112 Jungang 2, 144-5 Sanghwa-dong, Jungwon, Seongnam, Gyeonggi-do 461-120 Korea
 Hobbyway, INC. © Printed in Korea

<PoW / KGV (Degaussing Cables :KGV Only)>

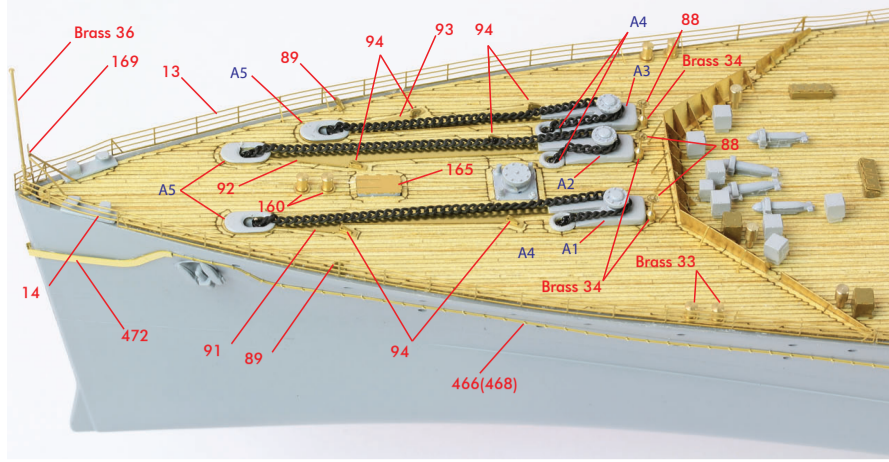

<DoW only>

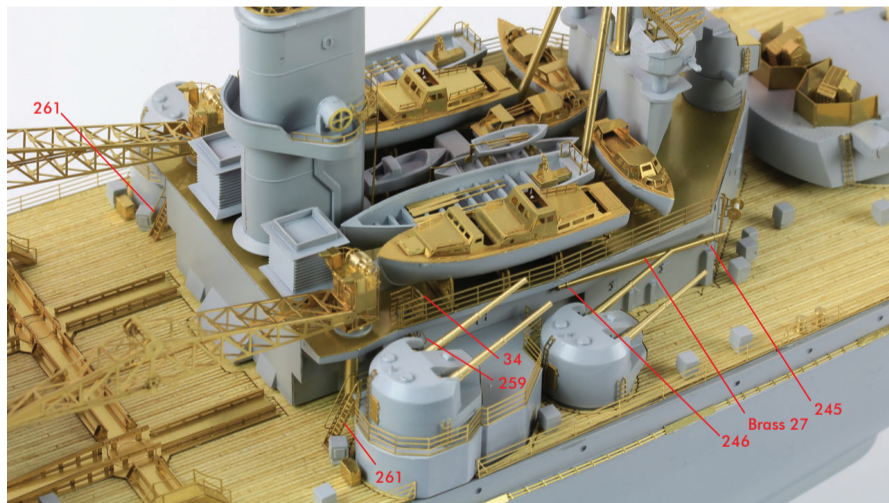
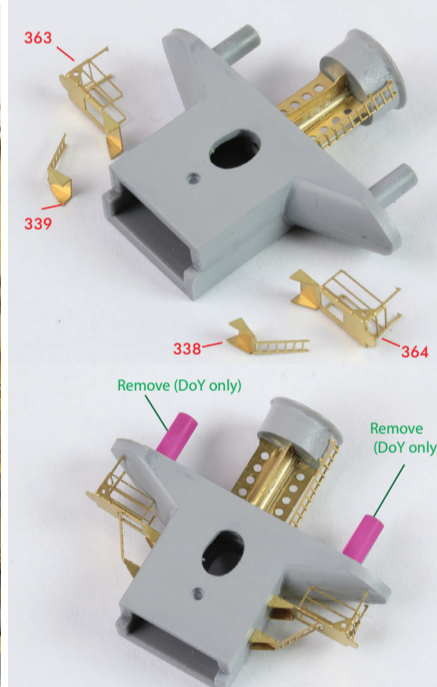
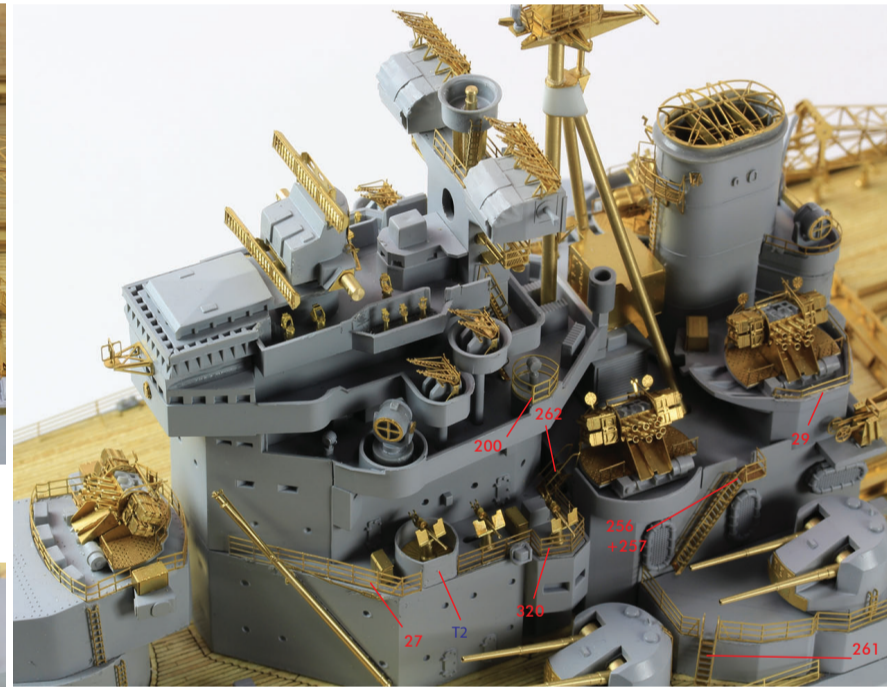
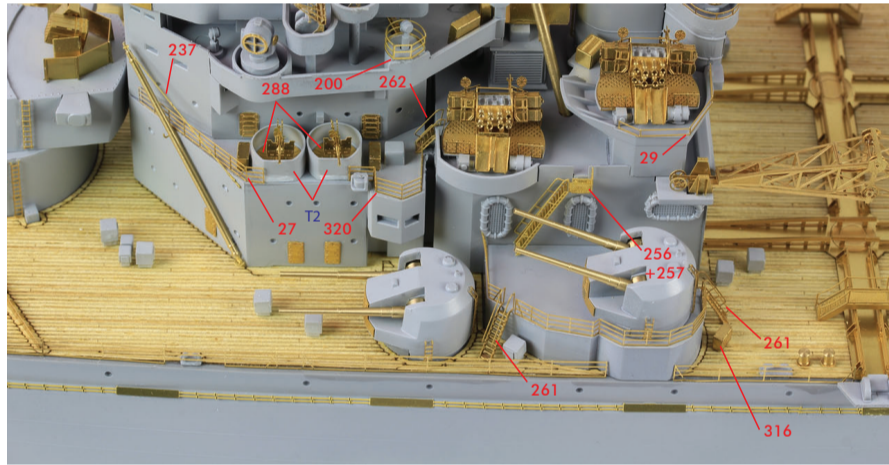
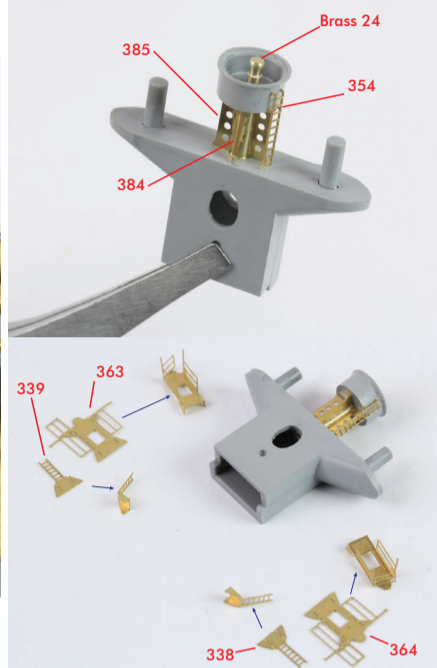
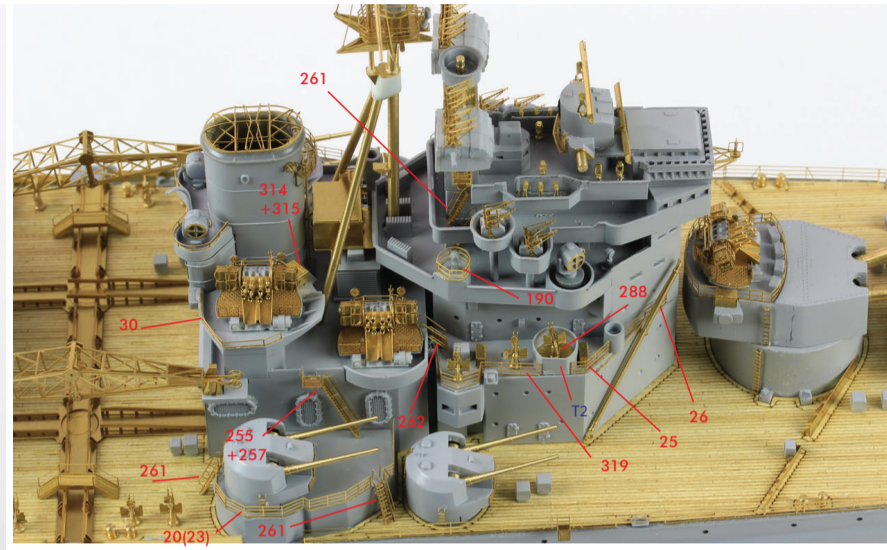
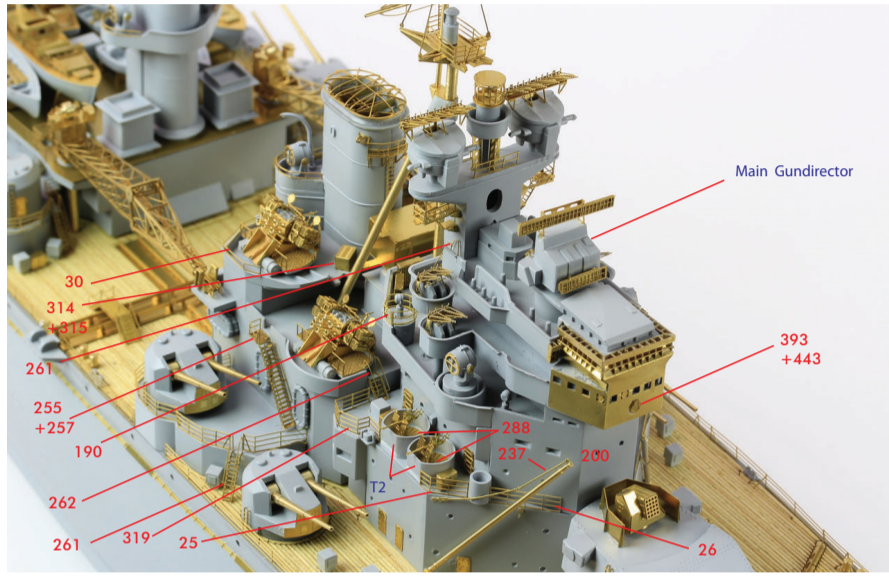
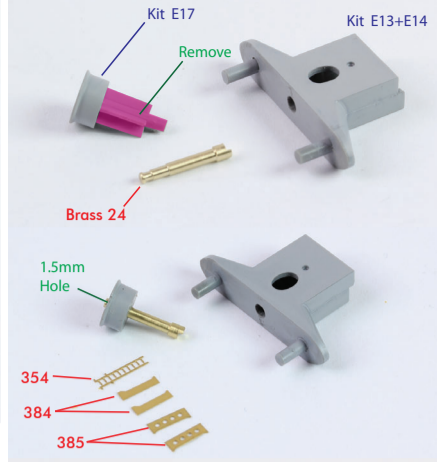
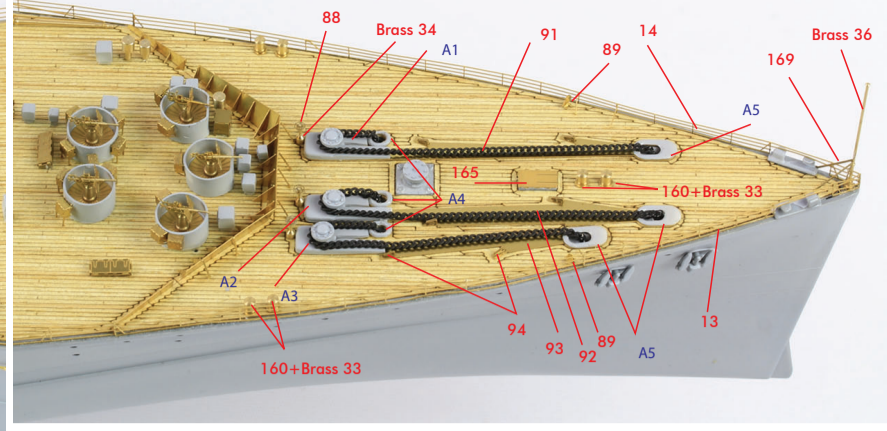

<Mast Joint & Anchor Chain parts>

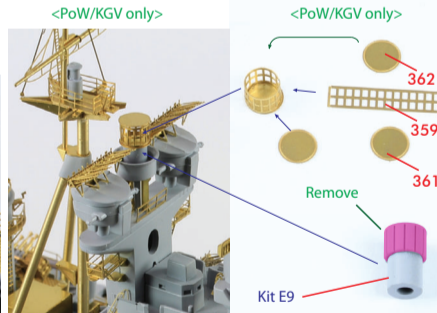
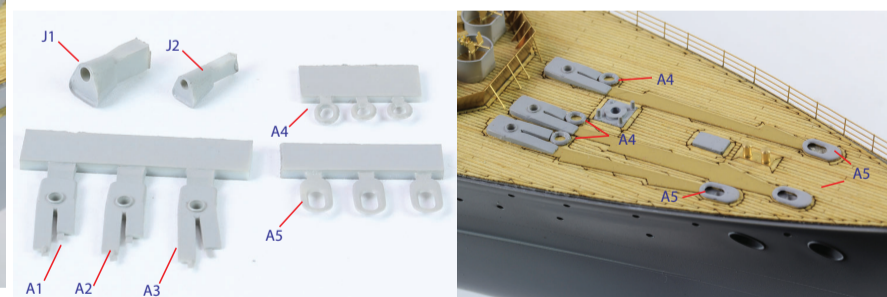

<Degaussing Coils : KGV Only>

