



WAH KEUNG MODEL

1:48 Government Flying Service Helicopter **S70 Black Hawk '48-01'**

The Hong Kong Government Flying Service (GFS) is the successor to the former Royal Hong Kong Auxiliary Air Force which disbanded on 1 April 1993. The GFS is one of seven Disciplined Services of the Hong Kong Government. Its two prime missions are Search and Rescue (SAR) / Casevac and Police Supports. Other regular taskings include VIP transport and photographic surveys.

The three powerful Sikorsky S-70A Blackhawks Helicopters were bought primarily for the Police, hence their unusual 'tactical' paint scheme. Two of them were delivered in December 1992 and the third arrived on December 1995.

GFSs' S-70As are equivalent to the United States' UH-60L Blackhawks. They all fitted with winches specially for SAR operations. A Bendix RDR-1400C colour weather radar has been added to the nose. It is also function as an efficient search radar. The GFS has also added a Spectrolab Nitesun spotlight that can be used in conjunction with the airmen's Night Vision Goggles. These NVGs are most often used when flying surveillance missions with the Police Force against suspected smugglers.

The Blackhawks have been active in ferrying elements of the Police SDU riot teams. Up to 19 fully-equipped policemen can be carried by these Blackhawks in one lift, plus three crew.

In 1995 GFS undertook 1,190 Casevac, 169 SAR and 105 fire-fighting missions and it will be maintaining that roles beyond 30 June, 1997!

香港政府飛行服務隊接替剛解散的皇家香港輔助空軍，於一九九三年四月一日成立，並繼續為市民服務。政府飛行服務隊是香港政府七個紀律部隊之一。他們的兩項基本任務是執行搜索與救援任務和公眾支援服務。除此之外還負責接載貴賓和空中測量攝影等任務。

三架強勁而優秀卓越的“塞科斯基”S-70A——黑鷹式直升機是從警隊預算中撥款購置，所以添上“戰術”保護顏色。其中兩架於一九九二年十二月抵港，而另外一架則於九五年年終運到。

政府飛行服務隊的S-70A黑鷹是美國空軍UH-60的外銷型號，三架黑鷹均裝置有適合搜索和救援用的設備。其中包括安裝於機鼻正中央的RDR-1400C型彩色顯示氣象及搜索雷達，機身左邊起落架前裝有強力探射燈，配合夜視頭盔系統，能於黑夜和能見度低的情況下執行所需任務。

黑鷹直升機經常配合警方執行特別任務，例如防暴、越南船民營騷亂及演習等。每一架黑鷹直升機除三名機組人員外，能運載多達十九名全副武裝的警察(包括特別任務連——SDU飛虎隊)執行任務，重載下的黑鷹仍保持靈活的操控性能。

一九九五年度內，香港政府飛行服務隊共接獲多達一千一百九十多次召喚，其中一百六十九次為搜索及救援任務，約一百零五次救火任務等。該隊即將順利渡過七月一日的交接，繼續為港人服務……。

1. MAIN ROTOR ASSEMBLY

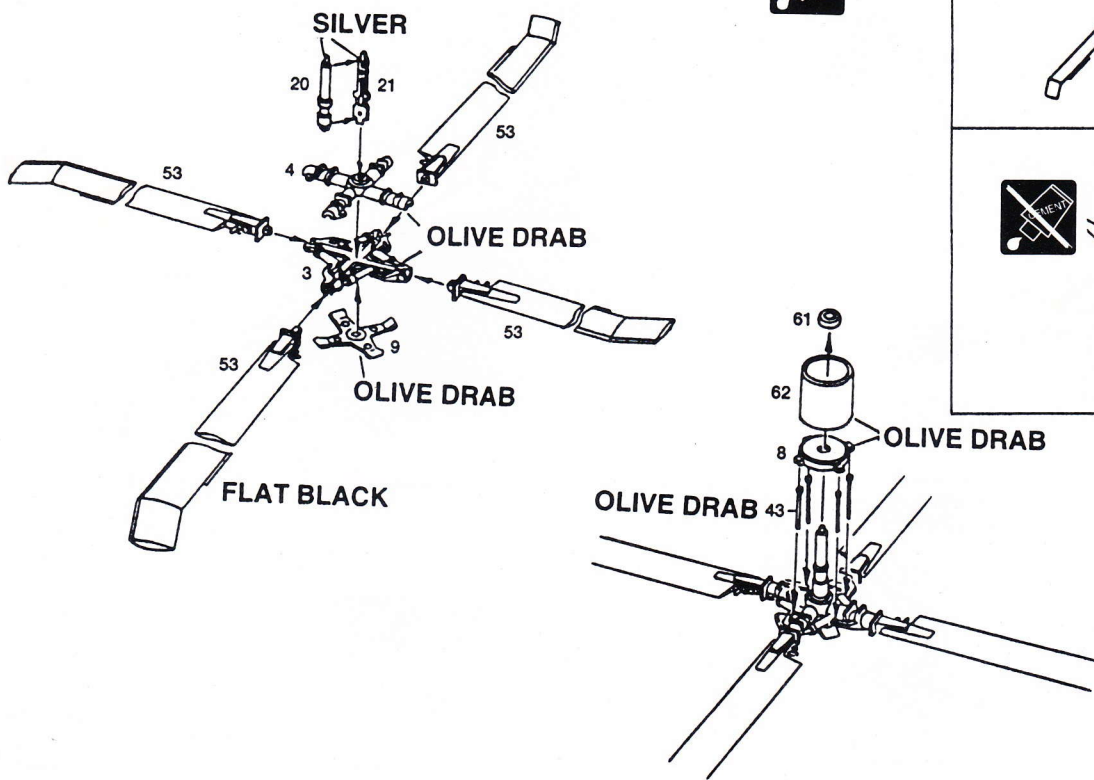

2. COCKPIT & INTERIOR ASSEMBLY

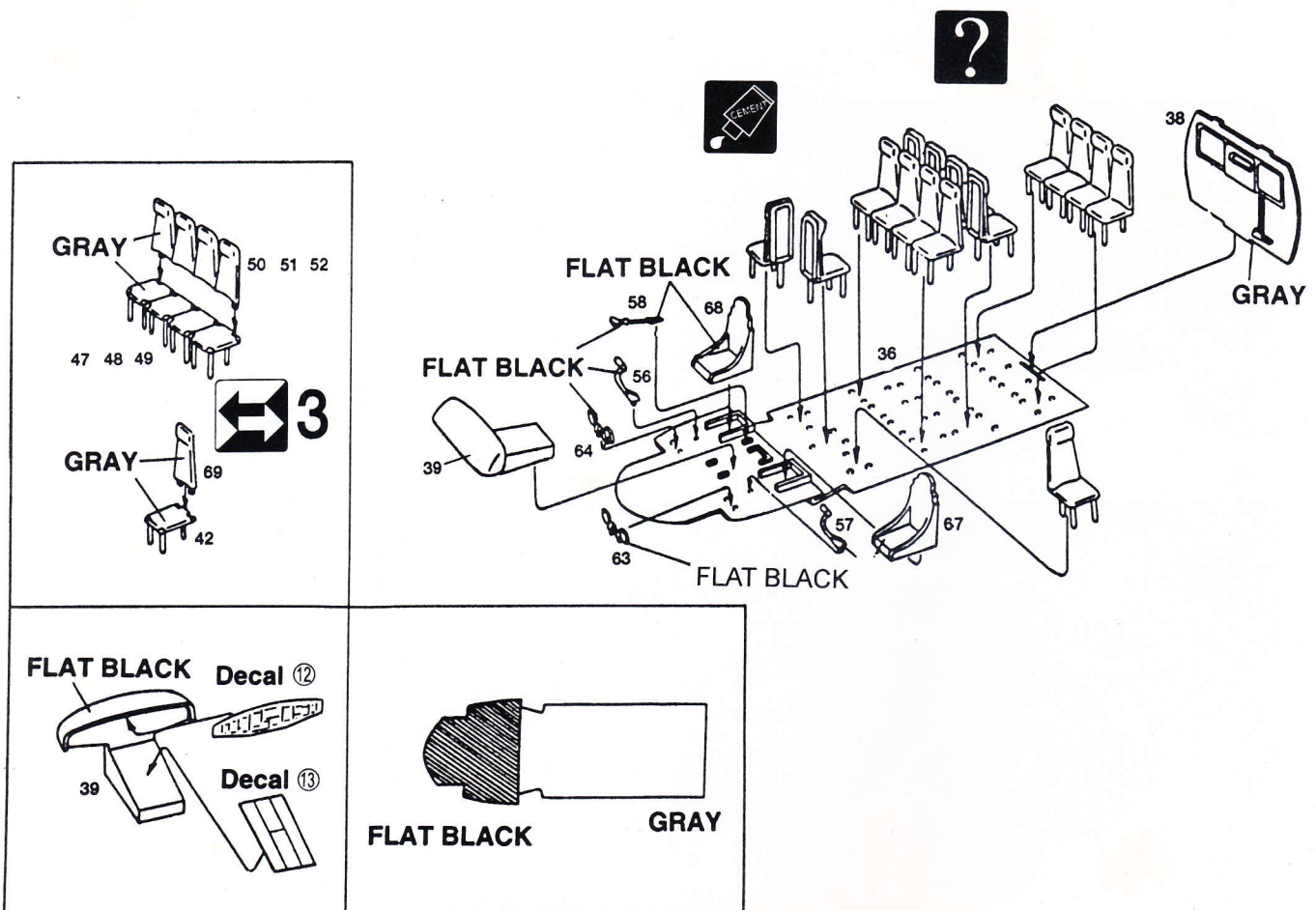

3. DOORS INSTALLATION

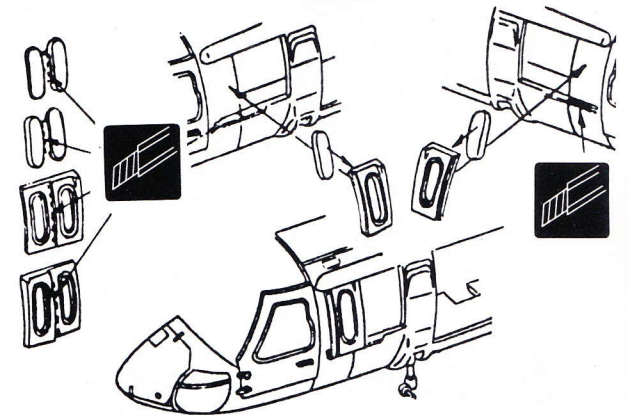
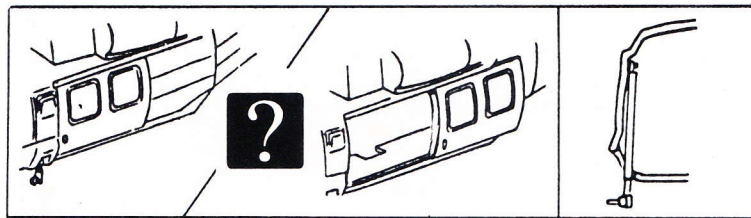
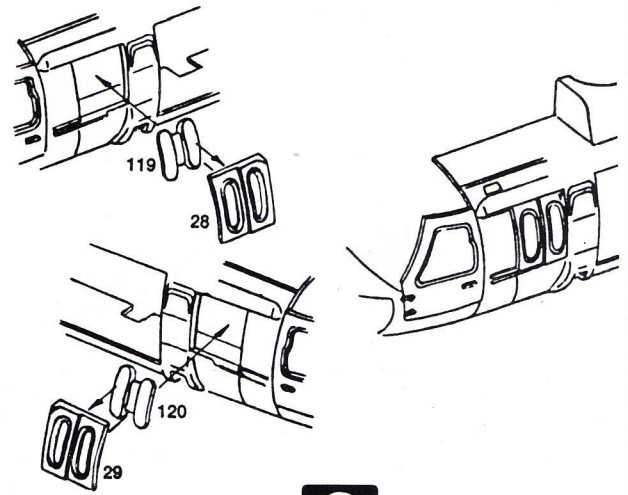
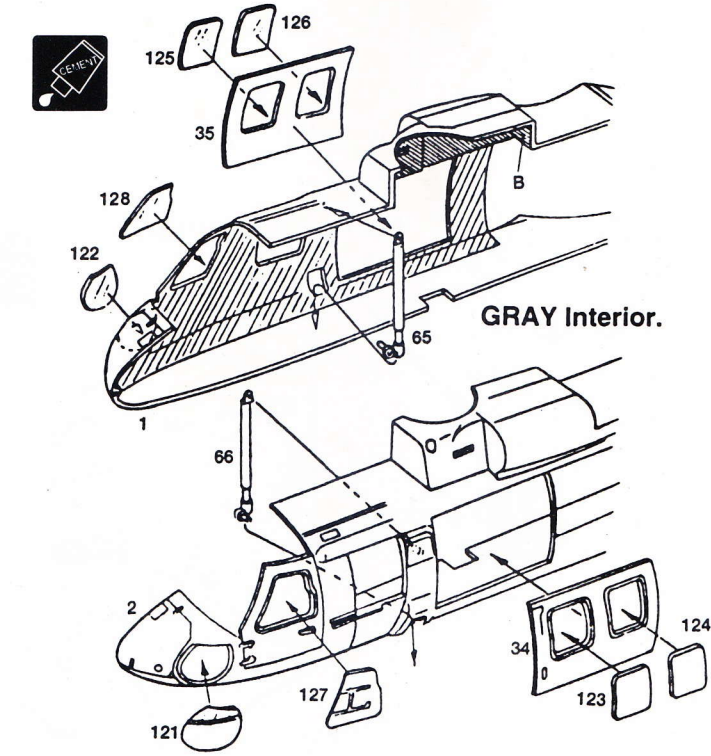

4. FUSELAGE ASSEMBLY & TAIL ROTOR ATTACHMENT

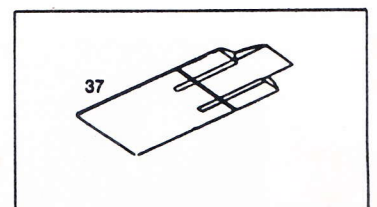
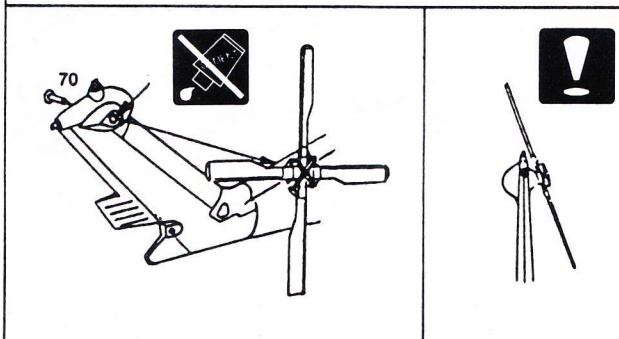
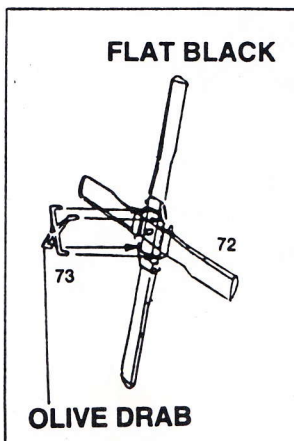
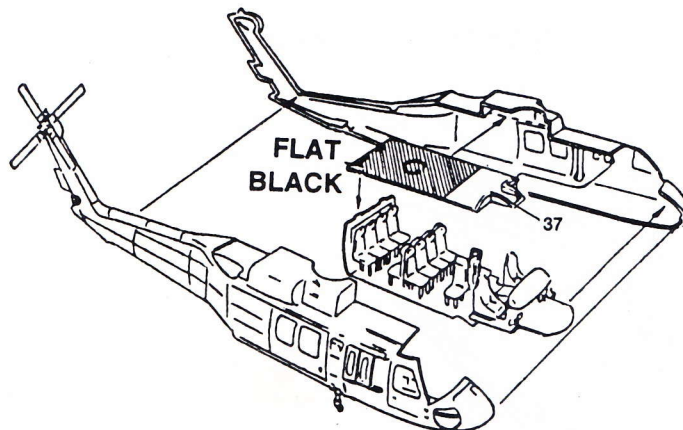

5. ENGINE ASSEMBLY

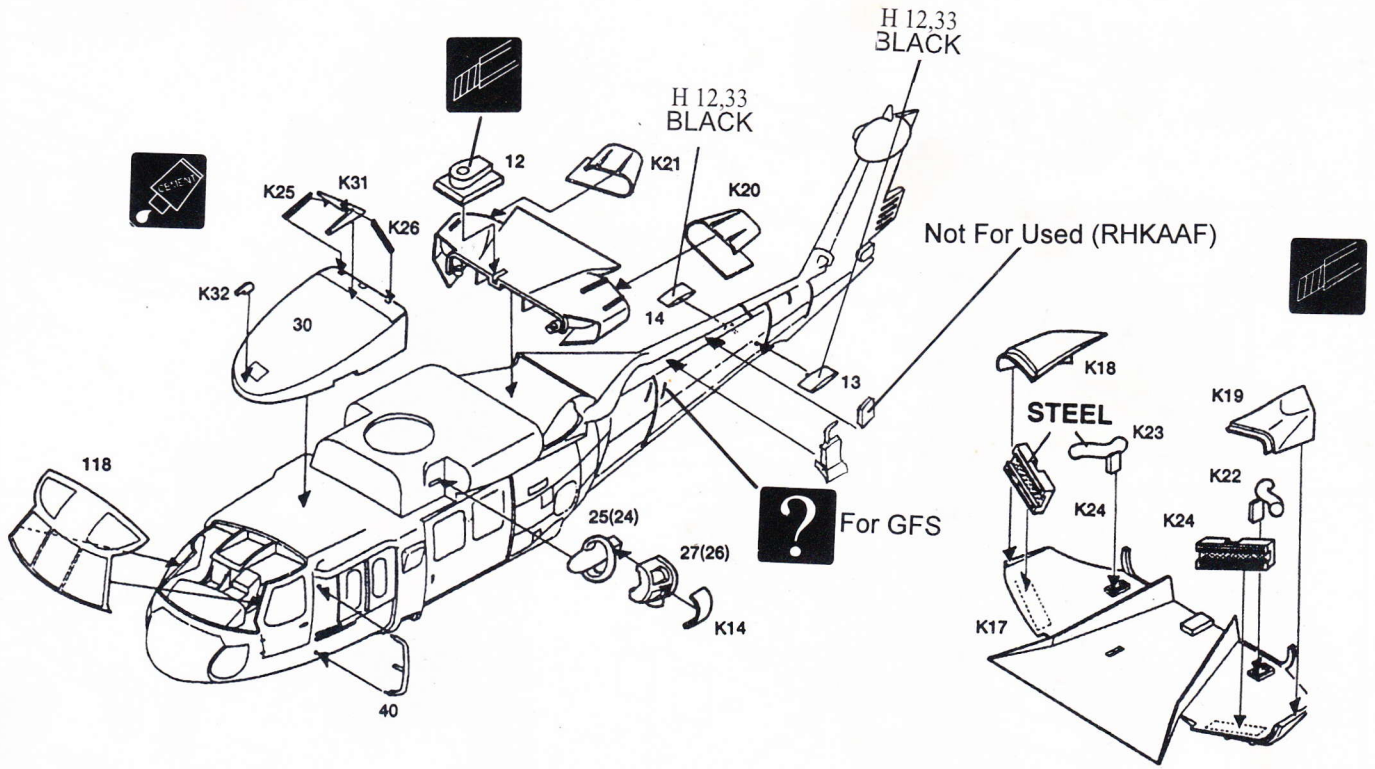

6. ELEVATOR ASSEMBLY & EXTERNAL FUSELAGE DETAILS

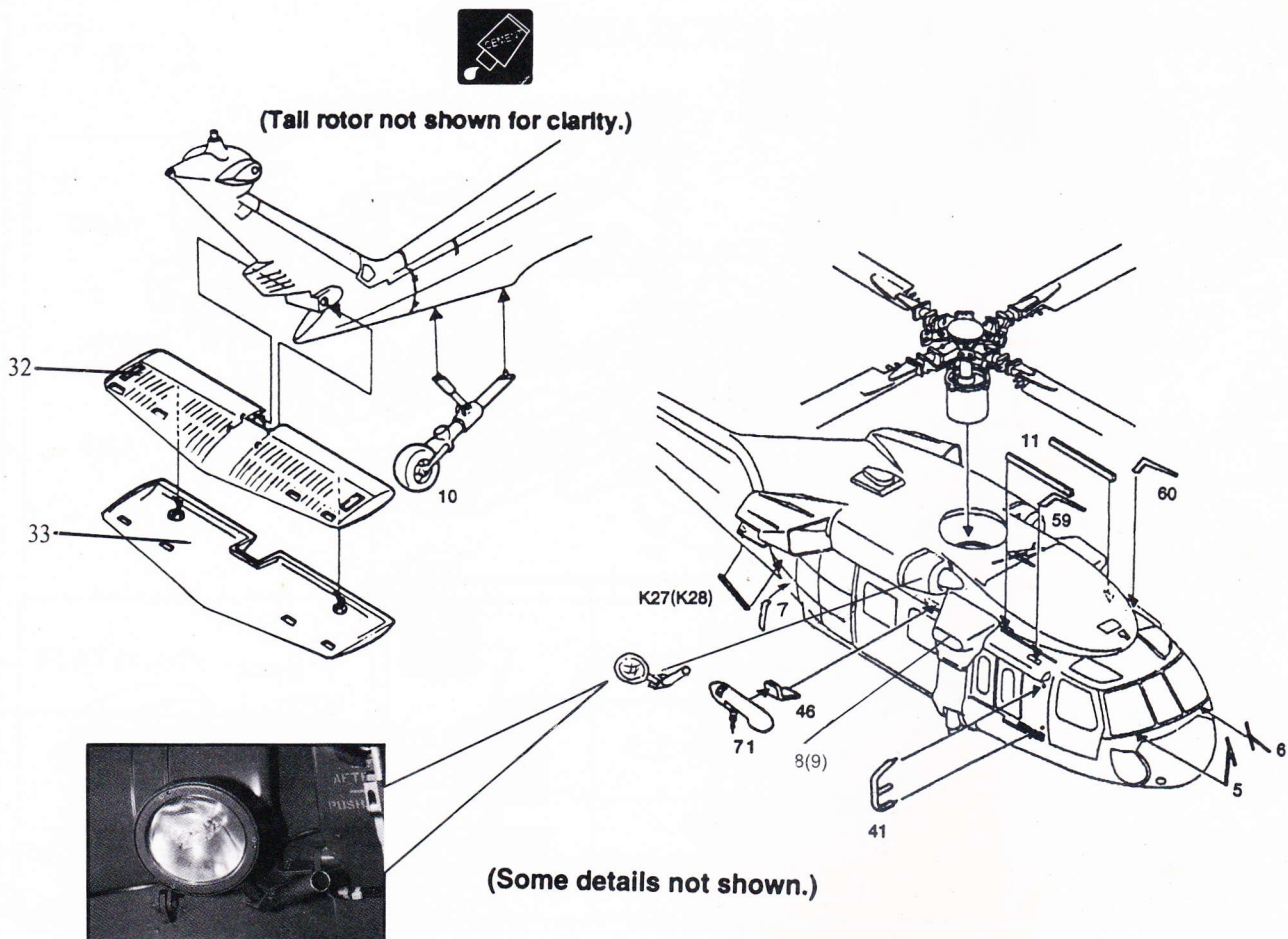

7. REFUELING & MAIN GEAR ATTACHMENT

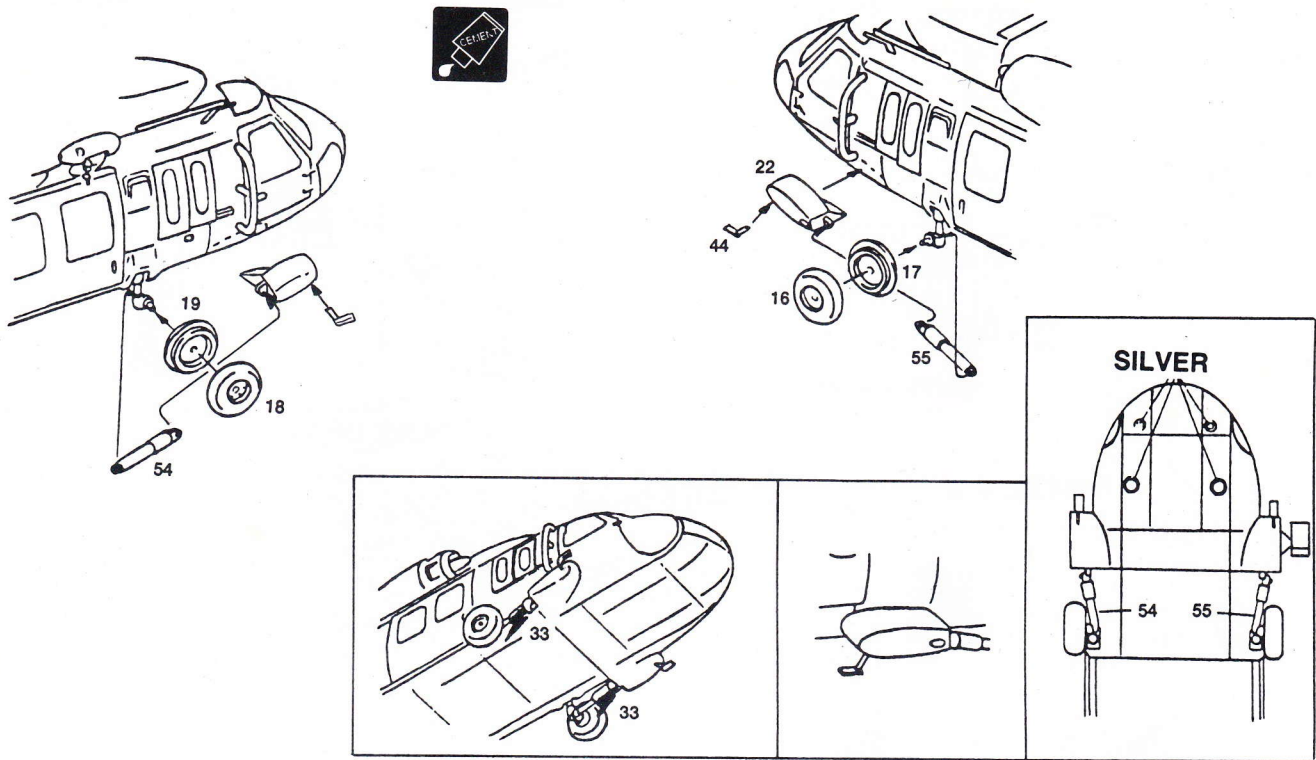

8. MAIN ROTOR AND FUEL TANK ATTACHMENT

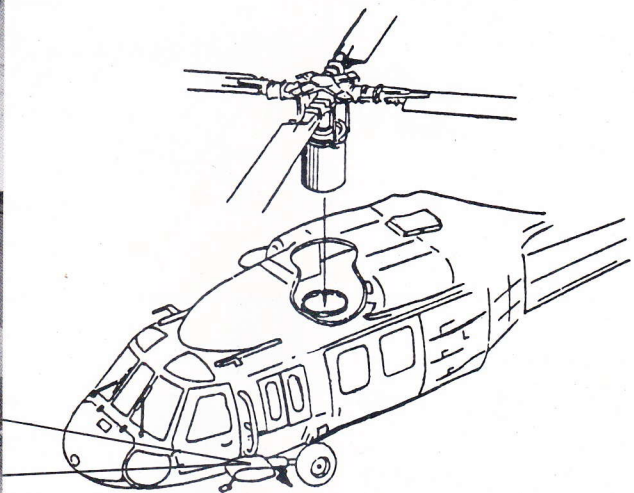
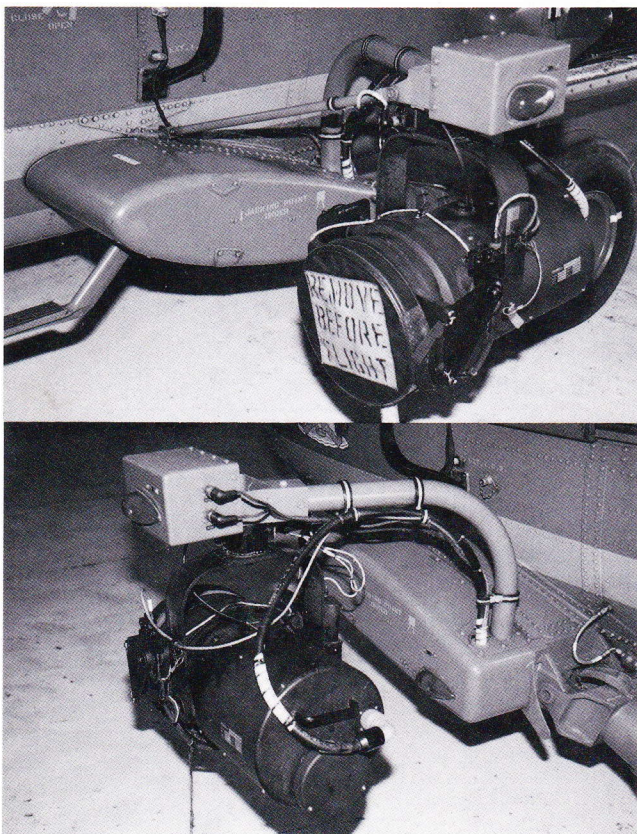

Marking & Painting

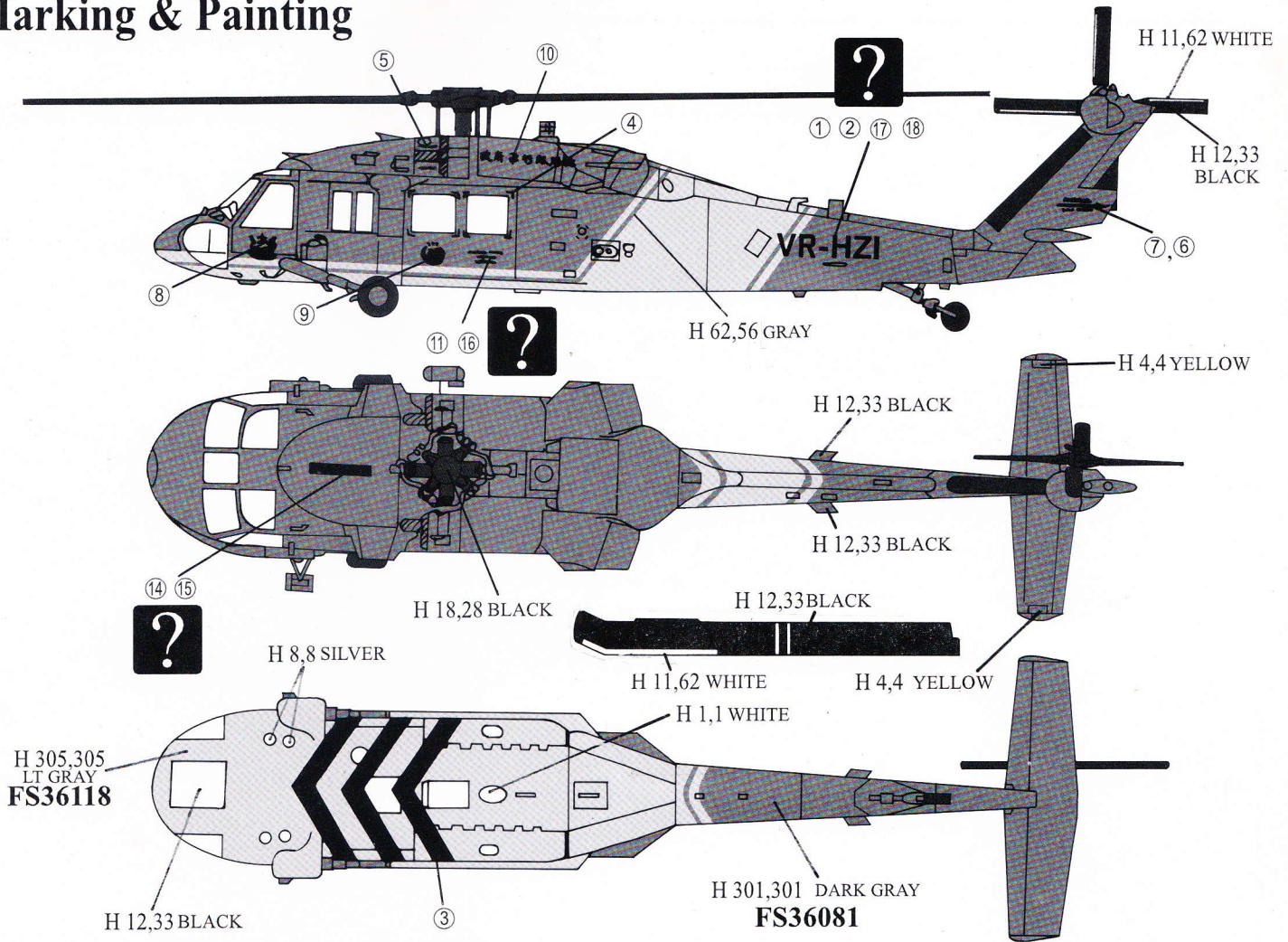

K

