



EN

The British army developed Infantry Carriers during the 1930's using modified Light Tank chassis for cross country speed and agility. Several different Carriers emerged during this time each designed to fill a specific roll, including the Bren Carrier, Scout Carrier and Cavalry Carrier. But in 1940 it was decided to build just one vehicle, the Universal Carrier, which could be modified for any role. The Universal Carrier Mk.I was built from 1940 to 1942 when it was replaced by the MkII version. This had a similar hull but had several detail changes made as a result of combat experience. The most important was the Stacy Towing Hitch, which allowed the MkII to tow the 6 Pounder Anti Tank Gun or small trailers. Welding was introduced to help waterproof the hull and the headlights were replaced by a smaller light mounted on the front hull. Stowage positions were revised to give more room in the rear compartments and steps were added to the hull sides for easier access. The Universal Carrier MkII first saw action in North Africa in 1942 and went on to serve on all fronts by the end of the war. Armour was 7-10mm thick and the combat weight was 4 tons. A Ford V-8 85bhp engine gave a maximum speed of 52 km/h on paved roads and a range of 250 km.

Short story by Phil Greenwood

★ ★ ★

DE

Das britische Heer entwickelte seit den 1930er Jahren verschiedene geländegängige Truppentransporter auf der Basis von leichten Panzern. 1940 entschied man sich für einen einzigen Typen als Universaltransporter, welcher für verschiedene Aufgaben angepasst wurde. Die von 1940 bis 1942 gebauten MkI wurden von dem MkII abgelöst. Der Aufbau war ähnlich, zeigte aber einige Neuerungen aufgrund der Einsatzerfahrungen. Die wichtigste Veränderung war die Stacy Kupplung zum Zuge der 6 Pfünder PaK oder kleinen Anhängern. Geschweißte Bleche halfen gegen eindringendes Wasser, eine kleinere Lampe ersetzte die Scheinwerfer. Die Gepäckabteile wurden überarbeitet, um mehr Platz zu schaffen und kleine Einstiegshilfen erleichterten das Aufsitzen. Nach den ersten Einsätzen in Nordafrika waren die MkII an allen Fronten zu finden. Die Panzerung war 7-10mm stark, das Gefechtsgewicht betrug 4 Tonnen. Ein Ford V-8 Motor mit 85 PS erlaubte 52 km/h auf ebenen Böden und eine Reichweite von 250 km.

© Translation Michael Knoblich ACADEMY EUROPE GmbH

★ ★ ★

CN

英国军方在上世纪三十年代末利用改造轻型坦克底盘发展出一系列步兵装载车，以期提升越野速度及机动性。期间出现包括‘布朗’式班用轻机枪装载车、侦察员运输车、和游骑兵运输车。在1940年英国当局决定制造一种单一多功能通用的履带装载车辆以适合各种不同任务的需要。全能履带装载车Mk. I型在1940到1942年被生产出来，其后被Mk. II型所替代。二者具有相似的车体，但是功能有异以适应各自作战需要，有相当部分的细节改变，最主要的是追加尾部拖曳钩，可以用Mk. II来牵引6磅反坦克炮或小型拖车，车体周边都焊接有防雨布篷，车首大灯更小些，后部储物隔舱空间调整更大空间，侧面增加方便登车的脚踏方便。Mk. II型首次参战于1942年北非战场，然后参加各场战役直至二战结束。其装甲厚度是从7-10mm，作战总重是4吨。该车的动力是由一台福特V-8 85 bhp引擎所提供，最高速度可达每小时52公里和有250公里的续航力。

★ ★ ★



**CORRECT METHOD FOR APPLYING DECALS:**

1. Clean model surface with wet cloth.
2. Cut out of decal sheet and dip them in cold water for 15 seconds.
3. Place it on proper position on model.
4. Slide off base paper leaving decals on model with wet finger tip.
5. Move decals to exact position, push out excess water under decal with soft cotton cloth.
6. When decals get dry then complete.

**正确贴水上贴纸的方法:**

1. 将模型表面擦干净。
2. 将贴纸剪下泡入清水中约15秒。
3. 将泡湿之贴纸取出置于欲贴处旁。
4. 用指尖轻推贴纸表面使其滑出底纸。
5. 将贴纸调整至适当位置并轻擦拭水份。
6. 待其自然干燥后即完成。

**READ BEFORE ASSEMBLING:**

- ★ When you use glue or paint, do not use near open flame, and use in well ventilated room.
- ★ Keep plastic model glue and tools away from children.
- ★ Glue, paints and tools are not included in the kit.
- ★ Remove all injection pins carefull using a modeling file.

**组装前必读:**

胶水或油漆勿接近火源，并打开窗户保持空气流通。  
 胶水、油漆及工具勿让小孩接触。  
 胶水、油漆及工具不包含在模型内。  
 小心用专业锉刀锉平所有多余胶料。

**ICON INSTUCTION 图标说明:**

 Bend 弯曲	 Optional 选择采用	 Apply Decal 贴上水贴纸	 Weight 配重	 Open Hole 钻孔	 2 Sets needed 同样的制作二组
 Remove 切除	 Attention 请注意	 Do not cement 不用粘合	 File/Sand 锉平	 Fill Hole 把孔填平	 Instant Glue For Metal 瞬间接着剂金属用

限中国大陆 Mainland China Orders Only Please!

部品名称	数量	单价 (RMB)	总计	部品名称	数量	单价 (RMB)	总计
A版零件		20		Decal 水贴		5	
B版零件		10		Pa 蚀刻片		8	
C版零件		10		Pb 蚀刻片		10	
D版零件		16		Chain 细链		4	
L版零件		20		Thread 棉绳		1	
N版零件		20					
G版零件		15					
H版零件		8					
J版零件		8		EMS 快递 — RMB 20 (请填写) 总计 RMB _____			
K版零件		8					
M1版零件		1		零件补充原因: (请于 <input type="checkbox"/> 打√) 原包装即 <input type="checkbox"/> 遗失或 <input type="checkbox"/> 毁损 制作途中 <input type="checkbox"/> 遗失或 <input type="checkbox"/> 毁损 其他原因 _____			
M2版零件		1					
M3版零件		1					
Wg3版零件		5					
Wh版零件		5					



**RV 35027**  
零件补充申请表

**申请人**

姓名: \_\_\_\_\_

电话: \_\_\_\_\_

邮箱: \_\_\_\_\_

地址: \_\_\_\_\_

请依本表将金额寄于我司或  
登陆公司网站与我们联系，  
我们会尽快为您处理。

**A** x1

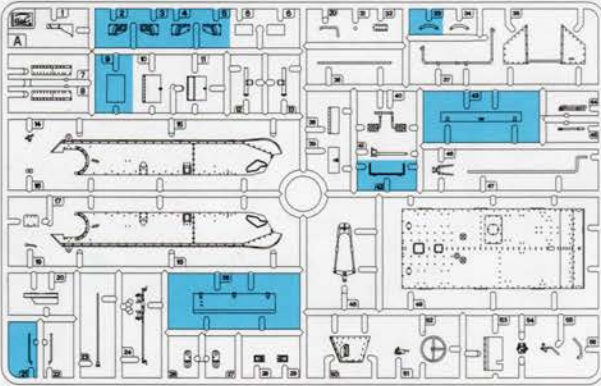

**B + C** x2

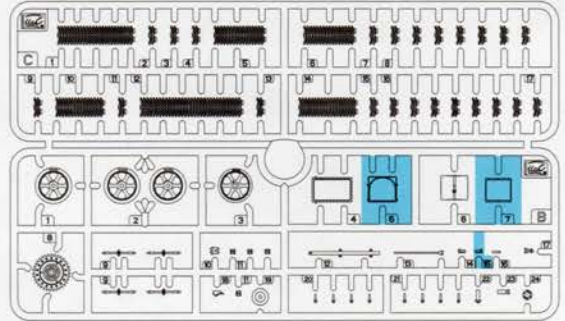

**L** x1

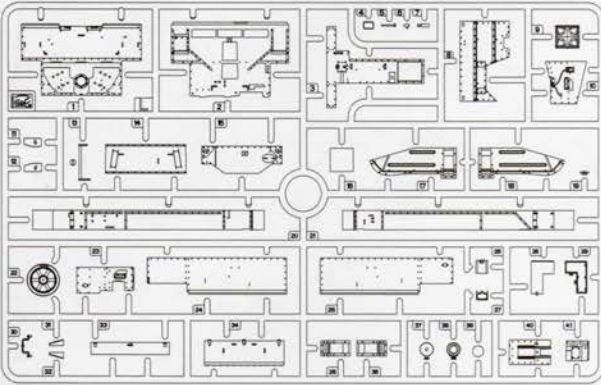

**N** x1

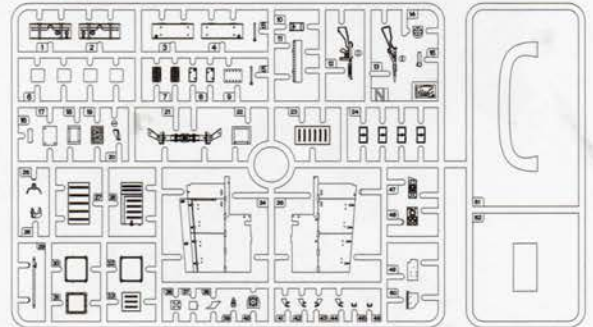

**Wgs** x1

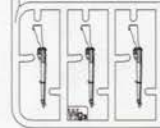

**Wh** x1

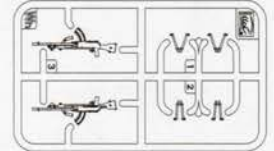

**D** x1

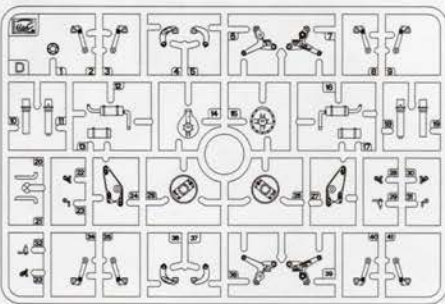

**K** x1

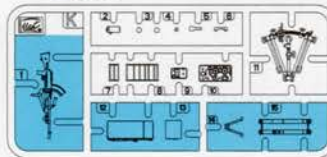

Decal x1

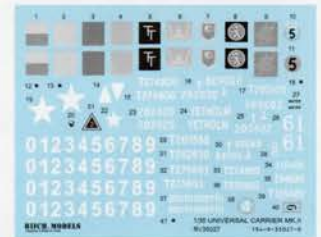

**G** x1

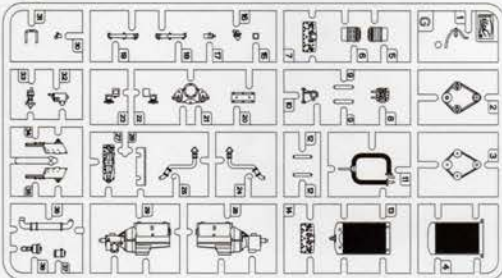

**J** x1

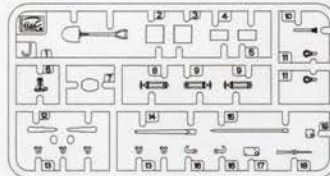

**Pa** x1

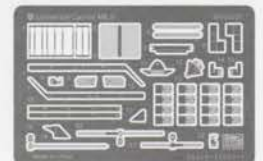

**M1** x8

Chain  
细链 (8cm)

**M2** x16

**M3** x16

**Pb** x1

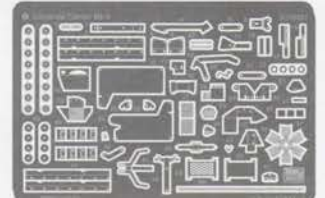

**H** x1

Thread  
细绳 (50cm)

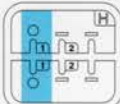

No used  
不使用的部件



1 Engine assembly  
发动机组装

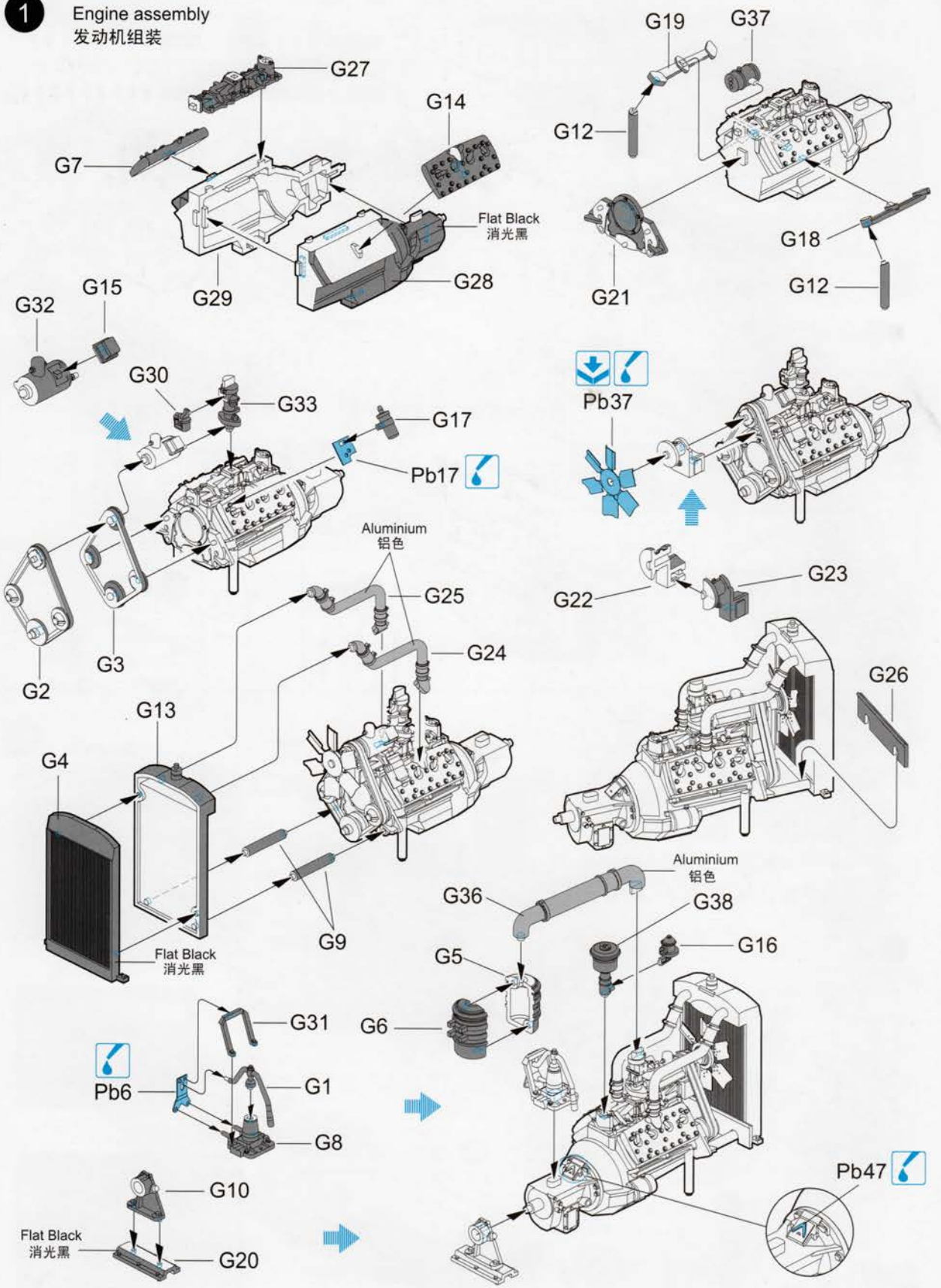

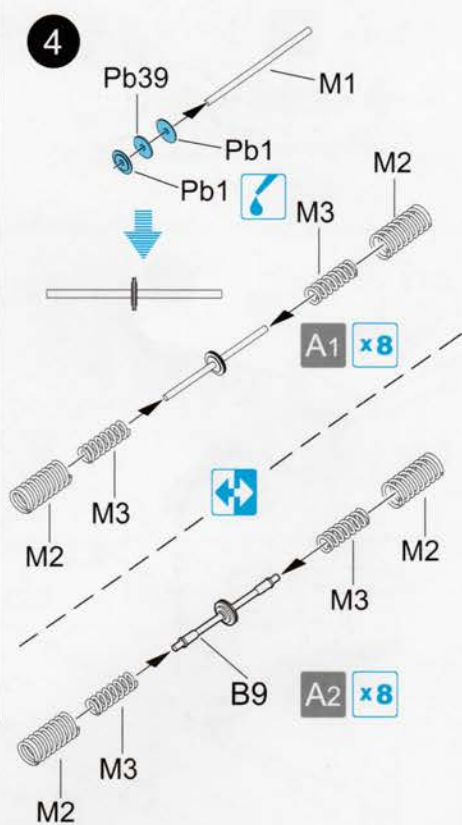
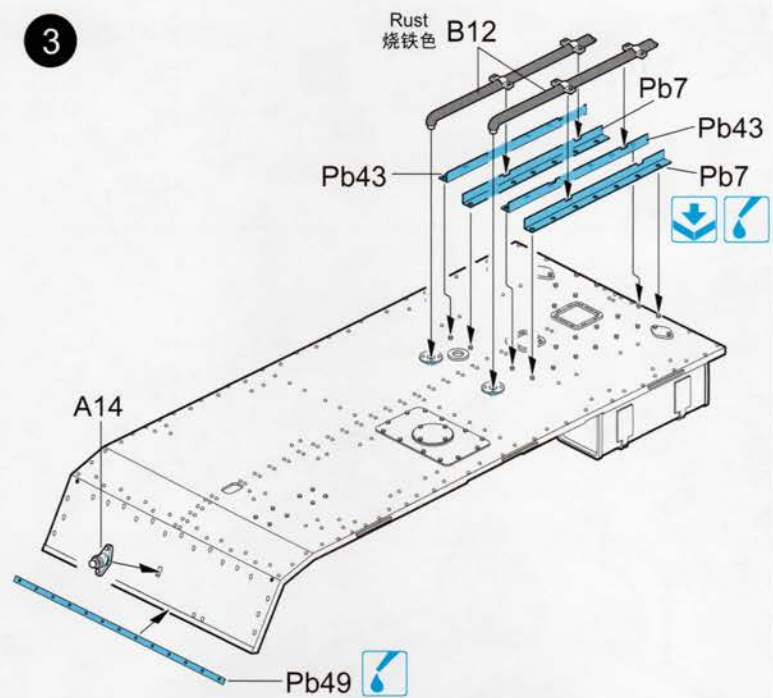
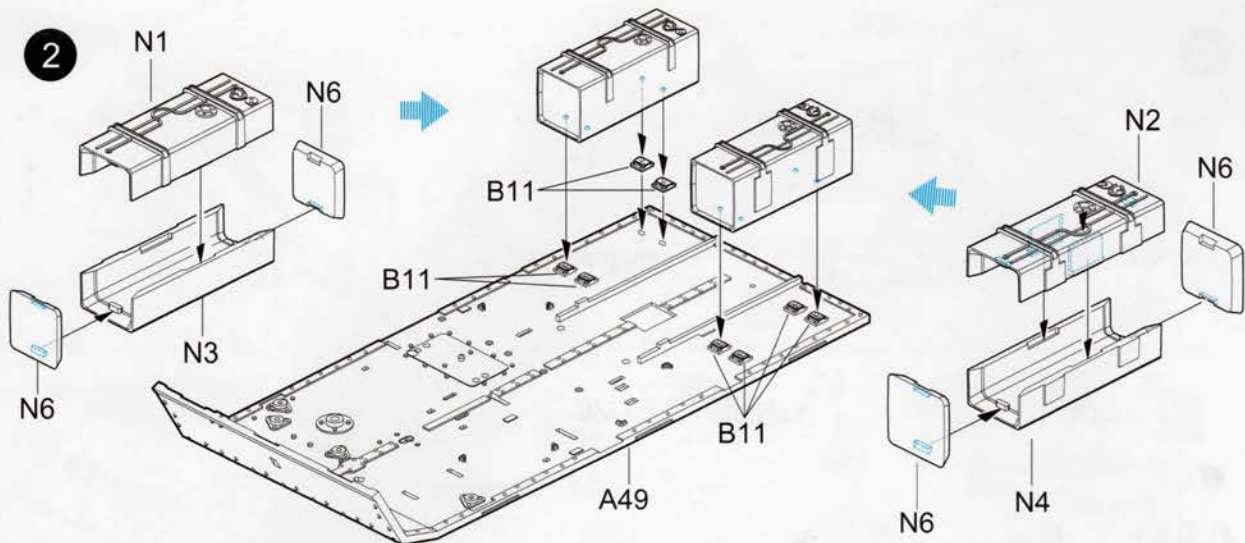

Cut B20、B21, when use **A1**  
使用 **A1** 时, B20、B21 切除

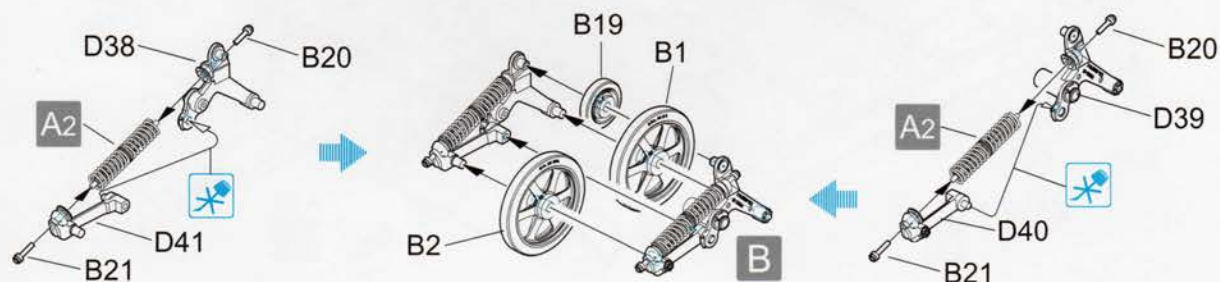



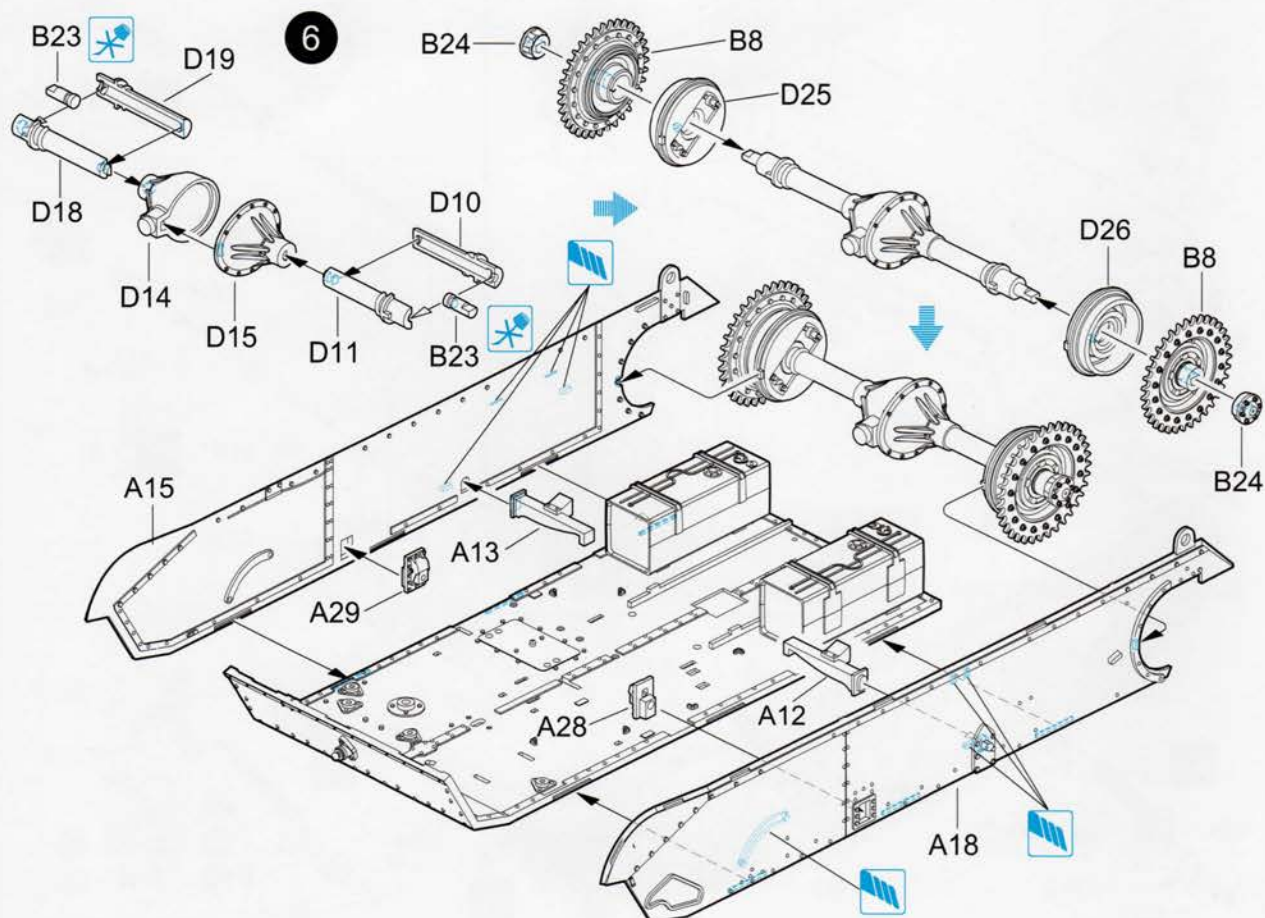
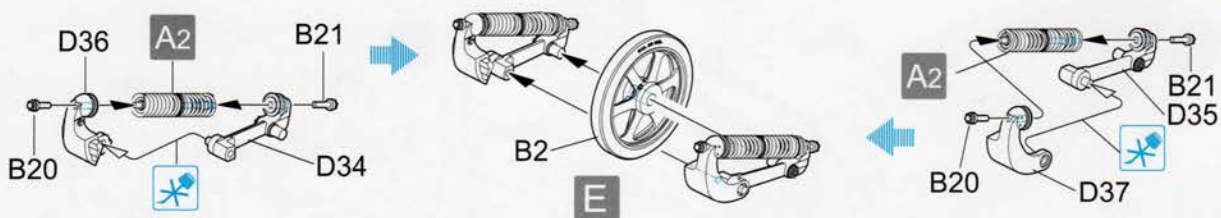
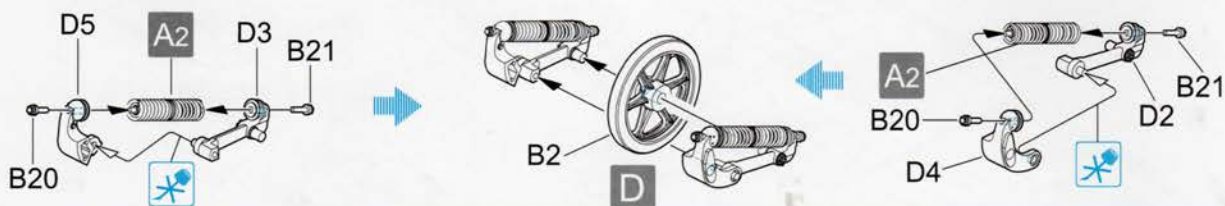
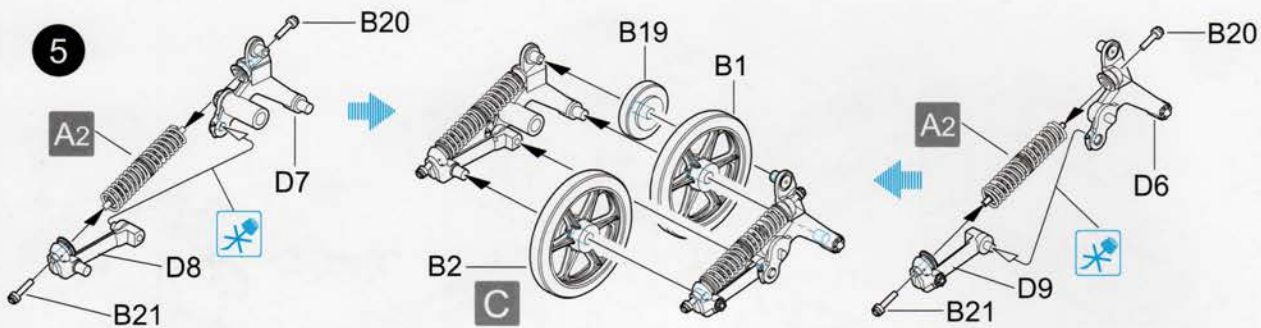

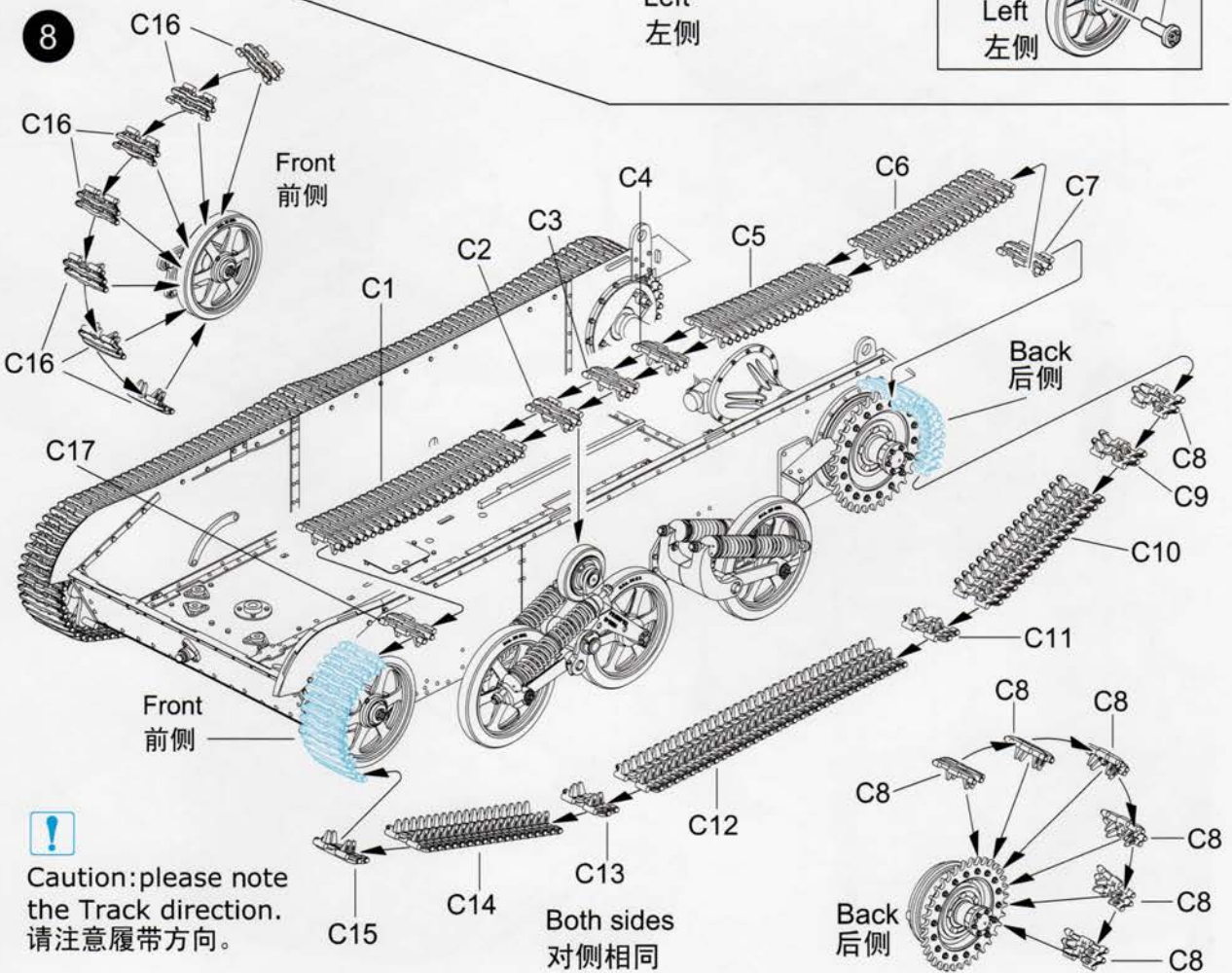
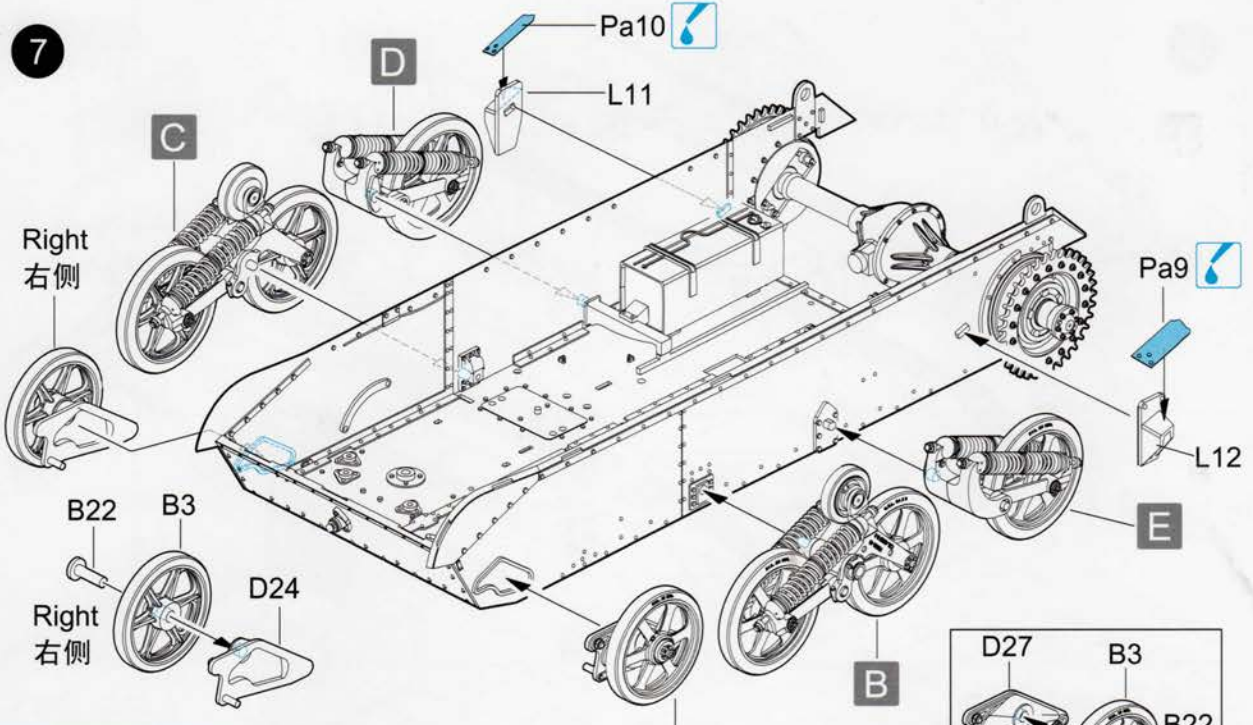

 Caution: please note the Track direction. 请注意履带方向。



9

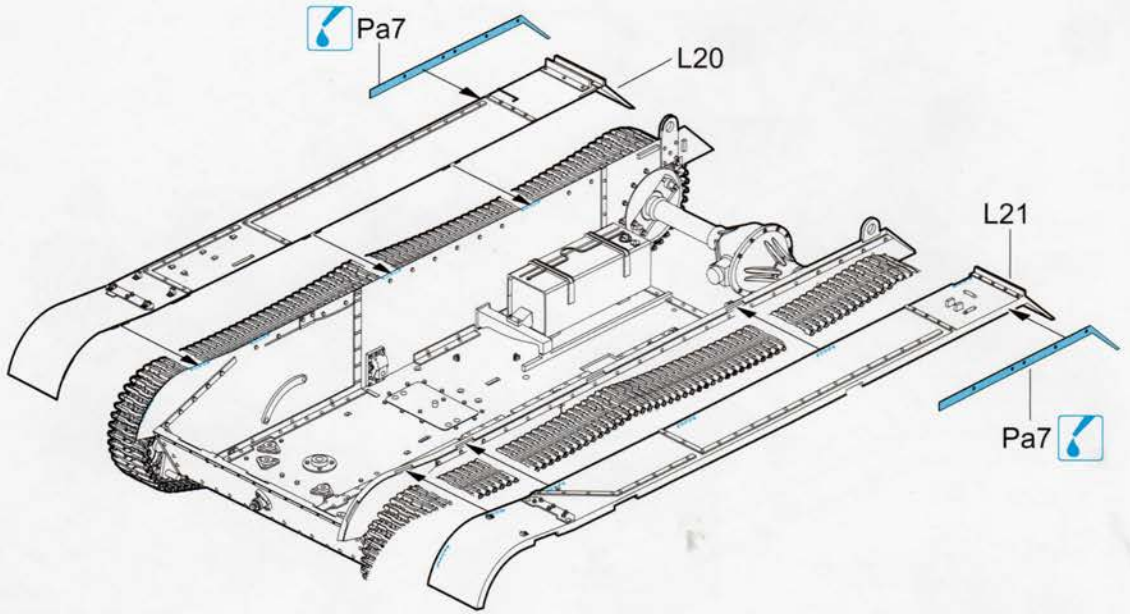

10

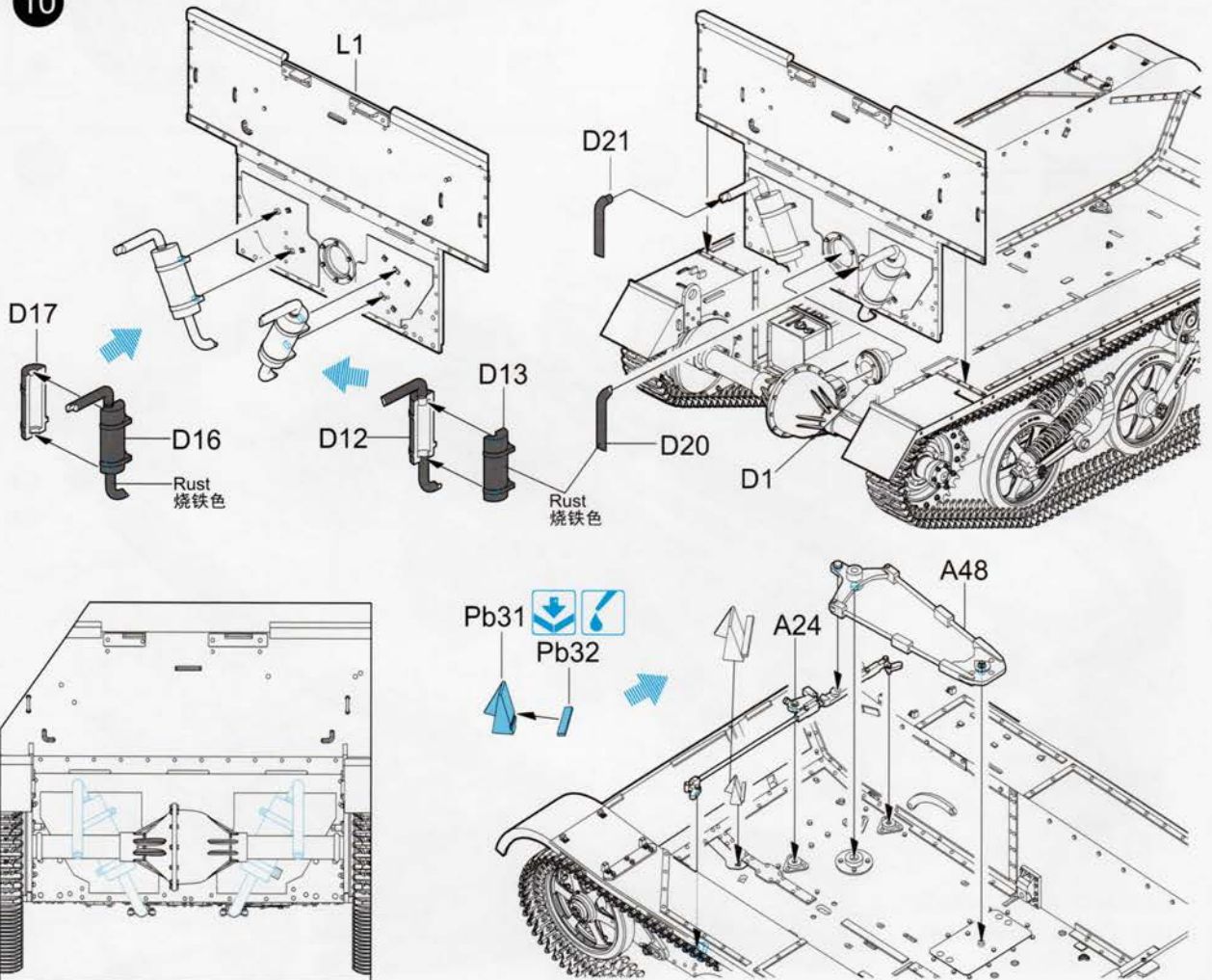



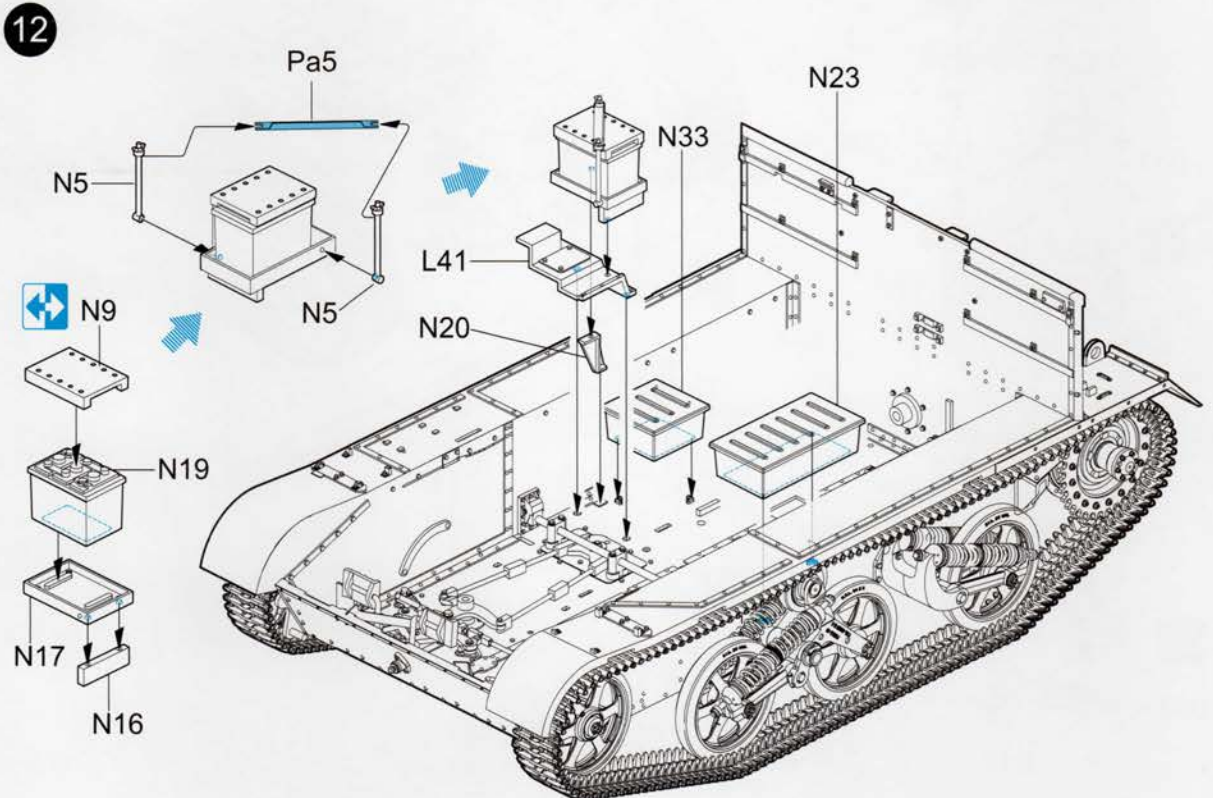
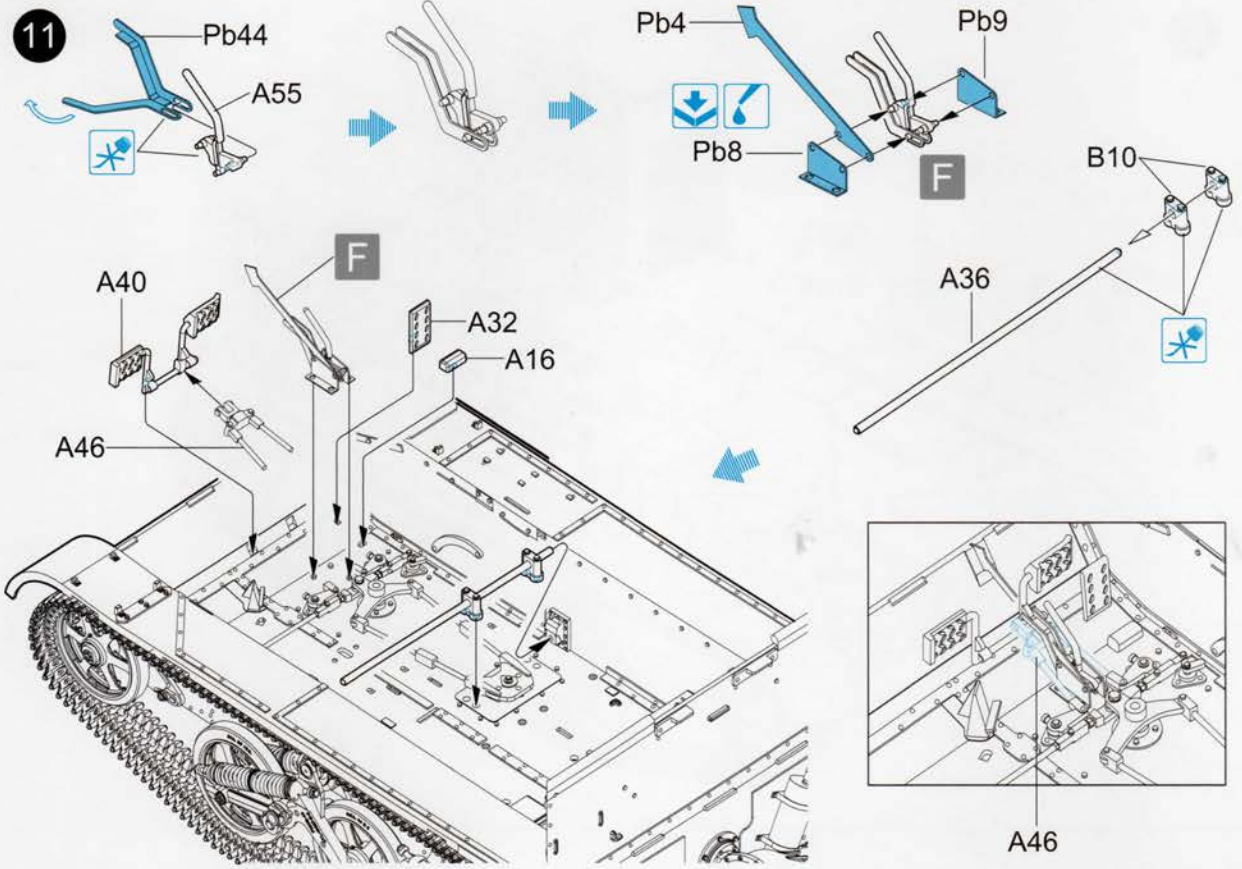

13

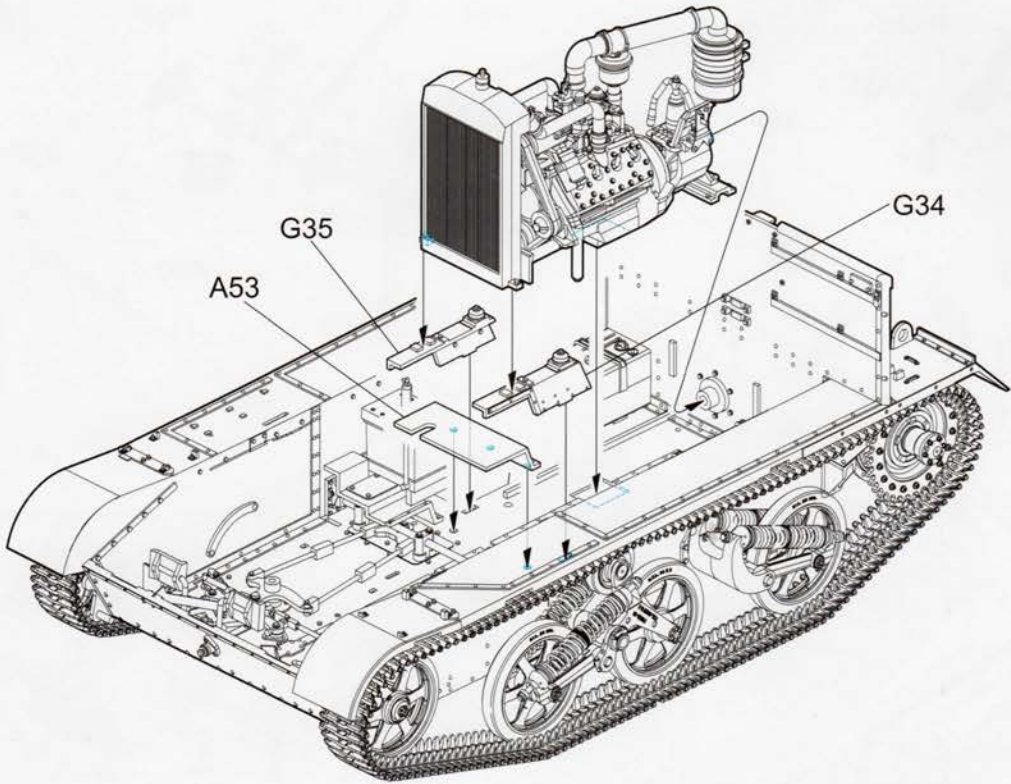

14

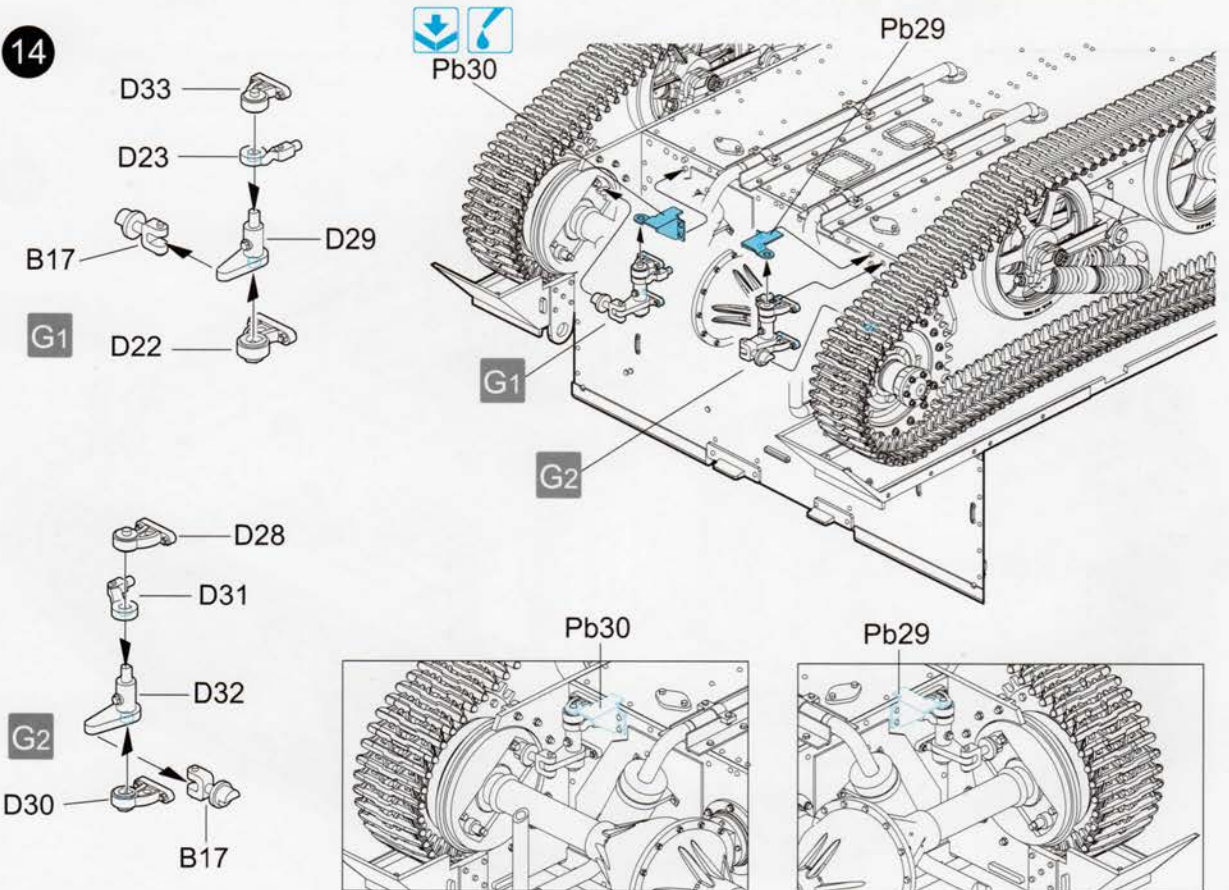



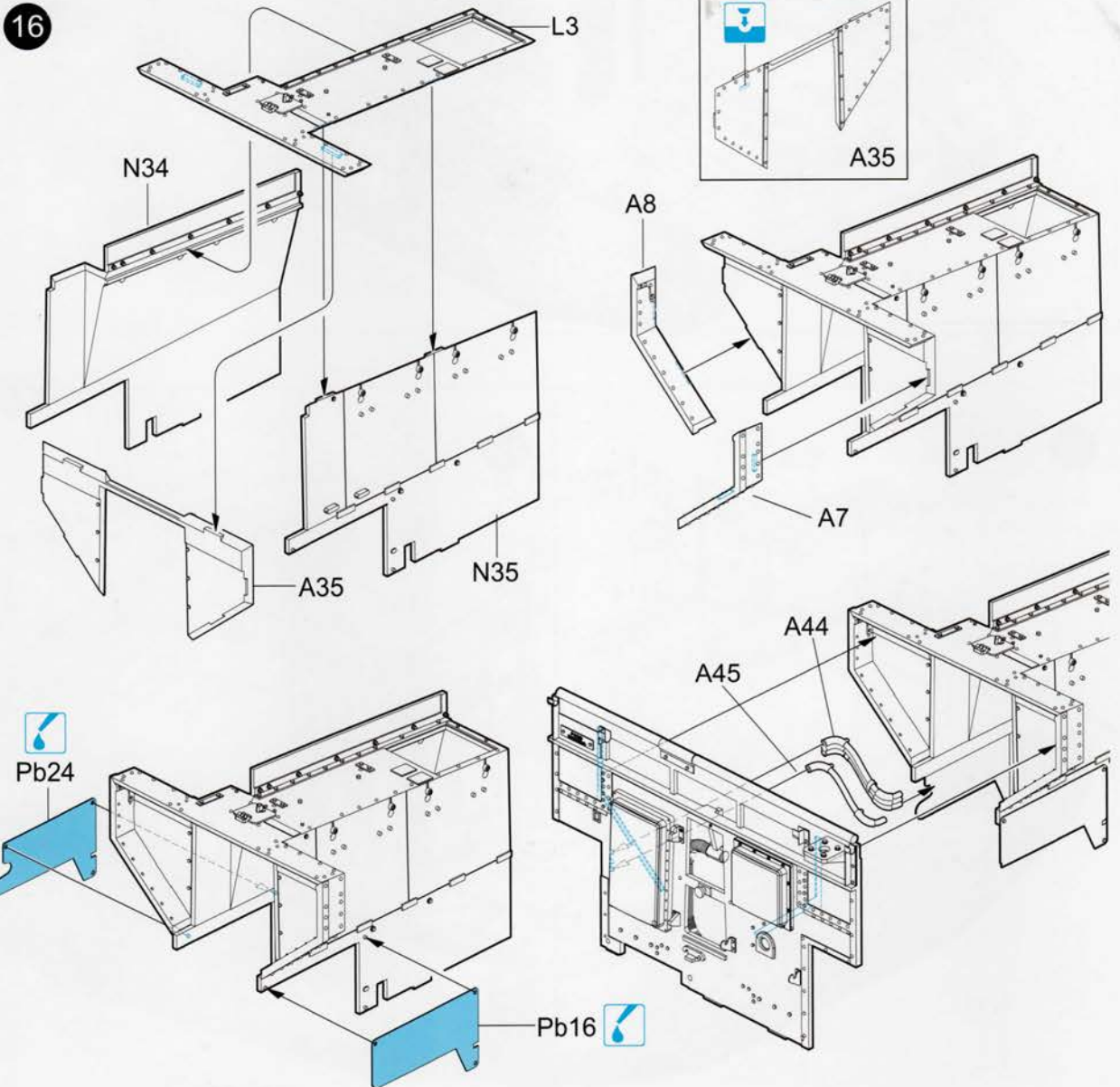
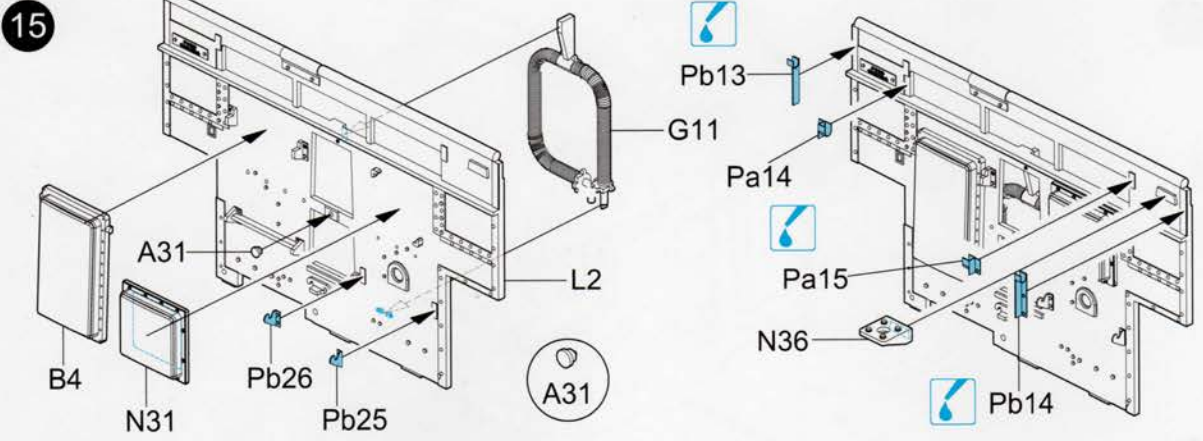

17

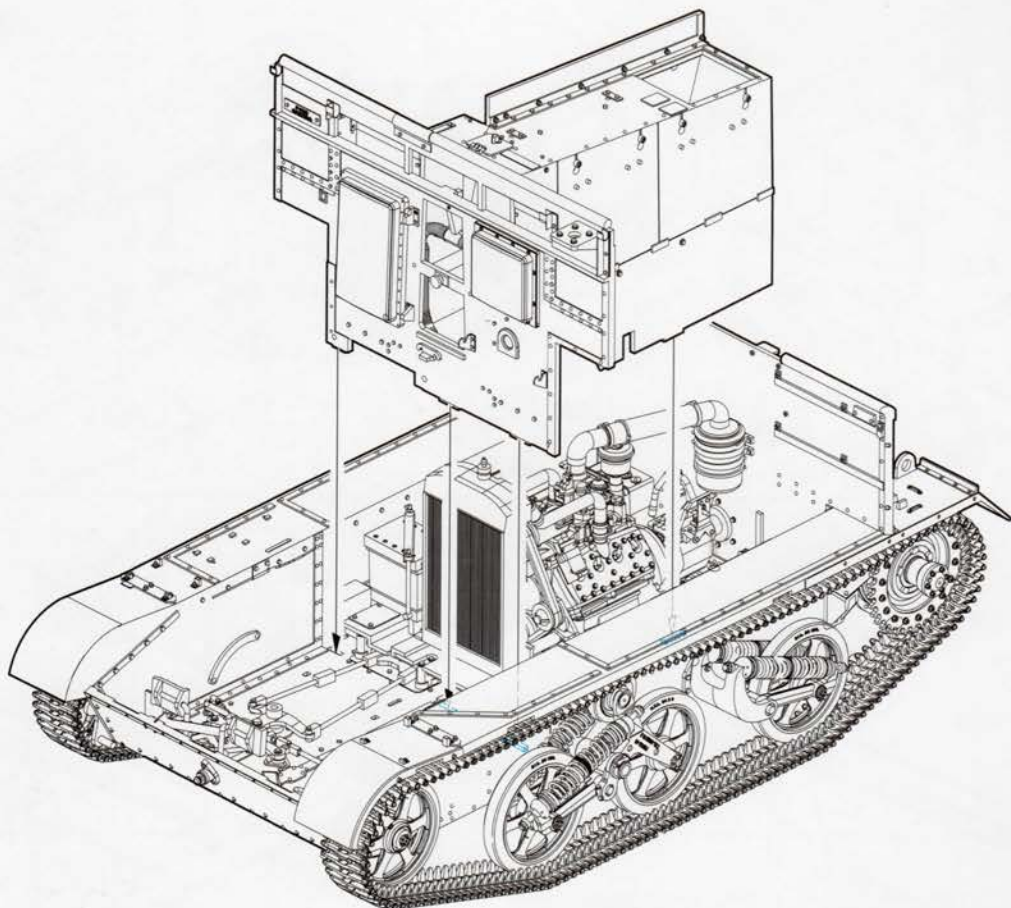

18

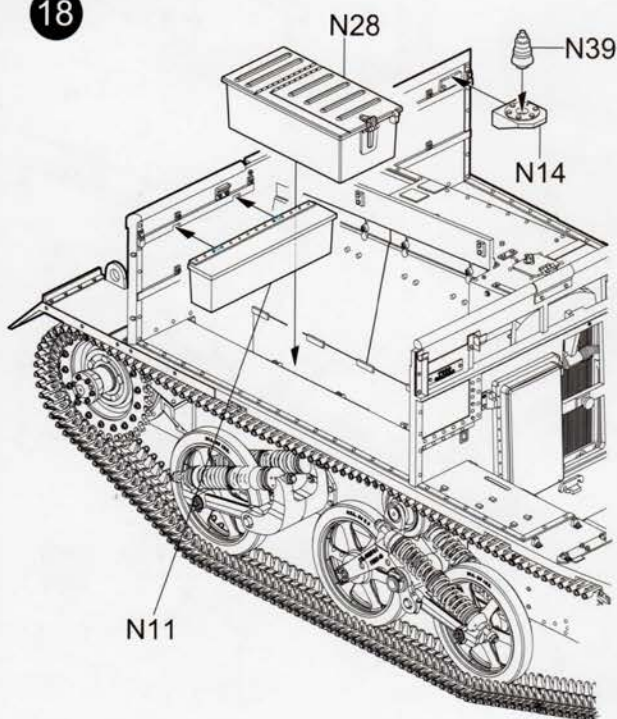

19

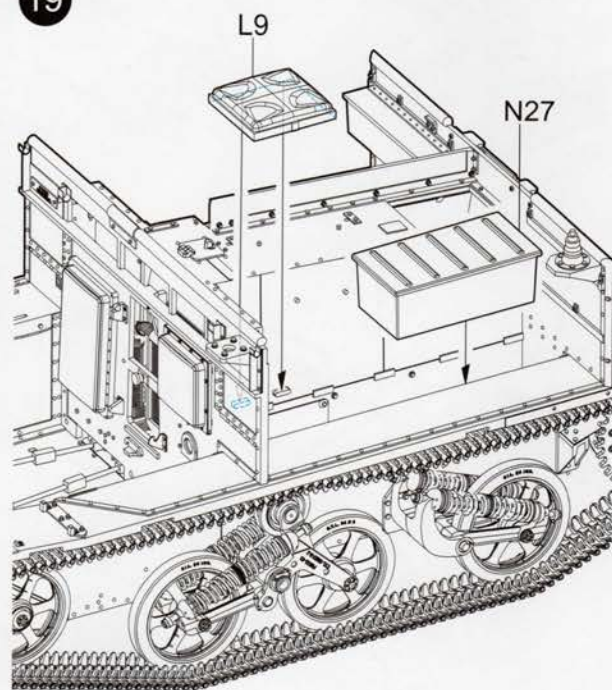



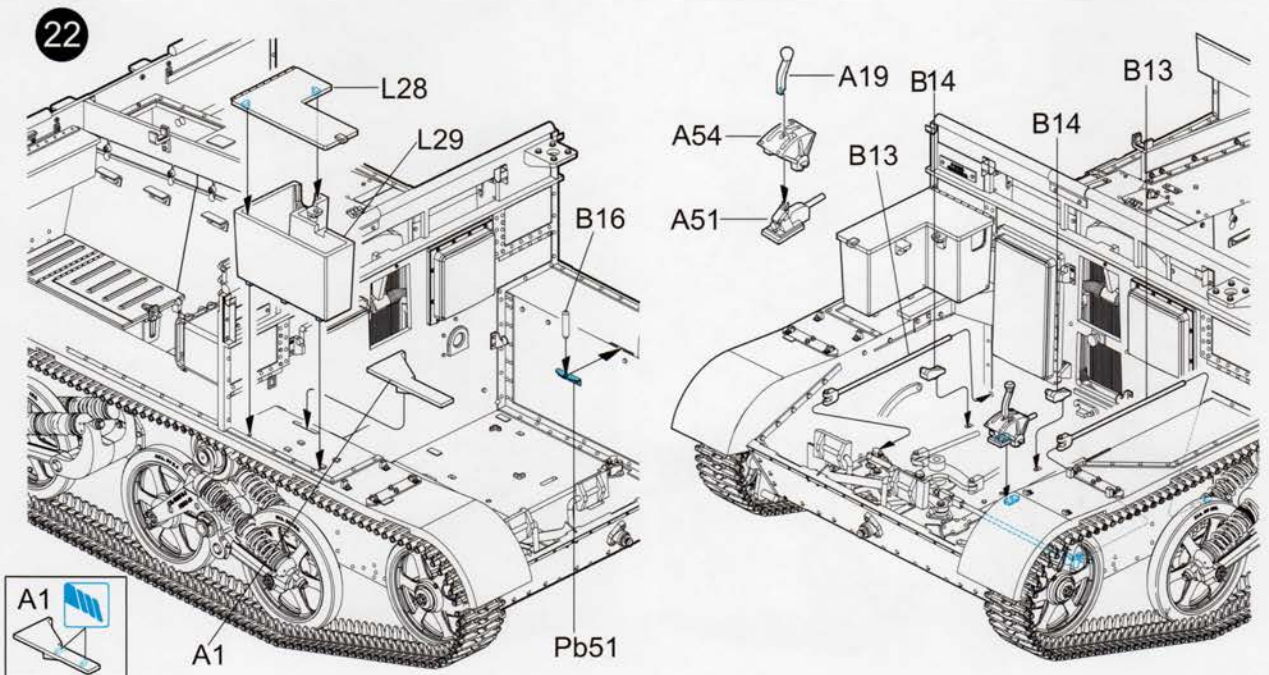
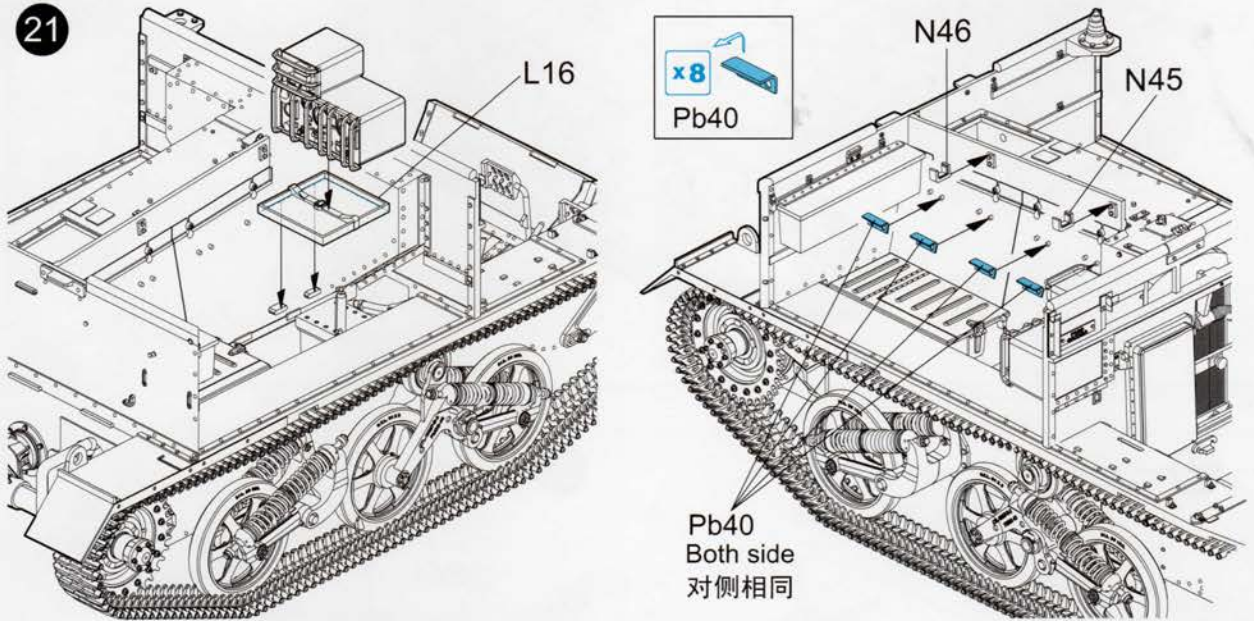
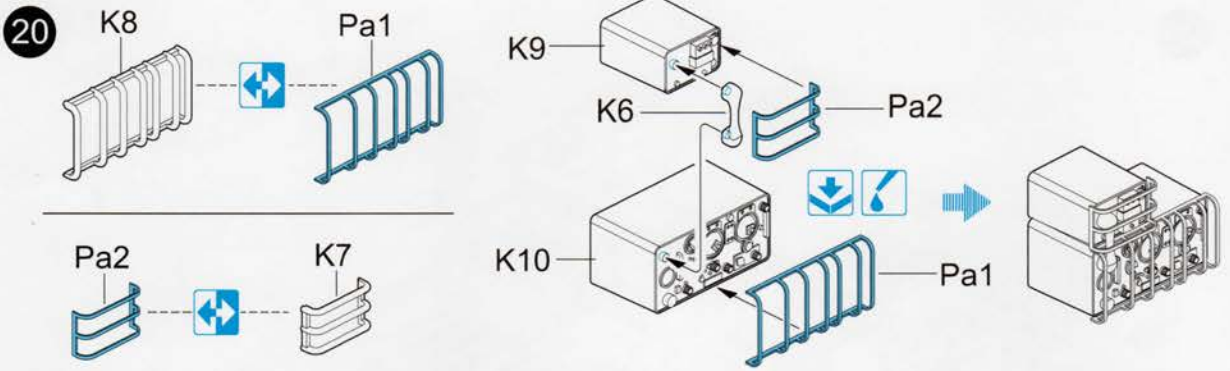



23

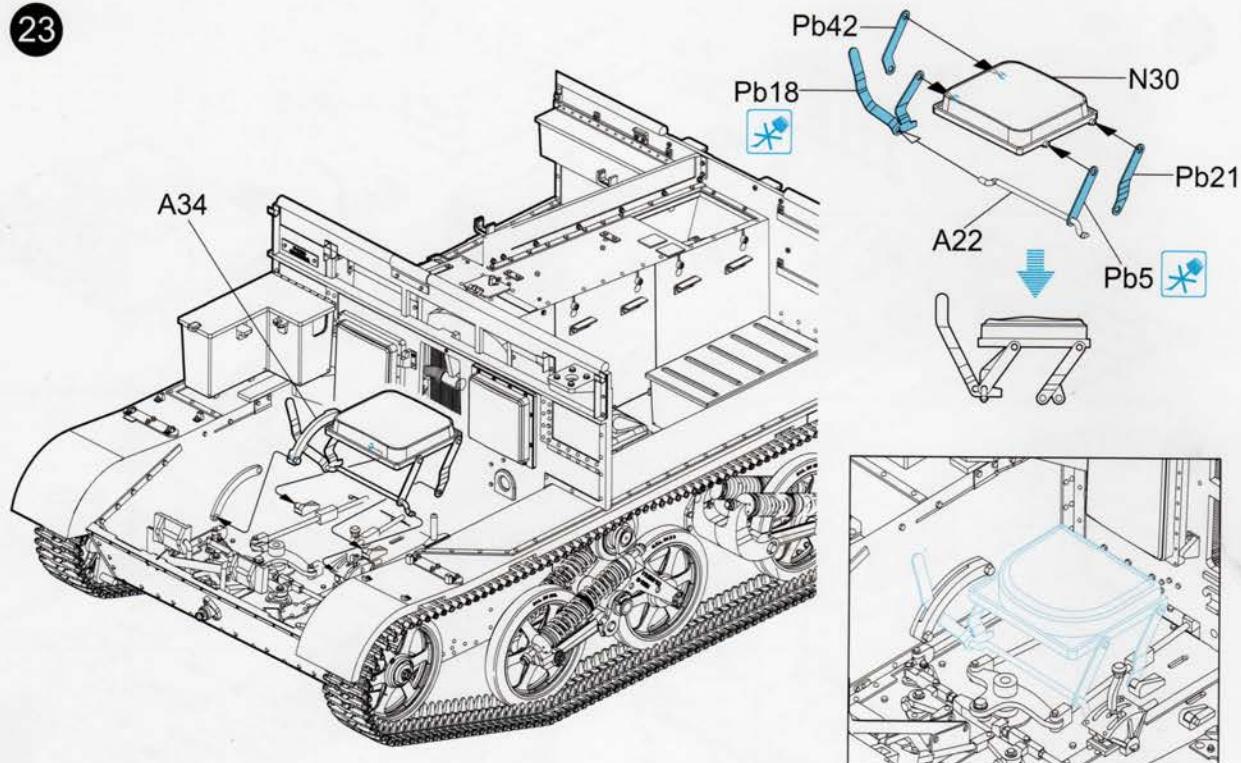

24

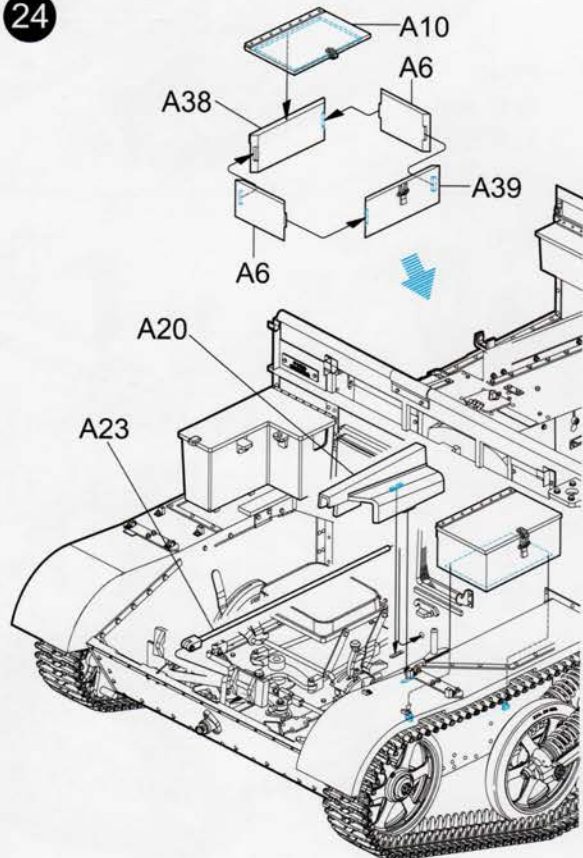

25

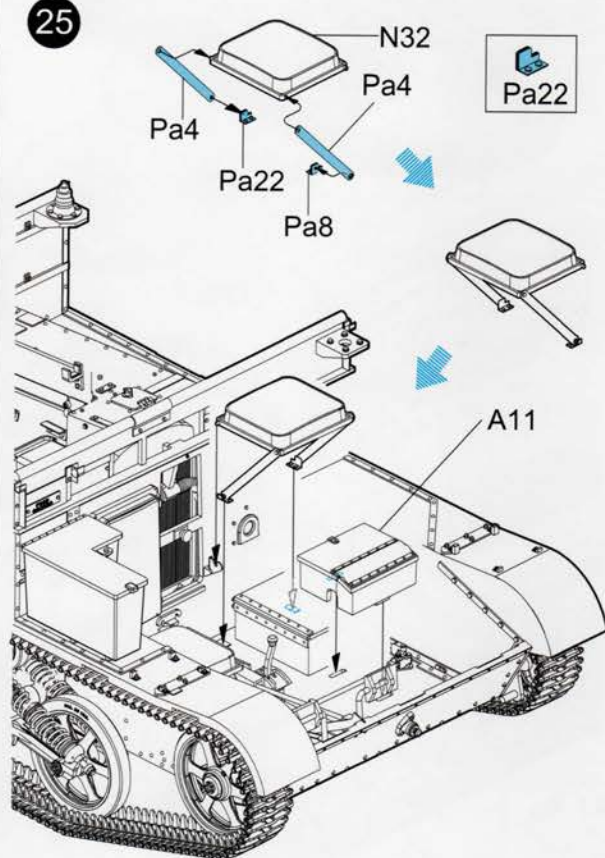



26

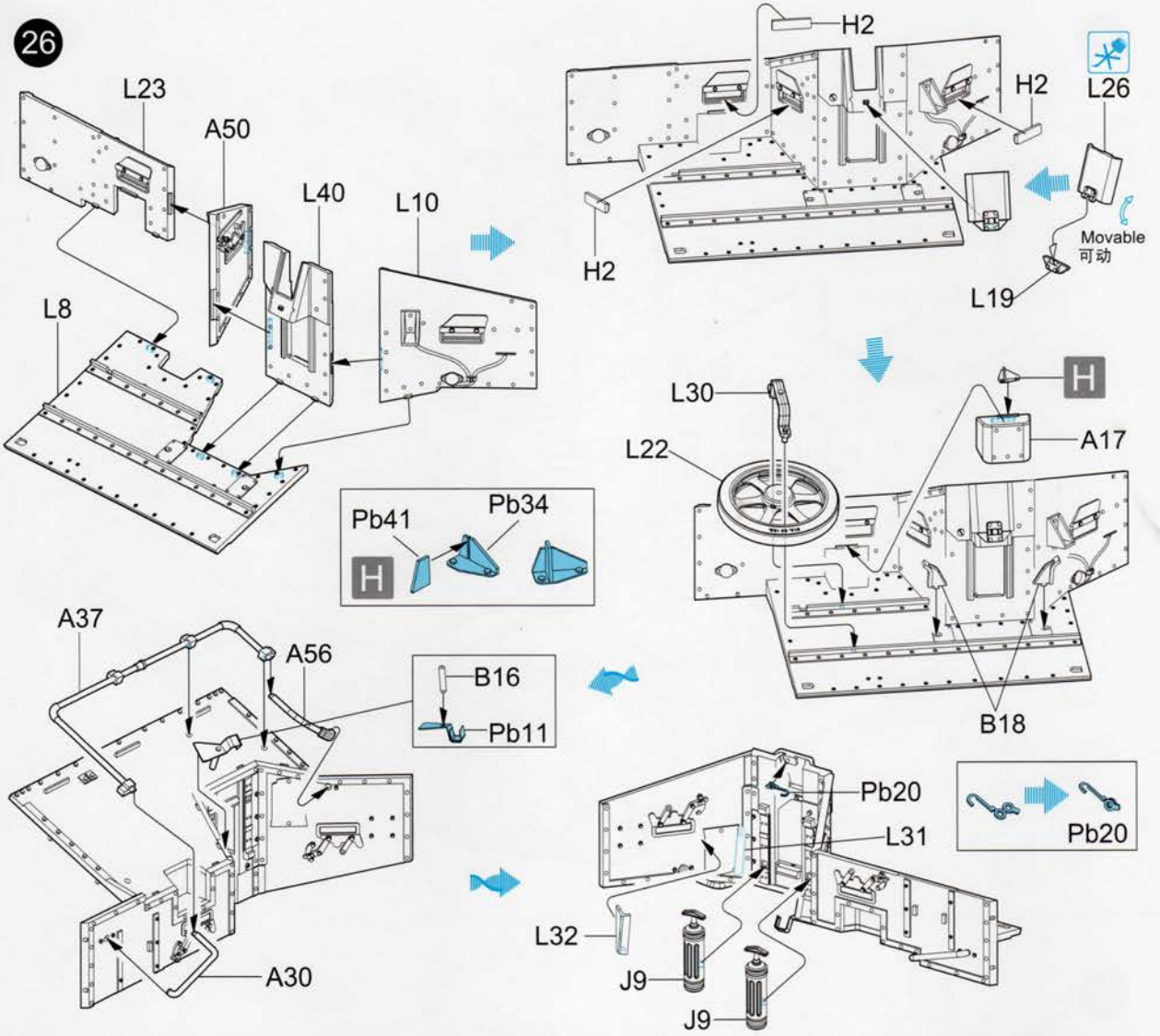

27

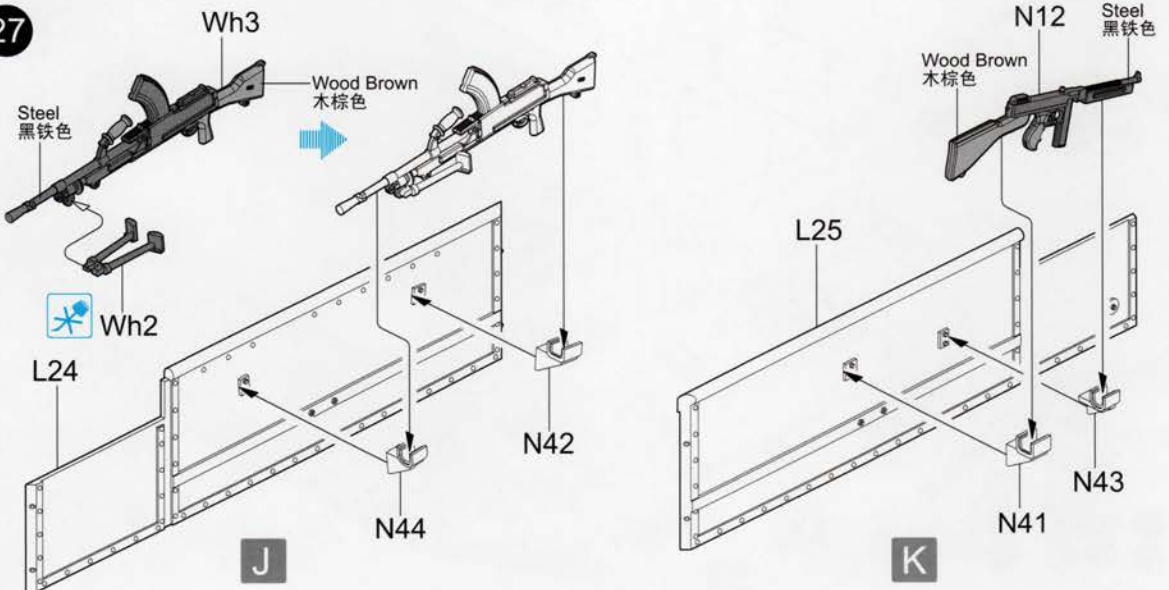

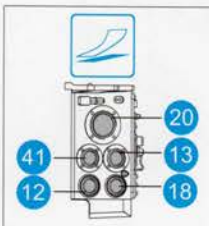
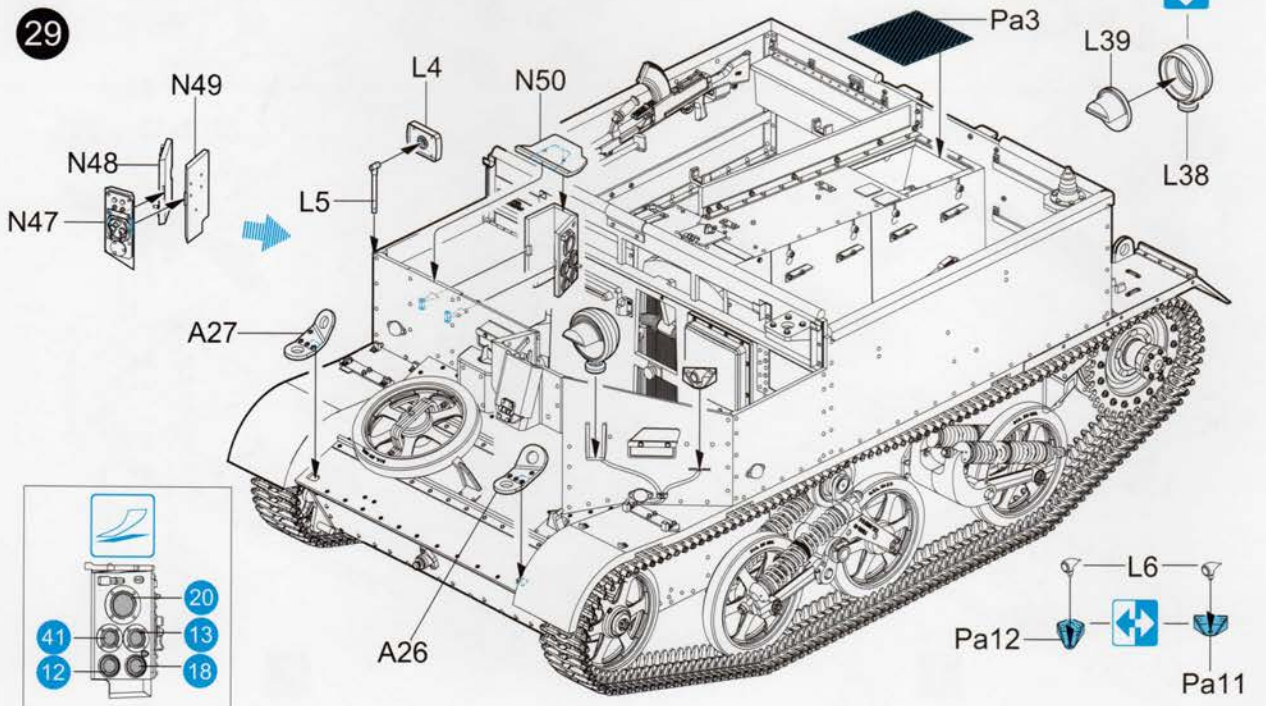
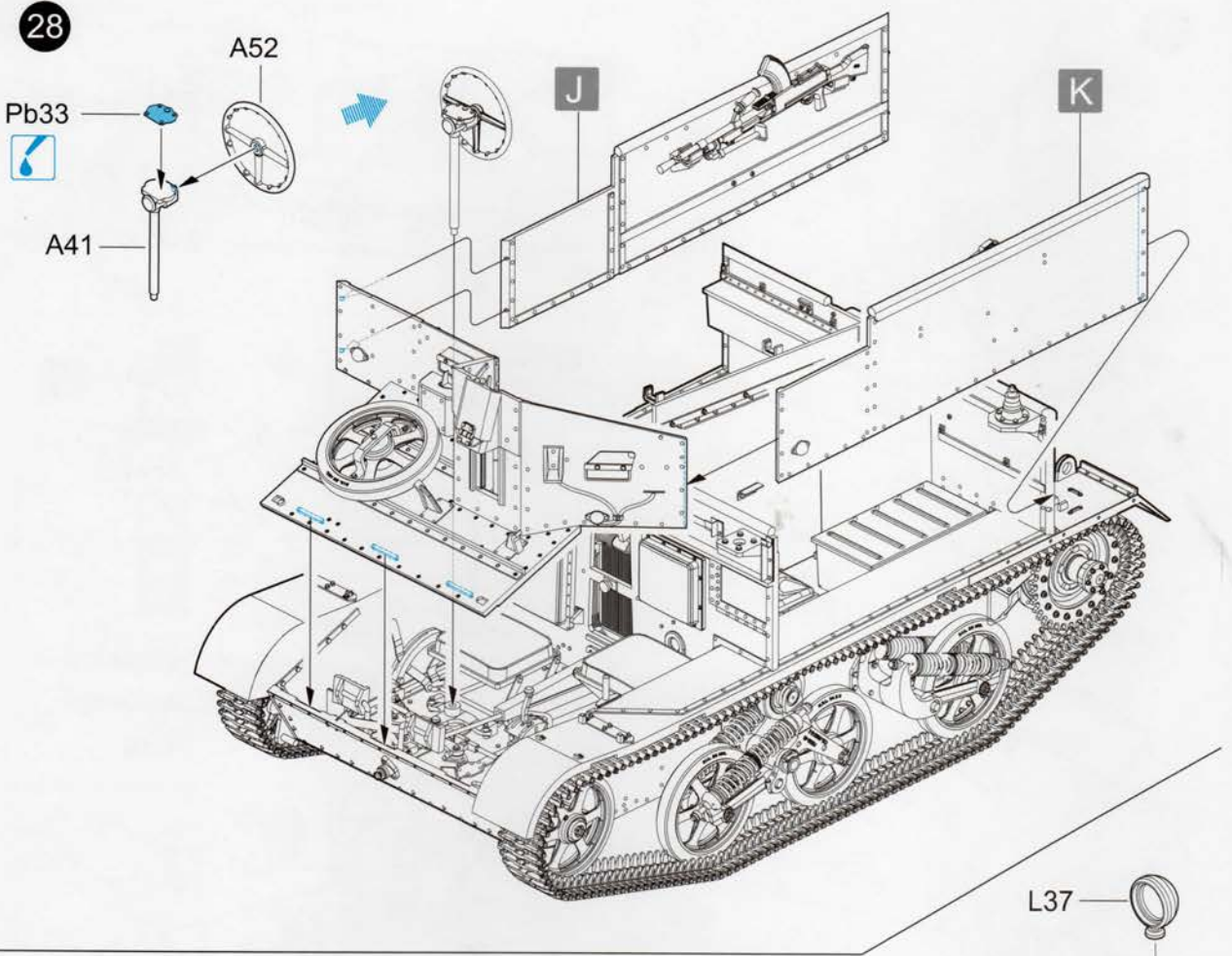



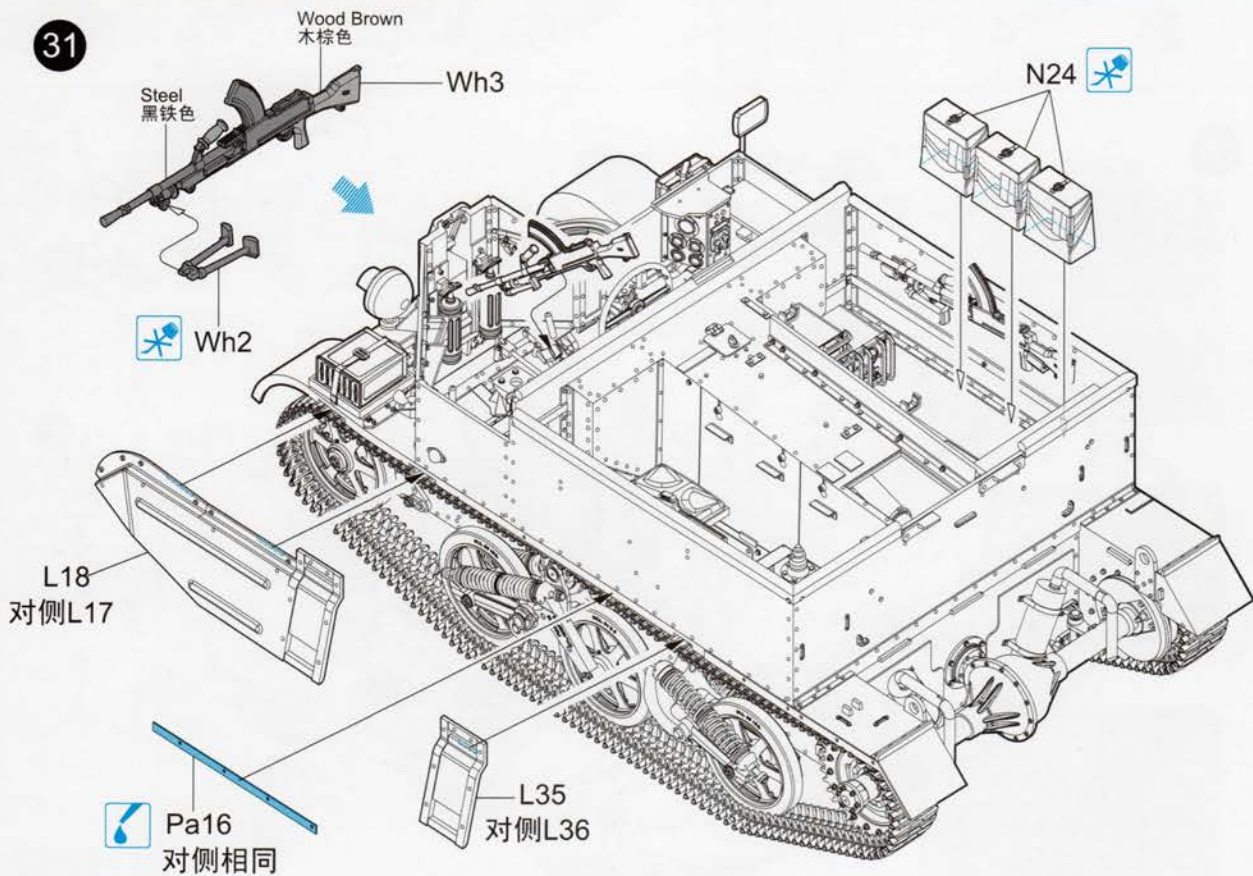
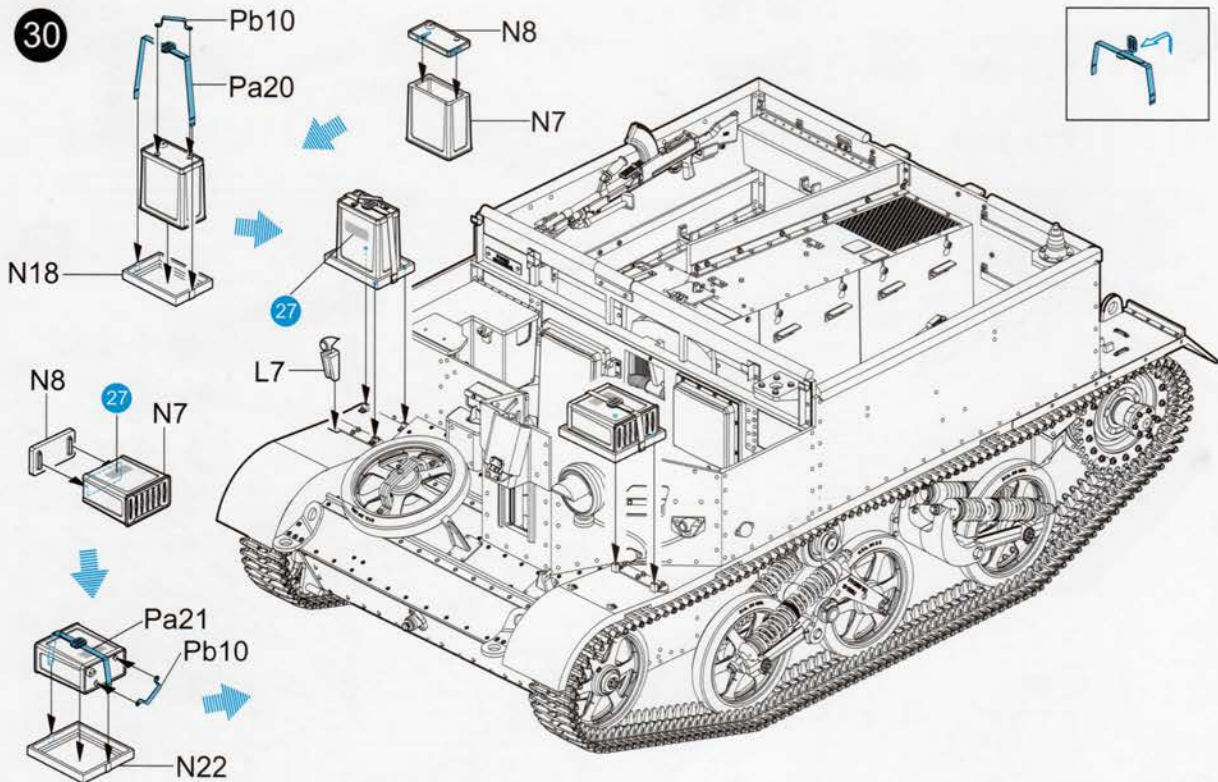

32

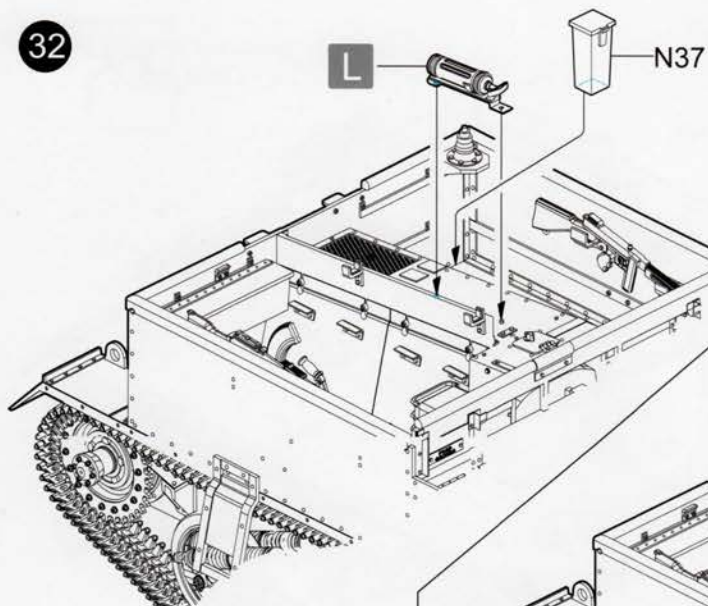

Pb45

J8

Pb2



Pb3

L

Pb45

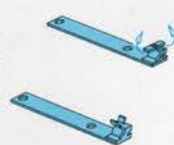

33

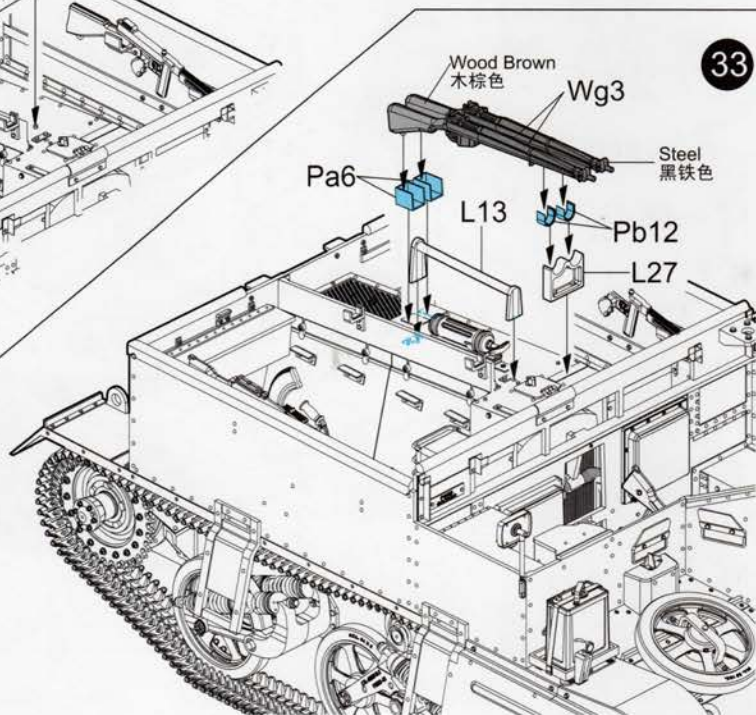

Wood Brown  
木棕色

Wg3

Steel  
黑铁色

Pa6

L13

Pb12

L27

34

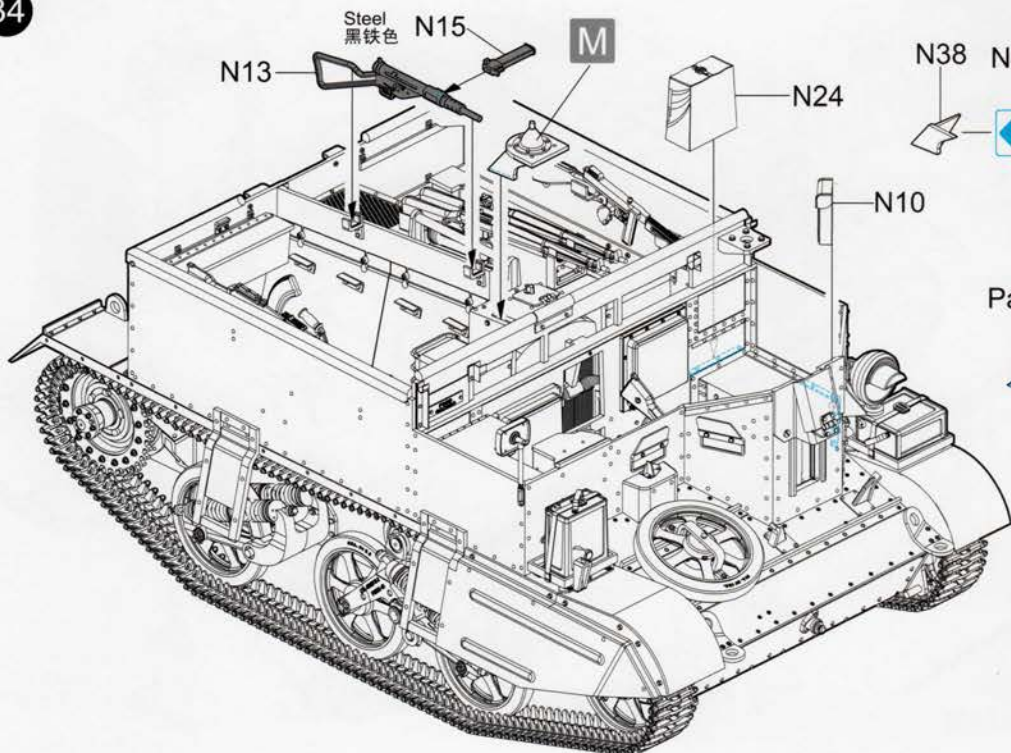

Steel  
黑铁色

N15

M

N13

N24

N38

N40



M

N10

Pa17

Pa19



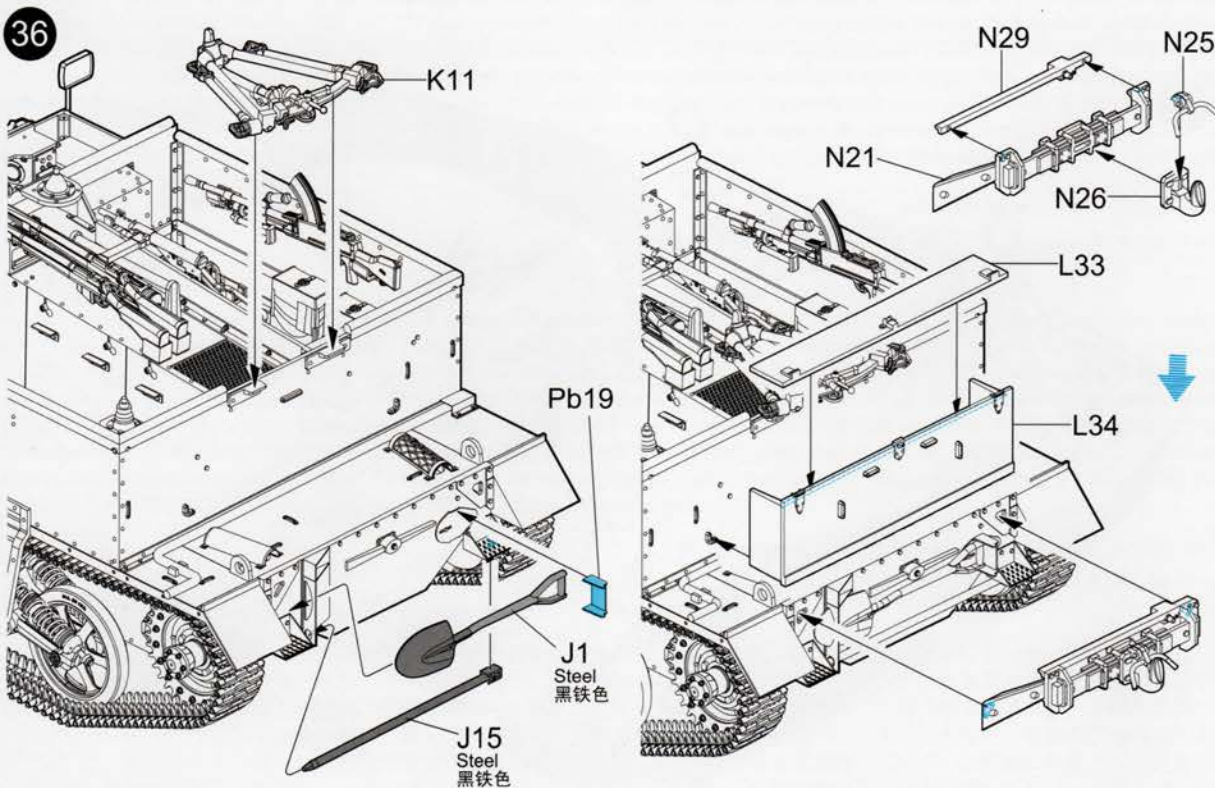
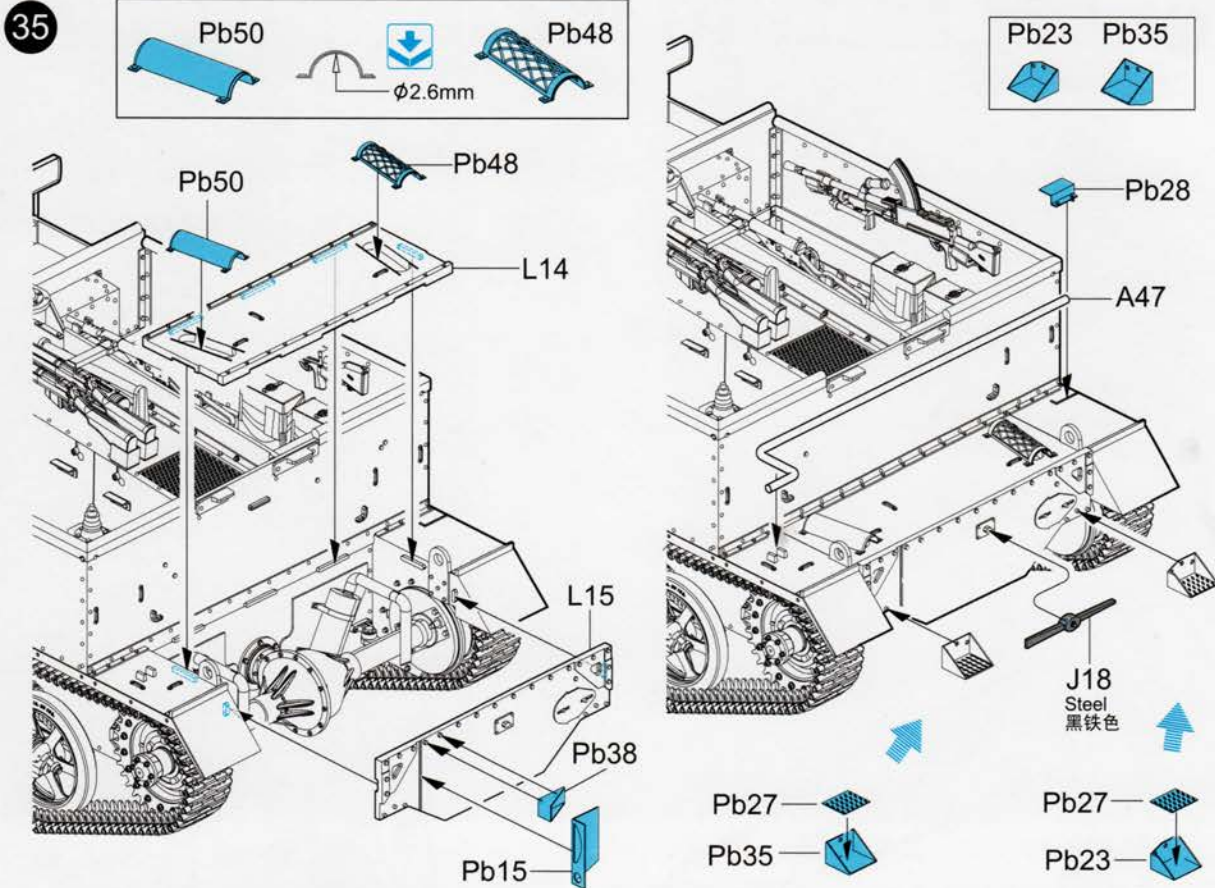



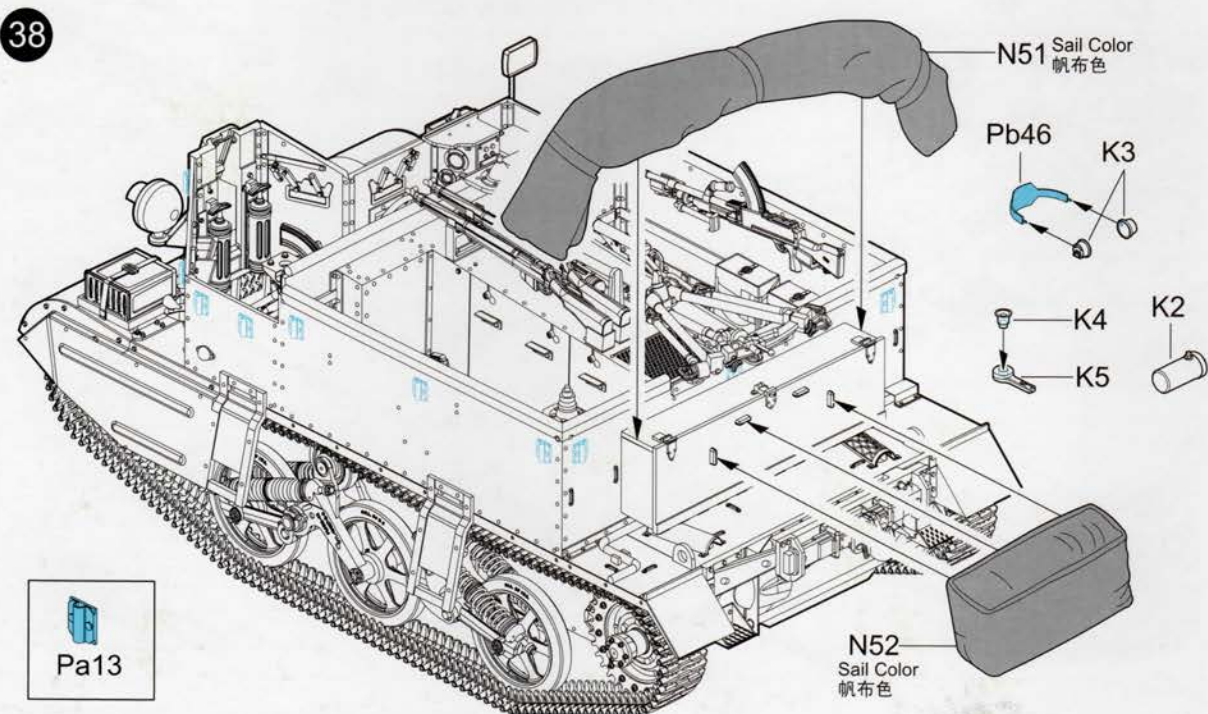
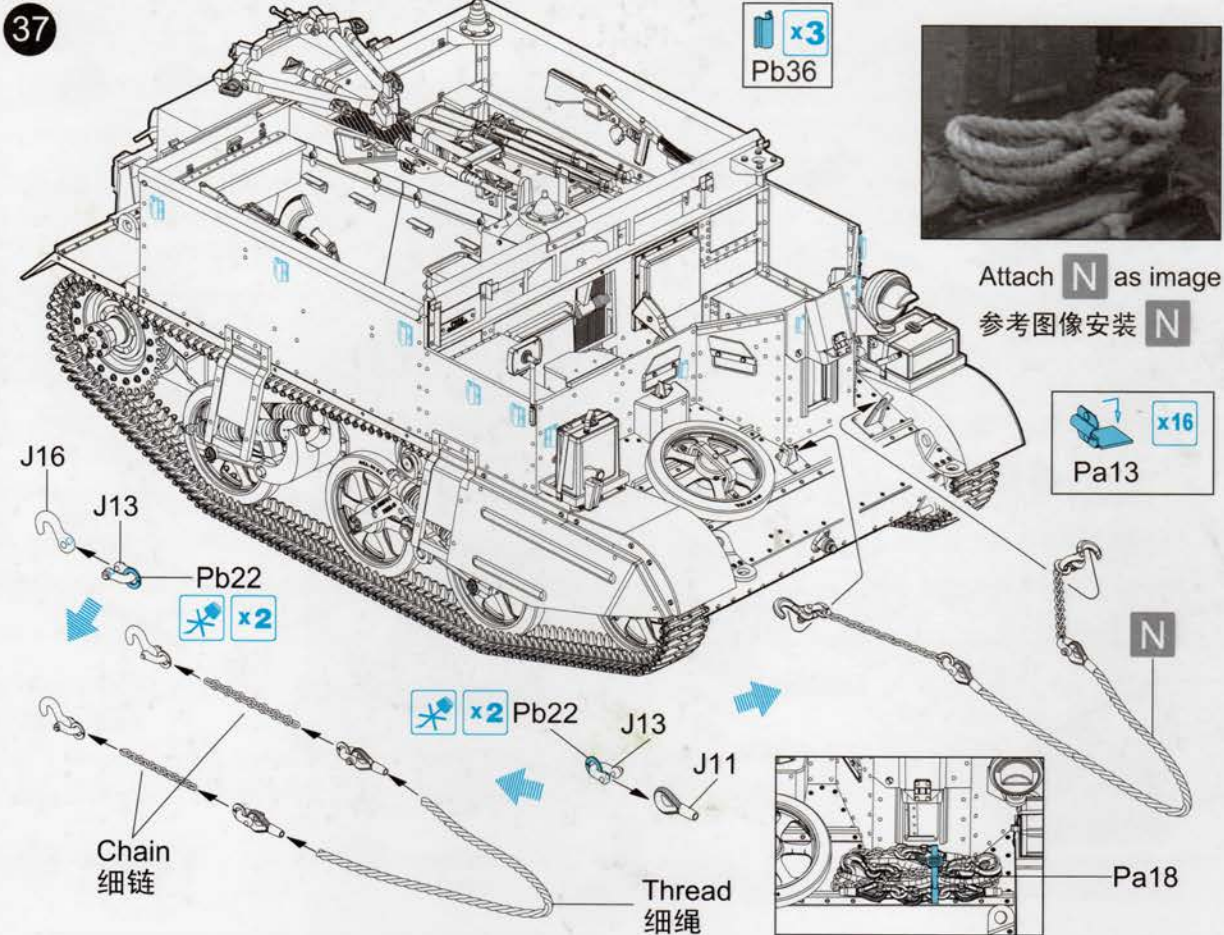



# Universal Carrier MK.II

**Option 1:** T202825, 1<sup>st</sup> Battalion Grenadier Guards, Guards Armoured Division, Operation Goodwood, Normandy, France, July 1944

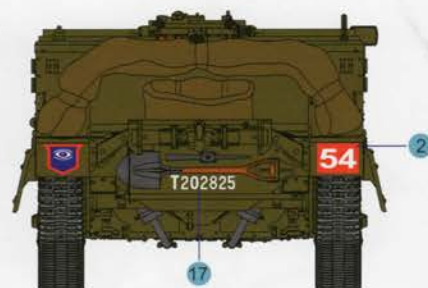
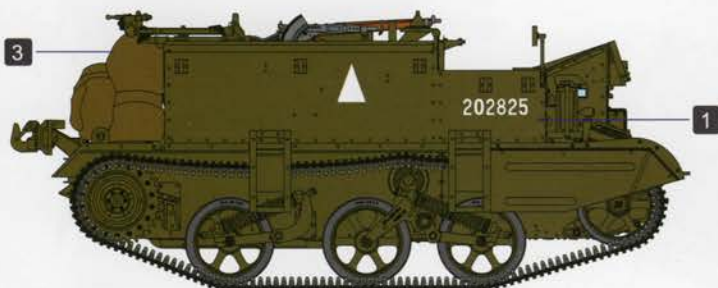
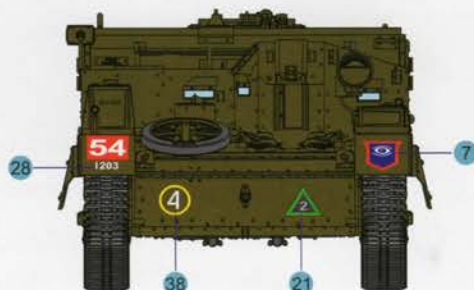

**Option 2:** T252630, 74<sup>th</sup> Field Regiment RA, 50<sup>th</sup> (Northumberland) Infantry Division, Chardonne, France, August 1944



**Option 3:** T274800, YETHOLM, 6<sup>th</sup> Battalion King's Own Scottish Borderers, 15<sup>th</sup> (Scottish) Infantry Division, River Rhine, Germany 1945



Colour	涂料表	Mr. Hobby	Model Master	Humbrol	Tamiya	Colour	涂料表	Mr. Hobby	Model Master	Humbrol	Tamiya
1	Khaki Drab G3 卡其绿G3	H 52 12	1710	/	XF-51	3	Sail Colo 帆布色	H 85 45	/	/	/
2	Tyre Black 轮胎黑	H 77 137	/	/	/						

注: ▲ 对侧相同  
▲ Both side

\*Some paints may not be available in your country. Please check your local hobby shop for substitute.



**Option 4:** T275691, SOUTH ROSYTH, 2<sup>nd</sup> Gordon Highlanders, 15<sup>th</sup> (Scottish Division)  
Celle, Germany April 1945



**Option 5:** T203582, 4<sup>th</sup> Battalion Dorset Regiment, 43<sup>rd</sup> (Wessex) Infantry Division,  
Vernon, France, August 1944

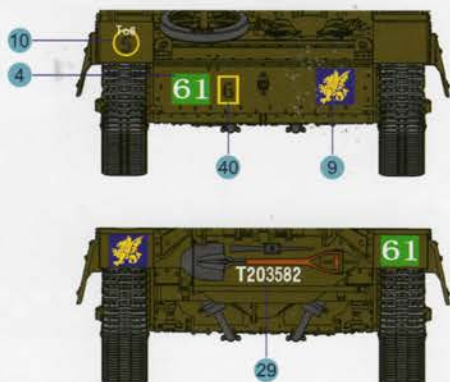

**Option 6:** T84039, 2<sup>nd</sup> Battalion Argyll and Sutherland Highlanders, 15<sup>th</sup> (Scottish)  
Infantry Division, Tilburg, The Netherlands, October 1944

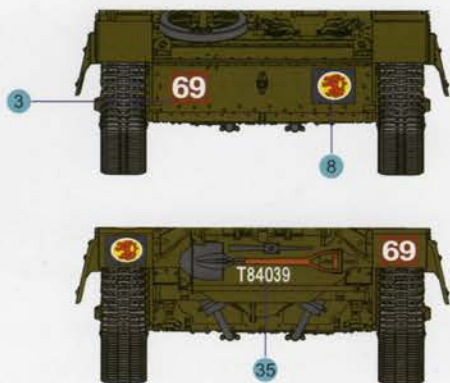
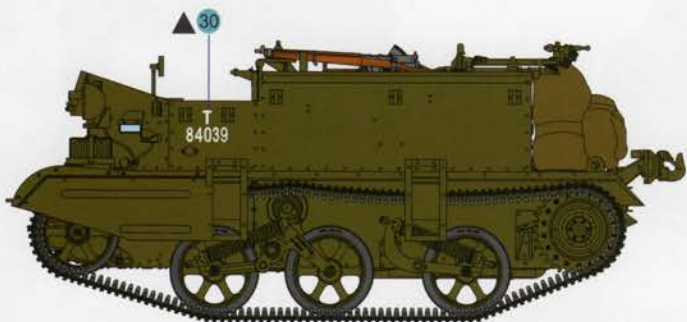

**Option 7:** T315429, 1<sup>st</sup> Battalion East Lancashire Regiment, 53<sup>rd</sup> (Welsh) Infantry  
Division, September 1944

