

# MESSERSCHMITT Me262

1/72 SCALE

A-1a - A-2a  
B-1a OR B-1a/U1



A-104

NOTE! READ THIS BEFORE YOU BEGIN. This kit features JO-HAN's exclusive stacked FRAME-PAK method of packaging. Each frame of plastic parts is molded with identifying numbers appearing on tabs next to the corresponding parts. These numbers correspond with numbers on the assembly drawings. Read the instructions thoroughly and study the assembly drawings to become familiar with all the parts. After removing the parts from their frames, trim away any excess plastic and check fit before cementing. Use just enough cement to join parts to avoid smearing on exposed surfaces. Work carefully and patiently. Build up sub-assemblies for painting. Use only paint and cement made for styrene plastic.

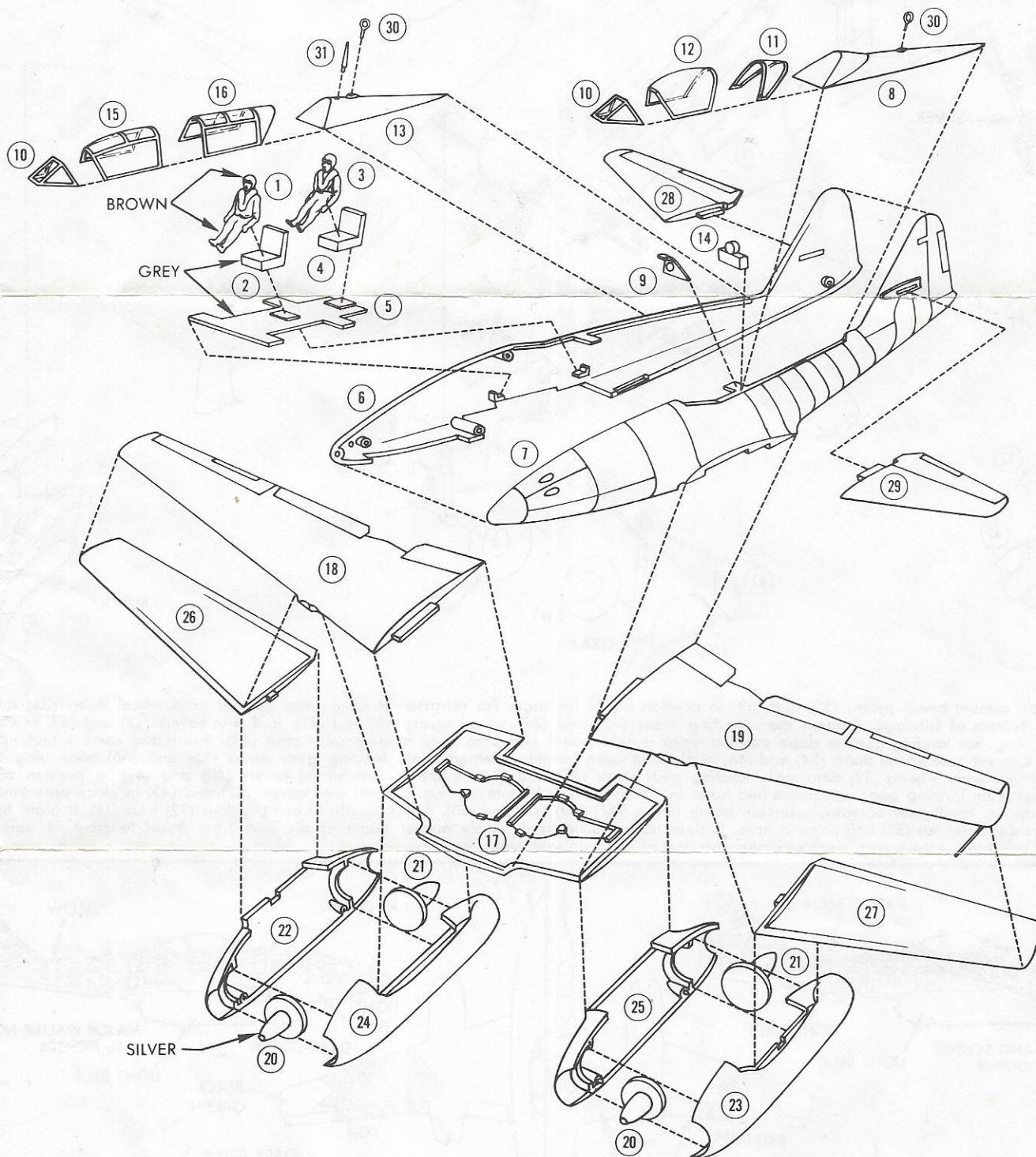

Decide whether to build the A-1a fighter (flown by Major Nowotny) or A-2a fighter bomber (flown by Major Schenk) or B-1a two seat trainer or B-1a/U1 two seat night fighter (flown by Major Welter). For overall painting suggestions and decal application refer to back side. For single seat, cement pilot (1) to seat (2) and seat to floor (5). For 2 seat, add pilot (3) and seat (4) to floor. For 2 seat night fighter version, open blind holes in nose of fuselage halves (6) and (7) for radar antennas. Also, if stand is used, open blind slot in bottom of fuselage halves. Cement seat assembly and fuselage halves together. For 1 seater, cement fuselage top (8) in place. For 2 seater, cement fuselage top (13) in place. For 1 seater, cement armor plate headrest (9) in place. For 2 seat night fighter, cement radar unit (14) in position. For 1 seater, cement windshield (10) and canopy sections (11) and (12) in place. For 2 seater, cement windshield (10) and canopy sections (15) and (16) in place. Sections (12) or (15) and (16) may be in open position. Cement bottom center wing section (17) and right wing top (18) and left wing top (19) together onto fuselage bottom. Assemble right engine unit (20) (21) (22) and (24). Assemble left engine unit (20) (21) (23) and (25). Cement both units into position under right and left wings. Cement bottom outer wing panels (26) and (27) in place. Cement stabilizer halves (28) and (29) into slots in rudder. Cement loop antenna (30) in place. Cement antenna mast (31) in place in 2 seater.

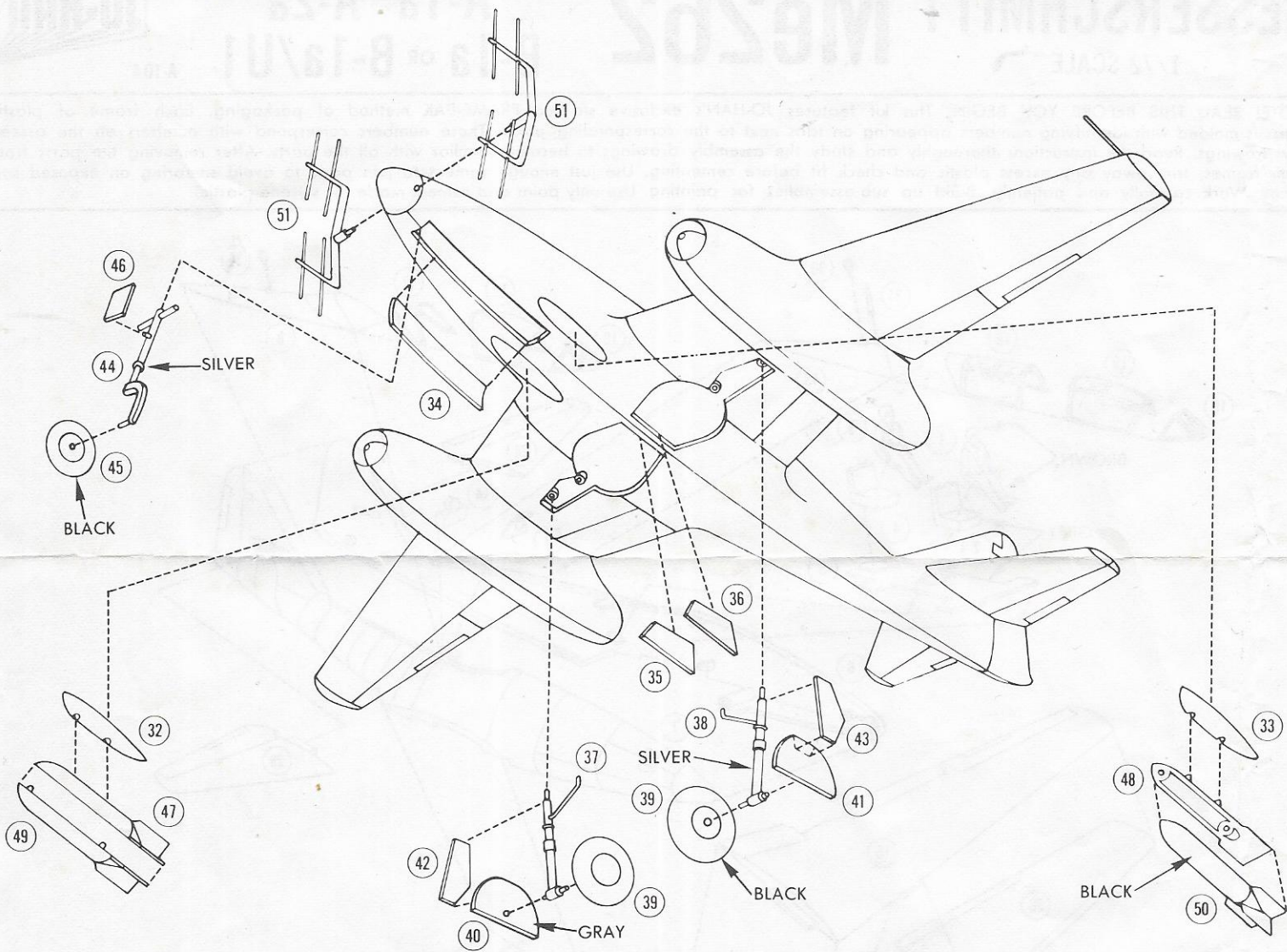

For fighter bomber, cement bomb pylons (32) and (33) in position under fuselage. For retracted landing gear, cement nose wheel doors (34) and (46) in closed position in bottom of fuselage. Cement main landing doors (35) and (36), wheel covers (40) and (41), and strut covers (42) and (43) in closed position in bottom of wing. For landing gear in down position, cement nose wheel (45) onto nose landing gear strut (44). Insert and cement unit into bottom of fuselage nose. Cement nose wheel doors (34) and (46) in place in open position. Cement main landing gear doors (35) and (36) onto wing bottom in open position. Cement main wheels (39) onto main landing gear struts (37) and (38). Cement main wheel covers (40) and (41) in position on landing gear struts. Cement main landing gear assemblies into holes in wheel wells in bottom of wing. Cement strut covers (42) and (43) in place onto landing gear struts and wheel covers. For fighter bomber, assemble bomb halves (47) (48) (49) and (50). Attach bombs to bomb pylons (32) and (33). If night fighter was selected, cement radar antennas (51) into holes in nose. If clear base will be used, apply proper name of airplane from decal to front of base. Cement clear upright arm into base. Attach or cement airplane onto top of clear upright arm.

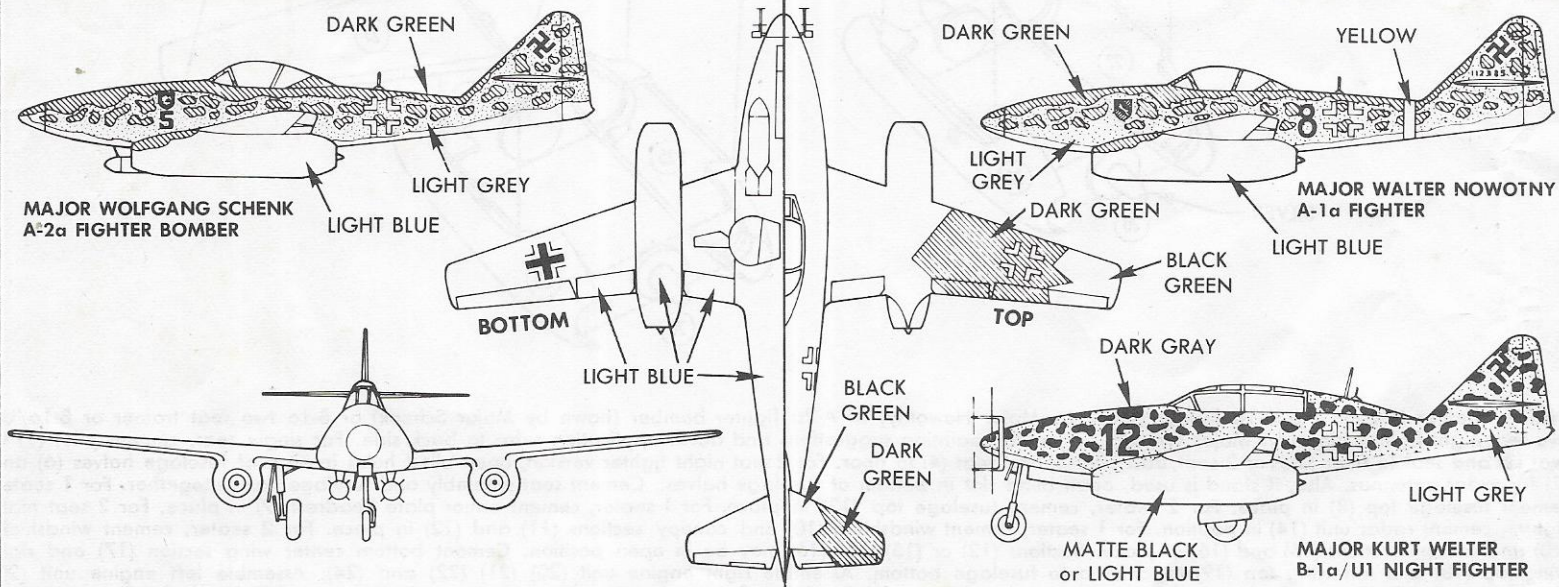



A-104

112385

112385



12

12

MESSERSCHMITT Me 262 A-1a A-2a B-1a B-1a/U1



**JO-HAN**

**MESSERSCHMITT**

**Me 262**

**A-1a**

**A-2a**

**B-1a**

**OR**

**B-1a/U1**

**ACES** FEATURED:

MAJOR WALTER NOWOTNY

MAJOR WOLFGANG SCHENK

MAJOR KURT WELTER

**1/72 SCALE**

**ASSEMBLY KIT**