

MIG-29A FULCRUM



With over 1,000 **MIG-29 Fulcrums** produced between 1977 and 1992, it must be recognized that the **MIG-29** is one of the three or four most important fighter aircraft in the air today. The **MIG-29** is frequently compared to the F-16 Fighting Falcon, while its companion interceptor/fighter the SU-27 shows greater similarity to the F-15 Eagle or F-18 Hornet

The **MIG-29** was designed in the early '70s to equal or surpass the performance of any known western block fighter. With its extreme agility, the **MIG-29** is Certainly an equal to the Falcon and probably its superior in many aspects such as twin-engine reliability and ease of maintenance. Five mechanics can remove and replace and test an engine in one hour or less! The **MIG-29** was designed for easy field maintenance with a minimum of skilled labor.

Powered by the RD-33 turbofan engines, a fully loaded **Fulcrum** can take off on one engine and subsequently air-start the second engine after lifting off. Armed with air-to-air AA-10, AA-11 or AA-8 missiles, the **Fulcrum** is more than equal in air-to-air combat. For the ground attack role, the **MIG-29** can carry the UB-32-57 rocket pods or the larger unguided S-8K rockets. Additionally, each **MIG** carries an internal 30mm cannon and 150 rounds of ammunition. The GSh-301 cannon is known for its very fine accuracy.

This model represents a late production version of the improved **MIG-29A**. Many significant improvements were incorporated into the design of the plane as it went through its production cycles. Each batch of aircraft was improved from earlier versions.

Flown by all former Soviet-bloc nations and many customer-client countries, the **MIG-29A** will be one of the most important fighters well into the 21st century.



Cement Parts
Coller
Kleben
Pegar
Incollare
Colar
Kleven



DO NOT cement
Ne pas coller
Nicht kleben
No pegar
Non incollare
Nao colar
Niet kleven



Cut away
Couper
Scheiden
Cortar
Tagliare
Cortar
Snijden



Optional parts
Choix
Auswahlmoglichkeit
Eleccion
Scefta
Opcao
Keuze

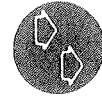

3

Repeat operation
Répéter l'opération
Vorgang wiederholen
Repitir la operacion
Ripetere
Repitir a operação
Herhalen

1 ASSEMBLY OF COCKPIT AND FUSELAGE FRONT

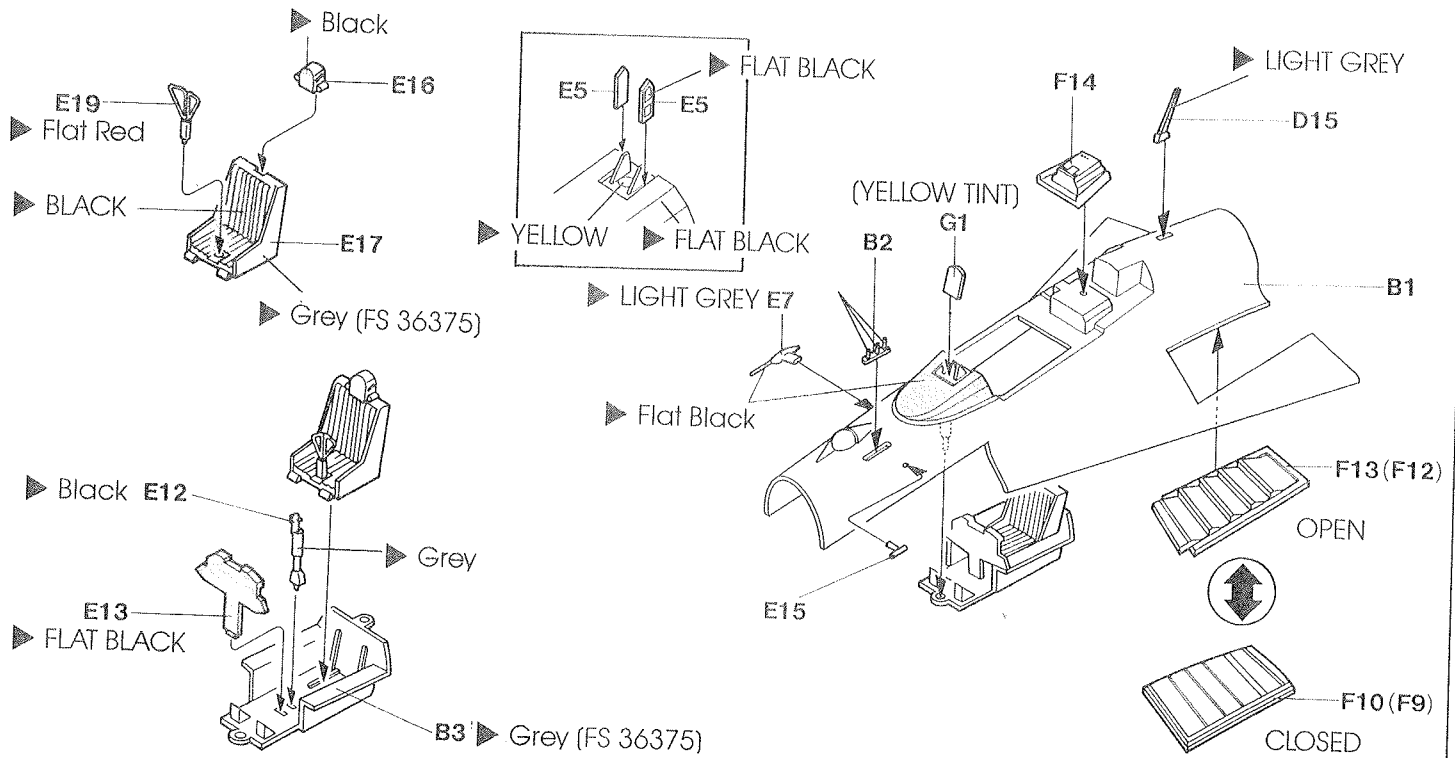

2 ASSEMBLY OF FUSELAGE

INTERIOR COLOR
Grey (FS 36375)

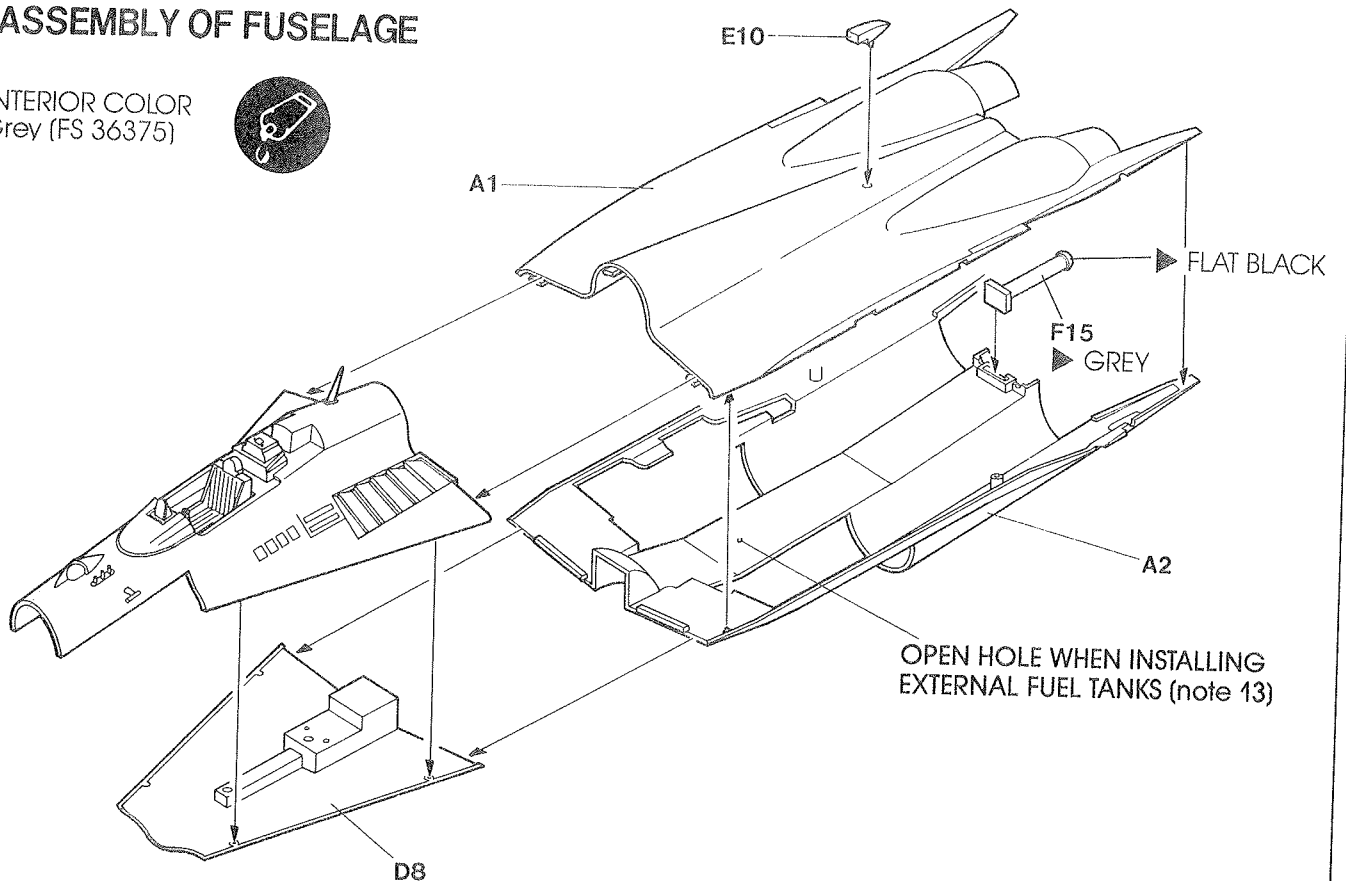

3 CANOPY INSTALLATION

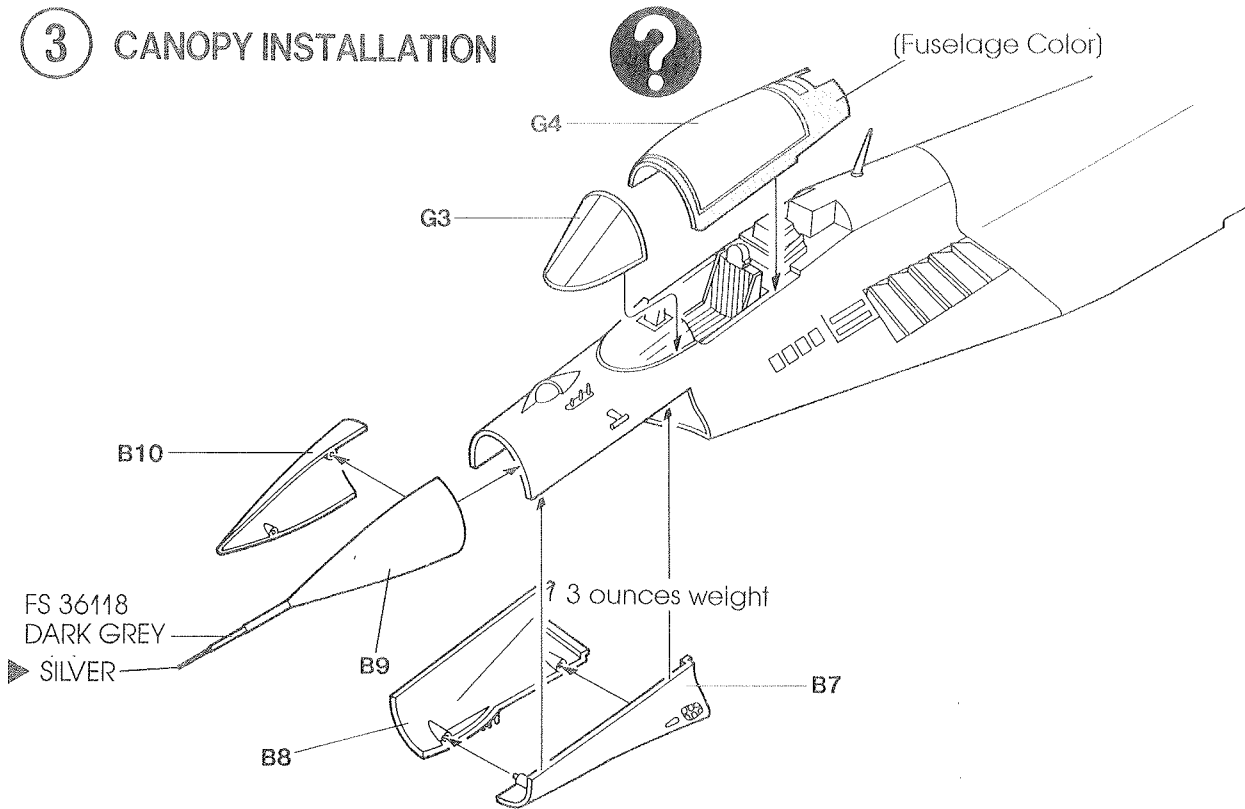

4 ASSEMBLY OF LANDING GEAR BAY

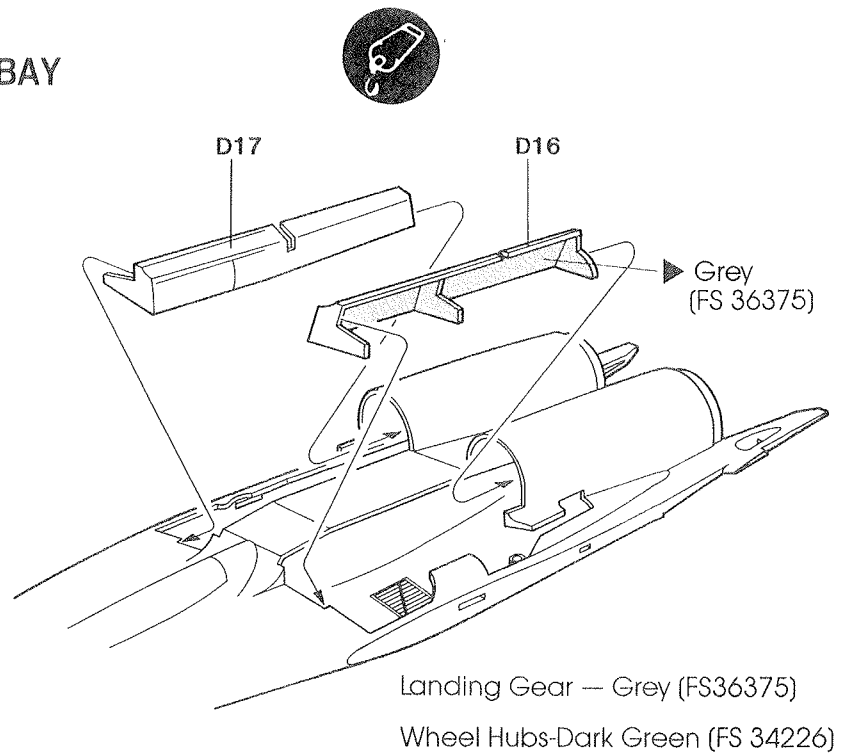
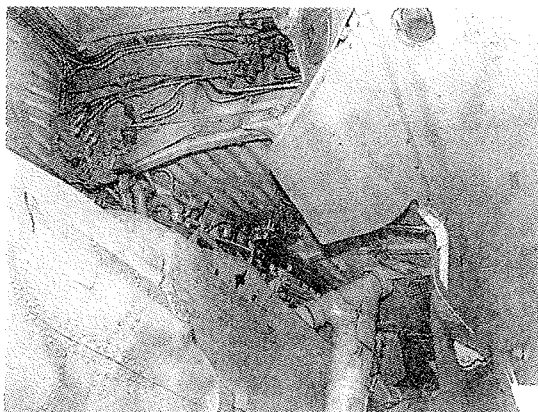

5 ASSEMBLY OF LANDING GEAR I

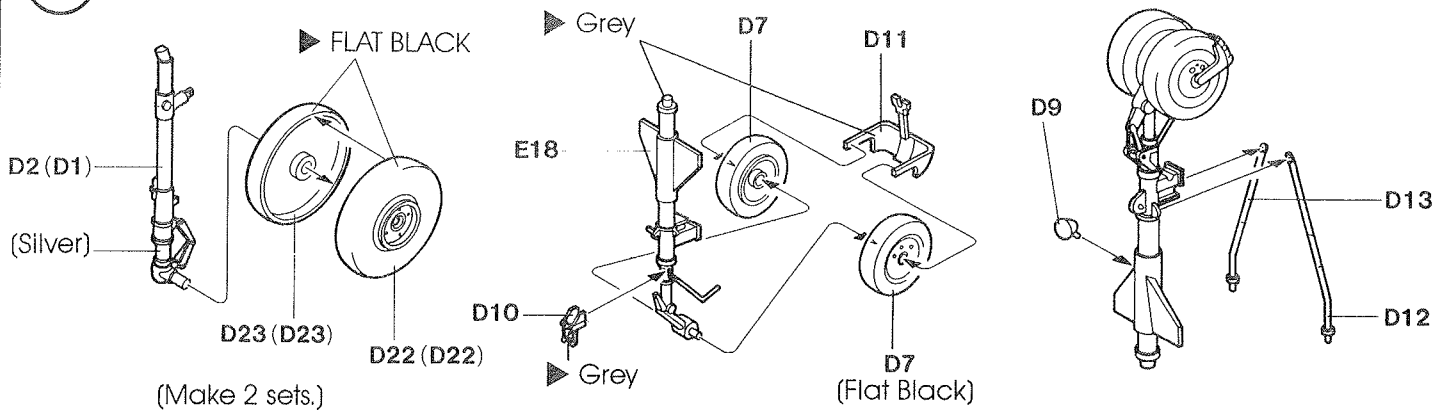

6 ASSEMBLY OF LANDING GEAR II

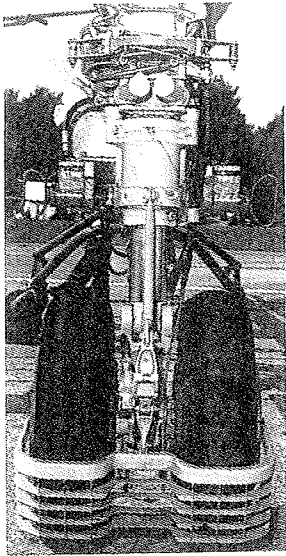

607 170 01 00

INTERIOR LANDING GEAR WHEELS
GREY (FS 36375)

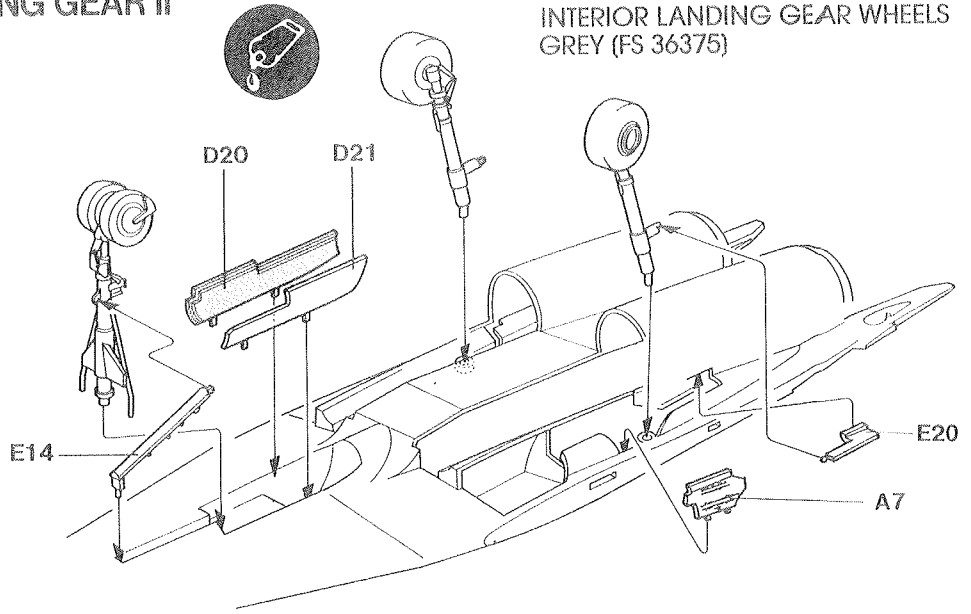

7 ASSEMBLY OF AIR INTAKE

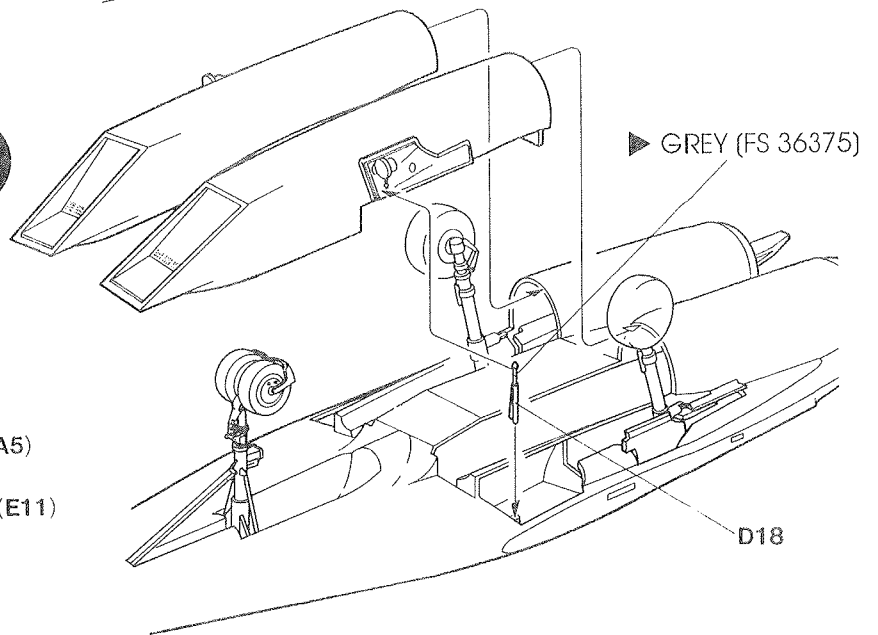
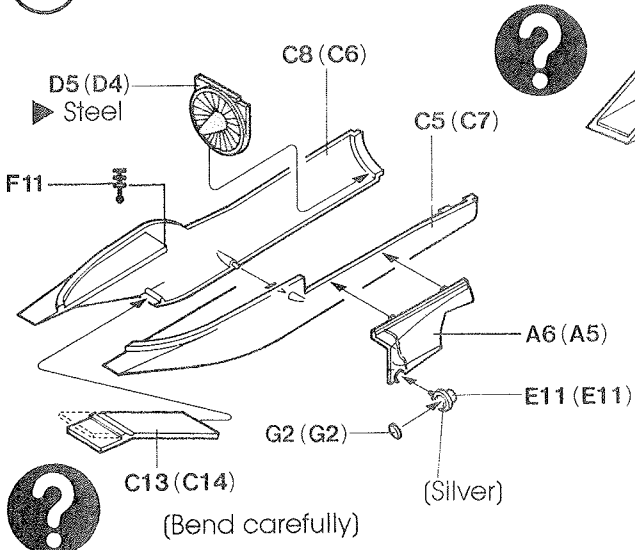

8 ASSEMBLY OF AIR BREAK

(Closed Position)

(Open Position)

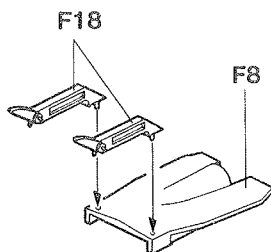
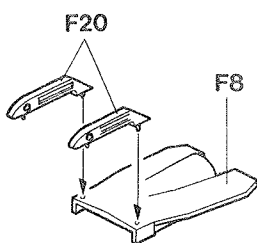
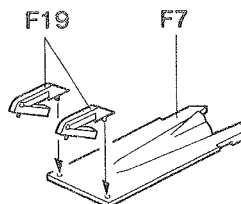
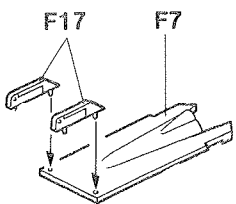

•F8,F7

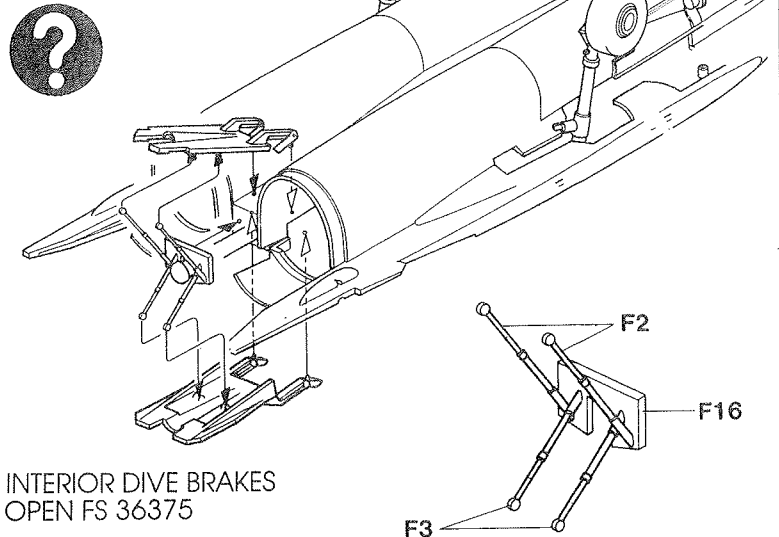

INTERIOR DIVE BRAKES
OPEN FS 36375

DO NOT ASSEMBLE WHEN IN CLOSED POSITION

9 ASSEMBLY OF EXHAUST CONE

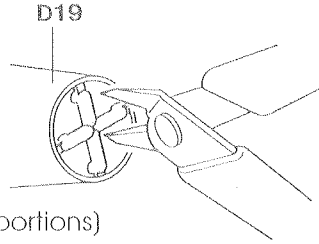
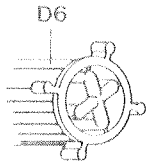

(Remove the useless portions)

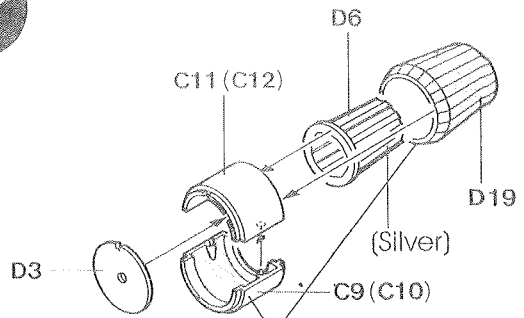

Steel and Burnt Metal

(Make 2 sets)

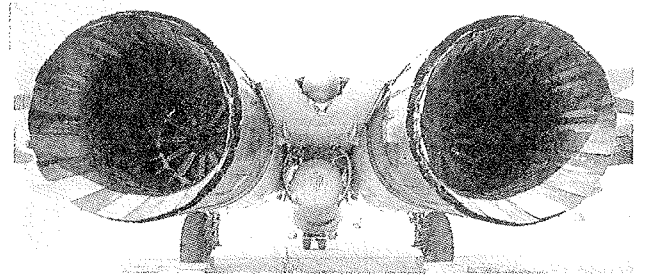
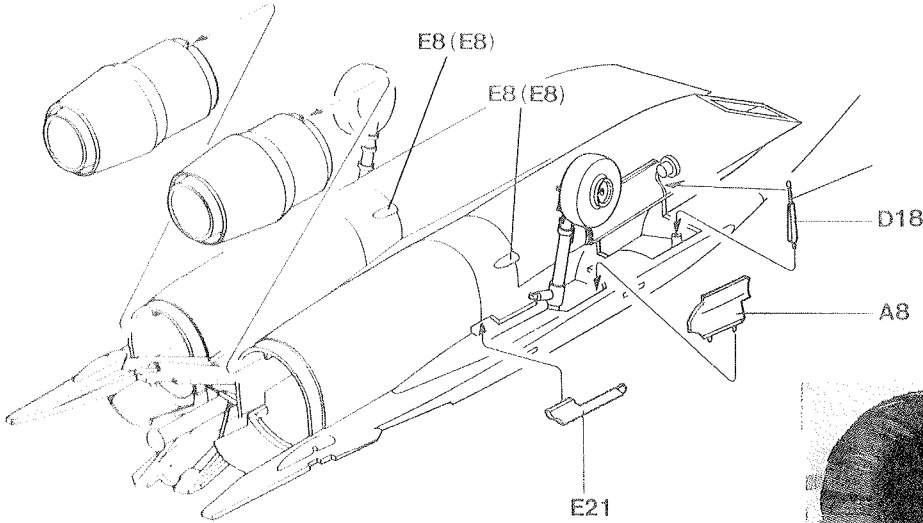

10 ASSEMBLY OF WING

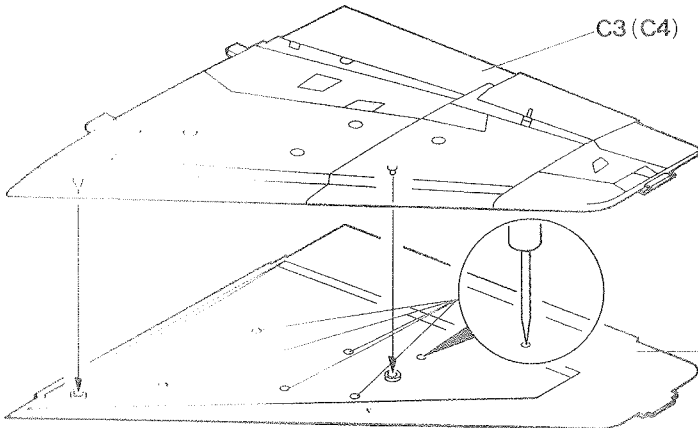

OPEN HOLES IF INSTALLING PYLONS



■ R-60MK/AA-8

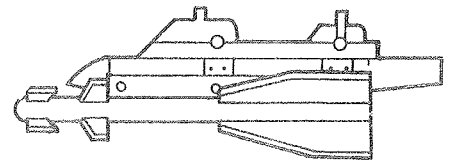

11 ASSEMBLY OF MISSILES I

■ R-27/AA-10D

■ R-73/AA-11

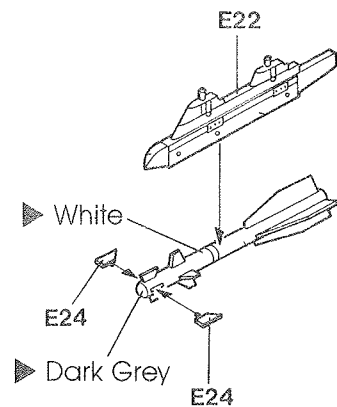
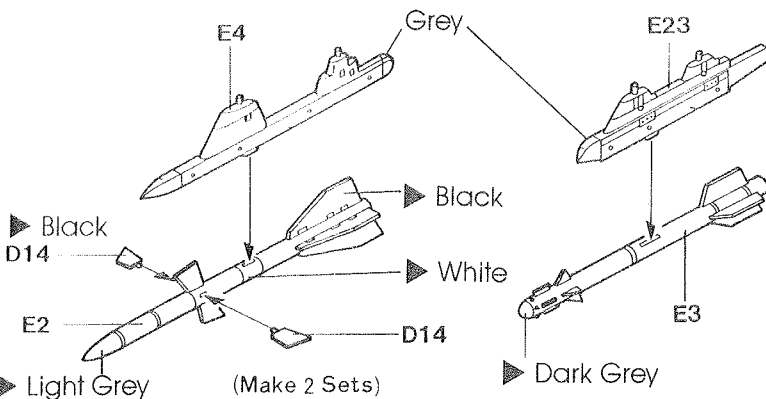

12 ASSEMBLY OF MISSILES II

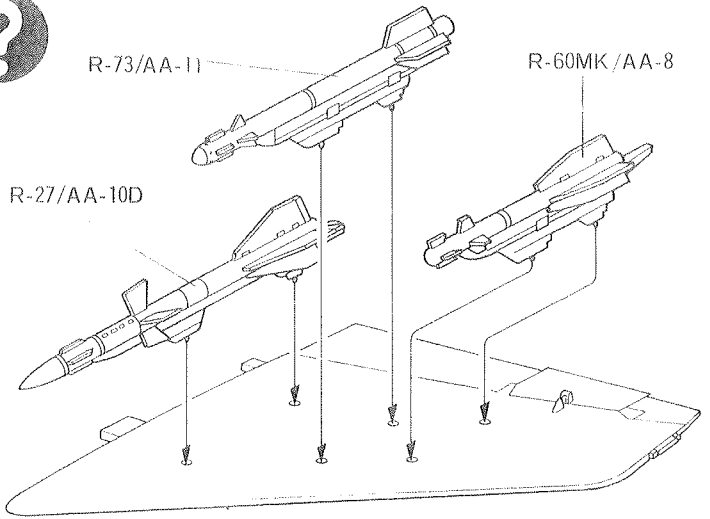
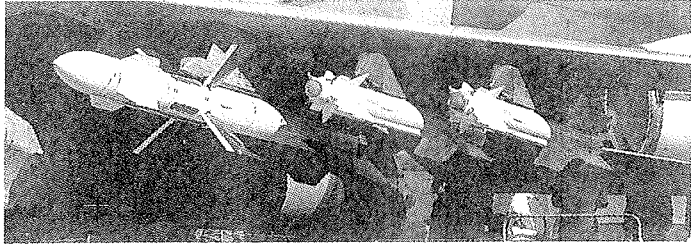

13 ASSEMBLY OF EXTERNAL FUEL TANK

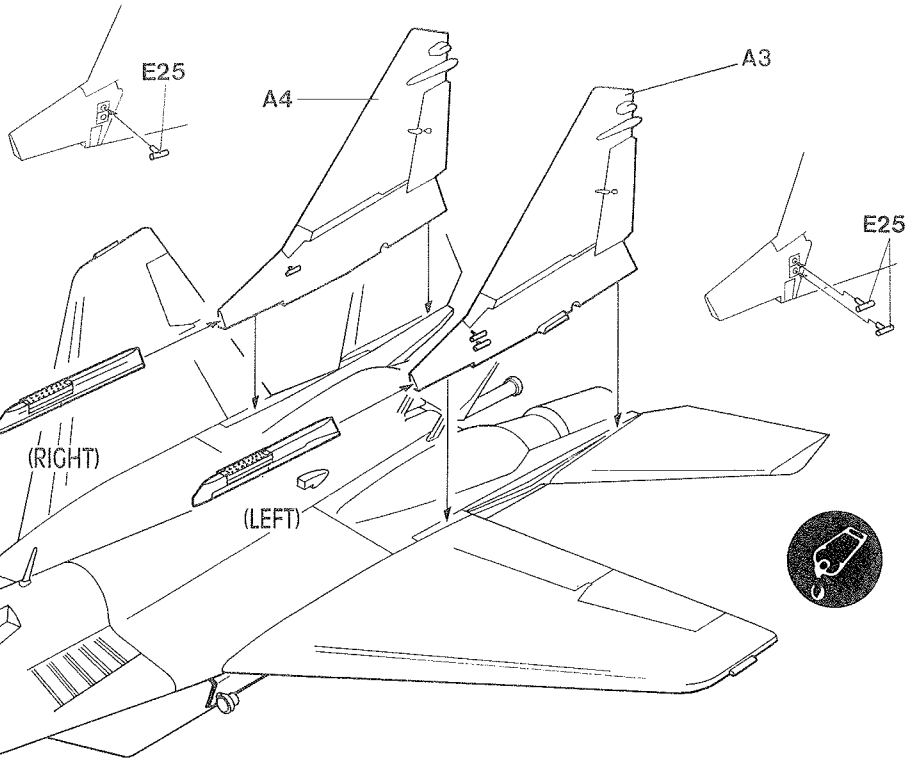
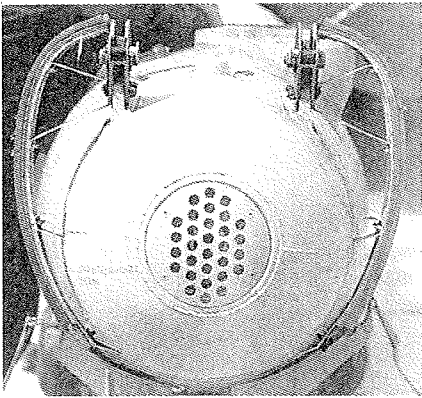
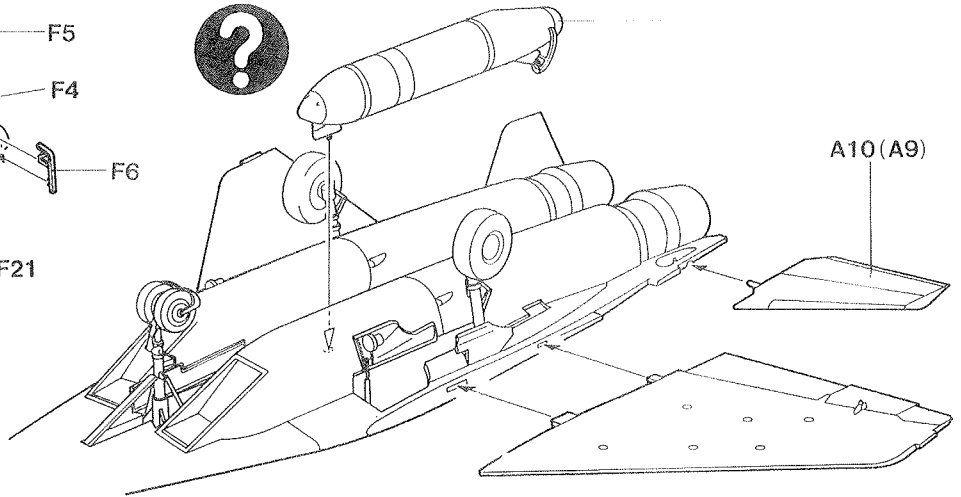
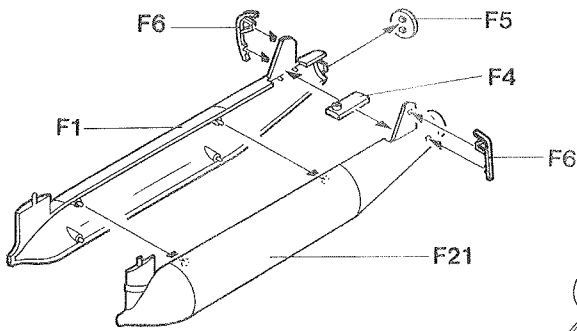

14 ASSEMBLY OF RUDDER

■ ASO-2W (Chaff/Flare Dispenser Fairing)

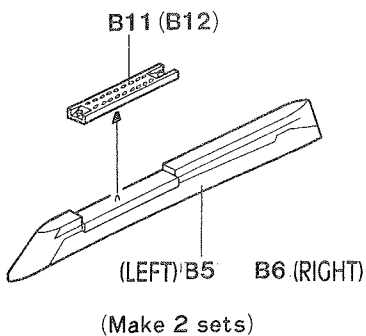

PARTS LOCATOR

A

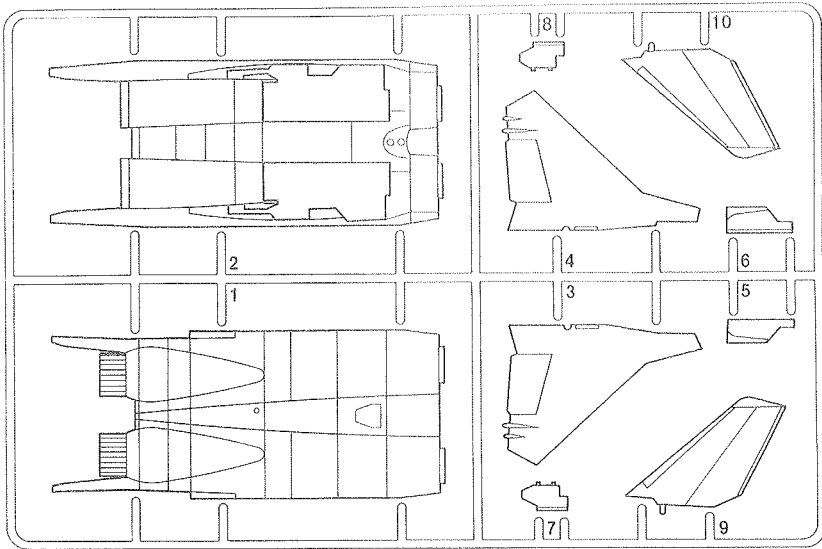

B

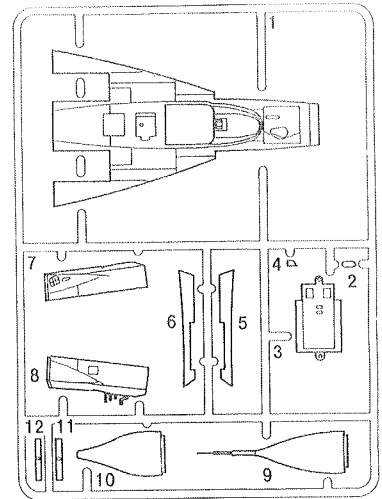

C

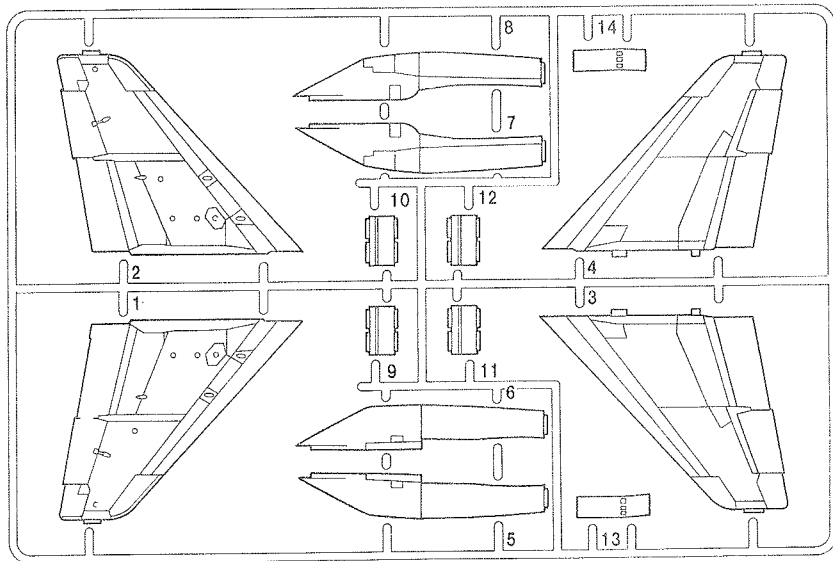

D

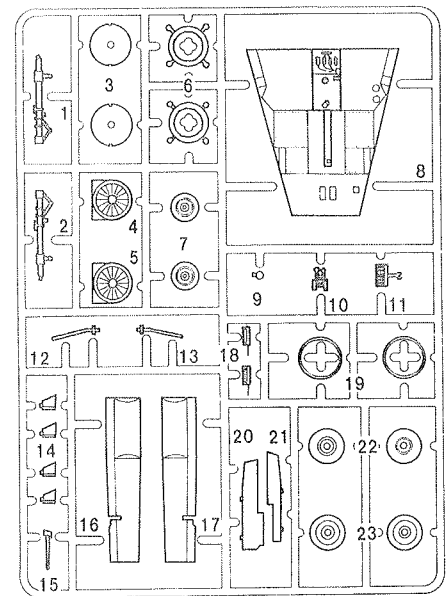

F

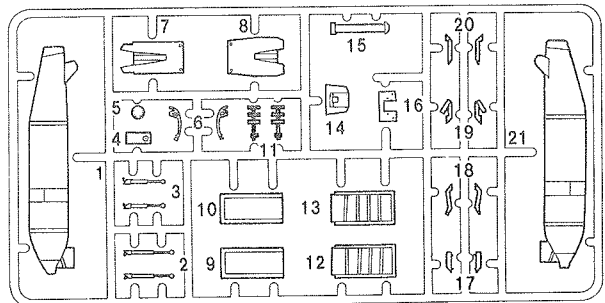

un necessary parts

E

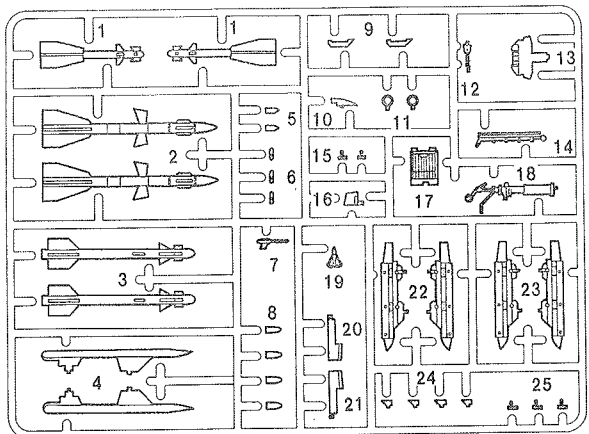

G

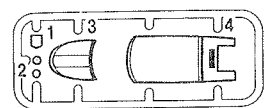

F11,E6,E9,E15

ACADEMY
HOBBY MODEL KITS

■ P38J/L LIGHTNING

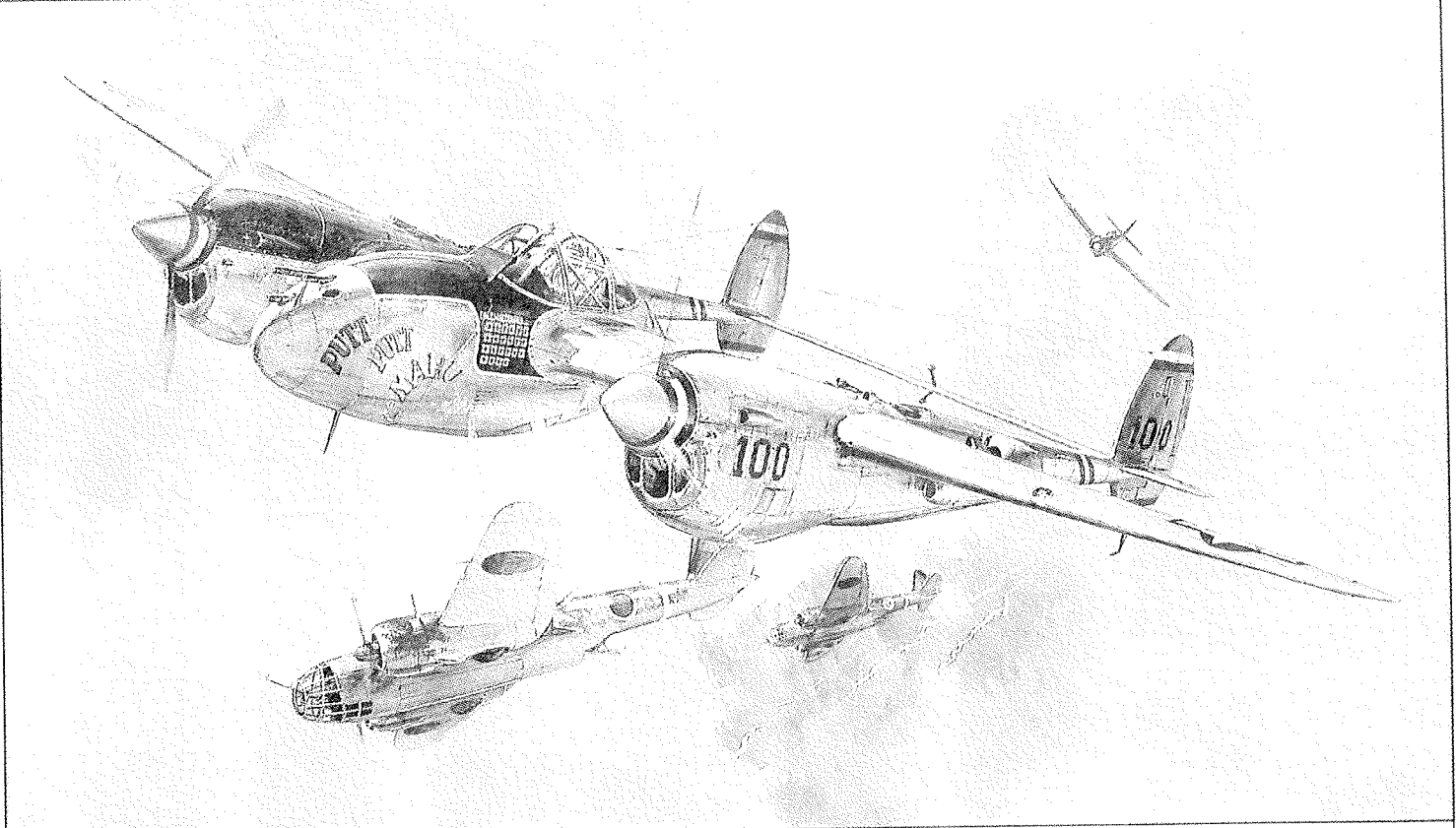



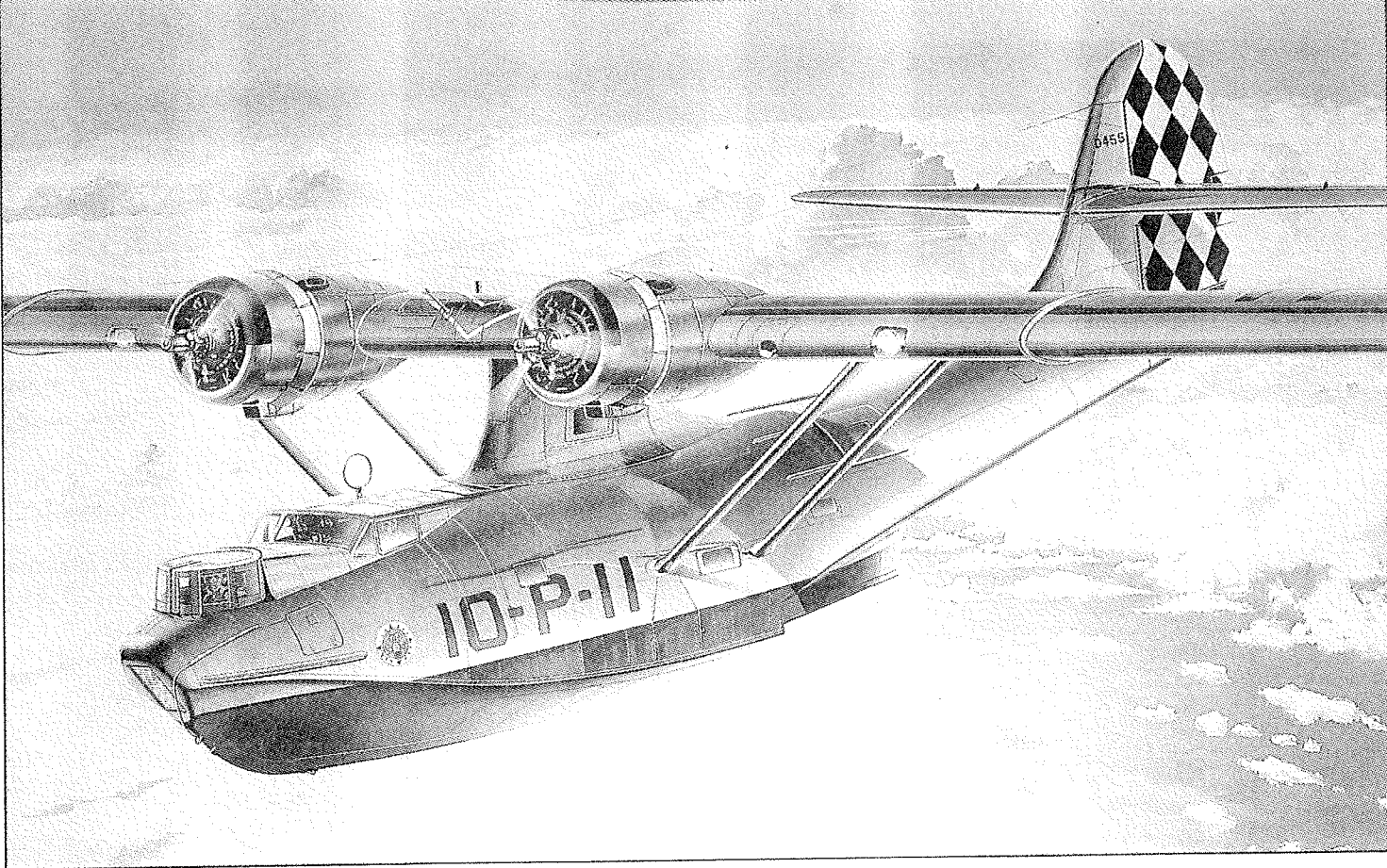

■ PBY2/5 CATALINA



Copyright Academy Plastic Model Co., Ltd.
273-64, Suyu-dong, Kangbuk-ku, Seoul, Korea FAX: 82-2-997-3003

MIG 29A Fulcrum Decal and Painting Instructions

Russian Version

	GUNSHIP GRAY	FS 36118
	BLUE GRAY	FS 35327
	LIGHT GRAY	FS 36375
	BLACK	

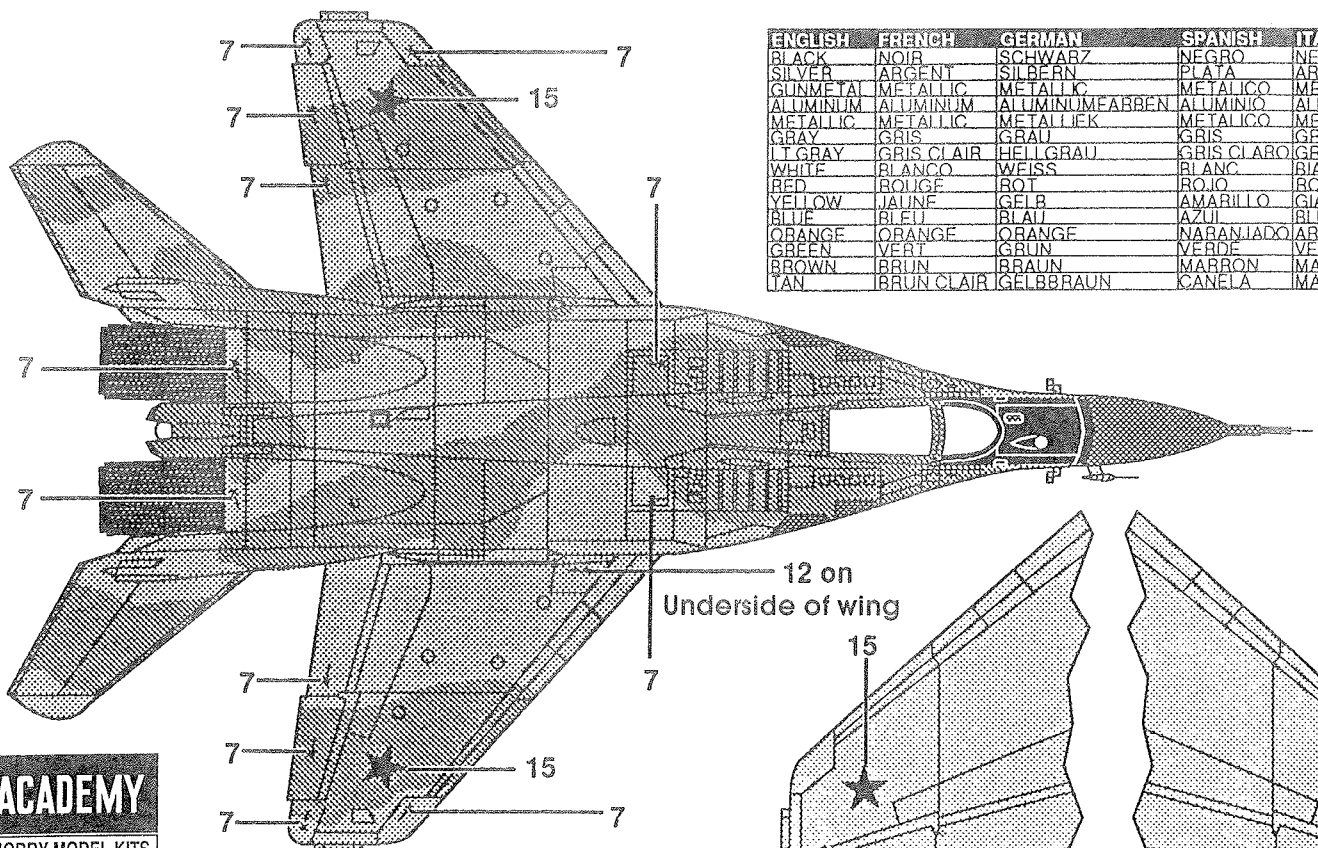
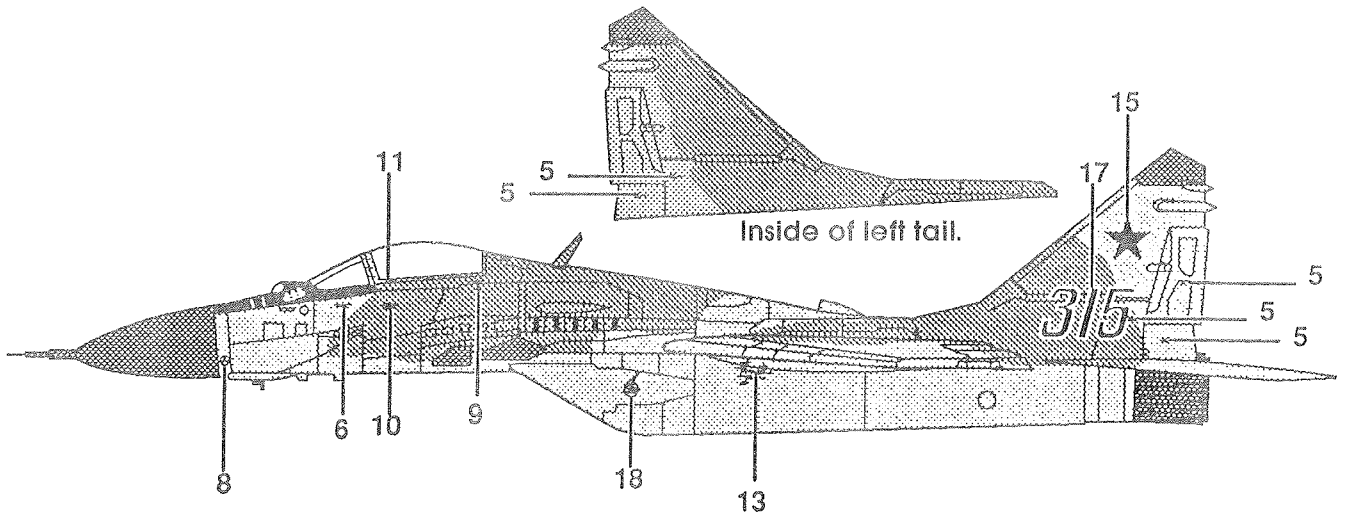
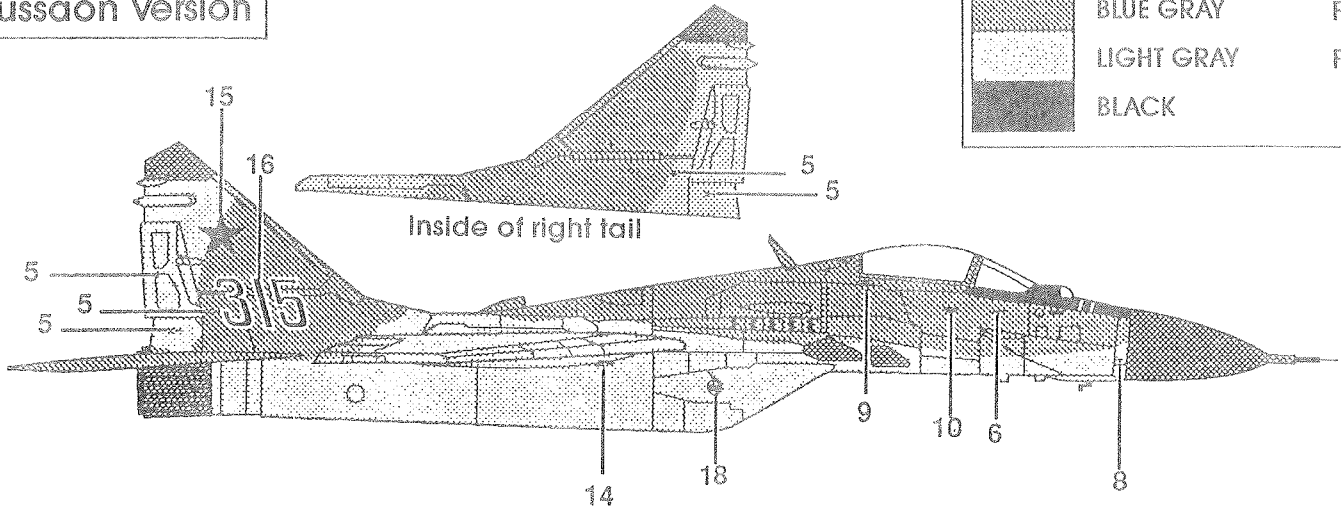

ENGLISH	FRENCH	GERMAN	SPANISH	ITALIAN
BLACK	NOIR	SCHWARZ	NEGRO	NERO
SILVER	ARGENT	SILBERN	PLATA	ARGENTO
GUNMETAL	METALLIC	METALLIC	METALICO	METALLICO
ALUMINUM	ALUMINUM	ALUMINIUM	ALUMINIO	ALLUMINIO
METALLIC	METALLIC	METALLIJK	METALICO	METALLICO
GRAY	GRIS	GRAU	GRIS	GRIGIO
LIGHT GRAY	GRIS CLAIR	HELLGRAU	GRIS CLARO	GRIGIO CHIARO
WHITE	BLANC	WEISS	BIANCO	BIANCO
RED	ROUGE	ROT	ROJO	ROSSO
YELLOW	JALUNE	GELB	AMARILLO	GIALLO
BLUE	BLEU	BLAU	AZUL	BLU
ORANGE	ORANGE	ORANGE	NARANJADO	ABANCIO
GREEN	VERT	GRUN	VERDE	VERDE
BROWN	BRUN	BRAUN	MARRON	MARRONE
TAN	BRUN CLAIR	GELBBRAUN	CANELA	MARRONE CHIARO

ACADEMY
HOBBY MODEL KITS