



SCALE 1/35 AF 35277



# IDF SHO'T KAL DALET 1982

w/BATTERING RAM



\*\*Special thanks to Robert Goldman , Robert Skipper, Yoav Efrati and other friends of IDF.

Sho't Kal tanks entered service in IDF in 1970. Its number was over 1000 before the Yom Kippur War broke out in 1973. Most of Sho't kal tanks were deployed in armor brigades located in the northern Israel. When the war broke out on 6th October 1973, IDF 188th and 7th armor divisions defended Golan Height and held the surprise attack of Syrian armor divisions. During four days of battles in Golan Height, IDF lost about 200 Sho't Kal tanks and caused Syrian forces heavy losses. The most importantly, it bought precious time for regrouping reserve troops and preparing counterattack.

After Yom Kippur War ended, IDF received M60A3 and Mercava Mk.I tanks and still continually upgraded Sho't kal tanks which were still in service. control mechanisms of turret were upgraded in 1976. It was called Sho't Kal B(Sho't Kal Bet) after this upgrade. After went through a series of battles, IDF established their tank design standards which emphasized personnel protection. Consequently, Sho't Kal tanks were later equipped with explosive reactive armor (ERA) which was very effective against shape charge warheads called Sho't Kal C(Sho't Gimel). It was the first time that ERA was used in the battlefield in 1982 Lebanon War. In the urban battles of Beirut, many Sho't Kal tanks were hit by rocket-propelled grenades (RPG) and they still maintained their combat capabilities because of protection of explosive reactive armor. In the 1984, Sho't Kal tanks with upgraded explosive reactive armor were called Sho't Kal D(Sho't Kal Dalet) and they served in IDF until late 1980s.

イスラエル国防軍のショットカルは、1970年に配備が始まり、1973年の第四次中東戦争勃発前には、数が1000輛以上に達しており、そのほとんどが、イスラエル北部に配置された装甲部隊に属していた。1973年10月6日 第四次中東戦争が始まったとき、イスラエル第188および第7装甲師団がゴラン高原防衛に投入され、シリア軍装甲部隊の奇襲攻撃に対抗したのであった。4日間に及ぶ戦闘で、イスラエル軍は約200輛のショットカルを失ったが、シリア軍はさらに大きな損失を被ったのであった。そしてイスラエルにとって最も重要な点は、この戦闘で敵の行動を遅滞させ、後備部隊編成による反撃準備のための貴重な時間を稼いだということであった。

第四次中東戦争終結後、イスラエル国防軍はM60A3やメルカバMk. I といった戦車を装備していったが、いまだ現役であるショットカルについての改良も引き続き行っていた。1976年に砲の俯仰、砲塔の旋回装置に改良が加えられ、この型はショットカルBと呼称された。その後、幾度もの戦闘を経て、イスラエル国防軍は、乗員防御に力点を置く独自の戦車設計を確立していったのである。その結果、ショットカルは成型炸薬弾に対する防御効果のある、リアクティブアーマー(ERA)を装備するようになり、この型はショットカルC(ギメル)と呼称された。初めてリアクティブアーマーが実戦に投入されたのは、1982年のレバノン戦争であった。ベイルート郊外での戦闘において、多くのショットカルが対戦車擲弾(RPG)による攻撃を受け被弾したが、リアクティブアーマーの防御効果により、ほとんどが戦闘力を失うことを免れたのである。1984年、改良型のリアクティブアーマーを装備したタイプが登場し、ショットカルDと呼称され、1980年代の終わりごろまで、イスラエル国防軍に配備されたのであった。

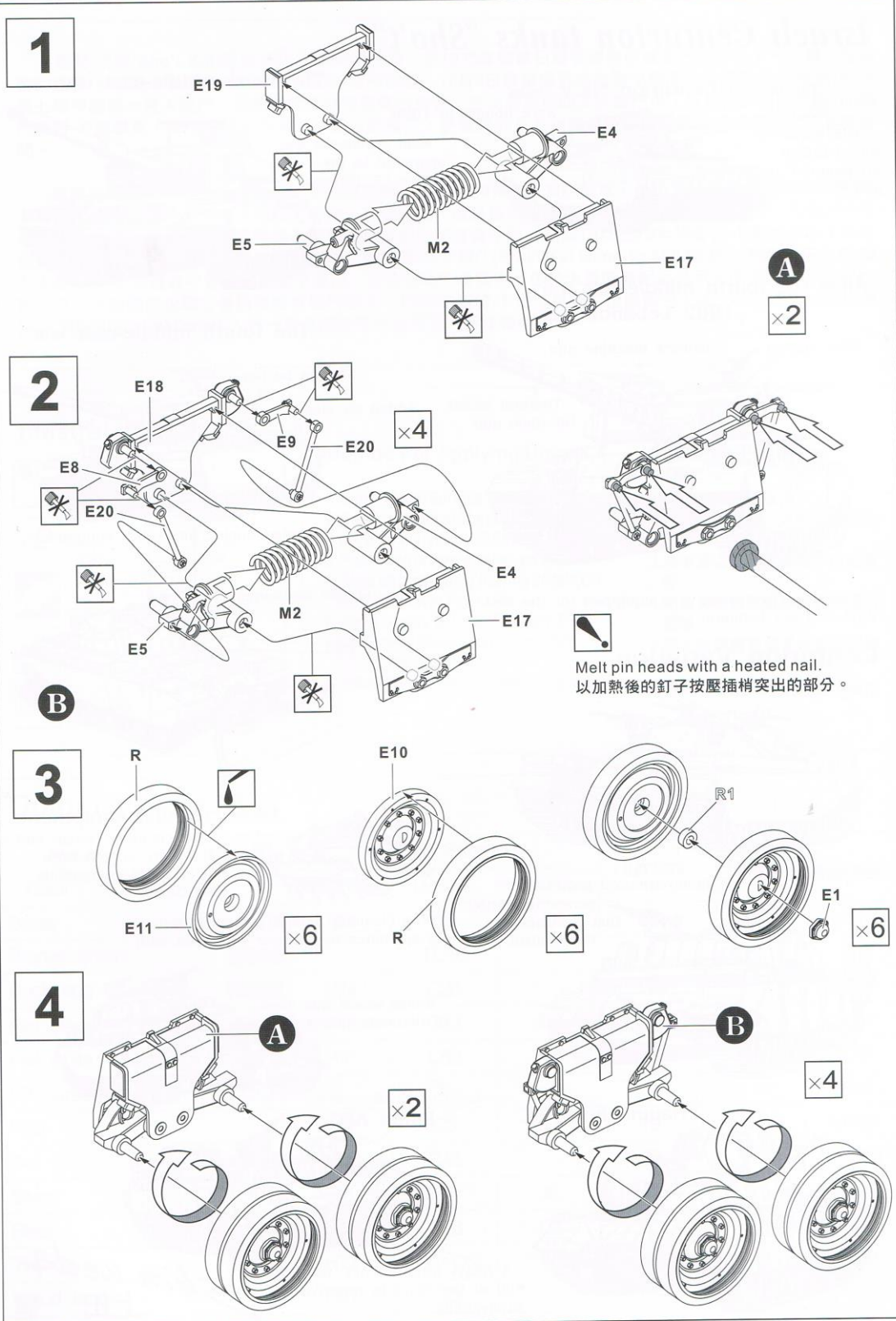



5

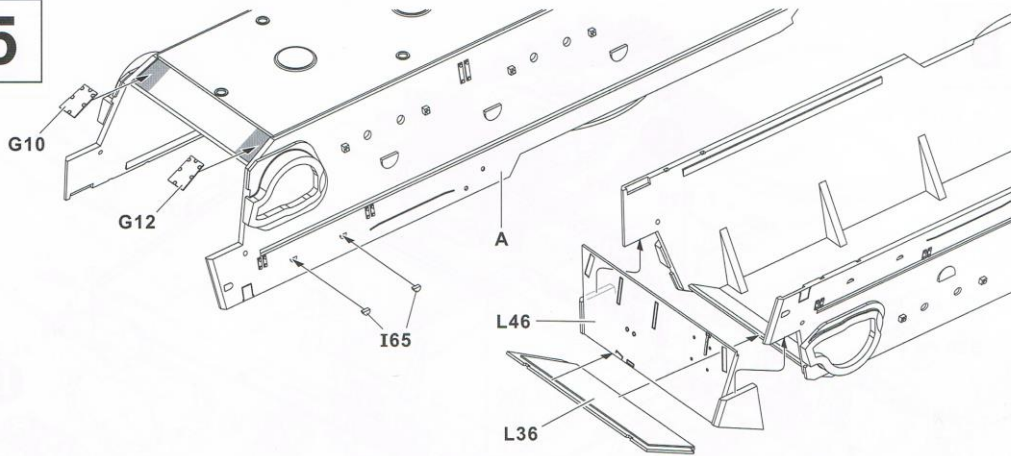

6

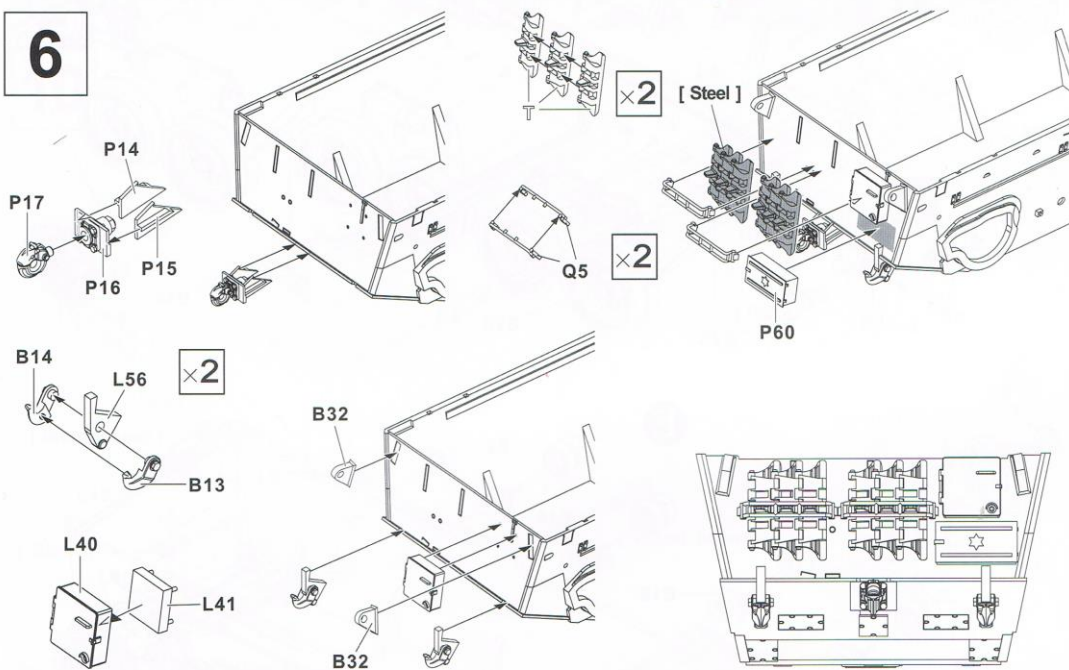

7

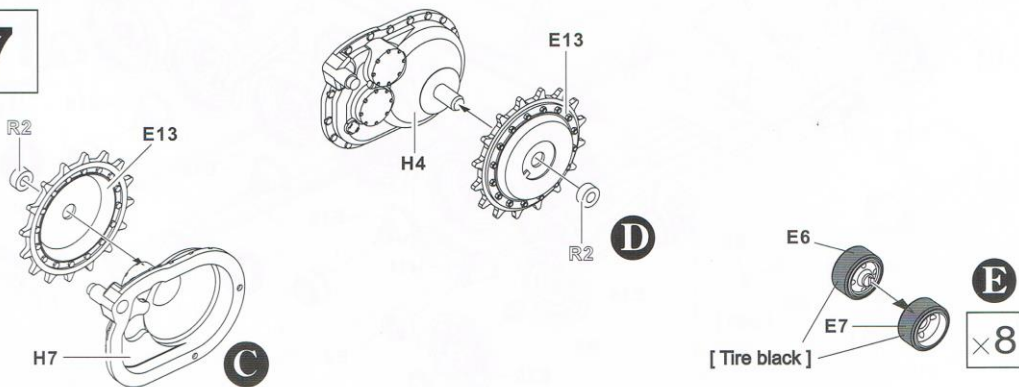

8

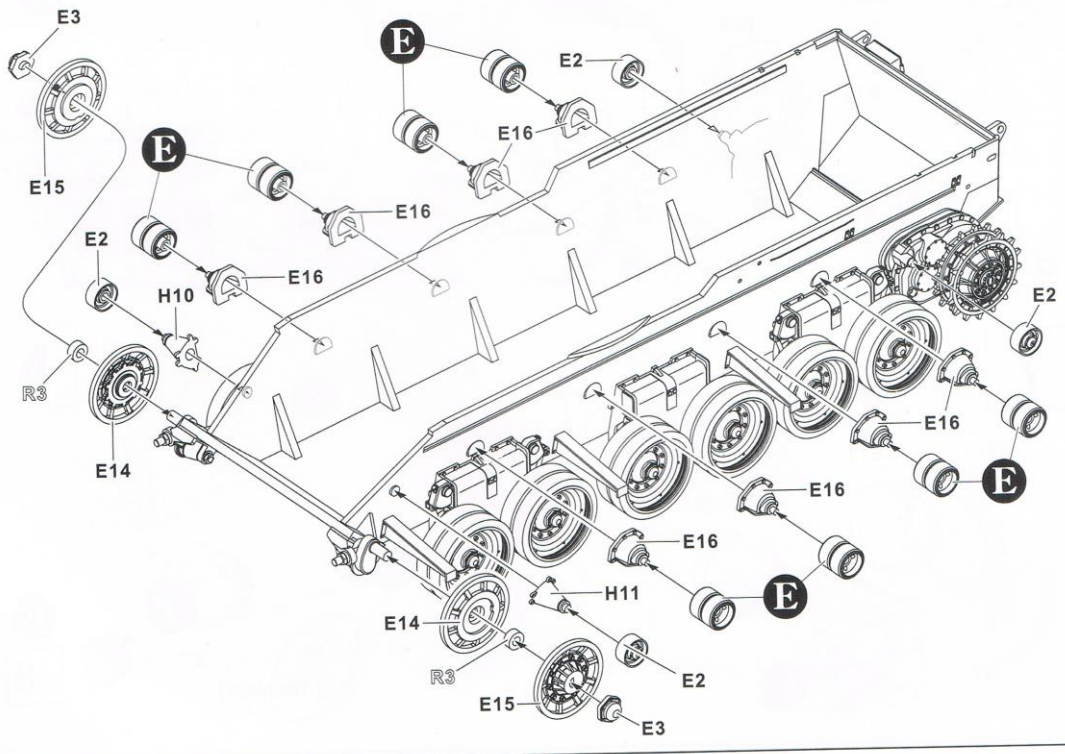
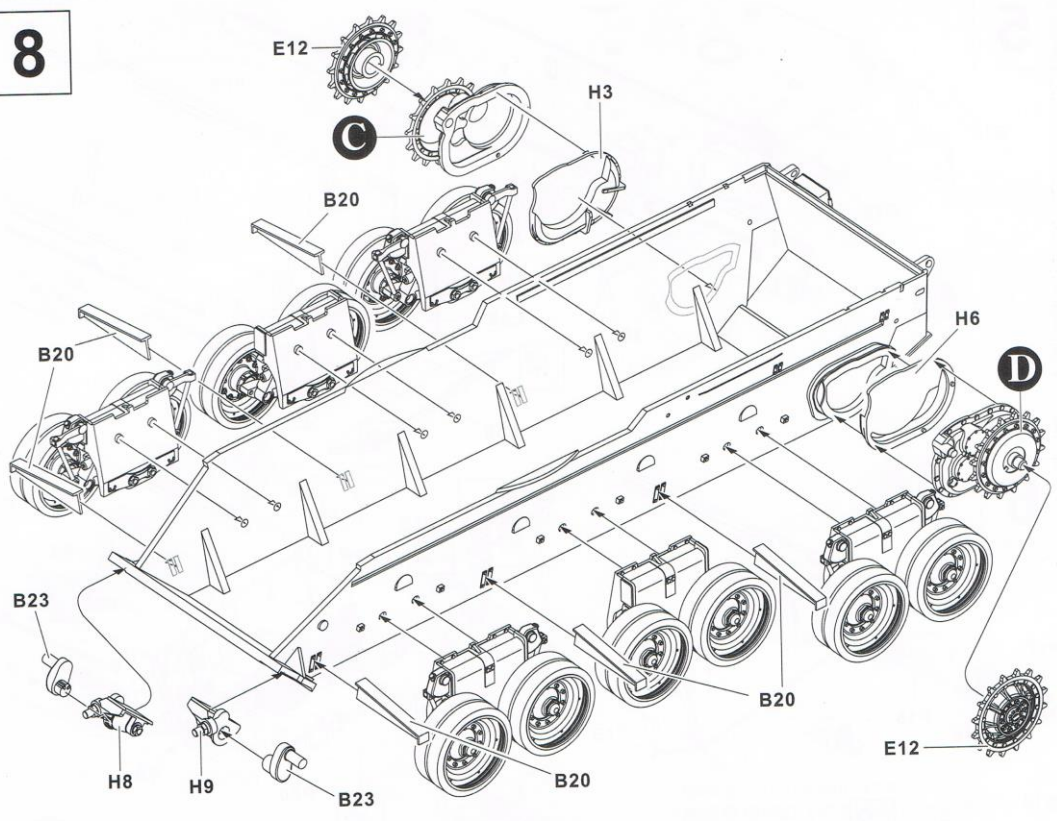



9

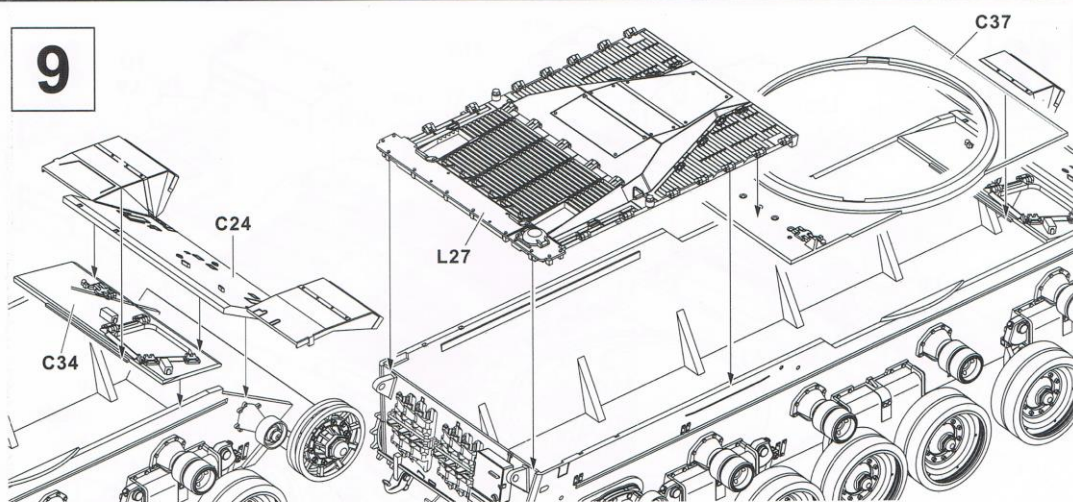

10

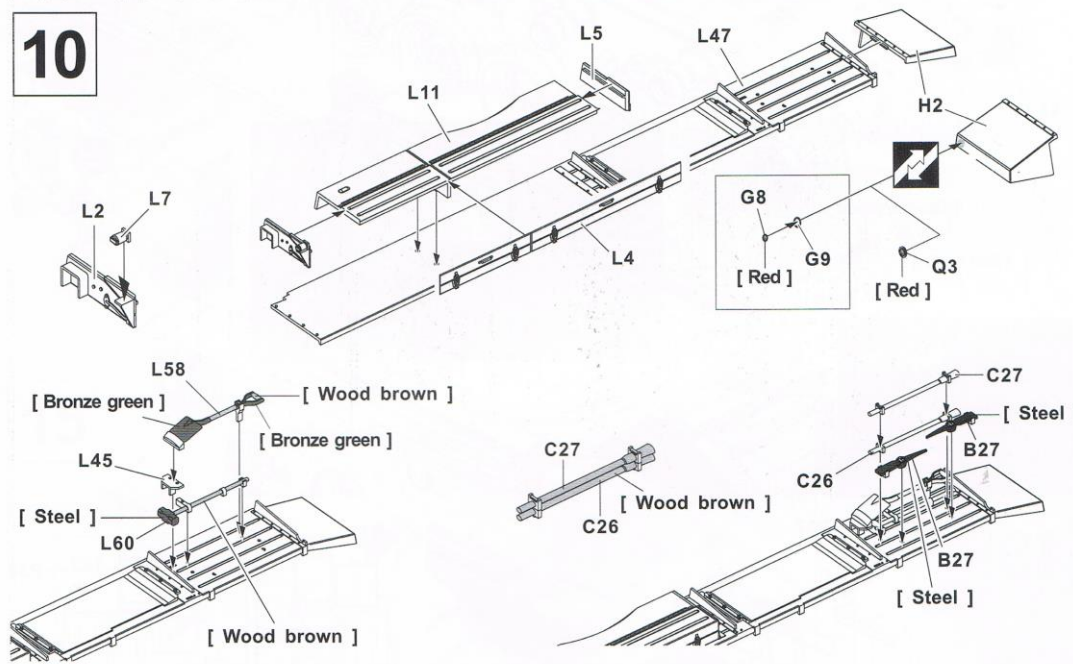

11

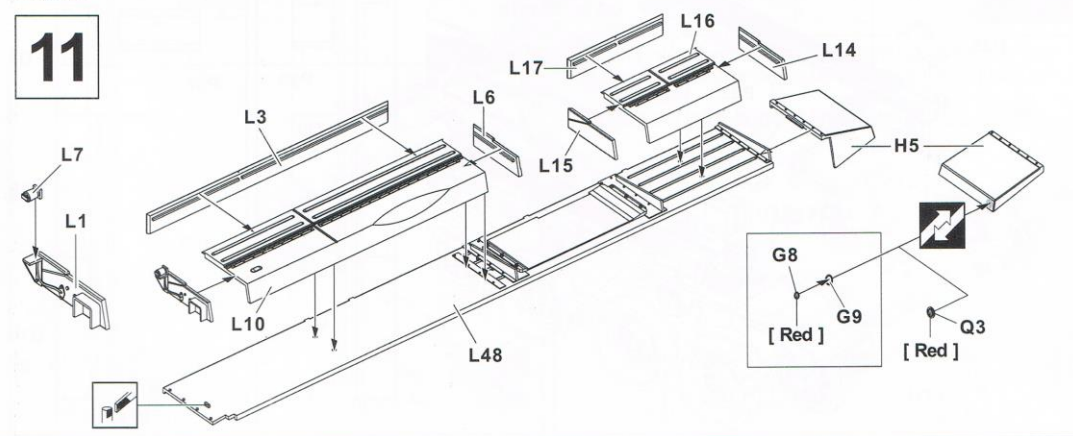

12

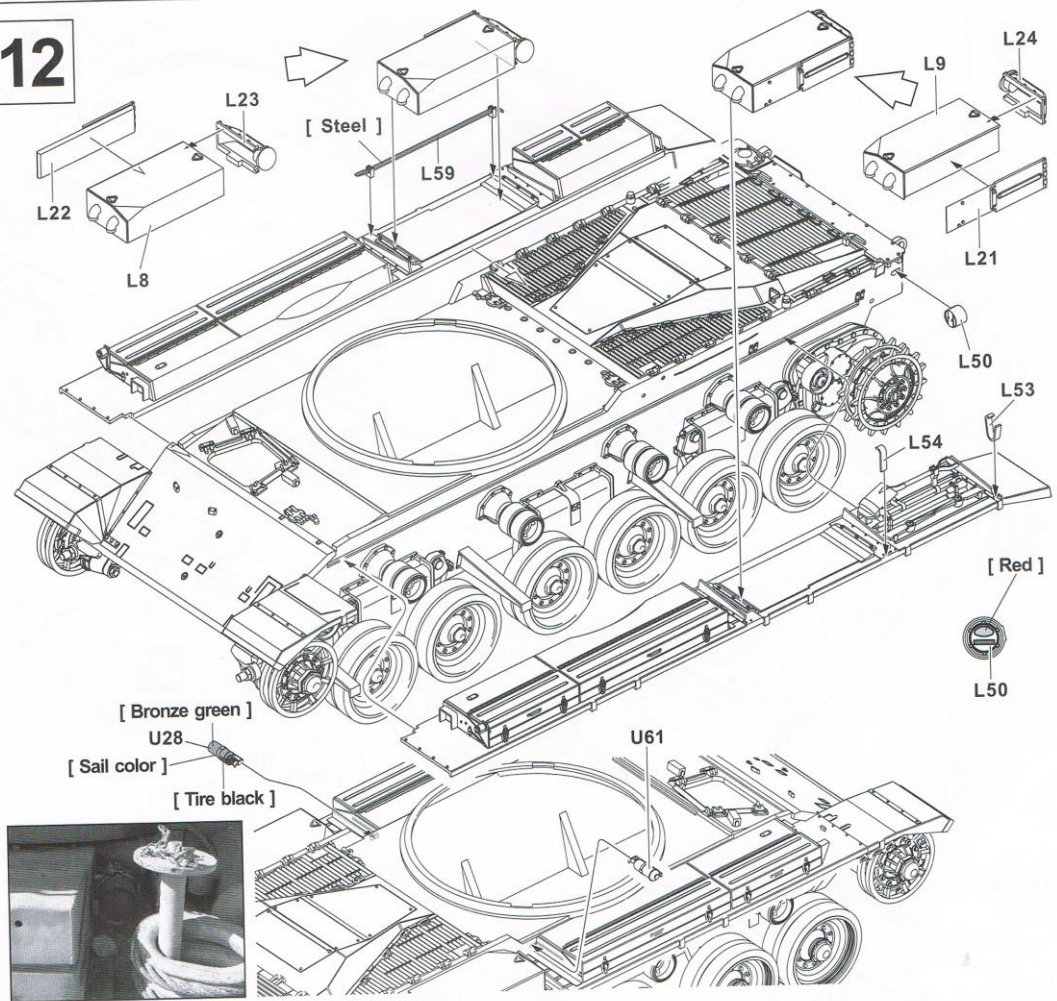

13

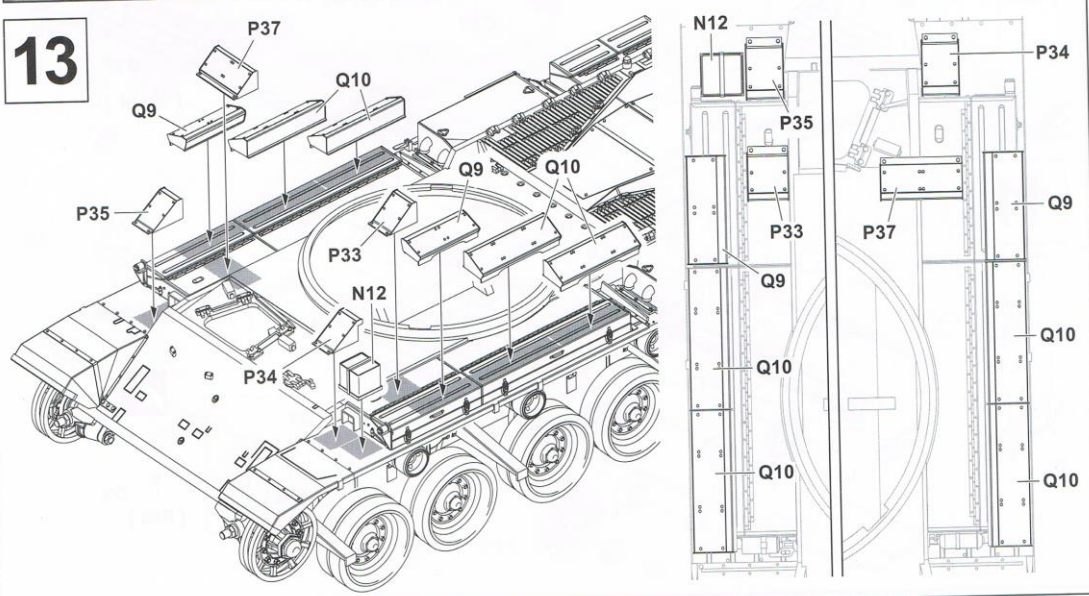



# 14

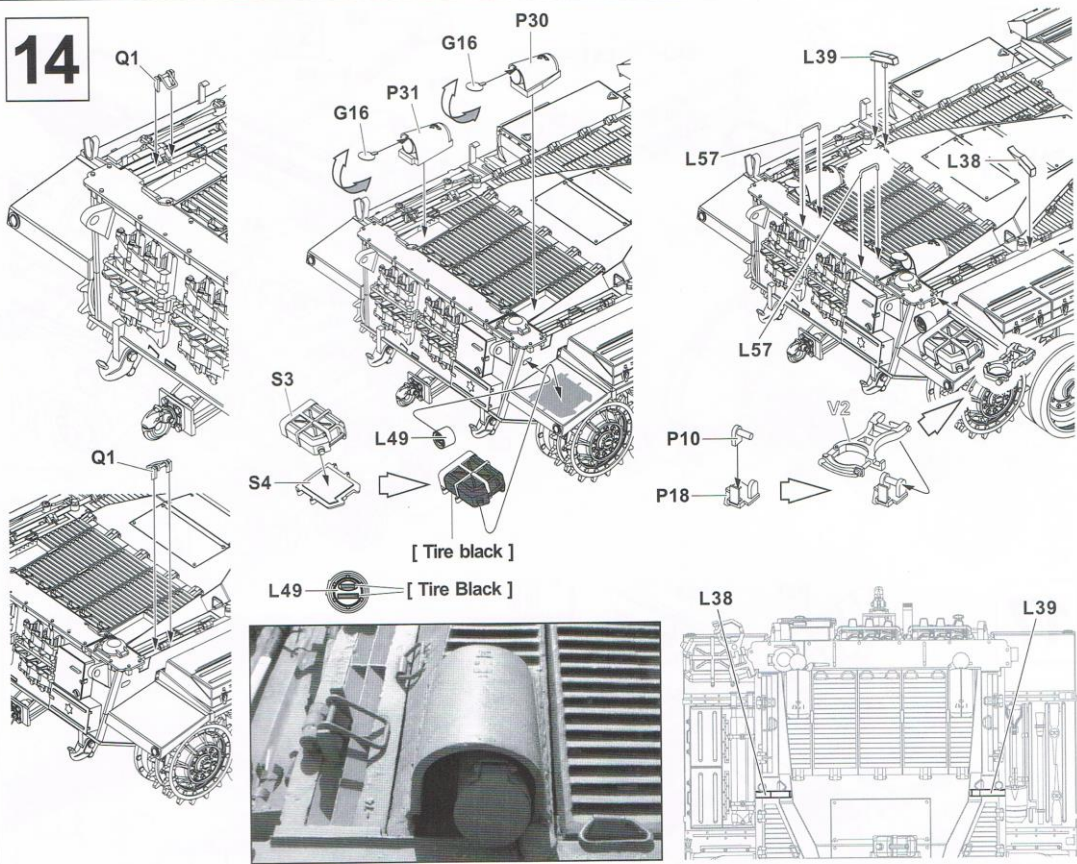

# 15

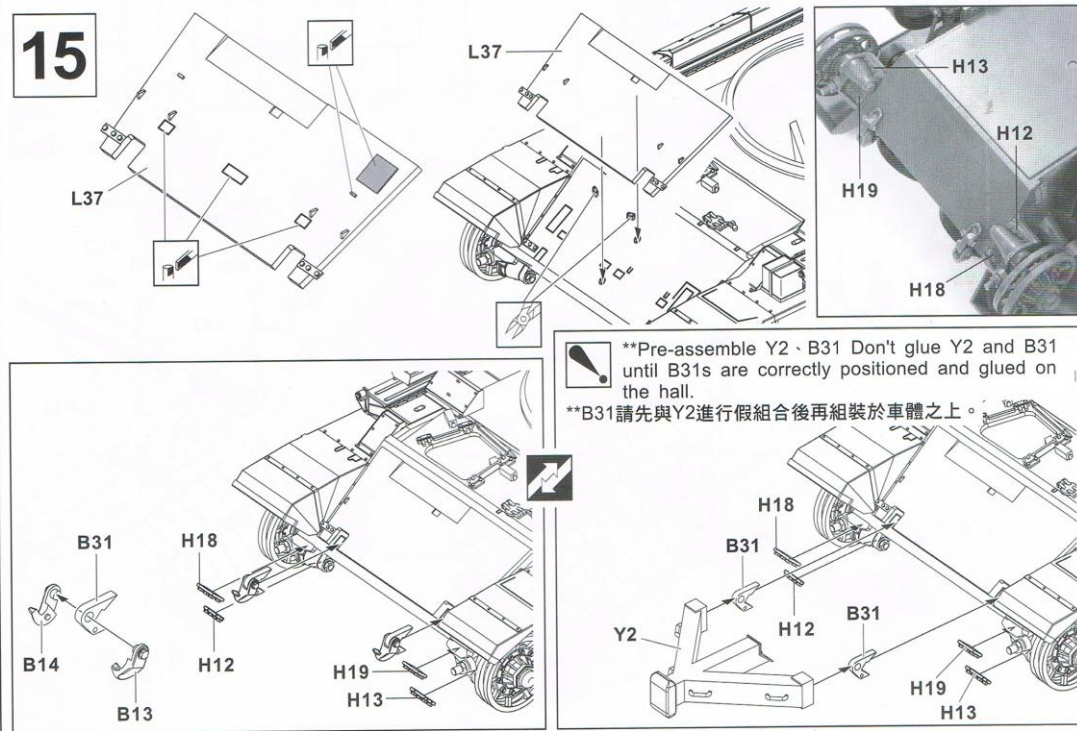

16

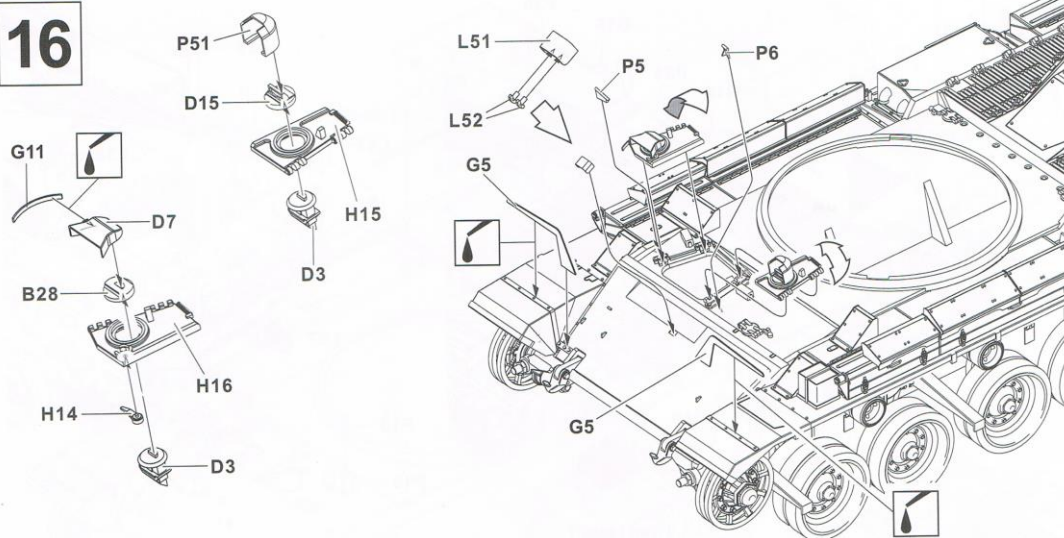

17

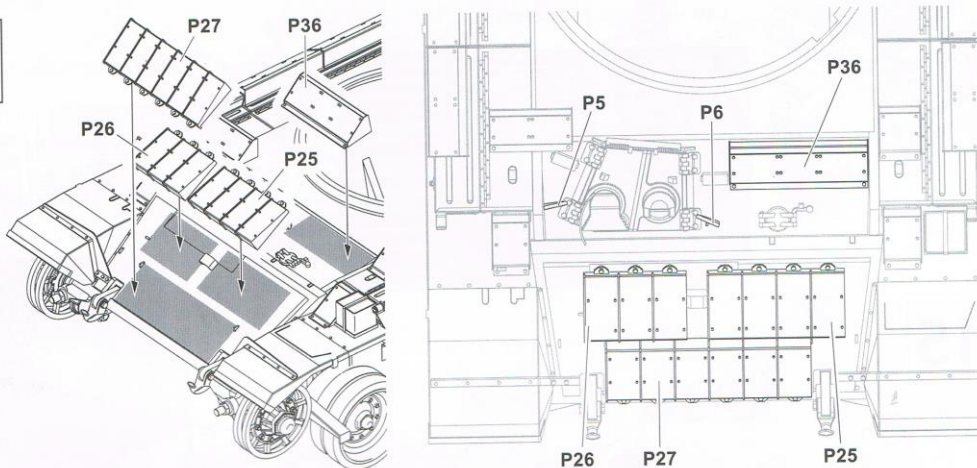

18

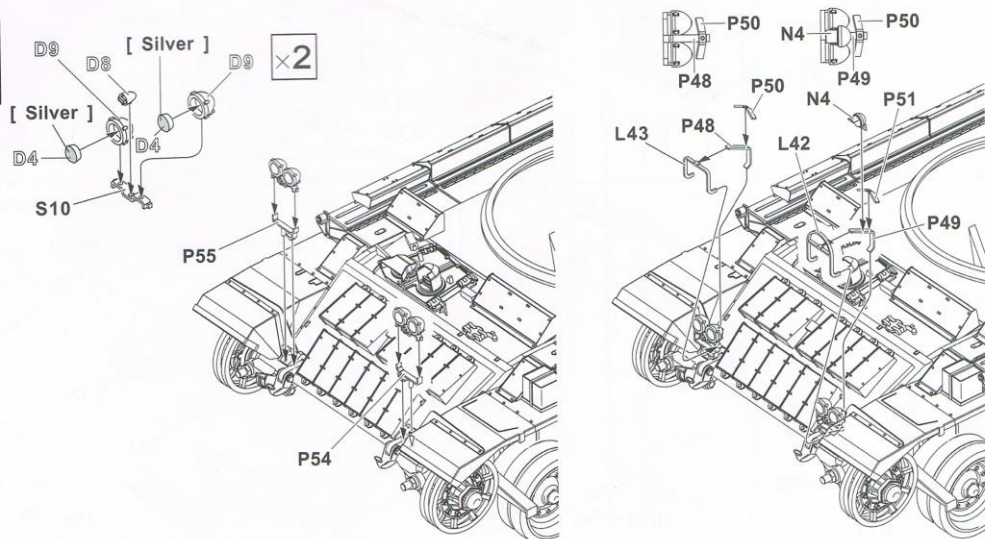



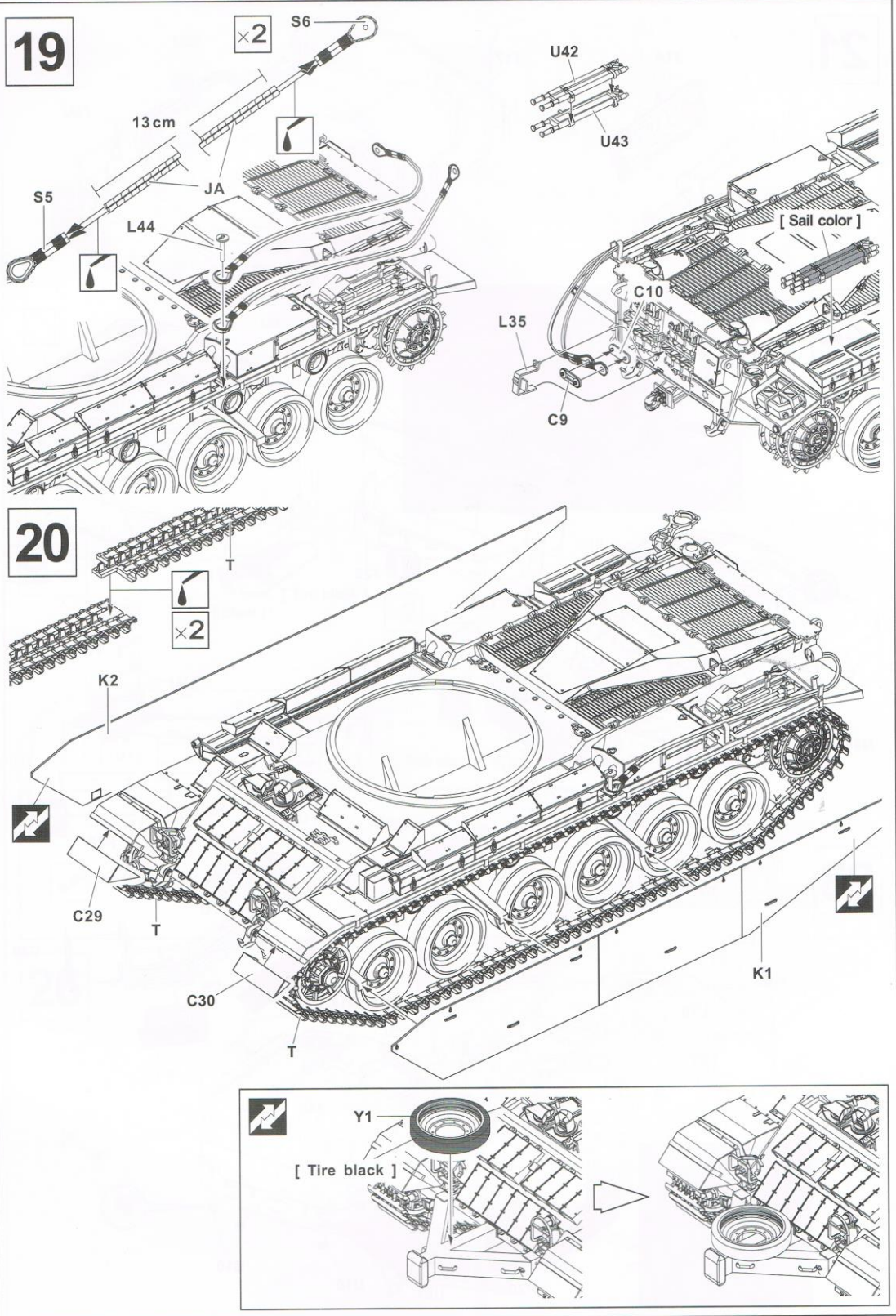

21

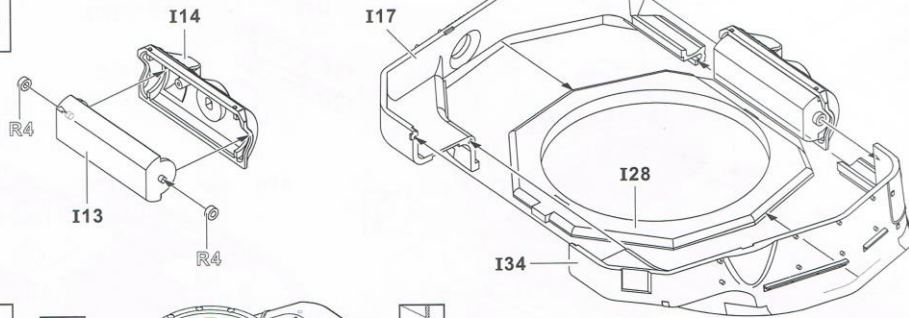

22

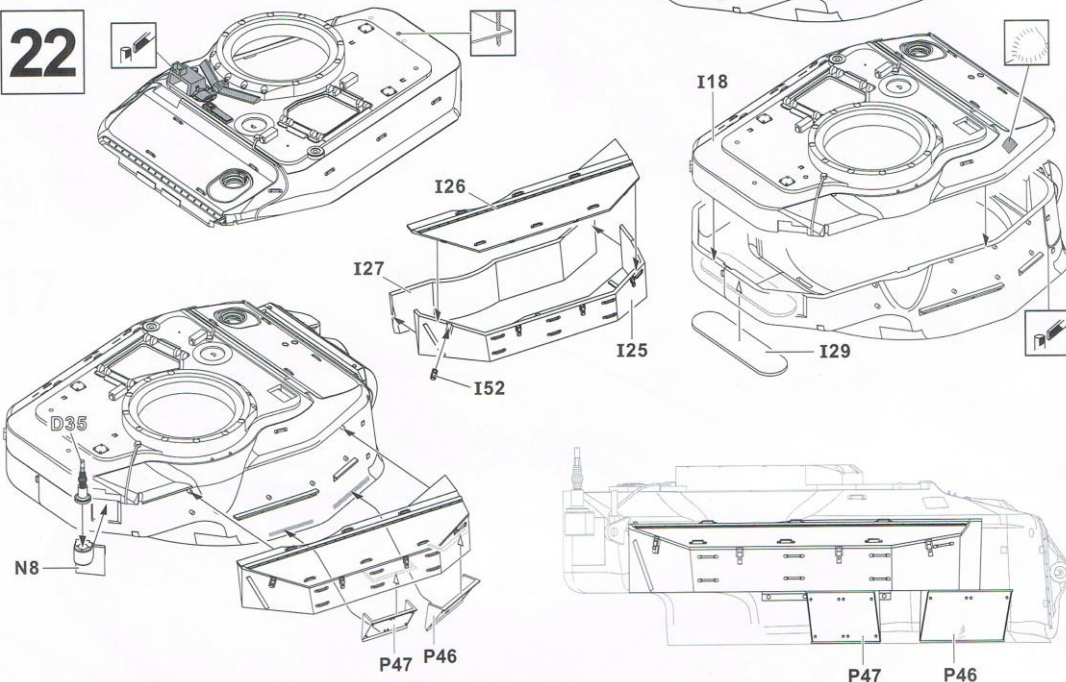

23

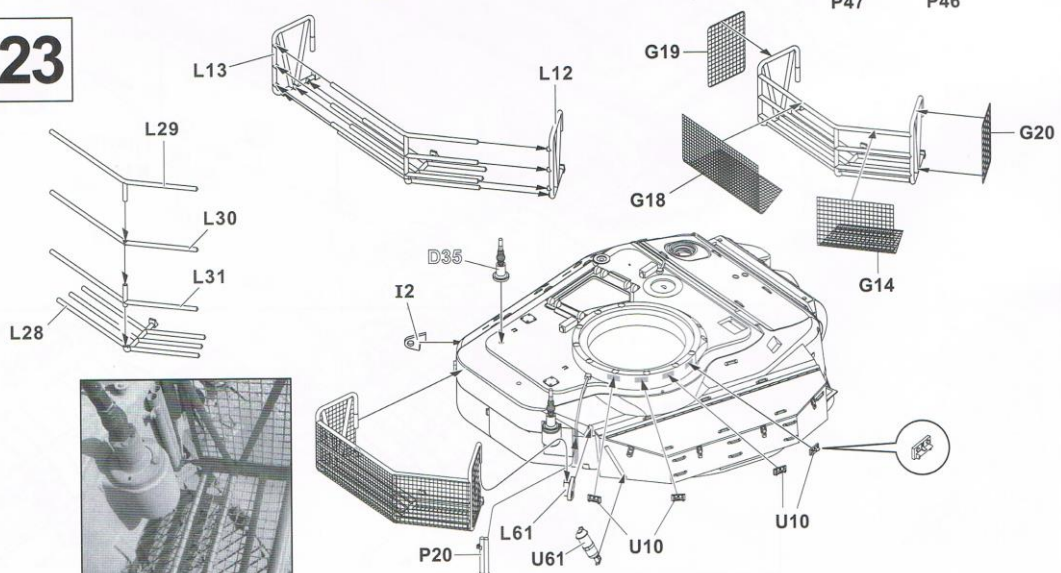



24

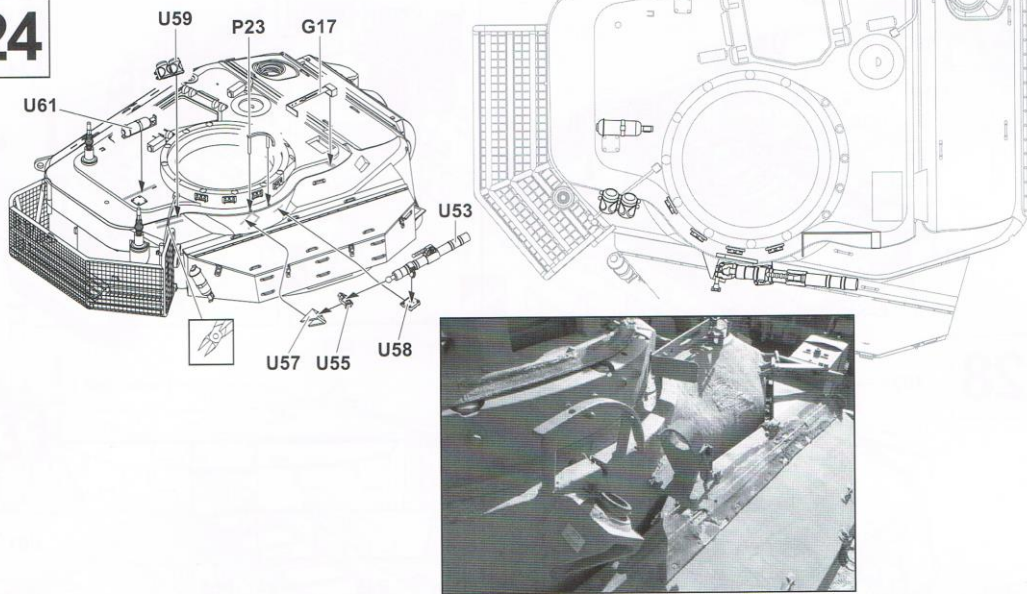

25

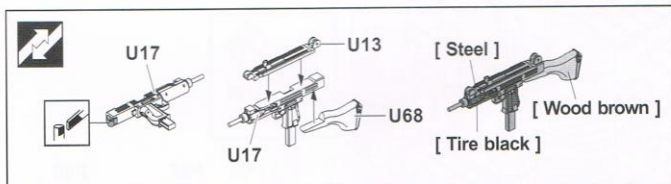
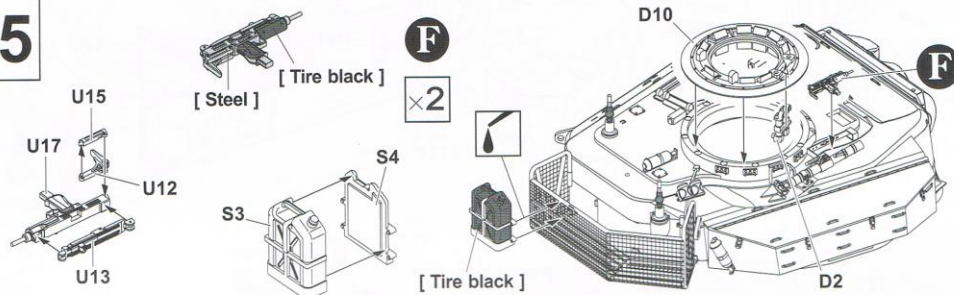

26

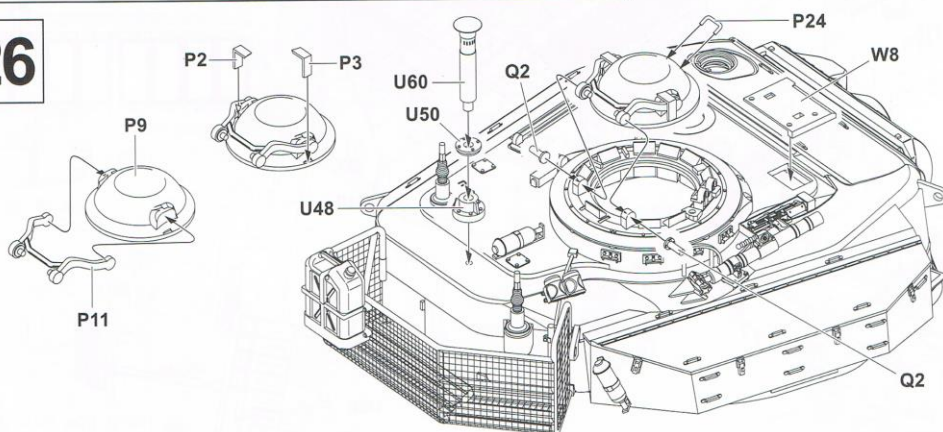

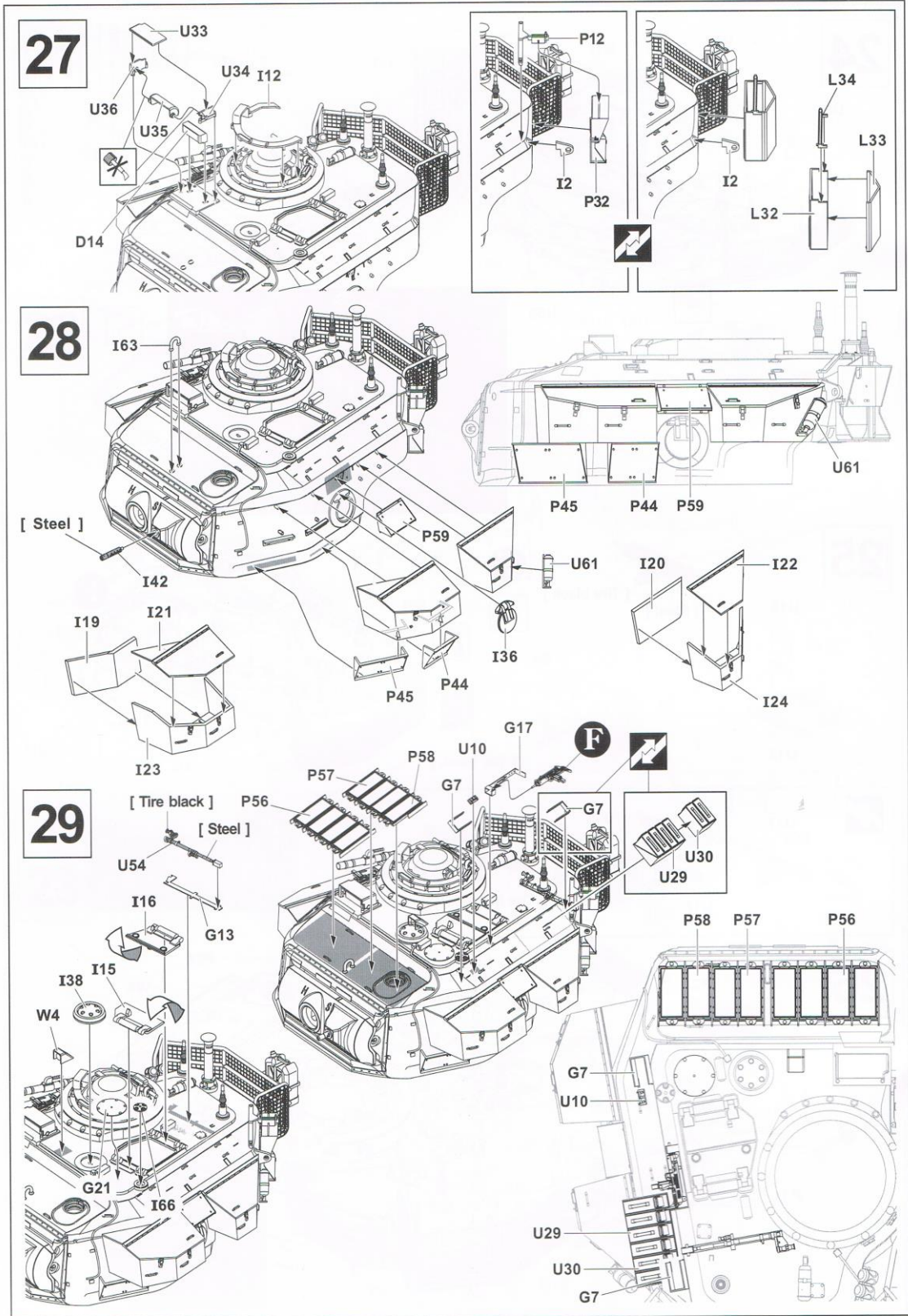



30

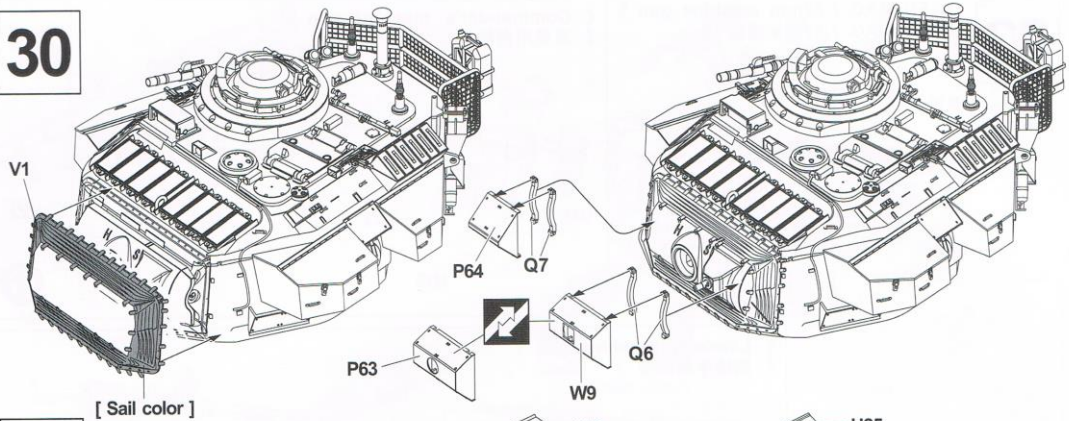

31

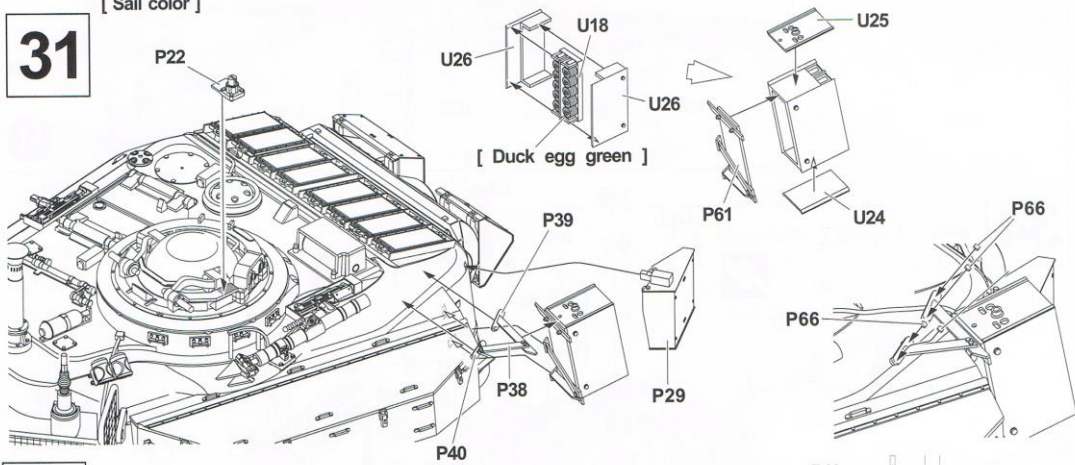

32

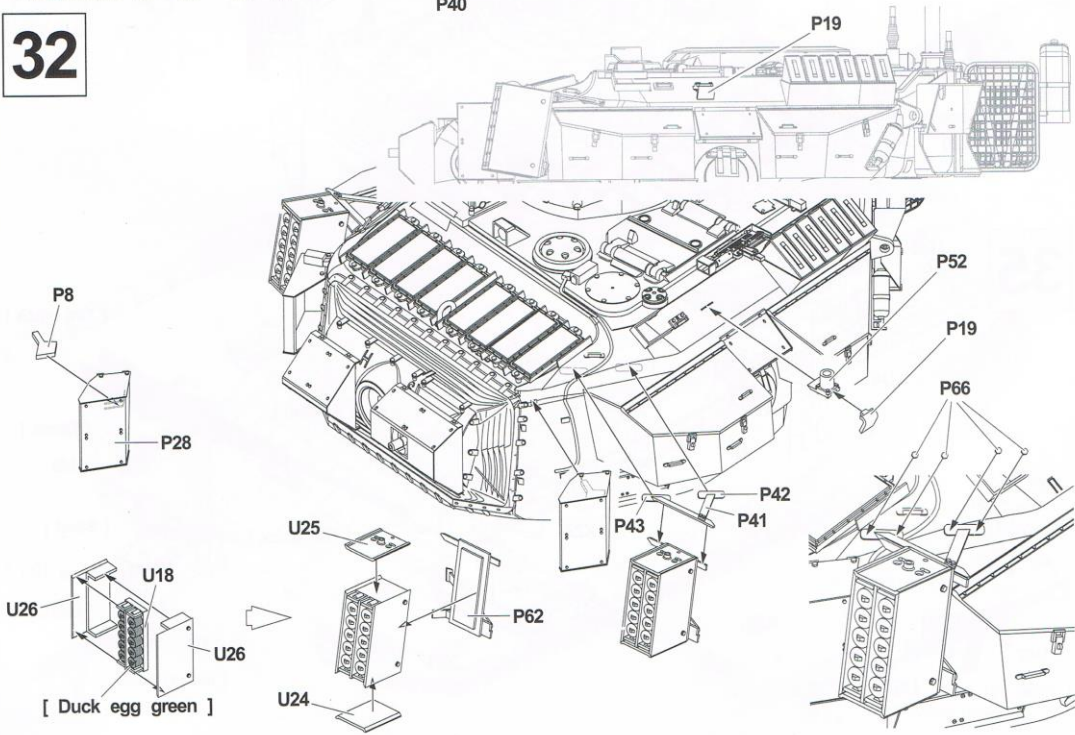

**33**

《 FN MAG 7.62mm machine gun 》  
《 FN MAG 7.62毫米機槍 》

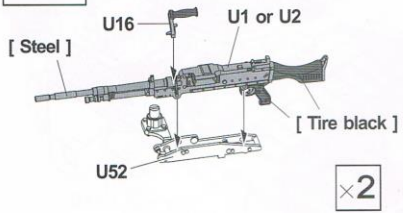

《 Commander's machine gun 》  
《 車長用機槍 》

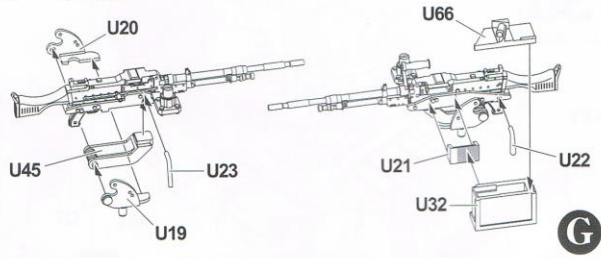

《 Loader's machine gun 》  
《 裝填手用機槍 》

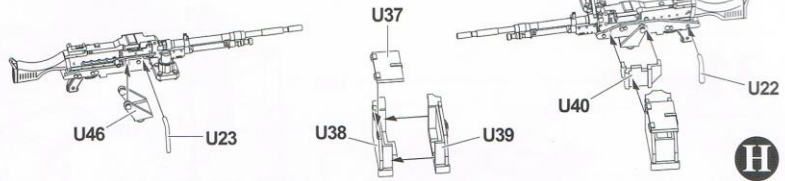

**34**

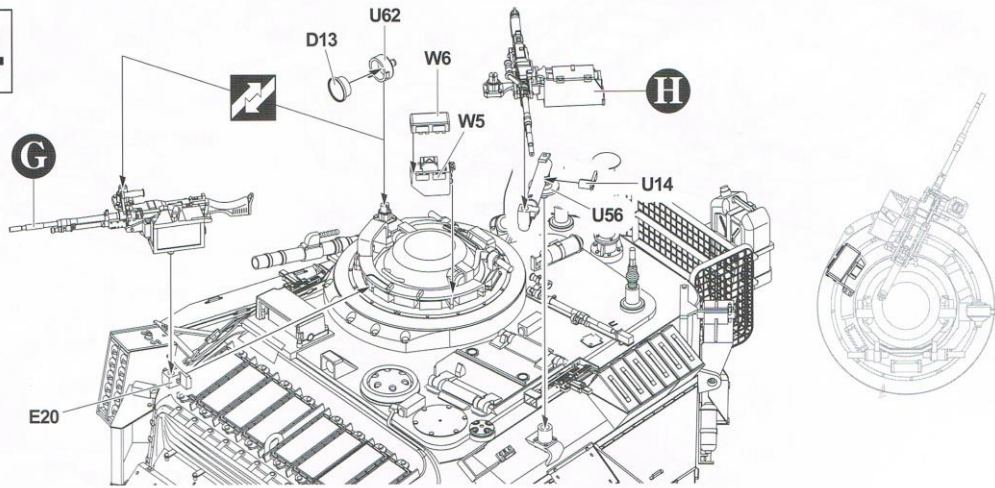

**35**

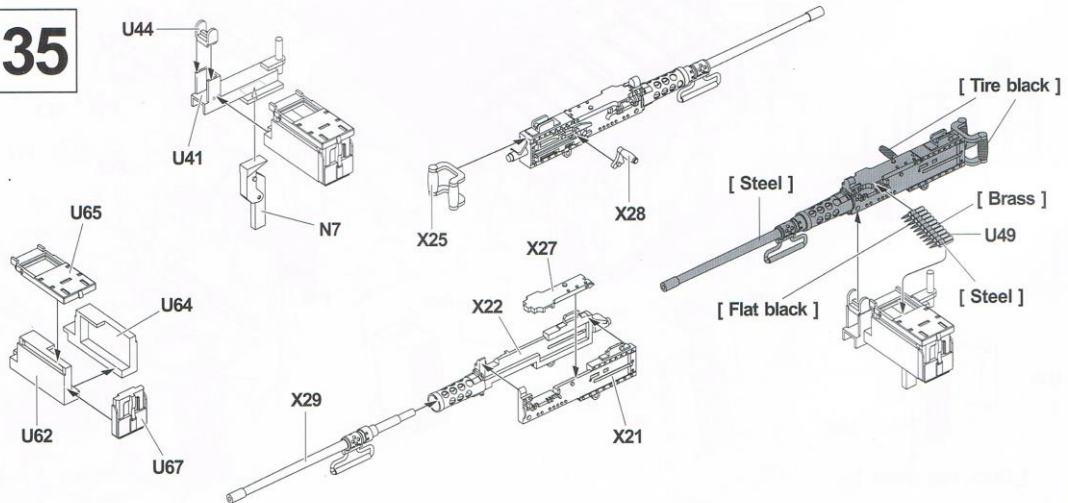



36

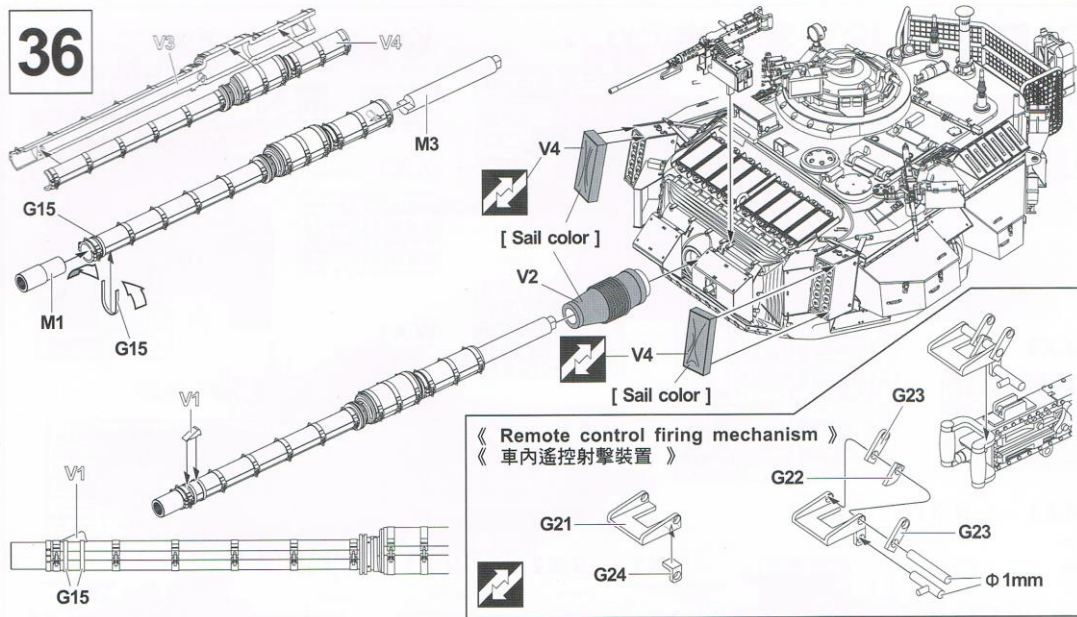

37

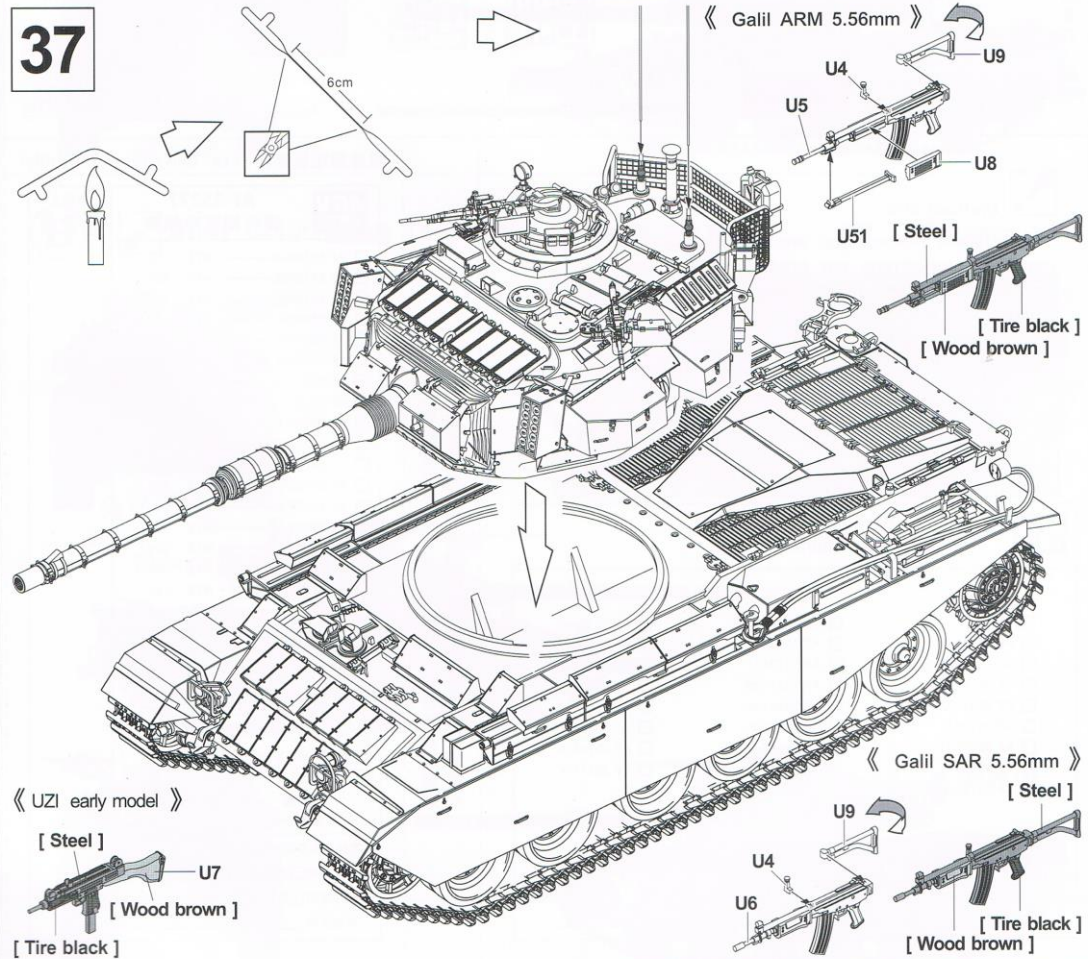

# PARTS LIST 零件表

AX1 AF 35100  
 BX2 AF 35100  
 CX1 AF 35100  
 DX1 AF 35041  
 EX2 AF 35100  
 LX1 AF 35124  
 UX2 AF 35267  
 PX1 AF 35267  
 WX1 AF 35282  
 IX1 AF 35100  
 MX1 AF 35277  
 RX24 AF 35100  
 QX2 AF 35267  
 TX1 AF 35102  
 SX2 AF 35124  
 VX1 AF 35267  
 JX1 AF 35277  
 M1  
 M2  
 X6  
 M3  
 RX2 AF 35041  
 GX1 AF 35277  
 TX2 AF 35100  
 DX1 AF 35100  
 NX1 AF 35124



## Instructions:

If for some reason, you are not fully satisfied or have questions concerning our product; Please use the form provide, and send it to our nearest representative or mail it directly to our office.

We will deal with that A.S.A.P.



## AF 35277 Parts Replacement Form

- |                                     |                                     |                                     |
|-------------------------------------|-------------------------------------|-------------------------------------|
| <input type="checkbox"/> AF 35100-A | <input type="checkbox"/> AF 35277-J | <input type="checkbox"/> AF 35124-S |
| <input type="checkbox"/> AF 35100-B | <input type="checkbox"/> AF 35100-K | <input type="checkbox"/> AF 35100-T |
| <input type="checkbox"/> AF 35100-C | <input type="checkbox"/> AF 35124-L | <input type="checkbox"/> AF 35102-T |
| <input type="checkbox"/> AF 35100-D | <input type="checkbox"/> AF 35277-M | <input type="checkbox"/> AF 35267-U |
| <input type="checkbox"/> AF 35041-D | <input type="checkbox"/> AF 35124-N | <input type="checkbox"/> AF 35277-V |
| <input type="checkbox"/> AF 35100-E | <input type="checkbox"/> AF 35267-P | <input type="checkbox"/> AF 35282-W |
| <input type="checkbox"/> AF 35277-G | <input type="checkbox"/> AF 35267-Q | <input type="checkbox"/> AF 35246-X |
| <input type="checkbox"/> AF 35100-H | <input type="checkbox"/> AF 35100-R | <input type="checkbox"/> AF 35277-Y |
| <input type="checkbox"/> AF 35100-I | <input type="checkbox"/> AF 35041-R |                                     |

Reason for replacement:  Missing  
 Broken

Signature: \_\_\_\_\_

限臺灣地區使用 For Taiwanese use only!



## AF 35277 零件補充申請表

- |                                     |          |
|-------------------------------------|----------|
| <input type="checkbox"/> AF 35100-A | NT\$ 100 |
| <input type="checkbox"/> AF 35100-B | NT\$ 300 |
| <input type="checkbox"/> AF 35100-C | NT\$ 260 |
| <input type="checkbox"/> AF 35100-D | NT\$ 80  |
| <input type="checkbox"/> AF 35041-D | NT\$ 80  |
| <input type="checkbox"/> AF 35100-E | NT\$ 300 |
| <input type="checkbox"/> AF 35277-G | NT\$ 250 |
| <input type="checkbox"/> AF 35100-H | NT\$ 180 |
| <input type="checkbox"/> AF 35100-I | NT\$ 300 |
| <input type="checkbox"/> AF 35277-J | NT\$ 160 |
| <input type="checkbox"/> AF 35100-K | NT\$ 160 |
| <input type="checkbox"/> AF 35124-L | NT\$ 260 |
| <input type="checkbox"/> AF 35277-M | NT\$ 200 |
| <input type="checkbox"/> AF 35124-N | NT\$ 120 |
| <input type="checkbox"/> AF 35267-P | NT\$ 200 |
| <input type="checkbox"/> AF 35267-Q | NT\$ 180 |
| <input type="checkbox"/> AF 35100-R | NT\$ 160 |
| <input type="checkbox"/> AF 35041-R | NT\$ 30  |
| <input type="checkbox"/> AF 35124-S | NT\$ 160 |
| <input type="checkbox"/> AF 35100-T | NT\$ 160 |
| <input type="checkbox"/> AF 35102-T | NT\$ 30  |
| <input type="checkbox"/> AF 35267-U | NT\$ 200 |
| <input type="checkbox"/> AF 35277-V | NT\$ 120 |
| <input type="checkbox"/> AF 35282-W | NT\$ 160 |
| <input type="checkbox"/> AF 35246-X | NT\$ 180 |
| <input type="checkbox"/> AF 35277-Y | NT\$ 120 |
| +郵寄費                                | NT\$ 80  |

(請填)總計NT\$ \_\_\_\_\_

零件補充原因:(請於  打 )

原包裝即  遺失或  毀損,

製作途中  遺失或  毀損,

其他原因 \_\_\_\_\_

申請人  
姓名 地址 電話



總代理戰鷹企業有限公司收本公司將儘速為您處理。  
 請將本表與該部品相同金額之郵政匯票一同寄至。



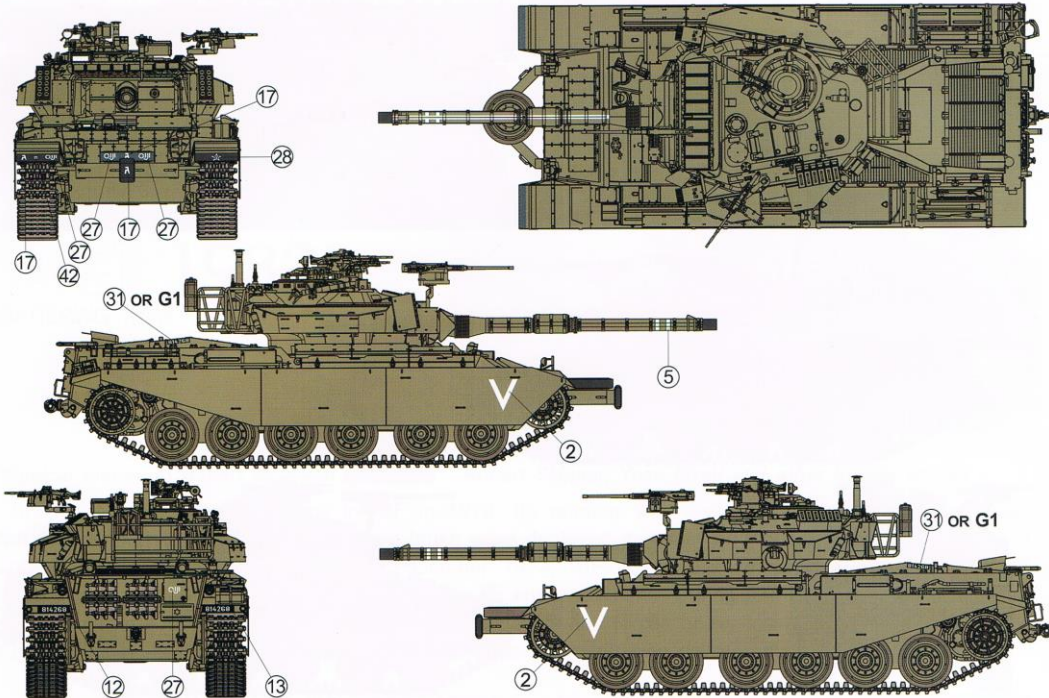

**A**  Body Color:  IDF green  Flat black  Flat white



**B**  Body Color:  IDF green  Flat black  Flat white

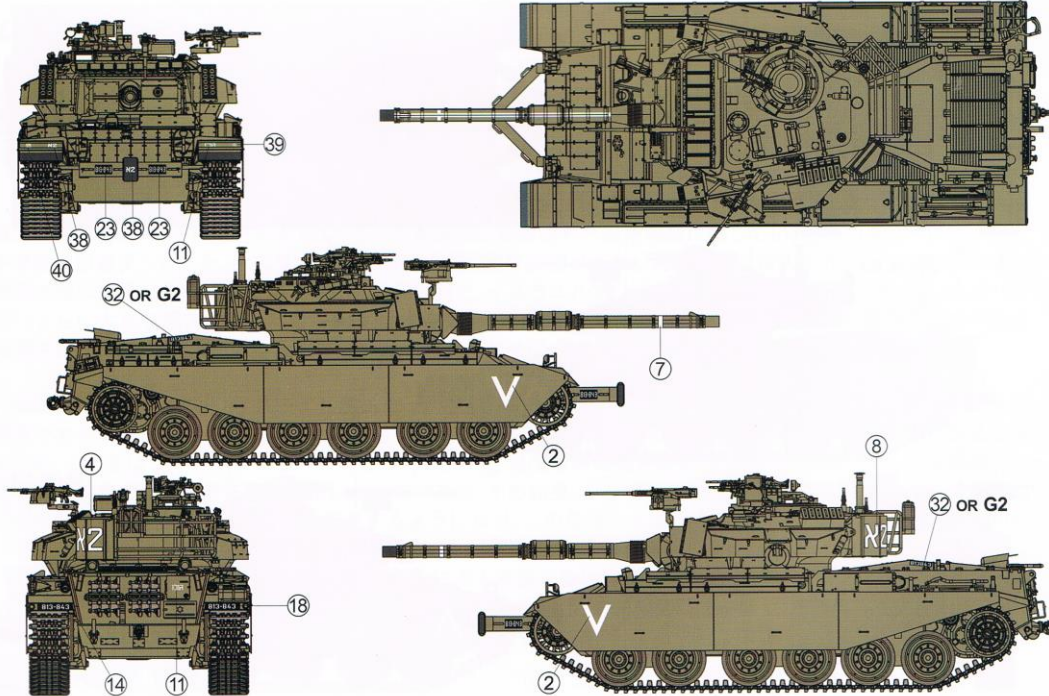

C



Body Color: IDF green



Flat black



Flat white

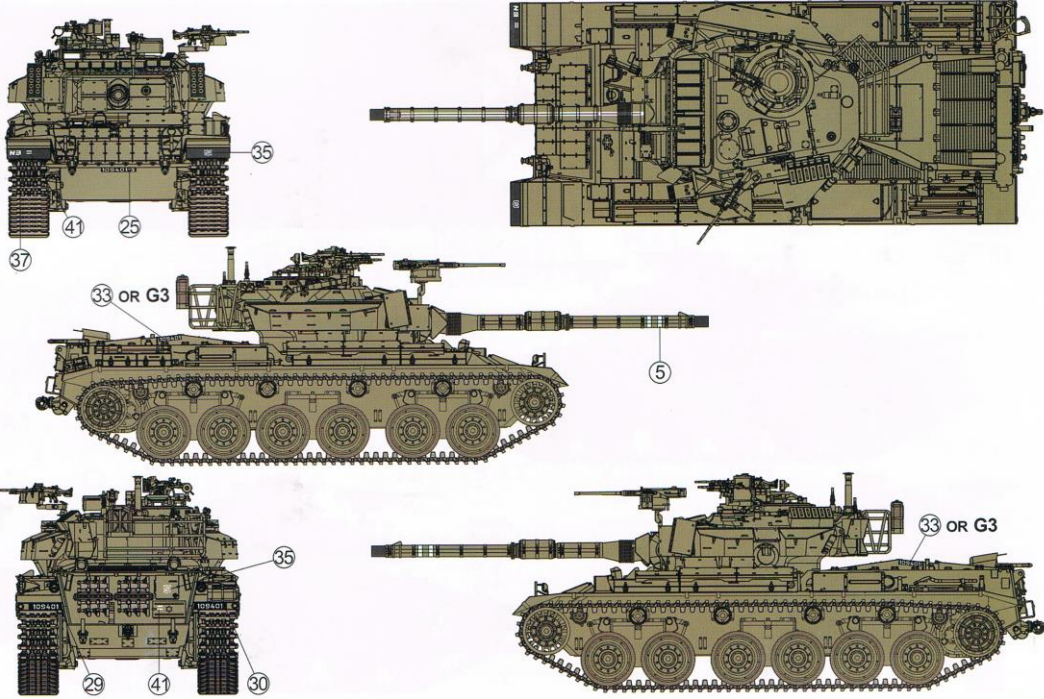

D



Body Color: IDF green



Flat black



Flat white

